

Assembly Instructions

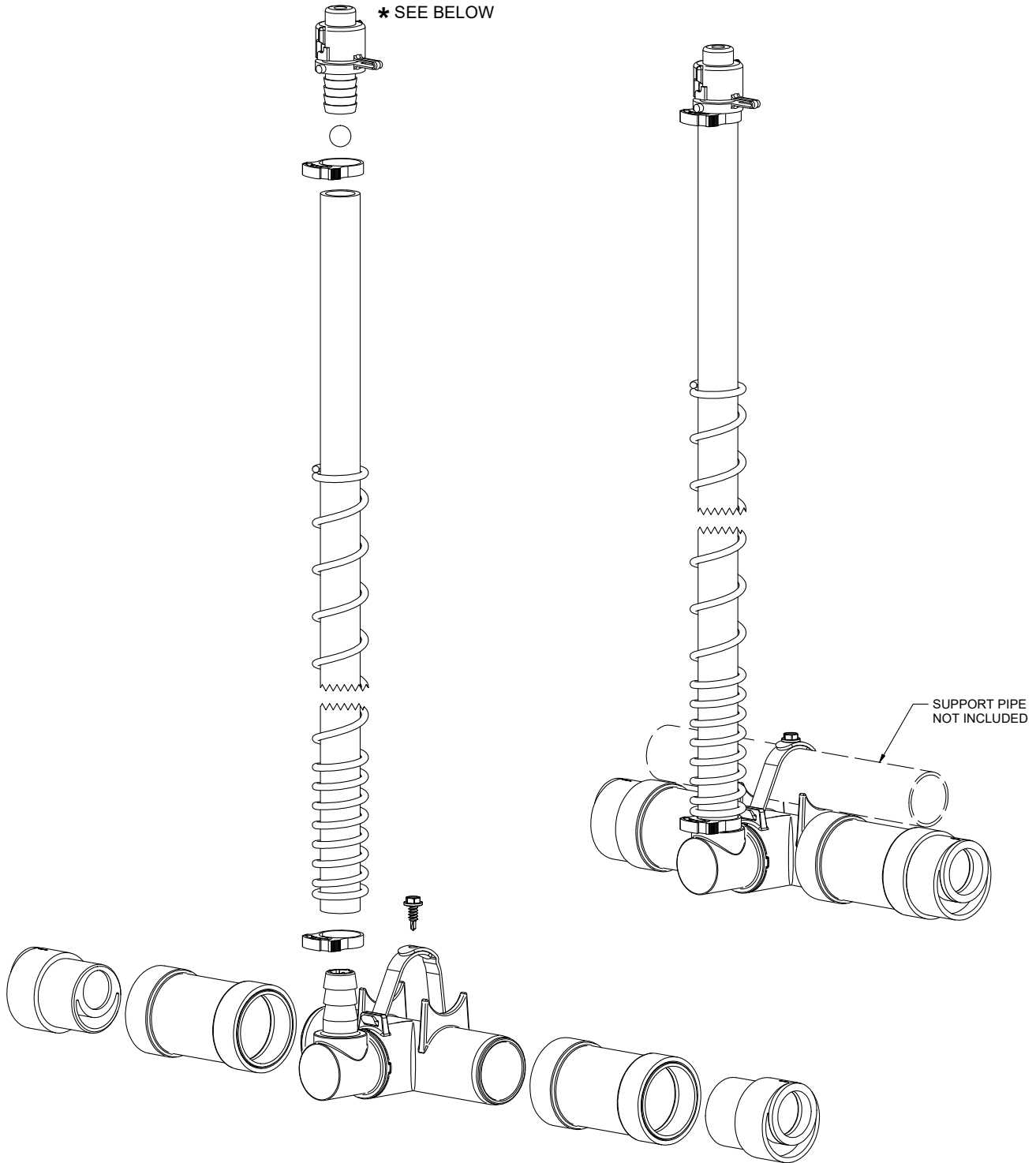

CAUTION

- DO NOT ALLOW THIS ITEM TO COME INTO CONTACT WITH PETROLEUM, PHENOL OR ALDEHYDE BASED PRODUCTS OR ANY OTHER CORROSIVE PRODUCT IN GENERAL.
- *IF PRESSURE DURING FLUSHING IS BELOW 5 PSI/0.35 BAR SEE GL1089

3977 COMPONENTS

PART NR.	QTY	DESCRIPTION
122-24	1	RISER TUBE: 24" / 60 CM
147	1	BALL: RISER TUBE
511	2	CLAMP: SNAP 0.746" - 0.848" DIA. - BLACK
1895	1	SPRING: RISER TUBE
2005	1	RISER TUBE CAP
2537	1	FASTENER: SCREW HEX WHD SELF TAPPING #8-18 X 1/2" LG
3890	1	RISER ASSEMBLY PART: BASE - FLEXIBLE
896	2	PIPE CONNECTOR: BIG ACE / BIG Z - BLACK
1369	2	ADAPTER: BIG ACE SPIGOT X ACE SLIP
3894	1	RISER ASSEMBLY PART: STABILIZING BRACKET - FRONT
3895	1	RISER ASSEMBLY PART: STABILIZING BRACKET - REAR

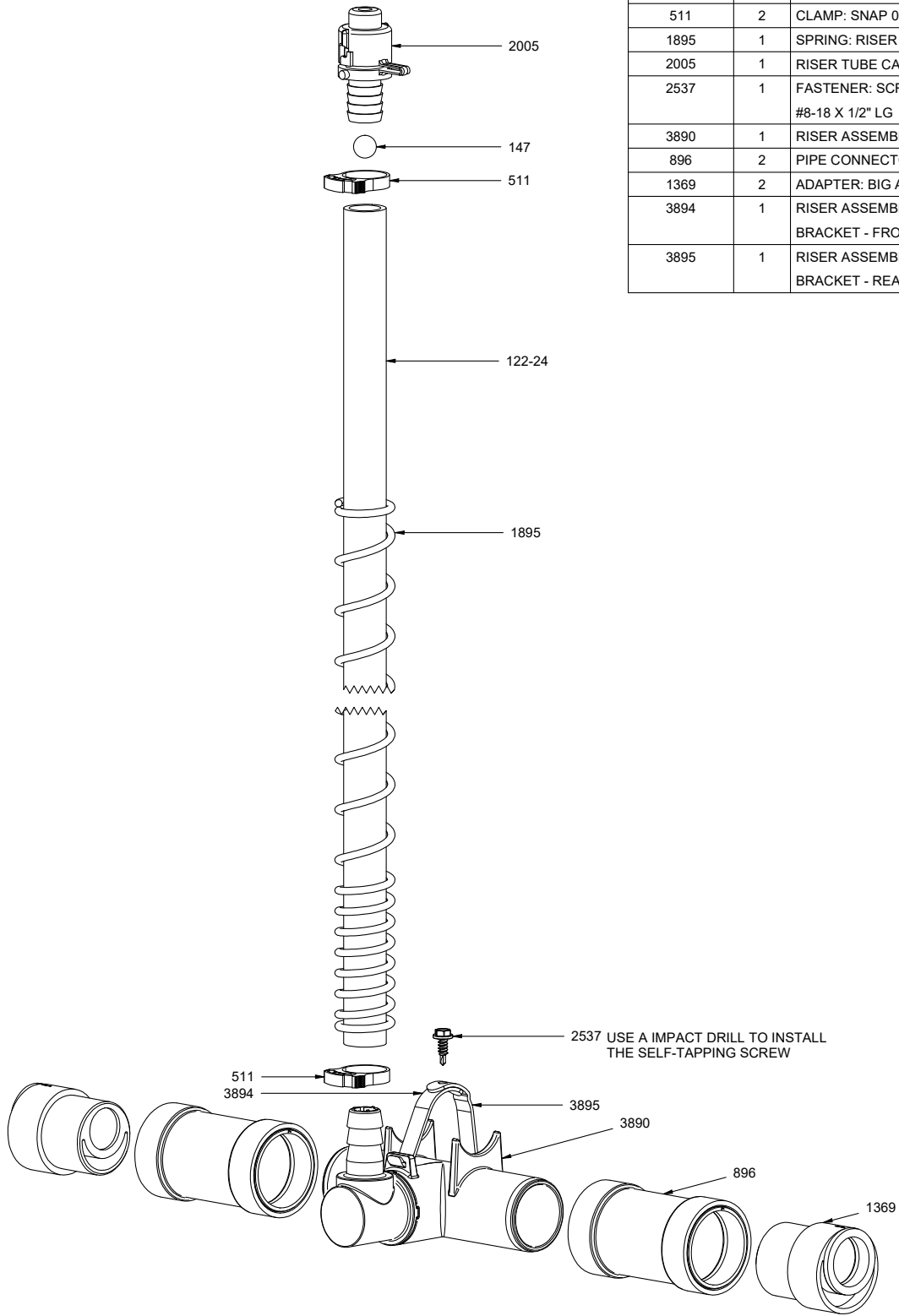

Ziggity Systems Inc.
 101 Industrial Parkway East
 Middlebury Indiana 46540-8549
 USA
 Tel: + 1 574.825.5849
 Fax: + 1 574.825.7674
 Web: www.ziggity.com