

product catalog



ZÄHBUILT

[www.zahbuilt.com](http://www.zahbuilt.com)

SONOMA MOROCCO SPECIAL ORDER





# Reimagining The Way We Live

Call : 321-308-3297

Email : [sales@zahbuilt.com](mailto:sales@zahbuilt.com)

Showroom : 325 East Drive, Melbourne, FL 32904

[www.zahbuilt.com](http://www.zahbuilt.com)



# TABLE OF CONTENTS

SPECIFICATIONS .....	1
DOOR STYLES .....	6
FINISHES .....	13
GRILL BASE CABINETS .....	22
CERAMIC GRILL CABINETS .....	27
BASE CABINETS .....	30
WALL CABINETS .....	40
TALL CABINETS .....	43
PANELS, FILLERS & ACCESSORIES .....	45
WINDSWEPT MOULDINGS .....	57
HOODS .....	63
BESPOKE.....	67







---

## specifications



# CABINET CONSTRUCTION SPECIFICATIONS

## CABINET BOX

Cabinet sides, top and bottom are constructed with a 3/4" thick, lightweight HDPE (LDPE) poly marine board that is UV stable. It is NOT PVC.

All of the components are assembled with "lockdowels"™. These fasteners are made from high strength plastic and CNC machined into the cabinet parts.

## EDGE BANDING

There is no edgebanding, the LDPE is solid black and all cabinet edges are black. The full overlay door covers all but 1/8" of the edge. This also eliminates possible edgebanding point of failure.

## CABINET BACK

All cabinets have a 1/4" thick (LDPE) back with 4" nailers top and bottom.

## SHELVES

Shelves are 3/4" thick LDPE. There are shelf holes drilled in 32mm (1 1/4") increments. All shelves are full depth.

## DRAWER BOXES

Standard drawer boxes are constructed with 3/4" LDPE sides and back with a 1/4" thick bottom and assembled with lock dowels. Full extension soft-close bottom mount slides are treated for corrosion.

## DOOR HINGES

Hinges are soft-close stainless steel 110° concealed hinges with 6 way adjustment.

## FINISHED ENDS

Finished ends can be purchased loose. Finished end panels are the thickness of the species panel, which adds to the overall width of a cabinet.

## TOE KICK

All base and tall cabinets are constructed on adjustable leg levelers. 3 1/2" to 5" high. Additional height levelers and spacers available.

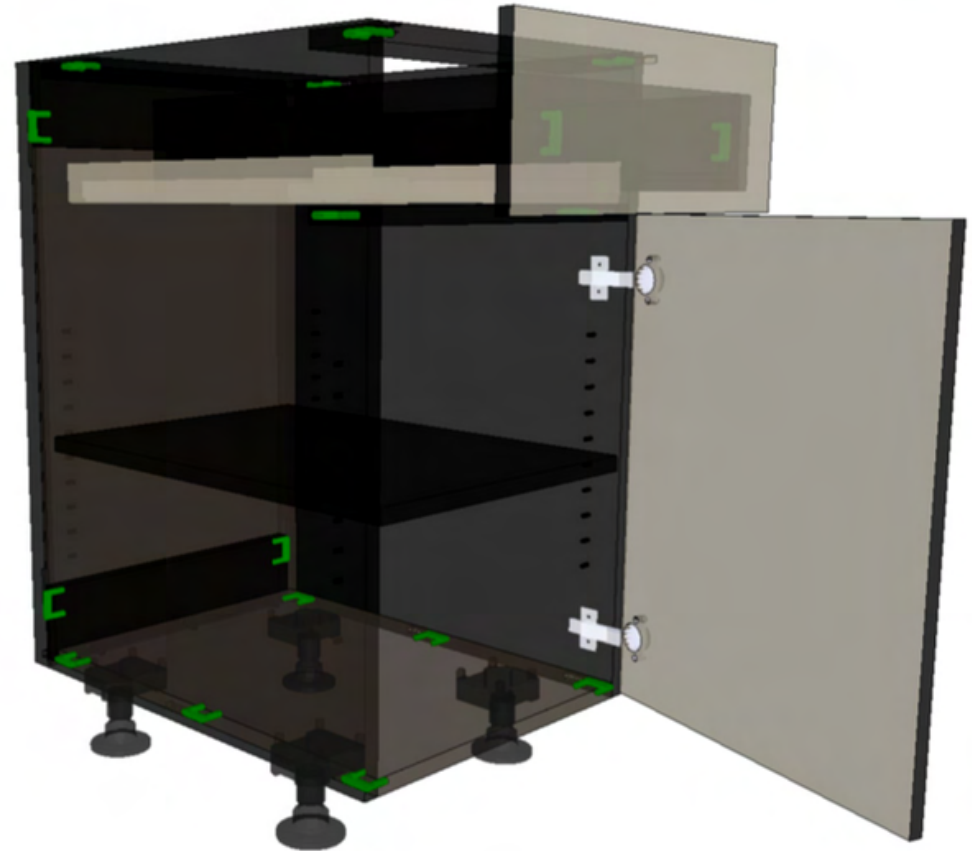





# CABINET STANDARDS

## GENERAL SPECIFICATIONS:

We manufacture our cabinet boxes using 3/4" Black LDPE (Low Density Polyurethane). LDPE is UV stable. Assembly is done with lock dowels. LDPE is not PVC

## CABINET SIZES:

Available in sizes listed only. To increase the depth of a cabinet, modification charges will apply. See modification section for up-charges.

**MINIMUM CABINET WIDTH:** With doors: 9" W based on the minimum width of available door styles. With drawers: 12" W

**MAXIMUM CABINET WIDTH:** To be warrantied, the maximum width of a specific cabinet type is the width listed as the largest available.

**MINIMUM HEIGHT:** With doors: 12" H

**MAXIMUM HEIGHT:** 90 1/2"

## STANDARD CABINET DEPTHS (DEFAULTS):

Wall cabinets: 12" D | Base cabinets: 24" D | Grill base cabinets: 28" D | Burner base cabinets: 28" D | Wall depth cabinets: 12" D |  
Base depth tall cabinets: 24" D

**MAXIMUM DEPTH:** 32" D. When the depth is increased for cabinets with drawers and/or roll out drawers, the drawer box depth remains 20" regardless of cabinet depth.

## FINISHED ENDS:

ZahBuilt provides finished ends as an applied panel, subject to additional up-charges.

## TOE KICK:

ZahBuilt provides plastic leg levelers that are adjustable from 3 1/2" H to 5" H. We also offer door matching toe kick planks

## EDGE BANDING

There is no edgebanding, the LDPE is solid black and all cabinet edges are black. The full overlay door covers all but 1/8" of the edge. This also eliminates possible edgebanding point of failure.



# GENERAL KNOWLEDGE

## GENERAL INSTALLATION GUIDELINES

- It is very important the cabinetry is installed level and plumb. This will ensure the doors hang properly. The fronts are set squarely at the factory. If the cabinet is not level, the doors and drawers will be skewed. Only after leveling should the doors be adjusted.
- To adjust the floor levelers, we recommend the use of the Hafele leveler tool (PN # 637.76.430) for easy access, available from ZahBuilt or Hafele direct.
- Use stainless steel screws and washers for installation hardware.
- Grill panels may be removed in order to trim and fit to the grill. The countertop thickness will determine the depth of the cut. Reattach the trimmed grill panel using lock dowels if accessible.
- The door adjustments are accessible by removing the cover plate on the hinge arm.
- There is a small amount of adjustment available on the drawer by using the dials on the drawer box clips.

## CABINETRY AND PARTS

- The LDPE cabinet parts saw and machines similar to MDF with smooth, non-splintered, chip free cuts.
- Cleans with soap and water. Use denatured alcohol or non oil based cleaners for greasy spots.
- All cabinet backs are 1/4" LDPE with 4" nailers top and bottom.
- We recommend 1-1/4" stainless steel washer head screws for joining cabinets and fillers, etc.
- Bases come with adjustable leg levelers, making installation easy on sloped floors.
- The toe plates are held in place with a friction clip on the leveler, additional screws could be used as necessary.

## GRILL ACCOMODATIONS

- An insulation jacket is required for gas grill cabinets.
- The cabinet needs to be minimum 3" wider than grill LINER, preferably 6" + (must be 6" wider for NEO collection).





# WORKING WITH OUR COMPACT HPL PANELS

## SAWING

- Compact panels can be cut on stationary circular saws, portable circular saws or jig saws using carbide tipped blades.
- We recommend alternating bevel fine cutting blades.
- Cutting too fast or too slow can result in surface discoloration. The discolored surface can be sanded off using 180 - 220 grit sandpaper.

## FINISHING

- Cut edges are dangerously sharp and need to be eased. We recommend routing the edges or breaking the edge with sand paper.
- Teak or mineral oil can be used to polish the edges and add a layer of protection.

## DRILLING

- Use high-speed steel drill bits.

## ATTACHING

- Stainless steel screws offer the most secure way of attaching Compact panels/fillers/overlay doors to our cabinetry.
- Carefully drill a pilot hole first. Stainless steel self tapping screws are a good option as Compact panels produce a fine thread and can be tapped.
- VHB tape is a good alternative for panels resting on a solid surface or to hold panels until the adhesive sets.

## BONDING

- We recommend West Systems "Six - Ten" epoxy when bonding compact to compact.
- Both surfaces should be clean and dry.
- For best adhesion, the back of the panels should be roughened with sandpaper.
- Clean the surface of the compact panel well with an oil free cleaner (do not use mineral spirits).
- Clamp for the minimum time recommended by the adhesive manufacturer given the ambient temperature.
- High Quality panel adhesives can be used for bonding unlike surfaces.





# LOUVER DOOR

## Specifications

SPECIES AVAILABLE: **Accoya**

CONSTRUCTION: **1" thick Stiles & Rails, 5/8" Panel**

RAIL WIDTH: **2 3/4"**

MINIMUM/MAXIMUM DOOR WIDTH: **12" / 24"**

MINIMUM/MAXIMUM DOOR HEIGHT: **12" / 60"**

**DRAWER FRONTS: The top drawer face is always a 7" high SLAB. drawer fronts over 8" can be ordered in a stile and rail configuration for an additional cost**

**FINISHED BACK OF DOOR: Painted Base Color only, no glaze**

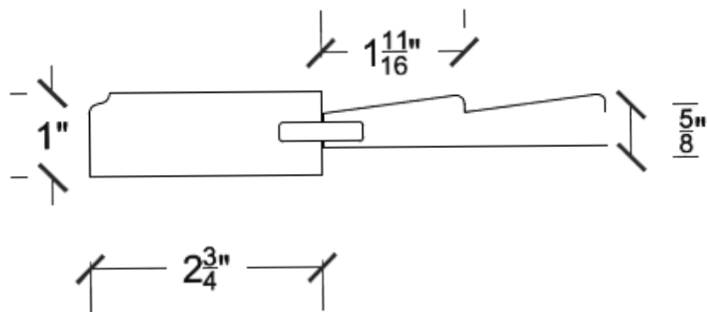

The center louver is accomplished by stacking 6" wide T & G moldings. The moldings "float" between the stiles and rails utilizing our patent pending design. This method of assembly mitigates movement that may split the frame or damage the paint.

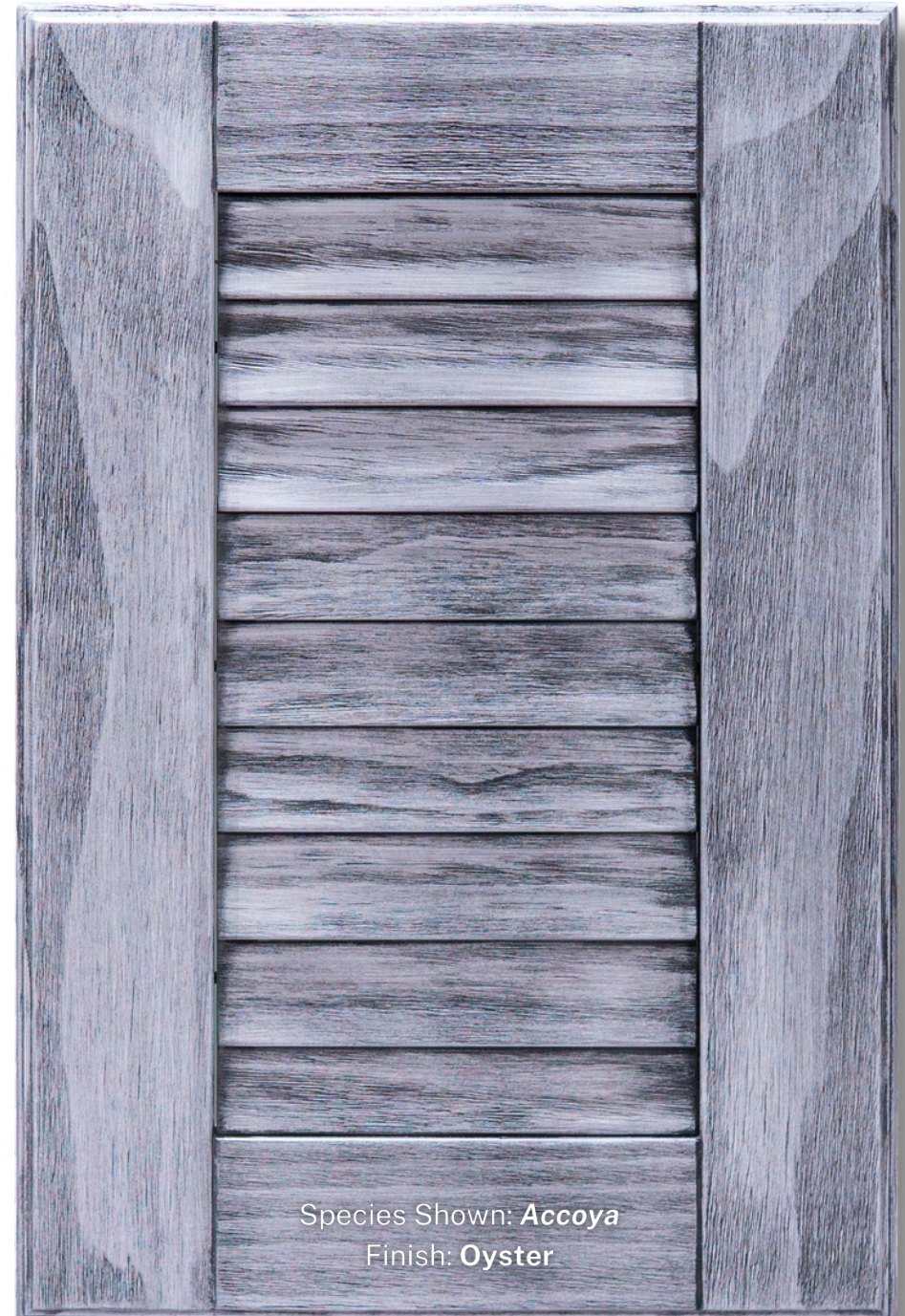

Species Shown: **Accoya**  
Finish: **Oyster**



# SHAKER DOOR

## Specifications

SPECIES AVAILABLE: **Accoya**

CONSTRUCTION: **1" thick Stiles & Rails, 5/8" Panel**

RAIL WIDTH: **2 3/4"**

MINIMUM/MAXIMUM DOOR WIDTH: **12" / 24"**

MINIMUM/MAXIMUM DOOR HEIGHT: **12" / 60"**

**DRAWER FRONTS: The top drawer face is always a 7" high SLAB. drawer fronts over 8" can be ordered in a stile and rail configuration for an additional cost**

**FINISHED BACK OF DOOR: Painted Base Color only, no glaze**

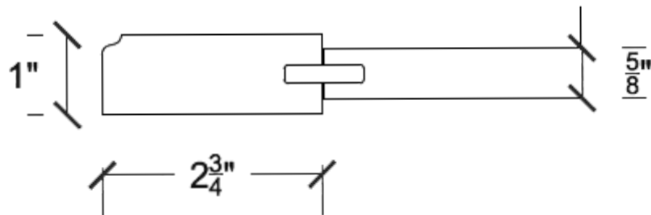

The center panel is "floating" between the stiles and rails utilizing our patent pending design. This method of assembly mitigates movement that may split the frame or damage the paint.



Species Shown: **Accoya**  
Finish: **Storm**





# SLAB DOOR / DRAWER

## Specifications

SPECIES AVAILABLE: **Accoya**

CONSTRUCTION: **Slab**

MINIMUM/MAXIMUM DOOR WIDTH: **12" - 24"**

MINIMUM/MAXIMUM DOOR HEIGHT: **12" - 60"**

DRAWER FRONTS: **1" thick slab with integral edge detail**

GRAIN DIRECTION, DOOR: **Grain direction is vertical on doors, horizontal grain not available**

GRAIN DIRECTION, DRAWER: **Grain direction is horizontal on drawers, vertical grain not available**

FINISHED BACK OF DOOR: **Painted base color only, no glaze**

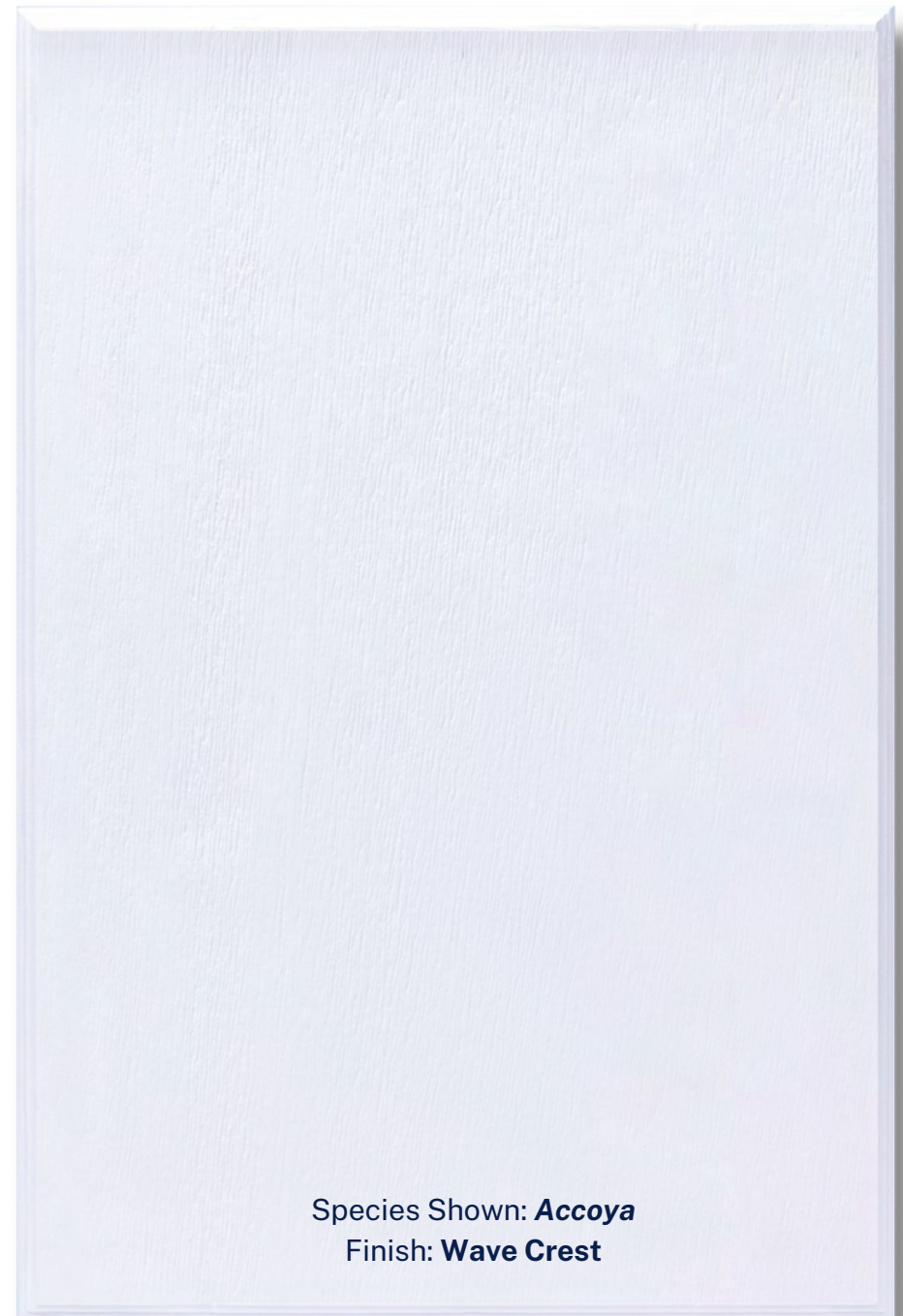

Species Shown: **Accoya**  
Finish: **Wave Crest**

# COMPACT DOOR / DRAWER

## Specifications

SPECIES AVAILABLE: **Compact**

CONSTRUCTION: **5/8" Compact (phenolic resin) door with micro chamfer with an ebony colored polished edge**

MINIMUM/MAXIMUM DOOR WIDTH: 9" / 21"

MINIMUM/MAXIMUM DOOR HEIGHT: 12" / 60"

DRAWER FRONTS: **5/8" thick slab with micro chamfer edges**

GRAIN DIRECTION, DOOR: **Grain direction is vertical by default.**

GRAIN DIRECTION, DRAWER: **Grain direction is horizontal by default.**

FINISHED BACK OF DOOR: **Same finish as the front**

DOOR STYLE FACTOR: **Also applies to all panels and fillers**

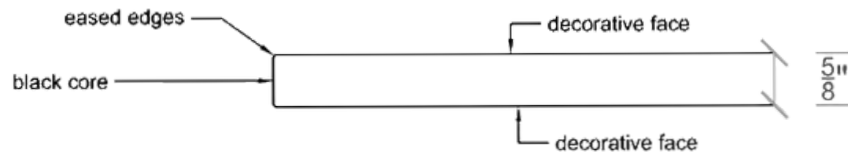

Species Shown: **Compact**  
Finish: **Gray Cedar**





# NEO DOOR / DRAWER FRONT

## Specifications

**AVAILABLE:** Brushed Aluminum finish or powder coated Black available

**CONSTRUCTION:** Aluminum with either a 1/4" thick compact or 3/4" thick Accoya insert

**ALUMINUM RAIL Width:** Front 3/8" W and back is 2 1/8" W.  
**There are miter joints in the corners**

**MINIMUM/MAXIMUM DOOR WIDTH:** 12" / 24"

**MINIMUM/MAXIMUM DOOR HEIGHT:** 12" / 60"

**GRAIN DIRECTION, DOOR:** Grain direction is vertical on door panel

**GRAIN DIRECTION, DRAWER:** Grain direction is horizontal on drawers, vertical grain not available. Top drawer is always 7" high

**FINISH OPTIONS:** Neo doors are available with all Windswept and Sonoma color selections

**FINISHED BACK OF DOOR:** Accoya back will be base color only, Compact will be same as face

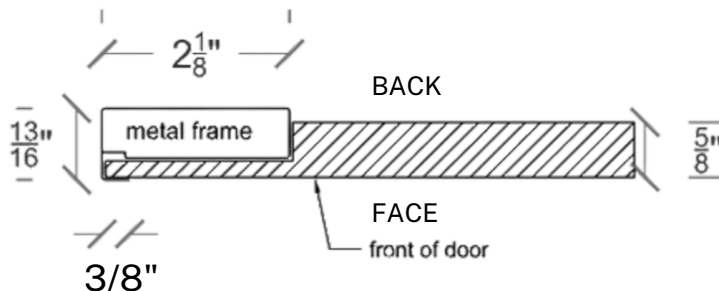

# ADDITIONAL NEO INFORMATION

CROSS SECTION

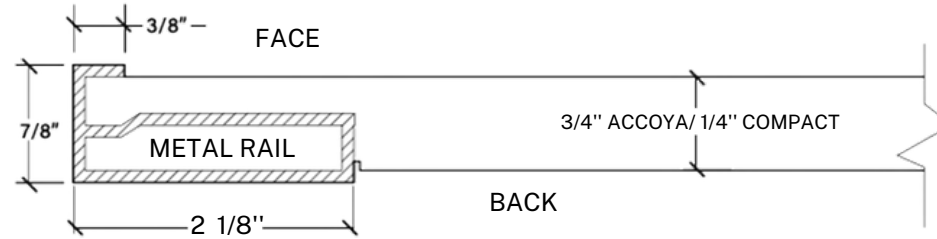

## NEOGRILL FRONTS:

Contempo Grill fronts will only have the Aluminum frame on the bottom and 2 sides to make it easier to install the insulated jacket.

Grill Cabinet must be a minimum of 6" wider than the LINER

Filler or Backer needed on Compact. >

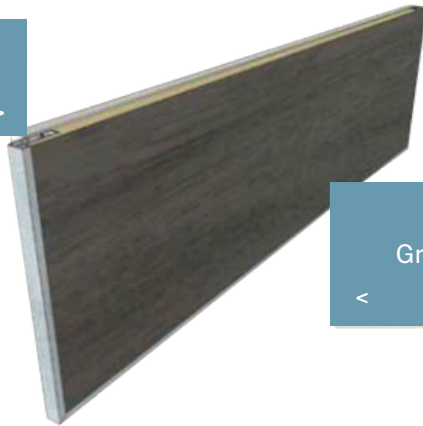

< Grill Front only has Aluminum Frame on 3 Sides









SANDSTONE



SEA WHITE



AVALON OAK

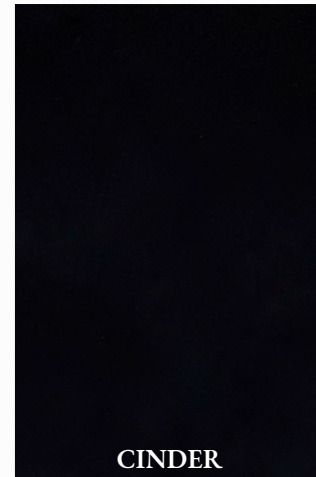

CINDER



GRAY CEDAR



NOCE HAVANA



RIVERSIDE OAK



TEAL



ROYAL WALNUT



FOG (GLOSS)  
\*GLOSS COLORS  
SUBJECT TO  
UPCHARGE



POLAR WHITE  
(GLOSS)  
\*GLOSS COLORS  
SUBJECT TO  
UPCHARGE

## HOW IT'S MADE:

Layers of sustainably harvested kraft paper are impregnated with thermosetting phenolic resins. The surface decorative finish layers are then applied on both sides and a transparent topcoat is added to the surface layers. This is cured to enhance weather and light protecting properties. The panels are then subject to high heat and pressure to bond the material into a non-porous, homogeneous material that is dense and perfect for outdoor surfaces like our cabinetry.

## DESIGN CONSIDERATIONS:

Compact doors, drawers and panels are available in a sleek, ebony-polished edge, offering a clean, contemporary look. ZahBuilt has proprietary 5/8" (16mm) thick





# WINDSWEPT LOUVER DOOR FINISHES

## DESIGN CONSIDERATIONS:

Doors painted in White will come standard with a white door back, all other paint colors, stain and glaze or weathered finishes come standard with base color back, regardless of cabinet interior color.

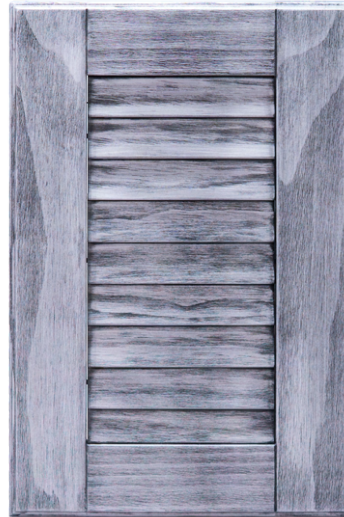

OYSTER



SAND



COCO BEAN



OYSTER (BACK)



SAND (BACK)

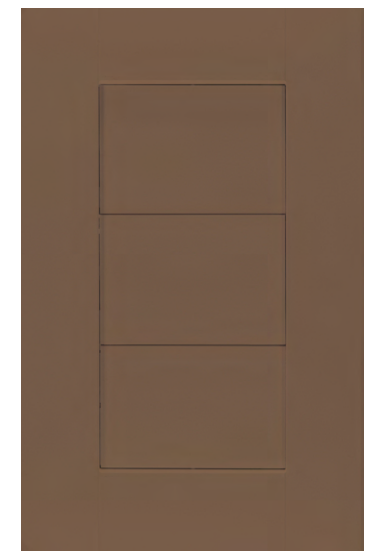

COCO BEAN (BACK)

# WINDSWEPT LOUVER DOOR FINISHES

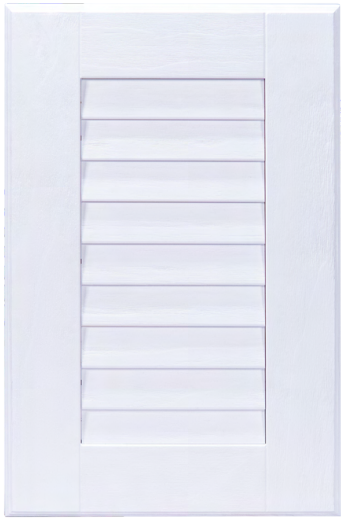

WAVE CREST



STORM



SAHARA



WAVE CREST (BACK)

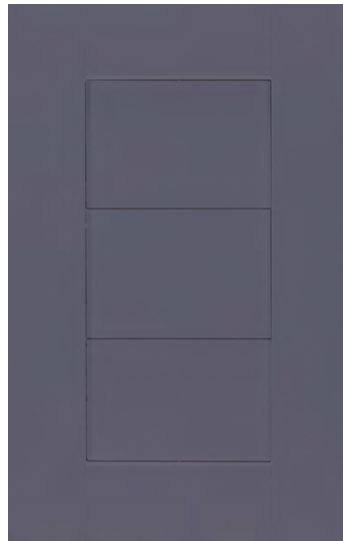

STORM (BACK)

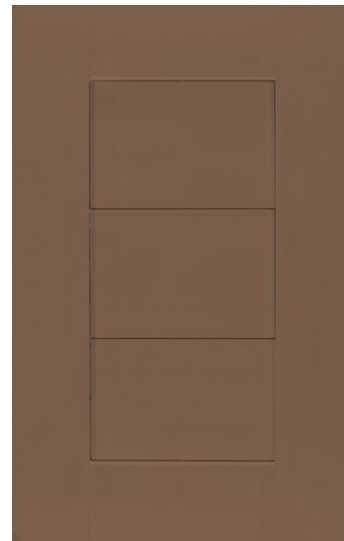

SAHARA (BACK)

## DESIGN CONSIDERATIONS:

Doors painted in White will come standard with a white door back, all other paint colors, stain and glaze or weathered finishes come standard with base color back, regardless of cabinet interior color.





# WINDSWEPT SHAKER DOOR FINISHES

## DESIGN CONSIDERATIONS:

Doors painted in White will come standard with a white door back, all other paint colors, stain and glaze or weathered finishes come standard with base color back, regardless of cabinet interior color.



OYSTER



SAND



COCO BEAN



OYSTER (BACK)



SAND (BACK)



COCO BEAN (BACK)

# WINDSWEPT SHAKER DOOR FINISHES



WAVE CREST



STORM



SAHARA



WAVE CREST (BACK)



STORM (BACK)

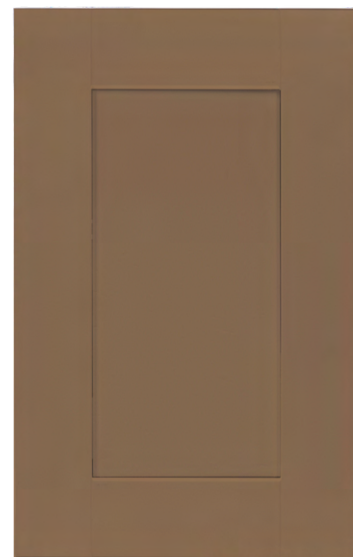

SAHARA (BACK)

## DESIGN CONSIDERATIONS:

Doors painted in White will come standard with a white door back, all other paint colors, stain and glaze or weathered finishes come standard with base color back, regardless of cabinet interior color.





# WINDSWEPT SLAB DOOR FINISHES

## DESIGN CONSIDERATIONS:

Doors painted in White will come standard with a white door back, all other paint colors, stain and glaze or weathered finishes come standard with base color back, regardless of cabinet interior color.



OYSTER



SAND



COCO BEAN

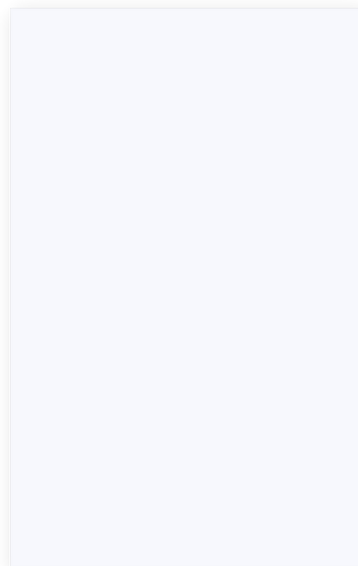

OYSTER (BACK)

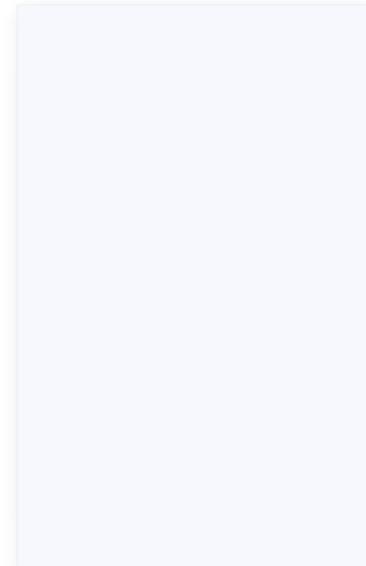

SAND (BACK)



COCO BEAN (BACK)

# WINDSWEPT SLAB DOOR FINISHES

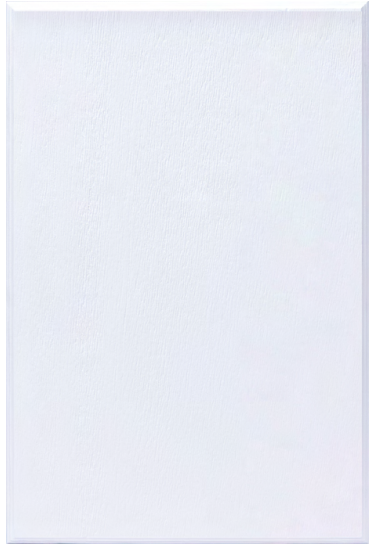

WAVE CREST



STORM



SAHARA

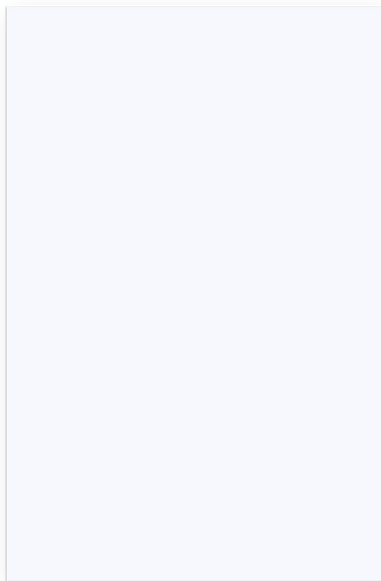

WAVE CREST (BACK)

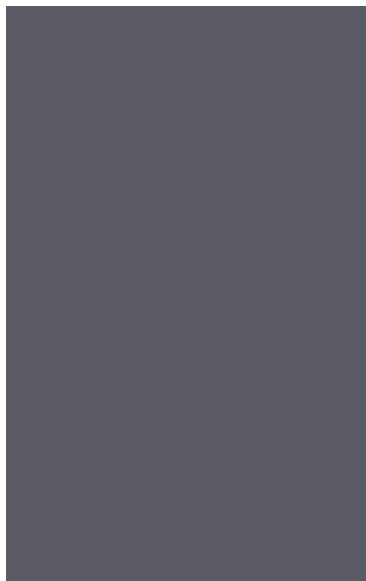

STORM (BACK)



SAHARA (BACK)

## DESIGN CONSIDERATIONS:

Doors painted in White will come standard with a white door back, all other paint colors, stain and glaze or weathered finishes come standard with base color back, regardless of cabinet interior color.



# CUSTOM COLOR OPTIONS

## WINDSWEPT CUSTOM COLOR PROGRAM



**SKU**

WCCP

### Design Considerations:

- Only available in solid colors, no glazes
- Standard selection of solid paint colors
- \$250 NET sample cost for approval is mandatory
- Add 2 weeks to lead time
- Approximate 10% cost increase over standard Windswept door cost

## COMPACT CUSTOM COLOR PROGRAM

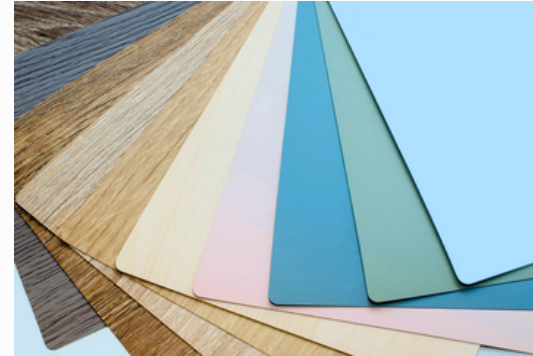

**SKU**

CCCP

### Design Considerations:

- Ask your sales rep for current selections and lead time
- Add 8-12 weeks to lead time
- \$2,500 NET cost for custom color
- Approximate 15% cost increase over Compact door cost

**Call : 321-308-3297**

**Email : [sales@zahbuilt.com](mailto:sales@zahbuilt.com)**

**[www.zahbuilt.com](http://www.zahbuilt.com)**





---

## grill base cabinets



# GRILL BASE SPECIFICATIONS

- Grill/side burner bases are available from 18" to 78" wide constructed from 3/4" black LDPE and assembled with Lockdowels and strategic stainless steel screws
- Grill bases are 30 1/2" tall with 4" adjustable plastic leveler legs
- Grill bases have removable/trimmable "L" shaped risers to support the grill liner
- Grill base must be a minimum 3" wider than grill LINER, preferably 6" + (must be 6" wider for NEO collection)
- Grill bases are 28" deep as a standard
- All grills require an insulation jacket, generally this requires a base cabinet at least 6" wider than the grill
- All grill bases have a 12 1/2" high front that needs to be cut to accommodate the liner dimensions, the final height is determined by the countertop thickness (grill height minus countertop thickness = front cut out)
- Standard propane tanks will slide under the grill due to our patent pending aluminum drop down tray, this tray also provides a gas ventilation
- Cabinet edges are black

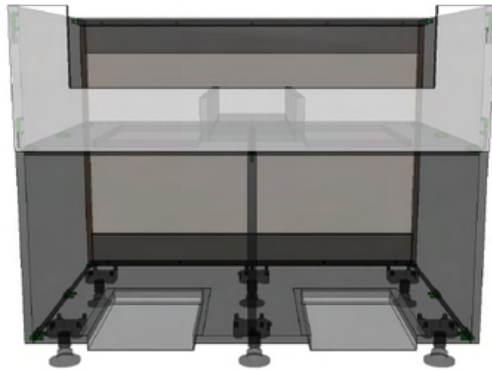

Patent Pending Ventilation/Propane tank clearance trays are installed into the bottom of all grill base and burner base cabinets in order to prevent potential gas build-up within the cabinets.



LDPE risers are trimmed on site to provide the proper grill height. The stretcher and riser system allows air flow for proper ventilation. **Place risers near to/above the partitions.**



# STANDARD GRILL BASE CABINETS

2 DOORS



## SKU

GB30-2  
GB36-2  
GB39-2  
GB42-2

**Design Considerations:**

- Cabinet is 28" DEEP
- Front panel is 12 1/2" H
- Panel can be cut on site to fit individual grills
- Doors are 17 3/4" H

**Partition:**

- Cabinets 36" W and wider will have a centered vertical partition between the doors

3 DOORS



## SKU

GB54-3  
GB60-3

**Design Considerations:**

- Cabinet is 28" DEEP
- Front panel is 12 1/2" H
- Panel can be cut on site to fit individual grills
- Doors are 17 3/4" H

**Partition:**

- Cabinets 36" W and wider will have a centered vertical partition between the doors

4 DOORS

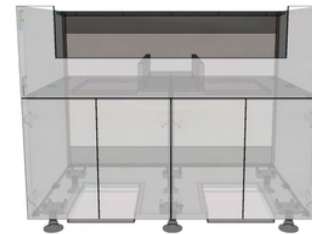

## SKU

GB45-4  
GB48-4  
GB54-4  
GB60-4  
GB72-4  
GB78-4

**Design Considerations:**

- Cabinet is 28" DEEP
- Front panel is 11 7/8" H
- Panel can be cut on site to fit individual grills
- Doors are 17 3/4" H

**Partition:**

- Cabinets will have a partition separating the doors



# GRILL BASES WITH DRAWERS

4 DRAWERS



## SKU

- GB30-4D
- GB36-4D
- GB39-4D
- GB42-4D
- GB45-4D
- GB48-4D
- GB54-4D
- GB60-4D
- GB72-4D
- GB78-4D

**Design Considerations:**

- Grill base is 28" deep
- Front panel is 12 1/2" high to be cut by installer
- Drawer fronts are 8 3/4" high
- Drawer fronts over 8" can be ordered in a stile and rail configuration for an additional cost

**Partition:**

- There is a full depth partition separating the drawers

2 DRAWERS  
& 1 DOOR



## SKU

- GBC30-(L,R)
- GBC36-(L,R)
- GBC39-(L,R)
- GBC42-(L,R)
- GBC30-(L,R)
- GBC36-(L,R)
- GBC39-(L,R)
- GBC42-(L,R)

**Design Considerations:**

- Grill base is 28" deep
- Front panel is 12 1/2" high to be cut by installer
- Drawer fronts are 8 3/4" high
- Drawer fronts over 8" can be ordered in a stile and rail configuration for an additional cost

**Partition:**

- There is a full depth partition separating the drawers
- The 'R' or 'L' signify what side the drawers are on

2 DRAWERS  
& 1 DOOR



## SKU

- GBC48 (L,R)
- GBC54-(L,R)
- GBC60-(L,R)
- GBC72-(L,R)
- GBC78-(L,R)
- GBC45-(L,R)
- GBC54-(L,R)
- GBC60-(L,R)
- GBC72-(L,R)
- GBC78-(L,R)

**Design Considerations:**

- Grill base is 28" deep
- Front panel is 12 1/2" high to be cut by installer
- Drawer fronts are 8 3/4" high
- Drawer fronts over 8" can be ordered in a stile and rail configuration for an additional cost

**Partition:**

- There is a full depth partition separating the drawers
- The 'R' or 'L' signify what side the drawers are on

## BURNER BASE CABINETS

1 DOOR /  
BURNER BASE

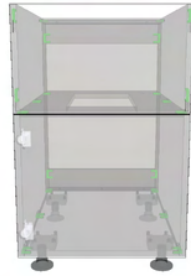

SKU

BB15  
BB18  
BB21  
BB24

Design Considerations:

- Burner base is 28" deep
- Front panel is 12 1/2" high to be cut by installer

1 DRAWER  
BURNER BASE

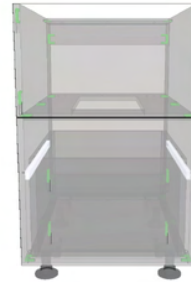

SKU

BB15-1D  
BB18-1D  
BB21-1D  
BB24-1D

Design Considerations:

- Burner base is 28" deep
- Front panel is 12 1/2" high to be cut by installer
- Drawer front is 17 3/4" high
- Drawer box is 12" H x 20" D
- Drawer fronts over 8" can be ordered in a stile and rail configuration for an additional cost





---

ceramic grill cabinets



# STANDARD CERAMIC GRILL CABINETS

## WINDSWEPT CERAMIC GRILL CABINETS

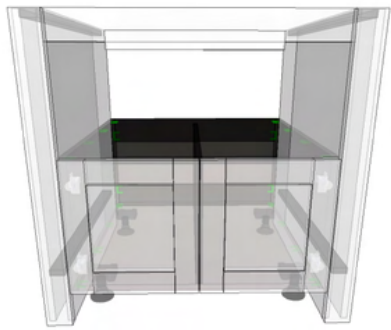

**SKU**

WCG34.5  
WCG30.5  
DOOR

**Design Considerations:**

- End panels are 30" deep and 3" wide
- For suspended application, see Specialty low base
- Overall H is 34 1/2" or 30 1/2"
- Overall W is 36"
- Inside dimension is 30" W
- There is a vertical center partition
- A non-combustible surface (stone) must be installed on the resting platform

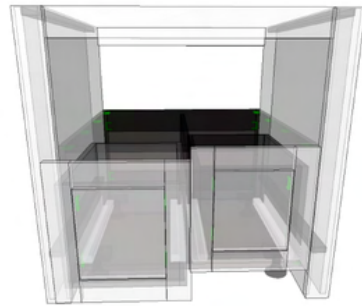

**SKU**

WCGD34.5  
WCGD30.5  
DRAWER

**Design Considerations:**

- End panels are 30" deep and 3" wide
- For suspended application, see Specialty low base
- Overall H is 34 1/2" or 30 1/2"
- Overall W is 36"
- Inside dimension is 30" W
- There is a vertical center partition
- Drawer box is 10" high
- A non-combustible surface (stone) must be installed on the resting platform

## COMPACT CERAMIC GRILL CABINETS

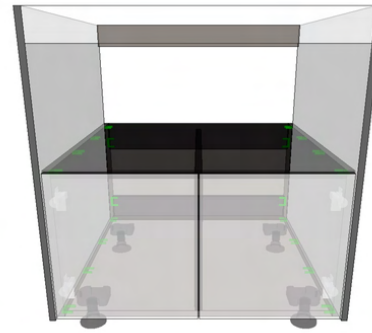

**SKU**

CCG34.5  
CCG30.5  
DOOR

**Design Considerations:**

- End panels are 30" deep and 5/8" wide
- For suspended application, see Specialty low base
- Optional mitered matching front edges available
- Overall H is 34 1/2" or 30 1/2"
- Overall W is 36"
- Inside dimension is 34 3/4" W
- There is a vertical center partition
- A non-combustible surface (stone) must be installed on the resting platform

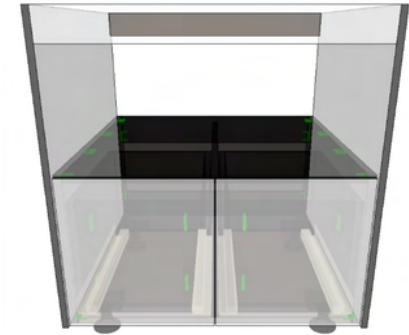

**SKU**

CCGD34.5  
CCGD30.5  
DRAWER

**Design Considerations:**

- End panels are 30" deep and 5/8" wide
- For suspended application, see Specialty low base
- Optional mitered matching front edges available
- Overall H is 34 1/2" or 30 1/2"
- Overall W is 36"
- Inside dimension is 34 3/4" W
- There is a vertical center partition
- Drawer box is 10" high
- A non-combustible surface (stone) must be installed on the resting platform



# BOW FRONT CERAMIC GRILL CABINETS

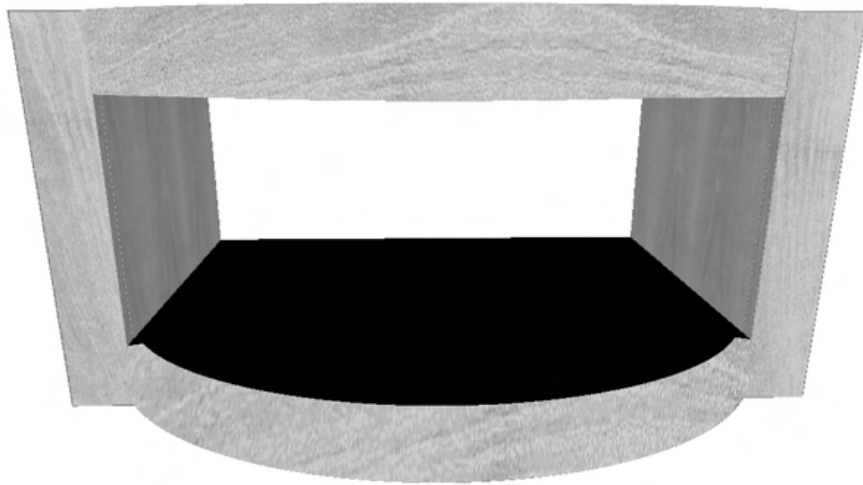

WINDSWEPT SUSPENDED BOW FRONT  
SKU  
WSBF-20

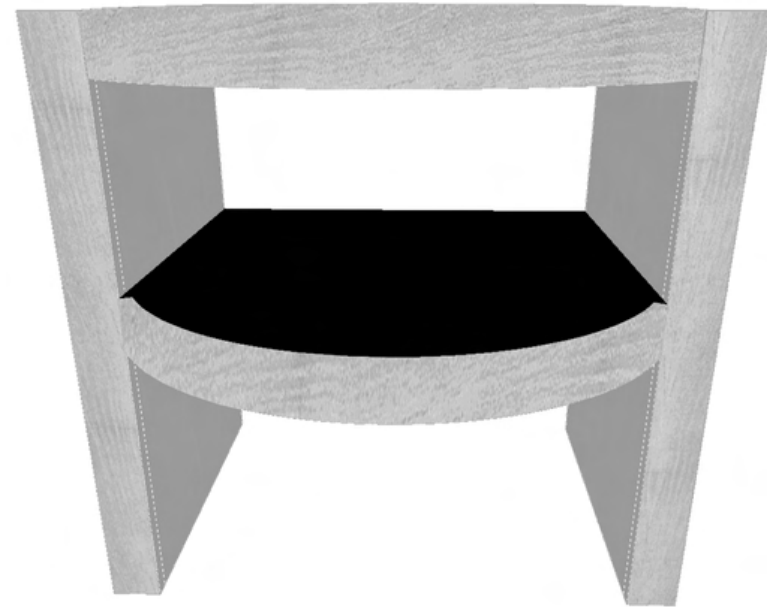

WINDSWEPT FREE STANDING BOW FRONT  
SKU  
WFSBF- 34.5

## DESIGN CONSIDERATIONS:

- End panels are 25" deep x 3" wide
- Overall height of suspended cabinet is 20", including 2 3/4" top and bottom rails  
(14" clear between)
- Overall height of free standing unit is 34 1/4"
- Overall width is 36"
- Inside dimension is 30" wide
- Depth to end of radius is 34"
- Radius of arch is approx. 27" outside
- A non-combustible surface (stone) must be installed on the resting platform



---

base cabinets



# STANDARD BASE CABINET SPECIFICATIONS

All ZahBuilt boxes are constructed from 3/4" black LDPE panels, making them weather resistant. Assembled with Lockdowels

- Full Access, frameless construction
- Standard depth is 24" deep, can be ordered 28" deep. Drawers remain 20" deep
- 1/4" LDPE thick cabinet backs with 4" nailers top and bottom
- Full depth adjustable shelves
- 110° soft-close stainless steel concealed hinges
- Finished ends can be purchased loose or factory applied
- Undermount full extension 20" slides, concealed by drawer sides and treated with corrosion blocker
- Drawer boxes are 3/4" LDPE with 1/4" bottoms. Assembled with lockdowels
- Standard base cabinets are 30 1/2" H plus an adjustable leg leveler (standard toe kick is 4")

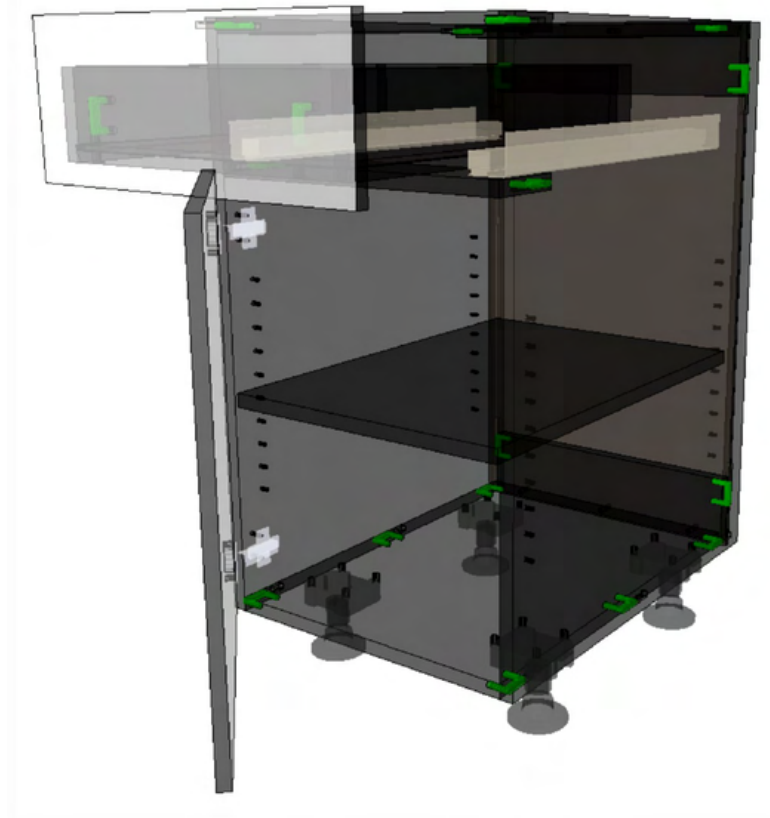

# STANDARD BASE CABINETS

FULL HEIGHT  
DOOR

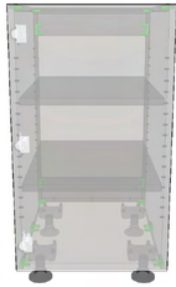

**SKU**

BFH12  
BFH15  
BFH18  
BFH21

**Design Considerations:**

- 24" deep
- 2 adjustable shelves
- Can be order 28" deep
- 'L' or 'R' signifies door hinge location

2 FULL HEIGHT  
DOORS

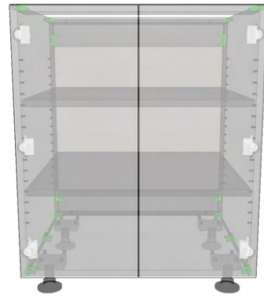

**SKU**

BFH24-2  
BFH27-2  
BFH30-2  
BFH3302  
BFH36-2

**Design Considerations:**

- 24" deep
- 2 adjustable shelves
- Can be order 28" deep

DRAWER OVER  
DOOR

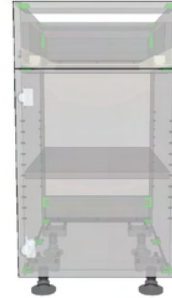

**SKU**

B12  
B15  
B18  
B21

**Design Considerations:**

- 24" deep
- Top drawer face is 7" high slab
- Drawer box is 4" x 20" deep
- 1 adjustable shelf
- Can be ordered 28" deep, drawer box will remain 20" deep

DRAWER OVER  
DOORS

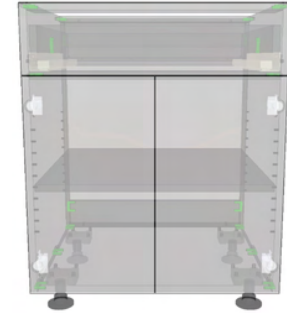

**SKU**

B24-2  
B27-2  
B30-2  
B33-2  
B36-2

**Design Considerations:**

- 24" deep
- Top drawer face is 7" high slab
- Drawer box is 4" x 20" deep
- 1 adjustable shelf
- Can be ordered 28" deep, drawer box will remain 20" deep



# DRAWER BASE CABINETS

3 DRAWER

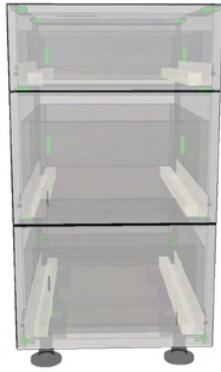

## SKU

- B3D12
- B3D15
- B3D18
- B3D21
- B3D24
- B3D27
- B3D30
- B3D33
- B3D36

**Design Specifications:**

- 24" deep cabinet
- Top drawer face is 7" high slab
- Top drawer box is 4" high
- Drawer Face 2 and 3 are 11 1/2" high
- Drawer Boxes 2 and 3 are 8" high
- Can be ordered 28" deep, drawer box will remain 20" deep
- drawer fronts over 8" can be ordered in a stile and rail configuration for an additional cost

2 DRAWER

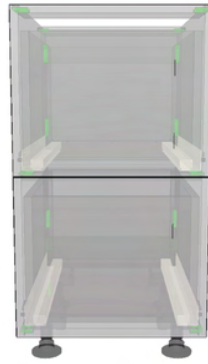

## SKU

- B2D12
- B2D18
- B2D21
- B2D24

**Design Specifications:**

- 24" deep cabinet
- Both Drawer faces are 15" high
- Both drawer boxes are 10" high
- Can be ordered 28" deep, drawer box will remain 20" deep
- drawer fronts over 8" can be ordered in a stile and rail configuration for an additional cost

ROLL OUTS



## SKU

- RO4
- RO8

**Design Specifications:**

- 20" deep box
- 4" or 8" deep
- Full extension under mount slides
- Slides are behind front
- 1" spacer on hinge sides

# SINK BASE CABINETS

1 FULL HEIGHT  
DOOR

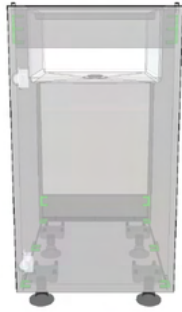

**SKU**

SBFH18 (L,R)  
SBFH21 (L,R)

2 FULL HEIGHT  
DOORS

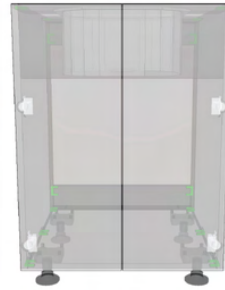

**SKU**

SBFH24  
SBFH27  
SBFH30  
SBFH33  
SBFH36

1 DOOR FALSE  
FRONT

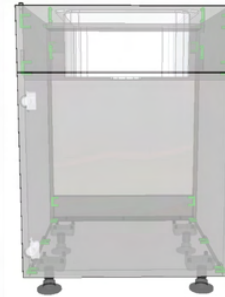

**SKU**

SBFF18 (L,R)  
SBFF21 (L,R)

2 DOOR FALSE  
FRONT

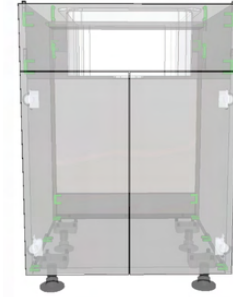

**SKU**

SBFF24  
SBFF27  
SBFF30  
SBFF33  
SBFF36

**Design Considerations:**

- (L,R) refers to door hinge location

**Sink Skirt:**

- 4" sink skirt including top stretcher

**Partitions:**

- Sink cabinets have no interior partition (unless requested)

**Shelves:**

- Sink cabinets have no shelves

**Design Considerations:**

- (L,R) refers to door hinge location

**Sink Skirt:**

- 8 1/4" sink skirt including top stretcher

**Partitions:**

- Sink cabinets have no interior partition

**Shelves:**

- Sink cabinets have no shelves
- 7" high slab FF



# SPECIALTY BASE CABINETS

SPICE PULLOUT



**SKU**

BSP9

Design Considerations:

- Only available 9" wide
- 1 fixed shelf on center
- 2" lip on both sides of fixed shelves

HANGING CUTLERY PULLOUT



**SKU**

BGA9

Design Considerations:

- Only available 9" wide
- Approx. 26" clear inside height
- 5 stainless steel hanging hooks

LOW HEIGHT BASE DOORS



**SKU**

LBH24  
LBH30  
LBH36

Design Considerations:

- Cabinet is 12" high plus 4" adjustable legs
- Has a center partition
- Can support a ceramic grill
- Standard is 24" deep

LOW HEIGHT BASE DRAWERS

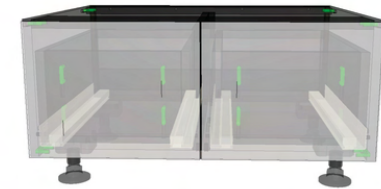

**SKU**

LHBD24  
LHBD30  
LHBD36

Design Considerations:

- Cabinet is 12" high plus 4" legs
- Drawers are 8" high
- Has a center partition
- Can support a ceramic grill
- Standard is 24" deep
- drawer fronts over 8" can be ordered in a stile and rail configuration for an additional cost

# SPECIALTY BASE CABINETS

WALL DEPTH BASE  
CABINET 1 DOOR

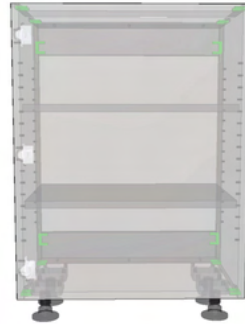

## SKU

WDB12-(12,15,18)  
WDB15-(12,15,18)  
WDB18-(12,15,18)  
WDB21-(12,15,18)

Design Considerations:

- Please note 12", 15", or 18" depth
- Cabinet is 30 1/2" high plus 4" levelers
- 2 adjustable shelves
- 3 hinges per door

WALL DEPTH CABINET 2  
DOORS

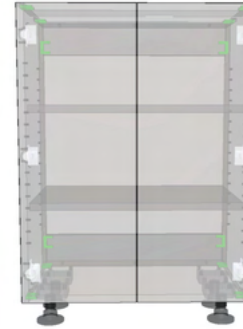

## SKU

WDB24-(12,15,18)  
WDB27-(12,15,18)  
WDB30-(12,15,18)  
WDB33-(12,15,18)  
WDB36-(12,15,18)

Design Considerations:

- Please note 12", 15", or 18" depth
- Cabinet is 30 1/2" high plus 4" levelers
- 2 adjustable shelves
- 3 hinges per door
-



# WASTE BIN CABINETS

# TOE PLATES

FULL HEIGHT WASTE BIN

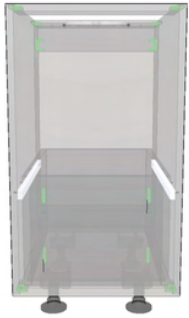

FULL HEIGHT WASTE BIN WITH DRAWER

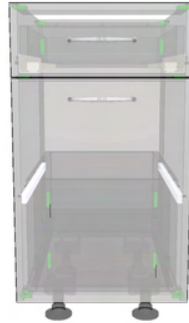

WINDSWEPT TOE PLATE



COMPACT TOE PLATE



SKU

FHWB12  
FHWB15  
FHWB18  
FHWB21

SKU

WB12  
WB15  
WB18  
WB21

SKU

WTP

SKU

CTP

**Design Considerations:**

- Trash bin not included
- Cabinet has a 12" high roll out attached to the front allowing for a 26" high bin
- The 18" and 21" wide will accommodate 2 trash bins

**Design Considerations:**

- Trash bin not included
- Drawer front is 7" high
- Cabinet has a 12" high roll out attached to the front allowing for a 18" high bin
- The 18" and 21" wide will accommodate 2 trash bins

**Design Considerations:**

- 94" maximum standard length
- 5 1/2" standard height
- 5/8" thick
- Windswept primed all sides
- Finished color 1 face
- Compact has 2 faces, ebony 2 edges

**Design Considerations:**

- 94" maximum standard length
- 5 1/2" standard height
- 5/8" thick
- Windswept primed all sides
- Finished color 1 face
- Compact has 2 faces, ebony 2 edges

## CORNER BASE CABINETS

FULL HEIGHT  
BLIND CORNER



SKU

BFH42 (L,R)

Design Considerations:

- (L,R) refers to door hinge location
- Left side hinge is standard
- 42" W cabinet has a 14 7/8" W door
- Includes a 7" W slab filler where corner cabinet joint perpendicular cabinets
- 1 adjustable shelf

45 DEGREE  
CORNER BASE

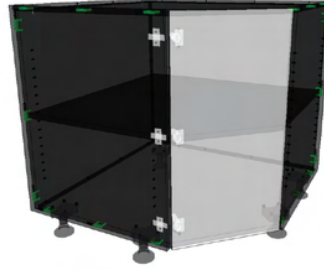

SKU

DCC3636 (L,R)

Design Considerations:

- Cabinet is 36" x 36"
- Door is 16" W x 30 1/4" H
- (L,R) refers to door hinge location
- 1 adjustable shelf

## GALLEY SINK CAB

GALLEY SINK CAB

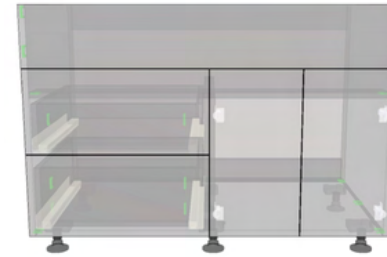

SKU

GS48 (L,R)  
GS72(L,R)

Design Considerations:

- Cabinet is 28" deep
- Top false front is 7" high
- Drawers 2 & 3 are 11 1/2" high
- Specify left or right for drawers
- The side opposite of the drawer is open under for plumbing clearance
- drawer fronts over 8" can be ordered in a stile and rail configuration for an additional cost



# BAR HEIGHT COUNTER EXTENSIONS

BAR HEIGHT BASE  
CABINET EXTENSION

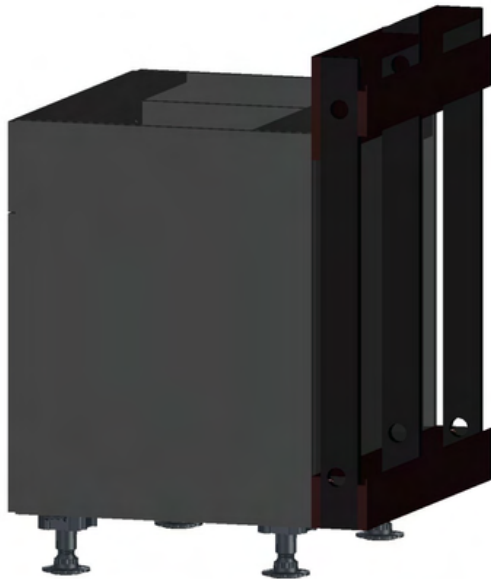

SKU

BHBCT

Design Considerations:

- This SKU is designed as a separate assembly to be attached to the back of a standard cabinet
- 6" higher than a standard base cabinet space
- Made to the width of each individual cabinet

BAR HEIGHT CORNER  
EXTENSION KIT

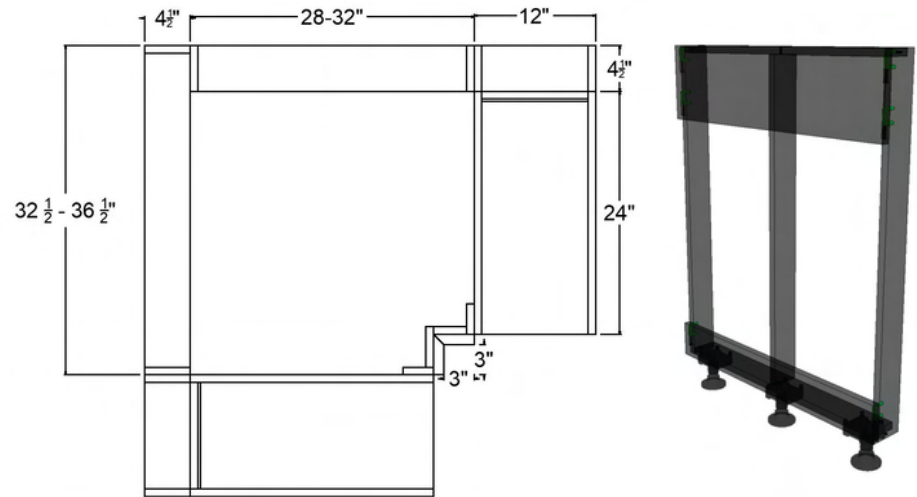

SKU

BHCEK24

BHCEK28

Design Considerations:

- This SKU is designed to complete an outside corner for back panel attachment, using 3" inside corner fillers
- Designate 24" or 28" deep cabinetry
- 1 wall at 28" w and 1 wall at 32 1/2" w for 24" D cabinetry
- 1 wall 32" w and 1 wall at 36 1/2" W for 28" deep cabinetry
- 6" higher than a standard base cabinet (40 1/2" h including leveler)



---

## wall cabinets

# STANDARD WALL CABINET SPECIFICATIONS

All ZahBuilt boxes are constructed from 3/4" black LDPE

- Full access, frameless construction
- 1/4" LDPE thick cabinet backs with 4" nailers top and bottom
- Use washers with stainless steel screws when hanging wall cabinets
- Wall cabinets are 12" deep and come with full depth 3/4" thick LDPE adjustable shelves
- Stainless steel, adjustable soft close hinges
- Finished ends, crown and light rails available as accessories
- We recommend a light rail for cabinets over 21" wide
- 11" Clear inside D

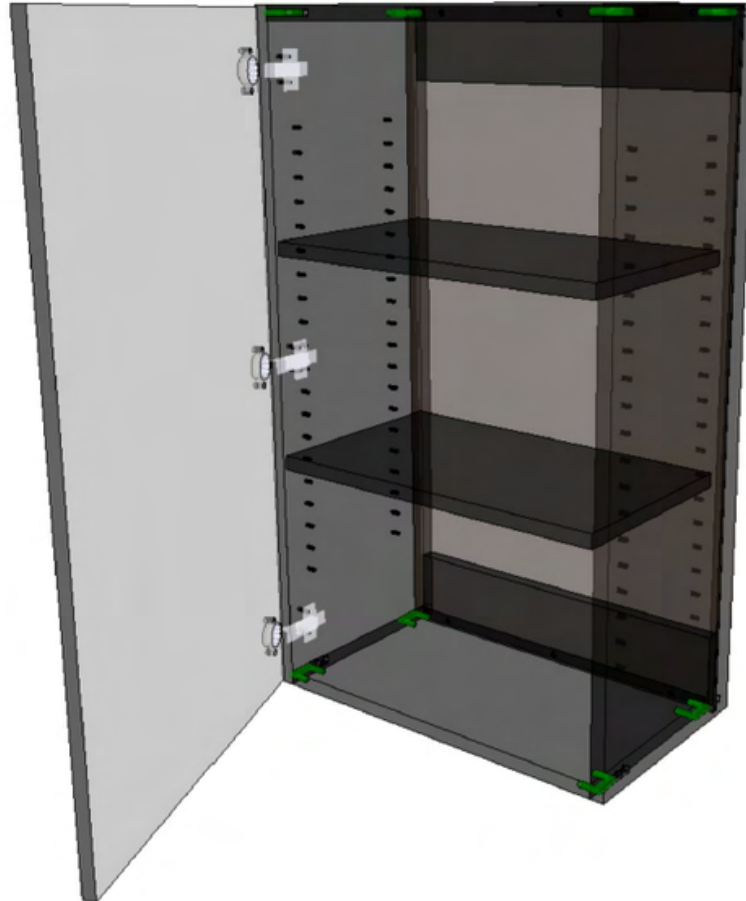



# STANDARD WALL CABINETS

1 DOOR CABINET



SKU

**18" H**

W1218(L,R)  
W1518(L,R)  
W1818(L,R)  
W2118(L,R)

**24" H**

W1224(L,R)  
W1524(L,R)  
W1824(L,R)  
W2124(L,R)

SKU

**30" H**

W1230(L,R)  
W1530(L,R)  
W1830(L,R)  
W2130(L,R)

**36" H**

W1236(L,R)  
W1536(L,R)  
W1836(L,R)  
W2136(L,R)

2 DOOR CABINET

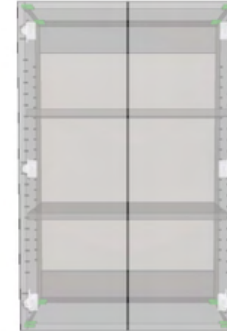

SKU

**18" H**

W2418  
W2718  
W3018  
W3318  
W3618

**24" H**

W2424  
W2724  
W3024  
W3324  
W3624

SKU

**30" H**

W2730  
W3030  
W3330  
W3630

**36" H**

W2436  
W3036  
W3636

Design Considerations:

- (L,R) refers to door hinge location

Shelves:

- 18" H - no shelves
- 24" H cabinets - 1 adjustable shelf
- 30" & 36" H cabinets - 2 adjustable shelves
- 12" deep outside, 11" clear inside

Design Considerations:

- 18" H - no shelves
- 24" H cabinets - 1 adjustable shelf
- 30" & 36" H cabinets - 2 adjustable shelves
- 12" deep outside, 11" clear inside



---

# tall cabinets

## TALL CABINETS 2-DOOR



SKU

T1294-12(L,R)  
T1294-24(L,R)  
T1594-12(L,R)  
T1594-24(L,R)  
T1894-12(L,R)  
T2194-12(L,R)  
T2194-24(L,R)

## TALL CABINETS 4-DOOR



SKU

T2494-12  
T2494-24  
T2794-12  
T2794-24  
T3094-12  
T3094-24

### Design Considerations:

- Standard height is 90 1/2" plus 4" levelers
- Top door is always 30" high
- Bottom door will vary with height change
- Fixed shelf between doors
- 6 adjustable shelves total
- Note depth (12" or 24") on order
- Note door swing on 2 door cabinet





---

panels, fillers &  
accessories



# DECORATIVE APPLIED PANELS



## AP (Width x Height x Style x Finish)

### Design Considerations:

- Only available in custom sizes
- Reference the specifications section for additional information and limitations
- Appliance panels, please input the exact size required
- Note door style, color, width and height

# APPLIED PANELS

## COMPACT LAMINATED BACK PANELS

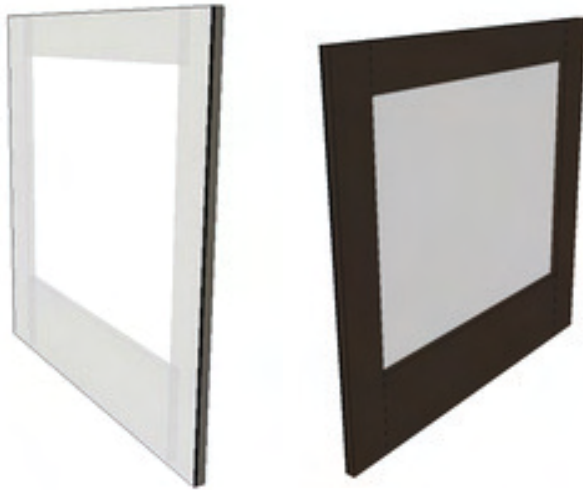

### SKU

- CLBP30.548
- CLBP34.548
- CLBP40.548
- CLBP4448

#### Design Considerations:

- 3/16" thick compact adhered to 3/4" PVC frame with VHB tape
- Includes one 1" wide 3/16" thick finished end strip with VHB tape
- Can be screwed to back of cabinetry or hung on low wall extension with optional 'Z' clips
- Factory finished ends not available, needs to be butted, mitered or capped
- Frame is 4" on sides and top, 8" on sides and bottom

## Z CLIP



### SKU

ZC2

#### Design Considerations:

- 5/8" Drop
- Includes 5/8" pane head SS screws

## END PANELS



## WINDSWEPT END/BACK PANEL

### SKU

- WEP1536
- WEP1595
- WEP2636



## COMPACT END PANEL

### SKU

- CEP2636
- CEP3036
- CEP1430
- CEP1436
- CEP1495
- CEP2695

#### Design Considerations:

- All 'end panels' are shipped loose
- All 'end panels' are a slab (not decorative)
- Windswept is 3/4" thick
- Compact panels are 5/8" thick
- Standard compact have an ebony edge
- Compact can be ordered with a matching front edge (add cost)
- Custom sizes available at additional cost
- Maximum size is 44" x 44" Compact
- If size exceeds maximum, need to order a 'back or tall panel'
- Windswept panels are profiled on 1 long edge only



# COMPACT BOX COLUMNS

COMPACT BOX  
COLUMN SHALLOW



**SKU**

CBCS3X634.5  
CBCS3X636  
CBCS3X694.5

Design Considerations:

- 7 1/4" both sides
- 36" high for scribing as needed
- 3" wide
- Matching mitered edge available for an added cost

COMPACT BOX  
COLUMN 1 FULL SIDE

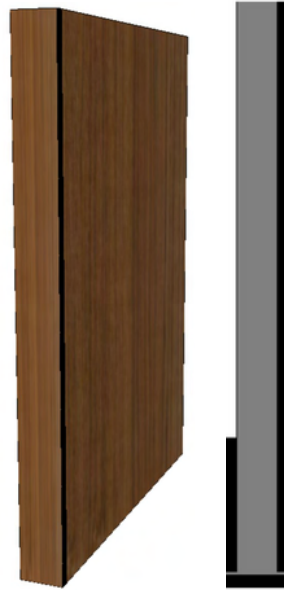

EBONY EDGE SHOWN

**SKU**

CBC1S2634.5  
CBC1S2636  
CBC1S2694.5  
CBC1S3034.5  
CBC13036  
CBC13094.5

Design Considerations:

- 7 1/4" return 1 side
- 1 side full depth (26" or 30")
- 36" high is for scribing
- 3" wide
- Matching mitered edge available for an added cost

COMPACT BOX  
COLUMN 3 SIDES



MITRED EDGE SHOWN

**SKU**

CBC3S2634.5  
CBC3S2636  
CBC3S2694.5  
CBC3S3034.5  
CBC3S3036  
CBC3S3094.5

Design Considerations:

- Both sides full depth (26" or 30")
- 36" high is for scribing
- 3" wide
- Matching mitered edge available
- Custom sizing available at additional cost

# WINDSWEPT PILASTERS

WINDSWEPT BOX  
COLUMN SHALLOW



**SKU**

WBCS3X636  
WBCS3X694.5

Design Considerations:

- 7" both sides
- 36" high for scribing as needed
- 3" wide

WINDSWEPT BOX  
COLUMN 1 FULL SIDE



**SKU**

WBC2S2636  
WBC2S2694.5  
WBC2S3036  
WBC2S3094.5

Design Considerations:

- 3" face x 7" one side x full depth 1 side

WINDSWEPT BOX  
COLUMN 3 SIDES



**SKU**

WBC3S2636  
WBC3S2694.5  
WBC3S3036  
WBC3S3094.5

Design Considerations:

- Finished on 3" w face, side return and long inside edge
- 3" face with both sides finished full depth

# FILLERS & FLOATING SHELVES

COMPACT FILLER  
WITH BACKER

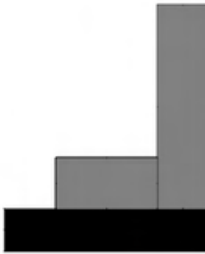

SKU

CF336  
CF394.5  
CF5.536  
CF5.594.5

Design Considerations:

- 3" or 5 1/2" wide
- There is an "L" shaped LDPE attachment cleat on back
- Any length over 48" will require special shipping arrangements

WINDSWEPT FILLER  
WITH BACKER



SKU

WF336  
WF394.5  
WF5.536  
WF5.594.5

Design Considerations:

- 3" or 5 1/2" wide
- There is an "L" shaped cleat on back
- Any length over 48" will require special shipping arrangements

WINDSWEPT FLOATING  
SHELF



SKU

WFS24(L,R,B,N)  
WFS30(L,R,B,N)  
WFS36(L,R,B,N)  
WFS42(L,R,B,N)  
WFS48(L,R,B,N)  
WFS54(L,R,B,N)  
WFS60(L,R,B,N)  
WFS66(L,R,B,N)  
WFS72(L,R,B,N)

Design Considerations:

- Specify finished ends: Left, Right, Both, none
- 3" wide front edge
- 3/4" thick material
- 1 1/2" hollow between layers
- No wall brackets included



# CORNER FILLERS

3X3 COMPACT CORNER FILLER

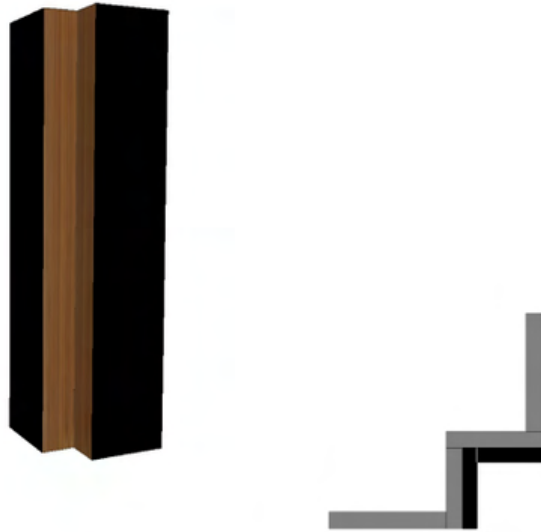

SKU

CCF3336

Design Considerations:

- 3" x 3" inside filler
- Overall 9 5/8" x 9 5/8" x 36" high
- LDPE back filler

3X3 WINDSWEPT CORNER FILLER

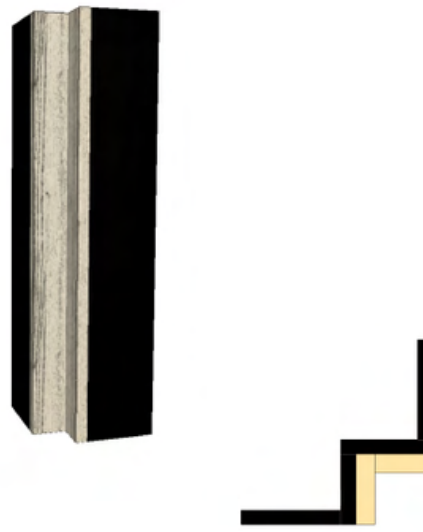

SKU

WCF3336

Design Considerations:

- 3" x 3" inside filler
- Overall 10" x 10" x 36"
- LDPE back filler

APPLIANCE PILASTER



SKU

WCF3336

Design Considerations:

- Used to separate under counter appliances and support counter top
- LDPE back structure
- Specify 24" or 28" deep
- Available 3" or 6" wide
- Comes with front that matches door/drawer
- Standard height is 36"

# POSTS

WINDSWEPT POST 3"

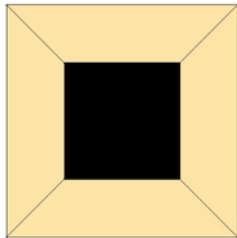

SKU

WP336

WINDSWEPT POST 6"

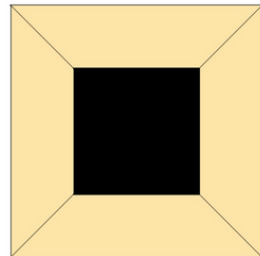

SKU

WP636

Actual Net Size is 5 1/2" Square

Design Considerations:

- We define a post as having 4 finished sides
- 36" high
- 3/4" thick material
- Windswept standard is mitred all sides
- 6" post is 5 1/2" square

COMPACT POST 3"



EBONY SHOWN MITRED SHOWN

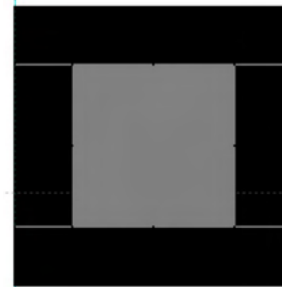

SKU

CP334.5  
CP636

Design Considerations:

- We define a post as having 4 finished sides
- Available 34 1/2" or 36" high
- Compact standard has 4 ebony edges
- Compact can be mitred all sides for additional cost

COMPACT POST 6"



EBONY SHOWN MITRED SHOWN



SKU

CP634.5  
CP636

## LDPE PANELS

BLACK & WHITE PVC



**SKU**

LDPE2424  
LDPE2448  
LDPE2496  
LDPE3648  
LDPE3696  
LDPE4448  
LDPE4896

- 3/4" thick LDPE
- All edges unfinished

## TOE PLATES

WINDSWEPT TOE PLATE



**SKU**

WTP

- Design Considerations:
- 94" maximum standard length
  - 5 1/2" standard height
  - 5/8" thick
  - Windswept primed all sides
  - Finished color 1 face
  - Compact has 2 faces, ebony 2 edges

COMPACT TOE PLATE



**SKU**

CTP

- Design Considerations:
- 94" maximum standard length
  - 5 1/2" standard height
  - 5/8" thick
  - Windswept primed all sides
  - Finished color 1 face
  - Compact has 2 faces, ebony 2 edges



# PULLS & ACCESSORIES

1" KNOB



SKU

SSK  
SSB

7" PULL

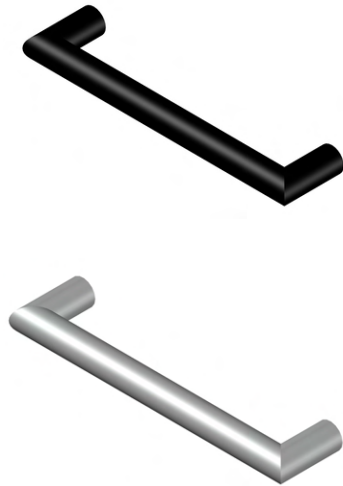

SKU

SSP  
SSPB

**Design Considerations:**

- Hardware is 304 stainless
- Black is powder coated
- Pulls are mounted horizontal on drawers vertical on doors
- Standard Placement is centered on drawers horizontally and vertically.
- Standard placement on doors is 1-1/2" from top and edge.
- only Zahbuilt hardware is drilled and mounted on doors and drawers.

DOOR CAM LOCKS



SKU

CAMLOCK

**Design Considerations:**

- Locks are keyed alike
- Contact your rep for installed lock pricing

TOUCH UP KIT



SKU

TUK

**Design Considerations:**

- Only available in base colors
- Order individually by color



SKU

VHB1

**Design Considerations:**

- 1" wide x 108" long

# ACCESSORIES

## LEVELER SPACER



SKU

LS1

### Design Considerations:

- Adds 3/8" of Height per Spacer
- Can use up to 3

## LEVELER INSERT



SKU

LL3  
LL7

### Design Considerations:

- Modifies base cabinet heights from the stock 4" leg
- Standard leg adjusts from 3 3/4" to 5"
- LL3 adjusts from 2 1/2" to 4"
- LS7 adjusts from 6 3/4" to 7 3/4"

## LEVELER ADJUSTMENT TOOL



SKU

LAT

### Design Considerations:

- Used to adjust levelers during install

# DEALER SALES TOOLS

DEALER MINI BASE



SKU

DMB

Design Considerations:

- Cabinet is 13" W x 23" H x 13" D + toe
- Specify brushed stainless or black pull
- Color and finish is random, allow 4-6 weeks for requested finished

WINDSWEPT SAMPLE BLOCKS

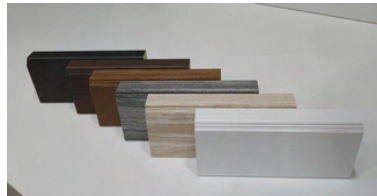

SKU

WSB

Design Considerations:

- 6 blocks 2 3/4" W x 6" long
- Finished 1 edge 1 face

COMPACT SAMPLE BLOCKS

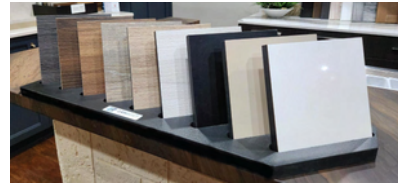

SKU

CSB

Design Considerations:

- 6" x 6" x 5/8" thick blocks
- Includes stand

DEALER SAMPLE DOOR



SKU

DSD

Design Considerations:

- Standard sample doors is Windswept White
- 12 3/4" W x 15 3/4" high
- Allow 2 weeks lead time for colors other than white



---

windswept mouldings



# ACCOYA®

A new way of thinking about wood



## PERFORMANCE

Excels in every way



WARRANTY



HIGHLY STABLE



HIGHLY DURABLE

## FINISH

Beautifully versatile



IDEAL FOR COATING



LOW MAINTENANCE



NATURAL WOOD

## SUSTAINABILITY

World-changing environmental credentials



SUSTAINABLY SOURCED



NON TOXIC



100% RECYCLABLE

Accoya turns everything you know about wood on its head. Through a revolutionary process called acetylation, it modifies wood to give it properties above and beyond the very best hardwoods - and in many cases, aluminum and PVC.



Highly durable and stable, Accoya withstands the test of any climate.

The warranty is a testament to the fact you will enjoy your Accoya wood for years to come.

To learn more visit:  
[www.accoya.com](http://www.accoya.com)



The mark of responsible forestry

# WINDSWEPT CROWN

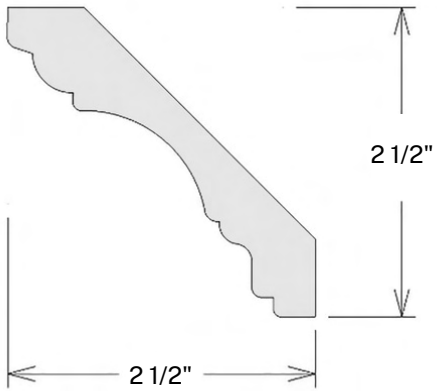

SKU

WSC71  
Net width is 3 1/2"W



SKU

WSC50  
Net width is 5 1/4" W

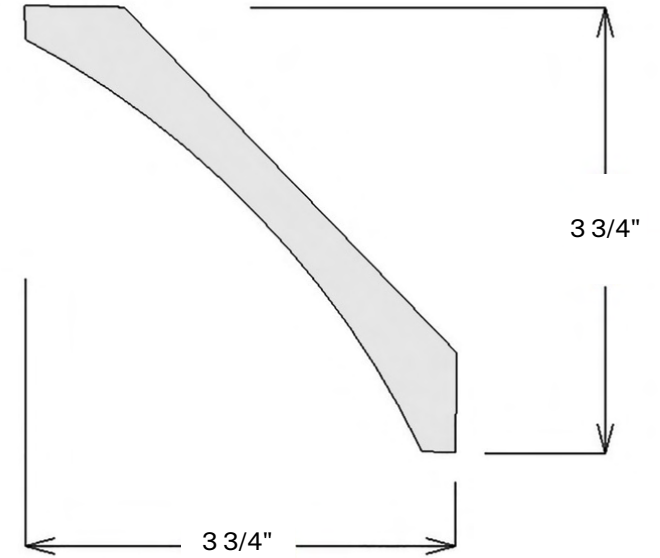

SKU

WSC103  
Net width is 5 1/4" W

## Design Considerations:

- If a nailer is needed please order Flat Stock or Base
- 94" maximum standard length
- Primed all sides
- Finished color on all exposed faces



# WINDSWEPT T & G MOLDINGS

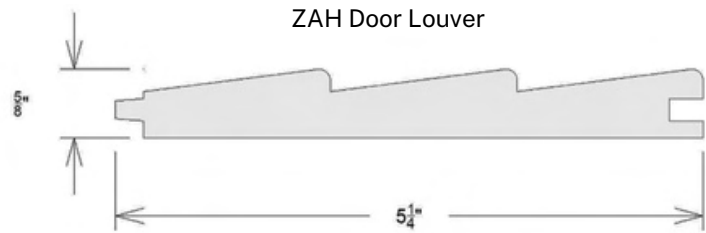

**SKU**

WSZL

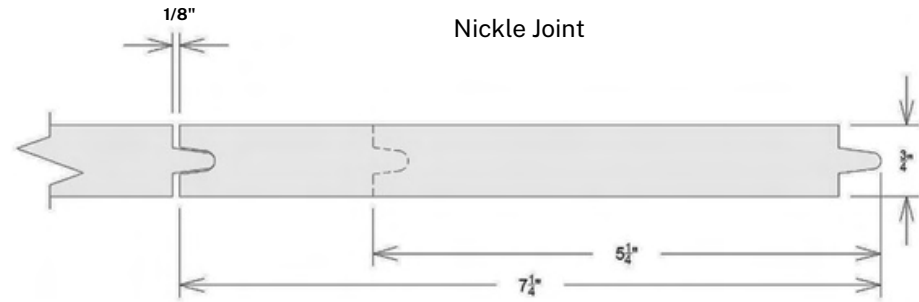

**SKU**

WSNJ5.25  
WSNJ7.25

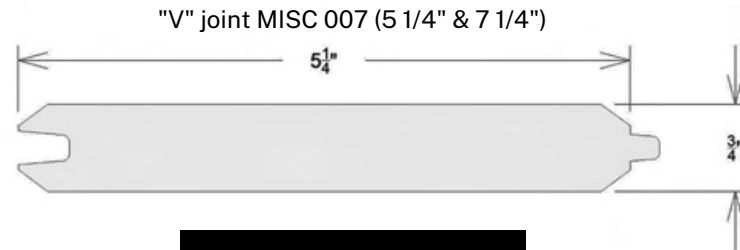

**SKU**

WSVJ

## Design Considerations:

- 94" maximum standard length
- Primed all sides
- Finished color on all exposed faces

# WINDSWEPT BASE BOARDS

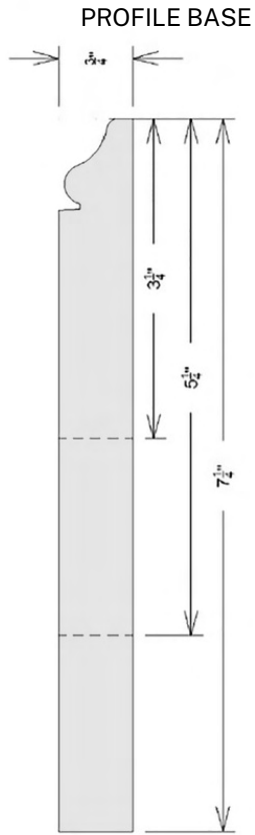

**SKU**

BP192.25  
BP195.25  
BP197.25

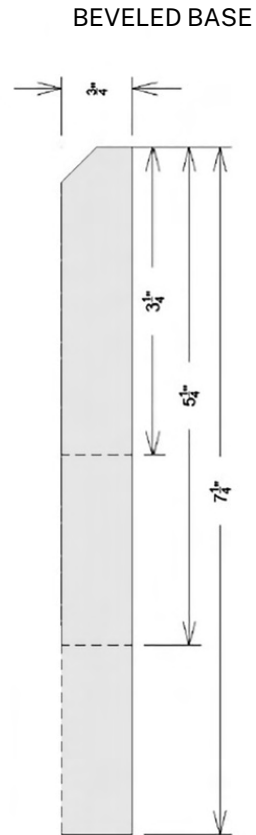

**SKU**

BB3.25  
BB5.25  
BB7.25

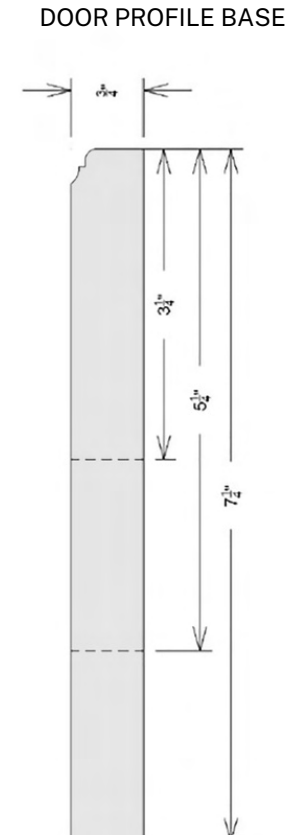

**SKU**

BDP3.25  
BDP5.25  
BDP7.25

## Design Considerations:

- 94" maximum standard length
- Primed all sides
- Finished color on all exposed faces

# MISC. WINDSWEPT MOLDINGS



## PICTURE FRAME MOLDING

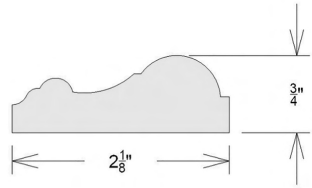

**SKU**

M095

**Design Considerations:**

- 94" maximum standard length

## VALANCE

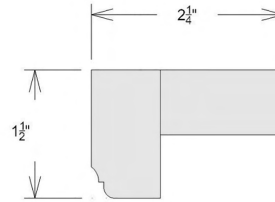

**SKU**

WSV  
CV

**Design Considerations:**

- 94" maximum standard length
- Primed all sides
- Finished color on 1 face and profiled edge
- Available in a similar Compact design

## FLAT STOCK

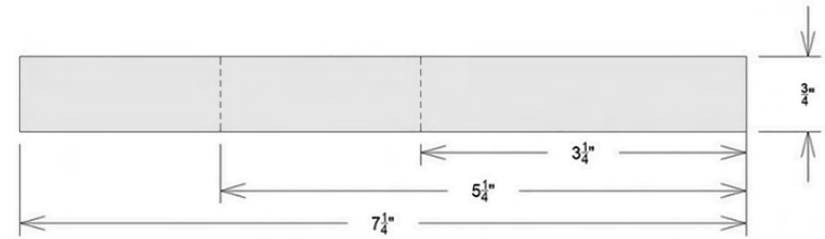

**SKU**

1x4x8  
1x6x8  
1x8x8

**Design Considerations:**

- Net size of 1x4x8 is 3/4" x 3 1/4" x 94"
- Net size of 1x6x8 is 3/4" x 5 1/4" x 94"
- Net size of 1x8x8 is 3/4" x 7 1/4" x 94"
- Flat stock is primed all sides
- Finished color on 1 face and 1 edge





ZÄHBUILT



hoods



# WINDSWEPT LOUVER HOOD

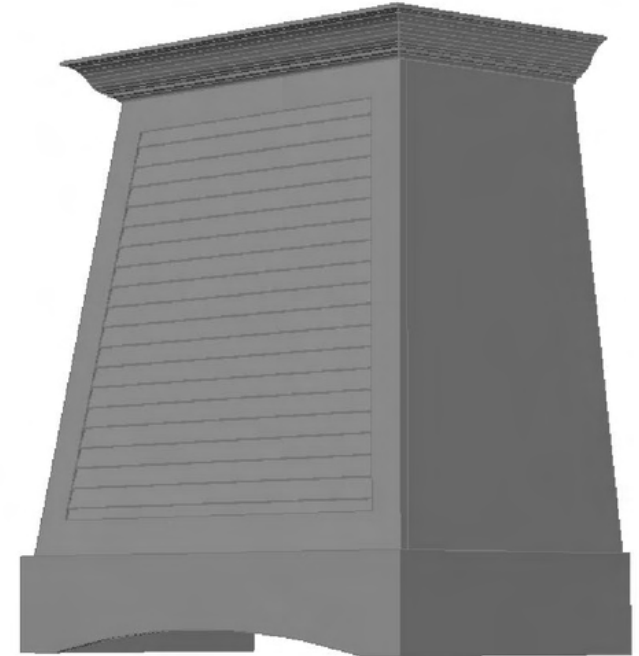
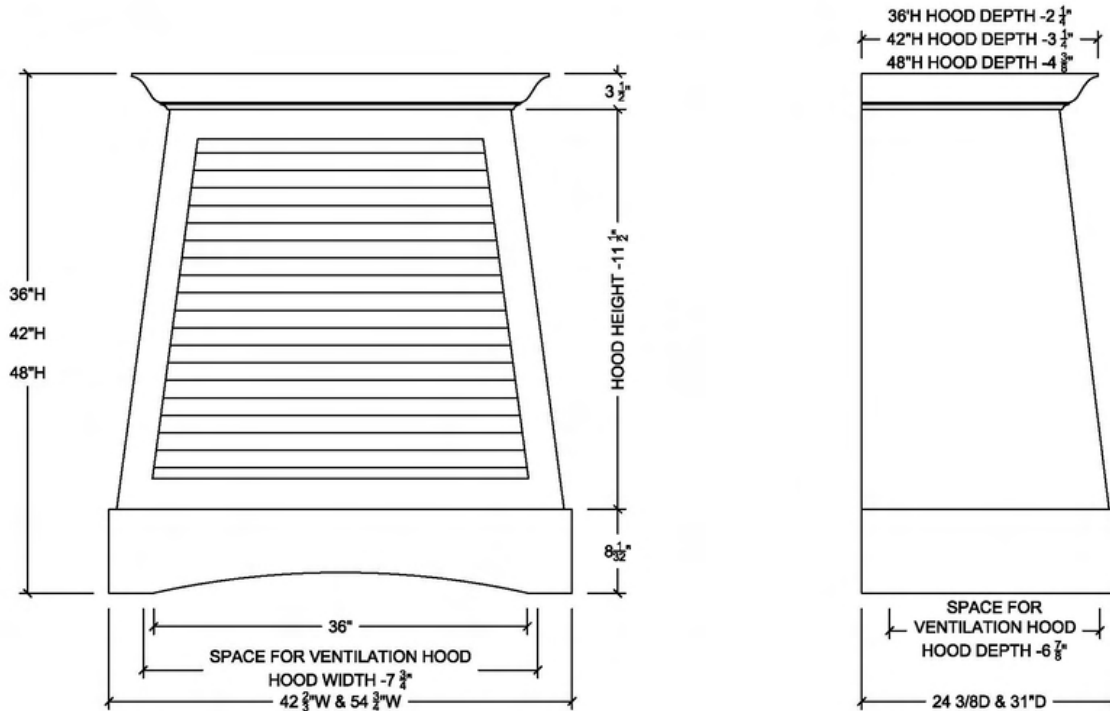

## Design Considerations:

- Widths available 44" and 55"
- Heights available 36", 42" and 48"
- Depths available 25" and 32"
- Crown molding is shipped loose and is optional
- Ventilator cut out is done on site
- Generally liner must be 36" above cooking surface

## SKU

- LH4436-25
- LH4436-32
- LH4442-25
- LH4442-32
- LH4448-25
- LH4448-32
- LH5536-25
- LH5536-32
- LH5542-25
- LH5542-32
- LH5548-25
- LH5548-32

# WINDSWEPT SHAKER HOOD

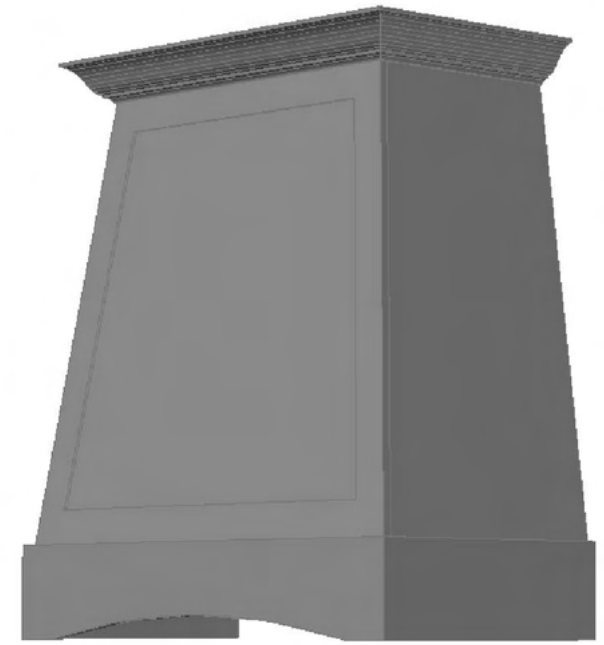
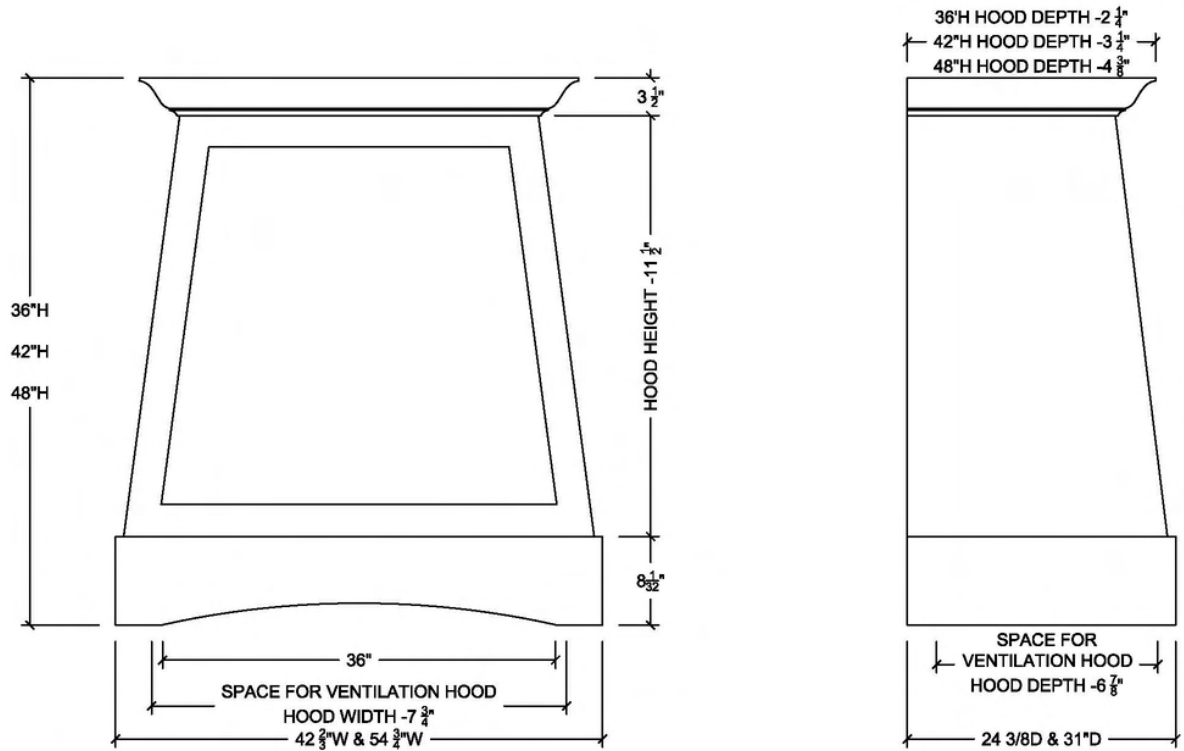

## Design Considerations:

- Widths available 44" and 55"
- Heights available 36", 42" and 48"
- Depths available 25" and 32"
- Crown molding is shipped loose and is optional
- Ventilator cut out is done on site
- Generally liner must be 36" above cooking surface

## SKU

- SH4436-25
- SH4436-32
- SH4442-25
- SH4442-32
- SH4448-25
- SH4448-32
- SH5536-25
- SH5536-32
- SH5542-25
- SH5542-32
- SH5548-25
- SH5548-32



# WINDSWEPT NICKEL JOINT HOOD

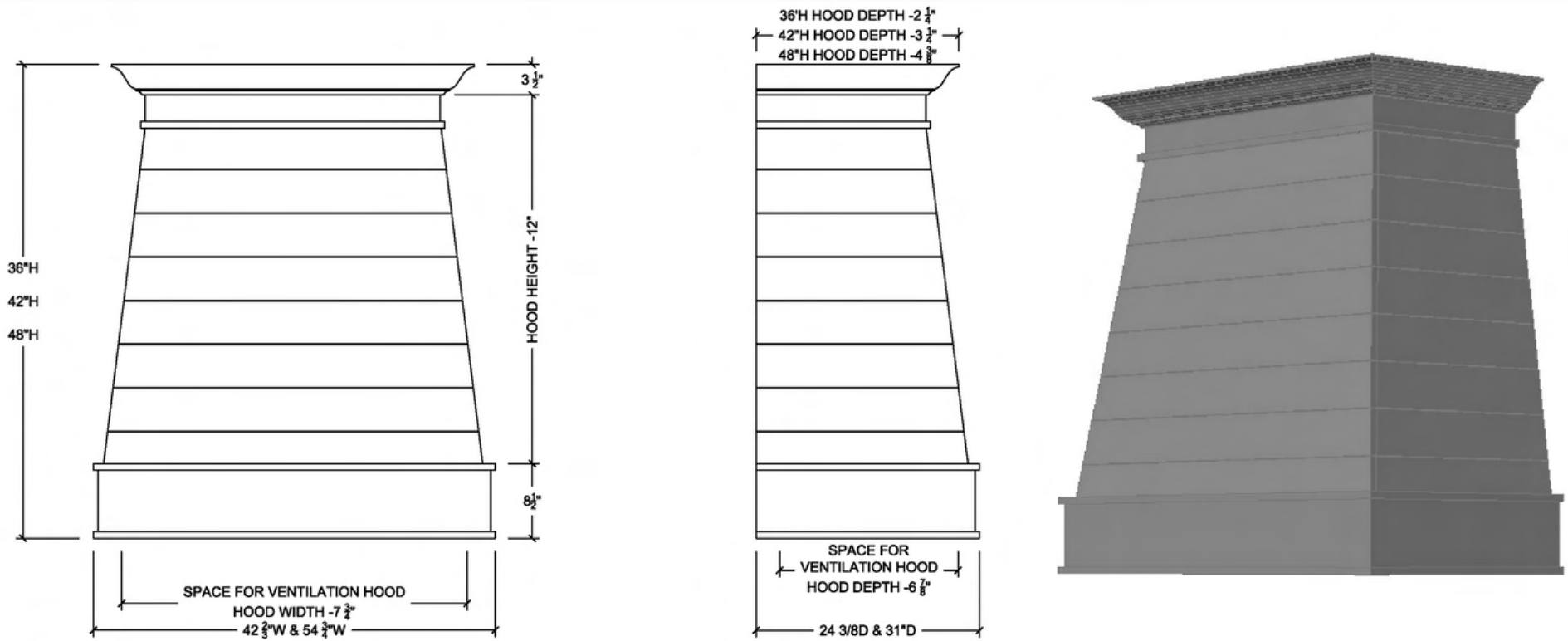

## Design Considerations:

- Widths available 44" and 55"
- Heights available 36" ,42" and 48"
- Depths available 25" and 32"
- Crown molding is shipped loose and is optional
- Ventilator cut out is done on site
- Generally liner must be 36" above cooking surface

## SKU

- NJH4436-25
- NJH4436-32
- NJH4442-25
- NJH4442-32
- NJH4448-25
- NJH4448-32
- NJH5536-25
- NJH5536-32
- NJH5542-25
- NJH5542-32
- NJH5548-25
- NJH5548-32





---

bespoke



# BESPOKE

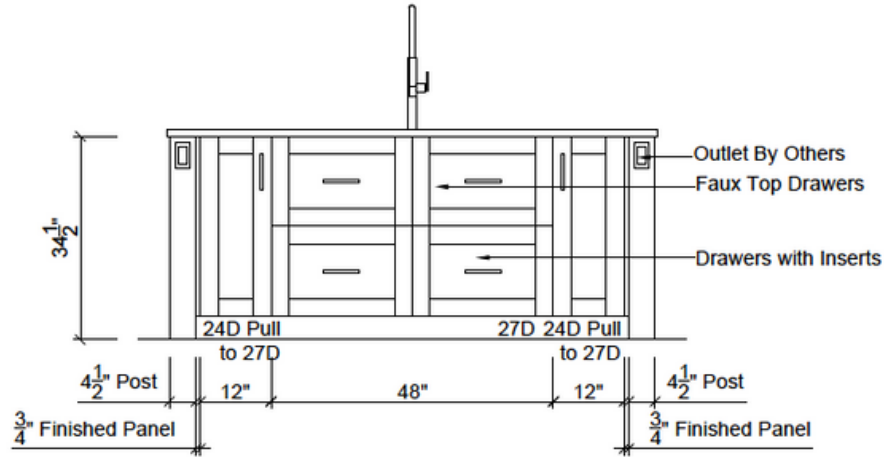

(B) GRILL DISPLAY ELEVATION

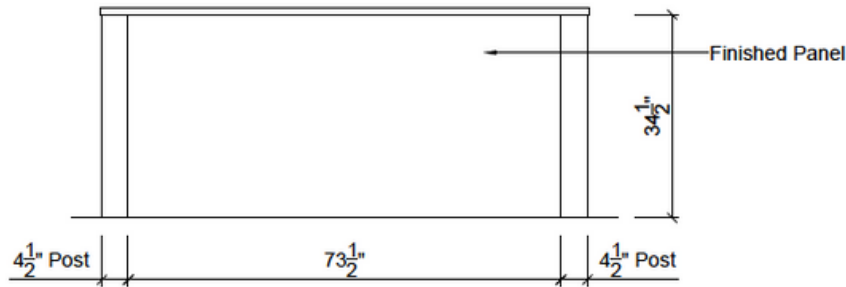

(D) GRILL DISPLAY ELEVATION

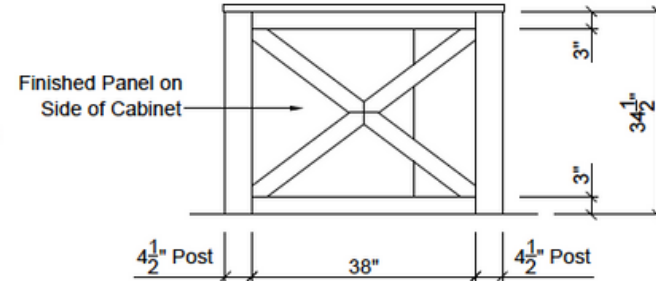

(C) GRILL DISPLAY ELEVATION

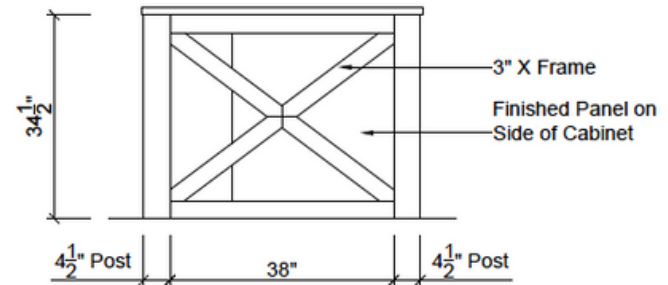

(E) GRILL DISPLAY ELEVATION

## Design Considerations:

- Must provide a scaled drawing
- Design & color selections
- Allow 10 days for pricing
- Allow additional time for scheduling/processing

SKU

BESPOKE





SONOMA BRUN SPECIAL ORDER  
PHIL KEAN DESIGNS