

Appendix A. Sample Survey Forms

For the Reconnaissance Level Historical and Architectural Survey of Jefferson Township, Henry County, an Iowa Site Inventory Form was prepared for each property with at least one resource built by 1975. A digital photograph of each site was inserted on the last page of each form. Twelve sample survey forms are included in this appendix as example of the forms used and type of information recorded for this survey. One set of the survey forms was archived at the State Historic Preservation Office, State Historical Society of Iowa, Des Moines, and the other set of survey forms was retained by the Henry County Historic Preservation Commission at the Wayland and Midwest Memories Museum in Wayland.

- Farm - house and buildings - 1144 Benton Ave, section 9 - State #44-02102 - Map/Site #F-10 - Queen Anne - 2 story - c.1902 - garage: attached (c.2014 - side gable - 2 car) - outbuildings: yes - 11 (barn - c.1920s, barn - c.1940s, barn - c.1949, machine shed - c.1950, three silo - Harvestore - c.1965, metal building - c.1973, hog building - c.1978, hog building - c.2007, hog building - c.2010)
- House - 1171 Delaware Ave, section 10 - State #44-02131 - Map/Site #D-04 - Queen Anne / Foursquare - 2 story - c.1914 - garage: no - outbuildings: yes - 1 (small bldg)
- House - 1577 Franklin Ave, section 34 - State #44-02142 - Map/Site #B-17 - side gable (early brick) - 1 story - c.1850s - garage: no - outbuildings: yes - 2 (building - c.1900s, poultry house - c.1900s)
- Finley Chapel and Cemetery - 1501 150th St, section 25 - State #44-02081 - Map/Site #B-07 - church, cemetery - 1937-38
- Bridge - 1000s Gabriel Ave, section 13/14 - State #44-02143 - Map/Site #C-25 - Bridge - concrete, two panel sidewalls - 1919
- G.F. Dold Garage - 103? Coppock Rd, Coppock - State #44-02112 - Map/Site #F-24 - false front - c.1924
- House - 312 E. Front, Wayland - State #44-01844 - Map/Site #J-14 - ranch - 1 story - c.1965 - garage: attached (c.1960 - hip roof - 2 car), also detached (c.1980 - frame - gable-front - 2 car) - outbuildings: no
- House - 105 W. Front, Wayland - State #44-01848 - Map/Site #P-03 - Victorian vernacular - 1 story - c.1900s - garage: yes (c.1999 - frame - gable-front - 2+ car) - outbuildings: no
- House - 415 W. Front, Wayland - State #44-01881 - Map/Site #S-22 - bungalow - side gable - 1 1/2 story - c.1919 - garage: yes (c.1960s - frame - gable-front - 2 car) - outbuildings: no
- House - 302 E. Main, Wayland - State #44-01929 - Map/Site #K-10 - Queen Anne / T-plan - 2 story - c.1899 - garage: yes (c.1952 - frame - side gable - 2 car) - outbuildings: no
- John and Lenore Wenger House - 314 W. Main, Wayland - State #44-01977 - Map/Site #T-12 - Foursquare - 2 story - c.1912 - garage: attached addition (c.1970 - side-gable - 2 car) - outbuildings: no
- James Wideman Building - 208 W. Main, Wayland - State #44-01723 - Map/Site #O-02 - 2 story brick - c.1899

Iowa Site Inventory Form

State Historic Preservation Office

(July 2014)

State Inventory Number: 44-02102 New Supplemental

9-Digit SHPO Review & Compliance (R&C) Number: _____

Non-extant Year: _____

Read the Iowa Site Inventory Form Instructions carefully, to ensure accuracy and completeness before completing this form. The instructions are available on our website: <http://www.iowahistory.org/historic-preservation/statewide-inventory-and-collections/iowa-site-inventory-form.html>

• **Property Name**

A) Historic name: House and buildings

B) Other names: Reconnaissance Survey Field Site # F-10

• **Location**

A) Street address: 1144 Benton Ave

B) City or town: Wayland (Vicinity) County: Henry

C) Legal description:

Rural: Township Name: Jefferson Township No.: 73N Range No.: 7W Section: 009 Quarter: part of SW NW & NW SW-BEG SW COR NW N578.97' E902.6' S703.07' of Quarter: _____

Urban: Subdivision: _____ Block(s): Lot(s): _____

• **Classification**

A) Property category: *Check only one*

- Building(s)
- District
- Site
- Structure
- Object

B) Number of resources (within property):

If eligible property, enter number of:		If non-eligible property, enter number of:	
Contributing	Noncontributing		
—	Buildings	—	Buildings
—	Sites	—	Sites
—	Structures	—	Structures
—	Objects	—	Objects
—	Total	—	Total

C) For properties listed in the National Register:

National Register status: Listed De-listed NHL NPS DOE

D) For properties within a historic district:

- Property contributes to a National Register or local certified historic district.
- Property contributes to a potential historic district, based on professional historic/architectural survey and evaluation.
- Property *does not* contribute to the historic district in which it is located.

Historic district name: _____ Historic district site inventory number: _____

E) Name of related project report or multiple property study, if applicable:

MPD title: Reconnaissance Level Historical/Architectural Survey of Jefferson Township, Henry County Historical Architectural Data Base #: 44-024

• **Function or Use** *Enter categories (codes and terms) from the Iowa Site Inventory Form Instructions*

A) Historic functions

09B01: Agriculture-Farmstead

B) Current functions

09B01: Agriculture-Farmstead

• **Description** *Enter categories (codes and terms) from the Iowa Site Inventory Form Instructions*

A) Architectural classification

05D: House- 2 stories, gable cross roof, Queen Anne

09B: Barn

B) Materials

Foundation (visible exterior): 04: Stone

Walls (visible exterior): 15B: vinyl siding

Roof: 08A: Asphalt shingles

Other: _____

C) Narrative description *SEE CONTINUATION SHEETS, WHICH MUST BE COMPLETED*

Site Number: 44-02102 Address: 1144 Benton Ave City: Wayland County: Henry District Number:

• **Statement of Significance**

A) Applicable National Register Criteria: *Mark your opinion of eligibility after applying relevant National Register criteria*

- Criterion A: Property is associated with significant events. Yes No More research recommended
Criterion B: Property is associated with the lives of significant persons. Yes No More research recommended
Criterion C: Property has distinctive architectural characteristics. Yes No More research recommended
Criterion D: Property yields significant information in archaeology/history. Yes No More research recommended

B) Special criteria considerations: *Mark any special considerations; leave blank if none*

- A: Owned by a religious institution or used for religious purposes. E: A reconstructed building, object, or structure.
 B: Removed from its original location. F: A commemorative property.
 C: A birthplace or grave. G: Property less than 50 years of age or
 D: A cemetery. achieved significance within the past 50 years.

C) Areas of significance

Enter categories from instructions

D) Period(s) of significance

E) Significant dates

Construction date

1902 *check if circa or estimated date*
Other dates, including renovations

F) Significant person

Complete if Criterion B is marked above

G) Cultural affiliation

Complete if Criterion D is marked above

H) Architect/Builder

Architect

Builder/contractor

I) Narrative statement of significance *SEE CONTINUATION SHEETS, WHICH MUST BE COMPLETED*

• **Bibliography** *See continuation sheets for the list of research sources used in preparing this form*

• **Geographic Data** *Optional UTM references* *See continuation sheet for additional UTM or comments*

Zone	Easting	Northing	NAD	Zone	Easting	Northing	NAD
1	___	___	___	2	___	___	___
3	___	___	___	4	___	___	___

• **Form Preparation**

Name and Title: Marsha Chalupa - volunteer Rebecca Lawin McCarley, consultant Date: 12-17-15
Organization/firm: Henry County Historic Preservation Commission E-mail: -
Street address: Henry County Courthouse, 100 E, Washington St Telephone: 319-385-0756
City or Town: Mount Pleasant State: Iowa Zip code: 52641

• **ADDITIONAL DOCUMENTATION** *Submit the following items with the completed form*

A) For all properties, attach the following, as specified in the Iowa Site Inventory Form Instructions:

- 1. Map** of property's location within the community.
- 2. Glossy color 4x6 photos labeled** on back with property/building name, address, date taken, view shown, and unique photo number.
- 3. Photo key showing each photo number on a map and/or floor plan, using arrows next to each photo number to indicate the location and directional view of each photograph.**
- 4. Site plan** of buildings/structures on site, identifying boundaries, public roads, and building/structure footprints.

B) For State Historic Tax Credit Part 1 Applications, historic districts and farmsteads, and barns:

See lists of special requirements and attachments in the Iowa Site Inventory Form Instructions.

State Historic Preservation Office (SHPO) Use Only Below This Line

The SHPO has reviewed the Site Inventory and concurs with above survey opinion on National Register eligibility:

- Yes No More research recommended
 This is a locally designated property or part of a locally designated district.

Comments: _____

SHPO authorized signature: _____ Date: _____

Iowa Site Inventory Form
State Historic Preservation Office
Continuation Sheet

Site Number: 44-02102
 Related District Number: _____

Page 3

House	Henry
Name of Property	County
1144 Benton Ave	Wayland
Address	City

Construction dates:

Assessor date (1900 is default date): 1902
 Better estimated date and source: c.1902

Additional architectural information from the Reconnaissance Survey:

House: Queen Anne
 Height (stories): 2 stories
 Walls (construction/cladding): frame construction-vinyl siding-wood siding-decorative scalloped siding
 Foundation: concrete
 Roof style: gable cross
 Primary window type: 1/1 wood & vinyl windows
 - storm windows: yes-wood & vinyl
 Porch: yes-full wood front porch that wraps around south side of house
 Front entry: yes
 Other architectural features: dormers over entry

Garage: attached – 2014 addition
 Walls: frame construction-wood siding
 Roof style/material: gable cross-asphalt shingles
 Size: larger than two car
 Front faces: south
 Other architectural features:

Other buildings (list and provide any additional information:
 excellent example of barn – tile block – bow roof – significant on own
 numerous others - hog shed, shed-wood siding & steel roof, shed-aluminum siding & steel roof,
 barn-brick & wood siding & steel roof, 3 silos

per assessor

1 Barn - Feed and Livestock		32	50	1949
2 Lean-To	ATT TO #1	20	24	1949
5 Feeder Bunk		0	0	1966
6 Machine or Utility Building		30	50	1950
7 Steel Utility Building		48	154	1973
9 Barn - Flat		50	50	1920s
21 Lean-To	ATT TO #9	18	50	1975
11 Barn - Pole		17	32	1940s
12 Silo - Harvester		20	60	1965
18 Bin - Steel Grain Storage		27	18	1975
19 Bin - Steel Grain Storage		18	18	1960

Iowa Site Inventory Form
State Historic Preservation Office
Continuation Sheet

Site Number: 44-02102
 Related District Number: _____

Page 4

House	Henry
Name of Property	County
1144 Benton Ave	Wayland
Address	City

1 Barn - Feed and Livestock	32	50	1949
20 Bin - Steel Grain Storage	36	20	1978
24 Confinement - Custom-Built	50	260	2007
15 Confinement - Pre-Cut	33	154	1978
Confinement - Pre-Cut	71	277	2010

Additional historical information from the Reconnaissance Survey:

- 1870 owner/acres: Henry Davis Jr.
- 1895 owner/acres: Henry Davis (Davies) - 246 acres
- 1917 owner/acres: Sadie E Henss - 120 acres
- 1931 owner/acres: Sadie E Henss - 120 acres
- 1961 owner/acres: R.C. Kauffman
- 2015 property owner: Timothy Micheal Meyer

Property ownership research conducted for the property:

Grantor/Seller:	Henry Davies & wife	Legal Description and other relevant notes: W ½ NW & NW SW
Grantee/Buyer:	William & Sadie Henss	
Date:	12-22-1900	
Price:		
Deed book record (if listed) – book/page:		
Grantor/Seller:	Henry Davies & wife	Legal Description and other relevant notes: W ½ SW SW
Grantee/Buyer:	William & Sadie Henss	
Date:	12-13-1901	
Price:		
Deed book record (if listed) – book/page:1882-1904/302		
Grantor/Seller:	Lestor Henss	Legal Description and other relevant notes: W ½ SW SW
Grantee/Buyer:	Sadie Henss	
Date:	12-08-1933	
Price:		
Deed book record (if listed) – book/page: 1903-1948/258		
Grantor/Seller:	Wm. Henss & Sadie	Legal Description and other relevant notes: W ½ NW, NW SW, W ½ SW SW
Grantee/Buyer:	Ralph & Mabel Kauffman	
Date:	10-16-1948	
Price:		
Deed book record (if listed) – book/page: 1948-1978/273		
Grantor/Seller:	Ralph & Mabel Kauffman	Legal Description and other relevant notes: W ½ NW, NW SW, W ½ SW SW
Grantee/Buyer:	Maurice & Leila Greiser	
Date:	10-29-1965	
Price:		
Deed book record (if listed) – book/page:		
Grantor/Seller:	Maurice & Leila Greiser	Legal Description and other relevant notes: W ½ NW, NW SW & W ½ SW SW
Grantee/Buyer:	LeRoy & Patricia Jane Meyer	
Date:	03-11-1968	
Price:		
Deed book record (if listed) – book/page:1948-1978/273		

Iowa Site Inventory Form
State Historic Preservation Office
Continuation Sheet

Site Number: 44-02102
 Related District Number: _____

Page 5

House	Henry
Name of Property	County
1144 Benton Ave	Wayland
Address	City

Grantor/Seller:		Legal Description and other relevant notes:
Grantee/Buyer:		
Date:		
Price:		
Grantor/Seller:		Deed book record (if listed) – book/page:
Grantee/Buyer:		
Date:		
Price:		
Grantor/Seller:		Legal Description and other relevant notes:
Grantee/Buyer:		
Date:		
Price:		
Grantor/Seller:		Deed book record (if listed) – book/page:
Grantee/Buyer:		
Date:		
Price:		

Bibliography

- Brooks and Whiting. *Atlas of Henry County, Iowa*. St. Louis, MO: W.E. Stephens and Co., 1895.
- Cooper, Carolyn, ed. *Map of Henry County, Iowa 1859*. Reprint Edition. Mt. Pleasant, Iowa : Henry County Genealogical Society, 1989.
- Drury, John. *This is Henry County, Iowa*. Chicago: Inland Photo Company, 1956.
- Henry County Bicentennial Commission (HCBC). *The History of Henry County, Iowa*. Dallas, TX: National ShareGraphics, Inc., 1982.
- Henry County Auditor’s Office. Transfer book records, various books/dates.
- History of Henry County, Iowa*. Chicago: Western Historical Company, 1879.
- Jaynes, Peter H., ed. *Highlights of Henry County History 1833-1976*. Burlington, IA: Doran & Ward Lithographing Co., 1977.
- Kean Map Company. *Atlas of Henry County, Iowa*. Des Moines: Kean Map Company, 1931.
- Mason, George T. *Directory of Henry County, Iowa, 1911-1912*. Mt. Pleasant, IA: The News, 1911.
- Ogle, George A. & Co. *Standard Atlas of Henry County, Iowa*. George A. Ogle & Co., 1917.
- Portrait and Biographical Album of Henry County, Iowa*. Chicago: Acme Publishing Co., 1888.
- Thompson and Everts. *Combination Atlas Map of Henry County, Iowa*. Geneva, IL: Thompson and Everts, 1870.
- Wayland Centennial Committee. *Wayland: The First Century, 1880-1980*. Wayland, 1980.

Iowa Site Inventory Form
State Historic Preservation Office
Continuation Sheet

Site Number: 44-02102
Related District Number: _____

Page 6

House	Henry
Name of Property	County
1144 Benton Ave	Wayland
Address	City

Sketch map

SH
ED



barn

Silos – Harvestore

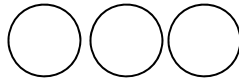

hog
building

Barn

BARN
c.1949

HOUSE
(1902)



Benton Ave

Iowa Site Inventory Form
State Historic Preservation Office
Continuation Sheet

Site Number: 44-02102
Related District Number: _____

Page 7

House	Henry
Name of Property	County
1144 Benton Ave	Wayland
Address	City

Location map

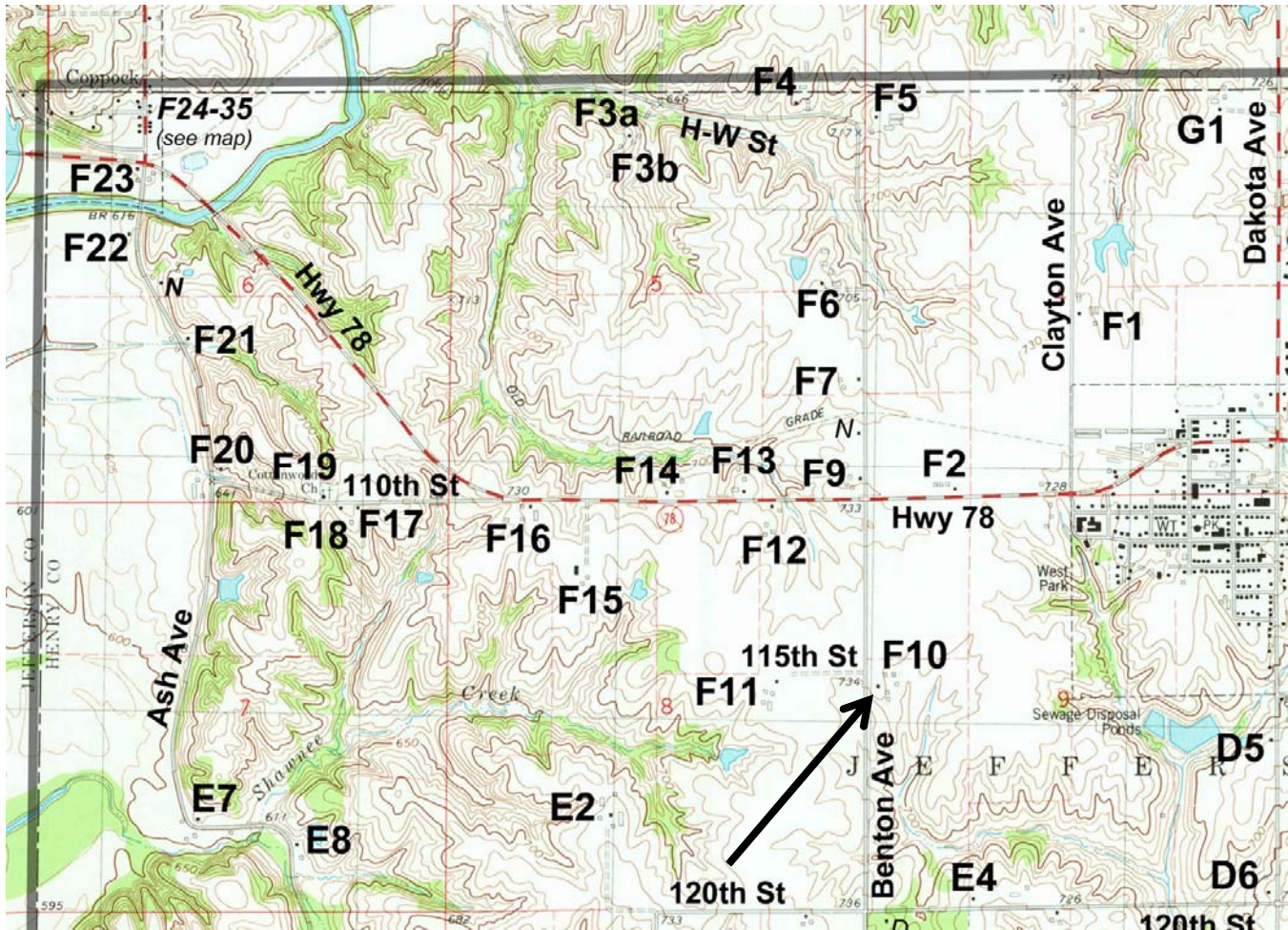

Iowa Site Inventory Form
State Historic Preservation Office
Continuation Sheet

Site Number: 44-02102
Related District Number: _____

Page 8

House
Name of Property

Henry
County

1144 Benton Ave
Address

Wayland
City

Pictometry view from Henry County GIS – 2013 imagery



Iowa Site Inventory Form
State Historic Preservation Office
Continuation Sheet

Site Number: 44-02102
Related District Number: _____

Page 9

House	Henry
Name of Property	County
1144 Benton Ave	Wayland
Address	City

Digital photographs



Photograph 44-02102-001 - House, looking northeast (December 2015)

Iowa Site Inventory Form
State Historic Preservation Office
Continuation Sheet

Site Number: 44-02102
Related District Number: _____

Page 10

House	Henry
Name of Property	County
1144 Benton Ave	Wayland
Address	City



Photograph 44-02102-002 - Barn, looking southeast (December 2015)

Iowa Site Inventory Form
State Historic Preservation Office
Continuation Sheet

Site Number: 44-02102
Related District Number: _____

Page 11

House
Name of Property

1144 Benton Ave
Address

Henry
County

Wayland
City



Photograph 44-02102-003 - Barn, looking south (December 2015)

Iowa Site Inventory Form
State Historic Preservation Office
Continuation Sheet

Site Number: 44-02102
Related District Number: _____

Page 12

House	Henry
Name of Property	County
1144 Benton Ave	Wayland
Address	City



Photograph 44-02102-004 - Buildings, looking northeast (December 2015)

Iowa Site Inventory Form

State Historic Preservation Office

(July 2014)

State Inventory Number: 44-02131 New Supplemental

9-Digit SHPO Review & Compliance (R&C) Number: _____

Non-extant Year: _____

Read the Iowa Site Inventory Form Instructions carefully, to ensure accuracy and completeness before completing this form. The instructions are available on our website: <http://www.iowahistory.org/historic-preservation/statewide-inventory-and-collections/iowa-site-inventory-form.html>

• **Property Name**

A) Historic name: House

B) Other names: Reconnaissance Survey Field Site # D-04

• **Location**

A) Street address: 1171 Delaware Ave

B) City or town: Wayland (Vicinity) County: Henry

C) Legal description:

Rural: Township Name: Jefferson Township No.: 73N Range No.: 7W Section: 010 Quarter: SOUTH SIDE SUB LOT 1 of Quarter: _____

Urban: Subdivision: _____ Block(s): _____ Lot(s): _____

• **Classification**

A) Property category: *Check only one*

- Building(s)
- District
- Site
- Structure
- Object

B) Number of resources (within property):

If eligible property, enter number of:		If non-eligible property, enter number of:	
Contributing	Noncontributing		
—	Buildings	—	Buildings
—	Sites	—	Sites
—	Structures	—	Structures
—	Objects	—	Objects
—	Total	—	Total

C) For properties listed in the National Register:

National Register status: Listed De-listed NHL NPS DOE

D) For properties within a historic district:

- Property contributes to a National Register or local certified historic district.
- Property contributes to a potential historic district, based on professional historic/architectural survey and evaluation.
- Property *does not* contribute to the historic district in which it is located.

Historic district name: _____ Historic district site inventory number: _____

E) Name of related project report or multiple property study, if applicable:

MPD title: Reconnaissance Level Historical/Architectural Survey of Jefferson Township, Henry County Historical Architectural Data Base #: 44-024

• **Function or Use** *Enter categories (codes and terms) from the Iowa Site Inventory Form Instructions*

A) Historic functions

01A01: Domestic-residence

09B01: Agriculture-Farmstead

B) Current functions

01A01: Domestic-residence

• **Description** *Enter categories (codes and terms) from the Iowa Site Inventory Form Instructions*

A) Architectural classification

05D: House-2 stories-gable cross roof-Queen Anne

Foursquare

B) Materials

Foundation (visible exterior): 10A: concrete block (rus.)

Walls (visible exterior): 02A: wood weatherboard

Roof: 05F: steel

Other: _____

C) Narrative description SEE CONTINUATION SHEETS, WHICH MUST BE COMPLETED

Site Number: 44-02131 Address: 1171 Delaware Ave City: Wayland County: Henry District Number:

• **Statement of Significance**

A) Applicable National Register Criteria: *Mark your opinion of eligibility after applying relevant National Register criteria*

- Criterion A: Property is associated with significant events. Yes No More research recommended
Criterion B: Property is associated with the lives of significant persons. Yes No More research recommended
Criterion C: Property has distinctive architectural characteristics. Yes No More research recommended
Criterion D: Property yields significant information in archaeology/history. Yes No More research recommended

B) Special criteria considerations: *Mark any special considerations; leave blank if none*

- A: Owned by a religious institution or used for religious purposes. E: A reconstructed building, object, or structure.
 B: Removed from its original location. F: A commemorative property.
 C: A birthplace or grave. G: Property less than 50 years of age or
 D: A cemetery. achieved significance within the past 50 years.

C) Areas of significance

Enter categories from instructions

D) Period(s) of significance

E) Significant dates

Construction date

1914 *check if circa or estimated date*
Other dates, including renovations

F) Significant person

Complete if Criterion B is marked above

G) Cultural affiliation

Complete if Criterion D is marked above

H) Architect/Builder

Architect

Builder/contractor

I) Narrative statement of significance *SEE CONTINUATION SHEETS, WHICH MUST BE COMPLETED*

• **Bibliography** *See continuation sheets for the list of research sources used in preparing this form*

• **Geographic Data** *Optional UTM references* *See continuation sheet for additional UTM or comments*

Zone	Easting	Northing	NAD	Zone	Easting	Northing	NAD
1	___	___	___	2	___	___	___
3	___	___	___	4	___	___	___

• **Form Preparation**

Name and Title: Marsha Chalupa- volunteer Rebecca Lawin McCarley, consultant Date: 12-10-15
Organization/firm: Henry County Historic Preservation Commission E-mail: -
Street address: Henry County Courthouse, 100 E, Washington St Telephone: 319-385-0756
City or Town: Mount Pleasant State: Iowa Zip code: 52641

• **ADDITIONAL DOCUMENTATION** *Submit the following items with the completed form*

A) For all properties, attach the following, as specified in the Iowa Site Inventory Form Instructions:

- 1. Map** of property's location within the community.
- 2. Glossy color 4x6 photos labeled** on back with property/building name, address, date taken, view shown, and unique photo number.
- 3. Photo key showing each photo number on a map and/or floor plan, using arrows next to each photo number to indicate the location and directional view of each photograph.**
- 4. Site plan** of buildings/structures on site, identifying boundaries, public roads, and building/structure footprints.

B) For State Historic Tax Credit Part 1 Applications, historic districts and farmsteads, and barns:

See lists of special requirements and attachments in the Iowa Site Inventory Form Instructions.

State Historic Preservation Office (SHPO) Use Only Below This Line

The SHPO has reviewed the Site Inventory and concurs with above survey opinion on National Register eligibility:

- Yes No More research recommended
 This is a locally designated property or part of a locally designated district.

Comments: _____

SHPO authorized signature: _____ Date: _____

Iowa Site Inventory Form
State Historic Preservation Office
Continuation Sheet

Site Number: 44-02131
Related District Number: _____

Page 3

House	Henry
Name of Property	County
1171 Delaware Ave	Wayland
Address	City

Construction dates:

Assessor date (1900 is default date): 1914
Better estimated date and source: c.1914

Additional architectural information from the Reconnaissance Survey:

House: Queen Anne-foursquare
Height (stories): 2 stories
Walls (construction/cladding): frame construction-wood siding
Foundation: concrete textured block
Roof style: gable cross
Primary window type: 1/1 wood windows
- storm windows: yes-wood
Porch: yes-wood full front porch & side porch
Front entry:
Other architectural features: Dormers on south, east and north sides. Scalloped shingles or dormers

Garage: none
Walls:
Roof style/material:
Size:
Front faces:
Other architectural features:

Other buildings (list and provide any additional information: garden shed

Additional historical information from the Reconnaissance Survey:

1870 owner/acres: J. Conrad
1895 owner/acres: Thomas Walker – 140 acres (or C. Wenger – 60 acres)
1917 owner/acres: Eli Speidel – 111 acres – house here
1931 owner/acres: I.E. Boshart – 91 acres
1961 owner/acres: A.J. Wyse – 91 acres

2015 property owner: Josh & Stephanie Miller

Iowa Site Inventory Form
State Historic Preservation Office
Continuation Sheet

Site Number: 44-02131
 Related District Number: _____

Page 4

House	Henry
Name of Property	County
1171 Delaware Ave	Wayland
Address	City

Property ownership research conducted for the property:

Grantor/Seller:		Legal Description and other relevant notes:
Grantee/Buyer:		
Date:		
Price:		Deed book record (if listed) – book/page:
Grantor/Seller:		Legal Description and other relevant notes:
Grantee/Buyer:		
Date:		
Price:		Deed book record (if listed) – book/page:

Bibliography

Brooks and Whiting. *Atlas of Henry County, Iowa*. St. Louis, MO: W.E. Stephens and Co., 1895.

Cooper, Carolyn, ed. *Map of Henry County, Iowa 1859*. Reprint Edition. Mt. Pleasant, Iowa : Henry County Genealogical Society, 1989.

Drury, John. *This is Henry County, Iowa*. Chicago: Inland Photo Company, 1956.

Henry County Bicentennial Commission (HCBC). *The History of Henry County, Iowa*. Dallas, TX: National ShareGraphics, Inc., 1982.

Henry County Auditor's Office. Transfer book records, various books/dates.

History of Henry County, Iowa. Chicago: Western Historical Company, 1879.

Jaynes, Peter H., ed. *Highlights of Henry County History 1833-1976*. Burlington, IA: Doran & Ward Lithographing Co., 1977.

Kean Map Company. *Atlas of Henry County, Iowa*. Des Moines: Kean Map Company, 1931.

Mason, George T. *Directory of Henry County, Iowa, 1911-1912*. Mt. Pleasant, IA: The News, 1911.

Ogle, George A. & Co. *Standard Atlas of Henry County, Iowa*. George A. Ogle & Co., 1917.

Portrait and Biographical Album of Henry County, Iowa. Chicago: Acme Publishing Co., 1888.

Thompson and Everts. *Combination Atlas Map of Henry County, Iowa*. Geneva, IL: Thompson and Everts, 1870.

Wayland Centennial Committee. *Wayland: The First Century, 1880-1980*. Wayland, 1980.

Iowa Site Inventory Form
State Historic Preservation Office
Continuation Sheet

Site Number: 44-02131
Related District Number: _____

Page 5

House	Henry
Name of Property	County
1171 Delaware Ave	Wayland
Address	City

Sketch map



Garden
Shed

HOUSE
(c.1914)

Delaware Ave

Iowa Site Inventory Form
State Historic Preservation Office
Continuation Sheet

Site Number: 44-02131
Related District Number: _____

Page 6

House	Henry
Name of Property	County
1171 Delaware Ave	Wayland
Address	City

Location map

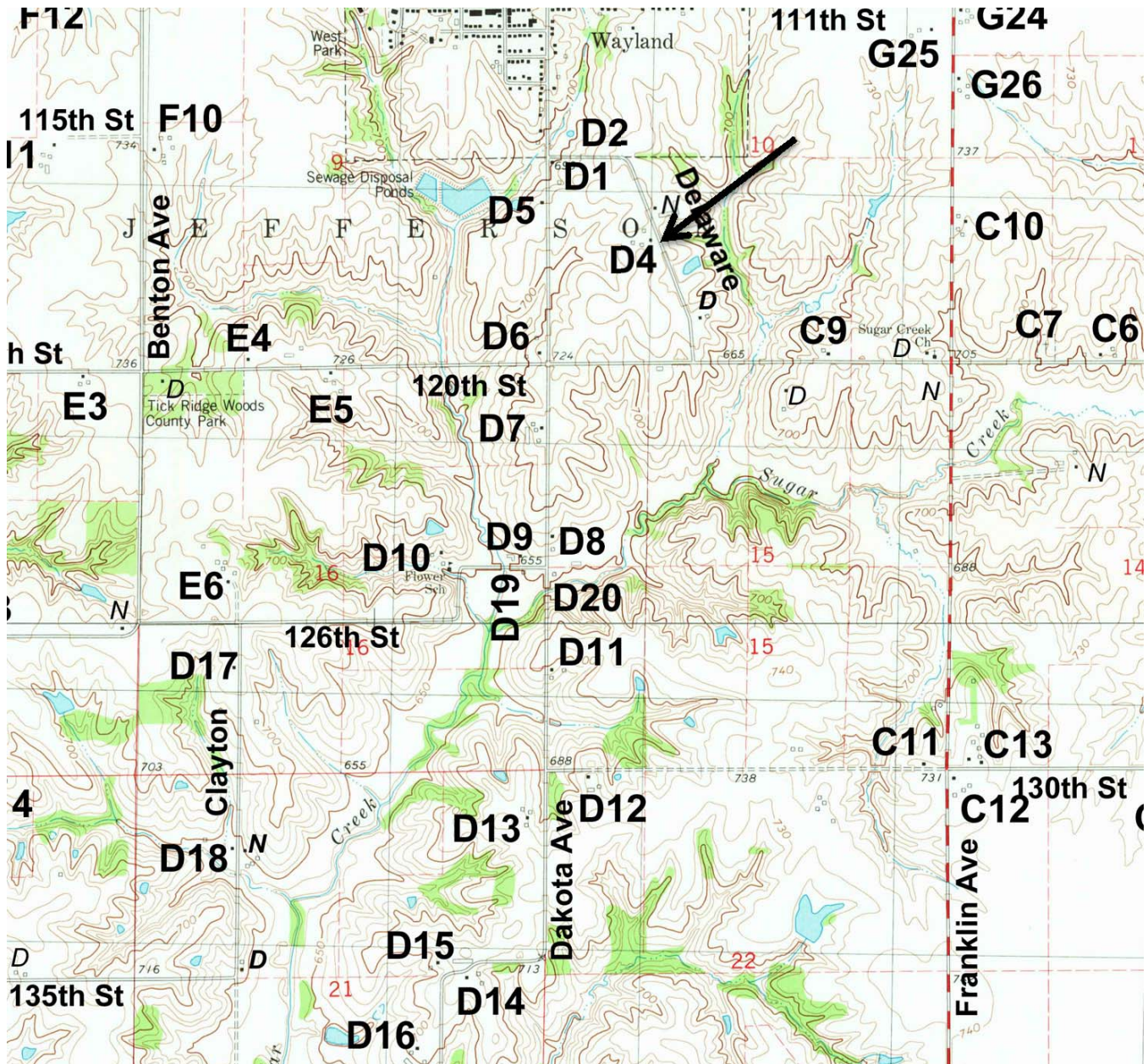

Iowa Site Inventory Form
State Historic Preservation Office
Continuation Sheet

Site Number: 44-02131
Related District Number: _____

Page 7

House	Henry
Name of Property	County
1171 Delaware Ave	Wayland
Address	City

Pictometry view from Henry County GIS – 2013 imagery



Iowa Site Inventory Form
State Historic Preservation Office
Continuation Sheet

Site Number: 44-02131
Related District Number: _____

Page 8

House	Henry
Name of Property	County
1171 Delaware Ave	Wayland
Address	City

Digital photographs



Photograph 44-02131 - House, looking northwest (December 2015)

Iowa Site Inventory Form

State Historic Preservation Office

(July 2014)

State Inventory Number: 44-02142 New Supplemental

9-Digit SHPO Review & Compliance (R&C) Number: _____

Non-extant Year: _____

Read the Iowa Site Inventory Form Instructions carefully, to ensure accuracy and completeness before completing this form. The instructions are available on our website: <http://www.iowahistory.org/historic-preservation/statewide-inventory-and-collections/iowa-site-inventory-form.html>

• **Property Name**

A) Historic name: House

B) Other names: Reconnaissance Survey Field Site # B-17

• **Location**

A) Street address: 1577 Franklin Ave

B) City or town: Wayland (Vicinity) County: Henry

C) Legal description:

Rural: Township Name: Jefferson Township No.: 73N Range No.: 7W Section: 34: E 20' N 346.8' SE SE EX RD

Urban: Subdivision: _____ Block(s): Lot(s): _____

• **Classification**

A) Property category: *Check only one*

- Building(s)
- District
- Site
- Structure
- Object

B) Number of resources (within property):

If eligible property, enter number of:		If non-eligible property, enter number of:	
Contributing	Noncontributing		
—	Buildings	—	Buildings
—	Sites	—	Sites
—	Structures	—	Structures
—	Objects	—	Objects
—	Total	—	Total

C) For properties listed in the National Register:

National Register status: Listed De-listed NHL NPS DOE

D) For properties within a historic district:

- Property contributes to a National Register or local certified historic district.
- Property contributes to a potential historic district, based on professional historic/architectural survey and evaluation.
- Property *does not* contribute to the historic district in which it is located.

Historic district name: _____ Historic district site inventory number: _____

E) Name of related project report or multiple property study, if applicable:

MPD title

Historical Architectural Data Base #

Reconnaissance Level Historical/Architectural Survey of Jefferson Township, Henry County 44-024

• **Function or Use** *Enter categories (codes and terms) from the Iowa Site Inventory Form Instructions*

A) Historic functions

01A01: Domestic-residence

B) Current functions

01A01: Domestic-residence

• **Description** *Enter categories (codes and terms) from the Iowa Site Inventory Form Instructions*

A) Architectural classification

09A03: House-1 story, gable side roof

B) Materials

Foundation (visible exterior): 03: brick

Walls (visible exterior): 03: brick

Roof: 05: metal

Other: _____

C) Narrative description *SEE CONTINUATION SHEETS, WHICH MUST BE COMPLETED*

Site Number: 44-02142 Address: 1577 Franklin Ave City: Wayland County: Henry District Number:

• **Statement of Significance**

A) Applicable National Register Criteria: *Mark your opinion of eligibility after applying relevant National Register criteria*

- Criterion A: Property is associated with significant events. Yes No More research recommended
Criterion B: Property is associated with the lives of significant persons. Yes No More research recommended
Criterion C: Property has distinctive architectural characteristics. Yes No More research recommended
Criterion D: Property yields significant information in archaeology/history. Yes No More research recommended

B) Special criteria considerations: *Mark any special considerations; leave blank if none*

- A: Owned by a religious institution or used for religious purposes. E: A reconstructed building, object, or structure.
 B: Removed from its original location. F: A commemorative property.
 C: A birthplace or grave. G: Property less than 50 years of age or
 D: A cemetery. achieved significance within the past 50 years.

C) Areas of significance

Enter categories from instructions

D) Period(s) of significance

E) Significant dates

Construction date

1850s *check if circa or estimated date*
Other dates, including renovations

F) Significant person

Complete if Criterion B is marked above

G) Cultural affiliation

Complete if Criterion D is marked above

H) Architect/Builder

Architect

Builder/contractor

I) Narrative statement of significance *SEE CONTINUATION SHEETS, WHICH MUST BE COMPLETED*

• **Bibliography** *See continuation sheets for the list of research sources used in preparing this form*

• **Geographic Data** *Optional UTM references* *See continuation sheet for additional UTM or comments*

Zone	Easting	Northing	NAD	Zone	Easting	Northing	NAD
1	___	___	___	2	___	___	___
3	___	___	___	4	___	___	___

• **Form Preparation**

Name and Title: Marsha Chalupa - volunteer Rebecca Lawin McCarley, consultant Date: 2-22-16
Organization/firm: Henry County Historic Preservation Commission E-mail: -
Street address: Henry County Courthouse, 100 E, Washington St Telephone: 319-385-0756
City or Town: Mount Pleasant State: Iowa Zip code: 52641

• **ADDITIONAL DOCUMENTATION** *Submit the following items with the completed form*

A) For all properties, attach the following, as specified in the Iowa Site Inventory Form Instructions:

- 1. Map** of property's location within the community.
- 2. Glossy color 4x6 photos labeled** on back with property/building name, address, date taken, view shown, and unique photo number.
- 3. Photo key showing each photo number on a map and/or floor plan, using arrows next to each photo number to indicate the location and directional view of each photograph.**
- 4. Site plan** of buildings/structures on site, identifying boundaries, public roads, and building/structure footprints.

B) For State Historic Tax Credit Part 1 Applications, historic districts and farmsteads, and barns:

See lists of special requirements and attachments in the Iowa Site Inventory Form Instructions.

State Historic Preservation Office (SHPO) Use Only Below This Line

The SHPO has reviewed the Site Inventory and concurs with above survey opinion on National Register eligibility:

- Yes No More research recommended
 This is a locally designated property or part of a locally designated district.

Comments: _____

SHPO authorized signature: _____ Date: _____

Iowa Site Inventory Form
State Historic Preservation Office
Continuation Sheet

Site Number: 44-02142
Related District Number: _____

Page 3

House	Henry
Name of Property	County
1577 Franklin Ave	Wayland
Address	City

Construction dates:

Assessor date (1900 is default date): 1900

Better estimated date and source: c.1850s – may be early 1860s

Additional architectural information from the Reconnaissance Survey:

House:

Height (stories): 1 story
Walls (construction/cladding): frame construction-brick
Foundation: brick
Roof style: gable side
Primary window type: 1/1 wood windows
- storm windows:
Porch: yes-wood entry porch
Front entry:
Other architectural features:

Garage: c.1920s

Walls: frame construction-metal siding
Roof style/material: gable front-metal
Size: 2 car
Front faces: east
Other architectural features: doors

Other buildings (list and provide any additional information:
poultry house

Additional historical information from the Reconnaissance Survey:

1859 owner: P. Morrison? – large tract, including these 40 acres (J. Harrison to north)
1870 owner/acres: small tract with house – S.H.
1895 owner/acres: Samuel Hulme, 40 acres – also 60 acres to northwest in Sec 35
1917 owner/acres: Samuel Hulme – 160 acres – also 60 to northwest
1931 owner/acres: Max Hulme, 80 acres
1961 owner/acres: M.H. Hulme – 80 acres

August 2000 – James Page Hulme transferred the property to Sandra Hoover

2015 property owner: Sandra Hoover

Iowa Site Inventory Form
State Historic Preservation Office
Continuation Sheet

Site Number: 44-02142
Related District Number: _____

Page 4

House	Henry
Name of Property	County
1577 Franklin Ave	Wayland
Address	City

a Perry Morrison is consistently listed in Trenton Twp to south in 1850s-1880s
he is noted in the 1888 county history as one of the first settlers in Trenton Twp
1879 county history notes "Morrison, P., farmer, Section 2, P.O. Trenton" in the Trenton Twp directory

Samuel Hulme owned from roughly 1860s to 1910s

1850 census – Mt Pleasant – Henry Co, IA
John S. Green – 34 – clerk – born in PA
E.P. Hulme – 38 – female – born in PA (sister?)
- Samuel – 14 – born in NJ
- James P. – 12 – born in PA
- Rebecca S – 9 – born in PA

1860 census – Jefferson Twp – Henry Co
H. Howard – 59 – farmer - \$10,000 in real estate – born in England
- Elizabeth – 46 – born in PA (likely E.P. Hulme)
- Joel – 28 – born in OH
- Sarah J – 18 – born in IA
- Martha – 16 – born in IA
- Samuel Hulme – 23 – born in NJ
- Rebecca Hulme – 17 – born in PA
- also three laborers

1870 census – Jefferson Twp – in this area based on other names
Samuel Holme – 33 – farmer - \$3120 in real estate - \$200 in personal – born in NJ
- Sarah – 28 – born in IA
- Howard – 8 – born in IA
- Anna – 4 – born in IA
- Mary – 1 – born in Iowa

1885 Iowa census – Jefferson Twp – living here
Samuel Hulme – 48 – born in NJ
- Sarah – 43
- Howard – 21
- Anna – 18
- Mary – 15
- Alice – 12
- Bessie - 7

Iowa Site Inventory Form
State Historic Preservation Office
Continuation Sheet

Site Number: 44-02142
 Related District Number: _____

Page 5

House	Henry
Name of Property	County
1577 Franklin Ave	Wayland
Address	City

Property ownership research conducted for the property:

not completed for this property

Grantor/Seller:		Legal Description and other relevant notes:
Grantee/Buyer:		
Date:		
Price:		Deed book record (if listed) – book/page:
Grantor/Seller:		Legal Description and other relevant notes:
Grantee/Buyer:		
Date:		
Price:		Deed book record (if listed) – book/page:

Bibliography

Brooks and Whiting. *Atlas of Henry County, Iowa*. St. Louis, MO: W.E. Stephens and Co., 1895.

Cooper, Carolyn, ed. *Map of Henry County, Iowa 1859*. Reprint Edition. Mt. Pleasant, Iowa : Henry County Genealogical Society, 1989.

Drury, John. *This is Henry County, Iowa*. Chicago: Inland Photo Company, 1956.

Henry County Bicentennial Commission (HCBC). *The History of Henry County, Iowa*. Dallas, TX: National ShareGraphics, Inc., 1982.

Henry County Auditor's Office. Transfer book records, various books/dates.

History of Henry County, Iowa. Chicago: Western Historical Company, 1879.

Jaynes, Peter H., ed. *Highlights of Henry County History 1833-1976*. Burlington, IA: Doran & Ward Lithographing Co., 1977.

Kean Map Company. *Atlas of Henry County, Iowa*. Des Moines: Kean Map Company, 1931.

Mason, George T. *Directory of Henry County, Iowa, 1911-1912*. Mt. Pleasant, IA: The News, 1911.

Ogle, George A. & Co. *Standard Atlas of Henry County, Iowa*. George A. Ogle & Co., 1917.

Portrait and Biographical Album of Henry County, Iowa. Chicago: Acme Publishing Co., 1888.

Thompson and Everts. *Combination Atlas Map of Henry County, Iowa*. Geneva, IL: Thompson and Everts, 1870.

Wayland Centennial Committee. *Wayland: The First Century, 1880-1980*. Wayland, 1980.

Iowa Site Inventory Form
State Historic Preservation Office
Continuation Sheet

Site Number: 44-02142
Related District Number: _____

Page 6

House	Henry
Name of Property	County
1577 Franklin Ave	Wayland
Address	City

Sketch map

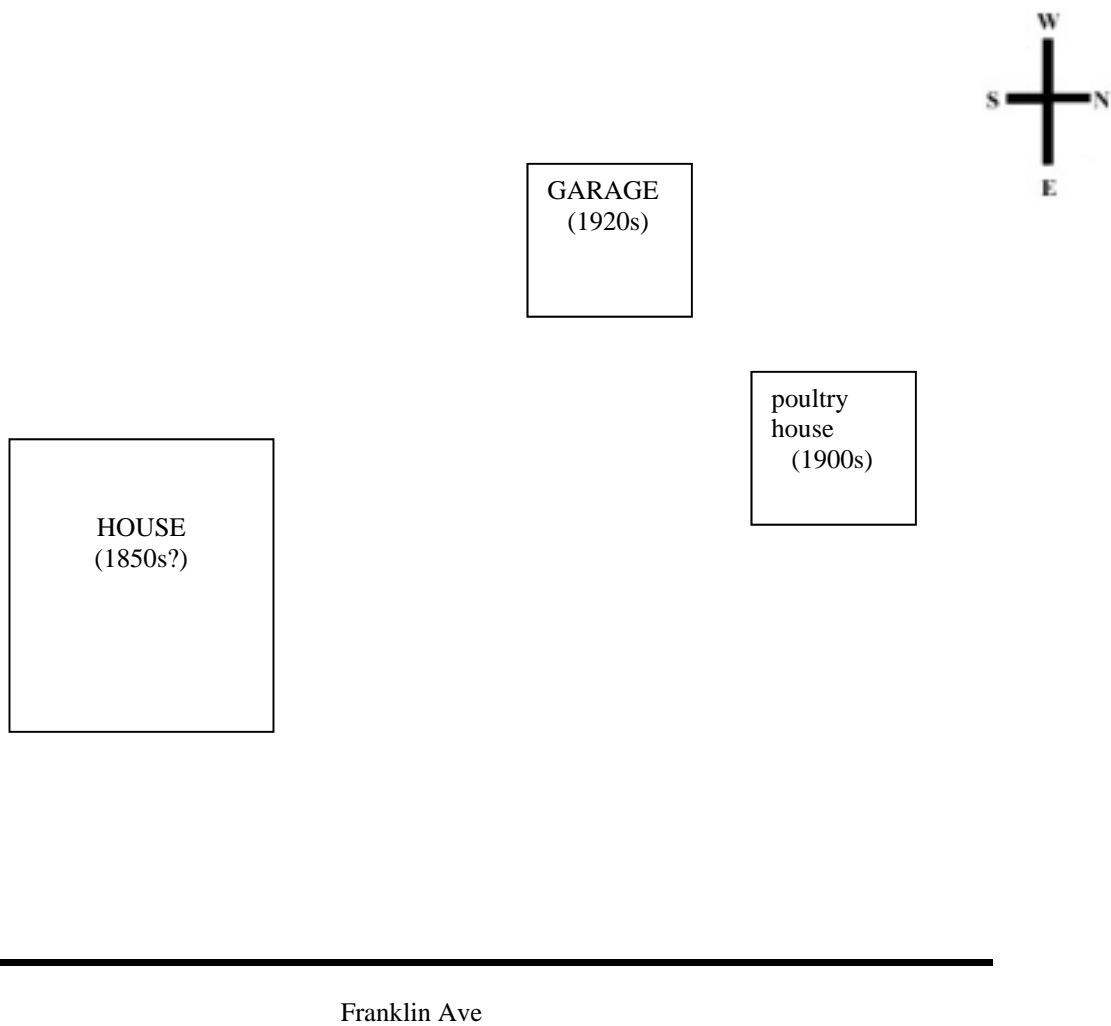

Iowa Site Inventory Form
State Historic Preservation Office
Continuation Sheet

Site Number: 44-02142
Related District Number: _____

Page 7

House	Henry
Name of Property	County
1577 Franklin Ave	Wayland
Address	City

Location map

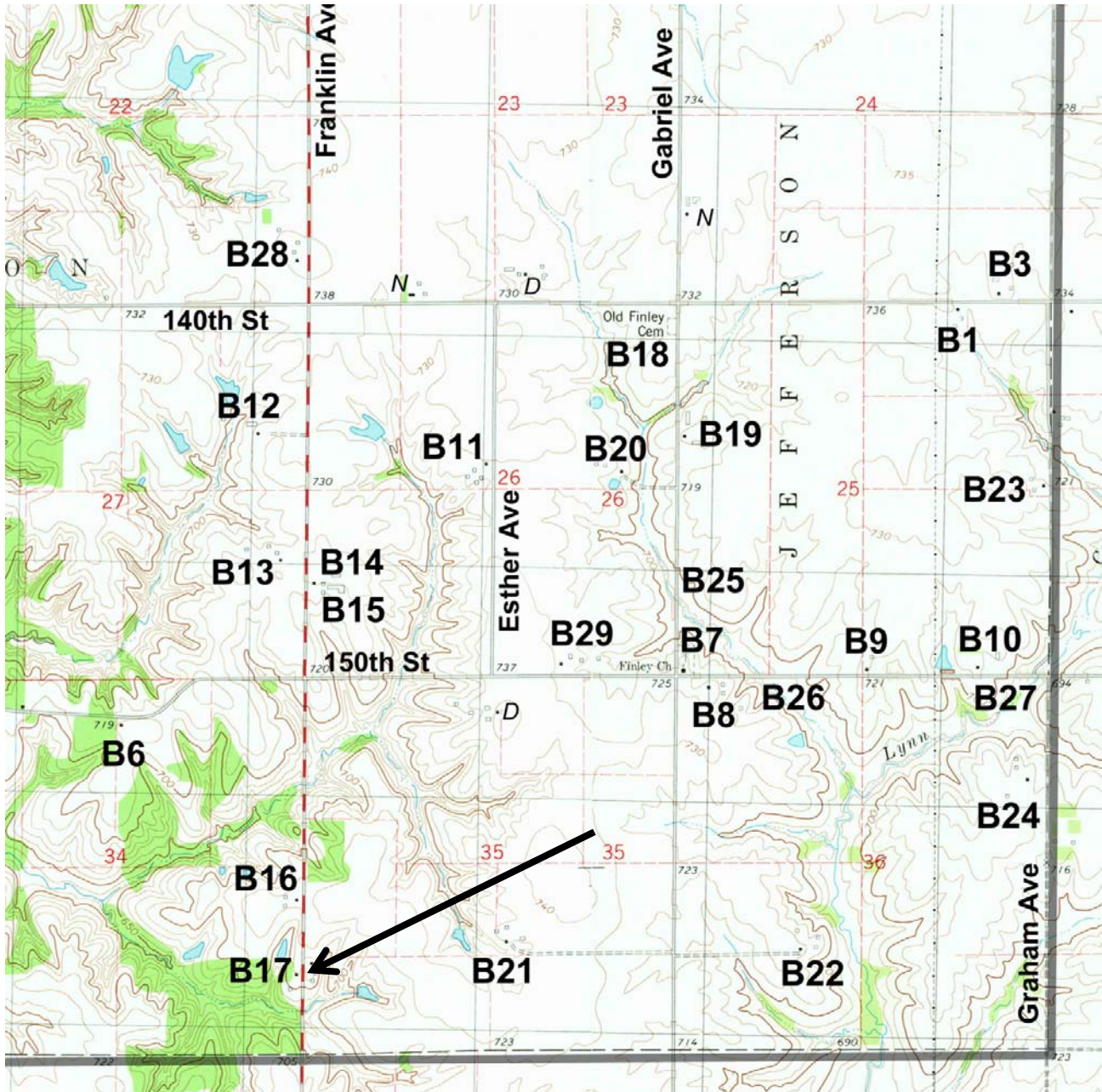

Iowa Site Inventory Form
State Historic Preservation Office
Continuation Sheet

Site Number: 44-02142
Related District Number: _____

Page 8

House	Henry
Name of Property	County
1577 Franklin Ave	Wayland
Address	City

Pictometry view from Henry County GIS – 2013 imagery



Iowa Site Inventory Form
State Historic Preservation Office
Continuation Sheet

Site Number: 44-02142
Related District Number: _____

Page 9

House	Henry
Name of Property	County
1577 Franklin Ave	Wayland
Address	City

Digital photographs



Photograph 44-02142-001 - House, looking southwest (December 2015)

Iowa Site Inventory Form
State Historic Preservation Office
Continuation Sheet

Site Number: 44-02142
Related District Number: _____

Page 10

House	Henry
Name of Property	County
1577 Franklin Ave	Wayland
Address	City



Photograph 44-02142-002 - House, looking west (October 2015)

Iowa Site Inventory Form
State Historic Preservation Office
Continuation Sheet

Site Number: 44-02142
Related District Number: _____

Page 11

House	Henry
Name of Property	County
1577 Franklin Ave	Wayland
Address	City



Photograph 44-02142-003 - House, looking southwest (October 2015)

Iowa Site Inventory Form

State Historic Preservation Office

(July 2014)

State Inventory Number: 44-02081 New Supplemental

9-Digit SHPO Review & Compliance (R&C) Number: _____

Non-extant Year: _____

Read the Iowa Site Inventory Form Instructions carefully, to ensure accuracy and completeness before completing this form. The instructions are available on our website: <http://www.iowahistory.org/historic-preservation/statewide-inventory-and-collections/iowa-site-inventory-form.html>

• **Property Name**

A) Historic name: Finley Chapel

B) Other names: Reconnaissance Survey Field Site # B-07

• **Location**

A) Street address: 1501 150th St

B) City or town: Wayland (Vicinity) County: Henry

C) Legal description:

Rural: Township Name: Jefferson Township No.: 73N Range No.: 7W Section: 025 TR SW COR SW SW (13 RDS X 13RDS) Quarter: ___ of Quarter: _____

Urban: Subdivision: _____ Block(s): ___ Lot(s): _____

• **Classification**

A) Property category: *Check only one*

- Building(s)
- District
- Site
- Structure
- Object

B) Number of resources (within property):

If eligible property, enter number of:		If non-eligible property, enter number of:	
Contributing	Noncontributing		
___	Buildings ___	___	Buildings
___	Sites ___	___	Sites
___	Structures ___	___	Structures
___	Objects ___	___	Objects
___	Total ___	___	Total

C) For properties listed in the National Register:

National Register status: Listed De-listed NHL NPS DOE

D) For properties within a historic district:

- Property contributes to a National Register or local certified historic district.
- Property contributes to a potential historic district, based on professional historic/architectural survey and evaluation.
- Property *does not* contribute to the historic district in which it is located.

Historic district name: _____ Historic district site inventory number: _____

E) Name of related project report or multiple property study, if applicable:

MPD title Reconnaissance Level Historical/Architectural Survey of Jefferson Township, Henry County Historical Architectural Data Base # 44-024

• **Function or Use** *Enter categories (codes and terms) from the Iowa Site Inventory Form Instructions*

A) Historic functions

06A01: Church

B) Current functions

06A01: Church

• **Description** *Enter categories (codes and terms) from the Iowa Site Inventory Form Instructions*

A) Architectural classification

09G: Church-1 story, gable front

B) Materials

Foundation (visible exterior): 03: &10: brick & cement

Walls (visible exterior): 15B: vinyl siding

Roof: 05: metal

Other: _____

C) Narrative description *SEE CONTINUATION SHEETS, WHICH MUST BE COMPLETED*

Site Number: 44-02081 Address: 1501 150th St City: Wayland County: Henry District Number:

• **Statement of Significance**

A) Applicable National Register Criteria: *Mark your opinion of eligibility after applying relevant National Register criteria*

- Criterion A: Property is associated with significant events. Yes No More research recommended
Criterion B: Property is associated with the lives of significant persons. Yes No More research recommended
Criterion C: Property has distinctive architectural characteristics. Yes No More research recommended
Criterion D: Property yields significant information in archaeology/history. Yes No More research recommended

B) Special criteria considerations: *Mark any special considerations; leave blank if none*

- A: Owned by a religious institution or used for religious purposes. E: A reconstructed building, object, or structure.
 B: Removed from its original location. F: A commemorative property.
 C: A birthplace or grave. G: Property less than 50 years of age or
 D: A cemetery. achieved significance within the past 50 years.

C) Areas of significance

Enter categories from instructions

D) Period(s) of significance

E) Significant dates

Construction date

1938 *check if circa or estimated date*
Other dates, including renovations

F) Significant person

Complete if Criterion B is marked above

G) Cultural affiliation

Complete if Criterion D is marked above

H) Architect/Builder

Architect

Builder/contractor

I) Narrative statement of significance *SEE CONTINUATION SHEETS, WHICH MUST BE COMPLETED*

• **Bibliography** *See continuation sheets for the list of research sources used in preparing this form*

• **Geographic Data** *Optional UTM references* *See continuation sheet for additional UTM or comments*

Zone	Easting	Northing	NAD	Zone	Easting	Northing	NAD
1	___	___	___	2	___	___	___
3	___	___	___	4	___	___	___

• **Form Preparation**

Name and Title: Marsha Chalupa - volunteer Rebecca Lawin McCarley, consultant Date: 2-19-16
Organization/firm: Henry County Historic Preservation Commission E-mail: -
Street address: Henry County Courthouse, 100 E, Washington St Telephone: 319-385-0756
City or Town: Mount Pleasant State: Iowa Zip code: 52641

• **ADDITIONAL DOCUMENTATION** *Submit the following items with the completed form*

A) For all properties, attach the following, as specified in the Iowa Site Inventory Form Instructions:

- 1. Map** of property's location within the community.
- 2. Glossy color 4x6 photos labeled** on back with property/building name, address, date taken, view shown, and unique photo number.
- 3. Photo key showing each photo number on a map and/or floor plan, using arrows next to each photo number to indicate the location and directional view of each photograph.**
- 4. Site plan** of buildings/structures on site, identifying boundaries, public roads, and building/structure footprints.

B) For State Historic Tax Credit Part 1 Applications, historic districts and farmsteads, and barns:

See lists of special requirements and attachments in the Iowa Site Inventory Form Instructions.

State Historic Preservation Office (SHPO) Use Only Below This Line

The SHPO has reviewed the Site Inventory and concurs with above survey opinion on National Register eligibility:

- Yes No More research recommended
 This is a locally designated property or part of a locally designated district.

Comments: _____

SHPO authorized signature: _____ Date: _____

Iowa Site Inventory Form
State Historic Preservation Office
Continuation Sheet

Site Number: 44-02081
Related District Number: _____

Page 3

Finley Chapel	Henry
Name of Property	County
1501 150 th St	Wayland
Address	City

Construction dates:

Assessor date (1900 is default date):
Better estimated date and source: 1938

Additional architectural information from the Reconnaissance Survey:

Church:

Height (stories): 1 story
Walls (construction/cladding): frame construction-vinyl siding
Foundation: brick & concrete
Roof style: gable front
Primary window type: 1/1
- storm windows:
Porch: none
Front entry:
Other architectural features: has a ramp and steps to go into the church

cemetery on property also

Additional historical information from the Reconnaissance Survey:

1870 owner/acres: Church
1895 owner/acres: Church
1917 owner/acres: Church
1931 owner/acres: Church

2015 property owner: Church Trustees Of Methodist

1851 - Finley Chapel – Jefferson Twp, Section 25 – M.E. Church – part of Marshall circuit in 1851 – meetings held in Maple Grove School – then home of John Everts – first church built in 1856 – historic photo shows gable-oriented building with two doors – first building noted as plain rectangular frame building with two doors spaced equally on the front, three windows on the sides, and a chimney in the center of the building – pulpit in center of north end with an Amen section to either side – short straight pews – no basement – sold and moved to farm when new church built (*Centennial History of Finley Methodist Church*, June 3-4, 1951) – first doctor in Trenton was William Finley – may have been named after him – part of Marshall Mission Circuit starting in 1851 – church had two entry doors – three windows on each side – chimney/stove in center – pulpit in center at the north end – Amen section on either side – short straight pews – new church built in 1901 – old building moved to nearby farm (HCBC 1982: 74)

Iowa Site Inventory Form
State Historic Preservation Office
Continuation Sheet

Site Number: 44-02081
Related District Number: _____

Page 4

Finley Chapel	Henry
Name of Property	County
1501 150 th St	Wayland
Address	City

1851 – Finley Chapel is part of Marshall circuit – services held in Maple Grove School and home of John Everts until first building constructed around 1856 – southwest corner of Section 25 (WCC 1980: 258)

Section 25 – Finley Cemetery – associated with Finley Church – earliest – Sylvia C. Goble – 1853 – others also before church built in 1856 – over 353 burials – still in use (WCC 1980: 301)

March 15, 1852 – Baptist Church organized – Section 26 – cemetery only thing that is left – home of Robert Stockton – Hiram Burnett chosen as moderator and clerk – organized many Baptist churches in Henry Co – one mile south of Finley – not enough people for two churches – church appears disbanded by 1870s – last burial in cemetery in 1911 – contractor and builder George Conover – seven children buried there earlier 1851 (WCC 1980: 260)

“Jefferson Township,” *Mt Pleasant Free Press*, January 6, 1875, 2
eight churches: Marshall M.E. Church, Center Chapel M.E., Finley Chapel M.E. (J.C. Kendrick is pastor for three M.E. churches), Cottonwood, Henthron, and Mount Ayr – United Brethren (Rev. Thomas Brown for three U.B. churches) – Mennonite (Joseph Stayla) – Baptist Church (no regular pastor)

1879 – Marshall Mission became Wayland Circuit, Burlington District – Finley Chapel included on circuit (WCC 1980: 259)

Finley Chapel – Jefferson Twp, Section 25 – (*Centennial History of Finley Methodist Church*, June 3-4, 1951) – new church built in 1901 – old building moved to nearby farm (HCBC 1982: 74) – “Finley Chapel” noted on 1895 map – new building in 1901 – three gables with corner bell tower – 1911 county directory - Finley Chapel – M.E. Church – Section 25 – Rev. J.W. Carson, pastor - destroyed by fire on December 18, 1936

1901 – Finley Chapel – c.1856 building moved to nearby farm – new church built on site – 40 by 46 – steeple and belfry – modern interior arrangement – center pulpit – pews in semi-circle around – fire in 1936 (WCC 1980: 258)

1911-12 county directory (Mason 1911: 204)

six pages for Jefferson Township (also six for Wayland, one for Coppock – see separate)

Amish Mennonite Church – Section 10

Finley Chapel – M.E. Church – section 25 – Rev. J.W. Carson

Mt. Ayr U.B. Church – section 32

Sugar Creek Mennonite Church – Section 6

Finley Chapel – Jefferson Twp, Section 25 – M.E. Church – destroyed by fire on December 18, 1936 – worked to rebuild – services in Union School two miles to east – then in Flowers School – two miles to north – met on December 20, 1936 to discuss building new church – Methodist Church at Hillsboro closed – Conference held title to building – agreed to have building demolished and material used for new church for Finley – built by John and Joe Reschley - cornerstone on September 12, 1937 – article on **dedication on May 1, 1938** – “probably is the finest strictly rural church in the county” – replaced building destroyed by fire – larger gable-oriented church – vestibule on front – five windows per side – membership around 100 - \$2500 in insurance - \$2500 in pledges – volunteer labor – contractors John and Joe Reschley (brothers) (*Centennial History of Finley Methodist Church*, June 3-4, 1951)

Iowa Site Inventory Form
State Historic Preservation Office
Continuation Sheet

Site Number: 44-02081
 Related District Number: _____

Page 5

Finley Chapel	Henry
Name of Property	County
1501 150 th St	Wayland
Address	City

December 18, 1936 – fire at Finley Chapel – membership around 100 – continued to meet – Union School – Flowers School – vote to rebuild on December 20 – move building from Hillsboro – permission of Iowa Conference – cornerstone laid on September 12, 1937 – dedicated on May 1, 1938 – same site – center aisle on interior (WCC 1980: 258)

Jun 3-4, 1951 – centennial celebrated for Finley Chapel (WCC 1980: 259) – have booklet

1951 – Wayland circuit of Methodist Church – church in Wayland, church in Trenton, and Finley Chapel (WCC 1980: 146)

1968 – merger of Methodist and United Brethren – Finley Chapel – member of the United Methodist Church – three churches on circuit – Wayland, Trenton, Finley – then Cottonwood added in 1971 – Wayland Circuit, Muscatine District – became New Life United Methodist Parish in 1975 (WCC 1980: 259)

1980 – cemeteries in Jefferson Township
 Section 25 – Finley Cemetery – associated with Finley Church – earliest – Sylvia C. Goble – 1853 – others also before church built in 1856 – over 353 burials – still in use (WCC 1980: 301)

Property ownership research conducted for the property:

Grantor/Seller:		Legal Description and other relevant notes:
Grantee/Buyer:		
Date:		
Price:		Deed book record (if listed) – book/page:
Grantor/Seller:		Legal Description and other relevant notes:
Grantee/Buyer:		
Date:		
Price:		Deed book record (if listed) – book/page:

Iowa Site Inventory Form
State Historic Preservation Office
Continuation Sheet

Site Number: 44-02081
Related District Number: _____

Page 6

Finley Chapel	Henry
Name of Property	County
1501 150 th St	Wayland
Address	City

Bibliography

Brooks and Whiting. *Atlas of Henry County, Iowa*. St. Louis, MO: W.E. Stephens and Co., 1895.

Cooper, Carolyn, ed. *Map of Henry County, Iowa 1859*. Reprint Edition. Mt. Pleasant, Iowa : Henry County Genealogical Society, 1989.

Drury, John. *This is Henry County, Iowa*. Chicago: Inland Photo Company, 1956.

Henry County Bicentennial Commission (HCBC). *The History of Henry County, Iowa*. Dallas, TX: National ShareGraphics, Inc., 1982.

Henry County Auditor's Office. Transfer book records, various books/dates.

History of Henry County, Iowa. Chicago: Western Historical Company, 1879.

Jaynes, Peter H., ed. *Highlights of Henry County History 1833-1976*. Burlington, IA: Doran & Ward Lithographing Co., 1977.

Kean Map Company. *Atlas of Henry County, Iowa*. Des Moines: Kean Map Company, 1931.

Mason, George T. *Directory of Henry County, Iowa, 1911-1912*. Mt. Pleasant, IA: The News, 1911.

Ogle, George A. & Co. *Standard Atlas of Henry County, Iowa*. George A. Ogle & Co., 1917.

Portrait and Biographical Album of Henry County, Iowa. Chicago: Acme Publishing Co., 1888.

Thompson and Everts. *Combination Atlas Map of Henry County, Iowa*. Geneva, IL: Thompson and Everts, 1870.

Wayland Centennial Committee. *Wayland: The First Century, 1880-1980*. Wayland, 1980.

Iowa Site Inventory Form
State Historic Preservation Office
Continuation Sheet

Site Number: 44-02081
Related District Number: _____

Page 7

<u>Finley Chapel</u>	<u>Henry</u>
Name of Property	County
<u>1501 150th St</u>	<u>Wayland</u>
Address	City

Sketch map

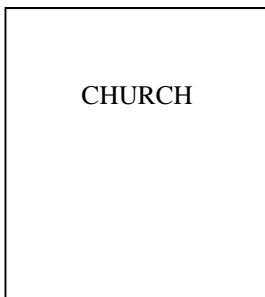
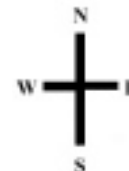

150th

Iowa Site Inventory Form
State Historic Preservation Office
Continuation Sheet

Site Number: 44-02081
Related District Number: _____

Page 8

Finley Chapel
Name of Property
1501 150th St
Address

Henry
County
Wayland
City

Location map

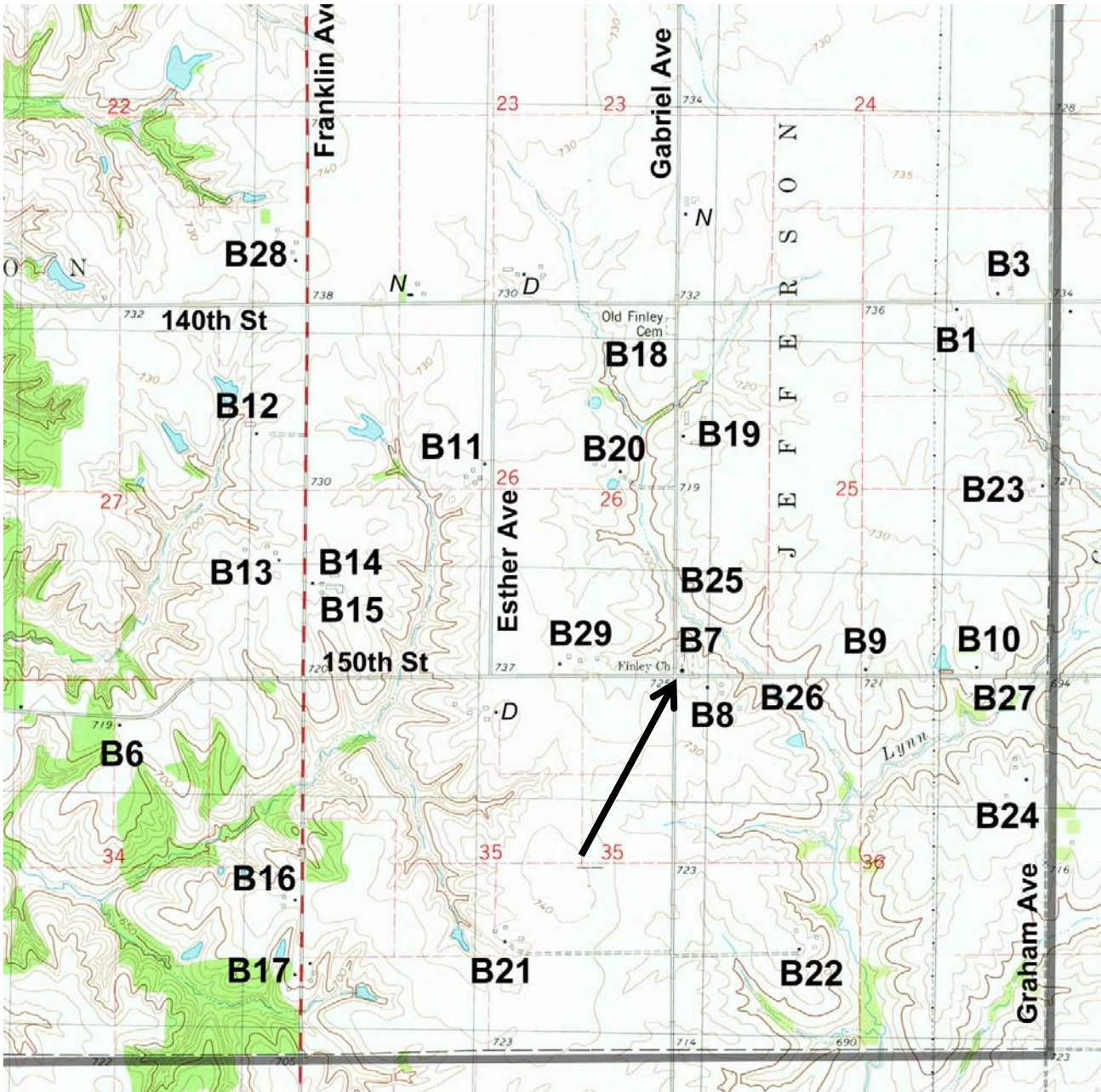

Iowa Site Inventory Form
State Historic Preservation Office
Continuation Sheet

Site Number: 44-02081
Related District Number: _____

Page 9

Finley Chapel
Name of Property

Henry
County

1501 150th St
Address

Wayland
City

Pictometry view from Henry County GIS – 2013 imagery



Iowa Site Inventory Form
State Historic Preservation Office
Continuation Sheet

Site Number: 44-02081
Related District Number: _____

Page 10

Finley Chapel
Name of Property

Henry
County

1501 150th St
Address

Wayland
City

Digital photographs



Photograph 44-02081-001 – Finley Chapel, looking northeast (December 2015)

Iowa Site Inventory Form
State Historic Preservation Office
Continuation Sheet

Site Number: 44-02081
Related District Number: _____

Page 11

Finley Chapel
Name of Property

Henry
County

1501 150th St
Address

Wayland
City



Photograph 44-02081-002 – Finley Chapel, looking northwest (December 2015)

Iowa Site Inventory Form

State Historic Preservation Office

(July 2014)

State Inventory Number: 44-02143 New Supplemental

9-Digit SHPO Review & Compliance (R&C) Number: _____

Non-extant Year: _____

Read the Iowa Site Inventory Form Instructions carefully, to ensure accuracy and completeness before completing this form. The instructions are available on our website: <http://www.iowahistory.org/historic-preservation/statewide-inventory-and-collections/iowa-site-inventory-form.html>

• Property Name

A) Historic name: Bridge

B) Other names: Reconnaissance Survey Field Site #C-25

• Location

A) Street address: 1000s Gabriel - Between Section 13 & 14 on Gabriel Ave

B) City or town: Wayland (Vicinity) County: Henry

C) Legal description:

Rural: Township Name: Jefferson Township No.: 73N Range No.: 7W Section: _____ Quarter: _____ of Quarter: _____

Urban: Subdivision: _____ Block(s): _____ Lot(s): _____

• Classification

A) Property category: *Check only one*

- Building(s)
- District
- Site
- Structure
- Object

B) Number of resources (within property):

If eligible property, enter number of:		If non-eligible property, enter number of:	
Contributing	Noncontributing		
—	Buildings	—	Buildings
—	Sites	—	Sites
—	Structures	—	Structures
—	Objects	—	Objects
—	Total	—	Total

C) For properties listed in the National Register:

National Register status: Listed De-listed NHL NPS DOE

D) For properties within a historic district:

- Property contributes to a National Register or local certified historic district.
- Property contributes to a potential historic district, based on professional historic/architectural survey and evaluation.
- Property *does not* contribute to the historic district in which it is located.

Historic district name: _____ Historic district site inventory number: _____

E) Name of related project report or multiple property study, if applicable:

MPD title

Historical Architectural Data Base #

Reconnaissance Level Historical/Architectural Survey of Jefferson Township, Henry County 44-024

• Function or Use *Enter categories (codes and terms) from the Iowa Site Inventory Form Instructions*

A) Historic functions

14D04: Bridge

B) Current functions

14D04: Bridge

• Description *Enter categories (codes and terms) from the Iowa Site Inventory Form Instructions*

A) Architectural classification

09E26: Bridge – Concrete Culverts

B) Materials

Foundation (visible exterior): 10A: Concrete Poured

Walls (visible exterior): 10A: Concrete Poured

Roof: _____

Other: _____

C) Narrative description *SEE CONTINUATION SHEETS, WHICH MUST BE COMPLETED*

Site Number: 44-02143 Address: 1000's block S13/14 Gabriel City: Wayland County: Henry District Number:

• **Statement of Significance**

A) Applicable National Register Criteria: *Mark your opinion of eligibility after applying relevant National Register criteria*

- Criterion A: Property is associated with significant events. Yes No More research recommended
Criterion B: Property is associated with the lives of significant persons. Yes No More research recommended
Criterion C: Property has distinctive architectural characteristics. Yes No More research recommended
Criterion D: Property yields significant information in archaeology/history. Yes No More research recommended

B) Special criteria considerations: *Mark any special considerations; leave blank if none*

- A: Owned by a religious institution or used for religious purposes. E: A reconstructed building, object, or structure.
 B: Removed from its original location. F: A commemorative property.
 C: A birthplace or grave. G: Property less than 50 years of age or
 D: A cemetery. achieved significance within the past 50 years.

C) Areas of significance

Enter categories from instructions

D) Period(s) of significance

E) Significant dates

Construction date

1919 *check if circa or estimated date*
Other dates, including renovations

F) Significant person

Complete if Criterion B is marked above

G) Cultural affiliation

Complete if Criterion D is marked above

H) Architect/Builder

Architect

Builder/contractor

I) Narrative statement of significance *SEE CONTINUATION SHEETS, WHICH MUST BE COMPLETED*

• **Bibliography** *See continuation sheets for the list of research sources used in preparing this form*

• **Geographic Data** *Optional UTM references* *See continuation sheet for additional UTM or comments*

Zone	Easting	Northing	NAD	Zone	Easting	Northing	NAD
1	___	___	___	2	___	___	___
3	___	___	___	4	___	___	___

• **Form Preparation**

Name and Title: Beverly Conrad - volunteer Rebecca Lawin McCarley, consultant Date: 01/14/2016
Organization/firm: Henry County Historic Preservation Commission E-mail: -
Street address: Henry County Courthouse, 100 E, Washington St Telephone: 319-385-0756
City or Town: Mount Pleasant State: Iowa Zip code: 52641

• **ADDITIONAL DOCUMENTATION** *Submit the following items with the completed form*

A) For all properties, attach the following, as specified in the Iowa Site Inventory Form Instructions:

- 1. Map** of property's location within the community.
- 2. Glossy color 4x6 photos labeled** on back with property/building name, address, date taken, view shown, and unique photo number.
- 3. Photo key showing each photo number on a map and/or floor plan, using arrows next to each photo number to indicate the location and directional view of each photograph.**
- 4. Site plan** of buildings/structures on site, identifying boundaries, public roads, and building/structure footprints.

B) For State Historic Tax Credit Part 1 Applications, historic districts and farmsteads, and barns:

See lists of special requirements and attachments in the Iowa Site Inventory Form Instructions.

State Historic Preservation Office (SHPO) Use Only Below This Line

The SHPO has reviewed the Site Inventory and concurs with above survey opinion on National Register eligibility:

- Yes No More research recommended
 This is a locally designated property or part of a locally designated district.

Comments: _____

SHPO authorized signature: _____ Date: _____

Iowa Site Inventory Form
State Historic Preservation Office
Continuation Sheet

Site Number: 44-02143
 Related District Number: _____

Page 3

Bridge	Henry
Name of Property	County
1000 Block Between Section 13 & 14 Gabriel Ave	Wayland
Address	City

Construction dates:

Assessor date (1900 is default date): 1900
 Better estimated date and source: 1919

Additional architectural information from the Reconnaissance Survey:

concrete bridge

Additional historical information from the Reconnaissance Survey:

- top of concrete wall of bridge has "Henry County 1919" inset in concrete
- see context / other examples in 2005 Scott Township survey report (McCarley 2005)
 - one of only two noted in Jefferson Twp – other is earlier/smaller design with only "1915" in middle – only one noted of this style
 - also c.1920s examples with inset concrete panels, no date stamps

Property ownership research conducted for the property:

Grantor/Seller:		Legal Description and other relevant notes:
Grantee/Buyer:		
Date:		
Price:		Deed book record (if listed) – book/page:
Grantor/Seller:		Legal Description and other relevant notes:
Grantee/Buyer:		
Date:		
Price:		Deed book record (if listed) – book/page:

Iowa Site Inventory Form
State Historic Preservation Office
Continuation Sheet

Site Number: 44-02143
Related District Number: _____

Page 4

Bridge	Henry
Name of Property	County
1000 Block Between Section 13 & 14 Gabriel Ave	Wayland
Address	City

Bibliography

Brooks and Whiting. *Atlas of Henry County, Iowa*. St. Louis, MO: W.E. Stephens and Co., 1895.

Cooper, Carolyn, ed. *Map of Henry County, Iowa 1859*. Reprint Edition. Mt. Pleasant, Iowa : Henry County Genealogical Society, 1989.

Drury, John. *This is Henry County, Iowa*. Chicago: Inland Photo Company, 1956.

Henry County Bicentennial Commission (HCBC). *The History of Henry County, Iowa*. Dallas, TX: National ShareGraphics, Inc., 1982.

Henry County Auditor's Office. Transfer book records, various books/dates.

History of Henry County, Iowa. Chicago: Western Historical Company, 1879.

Jaynes, Peter H., ed. *Highlights of Henry County History 1833-1976*. Burlington, IA: Doran & Ward Lithographing Co., 1977.

Kean Map Company. *Atlas of Henry County, Iowa*. Des Moines: Kean Map Company, 1931.

Mason, George T. *Directory of Henry County, Iowa, 1911-1912*. Mt. Pleasant, IA: The News, 1911.

Ogle, George A. & Co. *Standard Atlas of Henry County, Iowa*. George A. Ogle & Co., 1917.

Portrait and Biographical Album of Henry County, Iowa. Chicago: Acme Publishing Co., 1888.

Thompson and Everts. *Combination Atlas Map of Henry County, Iowa*. Geneva, IL: Thompson and Everts, 1870.

Wayland Centennial Committee. *Wayland: The First Century, 1880-1980*. Wayland, 1980.

Iowa Site Inventory Form
State Historic Preservation Office
Continuation Sheet

Site Number: 44-02143
Related District Number: _____

Page 5

Bridge	Henry
Name of Property	County
<u>1000 Block Between Section 13 & 14 Gabriel Ave</u>	Wayland
Address	City

Sketch map

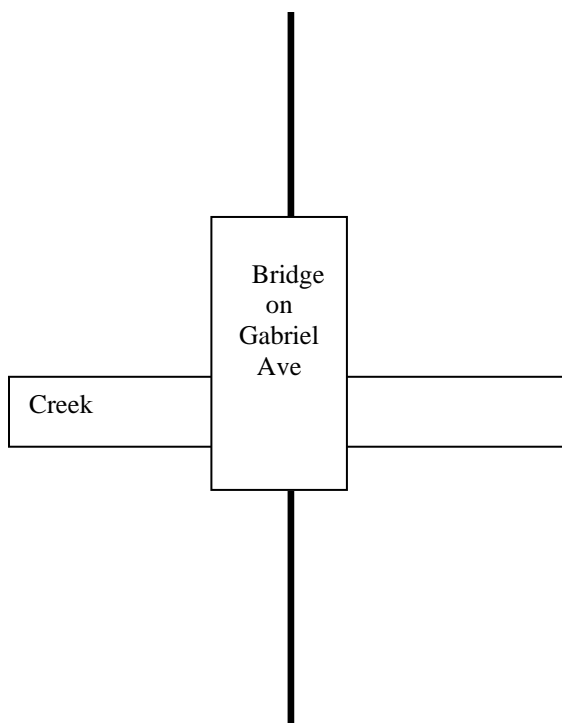
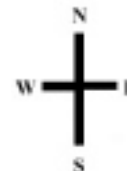

Iowa Site Inventory Form
State Historic Preservation Office
Continuation Sheet

Site Number: 44-02143
Related District Number: _____

Page 6

Bridge	Henry
Name of Property	County
1000 Block Between Section 13 & 14 Gabriel Ave	Wayland
Address	City

Location map

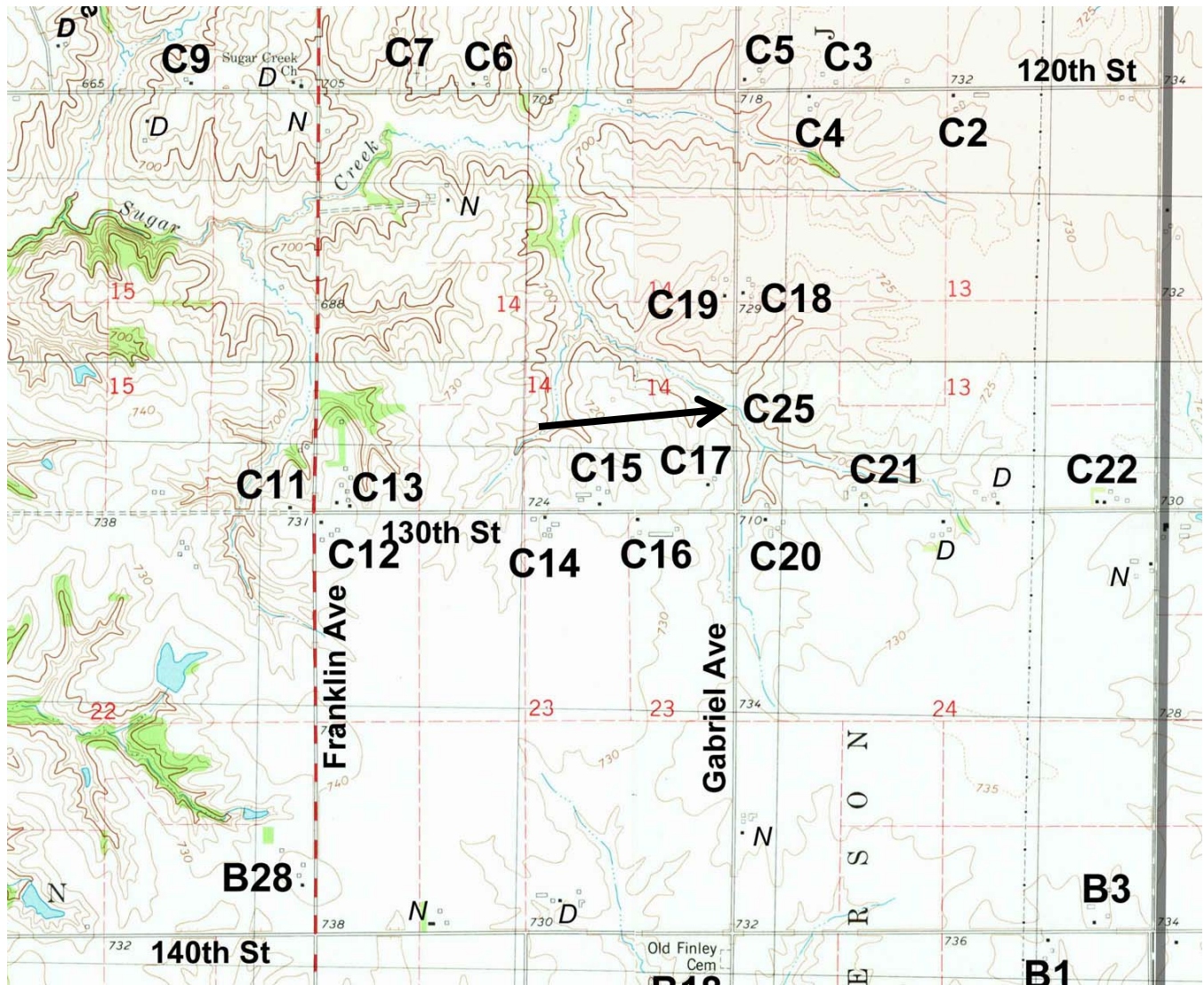

Iowa Site Inventory Form
State Historic Preservation Office
Continuation Sheet

Site Number: 44-02143
Related District Number: _____

Page 7

Bridge	Henry
Name of Property	County
<u>1000 Block Between Section 13 & 14 Gabriel Ave</u>	Wayland
Address	City

Pictometry view from Henry County GIS – 2013 imagery



Iowa Site Inventory Form
State Historic Preservation Office
Continuation Sheet

Site Number: 44-02143
Related District Number: _____

Page 8

Bridge	Henry
Name of Property	County
<u>1000 Block Between Section 13 & 14 Gabriel Ave</u>	Wayland
Address	City

Digital photographs



Photograph 44-02143-001 - Bridge, looking north on Gabriel Ave (October 2015)

Iowa Site Inventory Form
State Historic Preservation Office
Continuation Sheet

Site Number: 44-02143
Related District Number: _____

Page 9

Bridge	Henry
Name of Property	County
<u>1000 Block Between Section 13 & 14 Gabriel Ave</u>	Wayland
Address	City



Photograph 44-02143-002 - Bridge, showing 1919 date stamp (October 2015)

Iowa Site Inventory Form
State Historic Preservation Office
Continuation Sheet

Site Number: 44-02143
Related District Number: _____

Page 10

Bridge	Henry
Name of Property	County
1000 Block Between Section 13 & 14 Gabriel Ave	Wayland
Address	City



Photograph 44-02143-003 - Bridge, looking northwest (October 2015)

Iowa Site Inventory Form

State Historic Preservation Office

(July 2014)

State Inventory Number: 44-02112 New Supplemental

9-Digit SHPO Review & Compliance (R&C) Number: _____

Non-extant Year: _____

Read the Iowa Site Inventory Form Instructions carefully, to ensure accuracy and completeness before completing this form. The instructions are available on our website: <http://www.iowahistory.org/historic-preservation/statewide-inventory-and-collections/iowa-site-inventory-form.html>

• **Property Name**

A) Historic name: G.F. Dold Garage

B) Other names: Reconnaissance Survey Field Site # F-24

• **Location**

A) Street address: 103? Coppock Rd

B) City or town: Coppock (Vicinity) County: Henry

C) Legal description:

Rural: Township Name: Jefferson Township No.: 73N Range No.: 7W Section: _____ Quarter: _____ of Quarter: _____

Urban: Subdivision: Coppock Block(s): _____ Lot(s): N 47 1/2'-Out Lot 16

• **Classification**

A) Property category: *Check only one*

- Building(s)
- District
- Site
- Structure
- Object

B) Number of resources (within property):

If eligible property, enter number of:		If non-eligible property, enter number of:	
Contributing	Noncontributing		
<u>1</u>	Buildings	—	Buildings
—	Sites	—	Sites
—	Structures	—	Structures
—	Objects	—	Objects
<u>1</u>	Total	—	Total

C) For properties listed in the National Register:

National Register status: Listed De-listed NHL NPS DOE

D) For properties within a historic district:

- Property contributes to a National Register or local certified historic district.
- Property contributes to a potential historic district, based on professional historic/architectural survey and evaluation.
- Property *does not* contribute to the historic district in which it is located.

Historic district name: _____ Historic district site inventory number: _____

E) Name of related project report or multiple property study, if applicable:

MPD title: Reconnaissance Level Historical/Architectural Survey of Jefferson Township, Henry County Historical Architectural Data Base #: 44-024

• **Function or Use** *Enter categories (codes and terms) from the Iowa Site Inventory Form Instructions*

A) Historic functions

02A: Commerce-business

B) Current functions

01C05: Domestic-garage

• **Description** *Enter categories (codes and terms) from the Iowa Site Inventory Form Instructions*

A) Architectural classification

09F01: Commercial Building-1 1/2 stories- false front

B) Materials

Foundation (visible exterior): 10: concrete

Walls (visible exterior): 05D: tin

Roof: 05D: tin

Other: _____

C) Narrative description *SEE CONTINUATION SHEETS, WHICH MUST BE COMPLETED*

Site Number: 44-02112 Address: 103? Coppock Rd City: Coppock County: Henry District Number:

• **Statement of Significance**

A) Applicable National Register Criteria: *Mark your opinion of eligibility after applying relevant National Register criteria*

- Criterion A: Property is associated with significant events. Yes No More research recommended
Criterion B: Property is associated with the lives of significant persons. Yes No More research recommended
Criterion C: Property has distinctive architectural characteristics. Yes No More research recommended
Criterion D: Property yields significant information in archaeology/history. Yes No More research recommended

B) Special criteria considerations: *Mark any special considerations; leave blank if none*

- A: Owned by a religious institution or used for religious purposes. E: A reconstructed building, object, or structure.
 B: Removed from its original location. F: A commemorative property.
 C: A birthplace or grave. G: Property less than 50 years of age or
 D: A cemetery. achieved significance within the past 50 years.

C) Areas of significance

Enter categories from instructions

D) Period(s) of significance

E) Significant dates

Construction date

1920s *check if circa or estimated date*
Other dates, including renovations

F) Significant person

Complete if Criterion B is marked above

G) Cultural affiliation

Complete if Criterion D is marked above

H) Architect/Builder

Architect

Builder/contractor

I) Narrative statement of significance *SEE CONTINUATION SHEETS, WHICH MUST BE COMPLETED*

• **Bibliography** *See continuation sheets for the list of research sources used in preparing this form*

• **Geographic Data** *Optional UTM references* *See continuation sheet for additional UTM or comments*

Zone	Easting	Northing	NAD	Zone	Easting	Northing	NAD
1	___	___	___	2	___	___	___
3	___	___	___	4	___	___	___

• **Form Preparation**

Name and Title: Marsha Chalupa - volunteer Rebecca Lawin McCarley, consultant Date: 12-17-15
Organization/firm: Henry County Historic Preservation Commission E-mail: -
Street address: Henry County Courthouse, 100 E, Washington St Telephone: 319-385-0756
City or Town: Mount Pleasant State: Iowa Zip code: 52641

• **ADDITIONAL DOCUMENTATION** *Submit the following items with the completed form*

A) For all properties, attach the following, as specified in the Iowa Site Inventory Form Instructions:

- 1. Map** of property's location within the community.
- 2. Glossy color 4x6 photos labeled** on back with property/building name, address, date taken, view shown, and unique photo number.
- 3. Photo key showing each photo number on a map and/or floor plan, using arrows next to each photo number to indicate the location and directional view of each photograph.**
- 4. Site plan** of buildings/structures on site, identifying boundaries, public roads, and building/structure footprints.

B) For State Historic Tax Credit Part 1 Applications, historic districts and farmsteads, and barns:

See lists of special requirements and attachments in the Iowa Site Inventory Form Instructions.

State Historic Preservation Office (SHPO) Use Only Below This Line

The SHPO has reviewed the Site Inventory and concurs with above survey opinion on National Register eligibility:

- Yes No More research recommended
 This is a locally designated property or part of a locally designated district.

Comments: _____

SHPO authorized signature: _____ Date: _____

Iowa Site Inventory Form
State Historic Preservation Office
Continuation Sheet

Site Number: 44-02112
Related District Number: _____

Page 3

<u>Commercial Building</u>	<u>Henry</u>
Name of Property	County
<u>103? Coppock Rd</u>	<u>Coppock</u>
Address	City

Construction dates:

Assessor date (1900 is default date): 1920

Better estimated date and source: 1900s if earlier store – likely c.1924 if built as garage

Additional architectural information from the Reconnaissance Survey:

Commercial Building:

Height (stories): 1 ½ stories

Walls (construction/cladding): frame construction-tin siding

Foundation: concrete

Roof style: false front with gable front behind this false front

Primary window type: 2 vertical panel wood windows

- storm windows: no

Porch: no

Front entry:

Other architectural features: says (G.F. Dold Garage) on front of building

Garage: none

Walls:

Roof style/material:

Size:

Front faces:

Other architectural features:

Other buildings (list and provide any additional information:

Additional historical information from the Reconnaissance Survey:

* only commercial building left in Coppock – frame building clad in pressed tin siding

* large house across street at 102 Coppock – histories intertwined from 1900s to 1920s (44-02111)

1870 owner/acres: T. Merrill

1895 owner/acres: E.A. and W.J. Hill, 65 acres

1917 owner/acres: D.D. Davision (Out Lot 16)

1931 owner/acres:

2015 property owner: Jean A Abbott

Iowa Site Inventory Form
State Historic Preservation Office
Continuation Sheet

Site Number: 44-02112
Related District Number: _____

Page 4

Commercial Building	Henry
Name of Property	County
103? Coppock Rd	Coppock
Address	City

owned by Rudolph Turner prior to April 1904

- *farmer in this area in 1900 census*
- *built store and rented out?*
- *first transfer for Out Lot 16 in April 1904 – transferred under township previously*

owned by Claude Essley from April 1904 to July 1907

- *owned property with house across street from 1899 to 1907*
- *likely built both house and store by 1907*
- *operated/rented the store prior to buying property?*

March 28, 1898 – “Claude Essley, of the enterprising firm of Essley & Stichter at Coppock, was the guest of friends in the city, Saturday” – *Washington Evening Journal*, page 3

October 20, 1899 – “Eugene Stichter has sold his interest in the Coppock store to his partner Claude Essley” – *Washington Gazette*, page 8

May 1901 – petition to incorporate Coppock – filed in Mt Pleasant – appoint Claude Essley, John L. Coppock, D.D. Bolding, John Turner, and William Kurtz as commissioners to hold election in territory on issue – land situated in three counties – Washington, Jefferson, and Henry – 160 acres – reason is to get better school facilities – faulty petition previously – rejected (“Coppock Again,” *Washington Evening Journal*, May 9, 1901, 2)

February 24, 1902 – Coppock incorporated – W.B. Bolding, mayor; Fred Dold, secretary; John Turner, marshal – councilmen included William Kurtz, D.D. Bolding, J.L. Coppock, **Claude Essley**, and P. Anderson (Fisher 1978: 51) – businesses in town included:

- restaurant and bar run by John Hyde
- hotel in the large house on the west side of the road run by Mitch Turner (where Jim Arbogast lives in 1978)
- August Volger – blacksmith
- grist mill on east side of road just south of county line – run by C.E. Caulkins
- four stores at one time – **Claude Essley** and William Hill each had one – freight depot in back of Hill’s store – Fred and Louis Dold had store on west side of road – Eli Hesser had store on east side of road – burned one year on Fourth of July (Fisher 1978: 51)
- ice harvesting – big business at Coppock – Burlington & Western had built siding – steam engine pull chunks from river – shipped to Burlington and elsewhere (Fisher 1978: 51)
- two parks – Brown’s and Trite’s – picnicking, swimming, boating, and band concerts – excursion trains brought people – also by buggy and bike to parks – 1890s and 1900s (Fisher 1978: 51) - Trite’s Park on farm of George Davis Trite – one mile upstream from Coppock – tables and benches – platform for dancing – small steam boat – ferry people from Coppock to park – Bill Cochran as pilot – noted in June 1902 that as enjoyable as Spirit Lake, Okiboji, etc. and much cheaper (Fisher 1978: 52)
- 1903 – flood partially destroyed the mill dam – swept away park (Fisher 1978: 52)

Iowa Site Inventory Form
State Historic Preservation Office
Continuation Sheet

Site Number: 44-02112
Related District Number: _____

Page 5

Commercial Building	Henry
Name of Property	County
103? Coppock Rd	Coppock
Address	City

1895 - Cottonwood Church – Jefferson Twp, Section 6 – first church built around 1865 – building constructed nearly completely from Cottonwood – hence name – sold to Mitch Turner in 1895– became room for Dold Brothers store in Coppock (not Hesser) (Cottonwood UMC, 2000)

owned by John Mueller from 1907 to 1910

- *bought house across street at same time as store – likely both already built*

1910 census - Coppock

John J. Mueller – 29 – merchant – general store

- Julia – 27
- Lester – 5
- Alice F – 2

owned by Clayton McKenzie from 1910 to 1916

- *bought/owned house across street during same period*
- *in census in Wayland in 1905 – could not find in 1910*

1911-12 county directory (Mason 1911: 204)

Coppock – section 6 – Jefferson Twp – also portion in Washington County

Fred Dold – merchant

John Hesser – justice of peace

M.H. Hesser

C.L. McKenzie

E.S. Seller – merchant

1915 Iowa census

C.L. McKenzie – 45 – Coppock – retail merchant - \$1200 in earnings – born in Iowa – house valued at \$8000 – United Brethren

then moved to Washington by 1920

owned by D.D. Davison from August 1916 to November 1916

- *noted as owner on 1917 map*

owned by C.W. Merchant from November 1916 to January 1918 – died

owned by Ella Merchant (widow) from January 1918 to October 1921

- *owned/lived in house across street (102 Coppock) also*

Iowa Site Inventory Form
State Historic Preservation Office
Continuation Sheet

Site Number: 44-02112
Related District Number: _____

Page 6

Commercial Building	Henry
Name of Property	County
103? Coppock Rd	Coppock
Address	City

1920 census – Coppock
Ella Merchant – 45 – widow – no occupation

owned by Fred and Emma Dold from October 1921 to 1945

- *Ella Merchant continued to own house across street*
- *Dolds previously bought Out Lot 17 to south from Peter Anderson in March 13, 1907*
- *store there and then garage here to north?*

April 1925 – *Washington Democrat* – special edition – page 18

“Dold Brothers Have a Big Stock”

- F. Dold – manager – born in Rome (Henry Co) in 1871 – moved to Coppock in 1895 – opened store – extensive stock – groceries and dry goods in 1925

“G.F. Dold is Ford Expert”

- starting July 1924 – garage of G.F. Dold at Coppock is getting more than its full share of trade – born in Rome in 1857(?) – parents moved to Coppock when young – lived there since then – spent past 10 years in garage business – thoroughly competent
- repair shop is modern and fully equipped – complete line of repair parts – also radios

ad – “Dold Brothers” – Coppock

- quality and service are the predominating features of the store
- groceries, fresh meats, hardware, candies, cigars, tobaccos
- “drive up when your car needs gas or oil”

1930 census - Coppock

Frederick Dold – 58 – proprietor of general store

- Emma M – 53

Ronald F. Dold – 30 – clerk

- Lizzie M – 27
- Corrine – 8
- Gwendolyn – 5
- Vivian – 3

Gleede F. Dold – 33 – proprietor of auto repair shop

- Helen M – 28
- Evelyn P - 2

September 1941 – Coppock – Mrs. Gleede (Helen) Dold is appointed as postmistress– succeeding Fred Dold – retired on August 31, 1941 – postmaster for 35 years – began duties on September (“Appoint Mrs. Dold New Postmistress,” *Washington Evening Journal*, September 4, 1941, 7 - Mrs. Gleede Dold is also the correspondent for the newspaper sending the local news)

owned by Emma Dold (widow) from 1945 to 1952

Iowa Site Inventory Form
State Historic Preservation Office
Continuation Sheet

Site Number: 44-02112
 Related District Number: _____

Page 7

Commercial Building	Henry
Name of Property	County
103? Coppock Rd	Coppock
Address	City

owned by Gleede and Helen Dold from 1952 to 1970s

January 31, 1955 – last day for post office in Coppock – Mrs. Gleede Dold – postmaster for last 13 years and five months – established in 1882 in general store at Coppock – remained here until October 1944 – moved to present location in Dold’s garage – seven postmasters – Al Morris, Mitch Turner, W.I. Hill, **Mr. Stickner, Claude Essley, Fred Dold, and Gleede Dold** – retiring – residents now get mail via Route 2 from Wayland (“Monday is Last Day for Post Office at Coppock,” *Washington Evening Journal*, February 1, 1955, 1)

Property ownership research conducted for the property:

Grantor/Seller:	Rudolph Turner	Legal Description and other relevant notes: Out Lot 16 (first transfer for Out Lots - Turner also owned Out Lot 17 – sold to Andersons in 1905 Deed book record (if listed) – book/page: page 185
Grantee/Buyer:	Claude Essley	
Date:	4-14-1904	
Price:		
Grantor/Seller:	Claude Essley	Legal Description and other relevant notes: Out Lot 16 TL Transfer Book C Deed book record (if listed) – book/page: page 185
Grantee/Buyer:	John Mueller	
Date:	7-24-1907	
Price:		
Grantor/Seller:	John Mueller	Legal Description and other relevant notes: Out Lot 16 TL Transfer Book C Deed book record (if listed) – book/page: page 185
Grantee/Buyer:	Clayton McKenzie	
Date:	8-23-1910	
Price:		
Grantor/Seller:	Clayton McKenzie	Legal Description and other relevant notes: N 47 ½ Lot 16 TL Transfer Book D Deed book record (if listed) – book/page: page 208
Grantee/Buyer:	D. D. Davison	
Date:	8-21-1916	
Price:		
Grantor/Seller:	D.D. Davison	Legal Description and other relevant notes: N 47 ½ Lot 16 TL Transfer Book D Deed book record (if listed) – book/page: page 208
Grantee/Buyer:	CW Merchant	
Date:	11-04-1916	
Price:		
Grantor/Seller:	John Merchant & heirs of CW Merchant	Legal Description and other relevant notes: N 47 ½ Lot 16 TL Transfer Book D Deed book record (if listed) – book/page: page 208
Grantee/Buyer:	Ella Merchant	
Date:	1-09-1918	
Price:		
Grantor/Seller:	Ella Merchant	Legal Description and other relevant notes: N 47 ½ Lot 16 TL Transfer Book D Deed book record (if listed) – book/page: page 208
Grantee/Buyer:	Joe Roth	
Date:	10-25-1921	
Price:		
Grantor/Seller:	Joe Roth & wife	Legal Description and other relevant notes: N 47 ½ Lot 16 TL Transfer Book D Deed book record (if listed) – book/page: page 208
Grantee/Buyer:	Fred & Emma Dold	
Date:	10-25-1921	
Price:		
Grantor/Seller:	Frederick Dold	Legal Description and other relevant notes: OL 17 & 16 TL Transfer Book D Deed book record (if listed) – book/page: page 208
Grantee/Buyer:	Emma Dold	
Date:	8-06-1945	
Price:		

Iowa Site Inventory Form
State Historic Preservation Office
Continuation Sheet

Site Number: 44-02112
 Related District Number: _____

Page 8

Commercial Building	Henry
Name of Property	County
103? Coppock Rd	Coppock
Address	City

Grantor/Seller:	Emma Dold	Legal Description and other relevant notes: Lot 16
Grantee/Buyer:	Gleede & Helen Dold	
Date:	10-25-1952	
Price:		Deed book record (if listed) – book/page:
Grantor/Seller:		Legal Description and other relevant notes:
Grantee/Buyer:		
Date:		
Price:		

Bibliography

Brooks and Whiting. *Atlas of Henry County, Iowa*. St. Louis, MO: W.E. Stephens and Co., 1895.

Cooper, Carolyn, ed. *Map of Henry County, Iowa 1859*. Reprint Edition. Mt. Pleasant, Iowa : Henry County Genealogical Society, 1989.

Drury, John. *This is Henry County, Iowa*. Chicago: Inland Photo Company, 1956.

Henry County Bicentennial Commission (HCBC). *The History of Henry County, Iowa*. Dallas, TX: National ShareGraphics, Inc., 1982.

Henry County Auditor's Office. Transfer book records, various books/dates.

History of Henry County, Iowa. Chicago: Western Historical Company, 1879.

Jaynes, Peter H., ed. *Highlights of Henry County History 1833-1976*. Burlington, IA: Doran & Ward Lithographing Co., 1977.

Kean Map Company. *Atlas of Henry County, Iowa*. Des Moines: Kean Map Company, 1931.

Mason, George T. *Directory of Henry County, Iowa, 1911-1912*. Mt. Pleasant, IA: The News, 1911.

Ogle, George A. & Co. *Standard Atlas of Henry County, Iowa*. George A. Ogle & Co., 1917.

Portrait and Biographical Album of Henry County, Iowa. Chicago: Acme Publishing Co., 1888.

Thompson and Everts. *Combination Atlas Map of Henry County, Iowa*. Geneva, IL: Thompson and Everts, 1870.

Wayland Centennial Committee. *Wayland: The First Century, 1880-1980*. Wayland, 1980.

Iowa Site Inventory Form
State Historic Preservation Office
Continuation Sheet

Site Number: 44-02112
Related District Number: _____

Page 9

<u>Commercial Building</u>	<u>Henry</u>
Name of Property	County
<u>103? Coppock Rd</u>	<u>Coppock</u>
Address	City

Sketch map

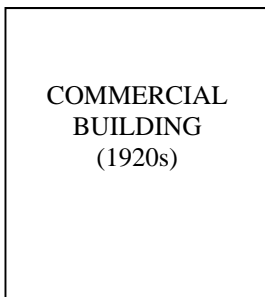

Coppock Rd

Iowa Site Inventory Form
State Historic Preservation Office
Continuation Sheet

Site Number: 44-02112
Related District Number: _____

Page 10

Commercial Building	Henry
Name of Property	County
103? Coppock Rd	Coppock
Address	City

Location map

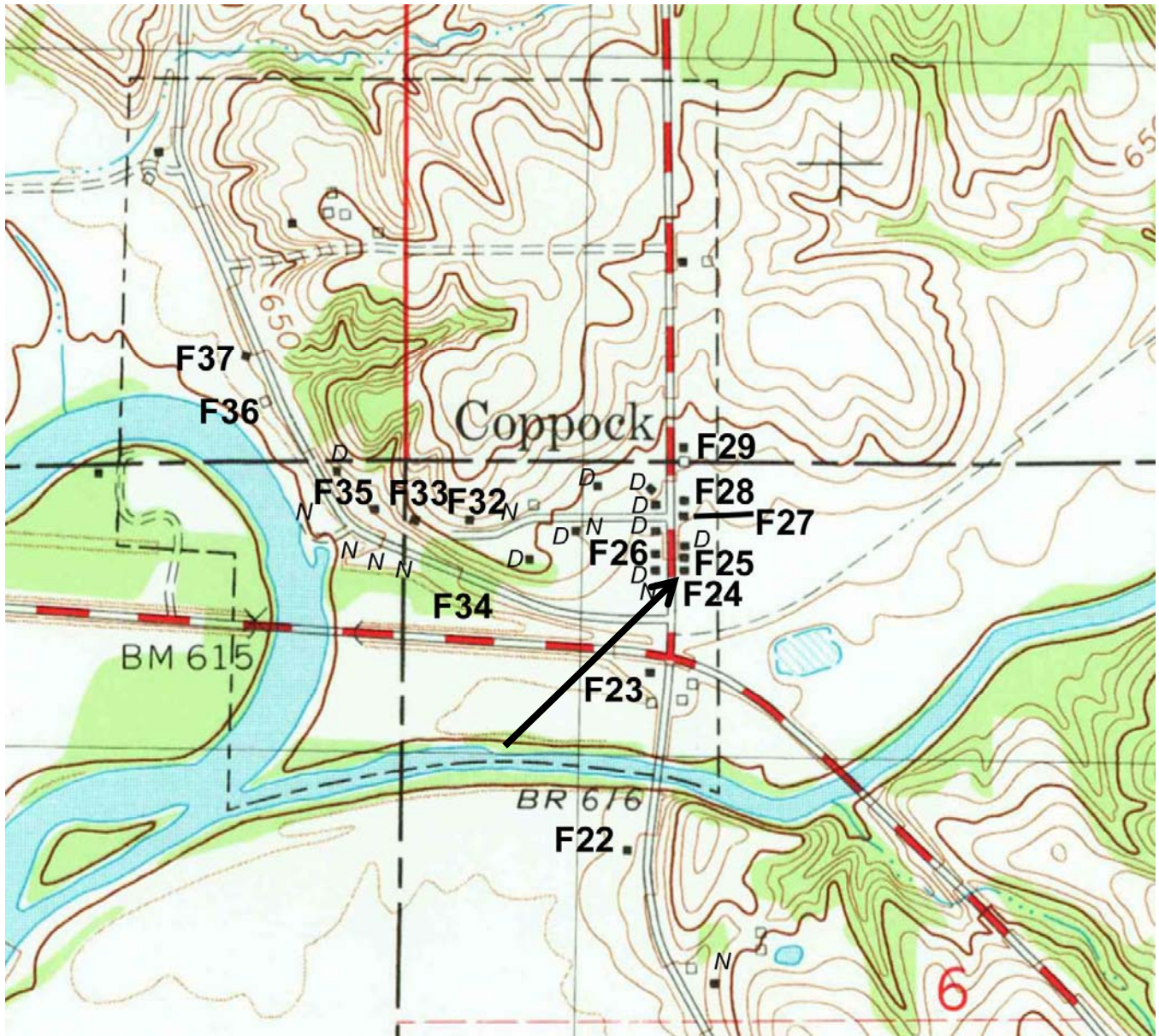

Iowa Site Inventory Form
State Historic Preservation Office
Continuation Sheet

Site Number: 44-02112
Related District Number: _____

Page 11

Commercial Building	Henry
Name of Property	County
103? Coppock Rd	Coppock
Address	City

Pictometry view from Henry County GIS – 2013 imagery



Iowa Site Inventory Form
State Historic Preservation Office
Continuation Sheet

Site Number: 44-02112
Related District Number: _____

Page 12

Commercial Building

Name of Property

103? Coppock Rd

Address

Henry

County

Coppock

City

Digital photographs



Photograph 44-02112-001 - Building, looking northeast (December 2015)

Iowa Site Inventory Form

State Historic Preservation Office

(July 2014)

State Inventory Number: 44-01844 New Supplemental

9-Digit SHPO Review & Compliance (R&C) Number: _____

Non-extant Year: _____

Read the Iowa Site Inventory Form Instructions carefully, to ensure accuracy and completeness before completing this form. The instructions are available on our website: <http://www.iowahistory.org/historic-preservation/statewide-inventory-and-collections/iowa-site-inventory-form.html>

• **Property Name**

A) Historic name: House

B) Other names: Reconnaissance Survey Field Site # J-14

• **Location**

A) Street address: 312 E Front St

B) City or town: Wayland (Vicinity) County: Henry

C) Legal description:

Rural: Township Name: Jefferson Township No.: 73N Range No.: 7W Section: _____ Quarter: _____ of Quarter: _____

Urban: Subdivision: Wayland Land Co Block(s): _____ Lot(s): LOTS 14 & 15

• **Classification**

A) Property category: *Check only one*

- Building(s)
- District
- Site
- Structure
- Object

B) Number of resources (within property):

If eligible property, enter number of:		If non-eligible property, enter number of:	
Contributing	Noncontributing		
—	Buildings	—	Buildings
—	Sites	—	Sites
—	Structures	—	Structures
—	Objects	—	Objects
—	Total	—	Total

C) For properties listed in the National Register:

National Register status: Listed De-listed NHL NPS DOE

D) For properties within a historic district:

- Property contributes to a National Register or local certified historic district.
- Property contributes to a potential historic district, based on professional historic/architectural survey and evaluation.
- Property *does not* contribute to the historic district in which it is located.

Historic district name: _____ Historic district site inventory number: _____

E) Name of related project report or multiple property study, if applicable:

MPD title

Historical Architectural Data Base #

Reconnaissance Level Historical/Architectural Survey of Jefferson Township, Henry County 44-024

• **Function or Use** *Enter categories (codes and terms) from the Iowa Site Inventory Form Instructions*

A) Historic functions

01A01: Domestic-residence

B) Current functions

01A01: Domestic-residence

• **Description** *Enter categories (codes and terms) from the Iowa Site Inventory Form Instructions*

A) Architectural classification

09A05: House - 1 story, hip roof

10C: Ranch

B) Materials

Foundation (visible exterior): 10A: concrete block

Walls (visible exterior): 03: brick

Roof: 08A: Asphalt shingles

Other: _____

C) Narrative description *SEE CONTINUATION SHEETS, WHICH MUST BE COMPLETED*

Site Number: 44-01844 Address: 312 E Front City: Wayland County: Henry District Number:

• **Statement of Significance**

A) Applicable National Register Criteria: *Mark your opinion of eligibility after applying relevant National Register criteria*

- Criterion A: Property is associated with significant events. Yes No More research recommended
Criterion B: Property is associated with the lives of significant persons. Yes No More research recommended
Criterion C: Property has distinctive architectural characteristics. Yes No More research recommended
Criterion D: Property yields significant information in archaeology/history. Yes No More research recommended

B) Special criteria considerations: *Mark any special considerations; leave blank if none*

- A: Owned by a religious institution or used for religious purposes. E: A reconstructed building, object, or structure.
 B: Removed from its original location. F: A commemorative property.
 C: A birthplace or grave. G: Property less than 50 years of age or
 D: A cemetery. achieved significance within the past 50 years.

C) Areas of significance

Enter categories from instructions

D) Period(s) of significance

E) Significant dates

Construction date

1965 *check if circa or estimated date*
Other dates, including renovations

F) Significant person

Complete if Criterion B is marked above

G) Cultural affiliation

Complete if Criterion D is marked above

H) Architect/Builder

Architect

Builder/contractor

I) Narrative statement of significance *SEE CONTINUATION SHEETS, WHICH MUST BE COMPLETED*

• **Bibliography** *See continuation sheets for the list of research sources used in preparing this form*

• **Geographic Data** *Optional UTM references* *See continuation sheet for additional UTM or comments*

Zone	Easting	Northing	NAD	Zone	Easting	Northing	NAD
1	___	___	___	2	___	___	___
3	___	___	___	4	___	___	___

• **Form Preparation**

Name and Title: Marsha Chalupa - volunteer Rebecca Lawin McCarley, consultant Date: 2-03-16
Organization/firm: Henry County Historic Preservation Commission E-mail: -
Street address: Henry County Courthouse, 100 E, Washington St Telephone: 319-385-0756
City or Town: Mount Pleasant State: Iowa Zip code: 52641

• **ADDITIONAL DOCUMENTATION** *Submit the following items with the completed form*

A) For all properties, attach the following, as specified in the Iowa Site Inventory Form Instructions:

- 1. Map** of property's location within the community.
- 2. Glossy color 4x6 photos labeled** on back with property/building name, address, date taken, view shown, and unique photo number.
- 3. Photo key showing each photo number on a map and/or floor plan, using arrows next to each photo number to indicate the location and directional view of each photograph.**
- 4. Site plan** of buildings/structures on site, identifying boundaries, public roads, and building/structure footprints.

B) For State Historic Tax Credit Part 1 Applications, historic districts and farmsteads, and barns:

See lists of special requirements and attachments in the Iowa Site Inventory Form Instructions.

State Historic Preservation Office (SHPO) Use Only Below This Line

The SHPO has reviewed the Site Inventory and concurs with above survey opinion on National Register eligibility:

- Yes No More research recommended
 This is a locally designated property or part of a locally designated district.

Comments: _____

SHPO authorized signature: _____ Date: _____

Iowa Site Inventory Form
State Historic Preservation Office
Continuation Sheet

Site Number: 44-01844
Related District Number: _____

Page 3

House	Henry
Name of Property	County
312 E Front	Wayland
Address	City

Construction dates:

Assessor date (1900 is default date): 1965
Better estimated date and source: c.1965

Additional architectural information from the Reconnaissance Survey:

House:

Height (stories): 1 story
Walls (construction/cladding): frame construction-brick siding
Foundation: concrete block
Roof style: hip
Primary window type: 1/1 wood windows
- storm windows: yes-aluminum
Porch: yes-entry porch-brick & stone
Front entry:
Other architectural features:

Garage: attached

Walls: frame construction-brick
Roof style/material: hip-asphalt shingles
Size: 1 car
Front faces: south
Other architectural features:

Other buildings (list and provide any additional information:

Additional historical information from the Reconnaissance Survey:

In January 1899, the Wayland Land Company was formed, with H.C. Meyer, president; C.K. Schantz, secretary, and R.M. Luellen, treasurer. Their purpose was to control and lay out additions to town and to deal in lands and buildings (WCC 1980: 26). The Wayland Land Company platted the addition along the south side of E. Railroad and east side of N. Adams, extending E. Main further to the east along the south side of the addition and naming the streets in this east portion of town. Thus, the old route into Wayland then ran along E. Railroad Street, south on N. Adams at the west edge of their addition, and west on E. Main Street into the core of Wayland. The first lots sold in May 1899, around \$70 to \$100 per lot (McCarley 2016: 97). The neighborhood was developed over the next several decades.

2015 property owner: Leonard & Betty Grieser

Iowa Site Inventory Form
State Historic Preservation Office
Continuation Sheet

Site Number: 44-01844
 Related District Number: _____

Page 4

House	Henry
Name of Property	County
312 E Front	Wayland
Address	City

Property ownership research conducted for the property:

Grantor/Seller:	Clair D. and Lydia R. Boshart	Legal Description and other relevant notes: Lot 15 and part of Lot 14 (previously bought other part)
Grantee/Buyer:	Floyd E. and Hazel M. Reschly	
Date:	February 5, 1965	
Price:		Deed book record (if listed) – book/page:
Grantor/Seller:		Legal Description and other relevant notes:
Grantee/Buyer:		
Date:		
Price:		

Bibliography

Brooks and Whiting. *Atlas of Henry County, Iowa*. St. Louis, MO: W.E. Stephens and Co., 1895.

Cooper, Carolyn, ed. *Map of Henry County, Iowa 1859*. Reprint Edition. Mt. Pleasant, Iowa : Henry County Genealogical Society, 1989.

Drury, John. *This is Henry County, Iowa*. Chicago: Inland Photo Company, 1956.

Henry County Bicentennial Commission (HCBC). *The History of Henry County, Iowa*. Dallas, TX: National ShareGraphics, Inc., 1982.

Henry County Auditor's Office. Transfer book records, various books/dates.

History of Henry County, Iowa. Chicago: Western Historical Company, 1879.

Jaynes, Peter H., ed. *Highlights of Henry County History 1833-1976*. Burlington, IA: Doran & Ward Lithographing Co., 1977.

Kean Map Company. *Atlas of Henry County, Iowa*. Des Moines: Kean Map Company, 1931.

Mason, George T. *Directory of Henry County, Iowa, 1911-1912*. Mt. Pleasant, IA: The News, 1911.

Ogle, George A. & Co. *Standard Atlas of Henry County, Iowa*. George A. Ogle & Co., 1917.

Portrait and Biographical Album of Henry County, Iowa. Chicago: Acme Publishing Co., 1888.

Thompson and Everts. *Combination Atlas Map of Henry County, Iowa*. Geneva, IL: Thompson and Everts, 1870.

Wayland Centennial Committee. *Wayland: The First Century, 1880-1980*. Wayland, 1980.

Iowa Site Inventory Form
State Historic Preservation Office
Continuation Sheet

Site Number: 44-01844
Related District Number: _____

Page 5

House	Henry
Name of Property	County
312 E Front	Wayland
Address	City

Sketch map

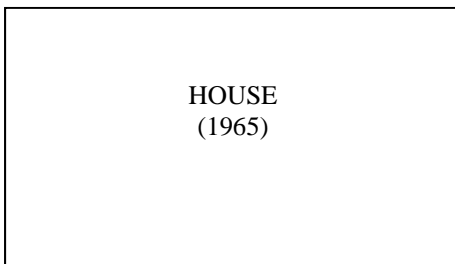
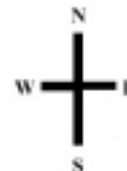

E Front

Iowa Site Inventory Form
State Historic Preservation Office
Continuation Sheet

Site Number: 44-01844
Related District Number: _____

Page 6

House	Henry
Name of Property	County
312 E Front	Wayland
Address	City

Location map



Iowa Site Inventory Form
State Historic Preservation Office
Continuation Sheet

Site Number: 44-01844
Related District Number: _____

Page 7

House	Henry
Name of Property	County
312 E Front	Wayland
Address	City

Pictometry view from Henry County GIS – 2013 imagery



Iowa Site Inventory Form
State Historic Preservation Office
Continuation Sheet

Site Number: 44-01844
Related District Number: _____

Page 8

House
Name of Property

Henry
County

312 E Front
Address

Wayland
City

Digital photographs



Photograph 44-01844-001 - House, looking north (December 2015)

Iowa Site Inventory Form

State Historic Preservation Office

(July 2014)

State Inventory Number: 44-01848 New Supplemental

9-Digit SHPO Review & Compliance (R&C) Number: _____

Non-extant Year: _____

Read the Iowa Site Inventory Form Instructions carefully, to ensure accuracy and completeness before completing this form. The instructions are available on our website: <http://www.iowahistory.org/historic-preservation/statewide-inventory-and-collections/iowa-site-inventory-form.html>

• **Property Name**

A) Historic name: House

B) Other names: Reconnaissance Survey Field Site # P-3

• **Location**

A) Street address: 105 W. Front St.

B) City or town: Wayland (Vicinity) County: Henry

C) Legal description:

Rural: Township Name: Jefferson Township No.: 73N Range No.: 7W Section: _____ Quarter: _____ of Quarter: _____

Urban: Subdivision: Bains Addition Block(s): _____ Lot(s): 3

• **Classification**

A) Property category: *Check only one*

- Building(s)
- District
- Site
- Structure
- Object

B) Number of resources (within property):

If eligible property, enter number of:		If non-eligible property, enter number of:	
Contributing	Noncontributing		
___	Buildings	___	Buildings
___	Sites	___	Sites
___	Structures	___	Structures
___	Objects	___	Objects
___	Total	___	Total

C) For properties listed in the National Register:

National Register status: Listed De-listed NHL NPS DOE

D) For properties within a historic district:

- Property contributes to a National Register or local certified historic district.
- Property contributes to a potential historic district, based on professional historic/architectural survey and evaluation.
- Property *does not* contribute to the historic district in which it is located.

Historic district name: _____ Historic district site inventory number: _____

E) Name of related project report or multiple property study, if applicable:

MPD title

Historical Architectural Data Base #

Reconnaissance Level Historical/Architectural Survey of Jefferson Township, Henry County 44-024

• **Function or Use** *Enter categories (codes and terms) from the Iowa Site Inventory Form Instructions*

A) Historic functions

01A01: Domestic - residence

B) Current functions

01A01: Domestic - residence

• **Description** *Enter categories (codes and terms) from the Iowa Site Inventory Form Instructions*

A) Architectural classification

09A09: House – 1 story – cross gable

(Victorian vernacular)

B) Materials

Foundation (visible exterior): 10A: Concrete block

Walls (visible exterior): 02: Wood

Roof: 08A: Asphalt shingles

Other: _____

C) Narrative description *SEE CONTINUATION SHEETS, WHICH MUST BE COMPLETED*

Site Number: 44-01848 Address: 105 W. Front St. City: Wayland County: Henry District Number: _____

• **Statement of Significance**

A) Applicable National Register Criteria: *Mark your opinion of eligibility after applying relevant National Register criteria*

- Criterion A: Property is associated with significant events. Yes No More research recommended
- Criterion B: Property is associated with the lives of significant persons. Yes No More research recommended
- Criterion C: Property has distinctive architectural characteristics. Yes No More research recommended
- Criterion D: Property yields significant information in archaeology/history. Yes No More research recommended

B) Special criteria considerations: *Mark any special considerations; leave blank if none*

- A: Owned by a religious institution or used for religious purposes. E: A reconstructed building, object, or structure.
- B: Removed from its original location. F: A commemorative property.
- C: A birthplace or grave. G: Property less than 50 years of age or achieved significance within the past 50 years.
- D: A cemetery.

C) Areas of significance

Enter categories from instructions

D) Period(s) of significance

E) Significant dates

Construction date

1900s *check if circa or estimated date*
Other dates, including renovations

G) Cultural affiliation

Complete if Criterion D is marked above

F) Significant person

Complete if Criterion B is marked above

H) Architect/Builder

Architect

Builder/contractor

I) Narrative statement of significance *SEE CONTINUATION SHEETS, WHICH MUST BE COMPLETED*

• **Bibliography** *See continuation sheets for the list of research sources used in preparing this form*

• **Geographic Data** *Optional UTM references* *See continuation sheet for additional UTM or comments*

Zone	Easting	Northing	NAD	Zone	Easting	Northing	NAD
1	_____	_____	_____	2	_____	_____	_____
3	_____	_____	_____	4	_____	_____	_____

• **Form Preparation**

Name and Title: Melanie Stutzman - volunteer Rebecca Lawin McCarley, consultant Date: Dec. 1, 2015
 Organization/firm: Henry County Historic Preservation Commission E-mail: -
 Street address: Henry County Courthouse, 100 E. Washington St Telephone: 319-385-0756
 City or Town: Mount Pleasant State: Iowa Zip code: 52641

• **ADDITIONAL DOCUMENTATION** *Submit the following items with the completed form*

A) For all properties, attach the following, as specified in the Iowa Site Inventory Form Instructions:

1. **Map** of property's location within the community.
2. **Glossy color 4x6 photos labeled** on back with property/building name, address, date taken, view shown, and unique photo number.
3. **Photo key showing each photo number on a map and/or floor plan, using arrows next to each photo number to indicate the location and directional view of each photograph.**
4. **Site plan** of buildings/structures on site, identifying boundaries, public roads, and building/structure footprints.

B) For State Historic Tax Credit Part 1 Applications, historic districts and farmsteads, and barns:

See lists of special requirements and attachments in the Iowa Site Inventory Form Instructions.

State Historic Preservation Office (SHPO) Use Only Below This Line

The SHPO has reviewed the Site Inventory and concurs with above survey opinion on National Register eligibility:

- Yes No More research recommended
- This is a locally designated property or part of a locally designated district.*

Comments: _____

SHPO authorized signature: _____ Date: _____

Iowa Site Inventory Form
State Historic Preservation Office
Continuation Sheet

Site Number: 44-01848
Related District Number: _____

Page 3

House	Henry
Name of Property	County
105 W. Front St.	Wayland
Address	City

Construction dates:

Assessor date (1900 is default date): 1900
Better estimated date and source: 1900s

Additional architectural information from the Reconnaissance Survey:

House:

Height (stories): 1 story
Walls (construction/cladding): Frame construction – Wood Walls
Foundation: concrete
Roof style: Gable - Side
Primary window type: Wood
- storm windows: 1/1 Aluminum
Porch: Wood full front porch & side porch
Front entry:
Other architectural features:

Garage:

Walls: Frame construction - tin
Roof style/material: Gable - front
Size: 2 car
Front faces:
Other architectural features:

Other buildings (list and provide any additional information:

Additional historical information from the Reconnaissance Survey:

2015 property owner: Randall L Davidson

Iowa Site Inventory Form
State Historic Preservation Office
Continuation Sheet

Site Number: 44-01848
 Related District Number: _____

Page 4

House	Henry
Name of Property	County
105 W. Front St.	Wayland
Address	City

Property ownership research conducted for the property:

Grantor/Seller:	A.J. Bain & Wife	Legal Description and other relevant notes: Lots 1,2,&3
Grantee/Buyer:	David Hayes	
Date:	June 14, 1890	
Price:		
Grantor/Seller:	Aaron B. Nott	Legal Description and other relevant notes: Lots 1,2,&3
Grantee/Buyer:	David Hayes	
Date:	Jan. 14, 1891	
Price:		
Grantor/Seller:	Asbury Bain & Wife	Legal Description and other relevant notes: Lots 1,2,&3
Grantee/Buyer:	David Hayes	
Date:	Feb. 3, 1892	
Price:		
Grantor/Seller:	B.F. Morgan & Wife	Legal Description and other relevant notes: Lots 1,2,&3
Grantee/Buyer:	David Hayes	
Date:	Oct. 17, 1892	
Price:		
Grantor/Seller:	M.O. Bain & Wife	Legal Description and other relevant notes: Lots 1,2,&3
Grantee/Buyer:	David Hayes	
Date:	May 28, 1892	
Price:		
Grantor/Seller:	John J. Ruby & Wife	Legal Description and other relevant notes: Lots 1,2,&3
Grantee/Buyer:	David Hayes	
Date:	June 30, 1892	
Price:		
Grantor/Seller:	J.F. Bain & Wife	Legal Description and other relevant notes: Lots 1,2,&3
Grantee/Buyer:	David Hayes	
Date:	June 15, 1892	
Price:		
Grantor/Seller:	Matilda Hayes et al	Legal Description and other relevant notes: Lot 3
Grantee/Buyer:	Wm. Deeds	
Date:	Feb 11, 1899	
Price:		
Grantor/Seller:	Wm. Deeds & Wife	Legal Description and other relevant notes: Lot 3
Grantee/Buyer:	Susanna Arthand	
Date:	Nov. 18, 1901	
Price:		
Grantor/Seller:	J.B. Arthand et al	Legal Description and other relevant notes: Lot 3
Grantee/Buyer:	C.W. Schlatter, Jr.	
Date:	Jan 30, 1907	
Price:		
Grantor/Seller:	C.W. Schlatter & Wife	Legal Description and other relevant notes: Lot 3
Grantee/Buyer:	J.F. Wittrig	
Date:	Nov 7, 1910	
Price:		
Grantor/Seller:	J.F. Wittrig	Legal Description and other relevant notes: Lot 3
Grantee/Buyer:	J.E. Leeper	
Date:	Feb 28, 1917	
Price:		
		Deed book record (if listed) – book/page: 114

Iowa Site Inventory Form
State Historic Preservation Office
Continuation Sheet

Site Number: 44-01848
 Related District Number: _____

Page 5

House	Henry
Name of Property	County
105 W. Front St.	Wayland
Address	City

Grantor/Seller:	J.E. Leeper & Wife	Legal Description and other relevant notes: Lot 3 Deed book record (if listed) – book/page: 114
Grantee/Buyer:	Carrie Funk	
Date:	Jan. 27, 1919	
Price:		
Grantor/Seller:	Carrie Funk	Legal Description and other relevant notes: Lot 3 Deed book record (if listed) – book/page: 114
Grantee/Buyer:	Bertha Shumaker	
Date:	Feb. 24, 1941	
Price:		
Grantor/Seller:	Bertha Shumaker	Legal Description and other relevant notes: Lot 3 Deed book record (if listed) – book/page: 5/120
Grantee/Buyer:	Willis L. & Vivian J. Hildebrand	
Date:	May 29, 1973	
Price:		
Grantor/Seller:		Legal Description and other relevant notes: Deed book record (if listed) – book/page:
Grantee/Buyer:		
Date:		
Price:		

Bibliography

Henry County Bicentennial Commission (HCBC). *The History of Henry County, Iowa*. Dallas, TX: National ShareGraphics, Inc., 1982.

Henry County Auditor's Office. Transfer book records, various books/dates.

History of Henry County, Iowa. Chicago: Western Historical Company, 1879.

Jaynes, Peter H., ed. *Highlights of Henry County History 1833-1976*. Burlington, IA: Doran & Ward Lithographing Co., 1977.

Kean Map Company. *Atlas of Henry County, Iowa*. Des Moines: Kean Map Company, 1931.

Mason, George T. *Directory of Henry County, Iowa, 1911-1912*. Mt. Pleasant, IA: The News, 1911.

Ogle, George A. & Co. *Standard Atlas of Henry County, Iowa*. George A. Ogle & Co., 1917.

Portrait and Biographical Album of Henry County, Iowa. Chicago: Acme Publishing Co., 1888.

Wayland Centennial Committee. *Wayland: The First Century, 1880-1980*. Wayland, 1980.

Iowa Site Inventory Form
State Historic Preservation Office
Continuation Sheet

Site Number: 44-01848
Related District Number: _____

Page 6

House	Henry
Name of Property	County
105 W. Front St.	Wayland
Address	City

Sketch map

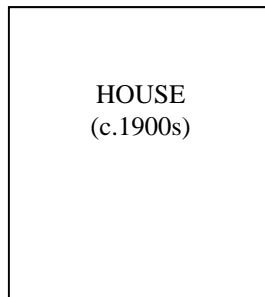
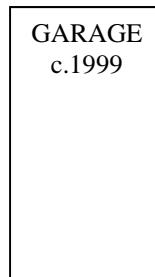

Iowa Site Inventory Form
 State Historic Preservation Office
Continuation Sheet

Site Number: 44-01848
 Related District Number: _____

Page 7

House
 Name of Property
 105 W. Front St.
 Address

Henry
 County
 Wayland
 City

Location map

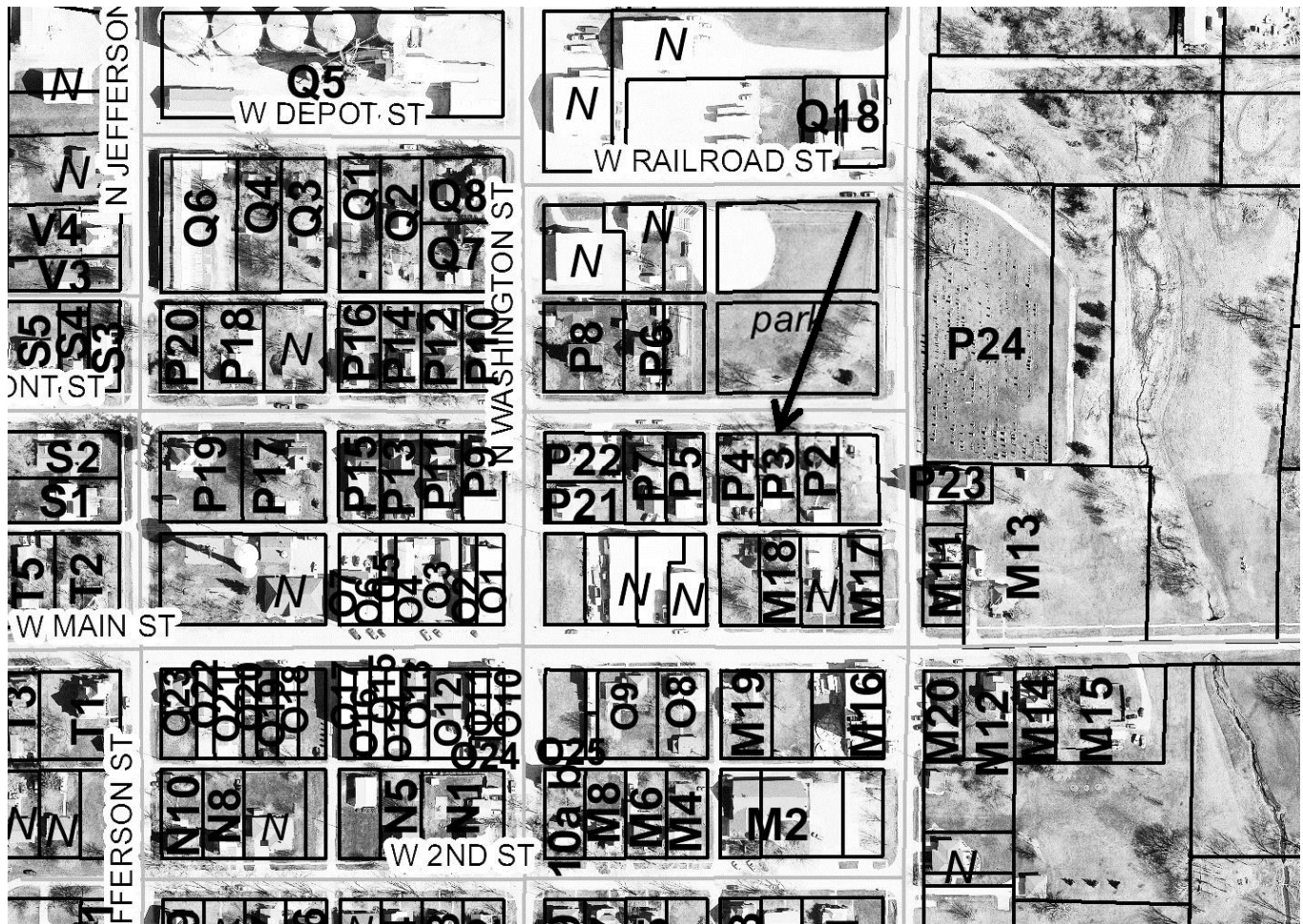

Iowa Site Inventory Form
State Historic Preservation Office
Continuation Sheet

Site Number: 44-01848
Related District Number: _____

Page 8

House	Henry
Name of Property	County
105 W. Front St.	Wayland
Address	City

Pictometry view from Henry County GIS – 2013 imagery



Iowa Site Inventory Form
State Historic Preservation Office
Continuation Sheet

Site Number: 44-01848
Related District Number: _____

Page 9

House
Name of Property
105 W. Front St.
Address

Henry
County
Wayland
City

Digital photographs



Photograph 44-01848-001 - House, looking south (December 2015)

Iowa Site Inventory Form

State Historic Preservation Office

(July 2014)

State Inventory Number: 44-01881 New Supplemental

9-Digit SHPO Review & Compliance (R&C) Number: _____

Non-extant Year: _____

Read the Iowa Site Inventory Form Instructions carefully, to ensure accuracy and completeness before completing this form. The instructions are available on our website: <http://www.iowahistory.org/historic-preservation/statewide-inventory-and-collections/iowa-site-inventory-form.html>

• **Property Name**

A) Historic name: House

B) Other names: Reconnaissance Survey Field Site # S-22

• **Location**

A) Street address: 415 W Front

B) City or town: Wayland (Vicinity) County: Henry

C) Legal description:

Rural: Township Name: Jefferson Township No.: 73N Range No.: 7W Section: ___ Quarter: ___ of Quarter: ___

Urban: Subdivision: Wayland Investment Co-1st Add. Block(s): ___ Lot(s): Lots 29-30

• **Classification**

A) Property category: Check only one

- Building(s)
- District
- Site
- Structure
- Object

B) Number of resources (within property):

If eligible property, enter number of:		If non-eligible property, enter number of:	
Contributing	Noncontributing		
___	Buildings	___	Buildings
___	Sites	___	Sites
___	Structures	___	Structures
___	Objects	___	Objects
___	Total	___	Total

C) For properties listed in the National Register:

National Register status: Listed De-listed NHL NPS DOE

D) For properties within a historic district:

- Property contributes to a National Register or local certified historic district.
- Property contributes to a potential historic district, based on professional historic/architectural survey and evaluation.
- Property does not contribute to the historic district in which it is located.

Historic district name: _____ Historic district site inventory number: _____

E) Name of related project report or multiple property study, if applicable:

MPD title: Reconnaissance Level Historical/Architectural Survey of Jefferson Township, Henry County Historical Architectural Data Base #: 44-024

• **Function or Use** Enter categories (codes and terms) from the Iowa Site Inventory Form Instructions

A) Historic functions

01A01: Domestic-residence

B) Current functions

01A01: Domestic-residence

01C05: Domestic-garage

• **Description** Enter categories (codes and terms) from the Iowa Site Inventory Form Instructions

A) Architectural classification

09A10: House-1 1/2 stories, gable side roof

07E01: Bungalow

B) Materials

Foundation (visible exterior): 10: concrete

Walls (visible exterior): 02A: wood weatherboard

Roof: 08A: Asphalt shingles

Other: _____

C) Narrative description SEE CONTINUATION SHEETS, WHICH MUST BE COMPLETED

Site Number: 44-01881 Address: 415 W Front City: Wayland County: Henry District Number:

• **Statement of Significance**

A) Applicable National Register Criteria: *Mark your opinion of eligibility after applying relevant National Register criteria*

- Criterion A: Property is associated with significant events. Yes No More research recommended
Criterion B: Property is associated with the lives of significant persons. Yes No More research recommended
Criterion C: Property has distinctive architectural characteristics. Yes No More research recommended
Criterion D: Property yields significant information in archaeology/history. Yes No More research recommended

B) Special criteria considerations: *Mark any special considerations; leave blank if none*

- A: Owned by a religious institution or used for religious purposes. E: A reconstructed building, object, or structure.
 B: Removed from its original location. F: A commemorative property.
 C: A birthplace or grave. G: Property less than 50 years of age or
 D: A cemetery. achieved significance within the past 50 years.

C) Areas of significance

Enter categories from instructions

D) Period(s) of significance

E) Significant dates

Construction date

1919 *check if circa or estimated date*
Other dates, including renovations

F) Significant person

Complete if Criterion B is marked above

G) Cultural affiliation

Complete if Criterion D is marked above

H) Architect/Builder

Architect

Builder/contractor

I) Narrative statement of significance *SEE CONTINUATION SHEETS, WHICH MUST BE COMPLETED*

• **Bibliography** *See continuation sheets for the list of research sources used in preparing this form*

• **Geographic Data** *Optional UTM references* *See continuation sheet for additional UTM or comments*

Zone	Easting	Northing	NAD	Zone	Easting	Northing	NAD
1	___	___	___	2	___	___	___
3	___	___	___	4	___	___	___

• **Form Preparation**

Name and Title: Marsha Chalupa - volunteer Rebecca Lawin McCarley, consultant Date: 11-20-15
Organization/firm: Henry County Historic Preservation Commission E-mail: -
Street address: Henry County Courthouse, 100 E, Washington St Telephone: 319-385-0756
City or Town: Mount Pleasant State: Iowa Zip code: 52641

• **ADDITIONAL DOCUMENTATION** *Submit the following items with the completed form*

A) For all properties, attach the following, as specified in the Iowa Site Inventory Form Instructions:

- 1. Map** of property's location within the community.
- 2. Glossy color 4x6 photos labeled** on back with property/building name, address, date taken, view shown, and unique photo number.
- 3. Photo key showing each photo number on a map and/or floor plan, using arrows next to each photo number to indicate the location and directional view of each photograph.**
- 4. Site plan** of buildings/structures on site, identifying boundaries, public roads, and building/structure footprints.

B) For State Historic Tax Credit Part 1 Applications, historic districts and farmsteads, and barns:

See lists of special requirements and attachments in the Iowa Site Inventory Form Instructions.

State Historic Preservation Office (SHPO) Use Only Below This Line

The SHPO has reviewed the Site Inventory and concurs with above survey opinion on National Register eligibility:

- Yes No More research recommended
 This is a locally designated property or part of a locally designated district.

Comments: _____

SHPO authorized signature: _____ Date: _____

Iowa Site Inventory Form
State Historic Preservation Office
Continuation Sheet

Site Number: 44-01881
Related District Number: _____

Page 3

House	Henry
Name of Property	County
415 W Front	Wayland
Address	City

Construction dates:

Assessor date (1900 is default date): 1900
Better estimated date and source: c.1919

Additional architectural information from the Reconnaissance Survey:

House:

Height (stories): 1 ½ stories
Walls (construction/cladding): frame construction-wood weatherboard siding
Foundation: concrete
Roof style: gable side
Primary window type: 1/1 wood window
- storm windows: yes-aluminum
Porch: yes-full front porch-brick
Front entry:
Other architectural features: 4 window dormer on front roof line, 3 window dormer on back roof line

Garage: unattached

Walls: frame construction-wood siding
Roof style/material: gable front-asphalt
Size: 2 car
Front faces: west
Other architectural features:

Other buildings (list and provide any additional information:

Additional historical information from the Reconnaissance Survey:

2015 property owner: Dan R & Kimberly M Sheets

Iowa Site Inventory Form
State Historic Preservation Office
Continuation Sheet

Site Number: 44-01881
 Related District Number: _____

Page 4

House	Henry
Name of Property	County
415 W Front	Wayland
Address	City

Property ownership research conducted for the property:

Grantor/Seller:	Wayland Investment Co.	Legal Description and other relevant notes: Lots 29 & 30 Deed book record (if listed) – book/page: 3/335
Grantee/Buyer:	A.S. Allen	
Date:	3-14-1907	
Price:		
Grantor/Seller:	A.S. Allen	Legal Description and other relevant notes: Lots 29 & 30 Deed book record (if listed) – book/page: 4/134
Grantee/Buyer:	C.K. Schantz (carpenter/contractor)	
Date:	10-19-1917	
Price:	800.00	
Grantor/Seller:	C.K. Schantz	Legal Description and other relevant notes: Lots 29 & 30 Deed book record (if listed) – book/page: 4/134
Grantee/Buyer:	Wm Boshart	
Date:	4-02-1920	
Price:	1000.00	
Grantor/Seller:	Wm Boshart	Legal Description and other relevant notes: Lots 29 & 30 Deed book record (if listed) – book/page: 4/134
Grantee/Buyer:	J.W. McCoy	
Date:	10-27-1920	
Price:	1300.00	
Grantor/Seller:	McCoy heirs	Legal Description and other relevant notes: Lots 29 & 30 Deed book record (if listed) – book/page:
Grantee/Buyer:	Mildred Gisell	
Date:	Nov-Dec 1956	
Price:	\$5,000	
Grantor/Seller:	Mildred and Glenn Gisell	Legal Description and other relevant notes: Deed book record (if listed) – book/page:
Grantee/Buyer:	Jake and Hannah Roth	
Date:	10-14-1961	
Price:		
Grantor/Seller:		Legal Description and other relevant notes: Deed book record (if listed) – book/page:
Grantee/Buyer:		
Date:		
Price:		
Grantor/Seller:		Legal Description and other relevant notes: Deed book record (if listed) – book/page:
Grantee/Buyer:		
Date:		
Price:		

Iowa Site Inventory Form
State Historic Preservation Office
Continuation Sheet

Site Number: 44-01881
Related District Number: _____

Page 5

House	Henry
Name of Property	County
415 W Front	Wayland
Address	City

Bibliography

Brooks and Whiting. *Atlas of Henry County, Iowa*. St. Louis, MO: W.E. Stephens and Co., 1895.

Cooper, Carolyn, ed. *Map of Henry County, Iowa 1859*. Reprint Edition. Mt. Pleasant, Iowa : Henry County Genealogical Society, 1989.

Drury, John. *This is Henry County, Iowa*. Chicago: Inland Photo Company, 1956.

Henry County Bicentennial Commission (HCBC). *The History of Henry County, Iowa*. Dallas, TX: National ShareGraphics, Inc., 1982.

Henry County Auditor's Office. Transfer book records, various books/dates.

History of Henry County, Iowa. Chicago: Western Historical Company, 1879.

Jaynes, Peter H., ed. *Highlights of Henry County History 1833-1976*. Burlington, IA: Doran & Ward Lithographing Co., 1977.

Kean Map Company. *Atlas of Henry County, Iowa*. Des Moines: Kean Map Company, 1931.

Mason, George T. *Directory of Henry County, Iowa, 1911-1912*. Mt. Pleasant, IA: The News, 1911.

Ogle, George A. & Co. *Standard Atlas of Henry County, Iowa*. George A. Ogle & Co., 1917.

Portrait and Biographical Album of Henry County, Iowa. Chicago: Acme Publishing Co., 1888.

Thompson and Everts. *Combination Atlas Map of Henry County, Iowa*. Geneva, IL: Thompson and Everts, 1870.

Wayland Centennial Committee. *Wayland: The First Century, 1880-1980*. Wayland, 1980.

Iowa Site Inventory Form
State Historic Preservation Office
Continuation Sheet

Site Number: 44-01881
Related District Number: _____

Page 6

House	Henry
Name of Property	County
415 W Front	Wayland
Address	City

Sketch map

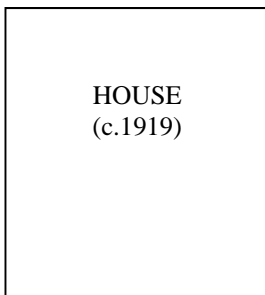
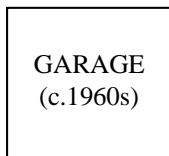

Front

Iowa Site Inventory Form
State Historic Preservation Office
Continuation Sheet

Site Number: 44-01881
Related District Number: _____

Page 7

House	Henry
Name of Property	County
415 W Front	Wayland
Address	City

Location map

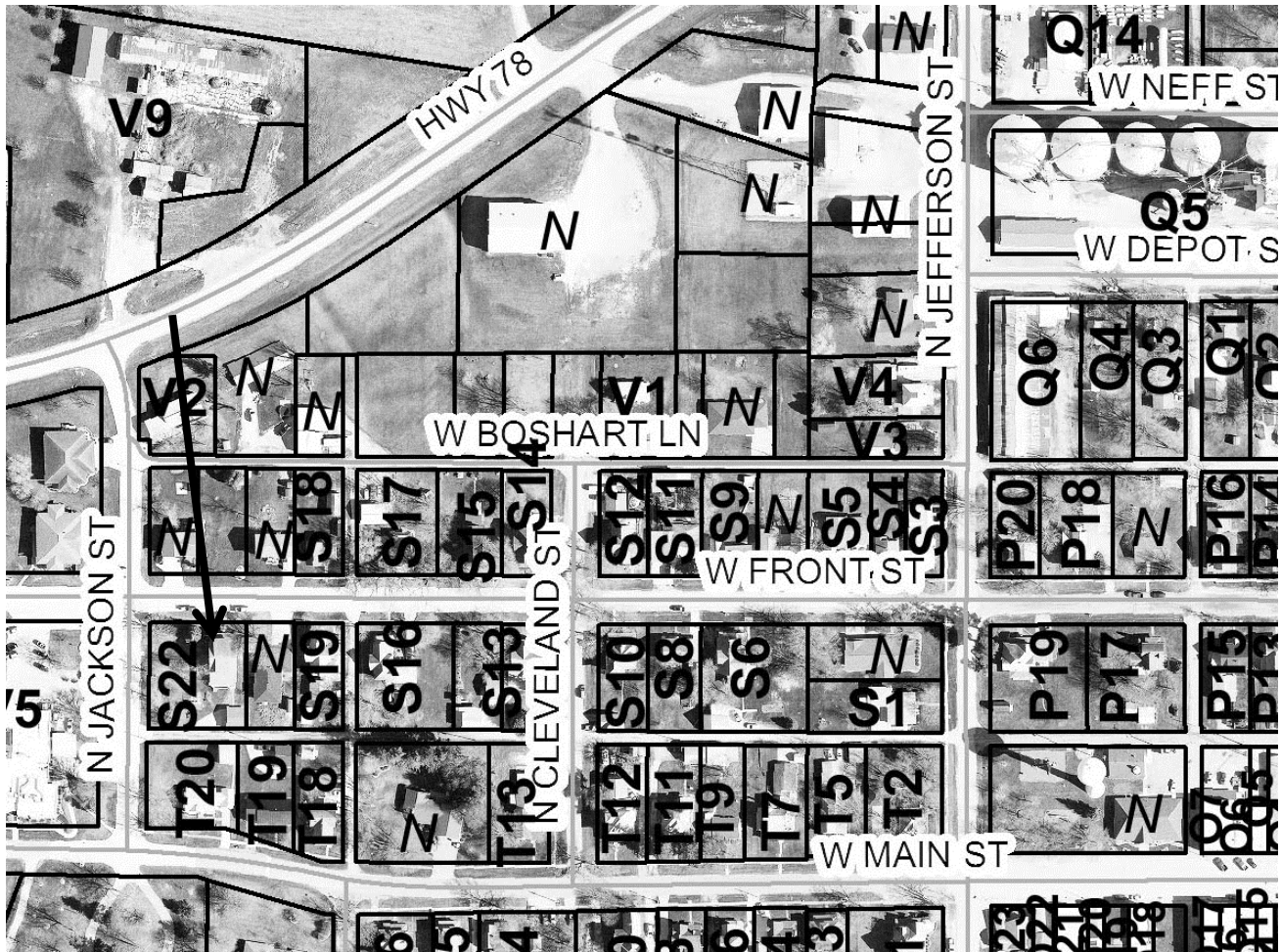

Iowa Site Inventory Form
State Historic Preservation Office
Continuation Sheet

Site Number: 44-01881
Related District Number: _____

Page 8

House	Henry
Name of Property	County
415 W Front	Wayland
Address	City

Pictometry view from Henry County GIS – 2016 imagery



Iowa Site Inventory Form
State Historic Preservation Office
Continuation Sheet

Site Number: 44-01881
Related District Number: _____

Page 9

House	Henry
Name of Property	County
415 W Front	Wayland
Address	City

Digital photographs



Photograph 44-01881-001 - House, looking southwest (December 2015)

Iowa Site Inventory Form

State Historic Preservation Office

(July 2014)

State Inventory Number: 44-01929 New Supplemental

9-Digit SHPO Review & Compliance (R&C) Number: _____

Non-extant Year: _____

Read the Iowa Site Inventory Form Instructions carefully, to ensure accuracy and completeness before completing this form. The instructions are available on our website: <http://www.iowahistory.org/historic-preservation/statewide-inventory-and-collections/iowa-site-inventory-form.html>

• **Property Name**

A) Historic name: House

B) Other names: Reconnaissance Survey Field Site #K-10

• **Location**

A) Street address: 302 E Main St

B) City or town: Wayland (Vicinity) County: Henry

C) Legal description:

Rural: Township Name: Jefferson Township No.: 73N Range No.: 7W Section: _____ Quarter: _____ of Quarter: _____

Urban: Subdivision: Wayland Land Co Block(s): _____ Lot(s): 34 & 35

• **Classification**

A) Property category: *Check only one*

- Building(s)
- District
- Site
- Structure
- Object

B) Number of resources (within property):

If eligible property, enter number of:		If non-eligible property, enter number of:	
Contributing	Noncontributing		
—	Buildings	—	Buildings
—	Sites	—	Sites
—	Structures	—	Structures
—	Objects	—	Objects
—	Total	—	Total

C) For properties listed in the National Register:

National Register status: Listed De-listed NHL NPS DOE

D) For properties within a historic district:

- Property contributes to a National Register or local certified historic district.
- Property contributes to a potential historic district, based on professional historic/architectural survey and evaluation.
- Property *does not* contribute to the historic district in which it is located.

Historic district name: _____ Historic district site inventory number: _____

E) Name of related project report or multiple property study, if applicable:

MPD title

Historical Architectural Data Base #

Reconnaissance Level Historical/Architectural Survey of Jefferson Township, Henry County 44-024

• **Function or Use** *Enter categories (codes and terms) from the Iowa Site Inventory Form Instructions*

A) Historic functions

01A01: Domestic - residence

B) Current functions

01A01: Domestic - residence

0C105: Domestic - garage

• **Description** *Enter categories (codes and terms) from the Iowa Site Inventory Form Instructions*

A) Architectural classification

09A09: House – Cross-gabled roof

05D: Queen Anne

B) Materials

Foundation (visible exterior): 03: Brick

Walls (visible exterior): 15B: Vinyl

Roof: 08A: Asphalt shingles

Other: _____

C) Narrative description *SEE CONTINUATION SHEETS, WHICH MUST BE COMPLETED*

Site Number: 44-01929 Address: 302 E Main St City: Wayland County: Henry District Number:

• **Statement of Significance**

A) Applicable National Register Criteria: *Mark your opinion of eligibility after applying relevant National Register criteria*

- Criterion A: Property is associated with significant events. Yes No More research recommended
Criterion B: Property is associated with the lives of significant persons. Yes No More research recommended
Criterion C: Property has distinctive architectural characteristics. Yes No More research recommended
Criterion D: Property yields significant information in archaeology/history. Yes No More research recommended

B) Special criteria considerations: *Mark any special considerations; leave blank if none*

- A: Owned by a religious institution or used for religious purposes. E: A reconstructed building, object, or structure.
 B: Removed from its original location. F: A commemorative property.
 C: A birthplace or grave. G: Property less than 50 years of age or
 D: A cemetery. achieved significance within the past 50 years.

C) Areas of significance

Enter categories from instructions

D) Period(s) of significance

E) Significant dates

Construction date

1899 *check if circa or estimated date*

Other dates, including renovations

F) Significant person

Complete if Criterion B is marked above

G) Cultural affiliation

Complete if Criterion D is marked above

H) Architect/Builder

Architect

Builder/contractor

I) Narrative statement of significance *SEE CONTINUATION SHEETS, WHICH MUST BE COMPLETED*

• **Bibliography** *See continuation sheets for the list of research sources used in preparing this form*

• **Geographic Data** *Optional UTM references* *See continuation sheet for additional UTM or comments*

Zone	Easting	Northing	NAD	Zone	Easting	Northing	NAD
1	___	___	___	2	___	___	___
3	___	___	___	4	___	___	___

• **Form Preparation**

Name and Title: Beverly Conrad - volunteer Rebecca Lawin McCarley, consultant Date: 02/10/2016

Organization/firm: Henry County Historic Preservation Commission E-mail: -

Street address: Henry County Courthouse, 100 E, Washington St Telephone: 319-385-0756

City or Town: Mount Pleasant State: Iowa Zip code: 52641

• **ADDITIONAL DOCUMENTATION** *Submit the following items with the completed form*

A) For all properties, attach the following, as specified in the Iowa Site Inventory Form Instructions:

- 1. Map** of property's location within the community.
- 2. Glossy color 4x6 photos labeled** on back with property/building name, address, date taken, view shown, and unique photo number.
- 3. Photo key showing each photo number on a map and/or floor plan, using arrows next to each photo number to indicate the location and directional view of each photograph.**
- 4. Site plan** of buildings/structures on site, identifying boundaries, public roads, and building/structure footprints.

B) For State Historic Tax Credit Part 1 Applications, historic districts and farmsteads, and barns:

See lists of special requirements and attachments in the Iowa Site Inventory Form Instructions.

State Historic Preservation Office (SHPO) Use Only Below This Line

The SHPO has reviewed the Site Inventory and concurs with above survey opinion on National Register eligibility:

- Yes No More research recommended
 This is a locally designated property or part of a locally designated district.

Comments: _____

SHPO authorized signature: _____

Date: _____

Iowa Site Inventory Form
State Historic Preservation Office
Continuation Sheet

Site Number: 44-01929
Related District Number: _____

Page 3

House	Henry
Name of Property	County
<u>302 E Main St.</u>	<u>Wayland</u>
Address	City

Construction dates:

Assessor date (1900 is default date): 1900
Better estimated date and source: c.1899

Additional architectural information from the Reconnaissance Survey:

House:

Height (stories): 2 stories
Walls (construction/cladding): Frame Construction, Vinyl Siding
Foundation: Brick
Roof style: Cross-gable roof, asphalt shingles
Primary window type: 1/1, wood & vinyl
- storm windows: vinyl
Porch: full front and wraps around to side
Front entry:
Other architectural features: Intricate wood scroll patterns on front porch (old metal roof on it)

Garage:

Walls: Frame Construction, vinyl siding
Roof style/material: Gable-side, asphalt shingles
Size: two car
Front faces: west
Other architectural features: Built 1952

Other buildings (list and provide any additional information:

Additional historical information from the Reconnaissance Survey:

In January 1899, the Wayland Land Company was formed, with H.C. Meyer, president; C.K. Schantz, secretary, and R.M. Luellen, treasurer. Their purpose was to control and lay out additions to town and to deal in lands and buildings (WCC 1980: 26). The Wayland Land Company platted the addition along the south side of E. Railroad and east side of N. Adams, extending E. Main further to the east along the south side of the addition and naming the streets in this east portion of town. Thus, the old route into Wayland then ran along E. Railroad Street, south on N. Adams at the west edge of their addition, and west on E. Main Street into the core of Wayland. The first lots sold in May 1899, around \$70 to \$100 per lot (McCarley 2016: 97). The neighborhood was developed over the next several decades.

1911-12 county directory (Mason 1911: 192-197) - 3 pages of listings for Wayland
furniture: Jacob Wenger

2015 property owner: Paul A & Melissa J Kissell

Iowa Site Inventory Form
State Historic Preservation Office
Continuation Sheet

Site Number: 44-01929
 Related District Number: _____

Page 4

House	Henry
Name of Property	County
302 E Main St.	Wayland
Address	City

Property ownership research conducted for the property:

Grantor/Seller:	Wayland Land Co	Legal Description and other relevant notes: Lots 34 & 35 Deed book record (if listed) – book/page: 2/490
Grantee/Buyer:	Jacob Wenger	
Date:	May 2, 1899	
Price:	\$195	
Grantor/Seller:	Jacob Wenger	Legal Description and other relevant notes: Lots 34 & 35 Deed book record (if listed) – book/page: D/131
Grantee/Buyer:	Olive Hulme Boller	
Date:	May 10, 1916	
Price:		
Grantor/Seller:	W.E. and Olive Hulme Boller	Legal Description and other relevant notes: Lots 34, 35, & 36 Deed book record (if listed) – book/page: D/131
Grantee/Buyer:	H.H. Hulme	
Date:	December 31, 1935	
Price:		
Grantor/Seller:	Sam Hulme et al	Legal Description and other relevant notes: Lots 34, 35, & 36 Deed book record (if listed) – book/page: D/131
Grantee/Buyer:	Edna Widmer	
Date:	December 30, 1946	
Price:	375	
Grantor/Seller:		Legal Description and other relevant notes: Deed book record (if listed) – book/page:
Grantee/Buyer:		
Date:		
Price:		
Grantor/Seller:		Legal Description and other relevant notes: Deed book record (if listed) – book/page:
Grantee/Buyer:		
Date:		
Price:		

Iowa Site Inventory Form
State Historic Preservation Office
Continuation Sheet

Site Number: 44-01929
Related District Number: _____

Page 5

House	Henry
Name of Property	County
302 E Main St.	Wayland
Address	City

Bibliography

Brooks and Whiting. *Atlas of Henry County, Iowa*. St. Louis, MO: W.E. Stephens and Co., 1895.

Cooper, Carolyn, ed. *Map of Henry County, Iowa 1859*. Reprint Edition. Mt. Pleasant, Iowa : Henry County Genealogical Society, 1989.

Drury, John. *This is Henry County, Iowa*. Chicago: Inland Photo Company, 1956.

Henry County Bicentennial Commission (HCBC). *The History of Henry County, Iowa*. Dallas, TX: National ShareGraphics, Inc., 1982.

Henry County Auditor's Office. Transfer book records, various books/dates.

History of Henry County, Iowa. Chicago: Western Historical Company, 1879.

Jaynes, Peter H., ed. *Highlights of Henry County History 1833-1976*. Burlington, IA: Doran & Ward Lithographing Co., 1977.

Kean Map Company. *Atlas of Henry County, Iowa*. Des Moines: Kean Map Company, 1931.

Mason, George T. *Directory of Henry County, Iowa, 1911-1912*. Mt. Pleasant, IA: The News, 1911.

Ogle, George A. & Co. *Standard Atlas of Henry County, Iowa*. George A. Ogle & Co., 1917.

Portrait and Biographical Album of Henry County, Iowa. Chicago: Acme Publishing Co., 1888.

Thompson and Everts. *Combination Atlas Map of Henry County, Iowa*. Geneva, IL: Thompson and Everts, 1870.

Wayland Centennial Committee. *Wayland: The First Century, 1880-1980*. Wayland, 1980.

Iowa Site Inventory Form
State Historic Preservation Office
Continuation Sheet

Site Number: 44-01929
Related District Number: _____

Page 6

House	Henry
Name of Property	County
302 E Main St.	Wayland
Address	City

Sketch map



GARAGE
(pre-1975)

HOUSE
(c.1899)

Main St

Iowa Site Inventory Form
State Historic Preservation Office
Continuation Sheet

Site Number: 44-01929
Related District Number: _____

Page 7

House	Henry
Name of Property	County
302 E Main St.	Wayland
Address	City

Location map



Iowa Site Inventory Form
State Historic Preservation Office
Continuation Sheet

Site Number: 44-01929
Related District Number: _____

Page 8

House	Henry
Name of Property	County
302 E Main St.	Wayland
Address	City

Pictometry view from Henry County GIS – 2013 imagery



Iowa Site Inventory Form
State Historic Preservation Office
Continuation Sheet

Site Number: 44-01929
Related District Number: _____

Page 9

House
Name of Property

Henry
County

302 E Main St.
Address

Wayland
City

Digital photographs



Photograph 44-01929-001 - House, looking southwest (December 2015)

Iowa Site Inventory Form

State Historic Preservation Office

(July 2014)

State Inventory Number: 44-01977 New Supplemental

9-Digit SHPO Review & Compliance (R&C) Number: _____

Non-extant Year: _____

Read the Iowa Site Inventory Form Instructions carefully, to ensure accuracy and completeness before completing this form. The instructions are available on our website: <http://www.iowahistory.org/historic-preservation/statewide-inventory-and-collections/iowa-site-inventory-form.html>

• **Property Name**

A) Historic name: John and Lenore Wenger House

B) Other names: Reconnaissance Survey Field Site #T-12

• **Location**

A) Street address: 314 W Main St

B) City or town: Wayland (Vicinity) County: Henry

C) Legal description:

Rural: Township Name: Jefferson Township No.: 73N Range No.: 7W Section: _____ Quarter: _____ of Quarter: _____

Urban: Subdivision: Wayland Investment Co 1st Addition Block(s): _____ Lot(s): Lot 40

• **Classification**

A) Property category: *Check only one*

- Building(s)
- District
- Site
- Structure
- Object

B) Number of resources (within property):

If eligible property, enter number of:		If non-eligible property, enter number of:	
Contributing	Noncontributing		
<u>1</u>	Buildings	—	Buildings
—	Sites	—	Sites
—	Structures	—	Structures
—	Objects	—	Objects
<u>1</u>	Total	—	Total

C) For properties listed in the National Register:

National Register status: Listed De-listed NHL NPS DOE

D) For properties within a historic district:

- Property contributes to a National Register or local certified historic district.
- Property contributes to a potential historic district, based on professional historic/architectural survey and evaluation.
- Property *does not* contribute to the historic district in which it is located.

Historic district name: West Main Residential Historic District Historic district site inventory number: 44-02194

E) Name of related project report or multiple property study, if applicable:

MPD title: Reconnaissance Level Historical/Architectural Survey of Jefferson Township, Henry County Historical Architectural Data Base #: 44-024

• **Function or Use** *Enter categories (codes and terms) from the Iowa Site Inventory Form Instructions*

A) Historic functions

01A01: Domestic - residence

B) Current functions

01A01: Domestic - residence

• **Description** *Enter categories (codes and terms) from the Iowa Site Inventory Form Instructions*

A) Architectural classification

09A06: 2 stories – Hip Roof, cubic

B) Materials

Foundation (visible exterior): 10B: Concrete Block

Walls (visible exterior): 02A: Weatherboard, 02B: shingle

Roof: 09: Asbestos

Other: _____

C) Narrative description SEE CONTINUATION SHEETS, WHICH MUST BE COMPLETED

• Statement of Significance

A) Applicable National Register Criteria: *Mark your opinion of eligibility after applying relevant National Register criteria*

- Criterion A: Property is associated with significant events. Yes No More research recommended
 Criterion B: Property is associated with the lives of significant persons. Yes No More research recommended
 Criterion C: Property has distinctive architectural characteristics. Yes No More research recommended
 Criterion D: Property yields significant information in archaeology/history. Yes No More research recommended

B) Special criteria considerations: *Mark any special considerations; leave blank if none*

- A: Owned by a religious institution or used for religious purposes. E: A reconstructed building, object, or structure.
 B: Removed from its original location. F: A commemorative property.
 C: A birthplace or grave. G: Property less than 50 years of age or
 D: A cemetery. achieved significance within the past 50 years.

C) Areas of significance

Enter categories from instructions

D) Period(s) of significance

E) Significant dates

Construction date

1912 *check if circa or estimated date*
 Other dates, including renovations

F) Significant person

Complete if Criterion B is marked above

G) Cultural affiliation

Complete if Criterion D is marked above

H) Architect/Builder

Architect

Builder/contractor

I) Narrative statement of significance *SEE CONTINUATION SHEETS, WHICH MUST BE COMPLETED*

• Bibliography *See continuation sheets for the list of research sources used in preparing this form*

• Geographic Data *Optional UTM references* *See continuation sheet for additional UTM or comments*

Zone	Easting	Northing	NAD	Zone	Easting	Northing	NAD
1	_____	_____	_____	2	_____	_____	_____
3	_____	_____	_____	4	_____	_____	_____

• Form Preparation

Name and Title: Beverly Conrad - volunteer Rebecca Lawin McCarley, consultant Date: 11/27/2015
 Organization/firm: Henry County Historic Preservation Commission E-mail: -
 Street address: Henry County Courthouse, 100 E, Washington St Telephone: 319-385-0756
 City or Town: Mount Pleasant State: Iowa Zip code: 52641

• ADDITIONAL DOCUMENTATION *Submit the following items with the completed form*

A) For all properties, attach the following, as specified in the Iowa Site Inventory Form Instructions:

- 1. Map** of property's location within the community.
- 2. Glossy color 4x6 photos labeled** on back with property/building name, address, date taken, view shown, and unique photo number.
- 3. Photo key showing each photo number on a map and/or floor plan, using arrows next to each photo number to indicate the location and directional view of each photograph.**
- 4. Site plan** of buildings/structures on site, identifying boundaries, public roads, and building/structure footprints.

B) For State Historic Tax Credit Part 1 Applications, historic districts and farmsteads, and barns:

See lists of special requirements and attachments in the Iowa Site Inventory Form Instructions.

State Historic Preservation Office (SHPO) Use Only Below This Line

The SHPO has reviewed the Site Inventory and concurs with above survey opinion on National Register eligibility:

- Yes No More research recommended
 This is a locally designated property or part of a locally designated district.

Comments: _____

SHPO authorized signature: _____ Date: _____

Iowa Site Inventory Form
State Historic Preservation Office
Continuation Sheet

Site Number: 44-01977
Related District Number: 44-02194

Page 3

John and Lenore Wenger House	Henry
Name of Property	County
314 W Main St	Wayland
Address	City

Construction dates:

Assessor date (1900 is default date): 1900
Better estimated date and source: c.1912

Additional architectural information from the Reconnaissance Survey:

House:

Height (stories): 2 stories
Walls (construction/cladding): Frame construction, weatherboard siding / wood shingles on 2nd story
Foundation: concrete block – rusticated
Roof style: hip roof, asbestos shingles
Primary window type: 1/1 wood windows
- storm windows: wood storm/screens
Porch: full front porch, wood
Front entry:
Other architectural features: dormer

Garage: attached – rear addition – c.1970

Walls:
Roof style/material:
Size:
Front faces:
Other architectural features:

Other buildings (list and provide any additional information:

Additional historical information from the Reconnaissance Survey:

appears built around 1912 for John Wenger
contributing within potential West Main Residential Historic District
likely also individually eligible under Criterion C for architecture

1911-12 county directory (Mason 1911: 192-197)
auctioneer: John Wenger

1920 census (says Front, but looks like should be Main)
John Wenger – 52 – auctioneer – farm sales
- Lenore – 49

2015 property owner: Charles B Peck

Iowa Site Inventory Form
State Historic Preservation Office
Continuation Sheet

Site Number: 44-01977
 Related District Number: 44-02194

Page 4

John and Lenore Wenger House	Henry
Name of Property	County
314 W Main St	Wayland
Address	City

Property ownership research conducted for the property:

Grantor/Seller:	Wayland Investment Co	Legal Description and other relevant notes: Wayland Investment Co (1 st Addition) Lot 40 Deed book record (if listed) – book/page: 2/498
Grantee/Buyer:	William Deeds	
Date:	June 12, 1902	
Price:	\$150	
Grantor/Seller:	William Deeds	Legal Description and other relevant notes: Wayland Investment Co (1 st Addition) Lot 40 Deed book record (if listed) – book/page: 3/335
Grantee/Buyer:	C C Wenger	
Date:	July 20, 1906	
Price:	-	
Grantor/Seller:	C C Wenger	Legal Description and other relevant notes: Wayland Investment Co (1 st Addition) Lot 22 & Lot 40 Deed book record (if listed) – book/page: 3/335
Grantee/Buyer:	John Wenger	
Date:	June 11, 1912	
Price:	-	
Grantor/Seller:	Lenore Wenger, widow	Legal Description and other relevant notes: Wayland Investment Co (1 st Addition) Lot 40 Deed book record (if listed) – book/page: 4/135
Grantee/Buyer:	Jacob & Grase Eicher	
Date:	August 14, 1947	
Price:		
Grantor/Seller:		Legal Description and other relevant notes: Deed book record (if listed) – book/page:
Grantee/Buyer:		
Date:		
Price:		
Grantor/Seller:		Legal Description and other relevant notes: Deed book record (if listed) – book/page:
Grantee/Buyer:		
Date:		
Price:		

Iowa Site Inventory Form
State Historic Preservation Office
Continuation Sheet

Site Number: 44-01977
Related District Number: 44-02194

Page 5

<u>John and Lenore Wenger House</u>	<u>Henry</u>
Name of Property	County
<u>314 W Main St</u>	<u>Wayland</u>
Address	City

Bibliography

Brooks and Whiting. *Atlas of Henry County, Iowa*. St. Louis, MO: W.E. Stephens and Co., 1895.

Cooper, Carolyn, ed. *Map of Henry County, Iowa 1859*. Reprint Edition. Mt. Pleasant, Iowa : Henry County Genealogical Society, 1989.

Drury, John. *This is Henry County, Iowa*. Chicago: Inland Photo Company, 1956.

Henry County Bicentennial Commission (HCBC). *The History of Henry County, Iowa*. Dallas, TX: National ShareGraphics, Inc., 1982.

Henry County Auditor's Office. Transfer book records, various books/dates.

History of Henry County, Iowa. Chicago: Western Historical Company, 1879.

Jaynes, Peter H., ed. *Highlights of Henry County History 1833-1976*. Burlington, IA: Doran & Ward Lithographing Co., 1977.

Kean Map Company. *Atlas of Henry County, Iowa*. Des Moines: Kean Map Company, 1931.

Mason, George T. *Directory of Henry County, Iowa, 1911-1912*. Mt. Pleasant, IA: The News, 1911.

Ogle, George A. & Co. *Standard Atlas of Henry County, Iowa*. George A. Ogle & Co., 1917.

Portrait and Biographical Album of Henry County, Iowa. Chicago: Acme Publishing Co., 1888.

Thompson and Everts. *Combination Atlas Map of Henry County, Iowa*. Geneva, IL: Thompson and Everts, 1870.

Wayland Centennial Committee. *Wayland: The First Century, 1880-1980*. Wayland, 1980.

Iowa Site Inventory Form
State Historic Preservation Office
Continuation Sheet

Site Number: 44-01977
Related District Number: 44-02194

Page 6

John and Lenore Wenger House

Henry

Name of Property

County

314 W Main St

Wayland

Address

City

Sketch map

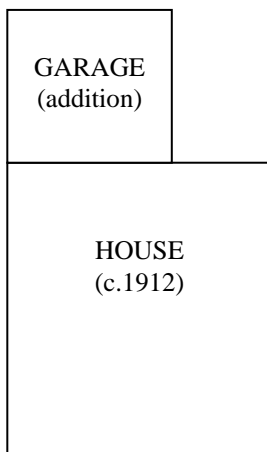
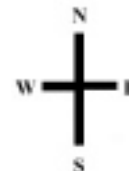

MAIN

Iowa Site Inventory Form
State Historic Preservation Office
Continuation Sheet

Site Number: 44-01977
Related District Number: 44-02194

Page 7

John and Lenore Wenger House

Henry

Name of Property

County

314 W Main St

Wayland

Address

City

Location map



Iowa Site Inventory Form
State Historic Preservation Office
Continuation Sheet

Site Number: 44-01977
Related District Number: 44-02194

Page 8

John and Lenore Wenger House

Henry

Name of Property

County

314 W Main St

Wayland

Address

City

Pictometry view from Henry County GIS – 2013 imagery

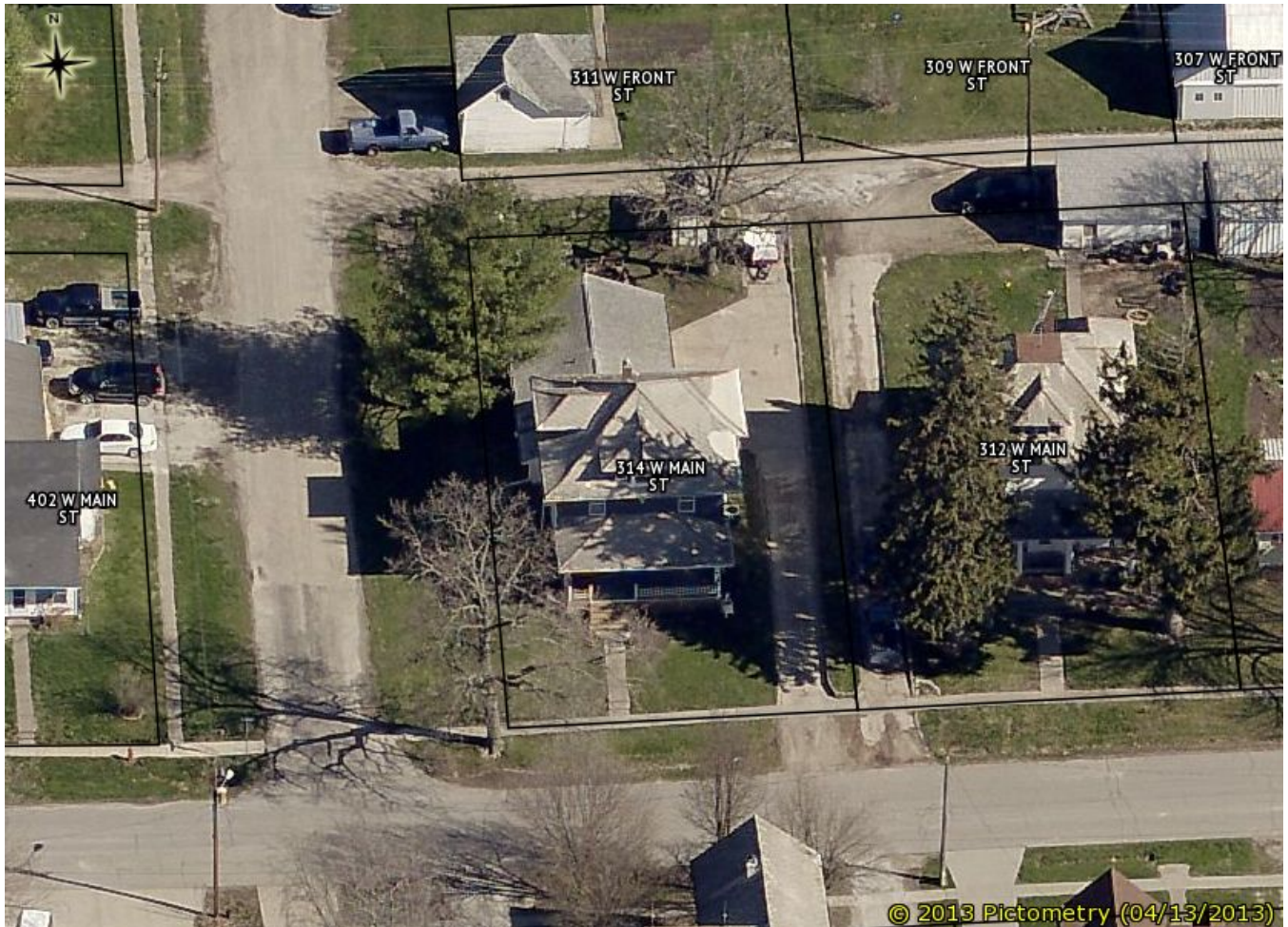

Iowa Site Inventory Form
State Historic Preservation Office
Continuation Sheet

Site Number: 44-01977
Related District Number: 44-02194

Page 9

John and Lenore Wenger House

Name of Property

Henry

County

314 W Main St

Address

Wayland

City

Digital photographs



Photograph 44-01977-001 - House, looking northeast (December 2015)

Iowa Site Inventory Form

State Historic Preservation Office

(July 2014)

State Inventory Number: 44-01723 New Supplemental

9-Digit SHPO Review & Compliance (R&C) Number: _____

Non-extant Year: _____

Read the Iowa Site Inventory Form Instructions carefully, to ensure accuracy and completeness before completing this form. The instructions are available on our website: <http://www.iowahistory.org/historic-preservation/statewide-inventory-and-collections/iowa-site-inventory-form.html>

• Property Name

A) Historic name: Commercial Building

B) Other names: Reconnaissance Survey Field Site #O-02

• Location

A) Street address: 208 W. Main

B) City or town: Wayland (Vicinity) County: Henry

C) Legal description:

Rural: Township Name: Jefferson Township No.: 73N Range No.: 7W Section: _____ Quarter: _____ of Quarter: _____

Urban: Subdivision: Original Town Block(s): _____ Lot(s): W 20' Lot 9 & E 3' Lot 10

• Classification

A) Property category: *Check only one*

- Building(s)
- District
- Site
- Structure
- Object

B) Number of resources (within property):

If eligible property, enter number of:		If non-eligible property, enter number of:	
Contributing	Noncontributing		
<u>1</u>	Buildings	—	Buildings
—	Sites	—	Sites
—	Structures	—	Structures
—	Objects	—	Objects
<u>1</u>	Total	—	Total

C) For properties listed in the National Register:

National Register status: Listed De-listed NHL NPS DOE

D) For properties within a historic district:

- Property contributes to a National Register or local certified historic district.
- Property contributes to a potential historic district, based on professional historic/architectural survey and evaluation.
- Property *does not* contribute to the historic district in which it is located.

Historic district name: Wayland Downtown Historic District Historic district site inventory number: 44-02195

E) Name of related project report or multiple property study, if applicable:

MPD title

Historical Architectural Data Base #

Reconnaissance Level Historical/Architectural Survey of Jefferson Township, Henry County 44-024

• **Function or Use** *Enter categories (codes and terms) from the Iowa Site Inventory Form Instructions*

A) Historic functions

02G01: Commerce – cafe

B) Current functions

02A01 – Commerce – office building

• **Description** *Enter categories (codes and terms) from the Iowa Site Inventory Form Instructions*

A) Architectural classification

09F06: Commercial – Brick front

B) Materials

Foundation (visible exterior): 04C: Limestone

Walls (visible exterior): 03: Brick

Roof: 17: Other

Other: _____

C) Narrative description SEE CONTINUATION SHEETS, WHICH MUST BE COMPLETED

• Statement of Significance

A) Applicable National Register Criteria: *Mark your opinion of eligibility after applying relevant National Register criteria*

- Criterion A: Property is associated with significant events. Yes No More research recommended
 Criterion B: Property is associated with the lives of significant persons. Yes No More research recommended
 Criterion C: Property has distinctive architectural characteristics. Yes No More research recommended
 Criterion D: Property yields significant information in archaeology/history. Yes No More research recommended

B) Special criteria considerations: *Mark any special considerations; leave blank if none*

- A: Owned by a religious institution or used for religious purposes. E: A reconstructed building, object, or structure.
 B: Removed from its original location. F: A commemorative property.
 C: A birthplace or grave. G: Property less than 50 years of age or achieved significance within the past 50 years.
 D: A cemetery

C) Areas of significance

Enter categories from instructions

D) Period(s) of significance

E) Significant dates

Construction date
1899 *check if circa or estimated date*
Other dates, including renovations

G) Cultural affiliation

Complete if Criterion D is marked above

F) Significant person

Complete if Criterion B is marked above

H) Architect/Builder

Architect

Builder/contractor

I) Narrative statement of significance *SEE CONTINUATION SHEETS, WHICH MUST BE COMPLETED*

• Bibliography *See continuation sheets for the list of research sources used in preparing this form*

• Geographic Data *Optional UTM references* *See continuation sheet for additional UTM or comments*

Zone	Easting	Northing	NAD	Zone	Easting	Northing	NAD
1	_____	_____	_____	2	_____	_____	_____
3	_____	_____	_____	4	_____	_____	_____

• Form Preparation

Name and Title: Denise Roth Rebecca Lawin McCarley, consultant Date: November 14, 2015
 Organization/firm: Henry County Historic Preservation Commission E-mail: -
 Street address: Henry County Courthouse, 100 E, Washington St Telephone: 319-385-0756
 City or Town: Mount Pleasant State: Iowa Zip code: 52641

• ADDITIONAL DOCUMENTATION *Submit the following items with the completed form*

A) For all properties, attach the following, as specified in the Iowa Site Inventory Form Instructions:

- 1. Map** of property's location within the community.
- 2. Glossy color 4x6 photos labeled** on back with property/building name, address, date taken, view shown, and unique photo number.
- 3. Photo key showing each photo number on a map and/or floor plan, using arrows next to each photo number to indicate the location and directional view of each photograph.**
- 4. Site plan** of buildings/structures on site, identifying boundaries, public roads, and building/structure footprints.

B) For State Historic Tax Credit Part 1 Applications, historic districts and farmsteads, and barns:

See lists of special requirements and attachments in the Iowa Site Inventory Form Instructions.

State Historic Preservation Office (SHPO) Use Only Below This Line

The SHPO has reviewed the Site Inventory and concurs with above survey opinion on National Register eligibility:

- Yes No More research recommended
 This is a locally designated property or part of a locally designated district.

Comments: _____

SHPO authorized signature: _____ Date: _____

Iowa Site Inventory Form
State Historic Preservation Office
Continuation Sheet

Site Number: 44-01723
Related District Number: 44-02195

Page 3

Commercial Building	Henry
Name of Property	County
208 W. Main	Wayland
Address	City

Construction dates:

Assessor date (1900 is default date): 1899
Better estimated date and source: 1899

Additional architectural information from the Reconnaissance Survey:

Commercial building:

Height (stories): 2 story
Walls (construction/cladding): brick frame, walls clad in brick
Foundation: limestone
Roof style: 2 lb polyurethane foam with elastomeric paint
Primary window type: vinyl; style 1/1
- storm windows: no
Porch: yes front entry porch made of wood
Front entry:
Other architectural features:

Garage:

Walls: wood
Roof style/material: steel, hip
Size: one car
Front faces: north
Other architectural features: completely renovated in 2013/2014

Other buildings (list and provide any additional information:

Additional historical information from the Reconnaissance Survey:

Many years ago Doctor McKirham M.D. had his office upstairs.
Later it was a café and also workout business in the rear.

2015 property owner: Wenger Rentals, LLC

Iowa Site Inventory Form
State Historic Preservation Office
Continuation Sheet

Site Number: 44-01723
Related District Number: 44-02195

Page 4

Commercial Building	Henry
Name of Property	County
208 W. Main	Wayland
Address	City

(deed research: mother Mary owned from 1883-1899; then James from 1899-1908)

1875 - James Wideman – engaged in **manufacture and sale of harness in Wayland** – good business – good annual sales – born in PA in 1853 to Philip and Mary Wideman – with parents to Washington – moved to Keota – learned harness making trade – four years – established shop in Wayland in 1875 – rented second story of frame building for four years – then built frame building– **occupied until 1900 – built a fine brick business block – 24 by 70 – occupied first story with harness shop and manufactured goods – second story divided into four offices – rented – deals in harness, saddles, collars, and oils – first class establishment – also Landis sewing machine – other modern machinery – stock of \$2,000** – married Mary Henthorn in January 1886 – two children – wife died in 1893 – Republican – **one of first councilmen of Wayland – serve for six years – also town clerk for two years** – interested in community affairs – success in business since young age – reliable – desire to please patrons (*Biographical Review of Henry County* 1906: 196-197)

(deed research: owned by E.C. Allen from 1910-death, heirs sold in 1954)

1911-12 county directory (Mason 1911: 192-197)

physicians: **Dr. Edward Allen**, Dr. G.M. Jones, Dr. D.S. McConnaughery, Dr. J.T. McConnaughey

1899 – Wideman building constructed – harness shop – later used by W.A. Shaffer until early 1930s (WCC 1980: 57)

1917 map of Wayland in *Atlas of Henry County* – W.A. Schaffer harness manufacturing – roughly west half of Lot 9 on map

early 1930s – W.A. Shaffer move harness shop from old Wideman building across street to Eicher building – no more use for display horse – finally sold in August 1933 (WCC 1980: 57)

(deed research: owned by Virgil & Freida Aldrich from 1954 through 1970s)

1970 telephone directory

- Aldrich Café

“Wayland: a complete community,” Bicentennial Edition, *Washington Evening Journal*, July 1, 1976, 177 – by Waunita Magdefrau
businesses include Sail Inn Café , Aldrich Café

Iowa Site Inventory Form
State Historic Preservation Office
Continuation Sheet

Site Number: 44-01723
 Related District Number: 44-02195

Page 5

Commercial Building	Henry
Name of Property	County
208 W. Main	Wayland
Address	City

Property ownership research conducted for the property:

Grantor/Seller:	A.G. Brown & Wife	Legal Description and other relevant notes: Lots 9 & 10
Grantee/Buyer:	Mary Wideman	
Date:	September 5, 1883	
Price:		
Grantor/Seller:	John Goldsmith & Wife	Legal Description and other relevant notes: 3' off of East Side of Lot 10
Grantee/Buyer:	James Wideman	
Date:	April 18, 1899	
Price:		
Grantor/Seller:	Mary Wideman (Widow)	Legal Description and other relevant notes: West 20' of Lot 9
Grantee/Buyer:	James Wideman	
Date:	April 22, 1899	
Price:		
Grantor/Seller:	James Wideman	Legal Description and other relevant notes: W 20' of Lot 9 & E 3' of Lot 10
Grantee/Buyer:	F.R. Sage	
Date:	March 30, 1908	
Price:	\$6,000	
Grantor/Seller:	F.R. Sage & Wife	Legal Description and other relevant notes: W 20' of Lot 10 and E 3' of Lot 10
Grantee/Buyer:	J.D. Conrad	
Date:	February 18, 1910	
Price:		
Grantor/Seller:	J.D. Conrad & Wife	Legal Description and other relevant notes: W 20' of Lot 9 and E 3' of Lot 10
Grantee/Buyer:	E.C. Allen	
Date:	May 5, 1910	
Price:		
Grantor/Seller:	M. Eicher & Wife	Legal Description and other relevant notes: W 20' of Lot 9 and E 3' of Lot 10 undivided 1/2 interest
Grantee/Buyer:	E.C. Allen	
Date:	May 17, 1910	
Price:		
Grantor/Seller:	Hoyt Allen et al	Legal Description and other relevant notes: W 20' of Lot 9 and E 3' of Lot 10
Grantee/Buyer:	Virgil & Freida Aldrich	
Date:	July 6, 1954	
Price:	\$5,000	
Grantor/Seller:		Legal Description and other relevant notes:
Grantee/Buyer:		
Date:		
Price:		
Grantor/Seller:		Legal Description and other relevant notes:
Grantee/Buyer:		
Date:		
Price:		

Iowa Site Inventory Form
State Historic Preservation Office
Continuation Sheet

Site Number: 44-01723
Related District Number: 44-02195

Page 6

Commercial Building	Henry
Name of Property	County
208 W. Main	Wayland
Address	City

Bibliography

Brooks and Whiting. *Atlas of Henry County, Iowa*. St. Louis, MO: W.E. Stephens and Co., 1895.

Cooper, Carolyn, ed. *Map of Henry County, Iowa 1859*. Reprint Edition. Mt. Pleasant, Iowa : Henry County Genealogical Society, 1989.

Drury, John. *This is Henry County, Iowa*. Chicago: Inland Photo Company, 1956.

Henry County Bicentennial Commission (HCBC). *The History of Henry County, Iowa*. Dallas, TX: National ShareGraphics, Inc., 1982.

Henry County Auditor's Office. Transfer book records, various books/dates.

History of Henry County, Iowa. Chicago: Western Historical Company, 1879.

Jaynes, Peter H., ed. *Highlights of Henry County History 1833-1976*. Burlington, IA: Doran & Ward Lithographing Co., 1977.

Kean Map Company. *Atlas of Henry County, Iowa*. Des Moines: Kean Map Company, 1931.

Mason, George T. *Directory of Henry County, Iowa, 1911-1912*. Mt. Pleasant, IA: The News, 1911.

Ogle, George A. & Co. *Standard Atlas of Henry County, Iowa*. George A. Ogle & Co., 1917.

Portrait and Biographical Album of Henry County, Iowa. Chicago: Acme Publishing Co., 1888.

Thompson and Everts. *Combination Atlas Map of Henry County, Iowa*. Geneva, IL: Thompson and Everts, 1870.

Wayland Centennial Committee. *Wayland: The First Century, 1880-1980*. Wayland, 1980.

Iowa Site Inventory Form
State Historic Preservation Office
Continuation Sheet

Site Number: 44-01723
Related District Number: 44-02195

Page 7

Commercial Building	Henry
Name of Property	County
208 W. Main	Wayland
Address	City

Sketch map

GARAGE
(pre-1975)

Apartments upstairs
and on north lower
level
(pre-1975)

Benchmark Real
Estate lower level
on south side



W. Main

Iowa Site Inventory Form
State Historic Preservation Office
Continuation Sheet

Site Number: 44-01723
Related District Number: 44-02195

Page 8

Commercial Building	Henry
Name of Property	County
208 W. Main	Wayland
Address	City

Location map



Iowa Site Inventory Form
State Historic Preservation Office
Continuation Sheet

Site Number: 44-01723
Related District Number: 44-02195

Page 9

Commercial Building	Henry
Name of Property	County
208 W. Main	Wayland
Address	City

Pictometry view from Henry County GIS – 2016 imagery



Iowa Site Inventory Form
State Historic Preservation Office
Continuation Sheet

Site Number: 44-01723
Related District Number: 44-02195

Page 10

Commercial Building	Henry
Name of Property	County
208 W. Main	Wayland
Address	City

Historic images



*appears to have sign for J.N. McClintic in window of corner building – owned from 1918-1944
WCC 1980: page 49*

Iowa Site Inventory Form
State Historic Preservation Office
Continuation Sheet

Site Number: 44-01723
Related District Number: 44-02195

Page 11

Commercial Building

Henry

Name of Property

County

208 W. Main

Wayland

Address

City

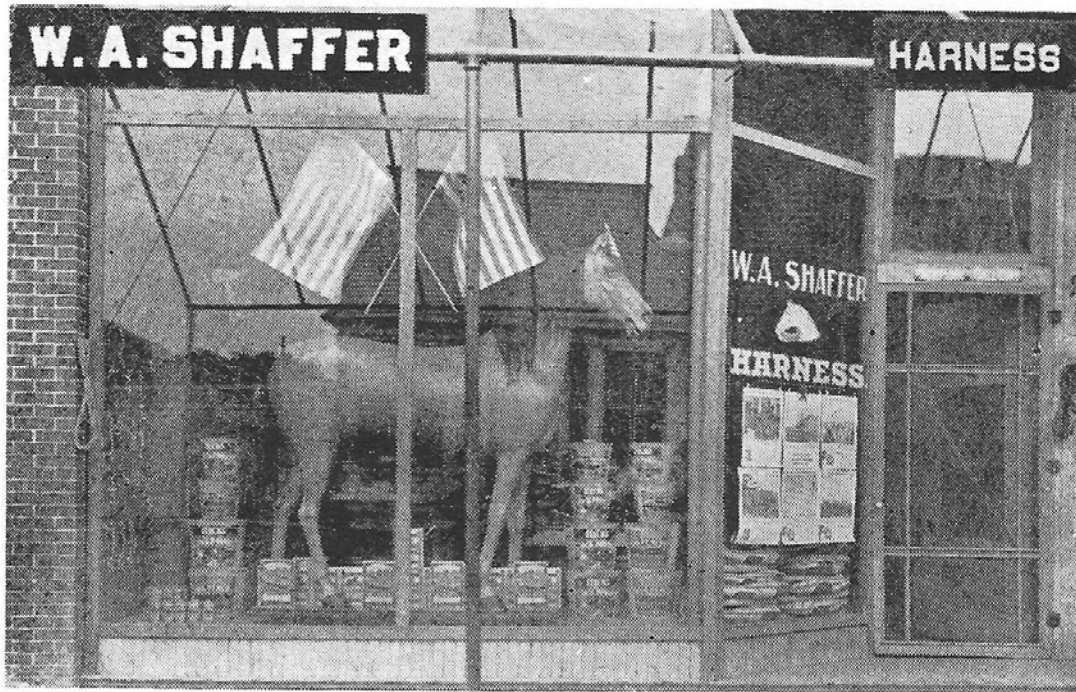

W. A. Shaffer Harness

WCC 1980: page 20

Iowa Site Inventory Form
State Historic Preservation Office
Continuation Sheet

Site Number: 44-01723
Related District Number: 44-02195

Page 12

Commercial Building	Henry
Name of Property	County
208 W. Main	Wayland
Address	City



current site of City Hall

220-218 216 214 212 210 208 202-200
C.C. Wenger

early 1900s

(WCC 1980, page 81)

Iowa Site Inventory Form
State Historic Preservation Office
Continuation Sheet

Site Number: 44-01723
Related District Number: 44-02195

Page 13

Commercial Building	Henry
Name of Property	County
208 W. Main	Wayland
Address	City



Main Street Blacktopping 1936

current site of City Hall 220-218 216 214 212 (210) 208 202-200
C.C. Wenger

(WCC 1980, page 53)

Iowa Site Inventory Form
State Historic Preservation Office
Continuation Sheet

Site Number: 44-01723
Related District Number: 44-02195

Page 14

Commercial Building	Henry
Name of Property	County
208 W. Main	Wayland
Address	City

Digital photographs



Photograph 44-01723-001 - Building, looking northeast (December 2015)