

# H5

LARGE FIREPLACE



**valor**<sup>®</sup>  
Radiant  
Gas Fireplaces

**NEW** V-CLASS BURNER.  
**NEW** LOGS, LINERS AND FRONTS.



# THE SCIENCE OF WARMTH™

Since 1890, we've been pioneering and perfecting radiant heat technology that generates constant, comfortable warmth within your home.

## RADIANT HEAT

We put radiant warmth into every fire. You can feel it.

## CERAMIC GLASS

Durable and robust ceramic glass improves radiant performance.

## REALISTIC LOGS

High definition, low mass fiber ceramic logs heat up and glow quickly, radiating warmth.

## ALUMINIZED STEEL

Lightweight, high temperature aluminized steel firebox and heat exchanger deliver efficient warmth, preventing rust and wear.

On cover:  
BIRCH 1100BLK  
FLUTED BLACK 1125FBL  
CLEAN INSTALL 1130CIK

Proudly Made  
in North America



### **V-CLASS BURNER**

The high temperature precision stainless steel of our new V-Class burner creates a new level of radiant fire and aesthetics.

### **EFFICIENCY**

Radiant heat and zone heating technology are up to 30% more efficient than central forced air systems.

### **CONVECTIVE HEAT**

Secondary heat exchanger naturally improves convective heat—without a fan.

### **ENHANCED FLAME**

Our fires create realistic, soothing flames and ambient glowing embers that radiate heat.

### **HEATSHIFT™ SYSTEM**

Valued artwork, a TV and construction materials stay cooler despite the heat of our fireplaces.

### **ADJUSTABLE HEAT**

Adjustable flame for constant, even warmth without having to cycle the fire on and off.

### **SAFETY**

Our fires are put through rigorous safety testing in our in-house CSA approved lab.

**DRIFTWOOD**  
1100DWK

Please Note: Printed images may vary from actual product. All product information is accurate at time of printing and is subject to change. For more visit [valorfireplaces.com](http://valorfireplaces.com)



## ZERO CLEARANCE (ZC)

Always a great addition to your new home or major reno. OK as an insert too!



## 1 LOGS

We designed these expertly crafted fire beds as realistic-looking as possible, and engineered them to harness radiant heat from the flames and glowing embers.

For more images, go to [valorfireplaces.com](http://valorfireplaces.com) or to see in person, visit your local Valor dealer.

## NEW BIRCH







DRIFTWOOD 1100DWK  
REFLECTIVE LINER 1170RGL  
3-SIDED FRONT 1135TSB

**NEW TRADITIONAL LOGS**



**NEW DRIFTWOOD**







TRADITIONAL LOGS 1100LSK  
RED BRICK 1110VRL  
3-SIDED FRONT 1135TSB

## 2 LINERS

A liner can change the whole look of a fireplace and fire. Consider a firebox liner that complements your front as well as your firebed.

Visit your local authorized Valor dealer to see a liner in person, or go to [valorfireplaces.com/h5](http://valorfireplaces.com/h5)

PLAIN BLACK

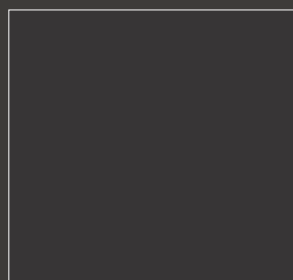

BLACK FLUTED

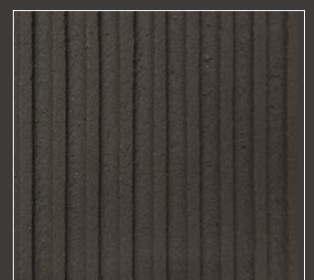



## LINERS

Liners may vary in appearance, depending on whether the fire is on or off, and what fire bed you choose.



REFLECTIVE GLASS



HERRINGBONE

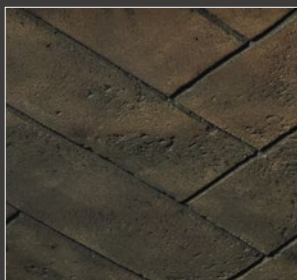

RED BRICK



LEDGESTONE

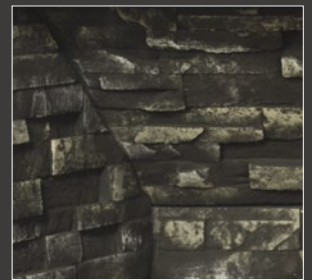



## PUT US OUTDOORS

Our fireplaces are highly suited to outdoor living with the generous warmth of radiant heat they provide—the only heat that works outside. [valorfireplaces.com/outdoor](http://valorfireplaces.com/outdoor)



TRADITIONAL LOGS 1100LSK  
PLAIN BLACK LINER 1160PBL  
CRAFTSMAN AGED STEEL 1184ECAS

## 3 FRONTS

We offer a selection of H5 fronts for your fireplaces. Consider the style of the room, and the fuel bed and liner when choosing a front.

NEW CRAFTSMAN AGED STEEL



NEW CRAFTSMAN PEWTER



NEW CLEAN INSTALL  
25½" h x 35" w  
with fine mesh screen







To see more examples, visit your local Valor dealer or go to [valorfireplaces.com/h5](http://valorfireplaces.com/h5)

**FIXED FRAME**  
26 $\frac{3}{8}$ "h x 35 $\frac{3}{4}$ "w



**3-SIDED BLACK** 30 $\frac{3}{8}$ "h x 40 $\frac{1}{4}$ "w



**H5 4-SIDED BLACK** 32 $\frac{1}{2}$ "h x 41 $\frac{1}{2}$ "w  
*This floating front sits proud of the wall by  $\frac{1}{2}$ ".*





## H5

A large format fireplace, compact in design, with a generous viewing area—fits where the H6 can't.



## FINISHES

Whether it's a powder-coated or plated trim, our finishes are made to last.

Ask your Valor dealer to see a finish sample in person.

BLACK

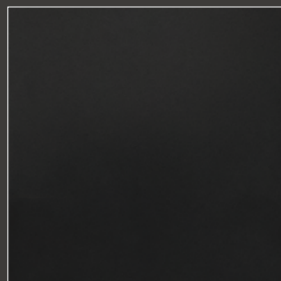

CRAFTSMAN PEWTER

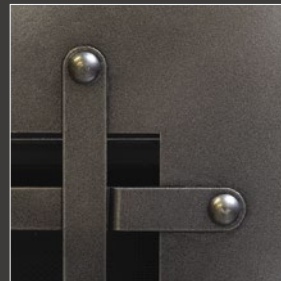

CRAFTSMAN AGED STEEL







DRIFTWOOD 1100DWK  
PLAIN BLACK LINER 1160PBL  
CRAFTSMAN PEWTER 1184ECPW



HeatShift keeps your valued artwork, a TV and construction materials cooler—ideal for wood cladding!

Find out more at [valorfireplaces.com/heatshift](http://valorfireplaces.com/heatshift)



## HEAT SHIFT™

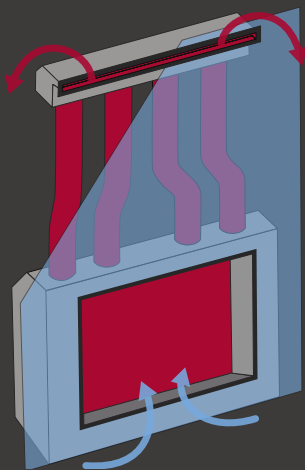

### KEEPS WALL COOLER

Pioneered by Valor, our unique HeatShift System naturally circulates up to 125 cubic feet of convective heat per minute through hidden ducts and back into the room—avoiding surface areas above the fireplace.

### DESIGN FLEXIBILITY

Run standard finishing materials right up to the fireplace surround, including drywall, wood, tile and stone.

Install mantels lower than usual from the fireplace surround.





TRADITIONAL LOGS 1100LSK  
FLUTED BLACK LINER 1125FBL  
CLEAN INSTALL 1130CIK

#### IMPROVES PERFORMANCE

Harnessing convective warmth, up to 60% of fireplace heat rises and flows through HeatShift and back into the room. The remaining heat radiates from the fireplace, keeping you warm.

#### NO ELECTRICITY REQUIRED

Heatshift circulates heat naturally using gravity and Valor product ingenuity—no need for a fan or electricity. No power—no problem.

#### CONSTRUCTION MADE EASY

Unlike many competing products, Valor fully ducts HeatShift for clean, safe air quality. HeatShift is built and designed in North America for North American homes, meeting building code requirements.



Do everything you can do with your Valor 10 remote—and more—with our Valor 10 app.

Child Proof your remote for safety and ease.

Accurately knows the current temperature of your room.

Set the timer to turn the fireplace off up to 9 hours ahead.

Set the temperature for specific times of the day.

Program your fireplace to turn on and off when you want at the temperature you want.



The Remote Battery and Wall Switch kit comes standard with all Valor 10 remotes. The kit lets you control your fireplace and gives you easy access to your fireplace's receiver batteries.



## VALOR 10: REMOTE

VALOR 10 REMOTE CONTROL **NEW**

Standard in the updated H5, Valor's new interactive remote control has up-to-the-moment information on the state of your fireplace, such as temperature, and other customizable settings. To find out more, go to [valorfireplaces.com/remote](http://valorfireplaces.com/remote)





### TAKE COMPLETE CONTROL

Increase or decrease flame height to find the perfect ambiance. Use the color wheel to find the ideal temperature setting.



### PROGRAM ON THE GO

Program days, times and temperature settings to match your lifestyle.

Set a countdown timer so your fireplace shuts off automatically.

### CONTROL FEATURES

If you have a fan, set the speed of the fan from low to high.

### SAVE ON ENERGY COSTS

Save energy while enjoying a changing, realistic flame with ECO mode.



Choose time and the percentage of energy saved is shown in the circle/leaf.

# VALOR 10: APP

### VALOR 10 APP **NEW**

The Valor 10 remote pairs with the Valor 10 App so you can control your fireplace with your smartphone. To find out more, go to [valorfireplaces.com/valor10](http://valorfireplaces.com/valor10)







**BIRCH** 1100BLK  
**BLACK FLUTED** 1125FBL  
**FIXED FRAME** 1130FFK



## ENERGY EFFICIENCY

### EFFICIENCY RATINGS

While the North American fireplace industry is largely self-regulated, at Valor we use recognized Canadian and US government testing methods to determine our energy efficiencies, and ensure our products perform in your home as rated. All our fireplaces are available as natural gas or propane.

### SECONDARY HEAT EXCHANGER

The built-in Secondary Heat Exchanger naturally improves convective heat—removing the need for a fan. Your fire will heat up fast for immediate comfort—and with no need for electricity, you'll save money.

To find out more, visit  
[valorfireplaces.com/efficiency](http://valorfireplaces.com/efficiency)



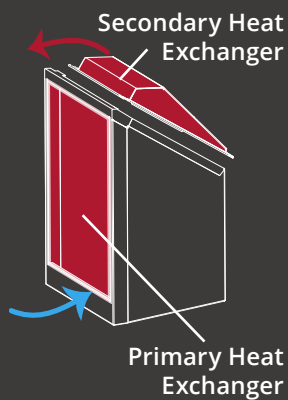

<b>H5 1100MN/MP</b>	
EnerGuide	71%
High	30,000
Low	16,000
Max Output*	22,857

\*EnerGuide ratings and outputs have been determined without a fan/blower, using the CSA P.4.1-15 test method.  
 Certified to ANSI Z21.88/CSA 2.33 Vented Gas Fireplace Heater American National Standard. CGA-2.17-91 Gas Fired Appliances for use at High Altitudes.

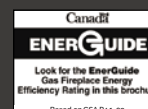



# FRAMING AND VENTING

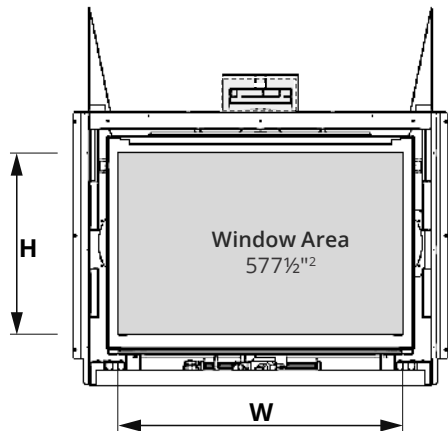

## Window

W	30"
H	19¼"

H	40"
W	38"
D	17½"

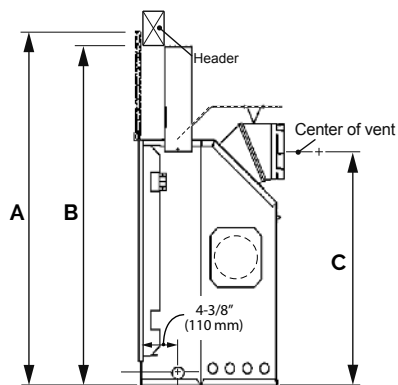
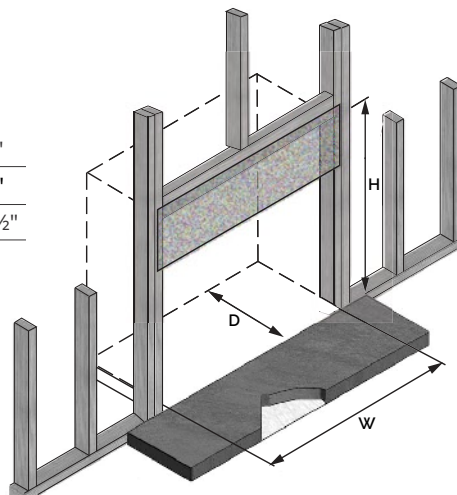

A	41½" min.
B	40"
C	27½"

ALWAYS REFER TO THE  
MANUAL FOR COMPLETE  
INSTALLATION INSTRUCTIONS.  
[valorfireplaces.com/manuals](http://valorfireplaces.com/manuals)

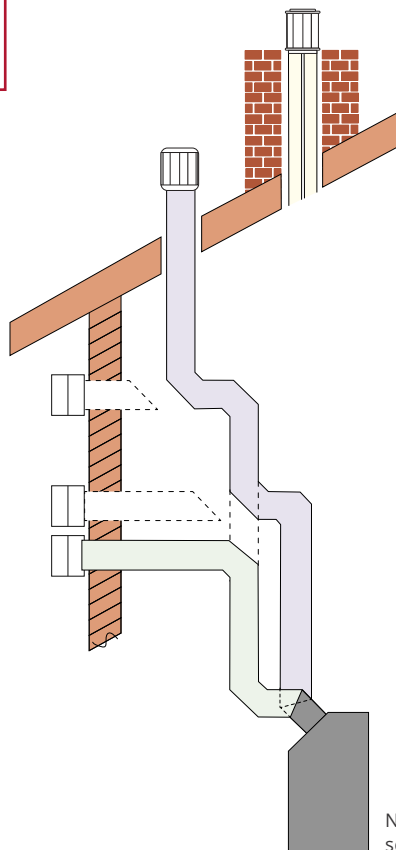

Not to scale

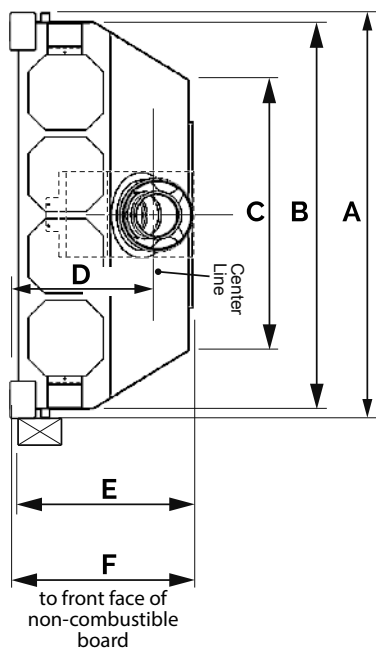

A	38"
B	36½"
C	25¼"
D	13¾"
E	17½"
F	18"

## Venting requirements

- Total length of vent pipe can't exceed 40 feet.
- Maximum of 4 x 90 degrees elbows or equivalent (2 x 45 degrees—90 degrees).



# OPTIONS

## DIRECT VENT ENGINE

Natural Gas	1100MN
Propane	1100MP

## 1 FIRE BEDS

<b>New</b> Birch	1100BLK
<b>New</b> Traditional Logs	1100LSK
<b>New</b> Driftwood	1100DWK

## 2 LINERS

<b>New</b> Plain Black	1160PBL
<b>New</b> LedgeStone	1115LSL
Fluted Black	1125FBL
Reflective Glass	1170RGL
Herringbone	1175HBL
Red Brick	1110VRL

## 3 FRONT

<b>New</b> Clean Install	1130CIK
Fixed Frame , Black	1130FFK
3-sided, Black	3¼" 1135TSB
4-sided, Black	4" 1140FSB2
<b>New</b> Edgemont Craftsman Aged Steel	2¼" 1184ECAS
<b>New</b> Edgemont Craftsman Pewter	2¼" 1184ECPW

## OPTIONAL

Reflective Glass Rear Panel*	1105RGL
Outdoor Conversion Kit	GV60CKO
Remote Blower for Zone Heating	1270RBL
Circulating Fan	1195CFK

\*For Fluted or Plain Black liner only.

## Recommended

### HEATSHIFT

48" Plenum + Finishing Frame	LDK1 + LDK2
14" Plenums + two grilles	LDK3
38" Plenum + Finishing Frame	LDK4 + LDK5
Valance, two plates	LDK7

### **WARNING**

This product can expose you to chemicals including Benzene, which is known to the State of California to cause cancer and birth defects or other reproductive harm.

For more information go to [www.P65Warnings.ca.gov](http://www.P65Warnings.ca.gov)



Note: Natural gas, in its original state, contains Benzene.



H5 DRIFTWOOD 1100DWK  
HERRINGBONE LINER 1175HBL  
4-SIDED BLACK FRONT 1140FSB2



[valorfireplaces.com](http://valorfireplaces.com)

BRH522E APR

Copyright Miles Industries Ltd. 2022  
Designed and manufactured by Miles Industries Ltd.

**Valor**  
Radiant  
Gas Fireplaces