

# Single Monitor Holder

## MH1 Specifications



### Features:

- Compatible with 4k HD and 3D monitors
- 19" to 32" (1.6' - 2.7') screen size monitors, up to 30 lbs (13.6 kg)
- Up to 450° rotation allowing greater flexibility in positioning
- Up to 90° forward or backwards tilt
- Side to side adjustments for precise leveling, up to 90°
- Multiple mounting holes available to balance top/bottom heavy monitors
- Compact size ensures maximum maneuverability
- Sterilizable and non-sterilizable handles available
- Optional back-box available to hold converters and cabling, with spacer plate for counterbalancing

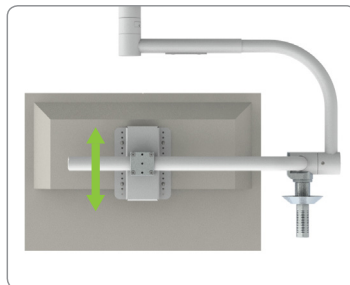
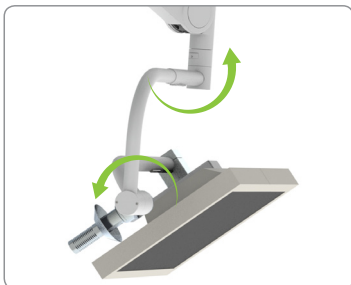
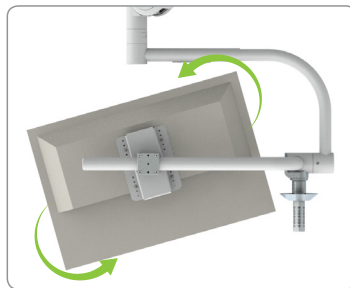

### Specifications:

- Up to 30 lbs (13.6 kg) monitor
- 12 lbs (5.4 kg) yoke weight
- 4 lbs (1.8 kg) back-box weight
- 1.6 lbs (.7 kg) spacer plate
- Standard monitor mounting patterns
  - VESA 100 x 100
  - VESA 100 x 150
- Common monitors
  - FSN, FS-L2402D & FS-2601D
  - Sony, LMD-2451MT & LMD-3251ST
  - LG, 27HJ710S-W

# Single Monitor Holder

## MH1 Dimensions

