

NEMA 3R

PANEL - 'C'

Table with columns: LOAD DESCRIPTION, KVA LOAD, C.B., LIT-SITE LIGHTING, POLES, etc. Includes a summary table for TOTALS and a table for ADDITIONAL FEATURES.

LIGHTING FIXTURE SCHEDULE

Table with columns: TAG, MANUFACTURER & CATALOG NUMBER, VOLTS, LAMPS, VA, MOUNTING, REMARKS. Lists fixtures like LITHONIA LDM6 40K 1S L06 AR 1S MWOLT and GUARDOO QULLWING G13.

ELECTRICAL SYMBOLS

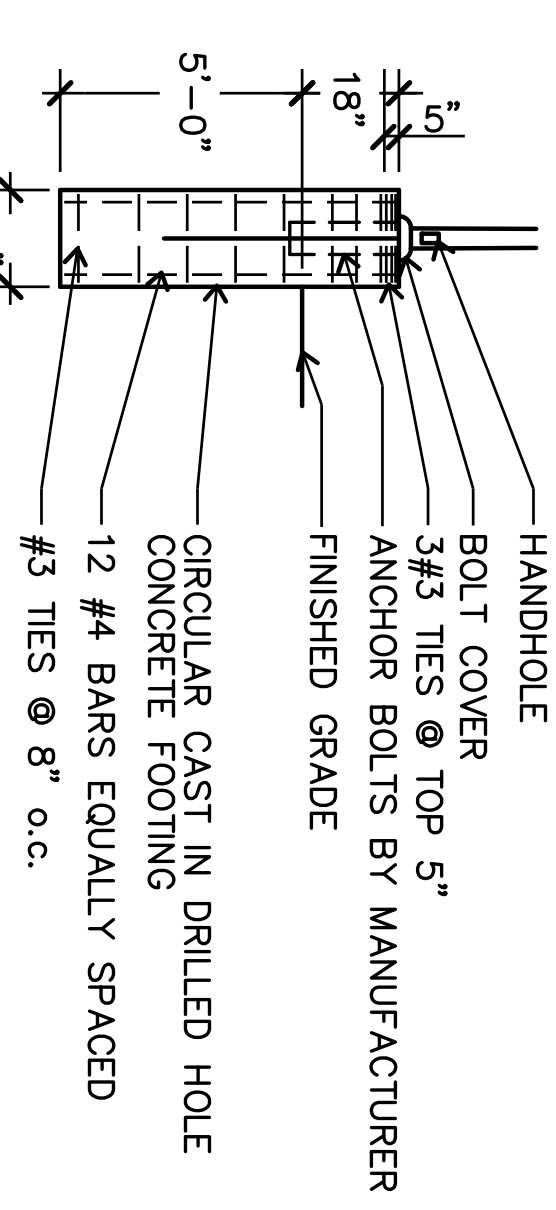
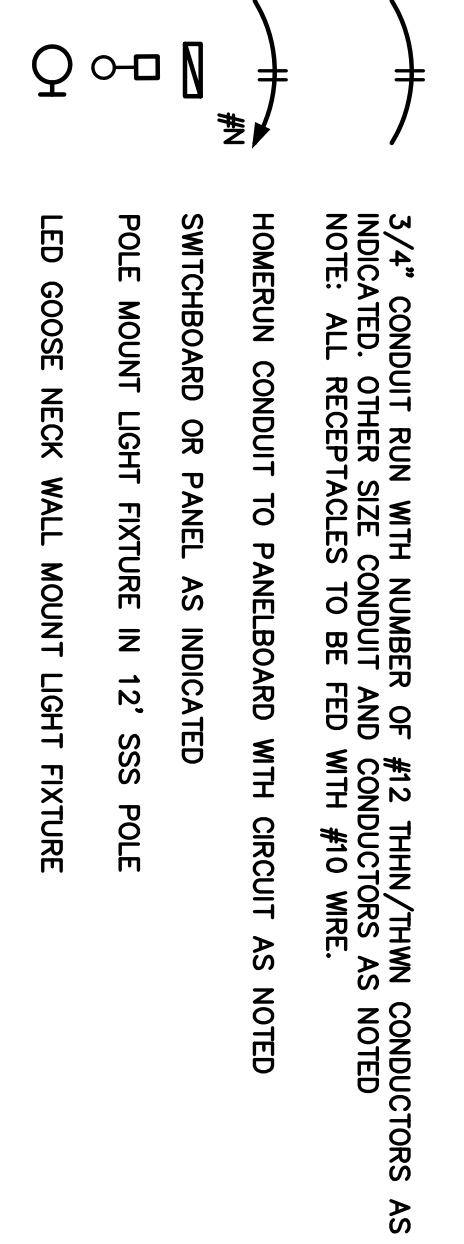

ELECTRICAL GENERAL NOTES

- List of 22 electrical general notes covering topics like receptacles, mounting heights, conduit types, and equipment testing requirements.

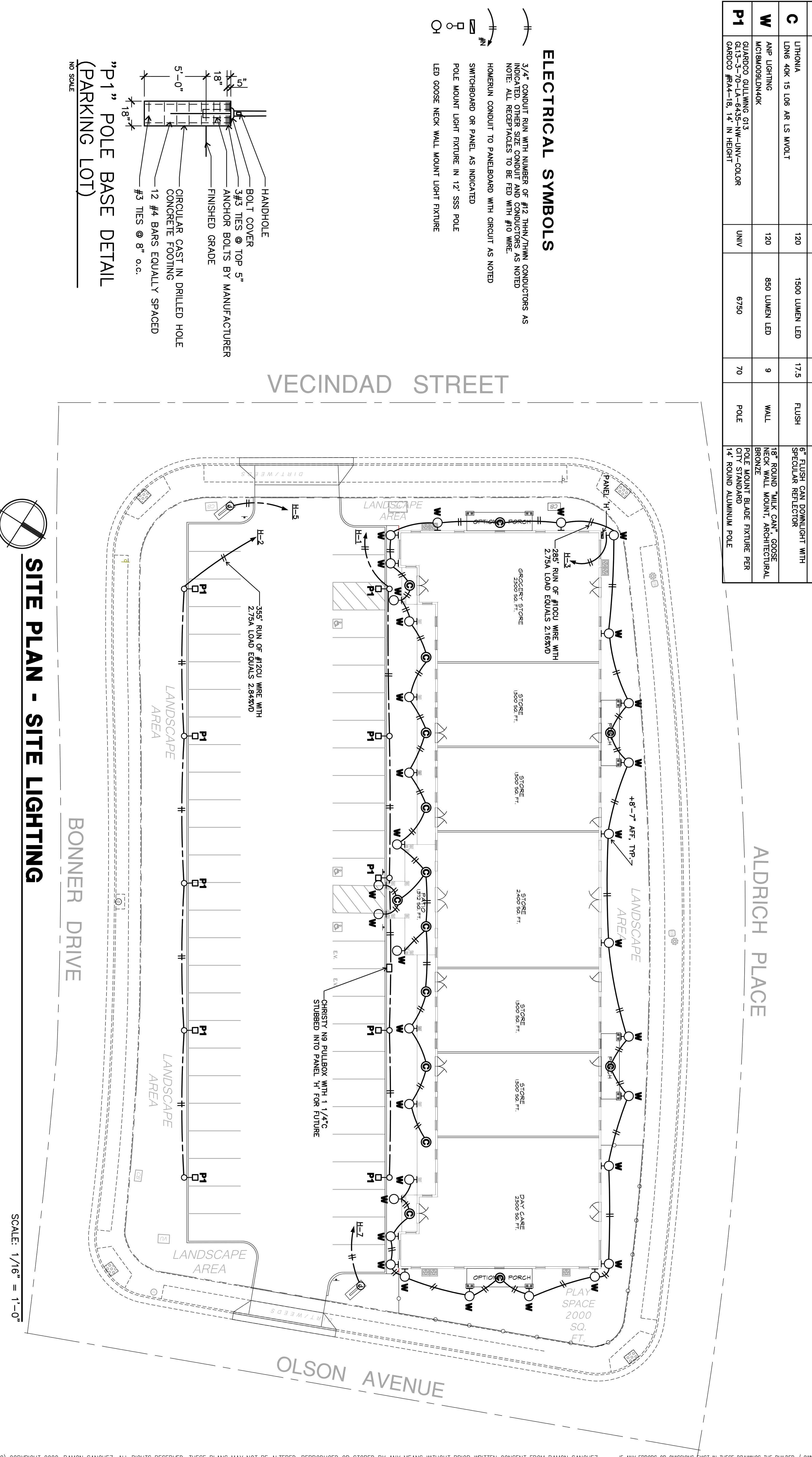

SITE PLAN - SITE LIGHTING

SCALE: 1/16" = 1'-0"

Copyright notice: (C) COPYRIGHT 2022, RAMON SANCHEZ, ALL RIGHTS RESERVED. THESE PLANS MAY NOT BE ALTERED, REPRODUCED OR STORED BY ANY MEANS WITHOUT PRIOR WRITTEN CONSENT FROM RAMON SANCHEZ.

Logo for Ramon Sanchez Drafting & Design, including contact information: 334 Norton Ave, San Jose, CA 95128, Phone: 408-265-5555, Fax: 408-265-5556.

Proposed Shopping Complex for: HI-TECH DEVELOPING INC. 1140 S. VECINDAD ST. MOUNTAIN HOUSE, CA 95391. SAN JOAQUIN COUNTY CALIFORNIA

Revisions table with columns: REVISIONS, BY.

Developer: Hi-Tech Developing Inc. 3308 W. Hubbard Ave, Fresno, CA 93708.

Job No: 22-0715, Date: 03/13/2023, Sheet: E-1.



Gardco Gullwing LED GL13 area luminaires combine LED performance excellence and advanced Gardco LED thermal management technology with the distinct Gullwing style to provide outdoor area lighting that is both energy efficient and aesthetically pleasing.

Project: \_\_\_\_\_  
 Location: \_\_\_\_\_  
 Cat.No: \_\_\_\_\_  
 Type: \_\_\_\_\_  
 Lamps: \_\_\_\_\_ Qty: \_\_\_\_\_  
 Notes: \_\_\_\_\_

Ordering guide

Example: GL13-DIM-4-70LA-6435-NW-120-BRP-LF

Prefix	Controls	Mounting	Optical System <sup>4</sup>	Wattage	LED Color	Voltage	Finish	Options				
<b>GL13</b> 13" Gullwing LED Luminaire Constant Wattage	<b>GL13-DIM</b> 13" Gullwing LED with 0-10V Dimming	<b>--</b> Arm Mount (Standard, for 4" O.D. round pole)	<b>2</b> Type 2	<b>70LA-6435</b> 64 LEDs, 350mA	<b>NW</b> Neutral White 4000K, 70 min. CRI	<b>120</b> <b>208</b> <b>240</b> <b>277</b> <b>347</b> <b>480</b> <b>UNV</b> (120-277V)	<b>BLP</b> Black Paint	<b>LF</b> <sup>2</sup> In-Line/In-Pole Fusing				
			<b>3</b> Type 3	<b>85LA-8035</b> 80 LEDs, 350mA					<b>WP</b> White Paint	<b>PC</b> <sup>1,2,3</sup> Photocontrol and Receptacle (Includes PCR5)		
			<b>4</b> Type 4	<b>105LA-6453</b> 64 LEDs, 530mA							<b>BRP</b> Bronze Paint	<b>PCR7</b> <sup>1,3,4,5</sup> Photocell Receptacle only with 2 dimming and 2 auxiliary connections
<b>GL13-RK</b> 13" Gullwing LED Retrofit Kit		<b>W</b> Wall Mount, Recessed J-Box (must order as separate line item)	<b>5</b> Type 5		<b>CW</b> Cool White 5000K, 70 min. CRI	<b>480</b> <b>UNV</b> (120-277V)	<b>NP</b> Natural Aluminum Paint	<b>IS</b> Internal House side Shield (types 2, 3, 4 only)				
			<b>WS</b> Wall Mount, Surface Conduit (must order as separate line item)						<b>WW</b> Warm White 3000K, 70 min. CRI	<b>HVU</b> (347-480V)	<b>OC</b> Optional Color Specify optional color or RAL ex: OC-LGP or OC-RAL7024	<b>PTF2</b> <sup>6</sup> Pole Top Fitter 2 3/8" - 3" Dia. Tenon
							<b>PTF4</b> <sup>6</sup> Pole Top Fitter 3 1/2" - 4" Dia. Tenon	<b>SPA</b> <sup>7</sup> Square Pole Adapter				

- Not available with Retrofit Kits (**GL13-RK**).
- Voltage must be specified.
- Not available with **480V**.
- Works with 3-pin or 5-pin NEMA photocell/dimming device.
- If ordered with **DIM** dimming will not be connected to NEMA receptacle.
- Not available in 120" mounting configurations.
- Required for mounting to straight square poles.

# GL13 Gullwing LED area luminaire, small

## Site & Area

### Dimensions and EPA

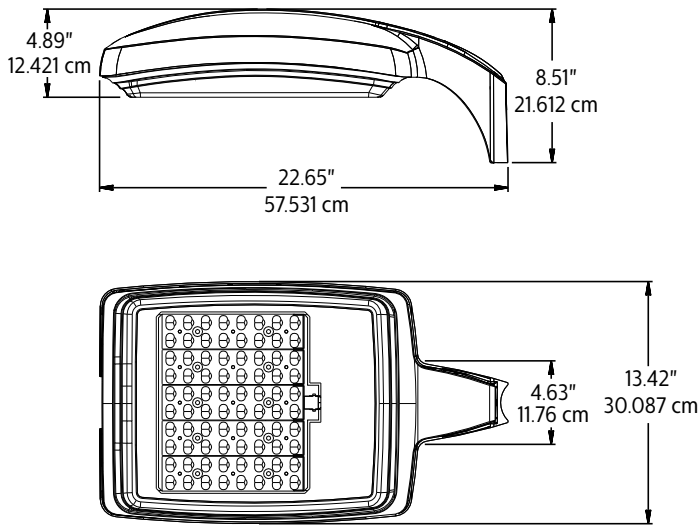

#### EPA Data

1	2	3-4
.8 ft <sup>2</sup>	1.6 ft <sup>2</sup>	2.2 ft <sup>2</sup>
.07 m <sup>2</sup>	.15 m <sup>2</sup>	.20 m <sup>2</sup>

#### Approximate Weight Single Luminaire

33 lbs / 14.969 kg

## Technical Data

Ordering Code	Total LEDs	LED Current (mA)	Average System Watts	Color Temp.	Type 2			Type 3		
					Lumen Output	Efficacy (LPW)	BUG Rating	Lumen Output	Efficacy (LPW)	BUG Rating
70LA-6435	64	350	70	4000K	6652	95	B2-U0-G1	6750	96	B1-U0-G2
85LA-8035	80	350	86	4000K	8064	95	B2-U0-G1	8173	95	B1-U0-G2
105LA-6453	64	530	101	4000K	9870	97	B2-U0-G2	9385	93	B2-U0-G2

Ordering Code	Total LEDs	LED Current (mA)	Average System Watts	Color Temp.	Type 4			Type 5		
					Lumen Output	Efficacy (LPW)	BUG Rating	Lumen Output	Efficacy (LPW)	BUG Rating
70LA-6435	64	350	70	4000K	6731	96	B1-U0-G2	6657	95	B3-U0-G1
85LA-8035	80	350	86	4000K	8027	94	B1-U0-G2	8025	93	B3-U0-G2
105LA-6453	64	530	101	4000K	9388	93	B2-U0-G2	9139	90	B3-U0-G2

Values from photometric tests performed in accordance with IESNA LM-79 and are representative of the configurations shown. Actual performance may vary due to installation and environmental variables, LED and driver tolerances, and field measurement considerations. It is highly recommended to confirm performance with a photometric layout.

NOTE: Some data may be scaled based on tests of similar (but not identical) luminaires. Contact factory for configurations not shown.

# GL13 Gullwing LED area luminaire, small

## Site & Area

### Luminaire Configuration Information

#### GL13

Gardco Gullwing LED standard luminaire providing constant wattage and constant light output when power to the luminaire is energized.

#### GL13-DIM

Gardco Gullwing LED luminaire provided with 0 -10V dimming for connection to a control system provided by Philips or by others.

#### GL13 Drill Template

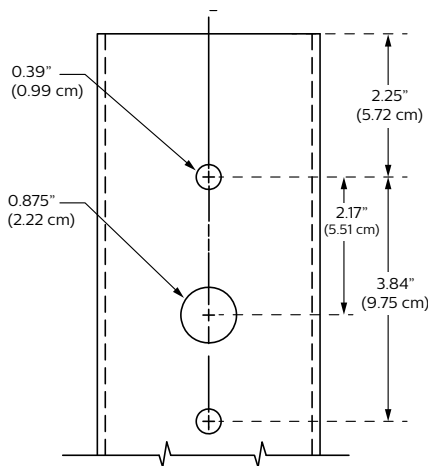

### Specifications

#### General Description

The Gardco Gullwing LED GL13 area luminaire is defined by its high performance, sleek profile and rugged construction. Gullwing LED luminaires combine LED performance excellence and advanced Gardco LED thermal management technology with the distinct Gullwing style to provide outdoor area lighting that is both energy efficient and aesthetically pleasing.

#### Housing

A one-piece die cast aluminum housing mounts directly to a pole or wall without the need for a support arm. The low profile rounded form reduces the effective projected area of the luminaire to only 0.8 ft<sup>2</sup> / 0.07 m<sup>2</sup>.

#### IP Rating

Gullwing LED 13" optics are IP65 rated.

#### Thermal Management

The Gardco Gullwing LED provides extruded aluminum integral thermal radiation fins to provide the excellent thermal management so critical to long LED system life.

#### LED Optical System

LED arrays are set to achieve IES Type II, Type III, Type IV, and Type V, available with internal shields for back light control. Individual LED arrays are replaceable. Luminaires feature high performance Class 1 LED systems.

#### Electrical

Luminaires are equipped with an LED driver that accepts 120V through 277V, or 347V through 480V, 50hz to 60hz, input. Driver output is based on the LED wattage selected. Component-to-component wiring within the luminaire will carry no more than 80% of rated current and is listed by UL. Power factor is not less than 90%. Luminaire consumes 0.0 watts in the off state. Surge protector standard. 10KA per ANSI/IEEE C62.41.2.

#### Finish

Each standard color luminaire receives a fade and abrasion resistant, electrostatically applied, thermally cured, triglycidyl isocyanurate (TGIC) textured polyester powdercoat finish. Standard colors include bronze (BRP), black (BLP), white (WP), and natural aluminum (NP). Consult factory for specs on optional or custom colors.

#### Labels

All luminaires bear UL or CUL (where applicable) Wet Location labels.

#### Limited Warranty

5 year limited warranty. See [signify.com/warranties](http://signify.com/warranties) for complete details and exclusions.

### Predicted lumen depreciation data:

PREDICTED LUMEN DEPRECIATION DATA				
Ambient Temperature °C	Driver mA	Calculated L <sub>70</sub> Hours	L <sub>70</sub> Per TM-21	Lumen Maintenance % @ 60,000 hours
25°C	up to 530 mA	>100,000	>60,000	82%

Predicted performance derived from LED manufacturer's data and engineering design estimates, based on IESNA LM-80 methodology. Actual experience may vary due to field application conditions. L<sub>70</sub> is the predicted time when LED performance depreciates to 70% of initial lumen output. Calculated per IESNA TM21-11. Published L<sub>70</sub> hours limited to 6 times actual LED test hours.

### Buy American Act of 1933 (BAA):

This product is manufactured in one of our US factories and, as of the date of this document, this product was considered a commercially available off-the-shelf (COTS) item meeting the requirements of the BAA. This BAA designation hereunder does not address (i) the applicability of, or availability of a waiver under, the Trade Agreements Act, or (ii) the "Buy America" domestic content requirements imposed on states, localities, and other non-federal entities as a condition of receiving funds administered by the Department of Transportation or other federal agencies. Prior to ordering, please visit [www.signify.com/baa](http://www.signify.com/baa) to view a current list of BAA-compliant products to confirm this product's current compliance.



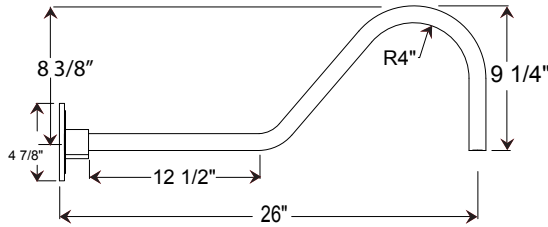

**E6**

26" x 9 1/4"

Weight: 1.5 lbs

**ACCESSORIES**

**CBC**  
Cast Back Plate Cover  
(Spun Aluminum)

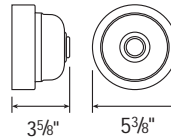

**SC**  
Scroll



**SQ**  
Square Back Plate

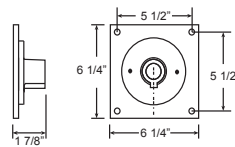

**CAST BACK PLATE MOUNTING DETAIL**

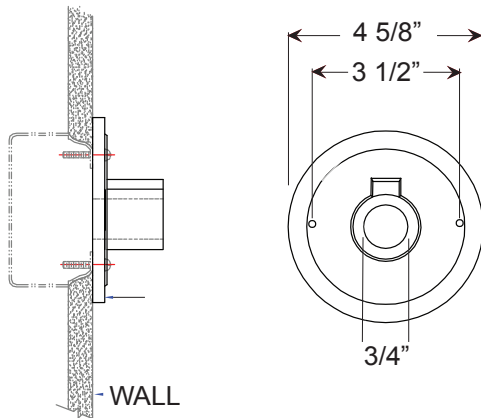

Project: \_\_\_\_\_

Fixture Type: \_\_\_\_\_ Quantity: \_\_\_\_\_

Customer: \_\_\_\_\_



**Specifications**

**General:**  
Due to size or weight, RLM arms may not accommodate all ANP RLM fixtures.

Cast back plate is provided as standard. Fits standard 4/0 junction box.

**Material:**  
Arm is aluminum, Schedule 40, 3/4" ips. All parts are durable 356 cast aluminum. All mounting hardware provided shall be stainless steel or zinc plated steel and may not match finish.

**Fixture Mounting:**  
Arm is threaded to attach to 3/4" fixture hub.

**Electrical:**  
Pull wire provided with fixture.

**Accessories:**  
Optional cast back plate cover (CBC) slides over arm and is secured to arm by a set screw.

Optional scroll (SC) is welded to arm per customer specification.

**Finish:**  
A polyester powder coat high quality finish is electro-statically applied and baked at 430° for exceptional durability and color retention. Products undergo an intensive five-step cleansing and pretreatment process for maximum paint adhesion.

Marine grade finish provides superior salt, humidity and UV protection. This coating withstands up to 3000 hours of continuous salt spray, comes with a 5-year warranty and is available in either a textured or gloss surface.

**Modifications:**  
Consult factory for custom or modified arms.

**FINISHES**

Standard Grade	Marine Grade		Standard Grade	Marine Grade	
40	NA	Raw Unfinished	53	100	Copper Clay
41	101	Black	56	109	Silver
42	102	Forest Green	61	106	Black Verde
43	114	Bright Red	70	118	Painted Chrome
44	107	White	71	105	Painted Copper
45	112	Bright Blue	72	108	Textured Black
46	123	Sunny Yellow	73	125	Matte Black
47	120	Aqua Green	76	121	Textured Architectural Bronze
49	NA	Galvanized	77	127	Textured White
50	111	Navy	78	124	Textured Silver
51	103	Architectural Bronze	10	130	Aspen Green
52	104	Patina Verde	11	131	Cantaloupe
12	133	Lilac	13	132	Putty
Premium Grade	Marine Grade		Premium Grade	Marine Grade	
81	129	Extreme Chrome	64	116	Candy Apple Red
80	117	Textured Desert Stone	65	122	Cobalt Blue
67	119	Butterscotch	82	128	Graystone
66	115	Caramel	69	113	Gunmetal Gray
68	126	Black Silver	83	134	Oil Rubbed Bronze

Consult factory for additional paint charges and availability

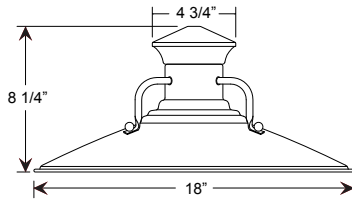

Project: \_\_\_\_\_

Fixture Type: \_\_\_\_\_ Quantity: \_\_\_\_\_

Customer: \_\_\_\_\_

**Specifications**

**Material:**  
RLM shades are constructed of heavy duty spun aluminum. Wall back plate and driver housing are cast aluminum. All fasteners are stainless steel. Inside of shade is reflective white finish for all colors except galvanized paint finish. Screw hardware may not match paint.

**Electrical:**  
Universal voltage 120-277 is standard. 0-10V, TRIAC and ELV dimming to 1% protocols are standard for LED modules. (12w is 120v and TRIAC dimming only)

See page 2 table for LED module and driver specs, voltage and dimming protocols.

**Certifications:**  
Cord mounts are UL Listed for dry locations. Arm mount, stem mount and wall mount are UL Listed for wet locations.



**Finish:**  
A polyester powder coat high quality finish is electro-statically applied and baked at 430° for exceptional durability and color retention. Products undergo an intensive five-step cleansing and pretreatment process for maximum paint adhesion.

Marine grade finish provides superior salt, humidity and UV protection. This coating withstands up to 3000 hours of continuous salt spray, comes with a 5-year warranty and is available in either a textured or glass surface.

**Modifications:**  
Consult factory for custom or modified designs.

**MCFT18 LED**

Weight: 2 lbs

**Catalog Logic**

**MCFT18 - M024LDD W 40K - RTCW - E6 - PC - 41 - UNV**

RLM Style | Light Source & Wattage | Distribution | CCT | Driver Housing | Mounting | Accessories | Finish | Voltage

**Catalog Number**

1 **MCFT18** 2 3 4 5 6 7 8 **UNV**

**1 LIGHT SOURCE & WATTAGES**

<b>M012LDN</b>	(12w, 750 lumen, Cree module) Integral driver, 120V, TRIAC dimming & narrow distribution only.
<b>M009LDD</b>	(9w, 850 lumen, Cree module)
<b>M010LDD</b>	(10w, 1250 lumen, Cree module)
<b>M016LDD</b>	(16w, 2000 lumen, Cree module)
<b>M024LDD</b>	(24w, 3000 lumen, Cree module)

**2 DISTRIBUTION**

<b>W</b>	(T5 Wide Distribution with Dome LED Lens)
<b>N*</b>	(T5 Narrow Distribution with Flat LED Lens)

\*12w is narrow only, select "N".

**3 COLOR TEMPERATURE (CCT)**

<b>27K</b>	(2700K)
<b>30K</b>	(3000K)
<b>35K</b>	(3500K)
<b>40K</b>	(4000K)

**4 DRIVER HOUSINGS\***

<b>NA</b>	(Housing not required for 12w)
<b>Wall Mount Options Choose Arm in Box 5</b>	
<b>RTCW</b>	(Driver Housing for Wall only (E-arms); 6 1/2" OD x 5 5/8" H)
<b>SRTCW</b>	(Smooth Driver Housing for Wall only (E-arms); 6" OD x 2 7/8" H)
<b>RTCNCW</b>	(Driver Housing/No Spun Cover for Wall only (E-arms); 5 7/8" OD x 2 5/8" H)
<b>Cord Mount Options Choose Cord Style in Box 5</b>	
<b>CRD-RTCC</b>	(Driver Housing for Cord only; 6 1/2" OD x 5 5/8" H)
<b>CRD-SRTCC</b>	(Smooth Driver Housing for Cord only; 6" OD x 2 7/8" H)
<b>CRD-RTCNC</b>	(Driver Housing/No Spun Cover for Cord only; 5 7/8" OD x 2 5/8" H)
<b>Cable Mount Options Choose Cord Style in Box 5</b>	
<b>SSC-RTCC</b>	(Driver Housing for SS Cable/Cord only; 6 1/2" OD x 5 5/8" H)
<b>SSC-SRTCC</b>	(Smooth Driver Housing for SS Cable/Cord only; 6" OD x 2 7/8" H)
<b>SSC-RTCNC</b>	(Driver Housing/No Spun Cover for SS Cable/Cord only; 5 7/8" OD x 2 5/8" H)
<b>Stem Mount Options Choose Stem Size in Box 5</b>	
<b>ST-RTCC</b>	(Driver Housing for Stem only; 6 1/2" OD x 5 5/8" H)
<b>ST-SRTCC</b>	(Smooth Driver Housing for Stem only; 6" OD x 2 7/8" H)
<b>ST-RTCNC</b>	(Driver Housing/No Spun Cover for Stem only; 5 7/8" OD x 2 5/8" H)
<b>Emergency Backup Housing Options Choose EMG Driver in Box 7</b>	
<b>CRD-DCEM</b>	(Emergency Ballast Housing for Cord only; 12" OD x 1 1/2" H) Choose Cord Style in Box 5.
<b>ST-DCEM</b>	(Emergency Ballast Housing for Stem only; 12" OD x 1 1/2" H) Choose Stem Size in Box 5.
<b>SSC-DCEM</b>	(Emergency Ballast Housing for SS Cable/Cord only; 12" OD x 1 1/2" H) Choose Cord Style in Box 5.

\*Driver Housing finish will match fixture finish.

**5 MOUNTING SOURCES\***

<b>Arm Mounts</b>	
<b>E3 E4 E6 E8 E9 E10 E11 E12 E15 E18 E24 E25 E36</b>	
<b>Wall Mounts</b>	
<b>WM40 WM54 WM74 WM317</b>	
<b>Post Mounts</b>	
<b>PM10 PM20 PM30 PM40 PM50 PM319</b>	
<b>Cord Mounts Color &amp; Style (See page 4 for color cord style)</b>	
<b>SJT Cord</b>	
<b>BLC</b> (6' Black SJT Cord)	<b>WHC</b> (6' White SJT Cord)
<b>Solid Fabric Colored Cords</b>	
<b>BLSF</b> (6' Black)	<b>ORSF</b> (6' Orange)
<b>GYSF</b> (6' Gray)	<b>LGSF</b> (6' Lime Green)
<b>CHSF</b> (6' Chocolate Brown)	<b>KGSF</b> (6' Kelly Green)
<b>WHSF</b> (6' White)	<b>CBSF</b> (6' Cobalt Blue)
<b>CASF</b> (6' Cardinal)	<b>SBSF</b> (6' Sky Blue)
<b>Patterned Fabric Colored Cords</b>	
<b>BWHPF</b> (6' Black/White Houndstooth)	<b>BIHPF</b> (6' Brown/Ivory Houndstooth)
<b>GYCPF</b> (6' Gray/Citrus Yellow)	<b>MOSPF</b> (6' Magenta/Orange Stripe)
<b>NMTPF</b> (6' Navy Mini Tweed)	
<b>Glossy Fabric Colored Cords</b>	
<b>GMGF</b> (6' Gun Metal)	<b>SSGF</b> (6' Sterling Silver)
<b>CPGF</b> (6' Copper Penny)	<b>BRGF</b> (6' Bronze)
<b>GOGF</b> (6' Gold)	
<b>Stem Mounts</b>	
1/2" (13/16" OD) Rigid Stems	
<b>2ST6 2ST12 2ST18</b>	<b>3ST6 3ST12 3ST18</b>
<b>2ST24 2ST36 2ST48</b>	<b>3ST24 3ST36 3ST48</b>
<b>2ST60 2ST72 2ST96</b>	<b>3ST60 3ST72 3ST96</b>

\*Arm mounts, Wall mounts or Stem finish will match fixture finish.

Project: \_\_\_\_\_

Fixture Type: \_\_\_\_\_ Quantity: \_\_\_\_\_

Customer: \_\_\_\_\_

6 ACCESSORIES*	
<b>*EMG-LED06</b>	(6w, LED Emergency Driver, remote placement, Cree module only, Not applicable for 12w LED) <b>MUST CHOOSE DCCEM CANOPY IN BOX 4.</b>
<b>*EMG-LED10</b>	(10w, LED Emergency Driver, remote placement, Cree module only, Not applicable for 12w LED) <b>MUST CHOOSE DCCEM CANOPY IN BOX 4.</b>
<b>*EMG-LED16</b>	(16w, LED Emergency Driver, remote placement, Cree module only, Not applicable for 12w LED) <b>MUST CHOOSE DCCEM CANOPY IN BOX 4.</b>
<b>*EMG-LED20</b>	(20w, LED Emergency Driver, remote placement, Cree module only, Not applicable for 12w LED) <b>MUST CHOOSE DCCEM CANOPY IN BOX 4.</b>
<b>GR18</b>	(18" Wire Grill)**
<b>PC</b>	(Button Photo Cell) Remote Only
<b>SC</b>	(Scroll for Arms)**
<b>SLC</b>	(Sloped Ceiling Mount Canopy, 20° Max)**
<b>SQ</b>	(Square Back Plate)**
<b>SWL</b>	(Adjustable Locking Swivel)**
<b>TBK</b>	(Turn Buckle Kit)**
<b>*For Emergency lumen output data; see Resources section at <a href="http://www.ANPLighting.com">www.ANPLighting.com</a></b>	
<b>**Accessory finish will match fixture finish.</b>	

7 FINISHES					
*Marine Grade Finish has an additional charge					
Standard Colors	Standard Grade	Marine Grade*	Premium Colors	Premium Grade	Marine Grade*
Aspen Green	10	10M	High Gloss Black	01	01M
Cantaloupe	11	11M	Arctic Silver	14	14M
Lilac	12	12M	Candy Apple Red	64	64M
Putty	13	13M	Cobalt Blue	65	65M
Raw Unfinished	40	NA	Caramel	66	66M
Black	41	41M	Butterscotch	67	67M
Forest Green	42	42M	Black Silver	68	68M
Bright Red	43	43M	Gunmetal Gray	69	69M
White	44	44M	Mayan Gold	79	NA
Bright Blue	45	45M	Textured Desert Stone	80	80M
Sunny Yellow	46	46M	Extreme Chrome	81	81M
Aqua Green	47	47M	Graystone	82	82M
Galvanized	49	NA	Oil Rubbed Bronze	83	83M
Navy	50	50M	Carbon Graphite	96	96M
Architectural Bronze	51	51M			
Patina Verde	52	52M			
Copper Clay	53	53M			
Silver	56	56M			
Black Verde	61	61M			
Painted Chrome	70	70M			
Painted Copper	71	71M			
Textured Black	72	72M			
Matte Black	73	73M			
Textured Architectural	76	76M			
Textured White	77	77M			
Textured Silver	78	78M			

Consult Factory for additional paint charges and availability.

8 VOLTAGE	
<b>UNV</b>	(120-277)

LED MODULE SPECIFICATIONS				
LED	CCT	Typical Luminous Flux	System Wattage	Typical Efficacy
9W	2700K	850	11W	97
	3000K	850	11W	97
	3500K	850	11W	97
10W	4000K	850	11W	97
	2700K	1250	12W	125
	3000K	1250	12W	125
12W	3500K	1250	12W	125
	4000K	1250	12W	125
	2700K	750	12W	65
16W	3000K	750	12W	65
	3500K	750	12W	65
	4000K	750	12W	65
24W	2700K	2000	19W	125
	3000K	2000	19W	125
	3500K	2000	19W	125
24W	4000K	2000	19W	125
	2700K	3000	29W	125
	3000K	3000	29W	125
24W	3500K	3000	29W	125
	4000K	3000	29W	125

MODULE SPECIFICATION:
• Efficacy 65-125 lumens per watt
• Life: L70 50,000 hours
• Color temp: 2700K, 3000K, 3500K and 4000K
• CRI: >90

MODULE LISTINGS
• Fully compliant with the RoHS Directive
• Certifications: CE/UL

MODULE DRIVER SPECIFICATION:
• Input Voltage: 120-277 Volts; 50/60Hz
• Dimmable down to 1%
• 0-10V, TRIAC and ELV dimming protocols are standard. (12w is 120v and TRIAC dimming only)
• Output Current: Constant Current; 440mA to 940mA (model dependent)
• Driver Efficiency > 80%; Power Factor > 0.9
• Integral Surge Protection in conformance to ANSI C62.41 Category A.

WARRANTY
See <a href="http://www.ANPLighting.com">www.ANPLighting.com</a> for complete fixture warranty.
LED warranty information
• 5 year limited warranty*
*Limited Warranty: A typical year is defined as 4380 hours of operation

Project: \_\_\_\_\_

Fixture Type: \_\_\_\_\_ Quantity: \_\_\_\_\_









Customer: \_\_\_\_\_

**ARM MOUNTS** | Dimensions are Projection x Height | CB included with all arms | Arm will match fixture finish







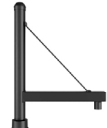

 E3   35" x 11 7/8"	 E4   29" x 14"	 E6   29" x 9 1/4"	 E8   32 1/4" x 12 1/2"
 E9   28" x 43 5/8"	 E10   55 1/4" x 18"	 E11   38 1/4" x 17 1/4"	 E12   40 3/8" x 2"
 E15   16 3/8" x 10 1/2"	 E18   30 3/4" x 21 3/8"	 E24   13" x 2"	 E25   23" x 5 1/4"
 E36   23 1/4" x 8"			

Driver Housings	
	RTCW (6 1/2" OD x 5 5/8" H) Wall Only (E-arms)
	RTCNCW (5 7/8" OD x 2 5/8" H) Wall Only (E-arms)
	SRTCW (6" OD x 2 7/8" H) Wall Only (E-arms)
	ST-RTCC (6 1/2" OD x 5 5/8" H) Stem Only
	CRD-RTCC (6 1/2" OD x 5 5/8" H) Cord Only
	SSC-RTCC (6 1/2" OD x 5 5/8" H) Cable Only
	ST-RTCNC (5 7/8" OD x 2 5/8" H) Stem Only
	CRD-RTCNC (5 7/8" OD x 2 5/8" H) Cord Only
	SSC-RTCNC (5 7/8" OD x 2 5/8" H) Cable Only
	ST-SRTCC (6" OD x 2 7/8" H) Stem Only
	CRD-SRTCC (6" OD x 2 7/8" H) Cord Only
	SSC-SRTCC (6" OD x 2 7/8" H) Cable Only
	ST-DCCEM (12" OD x 1 1/2" H) Stem Only
	CRD-DCCEM (12" OD x 1 1/2" H) Cord Only
	SSC-DCCEM (12" OD x 1 1/2" H) Cable Only

**WALL MOUNTS** | Dimensions are Projection x Height | **POST MOUNTS** | Dimensions are Projection x Height

 WM40   13 7/8" x 14 3/4"	 WM54   23 3/8" x 18"	 PM10   14 1/2" x 25"	 PM20   30 1/8" x 25"
 WM74   22" x 26 1/2"	 WM317   15" x 12 3/4"	 PM30   21 5/8" x 28 7/8"	 PM40   43 3/8" x 28 7/8"
		 PM50   27" x 38"	 PM319   16 5/8" x 27 1/2"

**ACCESSORIES**

 EMG-LED	 GR18	 PC	 SLC
 SQ	 SWL	 TBK	 SC



Project: \_\_\_\_\_

Fixture Type: \_\_\_\_\_ Quantity: \_\_\_\_\_

Customer: \_\_\_\_\_

All fabric Color Cords are three conductor, 1/4" diameter

**Solid Fabric Colored Cords**



**BLSF** | Black



**GYSF** | Gray



**CHSF** | Chocolate Brown



**WHSF** | White



**CASF** | Cardinal



**ORSF** | Orange



**LGSF** | Lime Green



**KGSF** | Kelly Green



**CBSF** | Cobalt Blue



**SBSF** | Sky Blue

**Patterned Fabric Colored Cords**



**BWHPF** | Black/White Houndstooth



**BIHPF** | Houndstooth



**GYCPF** | Gray/Citrus Yellow



**MOSPF** | Magenta/Orange Stripe



**NMTPF** | Navy Mini Tweed

**Glossy Fabric Colored Cords**



**GMGF** | Gun Metal



**SSGF** | Sterling Silver



**CPGF** | Copper Penny



**BRGF** | Bronze



**GOGF** | Gold