

NEC 75" InfinityBoard® 2.1 LCD 75" All-in-One Collaboration Solution

Datasheet

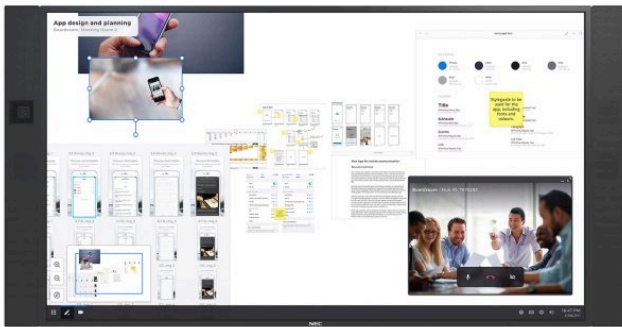

*incl. Huddly IQ

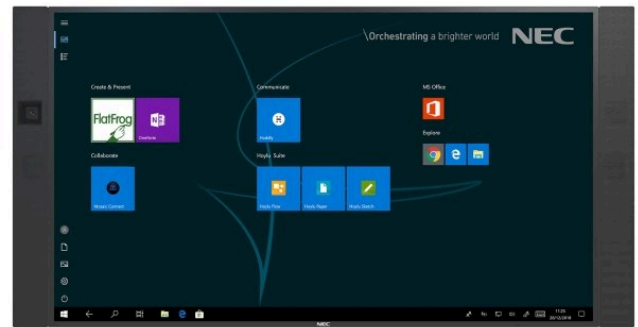

*incl. Huddly IQ

Your meeting room companion

NEC's InfinityBoard is a powerful and scalable workspace that is designed to fit any meeting scenario. Brainstorming, reviewing, video conferencing or collaborating, whatever the objectives of your meeting, the InfinityBoard is the modular solution that's here to help create your ideal meeting space.

Designed to 'just work', the InfinityBoard supports any scenario – from multiple presenters to large groups with remote participation. In virtual workspaces, collaboration lifts to a new level and interactive meetings boost group work efficiency.

The InfinityBoard comes with an ultra-high definition InGlass™ touch display and two passive pens. Its design also includes an ultra-wide angle Huddly IQ video conferencing camera and high-end conference speakers. The combination of an open platform slot-in PC and Windows 10 Professional allows to tailor the solution according to the customers' requirements without restriction to any particular software, video conferencing app or infrastructure. Uniting all this, the InfinityBoard facilitates smart collaboration in modern meeting spaces.

Benefits

Natural writing experience – it's like working on paper! Whether using finger or pen, the InGlass™ touch technology provides seamless interactive touch performance including Windows Ink and palm rejection.

Simplify smart video conferencing – enjoy perfect audio and video quality with an integrated ultra-wide-angle camera with auto-framing and high-end conference speakers.

Future-proof PC option and reduced footprint – the integrated Slot-In PC using the integrated OPS option slot future-proofs your investment whilst reducing the product footprint and installation efforts.

Custom fit to your application needs – Windows 10 Professional makes this a flexible solution that supports your staff by offering a familiar user-interface.

Product Information

Product Name	NEC 75" InfinityBoard® 2.1			
Product Group	LCD 75" All-in-One Collaboration Solution			
Order Code	40001303			

Display

Panel Technology	IPS with Edge LED backlights			
Active Screen Area (W x H) [mm]	1,649.7 x 927.9			
Screen Size [inch/cm]	75 / 189			
Brightness [cd/m²]	500, 350 (shipment setting)			
Contrast Ratio (typ.)	1200:1			
Viewing Angle [°]	178 / 178 (at contrast ratio > 10:1)			
Colour Depth [bn]	1.073 (10bit)			
Response Time (typ.) [ms]	8 (grey-to-grey)			
Haze Level [%]	Pro (28)			
Supported Orientation	Face Up ¹ ; Landscape; Portrait			

Touch

Touch Technology	InGlass™			
Number of Touches	Real multi-touch up to 20 touches			
Response Time [ms]	≤ 15			
Touch Method	Finger; Gloves; Stylus (≥ 2 mm)			
Supported Operating System	Native Multi-Touch: Windows 7, Windows 8, Windows 10, Linux, Android; Default Mouse: Windows XP, Windows Vista, Mac OS X			
Data Interface	USB-HID			
Accuracy [mm]	< 1			
Windows Ink	yes			
Palm Rejection	no			

Glass

Type	Premium toughened glass, anti-glare coating			
Thickness [mm]	3			
Light Transmission [%]	88 (+/- 1 %)			

Resolution

Native Resolution	3840 x 2160			
Supported Resolutions	1920 x 1080;	1920 x 2160;	3840 x 2160;	4096 x 2160

Synchronisation Rate

Horizontal Frequency [kHz]	31.5 - 91.1			
Vertical Frequency [Hz]	24 - 85			

Connectivity

Input Video Digital	2 x DisplayPort (with HDCP); 3 x HDMI (with HDCP)			
Input Audio Analogue	1 x 3,5 mm jack			
Input Audio Digital	2 x DisplayPort; 3 x HDMI			
Input Control	1 x LAN 100Mbit; 1 x Remote Control (3.5 mm jack); 1 x RS232			

Input Data	1 x microSD (MediaPlayer); 1 x USB 2.0 (Downstream); 1 x USB 2.0 (MediaPlayer); 1 x USB Type-B (Upstream); 2 x USB 2.0 (Compute Module, 1 x 5V/2A powered)
Output Video Digital	1 x DisplayPort (loop through: DisplayPort, OPS slot-in PC)
Output Audio Analogue	1 x 3,5 mm jack
Output Control	1 x LAN 100Mbit
USB Hub	4x USB 3.0

Open Modular Intelligence

OPS Slot	Slot Technology: Open pluggable specification (NEC / Intel OPS standard)
OPS Max. Current / Power Consumption [A / W]	4.7 / 75
Compute Module Slot	Slot Technology: Compute Module 3 Slot (NEC proprietary standard)

Sensors

Human Sensor	Optional, external, 4-5m range, triggered actions programmable
Temperature Sensor	Integrated, 3 sensors, triggered actions programmable

Electrical

Power Consumption [W]	167 shipping
Power Savings Mode [W]	< 0.5; < 2 (Networked Standby)
Power Management	VESA DPMS

Environmental Conditions

Operating Temperature [°C]	+0 to +35
Operating Humidity [%]	20 to 80

Mechanical

Dimensions (W x H x D) [mm]	Without stand: 1,944.6 x 1,003 x 86
Weight [kg]	80.3
Bezel Width [mm]	18.8 (left and right); 18.8 (top and bottom)
VESA Mounting [mm]	4 holes; 400 x 400 (FDMI); 600 x 400 (FDMI); M8
Ingress Protection	IP5x (front); IP2x (back)
Packaging Dimensions (W x H x D) [mm]	Box 1: 1,830 x 280 x 1,190; Box 2: 1,400 x 250 x 250
Packaging Weight [kg]	Box 1: 84.5; Box 2: 9.6

MediaPlayer

Supported File Storage / File System	MicroSDHC / FAT16, FAT32; USB 2.0 / FAT16, FAT32
Supported Image Formats	JPG (baseline, progressive, RGB, CMYK); max. resolution 5000 x 5000; PNG (interlace, alpha channel); max. resolution 4000 x 4000
Supported Video Formats	MP4 / MOV / FLV (video H.264, audio MP3, AAC); max. resolution 1080p at 30 Hz, 1080i at 60 Hz; MPG (video mpeg1/2, audio mpeg audio layer2/3, AAC-LC); MP @ ML, MP @ HL; WMV (video H.264, wmv advanced L3, wmv simple / main, audio mp3 wmv std); max. resolution 1080p at 30 Hz, 1080i at 60 Hz
Supported Audio Formats	MP3 (MP3); max. bit-rate 320 kBit/s; WAV (LPCM); max. 48 kHz sampling

Video Conference Camera

Camera Model	Huddly IQ (no microphone)
Viewing Angle [°]	150 diagonal / 120 horizontal / 90 vertical

Resolution	Output HD 1080p 30fps
Aspect Ratio	16:9
Optical Capabilities	Digital Pan / Tilt / Zoom with 3x lossless digital zoom
Driver	Plug&Play, driverless install
Connectivity	SuperSpeed USB
Software Specification	3D noise reduction; 3DNR sensor-model-based visual noise reduction; Flicker elimination; Genius Framing; High-quality video scaling and dewarping; Huddly InSights analytics API; Optical aberration correction; Robust automatic white balance; Spatio-temporal noise filtering

Conference Speakers

Input (max.) [W]	40
Rated Speaker Impedance [Ω]	8
Frequency Response Rate [Hz-kHz]	70 to 15
Sound Pressure Level [dB]	82.1 (2.83 V)

OPS Slot-In PC

CPU	Intel® Core i7; 8M Cache 4x3 GHz
Graphics	Intel® HD Graphics 630
SSD	SATA SSD (Msata) 2 Gb/s (MLC); 128 GB
RAM	8 GB (DDR4), dual channel mode
Operating System	Microsoft Windows 10 Professional
Interfaces Frontside	1 x Micro Sim Card; 1 x USB 2.0; 1 x USB 3.1 Gen1 Type C; 2 x Antenna for WiFi; 2 x DisplayPort 1.2 ++; 2 x USB 3.0; RJ45 10 / 100 / 1000 Mbps
Interfaces Backside	Internal HDMI 1.4 or DisplayPort 1.2; Internal OPS interface to OPS slot-in PC (JAE 80-pin connector)
Wi-Fi	Intel Dual Band Wireless-AC 8260 802.11ac, dual band; Wi-Fi and bluetooth 4.2 adapter
Security	TPM (Trusted Platform Module)
EDID/DDC Support	Internal OPS Interface DisplayPort up to 4096 x 2160 at 60 Hz

Pre-installed Applications

Free Software Included	Mosaic Connect
Software	FlatFrog Whiteboard; Hoylu (single user license); Windows 10 Professional

Available Options

Accessories	Trolley (PD02MHM, PD02MHA, PD03MHA); Wall mount (BalanceBox 400 HEAVY, PDW T XL-2)
Compute Module Slot	NEC Compute Module; Raspberry Pi Compute Module 1 and 3

Green Features

Energy Efficiency	Carbon savings meter; ECOMode; Local dimming
-------------------	--

Additional Features

Special Characteristics	12-bit Look Up table; AMX NetLinx Support; ASCII Control Commands; Auto ID assignment; Auto tiling function; Automated Email Alert; CEC Support; Cisco Webex Kit compatible; Crestron Connected Support; DICOM Simulation; Display Browser Control; Emergency Notification; HDMI with UHD at 60 Hz; HDR Gamma Support (HLG, PQ); KeyGuide; MediaPlayer with Browser Control; NaViSet Administrator 2 - free download; OmniColor Control; OSD rotation for portrait mode; PIN as theft protection; PJLink Support; Powered USB-Port; Scheduler; Slim LED Indicator; SNMP Support; TileMatrix (10 x 10); User readable log function
-------------------------	---

Safety and Ergonomics	CE; EAC; EMC Class B; FCC; RCM; REACH; RoHS; UL/C-UL
Shipping Content	1x 10 cm USB Cable; 2 x Stylus; 2x 300 cm USB Cable; Cable Clamps; CD-ROM (User Guides/ Manuals); Display; DisplayPort Cable; Huddly Camera; OPS Slot-in PC; Power Cable; Remote Control; Side-mounted Speakers
Warranty	3 years warranty incl. backlight; optional 4. + 5. year warranty extension ²
Operating Hours	24/7

¹ adjusted usage conditions for face up/down installations, please refer to operational guidelines or contact our support

² please refer to terms and conditions of warranty extensions

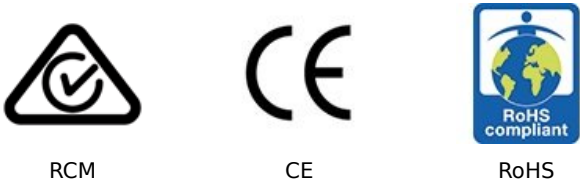

This document is © 2024 Sharp NEC Display Solutions Europe GmbH.

All rights reserved in favour of their respective owners. All hardware and software names are brand names and/or registered trademarks of the respective manufacturers. All specifications are subject to change without notice. Errors and omissions are excepted. 09.04.2024