

DELL Technologies

DELL 27 MONITOR | E2720HS

Upgrade your essentials.



AMPLIFY YOUR WORK

Enhance your daily workflow with a 27" FHD monitor with height adjustability and integrated speakers.



DELL DISPLAY MANAGER

Superior productivity and manageability featuring quick access keys, preset layouts, multi-monitor configuration and remote management for IT managers.



AWARDED THE ENERGY STAR® MOST EFFICIENT MARK IN 2020¹

Delivering cutting-edge energy efficiency that represents the best in energy savings and environmental protection.¹



TRUSTED RELIABILITY

As the world's #1 monitor company*, we take pride in our unyielding commitment to quality and the utmost satisfaction of our customers.

Reliable, eco-conscious monitors at a great value



AMPLIFY YOUR WORK

More productive by design: Make your monitor your own with the height adjustable stand and incoming notifications from integrated speakers.

Enhance your workspace: A thinner profile than the previous generation and improved cable management create a smaller footprint, lending itself to a clean, uncluttered desk.

Plug in: Quickly connect legacy or non-legacy PCs with VGA and HDMI ports.

Adapts to your needs: Make your workspace your own with VESA-compatible mounts and stands.



ECO-CONSCIOUS INSIDE AND OUT

Energy efficient: This monitor meets the latest regulatory and environmental standards such as ENERGY STAR® and TCO, and is registered EPEAT® Gold.² Dell E2720HS has also been awarded the ENERGY STAR® Most Efficient Mark in 2020!

Reduce energy: Save energy with PowerNap³, a feature that dims or puts the monitor to sleep when not in use.

Eco-conscious packaging: To reduce our manufacturing impact on the environment, this monitor is shipped in Styrofoam-free packaging and the paper based material is made of at least 75% recycled cardboard.



DELL DISPLAY MANAGER

Productive at every level: Dell Display Manager's (DDM) Easy Arrange feature lets you quickly tile and view your applications side by side across one or more connected screens for multi-tasking efficiency.

Seamless transitions: The Auto-Restore feature remembers where you left off, so applications will go back to where you left them — even after you've unplugged.

The key to convenience: Shortcut keys can save you time, allowing quick access to commonly used controls that let you work faster.

More ways to manage: Asset management reports allow IT managers to quickly capture and track monitor information as well as configure multiple displays at once through a single setup.

THANK YOU FOR MAKING DELL MONITORS #1 WORLDWIDE*

Uncompromised testing: Rigorous development processes help ensure consistent, reliable performance in busy office environments.

Minimize downtime: Your monitor comes with a 3-year Advanced Exchange Service⁴ so that if a replacement becomes necessary, it will be shipped to you the next business day during your 3-year Limited Hardware Warranty.⁵

Get a higher level of support: Upgrade to 24 X 7, in-region technical phone support from qualified engineers with Dell ProSupport option.⁶

Features & Technical Specifications

Monitor	Dell 27 Monitor – E2720HS
Diagonal Viewing Size	68.59 cm (27.0 inches)
Horizontal	597.89 mm (23.54 inches)
Vertical	336.31 mm (13.24 inches)
Maximum Preset Resolution	1920 x 1080 at 60 Hz
Aspect Ratio	16:9
Pixel Pitch	0.311 mm x 0.311 mm
Pixel Per Inch (PPI)	81
Brightness	300 cd/m ² (typical)
Color Support	Color gamut (typical): 83% (CIE1976) 72% (CIE1931) Color depth: 16.7 Million
Contrast Ratio	1000:1 (typical)
Viewing Angle	178°/178°
Response Time	8 ms typical (Normal) 5 ms typical (Fast) (gray to gray)
Panel Type	IPS (In-Plane Switching)
Display Screen Coating	Anti-Glare
Backlight Technology	LED
ComfortView with Flicker-free screen	Yes
Dell Display Manager Compatibility	Yes
Remote Asset Management	Yes, via Dell Command Monitor
GSA/TAA	Yes
Integrated Speakers	Yes - Integrated speakers with 2 x 1w
Optional Soundbar	Dell Stereo Soundbar – AC511M
Connectivity	
Connectors	1 x VGA 1 x HDMI 1.4
HDCP Support	HDMI HDCP 1.2
Design Features	
Adjustability	Height adjustable (100 mm) and Tilt (-5° to 21°)
Security	Security lock slot (cable lock sold separately)
Flat Panel Mount Interface	VESA (100 mm)
Power	
AC input voltage/frequency/current	100 VAC to 240 VAC / 50 Hz or 60 Hz ± 3 Hz / 1.0 A (typical)
Power Consumption (Operational)	23W (Typ). 30W (Max). 16.40W (ENERGY STAR®)
Power Consumption Stand by/Sleep	Less than 0.3W
Dimensions (with stand)	
Height (Fully Extended & Compressed ~ Standard)	508.30 mm (20.01 inches) & 408.30 mm (16.07 inches)
Width	621.50 mm (24.46 inches)
Depth	187.0 mm (7.36 inches)
Weight	
Weight (panel only - for VESA mount/ no cables)	4.54 kg (10.01 lbs)
Weight (monitor and cables with stand)	6.11 kg (13.47 lbs)
Weight (with packaging)	8.40 kg (18.52 lbs)
Standard Service Plan	3-Years Advanced Exchange Service ⁴ and Limited Hardware Warranty ⁵
Optional Service Plan	Dell ProSupport ⁶
Environmental Compliance	Awarded the ENERGY STAR® Most Efficient Mark in 2020 ¹ , EPEAT® Gold registered where applicable ² , TCO Certified Display

What's in the box?

Components

- Monitor with stand

Cables

- Power cable
- 1 x HDMI Cable
- 1 x VGA Cable (EMEA and Japan only)
- 1 x VESA screw cover

Documentation

- Quick Setup Guide
- Safety and Regulatory Information

Recommended Accessories

DELL 27 MONITOR | E2720HS

Easily adjust the panel to your preferred viewing position.



Back view -
Cable management slot

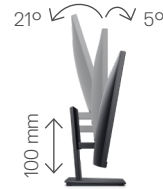

Tilt and height adjustable

Connectivity

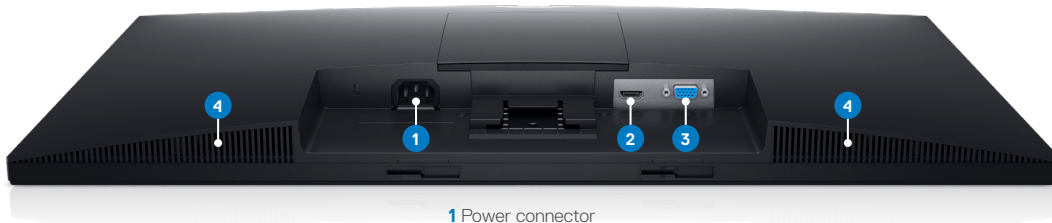

- 1 Power connector
- 2 HDMI Port
- 3 VGA Port
- 4 Speakers

RECOMMENDED ACCESSORIES



DELL SINGLE MONITOR ARM | MSA20

For greater viewing flexibility and a smaller footprint, choose the Dell Single Monitor Arm. Set up is virtually tool-free and its advanced cable management features offer a neat and clutter-free desk.



DELL STEREO SOUNDBAR | AC511M

The Dell Stereo Soundbar AC511M offers clear stereo sound, allowing you to enjoy audio on your favorite games, music and movies, without sacrificing desk space.



DELL PRO WIRELESS KEYBOARD AND MOUSE | KM5221W**

Enhance your everyday productivity with a quiet full size keyboard and mouse combo that offers programmable shortcuts and 36 months*** battery life.

* Dell monitors are #1 Worldwide for 7 consecutive years (2013, Q2 to 2020, Q3)! Source: IDC Worldwide Quarterly PC Monitor Tracker, Q3, 2020.

** Product availability varies by country. Contact your Dell representative or visit Dell.com to learn more.

*** Based on Dell analysis of battery life usage model calculations, Nov 2020. Results vary depending on use, operating conditions and other factors.

1 This monitor is ENERGY STAR® certified and awarded the ENERGY STAR® Most Efficient Mark in 2020. For more information, visit <https://www.energystar.gov/most-efficient/me-certified-computer-monitors>

2 EPEAT registered where applicable. EPEAT registration varies by country. See www.epeat.net for registration status by country.

3 PowerNap is available via Dell Display Manager. Download the software at www.dell.com/ddm

4 Advanced Exchange Service: Dell will send you a replacement monitor the next business day in most cases, if deemed necessary after phone/online diagnosis. Shipping times may vary by location and for monitors 55" and above. Fee charged for failure to return defective unit. See dell.com/servicecontracts/global for details.

5 For a copy of the Limited Hardware Warranty, write to Dell USA LP, Attention: Warranties One Dell Way, Round Rock, TX 78682 or see dell.com/warranty for details.

6 Availability varies by region, please visit dell.com/support for details.

Dell.com/monitors Product availability varies by country. Please contact your Dell representative for more information.

© 2020 Dell All rights reserved.

Trademarks or trade names may be used in this document to refer to either the entities claiming the marks and names of their products. Dell disclaims proprietary interest in the marks and names of others. Reproduction in any manner whatsoever without express written permission from Dell is strictly forbidden.

