

MS90556 Connector Type Datasheet

LM Series • MIL-DTL-22992 Type Power Connectors



LM06 C 44-12 4 N

- 1 **BASIC PART NUMBER**
LM06 Cable mount plug
 Pin contacts (equipment end)
 Includes backshell, cable grip, cover
- 2 **MATERIAL & FINISH**
C Aluminum, olive drab cadmium
 (Conductive for AC applications)
N Aluminum, anodized finish
 (Non-conductive for DC applications)
- 3 **SHELL SIZE & INSERT PATTERN**
 See Insert Arrangement Drawings, p. P-8
- 4 **MASTER KEYWAY POSITION**
 Power requirements determine master key/keyway
 (See Master Key/Keyway Position table, p. P-7)
- 5 **ALTERNATE ROTATION**
N NORMAL or W, X, Y, Z, see p. P-7 for availability

LM06 Cross Reference & Compatibility

Compatible Brands	Equivalent	Mates
MIL-DTL-22992 Class L	MS90556	MS90555, MS90557
Cooper Interconnect	GCL56	GCL55, GCL57
Robert Technologies	RT90556	RT90555, RT90557
UEC	UEC90556	UEC90555, UEC90557

Note: See part builder (p. P-6) for complete information.

Plug Dimensions

Shell Size Arrangement	D	C Thread Class 2B	L	T	M	U	CC Cable Clearance	
							Min	Max
28-12	2.439 (62.0)	2.000-.1428P-.2857L	8.188 (208.0)	7.188 (182.6)	2.312 (58.7)	2.000 (50.8)	.922 (23.4)	1.047 (26.6)
28-13				7.188 (182.6)			1.005 (25.5)	1.130 (28.7)
32-04	2.689 (68.3)	2.250-.1428P-.2857L	8.188 (208.0)	7.188 (182.6)	2.562 (65.1)	2.000 (50.8)	.844 (21.4)	.969 (24.6)
32-05, 32-12				7.188 (182.6)			1.005 (25.5)	1.130 (28.7)
32-13	3.667 (93.1)	3.000-.1428P-.2857L	10.172 (258.4)	8.688 (220.7)	3.531 (89.7)	2.500 (63.5)	1.217 (30.9)	1.342 (34.1)
44-02				10.688 (271.5)			1.187 (30.1)	1.312 (33.3)
44-03	3.667 (93.1)	3.000-.1428P-.2857L	10.172 (258.4)	9.688 (246.1)	3.531 (89.7)	2.500 (63.5)	1.313 (33.4)	1.438 (36.5)
44-12				10.688 (271.5)			1.391 (35.3)	1.516 (38.5)
44-13	3.667 (93.1)	3.000-.1428P-.2857L	10.172 (258.4)	12.688 (322.3)	3.531 (89.7)	2.500 (63.5)	1.547 (39.2)	1.672 (42.5)
44-51				11.688 (296.9)			1.609 (40.9)	1.734 (44.0)
44-52	3.667 (93.1)	3.000-.1428P-.2857L	10.172 (258.4)	11.188 (284.2)	3.531 (89.7)	2.500 (63.5)	1.435 (36.4)	1.525 (38.7)
44-56				7.188 (182.6)			1.065 (27.1)	1.135 (28.8)
52-12	4.167 (105.8)	3.500-.1428P-.2857L	11.109 (282.2)	17.188 (436.6)	4.016 (102.0)	3.250 (82.6)	2.183 (55.4)	2.328 (59.1)
52-13				18.188 (462.0)			2.308 (58.6)	2.453 (62.3)

Dimensions are in inches (mm).

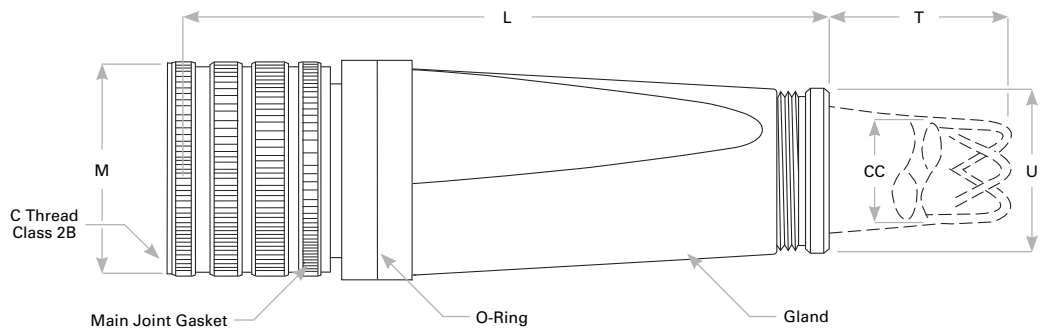
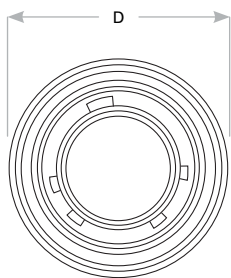

Rev. 1806