

## Berkeley B-6Z Water Pump - CW, Splined Shaft Part No. 302565

Berkeley standard open centrifugal water pump with direct motor mount. Mechanical shaft seal.  
 • Clockwise Rotation • Inlet 6 inch • Outlet 8 inch • 9 inch Impeller

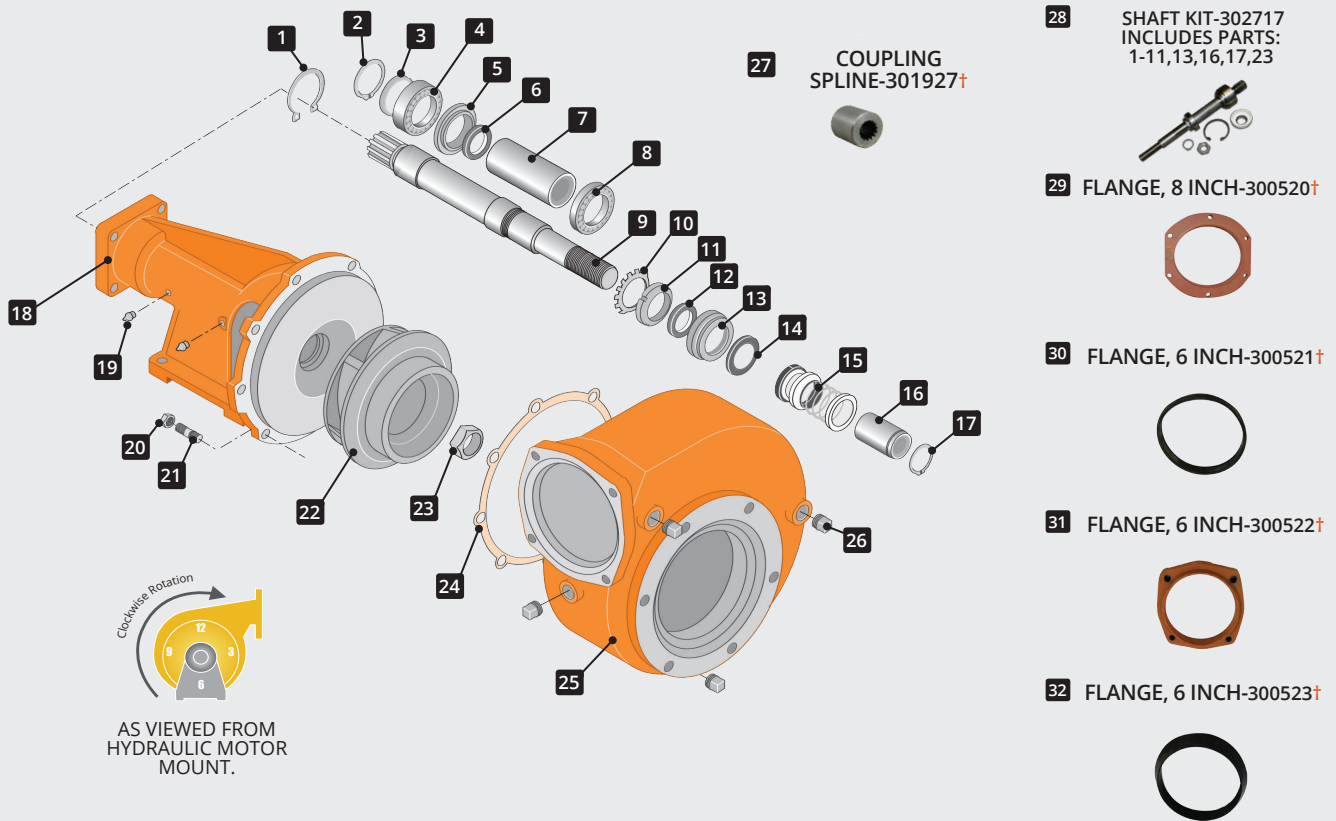

| ITEM | PART NO. | DESCRIPTION                                  | QTY | ITEM | PART NO. | DESCRIPTION                  | QTY |
|------|----------|--|-----|------|----------|------------------------------|-----|
|      | 302565   | Berkeley, B-6Z Water Pump-CW (Splined Shaft) | 1   | 16   | 303952   | Sleeve, Shaft*               | 1   |
| 1    | 302483   | Ring, Retaining*                             | 1   | 17   | 302484   | Ring, External, Retaining*   | 1   |
| 2    | 302482   | Ring, External, Retaining*                   | 1   | 18   | 302004   | Bracket                      | 1   |
| 3    | 302009   | Thrust Washer*                               | 1   | 19   | 300519   | Grease Fitting, 1/4 inch     | 2   |
| 4    | 302450   | Ball Bearing*                                | 1   | 20   | 350025   | Nut, 3/8 inch                | 8   |
| 5    | 302453   | Cap, Outer Bearing*                          | 1   | 21   | 302298   | Stud, 3/8-16 X 1 3/8 inch    | 8   |
| 6    | 302446   | Seal, Oil*                                   | 1   | 22   | 300388   | Impeller, CW                 | 1   |
| 7    | 302448   | Sleeve, Spacer*                              | 1   | 23   | 302480   | Nut, Impeller*               | 1   |
| 8    | 300384   | Ball Bearing*                                | 1   | 24   | 300385   | Gasket, Case                 | 1   |
| 9    | 303190   | Shaft*                                       | 1   | 25   | 300392   | Volute Case                  | 1   |
| 10   | 300379   | Bearing Lock Washer*                         | 1   | 26   | 350852   | Pipe Plug, 1/2 inch          | 4   |
| 11   | 300378   | Bearing Lock Nut*                            | 1   | 27   | 301927   | Spline Coupling, 1 1/4 inch† | 1   |
| 12   | 302447   | Seal, Oil                                    | 1   | 28   | 303614   | Shaft Kit                    | 1   |
| 13   | 302451   | Cap Drip, Bearing*                           | 1   | 29   | 300521   | Gasket, 8 inch†              | 1   |
| 14   | 300558   | Slinger, Water                               | 1   | 30   | 300520   | Flange, 8 inch†              | 1   |
| 15   | 302452   | Seal, Mechanical                             | 1   | 31   | 300522   | Flange, 6 inch†              | 1   |
|      |          |  |     | 32   | 300523   | Gasket, 6 inch†              | 1   |

\* These parts are included in the shaft kit. The shaft is not sold separately and is only sold as a shaft kit.

\*\* Gasket and seals required for pump rebuild assembly.

† Replacement parts only. Parts sold separately and not included with the water pump.

If illustration does not match your configuration please call product support at 505-345-2661 or 1-800-345-8889.