

Memory Module Specifications

KSM24RS4/16MEI

16GB 1Rx4 2G x 72-Bit PC4-2400

CL17 Registered w/Parity 288-Pin DIMM

DESCRIPTION

Kingston's KSM24RS4/16MEI is a 2G x 72-bit (16GB) DDR4-2400 CL17 SDRAM (Synchronous DRAM) registered w/ parity, 1Rx4, ECC, memory module, based on eighteen 2G x 4-bit FBGA components. The SPD is programmed to JEDEC standard latency DDR4-2400 timing of 17-17-17 at 1.2V. Each 288-pin DIMM uses gold contact fingers. The electrical and mechanical specifications are as follows:

FEATURES

- Power Supply: VDD = 1.2V
- VDDQ = 1.2V
- VPP = 2.5V
- VDDSPD = 2.25V to 2.75V
- Functionality and operations comply with the DDR4 SDRAM datasheet
- 16 internal banks
- Bank Grouping is applied, and CAS to CAS latency (tCCD_L, tCCD_S) for the banks in the same or different bank group accesses are available
- Data transfer rates: PC4-2400, PC4-2133, PC4-1866, PC4-1600
- Bi-Directional Differential Data Strobe
- 8 bit pre-fetch
- Burst Length (BL) switch on-the-fly BL8 or BC4(Burst Chop)
- Supports ECC error correction and detection
- On-Die Termination (ODT)
- Temperature sensor with integrated SPD
- This product is in compliance with the RoHS directive.
- Per DRAM Addressability is supported
- Internal Vref DQ level generation is available
- Write CRC is supported at all speed grades
- CA parity (Command/Address Parity) mode is supported

SPECIFICATIONS

CL(IDD)	17 cycles
Row Cycle Time (tRCmin)	46.16ns(min.)
Refresh to Active/Refresh Command Time (tRFCmin)	350ns(min.)
Row Active Time (tRASmin)	32ns(min.)
Maximum Operating Power	*
UL Rating	94 V - 0
Operating Temperature	0° C to +85° C
Storage Temperature	-55° C to +100° C

*See IDD Specifications (page 2)

Module Assembly

DRAM: MICRON (E-DIE)

RCD: IDT

Continued >>

IDD Specifications

Symbol	2400	Units
I _{DD0}	774	mA
I _{PP0}	54	mA
I _{DD1}	990	mA
I _{DD2N}	612	mA
I _{DD2NT}	900	mA
I _{DD2P}	450	mA
I _{DD2Q}	540	mA
I _{DD3N}	774	mA
I _{PP3N}	54	mA
I _{DD3P}	576	mA
I _{DD4R}	2160	mA
I _{DD4W}	1944	mA
I _{DD5R}	1044	mA
I _{PP5R}	90	mA
I _{DD6N}	612	mA
I _{DD6E}	828	mA
I _{DD6R}	378	mA
I _{DD6A}	154.8	mA
I _{DD6A}	378	mA
I _{DD6A}	558	mA
I _{PP6X}	90	mA
I _{DD7}	3330	mA
I _{PP7}	306	mA
I _{DD8}	450	mA

MODULE DIMENSIONS

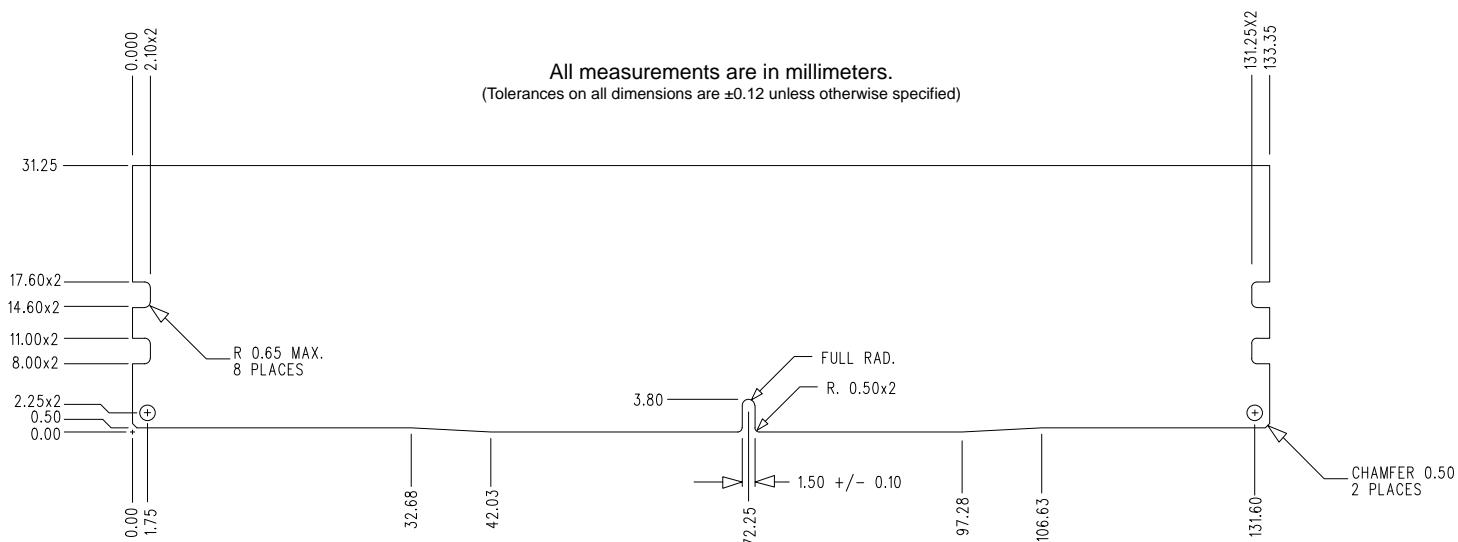
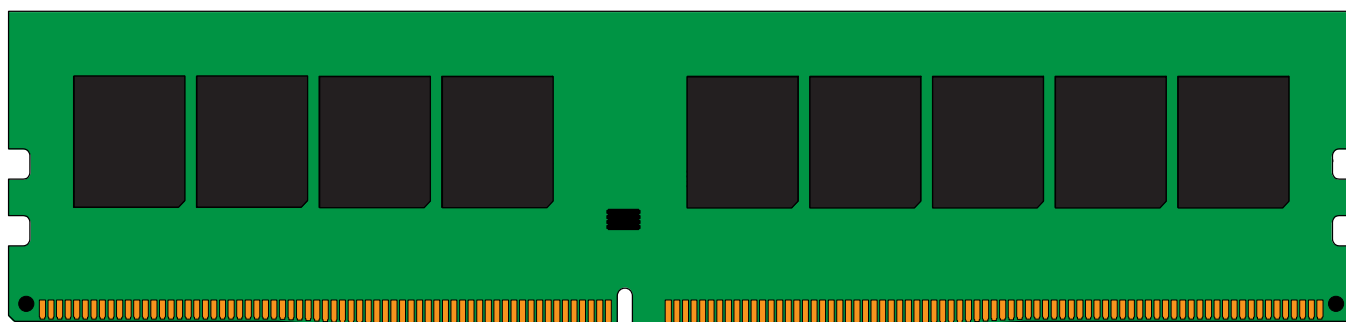
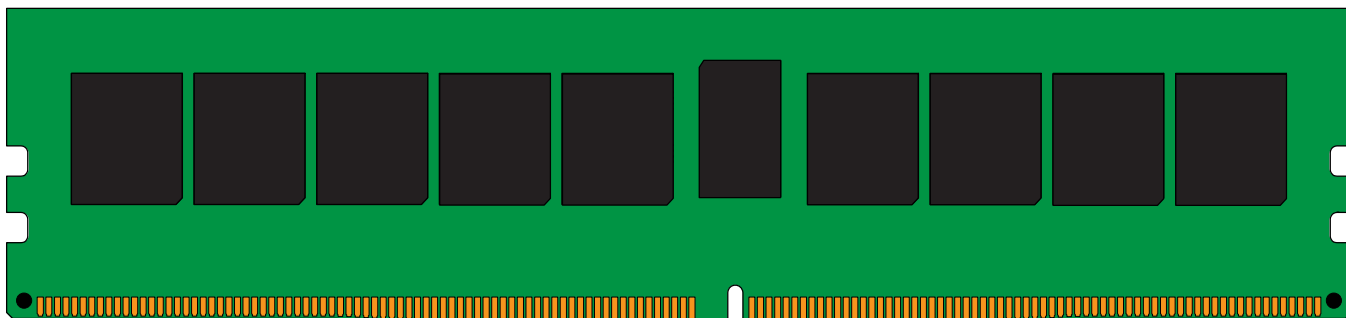

The product images shown are for illustration purposes only and may not be an exact representation of the product.
Kingston reserves the right to change any information at anytime without notice.