

# Machines and Tools

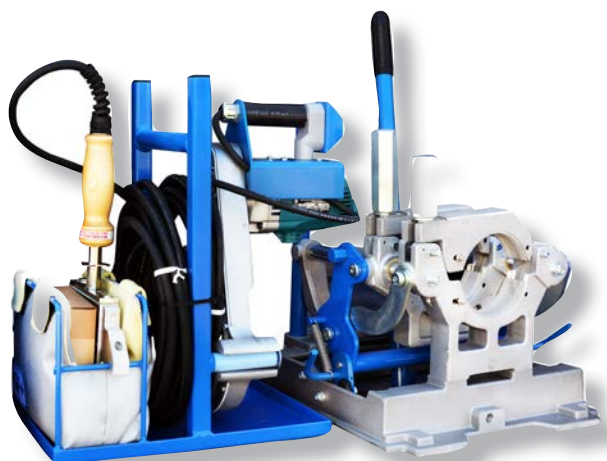

**Disclaimer**

Information in the catalog

GF Central Plastics is as diligent as possible in compiling and updating the information in its catalog. However, GF Central Plastics does not guarantee the correctness and completeness of the information provided in its catalog. Equally, GF Central Plastics does not guarantee that this information is up to date. Drawings dimensions and weights, unless otherwise noted by tolerances, should be considered for reference only and may not reflect the exact physical measurements of the parts. For questions concerning our products, their specifications and their utilization please contact your local Regional Sales Manager or Customer Service Representative of GF Central Plastics. For comments concerning the product catalog, please email [gfccentralmarketing@georgfischer.com](mailto:gfccentralmarketing@georgfischer.com).

# Machines & Tools: General Equipment Information

GF Central Plastics has been a manufacturer of polyethylene fusion equipment since the early days of plastic product development and we continue to manufacture a line of quality fusion equipment.

**CONNECTRA FUSION TECHNOLOGY** – In 2007, GF Central Plastics acquired Connectra Fusion Technologies to expand product offerings in order to support the installation of larger diameter pipe. The 28 series machines are designed for 2" IPS to 8" DIPS and the 414 series machines are designed for 4" IPS to 14" IPS. Larger diameter machines go up to 42" IPS. All machines are tough, reliable and self-contained.

**BS4 BUTT FUSION MACHINE** – capable of butt fusing ½" IPS thru 4" IPS pipe and fittings. This compact machine is manufactured using structural aluminum castings for stability, yet is still light weight - ONLY 34 POUNDS. Extra wide grooved pipe clamps and liners help to assure alignment on coiled and out-of-round pipe. The precision ground guide bars are in the center line of pipe to maintain equal load balance and proper alignment. Clamp knobs are stainless steel with thrust bearings. A pressure control knob allows operator to lock position during cooling time for better joint integrity.

**BS4 ELECTRIC TRIMMER** - with adjustable trimming stops. The chain driven 110 or 220 volt BS4 Electric Trimmer utilizes a 1/2 hp, 620 watt, 5.63 amp motor. The main spindle turns on sealed ball bearings for longer life. Trimmer blades are made of hardened stainless steel for longer wear, better edge and rust free operation.

**MANUAL TRIMMER** – is typically used in conjunction with the Central Gas Fired Heating Tool and allows quality fusion in remote areas. The manual trimmer can be used in lieu of electric trimmer.

## **BUTT, SOCKET AND SADDLE HEATING TOOLS**

- Versatile heating tools capable of Socket, Saddle or Butt Fusion
- Interchangeable Heater Faces – Heating tools are interchangeable with most conventional heater faces currently in the field.
- Central Quality – GF Central Plastics' heater face coating is designed to provide durability and long wear.
- Portable – Lightweight for easy handling.
- Recessed Thermometer – Easy to read dial thermometer recessed in the handle.
- Gas Fired Tools – Economical tools for quick line repairs. No generator is required – simply heat desired temperature with a conventional gas torch.

## Fusion Machines

- **14M Butt Fusion Machine**  
Accommodates pipe sizes ranging from ¾" IPS through 4" DIPS
- **BS4 Butt Fusion Machine**  
Accommodates pipe sizes ranging from ½" IPS through 4" IPS
- **28CQ Butt Fusion Machine**  
Accommodates pipe sizes ranging from 2" IPS through 8" DIPS
- **28HP Butt Fusion Machine**  
Accommodates pipe sizes ranging from 2" IPS through 8" DIPS
- **28EP Butt Fusion Machine**  
Accommodates pipe sizes ranging from 2" IPS through 8" DIPS
- **414CQ Butt Fusion Machine**  
Accommodates pipe sizes ranging from 4" IPS through 14" IPS
- **414HP Butt Fusion Machine**  
Accommodates pipe sizes ranging from 4" IPS through 14" IPS
- **414EP Butt Fusion Machine**  
Accommodates pipe sizes ranging from 4" IPS through 14" IPS
- **414SC Butt Fusion Machine**  
Accommodates pipe sizes ranging from 4" IPS through 14" IPS
- **414HD Butt Fusion Machine**  
Accommodates pipe sizes ranging from 4" IPS through 14" IPS
- **620SC Butt Fusion Machine**  
Accommodates pipe sizes ranging from 6" IPS through 20" IPS
- **824EP Butt Fusion Machine**  
Accommodates pipe sizes ranging from 8" IPS through 24" IPS
- **1442EP Butt Fusion Machine**  
Accommodates pipe sizes ranging from 14" IPS through 42" IPS
- **Outrider 1500 Sidewall Fusion Machine**  
Accommodates pipe sizes ranging from ½" IPS through 4" IPS
- **Outrider 3000 Sidewall Fusion Machine**  
Accommodates pipe sizes ranging from 4" IPS through 8" DIPS

## Fusion Equipment Accessories

- Butt Fusion Heater Faces
- Socket Heater Faces
- Tapping Tee Faces
- High-Volume Multi-Saddle Faces
- Branch Saddle Faces
- BS4 Butt Fusion Machine Liner Kits
- Special Liner Kits
- Socket Fusion Depth Gauges
- Socket Fusion Cold Rings
- Socket Fusion Fitting Holders
- Socket Fusion Chamfer Tools
- Squeeze-Off Tools
- Refurbished Heater Plates

# Electrofusion: Equipment Information

Whether the installer of an electrofusion fitting is in a controlled environment or in one of many rigorous field applications, GF Central Plastics recommends the proper use of approved installation equipment in order to ensure the successful installation of the fitting. Electrofusion installation equipment typically falls into one of three general categories:

1. **Pipe preparation equipment** which includes various pieces of equipment used to prepare the pipe surface before the fusion process is initiated. Examples of this type of equipment include tools that are designed to remove calculated amounts of surface material from the pipe as well as re-rounding tools which are necessary at times to ensure that the pipe surface is not outside the published out-of-round pipe tolerances in order for the fusion process to take place.

2. **Pipe restraint devices** include various types of equipment (i.e clamps and straps) designed to fit specific GF Central Plastics fittings for the purpose of holding the fitting in place for the duration of the fusion process and then continuing to immobilize the fitting being installed until the cooling cycle is complete.

3. **Electrofusion Processors** which are specially designed computer-controlled equipment that subject the fitting being installed to a regulated amount of voltage for a designated amount of time.

## Manufacturers Note

Permanent field installation of electrofusion fittings should be done only by operators who have been properly trained and qualified. Please refer to the GF Central Plastics' Electrofusion Installation Manual for proper installation techniques. Should you have any questions or need installation training please contact:

**GF Central Plastics at (800) 654-3872**

or

**Your Local GF Central Plastics Representative**

# Electrofusion Processors: MSA 340

Introducing the MSA 340 – the next generation of electrofusion processors from GF Central Plastics. Engineering at its best. High-end components and custom configuration support your work flow perfectly.

## DURABILITY

- Made of high quality components
- Prevention of electrical damage
- Water resistant design to IP54 standards

## SIMPLICITY

- Intuitive user interface
- Clear and explicit error messages
- USB interface for fusion record downloading and firmware updates

## CUSTOMIZATION

- New software is able to decipher ASTM barcodes and fusion data can be saved into .PDF or .CSV formats
- 3 operating modes: Auto-ID, Barcode and Manual
- Selectable menu language
- Customized traceability options to fit your work flow
  - Guardian™ Auto-lock rental function

## Features

- Enclosure: 13.5" x 12.5" x 16.8"
- Weight: 52 lbs
- Input Cable: 12'
- Output Cable: 25'
- Input Voltage: 115 V and 230 V (+/- 20%)
- Input Frequency: 50-70 Hz
- Input Waveform: AC (sine, square or quasi-sine)
- Operating Temperature Range: -10°F - 120°F
- Internal Temperature Range: -10°F - 180°F
- Fusion Modes: Barcode, manual and GF Central Plastics (dedicated)
- Capacity of Internal Memory: 1000 fusions
- Barcode Reader Port: Dedicated inputs, DIN 5 connector



# Electrofusion Processors: BOSS III Processor

## Features

- Enclosure: 9.125" × 15.5" × 7.5"
- Weight: 48 lbs
- Output cable length: 25'
- Max continuous output current: 25 amps AC
- Output voltage: 8 VAC to 40 VAC
- Operating temperature range: 0°F to 120°F
- Operating modes: Barcode, CPID, manual barcode and manual
- Fusing capacity: 8 GF Central 2" couplers on full charge
- Maximum coupling size: 2"
- Charge time: 1 hour per battery
- Fusion information storage: 4000 fusions
- Download port: Serial
- Serial port specifications: 9600 baud, 8 data bits, 1 stop bit, no parity
- Environmental protection: IP54 splash-proof case open, water-proof with case lid closed and locked
- Calibration interval: 1 year
- Warranty: 1 year



# Table of Contents

## Machines and Tools

Processors	2
Butt Fusion Equipment	7
BS4	10
14M	13
28CQ	16
28HP	18
28EP	20
414CQ	22
414HP	24
414EP	26
414SC	28
414HD	30
620SC	32
824EP	35
1442EP	37
Sidewall Fusion Tools	39
Socket Fusion Equipment	48
Electrofusion Tools	57
Scrapers and Peelers	61
Clamps	64
Re-rounding Tools	68
Squeeze Tools	69
Index	76





**ELECTROFUSION PROCESSORS: MSA 340 Processor**

- Approval: ISO 12176-2, ISO 12176-3, ISO 12176-4, EN 60335-1 (Safety), EN 61000-6-2 (EMC), EN 610006-4 (EMC)
  - \*CSA Only
  - Extension Cord Information: Cord Length - 25' Wire Gauge - #10/3 (6 mm2)
  - Extension Cord Information: Cord Length - 50' Wire Gauge - #8/3 (10 mm2)
- Please call for pricing and availability.



<...>	Description	Voltage	GFCP Part No.	GF Part No.	weight (lb)
	Processor with Case, Scanner Kit, Barcode, Manual and CP Modes	230V	<b>10014336</b>	<b>360 029 070</b>	57.012
	Processor with Case, Scanner Kit, Barcode, Manual and CP Modes	115V	<b>10014376</b>	<b>360 029 067</b>	57.012
*	Processor with Case, Scanner Kit, Barcode, Manual and CP Modes	115V	<b>10014335</b>	<b>360 029 069</b>	57.012

## ELECTROFUSION PROCESSORS: Boss III Battery Processor

Please call for pricing and availability.



Description	GFCP Part No.	GF Part No.	weight (lb)
Boss III with 25' Barcode Cable and Lead Acid Batteries	10012034	360 021 134	47.366
Boss III Charger for Lead Acid Battery Pack	10013000	360 020 512	0.002
Boss III Barcode Scanner with GPS	10012846	360 020 511	0.470
Boss III Lead Acid Battery Pack	10013001	360 022 117	0.002

**ELECTROFUSION PROCESSORS: Leads and Tips**

Please call for pricing and availability.

Description	Size	GFCP Part No.	GF Part No.	weight (lb)
CP Easy Fuse, MSA340, Boss III Connector Tip Set, Thread on Type, 2 Tips per Set	4.7MM Solid Pin and 4.7MM Resistor Pin	<b>10002790</b>	<b>360 000 719</b>	0.002
Pin Adapter Set	4.7/4.0MM	<b>10001005</b>	<b>360 003 020</b>	0.000
Pin Adapter Set	4.7/3.0MM	<b>10001004</b>	<b>360 003 019</b>	0.000
GF Barcode Scanner Kit (scanner, cable assembly, pouch). Will fit MSA, Easy Fuse and Emie Barcode Units.	Kit	<b>10012994</b>	<b>360 004 496</b>	1.213
Connector Tip, Replacement, Nonresistor, 90°, Threaded for Easy Fuse, MSA and Boss III	4.7MM	<b>10012312</b>	<b>360 021 003</b>	0.022
Connector Tip, Replacement, Resistor, 90°, Threaded for Easy Fuse, MSA and Boss III	4.7MM	<b>10012313</b>	<b>360 021 004</b>	0.022
Scanner Cable Assembly	Assembly	<b>10012849</b>	<b>360 022 702</b>	0.243

**ELECTROFUSION PROCESSORS: Accessories**

Please call for pricing and availability.

Description	Voltage	GFCP Part No.	GF Part No.	weight (lb)
Power Adaptor 30A 125V Locking Female 15A 125V Straight Blade Male	125V	<b>9000643</b>	<b>360 002 996</b>	1.239
Fuse Kit for 115V Easy Fuse Processor, F1=63MA Fast, F2=100MA Delay (5x20MM), F3=40A Delay (13/32" x 2-1/4")	115V	<b>10002412</b>	<b>360 003 024</b>	0.044
Fuse Kit for 220V Easy Fuse Processor, F1=32MA Fast, F2=50MA Delay (5x20MM), F3=30A Delay (13/32" x 2-1/4")	220V	<b>10003892</b>	<b>360 001 605</b>	0.044
Fuse Kit for 115V MSA Processor, Fuse 500MA/250V, 5 x 20MM, Time Delay, Fuse 32A/400 VAC, 10 x 38MM, Slow Blow	115V	<b>10014171</b>		0.025
Fuse Kit for 230V MSA Processor, Fuse 500MA/250V, 5 x 20MM, Time Delay, Fuse 20A/500 VAC, 10 x 38MM, Slow Blow	230V	<b>10014172</b>		0.025
Cable, Easy Fuse RS232 Circular to D9 Serial Cable, Black and Boss III		<b>5900091</b>	<b>360 002 971</b>	0.313

# BS4 Fusion Machine



## FUSION EQUIPMENT: System Assembly BS4

- Please call for pricing and availability.

Description	GFCP Part No.	GF Part No.	weight (lb)
BS4 Butt Fusion Machine Kit, with Electric Heater, BF plates, Electric Trimmer, Liners for 1" IPS thru 3" IPS	10004000	360 000 630	88.009



## FUSION EQUIPMENT: Facer BS4

- Please call for pricing and availability.

Description	GFCP Part No.	GF Part No.	weight (lb)
Model MS4 Electric Facer Trimmer Assembly 120VAC	10007735	360 002 656	17.130
Manual Facer Trimmer Model TM4	5590000	360 001 756	12.500



## FUSION EQUIPMENT: Carriage BS4

- Please call for pricing and availability.

Description	GFCP Part No.	GF Part No.	weight (lb)
BS4 Butt Fusion Carriage Machine	557BS0400000	360 000 651	29.211



**FUSION EQUIPMENT: Heater  
BS4**

- Please call for pricing and availability.

Description	GFCP Part No.	GF Part No.	weight (lb)
Heater Model 4SW Electric, with High-Temp Handle	<b>5560022</b>	<b>360 001 623</b>	5.666



**FUSION EQUIPMENT: Liner Set  
BS4**

- Please call for pricing and availability.

Description	GFCP Part No.	GF Part No.	weight (lb)
4" IPS x 1/2" IPS	<b>557LK1404501</b>	<b>360 001 744</b>	1.984
4" IPS x 3/4" IPS	<b>557LK1404751</b>	<b>360 001 746</b>	1.896
4" IPS x 1" CTS	<b>557LK1404111</b>	<b>360 001 742</b>	1.940
4" IPS x 1" IPS	<b>557LK1404011</b>	<b>360 001 743</b>	3.329
4" IPS x 1-1/4" IPS	<b>557LK1404121</b>	<b>360 001 741</b>	1.830
4" IPS x 1-1/2" IPS	<b>557LK1404151</b>	<b>360 001 740</b>	1.676
4" IPS x 2" IPS	<b>557LK1404021</b>	<b>360 001 745</b>	1.499
4" IPS x 2-1/2" IPS	<b>5750371</b>	<b>360 001 753</b>	3.594
4" IPS x 3" IPS	<b>557LK1404030</b>	<b>360 001 750</b>	2.646
4" IPS x 2" IPS	<b>557LK1404020</b>	<b>360 001 749</b>	4.233
4" IPS x 1-1/4" IPS	<b>5750263</b>	<b>360 001 752</b>	5.225
4" IPS x 1-1/2" IPS	<b>5750297</b>	<b>360 001 751</b>	4.850

**FUSION EQUIPMENT: Accessories/Replacement Parts  
BS4**

- Please call for pricing and availability.

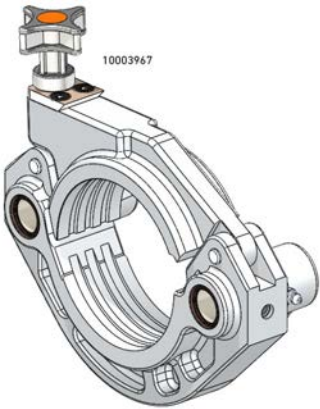
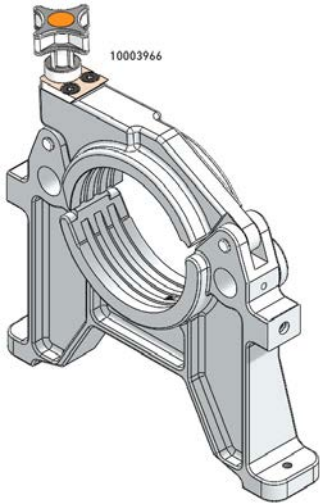

Description	GFCP Part No.	GF Part No.	weight (lb)
Facer Motor and Handle Assembly 120VAC	<b>10007817</b>	<b>360 004 231</b>	7.253
Thumb Switch	<b>10008065</b>		0.035
Drive Sprocket 14 Tooth 3/8 Pitch 5/8 Hex Drive for Model MS4 Facer Trimmer	<b>10007734</b>	<b>360 006 362</b>	0.243
Driven Sprocket, Steel, Type A, 3/8 Pitch, 36 Tooth, I.D. Bore-Per Print	<b>10007749</b>	<b>360 010 053</b>	0.683
Master Link 3/8 Pitch Drive Chain	<b>555TRO210067</b>		0.035
Facer Blade Trimmer Stainless Steel	<b>555TR1210004</b>	<b>360 003 412</b>	0.066
Facer Blade Set	<b>280204456040</b>	<b>360 003 280</b>	0.463
Facer Chain, ANSI #35 Single Row, 3/8 Pitch-Strand	<b>V00028</b>	<b>360 005 837</b>	1.000
MS4 Electric Facer	<b>10008412</b>	<b>360 005 825</b>	0.002
Thermoswitch .812 DIA x 3 3/4 25A-115V 100/600F #01-017052-309 Fenwal Heavy Duty Heater Cartridge, .375 DIA x 4.50 LG., 120V-400W, with 7 in. Swaged in Flexible Leads, No Silicone	<b>V00169</b>	<b>360 003 426</b>	2.050
Thermometer BI Metal Dial .187 Stem x 4.5 Long x 1 Head 100-650F Range +/- 1% Full Scale	<b>556EB0400061</b>	<b>360 007 185</b>	0.088
Heater Butt Plate Set, Model 4SW, Set of 2 Plates	<b>556EB0400018</b>	<b>360 003 414</b>	0.066
Heater Muff with Rope	<b>556EB3400014</b>	<b>360 000 650</b>	1.676
Heater Muff with Rope	<b>556HM3000102</b>	<b>360 001 624</b>	2.601
BS4 Sub Assembly, Fixed Pipe Clamp	<b>10003966</b>	<b>360 004 229</b>	6.261
BS4 Sub Assembly, Sliding Pipe Clamp	<b>10003967</b>	<b>360 004 230</b>	4.850
Knob Top Clamp Assembly BS4	<b>5570074</b>	<b>360 002 940</b>	0.243

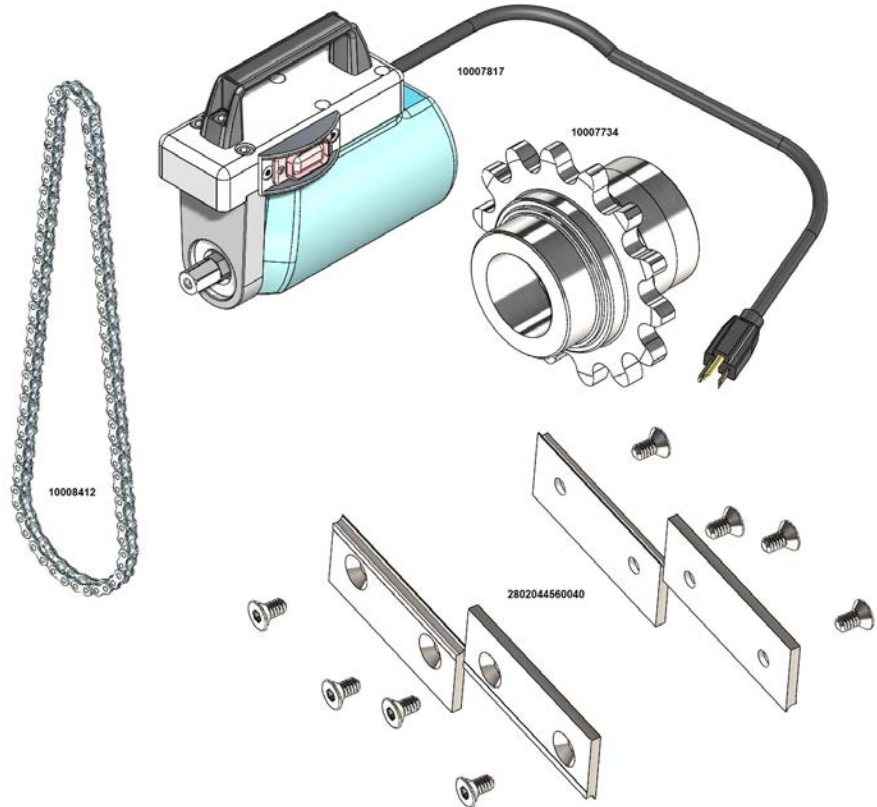

# 14M Fusion Machine



## FUSION EQUIPMENT: System Assembly 14M

- Please call for pricing and availability.

Description	GFCP Part No.	GF Part No.	weight (lb)
120V	<b>280204302040</b>	<b>360 003 278</b>	100.002
240V	<b>280204304040</b>	<b>360 003 279</b>	102.008



## FUSION EQUIPMENT: Facer 14M

- Please call for pricing and availability.

Description	GFCP Part No.	GF Part No.	weight (lb)
Facer Assembly 120VAC	<b>288204724030</b>	<b>360 004 244</b>	20.327
Facer Assembly 240VAC	<b>288204725030</b>	<b>360 006 475</b>	20.327



## FUSION EQUIPMENT: Carriage 14M

- Please call for pricing and availability.

Description	GFCP Part No.	GF Part No.	weight (lb)
Joining Assembly	<b>288204701030</b>	<b>360 004 239</b>	41.998





**FUSION EQUIPMENT: Heater  
14M**

- Please call for pricing and availability.

Description	GFCP Part No.	GF Part No.	weight (lb)
Heater Assembly 120V (with Removable Butt Plates)	288204795130	360 003 352	11.530
Heater Assembly 240V (with Reomavable Butt Plates)	288204799130	360 007 163	11.530



**FUSION EQUIPMENT: Cart  
14M**

- Please call for pricing and availability.

Description	GFCP Part No.	GF Part No.	weight (lb)
Cart Assembly	288204500030	360 003 347	80.006



**FUSION EQUIPMENT: Liner Set  
14M**

- \*Requires 2" IPS Master
- Please call for pricing and availability.

<...>	Description	GFCP Part No.	GF Part No.	weight (lb)
*	2" IPS x 3/4" IPS (4 Liners)	280204616040	360 003 290	0.970
*	2" IPS x 1" IPS (4 Liners)	280204615040	360 003 289	0.904
*	2" IPS x 1-1/4" IPS (4 Liners)	280204611040	360 003 288	0.705
*	2" IPS x 1-1/2" IPS (4 Liners)	280204609040	360 003 287	0.639
	4" DIPS x 2" IPS (4 Liners)	280204607040	360 003 286	3.395
	4" DIPS x 2-1/2" IPS (4 Liners)	280204605040	360 003 285	3.153
	4" DIPS x 3" IPS (4 Liners)	280204603040	360 003 284	2.491
	4" DIPS x 3" IPS (4 Liners)	901062	360 002 934	2.094
*	2" IPS x 3/4" CTS (4 Liners)	280204618040	360 004 090	1.036
*	2" IPS x 1" CTS (4 Liners)	280204617040	360 003 291	0.948
*	2" IPS x 1-1/4" CTS (4 Liners)	280204613040	360 004 086	0.948
*	2" IPS x 1-1/2" CTS (4 Liners)	280204639040	360 004 097	0.794
*	2" IPS x 2" CTS (4 Liners)	280204637040	360 004 096	0.529
*	2" IPS x 25mm (4 Liners)	280204635040	360 006 640	0.992
*	2" IPS x 50mm (4 Liners)	280204629040	360 004 014	3.990
*	4" DIPS x 63mm (4 Liners)	280204627040	360 004 095	4.762
*	4" DIPS x 75mm (4 Liners)	280204625040	360 004 094	3.109
*	4" DIPS x 90mm (4 Liners)	280204623040	360 004 093	5.004
*	4" DIPS x 100mm (4 Liners)	280204621040	360 004 092	2.205
*	4" DIPS x 110mm (4 Liners)	280204619040	360 004 091	3.329

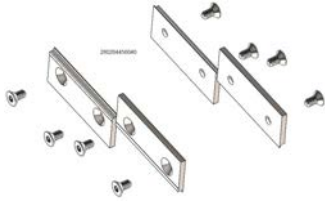

**FUSION EQUIPMENT: Accessories/Replacement Parts  
14M**

- Please call for pricing and availability.

Description	GFCP Part No.	GF Part No.	weight (lb)
Facer Blade Set	<b>280204456040</b>	<b>360 003 280</b>	0.463
Torque Wrench	<b>288544003010</b>	<b>360 003 394</b>	1.105
Butt Plate Set	<b>288453323030</b>	<b>360 003 339</b>	1.874
Kit, Retro-Fit, TD-3 Adapter to MAC 14 Butt Fusion Machine	<b>280153500040</b>	<b>360 010 428</b>	2.998
Heater Carrier (No Bag)	<b>288204350030</b>	<b>360 005 660</b>	14.661
Carrier Bag	<b>288204355010</b>	<b>360 003 341</b>	1.080

# 28CQ Fusion Machine



## FUSION EQUIPMENT: System Assembly 28CQ

- Please call for pricing and availability.

Description	GFCP Part No.	GF Part No.	weight (lb)
System Assembly 120V	101125	360 002 883	180.007
System Assembly 120V with Power Pack	101127	360 004 269	189.994
System Assembly 240V	101125A	360 004 258	180.007



## FUSION EQUIPMENT: Facer 28CQ

- Please call for pricing and availability.

Description	GFCP Part No.	GF Part No.	weight (lb)
Facer Assembly, 120V	500347	360 004 210	44.247
Facer Assembly, 240V	500347A	360 006 477	42.990



## FUSION EQUIPMENT: Carriage 28CQ

- Please call for pricing and availability.

Description	GFCP Part No.	GF Part No.	weight (lb)
Jig Assembly	200445	360 008 022	99.010



## FUSION EQUIPMENT: Heater 28CQ

- Please call for pricing and availability.

Description	GFCP Part No.	GF Part No.	weight (lb)
Heater Assembly 120V (with Removable Butt Plates)	600266	360 002 915	19.996
Heater Assembly 240V (with Removable Butt Plates)	600273	360 007 164	19.996



### FUSION EQUIPMENT: Cart 28CQ

- Please call for pricing and availability.

Description	GFCP Part No.	GF Part No.	weight (lb)
Cart Assembly	101111	360 004 141	80.998



### FUSION EQUIPMENT: Liner Set 28CQ

- \*Requires 4" DIPS Master
- Please call for pricing and availability.

Description	GFCP Part No.	SAP Part No.	weight (lb)
4" DIPS x 2" IPS (4 Liners)	280204607040	360 003 286	3.395
4" DIPS x 2-1/2" IPS (4 Liners)	280204605040	360 003 285	3.153
4" DIPS x 3" IPS (4 Liners)	280204603040	360 003 284	2.491
4" DIPS x 4" IPS (4 Liners)	280204601040	360 003 283	1.190
8" DIPS x 5" IPS (2 Upper, 2 Lower)	280208615140	360 003 303	8.003
8" DIPS x 5" IPS (2 Upper, 2 Lower)	280208640140	360 003 972	14.991
8" DIPS x 5" IPS (2 Upper, 2 Lower)	280208635140	360 003 964	16.006
8" DIPS x 6" IPS (2 Upper, 2 Lower)	280208610140	360 003 302	9.326
8" DIPS x 8" IPS (2 Upper, 2 Lower)	280208600140	360 003 297	4.365
8" DIPS x 4" DIPS (2 Upper, 2 Lower)	280208620140	360 003 305	17.990
8" DIPS x 6" DIPS (2 Upper, 2 Lower)	280208605140	360 004 073	9.987
Mitered 8" DIPS x 4" IPS (2 Upper, 2 Lower)	280208700040	360 003 986	19.599
Mitered 8" DIPS x 6" IPS (2 Upper, 2 Lower)	280208685040	360 003 985	13.999
Mitered 8" DIPS x 8" IPS (2 Upper, 2 Lower)	280208675040	360 006 675	17.791
Mitered 8" DIPS x 6" DIPS (2 Upper, 2 Lower)	280208680040	360 003 984	13.492
Set, 4" IPS X 3" IPS (4 Liners per Set)	901062	360 002 934	2.094

### FUSION EQUIPMENT: Accessories/Replacement Parts 28CQ

- Please call for pricing and availability.

Description	GFCP Part No.	GF Part No.	weight (lb)
Facer Stand	800200	360 004 194	9.348
Facer Blade Set, 4 Blades, 12 Screws, and 1 Hex Key Wrench	280208456040	360 003 296	1.168
Ultra Light Aluminum 8" Stub End Fitting Holder	800030	360 002 918	13.382
Hydraulic Extension Hose 25 FT ( 2 Required per Machine)	300212	360 003 895	13.007
Hydraulic Hose Extension Kit	800185	360 003 904	17.990
Heater Carrier	600268	360 004 646	7.981
Hi Temp Silicone Heater Bag	288208352010	360 003 354	2.646
8" Butt Plate Set	600260	360 002 912	5.137
Pipe Stand	800161	360 002 922	58.996

# 28HP Fusion Machine



## FUSION EQUIPMENT: System Assembly 28HP

- Please call for pricing and availability.

Description	GFCP Part No.	GF Part No.	weight (lb)
28HP Unit 120V	280208100040	360 003 295	590.001
System Assembly 240V	280208100140	360 004 273	438.014



## FUSION EQUIPMENT: Facer 28HP

- Please call for pricing and availability.

Description	GFCP Part No.	GF Part No.	weight (lb)
Facer Assembly 110V	500359	360 006 478	323.264
Facer Assembly 240V	500360	360 006 479	324.013



## FUSION EQUIPMENT: Carriage 28HP

- Please call for pricing and availability.

Description	GFCP Part No.	GF Part No.	weight (lb)
Clamp Unit & Assembly 28 HP	288208100030	360 005 930	142.992



## FUSION EQUIPMENT: Heater 28HP

- Please call for pricing and availability.

Description	GFCP Part No.	SAP Part No.	weight (lb)
Heater Assembly 120V (with Removable Butt Plates)	600266	360 002 915	19.996
Heater Assembly 240V (with Removable Butt Plates)	600273	360 007 164	19.996



### FUSION EQUIPMENT: Cart 28HP

- Please call for pricing and availability.

Description	GFCP Part No.	GF weight Part No.	(lb)
Cart Assembly	<b>288208500030</b>	<b>360 005 665</b>	19.996



### FUSION EQUIPMENT: Liner Set 28HP

- \*Requires 4" DIPS Master
- Please call for pricing and availability.

<...>	Description	GFCP Part No.	GF weight Part No.	(lb)
*	4" DIPS x 2" IPS (8 Liners)	<b>280208607040</b>	<b>360 003 300</b>	7.121
*	4" DIPS x 3" IPS (8 Liners)	<b>280208603040</b>	<b>360 003 299</b>	4.696
*	4" DIPS x 4" IPS (8 Liners)	<b>280208601040</b>	<b>360 003 298</b>	3.219
	8" DIPS x 5" IPS (4 Upper, 4 Lower)	<b>280208615040</b>	<b>360 003 956</b>	31.592
	8" DIPS x 5" IPS (4 Upper, 4 Lower)	<b>280208635040</b>	<b>360 003 963</b>	32.011
	8" DIPS x 6" IPS (4 Upper, 4 Lower)	<b>280208610040</b>	<b>360 003 301</b>	20.900
	8" DIPS x 8" IPS (4 Upper, 4 Lower)	<b>280208600040</b>	<b>360 004 068</b>	7.760
	8" DIPS x 4" DIPS (4 Upper, 4 Lower)	<b>280208620040</b>	<b>360 003 304</b>	36.994
	8" DIPS x 6" DIPS (4 Upper, 4 Lower)	<b>280208605040</b>	<b>360 004 072</b>	18.298
	Mitered 8" DIPS x 6" IPS (2 Upper, 2 Lower)	<b>280208685040</b>	<b>360 003 985</b>	13.999
	Mitered 8" DIPS x 4" IPS (2 Upper, 2 Lower)	<b>280208700040</b>	<b>360 003 986</b>	19.599
	8 IPS Mitered 11.25° ( nonstock item )	<b>280208675040</b>	<b>360 006 675</b>	17.791
	Mitered 8" DIPS x 6" DIPS (2 Upper, 2 Lower)	<b>280208680040</b>	<b>360 003 984</b>	13.492
	Liner Set, 4" DIPS x 3" DIPS (8 Liners per Set)	<b>901060</b>	<b>360 004 082</b>	3.990

### FUSION EQUIPMENT: Accessories/Replacement Parts 28HP

- Please call for pricing and availability.

Description	GFCP Part No.	GF weight Part No.	(lb)
Facer Blade Set, 4 Blades, 12 Screws, and 1 Hex Key Wrench	<b>280208456040</b>	<b>360 003 296</b>	1.168
Ultra Light Aluminum 8" Stub End Fitting Holder	<b>800030</b>	<b>360 002 918</b>	13.382
8" Butt Plate Set	<b>600260</b>	<b>360 002 912</b>	5.137
Hi Temp Silicone Heater Bag	<b>288208352010</b>	<b>360 003 354</b>	2.646
Pipe Stand	<b>800161</b>	<b>360 002 922</b>	58.996

# 28EP Fusion Machine



## FUSION EQUIPMENT: System Assembly 28EP

- Please call for pricing and availability.

Description	GFCP Part No.	GF Part No.	weight (lb)
System Assembly, 120V	280208940040	360 010 398	0.002
28Ep Unit 240v	280208950040	360 003 311	590.001



## FUSION EQUIPMENT: Facer 28EP

- Please call for pricing and availability.

Description	GFCP Part No.	GF Part No.	weight (lb)
Facer Assembly 8"	288208950030	360 004 238	44.996



## FUSION EQUIPMENT: Carriage 28EP

- Please call for pricing and availability.

Description	GFCP Part No.	GF Part No.	weight (lb)
Clamp Unit Assembly		360 060 023	145.000



## FUSION EQUIPMENT: Heater 28EP

- Please call for pricing and availability.

Description	GFCP Part No.	GF Part No.	weight (lb)
Heater Assembly 120V (with removable butt plates)	288208350030	360 003 353	19.798
Heater Assembly 240V (with removable butt plates)	288208311030	360 007 165	19.798



## FUSION EQUIPMENT: Cart 28EP

- Please call for pricing and availability.

Description	GFCP Part No.	GF Part No.	weight (lb)
Cart Assembly	288208500030	360 005 665	19.996



## FUSION EQUIPMENT: Liner Set 28EP

- \*Requires 4" DIPS Master
- Please call for pricing and availability.

<...>	Description
*	4" DIPS x 2" IPS (8 Liners)
*	4" DIPS x 3" IPS (8 Liners)
*	4" DIPS x 4" IPS (8 Liners)
	4" DIPS x 3" DIPS (8 Liners)
	8" DIPS x 5" IPS (4 Upper, 4 Lower)
	Liner Set, 8" DIPS x 5.375" IPS (4 Upper, 4 Lower, per set)
	8" DIPS x 6" IPS (4 Upper, 4 Lower)
	8" DIPS x 8" IPS (4 Upper, 4 Lower)
*	8" DIPS x 4" DIPS (4 Upper, 4 Lower)
*	8" DIPS x 6" DIPS (4 Upper, 4 Lower)
*	Mitered 8" DIPS x 4" IPS (2 Upper, 2 Lower)
	Mitered 8" DIPS x 6" IPS (2 Upper, 2 Lower)
	8" IPS Mitered 11.25° (nonstock item)
	8" DIPS x 6" DIPS (2 Upper, 2 Lower)

GFCP Part No.	GF Part No.	weight (lb)
280208607040	360 003 300	7.121
280208603040	360 003 299	4.696
280208601040	360 003 298	3.219
901060	360 004 082	3.990
280208615040	360 003 956	31.592
280208635040	360 003 963	32.011
280208610040	360 003 301	20.900
280208600040	360 004 068	7.760
280208620040	360 003 304	36.994
280208605040	360 004 072	18.298
280208700040	360 003 986	19.599
280208685040	360 003 985	13.999
280208675040	360 006 675	17.791
280208680040	360 003 984	13.492

## FUSION EQUIPMENT: Accessories/Replacement Parts 28EP

- Please call for pricing and availability.

Description	GFCP Part No.	GF Part No.	weight (lb)
Facer Blade Set, 4 Blades, 12 Screws, and 1 Hex Key Wrench	280208456040	360 003 296	1.168
Hydraulic Extension Hose Assembly, 50FT	288218510030	360 003 905	55.005
Power Extension Cord 25FT	288208369030	360 003 357	14.991
Ultra Light Aluminum 8" Stub End Fitting Holder	800030	360 002 918	13.382
Hydraulic Extension Hose Assembly, 25FT	288208510030	360 004 675	30.997
Power Extension Cord 50FT	288218379030	360 004 163	19.996
Hydraulic Power Unit	288208540030	360 007 755	144.998
Butt Plate Set	280208357040	360 005 589	5.379
Hi Temp Silicone Heater Bag	288208352010	360 003 354	2.646
Pipe Stand	800161	360 002 922	58.996



# 414CQ Fusion Machine



## FUSION EQUIPMENT: System Assembly 414CQ

- Please call for pricing and availability.

Description	GFCP Part No.	GF Part No.	weight (lb)
Hydraulic Hand Pump System Assembly 120V	101350	360 010 400	356.002



## FUSION EQUIPMENT: Facer 414CQ

- Please call for pricing and availability.

Description	GFCP Part No.	GF Part No.	weight (lb)
Facer Assembly 120V	10013458	360 006 474	64.992

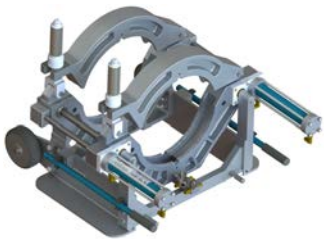

## FUSION EQUIPMENT: Carriage 414CQ

- Please call for pricing and availability.

Description	GFCP Part No.	GF Part No.	weight (lb)
Jig Assembly	200515	360 027 993	185.012



## FUSION EQUIPMENT: Heater 414CQ

- Please call for pricing and availability.

Description	GFCP Part No.	GF Part No.	weight (lb)
Heater Assembly 120V	600210	360 002 908	27.492

## FUSION EQUIPMENT: Liner Set 414CQ

- Please call for pricing and availability.

Description	GFCP Part No.	GF Part No.	weight (lb)
4" DIPS x 3" DIPS (4 Liners)	901062	360 002 934	2.094
Master Liner 14" IPS x 12" IPS (4 Liners)	10013568	360 028 048	11.993
12" IPS x 10" IPS (2 Upper, 2 Lower)	10013569	360 028 049	60.010
12" IPS x 8" IPS (2 Upper, 2 Lower)	10013570	360 028 050	91.999
12" IPS x 6" IPS (2 Upper, 2 Lower)	10013571	360 028 051	111.995
6" IPS x 4" IPS (2 Upper, 2 Lower)	10013572	360 028 052	11.993
6" IPS x 3" IPS (2 Upper, 2 Lower)	10013573	360 028 053	13.999

table continued on the next page

Description	GFCP Part No.	GF Part No.	weight (lb)
14" IPS x 12" DIPS (4 Liners)	10013574	360 028 054	8.995
6" DIPS x 4" DIPS (4 Liners)	10013575	360 028 055	11.993
12" IPS x 10" DIPS (2 Upper, 2 Lower)	10013576	360 028 056	60.010
12" IPS x 8" DIPS (2 Upper, 2 Lower)	10013577	360 028 057	91.999
12" IPS x 6" DIPS (2 Upper, 2 Lower)	10013578	360 028 058	111.995
6" IPS x 5" IPS (2 Upper, 2 Lower)	10013579	360 028 059	11.993
12" IPS x 280mm (2 Upper, 2 Lower)	10013580	360 028 060	60.010
12" IPS x 225mm (2 Upper, 2 Lower)	10013582	360 028 062	91.999
12" IPS x 200mm (2 Upper, 2 Lower)	10013583	360 028 063	111.995
12" IPS x 180mm (2 Upper, 2 Lower)	10013584	360 028 064	111.995
Master Liner 12" IPS x 160mm (2 Upper, 2 Lower)	10013585	360 028 065	111.995
160mm x 125mm (2 Upper, 2 Lower)	10013586	360 028 078	10.009
14" IPS x 315mm (4 Liners)	10013587	360 028 096	10.009
14" IPS x 340mm (4 Liners)	10013606	360 028 323	11.993

#### FUSION EQUIPMENT: Accessories/Replacement Parts 414CQ

- Please call for pricing and availability.

Description	GFCP Part No.	GF Part No.	weight (lb)
Facer Blade Set	500375	360 007 114	1.521
Heater Stand	600082	360 004 196	9.149
14" Heater Bag	600012	360 007 176	4.652

# 414HP Fusion Machine



## FUSION EQUIPMENT: System Assembly 414HP

- Please call for pricing and availability.

Description	GFCP Part No.	GF Part No.	weight (lb)
System Assembly 110V	101149	360 004 266	1325.022



## FUSION EQUIPMENT: Facer 414HP

- Please call for pricing and availability.

Description	GFCP Part No.	GF Part No.	weight (lb)
Facer Assembly 110V	500325	360 006 473	64.992

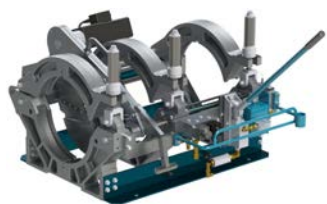

## FUSION EQUIPMENT: Carriage 414HP

- Please call for pricing and availability.

Description	GFCP Part No.	GF Part No.	weight (lb)
Chassis Assembly	200463	360 005 871	19.996



## FUSION EQUIPMENT: Heater 414HP

- Please call for pricing and availability.

Description	GFCP Part No.	GF Part No.	weight (lb)
Heater Assembly 120V	600210	360 002 908	27.492



## FUSION EQUIPMENT: Cart 414HP

- Please call for pricing and availability.

Description	GFCP Part No.	GF Part No.	weight (lb)
Cart Assembly	101146	360 005 666	335.014

**FUSION EQUIPMENT: Liner Set  
414HP**

- \*Requires 12" IPS Master Liner Set
- \*\*Requires 12" IPS and 6" IPS Master Liner Set
- \*\*\*Requires 6" DIPS Master Liner Set
- Please call for pricing and availability.

<...>	Description	GFCP Part No.	GF Part No.	weight (lb)
*	6" IPS x 4" IPS (4 Upper, 4 Lower)	900972	360 004 077	23.810
*	12" IPS x 6" IPS (4 Upper, 4 Lower)	280218618040	360 003 318	80.998
*	12" IPS x 8" IPS (4 Upper, 4 Lower)	280218615040	360 003 317	5.004
*	12" IPS x 10" IPS (4 Upper, 4 Lower)	280218612040	360 003 316	35.494
	Master Liner 14" IPS x 12" IPS (8 Liners)	900945	360 002 933	22.994
***	6" DIPS x 4" DIPS (4 Upper, 4 Lower)	900974	360 004 078	23.060
*	12" IPS x 6" DIPS (4 Upper, 4 Lower)	280218668040	360 003 979	80.006
*	12" IPS x 8" DIPS (4 Upper, 4 Lower)	280218665040	360 003 978	13.999
*	12" IPS x 10" DIPS (4 Upper, 4 Lower)	280218662040	360 003 977	7.011
	14" IPS x 12" DIPS (8 Liners)	900948	360 004 076	18.210
	Mitered Liner 12" IPS x 8" IPS, (2 Upper, 2 Lower)	280218715040	360 004 019	38.008
	Mitered Liner 12" IPS x 10" IPS, (2 Upper, 2 Lower)	280218712040	360 004 020	24.008
	Mitered Liner, 6" DIPS	280218768040	360 003 992	42.990
	Mitered Liner, 8" DIPS	280218765040	360 003 991	35.009
	Mitered Liner, 10" DIPS	280218762040	360 003 990	21.010

**FUSION EQUIPMENT: Accessories/Replacement Parts  
414HP**

Description	GFCP Part No.	GF Part No.	weight (lb)
Facer Blade Set	500378	360 002 906	1.521
Clamp Assembly	200460	360 005 885	53.991
Hydraulic Extension Hose Assembly, 25FT	288208510030	360 004 675	30.997
Hydraulic Extension Hose Assembly, 50FT	288218510030	360 003 905	55.005
Ultra Light Aluminum Stub End Holder	800035	360 004 139	18.497
Heater Stand	600082	360 004 196	9.149
14" Heater Bag	600012	360 007 176	4.652
14" Butt Plate Set	600261	360 002 913	10.207
14" Pipe Stand Assembly	800110	360 002 920	97.003

# 414EP Fusion Machine



## FUSION EQUIPMENT: System Assembly 414EP

- Please call for pricing and availability.

Description	GFCP Part No.	GF Part No.	weight (lb)
System Assembly 220V	101148	360 004 265	1420.019



## FUSION EQUIPMENT: Facer 414EP

- Please call for pricing and availability.

Description	GFCP Part No.	GF Part No.	weight (lb)
Hydraulic Facer Assembly	500370	360 006 486	19.996

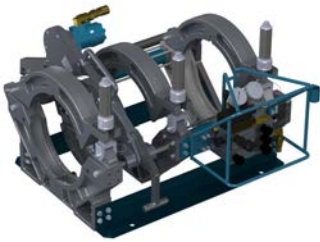

## FUSION EQUIPMENT: Carriage 414EP

- Please call for pricing and availability.

Description	GFCP Part No.	GF Part No.	weight (lb)
Chassis Assembly	200461	360 005 869	403.005



## FUSION EQUIPMENT: Heater 414EP

- Please call for pricing and availability.

Description	GFCP Part No.	GF Part No.	weight (lb)
14" Heater Assembly 240V	600211	360 002 909	27.007



## FUSION EQUIPMENT: Cart 414EP

- Please call for pricing and availability.

Description	GFCP Part No.	GF Part No.	weight (lb)
Cart Assembly	101150	360 005 667	0.002

**FUSION EQUIPMENT: Liner Set  
414EP**

- \*Requires 12" IPS Master Liner Set
- \*\*Requires 12" IPS and 6" IPS Master Liner Set
- \*\*\*Requires 6" DIPS Master Liner Set
- Please call for pricing and availability.

<...>	Description
	Master Liner Set, 14" IPS x 12" IPS (8 Liners per set)
**	4" IPS (6" IPS to 4" IPS)
***	Liner Set, 6" DIPS x 4" DIPS (4 Upper, 4 Lower, per set)
	14" IPS x 12" DIPS (8 Liners)
*	12" IPS x 6" IPS (4 Upper, 4 Lower)
*	Liner Set, 12" IPS x 8" IPS (4 Upper, 4 Lower, per set)
*	12" IPS x 10" IPS (4 Upper, 4 Lower)
*	6" DIPS (12" DIPS to 6" DIPS)
*	8 DIPS (12 DIPS to 8 DIPS)
*	Liner Set, 12" IPS x 10" DIPS (4 Upper, 4 Lower, per set)
	Mitered 12" IPS x 6" IPS (2 Upper, 2 Lower)
	Mitered 12" IPS x 8" IPS (2 Upper, 2 Lower)
	Mitered 12" IPS x 10" IPS (2 Upper, 2 Lower)

GFCP Part No.	GF Part No.	weight (lb)
900945	360 002 933	22.994
900972	360 004 077	23.810
900974	360 004 078	23.060
900948	360 004 076	18.210
280218618040	360 003 318	80.998
280218615040	360 003 317	5.004
280218612040	360 003 316	35.494
280218668040	360 003 979	80.006
280218665040	360 003 978	13.999
280218662040	360 003 977	7.011
280218718040	360 003 983	44.004
280218715040	360 004 019	38.008
280218712040	360 004 020	24.008

**FUSION EQUIPMENT: Accessories/Replacement Parts  
414EP**

- Please call for pricing and availability.

Description	GFCP Part No.	GF Part No.	weight (lb)
Facer Blade Set	500378	360 002 906	1.521
Hydraulic Extension Hose Assembly, 25FT	288208510030	360 004 675	30.997
Hydraulic Extension Hose Assembly, 50FT	288218510030	360 003 905	55.005
Ultra light Aluminum Stub End Holder	800035	360 004 139	18.497
Clamp Assembly	200460	360 005 885	53.991
Heater Stand	600082	360 004 196	9.149
14" Heater Bag	600012	360 007 176	4.652
14" Butt Plate Set	600261	360 002 913	10.207
14" Pipe Stand Assembly	800110	360 002 920	97.003

# 414SC Fusion Machine



## FUSION EQUIPMENT: System Assembly 414SC

- Please call for pricing and availability.

Description	GFCP Part No.	GF Part No.	weight (lb)
Butt Fusion System Assembly 240V	101147	360 002 884	1562.019



## FUSION EQUIPMENT: Facer 414SC

- Please call for pricing and availability.

Description	GFCP Part No.	GF Part No.	weight (lb)
Hydraulic Facer Assembly	500370	360 006 486	19.996

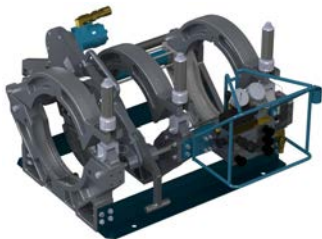

## FUSION EQUIPMENT: Carriage 414SC

- Please call for pricing and availability.

Description	GFCP Part No.	GF Part No.	weight (lb)
Chassis Assembly	200461	360 005 869	403.005



## FUSION EQUIPMENT: Heater 414SC

- Please call for pricing and availability.

Description	GFCP Part No.	GF Part No.	weight (lb)
14" Heater Assembly 240V	600211	360 002 909	27.007



## FUSION EQUIPMENT: Cart 414SC

- Please call for pricing and availability.

Description	GFCP Part No.	GF Part No.	weight (lb)
Cart/Engine Assembly	101205	360 005 673	19.996

**FUSION EQUIPMENT: Liner Set  
414SC**

- \*Requires 12" IPS Master Liner Set
- \*\*Requires 12" IPS and 6" IPS Master Liner Set
- \*\*\*Requires 6" DIPS Master Liner Set
- Please call for pricing and availability.

<...>	Description
**	4 IPS (6 IPS to 4 IPS)
*	Master 12" IPS x 6" IPS (4 Upper, 4 Lower)
*	12" IPS x 8" IPS (4 Upper, 4 Lower)
*	Liner Set, 12" IPS x 10" IPS (4 Upper, 4 Lower, per set)
	14" IPS x 12" IPS (8 Liners)
***	6" DIPS x 4" DIPS (4 Upper, 4 Lower)
*	6 DIPS (12 DIPS to 6 DIPS)
*	8 DIPS (12 DIPS to 8 DIPS)
*	12" IPS x 10" DIPS (4 Upper, 4 Lower)
	14" IPS x 12" DIPS (8 Liners)
	Mitered 12" IPS x 6" IPS, 11.25° (nonstock item)
	Mitered 12" IPS x 8" IPS, 11.25° (2 Upper, 2 Lower)
	Mitered 12" IPS x 10" IPS, 11.25° (2 Upper, 2 Lower)
	Mitered 6" DIPS, 11.25°
	Mitered 8" DIPS, 11.25°
	Mitered 10" DIPS, 11.25°

GFCP Part No.	GF Part No.	weight (lb)
900972	360 004 077	23.810
280218618040	360 003 318	80.998
280218615040	360 003 317	5.004
280218612040	360 003 316	35.494
900945	360 002 933	22.994
900974	360 004 078	23.060
280218668040	360 003 979	80.006
280218665040	360 003 978	13.999
280218662040	360 003 977	7.011
900948	360 004 076	18.210
280218718040	360 003 983	44.004
280218715040	360 004 019	38.008
280218712040	360 004 020	24.008
280218768040	360 003 992	42.990
280218765040	360 003 991	35.009
280218762040	360 003 990	21.010

**FUSION EQUIPMENT: Accessories/Replacement Parts  
414SC**

- Please call for pricing and availability.

Description	GFCP Part No.	GF Part No.	weight (lb)
Facer Blade Set	500378	360 002 906	1.521
Ultra Light Aluminum Stub End Holder	800035	360 004 139	18.497
Hydraulic Extension Hose Assembly, 25FT	288208510030	360 004 675	30.997
Hydraulic Extension Hose Assembly, 50FT	288218510030	360 003 905	55.005
Heater Stand	600082	360 004 196	9.149
14" Heater Bag	600012	360 007 176	4.652
14" Butt Plate Set	600261	360 002 913	10.207
14" Pipe Stand Assembly	800110	360 002 920	97.003



# 414HD Fusion Machine



## FUSION EQUIPMENT: System Assembly 414HD

- Please call for pricing and availability.

Description	GFCP Part No.	GF Part No.	weight (lb)
System Assembly 240V	10013991	360 028 384	1550.026



## FUSION EQUIPMENT: Facer 414HD

- Please call for pricing and availability.

Description	GFCP Part No.	GF Part No.	weight (lb)
Hydraulic Facer Assembly	500370	360 006 486	19.996

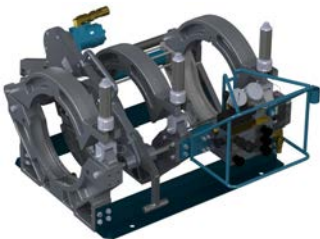

## FUSION EQUIPMENT: Carriage 414HD

- Please call for pricing and availability.

Description	GFCP Part No.	GF Part No.	weight (lb)
Chassis Assembly	200461	360 005 869	403.005



## FUSION EQUIPMENT: Heater 414HD

- Please call for pricing and availability.

Description	GFCP Part No.	GF Part No.	weight (lb)
14" Heater Assembly 240V	600211	360 002 909	27.007



## FUSION EQUIPMENT: Cart 414HD

- Please call for pricing and availability.

Description	GFCP Part No.	GF Part No.	weight (lb)
Cart/Engine Assembly	10013990	360 028 297	1000.017

**FUSION EQUIPMENT: Liner Set  
414HD**

- Please call for pricing and availability.

<...>	Description
**	6" IPS x 4" IPS (4 Upper, 4 Lower)
	Liner Set, 12" IPS X 6" IPS (4 Upper, 4 Lower, Per Set)
	12" IPS x 8" IPS (4 Upper, 4 Lower)
	Liner Set, 12" IPS x 10" IPS (4 Upper, 4 Lower)
	Liner Set, 14" IPS x 12" IPS (8 Liners, per set)
	Liner Set, 6" DIPS X 4" DIPS (4 Upper, 4 Lower, Per Set)
	Liner Set, 12" IPS X 6" DIPS (4 Upper, 4 Lower, Per Set)
*	12" IPS x 8" DIPS (4 Upper, 4 Lower)
	Liner Set, 12" IPS x 10" DIPS (4 Upper, 4 Lower, per set)
	14" IPS x 12" DIPS (8 Liners)
	Mitered Liner Set, 12" IPS X 6" IPS, 11.25° (2 Upper, 2 Lower, Per Set)
	Mitered Liner Set, 12" IPS x 8" IPS, 11.25° (2 Upper, 2 Lower, per set)
	Mitered 12" IPS x 10" IPS, 11.25° (2 Upper, 2 Lower)

GFCP Part No.	GF Part No.	weight (lb)
900972	360 004 077	23.810
280218618040	360 003 318	80.998
280218615040	360 003 317	5.004
280218612040	360 003 316	35.494
900945	360 002 933	22.994
900974	360 004 078	23.060
280218668040	360 003 979	80.006
280218665040	360 003 978	13.999
280218662040	360 003 977	7.011
900948	360 004 076	18.210
280218718040	360 003 983	44.004
280218715040	360 004 019	38.008
280218712040	360 004 020	24.008

**FUSION EQUIPMENT: Accessories/Replacement Parts  
414HD**

- Please call for pricing and availability.

Description	GFCP Part No.	GF Part No.	weight (lb)
Facer Blade Set	500378	360 002 906	1.521
Heater Stand	600082	360 004 196	9.149
14" Heater Bag	600012	360 007 176	4.652
14" Pipe Stand Assembly	800110	360 002 920	97.003

# 620SC Fusion Machine



## FUSION EQUIPMENT: System Assembly 620SC

- Please call for pricing and availability.

Description	GFCP Part No.	GF Part No.	weight (lb)
System Assembly 240V	<b>280220300040</b>	<b>360 003 319</b>	2500.04



## FUSION EQUIPMENT: Facer 620SC

- Please call for pricing and availability.

Description	GFCP Part No.	GF Part No.	weight (lb)
Facer Assembly	<b>500290</b>	<b>360 006 485</b>	167.992



## FUSION EQUIPMENT: Carriage 620SC

- Please call for pricing and availability.

Description	GFCP Part No.	GF Part No.	weight (lb)
Clamp Unit Assembly	<b>288220400030</b>	<b>360 005 931</b>	792.011

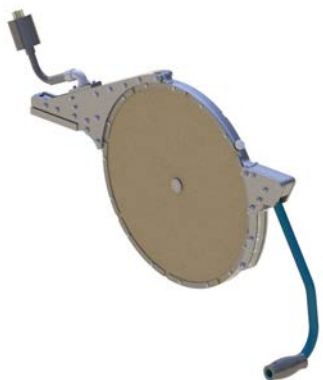

## FUSION EQUIPMENT: Heater 620SC

- Please call for pricing and availability.

Description	GFCP Part No.	GF Part No.	weight (lb)
Heater Assembly	<b>600340</b>	<b>360 002 917</b>	61.002



**FUSION EQUIPMENT: Cart  
620SC**

- Please call for pricing and availability.

Description	GFCP Part No.	GF Part No.	weight (lb)
Cart Assembly	10011527	360 005 668	1319.026



**FUSION EQUIPMENT: Liner Set  
620SC**

- \*Requires 18" IPS Master Set
- \*\*Requires both 18" IPS and 12" IPS Master Set
- Note: Millimeter liners available upon request - nonstock items.
- Please call for pricing and availability.

<...>	Description
**	12" IPS x 6" IPS (4 Upper, 4 Lower)
**	Liner Set, 12" IPS x 8" IPS (4 Upper, 4 Lower, per set)
**	Liner Set, 12" IPS x 10" IPS (4 Upper, 4 Lower, per set)
	Master 18" IPS x 12" IPS (4 Upper, 4 Lower)
*	*18" IPS x 14" IPS (4 Upper, 4 Lower)
*	*18" IPS x 16" IPS (4 Upper, 4 Lower)
	Master 20" IPS x 18" IPS (4 Upper, 4 Lower)
**	12" IPS x 6" DIPS (4 Upper, 4 Lower)
*	12" IPS x 8" DIPS (12" IPS to 8" DIPS)
**	12" IPS x 10" DIPS (4 Upper, 4 Lower)
*	18" IPS x 12" DIPS (4 Upper, 4 Lower)
*	18" IPS x 14" DIPS (4 Upper, 4 Lower)
	20" IPS x 16" DIPS (4 Upper, 4 Lower)
	Liner Set, 20" IPS x 18" DIPS (4 Upper, 4 Lower, per set)
	Mitered 12" IPS x 6" IPS, 11.25° (2 Upper, 2 Lower)
	Mitered 12" IPS x 8" IPS, 11.25° (2 Upper, 2 Lower)
	Mitered 12" IPS x 10" IPS, 11.25° (2 Upper, 2 Lower)
	Mitered 18" IPS x 12" IPS, 11.25° (2 Upper, 2 Lower)
	Mitered 18" IPS x 14" IPS, 11.25° (2 Upper, 2 Lower)
	Mitered Liner Set, 18" DIPS x 16" IPS, 11.25° (2 Upper, 2 Lower, per set)
	Mitered Liner 6" DIPS, 11.25°
	Mitered Liner 8" DIPS, 11.25°
	Mitered Liner 10" DIPS, 11.25°
	Mitered Liner 12" DIPS, 11.25°
	Mitered Liner 14" DIPS, 11.25°
	Mitered 20" IPS x 16" DIPS, 11.25°

	GFCP Part No.	GF Part No.	weight (lb)
	280218618040	360 003 318	80.998
	280218615040	360 003 317	5.004
	280218612040	360 003 316	35.494
	280218609040	360 003 315	144.998
	280218606040	360 003 314	121.012
	280218603040	360 003 313	74.009
	280220600040	360 003 320	86.002
	280218668040	360 003 979	80.006
	280218665040	360 003 978	13.999
	280218662040	360 003 977	7.011
	280218659040	360 003 971	161.004
	280218656040	360 003 970	97.995
	280220653040	360 003 916	100.994
	280220680040	360 003 917	97.995
	280218718040	360 003 983	44.004
	280218715040	360 004 019	38.008

table continued on the next page

<b>GFCP Part No.</b>	<b>GF Part No.</b>	<b>weight (lb)</b>
<b>280218712040</b>	<b>360 004 020</b>	24.008
<b>280218709040</b>	<b>360 004 018</b>	139.994
<b>280218706040</b>	<b>360 003 982</b>	130.007
<b>280218703040</b>	<b>360 003 981</b>	125.994
<b>280218768040</b>	<b>360 003 992</b>	42.990
<b>280218765040</b>	<b>360 003 991</b>	35.009
<b>280218762040</b>	<b>360 003 990</b>	21.010
<b>280218759040</b>	<b>360 003 989</b>	88.009
<b>280218756040</b>	<b>360 003 988</b>	52.999
<b>280220753040</b>	<b>360 003 987</b>	0.002

---

**FUSION EQUIPMENT: Accessories/Replacement Parts  
620SC**

- Please call for pricing and availability.

<b>Description</b>	<b>GFCP Part No.</b>	<b>GF Part No.</b>	<b>weight (lb)</b>
6" IPS x 20" IPS Standard Length Blade Set (used on 500290 Facer)	<b>280218456040</b>	<b>360 003 873</b>	2.778
Long Length (Optional)	<b>280218469040</b>	<b>360 003 312</b>	5.093
20" Ultra Light Aluminum Stub End Fitting Hold- er	<b>800190</b>	<b>360 002 923</b>	41.006
Power Extension Cord 25FT	<b>288208369030</b>	<b>360 003 357</b>	14.991
Power Extension Cord 50FT	<b>288218379030</b>	<b>360 004 163</b>	19.996
Pipe Stand	<b>800150</b>	<b>360 002 921</b>	150.003

---

# 824EP Fusion Machine



## FUSION EQUIPMENT: System Assembly 824EP

- Please call for pricing and availability.

Description	GFCP Part No.	GF Part No.	weight (lb)
System Assembly	101231C	360 003 410	2800.047



## FUSION EQUIPMENT: Facer 824EP

- Please call for pricing and availability.

Description	GFCP Part No.	GF Part No.	weight (lb)
Facer Assembly	500225	360 004 214	111.003

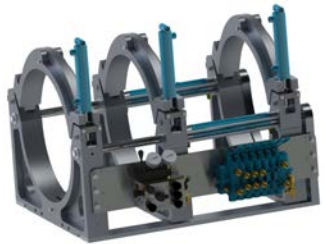

## FUSION EQUIPMENT: Carriage 824EP

- Please call for pricing and availability.

Description	GFCP Part No.	GF Part No.	weight (lb)
Carriage Assembly	200520		657.000

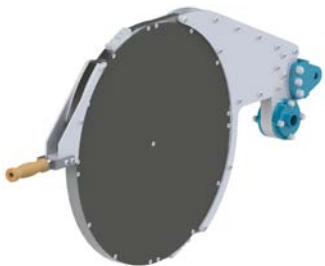

## FUSION EQUIPMENT: Heater 824EP

- Please call for pricing and availability.

Description	GFCP Part No.	GF Part No.	weight (lb)
Heater Assembly, 240V, 3 Phase	600215	360 002 910	110.011



## FUSION EQUIPMENT: Cart 824EP

- Please call for pricing and availability.

Description	GFCP Part No.	GF Part No.	weight (lb)
Motor Pump Cart Assembly	101380	360 008 430	19.996



### FUSION EQUIPMENT: Liner Set 824EP

- \*Requires 18" IPS Master Set
- \*\*Requires both 18" and 12" Masters
- Note: Millimeter liners available upon request - nonstock items.
- Please call for pricing and availability.

<...>	Description	GFCP Part No.	GF Part No.	weight (lb)
**	Master 12" IPS x 8" IPS (8 Liners)	900553	360 002 931	52.999
**	12" IPS x 10" IPS (8 Liners)	900554	360 002 932	36.994
*	18" IPS x 12" IPS (4 Upper, 4 Lower)	900533	360 002 925	86.994
*	18" IPS x 14" IPS (8 Liners)	900534	360 002 926	72.003
*	18" IPS x 16" IPS (8 Liners)	900535	360 002 927	42.990
	Master 24" IPS x 18" IPS (4 Upper, 4 Lower)	900539	360 002 928	130.999
	24" IPS x 20" IPS (4 Upper, 4 Lower)	900540	360 002 929	94.997
	24" IPS x 22" IPS (4 Upper, 4 Lower)	900541	360 002 930	63.008
**	12" IPS x 8" DIPS (8 Liners)	900729	360 004 066	52.999
*	12" IPS x 10" DIPS (8 Liners)	900728	360 004 065	97.995
*	18" IPS x 12" DIPS (8 Liners)	900727	360 004 064	78.000
*	18" IPS x 14" DIPS (8 Liners)	900726	360 004 075	63.008
	24" IPS x 16" DIPS (8 Liners)	900725	360 004 062	139.994
	24" IPS x 18" DIPS (4 Upper, 4 Lower)	900546	360 004 051	102.008
	24" IPS x 20" DIPS (4 Upper, 4 Lower)	900547	360 004 052	61.994
	14" IPS Mitered Liner, 11.25°	900543	360 004 048	30.005
	16" IPS Mitered Liner, 11.25°	900544	360 004 049	19.996
	18" IPS Mitered Liner, 11.25°	900545	360 004 050	65.499
	20" IPS Mitered Liner, 11.25°	900556	360 004 057	47.510

### FUSION EQUIPMENT: Accessories/Replacement Parts 824EP

- Please call for pricing and availability.

Description	GFCP Part No.	GF Part No.	weight (lb)
Facer Blade Set	500301	360 002 904	1.720
Ultra Light, Stub End 24" Fitting Holder	800038	360 002 919	52.007
Heater Blanket	600160	360 004 398	2.866
Butt Plate Set	600263	360 002 914	27.007
Pipe Stand	800150	360 002 921	150.003

# 1442EP Fusion Machine



## FUSION EQUIPMENT: System Assembly 1442EP

- Please call for pricing and availability.

Description	GFCP Part No.	GF Part No.	weight (lb)
System Assembly	280242305040	360 003 321	9650.162



## FUSION EQUIPMENT: Facer 1442EP

- Please call for pricing and availability.

Description	GFCP Part No.	GF Part No.	weight (lb)
42" Facer Assembly	288242375030	360 006 483	5.004



## FUSION EQUIPMENT: Carriage 1442EP

- Please call for pricing and availability.

Description	GFCP Part No.	GF Part No.	weight (lb)
Clamping Unit	288242400030	360 005 969	0.002



## FUSION EQUIPMENT: Heater 1442EP

- Please call for pricing and availability.

Description	GFCP Part No.	GF Part No.	weight (lb)
Heater Assembly	288242350030	360 007 169	336.999

## FUSION EQUIPMENT: Cart 1442EP

- Please call for pricing and availability.

Description	GFCP Part No.	GF Part No.	weight (lb)
Cart Assembly	288242500030	360 005 669	0.002



**FUSION EQUIPMENT: Liner Set  
1442EP**

- \*Requires 36" IPS Master
- \*\*Requires both 36" IPS and 630mm Masters
- \*\*\*Requires 36" IPS, 630mm and 18" IPS Masters
- Please call for pricing and availability.

<...>	Description	GFCP Part No.	GF Part No.	weight (lb)
*	36" IPS x 26" IPS (4 Upper, 4 Lower)	280242654040	360 004 016	360.01
*	36" IPS x 28" IPS (4 Upper, 4 Lower)	280242645040	360 003 935	636.01
*	36" IPS x 30" IPS (4 Upper, 4 Lower)	280242615040	360 003 323	579.00
*	36" IPS x 32" IPS (4 Upper, 4 Lower)	280242612040	360 004 011	469.01
*	36" IPS x 34" IPS	280242609040	360 003 922	225.00
	Master 42" IPS x 36" IPS (4 Upper, 4 Lower)	280242606040	360 003 322	290.00
*	Master 36" IPS x 630mm (4 Upper, 4 Lower)	280242624040	360 003 324	410.02
*	36" IPS x 710mm (4 Upper, 4 Lower)	280242621040	360 003 907	300.01
*	36" IPS x 800mm (4 Upper, 4 Lower)	280242618040	360 003 908	235.01
	42" IPS x 900mm (4 Upper, 4 Lower)	280242603040	360 003 909	275.00
	42" IPS x 1000mm	280242600040	360 003 910	570.01
***	18" IPS x 14" IPS (4 Upper, 4 Lower)	280218606040	360 003 314	121.01
***	18" IPS x 16" IPS (4 Upper, 4 Lower)	280218603040	360 003 313	74.01
***	18" IPS x 14" DIPS (4 Upper, 4 Lower)	280218656040	360 003 970	98.00
***	18" IPS x 16" DIPS (4 Upper, 4 Lower)	280218653040	360 003 969	80.01
**	630mm x 500mm (4 Upper, 4 Lower)	280242642040	360 003 911	114.99
**	630mm x 560mm (4 Upper, 4 Lower)	280242639040	360 003 912	85.01
**	Master 630mm x 18" IPS (4 Upper, 4 Lower)	280242651040	360 004 008	260.01
**	630mm x 20" IPS (4 Upper, 4 Lower)	280242633040	360 004 015	110.01
**	630mm x 22" IPS (4 Upper, 4 Lower)	280242648040	360 004 023	89.99
**	630mm x 24" IPS	280242627040	360 003 325	61.00
**	Master 630mm x 18" DIPS (4 Upper, 4 Lower)	280242636040	360 003 913	114.99
**	630mm x 20" DIPS (4 Upper, 4 Lower)	280242630040	360 003 914	100.00

**FUSION EQUIPMENT: Accessories/Replacement Parts  
1442EP**

- Please call for pricing and availability.

Description	GFCP Part No.	GF Part No.	weight (lb)
Facer Blade Set	280242398040	360 003 872	5.004
Hydraulic Extension Hose Assembly	288242510030	360 003 897	60.010
Power Extension Cord	288242372020	360 004 168	5.004
RTD Extension Cord	288242371020	360 004 188	5.004
Ditch Kit Accessory Set	280242401040	360 004 129	475.008
Heater Light-Out Channel	288242363020	360 008 210	19.996
Heater/Facer Storage Frame	288242596020	360 010 298	300.005
Pipe Stand	288242580030	360 008 830	169.998

# OR1500 Sidewall



## SIDEWALL: System OR1500 Size: 1 1/4 - 4" IPS

- Approval: ASTM F2620
- Please call for pricing and availability.

Pressure (psi)	Description	GFCP Part No.	GF Part No.	weight (lb)
1500# Gauge	No Pipe Holder, 4.50 Fitting Holder	280602845140	360 006 682	24.008
1500# Gauge	4 Rounding Shell, 4.50 Fitting Holder	280602844140	360 006 680	39.992
1500# Gauge	5 - 8" Chain Shell, 4.50 Fitting Holder	280602861140	360 006 683	42.990
600# Gauge	No Pipe Holder, 4.50 Fitting Holder	280602845040	360 006 691	25.993
600# Gauge	4 Rounding Shell, 4.50 Fitting Holder	280602844040	360 006 689	7.760
600# Gauge	5 - 8" Chain Shell, No Fitting Holder	280602861040	360 006 690	50.993
600# Gauge	4 Rounding Shell, 2.75 Fitting Holder	280602824040	360 006 688	36.001
300# Gauge	No Pipe Holder, 4.50 Fitting Holder	280602845240	360 006 687	24.008
300# Gauge	4 Rounding Shell, 4.50 Fitting Holder	280602844240	360 006 684	33.003
300# Gauge	5 - 8" Chain Shell, 4.50 Fitting Holder	280602861240	360 006 686	42.990
300# Gauge	5 - 8" Chain Shell, 2.75 Fitting Holder	280602861540	360 006 685	44.004
1500# Gauge	5 - 8" Chain Shell, 2.75 Fitting Holder	280602861340	360 006 681	44.004

## SIDEWALL: Accessory OR1500

- Please call for pricing and availability.

Description	GFCP Part No.	GF Part No.	weight (lb)
TD - 1 Heater 120V	288153030030	360 003 337	6.217
TD - 1 Heater 240V	288153033030	360 007 171	5.004
TD - 3 Heater 120V	280153300040	360 003 277	9.370
TD - 3 Heater 240V	280153350040	360 007 173	10.009
TD - 1 Heater with Sidewinder Adapter Kit 120V	288153130030	360 007 170	7.562
Carrying Case	288602985010	360 008 682	20.000
Surface Pyrometer	288559120010	360 009 192	1.499
Chain Ext Kit	288602863030	360 005 827	0.926

## SIDEWALL: Pipe Holder OR1500

- Please call for pricing and availability.

Description	GFCP Part No.	GF Part No.	weight (lb)
4 IPS Pipe Shell	280602445040	360 008 816	10.935
Chain Shell Assembly	280602635040	360 008 817	18.695

**SIDEWALL: Rounding Shell Liner  
OR1500**

- Please call for pricing and availability.

Description	GFCP Part No.	GF Part No.	weight (lb)
1 1/4 IPS	<b>280602234040</b>	<b>360 006 652</b>	4.806
1 1/2 IPS	<b>280602237040</b>	<b>360 006 653</b>	4.608
2 IPS	<b>280602231040</b>	<b>360 006 654</b>	5.093
3 IPS	<b>280602241040</b>	<b>360 006 655</b>	2.734

**SIDEWALL: Chain Shell Bolster Plate  
OR1500**

- Please call for pricing and availability.

Description	GFCP Part No.	GF Part No.	weight (lb)
2 Chain Shell Bolster	<b>288602872020</b>	<b>360 005 833</b>	2.006
3 Chain Shell Bolster	<b>288602873020</b>	<b>360 005 834</b>	4.497
4 Chain Shell Bolster	<b>288602874020</b>	<b>360 005 835</b>	5.490
6 Chain Shell Bolster	<b>288602875020</b>	<b>360 005 415</b>	7.496

**SIDEWALL: Fitting Holder  
OR1500**

- Please call for pricing and availability.

Description	GFCP Part No.	GF Part No.	weight (lb)
2.75 Fitting Holder	<b>288602833030</b>	<b>360 006 542</b>	3.880
4.5 Fitting Holder	<b>288602815030</b>	<b>360 006 543</b>	3.219

**SIDEWALL: Fitting Holder Liner  
OR1500**

- Please call for pricing and availability.

Description	GFCP Part No.	GF Part No.	weight (lb)
2.75" x .625"	<b>280602896040</b>	<b>360 006 642</b>	0.992
2.75" x 1.050"	<b>280602895040</b>	<b>360 006 643</b>	0.529
2.75" x 1.325"/1.315"	<b>280602893040</b>	<b>360 006 644</b>	0.551
2.75" x 1.385"/1.340"	<b>280602891040</b>	<b>360 006 645</b>	0.705
2.75" x 1.45"/1.44"	<b>280602889040</b>	<b>360 006 646</b>	0.992
2.75" x 1.68"/1.66"	<b>280602887040</b>	<b>360 006 647</b>	0.992
2.75" x 1.83"/1.8"	<b>280602885040</b>	<b>360 006 648</b>	0.705
2.75" x 1.9"/1.865"	<b>280602883040</b>	<b>360 006 649</b>	0.419
2.75" x 2.0"	<b>280602882040</b>	<b>360 006 641</b>	0.639
2.75" x 2.27"/2.25"	<b>280602880040</b>	<b>360 006 650</b>	0.287
4.5" x 2.375"	<b>280602859040</b>	<b>360 006 656</b>	1.521
4.5" x 2.46"/2.4"	<b>280602855040</b>	<b>360 006 657</b>	1.499
4.5" x 3.055"	<b>280602854040</b>	<b>360 006 658</b>	1.257
4.5" x 3.3"	<b>280602853040</b>	<b>360 006 659</b>	1.190
4.5" x 3.55"/3.5"	<b>280602850040</b>	<b>360 006 660</b>	0.794

# OR3000 Sidewall

## SIDEWALL: System OR3000

- Please call for pricing and availability.

Description	GFCP Part No.	GF Part No.	weight (lb)
Outrider 3000	288603250030	360 008 684	66.006



## SIDEWALL: Accessory OR3000

- Please call for pricing and availability.

Description	GFCP Part No.	GF Part No.	weight (lb)
Chain Shell Assembly	280602636040	360 005 832	19.996
TD - 1 Heater 120V	288153030030	360 003 337	6.217
TD - 1 Heater 240V	288153033030	360 007 171	5.004
TD - 3 Heater 120V	280153300040	360 003 277	9.370
TD - 3 Heater 240V	280153350040	360 007 173	10.009
TD - 5 Heater 120V	600320	360 007 174	35.009
TD - 1 Heater with Sidewinder Adapter Kit 120V	288153130030	360 007 170	7.562

## SIDEWALL: Rounding Shell Liner OR3000

- Please call for pricing and availability.

Description	GFCP Part No.	GF Part No.	weight (lb)
4" x 1 1/4"	280602234040	360 006 652	4.806
4" x 1 1/2"	280602237040	360 006 653	4.608
4" x 2"	280602231040	360 006 654	5.093
4" x 3"	280602241040	360 006 655	2.734
Surface Pyrometer	288559120010	360 009 192	1.499
Chain Ext Kit	288602863030	360 005 827	0.926

## SIDEWALL: Fitting Holder OR3000

- Please call for pricing and availability.

Description	GFCP Part No.	GF Part No.	weight (lb)
2.75" Fitting Holder	288602833030	360 006 542	3.880
4.5" Fitting Holder	288602815030	360 006 543	3.219
8" DIPS	288602785030	360 006 538	8.995
Fitting Holder Adapter	288603290040	360 006 536	3.131

**SIDEWALL: Chain Shell Bolster Plate Set  
OR3000**

- Please call for pricing and availability.

Description	GFCP Part No.	GF Part No.	weight (lb)
3	280602996140	360 008 685	5.004
4	280602997140	360 008 686	5.997

**SIDEWALL: Fitting Holder Liner  
OR3000**

- Please call for pricing and availability.

Description	GFCP Part No.	GF Part No.	weight (lb)
2.75" x .625"	280602896040	360 006 642	0.992
2.75" x 1.050"	280602895040	360 006 643	0.529
2.75" x 1.325"/1.315"	280602893040	360 006 644	0.551
2.75" x 1.385"/1.340"	280602891040	360 006 645	0.705
2.75" x 1.45"/1.44"	280602889040	360 006 646	0.992
2.75" x 1.68"/1.66"	280602887040	360 006 647	0.992
2.75" x 1.83"/1.8"	280602885040	360 006 648	0.705
2.75" x 1.9"/1.865"	280602883040	360 006 649	0.419
2.75" x 2.0"	280602882040	360 006 641	0.639
2.75" x 2.27"/2.25"	280602880040	360 006 650	0.287
4.5" x 2.375"	280602859040	360 006 656	1.521
4.5" x 2.46"/2.4"	280602855040	360 006 657	1.499
4.5" x 3.055"	280602854040	360 006 658	1.257
4.5" x 3.3"	280602853040	360 006 659	1.190
4.5" x 3.55"/3.5"	280602850040	360 006 660	0.794
8" DIPS x 8" IPS	900918	360 006 661	0.992
8" IPS x 6" DIPS	900916	360 004 007	3.990
8" IPS x 6" IPS	900914	360 006 663	5.004

# Parts and Accessories

## FUSION EQUIPMENT: Heater

- Please call for pricing and availability.

Description	Voltage	GFCP Part No.	GF Part No.	weight (lb)
Heater Assembly, TD-1	120V	288153030030	360 003 337	6.217
Heater Assembly, TD-1	240V	288153033030	360 007 171	5.004
Heater Assembly, TD-3	120V	280153300040	360 003 277	9.370
Heater Assembly, TD-3	240V	280153350040	360 007 173	10.009
Model 4SW Electric Heater		5560022	360 001 623	5.666
Model 4 Gas Fired Heater		5560023	360 001 622	7.430

## FUSION EQUIPMENT: Heater Face Sets

Please call for pricing and availability.

Size (inch)	Description	GFCP Part No.	GF Part No.	weight (lb)
1.25" IPS	Rectangle Base, Service, High Profile	10013443	360 006 614	0.002
1.50" IPS	Rectangle Base, Service, High Profile	10013444	360 006 615	0.002
2" IPS	Rectangle Base, Service, High Profile	10013151	360 006 620	0.002
3" IPS	Rectangle Base, Service, High Profile	10013152	360 006 623	0.002
4" IPS	Rectangle Base, Service, High Profile	10013153	360 006 626	3.990
6" IPS	Rectangle Base, Service, High Profile	10013154	360 006 629	0.002
8" IPS	Rectangle Base, Service, High Profile	10013155	360 006 632	0.002
10" IPS	Rectangle Base, Service, High Profile	10013156	360 006 616	0.002
12" IPS	Rectangle Base, Service, High Profile	10013157	360 006 618	0.002
2" IPS	Round Base, Branch, High Profile	10013158	360 006 621	0.002
3" IPS	Round Base, Branch, High Profile	10013159	360 006 624	3.616
4" IPS	Round Base, Branch, High Profile	10013160	360 006 627	4.652
6" IPS	Round Base, Branch, High Profile	10013161	360 006 630	0.002
8" IPS	Round Base, Branch, High Profile	10013162	360 006 633	3.990
10" IPS	Round Base, Branch, High Profile	10013163	360 006 617	0.002
12" IPS	Round Base, Branch, High Profile	10013164	360 006 619	0.002
6" DIPS	Rectangle Base, Service, High Profile	10013466	360 006 628	0.002
8" DIPS	Rectangle Base, Service, High Profile	10013469	360 006 631	0.002

table continued on the next page

Size (inch)	Description	GFCP Part No.	GF Part No.	weight (lb)
12" DIPS	Round Base, Branch, High Profile	<b>10013816</b>	<b>360 028 321</b>	0.022
1.25" IPS	Rectangle Base, Service, Low Profile	<b>288101855030</b>	<b>360 003 516</b>	2.094
1.50" IPS	Rectangle Base, Service, Low Profile	<b>288101860030</b>	<b>360 003 517</b>	1.962
2" IPS	Rectangle Base, Service, Low Profile	<b>288101865030</b>	<b>360 003 518</b>	2.293
3" IPS	Rectangle Base, Service, Low Profile	<b>288101870030</b>	<b>360 003 519</b>	2.447
4" IPS	Rectangle Base, Service, Low Profile	<b>288101875030</b>	<b>360 003 520</b>	2.690
6" IPS	Rectangle Base, Service, Low Profile	<b>288101880030</b>	<b>360 003 521</b>	2.249
8" IPS	Rectangle Base, Service, Low Profile	<b>288101885030</b>	<b>360 003 522</b>	0.000
2" IPS	Rectangle Base, Mul- ti-Saddle, Low Profile	<b>288103305030</b>	<b>360 003 523</b>	0.000
3" IPS	Rectangle Base, Mul- ti-Saddle, Low Profile	<b>288103310030</b>	<b>360 003 524</b>	0.000
4" IPS	Rectangle Base, Mul- ti-Saddle, Low Profile	<b>288103315030</b>	<b>360 003 525</b>	0.000
6" IPS	Rectangle Base, Mul- ti-Saddle, Low Profile	<b>288103320030</b>	<b>360 003 526</b>	0.000
3" IPS x 2" IPS	Rectangle Base, Branch, Low Profile	<b>288103425030</b>	<b>360 006 622</b>	0.002
4" IPS x 2" IPS	Rectangle Base, Branch, Low Profile	<b>288103430030</b>	<b>360 006 625</b>	0.002

# Socket Fusion Equipment

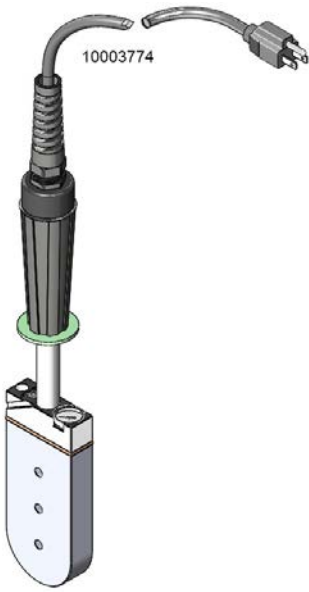

## FUSION EQUIPMENT: Heater

- Please call for pricing and availability.

Description	GFCP Part No.	GF Part No.	weight (lb)	Description
Model 2 Electric Heater	5560021	360 001 621	4.145	Model 2 Electric Heater
Model SF3 Heater	10003774	360 001 626	4.519	Model SF3 Heater
Hothead Gas Fired Heater	5560024	360 004 346	3.660	Hothead Gas Fired Heater





## FUSION EQUIPMENT: Cold Ring

- Please call for pricing and availability.

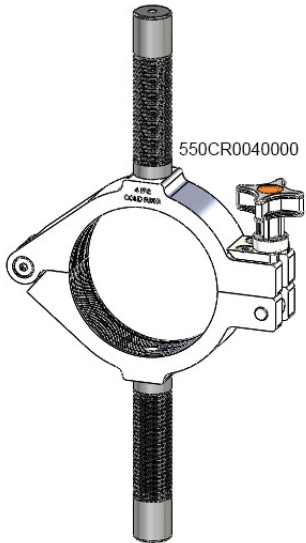

Description	Size	GFCP Part No.	GF Part No.	weight (lb)
Locking Pliers Style	1/2" CTS	550CR0620000	360 000 698	1.190
Locking Pliers Style	3/4" CTS	288107140030	360 003 332	1.058
Locking Pliers Style	1" CTS	550CR0110000	360 000 696	1.190
Locking Pliers Style	1 1/4" CTS	288107270032	360 005 999	1.213
Locking Pliers Style	1 1/2" CTS	288107272032	360 004 353	1.808
Locking Pliers Style	1/2" IPS	550CR0500000	360 000 699	1.411
Locking Pliers Style	3/4" IPS	550CR0750000	360 000 701	1.411
Locking Pliers Style	1" IPS	550CR0010000	360 000 697	1.411
Locking Pliers Style	1 1/4" IPS	550CR0120000	360 000 695	1.301
Locking Pliers Style	1 1/2" IPS	550CR0150000	360 000 694	2.006
Locking Pliers Style	2" IPS	550CR0020000	360 000 700	1.896
Clamp Style	3" IPS	550CR0030000	360 004 354	3.131
Clamp Style	4" IPS	550CR0040000	360 000 702	5.379
Clamp Style	6" IPS	000505	360 005 994	0.772

## FUSION EQUIPMENT: Fitting Holder

- Please call for pricing and availability.

Size	GFCP Part No.	GF Part No.	weight (lb)
2" IPS	000235	360 002 882	2.227
3" IPS	000327	360 003 437	5.335
4" IPS	000330	360 003 438	6.658

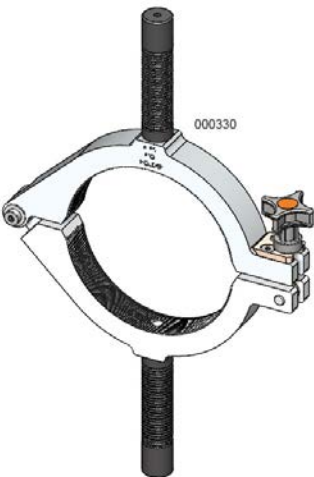
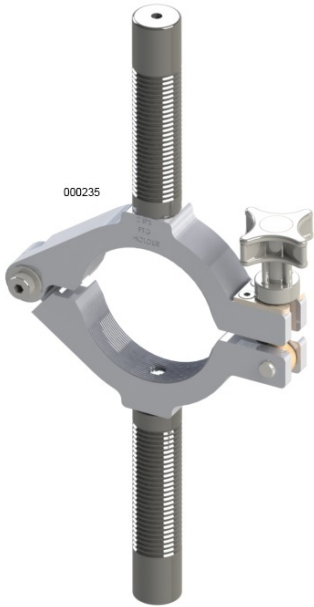



## FUSION EQUIPMENT: Chamfer Tool and Depth Gage

- Please call for pricing and availability.
- \*Approval: ASTM D2513
- Approval: ASTM F1056

Description	Size	GFCP Part No.	GF Part No.	weight (lb)
Chamfer/Depth Gage	1/2" CTS	10006069	360 000 673	0.154
Chamfer/Depth Gage	1/2" IPS	10006070	360 000 674	0.176
Chamfer/Depth Gage	3/4" IPS	10006071	360 000 675	0.220
Chamfer/Depth Gage	1" CTS	10006072	360 000 676	0.220
Chamfer/Depth Gage	1" IPS	10006073	360 000 677	0.198
Chamfer/Depth Gage	1-1/4" IPS	10006074	360 000 678	0.265
Chamfer/Depth Gage	1-1/2" IPS	10006075	360 000 679	0.331
Chamfer/Depth Gage	2" IPS	10006076	360 000 680	0.463
Chamfer/Depth Gage	3/4" CTS	288151410030	360 003 334	0.198
Chamfer/Depth Gage	1-1/4" CTS	288151430030	360 005 856	0.397
Chamfer/Depth Gage	1-1/2" CTS	288151442030	360 005 857	0.419
Chamfer/Depth Gage	2" CTS	288151447030	360 005 858	0.772
Chamfer/Depth Gage	3" IPS	288151460030	360 004 348	0.904
Chamfer/Depth Gage	4" IPS	288151465030	360 003 335	2.315
*Replacement Kit, Blade and Screws	all sizes	5500025	360 000 670	0.022
*Socket/Depth Gage	1/2" CTS	288108800010	360 003 333	0.110
*Socket/Depth Gage	1/2" IPS	555DG1500000	360 004 351	0.088
*Socket/Depth Gage	3/4" IPS	555DG1750000	360 000 725	0.066
*Socket/Depth Gage	1" CTS	288108820010	360 004 352	0.132
*Socket/Depth Gage	1" IPS	555DG1010000	360 000 722	0.110
*Socket/Depth Gage	1-1/4" IPS	555DG1120000	360 000 721	0.220
*Socket/Depth Gage	1-1/2" IPS	555DG1150000	360 000 720	0.132
*Socket/Depth Gage	2" IPS	555DG1020000	360 000 723	0.331
*Socket/Depth Gage	3" and 4" IPS	555DG2030400	360 000 724	2.535

**FUSION EQUIPMENT: Plug and Socket**

- Please call for pricing and availability.

Description	Size
Socket Face Set, Model SF3 Plug and Socket	3/4" IPS
Socket Face Set, Model SF3 Plug and Socket	1" IPS
Socket Face Set, Model SF3 Plug and Socket	1-1/4" IPS
Socket Face Set, Model SF3 Plug and Socket	1/2" CTS
Socket Face Set, Model SF3 Plug and Socket	1/2" IPS
Socket Face Set, Model SF3 Plug and Socket	1" CTS
Socket Face Set, Model SF3 Plug and Socket	1-1/2" IPS
Socket Face Set, Model SF3 Plug and Socket	2" IPS
Socket Face and Tooling Set, Model SF3	1/2" CTS
Socket Face and Tooling Set, Model SF3	1/2" IPS
Socket Face and Tooling Set, Model SF3	3/4" IPS
Socket Face and Tooling Set, Model SF3	1" CTS
Socket Face and Tooling Set, Model SF3	1" IPS
Socket Face and Tooling Set, Model SF3	1-1/4" IPS
Socket Face and Tooling Set, Model SF3	1-1/2" IPS
Socket Face and Tooling Set, Model SF3	2" IPS
Socket Face Set, Plug and Socket	1/2" CTS
Socket Face Set, Plug and Socket	1/2" IPS
Socket Face Set, Plug and Socket	3/4" CTS
Socket Face Set, Plug and Socket	3/4" IPS
Socket Face Set, Plug and Socket	1" CTS
Socket Face Set, Plug and Socket	1" IPS
Socket Face Set, Plug and Socket	1-1/4" CTS
Socket Face Set, Plug and Socket	1-1/4" IPS
Socket Face Set, Plug and Socket	1-1/2" IPS
Socket Face Set, Plug and Socket	2" IPS
Standard Plug and Socket	1" IPS
Standard Plug and Socket	2" IPS
Standard Plug and Socket	3" IPS
Standard Plug and Socket	4" IPS
Standard Plug and Socket	1-1/4" IPS
Standard Plug and Socket	1-1/2" IPS
Standard Plug and Socket	1/2" IPS
Standard Plug and Socket	1/2" CTS
Standard Plug and Socket	3/4" IPS

GFCP Part No.	GF Part No.	weight (lb)
10006170	360 002 234	0.309
10006171	360 002 230	0.507
10006172	360 002 228	0.507
10006662	360 002 231	0.243
10006663	360 002 232	0.243
10006664	360 002 229	0.419
10006665	360 002 227	0.772
10006666	360 002 233	0.926
10007307	360 003 760	2.491
10007308	360 003 761	2.491
10007309	360 003 762	2.646
10007310	360 003 763	2.646
10007311	360 003 066	2.800
10007312	360 003 764	3.880
10007313	360 003 765	3.109
10007314	360 003 766	3.285
280150800040	360 003 268	0.331
280150805040	360 009 887	0.331
280150810040	360 003 269	0.397
280150815040	360 003 270	1.962
280150820040	360 003 515	0.661
280150825040	360 003 271	0.529

table continued on the next page

<b>GFCP Part No.</b>	<b>GF Part No.</b>	<b>weight (lb)</b>
280150830040	360 009 888	0.002
280150835040	360 003 272	0.860
280150845040	360 003 273	0.860
280150855040	360 003 274	1.168
555SP2010000	360 002 220	0.485
555SP2020000	360 002 223	0.948
555SP2030000	360 002 224	1.764
555SP2040000	360 002 226	3.241
555SP2120000	360 002 218	0.463
555SP2150000	360 002 217	0.728
555SP2500000	360 002 222	0.220
555SP2620000	360 002 221	0.265
555SP2750000	360 002 225	0.287

---

# Socket Fusion Kits

## FUSION EQUIPMENT: Model SF3 Base Fusion Kit

Please call for pricing and availability.

Description	GFCP Part No.	GF Part No.	weight (lb)
Model SF3 Base Fusion Kit	10007306	360 001 738	15.719

### Kit includes:

- Model SF3 Heater
- Model SF3 Heater Muff
- Clamp Bracket Assembly
- 1 5/8" Capacity Ratchet Cutter
- 500° Temp-Stik
- 525° Temp-Stik
- Digital Countdown Timer
- Wrench, Hex Key 3/16"
- Wrench, Hex Key Screwdriver 3/16"
- Professional Tool Box
- Procedure Manual

---

## FUSION EQUIPMENT: Model SF3 Intermediate Fusion Kit

Please call for pricing and availability.

Description	GFCP Part No.	GF Part No.	weight (lb)
Model SF3 In- termediate Fu- sion Kit	10006132	360 001 737	20.283

### Kit includes:

- Model SF3 Heater
- Model SF3 Heater Muff
- Clamp Bracket Assembly
- 1 5/8" Capacity Ratchet Cutter
- 3/4" IPS Socket Tooling Kit
- 1 1/4" IPS Plug & Socket
- 500° Temp-Stik
- 525° Temp-Stik
- Digital Countdown Timer
- Wrench, Hex Key 3/16"
- Wrench, Hex Key Screwdriver 3/16"
- Chamfer Depth Gage .75" IPS
- Chamfer Depth Gage 1.25" IPS
- 3/4" Cold Ring
- 1 1/4" Cold Ring
- Professional Tool Box
- Procedure Manual

## FUSION EQUIPMENT: Model SF3 Full Fusion Kit

Please call for pricing and availability.

Description	GFCP Part No.	GF Part No.	weight (lb)	Description
Model SF3 Full Fusion Kit	<b>10007147</b>	<b>360 001 736</b>	35.009	Model SF3 Full Fusion Kit

### Kit includes:

- Model SF3 Heater
- Model SF3 Heater Muff
- Clamp Bracket Assembly
- 1/2" IPS Plug & Socket
- 3/4" IPS Plug & Socket
- 1" IPS Plug & Socket
- 1 1/4" IPS Plug & Socket
- 1 1/2" IPS Plug & Socket
- 2" IPS Plug & Socket
- Chamfer Depth Gage 1/2" IPS
- Chamfer Depth Gage 3/4" IPS
- Chamfer Depth Gage 1" IPS
- Chamfer Depth Gage 1 1/4" IPS
- Chamfer Depth Gage 1 1/2" IPS
- Chamfer Depth Gage 2" IPS
- 1/2" IPS Cold Ring
- 3/4" IPS Cold Ring
- 1" IPS Cold Ring
- 1 1/4" IPS Cold Ring
- 1 1/2" IPS Cold Ring
- 2" IPS Cold Ring
- 1 5/8" Capacity Ratchet Cutter
- 2 1/2" Capacity Ratchet Cutter
- 500° Temp-Stik
- 525° Temp-Stik
- Digital Countdown Timer
- Wrench, Hex Key 3/16"
- Wrench, Hex Key Screwdriver 3/16"
- Professional Tool Box
- Procedure Manual

# Parts and Accessories



## FUSION EQUIPMENT: General Tool

- Please call for pricing and availability.

Description	GFCP Part No.	GF Part No.	weight (lb)
Driver Punch 1/2" Hex with 11" Handle, Service Tee	5750007	360 000 733	1.080
Driver Punch 1/2" Hex with 18" High Volume Tee	5750202	360 000 734	2.072
WBVTT Punch Tool 5/8" Hex Heavy Duty with 18" Handle	5751907	360 000 735	4.123
Standard Tapping Tee Test Cap with 1/8" NPT Male	6920980	360 002 988	0.243
Rerounding Tool, 12" - 20" IPS/DIPS	10003956	360 002 531	0.000
Rerounding Tool, 20" - 28" IPS, 20" - 24" DIPS	10003957	360 002 532	112.001



**ELECTROFUSION TOOLS: General Tool**

- Please call for pricing and availability.



Description	GFCP Part No.	GF Part No.	weight (lb)
WBHVTT Punch Tool 3/4" Sq Ratchet Drive x 5/8" Hex Blow By Restrictor	5758111	360 000 730	4.519
Ratchet Wrench with 3/4" Sq Female Open End Socket	9001304	360 003 002	5.754
Wide Body HVTT Test Cap with 1/8" NPT Male	5758595	360 002 966	0.419
Driver HVTT Punch Tool 5/8" Hex Wide Body Blow By Restrictor	5758000	360 000 731	5.798

# Scrapers and Peelers

## ELECTROFUSION TOOLS: EMP Scraper Rotary Style

- Please call for pricing and availability.

Size	Description	GFCP Part No.	GF Part No.	weight (lb)
1 1/4" IPS		10001617	360 002 022	2.831
1 1/2" IPS		10001618	360 002 021	2.709
2" IPS		10001619	360 002 024	2.449
3" IPS		10001623	360 002 026	4.251
4" IPS		10001624	360 002 028	5.800
6" IPS		10001625	360 002 031	7.311
8" IPS		10001626	360 002 033	8.561
1 1/4" IPS, 2" IPS	Stiffener Combo	10002070	360 010 235	0.002

## ELECTROFUSION TOOLS: Ritmo Scraper

- Please call for pricing and availability.

Size	Description	GFCP Part No.	GF Part No.	weight (lb)
355MM-710MM ISO, 14"-28" IPS, 14"-24" DIPS	Pipe Scraper RTC 710 shipped in two different boxes	10003964	360 002 037	86.002
75MM-315MM ISO, 3"-12" IPS/ DIPS	Pipe Scraper RTC 315-A	5752206	360 002 036	19.004
50MM-160MM ISO, 2"-6" IPS/ DIPS	Pipe Scraper RTC 160	5752278	360 002 035	8.510

## ELECTROFUSION TOOLS: Mini Peeler

- Please call for pricing and availability.



Size	GFCP Part No.	GF Part No.	weight (lb)
1/2" CTS	10013546	360 029 235	0.485
1/2" IPS	10013547	360 029 236	0.595
3/4" IPS	10013549	360 029 237	0.772
1" CTS	10013550	360 029 238	0.750
1" IPS	10013551	360 029 239	0.926
1 1/4" IPS	10013553	360 029 240	1.190
3/4" IPS	10014663		
16 MM ISO	10014897		0.490
20 MM ISO	10014898		0.570
25 MM ISO	10014899		0.650
32 MM ISO	10014900		0.890
40 MM ISO	10014901		1.180
3/4" CTS	10013548		0.600
1 1/4" CTS	10013552		0.950



### ELECTROFUSION TOOLS: Rotary Peeler GF Piping Systems

- Please call for pricing and availability.

Size	GFCP Part No.	GF Part No.	weight (lb)
1 1/4" IPS	10014409	360 029 223	2.890
1 1/2" IPS	10014410	360 029 224	2.890
2" IPS	10014411	360 029 225	2.890
3" IPS	10014412	360 029 226	3.400
4" IPS	10014413	360 029 227	3.400
6" IPS	10014414	360 029 228	3.810
8" IPS	10014415	360 029 229	4.480
10" IPS	10014416	360 029 230	5.379
12" IPS	10014417	360 029 231	5.379

### ELECTROFUSION TOOLS: OEM Peeler Rotary Style

- Please call for pricing and availability.

Size	GFCP Part No.	GF Part No.	weight (lb)
1-1/4" IPS	10002723	360 002 023	2.141
2" IPS	10002724	360 002 025	2.330
3" IPS	10002725	360 002 027	2.712
4" IPS	10002726	360 002 029	3.600
6" IPS	10002727	360 002 032	5.291
8" IPS	10002728	360 002 034	5.997

### ELECTROFUSION TOOLS: OEM Pipe Surface Peeler

- Please call for pricing and availability.

Size	GFCP Part No.	GF Part No.	weight (lb)
3/4" CTS	10009286	360 009 554	1.349
1" CTS	10009287	360 009 556	1.301
1/2" IPS	10009288	360 009 553	1.349
3/4" IPS	10009289	360 009 555	1.281
1" IPS	10009290	360 009 557	1.329
1/2" CTS	10009285	360 009 552	1.360

### ELECTROFUSION TOOLS: Mandrel Stiffener

Please call for pricing and availability.

Size (inch)	Description	GF Part No.	weight (lb)
.5" CTS	.090 Wall	360 060 642	0.072
.5" IPS	DR9.3	360 060 643	0.130
.75" CTS	.090 Wall	360 060 644	0.246
.75" IPS	DR11	360 060 645	0.246
1" CTS	.099 Wall	360 060 646	0.280

table continued on the next page

Size (inch)	Description	GF Part No.	weight (lb)
1" IPS	DR11	<b>360 060 647</b>	0.378
1.25" CTS	.090 Wall	<b>360 060 648</b>	0.610
1.25" IPS	DR10	<b>360 060 649</b>	0.610
1.25" IPS	DR11	<b>360 060 650</b>	0.630

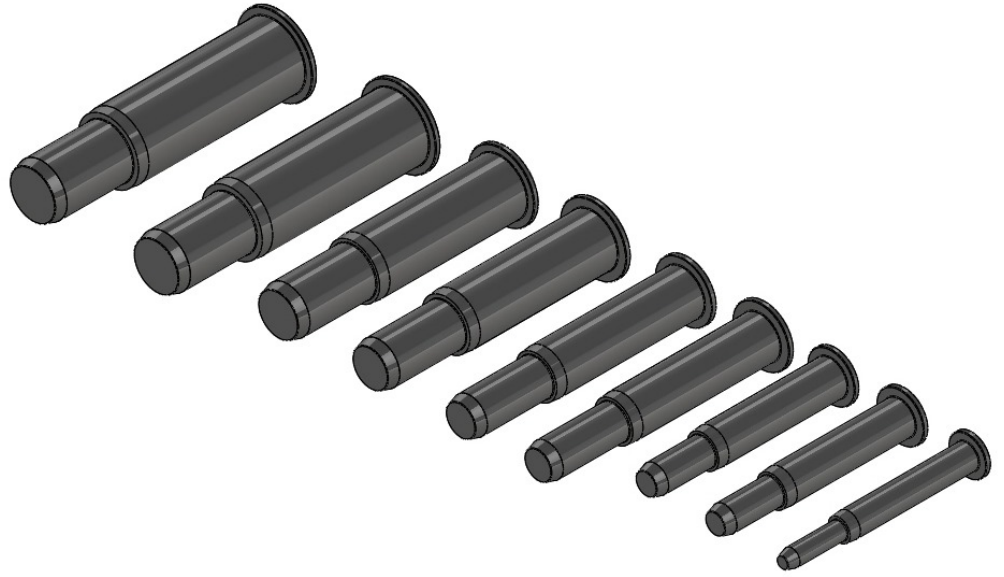

# Clamps



## ELECTROFUSION EQUIPMENT: Cast Mini Clamp

- Please call for pricing and availability.

Size	Description		GFCP Part No.	GF Part No.	weight (lb)
1/2" CTS	Full		<b>5752006</b>	<b>360 000 685</b>	1.190
1/2" IPS	Full		<b>5752005</b>	<b>360 000 686</b>	1.058
3/4" CTS	Full		<b>5752244</b>	<b>360 001 760</b>	1.808
3/4" IPS	Full		<b>5752004</b>	<b>360 000 682</b>	1.080
1" CTS	Full		<b>5752003</b>	<b>360 000 684</b>	1.102
1" IPS	Full		<b>5752002</b>	<b>360 000 681</b>	1.058
1-1/4" CTS	Full		<b>5752090</b>	<b>360 000 683</b>	0.992
3/4" IPS x 1/2" CTS	Reducing		<b>5752011</b>	<b>360 000 692</b>	1.058
1/2" IPS x 1/2" CTS	Reducing		<b>5752010</b>	<b>360 000 690</b>	1.036
1" IPS x 1/2" IPS	Reducing		<b>5752009</b>	<b>360 000 691</b>	1.124
1" IPS x 3/4" IPS	Reducing		<b>5752008</b>	<b>360 000 688</b>	1.014
1" IPS x 1" CTS	Reducing		<b>5752007</b>	<b>360 000 689</b>	1.014
1-1/4" CTS x 1" IPS	Reducing		<b>5752040</b>	<b>360 000 687</b>	0.992
1-1/4" CTS x 1" CTS	Reducing		<b>10000520</b>	<b>360 003 695</b>	1.014
1" CTS x 1/2" CTS	Reducing		<b>10000474</b>	<b>360 003 691</b>	1.080
1" CTS x 3/4" IPS	Reducing		<b>10000476</b>	<b>360 003 692</b>	1.080

## ELECTROFUSION EQUIPMENT: Side Wall Clamp

- Please call for pricing and availability.

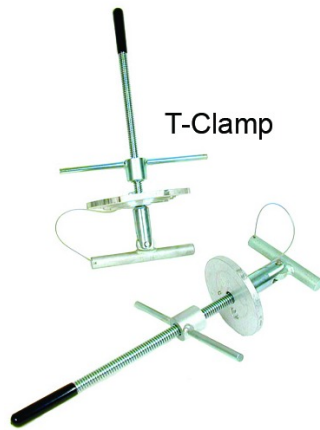
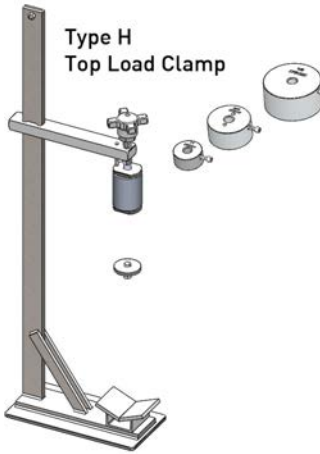
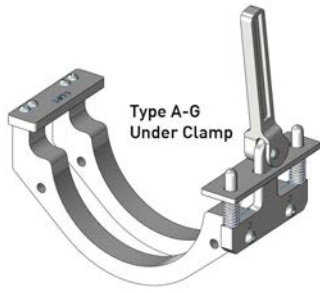

Size	Description	Clamp Type	GFCP Part No.	GF Part No.	weight (lb)
1-1/4" IPS	Saddle (Under) Clamp	A	5750014	360 002 058	1.190
1-1/2" IPS	Saddle (Under) Clamp	AA	5750019	360 002 057	1.918
2" CTS	Saddle (Under) Clamp	AB	5752093	360 002 059	2.579
2" IPS	Saddle (Under) Clamp	B	5750862	360 002 060	2.006
3" IPS	Saddle (Under) Clamp	C	5750863	360 002 061	0.992
4" IPS	Saddle (Under) Clamp	D	5750864	360 002 063	2.866
4" DIPS	Saddle (Under) Clamp	L	5751656	360 002 062	3.682
6" IPS	Saddle (Under) Clamp	E	5750865	360 002 066	2.998
6" DIPS	Saddle (Under) Clamp	M	5751644	360 002 065	4.255
4" x 4"	Saddle (Under) Clamp	F	5001063	360 002 064	4.894
6" x 4"	Saddle (Under) Clamp	G	5001080	360 002 067	13.162
8" IPS x 12" DIPS, 200MM x 400MM	Top Load Clamp	H	10006736	360 003 062	22.002
4" PSM and 4" IPS	T-Clamp	J	5750925	360 003 699	7.672
6" IPS, 6" PSM, 8" IPS	T-Clamp	K	5750926	360 002 948	10.119
1" x 12'	Ratchet Tie-Down Nylon Straps	N	9001287	360 009 217	1.951
8" IPS and Larger	Top Load Clamp, EF Tooling Strap Style, with Fitting Adapters		10014726		5.960



## ELECTROFUSION EQUIPMENT: Mini Clamp (Locking Plier)

- Please call for pricing and availability.

Size	Description
1 1/4" SIDR	Full, Locking Pliers Style
1 1/4" IPS x 1" CTS	Reducing, Locking Pliers Style
2" IPS x 1 1/4" IPS	Reducing, Locking Pliers Style, Wide Body Style
2" IPS	Bell Coupling, Locking Pliers Style
2" IPS	90L, Locking Pliers Style
1 1/4" IPS x 3/4" IPS	Reducing, Locking Pliers Style
1 1/4" IPS	Full, Locking Pliers Style
1 1/4" IPS x 1" IPS	Reducing, Locking Pliers Style
50MM ISO	Full, Locking Pliers Style
63MM ISO	Full, Locking Pliers Style, Wide Body Style
1 1/2" IPS	Full, Locking Pliers Style, Wide Body Style
2" IPS	Full, Locking Pliers Style, Wide Body Style
40MM ISO	Full, Locking Pliers Style
1 1/4" CTS	Full, Locking Pliers Style

GFCP Part No.	GF Part No.	weight (lb)
10006040		2.020
10008674	360 003 694	2.028
10012916	360 008 410	2.138
10013365	360 008 411	2.932
10014596		2.500
10014748		2.700
5752001	360 001 759	2.028
5752043	360 001 757	2.359
5752050	360 008 407	2.094
5752051	360 008 408	2.006
5752097	360 001 762	2.094
5752098	360 001 761	2.072
5752099	360 008 405	2.028
5752273	360 001 758	1.786

## ELECTROFUSION EQUIPMENT: Multi Clamp

- Please call for pricing and availability.

Size	Description	GFCP Part No.	GF Part No.	weight (lb)
2" - 4" IPS	Tee Swivel Kit	10014064		9.650
	Tee Swivel Kit	10015042		1.430
6" - 14" IPS	Mega Clamp Kit	5752080	360 002 949	28.556
2" - 4" IPS	Multi Clamp Kit	10013877	360 029 222	23.435
110MM ISO (457MM LG)	Metric Multi Clamp Kit		360 060 124	0.000
110MM ISO (610MM LG)	Metric Multi Clamp Kit		360 060 125	0.000
110MM ISO (489MM LG)	Metric Multi Clamp Kit		360 060 126	0.000
110MM ISO (610MM x 489MM)	Metric Multi Clamp Kit		360 060 127	0.000
	Swivel Base	10013873		0.850
13 1/4"	Bar Base	10013875	360 028 311	2.557
24"	Bar Base	10013876	360 028 313	4.630
	End Cap	10013881		0.470
18"	Bar Base	10014108	360 028 312	3.483
48"	Bar Base	10014109	360 028 314	9.259
19 1/4"	Bar Base	10014602		3.720

table continued on the next page

Size	Description	GFCP Part No.	GF Part No.	weight (lb)
8" IPS	FSEQ Kit, Strap Type, 4' Base	<b>10014950</b>		24.000
6" IPS	FSEQ Assembly, Single with Dove Tail	<b>10014499</b>	<b>360 029 215</b>	5.490
4" DIPS	FSEQ Assembly, Single with Dove Tail	<b>10014504</b>		3.310
6" DIPS	FSEQ Assembly, Single with Dove Tail	<b>10014517</b>		6.148

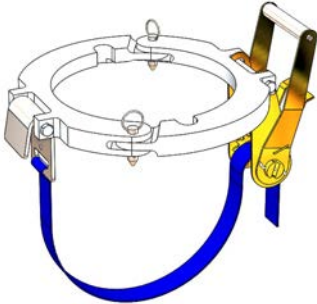

#### ELECTROFUSION EQUIPMENT: Branch Saddle Clamp

Please call for pricing and availability.

Size (inch)	Description	GFCP Part No.	GF Part No.	weight (lb)
12" and Larger	Type P Clamp, Main Sizes with 6" or 8" Outlets	<b>10009195</b>	<b>360 006 382</b>	11.508



# Re-rounding Tools



## ELECTROFUSION EQUIPMENT: Re-Rounding Tool

Please call for more information about our Re-Rounding Tool rental program.

- Please call for pricing and availability.

Size (inch)	Description	GFCP Part No.	GF Part No.	weight (lb)
12 to 20	IPS/DIPS TO IPS/DIPS	10003956	360 002 531	0.000
20 to 28	IPS/DIPS TO IPS/DIPS	10003957	360 002 532	112.001

# Squeeze Tools

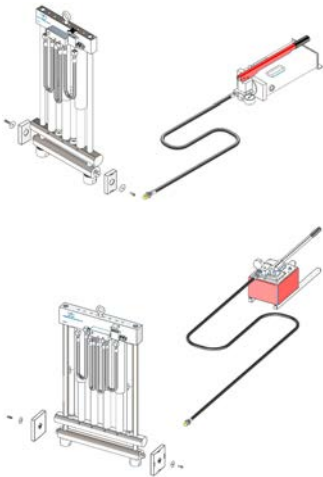

**SQUEEZE TOOLS: Hydraulic PolySqueez Tool**

- Please call for pricing and availability.

Size (inch)	GFCP Part No.	GF Part No.	weight (lb)
2" IPS x 4" IPS, DR11	10014739	360 029 256	66.998
4" IPS x 6" IPS, DR11	10014387	360 029 217	253.995
6" IPS x 8" IPS, DR11	10014389	360 029 341	208.998
10" IPS x 12" IPS, DR11	10014501	360 029 249	275.864



### SQUEEZE TOOLS: Hydraulic PolySqueez Accessory

- Please call for pricing and availability.

Description	GFCP Part No.	GF Part No.	weight (lb)
Static Ground Rod with 6' Cable and Heavy Duty Clip	281004001101	360 003 329	1.543
Gauge, Pressure, 10,000 PSI, Bottom Mount, 1/4 NPT, Glycerin Filled	000755003700	360 006 981	0.460

---



**SQUEEZE TOOLS: Mechanical PolySqueez Tool**

- Please call for pricing and availability.

Description	GFCP Part No.	GF Part No.	weight (lb)
SLP-2 without Stops and Carrying Case, Ref for 1/2" CTS - 2" IPS	<b>281002100099</b>	<b>360 003 328</b>	7.915
SLP-4 without Stops	<b>281004100099</b>	<b>360 010 095</b>	35.220



### SQUEEZE TOOLS: Mechanical PolySqueez Accessory

- Please call for pricing and availability.

Description	GFCP Part No.	GF Part No.	weight (lb)
Stop, SLP-2, Std, 1/2" CTS - 2" IPS, Requires 2	281602000202	360 010 264	0.110
Stop, SLP-4, Std, 2" IPS - 4" IPS, DR 11, Requires 2	281604000200	360 010 280	1.100
Static Ground Rod with 6' Cable and Heavy Duty Clip	281004001101	360 003 329	1.543
Wrench, Ratchet 1/2" Drive 16" Length	281500003200	360 010 952	1.655
Drive Socket, 5/8" Socket Size, 8 Point, 1/2" Square Drive	281500003100	360 006 361	0.212

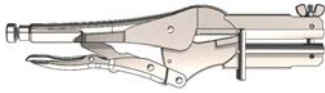

### SQUEEZE TOOLS: Service Line PolySqueeze Tool

- Please call for pricing and availability.

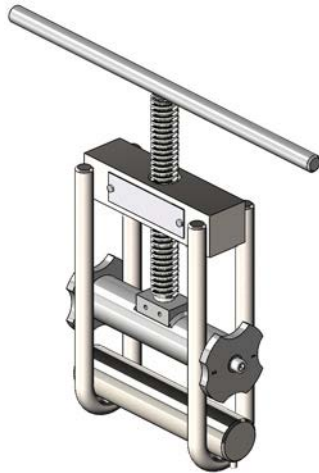

Description	Pipe Size	GFCP Part No.	GF Part No.	weight (lb)
Locking Pliers	1/2" CTS, 3/4" CTS, 1" CTS, 1-1/4" CTS	<b>280600501030</b>	<b>360 010 079</b>	2.320
Locking Pliers	3/4" CTS	<b>280600502030</b>	<b>360 010 080</b>	2.275
Locking Pliers	1/2" CTS, 3/4" CTS, 1" CTS, 1-1/4" CTS and 1/2" IPS (DR9.3), 3/4" IPS (DR11)	<b>280600503030</b>	<b>360 003 326</b>	2.601
Locking Pliers	1/2" CTS, 1" CTS	<b>280600504030</b>	<b>360 010 081</b>	2.610
Service Squeeze Tool	1/2" CTS - 1-1/4" CTS (6 Sizes, CTS and IPS)	<b>280004000041</b>	<b>360 003 267</b>	2.249
Mid-Range Squeeze Tool	1" IPS - 2" IPS (for Standard DR Sizes)	<b>280108021040</b>	<b>360 010 066</b>	8.686
Squeeze Off Tool	1/2" CTS - 2" IPS	<b>5570006</b>	<b>360 002 236</b>	10.494
Service Squeeze Tool	16MM to 40MM ISO, DR11	<b>10014448</b>		1.970
Squeeze Tool Assembly	32MM to 63MM ISO, DR11	<b>10014450</b>		8.720

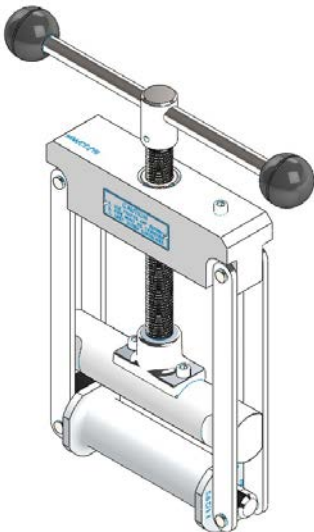



### SQUEEZE TOOLS: Service Line PolySqueez Accessory

- Please call for pricing and availability.

Description	GFCP Part No.	GF Part No.	weight (lb)
Static Ground Rod with 6' Cable and Heavy Duty Clip	281004001101	360 003 329	1.543

---



### SQUEEZE TOOLS: SteelSqueez Tool

- Please call for pricing and availability.

Size	Description	GFCP Part No.	GF Part No.	weight (lb)
3/4" - 2"	Hydraulic SLS-2B	281002000002	360 003 327	32.099
2" - 4"	Hydraulic SLS-4A	281004000002	360 010 107	150.003
6" IPS and 8" IPS	Hydraulic Assembly SLS-8B	281008100000	360 003 331	462.001



# Index

Part No.	Page	Part No.	Page	Part No.	Page	Part No.	Page
000235	48	10007314	50	10013577	21	101147	26
000327	48	10007734	10	10013578	21	101148	24
000330	48	10007735	8	10013579	21	101149	22
000505	47	10007749	10	10013580	21	101150	24
000755003700	68	10007817	10	10013582	21	101205	26
10000474	62	10008065	10	10013583	21	101231C	33
10000476	62	10008412	10	10013584	21	101350	20
10000520	62	10008674	64	10013585	21	101380	33
10001004	3	10009195	65	10013586	21	200445	14
10001005	3	10009285	60	10013587	21	200460	23, 25
10001617	59	10009286	60	10013606	21	200461	24, 26, 28
10001618	59	10009287	60	10013816	45	200463	22
10001619	59	10009288	60	10013873	64	200515	20
10001623	59	10009289	60	10013875	64	200520	33
10001624	59	10009290	60	10013876	64	280004000041	71
10001625	59	10011527	31	10013877	64	280108021040	71
10001626	59	10012034	2	10013881	64	280150800040	50
10002070	59	10012312	3	10013990	28	280150805040	50
10002412	4	10012313	3	10013991	28	280150810040	50
10002723	60	10012846	2	10014064	64	280150815040	50
10002724	60	10012849	3	10014108	64	280150820040	50
10002725	60	10012916	64	10014109	64	280150825040	50
10002726	60	10012994	3	10014171	4	280150830040	51
10002727	60	10013000	2	10014172	4	280150835040	51
10002728	60	10013001	2	10014335	1	280150845040	51
10002790	3	10013151	44	10014336	1	280150855040	51
10003774	46	10013152	44	10014376	1	280153300040	40, 42, 44
10003892	4	10013153	44	10014387	67	280153350040	40, 42, 44
10003956	54, 66	10013154	44	10014389	67	280153500040	13
10003957	54, 66	10013155	44	10014409	60	280204302040	11
10003964	59	10013156	44	10014410	60	280204304040	11
10003966	10	10013157	44	10014411	60	280204456040	10, 13
10003967	10	10013158	44	10014412	60	280204601040	15
10004000	8	10013159	44	10014413	60	280204603040	12, 15
10006040	64	10013160	44	10014414	60	280204605040	12, 15
10006069	49	10013161	44	10014415	60	280204607040	12, 15
10006070	49	10013162	44	10014416	60	280204609040	12
10006071	49	10013163	44	10014417	60	280204611040	12
10006072	49	10013164	44	10014448	71	280204613040	12
10006073	49	10013365	64	10014450	71	280204615040	12
10006074	49	10013443	44	10014499	65	280204616040	12
10006075	49	10013444	44	10014501	67	280204617040	12
10006076	49	10013458	20	10014504	65	280204618040	12
10006132	52	10013466	44	10014517	65	280204619040	12
10006170	50	10013469	44	10014596	64	280204621040	12
10006171	50	10013546	59	10014602	64	280204623040	12
10006172	50	10013547	59	10014663	59	280204625040	12
10006662	50	10013548	59	10014726	63	280204627040	12
10006663	50	10013549	59	10014739	67	280204629040	12
10006664	50	10013550	59	10014748	64	280204635040	12
10006665	50	10013551	59	10014897	59	280204637040	12
10006666	50	10013552	59	10014898	59	280204639040	12
10006736	63	10013553	59	10014899	59	280208100040	16
10007147	53	10013568	20	10014900	59	280208100140	16
10007306	52	10013569	20	10014901	59	280208357040	19
10007307	50	10013570	20	10014950	65	280208456040	15, 17, 19
10007308	50	10013571	20	10015042	64	280208600040	17, 19
10007309	50	10013572	20	101111	15	280208600140	15
10007310	50	10013573	20	101125	14	280208601040	17, 19
10007311	50	10013574	21	101125A	14	280208603040	17, 19
10007312	50	10013575	21	101127	14	280208605040	17, 19
10007313	50	10013576	21	101146	22	280208605140	15

# Index

Part No.	Page	Part No.	Page	Part No.	Page	Part No.	Page
280208607040	17, 19	280242612040	36	281500003200	70	288453323030	13
280208610040	17, 19	280242615040	36	281602000202	70	288544003010	13
280208610140	15	280242618040	36	281604000200	70	288559120010	40, 42
280208615040	17, 19	280242621040	36	288101855030	45	288602785030	42
280208615140	15	280242624040	36	288101860030	45	288602815030	41, 42
280208620040	17, 19	280242627040	36	288101865030	45	288602833030	41, 42
280208620140	15	280242630040	36	288101870030	45	288602863030	40, 42
280208635040	17, 19	280242633040	36	288101875030	45	288602872020	41
280208635140	15	280242636040	36	288101880030	45	288602873020	41
280208640140	15	280242639040	36	288101885030	45	288602874020	41
280208675040	15, 17, 19	280242642040	36	288103305030	45	288602875020	41
280208680040	15, 17, 19	280242645040	36	288103310030	45	288602985010	40
280208685040	15, 17, 19	280242648040	36	288103315030	45	288603250030	42
280208700040	15, 17, 19	280242651040	36	288103320030	45	288603290040	42
280208940040	18	280242654040	36	288103425030	45	300212	15
280208950040	18	280600501030	71	288103430030	45	360 000 630	8
280218456040	32	280600502030	71	288107140030	47	360 000 650	10
280218469040	32	280600503030	71	288107270032	47	360 000 651	8
280218603040	31, 36	280600504030	71	288107272032	47	360 000 670	49
280218606040	31, 36	280602231040	41, 42	288108800010	49	360 000 673	49
280218609040	31	280602234040	41, 42	288108820010	49	360 000 674	49
280218612040	23, 25, 27, 29, 31	280602237040	41, 42	288151410030	49	360 000 675	49
280218615040	23, 25, 27, 29, 31	280602241040	41, 42	288151430030	49	360 000 676	49
280218618040	23, 25, 27, 29, 31	280602445040	40	288151442030	49	360 000 677	49
280218653040	36	280602635040	40	288151447030	49	360 000 678	49
280218656040	31, 36	280602636040	42	288151460030	49	360 000 679	49
280218659040	31	280602824040	40	288151465030	49	360 000 680	49
280218662040	23, 25, 27, 29, 31	280602844040	40	288153030030	40, 42, 44	360 000 681	62
280218665040	23, 25, 27, 29, 31	280602844140	40	288153033030	40, 42, 44	360 000 682	62
280218668040	23, 25, 27, 29, 31	280602844240	40	288153130030	40, 42	360 000 683	62
280218703040	32	280602845040	40	288204350030	13	360 000 684	62
280218706040	32	280602845140	40	288204355010	13	360 000 685	62
280218709040	32	280602845240	40	288204500030	12	360 000 686	62
280218712040	23, 25, 27, 29, 32	280602850040	41, 43	288204701030	11	360 000 687	62
280218715040	23, 25, 27, 29, 31	280602853040	41, 43	288204724030	11	360 000 688	62
280218718040	25, 27, 29, 31	280602854040	41, 43	288204725030	11	360 000 689	62
280218756040	32	280602855040	41, 43	288204795130	12	360 000 690	62
280218759040	32	280602859040	41, 43	288204799130	12	360 000 691	62
280218762040	23, 27, 32	280602861040	40	288208100030	16	360 000 692	62
280218765040	23, 27, 32	280602861140	40	288208311030	18	360 000 694	47
280218768040	23, 27, 32	280602861240	40	288208350030	18	360 000 695	47
280220300040	30	280602861340	40	288208352010	15, 17, 19	360 000 696	47
280220600040	31	280602861540	40	288208369030	19, 32	360 000 697	47
280220653040	31	280602880040	41, 43	288208500030	17, 18	360 000 698	47
280220680040	31	280602882040	41, 43	288208510030	19, 23, 25, 27	360 000 699	47
280220753040	32	280602883040	41, 43	288208540030	19	360 000 700	47
280242305040	35	280602885040	41, 43	288208540030	19	360 000 701	47
280242398040	36	280602887040	41, 43	288208950030	18	360 000 702	47
280242401040	36	280602889040	41, 43	288218379030	19, 32	360 000 719	3
280242600040	36	280602891040	41, 43	288218510030	19, 23, 25, 27	360 000 720	49
280242603040	36	280602893040	41, 43	288220400030	30	360 000 721	49
280242606040	36	280602895040	41, 43	288242350030	35	360 000 722	49
280242609040	36	280602896040	41, 43	288242363020	36	360 000 723	49
		280602996140	43	288242371020	36	360 000 724	49
		280602997140	43	288242372020	36	360 000 725	49
		281002000002	73	288242375030	35	360 000 730	58
		281002100099	69	288242400030	35	360 000 731	58
		281004000002	73	288242500030	35	360 000 733	54
		281004001101	68, 70, 72	288242500030	35	360 000 734	54
		281004100099	69	288242510030	36	360 000 735	54
		281008100000	73	288242580030	36	360 001 605	4
		281500003100	70	288242596020	36	360 001 621	46

# Index

Part No.	Page	Part No.	Page	Part No.	Page	Part No.	Page
360 001 622	44	360 002 227	50	360 003 272	51	360 003 394	13
360 001 623	9, 44	360 002 228	50	360 003 273	51	360 003 410	33
360 001 624	10	360 002 229	50	360 003 274	51	360 003 412	10
360 001 626	46	360 002 230	50	360 003 277	40, 42, 44	360 003 414	10
360 001 736	53	360 002 231	50	360 003 278	11	360 003 426	10
360 001 737	52	360 002 232	50	360 003 279	11	360 003 437	48
360 001 738	52	360 002 233	50	360 003 280	10, 13	360 003 438	48
360 001 740	9	360 002 234	50	360 003 283	15	360 003 515	50
360 001 741	9	360 002 236	71	360 003 284	12, 15	360 003 516	45
360 001 742	9	360 002 531	54, 66	360 003 285	12, 15	360 003 517	45
360 001 743	9	360 002 532	54, 66	360 003 286	12, 15	360 003 518	45
360 001 744	9	360 002 656	8	360 003 287	12	360 003 519	45
360 001 745	9	360 002 882	48	360 003 288	12	360 003 520	45
360 001 746	9	360 002 883	14	360 003 289	12	360 003 521	45
360 001 749	9	360 002 884	26	360 003 290	12	360 003 522	45
360 001 750	9	360 002 904	34	360 003 291	12	360 003 523	45
360 001 751	9	360 002 906	23, 25, 27, 29	360 003 295	16	360 003 524	45
360 001 752	9	360 002 908	20, 22	360 003 296	15, 17, 19	360 003 525	45
360 001 753	9	360 002 909	24, 26, 28	360 003 297	15	360 003 526	45
360 001 756	8	360 002 910	33	360 003 298	17, 19	360 003 691	62
360 001 757	64	360 002 912	15, 17	360 003 299	17, 19	360 003 692	62
360 001 758	64	360 002 913	23, 25, 27	360 003 300	17, 19	360 003 694	64
360 001 759	64	360 002 914	34	360 003 301	17, 19	360 003 695	62
360 001 760	62	360 002 915	14, 16	360 003 302	15	360 003 699	63
360 001 761	64	360 002 917	30	360 003 303	15	360 003 760	50
360 001 762	64	360 002 918	15, 17, 19	360 003 304	17, 19	360 003 761	50
360 002 021	59	360 002 919	34	360 003 305	15	360 003 762	50
360 002 022	59	360 002 920	23, 25, 27, 29	360 003 311	18	360 003 763	50
360 002 023	60	360 002 921	32, 34	360 003 312	32	360 003 764	50
360 002 024	59	360 002 922	15, 17, 19	360 003 313	31, 36	360 003 765	50
360 002 025	60	360 002 923	32	360 003 314	31, 36	360 003 766	50
360 002 026	59	360 002 925	34	360 003 315	31	360 003 872	36
360 002 027	60	360 002 926	34	360 003 316	23, 25, 27, 29, 31	360 003 873	32
360 002 028	59	360 002 927	34	360 003 317	23, 25, 27, 29, 31	360 003 895	15
360 002 029	60	360 002 928	34	360 003 318	23, 25, 27, 29, 31	360 003 897	36
360 002 031	59	360 002 929	34	360 003 319	30	360 003 904	15
360 002 032	60	360 002 930	34	360 003 320	31	360 003 905	19, 23, 25, 27
360 002 033	59	360 002 931	34	360 003 321	35	360 003 907	36
360 002 034	60	360 002 932	34	360 003 322	36	360 003 908	36
360 002 035	59	360 002 933	23, 25, 27, 29	360 003 323	36	360 003 909	36
360 002 036	59	360 002 934	12, 15, 20	360 003 324	36	360 003 910	36
360 002 037	59	360 002 940	10	360 003 325	36	360 003 911	36
360 002 057	63	360 002 948	63	360 003 326	71	360 003 912	36
360 002 058	63	360 002 949	64	360 003 327	73	360 003 913	36
360 002 059	63	360 002 966	58	360 003 328	69	360 003 914	36
360 002 060	63	360 002 971	4	360 003 329	68, 70, 72	360 003 916	31
360 002 061	63	360 002 988	54	360 003 331	73	360 003 917	31
360 002 062	63	360 002 996	4	360 003 332	47	360 003 922	36
360 002 063	63	360 003 002	58	360 003 333	49	360 003 935	36
360 002 064	63	360 003 019	3	360 003 334	49	360 003 956	17, 19
360 002 065	63	360 003 020	3	360 003 335	49	360 003 963	17, 19
360 002 066	63	360 003 024	4	360 003 337	40, 42, 44	360 003 964	15
360 002 067	63	360 003 062	63	360 003 339	13	360 003 969	36
360 002 217	51	360 003 066	50	360 003 341	13	360 003 970	31, 36
360 002 218	51	360 003 267	71	360 003 347	12	360 003 971	31
360 002 220	51	360 003 268	50	360 003 352	12	360 003 972	15
360 002 221	51	360 003 269	50	360 003 353	18	360 003 977	23, 25, 27, 29, 31
360 002 222	51	360 003 270	50	360 003 354	15, 17, 19	360 003 978	23, 25, 27, 29, 31
360 002 223	51	360 003 271	50	360 003 357	19, 32		

# Index

Part No.	Page	Part No.	Page	Part No.	Page	Part No.	Page
360 003 979	23, 25, 27, 29, 31	360 004 188	36	360 006 478	16	360 006 690	40
360 003 981	32	360 004 194	15	360 006 479	16	360 006 691	40
360 003 982	32	360 004 196	21, 23, 25, 27, 29	360 006 483	35	360 006 981	68
360 003 983	25, 27, 29, 31	360 004 210	14	360 006 485	30	360 007 114	21
360 003 984	15, 17, 19	360 004 214	33	360 006 486	24, 26, 28	360 007 163	12
360 003 985	15, 17, 19	360 004 229	10	360 006 536	42	360 007 164	14, 16
360 003 986	15, 17, 19	360 004 230	10	360 006 538	42	360 007 165	18
360 003 987	32	360 004 231	10	360 006 542	41, 42	360 007 169	35
360 003 988	32	360 004 238	18	360 006 543	41, 42	360 007 170	40, 42
360 003 989	32	360 004 239	11	360 006 614	44	360 007 171	40, 42, 44
360 003 990	23, 27, 32	360 004 244	11	360 006 615	44	360 007 173	40, 42, 44
360 003 991	23, 27, 32	360 004 258	14	360 006 616	44	360 007 174	42
360 003 992	23, 27, 32	360 004 265	24	360 006 617	44	360 007 176	21, 23, 25, 27, 29
360 004 007	43	360 004 266	22	360 006 618	44	360 007 185	10
360 004 008	36	360 004 269	14	360 006 619	44	360 007 755	19
360 004 011	36	360 004 273	16	360 006 620	44	360 008 022	14
360 004 014	12	360 004 346	46	360 006 621	44	360 008 210	36
360 004 015	36	360 004 348	49	360 006 622	45	360 008 405	64
360 004 016	36	360 004 349	49	360 006 623	44	360 008 407	64
360 004 018	32	360 004 351	49	360 006 624	44	360 008 408	64
360 004 019	23, 25, 27, 29, 31	360 004 352	49	360 006 625	45	360 008 410	64
360 004 020	23, 25, 27, 29, 32	360 004 353	47	360 006 626	44	360 008 411	64
360 004 023	36	360 004 354	47	360 006 627	44	360 008 411	64
360 004 048	34	360 004 398	34	360 006 628	44	360 008 430	33
360 004 049	34	360 004 496	3	360 006 629	44	360 008 682	40
360 004 050	34	360 004 646	15	360 006 630	44	360 008 684	42
360 004 051	34	360 004 675	19, 23, 25, 27	360 006 631	44	360 008 685	43
360 004 052	34	360 005 415	41	360 006 632	44	360 008 686	43
360 004 057	34	360 005 589	19	360 006 633	44	360 008 816	40
360 004 062	34	360 005 660	13	360 006 640	12	360 008 817	40
360 004 064	34	360 005 665	17, 18	360 006 641	41, 43	360 008 830	36
360 004 065	34	360 005 666	22	360 006 642	41, 43	360 009 192	40, 42
360 004 066	34	360 005 667	24	360 006 643	41, 43	360 009 217	63
360 004 068	17, 19	360 005 668	31	360 006 644	41, 43	360 009 552	60
360 004 072	17, 19	360 005 668	31	360 006 645	41, 43	360 009 553	60
360 004 073	15	360 005 669	35	360 006 646	41, 43	360 009 554	60
360 004 075	34	360 005 673	26	360 006 647	41, 43	360 009 555	60
360 004 076	23, 25, 27, 29	360 005 825	10	360 006 648	41, 43	360 009 556	60
360 004 077	23, 25, 27, 29	360 005 827	40, 42	360 006 649	41, 43	360 009 557	60
360 004 078	23, 25, 27, 29	360 005 832	42	360 006 650	41, 43	360 009 887	50
360 004 082	17, 19	360 005 833	41	360 006 652	41, 42	360 009 888	51
360 004 086	12	360 005 834	41	360 006 653	41, 42	360 010 053	10
360 004 090	12	360 005 835	41	360 006 654	41, 42	360 010 066	71
360 004 091	12	360 005 837	10	360 006 655	41, 42	360 010 079	71
360 004 092	12	360 005 856	49	360 006 656	41, 43	360 010 080	71
360 004 093	12	360 005 857	49	360 006 657	41, 43	360 010 081	71
360 004 094	12	360 005 858	49	360 006 658	41, 43	360 010 081	71
360 004 095	12	360 005 869	24, 26, 28	360 006 659	41, 43	360 010 095	69
360 004 096	12	360 005 871	22	360 006 660	41, 43	360 010 107	73
360 004 097	12	360 005 875	23, 25	360 006 661	43	360 010 235	59
360 004 129	36	360 005 930	16	360 006 663	43	360 010 264	70
360 004 139	23, 25, 27	360 005 931	30	360 006 675	15, 17, 19	360 010 280	70
360 004 141	15	360 005 969	35	360 006 680	40	360 010 298	36
360 004 163	19, 32	360 005 994	47	360 006 681	40	360 010 398	18
360 004 168	36	360 005 999	47	360 006 682	40	360 010 400	20
		360 006 361	70	360 006 683	40	360 010 428	13
		360 006 362	10	360 006 684	40	360 010 952	70
		360 006 382	65	360 006 685	40	360 020 511	2
		360 006 473	22	360 006 686	40	360 020 512	2
		360 006 474	20	360 006 687	40	360 021 003	3
		360 006 475	11	360 006 688	40	360 021 004	3
		360 006 477	14	360 006 689	40	360 021 134	2
						360 022 117	2

# Index

Part No.	Page	Part No.	Page	Part No.	Page	Part No.	Page
360 022 702	3	360 060 646	60	557LK1404030	9	600263	34
360 027 993	20	360 060 647	61	557LK1404111	9	600266	14, 16
360 028 048	20	360 060 648	61	557LK1404121	9	600268	15
360 028 049	20	360 060 649	61	557LK1404151	9	600273	14, 16
360 028 050	20	360 060 650	61	557LK1404501	9	600320	42
360 028 051	20	5001063	63	557LK1404751	9	600340	30
360 028 052	20	5001080	63	5590000	8	6920980	54
360 028 053	20	500225	33	5750007	54	800030	15, 17, 19
360 028 054	21	500290	30	5750014	63	800035	23, 25, 27
360 028 055	21	500301	34	5750019	63	800038	34
360 028 056	21	500325	22	5750202	54	800110	23, 25, 27, 29
360 028 057	21	500347	14	5750263	9	800150	32, 34
360 028 058	21	500347A	14	5750297	9	800161	15, 17, 19
360 028 059	21	500359	16	5750371	9	800185	15
360 028 060	21	500360	16	5750862	63	800190	32
360 028 062	21	500370	24, 26, 28	5750863	63	800200	15
360 028 063	21	500375	21	5750864	63	9000643	4
360 028 064	21	500375	23, 25, 27, 29	5750865	63	9001287	63
360 028 065	21	500378	29	5750925	63	9001304	58
360 028 078	21	5500025	49	5750926	63	900533	34
360 028 096	21	550CR0010000	47	5751644	63	900534	34
360 028 297	28	550CR0020000	47	5751656	63	900535	34
360 028 311	64	550CR0030000	47	5751907	54	900539	34
360 028 312	64	550CR0040000	47	5752001	64	900540	34
360 028 313	64	550CR0110000	47	5752002	62	900541	34
360 028 314	64	550CR0120000	47	5752003	62	900543	34
360 028 321	45	550CR0150000	47	5752004	62	900544	34
360 028 323	21	550CR0500000	47	5752005	62	900545	34
360 028 384	28	550CR0620000	47	5752006	62	900546	34
360 029 067	1	550CR0750000	47	5752007	62	900547	34
360 029 069	1	555DG1010000	49	5752008	62	900553	34
360 029 070	1	555DG1020000	49	5752009	62	900554	34
360 029 215	65	555DG1120000	49	5752010	62	900556	34
360 029 217	67	555DG1150000	49	5752011	62	900725	34
360 029 222	64	555DG1500000	49	5752040	62	900726	34
360 029 223	60	555DG1750000	49	5752043	64	900727	34
360 029 224	60	555DG2030400	49	5752050	64	900728	34
360 029 225	60	555SP2010000	51	5752051	64	900729	34
360 029 226	60	555SP2020000	51	5752080	64	900914	43
360 029 227	60	555SP2030000	51	5752090	62	900916	43
360 029 228	60	555SP2040000	51	5752093	63	900918	43
360 029 229	60	555SP2120000	51	5752097	64	900945	23, 25, 27, 29
360 029 230	60	555SP2150000	51	5752098	64	900948	23, 25, 27, 29
360 029 231	60	555SP2500000	51	5752099	64	900972	23, 25, 27, 29
360 029 235	59	555SP2620000	51	5752206	59	900974	23, 25, 27, 29
360 029 236	59	555SP2750000	51	5752244	62	901060	17, 19
360 029 237	59	555TR1210004	10	5752273	64	901062	12, 15, 20
360 029 238	59	555TRO210067	10	5752278	59	V00028	10
360 029 239	59	5560021	46	5758000	58	V00169	10
360 029 240	59	5560022	9, 44	5758111	58		
360 029 249	67	5560023	44	5758595	58		
360 029 256	67	5560024	46	5900091	4		
360 029 341	67	556EB0400018	10	600012	21, 23, 25, 27, 29		
360 060 023	18	556EB0400061	10	600082	21, 23, 25, 27, 29		
360 060 124	64	556EB3400014	10	600160	34		
360 060 125	64	556HM3000102	10	600210	20, 22		
360 060 126	64	5570006	71	600211	24, 26, 28		
360 060 127	64	5570074	10	600215	33		
360 060 642	60	557BS0400000	8	600260	15, 17		
360 060 643	60	557LK1404011	9	600261	23, 25, 27		
360 060 644	60	557LK1404020	9				
360 060 645	60	557LK1404021	9				