

SAW Filter 137.50MHz

Model: TA1581A

Part No: MP07202

Rev No: 1

A. MAXIMUM RATING:

Electrostatic Sensitive Device (ESD)

1. Input Power Level: 10dBm
2. DC Voltage: 10V
3. Operating Temperature: -40°C to +85°C
4. Storage Temperature: -40°C to +85°C

B. ELECTRICAL CHARACTERISTICS: (Operating temperature: 25°C)

1. Terminating source impedance (single ended): $Z_S = 50\Omega$
2. Terminating load impedance (single ended): $Z_L = 50\Omega$

Item	Unit	Min.	Typ.	Max.	Note
Center frequency F_c	MHz	-	137.5	-	-
Insertion Loss @ 137.5MHz IL	dB	-	1.5	3.5	-
Passband Ripple (137 ~ 138MHz)	dB	-	0.4	1.5	-
2dB Bandwidth BW2	MHz	1.4	2.5	-	-
3dB Bandwidth BW3	MHz	1.8	2.6	-	-
20dB Bandwidth BW20	MHz	-	4.5	6	-
Attenuation (reference level from 0dB)					
129MHz	dB	42	70	-	-
134MHz	dB	30	34	-	-
141MHz	dB	20	23	-	-
146MHz	dB	30	40	-	-
Temperature Coefficient of Frequency	ppm/°C	-	-36	-	-

SAW Filter 137.50MHz
Part No: MP07202

Model: TA1581A
Rev No: 1

F. FREQUENCY CHARACTERISTICS:

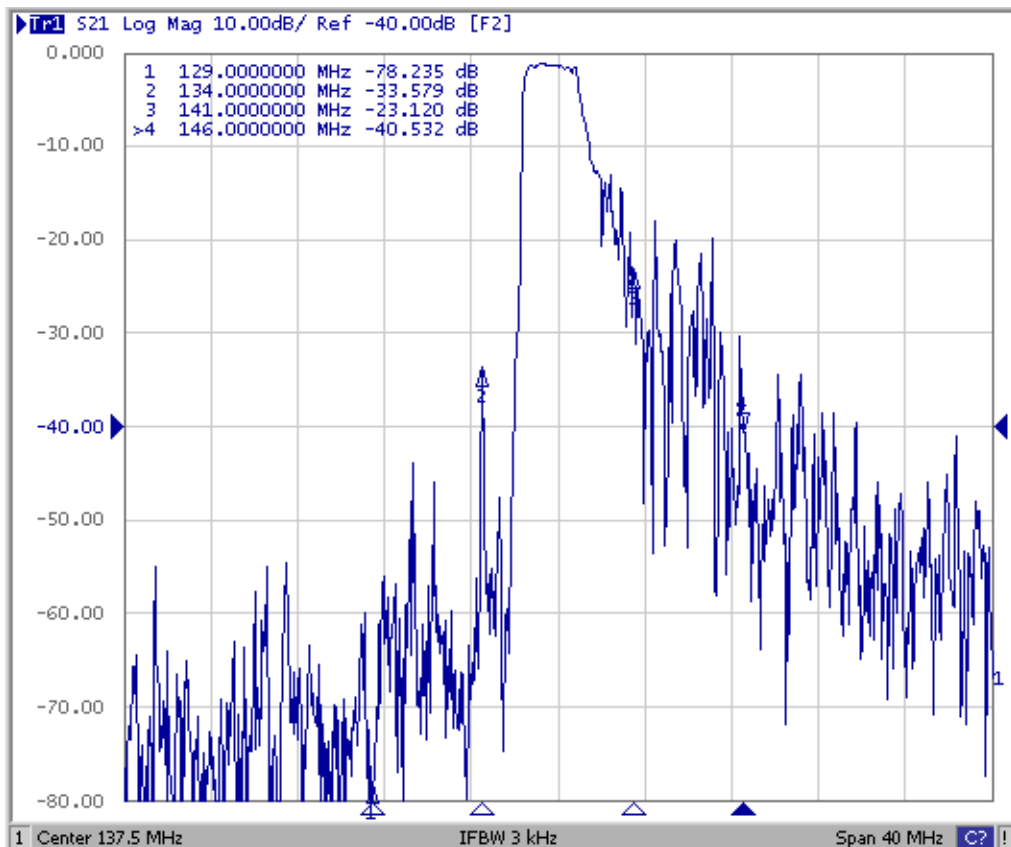
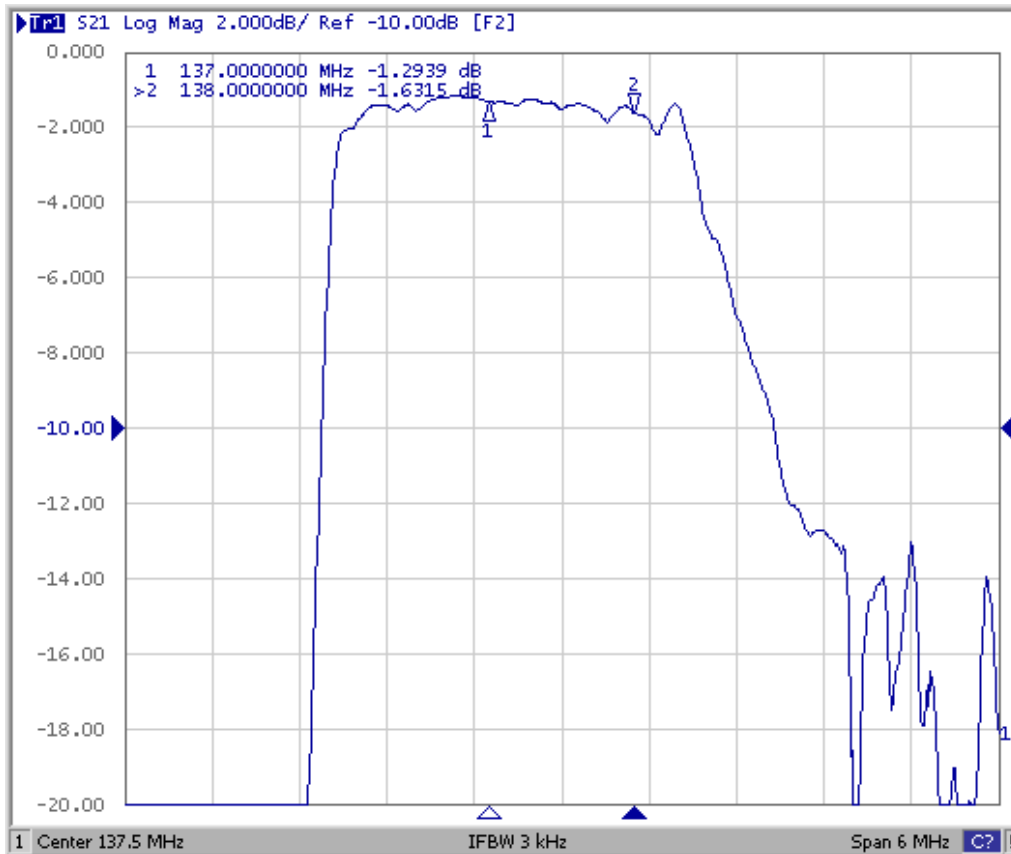

SAW Filter 137.50MHz
Part No: MP07202

Model: TA1581A
Rev No: 1

G. PACKING:

1. Reel Dimension

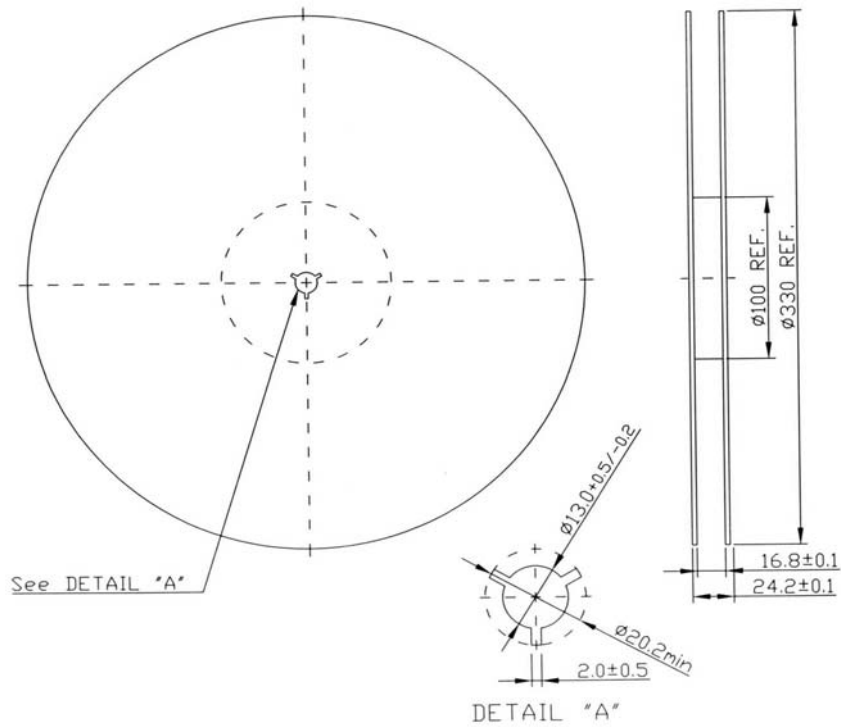

2. Tape Dimension

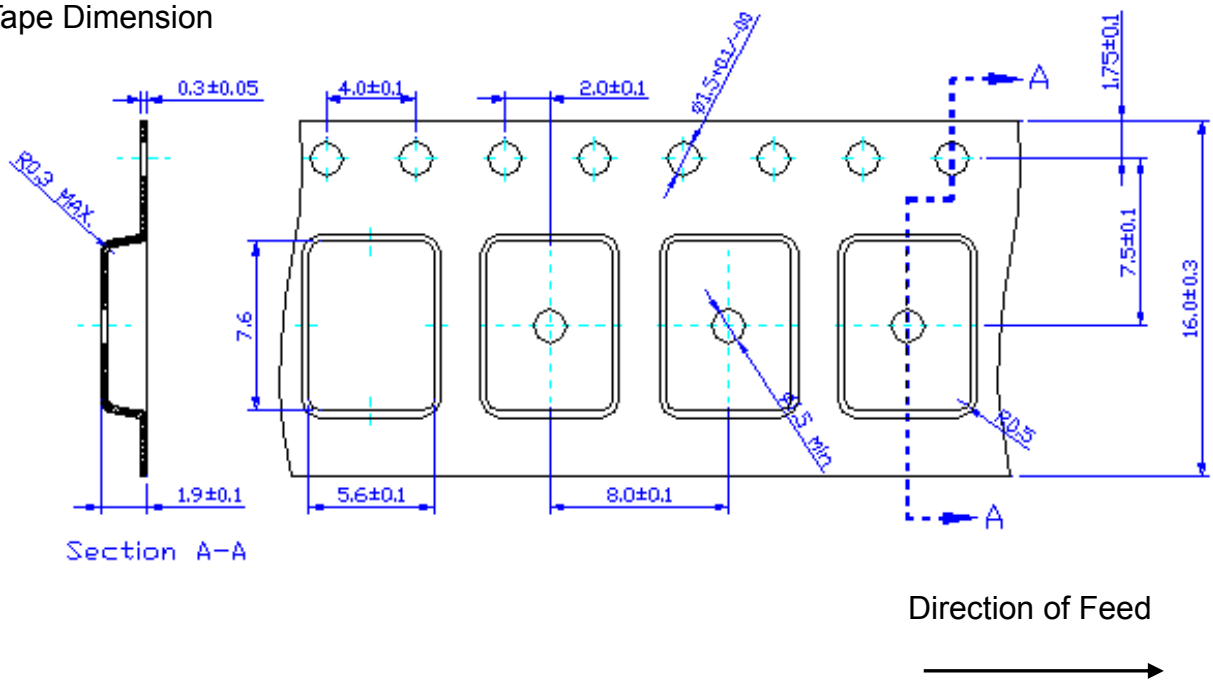

SAW Filter 137.50MHz
Part No: MP07202

Model: TA1581A
Rev No: 1

H. RECOMMENDED REFLOW PROFILE:

1. Preheating shall be fixed at 150 ~ 180°C for 60 ~ 90 seconds.
2. Ascending time to preheating temperature 150°C shall be 30 seconds min.
3. Heating shall be fixed at 220°C for 50 ~ 80 seconds and at 245 ~ 260° peak (min. 10 sec).
4. Time: 2 times.

