



31M04SW2047 2.20620 STRATHCONA

010

2 . 20620

PROSPECTING PROGRAM

**DIADEM/O'CONNOR CLAIMS
STATHCONA TOWNSHIP
G-3450**

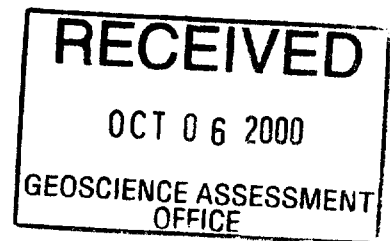

Prepared For:

TEMEX RESOURCES CORP.
4307 Kerry Road, Unit 100
Burlington, Ontario
L7L 1V8

Distribution:

3 Copies - Temex Resources Corp.
2 Copies - Ministry of Northern Development and Mines

October 2000

TEMEX RESOURCES CORP.



TABLE OF CONTENTS

SECTION	PAGE
1.0 INTRODUCTION	1
2.0 CLAIM GROUP	2
3.0 LOCATION AND ACCESS	3
4.0 REGIONAL GEOLOGY	4
5.0 GRAB SAMPLE ANALYTICAL RESULTS	6
6.0 CONCLUSIONS	7
7.0 RECOMMENDATIONS	8
8.0 STATEMENT OF QUALIFICATIONS	10

LIST OF FIGURES

- Figure 1: Claim Location Map
- Figure 2: Grab Sample Locations

LIST OF APPENDICIES

- Appendix A: Grab Sample Descriptions
- Appendix B: Certificates of Analyses

1.0 INTRODUCTION

On May 6 and 7, 2000 preliminary prospecting activities were completed by staff of Temex Resources Corp.. (Temex) on the Diadem/O'Connor Claims (Figure 1) held under option by Temex, 4307 Kerry Road, Burlington, Ontario, L7L 1V8 (MNDM Client No. 303055). The work was executed by Mr. Dan Bunner, Mr. Steve Parker and Mr. Duane Parnham of Temex.

A total of eleven grab sample rock specimens were collected and submitted to a commercial laboratory for gold, platinum, palladium, copper and nickel analyses. The location of these samples are presented on Figure 2.

All samples were submitted to ALS Chemex – Aurora Laboratory Services Ltd. on May 8, 2000 for analyses.

2.0 CLAIM GROUP

The property consists of three blocks of claims forming a contiguous group of forty-seven (47) claims in Strathcona Township, Ontario. The total area of the property is 121 units or 1,936 hectares. The claims are numbered as follows:

West Diadem Option
(David Laronde)

1225639 (2)
1225640 (1)
1225641 (1)
1225642 (2)
1225643 (2)
1225645 (3)
1231126 (3)
1231433 (15)

Diadem/O'Connor Option
(Teck Corporation)

L. 46998 (1)
L. 46999 (1)
L. 47000 (1)
L. 47113 (1)
L. 47114 (1)

Jessie Lake Option
(Gino Chitaroni)

1206386 (1)
1212343 (1)
1212353 (1)
1212354 (1)
1212355 (1)
1212356 (1)
1212357 (1)
1212394 (2)
1212400 (2)
1212906 (9)
1212907 (7)
1220118 (1)
1220141 (1)
1227392 (4)
1227393 (4)
1230078 (5)
1231124 (3)
1231125 (1)
1231133 (4)
1230644 (1)
1230645 (1)
1230646 (1)
1230662 (1)
1230663 (1)
1230664 (1)
1230666 (1)
1230667 (1)
1230668 (1)
1230669 (1)
1230673 (6)
1230676 (1)
1230677 (8)
1230678 (14)
1238899 (1)

3.0 LOCATION AND ACCESS

The property is located on the northeast arm of Lake Temagami. The property can be accessed from the Town of Temagami by snowmachine or boat. A year round gravel road is located on the south shore of Lake Temagami traverses the northern claims of the claim group. This road starts on Highway 11 and heads westward. The property is located about 2 km southwest of the town of Temagami. Temagami is located about 100 km north of the City of North Bay which in turn is about 450 km north of the City of Toronto.

4.0 REGIONAL GEOLOGY

The regional geology description provided below was presented in the following report entitled:

- “Report On the O’Connor Property, Strathcona Township, R. Scammell for Teck Exploration Ltd., Report No. 1195NB, January 10, 1992”

“The area is underlain by an assemblage of volcanic rocks which vary in composition from andesite to rhyolite. The units strike N70°E and dip 60° – 80° to the northwest. They lie on the south limb of a syncline whose axis lies 2 km to the northwest of the claim group.”

The volcanics are intruded to the southwest by the Iceland Lake Pluton, a granitic batholith, and by discordant diabase and other dykes. An extensive sill of metadiorite conformably intrudes the felsic volcanics on the claim group and the area to the southwest. An unusual feature of the intrusion is an intermittent concentration of pyrite with intergrowths of minor chalcopyrite and complex nickel minerals known as the “Pyrite Zone” along its southern contact or footwall.”

“Steeply north-dipping and east to northeast trending major transcurrent shears strike fault the volcanics. These are related to the major fault zone underlying the entire length of the Northeast Arm of Lake Temagami. The volcanics have also been subjected to a series of transverse north trending faults that block fault the units.

The volcanic units consist primarily of rhyolite and rhyolite breccia tuff. The rhyolite is dark grey to grey to creamy grey, massive is located on the footwall of the metadiorite and appears to be conformable with the intrusion. This unit appears to be identical with the Temagami Mine’s rhyolite that hosts the pod like high-grade copper ore bodies. To the south, the rhyolite is in contact with fine-grained pyroclastics termed rhyolite breccia tuff. It is at this contact between the two rhyolite units that the ore bodies are located

(Graham 1973). The rhyolite breccia tuff is dark green, relatively massive and is characterized by “pin head” sized clots of chlorite disseminated throughout the unit.

The metadiorite underlying the claims T-47113, T-47114 and T-46996 strikes at N65°E and dips steeply north. It attains a maximum thickness of 200 meters near the western boundary of claim T-47114 and appears to pinch out on claim T-46998.

The volcanics and metadiorite are intruded by a north-northwest striking diabase dyke along the western boundary of Claim T-47114.”

5.0 GRAB SAMPLE ANALYTICAL RESULTS

The location of the eleven grab samples collected is presented upon Figure 2. Field descriptions of the samples collected are presented in Appendix A. The samples are referenced as sample D1 through D11. The Certificates of Analyses are provided in Appendix B.

A review of the analytical and rock sample descriptions indicates that several of the rock specimens contain anomalous concentrations of copper and nickel with minor anomalous paladium and gold. Anomalous concentrations were detected in hand sample materials from rock materials containing massive sulphides (Sample D4) primarily comprised of pyrite an pyrrhotite with minor chalcopyrite from the pyrite zone, and from rock specimens of the hanging wall metadiorite (Samples D4, D10 and D11). Anomalous concentrations have thus far not been detected in the footwall rhyolite rocks.

6.0 CONCLUSIONS

Based upon the data obtained during this work program the property is considered to have a good to high potential for copper, nickel and platinum group elements to be present at economic grades. Considerable effort should be spent to expand the known copper nickel resource which is known to exist on the property. Further the platinum group potential of the rhyolite, rhyolite breccia, pyrite zone and the metadiorite must be explored.

7.0 RECOMMENDATIONS

Further work is warranted upon this claim group. That work should consist of;

1. Acquisition and detailed review of relevant exploration data on file with Teck, David Laronde and Gino Chitaroni.
2. Verification, location and GIS plotting of lease boundaries claim posts, previous drill collar locations, strategic mapping and geophysical information, and major and minor showings indicated by Teck and Laronde data.
3. Legal surveying of lease boundaries;
4. Detailed, systematic surface sampling of the Temagami Islands Gabbro (metadiorite), the pyrite zone and portions of the rhyolite and rhyolite breccia primarily for platinum group elements with copper and nickel work.
5. Verification of previous detailed mapping on file with Teck and Laronde.
6. Drilling of two verification twinned drill holes to confirm existing resource and check for platinum potential in areas of higher reported copper tenor and minor sulphide areas within footwall and hanging wall lithologies.
7. Drilling of one deeper drill hole to try to expand the known copper and nickel resource and check for platinum group potential in zones further away from the sulphide zone.
8. Possibly leaving some casing and/drill stem downhole to facilitate subsequent downhole geophysics.
9. Collection of five surface water samples for baseline surface water hydrogeological analyses.

Ground geophysics would be contemplated prior to drilling if verification activities provide insufficient confidence in proposed drilling locations.

The primary objectives of the work program are:

- To facilitate an understanding of the current knowledge of the property;
- To confirm the location of the leased property in order to minimize the risk of non-compliance to Skyline Reserve restrictions;
- To verify previous reported results regarding the copper and nickel potential and to begin work to further that resource; and
- To begin activities aimed at evaluating the potential for platinum group mineralization to be present.

8.0 STATEMENT OF QUALIFICATIONS

I, Dan P. Bunner of Oakville, Ontario hereby certify that:

1. I hold a Master of Science Degree in Geology from Carleton University, Ottawa, Ontario, obtained in February 1989.
2. I have been practicing my profession since 1979 in Newfoundland, Nova Scotia, Quebec, Ontario, Manitoba and the Northwest Territories.
3. I am currently employed as a Geologist/Project Manager for Golder Associates Ltd. and am also currently Vice President of Exploration for Temex Resources Ltd. and as of the date of preparing this report held 50,000 common shares in the company.
4. I am a Registered Professional Geoscientist (P. Geo.) in the Association of Professional Engineers and Geoscientists of the Province of British Columbia.
5. I am a Certified Engineering Technologist (C.E.T.) in the Ontario Association of Certified Engineering Technicians and Technologists.
6. I have based conclusions and recommendations contained in this report on knowledge of the area, my previous experience and on the results of the fieldwork conducted on the property during 1987.
- 7) I currently reside at 501 Orchard Drive, Oakville, Ontario, L6K 1N9.

Dated this 4th day of October, 2000
in Mississauga, Ontario

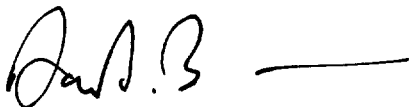
A handwritten signature in black ink, appearing to read 'Dan P. Bunner', is written above a horizontal line. A short horizontal stroke extends to the right from the end of the signature.

Dan P. Bunner

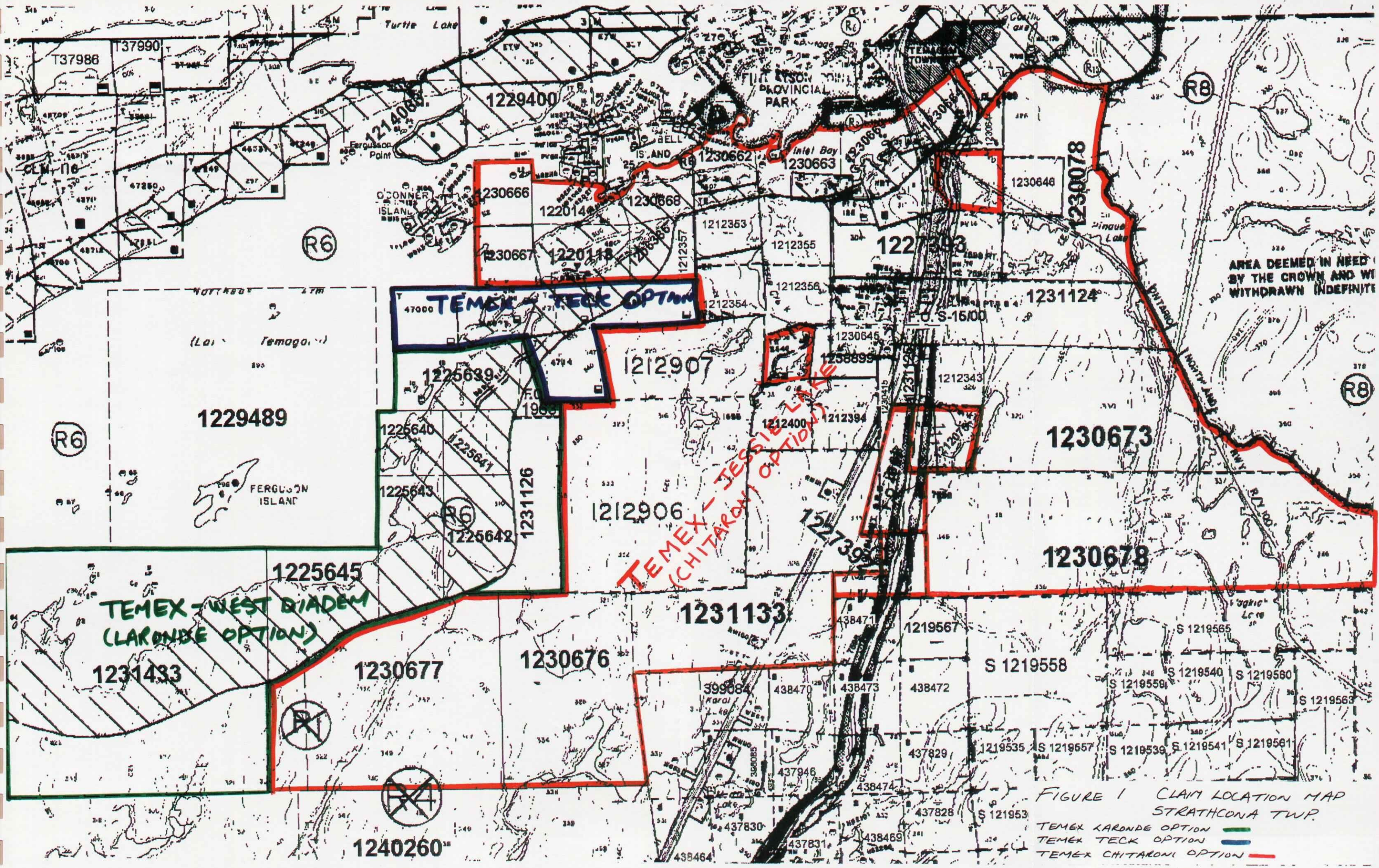
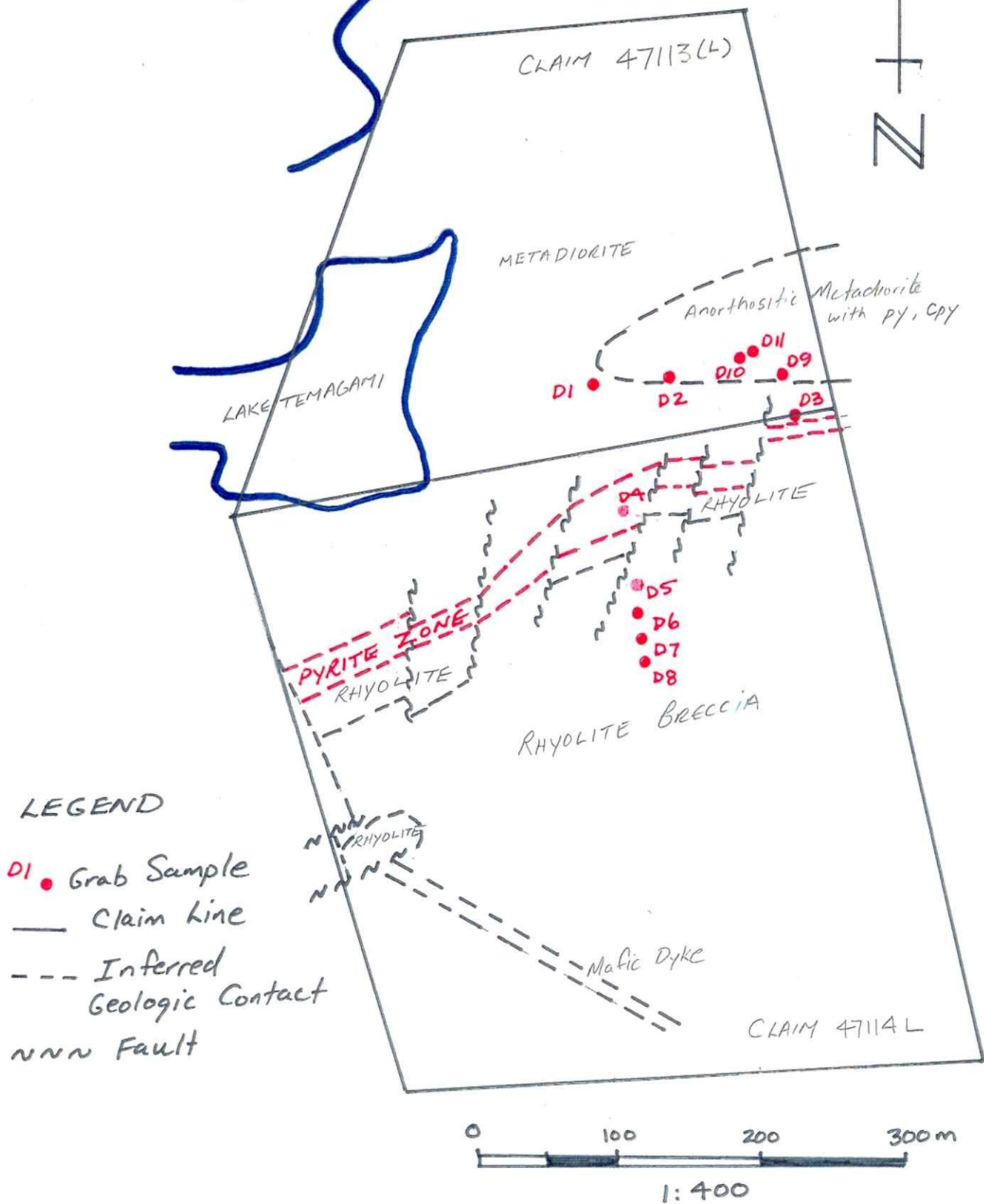

FIGURE 1 CLAIM LOCATION MAP
 STRATHCONA TWP.
 TEMEX LARONDE OPTION ———
 TEMEX TECK OPTION ———
 TEMEX CHITARONI OPTION ———

Sample Location Diagram
 Preliminary Prospecting Program
 O'Connor Property - Teck Option
 STRATHCONA TWP.

Figure 2



APPENDIX A
GRAB SAMPLE DESCRIPTIONS

Sample Location Diagram
 Preliminary Prospecting Program
 O'Connor Property - Teck Option
 STRATHCONA TWP.

Figure 2

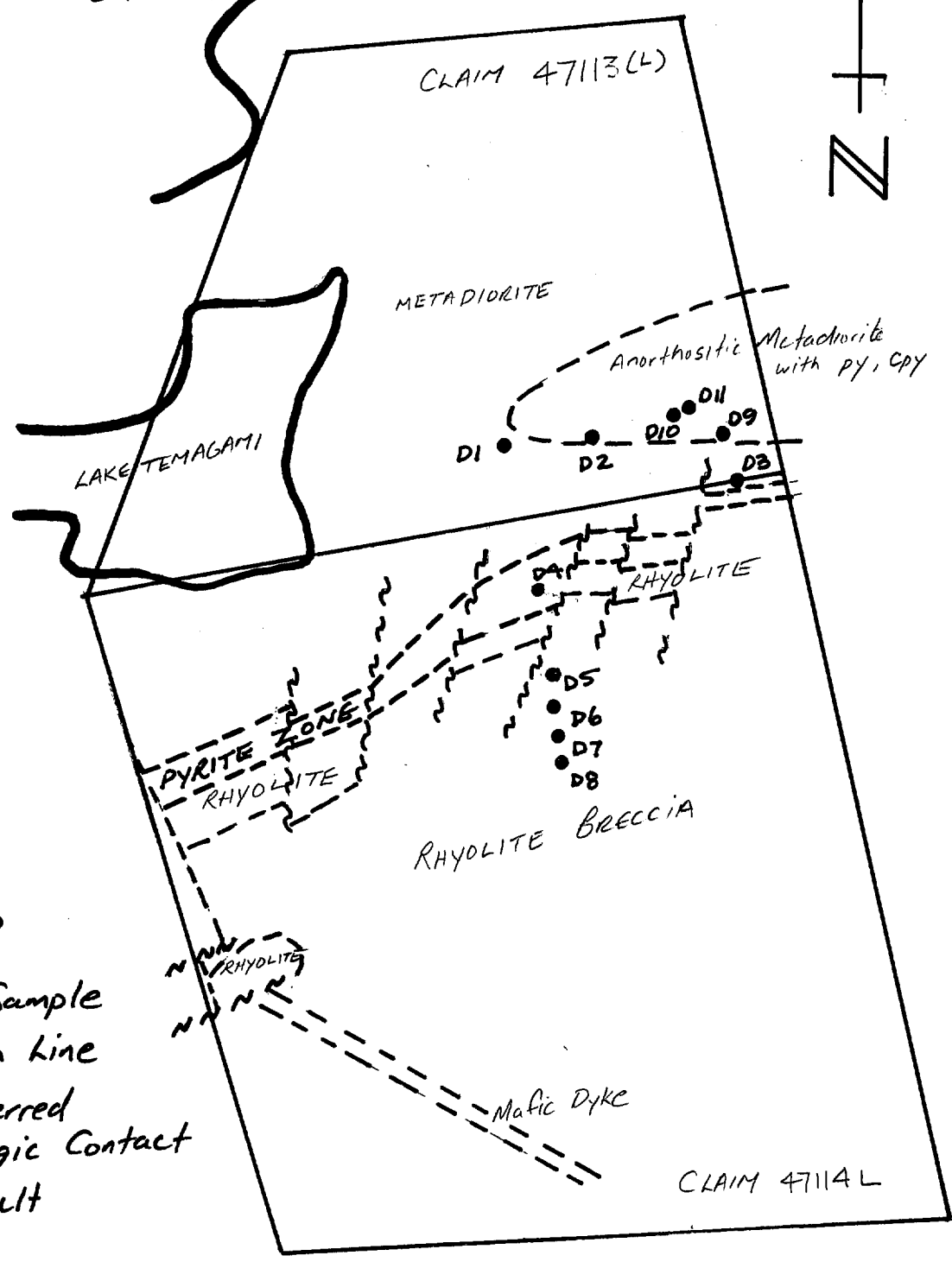

LEGEND

- D1 ● Grab Sample
- Claim line
- - - Inferred Geologic Contact
- n n n Fault

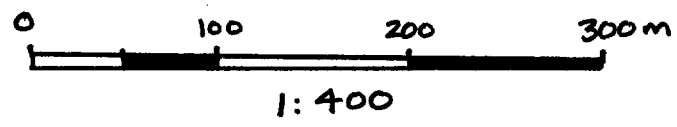

APPENDIX B
CERTIFICATES OF ANALYSES

ALS Chemex

AURORA LABORATORY SERVICES LTD.
212 Brookbank Ave. North Vancouver BC Canada V7J 2C1
Phone: 604-984-0221 Fax: 604-984-0218 Website: www.alschemex.com

FAX DATA REPORT

COMPANY : TEMEX RESOURCES LTD.

CONTACT : ATTN: DAN P. BUNNER

FAX NUMBER : 1-905-567-6561

SENDER : DEAN
NO OF PAGES : 2 INCL COVER
SUBJECT : Automated FAX data delivery

DATE SUBMITTED : 18-MAY-00 at 16:08 PD1

DESCRIPTION :

Results for workorder A0018331 - Project :
26 samples received on 08-MAY-00 by our Toronto office
This workorder has all data entered

FAX COPY ONLY - A certified copy will be sent through the mail

If there are any problems with this transmission, please call our office immediately at 604 984 0221

ALS Chemex charges clients \$0.50 per page of analytical results faxed within North America and \$2.00 per page faxed outside North America (billed monthly)

This facsimile contains privileged and confidential information intended only for the use of the addressee. If you are not the addressee, you are hereby notified that you must not disseminate, copy or take action in respect of its contents. If you have received the facsimile in error please notify ALS Chemex immediately and return it to the above fax.

A Campbell Brothers Limited Company

ALS Chemex

AURORA LABORATORY SERVICES LTD.
212 Brookbank Ave, North Vancouver BC Canada V7J 2C1
Phone: 604-984-0221 Fax: 604-984-0218 Website: www.alschemex.com

FAX DATA REPORT

COMPANY : TEMEX RESOURCES LTD.

CONTACT : ATTN: DAN P. BUNNER

FAX NUMBER : 1-905-567-8561

SENDER : DEAN

DATE SUBMITTED : 18-MAY-00 at 16:07 PD1

NO OF PAGES : 2 INCL COVER

SUBJECT : Automated FAX data delivery

DESCRIPTION :

**Results for workorder A0018511 - Project :
4 samples received on 08-MAY-00 by our Toronto office
This workorder has all data entered**

FAX COPY ONLY - A certified copy will be sent through the mail

If there are any problems with this transmission, please call our office immediately at 604 984 0221

ALS Chemex charges clients \$0.50 per page of analytical results faxed within North America and \$2.00 per page faxed outside North America (billed monthly)

This facsimile contains privileged and confidential information intended only for the use of the addressee. If you are not the addressee, you are hereby notified that you must not disseminate, copy or take action in respect of its contents. If you have received the facsimile in error please notify ALS Chemex immediately and return it to the above fax.

A Campbell Brothers Limited Company

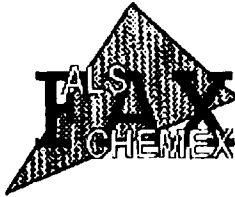

ALS Chemex

Aurora Laboratory Services Ltd.
 Analytical Chemists * Geochemists * Registered Assayers
 5175 Timberlea Blvd., Mississauga
 Ontario, Canada L4W 2S3
 PHONE: 905-624-2808 FAX: 905-624-6183

To: TEMEX RESOURCES LTD.

UNIT 100 - 4307 KERRY DR.
 BURLINGTON, ON
 L7L 1V8

Project :
 Comments: ATTN: DUANE PARNHAM CC: DAN BUNNER

Page Number : 1-A
 Total Pages : 1
 Certificate Date : 18-MAY-00
 Invoice No. : 10018511
 P.O. Number :
 Account : PHU

CERTIFICATE OF ANALYSIS A0018511

SAMPLE	PREP CODE	Au ppb ICP	Pt ppb ICP	Pd ppb ICP	Cu ppm	Ni ppm					
D8	208 226	< 2	< 5	4	15	16					
D9	208 226	< 2	< 5	6	176	116					
D10	208 226	20	15	52	2100	322					
D11	208 226	16	10	30	1160	257					

FROM : TEMEX RES. CORP.

FAX NO. : 905 631 8213
 CHEMEX LHS HLPNA-FAX
 Sep. 28 2000 06:28PM P2
 PAGE 005



ALS Chemex

Aurora Laboratory Services Ltd
 Analytical Chemists * Geochemists * Registered Assayers
 5175 Timberlea Blvd., Mississauga
 Ontario, Canada L4W 2S3
 PHONE: 905-624-2809 FAX: 905-624-6183

To: TEMEX RESOURCES LTD.

UNIT 100 - 4307 KERRY DR.
 BURLINGTON, ON
 L7L 1V8

Project:
 Comments: ATTN: DUANE PARNHAM GC: DAN BUNNER

Page Number : 1-A
 Total Pages : 1
 Certificate Date : 18-MAY-00
 Invoice No : 10018331
 P.O. Number :
 Account : PHU

CERTIFICATE OF ANALYSIS A0018331

SAMPLE	PREP CODE	Au ppb ICP	Pt ppb ICP	Pd ppb ICP	Cu ppm	Ni ppm					
D1	208 226	4	15	10	365	115					
D2	208 226	4	15	10	635	168					
D3	208 226	374	55	240	6260	3500					
D4	208 226	166	75	192	4940	2150					
D5	208 226	6	< 5	2	89	49					
D6	208 226	34	10	18	1315	229					
D7	208 226	12	< 5	2	735	117					
K1 A	208 226	8	10	6	439	636					
K1 B	208 226	< 2	< 5	4	72	149					
K2	208 226	< 2	< 5	< 2	147	53					
K3	208 226	4	< 5	2	228	102					
K4	208 226	10	5	18	131	425					
K5	208 226	58	140	350	2630	2370					
K6	208 226	84	955	1980	>10000	3790					
K7	208 226	< 2	10	12	282	546					
K8	208 226	86	5	20	1600	269					
K9	208 226	1375	765	2740	>10000	753					
K10	208 226	1435	1310	3830	>10000	>10000					
K11	208 226	16	85	254	932	875					
K12	208 226	4	5	10	229	171					
K13	208 226	< 2	< 5	12	349	675					
K14	208 226	2100	1420	2150	>10000	>10000					
K15	208 226	1130	1070	5240	>10000	>10000					
SNARE 1	208 226	8	10	20	415	242					
SNARE 2	208 226	6	10	26	463	311					
SNARE 3	208 226	2	< 5	2	55	60					

FROM : TEMEX RES. CORP.
 FAX NO. : 905 631 8213
 CHEMEX LABS Alpha-FHX
 Sep. 28 2000 06:24PM P2
 002



Declaration of Assessment Work Performed on Mining Land

Mining Act, Subsection 65(2) and 66(3), R.S.O. 1990

Transaction Number (office use) <i>W0070 00189</i>
Assessment Files Research Imaging



31M04SW2047 2.20620 STRATHCONA 900

of subsections 65(2) and 66(3) of the Mining Act. Under section 8 of the review the assessment work and correspond with the mining land holder. Recorder, Ministry of Northern Development and Mines, 6th Floor.

Instructions: - For work performed on Crown Lands before recording a claim, use form 0240.
- Please type or print in ink.

2.20620

1. Recorded holder(s) (Attach a list if necessary)	
Name <i>TEMEX RESOURCES CORP.</i>	Client Number <i>303055</i>
Address <i>4307 KERRY DRIVE, UNIT 100</i>	Telephone Number <i>905-631-9953</i>
<i>BURLINGTON, ONTARIO L7L 1V8</i>	Fax Number <i>905-631-8213</i>
Name	Client Number
Address	Telephone Number
	Fax Number

2. Type of work performed: Check (✓) and report on only ONE of the following groups for this declaration.

Geotechnical: prospecting, surveys, assays and work under section 18 (regs) Physical: drilling, stripping, trenching and associated assays Rehabilitation

Work Type <i>Prospecting</i>	Office Use
	Commodity
	Total \$ Value of Work Claimed <i>2228</i>
Dates Work Performed From <i>6 05 2000</i> To <i>7 05 2000</i>	NTS Reference
Global Positioning System Data (if available)	Township/Area <i>STRATHCONA TWP.</i>
	Mining Division <i>Sudbury</i>
M or G-Plan Number <i>6 3450</i>	Resident Geologist District <i>Kirkland Lake</i>

Please remember to: - obtain a work permit from the Ministry of Natural Resources as required;
- provide proper notice to surface rights holders before starting work;
- complete and attach a Statement of Costs, form 0212;
- provide a map showing contiguous mining lands that are linked for assigning work;
- include two copies of your technical report.

3. Person or companies who prepared the technical report (Attach a list if necessary)

Name <i>TEMEX RESOURCES CORP</i>	Telephone Number <i>905-631-9953</i>
Address <i>4307 KERRY DR., UNIT 100 BURLINGTON, ONT. L7L 1V8</i>	Fax Number <i>905-631-8213</i>
Name	Telephone Number
Address	Fax Number
Name	Telephone Number
Address	Fax Number

RECEIVED

OCT 06 2000

GEOSCIENCE ASSESSMENT OFFICE

4. Certification by Recorded Holder or Agent

I, *DAN P. BUNNER*, do hereby certify that I have personal knowledge of the facts set forth in this Declaration of Assessment Work having caused the work to be performed or witnessed the same during or after its completion and, to the best of my knowledge, the annexed report is true.

Signature of Recorded Holder or Agent <i>Dan P. Bunner</i>	Date <i>Oct 3, 2000</i>
Agent's Address <i>501 ORCHARD DRIVE, OAKVILLE, ONT. L6K 1N9</i>	Telephone Number <i>905-567-4444</i>
	Fax Number <i>905-567-6561</i>

#261

the mining land where work was performed, at the time work was performed. A map showing the contiguous link must accompany this form. *Revised* *1000410, 00157*

Mining Claim Number. Or if work was done on other eligible mining land, show in this column the location number indicated on the claim map.	Number of Claim Units. For other mining land, list hectares.	Value of work performed on this claim or other mining land.	Value of work applied to this claim.	Value of work assigned to other mining claims.	Bank. Value of work to be distributed at a future date.
eg TB 7827	16 ha	\$26,825	N/A	\$24,000	\$2,825
eg 1234567	12	0	\$24,000	0	0
eg 1234568	2	\$8,892	\$4,000	0	\$4,892
1 47113 (L)	1	\$1114.00	0	\$1114.00	0
2 47114 (L)	1	\$1114.00	0	\$1114.00	0
3 1230644	1	0	400	0	0
4 1230645	1	0	400	0	0
5 1230646	1	0	400	0	0
6 1220118	1	0	628	0	0
7 1206386	1	0	400	0	0
8					
9					
10					
11					
12					
13					
14					
15					
Column Totals		\$2228	\$2228	\$2228	0

I, Dan P. Bunner, do hereby certify that the above work credits are eligible under subsection 7 (1) of the Assessment Work Regulation 6/96 for assignment to contiguous claims or for application to the claim where the work was done.

Signature of Recorded Holder or Agent Authorized in Writing: Dan P. Bunner Date: Oct 3, 2000

6. Instructions for cutting back credits that are not approved.

Some of the credits claimed in this declaration may be cut back. Please check (✓) in the boxes below to show how you wish to prioritize the deletion of credits:

- 1. Credits are to be cut back from the Bank first, followed by option 2 or 3 or 4 as indicated.
- 2. Credits are to be cut back starting with the claims listed last, working backwards; or
- 3. Credits are to be cut back equally over all claims listed in this declaration; or
- 4. Credits are to be cut back as prioritized on the attached appendix or as follows (describe):

Cut back from 1206386 followed by 1220118, 1230646, 1230645 and 1230644

Note: If you have not indicated how your credits are to be deleted, credits will be cut back from the Bank first, followed by option number 2 if necessary.

For Office Use Only

Received Stamp RECEIVED OCT 06 2000 GEOSCIENCE ASSESSMENT OFFICE	Deemed Approved Date	Date Notification Sent
	Date Approved	Total Value of Credit Approved
	Approved for Recording by Mining Recorder (Signature)	

OCT 10 '00 12:44

Cut back from 1206386 followed by 1220118, 1230646, 1230645 and 1230644

Note: If you have not indicated how your credits are to be deleted, credits will be cut back from the Bank first, followed by option number 2 if necessary.

For Office Use Only

Received Stamp RECEIVED OCT 06 2000 GEOSCIENCE ASSESSMENT OFFICE	Deemed Approved Date	Date Notification Sent
	Date Approved	Total Value of Credit Approved
	Approved for Recording by Mining Recorder (Signature)	

10/6/00

Personal information collected on this form is obtained under the authority of subsection 8(1) of the Assessment Work Regulation 6/96. Under section 8 of the Mining Act, the information is a public record. This information will be used to review the assessment work and correspond with the mining land holder. Questions about this collection should be directed to the Chief Mining Recorder, Ministry of Northern Development and Mines, 6th Floor, 933 Ramsey Lake Road, Sudbury, Ontario, P3E 6B5.

2.20620

Work Type	Units of Work <small>Depending on the type of work, list the number of hours/days worked, metres of drilling, kilometres of grid line, number of samples, etc.</small>	Cost Per Unit of work	Total Cost
Prospecting (3men x 2days)	6 man days	\$125/man/day	\$750
Analyses	11 samples	\$ 29.35/sample	\$ 323
Associated Costs (e.g. supplies, mobilization and demobilization).			
Project Supervision and Reporting	2 man days	\$ 125 /day	\$ 250
Transportation Costs			
1339km @ \$0.31/km		\$ 0.31 /km	\$ 415
Food and Lodging Costs			
Accom. 2 nights for 3men		\$110/night	\$ 220
Food 6 man days		\$45/man/day	\$ 270
Total Value of Assessment Work			\$ 2228

Calculations of Filing Discounts:

1. Work filed within two years of performance is claimed at 100% of the above Total Value of Assessment Work.
2. If work is filed after two years and up to five years after performance, it can only be claimed at 50% of the Total Value of Assessment Work. If this situation applies to your claims, use the calculation below:

TOTAL VALUE OF ASSESSMENT WORK x 0.50 = Total \$ value of worked claimed.

Note:

- Work older than 5 years is not eligible for credit.
- A recorded holder may be required to verify expenditures claimed in this statement of costs within 45 days of a request for verification and/or correction/clarification. If verification and/or correction/clarification is not made, the Minister may reject all or part of the assessment work submitted.

Certification verifying costs:

I, DAN P. BUNNER (please print full name), do hereby certify, that the amounts shown are as accurate as may reasonably be determined and the costs were incurred while conducting assessment work on the lands indicated on the accompanying Declaration of Work form as Senior Geologist for Temex I am authorized to make this certification. (recorded holder, agent, or state company position with signing authority)

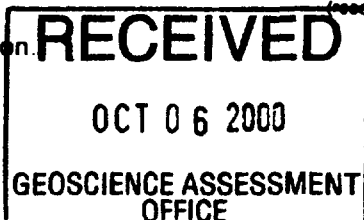

Signature: Dan P. Bunner Date: October 3, 2000

#261

Geoscience Assessment Office
933 Ramsey Lake Road
6th Floor
Sudbury, Ontario
P3E 6B5

Telephone: (888) 415-9845
Fax: (877) 670-1555

November 30, 2000

TEMEX RESOURCES LTD.
4307 KERRY DRIVE, SUITE 100
BURLINGTON, ONTARIO
L7L-1V8

Visit our website at:
www.gov.on.ca/MNDM/MINES/LANDS/mlsmnpge.htm

Dear Sir or Madam:

Submission Number: 2.20620

Status

Subject: Transaction Number(s): W0070.00189 Approval

We have reviewed your Assessment Work submission with the above noted Transaction Number(s). The attached summary page(s) indicate the results of the review. **WE RECOMMEND YOU READ THIS SUMMARY FOR THE DETAILS PERTAINING TO YOUR ASSESSMENT WORK.**

If the status for a transaction is a 45 Day Notice, the summary will outline the reasons for the notice, and any steps you can take to remedy deficiencies. The 90-day deemed approval provision, subsection 6(7) of the Assessment Work Regulation, will no longer be in effect for assessment work which has received a 45 Day Notice. Allowable changes to your credit distribution can be made by contacting the Geoscience Assessment Office within this 45 Day period, otherwise assessment credit will be cut back and distributed as outlined in Section #6 of the Declaration of Assessment work form.

Please note any revisions must be submitted in DUPLICATE to the Geoscience Assessment Office, by the response date on the summary.

If you have any questions regarding this correspondence, please contact BRUCE GATES by e-mail at bruce.gates@ndm.gov.on.ca or by telephone at (705) 670-5856.

Yours sincerely,



ORIGINAL SIGNED BY
Lucille Jerome
Acting Supervisor, Geoscience Assessment Office
Mining Lands Section

Work Report Assessment Results

Submission Number: 2.20620

Date Correspondence Sent: November 30, 2000

Assessor: BRUCE GATES

Transaction Number	First Claim Number	Township(s) / Area(s)	Status	Approval Date
W0070.00189	47113	STRATHCONA	Approval	November 28, 2000

Section:
17 Assays ASSAY

Correspondence to:

Resident Geologist
Kirkland Lake, ON

Assessment Files Library
Sudbury, ON

Recorded Holder(s) and/or Agent(s):

Daniel Peter Bunner
OAKVILLE, ONTARIO, CANADA

TEMEX RESOURCES LTD.
BURLINGTON, ONTARIO

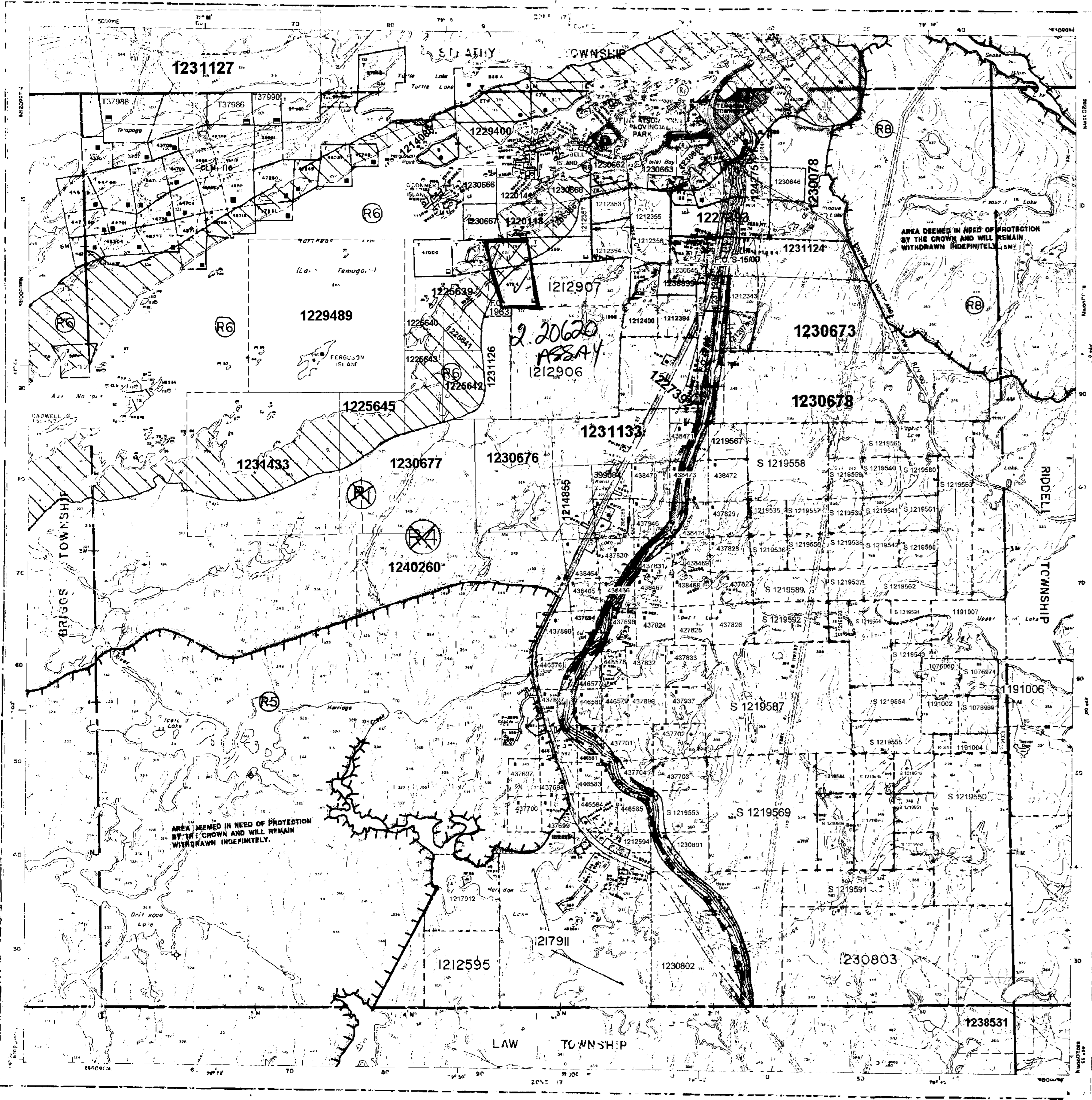

INDEX TO LAND DISPOSITION

PLAN
G-3450
 TOWNSHIP
STRATHCONA

S.M.R. ADMINISTRATIVE DISTRICT
TEMAGAMI
 MINING DIVISION
SUDBURY
 LAND TITLES/REGISTRY DIVISION
NIPISSING

THE INFORMATION THAT APPEARS ON THIS MAP HAS BEEN COMPILED FROM VARIOUS SOURCES, AND ACCURACY IS NOT GUARANTEED. THOSE WISHING TO STAKE MINING CLAIMS SHOULD CONSULT WITH THE MINING RECORDER, MINISTRY OF NORTHERN DEVELOPMENT AND MINES, FOR ADDITIONAL INFORMATION ON THE STATUS OF THE LANDS SHOWN HEREON.

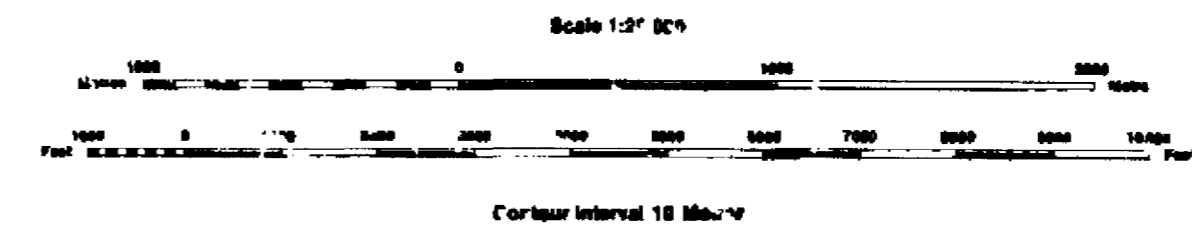

SYMBOLS

- Boundary
- Township, Meridian, Baseline
- Road allowance; surveyed
- shoreline
- Lot/Concession; surveyed
- unsurveyed
- Parcel; surveyed
- unsurveyed
- Right-of-way; road
- railway
- utility
- Reservation
- Cliff, Pit, Pile
- Contour
- Interpolated
- Approximate
- Depression
- Control point (horizontal)
- Flooded land
- Mine head frame
- Pipeline (above ground)
- Railway; single track
- double track
- abandoned
- Road; highway, county, township
- access
- trail, wash
- Shoreline (original)
- Transmission line
- Wooded area

AREAS WITHDRAWN FROM DISPOSITION

M.R.O. - MINING RIGHTS ONLY
 S.R.O. - SURFACE RIGHTS ONLY
 M+S. - MINING AND SURFACE RIGHTS

Description	Order No.	Date	Disposition	File
SEC. 35/90	W-3-45/90	23/10/90	M+S	195150
SEC. 35/90	W-3-47/90	26/10/90	SRO	195150
SEC. 35/90	W-3-48/90	26/10/90	M+S	195150
SEC. 35/90	W-3-49/90	26/10/90	M+S	195150
SEC. 35/90	W-3-50/90	26/10/90	M+S	195150
SEC. 35/90	W-3-51/90	26/10/90	M+S	195150
SEC. 35/90	W-3-52/90	26/10/90	M+S	195150
SEC. 35/90	W-3-53/90	26/10/90	M+S	195150
SEC. 35/90	W-3-54/90	26/10/90	M+S	195150
SEC. 35/90	W-3-55/90	26/10/90	M+S	195150
SEC. 35/90	W-3-56/90	26/10/90	M+S	195150
SEC. 35/90	W-3-57/90	26/10/90	M+S	195150
SEC. 35/90	W-3-58/90	26/10/90	M+S	195150
SEC. 35/90	W-3-59/90	26/10/90	M+S	195150
SEC. 35/90	W-3-60/90	26/10/90	M+S	195150
SEC. 35/90	W-3-61/90	26/10/90	M+S	195150
SEC. 35/90	W-3-62/90	26/10/90	M+S	195150
SEC. 35/90	W-3-63/90	26/10/90	M+S	195150
SEC. 35/90	W-3-64/90	26/10/90	M+S	195150
SEC. 35/90	W-3-65/90	26/10/90	M+S	195150
SEC. 35/90	W-3-66/90	26/10/90	M+S	195150
SEC. 35/90	W-3-67/90	26/10/90	M+S	195150
SEC. 35/90	W-3-68/90	26/10/90	M+S	195150
SEC. 35/90	W-3-69/90	26/10/90	M+S	195150
SEC. 35/90	W-3-70/90	26/10/90	M+S	195150

NOTES

80% of both of the "Highway" reserved in the "Proclamation" file: 100707.
 RESERVED IN THE "Highway" RESERVE IN THE "Proclamation" FILE: 100707.
 UNDER THE MINING ACT - ORDER IN COUNCIL - IN DEC. 1984, FILE 9438 V.2.
 ORDER IN COUNCIL - IN DEC. 1984, FILE 9438 V.2.

DISPOSITION OF CROWN LANDS

- Patent
- Surface & Mining Rights
- Surface Rights Only
- Mining Rights Only
- Lease
- Surface & Mining Rights
- Surface Rights Only
- Mining Rights Only
- Licence of Occupation
- Order-in-Council
- Cancelled
- Reservation
- Sand & Gravel
- LAND USE PERMIT

NOTICE

WORK PERMITS FOR MINERAL EXPLORATION ACTIVITY
 SEPTEMBER 15TH 1998
 The area shown as SKYLINE RESERVE and the land covered by the waters of LAKE TEMAGAMI on this map will be subject to Ontario Regulation 349/98 made under the Public Lands Act. Depending on the type and timing of your exploration work you may require a Work Permit. For further information please contact Gerhard Mayer, Regional Resident Geologist at (705) 567-5242 or Jeff FRASER, Regional Mining Engineer at (705) 235-1672.

NOTICE

Pursuant to Section 35, of the Mining Act, R.S.O. 1990, the MINING AND SURFACE RIGHTS of the area shown as SKYLINE RESERVE and the land covered by the waters of LAKE TEMAGAMI as indicated on this map will be REOPENED TO PROSPECTING AND STAKING OBT. This Order comes into effect on October 27, 1998 at 9:00 a.m. Eastern Standard Time, which is equivalent to 8:00 a.m. local time. These lands will be subject to Ontario Regulation 356/98 made under the Mining Act. ALL CLAIM STAKING ACTIVITY IN THIS AREA is subject to this new regulation. MAJOR AMENDMENTS TO NORMAL STAKING PRACTICES HAVE BEEN IMPLEMENTED FOR THIS AREA. Consult and understand these amendments prior to carrying out any staking in this designated area. For further information please contact the Provincial Records Office at 1-888-415-9944.

PLEASE NOTE: THE ISLAND ON LAKE TEMAGAMI ARE WITHDRAWN AND WILL NOT BE OPEN TO PROSPECTING AND STAKING OBT.