

BREATHER PLUGS

TCF/Z - FILLING PLUG WITH BREATHER

- Threaded plug with knurled round head for hand-tightening.
- Hole for venting internal pressure.
- For application only on upper part of the crankcase away from moving parts.
- For applications requiring extra-tight sealing, type TSFT/N is recommended.

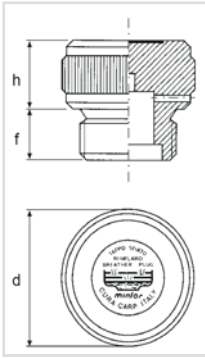

TYPE	CODE	GAS	h	f	d
TCF/ZOG	1GCFZ00A	1/8"	12	8	20
TCF/Z1G	1GCFZ10A	1/4"	12	8	22
TCF/Z2G	1 GCFZ20A	3/8"	13,5	10	26
TCF/ZOG	1GCFZ30A	1/2"	16,5	10	30
TCF/Z4G	1 GCFZ40A	3/4"	20	12	40
TCF/Z5G	1GCFZ50A	1"	21,5	14	45
TCF/ZOG	1GCFZ60A	1"1/4	20	15	55
TCF/Z7G	1 GCFZ70A	1"1/2	20	15	55
TCF/Z8G	1 GCFZ80A	2"	20	17	70

TYPE	CODE	MB SERIES	h	f	d
TCF/ZOM	1 MCFZ00A	10 x 1	12	8	20
TCF/Z1 M	1MCFZ10A	14 x 1,5	12	8	22
TCF/Z2M	1MCFZ20A	16 x 1,5	12	10	26
TCF/ZOM	1MCFZ30A	18 x 1,5	12	10	26
TCF/Z4M	1 MCFZ40A	20 x 1,5	15	10	30
TCF/Z5M	1MCFZ50A	22 x 1,5	15	10	30
TCF/ZOM	1MCFZ60A	24 x 2	15	12	36
TCF/Z7M	1 MCFZ70A	30 x 2	20	12	42
TCF/Z8M	1 MCFZ80A	33 x 2	21,5	14	45

TCF - FILLING PLUG WITH BREATHER

- Hole for venting internal pressure.
- For application only on upper part of the crankcase away from moving parts.
- For applications requiring extra-tight sealing, type TSFT/N is recommended.

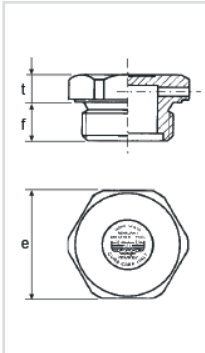

TYPE	CODE	GAS	t	f	e
TCFOG	1 GTC F00A	1/8"	5	8	14
TCF1 G	1GTCF10A	1/4"	7,5	8	17
TCF2G	1GTCF20A	3/8"	8,5	10	22
TCFOG	1GTCF30A	1/2"	8,5	10	27
TCF4G	1 GTCF40A	3/4"	9,5	12	32
TCFOG	1GTCF50A	1"	9,5	14	40
TCFOG	1GTCF60A	1"1/4	10	15	50
TCF7G	1GTCF70A	1"1/2	10	15	55
TCFOG	1 GTCF80A	2"	12	17	70

TYPE	CODE	MB SERIES	t	f	e
TCFOM	1 MTC F00A	10 x 1	5	8	14
TCF1M	1MTCF10A	14 x 1,5	6	8	17
TCF2M	1MTCF20A	16 x 1,5	7	10	22
TCF3M	1MTCF30A	18 x 1,5	7	10	22
TCF4M	1 MTCF40A	20 x 1,5	7	10	24
TCF5M	1MTCF50A	22 x 1,5	8,5	10	27
TCF6M	1MTCF60A	24 x2	8	12	30
TCF7M	1MTCF70A	26 x1,5	8	12	32
TCF8M	1 MTCF80A	30 x2	8	12	36
TCF9M	1MTCF90A	33 x2	8	14	40
TCF10M	1MTCF91A	42 x3	10	15	50
TCF11M	1 MTCF92A	48 x3	10	15	55
TCF12M	1MTCF93A	60 x 4	12	17	70

TCF/F - FILLING PLUG WITH BREATHER AND MILLED HEAD

- Hole for venting internal pressure.
- The milled head produces a crown with greater adherence area to the crankcase.
- For application only on upper part of the crankcase away from moving parts.
- For applications requiring extra-tight sealing, type TSFT/N is recommended



TYPE	CODE	GAS	d	t	f	e
TCF/FOG	1G F/FOOA	1/8"	14	7	8	10
TCF/F1G	1G F/F10A	1/4"	20	9,5	8	17
TCF/F2G	1G F/F20A	3/8"	22	10	9	18
TCF/FOG	1G F/F30A	1/2"	28	10,5	11	22
TCF/F4G	1G F/F40A	3/4"	32	10,5	12	27
TCF/F5G	1G F/F50A	1"	40	12	12,5	34

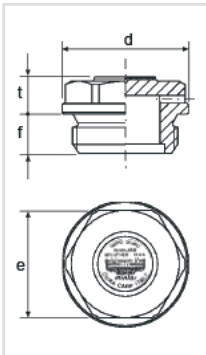

TYPE	CODE	MB SERIES	d	t	f	e
TCF/FOM	1MF/FOOA	10 x 1	14	7	8	10
TCF/F1M	1MF/F10A	14 x 1,5	20	8	8	17
TCF/F2M	1MF/F20A	16 x 1,5	22	10	9	18
TCF/FOM	1MF/F30A	18 x 1,5	26	8	9	20
TCF/F4M	1M F/F40A	20 x 1,5	28	9	11	22
TCF/F5M	1M F/F50A	22 x 1,5	28	10,5	11	22

TCFS - FILLING PLUG AND BREATHER

- Threaded plug with hex head and with hole and a spherical bronze filter which vent internal pressure and keep out foreign bodies during the intake stroke.
- The built-in filter has a filtration degree of 40 microns.
- The TCFS is especially suitable in dusty environments and with very small encumbrance.



TYPE	CODE	GAS	t	f	e	μ
TCFS1G	1GCFS10A	1/4"	7,5	8	17	40
TCFS2G	1 GCFS20A	3/8"	8,5	9	22	40
TCFS3G	1GCFS30A	1/2"	7	12	27	40
TCFS4G	1GCFS40A	3/4"	8	14	32	40
TCFS5G	1GCFS50A	1"	8	16	40	40

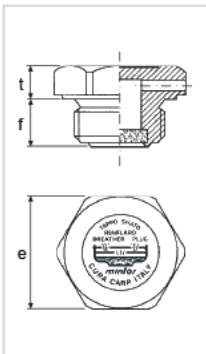

TYPE	CODE	MB SERIES	t	f	e	μ
TCFS1M	1MCFS10A	14 x 1,5	6	8	17	40
TCFS2M	1MCFS20A	16 x 1,5	7	9	22	40
TCFS3M	1MCFS30A	18 x 1,5	7	9	22	40
TCFS4M	1 MCFS40A	20 x 1,5	7	12	24	40
TCFS5M	1 MCFS50A	22 x 1,5	7	12	27	40

TCSF/Z - FILLING PLUG AND BREATHER

- Threaded plug with knurled round head for hand-tightening.
- The hole and a spherical bronze filter vent internal pressure and keep out foreign bodies during the intake stroke.
- The built-in filter has a filtration degree of 40 microns.
- The TCSF/Z is therefore especially suitable in dusty environments and is recommended for applications on Hydraulic Units.



TYPE	CODE	GAS	h	f	d	μ
TCSF/Z1G	1GSFZ10A	1/4"	12	8	22	40
TCSF/Z2G	1GSFZ20A	3/8"	12	10	26	40
TCSF/Z3G	1GSFZ30A	1/2"	16,5	12	30	40
TCSF/Z4G	1GSFZ40A	3/4"	20	13,5	40	40
TCSF/Z5G	1GSFZ50A	1"	21,5	14	45	40
TCSF/Z6G	1GSFZ60A	1" 1/4	21,5	16	55	200
TCSF/Z7G	1GSFZ70A	1" 1/2	21,5	16	55	200
TCSF/Z8G	1GSFZ80A	2"	20	17	70	200

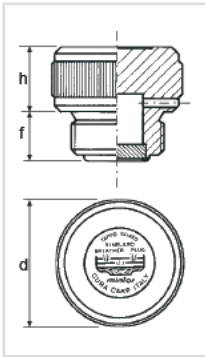

TYPE	CODE	MB SERIES	h	f	d	μ
TCSF/Z1M	1MSFZ10A	14 x 1,5	12	8	22	40
TCSF/Z2M	1MS FZ20A	16 x 1,5	12	10	26	40
TCSF/Z3M	1MS FZ30A	18 x 1,5	12	10	26	40
TCSF/Z4M	1MS FZ40A	20 x 1,5	15	12	30	40
TCSF/Z5M	1MS FZ50A	22 x 1,5	15	12	30	40
TCSF/Z6M	1MS FZ60A	24 x 2	15	13,5	36	40
TCSF/Z7M	1MS FZ70A	30 x 2	20	14	42	40
TCSF/Z8M	1MS FZ80A	33 x 2	20	14	45	40

TMV - BREATHER PLUG

- Breather plug with O-ring and external valve with an inox spring calibrated from 0,10 to 0,15 bar.
- It opens at intervals and vents internal pressure.
- The valve has the double function of keeping out foreign bodies and avoid fluid leakage.
- It is especially recommended for Differentials, Transmissions and small Speed Reducers.



TYPE	CODE	GAS	t	f	e
TMVOG	1GTMVO0A	1/8"	5	8	14
TMV1G	1GTMV10A	1/4"	6	8	17
TMV2G	1GTMV20A	3/8"	7	10	22
TMVOG	1GTMV30A	1/2"	7	10	27
TMV4G	1GTMV40A	3/4"	8	12	32
TMVOG	1GTMV50A	1"	8	14	40

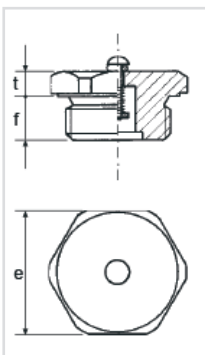

TYPE	CODE	MB SERIES	t	f	e
TMVOM	1MTMVO0A	10 x 1	5	8	14
TMV1M	1MTMV10A	12 x 1,5	6	8	17
TMV2M	1MTMV20A	14 x 1,5	6	8	17
TMVOM	1MTMV30A	16 x 1,5	7	10	22
TMV4M	1MTMV40A	18 x 1,5	7	10	22
TMVOM	1MTMV50A	20 x 1,5	7	10	24
TMVOM	1MTMV60A	22 x 1,5	7	10	27

TSVV - BREATHER PLUG WITH DOUBLE VALVE

- Breather plug with double valve made of hardened and tempered light alloy. It is provided with standard 0,10 bar calibration, which can be adjusted by the operator depending on the intended use.
- The double valve ensures venting of internal pressure and inlet of air when the flow medium level decreases thus hindering cavitation on delivery.
- Particularly suitable for Tanks, Oil-hydraulic Circuits and Hydraulically Operated Lifting Machines.



TYPE	CODE	GAS	t	f	e
TSVV1G	1GSVV10A	1/4"	10	10	17
TSVV2G	1GSVV20A	3/8"	10	10	22
TSVV3G	1GSVV30A	1/2"	10	10	27
TSVV4G	1GSVV40A	3/4"	8	12	32
TSVV5G	1GSVV50A	1"	8	14	40
TSVV/Z7G	1GSVVZ70	1" 1/2	31	14	55
TSVV/Z8G	1GSVVZ80	2"	31	14	70

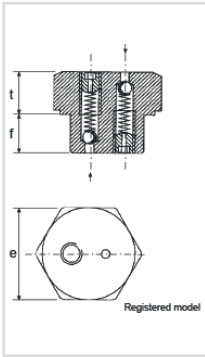

TYPE	CODE	MB SERIES	t	f	e
TSVVOM	1MSVV00A	12 x 1,5	10	10	17
TSVV1M	1MSVV10A	14 x 1,5	10	10	17
TSVV2M	1MSVV20A	16 x 1,5	10	10	22
TSVVOM	1MSVV30A	18 x 1,5	10	10	22
TSVV4M	1MSVV40A	20 x 1,5	10	10	24
TSVVOM	1MSVV50A	22 x 1,5	10	10	27
TSVVOM	1MSVV60A	24 x 1,5	10	10	30
TSVV7M	1MSVV70A	26 x 1,5	8	12	32
TSVVOM	1MSVV80A	30 x 2	8	12	36
TSVV9M	1MSVV90A	33 x 2	8	14	40

TSFO/R - BREATHER PLUG

- Oil filling and breather plug with galvanized-steel cover.
- Large internal chamber with O-ring especially designed for Agricultural and Earth-moving Machines, to be applied wherever there is strong sloshing of the fluids.



TYPE	CODE	GAS	d	h	f	e
TSFO/ROG	1GTOROOM	1/8"	21	21	8	17
TSFO/R1 G	1GTOR1OM	1/4"	21	21	8	17
TSFO/R2G	1GTOR2OM	3/8"	24	23	9	20
TSFO/R3G	1GTOR3OM	1/2"	30	26	10	27
TSFO/R4G	1GTOR4OM	3/4"	30	24	12	32
TSFO/R5G	1GTOR5OM	1"	38	29	14	40

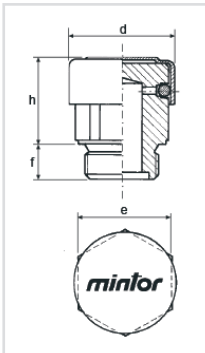

TYPE	CODE	MB SERIES	d	h	f	e
TSFO/ROM	1MTOROOM	10 x 1	21	21	8	17
TSFO/R1 M	1MTOR1OM	14 x 1,5	21	21	8	17
TSFO/R2M	1MTOR2OM	16 x 1,5	24	23	9	20
TSFO/R3M	1MTOR3OM	18 x 1,5	30	26	10	27
TSFO/R4M	1MTOR4OM	20 x 1,5	30	26	10	27
TSFO/R5M	1MTOR5OM	22 x 1,5	30	26	10	27

TSF - OIL FILLING PLUG WITH BREATHER

- A galvanized-steel cover and a spherical bronze filter vent internal pressure and keep out foreign bodies during the intake stroke.
- The built-in filter has a filtration degree of 40 microns.
- The TSF is therefore especially suitable in dusty environments and is recommended for applications on Hydraulic Units and Cylinders.

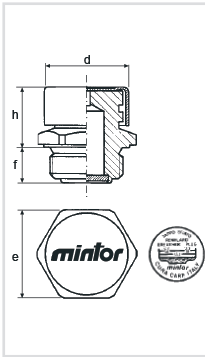

TYPE	CODE	GAS	d	h	f	e	μ
TSF1G	1GTSF10M	1/4"	16,5	17	8	17	40
TSF2G	1GTSF20M	3/8"	22	19	10	22	40
TSF3G	1GTSF30M	1/2"	26	21	12	27	40
TSF4G	1GTSF40M	3/4"	30	24	14	32	40
TSF5G	1GTSF50M	1"	38	29	16	40	40
TSF6G	1GTSF60A	1 1/4"	50	33	16	50	200
TSF7G	1GTSF70A	1 1/2"	55	35	16	55	200
TSF8G	1GTSF80A	2"	70	40	16	70	200

TYPE	CODE	MB SERIES	d	h	f	e	μ
TSF1M	1MTSF10M	14 x 1,5	16,5	17	8	17	40
TS F2M	1MTSF20M	16 x 1,5	22	19	10	22	40
TS F3M	1MTSF30M	18 x 1,5	22	19	10	22	40
TSF4M	1MTSF40M	20 x 1,5	24	21	12	24	40
TSF5M	1MTSF50M	22x 1,5	26	21	12	27	40
TSF6M	1MTSF60M	24 x 2	30	24	12	30	40
TSF7M	1MTSF70M	30 x 2	30	25	14	36	40
TSF8M	1MTSF80M	33 x 2	38	29	16	40	40
TSF9M	1MTSF90A	42 x 3	50	33	16	50	200
TSF10M	1MTSF91A	48 x 3	55	35	16	55	200
TSF11M	1MTSF92A	60 x 4	70	40	16	70	200

TSFA - OIL FILLING PLUG AND BREATHER

- A galvanized-steel cover and a spherical bronze filter vent internal pressure and keep out foreign bodies during the intake stroke.
- The built-in filter has a filtration degree of 40 microns.
- The TSFA is therefore especially suitable in dusty environments and is recommended for applications in the motor field.

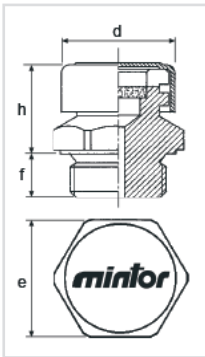

TYPE	CODE	GAS	d	h	f	e	μ
TSFAOG	1GTS FAOM	1/8"	16,5	16	8	14	40
TSFA1G	1GTSFA1M	1/4"	16,5	17	8	17	40
TSFA2G	1GTSFA2M	3/8"	22	19	11	22	40
TSFAOG	1GTSFA3M	1/2"	26	20	11	27	40
TSFA4G	1GTSFA4M	3/4"	30	24	12	32	40
TSFAOG	1GTSFA5M	1"	38	29	14	40	40

TYPE	CODE	MB SERIES	d	h	f	e	μ
TSFAOM	1MTSFAOM	10 x 1	16,5	16	8	14	40
TSFA1 M	1MTSFA1M	12 x 1,5	16,5	17	8	17	40
TSFA2M	1MTSFA2M	14 x 1,5	16,5	17	8	17	40
TSFAOM	1MTSFA3M	16 x 1,5	22	19	11	22	40
TSFA4M	1MTSFA4M	18 x 1,5	22	19	11	22	40
TSFAOM	1MTSFA5M	20 x 1,5	24	20	11	24	40
TSFAOM	1MTSFA6M	22 x 1,5	26	20	11	27	40
TSFA7M	1MTSFA7M	24 x 1,5	30	24	12	30	40
TSFAOM	1MTSFA8M	26 x 1,5	30	24	12	32	40
TSFA9M	1MTSFA9M	30 x 1,5	30	25	14	36	40

TSFT/N - OIL FILLING PLUG AND BREATHER

- Large chamber with labyrinth and perpendicular cut protected by a galvanized-steel cover.
- The pressure created by moving parts within the gearbox is vented through the labyrinth without oil spattering, even though the plug is mounted vertically to the parts.

- Particularly suitable for mounting on Reduction Gears, Geared Motors, Speed Variators and Gearshift Boxes.

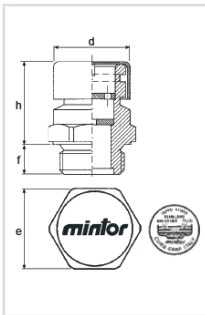

TYPE	CODE	GAS	d	h	f	e
TSFT/N1G	1GTSN10M	1/4"	16.5	23	8	17
TSFT/N2G	1GTSN20M	3/8"	22	29	9	22
TSFT/N3G	1GTSN30M	1/2"	26	29	10	27
TSFT/N4G	1GTSN40M	3/4"	30	35	12	32
TSFT/N5G	1GTSN50M	1"	38	43	14	40
TSFT/N6G	1GTSN60A	1" 1/4	50	45	15	50
TSFT/N7G	1GTSN70A	1" 1/2	55	46	15	55
TSFT/N8G	1GTSN80A	2"	70	46	17	70

TYPE	CODE	MB SERIES	d	h	f	e
TSFT/N1M	1MTSN10M	14 x 1,5	16,5	23	8	17
TSFT/N2M	1MTSN20M	16 x 1,5	22	29	9	22
TSFT/N3M	1MTSN30M	18 x 1,5	22	29	9	22
TSFT/N4M	1MTSN40M	20 x 1,5	24	29	10	24
TSFT/N5M	1MTSN50M	22 x 1,5	26	29	10	27
TSFT/N6M	1MTSN60M	24x2	30	35	12	30
TSFT/N7M	1MTSN70M	30 x 2	30	42	12	36
TSFT/N8M	1MTSN80M	33 x 2	38	43	14	40
TSFT/N9M	1MTSN90A	42 x 3	50	45	15	50
TSFT/N10M	1MTSN91A	48 x 3	55	46	15	55
TSFT/N11M	1MTSN92A	60 x 4	70	46	17	70

TSS - BREATHER PLUG WITH VALVE

- Breather plug with galvanized-steel cover and specially-designed internal valve with an inox spring, calibrated from 0,05 to 0,10 bar, which opens at intervals to vent internal pressure created by fluid turbulence and keep out foreign bodies.

- It is especially recommended for applications on Speed-shift Gears, Agricultural over-Gears and Industrial Speed-Reduction Gearboxes.

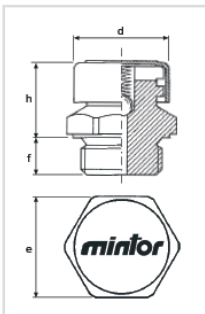

TYPE	CODE	GAS	d	h	f	e
TSSOG	1 GTSSO0M	1/8"	16,5	16	8	14
TSS1 G	1GTSS10M	1/4"	16,5	17	9,5	17
TSS2G	1 GTSS20M	3/8"	22	19	11	22
TSSOG	1GTSS30M	1/2"	26	20	11	27
TSS4G	1 GTSS40M	3/4"	30	24	12	32
TSSOG	1GTSS50M	1"	38	29	14	40

TYPE	CODE	GAS	d	h	f	e
TSSOM	1MTSSO0M	10 x 1	16,5	16	8	14
TSS1 M	1MTSS10M	14 x 1,5	16,5	17	9,5	17
TSS2M	1MTSS20M	16 x 1,5	22	19	11	22
TSSOM	1MTSS30M	18 x 1,5	22	19	11	22
TSS4M	1 MTSS40M	20 x 1,5	24	20	11	24
TSSOM	1MTSS50M	22 x 1,5	26	20	11	27
TSSOM	1MTSS60M	24 x 2	30	24	12	30
TSS7M	1MTSS70M	30 x 2	30	25	14	36
TSSOM	1MTSS80M	33 x 2	38	29	14	40

PRS/F - EXTENSION FOR OIL WITH BREATHER

- Made of aluminium alloy, same thread for both internal and external side, with large chamber with labyrinth.
- Particularly suitable for Agricultural, Earth Moving and Building Machines.



TYPE	CODE	GAS	d	h	f	e
PRS/F1G	1GPSF10A	Ye	20	40	8	17
PRS/F2G	1G PSF20A	3/8"	26	40	10	22
PRS/F3G	1G PSF30A	1/2"	30	40	11	27
PRS/F4G	1G PSF40A	3/4"	36	50	12	32
PRS/F5G	1G PSF50A	1"	42	50	14	38

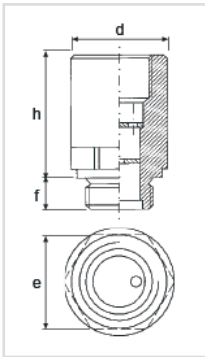

TYPE	CODE	MB SERIES	d	h	f	e
PRS/F1M	1MPSF10A	14 x 1,5	20	40	8	17
PRS/F2M	1M PSF20A	16 x 1,5	26	40	10	22
PRS/F3M	1M PSF30A	18 x 1,5	26	40	10	22
PRS/F4M	1M PSF40A	20 x 1,5	30	40	11	27
PRS/F5M	1M PSF50A	22 x 1,5	30	40	11	27

MAGNETIC PLUGS

TCEM - MAGNETIC OIL DRAIN PLUG WITH HEX SLOT

- Made of tempered, hardened alloy.
- Especially recommended for high-rpm machinery.
- A permanent magnetic insert of special alloy attracts and holds ferrous particles suspended or circulating in the oil.
- Available with metal washers only.



TYPE	CODE	GAS	e	g	h	f	t	d
TCEMOG	1GTEMOOA	1/8"	5	5	4	8	3	14
TCEM1G	1GTEM10A	1/4"	6	5	5	12	3	18
TCEM2G	1GTEM20A	3/8"	8	5	5	12	3	22
TCEMOG	1GTEM30A	1/2"	10	6	5	14	4	26
TCEM4G	1GTEM40A	3/4"	12	10	6	16	4	32
TCEMOG	1GTEM50A	1"	17	10	6	16	5	40
TCEMOG	1GTEM60A	1" 1/4	22	15	10	16	5	49
TCEM7G	1GTEM70A	1" 1/2	24	15	10	16	5	55
TCEMOG	1GTEM80A	2"	32	15	15	20	5	68

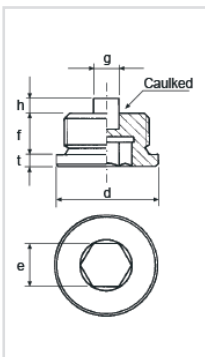

TYPE	CODE	MB SERIES	e	g	h	f	t	d
TCEMOM	1MTEMOOA	10 x 1	5	5	4	8	3	14
TCEM1M	1MTEM10A	12 x 1,5	6	5	4	12	3	17
TCEM2M	"1MTEM20A"	14 x 1,5	6	5	5	12	3	19
TCEM3M	1MTEM30A"	16 x 1,5	8	5	5	12	3	21
TCEM4M	1MTEM40A	18 x 1,5	8	6	5	12	3	23
TCEM5M	1MTEM50A	20 x 1,5	10	6	5	14	4	25
TCEM6M	1MTEM60A	22 x 1,5	10	6	5	14	4	27
TCEM7M	1MTEM70A	24 x 1,5	12	6	5	14	4	29
TCEM8M	1MTEM80A	24 x 2	12	6	5	14	4	29
TCEM9M	1MTEM90A	26 x 1,5	12	10	6	16	4	32
TCEM10M	1MTEM91A	27x 2	12	10	6	16	4	32
TCEM11M	1MTEM92A	30 x 1,5	17	10	6	16	4	36
TCEM12M	1MTEM93A	30x 2	17	10	6	16	4	36
TCEM13M	1MTEM94A	33x 2	17	10	6	16	5	40

TSCM - MAGNETIC DRAIN PLUG

- A magnetic insert attracts and holds ferrous particles suspended or circulating in the oil, safeguarding rotating parts.
- Recommended for high-rpm machinery.

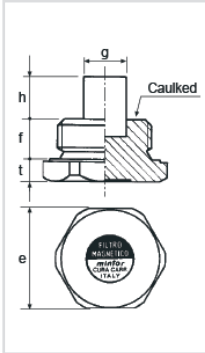

TYPE	CODE	GAS	e	g	h	f	t
TSCMOG	1GSCMOOA	1/8"	14	5	6	8	5
TSCM1G	1GSCM10A	1/4"	17	5	6	8	7,5
TSCM2G	1GSCM20A	3/8"	22	6	6	10	8,5
TSCM3G	1GSCM30A	1/2"	27	8	8	10	8,5
TSCM4G	1GSCM40A	3/4"	32	10	10	12	9,5
TSCM5G	1GSCM50A	1"	40	15	15	14	9,5
TSCM6G	1GSCM60A	1" 1/4	50	15	15	15	10
TSCM7G	1GSCM70A	1" 1/2	55	15	15	15	10
TSCM8G	1GSCM80A	2"	70	15	15	17	12

TYPE	CODE	MB SERIES	e	g	h	f	t
TSCMOM	1MSCMOOA	10 x 1	14	5	6	8	5
TSCM1M	1MSCM10A	12 x 1,5	17	5	6	8	6
TSCM2M	1MSCM20A	14 x 1,5	17	5	6	8	6
TSCM3M	1MSCM30A	16 x 1,5	22	6	6	10	8,5
TSCM4M	1MSCM40A	18 x 1,5	22	6	6	10	8,5
TSCM5M	1MSCM50A	20 x 1,5	24	8	8	10	7
TSCM6M	1MSCM60A	22 x 1,5	27	8	8	10	8,5
TSCM7M	1MSCM70A	24 x 2	30	10	10	12	8
TSCM8M	1MSCM80A	30 x 2	36	10	10	12	8
TSCM9M	1MSCM90A	33 x 2	40	15	15	14	8
TSCM10M	1MSCM91A	42 x 3	50	15	15	15	10
TSCM11M	1MSCM92A	48 x 3	55	15	15	15	10
TSCM12M	1MSCM93A	60 x 4	70	15	15	17	12

TSCM/F - MAGNETIC DRAIN PLUG WITH MILLED HEAD

- Head milling produces a crown with greater sealing area against the crankcase.
- Recommended for high-rpm machinery.
- A magnetic insert attracts and holds ferrous particles suspended or circulating in the oil, protecting all rotating parts.

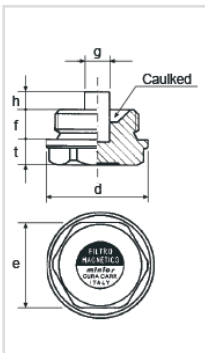

TYPE	CODE	GAS	e	g	h	f	t	d
TSCIWFOG	1GM/FOOA	1/8"	10	5	4	8	8	14
TSCIWF1G	1GM/F10A	1/4"	14	5	4	8	9,5	18
TSCWF2G	1GM/F20A	3/8"	18	5	5	9	10	22
TSCM/F3G	1GM/F30A	1/2"	22	6	6	11	10,5	28
TSCM/F4G	1GM/F40A	3/4"	27	10	6	12	12	32
TSCIWF5G	1GM/F50A	1"	34	10	7	14	12	40

TYPE	CODE	MB SERIES	e	g	h	f	t	d
TSCM/FOM	1MM/FOOA	10 x 1	10	5	4	8	8	14
TSCM/F1M	1MM/F10A	14 x 1,5	14	5	4	8	8	18
TSCWF2M	1MM/F20A	16 x 1,5	18	5	5	9	10	22
TSCWF3M	1MM/F30A	18 x 1,5	18	5	5	9	9	24
TSCWF4M	1MM/F40A	20 x 1,5	20	6	6	10	9	26
TSCWF5M	1MM/F50A	22 x 1,5	22	6	6	11	10,5	28
TSCWF6M	1MM/F60A	24 x 2	24	8	6	12	9	30
TSCWF7M	1MM/F70A	30 x 2	30	10	6	12	10,5	38
TSCWF8M	1MM/F80A	33 x 2	34	10	7	14	10,5	40

FMC - MAGNETIC FILTER ROD

- Head of hardened, tempered light alloy.
- Permanent magnetic sections of special alloy with wide-radius action.
- Non-magnetic coating is smooth for easier, better cleaning.
- Recommended for Grinding Machines, Hydraulic Units and Large tanks.
- On request, supplied with different length.



TYPE	CODE	GAS	t	f	l	h	g	e
FMC1G	1GFMC10A	3/8"	7	10	80	70	9	22
FMC2G	1G FMC20A	1/2"	9,5	10	95	85	12	27
FMC3G	1G FMC30A	3/4"	9,5	12	102	90	17	32
FMC4G	1G FMC40A	1"	9,5	14	104	90	17	40
FMC5G	1G FMC50A	1" 1/4	10	15	105	90	28	50
FMC6G	1G FMC60A	1" 1/2	10	15	105	90	28	55
FMC7G	1G FMC70A	2"	12	17	107	90	28	70

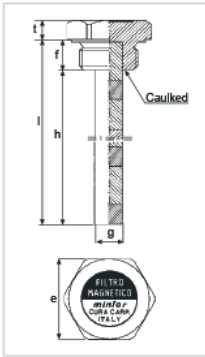

TYPE	CODE	MB SERIES	t	f	l	h	g	e
FMC1M	1MFMC10A	16 x 1,5	7	10	80	70	9	22
FMC2M	1MFMC20A	18 x 1,5	7	10	80	70	9	22
FM C3M	1MFMC30A	20 x 1,5	7	10	95	85	12	24
FMC4M	1MFMC40A	22 x 1,5	8,5	10	95	85	12	27
FMC5M	1MFMC50A	24 x 2	8	12	102	90	12	30
FM C6M	1MFMC60A	30 x 2	8	12	102	90	17	36
FMC7M	1MFMC70A	33 x 2	8	14	104	90	17	40
FMC8M	1MFMC80A	42 x 3	10	15	105	90	28	50
FM C9M	1MFMC90A	48 x 3	10	15	105	90	28	55
FMC10M	1M FMC95A	60 x 4	12	17	107	90	28	70

FMC/LS - MAGNETIC FILTER WITH DIPSTICK AND BREATHER

- Magnetic dipstick built into breather plug.
- Galvanized-steel cover vents internal pressure and keeps out foreign bodies during the intake stroke.
- The magnetic dipstick is composed of permanent magnetic sections in special alloy with wide-radius action.
- The non-magnetic coating is smooth for easier, better cleaning.
- Recommended for Grinding Machines Hydraulic Units and Large Tanks.
- On request, supplied with different length.



TYPE	CODE	GAS	t	f	l	h	g	e
FMC/LS1G	1GFLS10A	1/2"	26	22	10	170	9	27
FMC/LS2G	1G FLS20A	3/4"	30	24	12	200	12	32
FMC/LS3G	1G FLS30A	1"	38	29	14	200	12	40
FM C/LS4G	1G FLS40A	1" 1/4	50	33	15	200	17	50

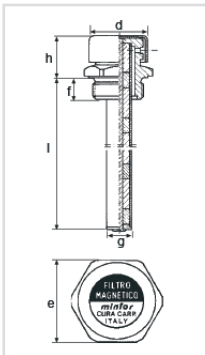

DRAIN FILLING PLUGS

TC/Z - FILLING PLUG

- Threaded plug with knurled round head for hand-tightening.
By request: with filling label

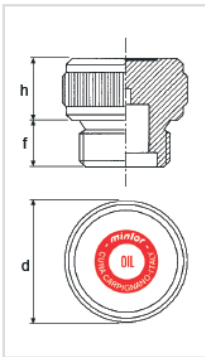

TYPE	CODE	GAS	h	f	d
TC/Z0G	1GCZ00A	1/8"	12	8	20
TC/Z1G	1GCZ010A	1/4"	12	8	22
TC/Z2G	1GCZ020A	3/8"	13,5	10	26
TC/Z3G	1GCZ030A	1/2"	16,5	10	30
TC/Z4G	1GCZ040A	3/4"	20	12	40
TC/Z5G	1GCZ050A	1"	21,5	14	45
TC/Z6G	1GCZ060A	1" 1/4	20	15	55
TC/Z7G	1GCZ070A	1" 1/2	20	15	55
TC/Z8G	1GCZ080A	2"	20	17	70

TYPE	CODE	MB SERIES	h	f	d
TC/Z0M	1MCZ00A	10 x 1	12	8	20
TC/Z1M	1MCZ010A	14 x 1,5	12	8	22
TC/Z2M	1MCZ020A	16 x 1,5	12	10	26
TC/Z0M	1MCZ030A	18 x 1,5	12	10	26
TC/Z4M	1MCZ040A	20 x 1,5	15	10	30
TC/Z5M	1MCZ050A	22 x 1,5	15	10	30
TC/Z0M	1MCZ060A	24 x 2	15	12	36
TC/Z7M	1MCZ070A	30 x 2	20	12	42
TC/Z8M	1MCZ080A	33 x 2	20	14	45

TCE - DRAIN FILLING PLUG WITH HEX SLOT

- Made of tempered, hardened light alloy.
- High twisting resistance, suitable for applications requiring minimum projection.
- Available with metal washers only.

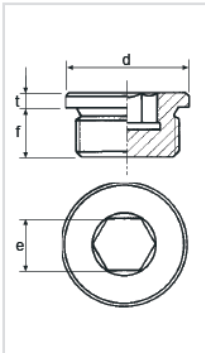

TYPE	CODE	GAS	d	t	f	e
TCE0G	1GTBE00A	1/8"	14	3	8	5
TCE1G	1GTBE10A	1/4"	18	3	12	6
TCE2G	1GTBE20A	3/8"	22	3	12	8
TCE0G	1GTBE30A	1/2"	26	4	14	10
TCE4G	1GTBE40A	3/4"	32	4	16	12
TCE0G	1GTBE50A	1"	40	5	16	17
TCE0G	1GTBE60A	1" 1/4	49	5	16	22
TCE7G	1GTBE70A	1" 1/2	55	5	16	24
TCE0G	1GTBE80A	2"	68	5	20	32

TYPE	CODE	MB SERIES	d	t	f	e
TCE0M	1MTBE00A	10 x 1	14	3	8	5
TCE1M	1MTBE10A	12 x 1,5	17	3	12	6
TCE2M	1MTBE20A	14 x 1,5	19	3	12	6
TCE3M	1MTBE30A	16 x 1,5	21	3	12	8
TCE4M	1MTBE40A	18 x 1,5	23	3	12	8
TCE5M	1MTBE50A	20 x 1,5	25	4	14	10
TCE6M	1MTBE60A	22 x 1,5	27	4	14	10
TCE7M	1MTBE70A	24 x 1,5	29	4	14	12
TCE8M	1MTBE80A	24 x 2	29	4	14	12
TCE9M	1MTBE90A	26 x 1,5	32	4	16	12
TCE10M	1MTBE91A	27 x 2	32	4	16	12
TCE11M	1MTBE92A	30 x 1,5	36	4	16	17
TCE12M	1MTBE93A	30 x 2	36	4	16	17
TCE13M	1MTBE94A	33 x 2	40	5	16	17

TC - FILLING PLUG

• Tight-sealing, maximum resistance to twisting and overheating.

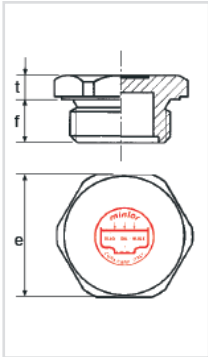

TYPE	CODE	GAS	t	f	e
TC0G	1GTC000A	1/8"	5	8	14
TC1G	1GTC010A	1/4"	7,5	8	17
TC2G	1GTCO20A	3/8"	8,5	10	22
TC3G	1GTCO30A	1/2"	8,5	10	27
TC4G	1GTC040A	3/4"	9,5	12	32
TC5G	1GTCO50A	1"	9,5	14	40
TC6G	1GTC060A	1" 1/4	10	15	50
TC7G	1GTC070A	1" 1/2	10	15	55
TC8G	1GTC080A	2"	12	17	70

TYPE	CODE	MB SERIES	t	f	e
TC0M	1MTC000A	10 x 1	5	8	14
TC1M	1MTC010A	14 x 1,5	6	8	17
TC2M	1MTCO20A	16 x 1,5	7	10	22
TC3M	1MTCO30A	18 x 1,5	7	10	22
TC4M	1MTC040A	20 x 1,5	7	10	24
TC5M	1MTCO50A	22 x 1,5	8,5	10	27
TC6M	1MTC060A	24 x 2	8	12	30
TC7M	1MTC070A	26 x 1,5	8	12	32
TC8M	1MTC080A	30 x 2	8	12	36
TC9M	1MTC090A	33 x 2	8	14	40
TC10M	1MTC091A	42 x 3	10	15	50
TC11M	1MTCO92A	48 x 3	10	15	55
TC12M	1MTC093A	60 x 4	12	17	70

TC - FILLING PLUG

• Tight-sealing, maximum resistance to twisting and overheating.

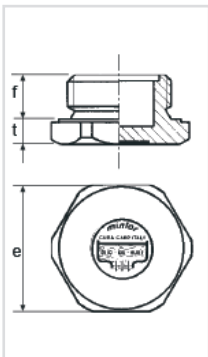

TYPE	CODE	GAS	f	t	e
TSCOG	1GTSC00A	1/8"	8	5	14
TSC1G	1GTSC10A	1/4"	8	7,5	17
TSC2G	1GTSC20A	3/8"	10	8,5	22
TSCOG	1GTSC30A	1/2"	10	8,5	27
TSC4G	1GTSC40A	3/4"	12	9,5	32
TSCOG	1GTSC50A	1"	14	9,5	40
TSCOG	1GTSC60A	1" 1/4	15	10	50
TSC7G	1GTSC70A	1" 1/2	15	10	55
TSCOG	1GTSC80A	2"	17	12	70

TYPE	CODE	MB SERIES	f	t	e
TSCOM	1MTSC00A	10 x 1	8	5	14
TSC1M	1MTSC10A	14 x 1,5	8	6	17
TSC2M	1MTSC20A	16 x 1,5	10	7	22
TSC3M	1MTSC30A	18 x 1,5	10	7	22
TSC4M	1MTSC40A	20 x 1,5	10	7	24
TSC5M	1MTSC50A	22 x 1,5	10	8,5	27
TSC6M	1MTSC60A	24 x 2	12	8	30
TSC7M	1MTSC70A	26 x 1,5	12	8	32
TSC8M	1MTSC80A	30 x 2	12	8	36
TSC9M	1MTSC90A	33 x 2	14	8	40
TSC10M	1MTSC91A	42 x 3	15	10	50
TSC11M	1MTSC92A	48 x 3	15	10	55
TSC12M	1MTSC93A	60 x 4	17	12	70

TC/F - FILLING PLUG

- Tight-sealing, maximum resistance to twisting and overheating.
- Head milling produces a crown with greater sealing area against the crankcase.



TYPE	CODE	GAS	d	t	f	e
TC/FOG	1GC/FOOA	1/8"	14	7	8	10
TC/F1G	1GC/F10A	1/4"	20	9,5	8	17
TC/F2G	1GC/F20A	3/8"	22	10	9	18
TC/FOG	1GC/F30A	1/2"	28	10,5	11	22
TC/F4G	1GC/F40A	3/4"	32	10,5	12	27
TC/F5G	1GC/F50A	1"	40	12	12,5	34

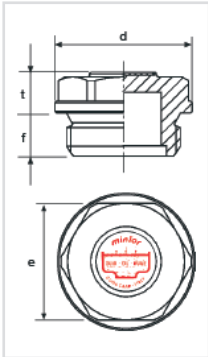

TYPE	CODE	MB SERIES	d	t	f	e
TC/FOM	1MC/FOOA	10x1	14	7	8	10
TC/F1M	1MC/F10A	14x 1,5	20	8	8	17
TC/F2M	1MC/F20A	16 x 1,5	22	10	9	18
TC/FOM	1MC/F30A	18 x 1,5	26	8	9	20
TC/F4M	1MC/F40A	20 x 1,5	28	9	10	22
TC/F5M	1MC/F50A	22 x 1,5	28	10,5	11	22

TSC/F - DRAIN PLUG

- Tight-sealing, maximum resistance to twisting and overheating.
- Head milling produces a crown with greater sealing area against the crankcase.



TYPE	CODE	GAS	d	t	f	e
TSC/FOG	1GS/FOOA	1/8"	14	7	8	10
TSC/F1G	1GS/F10A	1/4"	20	9,5	8	17
TSC/F2G	1GS/F20A	3/8"	22	10	9	18
TSC/FOG	1GS/F30A	1/2"	28	10,5	11	22
TSC/F4G	1GS/F40A	3/4"	32	10,5	12	27
TSC/F5G	1GS/F50A	1"	40	12	12,5	34

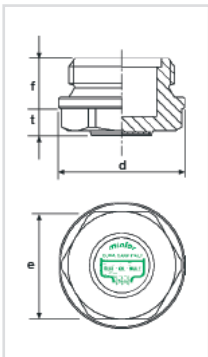

TYPE	CODE	MB SERIES	d	t	f	e
TSC/FOM	1MS/FOOA	10 x 1	14	7	8	10
TSC/F1M	1MS/F10A	14 x 1,5	20	8	8	17
TSC/F2M	1MS/F20A	16 x 1,5	22	10	9	18
TSC/FOM	1MS/F30A	18 x 1,5	26	8	9	20
TSC/F4M	1MS/F40A	20 x 1,5	28	9	10	22
TSC/F5M	1MS/F50A	22 x 1,5	28	10,5	11	22

VISUAL LEVEL INDICATORS

TLP - VISUAL LEVEL INDICATOR NON-THREADED

- Transparent inspection window unaffected by high or low temperatures.

- Avoid contact with alcohol and solvents.
- O-ring for pressure assembly.



TYPE	CODE	O - R	p	t	d	Øf ^{min}	V
TLP0	1PTP000A	OR 115	9	5	20	17	11
TLP1	1PTP010A	OR 119	9	6	24	20	13
TLP2	1PTP020A	OR 128	9	8	30	26	16
TLP3	1PTP030A	OR 3100	10	8	34	30	21
TLP4	1PTP040A	OR 3118	10	8	38	35	27
TLP5	1PTP050A	OR 3131	10	8	42	38	27

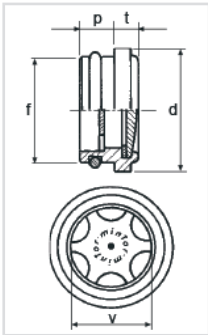

TLA - VISUAL LEVEL INDICATOR

- Standard polycarbonate transparent inspection window unaffected by high or low temperatures.

- Special version: with Pyrex glass for high temperatures.

- Avoid contacts with alcohol and solvents.

- By request: with anchor nut for unthreaded hole.



TYPE	CODE	GAS	d	t	v	e
TLAN1G	1GTLN10A	1/4"	8	7	10	17
TLA2G	1GTLA20A	3/8"	9	7	13	22
TLA3G	1GTLA30A	1/2"	10	9	16	27
TLA4G	1GTLA40A	3/4"	11	9	21	32
TLA5G	1GTLA50A	1"	14	10	27	40
TLA6G	1GTLA60A	1 1/4"	15	10	37	50
TLA7G	1GTLA70A	1 1/2"	15	10	40	55
TLA8G	1GTLA80A	2"	17	14	50	70

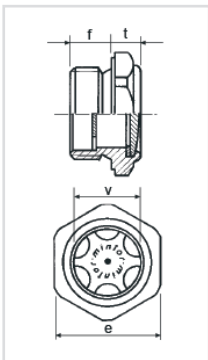

TYPE	CODE	MB SERIES	d	t	v	e
TLAN1M	1MTLN10A	14 x 1,5	8	7	10	17
TLA2M	1MTLA20A	16 x 1,5	9	7	13	22
TLA3M	1MTLA30A	18 x 1,5	9	7	13	22
TLA4M	1MTLA40A	20 x 1,5	10	7	16	24
TLA5M	1MTLA50A	22 x 1,5	10	9	16	27
TLA6M	1MTLA60A	24 x 1,5	11	9	16	30
TLA7M	1MTLA70A	24 x 2	11	9	16	30
TLA8M	1MTLA80A	25 x 1,5	11	9	21	32
TLA9M	1MTLA90A	27 x 1,5	11	9	21	32
TLA10M	1MTLA91A	30 x 1,5	11	9	21	36
TLA11M	1MTLA92A	30 x 2	11	9	21	36
TLA12M	1MTLA93A	33 x 1,5	14	10	27	40
TLA13M	1MTLA94A	33 x 2	14	10	27	40
TLA14M	1MTLA95A	35 x 1,5	14	10	27	40
TLA15M	1MTLA96A	40 x 1,5	12	10	37	50
TLA16M	1MTLA97A	42 x 3	15	10	37	50
TLA17M	1MTLA98A	48 x 3	15	10	40	55
TLA18M	1MTLA99A	60 x 2	17	14	50	70
TLA19M	1MTLA999	60 x 4	17	14	50	70

TLA/F - VISUAL LEVEL INDICATOR WITH MILLED HEAD

- Standard polycarbonate transparent inspection window unaffected by high or low temperatures.
- Avoid contacts with alcohol and solvents.
- Head milling produces a crown with greater sealing area against the crankcase.
- Special version: with Pyrex glass for high temperatures.



TYPE	CODE	GAS	v	e	f	t	d
TLA/F1G	1GL/F10A	3/8"	10	18	9	9	22
TLA/F2G	1GL/F20A	1/2"	16	22	10	9	28
TLA/F3G	1GL/F30A	3/4"	21	27	12	11	32
TLA/F4G	1GL/F40A	1"	27	34	12,5	12	40
TLA/F5G	1GL/F50A	1 1/4"	37	46	15	12	50

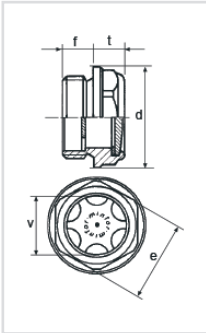

TYPE	CODE	GAS	v	e	f	t	d
TLA/F1 M	1ML/F10A	16 x 1,5	10	18	9	9	22
TLA/F2M	1ML/F20A	18 x 1,5	13	20	9	9	28
TLA/F3M	1ML/F30A	20 x 1,5	16	22	10	9	28
TLA/F4M	1ML/F40A	22 x 1,5	16	22	10	9	28

TLAX - VISUAL LEVEL INDICATOR WITH GLASS

- Transparent inspection window in Pyrex glass suitable for high and low temperatures from - 20°C till + 200°C max.
- Supplied complete with internal Viton washer.



TYPE	CODE	GAS	f	t	v	e
TLAX1G	1GTLX10A	1/4"	8	9	10	17
TLAX2G	1GTLX20A	3/8"	9	10	13	22
TLAX3G	1GTLX30A	1/2"	10	9	16	27
TLAX4G	1GTLX40A	3/4"	11	9	21	32
TLAX5G	1GTLX50A	1"	14	10	27	40
TLAX6G	1GTLX60A	1 1/4"	15	10	37	50
TLAX7G	1GTLX70A	1 1/2"	15	10	40	55
TLAX8G	1GTLX80A	2"	17	14	50	70

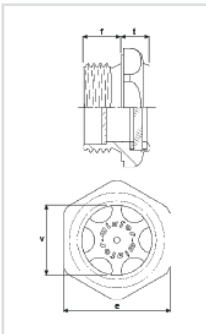

TYPE	CODE	MB SERIES	f	t	v	e
TLAX1M	1MTLX10A	14 x 1,5	8	9	10	17
TLAX2M	1MTLX20A	16 x 1,5	9	10	13	22
TLAX3M	1MTLX30A	18 x 1,5	9	10	13	22
TLAX4M	1MTLX40A	20 x 1,5	10	10	16	24
TLAX5M	1MTLX50A	22 x 1,5	10	9	16	27
TLAX6M	1MTLX60A	27 x 1,5	11	9	21	32
TLAX7M	1MTLX70A	33 x 1,5	14	10	27	40
TLAX8M	1MTLX80A	33 x 2	14	10	27	40
TLAX9M	1MTLX90A	35 x 1,5	14	10	27	40
TLAX10M	1MTLX91A	40 x 1,5	12	10	37	50
TLAX11 M	1MTLX92A	42 x 3	15	10	37	50

TLAXP - VISUAL LEVEL INDICATOR IN STEEL WITH GLASS FOR HIGH PRESSURE

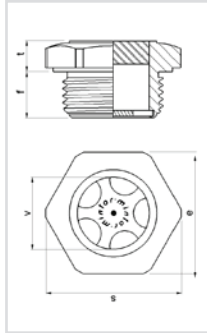
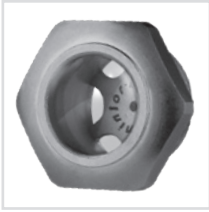

- Body made in nichel-plated steel and transparent inspection window in glass.
Suitable for high pressures max 30 bar.
- Suitable for high and low temperatures from -30°C till +250°C max.
- Application: Compressors, Construction Machinery and Earth Moving

TYPE	CODE	GAS	f	t	v	e	S
TLAXP3G	1GTLXP3A	1/2"	9	9,5	14	27	30,2
TLAXP4G	1GTLXP4A	3/4"	12,5	8	19	32	35,7

OBLÒ - INSPECTION PORTHOLE OR LIQUID-LEVEL Ø 100

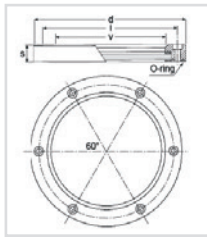

- Made of aluminium light alloy with tempered glass; supplied complete with gum washers, anchor screws and O-ring
- For the tightening to build a central hole of 100 mm and 6 threaded holes M6 arranged 60° on a diameter with inter-axis of 130 mm.
- The thickness of the reservoir must not be less than 5 mm.

TYPE	CODE	v	d	i	s
OBLÒ	10BL030A	Ø 100	Ø 150	Ø 130	19,5

OBLÒ - INSPECTION PORTHOLE OR LIQUID-LEVEL Ø 148

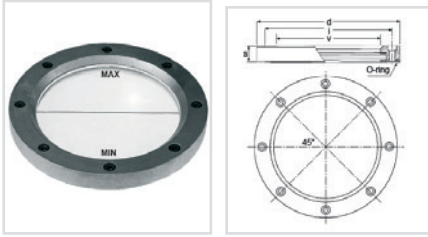

- Made of aluminium light alloy with tempered glass; supplied complete with gum washers, anchor screws and O-ring.
- For the tightening to build a central hole of 148 mm and 8 threaded holes M6 arranged 45° on a diameter with inter-axis of 180 mm
- The thickness of the reservoir must not be less than 5 mm.

TYPE	CODE	GAS	f	t	e
OBL0	10BL040A	Ø 148	Ø 202	Ø 180	21,5

IFC - DOME-SHAPED LEVEL GAUGE

- Transparent glass that does not alter at high and low temperatures.
- It is particularly suitable for seeing the fluid from the side, as well as the circulation of fluid from the top.
- Avoid contact with alcohol and solvents.
- It is supplied with fixing nut for non-threaded holes on request.

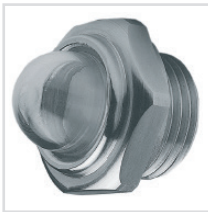

TYPE	CODE	GAS	f	t	v	e	c
IFCOG	1GIFC00A	3/8"	8	6	16	24	9
IFC1G	1GIFC10A	1/2"	10	9,5	16	27	9
IFC2G	1GIFC20A	3/4"	11	10	19	32	13
IFCOG	1GIFC30A	1"	14	10	25	40	17
IFC4G	1GIFC40A	1"1/4	15	10,5	33	50	23
IFCOG	1GIFC50A	1"1/2	15	10,5	36	55	24
IFCOG	1GIFC60A	2"	17	14	42	70	28

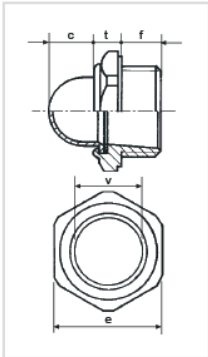

TYPE	CODE	MB SERIES	f	t	v	e	c
IFCOM	1MIFC00A	16x 1,5	8	6	16	24	9
IFCOM	1MIFC01A	18x 1,5	8	6	16	24	9
IFC1M	1MIFC10A	20 x 1,5	10	8	16	24	9
IFC2M	1MIFC20A	22 x 1,5	10	9,5	16	27	9
IFC3M	1MIFC30A	24 x 1,5	11	9,5	14	30	9
IFC4M	1MIFC40A	25 x 1,5	11	10	18	32	13
IFC5M	1MIFC50A	27 x 1,5	11	10	18	32	13
IFC6M	1MIFC60A	30 x 1,5	11	11	23	36	15
IFC7M	1MIFC70A	33 x 1,5	14	10,5	25	40	17
IFC8M	1MIFC80A	35 x 1,5	14	10,5	23	40	17
IFC9M	1MIFC90A	40 x 1,5	15	10,5	33	50	23
IFC10M	1MIFC95A	45 x 1,5	15	10,5	36	55	24
IFC11M	1MIFC99A	52 x 1,5	17	14	42	60	28

GTSF - LEVEL INDICATOR UNIT WITH BREATHER PLUG

• This unit was designed to satisfy both technical and economical requirements, because it can be applied with a single hole obtaining three services: oil filling, vapor venting, level indication.

• Avoid contact with alcohol and solvents.



TYPE	CODE	GAS	v	e	q	a	b	c	f	E
GTSF1G	1GGSF10M	3/8"	16	27	30	20	46	43	11	22
GTSF2G	1GGSF20M	1/2"	16	27	30	21	46	43	11	22
GTSF3G	1GGSF30M	3/4"	21	32	40	22	60	52	11	27
GTSF4G	1GGSF40M	1"	27	40	40	26	60	55	16	32

TYPE	CODE	MB SERES	v	e	q	a	b	c	f	E
GTSF1M	1MGSF10M	16 x 1,5	16	27	30	20	46	43	11	22
GTSF2M	1MGSF20M	18 x 1,5	16	27	30	21	46	43	11	22
GTSF3M	1MGSF30M	20 x 1,5	16	27	30	21	46	43	11	22
GTSF4M	1MGSF40M	22 x 1,5	16	27	30	21	46	43	11	22
GTSF5M	1MGSF50M	24 x 2	16	30	40	22	60	52	11	27
GTSF6M	1MGSF60M	30 x 2	21	36	40	26	60	52	14	27
GTSF7M	1MGSF70A	33 x 2	27	40	40	26	60	55	16	32

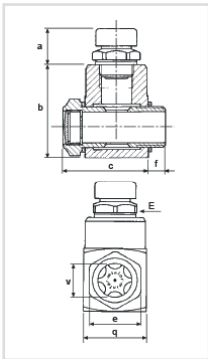

TCLA - FILLING PLUG WITH DIPSTICK

- Hex-head threaded plug with built-in dipstick.
- Also available in various min. and max. notches and lengths.



TYPE	CODE	GAS	t	f	l	g	e
TCLA1G	1GCLA10A	1/4"	6	8	120	5	17
TCLA2G	1GCLA20A	3/8"	8,5	10	170	5	22
TCLA3G	1GCLA30A	1/2"	8,5	10	170	5	27
TCLA4G	1GCLA40A	3/4"	9,5	12	200	5	32
TCLA5G	1GCLA50A	1"	9,5	14	200	5	40
TCLA6G	1GCLA60A	1" 1/4	10	15	250	5	50
TCLA7G	1GCLA70A	1" 1/2	10	15	250	5	55
TCLA8G	1GCLA80A	2"	12	17	250	5	70

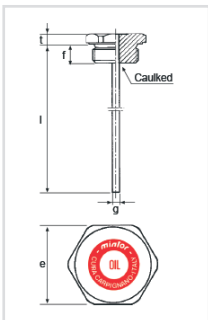

TYPE	CODE	MB SERIES	t	f	l	g	e
TCLA1M	1MCLA10A	14 x 1,5	6	8	120	5	17
TCLA2M	1MCLA20A	16 x 1,5	7	10	170	5	22
TCLA3M	1MCLA30A	18 x 1,5	7	10	170	5	27
TCLA4M	1MCLA40A	20 x 1,5	7	10	170	5	24
TCLA5M	1MCLA50A	22 x 1,5	7	10	170	5	27
TCLA6M	1MCLA60A	24 x 2	8	12	200	5	30
TCLA7M	1MCLA70A	30 x 2	8	12	200	5	36
TCLA8M	1MCLA80A	33 x 2	8	14	200	5	40
TCLA9M	1MCLA90A	42 x 3	10	15	250	5	50
TCLA10M	1MCLA95A	48 x 3	10	15	250	5	55
TCLA11M	1MCLA99A	60 x 4	12	17	250	5	70

TCLA/Z - FILLING PLUG WITH DIPSTICK

- Threaded plug with knurled round head for hand-tightening.
- Built-in dipstick.
- Available on request with various min. and max. notches and lengths.



TYPE	CODE	GAS	h	f	l	g	d
TCLA/Z1G	1GLAZ10A	1/4"	12	8	120	5	22
TCLA/Z2G	1GLAZ20A	3/8"	13,5	10	170	5	26
TCLA/Z3G	1GLAZ30A	1/2"	16,5	10	170	5	30
TCLA/Z4G	1GLAZ40A	3/4"	20	12	200	5	40
TCLA/Z5G	1GLAZ50A	1"	21,5	14	200	5	45
TCLA/Z6G	1GLAZ60A	1" 1/4	20	15	250	5	55
TCLA/Z7G	1GLAZ70A	1" 1/2	20	15	250	5	55
TCLA/Z8G	1GLAZ80A	2"	20	17	250	5	70

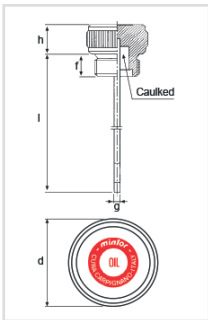

TYPE	CODE	MB SERIES	h	f	l	g	d
TCLA/Z1M	1MLAZ10A	14 x 1,5	12	8	120	5	22
TCLA/Z2M	1MLAZ20A	16 x 1,5	12	10	170	5	26
TCLA/Z3M	1MLAZ30A	18 x 1,5	12	10	170	5	26
TCLA/Z4M	1MLAZ40A	20 x 1,5	15	10	170	5	30
TCLA/Z5M	1MLAZ50A	22 x 1,5	15	10	170	5	30
TCLA/Z6M	1MLAZ60A	24 x 2	15	12	200	5	36
TCLA/Z7M	1MLAZ70A	30 x 2	20	12	200	5	42
TCLA/Z8M	1MLAZ80A	33 x 2	20	14	200	5	45

TCLS/Z - FILLING PLUG WITH DIPSTICK AND BREATHER

- Threaded plug with knurled round head for hand-tightening.
- Hole for venting internal pressure.
- Built-in dipstick.
- Available in various max. and min. notches and lengths on request.
- For applications requiring extratight sealing, type LSF is recommended.



TYPE	CODE	GAS	h	f	l	g	d
TCLS/Z1G	1GLSZ10A	1/4"	12	8	120	5	22
TCLS/Z2G	1GLSZ20A	3/8"	13,5	10	170	5	26
TCLS/Z3G	1GLSZ30A	1/2"	16,5	10	170	5	30
TCLS/Z4G	1GLSZ40A	3/4"	20	12	200	5	40
TCLS/Z5G	1GLSZ50A	1"	21,5	14	200	5	45
TCLS/Z6G	1GLSZ60A	1" 1/4	20	15	250	5	55
TCLS/Z7G	1GLSZ70A	1" 1/2	20	15	250	5	55
TCLS/Z8G	1GLSZ80A	2"	20	17	250	5	70

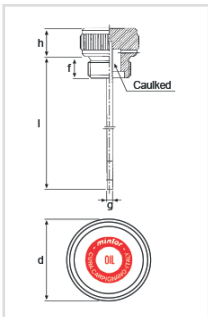

TYPE	CODE	MB SERIES	h	f	l	g	d
TCLS/Z1M	1MLSZ10A	14 x 1,5	12	8	120	5	22
TCLS/Z2M	1MLSZ20A	16 x 1,5	12	10	170	5	26
TCLS/Z3M	1MLSZ30A	18 x 1,5	12	10	170	5	26
TCLS/Z4M	1MLSZ40A	20 x 1,5	15	10	170	5	30
TCLS/Z5M	1MLSZ50A	22 x 1,5	15	10	170	5	30
TCLS/Z6M	1MLSZ60A	24 x 2	15	12	200	5	36
TCLS/Z7M	1MLSZ70A	30 x 2	20	12	200	5	42
TCLS/Z8M	1MLSZ80A	33 x 2	21,5	14	200	5	45

TCLS - FILLING PLUG WITH DIPSTICK AND BREATHER HOLE

- Threaded plug with hex head and breather hole for venting internal pressure.
- Built-in dipstick.
- Available with various min. and max. notches and lengths.
- For applications requiring extra-tight sealing, type LSF is recommended.



TYPE	CODE	GAS	t	f	l	g	e
TCLS1G	1GCSL10A		6	8	120	5	17
TCLS2G	1GCSL20A	3/8"	8	10	170	5	22
TCLS3G	1GCSL30A	1/2"	9	10	170	5	27
TCLS4G	1GCSL40A	3/4"	9	12	200	5	32
TCLS5G	1GCSL50A	1"	12	14	200	5	40
TCLS6G	1GCSL60A	1" 1/4	14	15	250	5	50
TCLS7G	1GCSL70A	1" 1/2	14	15	250	5	55
TCLS8G	1GCSL80A	2"	14	17	250	5	70

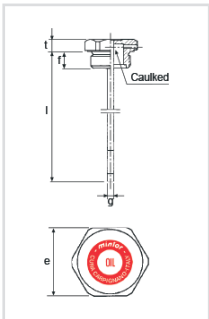

TYPE	CODE	MB SERIES	t	f	l	g	e
TCLS1M	1MCSL10A	14 x 1,5	6	8	120	5	17
TCLS2M	1MCSL20A	16 x 1,5	8	10	170	5	22
TCLS3M	1MCSL30A	18 x 1,5	8	10	170	5	22
TC LS4M	1MCSL40A	20 x 1,5	9	10	170	5	24
TCLS5M	1MCSL50A	22 x 1,5	9	10	170	5	27
TCLS6M	1MCSL60A	24 x 2	9	12	200	5	30
TCLS7M	1MCSL70A	30 x 2	10	12	200	5	36
TCLS8M	1MCSL80A	33 x 2	12	14	200	5	40
TCLS9M	1MCSL90A	42 x 3	14	15	250	5	50
TCLS10M	1MCSL95A	48 x 3	14	15	250	5	55
TCLS11M	1MCSL99A	60 x 4	14	17	250	5	70

ILA - LEVEL INDICATOR

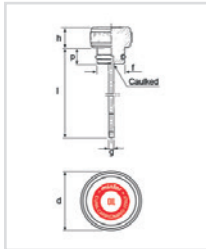

- O-ring version for smooth holes.
- Knurled round head.
- Built-in dipstick.
- Also available with different min. and max. notches and lengths.

TYPE	CODE	O - R	h	p	l	Øf ^{III}	g	d
ILAO	1PILAO0A	OR 108	12	20	120	12	5	21
ILA1	1PILA10A	OR 115	12	9	170	17	5	25
ILA2	1PILA20A	OR 119	15	9	170	20	5	30
ILA3	1PILA30A	OR 3081	15	11	170	25	5	32
ILA4	1PILA40A	OR 3100	18	14	200	30	5	36
ILA5	1PILA50A	OR 4112	18	14	200	35	5	40

ILAF - LEVEL INDICATOR WITH BREATHER

- Version for threaded holes.
- Large chamber with cut perpendicular to the axis protected by its cover of galvanized steel that keeps out foreign bodies and vents internal pressure.
- Built-in dipstick.
- Also available in various min. and max. notches and lengths.
- For applications requiring extratight sealing, type LSF is recommended.



TYPE	CODE	GAS	d	h	f	l	g	e
ILAF0G	1GIFA00A	1/4"	16,5	17	8	120	5	17
ILAF1G	1GIFA10A	3/8"	22	20	9	170	5	22
ILAF2G	1GIFA20A	1/2"	26	22	10	170	5	27
ILAF0G	1GIFA30A	3/4"	30	24	12	200	5	32
ILAF4G	1GIFA40A	1"	38	29	14	200	5	40
ILAF0G	1GIFA50A	1" 1/4	50	33	15	250	5	50
ILAF0G	1GIFA60A	1" 1/2	55	33	15	250	5	55
ILAF7G	1GIFA70A	2"	70	40	17	250	5	70

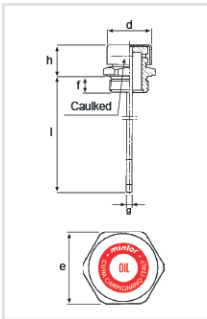

TYPE	CODE	MB SERIES	d	h	f	l	g	e
ILAF0M	1M1FA00A	14 x 1,5	16,5	17	8	120	5	17
ILAF1M	1M1FA10A	16 x 1,5	22	20	9	170	5	22
ILAF2M	1M1FA20A	18 x 1,5	22	20	10	170	5	22
ILAF0M	1M1FA30A	20 x 1,5	24	21	10	170	5	24
ILAF4M	1M1FA40A	22 x 1,5	26	22	10	170	5	27
ILAF0M	1M1FA50A	24 x 2	30	24	12	200	5	30
ILAF6M	1M1FA60A	30 x 2	30	25	12	200	5	36
ILAF7M	1M1FA70A	33 x 2	38	29	14	200	5	40
ILAF8M	1M1FA80A	42 x 3	50	33	15	250	5	50
ILAF9M	1M1FA90A	48 x 3	55	33	15	250	5	55
ILAF10M	1M1FA95A	60 x 4	70	40	17	250	5	70

ILAS - LEVEL INDICATOR WITH BREATHER

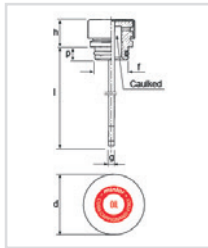

- O-ring version for smooth holes.
- Large chamber with cut perpendicular to the axis protected by its cover of galvanized steel that keeps out foreign bodies and vents internal pressure.
- Built-in dipstick.
- Also available in various min. and max. notches and lengths.

TYPE	CODE	O - R	h	p	l	Øf ^{mm}	g	d
ILAS1	1 PISA10A	OR 115	18	9	170	17	5	22
ILAS2	1 PISA20A	OR 119	19	9	170	20	5	26
ILAS3	1 PISA30A	OR 3081	21	11	170	25	5	30
ILAS4	1 PISA40A	OR 3100	26	14	200	30	5	38
ILAS5	1 PISA50A	OR 4112	30	14	200	35	5	50

LSF - LEVEL INDICATOR WITH BREATHER

- Breather plug and level indicator with galvanized-steel cover and suitably designed internal valve calibrated from 0,05 to 0,10 bar, that opens at intervals to vent internal pressure created by fluid turbulence.
- It is especially recommended for applications on high-rpm speed-change gears.



TYPE	CODE	GAS	d	h	f	l	g	e
LSF1G	1GLSF10A	1/4"	16,5	17,5	9	170	8	17
LSF2G	1GLSF20A	3/8"	22	19	11	170	10	22
LSF3G	1GLSF30A	1/2"	26	20	11	170	10	27
LSF4G	1GLSF40A	3/4"	30	24	12	200	10	32
LSF5G	1GLSF50A	1"	38	29	14	200	10	40

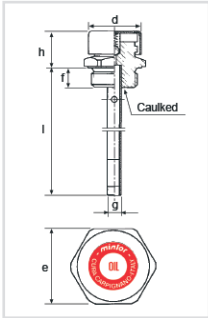

TYPE	CODE	MB SERIES	d	h	f	l	g	e
LSF1M	1MLSF10A	14 x 1,5	16,5	17,5	9	170	8	17
LSF2M	1MLSF20A	16 x 1,5	22	19	11	170	10	22
LSF3M	1MLSF30A	18 x 1,5	22	19	11	170	10	22
LSF4M	1MLSF40A	20 x 1,5	24	20	11	170	10	24
LSF5M	1MLSF50A	22 x 1,5	26	20	11	170	10	27
LSF6M	1MLSF60A	24 x 2	30	24	12	170	10	30
LSF7M	1MLSF70A	30 x 2	30	25	14	200	10	36
LSF8M	1MLSF80A	33 x 2	38	29	14	200	10	40

TRBF/LG - VISUAL LEVEL INDICATOR WITH FLOAT SYSTEM

- Composed of aluminium light alloy female cover with visual dial.
- It is screwed on burnished steel sleeve which is welded onto the machine cover or tank.
- Complete with float system, it allows an exact and constant indication of the level of fluid inside the tank.
- Especially designed for application on agricultural, earth moving, building machinery and hydraulic units.
- Temperature during use 80°C max.
- By request with breather. Avoid contacts with alcohol and solvents.



TYPE	OIL CODE	DIESEL CODE	GAS	L	d	h	p	l	f
TRBF/LG	1G1LGBS301	1LGBS305	2"	200	65	56	24	160	57
TRBF/LG	2G1LGBS302	1LGBS306	2"	300	65	56	24	260	57
TRBF/LG	3G1LGBS303	1LGBS307	2"	350	65	56	24	310	57
TRBF/LG	4G1LGBS304	1LGBS308	2"	400	65	56	24	360	57

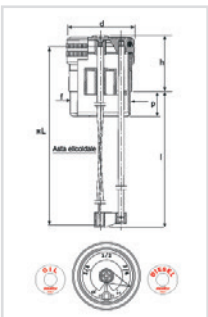

TYPE	OIL CODE	DIESEL CODE	METRIC	L	d	h	p	l	f
TRBF/LG1M	1LGBS401	1LGBS405	60 X 2	200	65	56	24	160	57
TRBF/LG2M	1LGBS402	1LGBS406	60 X 2	300	65	56	24	260	57
TRBF/LG3M	1LGBS403	1LGBS407	60 X 2	350	65	56	24	310	57
TRBF/LG4M	1LGBS404	1LGBS408	60 X 2	400	65	56	24	360	57

TC/ZLG - VISUAL LEVEL INDICATOR WITH FLOAT SYSTEM

- Composed of aluminium light alloy male cover with visual dial.
- Complete with float system, it allows an exact and constant indication of the level of fluid inside the tank.
- Especially designed for application on agricultural, earth moving, building machinery and hydraulic units.
- Supplied with O-ring.
- Temperature during use 80°C max.
- By request with breather.
- Avoid contacts with alcohol and solvents.



TYPE	OIL CODE	DIESEL CODE	GAS	L	d	h	f	l
TC/ZLG1G	1LGTM304	1LGTM300	2"	200	70	25	12	192
TC/ZLG2G	1LGTM305	1LGTM301	2"	300	70	25	12	292
TC/ZLG3G	1LGTM306	1LGTM302	2"	350	70	25	12	342
TC/ZLG4G	1LGTM307	1LGTM303	2"	400	70	25	12	392

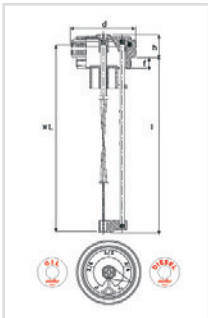

TYPE	OIL CODE	DIESEL CODE	METRIC	L	d	h	p	l
TC/ZLG1M	1LGTM404	1LGTM400	60 X 2	200	70	25	12	192
TC/ZLG2M	1LGTM405	1LGTM401	60 X 2	300	70	25	12	292
TC/ZLG3M	1LGTM406	1LGTM402	60 X 2	350	70	25	12	342
TC/ZLG4M	1LGTM407	1LGTM403	60 X 2	400	70	25	12	392

LGF68 - FLANGED LEVEL INDICATOR WITH FLOAT SYSTEM

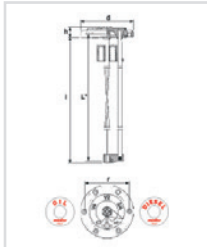

- Composed of aluminium light alloy flanged cover with orientable dial.
- Applicable to holes 50 to 54 mm.
- Complete with float system, it allows an exact and constant indication of the level of fluid inside the tank.
- Supplied with O-ring and alien screw M4 for the fixing.
- Especially designed for application on agricultural, earth moving, building machinery and hydraulic units.
- Temperature during use 80°C max.
- Avoid contacts with alcohol and solvents
- On request, provided in different colours.

TYPE	OIL CODE	GASOIL CODE	L*	d	h	l	r
LGF681	1LGF6801	1LGF6806	200	80	16	203	68
LGF682	1LGF6802	1LGF6807	250	80	16	253	68
LGF683	1LGF6803	1LGF6808	300	80	16	303	68
LGF684	1LGF6804	1LGF6809	350	80	16	353	68
LGF685	1LGF6805	1LGF6810	400	80	16	403	68

* variable data on customer's request (max. 200 mm)

LGF68 - FLANGED LEVEL INDICATOR WITH FLOAT SYSTEM

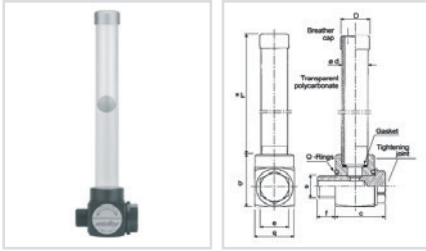

- Composed of aluminium light alloy flanged cover with orientable dial.
- Applicable to holes 50 to 54 mm.
- Complete with float system, it allows an exact and constant indication of the level of fluid inside the tank.
- Supplied with O-ring and alien screw M4 for the fixing.
- Especially designed for application on agricultural, earth moving, building machinery and hydraulic units.
- Temperature during use 80°C max.
- Avoid contacts with alcohol and solvents
- On request, provided in different colours.

TYPE	CODE	a	L*	b	e	q	D	d	c	f
GLVS1G	1GLVS10A	3/8"	50	40	22	30	22	20	43	10
GLVS2G	1GLVS20A	3/8"	100	40	22	30	22	20	43	10
GLVS3G	1GLVS30A	3/8"	150	40	22	30	22	20	43	10
GLVS4G	1GLVS40A	3/8"	200	40	22	30	22	20	43	10

GLVX - VERTICAL LEVEL INDICATOR WITH DOUBLE THREAD, WITH PYREX GLASS AND PROTECTION

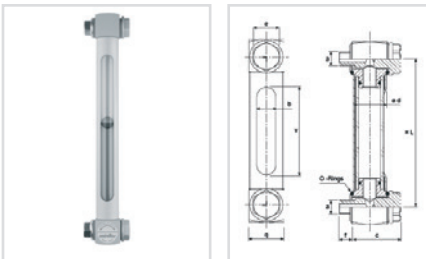

- Vertical level indicator with double thread to control fluid level.
- Realized with aluminium light alloy little blocks, transparent tube made in pyrex glass and Viton O-Rings.
- Suitable for low and high temperatures - 20°C + 200°C max.
- Supplied complete with protection.

TYPE	CODE	a	L*	e	q	d	c	f	v	b
GLVX1G	1GLVX10A	3/8"	127	22	30	28	43	10	75	16
GLVX2G	1GLVX20A	3/8"	254	22	30	28	43	10	202	16
GLVX1M	1MLVX10A	10x1,5	127	22	30	28	43	10	75	16
GLVX2M	1MLVX20A	10x1,5	254	22	30	28	43	10	202	16
GLVX3M	1MLVX30A	12x1,75	127	22	30	28	43	10	75	16
GLVX4M	1MLVX40A	12x1,75	254	22	30	28	43	10	202	16

GLV - VERTICAL LEVEL INDICATOR WITH DOUBLE THREAD

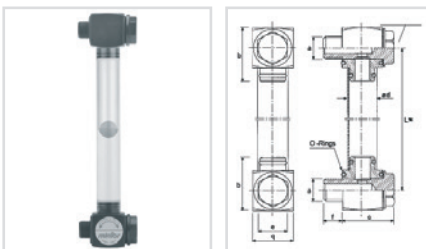

- Vertical level indicator with double thread to control fluid level.
- Realized with black anodized aluminium light alloy little blocks and transparent tube; available completed with O-Rings.
- Avoid contact with petrol, benzene, alcohol, petroleum, toluol and glycol.

TYPE	CODE	a	L*	b	e	q	d	c	f
GLV1G	1GGLV10A	3/8"	500	40	22	30	22	43	10
GLV2G	1GGLV20A	3/8"	1000	40	22	30	22	43	10
GLV3G	1GGLV30A	3/8"	1500	40	22	30	22	43	10
GLV4G	1GGLV40A	3/8"	2000	40	22	30	22	43	10

GLVE - VERTICAL LEVEL INDICATOR WITH DOUBLE ELECTRICAL CONTACT

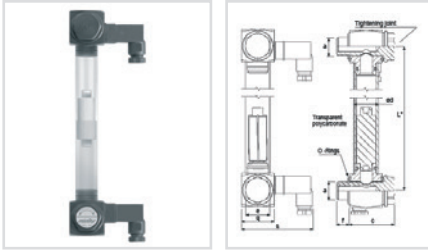

- Used for the control of the fluid for tanks.
- The electrical sensor indicates the attainment of the MIN and MAX level of the fluid. The contacts are normally opened, they close to the attainment of the MIN or MAX level.
- Available with length variable, on request of customer, from a minimum of 200 mm to a maximum of 2.000 mm.
- Supplied complete of connectors.
- Electrical characteristics: Maximum load on the electrical contacts: AC till 125 Volt — 1,0 A — 10 VA, DC till 100 Volt — 1,0 A — 10 VA.
- For further information please demand the electrical plan. Avoid contacts with alcohol, trichloroethylene, solvents, petrol and petroleum.

TYPE	CODE	a	L*	e	q	d	c	f	s
GLVE1G	1GLVE10A	3/8"	500	22	30	22	43	10	65
GLVE2G	1GLVE20A	3/8"	1000	22	30	22	43	10	65
GLVE3G	1GLVE30A	3/8"	1500	22	30	22	43	10	65
GLVE4G	1GLVE40A	3/8"	2000	22	30	22	43	10	65

PL - VERTICAL LEVEL INDICATOR

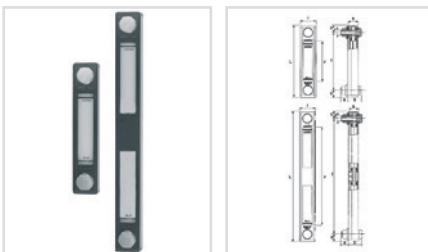

- Used for checking fluid level in large tanks.
- Complete with seals, screws and anchor nuts.
- Easy to assemble, it gives a tolerance of 0,5 mm along the interhole axis, maintaining a perfect seal.
- Avoid contact with alcohol, toluol and glycol.

TYPE	CODE	L	r	v	c	i	f	h	a	b
PL1	1VPLV10A	109	34	37	16,5	76	M 10	21,5	11	29
PL2	1VPLV20A	160	34	88	16,5	127	M 12	21,5	16	29
PL3	1VPLV30A	287	34	215	16,5	254	M 12	21,5	16	29

PLT - VERTICAL LEVEL INDICATOR WITH THERMOMETER

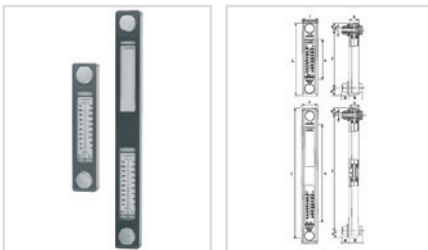

- Used for checking fluid level in large tanks.
- Complete with seals, thermometer, screws and anchor nuts.
- Easy to assemble, it gives a tolerance of 0,5 mm along the interhole axis, maintaining a perfect seal.
- Avoid contact with alcohol, toluol and glycol.

TYPE	CODE	L	r	v	c	i	f	h	a	b
PLT1	1VPLT10A	109	34	37	16,5	76	M 10	21,5	11	29
PLT2	1VPLT20A	160	34	88	16,5	127	M 12	21,5	16	29
PLT3	1VPLT30A	287	34	215	16,5	254	M 12	21,5	16	29

PLE - VERTICAL LEVEL INDICATOR WITH ELECTRICAL CONTACT

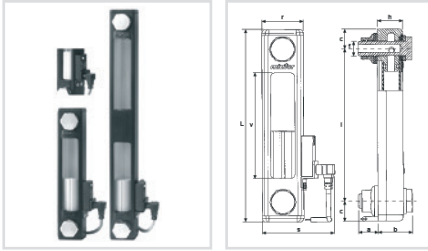

- Used for the control of the fluid for tanks.
- The electrical sensor indicates through a visual signal the attainment of the minimal level of the fluid.
- The contacts are normally opened, they close to the attainment of the minimal level.
- Supplied complete of connector and 2,5 mt cable.
- Electrical characteristics Electrical protection: as per norm IP67 - Maximum load on the electrical contacts: AC till 250 Volt - 0,5 Ampere, DC till 250 Volt - 0,5 Ampere. Concurred liquid specific weight: min. 0,80 kg/dm³.
- For further information pleas demand the electrical plan.
- Avoid contacts with alcohol, trichloroethylene and solvents.

TYPE	CODE	L	r	v	c	i	f	h	a	b	s
PLE2	1VPLE20A	160	34	88	16,5	127	M 12	21,5	16	29	59
PLE3	1VPLE30A	287	34	215	16,5	254	M 12	21,5	16	29	59

FILLING PLUGS

TFES - FEMALE THREADED PLUG WITH BREATHER

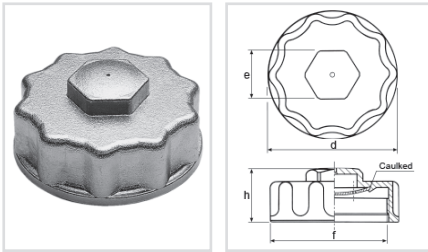

- Aluminium plug with inside thread and breather pipe, complete with gasket, suitable for large tanks.
- Handy grip and possibility of locking with Allen wrench.
- On request, with anodic treatment.

TYPE	CODE	f	d	h	e
TFES1M	1MTFE10A	80 x 2	95	40	36

TFE/Z - FEMALE THREADED PLUG



- Plug with internal thread in aluminium alloy for applications on sleeves with male thread.
- Optionally available with different wordings.

TYPE	OIL CODE	DIESEL CODE	f	d	h
TFE/ZOG	1 WCPA002	1 WCPA003	1"	40	20
TFE/Z1G	1WCPA102	1WCPA103	1" 1/4	50	20
TFE/Z2G	1WCPA202	1WCPA203	1" 1/2	55	20
TFE/Z3G	1WCPA302	1WCPA303	2"	65	20
TFE/Z4M	1WCPA402	1WCPA403	60 x 2	65	20

TFES/Z - FEMALE THREADED PLUG WITH BREATHER

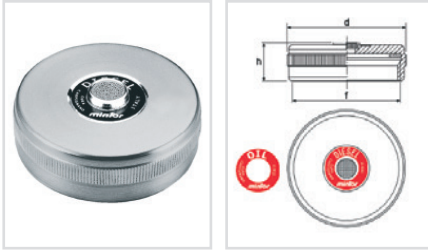

- Plug with internal thread in aluminium alloy for applications on sleeves with male thread.
- The spherical bronze filter of 40 microns built into the plug vents internal pressure and keeps out foreign bodies during the intake stroke.

TYPE	OIL CODE	DIESEL CODE	f	d	h
TFES/ZOG	1WFSZ002	1WFSZ003	1"	40	20
TFES/Z1G	1WFSZ102	1WFSZ103	1" 1/4	50	22
TFES/Z2G	1WFSZ202	1WFSZ203	1"1/2	55	22
TFES/ZOG	1WFSZ302	1WFSZ303	2"	65	22
TFES/Z4M	1WFSZ402	1WFSZ403	60 x 2	65	22

TFES/ZA - PLUG WITH FEMALE THREAD, BREATHER AND DIPSTICK

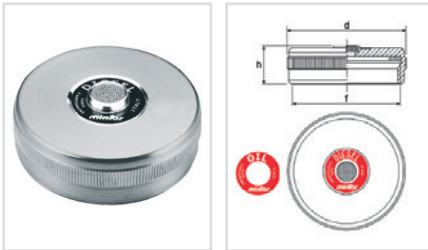

- Plug with internal thread in aluminium alloy for applications on sleeves with male thread.
- The spherical bronze filter of 40 microns built into the plug vents internal pressure and keeps out foreign bodies during the intake stroke.
- Built-in dipstick.
- On request, in different lengths and with minimum and maximum notches.

TYPE	OIL CODE	DIESEL CODE	f	d	h	l	g
TFES/ZAOG	1WFZA002	1WFZA003	1"	40	20	200	5
TFES/ZA1G	1WFZA102	1WFZA103	1" 1/4	50	20	250	5
TFES/ZA2G	1WFZA202	1WFZA203	1"1/2	55	20	250	5
TFES/ZAOG	1WFZA302	1WFZA303	2"	65	20	250	5
TFES/ZA4M	1WFZA402	1WFZA403	60 x 2	65	20	250	5

TFES/ZF - FEMALE THREADED PLUG WITH BREATHER



- Plug with internal thread in aluminium alloy for applications on sleeves with male thread.
- A galvanized-steel cover and a spherical 40 microns bronze filter vent internal pressure and keep out foreign bodies during the intake stroke.
- Especially suitable in dusty environments and for application on agricultural and building machinery.

TYPE	OIL CODE	DIESEL CODE	f	d	h	l	D
TFES/ZF1G	1WCPF101	1WCPF102	1"	30	21	41	40
TFES/ZF2G	1WCPF201	1WCPF202	1"1/2	38	21	41	55
TFES/ZF3G	1WCPF301	1WCPF302	2"	38	21	41	65
TFES/ZF4M	1WCPF401	1WCPF402	60 x 2	38	21	41	65

TCAR - FILLING PLUG

- With breather and trap for oil pre-filtering, made entirely of chromed steel with bayonet closure.
- Supplied with screws and seals for immediate use.
- The air filter contained in the plug is available at 10 microns and 40 microns.



TYPE 10 μ	CODE	LT 1'	d	h	l	$\varnothing r$	f	c	No of screws
TCAR 1046 C 65	1VTAR10A - Trademark	175	46	45	65	41	52	29	3
TCAR 1080 C 80	1VTAR20A - Trademark	500	80	52	80	73	83	50	6
TCAR 1080 C150	1VTAR30A - Trademark	500	80	52	150	73	83	50	6

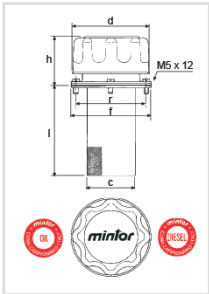

TYPE 40 μ	CODE	LT 1'	d	h	l	$\varnothing r$	f	c	No of screws
TCAR 4046 C 65	1VTAR40A - Trademark	250	46	45	65	41	52	29	3
TCAR 4080 C 80	1VTAR50A - Trademark	700	80	52	80	73	83	50	6
TCAR 4080 C150	1VTAR60A - Trademark	700	80	52	150	73	83	50	6

TCARS - FILLING PLUG WITH FLANGE TO BE WELDED

- With breather and trap oil pre-filtering.
- Made entirely of chromed steel with bayonet closure.
- Supplied with flange to be welded on the tank.
- The filter inside the plug is available with 10 or 40 microns.



TYPE 101J	CODE	LT 1'	d	h	l	r	f	c
TCARS 1080 C 100 Label	1VTAS30A	500	80	52	100	41,5	83	38
TCARS 1080 C 100 OIL	1VTAS302	500	80	52	100	41,5	83	38
TCARS 1080 C 100 DIESEL	1VTAS303	500	80	52	100	41,5	83	38

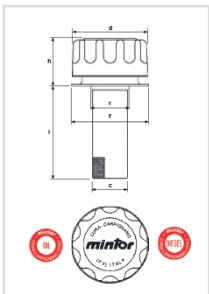

TYPE 40P	CODE	LT 1'	d	h	l	r	f	c
TCARS 4080 C 100 Label	1VTAS50A	700	80	52	100	41,5	83	38
TCARS 4080 C 100 OIL	1VTAS502	700	80	52	100	41,5	83	38
TCARS 4080 C 100 DIESEL	1VTAS503	700	80	52	100	41,5	83	38

TCAR/LC - FILLING PLUG WITH LOCK-HOLDER

- With breather and trap for oil pre-filtering.
- Made entirely of chromed steel with bayonet closure and lock-holder.
- Supplied with slot screws M6 and seals for the fixing.
- The air filter contained in the plug is available at 10 microns and 40 microns.
- On request, provided with lock.



TYPE 10 μ			CODE	LT 1'	d	h	l	r	f	c	a	No of screws
TCAR/LC	1080	C 80	1VTLC10A - Label	500	80	52	80	73	83	50	70	6
TCAR/LC	1080	C 150	1VTLC20A - Label	500	80	52	150	73	83	50	70	6

TYPE 40 μ			CODE	LT 1'	d	h	l	r	f	c	a	No of screws
TCAR/LC	1080	C 80	1VTLC30A - Label	700	80	52	80	73	83	50	70	6
TCAR/LC	1080	C 150	1VTLC40A - Label	700	80	52	150	73	83	50	70	6

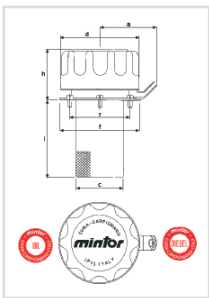

TCARF - FILLING PLUG WITH THREADED MOUNT

- Made entirely of chromed steel with threaded mount and breather.
- The air filter contained in the plug is available at 10 microns and 40 microns.



TYPE 10 μ		GAS	CODE	LT 1'	d	h	f	e
TCARF	1046	1/4"	2VTAF60A	175	46	41	10	17
TCARF	1046	3/8"	2VTAF70A	175	46	41	12	19
TCARF	1046	1/2"	2VTAF80A	175	46	43	14	22
TCARF	1080	3/4"	2VTAF90A	500	80	54	17	30
TCARF	1080	1"	2VTAF95A	500	80	55	19	36

TYPE 40 μ		GAS	CODE	LT 1'	d	h	f	e
TCARF	4046	1/4"	2VTAF10A	250	46	41	10	17
TCARF	4046	3/8"	2VTAF20A	250	46	41	12	19
TCARF	4046	1/2"	2VTAF30A	250	46	43	14	22
TCARF	4080	3/4"	2VTAF40A	700	80	54	17	30
TCARF	4080	1"	2VTAF50A	700	80	55	19	36

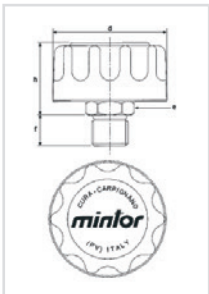

TRBF - HERMETIC FILLING PLUG

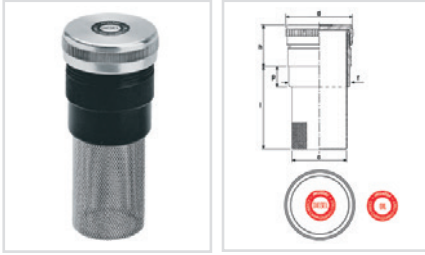

- Composed of aluminium alloy female cover with internal thread.
- It is screwed on UNI C30 burnished steel sleeve which is welded onto the machine tank.
- Complete with extractable steel cartridge which has a filtration degree of 800 microns.

TYPE	OIL CODE	DIESEL CODE	GAS	d	h	p	l	c	f
TRBF1G	1SBRF102	1SBRF103	1"	40	35	15	60	25	30
TRBF2G	1SBRF202	1 SBRF203	1"1/2	55	37	15	85	40	45
TRBF3G	1SBRF302	1SBRF303	2"	65	45	24	85	50	57

TYPE	OIL CODE	DIESEL CODE	METRIC	d	h	p	l	c	f
TRBF4M	1SBRF402	1SBRF403	60 x 2	65	45	24	85	50	57

TRBFS - FILLING PLUG WITH BREATHER

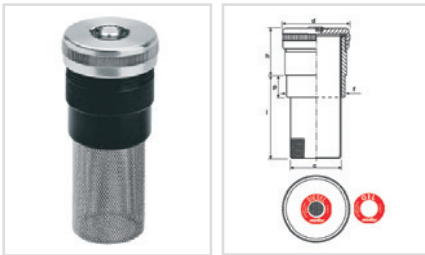

- Composed of aluminium alloy female cover with internal thread, with 40 microns spherical bronze filter.
- It is screwed on UNI C30 burnished steel sleeve which is welded on the machine cover or tank.
- Provided with extractable steel cartridge which has a filtration degree of 800 microns.

TYPE	OIL CODE	DIESEL CODE	GAS	d	h	p	l	c	f
TRBFS1G	1SBSF102	1SBSF103	1"	40	35	15	60	25	30
TRBFS2G	1SBSF202	1SBSF203	1"1/2	55	37	15	85	40	45
TRBFS3G	1 SBSF302	1SBSF303	2"	65	45	24	85	50	57

TYPE	OIL CODE	DIESEL CODE	METRIC	d	h	p	l	c	f
TRBFS4M	1SBSF402	1 SBSF403	60 x 2	65	45	24	85	50	57

TRBFSC- FILLING PLUG WITH BREATHER AND LOCK-HOLDER

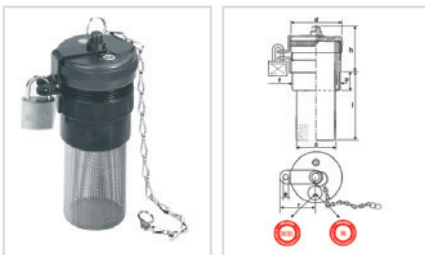

- Composed of a UNI C30 burnished steel sleeve that is welded on the machine cover or tank.
- Provided with extractable steel cartridge which has a filtration degree of 800 microns.
- Female cover with 40 microns spherical bronze filter and, on request, provided with lock.

TYPE	OIL CODE	DIESEL CODE	GAS	d	h	p	l	c	f	r	e
TRBFSC2G	1BRFC201	1 BRFC202	1"1/2	55	51	15	85	40	45	45	6
TRBFSC3G	1 BRFC301	1 BRFC302	2"	65	58	24	85	50	57	50	6

TYPE	OIL CODE	DIESEL CODE	METRIC	d	h	p	l	c	f	r	e
TRBFSC4M	1BRFC401	1 BRFC402	60 x 2	65	58	24	85	50	57	50	6

TRBF/ZK - HERMETIC FILLING PLUG WITH KEY LOCK

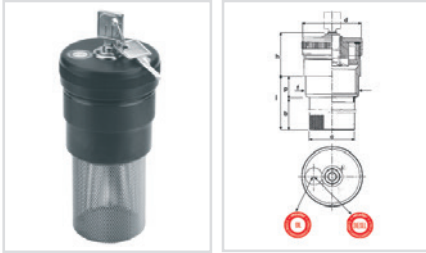

- Composed of light alloy female cover with internal thread with key lock.
- It is screwed on UNI C30 burnished steel sleeve which is welded onto the machine tank.
- Complete with extractable steel cartridge which has a filtration degree of 800 microns.

TYPE	OIL CODE	DIESEL CODE	GAS	d	h	f	p	c	b	l
TRBF/ZK3G	1 KBRF301	1KBRF303	2"	65	48	57	23	49	64	87

TYPE	OIL CODE	DIESEL CODE	METRIC	d	h	f	p	c	b	l
TRBF/ZK4M	1KBRF401	1KBRF403	60 x 2	65	48	57	23	49	64	87

TRBFS/A - FILLING PLUG WITH BREATHER

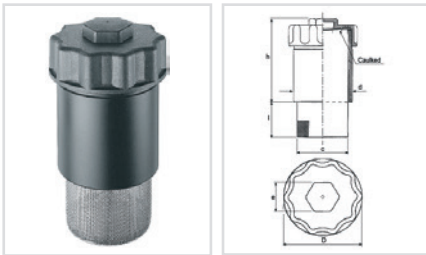

- Composed of duraluminium female plug and UNI C30 burnished steel sleeve which can be welded on large size machine cover or tanks.
- It is provided with breather device, with an extractable 800-microns filter cartridge made of steel.
- On request, supplied with sleeve length 50 mm.

TYPE	CODE	METRIC	d	h	l	c	D	e
TRBFS/A2M	1SBSF50A	80 x 2	82	118	49	70	95	36

TRTCSF/Z - BREATHER AND FILLING PLUG

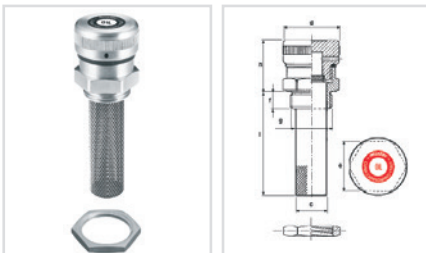

- Threaded plug with extractable filter cartridge in galvanized-steel.
- The built-in filter has a filtration degree of 40 microns.
- Optionally available with anchor nut for unthreaded hole, suitable for applications on Hydraulics units, Machine-tools and Earth-moving machinery.

TYPE	CODE	GAS	d	g	f	h	i	c	e
TRTCSF/Z5G	1FSFZ502	1"	45	33,3	14	42	82	25	40
TRTCSF/Z8G	1 FSFZ802	2"	70	59,4	17	53	113	49	70

PLUGS ON INCLINED FLANGE

FLGV - INCLINED FLANGE FOR SIDE APPLICATIONS

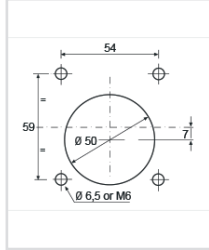
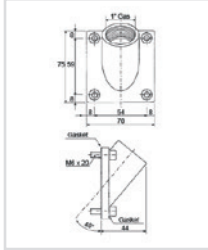

- Made of aluminium, supplied complete with washers and screws for receiving the different types of filling, filling with breather, breather filling and level dipsticks,
- For a rapid and economic application till a maximum thickness of 6 mm, it is advisable to conform to the boring jig indicated below.

TYPE	CODE
FLGV5G	1YFL0003

TFS - BREATHER PLUGS ON INCLINED FLANGE



TSFI5G

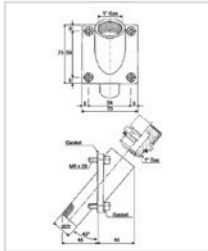

TCFI5G



TCF/FI5G



TCSF/ZI5G



TCF/ZI5G

- Alternative breather plugs group are available to apply on inclined flange when it is necessary the side oil filling.

TYPE	CODE
TSFI5G	11GTSFOA
TCFI5G	11GTCFOA
TCF/FI5G	11GF/F0A
TCSF/ZI5G	11GSFZ0A
TCF/ZI5G	11GCFZ0A

TCI - FILLING PLUGS ON INCLINED FLANGE



TSFI5G

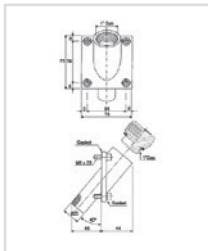

TCFI5G



TCSF/ZI5G

- Alternative filling plugs group are available to apply on inclined flange when it is necessary the side oil filling.

TYPE	CODE
TCI5G	11GTCCOA
TC/FI5G	11GC/F0A
TC/ZI5G	11GCZ0A

.....I - FILLING AND BREATHER PLUGS WITH LEVEL DIPSTICK ON INCLINED FLANGE



TCSI5G

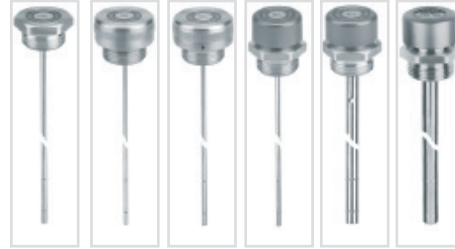
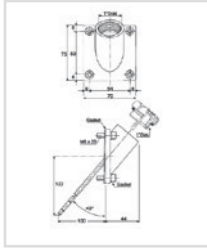

TCLAI5G TCLAZI5G TCLSZI5G ILAFI5G LSF15G FMCLSI5G

• Alternative group of filling and breather plugs with level dipsticks are available to apply on inclined flange when it is necessary the side level and oil filling.

TYPE	CODE
TCSI5G	1IGCSLOA
TCLAI5G	1IGCLAOA
TCLAZI5G	11GLAZOA
TCLSZI5G	11GLSZOA
ILAFI5G	1IGFAOA
LSF15G	1IGLSFOA
FMCLSI5G	1IGFLSOA

TCARI - INCLINED FILLING PLUG

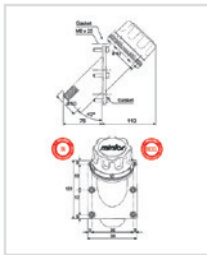

- Similar to the TCAR, it is already supplied mounted on an inclined aluminium flange for application to the wall when the space on the tank cover permits no other solution.
- The air filter contained in the plug is available at 10 microns and 40 microns.

TYPE 10 μ	CODE
TCARI 1080 C150	1 VTIR30A - Trademark
TYPE 40 μ	CODE
TCARI 4080 C150	1 VTIR60A - Trademark