

Explosionproof Rigmaster™ LED Series Luminaires

Linear LED fixture for hazardous environments

NEC/CEC:

Class I, Division 1, Groups C and D
Class II, Division 1, Groups E, F, G
Class III
Class I Zone 1, Group IIB

NEC/CEC:

Type 3R, 4, 4X, IP66
Simultaneous Exposure
Suitable for Use in Wet Locations

NEC/CEC:

Marine Outside Type (Salt Water)①
American Bureau of Shipping (ABS) Certified②

Applications

- For use in locations where:
 - Flammable gases, dusts and ignitable vapors are present
 - A high degree of corrosion resistance is required
 - Protection against dirt, water and moisture is necessary
 - Access to relamp is difficult
 - Extreme temperature conditions are present
- Typical applications include:
 - Drilling rigs
 - Offshore rigs
 - Oil refineries
 - Petrochemical facilities
 - Foundries
 - Waste and sewer treatment
 - Mining and underground tunnels
 - Power generation
 - Select paint booth areas ③

Features

- Low fixture profile allows installation in compact spaces.
- Two sizes and output options deliver up to 7600 lumens.

Fluorescent Equivalent

Model Number	Nominal Lumens ②	Replacement Lamp Wattage	Replacement Lamp Type	Replacement Lamp Quantity
ERM*2	4300	32W	T8	2
ERM*4	7600	32W	T8	3

② Nominal lumen value for 5000K, clear Lens. detailed lumen information is provided in data tables

- Choice of color temperature (CCT): 5000K cool white, 4000K neutral white or 3000K warm white with minimum 80 CRI.
- Field replaceable lens, LED driver, battery pack and battery management module (BMM).
- Two unique mounting bracket options allow for mounting in any location and retrofitting third party fixtures.
- For ease of retrofitting, mounting brackets accommodate most bolt patterns for Crouse-Hinds™ †, Dialight™ ‡ and other manufacturers. See compatibility chart below on page 10.
- Power leads are shipped with wire-nuts as standard.
- Screw-type terminal block can accept UL/CSA 22-12 AWG wire. ①
- Loop in/out wiring capability for interconnecting fixtures.
- Precision threaded wire cover provides hassle free access to wiring department for easy installation and maintenance.
- Emergency version is suitable for mounting heights up to 15 ft for 90 minute duration and up to 12 ft for 180 minute duration.
- Up to 4 casted points for secondary safety retention.
- Standard 6kV surge protection.
- Fixture position locking mechanism provides ease and consistency of aiming.
- Rugged housing with superior thermal design translates to long luminaire life.
- Ambient Temperature④: -40 °C to +65 °C (-40 °F to +149 °F).
- LED L70 of 60,000 hours reported at +65 °C (+149 °F).
- Photometric data and electronic drawings available upon request.

① Applicable to standard (non emergency) fixtures only.

② Nominal lumen value for 5000K, clear Lens. detailed lumen information is provided in data tables

③ Suitable for use in applications described under NEC 516.6(C)(1) and 516.6(C)(2), 2020 edition.

† Crouse-Hinds is a registered trademark of Eaton Corporation.

‡ Dialight is a registered trademark of Dialight.

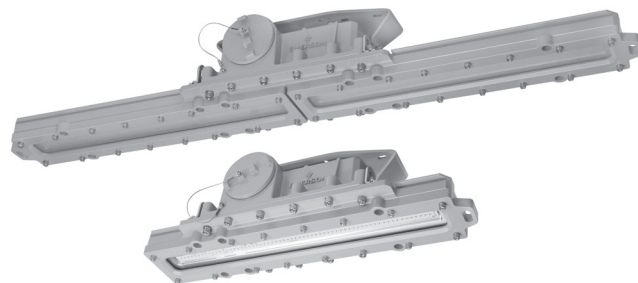

- Ambient Temperature for Emergency Version: -20 °C to +55 °C (-4 °F to +131 °F).

Options

- Brackets can be factory installed or purchased separately.
- Choice of clear or frosted glass lens
- Safety cable can be purchased separately or configured as an add on option to be shipped with the LED fixture
- Standard 3/4" NPT threads with 1/2" option
- Emergency battery back up option for 90 or 180 minutes
- Wirenuts or screw terminal blocks available ①

Standard Materials

- Housing: copperfree (4/10 of 1% max.) aluminum
- Lens: thermal shock- and impact-resistant glass lens
- Gasket: silicone rubber
- Bolts: Highly corrosion resistant stainless steel (SS 316)
- Close up plugs: (1) aluminum provided
- Mounting brackets: Zinc plated steel

Standard Finishes

- Housing: gray epoxy powder coat finish, electrostatically applied for complete uniform protection

NEC/CEC Certifications and Compliances

- UL Standard: UL 50 (13th Edition), UL 50E (2nd Edition), UL 844 (13th Edition), UL 1598 (4th Edition), UL 1598A (1st Edition)①, UL 8750 (2nd Edition), UL 924 (10th Edition)
- CSA Standard: CSA C22.2 No. 94.1-15, CSA 22.2 No 94.2 -15, CSA C22.2 No 137-18, CSA 22.2 No 250.0-18, CSA C22.2 No 250.13-17, CSA C22.2 No 60529 -16, CSA C22.2 No 141-15
- ANSI Standard: ANSI/IEC 60529
- Rigmaster Standard:
 - UL Certified, File Number: E10794
- Rigmaster Emergency
 - UL Certified, File Number: E175025

Related Products

- Industrial Rigmaster LED Luminaires
- Hazardous CID2 Rigmaster LED Luminaires

DesignLights™ Consortium

- Check DLC QPL for current list of products.

Explosionproof Rigmaster™ LED Series Luminaires

Linear LED fixture for hazardous environments

NEC/CEC:

Class I, Division 1, Groups C and D
Class II, Division 1, Groups E, F, G
Class III
Class I Zone 1, Group IIB

NEC/CEC:

Type 3R, 4, 4X, IP66
Simultaneous Exposure
Suitable for Use in Wet Locations

NEC/CEC:

Marine Outside Type (Salt Water)①
American Bureau of Shipping (ABS) Certified①

Illustrated Features

Flexibility and Ease of Use

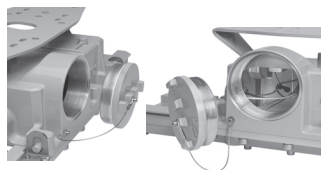

Precision threaded wirebox and cover allows hassle free access to power leads for easy wiring and maintenance in challenging conditions. Cover is secured with a safety chain to prevent accidental disengagement and enhances workplace safety

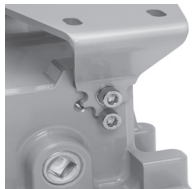

Notched position locking mechanism enables multiple fixtures to be aimed consistently without spending significant time

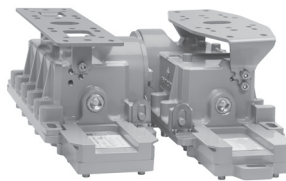

Rigmaster offers a NPT hub on each end for through wiring. The power leads are placed inside the wiring compartment and can be easily accessed by removing the tool-less wire box cover

Choose from **three color temperatures** (CCT): 3000K, 4000K, and 5000K

Standard linear light distribution pattern: wide distribution maximizes spread and work plane brightness to optimize number of luminaires needed

Configurable Options



Mounting Brackets ②③:

Choose to mount your Rigmaster using one of these distinctly designed brackets to best suit your installation needs. All brackets can be factory installed to save time in the field or purchased separately.



ERMLSB Large Swivel Bracket:

Can be used to tilt and aim the fixture up to 90 degrees in increments of 15 degrees using the pre-notched locking mechanism



ERMLPB Low Profile Bracket:

This fixed position bracket can be used to lower overall mounting profile in low ceiling applications

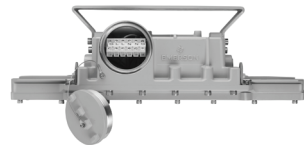

Wirenuts or Screw Terminal Blocks:①

Choose between wirenuts and screw terminal blocks to suit end user wiring preferences. Terminal blocks support UL/CSA 22 to 12 AWG wire

Safety Features



Safety Cables ②: can be purchased separately or included with fixture to reduce ordering and receiving complexity

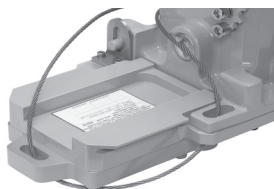

Up to four points for secondary retention provide protection against infield vibration.

① Applicable to standard (non emergency) fixtures only.

② Brackets and safety cables can be ordered separately or included with fixture. See Ordering Table for more information.

③ Mounting Brackets compatible with standard and emergency versions are not the same. please refer to mounting bracket details on page 9 for details.

Explosionproof Rigmaster™ LED Series Luminaires

Linear LED fixture for hazardous environments

NEC/CEC:

Class I, Division 1, Groups C and D
 Class II, Division 1, Groups E, F, G
 Class III
 Class I Zone 1, Group IIB

NEC/CEC:

Type 3R, 4, 4X, IP66
 Simultaneous Exposure
 Suitable for Use in Wet Locations

NEC/CEC:

Marine Outside Type (Salt Water)①
 American Bureau of Shipping (ABS) Certified①

Order using catalog numbering guides below.

<p>ERM</p> <p>Series:</p> <p>ERM - Explosionproof Rigmaster Linear LED CID1</p> <p>Mounting③:</p> <p>N - If None (Use if Ordering Appleton Bracket Separately) B - Large Swivel Bracket L - Low Profile Bracket</p>	<p>B</p>	<p>4</p> <p>Lumen (nominal)②:</p> <p>2 - 4,300 Lumens (2') 4 - 7,600 Lumens (4')</p>	<p>2</p> <p>Hub Size:</p> <p>1 - (4) 1/2" NPT 2 - (4) 3/4" NPT</p>	<p>C</p> <p>Color Temperature:</p> <p>C - Cool 5000K N - Neutral 4000K W - Warm 3000K</p>	<p>C</p> <p>Lens Material:</p> <p>C - Clear Glass F - Frosted Glass ④</p>	<p>L</p> <p>Light Distribution Pattern:</p> <p>L - Linear Pattern (non-optic) (standard)</p>	<p>BU</p> <p>Voltage①:</p> <p>BU - 120-277 Vac; 125-300 Vdc BH - 347-480 Vac</p>	<p>N</p> <p>Emergency:</p> <p>N - If None (Standard) H - 90 minutes E - 180 minutes</p>	<p>G</p> <p>Color:</p> <p>G - Appleton Gray (Standard)</p>	<p>W</p> <p>Wiring Method:</p> <p>W - Wire Nuts (Standard) T - Terminal Blocks④</p>	<p>2</p> <p>Option③:</p> <p>Blank - If None 1 - (1) Safety Cable 2 - (2) Safety Cables</p>
--	-----------------	--	--	--	---	--	---	--	--	---	---

APPLETON™
 LED/AREA: NEC/CEC, ATEX/IECEX ENCLOSED AND GASKETED

① Emergency battery back up version is only available with BU voltage configuration for 120-277Vac operation.

② For lumen output information, see Lumen Values Table.

③ Brackets and safety cables can be ordered separately or included with fixture. See Ordering Table for more information.

④ Applicable to standard (non emergency) fixtures only.

Explosionproof Rigmaster™ LED Series Luminaires

Linear LED fixture for hazardous environments

NEC/CEC:
 Class I, Division 1, Groups C and D
 Class II, Division 1, Groups E, F, G
 Class III
 Class I Zone 1, Group IIB

NEC/CEC:
 Type 3R, 4, 4X, IP66
 Simultaneous Exposure
 Suitable for Use in Wet Locations

NEC/CEC:
 Marine Outside Type (Salt Water)①
 American Bureau of Shipping (ABS) Certified①

Lumen Values Table①

Configuration	Lumen Output (Efficacy) for Clear Glass Lens			
	ERM*2		ERM*4	
	Lumens	Efficacy	Lumens	Efficacy
5000K, 80 CRI, Clear Glass Lens	4310	133	7530	136
4000K, 80 CRI, Clear Glass Lens	4125	128	7200	130
3000K, 80 CRI, Clear Glass Lens	4070	126	7100	128

Configuration	Lumen Output (Efficacy) for Frosted Glass Lens			
	ERM*2		ERM*4	
	Lumens	Efficacy	Lumens	Efficacy
5000K CCT, 80 CRI, Frosted Glass Lens	3190	96	5490	100
4000K CCT, 80 CRI, Frosted Glass Lens	3080	93	5310	97
3000K CCT, 80 CRI, Frosted Glass Lens	3040	92	5230	95

Configuration	Lumen Output in Emergency Mode for Clear Glass Lens	
	90 Minute	180 Minute
5000K CCT, 80 CRI	1350	800
4000K CCT, 80 CRI	1260	760
3000K CCT, 80 CRI	1200	720

① All lumen values are typical (tolerance +/- 10%)
 ② Applicable to standard (non emergency) fixtures only.

Explosionproof Rigmaster™ LED Series Luminaires

Linear LED fixture for hazardous environments

NEC/CEC:
 Class I, Division 1, Groups C and D
 Class II, Division 1, Groups E, F, G
 Class III
 Class I Zone 1, Group IIB

NEC/CEC:
 Type 3R, 4, 4X, IP66
 Simultaneous Exposure
 Suitable for Use in Wet Locations

NEC/CEC:
 Marine Outside Type (Salt Water)①
 American Bureau of Shipping (ABS) Certified①

Emergency Battery Backup Functionality – Automatic Testing System (ATS)①	
Functional	Full Duration
Starts within 24 to 45 hours after the initial powerup of the module	Starts within 5 to 26 days after the initial power of the module
Occurs every 14 days after the initial aforementioned functional test	Occurs every 364 days after the initial aforementioned functional test
Lasts for 30 seconds	Lasts for the full duration of the rated emergency period

At the completion of functional and full duration tests, LED indicator will display the status of the emergency luminaire when AC is present

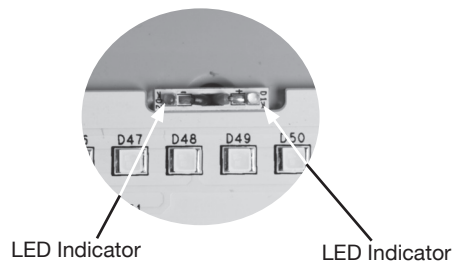

Indicator Color	LED Signals	
	Timing	Description
Green	1 sec ON: 1 sec OFF	Normal charging ok, Battery not yet fully charged, No fault detected, Testing ok
Green	0.25 sec ON: 0.25 sec OFF	Functional / Duration Self-Test on-going
Green	Steady ON	Charging ok, Battery fully charged, No fault detected, Testing ok
Red	1 sec ON: 1 sec OFF	Fault condition. Installation issue. Battery is reverse, not connected or shorted. Functional test failure, full duration test failure
LED Indicators OFF, LED Array ON	LED Indicator Lights (Red and Green) OFF	No AC, Emergency mode ON

① Applicable to standard (non emergency) fixtures only.

Explosionproof Rigmaster™ LED Series Luminaires

Linear LED fixture for hazardous environments

NEC/CEC:
 Class I, Division 1, Groups C and D
 Class II, Division 1, Groups E, F, G
 Class III
 Class I Zone 1, Group IIB

NEC/CEC:
 Type 3R, 4, 4X, IP66
 Simultaneous Exposure
 Suitable for Use in Wet Locations

NEC/CEC:
 Marine Outside Type (Salt Water)①
 American Bureau of Shipping (ABS) Certified②

Electrical Ratings①

	Voltage	Input Power	Input Current (amp)	Power Factor	THD	Model
BU	120 Vac	33	0.28	>0.9	<20	ERM*2
	277 Vac	33	0.12	>0.9	<20	
	125 Vdc	33	0.27	NA	NA	
	300 Vdc	33	0.11	NA	NA	
BH	347 Vac	36	0.11	>0.9	<20	
	480 Vac	36	0.08	>0.9	<20	
BU	120 Vac	55	0.47	>0.9	<20	ERM*4
	277 Vac	55	0.20	>0.9	<20	
	125 Vdc	55	0.44	NA	NA	
	300 Vdc	55	0.18	NA	NA	
BH	347 Vac	56	0.16	>0.9	<20	
	480 Vac	56	0.12	>0.9	<20	

Electrical Ratings - Emergency Version①

	Voltage	Input Power	Input Current (amp)	Power Factor	THD	Model
BU	120 Vac	39	0.35A	>0.9	<20	ERM*2
	277 Vac	39	0.15A	>0.9	<20	
BU	120 Vac	60	0.57A	>0.9	<20	ERM*4
	277 Vac	60	0.20A	>0.9	<20	

① All values are typical (tolerance +/-10%).

② Applicable to standard (non emergency) fixtures only.

Explosionproof Rigmaster™ LED Series Luminaires

Linear LED fixture for hazardous environments

NEC/CEC:

Class I, Division 1, Groups C and D
Class II, Division 1, Groups E, F, G
Class III
Class I Zone 1, Group IIB

NEC/CEC:

Type 3R, 4, 4X, IP66
Simultaneous Exposure
Suitable for Use in Wet Locations

NEC/CEC:

Marine Outside Type (Salt Water)①
American Bureau of Shipping (ABS) Certified①

NEC/CEC Temperature Codes①

Ambient Temperature °C (°F)	Supply wire Temperature °C (°F)	Class I, Division 1 Groups C and D	Class II, Division 1, Groups E, F and G	Simultaneous Class I Division 1 Groups C & D and Class II Division 1 Groups E, F & G	Model
40 (104)		T6	T6	T6	
55 (131)	90 (194)	T6	T6	T6	ERM*2
65 (149)		T6	T5	T5	
40 (104)		T6	T6	T6	
55 (131)	90 (194)	T6	T6	T6	ERM*4
65 (149)		T6	T5	T5	

NEC/CEC Temperature Codes - Emergency Version②

Ambient Temperature °C (°F)	Supply wire Temperature °C (°F)	Class I, Division 1, Groups C & D	Class II, Division 1, Group E, F & G	Simultaneous Class I Division 1 Groups C & D and Class II Division 1 Groups E, F & G	Model
40 (104)	90 (194)	T6	T6	T6	ERM*2
55(131)		T6	T6	T6	
40 (104)	90 (194)	T6	T6	T6	ERM*4
55(131)		T6	T6	T6	

"T" Numbers Represent the Maximum Internal Temperature③ or Maximum Surface Temperature④

"T" #	NEC/CEC															
	T1	350	325	T2	T2A	T2B	T2C	T2D	T3	T3A	T3B	T3C	T4	T4A	T5	T6
Temp. Range °C (°F)	351 - 450 (664 - 842)	326 - 350 (619 - 662)	301 - 325 (574 - 617)	281 - 300 (538 - 572)	261 - 280 (448 - 500)	231 - 260 (448 - 500)	216 - 230 (421 - 446)	201 - 215 (394 - 419)	181 - 200 (358 - 392)	166 - 180 (331 - 356)	161 - 165 (322 - 329)	136 - 160 (277 - 320)	121 - 135 (250 - 275)	101 - 120 (214 - 248)	86 - 100 (187 - 212)	85 (185)

① Ambient Temperature Range: -40 °C to +65 °C (-40 °F to +149 °F).

② Ambient Temperature Range: -20 °C to +55 °C (-4 °F to +131 °F)

③ T numbers represent the maximum internal temperature for Class I Division 1 and Class II Division 1 locations designated by the NEC.

④ T numbers represent the maximum surface temperature under a dust blanket for Class II, Division 2 as designated by the NEC.

⑤ Applicable to standard (non emergency) fixtures only.

Explosionproof Rigmaster™ LED Series Luminaires

Linear LED fixture for hazardous environments

NEC/CEC:

Class I, Division 1, Groups C and D
 Class II, Division 1, Groups E, F, G
 Class III
 Class I Zone 1, Group IIB

NEC/CEC:

Type 3R, 4, 4X, IP66
 Simultaneous Exposure
 Suitable for Use in Wet Locations

NEC/CEC:

Marine Outside Type (Salt Water)①
 American Bureau of Shipping (ABS) Certified①

Emergency Version Mounting Brackets

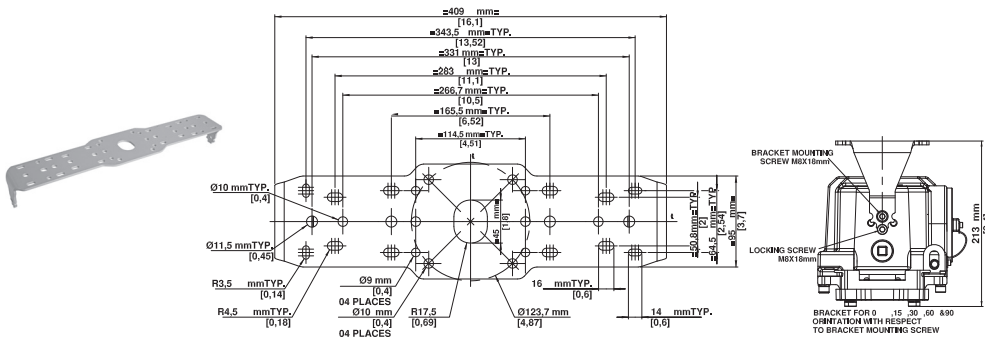
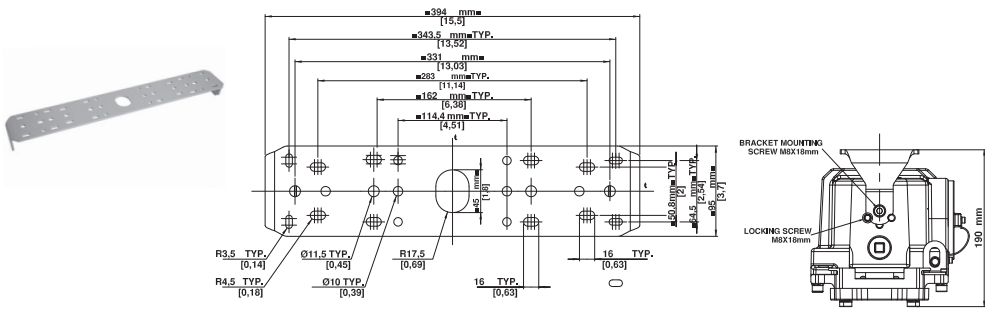
Dimensions mm (in)	Description	Weight kg (lbs)	Catalog Number
 <p>Technical drawing of the Rigmaster Emergency Swivel Bracket. It includes a top view with dimensions: overall length 409 mm (16.1 in), mounting hole spacing 343.5 mm (13.52 in), 331 mm (13.03 in), 283 mm (11.14 in), 266.7 mm (10.5 in), 165.5 mm (6.52 in), and 114.5 mm (4.51 in). Mounting hole diameters are 10 mm (0.4 in), 11.5 mm (0.45 in), 17.5 mm (0.69 in), and 23.7 mm (0.93 in). Other features include 0.9 mm (0.035 in) holes, 0.4 places, 16 mm (0.63 in) spacing, and 14 mm (0.55 in) spacing. A side view shows a height of 45.5 mm (1.79 in) and a mounting hole diameter of 16 mm (0.63 in). A detail view shows the bracket mounting screw (M6X16mm) and locking screw (M6X16mm) with a note: 'BRACKET FOR 0...15 20 50 60 690 ORIENTATION WITH RESPECT TO BRACKET MOUNTING SCREW'.</p>	Rigmaster Emergency Swivel Bracket	1.8 (4.0)	ERMHL5B
 <p>Technical drawing of the Rigmaster Emergency Low Profile Fixed Bracket. It includes a top view with dimensions: overall length 384 mm (15.1 in), mounting hole spacing 343.5 mm (13.52 in), 331 mm (13.03 in), 283 mm (11.14 in), 162 mm (6.38 in), and 114.4 mm (4.51 in). Mounting hole diameters are 10 mm (0.39 in), 11.5 mm (0.45 in), 17.5 mm (0.69 in), and 16 mm (0.63 in). Other features include 0.9 mm (0.035 in) holes, 0.4 places, 16 mm (0.63 in) spacing, and 14 mm (0.55 in) spacing. A side view shows a height of 45.5 mm (1.79 in) and a mounting hole diameter of 16 mm (0.63 in). A detail view shows the bracket mounting screw (M6X16mm) and locking screw (M6X16mm) with a note: 'BRACKET FOR 0...15 20 50 60 690 ORIENTATION WITH RESPECT TO BRACKET MOUNTING SCREW'.</p>	Rigmaster Emergency Low Profile Fixed Bracket	1.6 (3.5)	ERMHL5B

① Applicable to standard (non emergency) fixtures only.

APPLETON™
 LED/AREA: NEC/CEC, ATEX/IECEX ENCLOSED AND GASKETED

Explosionproof Rigmaster™ LED Series Luminaires

Linear LED fixture for hazardous environments

NEC/CEC:

Class I, Division 1, Groups C and D
Class II, Division 1, Groups E, F, G
Class III
Class I Zone 1, Group IIB

NEC/CEC:

Type 3R, 4, 4X, IP66
Simultaneous Exposure
Suitable for Use in Wet Locations

NEC/CEC:

Marine Outside Type (Salt Water)①
American Bureau of Shipping (ABS) Certified①

Mounting Bracket Selection Guide - Standard Version①

For customers trying to retrofit an existing fixture and match bolt patterns, use the table below as a guide to select the best bracket to suit your needs

Manufacturer	Part Number	ERMLSB Large Swivel Bracket	ERMLPB Low Profile Bracket
Crouse Hinds™†	DP1057MTK	X	X
Dialight™‡	LTXW4	X	—
	LSXW5	—	X
AZZ™* Rig-A-Lite™*	53050	X	—
Appleton Accessories	GRFC75A junction box	X	—

Mounting Bracket Selection Guide - Emergency Version①

For customers trying to retrofit an existing fixture and match bolt patterns, use the table below as a guide to select the best bracket to suit your needs

Manufacturer	Part Number	ERMHLB – Emergency Swivel Bracket	ERMHLPB – Emergency Low Profile Bracket
Crouse Hinds™†	DP1057MTK	X	X
Dialight™‡	LTXW4	X	X
	LSXW5	X	X
AZZ™* Rig-A-Lite™*	53050	X	—

Accessories and Replacement Parts

	Description	Catalog Numbers
Safety Cables		
	Stainless Steel Safety Cables	LEDSC
—	Replacement Battery Management Module	BPMLLED
—	Replacement Battery Pack	BMMRM

① The above information is strictly for guidance purposes and does not guarantee compatibility and fit. Please carefully review bolt patterns on each bracket to ensure it meets your needs

② Applicable to standard (non emergency) fixtures only.

† Crouse-Hinds is a registered trademark of Eaton Corporation.

‡ Dialight is a registered trademark of Dialight.

* AZZ and Rig-A-Lite are registered trademarks of AZZ.

Explosionproof Rigmaster™ LED Series Luminaires

Linear LED fixture for hazardous environments

NEC/CEC:

Class I, Division 1, Groups C and D
 Class II, Division 1, Groups E, F, G
 Class III
 Class I Zone 1, Group IIB

NEC/CEC:

Type 3R, 4, 4X, IP66
 Simultaneous Exposure
 Suitable for Use in Wet Locations

NEC/CEC:

Marine Outside Type (Salt Water)①
 American Bureau of Shipping (ABS) Certified①

Replacement Drivers

Catalog Number	Voltage	Constant Current Settings	Wattage	Luminaire Model
APM050C135UD060	BU	600mA	50W	ERM*2
APM050C135HD060	BH	600 mA	50W	ERM*2
APM050C135UD104	BU	1040 mA	50W	ERM*4
APM050C135HD104	BH	1040 mA	50W	ERM*4



Replacement Lenses

Description	Luminaire Model	Quantity per luminaire	Catalog Number
Clear Glass Lens	ERM*2	1	ERMCL
	ERM*4	2	
Frosted Glass Lens	ERM*2	1	ERMFL
	ERM*4	2	

① Applicable to standard (non emergency) fixtures only.

Explosionproof Rigmaster™ LED Series Luminaires

Linear LED fixture for hazardous environments

NEC/CEC:

Class I, Division 1, Groups C and D
 Class II, Division 1, Groups E, F, G
 Class III
 Class I Zone 1, Group IIB

NEC/CEC:

Type 3R, 4, 4X, IP66
 Simultaneous Exposure
 Suitable for Use in Wet Locations

NEC/CEC:

Marine Outside Type (Salt Water)①
 American Bureau of Shipping (ABS) Certified①

Dimensions in Millimeters (Inches)

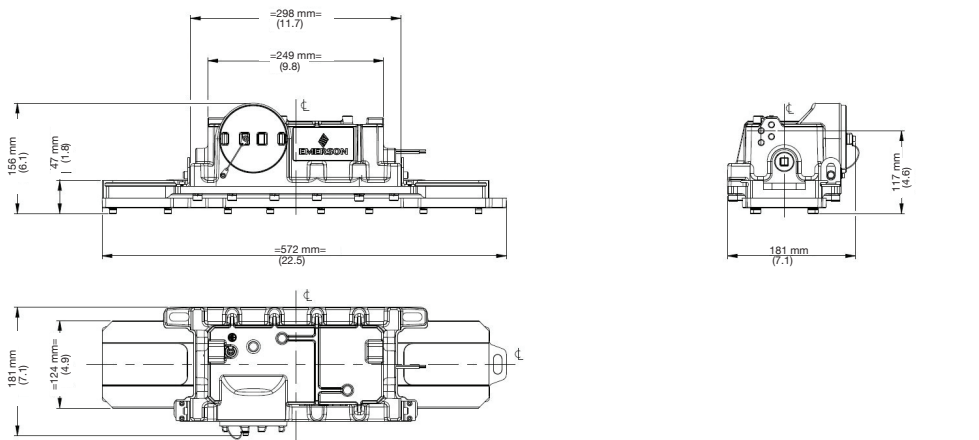

ERM*2 – Standard

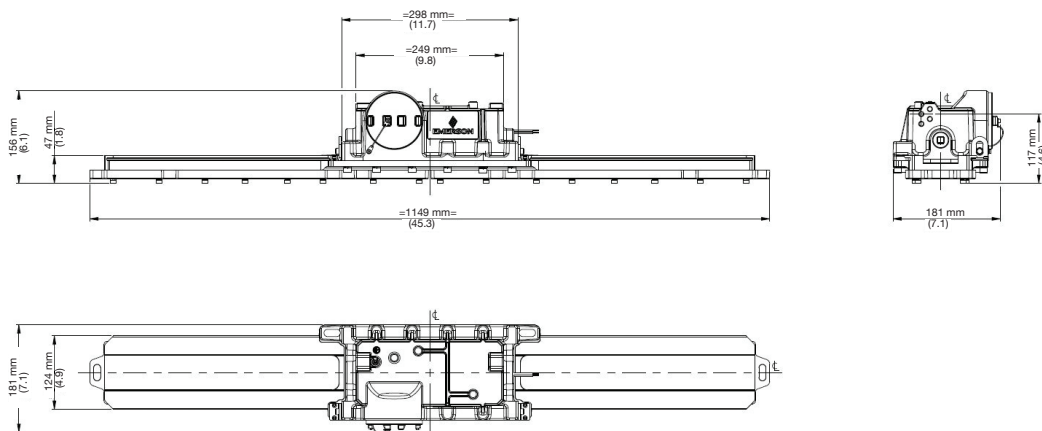

ERM*4 – Standard

Product Weight and Length

Model #	Lumens	Weight kg (lb)	Length m (ft)
ERM*2	4300	8.9 (19.6)	0.57 (1.9)
ERM*4	7600	13.4 (29.5)	1.15 (3.8)

Note: weight of brackets are not included

① Applicable to standard (non emergency) fixtures only.

Explosionproof Rigmaster™ LED Series Luminaires

Linear LED fixture for hazardous environments

NEC/CEC:

Class I, Division 1, Groups C and D
 Class II, Division 1, Groups E, F, G
 Class III
 Class I Zone 1, Group IIB

NEC/CEC:

Type 3R, 4, 4X, IP66
 Simultaneous Exposure
 Suitable for Use in Wet Locations

NEC/CEC:

Marine Outside Type (Salt Water)①
 American Bureau of Shipping (ABS) Certified①

Dimensions in Millimeters (Inches)

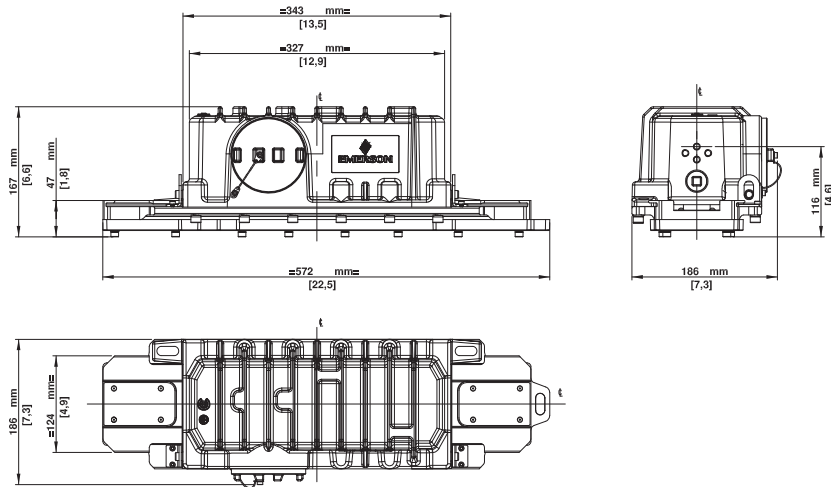

ERM*2 – Emergency

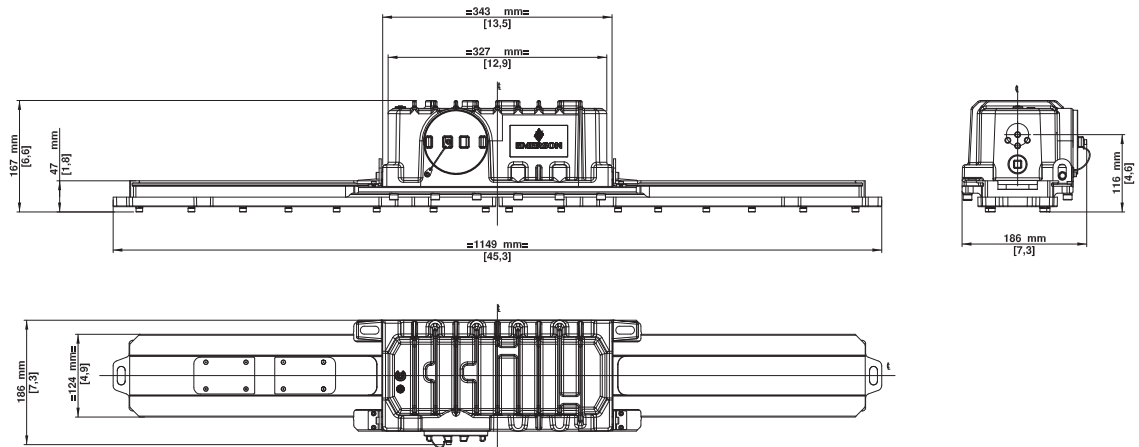

ERM*4 – Emergency

Product Weight and Length

Model	Weight kg (lb)	Length m (ft)
ERM*2 - Emergency	12.8 (28.2)	0.57 (1.9)
ERM*4 - Emergency	18.4 (40.6)	1.15 (3.8)

Note: weight of brackets are provided separately

① Applicable to standard (non emergency) fixtures only.

Explosionproof Rigmaster™ LED Series Luminaires

Linear LED fixture for hazardous environments

NEC/CEC:

Class I, Division 1, Groups C and D
 Class II, Division 1, Groups E, F, G
 Class III
 Class I Zone 1, Group IIB

NEC/CEC:

Type 3R, 4, 4X, IP66
 Simultaneous Exposure
 Suitable for Use in Wet Locations

NEC/CEC:

Marine Outside Type (Salt Water)①
 American Bureau of Shipping (ABS) Certified①

Photometric Data — DATA SHOWN IS ABSOLUTE

2ft, Clear Glass Lens, 5000K CCT

Luminaire Lumens 4325.5

POLAR CANDELA DISTRIBUTION

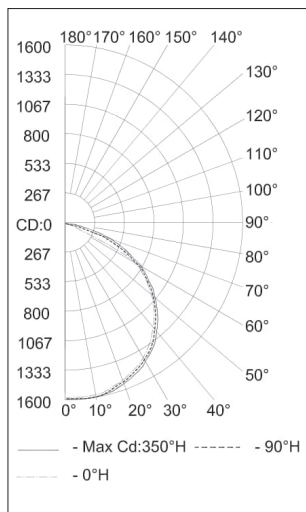

ISOFOOTCANDLE PLOT

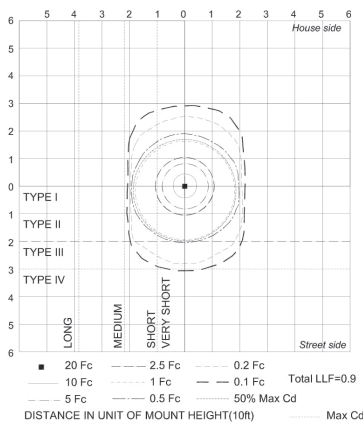

ZONAL LUMEN SUMMARY

Zone	Lumens	% Lamp	% Luminaire
0-30	1,246.9	28.8%	28.8%
0-40	2,062.9	47.7%	47.7%
0-60	3,703.1	85.6%	85.6%
60-90	609.8	14.1%	14.1%
70-100	131.1	3%	3%
90-120	2.4	0.1%	0.1%
0-90	4,312.9	99.7%	99.7%
90-180	13.0	0.3%	0.3%
0-180	4,325.9	100%	100%

LUMENS PER ZONE

Zone	Lumens	% Total	Zone	Lumens	% Total
0-10	149.6	3.5%	90-100	0.2	0%
10-20	432.2	10.0%	100-110	0.7	0%
20-30	665.1	15.4%	110-120	1.5	0%
30-40	816.1	18.9%	120-130	2.1	0%
40-50	859.6	19.9%	130-140	2.4	0.1%
50-60	780.6	18.0%	140-150	2.3	0.1%
60-70	478.8	11.1%	150-160	1.9	0%
70-80	120.4	2.8%	160-170	1.4	0%
80-90	10.6	0.2%	170-180	0.5	0%

4ft, Clear Glass Lens, 5000K CCT

Luminaire Lumens 7646.5

POLAR CANDELA DISTRIBUTION

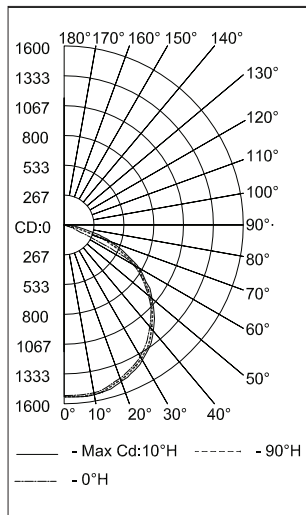

ISOFOOTCANDLE PLOT

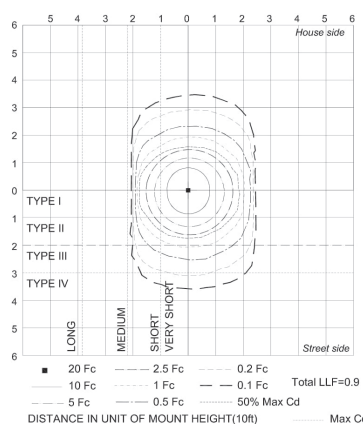

ZONAL LUMEN SUMMARY

Zone	Lumens	% Lamp	% Luminaire
0-30	2,221.6	29.1%	29.1%
0-40	3,680.0	48.1%	48.1%
0-60	6,587.3	86.1%	86.1%
60-90	1,040.7	13.6%	13.6%
70-100	223.5	2.9%	2.9%
90-120	4.1	0.1%	0.1%
0-90	7,628.1	99.7%	99.8%
90-180	18.4	0.2%	0.2%
0-180	7,646.5	100%	100%

LUMENS PER ZONE

Zone	Lumens	% Total	Zone	Lumens	% Total
0-10	265.0	3.5%	90-100	0.5	0%
10-20	769.1	10.1%	100-110	1.3	0%
20-30	1,187.6	15.5%	110-120	2.3	0%
30-40	1,458.4	19.1%	120-130	3.0	0%
40-50	1,530.8	20.0%	130-140	3.2	0%
50-60	1,376.5	18.0%	140-150	3.1	0%
60-70	817.7	10.7%	150-160	2.5	0%
70-80	205.0	2.7%	160-170	1.8	0%
80-90	18.1	0.2%	170-180	0.7	0%

① Applicable to standard (non emergency) fixtures only.

Explosionproof Rigmaster™ LED Series Luminaires

Linear LED fixture for hazardous environments

NEC/CEC:

Class I, Division 1, Groups C and D
 Class II, Division 1, Groups E, F, G
 Class III
 Class I Zone 1, Group IIB

NEC/CEC:

Type 3R, 4, 4X, IP66
 Simultaneous Exposure
 Suitable for Use in Wet Locations

NEC/CEC:

Marine Outside Type (Salt Water)Ⓛ
 American Bureau of Shipping (ABS) CertifiedⓁ

Photometric Data – DATA SHOWN IS ABSOLUTE

2ft Clear Glass Lens, 5000K CCT – 90 min Emergency Mode

Luminaire Lumens 1287.4

POLAR CANDELA DISTRIBUTION

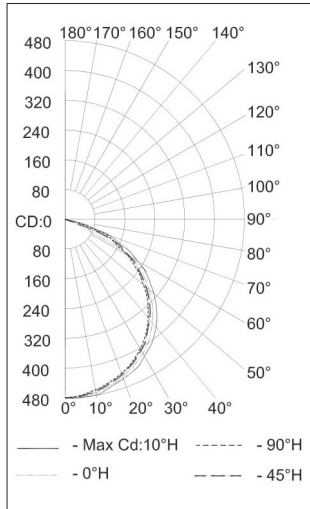

ISOFOOTCANDLE PLOT

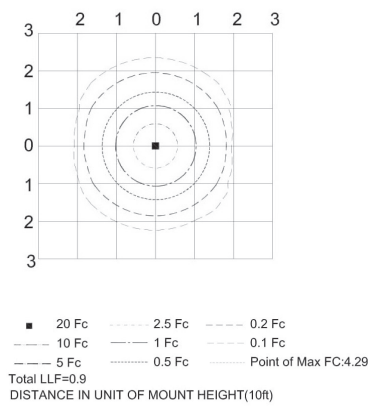

ZONAL LUMEN SUMMARY

Zone	Lumens	% Luminaire
0-30	375.6	29.2%
0-40	620.0	48.2%
0-60	1107.3	86%
60-90	177.9	13.8%
70-100	37.6	2.9%
90-120	0.2	0%
0-90	1285.2	99.8%
90-180	2.2	0.2%
0-180	1287.4	100%

LUMENS PER ZONE

Zone	Lumens	% Total	Zone	Lumens	% Total
0-10	45.3	3.5%	90-100	0.0	0%
10-20	130.4	10.0%	100-110	0.0	0%
20-30	199.9	15.5%	110-120	0.1	0%
30-40	244.4	19.0%	120-130	0.3	0%
40-50	256.2	19.9%	130-140	0.5	0%
50-60	231.1	17.9%	140-150	0.5	0%
60-70	140.3	10.9%	150-160	0.4	0%
70-80	34.8	2.7%	160-170	0.3	0%
80-90	2.8	0.2%	170-180	0.1	0%

4ft Clear Glass Lens, 5000K CCT – 90 min Emergency Mode

Luminaire Lumens 1316.5

POLAR CANDELA DISTRIBUTION

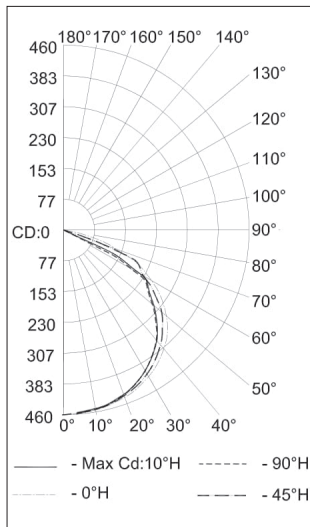

ISOFOOTCANDLE PLOT

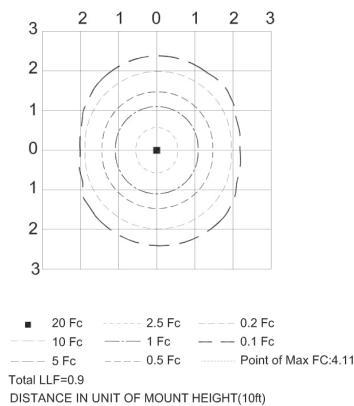

ZONAL LUMEN SUMMARY

Zone	Lumens	% Luminaire
0-30	364.8	27.2%
0-40	608.8	46.2%
0-60	1115.0	84.7%
60-90	200.5	15.2%
70-100	46.1	3.5%
90-120	0.2	0%
0-90	1315.5	99.9%
90-180	1.0	0.1%
0-180	1316.5	100%

LUMENS PER ZONE

Zone	Lumens	% Total	Zone	Lumens	% Total
0-10	43.4	3.3%	90-100	0.0	0%
10-20	125.8	9.6%	100-110	0.1	0%
20-30	195.6	14.9%	110-120	0.1	0%
30-40	244.0	18.5%	120-130	0.2	0%
40-50	262.2	19.9%	130-140	0.2	0%
50-60	244.0	18.5%	140-150	0.2	0%
60-70	154.4	11.7%	150-160	0.1	0%
70-80	42.5	3.2%	160-170	0.1	0%
80-90	3.5	0.3%	170-180	0.0	0%

Ⓛ Applicable to standard (non emergency) fixtures only.