



Product Group:	Air Preparation	Actuators	Cylinders	Grippers	Vacuum / Sensors	Valves	Other
Notice of Discontinuance							
Subject:	PS1E Series						

Parker is rationalizing its 15mm solenoid offering, and will obsolete the PS1E solenoids effective immediately, while shipping product as inventory supports. The PS1E solenoid will be replaced with the P2E solenoid, which is also 15mm in width.

The PS1E solenoid has a pin spacing of 9.4mm, while the P2E solenoid follows the 8mm pin spacing as outlined in Din 43650 Form C.

Please note, this discontinuance does not include any PS1E valve products, only the solenoids.

9.4mm Electrical Pin Spacing

to
→

**DIN 43650 Form - C
8mm Electrical Pin Spacing**

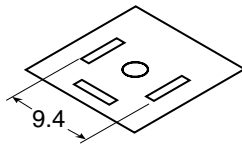

Used for PS1Exxxxx

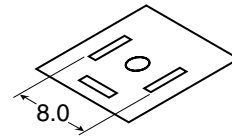

Used for PS1Exxxxx

-
- | | |
|--|------------------------------|
| 1) The Products Shown Above Will Be Discontinued Effective | <u>Immediately</u> |
| 2) Orders For Units Will Be Accepted Until..... | <u>As Inventory Supports</u> |
| 3) Orders For Parts Will Be Accepted Until..... | <u>As Inventory Supports</u> |
| 4) Last Date Returns Accepted | <u>August 1, 2010</u> |



Parker Hannifin Corporation
Pneumatic Division
8676 E. M89
P.O. Box 901
Richland, MI 49083 USA
Tel: 269 629 5000
Fax: 269 629 5385

Applications Engineering
Phone: 877 321 4PDN Option #2
E-mail: pdnapps@parker.com
Customer Support
Phone: 877 321 4PDN Option #1
E-mail: pdncustsvc@parker.com
Web site: www.parker.com/pneumatics

Valve products with plug-in solenoid assemblies (pin down orientation), such as the PVL and PS1E offerings, were redesigned in June of 2004 to accept either the 9.4mm or 8mm pin spacing. Customers with valve bodies older than June 2004 (date code stamp 4 26) will need to replace the valve body if the solenoid fails.

When replacing a PS1E solenoid with pin up orientation, a new electrical connector will be required.

**15mm 3-Pin DIN 43650C
(Use with Enclosure “5”)**

Connector	Connector with Cord	Description
PS2932BP	PS2932HBP 18 Inches	Unlighted
PS2932BP	PS2932JBP 6 Feet	Unlighted
PS294675BP	PS2946J75BP* 6 Feet	Light – 12VAC or DC
PS294679BP	PS2946J79BP* 6 Feet	Light – 24VAC or DC
PS294683BP	PS2946J83BP* 6 Feet	Light – 110/120VAC
PS294687BP	N/A	Light – 240/230VAC

* LED with surge suppression.

Note: Max ø6.5mm cable size required for connector w/o 6' (2m) cord. IP65 rated when properly installed.

Engineering Data:

Conductors: 2 Poles Plus Ground
Cable Range (Connector Only): 4 to 6mm (0.16 to 0.24 Inch)
Contact Spacing: 8mm

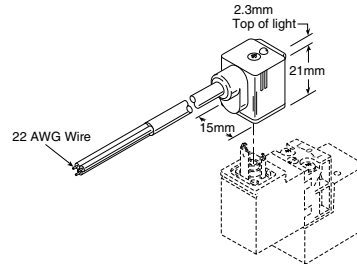

**Molded 6'
Cord Shown**

Customers using the sandwich suppressor and LED module on the PS1E solenoids will need to replace this module with one of the following:

Voltage	Part Number
24 VDC and 50/60 Hz	P8V-CR26C
48 VDC and 50/60 Hz	P8V-CR26D
115 V / 50 Hz 120 V / 60 Hz	P8V-CR24F
230 V / 50 Hz 240 V / 60 Hz	P8V-CR24J



Obsolete Solenoid List & Recommended Replacements

Obsolete Part Number	Solenoid Coil Only Replacement	Solenoid Kit Replacement**	Pin Orientation	Voltage	Override
PS1E2301B	P2E-KS31C1	PS3441B42P	Pin/Air Same	24 VAC	Non Locking
PS1E2301F	P2E-KS31F1	PS3441B53P	Pin/Air Same	120 VAC	Non Locking
PS1E2302B	P2E-KS32C1	PS3441B49P	Pin/Air Same	24 DC	Non Locking
PS1E2302E	P2E-KS32D1	PS3441B51P	Pin/Air Same	48 DC	Non Locking
PS1E2302J	P2E-KS32B1	PS3441B45P	Pin/Air Same	12 DC	Non Locking
PS1E2351B	P2E-KS31C2	PS3441C42P	Pin/Air Same	24 VAC	Locking
PS1E2351F	P2E-KS31F2	PS3441C53P	Pin/Air Same	120 VAC	Locking
PS1E2352B	P2E-KS32C2	PS3441C49P	Pin/Air Same	24 DC	Locking
PS1E2402B	P2E-KV32C1	PS2982B49P	Pin/Air Opposite	24 DC	Non Locking
PS1E2491B	P2E-KV31C0	PS2982A42P	Pin/Air Opposite	24 VAC	None
PS1E2491F	P2E-KV31F0	PS2982A53P	Pin/Air Opposite	120 VAC	None
PS1E2491M	P2E-KV31J0	PS2982A57P	Pin/Air Opposite	240 VAC	None
PS1E2492B	P2E-KV32C0	PS2982A49P	Pin/Air Opposite	24 DC	None
PS1E2492J	P2E-KV32B0	PS2982A45P	Pin/Air Opposite	12 DC	None
PVAH2491B*	P2E-KV31C0	PS2982A42P	Pin/Air Opposite	24 VAC	None
PVAH2491F*	P2E-KV31F0	PS2982A53P	Pin/Air Opposite	120 VAC	None
PVAH2492B*	P2E-KV32C0	PS2982A49P	Pin/Air Opposite	24 DC	None

*Solenoids included electrical connector without cord. Replacements must be ordered separately.

**Solenoid Kit Replacement include gaskets and mounting screws.