

# YEFB High static pressure blower

2 & 4 pipe system

A complete range from 4.3 kW up to 27.5 kW



**CSR00 (Wall mounted)**  
Fan speed selector



**CMR00 (Wall mounted)**  
Thermostat with manual fan speed and S/W change over



**CER00 (Wall mounted)**  
Thermostat with manual fan speed and automatic change over

**CER20 (Wall mounted)**  
Thermostat with auto. fan speed and automatic change over

**CER30 (Wall mounted)**  
Thermostat with auto. fan speed and automatic change over for modulating valve



**TUC03+ Terminal unit controller**  
BacNET and N2 Metasys network compatible



YEFB Blower units are available in 6 sizes for horizontal concealed installations: thanks to their high ESP fans that can handle up to 250Pa, they are the ideal solution for air conditioning large spaces.



Selection software

## Features

- 6 unit sizes for horizontal mounting
- Handles high external static pressure up to 250Pa
- Choice of 2 or 4 pipe systems
- Twin centrifugal fans
- Horizontal air return
- Air distribution plenum
- Electric heater option
- Optional paint finish
- F5 grade filter option
- 5 Row cooling coil option on sizes 060, 070
- EUROVENT Certified

# YEFB High static pressure blower

4.3 kW to 27.5 kW



## Unit performance at different Pa external static pressure, with 4 row cooling coil

Model YEFB		020-4	030-4	040-4	050-4	060-4*	070-4*	
Total cooling capacity [kW]	(1)	max	6.95	9.49	11.77	13.72	23.83	27.52
		med	5.90	8.23	10.35	12.6	21.59	25.55
		min	4.30	7.11	8.91	11.36	17.15	23.56
Sensible cooling capacity [kW]	(1)	max	4.99	7.91	9.94	11.80	18.89	22.00
		med	4.14	6.7	8.61	10.60	16.84	20.27
		min	2.98	5.68	7.17	9.44	12.93	18.54
Water flow in cooling [l/h]	(1)	max	1195	1632	2024	2360	4099	4699
		med	1015	1416	1780	2167	3714	4361
		min	740	1223	1533	1954	2950	4018
Pressure drop in cooling [kPa]	(1)	max	17.4	31.5	30.6	40.4	28.0	37.5
		med	12.2	24.1	23.3	33.8	23.2	33.0
		min	6.5	18.4	17.9	28.3	15.1	28.7
Heating capacity 2 pipes [kW]	(2)	max	7.08	11.40	14.32	17.4	28.08	33.85
		med	6.20	9.62	12.19	15.53	24.95	30.95
		min	4.55	8.20	10.4	13.85	18.9	28.09
Water flow in heating 2 pipes [l/h]	(2)	max	1219	1962	2465	2727	4495	5855
		med	1067	1656	2098	2673	4034	5354
		min	783	1411	1788	2392	3047	4858
Pressure drop in heating 2 pipes [kPa]	(2)	max	13.3	34.0	36.1	51.0	30.2	49.6
		med	10.3	25.7	26.9	41.3	23.5	42.4
		min	4.8	19.2	20.0	33.4	14.6	35.7
Air flow [m³/h]		max	1145	1910	2680	3250	4120	5512
		med	920	1520	2130	2870	3610	4936
		min	620	1205	1655	2470	2580	4383
Sound power level [dB(A)]		max	64.0	65.0	69.0	72.0	77.0	81.0
		med	58.0	61.0	63.0	68.0	74.0	79.0
		min	48.0	57.0	57.0	65.0	65.1	76.0
Sound pressure level [dB(A)]	(3)	max	53.0	54.0	58.0	61.0	66.0	70.0
		med	47.0	50.0	52.0	57.0	63.0	68.0
		min	37.0	46.0	46.0	54.0	54.0	65.0
Power supply [V-ph-Hz]		230 / 1 / 50						
Power input [W]	max	171	352	451	588	1007	1 781	
Absorbed current [A]	max	0.74	1.62	2.05	2.83	4.47	7.90	
Dimensions	Height	mm	407.6	407.6	407.6	407.6	517.6	517.6
	Width	mm	902	902	902	902	1 160	1 160
	Depth	mm	989.6	989.6	1 239.6	1 239.6	1 634.6	1 634.6

(1) Room temperature 27°C d.b., 19°C w.b. - Water temperature 7/12 °C

(2) Room temperature 20°C - Water inlet temperature: 45/40°C

(3) Lp= Total sound pressure level in open field at 1 m from the source

For each unit size there are 2, 3 and 4 row coils available; for 4 pipe systems it is possible to install a 2 or 3 row coil. It is therefore possible to have a combination of maximum 7 rows (4 row cooling + 3 row heating). For models 060 and 070 are also 5 row coils available, which can be combined with additional 2 or 3 row coils.

\* Performances are out of scope Eurovent FCP.



Manufacturer reserves the rights to change specifications without prior notice.

# YEFB-ECM Inverter high static pressure blower

2 & 4 pipe system

A complete range from 4.2 kW up to 23.8 kW



YEFB-ECM high pressure ducted fan coils with energy saving motors, are specifically designed for ducted installations, with external static pressure up to 300 Pa. Their high pressure fan decks permit to satisfy every request of heating and cooling application in big environments.

The YEFB-ECM high pressure fan coil units are available in 5 sizes for concealed horizontal installation, in 2 and 4 pipe systems. For each unit size there are 2, 3 and 4 row coils available and models 060 are also 5 row coils available, which can be combined with additional 2 or 3 row coils.



#### EDCR (Wall mounted)

Thermostat with manual or automatic fan speed and automatic change over for modulating valve



#### TUC03+ Terminal unit controller

BacNET and N2 Metasys network compatible



## Features

- 5 unit sizes for horizontal mounting
- Handles high external static pressure up to 300Pa
- Choice of 2 or 4 pipe systems
- Twin centrifugal fans
- Horizontal air return
- Air distribution plenum
- Electric heater option
- Optional paint finish
- F5 grade filter option
- 5 Row cooling coil option on size 060
- EUROVENT Certified



Selection software

# YEFB-ECM Inverter high static pressure blower

4.2 kW to 23.8 kW



## ECM the Energy Saving Technology

Brushless motor with inverter managed by dedicated controls. It permits to maintain extremely low electrical absorption and a continuous modulation of the air flow.

### Unit performance at different Pa external static pressure, with 4 row cooling coil

Model YEFB		020-4	030-4	040-4	050-4	060-4	
Total cooling capacity [kW]	(1)						
	max	6.75	9.94	13.64	14.40	23.82	
	med	5.62	8.13	11.22	13.25	20.32	
	min	4.23	7.11	8.43	11.90	18.79	
Sensible cooling capacity [kW]	(1)						
	max	5.27	7.98	11.17	11.94	18.76	
	med	4.30	6.34	10.82	10.82	15.78	
	min	3.16	5.47	6.46	9.56	14.49	
Water flow in cooling [l/h]	(1)						
	max	1162	1711	2348	2478	4088	
	med	812	1399	1931	2281	3488	
	min	728	1224	1451	2048	3224	
Pressure drop in cooling [kPa]	(1)						
	max	16.5	35.4	45.0	50.9	30.8	
	med	11.6	24.0	30.6	42.9	23.4	
	min	6.8	18.8	17.7	34.7	20.5	
Heating capacity 2 pipes [kW]	(2)						
	max	7.07	11.52	16.24	18.07	28.00	
	med	5.65	9.07	12.87	16.25	23.25	
	min	4.11	7.81	9.35	14.37	21.23	
Water flow in heating 2 pipes [l/h]	(2)						
	max	1217	1983	2795	3110	4866	
	med	972	1561	2215	2797	4041	
	min	707	1344	1609	2473	3689	
Pressure drop in heating 2 pipes [kPa]	(2)						
	max	15.4	39.1	53.2	65.7	32.1	
	med	10.4	25.4	34.8	54	23.2	
	min	5.8	19.3	19.3	43.1	19.8	
Air flow [m³/h]							
	max	1040	1948	2848	3217	4521 *	
	med	796	1471	2160	2834	3599 *	
	min	549	1241	1484	2442	2972 *	
Sound power level [dB(A)]							
	max	65	68	71	75	76 *	
	med	58	61	66	72	77 *	
	min	49	57	57	69	74 *	
Sound pressure level [dB(A)]	(3)						
	max	54	57	60	64	70 *	
	med	47	50	55	61	66 *	
	min	38	46	46	58	63 *	
Power supply [V-ph-Hz]		230 - 1 - 50/60 **					
Power input [W]	max	161	261	405	478	926 *	
Absorbed current [A]	max	1.08	1.12	1.85	2.17	4.16 *	
Dimensions	Height	mm	407.6	407.6	407.6	407.6	517.6
	Width	mm	902	902	902	902	1 160
	Depth	mm	989.6	989.6	1 239.6	1 239.6	1 634.6

(1) Room temperature 27°C d.b., 19°C w.b. - Water temperature 7/12 °C

(2) Room temperature 20°C - Water inlet temperature: 45/40°C

(3) Lp= Total sound pressure level in open field at 1 m from the source

4 pipe system not available with 4R heating coil

\* Performances are out of scope Eurovent FCP.

\*\* For a correct selection at 60 Hz of the units, pls use the YORK software for selection.



Manufacturer reserves the rights to change specifications without prior notice.

# YEFB Hydro Blower

## YEFB-ECM Inverter Hydro Blower

### Compatibility tables



#### Compatibility Options / Accessories / Models

Code	Designation	YEFB / YEFB-ECM					
		020	030	040	050	060	070
<b>Coils and heaters**</b>							
BA2	Additional 2 row heating	•	•	•	•	•	•
BA3	Additional 3 row heating	•	•	•	•	•	•
KREL	Kit electrical heater with safety thermostat and relay	•	•	•	•	•	•
<b>Factory fitted electric box</b>							
CBL10	Transformer 230/24V	•	•	•	•	•	•
CBL20	Parallel connection for ON/OFF valve	•	•	•	•	•	•
CBL30	Parallel connection for modulating valve	•	•	•	•	•	•
<b>Remote controllers and thermostats (wall mounted)</b>							
CSR00	Fan speed selector (wall mounted)	•	•	•	•	•	•
CMR00	Thermostat with manual fan speed and S/W change over	•	•	•	•	•	•
CER00	Thermostat with manual fan speed, dead band, automatic change over	Compatible with electrical heaters					
CER20	Thermostat with automatic fan speed, dead band, automatic change over	Compatible with electrical heaters					
CER30	Thermostat with automatic fan speed, dead band, automatic change over for modulating valves	•	•	•	•	•	•
EDCR	Thermostat with manual or automatic fan speed, dead band, automatic change over for modulating valves - Only for ECM models	Compatible with electrical heaters					
OxT+OC716	Omnibus control + Remote Analogue Plus	Compatible with electrical heaters					
OxT+OC216	Omnibus control + Remote Display console	Compatible with electrical heaters					
<b>Valves (Supplied loose) / Condensate pump / Water sensor (Factory fitted)</b>							
J3B2 (2p)	3-way 4-ports on/off valves for 2-pipe systems	•	•	•	•		
J3B2 (4p)	3-way 4-ports on/off valves for 4-pipe systems	•	•	•	•		
J3C2 (2p)	3-way 4-ports on/off valves for 2-pipe systems					•	•
J3C2 (4p)	3-way 4-ports on/off valves for 4-pipe systems					•	•
J3BM (2p)	3-way 4-ports modulating valves for 2-pipe systems	•	•	•	•		
J3BM (4p)	3-way 4-ports modulating valves for 4-pipe systems	•	•	•	•		
J3CM (2p)	3-way 4-ports modulating valves for 2-pipe systems					•	•
J3CM (4p)	3-way 4-ports modulating valves for 4-pipe systems					•	•
J2B2 (2p)	2-way on/off valves for 2-pipe systems	•	•	•	•		
J2B2 (4p)	2-way on/off valves for 4-pipe systems	•	•	•	•		
J2C2 (2p)	2-way modulating valves for 2-pipe systems					•	•
J2C2 (4p)	2-way modulating valves for 4-pipe systems					•	•
DTB (2p)	Shut-off valves for 2-pipe systems supplied loose in addition to J3B2 and J3BM valves	•	•	•	•		
DTB (4p)	Shut-off valves for 4-pipe systems (in addition to J3B2/J3BM valves)	•	•	•	•		
PC	Condensate pump	•	•	•	•	•	•
AS	Air sensor	•	•	•	•	•	•
WS	Water sensor	Compatible with CEL/CER/EDCR					
<b>Plenums</b>							
PAS	Air intake plenum collars	•	•	•	•	•	•
PM	Air delivery plenum with collars	•	•	•	•	•	•
PM + Grill	Air delivery plenum painted with air outlet grill	•	•	•	•	•	•

- Compatible
- ◻ Compatible with conditions
- ◻ Not compatible

# Dimensions & Weights

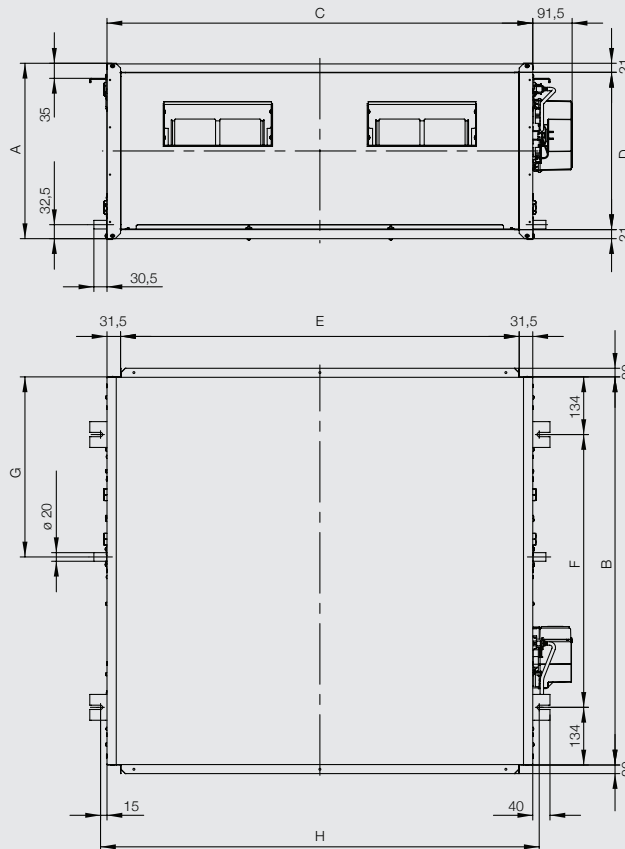

All dimensions in mm. Drawings not in scale.

Model YEFB / YEFB-ECM		020-4	030-4	040-4	050-4	060-4	070-4
A	mm	407.6	407.6	407.6	407.6	517.6	517.6
B	mm	902	902	902	902	1160	1160
C	mm	989.6	989.6	1239.6	1239.6	1634.6	1634.6
D	mm	365.6	365.6	365.6	365.6	475.6	475.6
E	mm	926.6	926.6	1176.6	1176.6	1571.6	1571.6
F	mm	634	634	634	634	892	892
G	mm	418.5	418.5	418.5	418.5	446.5	446.5
H	mm	1019.6	1019.6	1269.6	1269.6	1664.6	1664.6
Weight (3R - 3 rows)	kg	64.3	64.3	79.3	79.3	126.0	126.0

Model YEFB		(2-3-4 rows)	(2-3-4 rows)	(2-3-4 rows)	(2-3-4 rows)	(2-3-4-5 rows)	(2-3-4-5 rows)
Weight of the coil	kg	4.8 - 5.8 - 7.6	4.8 - 5.8 - 7.6	5.6 - 7.4 - 9.6	5.6 - 7.4 - 9.6	9.4 - 12.8 - 17.4 - 21.5	9.4 - 12.8 - 17.4 - 21.5
Water connection		G1/2" F	G1/2" F	G1/2" F	G1/2" F	G1" M	G1" M
Model YEFB-ECM		(2-3-4 rows)	(2-3-4 rows)	(2-3-4 rows)	(2-3-4 rows)	(2-3-4-5 rows)	-
Weight of the coil	kg	4.8 - 5.8 - 7.6	4.8 - 5.8 - 7.6	5.6 - 7.4 - 9.6	5.6 - 7.4 - 9.6	9.4 - 12.8 - 17.4 - 21.5	-
Water connection		G1/2" F	G1/2" F	G1/2" F	G1/2" F	G1" M	-

Model YEFB		(2-3-4 rows)	(2-3-4 rows)	(2-3-4 rows)	(2-3-4 rows)	(2-3-4-5 rows)	(2-3-4-5 rows)
Water content	l	1.4 - 2.2 - 2.9	1.4 - 2.2 - 2.9	1.9 - 2.8 - 3.8	1.9 - 2.8 - 3.8	3.4 - 5.0 - 6.7 - 8.4	3.4 - 5.0 - 6.7 - 8.4
Model YEFB-ECM		(2-3-4 rows)	(2-3-4 rows)	(2-3-4 rows)	(2-3-4 rows)	(2-3-4-5 rows)	-
Water content	l	1.5 - 2.2 - 2.9	1.4 - 2.2 - 2.9	1.9 - 2.8 - 3.8	1.9 - 2.8 - 3.8	3.4 - 5.0 - 6.7 - 8.4	-