

# Respiratory Humidification Products

USA AND CANADA

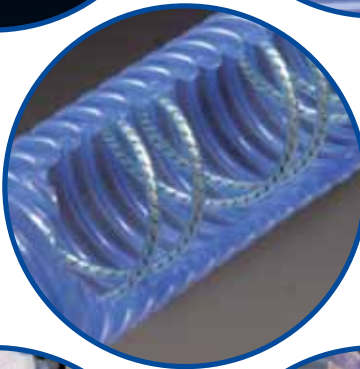
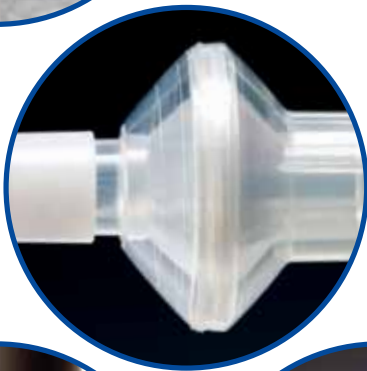

# Contents

---

## ***Respiratory Humidifiers***

Respiratory Humidifier Application Guide .....	2
Respiratory Humidifiers .....	3
Airway Temperature Probes .....	5
Heater Wire Adapters: Single Use.....	5
Heater Wire Adapters: Reusable Circuits .....	6
Humidifier Mounting Brackets .....	7
Water Bag Poles.....	10
Humidifier Stands .....	11
Locking Bracket .....	11
Humidifier Servicing Accessories .....	12
Ventilator Accessories .....	12

## ***Single Use Products***

Circuit & Chamber Application Guide .....	14
Adult Circuit & Chamber Kits .....	15
Adult Circuits .....	16
Oxygen Therapy Kits .....	17
Infant Breathing Circuit & Chamber Kits.....	18
Infant Breathing Circuits .....	19
Pediatric Circuit Application .....	19
Humidification Chambers .....	20
Waterfeed Sets.....	20
Components .....	21

## ***Reusable Products***

Circuit & Chamber Application Guide .....	26
Adult Breathing Circuits .....	27
Infant Breathing Circuits .....	28
Unheated Breathing Circuits .....	29
Humidification Chambers .....	30
Circuit Tubing .....	31
Heater Wires - Adult/Pediatric .....	32
Heater Wires - Infant .....	32
Heater Wires - Dual .....	33
Components .....	33
Index.....	41

<i>Application</i>	<i>Recommended Humidifier</i>	<i>Bracket &amp; Mounting Arrangement</i>	<i>Waterbag Pole</i>
<b>ADULT VENTILATION</b>			
Dräger Evita 1,2 4, XL, Dura, Savina	MR850	900MR305	900MR290
Hamilton Amadeus, Veolar, Raphael	MR850	900MR030 & 900MR087	900MR290
Hamilton Galileo	MR850	900MR087	900MR290
Infrasonics Adult Star 2000	MR850	900MR087	900MR290
Maquet 300A, 900C, Servo <sup>i</sup>	MR850	900MR303	900MR290
Newport Breeze HT50	MR850 or HC500	900MR030 or 900HC032	900MR011
Newport E100m	MR850	900MR030 & 900MR087	900MR290
Newport e500	MR850	900MR087	900MR290
Puritan Bennett 7200	MR850	900MR081 & 900MR087	900MR011
Puritan Bennett 740,760	MR850	900MR167 & 900MR087	900MR290
Puritan Bennett 840	MR850	900MR304	900MR290
Puritan Bennett MA1, MA2	MR850	900MR082 & 900MR087	900MR011
Pulmonetics LTV	MR850 or HC500	900MR030 & 900MR087	900MR290
Viasys Avea	MR850	900MR030 & 900MR087	900MR290
Viasys Bear 1, 2	MR850	900MR083	900MR011
Viasys Bear 1000	MR850	900MR082 & 900MR087	900MR290
Viasys Bird 6400,8400	MR850	900MR301	900MR290
Viasys Sensormedics 3100B	MR850	900MR301	900MR290
Viasys T-Bird	MR850	900MR303 or 900MR301	900MR290
Viasys Vela, Legacy	MR850 or HC500	900MR301 or 900HC032	900MR011
<b>ADULT &amp; PEDIATRIC CPAP/NPPV</b>			
Dräger CPAP CF800	MR850	900MR303	900MR290
Medicaid Whisperflow	MR850	900MR030 & 900MR087	900MR290
Respironics BiPAP S/T-D30, Synchrony	MR850	900MR030 & 900MR087	900MR290
Respironics Vision	MR850	900MR030 & 900MR087	900MR290
Wall Source	MR850	900MR030 & 900MR087	900MR290
Viasys Bird Blender	MR850	900MR030 & 900MR087	900MR290
Viasys Mark Series	MR850	900MR030 & 900MR087	900MR290
Vital Signs - Vital Flow	MR850	900MR030 & 900MR087	900MR290
<b>OXYGEN THERAPY</b>			
Tracheostomy	MR850	900MR030 & 900MR087	900MR290
Face Mask	MR850	900MR030 & 900MR087	900MR290
<b>INFANT VENTILATION</b>			
Dräger Babylog 8000	MR850	900MR030 & 900MR087	900MR290
Infrasonics Infant Star 500, 950	MR850	900MR030 & 900MR087	900MR290
Maquet 300A, 900C, Servo <sup>i</sup>	MR850	900MR303	900MR011
Newport Breeze E150	MR850	900MR030 & 900MR087	900MR290
Sechrist Millenium, IV100, IV200	MR850	900MR030 & 900MR087	900MR290
Viasys Bear Cub 750 PSV	MR850	900MR030 & 900MR087	900MR290
Viasys Bird VIP	MR850	900MR301	900MR290
Viasys Sensormedics 3100A HFV0	MR850	900MR301	900MR290
<b>INFANT CPAP</b>			
EME Flow Driver	MR850	900MR030	900MR292
Hamilton Arabella	MR850	900MR030	900MR292
<b>INFANT OXYGEN THERAPY</b>			
Headbox/ Oxygen Hood	MR850	900MR030 & 900MR087	900MR011
Nasal Cannula	MR850	900MR030	900MR292

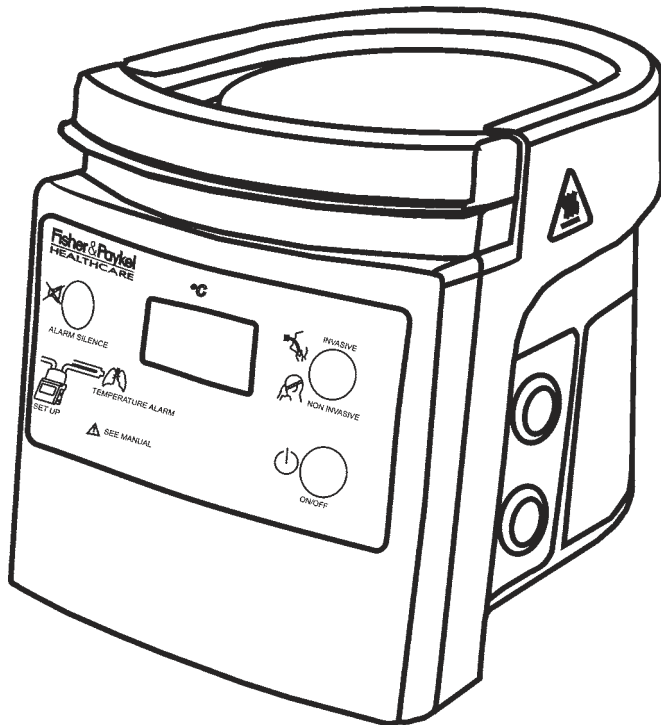
**MR850****Respiratory humidifier**

One button selects optimal temperature and humidification levels for neonatal, pediatric and adult patients requiring invasive or noninvasive respiratory support. One system, all patients

Advanced algorithms and flow-sensing optimize humidification delivery and minimize nuisance alarms

Continuous digital display of saturated gas temperature combined with simple controls and intuitive set-up indicator

Automatic standby during periods of gas flow interruption and water out monitor

Use with heated wire breathing circuits

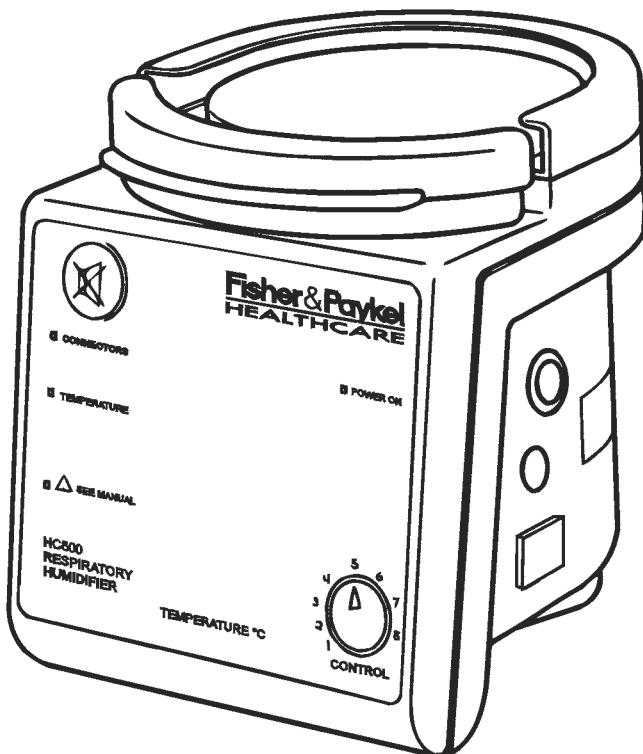
**HC500****Homecare humidifier**

Hidden temperature display illuminates only when needed

Simplified temperature level control designed for home respiratory support applications

Choice between heated wire or unheated breathing circuits

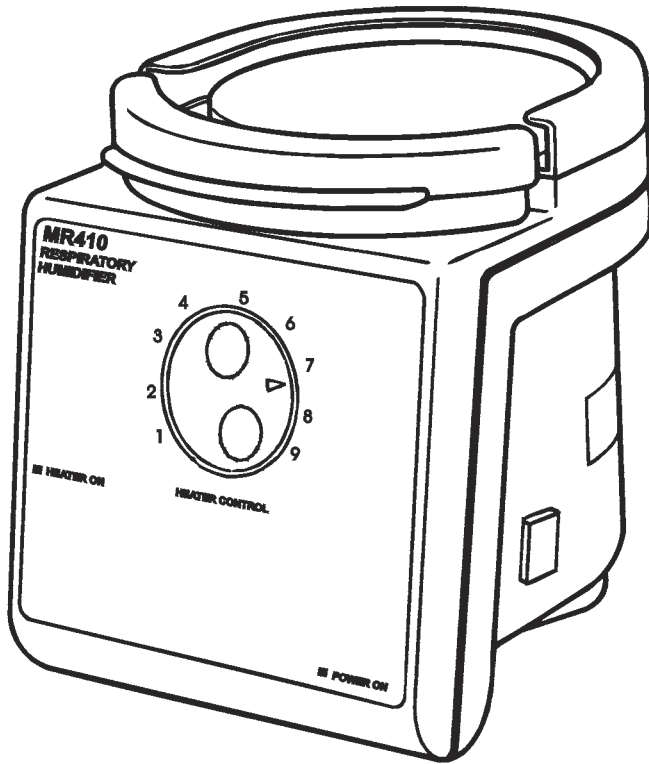
**MR410****Oxygen therapy and CPAP humidifier**

For noninvasive oxygen therapy and mask CPAP

Heater plate control dial

Electronic heater plate control maintains stable heater plate and gas temperatures in constant flow applications

Use with unheated circuits only



**900MR860-869**

**Temperature/flow probes for MR850 humidifier  
Right angle airway probe**

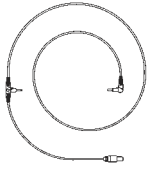

- 900MR863 for use with circuits 0.7m (28") in length
- 900MR868 for use with circuits 1.1m (44") in length
- 900MR860 for use with circuits 1.3m (52") in length
- 900MR869 for use with circuits 1.5m (60") in length**
- 900MR861 for use with circuits 1.8m (72") in length

**900MR560-571**

**Temperature probes for MR700 & HC500 series humidifiers  
Right angle airway probe**

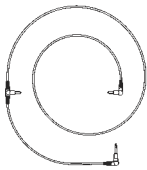

- 900MR563 for use with circuits 0.7m (28") in length
- 900MR568 for use with circuits 1.1m (44") in length
- 900MR560 for use with circuits 1.3m (52") in length
- 900MR569 for use with circuits 1.5m (60") in length**
- 900MR561 for use with circuits 1.8m (72") in length
- 900MR571 for use with circuits 2.5m (92") in length

**900MR208**

**Reflective shield for temperature probe**

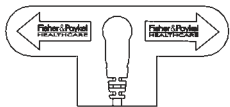

Protects airway temperature probe from radiant heat to improve humidifier performance with infant radiant warmers  
Available in packs of 20

## Heater Wire Adapters: Single Use



**900MR800**

**Heater wire adapter for *RT series* dual heated breathing circuits**

For use with the MR850 Humidifier

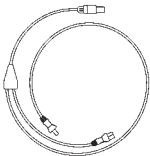

**900MR801**

**Heater wire adapter for *RT series* inspiratory heated breathing circuits**

For use with the MR850 Humidifier

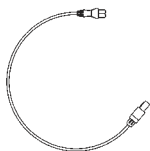

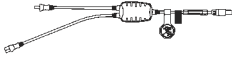
**900MR900****Heater wire adapter for *RT series* dual heated breathing circuits**

For use with MR700, MR730 & HC500 humidifiers

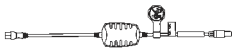
**900MR901****Heater wire adapter for *RT series* inspiratory heated breathing circuits**

For use with MR700, MR730 & HC500 humidifiers

**900MR554****Heater wire adapter for parallel wired dual heated Isothermal® breathing circuits**

For use with the HC500 and MR730 Humidifiers

**900MR555****Heater wire adapter for serial wired dual heated Isothermal® breathing circuits**

For use with the HC500 and MR730 Humidifiers

**900MR559****Heater wire adapter for inspiratory heated Isothermal® breathing circuits**

For use with the HC500 and MR730 Humidifiers

## Heater Wire Adapters: Reusable Circuits

**900MR858****Inspiratory heater wire adapter for reusable circuits Lemo™ style**

For use with the MR850 humidifier when paired with an inspiratory heated, reusable circuit

**900MR556****Dual heater wire adapter for reusable circuits Lemo™ style**

For use with the MR730 humidifier when paired with a dual heated, reusable circuit

**900MR558****Inspiratory heater wire adapter for reusable circuits Lemo™ style**

For use with the MR730 humidifier when paired with an inspiratory heated, reusable circuit

*Respiratory*

**HUMIDIFICATION**

**900MR030**

**Pole clamp**

For mounting the humidifier to a 15 - 50mm pole

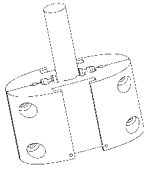

**900MR081**

**Mounting bracket for PB7200**

For mounting the humidifier to the Puritan Bennett 7200 ventilator

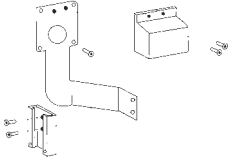

**900MR082**

**Mounting bracket for PB MA1, MA2, Bear V, Bear 1000**

For attaching the humidifier to Puritan Bennett MA1, MA2 ventilators or Bear V and Bear 1000 ventilators



**900MR083**

**Mounting bracket for Bear 2**

For mounting the humidifier on the Bear 2 ventilator

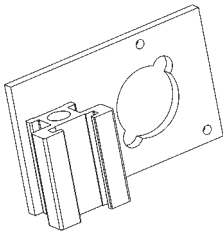

**900MR086**

**Wall mounting bracket**

For wall mounting of the humidifier

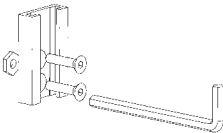

**900MR087**

**Waterbag pole mounting bracket**

For wall mounting the humidifier or mounting waterbag poles to humidifier brackets

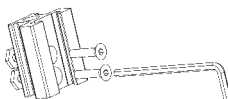

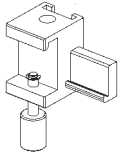

**900MR088**

**Rail bracket**

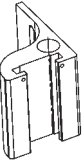
For mounting the humidifier and a water bag pole to Dräger and Maquet ventilators, or to 25mm x 10mm rails

**900MR167**

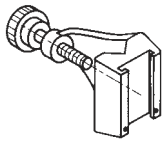
**Mounting kit for PB740/760**

For mounting the humidifier to the Puritan Bennett 740 or 760 ventilators

**900MR170**

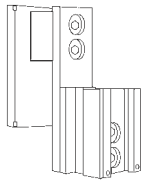
**C-Clamp**

For mounting the humidifier onto a 19 - 40mm pole  
Includes a clip to allow permanent attachment of the humidifier to the clamp

**900MR301**

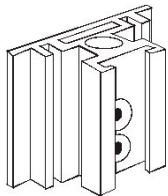
**Mounting bracket for Bird, Sensormedics**

For mounting the humidifier to Bird 6400/8400, T-Bird and Sensormedics ventilators

**900MR302**

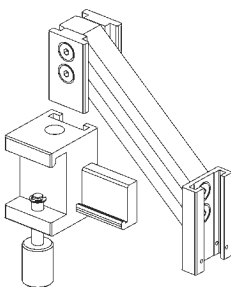
**Concha conversion bracket**

For mounting the humidifier to an existing Concha mounting bracket

**900MR303**

**Rail mounting bracket**

For mounting the humidifier to Maquet 300, 900 + Servo<sup>1</sup>, Dräger, Viasys T Bird and Aequitron ventilators, or to 30mm rails

**900MR304**

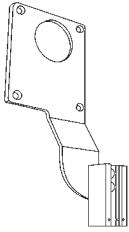
## Mounting bracket for PB840



For mounting the humidifier to the PB840 ventilator  
Includes splash cover

**900MR305**

## Dräger mounting bracket

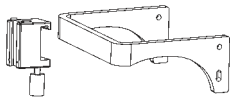

For mounting the humidifier to the Evita 4/XL ventilators  
Includes 900MR088

**900HC031**

## Aequitron, T-Bird, Lifecare, Marquet & Dräger mounting bracket

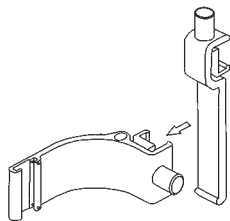

For mounting the humidifier onto Aequitron, T Bird, Lifecare, Marquet and Dräger ventilators  
Allows the humidifier to be mounted on the side or the top of the ventilator

**900HC032**

## Humidifier mounting tray

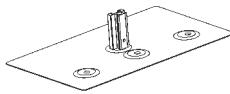

For mounting the humidifier in homecare environments  
Free standing metal tray with humidifier mount  
The tray can be secured to a flat surface if required  
Designed for use in conjunction with a homecare ventilator or flow generating device

**900HC033**

## Humidifier stand mounting tray

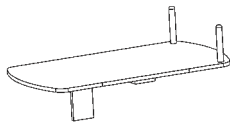

For mounting the flow generating device to the humidifier stand

**900MR011****Waterbag pole**

1.25 m (50") in height

**900MR012****Waterbag pole**

1.0m (40") in height

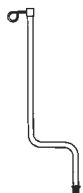
**900MR290****Waterbag pole bent**

0.7m (28") in height

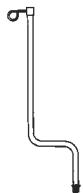
**900MR291****Waterbag pole bent**

1.05m (42") in height

**900MR292****Telescopic water bag pole**

Combined with the 900MR191 Water Feed Extension Set, this pole allows the MR290 autofeed humidification chamber to be used with Infant CPAP Drivers

Minimum height: 1.64m

Maximum height: 2.64m

## 900MR293

### Humidifier stand with water bag pole

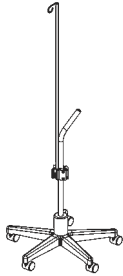

For mounting the humidifier to a mobile humidifier stand  
The waterbag pole allows the MR290 autofeed humidification chamber to be used with the humidifier stand. 1.65m in height

Includes:  
900MR294 humidifier stand  
900MR030 pole clamp  
900MR012 waterbag pole  
900MR087 waterbag pole mounting bracket

## 900MR294

### Humidifier stand

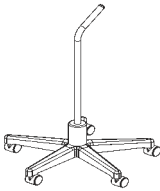

For mounting the humidifier to a mobile humidifier stand  
For use with manual feed chambers. 0.89m in height

Includes:  
Base  
Curved humidifier stand

## 900MR306

### Humidifier stand basket

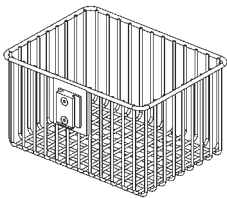

Able to be connected to the humidifier stand with the 900MR030 pole clamp

## Locking Bracket

## 900MR308

### MR850 locking bracket

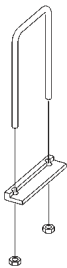

Locks the MR850 to all of the Fisher and Paykel Healthcare pole brackets. This prevents the humidifier from being separated from the pole  
The locking bracket can also secure the 900MR306 basket

**900MR848****MR850 technical manual and service kit**

For use with the 850 humidifier

Includes:

Technical Manual

Fuses

Serial Cable & Software

Calibration Probe

**900MR870****MR850 reference probe**

For use with MR850 humidifier

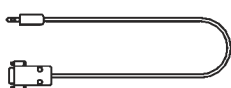
**900MR888****MR850 serial cable**

For use with MR850 humidifier

## Ventilator Accessories

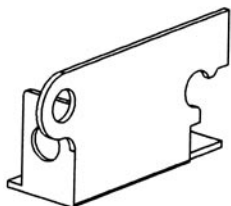
**900MR597****Dräger expiratory flow sensor shield**

The acrylic shield provides insulation to reduce condensation, in the flow sensor

Fits Dräger Evita 2, 4, XL

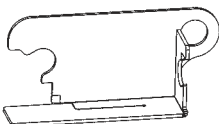
**900MR598****Dräger expiratory flow sensor shield**

The acrylic shield provides insulation to reduce condensation, in the flow sensor

Fits Dräger Evita 2, 4, XL, with some base mounting options where 900MR597 will not fit.

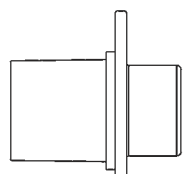
**900MR177****Maquet adapter**

22mm M / 15mm F

For use on Maquet 300 and 900 ventilators

Available as a single item

**Single Use Products**

Circuit & Chamber Application Guide ..... 14  
Adult Circuit & Chamber Kits ..... 15  
Adult Circuits ..... 16  
Oxygen Therapy Kits ..... 17  
Infant Breathing Circuit & Chamber Kits ..... 18  
Infant Breathing Circuits ..... 19  
Pediatric Circuit Application ..... 19  
Humidification Chambers ..... 20  
Waterfeed Sets ..... 20  
Components ..... 21

<b>Application</b>	<b>Breathing Circuit</b>	<b>MR850 Heater Wire Adapter</b>	<b>MR850 Temperature Probe</b>	<b>MR730 Heater Wire Adapter</b>	<b>MR730 Temperature Probe</b>
<b>ADULT VENTILATION</b>					
Dräger Evita 1, Evita 2 Dura, Evita 4, Evita XL, Savina	RT210 or RT240	900MR800	900MR869	900MR900	900MR569
eVent Inspirator	RT210 or RT240	900MR800	900MR869	900MR900	900MR569
GE Engstrom Carestation	RT210 or RT240	900MR800	900MR869	900MR900	900MR569
Hamilton Amadeus, Galileo, Raphael, Veolar	RT215 or RT240	900MR800	900MR869	900MR900	900MR569
Infrasonics Adult Star 2000	RT211	900MR800	900MR869	900MR900	900MR569
Maquet 300A, 900C, Servo <sup>i</sup>	RT210 or RT240	900MR800	900MR869	900MR900	900MR569
Newport E100M, Wave E200, e500 Wave	RT210 or RT240	900MR800	900MR869	900MR900	900MR569
Newport Breeze	RT215	900MR801	900MR869	900MR901	900MR569
Puritan Bennett 840, 7200	RT210 or RT240	900MR800	900MR869	900MR900	900MR569
Puritan Bennett 740, 760	RT215 or RT240	900MR800	900MR869	900MR900	900MR569
Pulmonetics LTV	Refer to Pulmonetics for recommended configuration				
Respironics Esprit	RT215 or RT240	900MR800	900MR869	900MR900	900MR569
Sensormedics 3100B	Refer to Sensormedics for recommended configuration				
Viasys	RT210 or RT240	900MR800	900MR869	900MR900	900MR569
Viasys Bear 1, 2, 5, 1000	RT211	900MR800	900MR869	900MR900	900MR569
Viasys Bird 8400	RT210 or RT240	900MR800	900MR869	900MR900	900MR569
Versamed iVent	Refer to Versamed for recommended configuration				
Viasys Avea, Legacy, Vela, T-Bird,	RT210 or RT240	900MR800	900MR869	900MR900	900MR569
<b>ADULT &amp; PEDIATRIC CPAP/NPPV</b>					
Dräger CF800	RT202	900MR801	900MR869	900MR901	900MR569
Newport HT50	RT202	900MR801	900MR869	900MR901	900MR569
Medicaid Whisperflow	RT202	900MR801	900MR869	900MR901	900MR569
Respironics BiPAP S/T-D30	RT219	900MR801	900MR869	900MR901	900MR569
Respironics Vision	RT219	900MR801	900MR869	900MR901	900MR569
Viasys Bird Blender	RT202	900MR801	900MR869	900MR901	900MR569
Vital Signs - Vital Flow	RT202	900MR801	900MR869	900MR901	900MR569
Wall Source	RT202	900MR801	900MR869	900MR901	900MR569
<b>OXYGEN THERAPY</b>					
Face Mask	RT408	900MR801	900MR869	900MR901	900MR569
Tracheostomy	RT408	900MR801	900MR869	900MR901	900MR569
<b>INFANT VENTILATION</b>					
Dräger Babylog 8000, Evita	RT235 or RT236	900MR800	900MR869	900MR901	900MR569
Infrasonics Infant Star 500, 950	RT235 or RT236	900MR800	900MR869	900MR901	900MR569
Maquet 300A, 900C, Servo <sup>i</sup>	RT236	900MR800	900MR869	900MR901	900MR569
Newport Breeze E150	RT235 or RT236	900MR800	900MR869	900MR901	900MR569
Puritan Bennett 840	RT235 or RT236	900MR800	900MR869	900MR901	900MR569
Sechrist IV100, IV200, Millenium	RT235 or RT236	900MR800	900MR869	900MR901	900MR569
Sensormedics 3100A HVFO	Refer to Sensormedics for recommended configuration				
Viasys Avea, Bear Cub 750 PSV	RT235 or RT236	900MR800	900MR869	900MR901	900MR569
Viasys Bird VIP	RT235 or RT236	900MR800	900MR869	900MR901	900MR569
<b>INFANT CPAP</b>					
Hamilton Arabella	RT132 or RT324	900MR801	900MR869	900MR901	900MR569
Viasys Infant Flow	RT132 or RT324	900MR801	900MR869	900MR901	900MR569
<b>INFANT OXYGEN THERAPY</b>					
Headbox/ Oxygen Hood	RT132 or RT324	900MR801	900MR869	900MR901	900MR569
Nasal Cannula	RT329	900MR801	900MR869	900MR901	900MR569

**RT202**

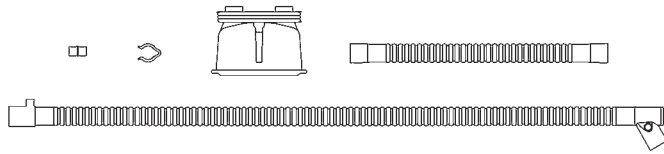

**Adult mask CPAP limb  
Inspiratory heated with autofeed chamber**

1.5m heated inspiratory limb  
0.5m humidifier connection tube  
MR290 humidification chamber  
Available in cartons of 10

**RT210**

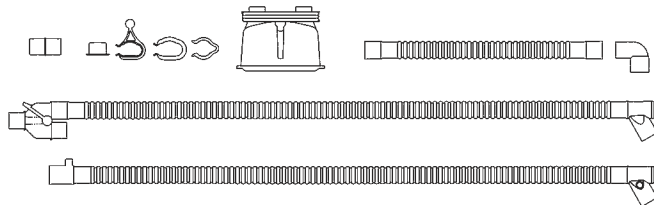

**Adult breathing circuit  
Dual heated with autofeed chamber**

1.5m heated inspiratory limb  
1.5m heated expiratory limb  
0.5m humidifier connection tube  
MR290 humidification chamber  
Available in cartons of 10

**RT211**

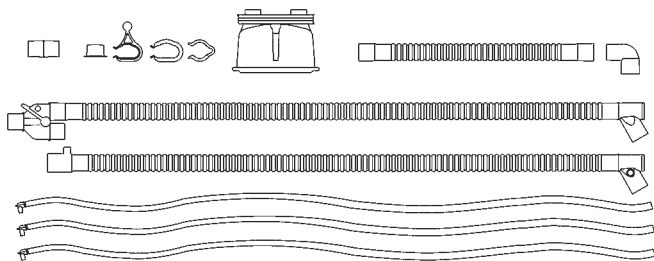

**Adult breathing circuit  
Dual heated with pressure line  
and autofeed chamber**

1.5m heated inspiratory limb  
1.5m heated expiratory limb  
2.0m pressure line 7/32", 1/8" & 1/4"  
0.5m humidifier connection tube  
MR290 humidification chamber  
Available in cartons of 10

**RT215**

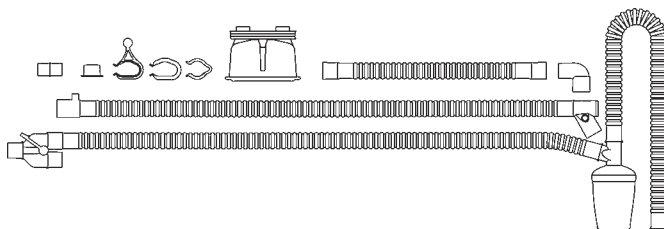

**Adult breathing circuit  
Inspiratory heated with autofeed chamber**

1.5m heated inspiratory limb  
2.0m unheated expiratory limb with water trap  
0.5m humidifier connection tube  
MR290 humidification chamber  
Available in cartons of 10

**RT219**

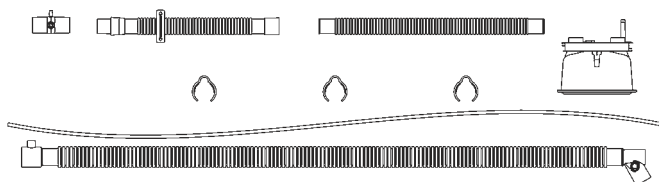

**Bi-level/CPAP circuit  
Inspiratory heated with pressure line and  
autofeed chamber**

1.5m heated inspiratory limb  
0.5m humidifier connection tube  
2.5m pressure line 1/8"  
RT022 unheated flexible extension  
MR290 humidification chamber  
Pressure/exhalation port  
Available in cartons of 10



**RT240**

EVAQUA

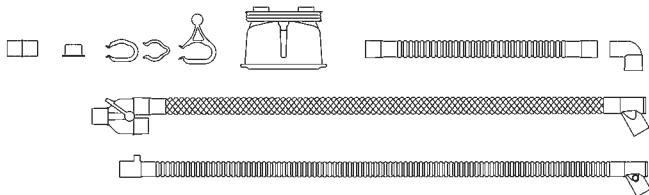

**Adult breathing circuit**  
**Dual heated with EVAQUA® expiratory limb**  
**and autofeed chamber**

1.5m heated inspiratory limb  
 1.8m heated EVAQUA® expiratory limb  
 0.5m humidifier connection tube  
 MR290 humidification chamber  
 Available in cartons of 10

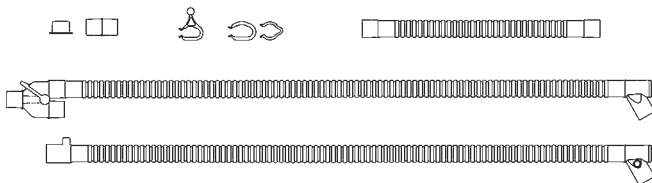
**RT110**

**Adult breathing circuit**  
**Dual heated**

1.5m heated inspiratory limb  
 1.5m heated expiratory limb  
 0.5m humidifier connection tube  
 Available in cartons of 10

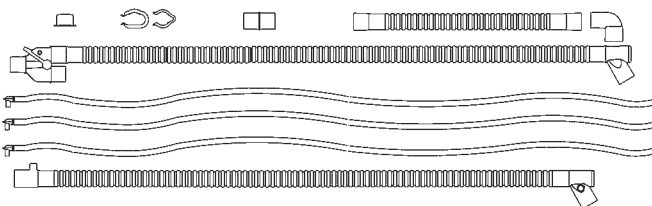
**RT111**

**Adult breathing circuit**  
**Dual heated with pressure line**

1.5m heated inspiratory limb  
 1.5m heated expiratory limb  
 2.0m pressure line 7/32\", 1/8\" & 1/4\"  
 0.5m humidifier connection tube  
 Available in cartons of 10

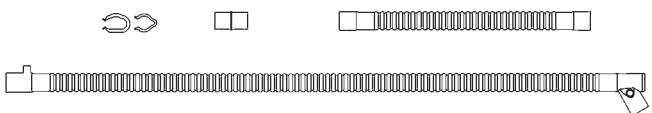
**RT114**

**Adult breathing circuit**  
**Inspiratory heated**

1.5m heated inspiratory limb  
 0.5m humidifier connection tube  
 MR290 humidification chamber  
 Available in cartons of 10

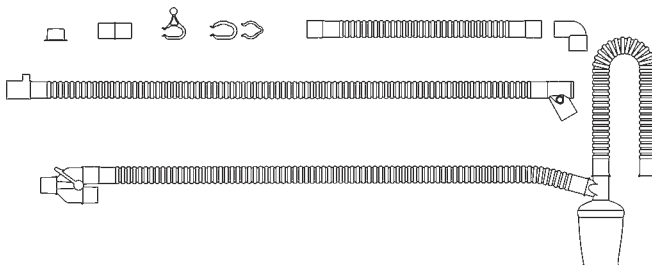
**RT115**

**Adult breathing circuit**  
**Inspiratory heated**

1.5m heated inspiratory limb  
 2.0m unheated expiratory limb with water trap  
 0.5m humidifier connection tube  
 Available in cartons of 10

**RT134**

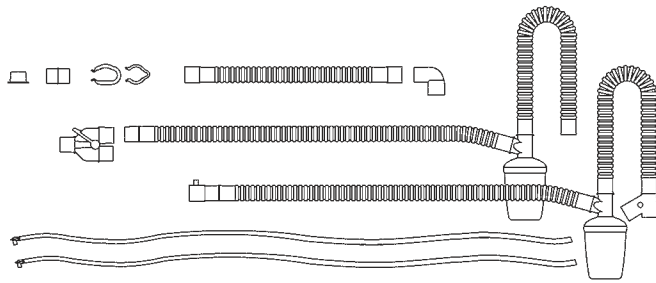

**Adult breathing circuit  
Nonheated**

1.5m unheated inspiratory limb with water trap  
1.5m unheated expiratory limb with water trap  
0.5m humidifier connection tube  
2.0m pressure line 7/32" & 1/8"  
Available in cartons of 10

**RT137**

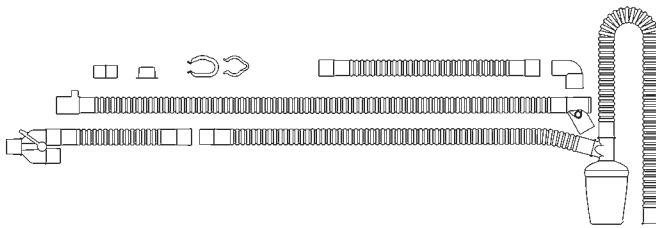

**Adult breathing circuit  
Inspiratory heated**

1.5m heated inspiratory limb  
2m unheated expiratory limb with water trap  
0.5m humidifier connection tube  
Available in cartons of 10

*Oxygen Therapy Kits*

**RT407**

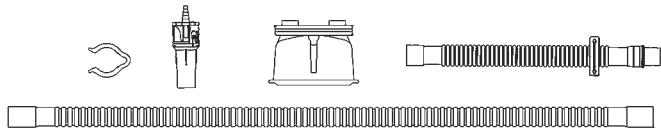

**Oxyflo™ oxygen therapy kit  
Nonheated limb**

1.5m non heated inspiratory limb  
RT008 Air Entrainer  
RT022 unheated extension  
MR290 humidification chamber  
Available in cartons of 10

**RT408**

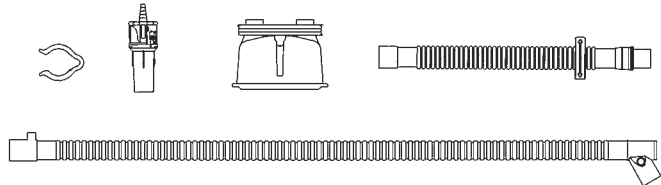

**Oxyflo™ oxygen therapy kit  
Heated limb**

1.5m heated inspiratory limb  
RT008 Air Entrainer  
RT022 unheated extension  
MR290 humidification chamber  
Available in cartons of 10

**RT235**

EVAQUA

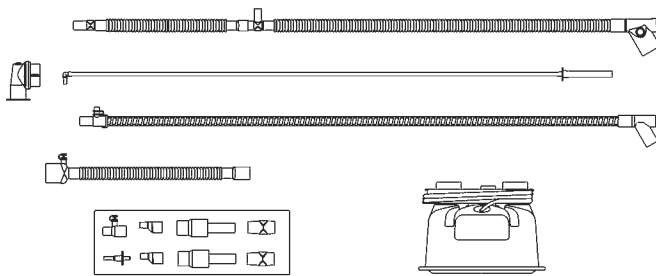
**Infant breathing circuit  
Dual heated with EVAQUA® expiratory limb**
**Flows  $\geq 4$  L/min**

1.1m heated inspiratory limb  
EVAQUA® heated expiratory limb  
0.3m incubator extension  
0.6m humidifier connection tube  
Pressure line and adapter kit  
MR290 humidification chamber  
Available in cartons of 10

**RT236**

EVAQUA

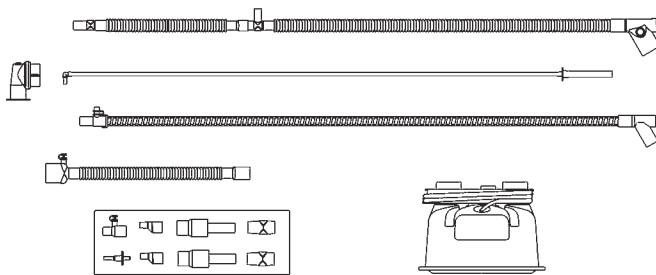
**Infant breathing circuit  
Dual heated with EVAQUA® expiratory limb**
**Flows  $< 4$  L/min**

For use with MR850 only  
1.1m heated inspiratory limb  
EVAQUA® heated expiratory limb  
0.3m incubator extension  
0.6m humidifier connection tube  
Pressure line and adapter kit  
MR290 humidification chamber  
Available in cartons of 10

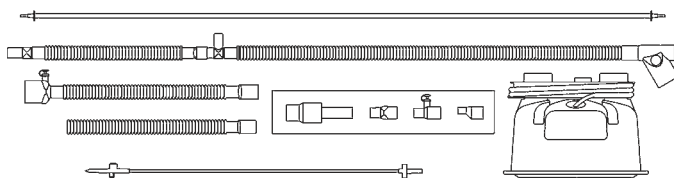
**RT324**
**Infant continuous flow breathing circuit kit**
**Flows  $\geq 4$  L/min**

1.1m heated inspiratory limb  
0.3m incubator extension  
0.5m expiratory extension for flowdriver interface  
0.6m humidifier connection tube  
Pressure line and adapter kit  
MR290 humidification chamber  
900MR191 chamber feed extension  
Available in cartons of 10

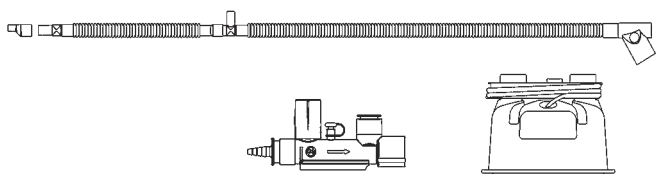
**RT329**
**Infant continuous flow breathing circuit kit**
**Flows  $< 4$  L/min**

For use with MR850 only  
1.1m heated inspiratory limb  
0.3m incubator extension  
Pressure relief valve  
MR290 humidification chamber  
Available in cartons of 10

## RT130

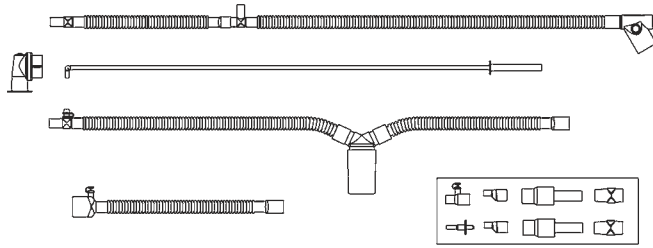

### Infant single heated breathing circuit

**Flows < 4 L/min**

- For use with MR850 only
- 1.1m heated inspiratory limb
- 0.3m incubator extension
- Unheated expiratory limb with water trap
- 0.6m humidifier connection tube
- Pressure line and adapter kit
- Available in cartons of 10

## RT131

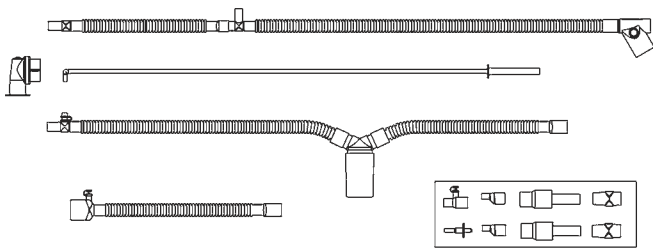

### Infant single heated breathing circuit

**Flows ≥ 4 L/min**

- 1.1m heated inspiratory limb
- 0.3m incubator extension
- Unheated expiratory limb with water trap
- 0.6m humidifier connection tube
- Pressure line and adapter kit
- Available in cartons of 10

## RT132

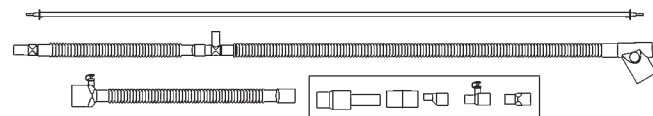

### Infant continuous flow breathing circuit

**Flows ≥ 4 L/min**

- 1.1m heated inspiratory limb
- 0.6m humidifier connection tube
- 0.3m incubator extension
- Pressure line and adapter kit
- Available in cartons of 10

Single Use Products

## Pediatric Circuit Application

The infant and adult circuit range provides optimal ventilation and humidity delivery for neonates through to adults. The optimum point to change from the infant to the adult circuit is 120ml  $V_T$  between about 12-15kg depending on your ventilation strategy.

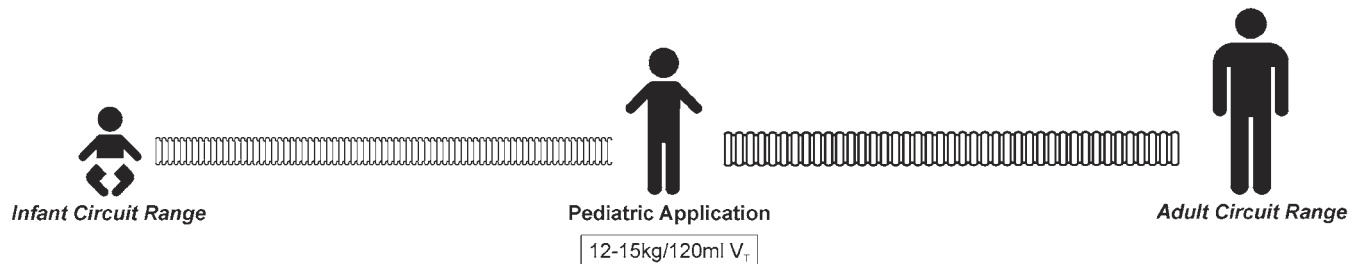

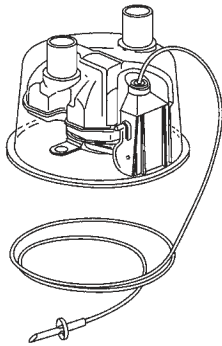
**MR290****Autofeed adult/ infant humidification chamber**

Inlet Port 22mm M  
 Outlet Port 22mm M  
 Available in cartons of 10 or 40 (for water bags or rigid water containers):  
 MR290UX Box of 10  
 MR290U Box of 40  
 MR290UV Box of 40 - vented

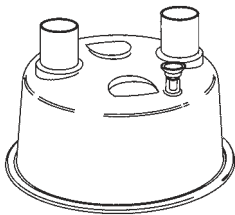
**MR250****Adult humidification chamber**

Inlet Port 22mm M  
 Outlet Port 22mm M  
 MR250X Box of 10  
 MR250 Box of 40

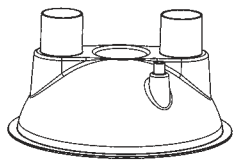
**MR225****Infant/pediatric humidification chamber**

Inlet Port 22mm M  
 Outlet Port 22mm M  
 MR225X Box of 10  
 MR225 Box of 50

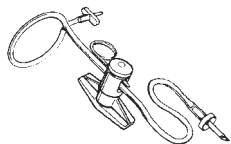
*Waterfeed Sets***900MR190****Waterfeed set for MR225/MR250**

Used to connect a waterbag to MR225/MR250 humidification chambers for refilling  
 Includes a self close clamp  
 900mm (35")  
 Available in packs of 30

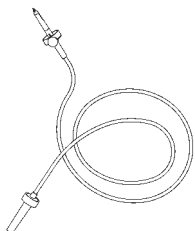
**900MR191X****Waterfeed extension set for MR290**

To extend the MR290 waterbag feed set for use with Infant CPAP Drivers. Used in conjunction with the 900MR292 telescopic waterbag pole.  
 600mm (24")  
 Available in packs of 10

**900MR161**

**Oxygen/air adapter**

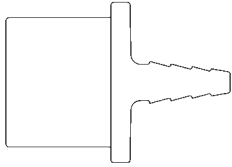

22mm F  
 Used to connect oxygen/air tubing to the humidification chamber  
 Available as single item, 50, 100  
 900MR161L = 50  
 900MR161C = 100

**900MR162**

**Oxygen/air adapter**

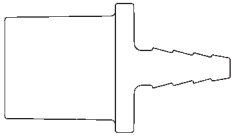

22mm M / 15mm F  
 Used to connect oxygen/air tubing to the humidification chamber  
 Available as single item, 50  
 900MR162L = 50

**RT008**

**Air entrainer**

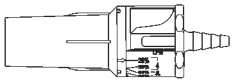

Designed to deliver oxygen concentrations between 28-90% from a 15 Lpm oxygen source  
 22mm Female (for MR225, 250 & 290 chambers)  
 Available in packs of 20

**RT010**

**Infant inline nebulizer adapter kit**

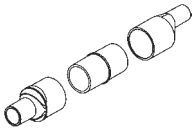

To fit infant 12mm circuits to many 22mm inline nebulizers  
 Available in cartons of 20

**RT020**

**End expiratory filter**

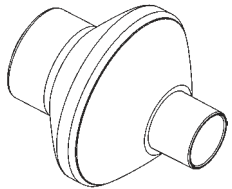

22mm M/ 22mm F  
 Doubled walled expiratory filter to protect ventilators from nebulizer waste and other contaminants, while minimizing condensate  
 Available in cartons of 20

**RT021**

**Catheter mount**

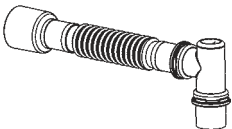

22mm F/ 15mm F patient end connection  
 Double swivel 90° elbow  
 Suction port  
 Flexible 15mm diameter catheter tube  
 Available in cartons of 20

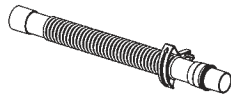
**RT022****Flexible extension**

22mm M/ 22mm F  
 Free swivelling 22 mm Male connection  
 0.3 m unheated limb  
 Clip for attaching product to clothing or bedding  
 Available in cartons of 20

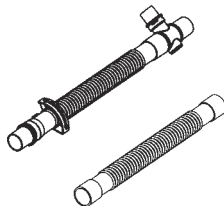
**RT023****T-piece weaning kit**

22mm M /22mm F /15mm F  
 T-Piece with suction port  
 15 mm F swivelling patient end connection  
 Free swivelling 22 mm Male connection  
 0.3 m Unheated inspiratory limb  
 0.3 m Unheated expiratory limb  
 Clip for attaching product to clothing or bedding  
 Available in cartons of 20

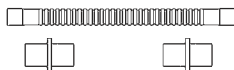
**RT024****Dry line extension kit**

0.5m humidifier connection tube  
 2 x 22mm M / 22mm M connectors  
 Available in cartons of 20

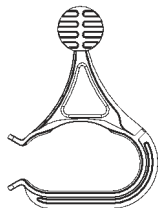
**RT028****Circuit hanger**

To fit adult 22mm circuits  
 Available in cartons of 20

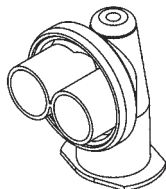
**RT029****Infant swivel Y-piece**

To fit infant 12mm circuits  
 Available in cartons of 20

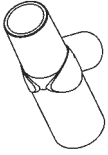
**RT030****Infant sidestream nebulizer adapter kit**

To fit infant 12mm circuits to Airlife Misty-Neb nebulizer  
Available in cartons of 20

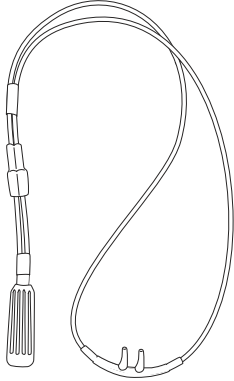
**RT091-RT095****Nasal Cannula**

Over the ear style nasal cannula. Designed to maximize humidity delivery for infants on oxygen therapy. For use with the RT329 low flow oxygen therapy kit.  
Available in cartons of 20

**Item Code****Size**

RT091	Premature; Less than term infants
RT092	Neonatal; More than 1400g
RT093	Infant; Newborn, full term
RT094	Pediatric; 1 year or older





**Reusable Products**

Circuit & Chamber Application Guide .....26  
Adult Breathing Circuits .....27  
Infant Breathing Circuits .....28  
Unheated Breathing Circuits .....29  
Humidification Chambers .....30  
Circuit Tubing .....31  
Heater Wires - Adult/Pediatric .....32  
Heater Wires - Infant .....32  
Heater Wires - Dual .....33  
Components .....33

# 26 Reusable Circuit & Chamber Application Guide

Application	Autoclavable Breathing Circuit	Non-Autoclavable Breathing Circuit	Humidification Chamber	MR850 Heater Wire Adapter	MR850 Temperature Probe	MR730 Heater Wire Adapter	MR730 Temperature Probe
<b>ADULT VENTILATION</b>							
Dräger Evita 1, 2, Dura, Evita 4, Evita XL, Savina	900MR761	900MR762	MR370	900MR858 or 900MR801	900MR869	900MR558 or 900MR901	900MR569
GE Engstrom Carestation	900MR761	900MR762	MR370	900MR858 or 900MR801	900MR869	900MR558 or 900MR901	900MR569
eVent Inspiration	900MR761	900MR762	MR370	900MR858 or 900MR801	900MR869	900MR558 or 900MR901	900MR569
Hamilton Amadeus, Galileo, Raphael, Veola	900MR761	900MR762	MR370	900MR858 or 900MR801	900MR869	900MR558 or 900MR901	900MR569
Infrasonics Adult Star 2000	900MR761 & 900MR753	900MR762 & 900MR753	MR370	900MR858 or 900MR801	900MR869	900MR558 or 900MR901	900MR569
Maquet 300A, 900C, Servo <sup>l</sup>	900MR761	900MR762	MR370	900MR858 or 900MR801	900MR869	900MR558 or 900MR901	900MR569
Newport Breeze E150, E100m, Wave E200 ,e500	900MR761	900MR762	MR370	900MR858 or 900MR801	900MR869	900MR558 or 900MR901	900MR569
Newport Breeze HT50	900MR742	900HC505	MR730	900MR858 or 900MR801	900MR869	900MR558 or 900MR901	900MR569
Puritan Bennett 740, 760, 840, 7200	900MR761	900MR762	MR370	900MR858 or 900MR801	900MR869	900MR558 or 900MR901	900MR569
Purtian Bennett MA1, MA2	900MR761 & 900MR753	900MR762 & 900MR753	MR370	900MR858 or 900MR801	900MR869	900MR558 or 900MR901	900MR569
Pulmonetics LTV	Refer to Pulmonetics for recommended configuration						
Respironics Esprit	900MR761	900MR762	MR370	900MR858 or 900MR801	900MR869	900MR558 or 900MR901	900MR569
Sensormedics 3100B	Refer to Sensormedics for recommended configuration						
Versamed iVent	900MR761	900MR762	MR370	900MR858 or 900MR801	900MR869	900MR558 or 900MR901	900MR569
Viasys Avea	900MR761	900MR762	MR370	900MR858 or 900MR801	900MR869	900MR558 or 900MR901	900MR569
Viasys Bear 1, 2, 5, 1000	900MR761 & 900MR753	900MR762 & 900MR753	MR370	900MR858 or 900MR801	900MR869	900MR558 or 900MR901	900MR569
Viasys Bird 8400	900MR761	900MR762	MR370	900MR858 or 900MR801	900MR869	900MR558 or 900MR901	900MR569
Viasys T-Bird, Legacy, Vela	900MR761	900MR762	MR370	900MR858 or 900MR801	900MR869	900MR558 or 900MR901	900MR569
<b>ADULT &amp; PEDIATRIC CPAP/NPPV</b>							
Dräger CPAP CF800	900MR742	900HC505 or 900HC506	MR370	900MR858 or 900MR801	900MR869 or 900MR861	900MR558 or 900MR901	900MR569 or 900MR561
Medicaid Whisperflow	900MR742	900HC505 or 900HC506	MR370	900MR858 or 900MR801	900MR869 or 900MR861	900MR558 or 900MR901	900MR569 or 900MR561
Respironics BiPAP S/T-D30	Not Applicable	900HC505 or 900HC506	MR370	900MR858 or 900MR801	900MR869 or 900MR861	900MR558 or 900MR901	900MR569 or 900MR561
Respironics Vision	Not Applicable	900HC505 or 900HC506	MR370	900MR858 or 900MR801	900MR869 or 900MR861	900MR558 or 900MR901	900MR569 or 900MR561
Wall Source	900MR742	900HC505 or 900HC506	MR370	900MR858 or 900MR801	900MR869 or 900MR861	900MR558 or 900MR901	900MR569 or 900MR561
Viasys Bird Blender	900MR742	900HC505 or 900HC506	MR370	900MR858 or 900MR801	900MR869 or 900MR861	900MR558 or 900MR901	900MR569 or 900MR561
Vital Signs - Vital Flow	900MR742	900HC505 or 900HC506	MR370	900MR858 or 900MR801	900MR869 or 900MR861	900MR558 or 900MR901	900MR569 or 900MR561
<b>OXYGEN THERAPY</b>							
Tracheostomy	900MR742	900HC505 or 900HC506	MR370	900MR858 or 900MR801	900MR869 or 900MR861	900MR558 or 900MR901	900MR569 or 900MR561
Face Mask	900MR742	900HC505 or 900HC506	MR370	900MR858 or 900MR801	900MR869 or 900MR861	900MR558 or 900MR901	900MR569 or 900MR561
<b>INFANT VENTILATION</b>							
Dräger Babylog 8000	900MR780 or 900MR781	Not Applicable	MR370	900MR858	900MR869	900MR558	900MR569
Infrasonics Infant Star 500, 950	900MR780 or 900MR781	Not Applicable	MR370	900MR858	900MR869	900MR558	900MR569
Maquet 300A, 900C, Servo <sup>l</sup>	900MR781	Not Applicable	MR370	900MR858	900MR869	900MR558	900MR569
Newport Breeze E150	900MR780 or 900MR781	Not Applicable	MR370	900MR858	900MR869	900MR558	900MR569
Sechrist Millenium, V100, IV200	900MR780 or 900MR781	Not Applicable	MR370	900MR858	900MR869	900MR558	900MR569
Sensormedics 3100A HVF0	Refer to Sensormedics for recommended configuration						
Viasys Avea, Bear Cub 750 PSV, Bird VIP	900MR780 or 900MR781	Not Applicable	MR340	900MR858	900MR869	900MR558	900MR569
<b>INFANT CPAP</b>							
Hamilton Arabella	Refer to Single Use Option	Not Applicable	MR340	Not Applicable	900MR869	900MR558	900MR569
Viasys Infant Flow	900MR743 & 900MR533	Not Applicable	MR340	900MR858	900MR869	900MR558	900MR569
<b>INFANT OXYGEN THERAPY</b>							
Headbox/ Oxygen Hood	900MR743	Not Applicable	MR340	900MR858	900MR869	900MR558	900MR569

**850 900MR761**

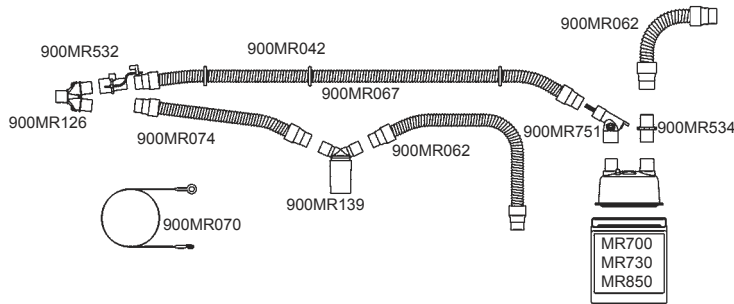

**Adult breathing circuit kit**

- 1.5m heated inspiratory limb
- 1.7m unheated expiratory limb with water trap
- 0.6m humidifier connection tube

**850 900MR762**

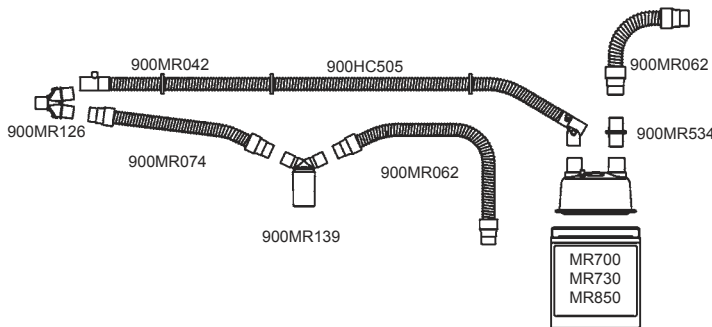

**Adult heated wall breathing circuit kit**

- Pasteurisable only
- 1.5m heated inspiratory limb
- 1.7m unheated expiratory limb with water trap
- 0.6m humidifier connection tube

**900MR742**

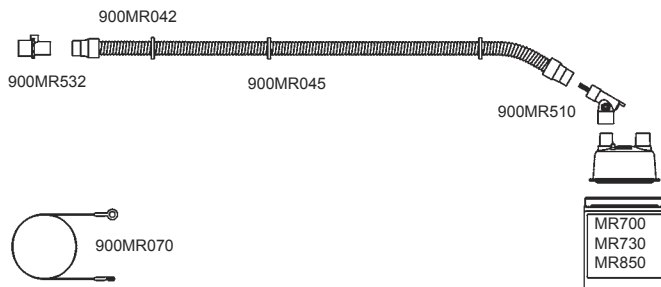

**Adult breathing circuit kit**

- Inspiratory heated
- 1.30m (52") in length

**850** **900MR780**

**Infant single heated flow breathing circuit kit**

*Flows ≥ 4 L/min*  
 1.1 Inspiratory heated limb  
 1.4m (55") in length

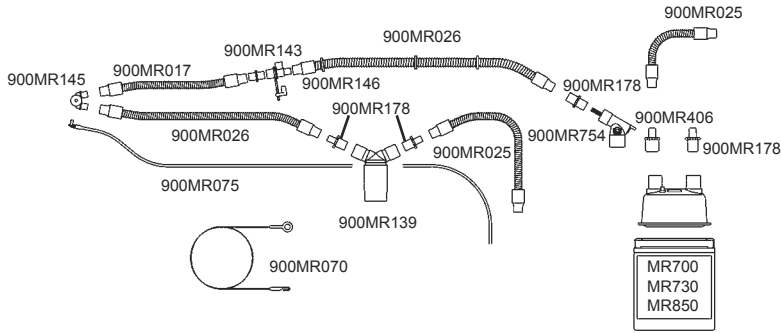

**850** **900MR781**

**Infant single heated breathing circuit kit**

*Flows < 4 L/min*  
 1.1m Inspiratory heated limb  
 1.4m (55") in length

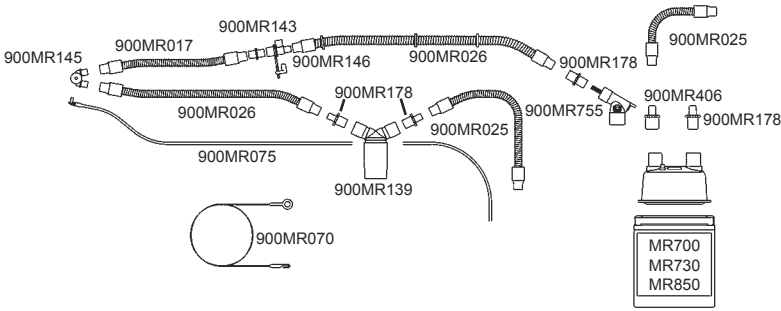

**900MR743**

**Infant continuous flow breathing circuit kit**

*Flows ≥ 5 L/min*  
 Inspiratory heated  
 1.30m (52") in length

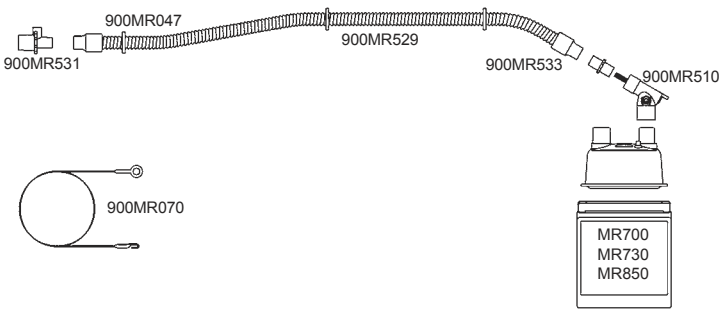

## 900MR422

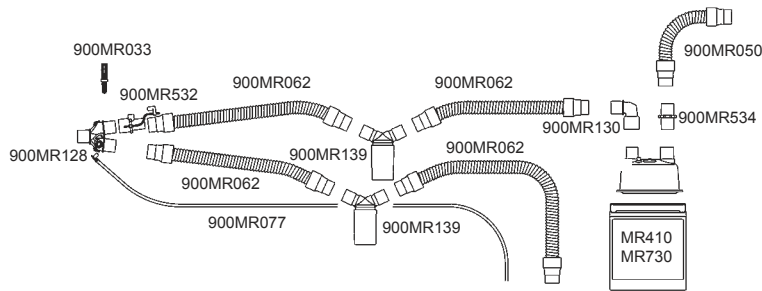

### Adult breathing circuit kit

Non heated  
1.2m (48") in length

## 900MR412

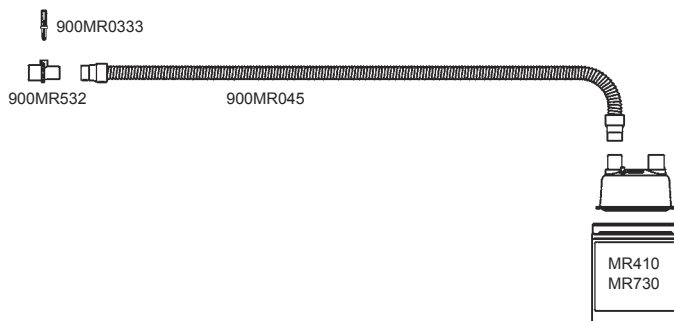

### Adult breathing circuit kit

Non heated  
1.3m (52") in length

## 900MR033

### Airway thermometer

For measuring gas temperature when used in conjunction with the MR410 humidifier

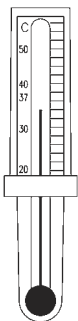

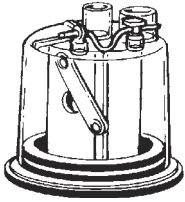
**MR370****Adult humidification chamber**

Inlet Port	22mm F
Outlet Port	22mm M

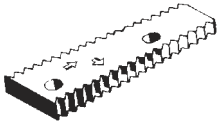
**900MR066****Absorbent paper refill pack**

For use with MR370 humidification chamber  
Each pack contains 100 sheets

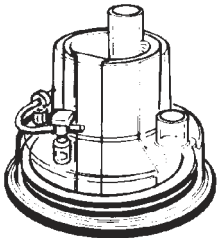
**MR340E****Infant humidification chamber**

Inlet Port	15mm F
Outlet Port	22mm M

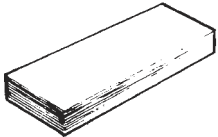
**900MR065****Absorbent paper refill pack**

For use with MR340 Humidification chamber  
Each pack contains 100 sheets

## HEATED WALL TUBING

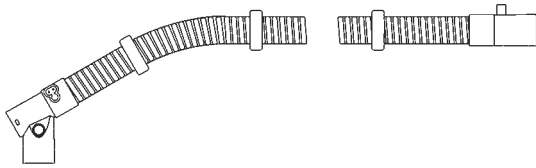

Internal diameter:	17mm
Plastic Cuffs:	22mm
<u>Part No.</u>	<u>Length</u>
900HC505	1.5m (60")
900HC506	1.8m (72")

## ADULT TUBING



All tubes are lightweight smooth internal wall Hytrel tubing

Internal diameter:	19mm
Silicone Cuffs:	22mm
<u>Part No.</u>	<u>Length</u>
900MR050	0.3m (12")
900MR062	0.6m (24")
900MR074	1.1m (44")
900MR045	1.3m (52")
900MR067	1.5m (60")
900MR068	1.8m (72")
900MR051	1.9m (74")
900MR061	2.4m (96")

## INFANT TUBING



Internal diameter:	12mm
Silicone Cuffs:	15mm
<u>Part No.</u>	<u>Length</u>
900MR591	0.3m (12")
900MR592	0.5m (18")
900MR593	0.7m (28")
900MR594	0.8m (30")
900MR595	1.3m (52")
900MR596	1.5m (60")

Internal diameter:	10mm
Silicone Cuffs:	10mm
<u>Part No.</u>	<u>Length</u>
900MR017	0.3m (12")
900MR025	0.7m (28")
900MR026	1.1m (43")
900MR072	0.5m (18")
900MR024	0.6m (24")
500RD103	1.2m (48")

## PEDIATRIC TUBING



Internal diameter:	15mm
Silicone Cuffs:	15mm
<u>Part No.</u>	<u>Length</u>
900MR528	0.3m (12")
900MR526	0.5m (18")
900MR540	0.7m (28")
900MR529	1.3m (52")





**900MR751**

### Heater wire

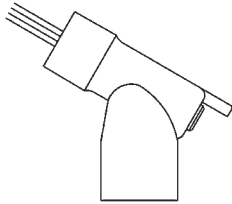

Heater wire assembly  
Use with reusable circuit tubing approximately 1.5m (60") in length  
Compatible with MR850 and MR730 humidifiers  
Lemo™ connection  
Available as single item



**900MR510**

### Heater wire

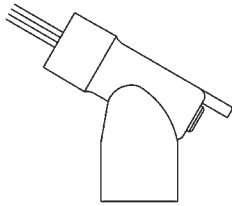

Heater wire assembly  
Use with reusable circuit tubing approximately 1.3m (52") in length  
Lemo™ connection  
Compatible with MR850 & MR730 humidifiers  
Available as single item

## Reusable Heater Wires - Infant

---



**900MR754**

### Heater wire

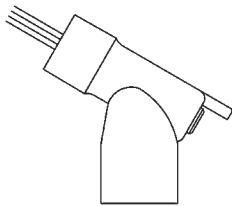

Flows  $\geq$  4L/min  
Use with reusable circuit tubing approximately 1.1m (43") in length  
Compatible with MR850 & MR700 humidifiers  
Available as single item



**900MR755**

### Heater wire

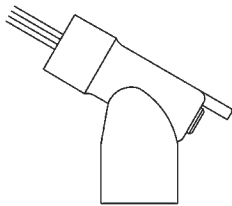

Flows  $<$  4L/min  
Use with reusable circuit tubing approximately 1.1m (43") in length  
Compatible with MR850 & MR700 humidifiers  
Available as single item

**900MR524**

### Heater wire

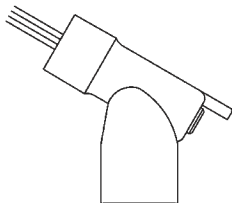

For high frequency ventilation  
Use with reusable circuit tubing approximately 0.8m (30") in length  
Compatible with MR700 humidifiers  
Available as single item

**900MR518**  
**900MR519**

## Dual Heater Wire

Insp: 900MR518      Exp: 900MR519

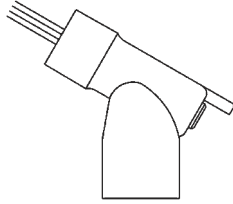

For use with delivery tubing 1.1m (44") in length  
Use each heater module in conjunction with the other  
Available as single item

*Caution: May only be used with humidifiers that state a heater wire capacity of 45W or greater on label*  
For use with MR700 Series

**900MR521**  
**900MR522**

## Dual Heater Wire

Insp: 900MR521      Exp: 900MR522

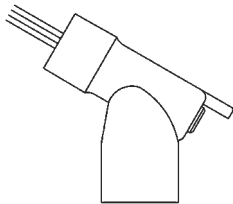

For use with delivery tubing 1.5m (60") in length  
Use each heater module in conjunction with the other  
Available as single item

*Caution: May only be used with humidifiers that state a heater wire capacity of 45W or greater on label*  
For use with MR700 Series

## Reusable Components

**900MR130**

### Elbow adapter

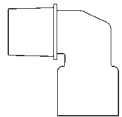

22mm F to 22mm M / 15mm F  
Available as single item, 50, 100  
900MR130L = 50  
900MR130C = 100

**900MR131**

### Elbow adapter with temperature port

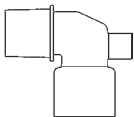

22mm F to 22mm M / 15mm F  
Available as single item, 100  
900MR131C = 100

**900MR143**

### Adapter

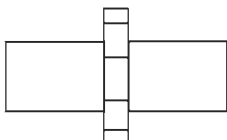

10mm M to 10mm M  
Available in packs of 10

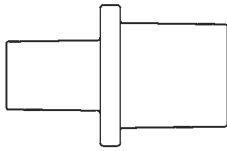
**900MR148****Adapter**

10mm M to 15mm M/ 10mm F  
Available as single item

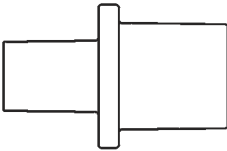
**900MR157****Adapter**

10mm M to 15mm M/ 11mm F  
Designed for use with Dräger circuits  
Available as single item

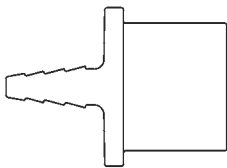
**900MR158****Adapter**

22 mm F  
Used to connect oxygen/air tubing to the humidification chamber  
Available as single item

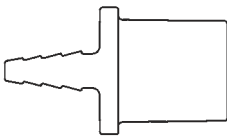
**900MR159****Adapter**

22 mm M/ 15mm F  
Used to connect oxygen/air tubing to the humidification chamber  
Available as single item

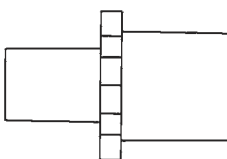
**900MR178****Adapter**

12 mm M to 15mm M/ 10mm F  
Available as single item

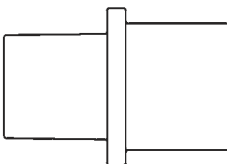
**900MR530****Adapter**

22 mm F to 22mm M/ 15mm F  
Available in as single item, 50  
900MR530L = 50

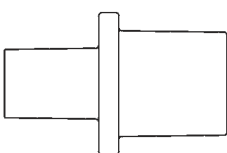
**900MR533****Adapter**

15mm M/ 10mm F to 15mm M/ 10mm F  
Available as single item, 50, 100  
900MR533L = 50  
900MR533C = 100

**900MR534**

**Adapter**

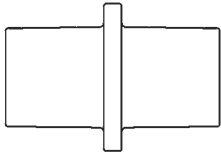

22mm M / 15mm F to 22mm M / 15mm F  
 Available as single item, 50, 100  
 900MR534L = 50  
 900MR534C = 100

**900MR535**

**Adapter**

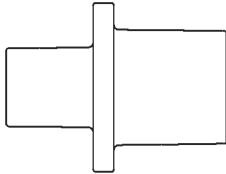

22mm M/ 15mm F to 15mm M/ 10 mm F  
 Available as single item

**900MR405**

**Adapter**

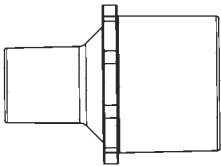

22mm F to 15mm M  
 Available as single item

**900MR406**

**Adapter**

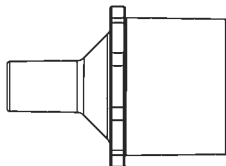

22mm F to 10mm M  
 Available as single item

**900MR139**

**Water trap**

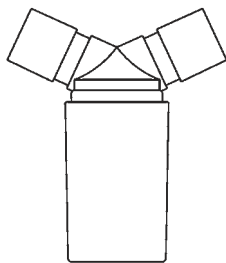

2 x 22mm M/ 15mm F ports  
 Spring load valve maintains circuit seal when emptying the water trap  
 Available as single item, 100  
 900MR139C = 100

**900MR146**

**Temperature probe housing**

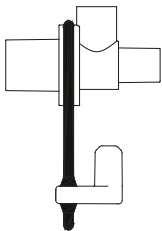

10mm M to 15mm M/ 10mm F  
 Available as single item, 100  
 900MR146C = 100

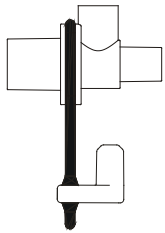
**900MR156****Temperature probe housing - Dräger**

11mm M to 11mm M  
Available as single item

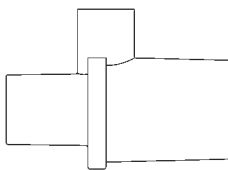
**900MR531****Temperature probe housing**

15 mm M to 22mm M/ 15mm F for use with pediatric Y pieces  
Available as single item, 50, 100  
900MR531L = 50  
900MR531C = 100

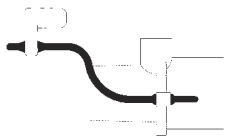
**900MR532****Temperature probe housing**

22mm F to 22mm M/ 15mm F for use with adult Y-piece  
Available as single item, 50, 100  
900MR532L = 50  
900MR532C = 100

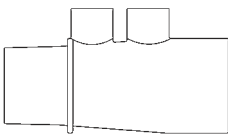
**900MR536****Probe and thermometer housing**

22mm F to 22mm M/ 15mm F  
Available as single item

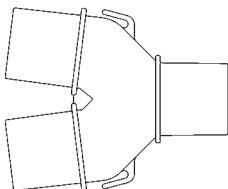
**900MR126****Adult Y-Piece**

No Ports  
Circuit connections - 22mm M  
Patient connection - 22mm M/ 15mm F  
Available as single item, 50, 100  
900MR126L = 50  
900MR126C = 100

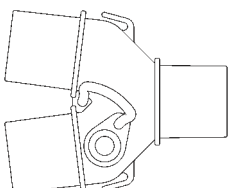
**900MR128****Adult Y-Piece**

Pressure Port  
Circuit connections - 22mm M  
Patient connection - 22mm M/ 15mm F  
Includes 900MR052 and 900MR053 pressure elbows  
Available as single item, 100  
900MR128C = 100

**900MR136**

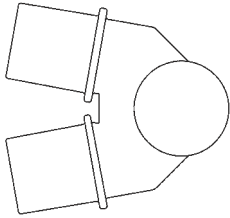

**Pediatric Y-Piece**

No Ports  
 Circuit connections - 15mm M  
 Patient connection - 15mm F  
 Available as single item

**900MR138**

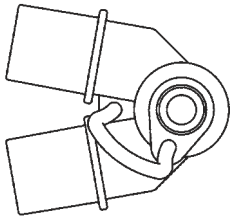

**Pediatric Y-Piece**

Pressure Port  
 Circuit connections - 15mm M  
 Patient connection - 15mm F  
 Includes 900MR052 and 900MR053 pressure elbows  
 Available as single item

**900MR145**

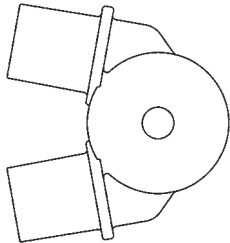

**Infant Y-Piece**

Pressure Port  
 Circuit connections - 10mm M  
 Patient connection - 15mm F  
 Includes 900MR147 pressure elbow and one 900MR144 luer port plug

**900MR147**

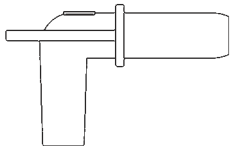

**Pressure monitoring elbow**

For use with reusable 900MR145 Y-piece  
 For use with pressure monitoring tubing of 3.3mm  
 (1/8") internal diameter  
 Available as single item

**900MR052**

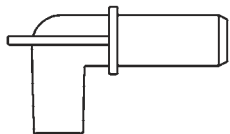

**Pressure monitoring elbow**

For use with reusable 900MR128 and 900MR138 Y-pieces  
 For use with pressure monitoring tubing of 4.8mm  
 (3/16") internal diameter  
 Available as single item, 100  
 900MR052C = 100

**900MR053**

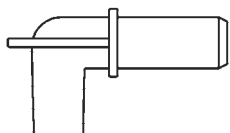

**Pressure monitoring elbow**

For use with reusable 900MR128 and 900MR138 Y-pieces  
 For use with pressure monitoring tubing of 6.4mm  
 (1/4") internal diameter  
 Available as single item, 100  
 900MR053C = 100

**900MR144**

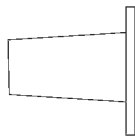

**Pressure port plug**

For use with reusable 900M145 Y-piece  
Available in packs of 10

**900MR124**



**Pressure port plug**

For use with reusable 900MR128 and 900MR138 Y-pieces  
Available as single item

**900MR164**



**Temperature and pressure port plug**

For use with 900MR128 and 900MR138, and 900MR146, 900MR156, 900MR531 and 900MR532 adapters  
Available as single item

**900MR132**

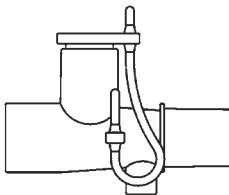

**Nebulizer T-piece with temperature port**

Tube connection: 22mm M  
Patient connection: 22mm F  
Nebulizer port: 22mm M / 18mm F  
Includes cap for nebulizer port  
Available as single item

**900MR753**

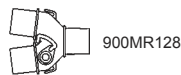

**Autoclavable pressure port kit**

- 2.0m pressure line 1/4"
- 2.0m pressure line 1/8"
- 2.0m pressure line 3/16"
- 900MR147 pressure monitoring elbow
- 900MR052 pressure monitoring elbow
- 900MR053 pressure monitoring elbow
- 900MR128 adult Y-piece with pressure port

**900MR075  
900MR076  
900MR077**

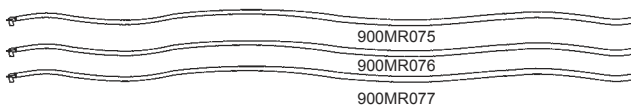

**Silicone pressure tubing**

Reusable silicone pressure tubing is available in three sizes. It is designed for use on ventilators that measure the patient airway pressure. Pressure tubing is used in conjunction with Fisher and Paykel Healthcare reusable pressure port elbows and Y-pieces

Part No.	Description:	Pressure port elbow:
900MR075	I.D. - 3.3mm (1/8") Length - 1.65m (66")	900MR147
900MR076	I.D. - 4.8mm (3/16") Length - 1.50m (60")	900MR052
900MR077	I.D. - 6.4mm (1/4") Length - 1.65m (66")	900MR053

**900MR042**

**Hose clip**

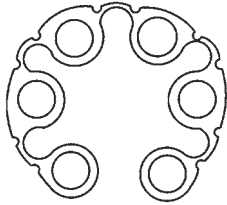

22mm

For use with 19mm and 22mm tubing

Used to hold the airway temperature probe or pressure tubing along the length of the delivery hose

Available as single item, 50

900MR042L = 50

**900MR047**

**Hose clip**

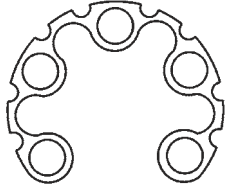

15mm

For use with 15mm tubing

Used to hold the airway temperature probe or pressure tubing along the length of the delivery hose

Available as single item, 50

900MR047L = 50

**900MR049**

**Hose clip**

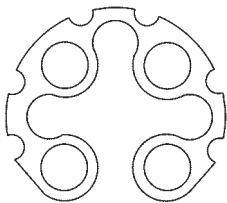

10mm

For use with 10mm and 12mm tubing

Used to hold the airway temperature probe or pressure tubing along the length of the delivery hose

Available as single item, 50

900MR049L = 50

**900MR070  
900MR071  
900MR171**

**Draw wire**

900MR070 1.5m (60")

900MR071 2.13m (85")

900MR171 0.75m (30")

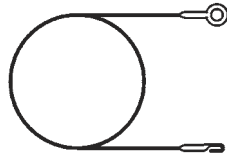

For use with reusable heater wire assemblies

Used to draw the heater wire into reusable tubing

Available as a single item





<i>Part Number</i>	<i>Page</i>	<i>Part Number</i>	<i>Page</i>	<i>Part Number</i>	<i>Page</i>	<i>Part Number</i>	<i>Page</i>
500RD103 .....	31	900MR131C ....	33	900MR530 .....	34	900MR888 .....	12
900HC031 .....	9	900MR132 .....	38	900MR530L .....	34	900MR900 .....	6
900HC032 .....	9	900MR136 .....	37	900MR531 .....	36	900MR901 .....	6
900HC033 .....	9	900MR138 .....	37	900MR531C ....	36	HC500 .....	3
900HC505 .....	31	900MR139 .....	35	900MR531L .....	36	MR225 .....	20
900HC506 .....	31	900MR139C ....	35	900MR532 .....	36	MR225X .....	20
900MR011 .....	10	900MR143 .....	33	900MR532C ....	36	MR250 .....	20
900MR012 .....	10	900MR144 .....	38	900MR532L .....	36	MR250X .....	20
900MR017 .....	31	900MR145 .....	37	900MR533 .....	34	MR290 .....	20
900MR024 .....	31	900MR146 .....	35	900MR533C ....	34	MR290U .....	20
900MR025 .....	31	900MR146C ....	35	900MR533L .....	34	MR290UV .....	20
900MR026 .....	31	900MR147 .....	37	900MR534 .....	35	MR290UX .....	20
900MR030 .....	7	900MR148 .....	34	900MR534C ....	35	MR340 .....	30
900MR033 .....	29	900MR156 .....	36	900MR534L .....	35	MR370 .....	30
900MR042 .....	39	900MR157 .....	34	900MR535 .....	35	MR410 .....	4
900MR042L .....	39	900MR158 .....	34	900MR536 .....	36	MR850 .....	3
900MR045 .....	31	900MR159 .....	34	900MR540 .....	31	RT008 .....	21
900MR047 .....	39	900MR161 .....	21	900MR554 .....	6	RT010 .....	21
900MR047L .....	39	900MR161C ....	21	900MR555 .....	6	RT020 .....	21
900MR049 .....	39	900MR161L .....	21	900MR556 .....	6	RT021 .....	21
900MR049L .....	39	900MR162 .....	21	900MR558 .....	6	RT022 .....	22
900MR050 .....	31	900MR162L .....	21	900MR559 .....	6	RT023 .....	22
900MR051 .....	31	900MR164 .....	38	900MR560 .....	5	RT024 .....	22
900MR052 .....	37	900MR167 .....	8	900MR561 .....	5	RT028 .....	22
900MR052C ....	37	900MR170 .....	8	900MR563 .....	5	RT029 .....	22
900MR053 .....	37	900MR171 .....	39	900MR568 .....	5	RT030 .....	23
900MR053C ....	37	900MR177 .....	12	900MR569 .....	5	RT091 .....	23
900MR061 .....	31	900MR178 .....	34	900MR571 .....	5	RT092 .....	23
900MR062 .....	31	900MR190 .....	20	900MR591 .....	31	RT093 .....	23
900MR065 .....	30	900MR191X ....	20	900MR592 .....	31	RT094 .....	23
900MR066 .....	30	900MR208 .....	5	900MR593 .....	31	RT095 .....	23
900MR067 .....	31	900MR290 .....	10	900MR594 .....	31	RT110 .....	16
900MR068 .....	31	900MR291 .....	10	900MR595 .....	31	RT111 .....	16
900MR070 .....	39	900MR292 .....	10	900MR596 .....	31	RT114 .....	16
900MR071 .....	39	900MR293 .....	11	900MR597 .....	12	RT115 .....	16
900MR072 .....	31	900MR294 .....	11	900MR598 .....	12	RT130 .....	19
900MR074 .....	31	900MR301 .....	8	900MR742 .....	27	RT131 .....	19
900MR075 .....	38	900MR302 .....	8	900MR743 .....	28	RT132 .....	19
900MR076 .....	38	900MR303 .....	8	900MR751 .....	32	RT134 .....	17
900MR077 .....	38	900MR304 .....	9	900MR753 .....	38	RT137 .....	17
900MR081 .....	7	900MR305 .....	9	900MR754 .....	32	RT202 .....	15
900MR082 .....	7	900MR306 .....	11	900MR755 .....	32	RT210 .....	15
900MR083 .....	7	900MR308 .....	11	900MR761 .....	27	RT211 .....	15
900MR086 .....	7	900MR405 .....	35	900MR762 .....	27	RT215 .....	15
900MR087 .....	7	900MR406 .....	35	900MR780 .....	28	RT219 .....	15
900MR088 .....	8	900MR412 .....	29	900MR781 .....	28	RT235 .....	18
900MR124 .....	38	900MR422 .....	29	900MR800 .....	5	RT236 .....	18
900MR126 .....	36	900MR510 .....	32	900MR801 .....	5	RT240 .....	16
900MR126C ....	36	900MR518 .....	33	900MR848 .....	12	RT324 .....	18
900MR126L .....	36	900MR519 .....	33	900MR858 .....	6	RT329 .....	18
900MR128 .....	36	900MR521 .....	33	900MR860 .....	5	RT407 .....	17
900MR128C ....	36	900MR522 .....	33	900MR861 .....	5	RT408 .....	17
900MR130 .....	33	900MR524 .....	32	900MR863 .....	5		
900MR130C ....	33	900MR526 .....	31	900MR868 .....	5		
900MR130L .....	33	900MR528 .....	31	900MR869 .....	5		
900MR131 .....	33	900MR529 .....	31	900MR870 .....	12		

