



FASTENER DIVISION

www.brauersupply.com

1-800-392-8776





Brauer Supply is the complete specialty fastener center serving Missouri, Illinois and Kansas. We represent only the finest quality established names in the industry.

Our twelve locations are conveniently located near your place of business with our fleet of modern delivery trucks ready to bring material directly to you from an extensive inventory of rivets, tools, threaded fasteners, inserts, screws and strut. Additionally, our application specialists are available for on-site visits to help you find solutions to your fastening problems.

Our state-of-the-art warehousing facility can meet your needs for “Just-In-Time” delivery. We provide the convenience of purchase order consolidation as well as repair services for pneumatic fastening tools. Our 130+ year history provides buying power with manufactures to insure that you receive competitive pricing and can obtain fasteners even in times of product shortage.

Brauer Supply is an acknowledged source for a wide range of industrial products in addition to fasteners. For a complete listing of lines we carry, visit www.brauersupply.com or call one of our product specialists.

We invite you to review the pages that follow to see how we can help your bottom line.

Give us a call at 314-534-7150 or 1-800-392-8776 to talk to your customer service specialist today.

We look forward to working with you!



Table of Contents

Pop Rivet Tools & Parts

Pop Hand Tools	7
Pop Power Tools	8
Tool Repair	12
Nosepieces	12
Tool Spare Parts	12

Rivets

Pop Brand (USA Made)	13
Trouble Shooting	37
Surebonder Brand (Imports)	38

Rivedrill & Lobster Tools

Rivedrill	47
Lobster Tools	47

Surebonder Tools & Parts

Surebonder Power Tools	48
Surebonder Hand Tools	49

Inserts

AVK Inserts	51
Sherex Inserts	55

Sherex Insert Tools & Parts

Sherex Insert Tools	65
---------------------	----

Self Drilling Screws

Brynolf (USA Made)	69
--------------------	----

Strut and Accessories

Rod	71
Strut	71
Accessories	72

St. Louis Pneumatic Tool

Tools	73
-------	----

Commodity Fasteners

74

Fastener Quote Form

75

Terms and Conditions

78

PRP-26A



Pop Hand Tool

A reliable tool, ideal for sheet metal and similar applications where power is not available. Sets rivets from 3/32" through 5/32" diameters. Furnished with standard nosepiece to set 1/8" rivets.



PS40

Pop Hand Tool

POPset PS40 Lever rivet tool.

- Robust, professional-standard steel construction.
- Long lever tool for optimum pulling force.
- Supplied with nosepieces for 1/8" (3.2mm), 5/32" (4.0mm), 3/16" (4.8mm), 6.0mm and 1/4" (6.4mm)
- Supplied with nosepiece wrench.
- Integral removable mandrel collector.



PS15-CS

Pop Hand Tools

PS15 Professional Hand Plier Rivet Tool. Portable and lightweight. Weight.60kg, Length 245mm.

- Setting capacity 4.8/5.0mm dia.
- Professional standard, robust cast aluminum and steel design.
- Contoured handle grips for comfort.
- Rivet-retaining handle, designed for one-handed riveting.
- Supplied with nosepieces for 2.4mm, 3.2mm, 4.0mm & 4.8mm dia rivets.
- Supplied with nosepiece wrench.
- Aluminum 4.8 mm.
- Steel 4.8 mm.
- Stainless Steel 4.8 mm



PS20

Pop Hand Tool

Proset PS20 Lazy tong rivet tool



- Robust, professional-standard aluminum and steel construction.
- Supplied with nosepieces for 1/8" (3.2mm), 5/32" (4.0mm), 3/16" (4.8mm), 6.0mm and 1/4" (6.4mm) rivets.
- Supplied with nosepiece wrench that doubles as a level lock.

PS25



Pop Hand Tool



POPset PS25 Heavy-duty lazy tong rivet tool.

- Robust, professional heavy-duty grade aluminum and steel construction.
- Supplied with nosepieces for 1/8" (3.2mm), 5/32" (4.0mm), 3/16" (4.8mm), 6.0mm, and 1/4" (6.4mm) rivets.

PS45

Pop hand tool

POPset PS45 lever rivet tool.



- Robust, professional-standard steel construction.
- Long lever tool for optimum pulling force.
- Supplied with nosepieces for 1/8" (3.2mm), 5/32" (4.0mm), 3/16" (4.8mm), 6.0mm, and 1/4" (6.4mm) rivets.
- Supplied with nosepiece wrench.
- Integral removable mandrel collector.

MFX 307

Hand Tool

MFX 307 Hand Rivet Tool



PRG 510A

Pop tool

This simple, effective pneumatic tool is small, lightweight and has a solid cast aluminum construction. An optional mandrel collection system version is also available. The PRG/MCS 511A offers an extended nose housing for extra reach and improved access.



PRG540

Pop tool

The heavy-duty pneumatic-hydraulic 540 is extremely strong and robust as a result of the solid cast construction. As such, it is unbeatable for efficient riveting on mass-production lines. It comes standard as a PRG version. An optional mandrel collection system version is also available.



ProSet 1600MCS

Pop Tool

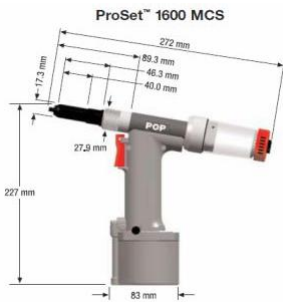

The Proset 1600 is the smallest and lightest of the Pop blind rivet tool family. The Proset 1600 is designed to facilitate blind rivet installation in applications with limited access. An optional mandrel collection system (MCS) version is available.

- Setting capacity 4.0 mm dia.
- Compact, lightweight and reliable pneumatic power tool.
- Ideal for production line environments.
- Polymer construction.
- Comfortable two finger, low activation force trigger.
- Quick disconnect front-end assembly.
- Energy saving On/Off, left or right swivel air fitting.
- Compatible with Pop rivet presenter.

ProSet 2500MCS

Pop tool

Among the new Proset family of pneumatic tool products is the ProSet 2500 designed to set a wide range of rivets. While incorporating the latest in ergonomic design, the patent pending front end with "quick disconnect" nose housing & jaw case requires no tools for removal. The ProSet 2501 offers a reduced nosehousing diameter for narrow access applications. This tool will set rivets from 1/8" - 3/16".

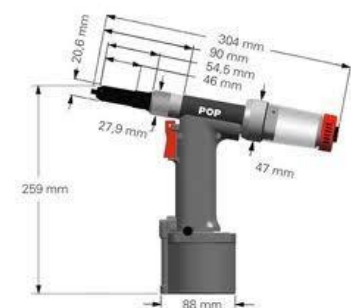

- Setting capacity 4.8 mm dia.
- Lightweight polymer construction.
- Comfortable two finger, low-activation force trigger.
- Quick disconnect front-end assembly.
- Energy saving On/Off, left or right swivel air fitting.
- Spring return for reliable fast setting cycle.
- Compatible with Pop rivet presenter.
- Air isolation during MCS removal.
- Available in deflector or MCS versions.

ProSet 3400MCS



Pop Tool

Offering a number of options to meet customer requirements, the 3400 family members are all capable of setting the entire range of Pop blind rivets. The 3400 features light trigger action, ease of handling and an air line attached at the tool centerline for less resistance to operator movement. The 3400 provides a stroke of 26 mm for setting longer and more specialized rivets.



- Strong, lightweight polymer construction
- Comfortable two-finger low-activation force trigger.
- Directional air exhaust
- On/Off, right or left swivel air fitting
- High force to weight ratio
- Quick disconnect nose housing, jaw case, mandrel collection system.
- Spring return for fast, reliable setting cycle.
- Extended 8" long front end for extra reach.
- Pop rivet presenter compatibility
- Pop remote mandrel collection system compatible.
- Pop specialty heads compatible
- Air-isolation switch during MCS removal

PRT/MCS 5250A

Pop Tool

The 5250A in-line riveter offers a range of features contributing to new standards in operator comfort and ease of movement. This style of setting tool accommodates the natural movements associated with vertical riveting operations at assembly benches or work stations. The 5251A offers a reduced nose housing diameter for limited access applications. The MCS model is equipped with a large capacity remote mandrel collection container MCS5000.



PB2500

Pop Tool

Ideal for site and maintenance work, the cordless 18v Li-Ion battery PB2500 also expands options on the production line allowing blind rivets to be installed at assembly stations where there is no convenient available air supply. Designed and constructed to withstand industrial conditions, the PB2500 is easy to use, well balanced and comfortable.



- High capacity, compact and lightweight, with lithium ion battery.
- Spent mandrels automatically drop into collector
- Award winning ergonomic design
- Capacity: 3/32 - 3/16" (2.4-4.8mm) diameter steel rivets
- Tool weight: 3.7 lbs. (1.69kg) - including battery
- Rivet golding mechanism
- 18v Li-ion battery charges in 30 minutes

PNT800A



Pop Insert Tool



Spin-pull tool for M3-M10 threaded Inserts. Compact lightweight pneumatic tool. Weight 1.68kg, length 288mm, height 263mm tool stroke 1.3-6.5mm, working air pressure 4.9-5.9 bar and air consumption approx. 6.5 litres/insert.

- Stroke adjustment mechanism.
- Can be used with counter-balance (clip ring provided).
- Quick-change mandrel and nosepieces.
- Swivel joint air connector.
- Supplied with M4 - M8 mandrels and nosepieces.
- M10 available on request.
- Aluminum M3-M10.
- Steel M3-M10.
- Stainless Steel M3-M8.

PNT800L-PC

Pop Insert Tool

Pneumatic control tool for M4-M10 threaded inserts. Pneumatic control automatically adjusts setting force. Weight 1.81mm, length 287mm, height 268mm, tool stroke 1.3-6.5mm, working air pressure 4.9-5.9 bar and air consumption approx 6.51 litres/insert.

- Automatic stroke adjustment suits various thicknesses within a grip range.
- Consistent setting achieved in varying application conditions.
- Fast cycle time with single trigger action for setting and spin-off.
- Quick-change mandrel and nosepiece design.
- Swivel joint air connector.
- Suspension ring supplied for use with counter balance.
- Eliminates potential application and nut damage due to double stroking.
- Supplied with M4-M8 mandrels and nosepieces.
- M10 available on request.
- Aluminum M6-M10.
- Steel M4-M10.
- Stainless Steel M4-M10.



PNT1000L-PC

Pneumatic control tool for M6-M12 threaded inserts. Pneumatic control automatically adjusts setting force. Weight 2.77kg, length 315mm, height 295mm, tool stroke 1.3-10.5 mm, working air pressure 4.9-5.9 bar and air consumption approx. 6.5 litres/insert.



- Automatic stroke adjustment suits various thicknesses within a grip range.
- Consistent setting achieved in varying application conditions.
- Fast cycle time with single trigger action for setting and spin-off.
- Quick-change mandrel and nosepiece design.
- Swivel joint air connector.
- Suspension ring supplied for use with counter balance.
- Eliminates potential application and nut damage due to double stroking.
- Supplied with M8-M10 mandrels and nosepieces.
- M12 available on request.
- Aluminum M6-M12.
- Steel M6-M12.
- Stainless Steel M6-M12.

Tool Repair



Pop

Brauer Supply repairs Pop tools in house by a specially trained tool repair specialist.

Nosepieces

Pop

Nosepiece for Pop Brand Rivet Tools



Part Number	Description
PRN314	Nosepiece for 3/32" open end rivets
PRN414	Nosepiece for 1/8" open end rivets
PRN424	Nosepiece for 1/8" alum/steel closed end rivets
PRN434	Nosepiece for 1/8" all aluminum closed end rivets
PRN514	Nosepiece for 5/32" open end rivets
PRN524	Nosepiece for 5/32" alum/steel closed end rivet
PRN534	Nosepiece for 5/32" all aluminum closed end rivets
PRN611	Nosepiece for 3/16" open end rivet - short shank
PRN614	Nosepiece for 3/16" open end rivets
PRN624	Nosepiece for 3/16" alum steel closed end rivets
PRN634	Nosepiece for 3/16" all aluminum closed end rivets
PRN811	Nosepiece for 1/4" open end rivets
PRN822	Nosepiece for 1/4" alum/steel closed end rivets
PRN625	Nosepiece for 3/16" T rivets
PRN825	Nosepiece for 1/4" T rivet
PRN826	Nosepiece for 1/4" T rivet recessed head
7497-3202	Nosepiece for 1/4" monobolts
7498-3001	Nosepiece for 3/16" monobolts



Spare Tool Parts

Brauer Supply Company has spare parts for many tools available to purchase. Please contact customer service for details.

5056 Aluminum/Steel Rivet - Domed Head



Pop Rivet

5056 Aluminum Rivets with Coated Carbon Steel Mandrel. Finish: Plain/Protective Coating

- Strong, low cost fastenings.
- Ideal for wide range of applications.
- Versatile for general fastening needs.
- Available in a range of sizes and materials.



Rivet Diameter	Rivet Body Length	Blind Side Protrusion	Grip Range	Rivet Part Number	Hole Size	Shear Strength	Tensile Strength
3/32	.225	.325	.031-.125	AD32BS	.097-.100	125	175
3/32	.350	.450	.126-.250	AD34BS	.097-.100	125	175
1/8	.188	.308	.032-.062	AD41BS	.129-.133	210	325
1/8	.250	.370	.063-.125	AD42BS	.129-.133	210	325
1/8	.313	.433	.126-.187	AD43BS	.129-.133	210	325
1/8	.375	.495	.188-.250	AD44BS	.129-.133	210	325
1/8	.438	.558	.251-.312	AD45BS	.129-.133	210	325
1/8	.500	.620	.313-.375	AD46BS	.129-.133	210	325
1/8	.625	.745	.376-.500	AD48BS	.129-.133	210	325
1/8	.750	.870	.501-.625	AD410BS	.129-.133	210	325
5/32	.275	.415	.063-.125	AD52BS	.160-.164	340	490
5/32	.338	.478	.126-.187	AD53BS	.160-.164	340	490
5/32	.400	.540	.188-.250	AD54BS	.160-.164	340	490
5/32	.525	.665	.251-.375	AD56BS	.160-.164	340	490
5/32	.650	.790	.376-.500	AD58BS	.160-.164	340	490
3/16	.300	.460	.063-.125	AD62BS	.192-.196	445	720
3/16	.425	.585	.126-.250	AD64BS	.192-.196	445	720
3/16	.550	.710	.251-.375	AD66BS	.192-.196	445	720
3/16	.675	.835	.376-.500	AD68BS	.192-.196	445	720
3/16	.800	.960	.501-.625	AD610BS	.192-.196	445	720
3/16	.925	1.085	.626-.750	AD612BS	.192-.196	445	720
3/16	1.05	1.210	.751-.875	AD614BS	.192-.196	445	720
3/16	1.175	1.335	.876-1.00	AD616BS	.192-.196	445	720
1/4	.475	.710	.063-.250	AD84BS	.257-.261	890	1200
1/4	.600	.835	.251-.375	AD86BS	.257-.261	890	1200
1/4	.725	.960	.376-.500	AD88BS	.257-.261	890	1200
1/4	.850	1.085	.501-.625	AD810BS	.257-.261	890	1200
1/4	.975	1.210	.626-.750	AD812BS	.257-.261	890	1200
1/4	1.225	1.460	.876-1.00	AD816BS	.257-.261	890	1200

5056 Aluminum/Steel Rivets - Large Flange

Pop Rivet

5056 Aluminum Rivets with Coated Steel Mandrel. Finish: Plain/Protective coating

- Strong, low cost fastenings.
- Ideal for wide range of applications.
- Versatile for general fastening needs.
- Available in a range of sizes and materials.



Rivet Diameter	Rivet Body Length	Blind Side Protrusion	Grip Range	Rivet Part Number	Hole Size	Shear Strength	Tensile Strength
1/8	.250	.370	.063-.125	AD42BSLF	.129-.133	210	325
1/8	.313	.433	.126-.187	AD43BSLF	.129-.133	210	325
1/8	.375	.495	.188-.250	AD44BSLF	.129-.133	210	325
1/8	.438	.558	.251-.312	AD45BSLF	.129-.133	210	325
5/32	.400	.540	.188-.250	AD54BSLF	.160-.164	340	490
3/16	.425	.585	.126-.250	AD64BSLF	.192-.196	445	720
3/16	.550	.710	.251-.375	AD66BSLF	.192-.196	445	720
3/16	.675	.835	.376-.500	AD68BSLF	.192-.196	445	720
3/16	.800	.960	.501-.625	AD610BSLF	.192-.196	445	720
3/16	.925	1.085	.626-.750	AD612BSLF	.192-.196	445	720
3/16	1.05	1.210	.751-.875	AD614BSLF	.192-.196	445	720
3/16	1.175	1.335	.876-1.00	AD616BSLF	.192-.196	445	720

5056 Aluminum/Steel Rivets - 120 Degree Countersunk



Pop Rivet

5056 Aluminum Rivets with Coated Carbon Steel Mandrel. Finish: Plain/Protective Coating



- Strong, low cost fastenings.
- Ideal for wide range of application.
- Versatile for general fastening needs.
- Available in a range of sizes and materials.

Rivet Diameter	Rivet Body Length	Blind Side Protrusion	Grip Range	Rivet Part Number	Hole Size	Shear Strength	Tensile Strength
1/8	.250	.370	.063-.125	AK42BS	.129-.133	210	325
1/8	.313	.433	.126-.187	AK43BS	.129-.133	210	325
1/8	.375	.495	.188-.250	AK44BS	.129-.133	210	325
1/8	.438	.558	.251-.312	AK45BS	.129-.133	210	325
1/8	.500	.620	.313-.375	AK46BS	.129-.133	210	325
1/8	.625	.745	.376-.500	AK48BS	.129-.133	210	325
5/32	.275	.415	.063-.125	AK52BS	.160-.164	340	490
5/32	.400	.540	.188-.250	AK54BS	.160-.164	340	490
5/32	.525	.665	.313-.375	AK56BS	.160-.164	340	490
3/16	.425	.585	.126-.250	AK64BS	.192-.196	445	720
3/16	.550	.710	.251-.375	AK66BS	.192-.196	445	720

ETP Copper/Steel Rivet

Pop Rivet

ETP Copper Rivets with Coated Steel Mandrel Domed Head Finish: Plain/Protective Coating



- Strong, low cost fastenings.
- Ideal for wide range of application.
- Versatile for general fastening needs.
- Available in a range of sizes and materials.

Rivet Diameter	Rivet Body Length	Blind Side Protrusion	Grip Range	Rivet Part Number	Hole Size	Shear Strength	Tensile Strength
1/8	.250	.370	.063-.125	CD42BS	.129-.133	215	300
1/8	.375	.495	.188-.250	CD44BS	.129-.133	215	300
1/8	.500	.620	.313-.375	CD46BS	.129-.133	215	300

5052 Aluminum/Aluminum Rivet - Large Flange

Pop Rivet

5052 Aluminum Body/Aluminum Mandrel - Large Flange - Finish: Plain/Plain



- Strong, low cost fastenings.
- Ideal for wide range of application.
- Versatile for general fastening needs.
- Available in a range of sizes and materials.

Rivet Diameter	Rivet Body Length	Blind Side Protrusion	Grip Range	Rivet Part Number	Hole Size	Shear Strength	Tensile Strength
1/8	.250	.370	.063-.125	AD42ABSLF	.129-.133	155	235
1/8	.313	.433	.126-.187	AD43ABSLF	.129-.133	155	235
1/8	.375	.495	.188-.250	AD44ABSLF	.129-.133	155	235
1/8	.500	.620	.313-.375	AD46ABSLF	.129-.133	155	235
5/32	.400	.540	.188-.250	AD54ABSLF	.160-.164	225	350
5/32	.525	.665	.251-.375	AD56ABSLF	.160-.164	225	350
5/32	.650	.790	.376-.500	AD58ABSLF	.160-.164	225	350
3/16	.425	.585	.126-.250	AD64ABSLF	.192-.196	315	500
3/16	.550	.710	.251-.375	AD66ABSLF	.192-.196	315	500
3/16	.675	.835	.376-.500	AD68ABSLF	.192-.196	315	500
3/16	.800	.960	.501-.625	AD610ABSLF	.192-.196	315	500
3/16	.925	1.085	.626-.750	AD612ABSLF	.192-.196	315	500
3/16	1.175	1.335	.876-1.000	AD616ABSLF	.192-.196	315	500

5052 Aluminum/Aluminum Rivet - Domed Head



Pop Rivet

5052 Aluminum Body/Aluminum Mandrel - Domed Head - Finish: Plain/Plain

- Strong, low cost fastenings.
- Ideal for wide range of applications.
- Versatile for general fastening needs.
- Available in a range of sizes and materials.



Rivet Diameter	Rivet Body Length	Blind Side Protrusion	Grip Range	Rivet Part Number	Hole Size	Shear Strength	Tensile Strength
3/32	.225	.325	.032-.125	AD32ABS	.097-.100	85	135
3/32	.350	.450	.126-.250	AD34ABS	.097-.100	85	135
3/32	.475	.575	.251-.375	AD36ABS	.097-.100	85	135
1/8	.188	.308	.032-.062	AD41ABS	.129-.133	155	235
1/8	.250	.370	.063-.125	AD42ABS	.129-.133	155	235
1/8	.313	.433	.126-.187	AD43ABS	.129-.133	155	235
1/8	.375	.495	.188-.250	AD44ABS	.129-.133	155	235
1/8	.438	.558	.251-.312	AD45ABS	.129-.133	155	235
1/8	.500	.620	.313-.375	AF46ABS	.129-.133	155	235
1/8	.625	.745	.376-.500	AD48ABS	.129-.133	155	235
1/8	.750	.870	.501-.625	AD410ABS	.129-.133	155	235
5/32	.275	.415	.063-.125	AD52ABS	.160-.164	225	350
5/32	.338	.478	.126-.187	AD53ABS	.160-.164	225	350
5/32	.400	.540	.188-.250	AD54ABS	.160-.164	225	350
5/32	.525	.665	.251-.375	AD56ABS	.160-.164	225	350
5/32	.650	.790	.376-.500	AD58ABS	.160-.164	225	350
5/32	.775	.915	.501-.625	AD510ABS	.160-.164	225	350
3/16	.300	.460	.063-.125	AD62ABS	.192-.196	315	500
3/16	.425	.585	.126-.250	AD64ABS	.192-.196	315	500
3/16	.550	.710	.251-.375	AD66ABS	.192-.196	315	500
3/16	.675	.835	.376-.500	AD68ABS	.192-.196	315	500
3/16	.800	.960	.501-.625	AD610ABS	.192-.196	315	500
3/16	.925	1.085	.626-.750	AD612ABS	.192-.196	315	500
3/16	1.05	1.210	.751-.875	AD614ABS	.192-.196	315	500
3/16	1.175	1.335	.876-1.00	AD616ABS	.192-.196	315	500
1/4	.350	.585	.062-.150	AD82ABS	.257-.261	600	750
1/4	.475	.710	.063-.250	AD84ABS	.257-.261	600	750
1/4	.600	.835	.251-.375	AD86ABS	.257-.261	600	750
1/4	.725	.960	.376-.500	AD88ABS	.257-.261	600	750
1/4	.850	1.085	.501-.625	AD810ABS	.257-.261	600	750
1/4	.975	1.210	.626-.750	AD812ABS	.257-.261	600	750
1/4	1.100	1.335	.751-.875	AD814ABS	.257-.261	600	750
1/4	1.225	1.460	.876-1.00	AD816ABS	.257-.261	600	750

1100 Aluminum/Aluminum Rivet - Domed Head

Pop Rivet

1100 Aluminum Body/Aluminum Mandrel - Domed Head - Finish: Plain/Plain

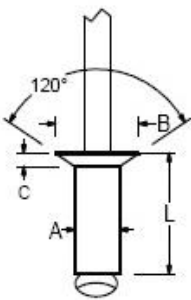

- Designed for soft or brittle materials.
- 1100 Aluminum alloy.
- Low clamping force.
- Available in 3/32" thru 3/16". - Low cost.

Rivet Diameter	Rivet Body Length	Blind Side Protrusion	Grip Range	Rivet Part Number	Hole Size	Shear Strength	Tensile Strength
.098	.287	.421	.126-.187	PAD25M3ABS	.100-.104	60	74
.098	.350	.484	.189-.252	PAD25M4ABS	.100-.104	60	74
.098	.448	.583	.252-.315	PAD25M5ABS	.100-.104	60	74
.118	.315	.492	.126-.189	PAD30M3ABS	.120-.124	69	94
.118	.385	.559	.189-.252	PAD30M4ABS	.120-.124	69	94
.118	.456	.630	.252-.315	PAD30M5ABS	.120-.124	69	94
1/8	.188	.308	.032-.062	PAD41ABS	.129-.133	65	85
1/8	.250	.370	.063-.125	PAD42ABS	.129-.133	65	85
1/8	.313	.433	.126-.187	PAD43ABS	.129-.133	65	85
1/8	.375	.495	.188-.250	PAD44ABS	.129-.133	65	85
1/8	.438	.558	.251-.312	PAD45ABS	.129-.133	65	85
1/8	.500	.620	.313-.375	PAD46ABS	.129-.133	65	85
5/32	.400	.540	.188-.250	PAD54ABS	.160-.164	105	145
5/32	.525	.665	.251-.375	PAD56ABS	.160-.164	105	145
3/16	.425	.585	.126-.250	PAD64ABS	.192-.196	145	205
3/16	.550	.710	.251-.375	PAD66ABS	.192-.196	145	205
3/16	.675	.835	.376-.500	PAD68ABS	.192-.196	145	205

5052 Aluminum/Aluminum Rivet - 120 Degree Countersunk



Pop Rivet

5052 Aluminum Body/Aluminum Mandrel - 120 Degree Countersunk -Finish: Plain/Plain

- Strong, low cost fastenings.
- Ideal for wide range of applications.
- Versatile for general fastening needs.
- Available in a range of sizes and materials.



Rivet Diameter	Rivet Body Length	Blind Side Protrusion	Grip Range	Rivet Part Number	Hole Size	Shear Strength	Tensile Strength
1/8	.250	.370	.063-.125	AK42ABS	.129-.133	155	235
1/8	.313	.433	.126-.187	AK43ABS	.129-.133	155	235
1/8	.375	.495	.188-.250	AK44ABS	.129-.133	155	235
1/8	.438	.558	.251-.312	AK45ABS	.129-.133	155	235
1/8	.500	.620	.313-.375	AK46ABS	.129-.133	155	235
1/8	.750	.870	.501-.625	AK410ABS	.129-.133	155	235
5/32	.275	.415	.063-.125	AK52ABS	.160-.164	225	350
5/32	.400	.540	.188-.250	AK54ABS	.160-.164	225	350
5/32	.525	.665	.313-.375	AK56ABS	.160-.164	225	350
3/16	1.175	1.335	.876-1.00	AK616ABS	.192-.196	315	500

Steel/Steel Rivet - Domed Head

Pop Rivet

C1006-C1010 Steel Body/Steel Mandrel - Domed Head - Finish: Zinc/Protective Coating.

- Strong, low cost fastenings.
- Ideal for wide range of applications.
- Versatile for general fastening needs.
- Available in a range of sizes and materials.



Rivet Diameter	Rivet Body Length	Blind Side Protrusion	Grip Range	Rivet Part Number	Hole Size	Shear Strength	Tensile Strength
3/32	.225	.325	.032-.125	SD32BS	.097-.100	150	205
3/32	.350	.450	.126-.250	SD34BS	.097-.100	150	205
1/8	.188	.308	.032-.062	SD41BS	.129-.133	295	425
1/8	.250	.370	.063-.125	SD42BS	.129-.133	295	425
1/8	.313	.433	.126-.187	SD43BS	.129-.133	295	425
1/8	.375	.495	.188-.250	SD44BS	.129-.133	295	425
1/8	.438	.558	.251-.312	SD45BS	.129-.133	295	425
1/8	.500	.620	.313-.375	SD46BS	.129-.133	295	425
1/8	.625	.745	.376-.500	SD48BS	.129-.133	295	425
5/32	.275	.415	.063-.125	SD52BS	.160-.164	410	570
5/32	.338	.478	.126-.187	SD53BS	.160-.164	410	570
5/32	.400	.540	.188-.250	SD54BS	.160-.164	410	570
5/32	.625	.665	.251-.375	SD56BS	.160-.164	410	570
5/32	.650	.790	.376-.500	SD58BS	.160-.164	410	570
3/16	.300	.460	.063-.125	SD62BS	.192-.196	590	815
3/16	.425	.585	.126-.250	SD64BS	.192-.196	590	815
3/16	.550	.710	.251-.375	SD66BS	.192-.196	590	815
3/16	.675	.835	.376-.500	SD68BS	.192-.196	590	815
3/16	.800	.960	.501-.625	SD610BS	.192-.196	590	815
3/16	.925	1.085	.626-.750	SD612BS	.192-.196	590	815
3/16	1.05	1.210	.751-.875	SD614BS	.192-.196	590	815
3/16	1.175	1.335	.876-1.00	SD616BS	.192-.196	590	815
1/4	.475	.710	.063-.250	SD84BS	.257-.261	1245	1505
1/4	.600	.835	.251-.375	SD86BS	.257-.261	1245	1505
1/4	.725	.960	.376-.500	SD88BS	.257-.261	1245	1505
1/4	.850	1.085	.501-.625	SD810BS	.257-.261	1245	1505
1/4	.975	1.210	.626-.750	SD812BS	.257-.261	1245	1505
1/4	1.10	1.335	.751-.875	SD814BS	.257-.261	1245	1505
1/4	1.225	1.460	.876-1.00	SD816BS	.257-.261	1245	1505

Steel/Steel Rivet - Large Flange

Pop Rivet

C1006-C1010 Steel Body/Steel Mandrel - Large Flange - Finish: Zinc/Protective Coating



- Strong, low cost fastenings.
- Ideal for wide range of applications.
- Versatile for general fastening needs.
- Available in a range of sizes and materials.

Rivet Diameter	Rivet Body Length	Blind Side Protrusion	Grip Range	Rivet Part Number	Hole Size	Shear Strength	Tensile Strength
1/8	.250	.370	.063-.125	SD42BSLF	.129-.133	295	425
1/8	.313	.433	.126-.187	SD43BSLF	.129-.133	295	425
1/8	.375	.495	.188-.250	SD44BSLF	.129-.133	295	425
5/32	.338	.478	.126-.187	SD53BSLF	.160-.164	410	570
5/32	.400	.540	.188-.250	SD54BSLF	.160-.164	410	570
5/32	.525	.665	.251-.375	SD56BSLF	.160-.164	410	570
3/16	.300	.460	.063-.125	SD62BSLF	.192-.196	590	815
3/16	.425	.585	.126-.250	SD64BSLF	.192-.196	590	815
3/16	.550	.710	.251-.375	SD66BSLF	.192-.196	590	815
3/16	.675	.835	.376-.500	SD68BSLF	.192-.196	590	815
3/16	.800	.960	.501-.625	SD610BSLF	.192-.196	590	815
3/16	.925	1.085	.626-.750	SD612BSLF	.192-.196	590	815
1/4	.600	.835	.251-.375	SD86BSLF	.257-.261	1245	1505
1/4	.850	1.085	.501-.625	SD810BSLF	.257-.261	1245	1505
1/4	1.100	1.335	.751-.875	SD814BSLF	.257-.261	1245	1505

Steel/Steel Rivet - 120 Degree Countersunk

Pop Rivet

C1006-C1010 Steel Body/Steel Mandrel - 120 Degree Countersunk - Finish: Zinc/Protective Coating.



- Strong, low cost fastenings
- Ideal for wide range of applications.
- Versatile for general fastening needs.
- Available in a range of sizes and materials.

Rivet Diameter	Rivet Body Length	Blind Side Protrusion	Grip Range	Rivet Part Number	Hole Size	Shear Strength	Tensile Strength
3/32	.225	.325	.063-.125	SK32BS	.097-.100	150	205
1/8	.250	.370	.063-.125	SK42BS	.129-.133	295	425
1/8	.313	.433	.126-.187	SK43BS	.129-.133	295	425
1/8	.375	.495	.188-.250	SK44BS	.129-.133	295	425
1/8	.500	.620	.313-.375	SK46BS	.129-.133	295	425
5/32	.650	.790	.376-.500	SK58BS	.160-.164	410	570
3/16	.425	.585	.126-.250	SK64BS	.192-.196	590	815

Stainless Steel/Steel Rivet - Domed Head



Pop Rivet

300 Series Stainless Steel Body/Steel Mandrel - Domed Head - Finish: Plain/Protective Coating.

- Strong, low cost fastenings.
- Ideal for wide range of applications.
- Versatile for general fastening needs.
- Available in a range of sizes and materials.



Rivet Diameter	Rivet Body Length	Blind Side Protrusion	Grip Range	Rivet Part Number	Hole Size	Shear Strength	Tensile Strength
1/8	.188	.308	.032-.062	SSD41BS	.129-.133	550	700
1/8	.250	.370	.063-.125	SSD42BS	.129-.133	550	700
1/8	.313	.433	.126-.187	SSD43BS	.129-.133	550	700
1/8	.375	.495	.188-.250	SSD44BS	.129-.133	550	700
1/8	.438	.558	.251-.312	SSD45BS	.129-.133	550	700
1/8	.500	.620	.313-.375	SSD46BS	.129-.133	550	700
1/8	.625	.745	.376-.500	SSD48BS	.129-.133	550	700
5/32	.275	.415	.063-.125	SSD52BS	.160-.164	900	1130
5/32	.400	.540	.188-.250	SSD54BS	.160-.164	900	1130
5/32	.525	.665	.251-.375	SSD56BS	.160-.164	900	1130
3/16	.300	.460	.063-.125	SSD62BS	.192-.196	1000	1375
3/16	.425	.585	.126-.250	SSD64BS	.192-.196	1000	1375
3/16	.550	.710	.251-.375	SSD66BS	.192-.196	1000	1375
3/16	.675	.835	.376-.500	SSD68BS	.192-.196	1000	1375
3/16	.800	.960	.501-.625	SSD610BS	.192-.196	1000	1375

Stainless Steel/Steel Rivet - Large Flange

Pop Rivet

300 Series Stainless Steel Body/Steel Mandrel - Large Flange - Finish: Plain/Protective Coating.

- Strong, low cost fastenings.
- Ideal for wide range of applications.
- Versatile for general fastening needs.
- Available in a range of sizes and materials.



Rivet Diameter	Rivet Body Length	Blind Side Protrusion	Grip Range	Rivet Part Number	Hole Size	Shear Strength	Tensile Strength
1/8	.250	.370	.063-.125	SSD42BSLF	.129-.133	550	700
1/8	.313	.433	.126-.187	SSD43BSLF	.129-.133	550	700
1/8	.375	.495	.188-.250	SSD44BSLF	.129-.133	550	700
3/16	.800	.960	.501-.625	SSD610BSLF	.192-.196	1000	1375

Stainless Steel/Steel Rivet - 120 Degree Countersunk

Pop Rivet

300 Series Stainless Steel Body/Steel Mandrel - 120 Degree Countersunk - Finish: Plain/Protective Coating.

- Strong, low cost fastenings.
- Ideal for wide range of applications.
- Versatile for general fastening needs.
- Available in a range of sizes and materials.



Rivet Diameter	Rivet Body Length	Blind Side Protrusion	Grip Range	Rivet Part Number	Hole Size	Shear Strength	Tensile Strength
1/8	.275	.370	.063-.125	SSK42BS	.129*-.133	550	700
3/16	.425	.585	.126-.250	SSK64BS	.192-.196	1000	1375

Stainless Steel/Stainless Steel - Domed Head



Pop Rivet

300 Series Stainless Steel Body/Stainless Steel Mandrel - Domed Head - Finish: Plain/Plain.



- Strong, low cost fastenings.
- Ideal for wide range of applications.
- Versatile for general fastening needs.
- Available in a range of sizes and materials.

Rivet Diameter	Rivet Body Length	Blind Side Protrusion	Grip Range	Rivet Part Number	Hole Size	Shear Strength	Tensile Strength
1/8	.188	.308	.032-.062	SSD41SSBS	.129-.133	550	700
1/8	.250	.370	.063-.125	SSD42SSBS	.129-.133	550	700
1/8	.313	.433	.126-.187	SSD43SSBS	.129-.133	550	700
1/8	.375	.495	.188-.250	SSD44SSBS	.129-.133	550	700
1/8	.438	.558	.251-.312	SSD45SSBS	.129-.133	550	700
1/8	.500	.620	.313-.375	SSD46SSBS	.129-.133	550	700
1/8	.625	.745	.376-.500	SSD48SSBS	.129-.133	550	700
5/32	.275	.415	.063-.125	SSD52SSBS	.160-.164	900	1130
5/32	.338	.478	.126-.187	SSD53SSBS	.160-.164	900	1130
5/32	.400	.540	.188-.250	SSD54SSBS	.160-.164	900	1130
5/32	.525	.665	.251-.375	SSD56SSBS	.160-.164	900	1130
3/16	.300	.460	.063-.125	SSD62SSBS	.192-.196	1000	1375
3/16	.425	.585	.126-.250	SSD64SSBS	.192-.196	1000	1375
3/16	.550	.710	.251-.375	SSD66SSBS	.192-.196	1000	1375
3/16	.675	.835	.376-.500	SSD68SSBS	.192-.196	1000	1375
3/16	.800	.960	.501-.625	SSD610SSBS	.192-.196	1000	1375
3/16	1.17	1.335	.876-1.000	SSD616SSBS	.192-.196	1000	1375

Stainless Steel/Stainless Steel Rivet - Large Flange

Pop Rivet

300 Series Stainless Steel/Stainless Steel Mandrel - Large Flange - Finish: Plain/Plain.



- Strong, low cost fastenings.
- Ideal for wide range of applications.
- Versatile for general fastening needs.
- Available in a range of sizes and materials.

Rivet Diameter	Rivet Body Length	Blind Side Protrusion	Grip Range	Rivet Part Number	Hole Size	Shear Strength	Tensile Strength
1/8	.250	.370	.063-.125	SSD42SSBSLF	.129-.133	550	700
1/8	.313	.433	.126-.187	SSD43SSBSLF	.129-.133	550	700
1/8	.375	.495	.188-.250	SSD44SSBSLF	.129-.133	550	700
5/32	.525	.665	.251-.375	SSD56SSBSLF	.160-.164	900	1130
3/16	.675	.835	.376-.500	SSD68SSBSLF	.192-.196	1000	1375
3/16	.800	.960	.501-.625	SSD610SSBSLF	.192-.196	1000	1375
3/16	.925	1.085	.626-.750	SSD612SSBSLF	.192-.196	1000	1375

Rivets

Stainless Steel/Stainless Steel Rivet - 120 Degree Countersunk



Pop Rivet

300 Series Stainless Steel Body/Stainless Steel Mandrel - 120 Degree Countersunk - Finish: Plain/Plain.



- Strong, low cost fastenings.
- Ideal for wide range of applications.
- Versatile for general fastening needs.
- Available in a range of sizes and materials.

Rivet Diameter	Rivet Body Length	Blind Side Protrusion	Grip Range	Rivet Part Number	Hole Size	Shear Strength	Tensile Strength
1/8	.275	.370	.063-.125	SSK42SSBS	.129-.133	550	700
1/8	.313	.433	.126-.187	SSK43SSBS	.129-.133	550	700
1/8	.375	.495	.188-.250	SSK44SSBS	.129-.133	550	700
3/16	.425	.585	.126-.250	SSK64SSBS	.192-.196	1000	1375
3/16	.675	.835	.376-.500	SSK68SSBS	.192-.196	1000	1375

5056 Closed End Aluminum/Steel Rivet

Pop Rivet

5056 Aluminum Body/Steel Mandrel - Domed Head - Finish: Plain/Protective Coating.



- Seals out moisture, air and other contaminants.
- Higher tensile and shear strength than the equivalent open end rivet.
- 100% mandrel head retention guaranteed.

Nominal Rivet Diameter	Nominal Rivet Body Length (H)	Grip Range	Rivet Part Number	Hole Size	Shear Strength	Tensile Strength
1/8	.237	.032-.062	AD41H	.129-.133	305	385
1/8	.301	.063-.125	AD42H	.129-.133	305	385
1/8	.362	.126-.187	AD43H	.129-.133	305	385
1/8	.425	.188-.250	AD44H	.129-.133	305	385
1/8	.487	.251-.312	AD45H	.129-.133	305	385
1/8	.550	.313-.375	AD45H	.129-.133	305	385
1/8	.675	.376-.500	AD48H	.129-.133	305	385
5/32	.315	.063-.125	AD52H	.160-.164	430	605
5/32	.377	.126-.187	AD53H	.160-.164	430	605
5/32	.440	.188-.250	AD54H	.160-.164	430	605
5/32	.502	.251-.312	AD55H	.160-.164	430	605
3/16	.330	.063-.125	AD62H	.192-.196	575	840
3/16	.39*2	.126-.187	AD63H	.192-.196	575	840
3/16	.455	.188-.250	AD64H	.192-.196	575	840
3/16	.517	.251-.312	AD65H	.192-.196	575	840
3/16	.580	.313-.375	AD66H	.192-.196	575	840
3/16	.705	.376-.500	AD68H	.192-.196	575	840
1/4	.485	.126-.250	AD84H	.257-.261	900	1100
1/4	.610	.251-.375	AD86H	.257-.261	900	1100

1100 Closed End Aluminum/Aluminum Rivet



Pop Rivet

1100 Aluminum Body/Aluminum Mandrel - Domed Head - Finish: Plain/Plain

- Seals out moisture, air and other contaminants.
- Higher tensile and shear strength than the equivalent open rivet.
- 100% mandrel head retention guaranteed.



Nominal Rivet Diameter	Nominal Rivet Body Length (H)	Grip Range	Rivet Part Number	Hole Size	Shear Strength	Tensile Strength
1/8	.237	.032-.062	AD41AH	.129-.133	105	150
1/8	.301	.063-.125	AD42AH	.129-.133	105	150
1/8	.362	.126-.187	AD43AH	.129-.133	105	150
1/8	.425	.188-.250	AD44AH	.129-.133	105	150
5/32	.440	.188-.250	AD54AH	.160-.164	155	240
5/32	.502	.251-.312	AD55AH	.160-.164	155	240
3/16	.330	.063-.125	AD62AH	.192-.196	220	310
3/16	.455	.126-.250	AD64AH	.192-.196	220	310
3/16	.580	.251-.375	AD66AH	.192-.196	220	310
3/16	.705	.376-.500	AD68AH	.192-.196	220	310

5056 Closed End Aluminum/Stainless Steel Rivet

Pop Rivet

5056 Aluminum Body/Stainless Steel Mandrel - Domed Head - Finish: Plain/Plain.

- Seals out moisture, air and other contaminants.
- Higher tensile and shear strength than the equivalent open end rivet.
- 100% mandrel head retention guaranteed.



Nominal Rivet Diameter	Nominal Rivet Body Length (H)	Grip Range	Rivet Part Number	Hole Size	Shear Strength	Tensile Strength
3/16	.455	.126-.250	AD64SSH	.192-.196	575	840
3/16	.580	.313-.375	AD66SSH	.192-.196	575	840
3/16	.705	.376-.500	AD68SSH	.192-.196	575	840

Closed End Copper/Steel Rivet

Pop Rivet

110 Copper Body/Steel Mandrel - Domed Head - Finish: Plain/Protective Coating.

- Seals out moisture, air and other contaminants.
- Higher tensile and shear strength than the equivalent open end rivet.
- 100% mandrel head retention guaranteed.



Nominal Rivet Diameter	Nominal Rivet Body Length (H)	Grip Range	Rivet Part Number	Hole Size	Shear Strength	Tensile Strength
1/8	.362	.126-.187	CD43H	.129-.133	270	335
1/8	.425	.188-.250	CD44H	.129-.133	270	335
1/8	.487	.251-.312	CD45H	.129-.133	270	335

5056 Closed End Aluminum/Steel Rivet - 120 Degree Countersunk



Pop Rivet

5056 Aluminum Body/Steel Mandrel - 120 Degree Countersunk
 - Finish: Plain/Protective Coating.



- Seals out moisture, air and other contaminants.
- Higher tensile and shear strength than the equivalent open end rivet.
- 100% mandrel head retention guaranteed.

Nominal Rivet Diameter	Nominal Rivet Body Length (H)	Grip Range	Rivet Part Number	Hole Size	Shear Strength	Tensile Strength
1/8	.277	.031-.062	AK41H	.129-.133	305	385
1/8	.341	.063-.125	AK42H	.129-.133	305	385
1/8	.402	.126-.187	AK43H	.129-.133	305	385
1/8	.466	.188-.250	AK44H	.129-.133	305	385
1/8	.528	.251-.312	AK45H	.129-.133	305	385
1/8	.591	.313-.375	AK46H	.129-.133	305	385
5/32	.307	.032-.062	AK51H	.160-.164	430	605
5/32	.370	.063-.125	AK52H	.160-.164	430	605
5/32	.432	.126-.187	AK53H	.160-.164	430	605
5/32	.475	.251-.312	AK55H	.160-.164	430	605
5/32	.558	.313-.375	AK56H	.160-.164	430	605
3/16	.395	.063-.125	AK62H	.192-.196	575	840
3/16	.520	.126-.250	AK64H	.192-.196	575	840
3/16	.645	.251-.375	AK66H	.192-.196	575	840

Closed End Stainless Steel/Stainless Steel

Pop Rivet

300 Stainless Steel Body/Stainless Steel Mandrel - Domed Head -
 Finish: Plain/Plain



- Seals out moisture, air and other contaminants.
- Higher tensile and shear strength than the equivalent open end rivet.
- 100% mandrel head retention guaranteed.

Nominal Rivet Diameter	Nominal Rivet Body Length (H)	Grip Range	Rivet Part Number	Hole Size	Shear Strength	Tensile Strength
1/8	.260	0-.063	SSD41SSH	.130-.134	472	499
1/8	.315	.063-.125	SSD42SSH	.130-.134	472	499
1/8	.382	.125-.190	SSD43SSH	.130-.134	472	499
1/8	.445	.188-.252	SSD44SSH	.130-.134	472	499
1/8	.508	.250-.311	SSD45SSH	.130-.134	472	499
5/32	.339	0-.125	SSD52SSH	.161-.165	742	899
5/32	.402	.125-.190	SSD53SSH	.161-.165	742	899
5/32	.465	.188-.252	SSD54SSH	.161-.165	742	899
5/32	.528	.250-.311	SSD55SSH	.161-.165	742	899
3/16	.362	0-.125	SSD62SSH	.193-.197	966	990
3/16	.425	.125-.189	SSD63SSH	.193-.197	966	990
3/16	.492	.188-.252	SSD64SSH	.193-.197	966	990
3/16	.610	.250-.374	SSD66SSH	.193-.197	966	990
3/16	.728	.371-.500	SSD68SSH	.193-.197	966	990
1/4	.559	0-.252	SSD84SSH	.256-.260	1528	1955
1/4	.618	.250-.311	SSD85SSH	.256-.260	1528	1955
1/4	.807	.311-.500	SSD88SSH	.256-.260	1528	1955

5154 Aluminum/Aluminum Rivet Load Spreading Rivet



Pop Rivet

5154 Aluminum Body/Aluminum Mandrel - Domed Head Load Spreading Rivet - Finish: Plain/Plain

- Splits to provide large secondary bearing surface.
- Will not crack soft or brittle material.
- Eliminated need for backup washer.

Rivet Diameter	Rivet Body Length	Blind Side Protrusion	Grip Range	Rivet Part Number	Hole Size	Shear Strength	Tensile Strength
1/8	.664	.755	0-.250	ACD408AS	.129-.133	124	202
5/32	.689	.780	0-.250	ACD508ASM	.165-.169	202	292
5/32	.838	.929	.118-.375	ACD512ASM	.165-.169	202	292
5/32	.984	1.071	.197-.472	ACD516ASM	.165-.169	202	292
3/16	.689	.800	0-.250	ACD608ASM	.197-.205	225	312
3/16	.795	.890	.118-.375	ACD612ASM	.197-.205	225	312
3/16	.925	1.040	.197-.472	ACD616ASM	.197-.205	225	312

5052 Multi-Grip Aluminum/Steel Rivet



Pop Rivet

5052 Aluminum Body/Steel Mandrel - Domed Head - Finish: Plain/Protective Coating.

- Accommodates oversized and irregular sized holes.
- Vibration and moisture resistant.
- Wide grip range.
- Reduces inventory.

Rivet Diameter	Rivet Body Length	Blind Side Protrusion	Grip Range	Rivet Part Number	Hole Size	Shear Strength	Tensile Strength
1/8	.313	.433	.039-.187	AD41-43BS	.129-.142	150	220
1/8	.453	.573	.157-.312	AD43-45BS	.129-.142	150	220
1/8	.594	.714	.251-.437	AD45-47BS	.129-.142	150	220
5/32	.400	.540	.047-.250	AD52-54BS	.160-.173	250	360
5/32	.485	.625	.126-.312	AD53-55BS	.160-.173	250	360
5/32	.715	.855	.251-.500	AD56-58BS	.160-.173	250	360
3/16	.425	.585	.063-.250	AD62-64BS	.192-.205	350	505
3/16	.605	.765	.188-.375	AD63-66BS	.192-.205	350	505
3/16	.716	.876	.251-.500	AD66-68BS	.192-.205	350	505
3/16	1.05	1.21	.438-.750	AD68-612BS	.192-.205	350	505
1/4	.600	.780	.080-.350	AD82-86BS	.257-.275	460	560

5052 Multi-Grip Aluminum/Stainless Steel Rivet



Pop Rivet

5052 Aluminum Body/Stainless Steel Mandrel - Domed Head - Finish: Plain/Plain.



- Accommodates oversized and irregular sized holes.
- Vibration and moisture resistant.
- Wide grip range.
- Reduces inventory.

Rivet Diameter	Rivet Body Length	Blind Side Protrusion	Grip Range	Rivet Part Number	Hole Size	Shear Strength	Tensile Strength
5/32	.715	.855	.376-.500	AD56-58SSBS	.160-.173	250	360
3/16	.425	.585	.063-.250	AD62-64SSBS	.192-.205	350	505
3/16	.605	.765	.188-.375	AD63-66SSBS	.192-.205	350	505

5052 Multi-Grip Aluminum/Steel Rivet - 120 Degree Countersunk

Pop Rivet

5052 Aluminum Body/Steel Mandrel - 120 Degree Countersunk - Finish: Plain/Protective Coating



- Accommodates oversized and irregular sized holes.
- Vibration and moisture resistant.
- Wide grip range.
- Reduces inventory.

Rivet Diameter	Rivet Body Length	Blind Side Protrusion	Grip Range	Rivet Part Number	Hole Size	Shear Strength	Tensile Strength
1/8	.375	.477	.039-.252	AK41-44BS	.129-.142	150	220
3/16	.565	.725	.126-.375	AK64-66BS	.192-.205	350	505
3/16	.716	.876	.251-.500	AK66-68BS	.192-.205	350	505

Easy Entry Aluminum/Steel Rivets - Domed Head

Pop Rivet

5056 Aluminum Body/Steel Mandrel - Domed Head - Finish: Plain/Protective Coating



- Aligns odd shaped and misaligned holes with a unique mandrel head design.
- Large expansion capabilities for strong, tight fit.
- Increases productivity while reducing assembly time.

Rivet Diameter	Rivet Body Length	Blind Side Protrusion	Grip Range	Rivet Part Number	Hole Size	Shear Strength	Tensile Strength
1/8	.250	.415	.031-.094	EAD42BS	.129-.133	210	325
1/8	.313	.478	.095-.156	EAD43BS	.129-.133	210	325
1/8	.375	.540	.157-.218	EAD44BS	.129-.133	210	325
5/32	.400	.565	.188-.218	EAD54BS	.160-.164	340	490

Easy Entry Aluminum/Steel Rivet - Large Flange



Pop Rivet

5056 Aluminum Body/Steel Mandrel - Large Flange - Finish: Plain/
Protective Coating



- Aligns odd shaped and misaligned holes with a unique mandrel head design.
- Large expansion capabilities for strong, tight fit.
- Increases productivity while reducing assembly time.

Rivet Diameter	Rivet Body Length	Blind Side Protrusion	Grip Range	Rivet Part Number	Hole Size	Shear Strength	Tensile Strength
1/8	.375	.540	.157-.218	EAD44BSLF	.129-.133	210	325

Easy Entry Steel/Steel Rivet - Domed Head

Pop Rivet

C1006-C1010 Steel Body/Steel Mandrel - Domed Head -
Finish: Zinc/Protective Coating



- Aligns odd shaped and misaligned holes with a unique mandrel head design.
- Large expansion capabilities for strong, tight fit.
- Increases productivity while reducing assembly time.

Rivet Diameter	Rivet Body Length	Blind Side Protrusion	Grip Range	Rivet Part Number	Hole Size	Shear Strength	Tensile Strength
1/8	.250	.415	.031-.094	ESD42BS	.129-.133	295	425
1/8	.313	.478	.095-.156	ESD43BS	.129-.133	295	425
1/8	.375	.540	.157-.218	ESD44BS	.129-.133	295	425
3/16	.425	.660	.126-.218	ESD64BS	.192-.196	590	815
3/16	.550	.785	.251-.343	ESD66BS	.192-.196	590	815

Easy Entry Steel/Steel Rivet - Large Flange

Pop Rivet

C1006-C1010 Steel Body/Steel Mandrel - Large Flange -
Finish: Zinc/Protective Coating



- Aligns odd shaped and misaligned holes with a unique mandrel head design.
- Large expansion capabilities for strong, tight fit.
- Increases productivity while reducing assembly time.

Rivet Diameter	Rivet Body Length	Blind Side Protrusion	Grip Range	Rivet Part Number	Hole Size	Shear Strength	Tensile Strength
1/8	.375	.540	.157-.218	ESD44BSLF	.129-.133	295	425

400 Monel/Stainless Steel Rivet - Domed Head



Pop Rivet

400 Monel Body/Stainless Steel - Domed Head - Finish: Zinc/Plain

- Strong, low cost fastenings.
- Ideal for wide range of applications.
- Versatile for general fastening needs.
- Available in a range of sizes and materials.



Rivet Diameter	Rivet Body Length	Blind Side Protrusion	Grip Range	Rivet Part Number	Hole Size	Shear Strength	Tensile Strength
1/8	.195	.315	0-.070	MD419SSBS	.129-.133	394	562
1/8	.242	.362	.07-.121	MD424SSBS	.129-.133	394	562
1/8	.293	.413	.121-.168	MD429SSBS	.129-.133	394	562
1/8	.352	.472	.168-.227	MD435SSBS	.129-.133	394	562
1/8	.402	.522	.227-.277	MD440SSBS	.129-.133	394	562
5/32	.242	.382	0-.098	MD524SSBS	.161-.165	675	900
5/32	.305	.445	.098-.160	MD530SSBS	.161-.165	675	900
5/32	.375	.511	.160-.228	MD537SSBS	.161-.165	675	900
5/32	.405	.542	.228-.260	MD540SSBS	.161-.165	675	900
5/32	.453	.590	.260-.311	MD545SSBS	.161-.165	675	900
3/16	.242	.402	0-.090	MD624SSBS	.192-.196	742	843
3/16	.301	.461	.090-.148	MD630SSBS	.192-.196	742	843
3/16	.363	.523	.148-.199	MD636SSBS	.192-.196	742	843
3/16	.391	.551	.199-.227	MD639SSBS	.192-.196	742	843
3/16	.500	.660	.227-.336	MD650SSBS	.192-.196	742	843
3/16	.645	.805	.336-.488	MD665SSBS	.192-.196	742	843
3/16	.742	.902	.488-.586	MD675SSBS	.192-.196	742	843

400 Monel/Stainless Steel Rivet - 120 Degree Countersunk

Pop Rivet

400 Monel Body/Stainless Steel Mandrel - 120 Degree Countersunk - Finish: Zinc/Plain

- Strong, low cost fastenings.
- Ideal for wide range of applications.
- Versatile for general fastening needs.
- Available in a range of sizes and materials.



Rivet Diameter	Rivet Body Length	Blind Side Protrusion	Grip Range	Rivet Part Number	Hole Size	Shear Strength	Tensile Strength
1/8	.227	.347	0-.098	MK419SSBS	.129-.133	394	562
1/8	.273	.393	.098-.148	MK424SSBS	.129-.133	394	562
1/8	.332	.452	.148-.199	MK429SSBS	.129-.133	394	562
1/8	.391	.511	.199-.259	MK435SSBS	.129-.133	394	562
1/8	.438	.558	.259-.309	MK440SSBS	.129-.133	394	562
5/32	.281	.421	0-.129	MK524SSBS	.161-.165	675	900
5/32	.340	.480	.129-.188	MK530SSBS	.161-.165	675	900
5/32	.410	.550	.188-.258	MK537SSBS	.161-.165	675	900
5/32	.441	.581	.258-.289	MK540SSBS	.161-.165	675	900
5/32	.488	.628	.289-.336	MK545SSBS	.161-.165	675	900
3/16	.383	.543	0-.180	MK630SSBS	.192-.196	742	843
3/16	.383	.543	0-.180	MK630SSBS	.192-.196	742	843
3/16	.410	.570	.180-.227	MK636SSBS	.192-.196	742	843
3/16	.430	.590	.227-.259	MK639SSBS	.192-.196	742	843
3/16	.547	.707	.259-.367	MK650SSBS	.192-.196	742	843
3/16	.703	.863	.367-.516	MK665SSBS	.192-.196	742	843
3/16	.801	.961	.516-.617	MK675SSBS	.192-.196	742	843

400 Monel/Steel - Domed Head

Pop Rivet

400 Monel Body/Steel Mandrel - Domed Head - Finish: Zinc/Zinc



- Strong low cost fastenings.
- Ideal for wide range applications.
- Versatile for general fastening needs
- Available in a range of sizes and materials.

Rivet Diameter	Rivet Body Length	Blind Side Protrusion	Grip Range	Rivet Part Number	Hole Size	Shear Strength	Tensile Strength
7/16	.195	.295	.020-.070	MD319BS	.113-.117	258	292
7/16	.217	.317	.070-.090	MD321BS	.113-.117	258	292
1/8	.195	.315	0-.070	MD419BS	.129-.133	394	562
1/8	.242	.362	.071-.121	MD424BS	.129-.133	394	562
1/8	.293	.413	.121-.168	MD429BS	.129-.133	394	562
1/8	.352	.472	.168-.227	MD435BS	.129-.133	394	562
1/8	.402	.522	.227-.277	MD440BS	.129-.133	394	562
5/32	.242	.382	0-.098	MD524BS	.161-.165	675	900
5/32	.305	.445	.098-.160	MD530BS	.161-.165	675	900
5/32	.375	.511	.160-.228	MD537BS	.161-.165	675	900
5/32	.405	.542	.228-.260	MD540BS	.161-.165	675	900
5/32	.453	.590	.260-.311	MD545BS	.161-.165	675	900
3/16	.242	.402	0-.090	MD624BS	.192-.196	742	844
3/16	.301	.461	.090-.148	MD630BS	.192-.196	742	844
3/16	.363	.523	.148-.199	MD636BS	.192-.196	742	844
3/16	.391	.551	.199-.227	MD639BS	.192-.196	742	844
3/16	.500	.660	.227-.336	MD650BS	.192-.196	742	844
3/16	.645	.805	.336-.488	MD665BS	.192-.196	742	844
3/16	.742	.902	.488-.586	MD675BS	.192-.196	742	844
1/4	.500	.735	0-.297	ND850BS	.257-.261	1215	1519
1/4	.703	.938	.297-.496	MD870BS	.257-.261	1215	1519

400 Monel/Steel - 120 Degree Countersunk

Pop Rivet

400 Monel Body/Steel Mandrel - 120 Degree Countersunk - Finish: Zinc/Zinc



- Strong, low cost fastenings.
- Ideal for wide range of applications.
- Versatile for general fastening needs.
- Available in a range of sizes and materials.

Rivet Diameter	Rivet Body Length	Blind Side Protrusion	Grip Range	Rivet Part Number	Hole Size	Shear Strength	Tensile Strength
7/64	.215	.315	0-.090	MK319BS	.113-.117	258	292
7/64	.234	.334	.090-.109	MK321BS	.113-.117	258	292
1/8	.227	.347	0-.098	MK419BS	.129-.133	394	562
1/8	.273	.393	.098-.148	MK424BS	.129-.133	394	562
1/8	.332	.452	.148-.199	MK429BS	.129-.133	394	562
1/8	.391	.511	.199-.259	MK435BS	.129-.133	394	562
1/8	.438	.558	.259-.309	MK440BS	.129-.133	394	562
5/32	.281	.421	0-.129	MK524BS	.153-.159	675	900
5/32	.340	.480	.129-.188	MK530BS	.153-.159	675	900
5/32	.410	.550	.188-.258	MK537BS	.153-.159	675	900
5/32	.441	.581	.258-.289	MK540BS	.153-.159	675	900
5/32	.488	.628	.289-.336	MK545BS	.153-.159	675	900
3/16	.290	.450	0-.120	MK624BS	.192-.196	742	844
3/16	.383	.543	0-.180	MK630BS	.192-.196	742	844
3/16	.410	.570	.180-.227	MK636BS	.192-.196	742	844
3/16	.430	.590	.227-.259	MK639BS	.192-.196	742	844
3/16	.547	.707	.259-.367	MK650BS	.192-.196	742	844
3/16	.703	.863	.367-.516	MK665BS	.192-.196	742	844
3/16	.801	.961	.516-.617	MK675BS	.192-.196	742	844
1/4	.565	.745	.151-.300	MK850BS	.257-.261	1215	1519
1/4	.763	.885	.301-.500	MK870BS	.257-.261	1215	1519

Soft Set Aluminum/Aluminum Rivet - Countersunk



Pop Rivet

1100 Aluminum Body/Aluminum Mandrel - Countersunk - Finish: Plain/Plain

- Designed for soft or brittle materials.
- 1100 Aluminum alloy.
- Low clamping force.
- Available in 3/32 thru 3/16. - Low Cost.

Rivet Diameter	Rivet Body Length	Blind Side Protrusion	Grip Range	Rivet Part Number	Hole Size	Shear Strength	Tensile Strength
1/8	.250	.370	.063-.125	PAK42ABS	.129-.133	65	85
1/8	.313	.433	.126-.187	PAK43ABS	.129-.133	65	85
1/8	.375	.495	.188-.250	PAK44ABS	.129-.133	65	85

Micro Rivet Aluminum/Steel - Domed Head

Pop Rivet

5154 Aluminum Body/Steel Mandrel - Domed Head - Finish: Plain/Zinc



- Very low secondary side clearance.
- Suitable for tight spaces.
- Smallest blind breakstem rivet available.
- Low head height.

Rivet Diameter	Rivet Body Length	Blind Side Protrusion	Grip Range	Rivet Part Number	Hole Size	Shear Strength	Tensile Strength
.078	.161	.295	0-.063	TAPD20M1BS	.080-.084	66	87
.078	.224	.358	.039-.126	TAPD20M2BS	.080-.084	66	87
.078	.291	.425	.126-.187	TAPD20M3BS	.080-.084	66	87
.078	.354	.488	.189-.252	TAPD20M4BS	.080-.084	66	87
.078	.421	.555	.252-.315	TAPD20M5BS	.080-.084	66	87

Multi-Grip Aluminum/Aluminum Rivet - Large Flange

Pop Rivet

1100 Aluminum Body/Aluminum Mandrel - Large Flange - Finish: Plain/Plain



- Accommodates oversized and irregular sized holes.
- Vibration and moisture resistant.
- Wide grip range.
- Reduces inventory.

Rivet Diameter	Rivet Body Length	Blind Side Protrusion	Grip Range	Rivet Part Number	Hole Size	Shear Strength	Tensile Strength
1/8	.313	.433	.039-.187	AD41-43ABSLF	.129-.142	65	85
3/16	.425	.585	.063-.250	AD62-64ABSLF	.192-.205	145	205
3/16	.605	.765	.188-.375	AD63-66ABSLF	.192-.205	145	205
3/16	1.05	1.21	.438-.750	AD68-612ABSLF	.192-.205	145	205

Multi-Grip Aluminum/Steel Rivet - Large Flange



Pop Rivet

5052 Aluminum Body/Steel Mandrel - Large Flange - Finish: Plain/Protective Coating

- Accommodates oversized and irregular sized holes.
- Vibration and moisture resistant.
- Wide grip range.
- Reduces inventory.

Rivet Diameter	Rivet Body Length	Blind Side Protrusion	Grip Range	Rivet Part Number	Hole Size	Shear Strength	Tensile Strength
1/8	.313	.433	1.0-.187	AD41-43BSLS	.129-.142	150	220
1/8	.453	.573	.157-.312	AD43-45BSLF	.129-.142	150	220
5/32	.400	.540	.047-.250	AD52-54BSLF	.160-.173	250	360
5/32	.485	.625	.126-.312	AD53-55BSLF	.160-.173	250	360
3/16	.425	.585	.063-.250	AD62-64BSLF	.192-.205	350	505
3/16	.716	.876	.251-.500	AD66-68BSLF	.192-.205	350	505
3/16	1.05	1.21	.438-.750	AD68-612BSLF	.192-.205	350	505

Multi-Grip Aluminum/Stainless Steel Rivet - Large Flange



Pop Rivet

5052 Aluminum Body/Stainless Steel Mandrel - Large Flange - Finish: Plain/Plain

- Accommodates oversized and irregular sized holes.
- Vibration and moisture resistant.
- Wide grip range.
- Reduces inventory.

Rivet Diameter	Rivet Body Length	Blind Side Protrusion	Grip Range	Rivet Part Number	Hole Size	Shear Strength	Tensile Strength
3/16	.425	.585	.063-.250	AD62-64SSBSLF	.192-.205	350	505
3/16	.716	.876	.126-.500	AD64-68SSBSLF	.192-.205	350	505
3/16	1.05	1.210	.438-.750	AD68-612SSBSLF	.192-.205	350	505

Multi-Grip Aluminum/Stainless Steel Rivet - 120 Degree Countersunk



Pop Rivet

5052 Aluminum Body/Stainless Steel Mandrel - 120 Degree Countersunk - Finish: Plain/Plain

- Accommodates oversized and irregular sized holes.
- Vibration and moisture resistant.
- Wide grip range.
- Reduces inventory.

Rivet Diameter	Rivet Body Length	Blind Side Protrusion	Grip Range	Rivet Part Number	Hole Size	Shear Strength	Tensile Strength
3/16	.565	.725	.126-.375	AK64-66SSBS	.192-.205	350	505

Multi-Grip Steel/Steel Rivet - Domed Head



Pop Rivet

C1002-C1010 Steel Body/Steel Mandrel - Domed Head - Finish: Zinc/Protective Coating



- Extended grip range capability.
- Mandrel Head Retention.
- Tolerant of oversized holes.
- Rattle resistant.
- Increased secondary side expansion.

Rivet Diameter	Rivet Body Length	Blind Side Protrusion	Grip Range	Rivet Part Number	Hole Size	Shear Strength	Tensile Strength
1/8	.334	.512	.059-.197	MG21-03208-210	.130-.134	270	360
1/8	.492	.669	.157-.315	MG21-03212-210	.130-.134	270	360
5/32	.413	.591	.059-.256	MG21-04010-210	.161-.165	370	540
5/32	.649	.827	.157-.472	MG21-04016-210	.161-.165	370	540
3/16	.413	.610	.059-.236	MG21-04810-210	.193-.197	607	719
3/16	.649	3846	.157-.433	MGF21-04816-210	.193-.197	607	719

Closed End Steel/Steel Rivet - Domed Head

Pop Rivet

C1002 Steel Body/Steel Mandrel - Domed Head - Finish: Zinc/Zinc

- Seals out moisture, air and other contaminants.
- Higher tensile and shear strength than the equivalent open end rivet.
- 100% mandrel head retention guaranteed.



Nominal Rivet Diameter	Nominal Rivet Body Length (H)	Grip Range	Rivet Part Number	Hole Size	Shear Strength	Tensile Strength
1/8	.382	.062-.187	SD43H	.129-.133	315	405
5/32	.040	.126-.187	SD53H	.160-.164	389	418
3/16	.362	0-.125	SD62SB	.192-.196	545	638
3/16	.488	.126-.250	SD68SB	.192-.196	545	638

Closed End Steel/Steel Rivet - 120 Degree Countersunk

Pop Rivet

C1002 Steel Body/Steel Mandrel - 120 Degree Countersunk - Finish: Zinc/Zinc

- Seals out moisture, air and other contaminants.
- Higher tensile and shear strength than the equivalent open end rivet.
- 100% mandrel head retention guaranteed.



Nominal Rivet Diameter	Nominal Rivet Body Length (H)	Grip Range	Rivet Part Number	Hole Size	Shear Strength	Tensile Strength
1/8	.295	0-.098	SK41H	.129-.133	315	405
1/8	.358	.098-.161	SK42H	.129-.133	315	405
1/8	.422	.161-.220	SK43H	.129-.133	315	405
1/8	.484	.220-.283	SK44H	.129-.133	315	405

Closed End Aluminum/Steel Rivet - Large Flange

Pop Rivet

5056 Aluminum Body/Steel Mandrel - Large Flange - Finish: Plain/Protective Coating

- Seals out moisture, air and other contaminants.
- Higher tensile and shear strength than the equivalent open end rivet.
- 100% mandrel head retention guaranteed.



Nominal Rivet Diameter	Nominal Rivet Body Length (H)	Grip Range	Rivet Part Number	Hole Size	Shear Strength	Tensile Strength
1/8	.262	0-.063	AD402SBMLF8	.129-.133	305	385
1/8	.324	.063-.125	AD404SBMLF8	.129-.133	305	385
1/8	.387	.125-.188	AD406SBMLF8	.129-.133	305	385
5/32	.332	0-.125	AD504SBMLF10	.160-.164	430	605
5/32	.394	.125-.188	AD506SBMLF10	.160-.164	430	605
5/32	.461	.188-.250	AD508SBMLF10	.160-.164	430	605
5/32	.523	.250-.309	AD510SBMLF10	.160-.164	430	605
3/16	.348	0-.125	AD604SBMLF11	.192-.196	575	840
3/16	.410	.125-.188	AD606SBMLF11	.192-.196	575	840
3/16	.473	.188-.250	AD608SBMLF11	.192-.196	575	840
3/16	.527	.250-.309	AD610SBMLF11	.192-.196	575	840
3/16	.590	.309-.371	AD612SBMLF11	.192-.196	575	840

Load Spreading Aluminum/Aluminum Rivet - Large Flange

Pop Rivet

5154 Aluminum Body/Aluminum Mandrel - Large Flange - Finish: Plain/Plain

- Splits to provide large secondary bearing surface.
- Will not crack soft or brittle materials.
- Eliminates need for backup washers.



Rivet Diameter	Rivet Body Length	Blind Side Protrusion	Grip Range	Rivet Part Number	Hole Size	Shear Strength	Tensile Strength
3/16	.690	.800	0-.250	ACD608ASMLF12	.197-.205	225	312
3/16	.787	.890	.118-.375	ACD612ASMLF12	.197-.205	225	312
3/16	.925	1.040	.197-.469	ACD616ASMLF12	.197-.205	225	312
3/16	.690	.800	0-.250	ACD608ASMLF14	.197-.205	225	312
3/16	.787	.890	.118-.375	ACD612ASMLF14	.197-.205	225	312
3/16	.925	1.040	.197-.469	ACD616ASMLF14	.197-.205	225	312

HR Steel/Steel Rivet



Pop Rivet



C1002-C1010 Steel Body/Steel Mandrel
- Finish: Zinc/Protective coating

- Excellent mandrel retention.
- Excellent rattle resistance.
- Consistent and stable clamp force.

Type	Nominal Rivet Diameter	Nominal Rivet Body Length	Nominal Blind Side Protrusion	Grip Range	Rivet Part Number	Hole Size	Shear Strength	Tensile Strength
Domed Head	1/8	.315	.440	.063-.125	SD42HR	.133-.141	325	382
Domed Head	1/8	.378	.503	.125-.187	SD43HR	.133-.141	325	382
Domed Head	1/8	.440	.566	.187-.250	SD44HR	.133-.141	325	382
Domed Head	5/32	.354	.492	.063-.125	SD52HR	.165-.173	449	584
Domed Head	5/32	.417	.555	.125-.187	SD53HR	.165-.173	449	584
Domed Head	5/32	.480	.618	.187-.250	SD54HR	.165-.173	449	584
Domed Head	3/16	.362	.531	.063-.125	SD62HR	.196-.212	696	764
Domed Head	3/16	.425	.594	.125-.187	SD63HR	.196-.212	696	764
Domed Head	3/16	.488	.657	.187-.250	SD64HR	.196-.212	696	764
Domed Head	3/16	.551	.720	.250-.312	SD65HR	.196-.212	696	764
Domed Head	1/4	.444	.624	.047-.187	SD83HR	.250-.258	876	1202
Domed Head	1/4	.570	.755	.187-.312	SD85HR	.250-.258	876	1202
Large Flange	3/16	.362	.531	.063-.125	SD62HRLF	.196-.212	696	764
Large Flange	3/16	.425	.594	.125-.187	SD63HRLF	.196-.212	696	764
Large Flange	3/16	.488	.657	.187-.250	SD64HRLF	.196-.212	696	764
Large Flange	3/16	.551	.720	.250-.312	SD65HRLF	.196-.212	696	764
Large Flange	1/4	.444	.624	.047-.187	SD83HRLF	.250-.258	876	1202
Large Flange	1/4	.570	.755	.187-.312	SD85HRLF	.250-.258	876	1202
120 Degree Countersunk	1/8	.315	.440	.078-.125	SK42HR	.133-.138	213	269
120 Degree Countersunk	1/8	.378	.503	.125-.187	SK43HR	.133-.138	213	269
120 Degree Countersunk	1/8	.440	.566	.187-.250	SK44HR	.133-.138	213	269
120 Degree Countersunk	5/32	.354	.492	.078-.125	SK52HR	.165-.169	292	449
120 Degree Countersunk	5/32	.417	.555	.125-.187	SK53HR	.165-.169	292	449
120 Degree Countersunk	5/32	.480	.618	.187-.250	SK54HR	.165-.169	292	449
120 Degree Countersunk	3/16	.425	.555	.093-.187	SK63HR	.196-.205	696	764
120 Degree Countersunk	3/16	.488	.657	.187-.250	SK64HR	.196-.205	696	764

HR Stainless Steel/Stainless Steel Rivet

Pop Rivet



HR Stainless Steel Body/Stainless Steel Mandrel - Finish: Plain/Plain

- Excellent mandrel retention.
- Excellent rattle resistance.
- Consistent and stable clamp force.

Type	Nominal Rivet Diameter	Nominal Rivet Body Length	Nominal Blind Side Protrusion	Grip Range	Rivet Part Number	Hole Size	Shear Strength	Tensile Strength
Domed Head	1/8	.315	.441	.063-.126	SSD42SSHR	.134-.142	427	562
Domed Head	1/8	.378	.503	.126-.189	SSD43SSHR	.134-.142	427	562
Domed Head	1/8	.441	.567	.189-.252	SSD44SSHR	.134-.142	427	562
Domed Head	5/32	.354	.492	.063-.126	SSD52SSHR	.165-.173	630	855
Domed Head	5/32	.417	.555	.126-.189	SSD53SSHR	.165-.173	630	855
Domed Head	5/32	.480	.618	.189-.252	SSD54SSHR	.165-.173	630	855
Domed Head	3/16	.362	.545	.063-.125	SSD62SSHR	.196-.212	1056	1124
Domed Head	3/16	.425	.610	.125-.187	SSD63SSHR	.196-.212	1056	1124
Domed Head	3/16	.488	.673	.187-.250	SSD64SSHR	.196-.212	1056	1124
120 Degree countersunk	1/8	.441	.441	.079-.125	SSK42SSHR	.134-.142	315	450
120 Degree Countersunk	1/8	.504	.504	.126-.187	SSK43SSHR	.134-.142	315	450
120 Degree Countersunk	1/8	.567	.567	.189-.252	SSK44SSHR	.134-.142	315	450
120 Degree Countersunk	3/16	.425	.555	.094-.187	SSK63SSHR	.196-.205	831	1124
120 Degree Countersunk	3/16	.488	.657	.187-.250	SSK64SSHR	.196-.205	831	1124

Self Plugger Steel/Steel Rivet



Pop Rivet

C1006-C1010 Steel Body/Steel Mandrel - Finish: Zinc/Zinc

- Mandrel remains locked in shear plain for optimum strength.
- Rattle resistant.
- Mandrel gripping rings provide optimum set.

Type	Nominal Rivet Diameter	Nominal Rivet Body Length	Nominal Blind Side Protrusion	Grip Range	Rivet Part Number	Hole Size	Shear Strength	Tensile Strength
Domed Head	1/8	.250	.452	.063-.125	SD42SP.093	.129-.133	450	350
Domed Head	1/8	.329	.528	.150-.195	SD43SP.165	.129-.133	450	350
Domed Head	1/8	.391	.590	.185-.240	SD44SP.185	.129-.133	450	350
Domed Head	1/8	.507	.706	.312-.360	SD46SP.312	.129-.133	450	350
Domed Head	5/32	.437	.669	.205-.260	SD55SP.218	.160-.164	525	500
Domed Head	5/32	.562	.794	.241-.368	SD56SP.241	.160-.164	525	500
Domed Head	3/16	.315	.612	.062-.125	SD62SP.093	.192-.196	900	700
Domed Head	3/16	.378	.668	.065-.187	SD63SP.130	.192-.196	900	700
Domed Head	3/16	.425	.693	.126-.250	ESD64SP.187	.192-.196	900	700
Domed Head	3/16	.440	.702	.181-.272	SD64SP.220	.192-.196	900	700
Domed Head	3/16	.700	.950	.376-.500	SD68SP.437	.192-.196	900	700
Domed Head	1/4	.365	.650	.062-.125	SD82SP.093	.257-.261	1750	1400
Large Flange	5/32	.300	.503	.063-.125	SD52SPLF.093	.160-.164	525	500
Large Flange	5/32	.417	.628	.129-.256	SD54SPLF.129	.160-.164	525	500
Large Flange	5/32	.525	.794	.126-.343	SD56SPLF.129	.160-.164	525	500
Large Flange	3/16	.700	.918	.407-.467	SD68SPLF.225	.192-.196	900	700
Large Flange	3/16	.442	.579	.187-.235	SD64SPRLF.187	.192-.196	900	700
Large Flange	3/16	.575	.793	.210-.327	SD65SPRLF.225	.192-.196	900	700
Large Flange	3/16	.566	.716	.188-.384	SD66SPRLF.210	.192-.196	900	700
Large Flange	3/16	.566	.716	.210-.375	SD66SPRLF.225	.192-.196	900	700

T Aluminum/Steel Rivet

Pop Rivet

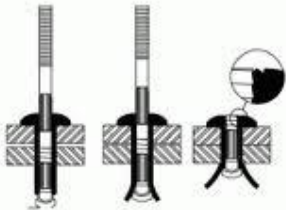

5056 Aluminum Body/Steel Mandrel - Finish: Plain/Zinc

- Provides large secondary bearing surface.
- Flush break provides high shear and tensile strength.
- Exceptional pull-up/clamp-up properties.

Type	Nominal Rivet Diameter	Nominal Rivet Body Length	Nominal Blind Side Protrusion	Grip Range	Rivet Part Number	Hole Size	Shear Strength	Tensile Strength
Domed Head	3/16	.447	.565	.032-.140	AD6140TFBS	.192-.196	950	600
Domed Head	3/16	.510	.630	.141-.187	AD6187TFBS	.192-.196	1025	600
Domed Head	3/16	.572	.690	.188-.250	AD6250TFBS	.192-.196	1050	600
Domed Head	3/16	.635	.755	.251-.312	AD6312TFBS	.192-.196	1125	600
Domed Head	3/16	.697	.820	.313-.375	AD6375TFBS	.192-.196	1200	600
Domed Head	3/16	.760	.880	.376-.437	AD6437TFBS	.192-.196	1275	600
Domed Head	3/16	.822	.940	.438-.519	AD6519TFBS	.192-.196	1350	600
Domed Head	1/4	.500	.625	.032-.140	AD8140TFBS	.257-.261	1425	1110
Domed Head	1/4	.552	.710	.141-.187	AD8187TFBS	.257-.261	1575	1110
Domed Head	1/4	.615	.775	.188-.250	AD8250TFBS	.257-.261	1650	1110
Domed Head	1/4	.677	.840	.251-.312	AD8312TFBS	.257-.261	1775	1110
Domed Head	1/4	.740	.900	.313-.375	AD8375TFBS	.257-.261	2050	1110
Domed Head	1/4	.802	.960	.376-.437	AD8437TFBS	.257-.261	2150	1110
Domed Head	1/4	.865	1.025	.437-.519	AD8519TFBS	.257-.261	2325	1110
Domed Head	1/4	.937	1.094	.520-.620	AD8620TFBS	.257-.261	2400	1110
Large Flange	3/16	.382	.500	.046-.140	AD6075TFBSLF	.192-.196	950	600
Large Flange	3/16	.447	.565	.032-.140	AD6140TFBSLF	.192-.196	950	600
Large Flange	1/4	.500	.625	.032-.140	AD8140TFBSLF	.257-.261	1425	1110

Ultra-Grip Aluminum/Aluminum Rivet



Pop Rivet

5056 Aluminum Body/Aluminum Mandrel - Finish: Plain/Plain

- High shear & tensile strength.
- Superior holding power (clamp up).
- Fastens over wide grip range.
- Locking feature prevents loosening of mandrel from vibration.

Type	Nominal Rivet Diameter	Nominal Rivet Body Length	Nominal Blind Side Protrusion	Grip Range	Rivet Part Number	Hole Size	Shear Strength	Tensile Strength
Domed Head	3/16	.413	.720	.062-.270	AD6270UG	.191-.201	700	500
Domed Head	3/16	.572	.880	.214-.437	AD6437UG	.191-.201	700	500
Domed Head	3/16	.572	1.020	.062-.437	AD6437UGX	.191-.201	700	500
Domed Head	1/4	.560	.970	.080-.375	AD8375UG	.261-.272	1300	890
100 Degree Countersunk	3/16	.486	.795	.125-.331	AK6331UG	.191-.201	700	500
100 Degree Countersunk	3/16	.653	.929	.305-.500	AK6500UG	.191-.201	700	500
100 Degree countersunk	1/4	.660	1.059	.160-.475	AK8475UG	.261-.272	1300	890

Ultra-Grip Steel/Steel Rivet

Pop Rivet



C1006-C1010 Steel Body/Steel Mandrel - Finish: Zinc/Zinc

- High shear & tensile strength.
- Superior holding power (clamp up).
- Fastens over wide grip range.
- Locking feature prevents loosening of mandrel from vibration.

Type	Nominal Rivet Diameter	Nominal Rivet Body Length	Nominal Blind Side Protrusion	Grip Range	Rivet Part Number	Hole Size	Shear Strength	Tensile Strength
Domed Head	3/16	.415	.743	.062-.270	SD6270UG	.191-.201	1450	1200
Domed Head	3/16	.582	1.011	.062-.437	SD6437UGX	.191-.201	1450	1200
Domed Head	1/4	.560	.999	.080-.375	SD8375UG	.261-.272	2750	2200
Domed Head	1/4	.810	1.220	.080-.625	SD8625UGX	.261-.272	2750	2200
Large Flange	3/16	.415	.710	.062-.270	SD6270UGLF	.191-.201	1450	1200
Large Flange	3/16	.572	.865	.214-.437	SD6437UGLF	.191-.201	1450	1200
100 Degree Countersunk	3/16	.486	.795	.125-.331	SK6331UG	.191-.201	1450	1200
100 Degree Countersunk	1/4	.660	1.059	.160-.475	SK8475UG	.261-.272	2500	1850
100 Degree Countersunk	1/4	.910	1.309	.415-.725	SK8725UG	.261-.272	2500	1850

Ultra-Grip Stainless Steel/Stainless Steel Rivet



Pop Rivet

300 Stainless Steel Body/Stainless Steel Mandrel - Finish: Plain/Plain



- High shear & tensile strength.
- Superior holding power (clamp up).
- Fastens over wide grip range.
- Locking feature prevents loosening of mandrel from vibration.

Type	Nominal Rivet Diameter	Nominal Rivet Body Length	Nominal Blind Side Protrusion	Grip Range	Rivet Part Number	Hole Size	Shear Strength	Tensile Strength
Domed Head	3/16	.415	.720	.062-.270	SSD6270UG	.191-.201	1600	1100
Domed Head	1/4	.560	.995	.080-.375	SSD8375UG	.261-.272	2500	2000
Domed Head	1/4	.810	1.245	.350-.625	SSD8625UG	.261-.272	2500	2000
Domed Head	1/4	.810	1.434	.080-.625	SSD8625UGX	.261-.272	2500	2000
100 Degree Countersunk	3/16	.486	.762	.125-.331	SSK6331UG	.191-.201	1400	1000
100 Degree Countersunk	1/4	.660	1.059	.160-.475	SSK8475UG	.261-.272	2500	2000

Multi-Grip Aluminum/Aluminum Rivet - Domed Head

Pop Rivet

1100 Aluminum Body/Aluminum Mandrel - Domed Head - Finish: Plain/Plain



- Accommodates oversized and irregular sized holes.
- Vibration and moisture resistant.
- Wide grip range.
- Reduces inventory.

Rivet Diameter	Rivet Body Length	Blind Side Protrusion	Grip Range	Rivet Part Number	Hole Size	Shear Strength	Tensile Strength
1/8	.313	.433	.039-.187	AD41-43ABS	.129-.142	65	85
1/8	.453	.573	.157-.312	AD43-45ABS	.129-.142	65	85
1/8	.594	.714	.251-.437	AD45-47ABS	.129-.142	65	85
3/16	.425	.585	.063-.250	AD62-64ABS	.192-.205	145	205
3/16	.605	.765	.188-.375	AD63-66ABS	.192-.205	145	205
3/16	.716	.876	.251-.500	AD66-68ABS	.192-.205	145	205
3/16	1.05	1.21	.438-.750	AD68-612ABS	.192-.205	145	205

HS Rivet - Domed Head

Pop Rivet

HS Rivet - Domed Head - Finish: Zinc/Protective Coating



- Structural rivet for superior shear & tensile strength.
- Increased blind side expansion for improved joint integrity.
- Excellent rattle resistance.

Type	Nominal Rivet Diameter	Nominal Rivet Body Length	Nominal Blind Side Protrusion	Grip Range	Rivet Part Number	Hole Size	Shear Strength	Tensile Strength
C1006-C1010 Steel/Steel	1/4	.449	.626	.110-.189	SD848HS	.260-.276	27000	2025
C1006-C1010 Steel/Steel	1/4	.472	.610	.134-.213	SD854HS	.260-.276	2700	2025
C1006-C1010 Steel/Steel	1/4	.528	.705	.189-.268	SD868HS	.260-.276	2700	2025
C1006-C1010 Steel/Steel	1/4	.606	.783	.268-.346	SD888HS	.260-.276	2700	2025
5056 Aluminum/Aluminum	1/4	.472	.650	.142-.220	AD856AHS	.260-.272	921	787

Multi-Grip Steel/Steel Rivet - Large Flange



Pop Rivet

C1002-C1010 Steel Body/Steel Mandrel - Large Flange - Finish: Zinc/Protective Coating



- Extended grip range capability
- Mandrel head retention.
- Tolerant of oversized holes
- Rattle resistant.
- Increased secondary side expansion.

Rivet Diameter	Rivet Body Length	Blind Side Protrusion	Grip Range	Rivet Part Number	Hole Size	Shear Strength	Tensile Strength
1/8	.334	.512	.059-.197	MG22-03208-210	.130-.134	270	360
1/8	.492	.669	.157-.315	MG22-03212-210	.130-.134	270	360
5/32	.413	.591	.059-.256	MG22-04010-210	.161-.165	370	540
5/32	.649	.827	.157-.472	MG22-04016-210	.161-.165	370	540
3/16	.413	.610	.059-.236	MG22-04810-210	.193-.197	607	719
3/16	.649	.846	.157-.433	MG22-04816-210	.193-.197	607	719

Washer (Back-Up Plates)

Pop Rivet

Washer (Back-up Plates)



Product Description	Part Number	Outside Diameter	Inside Diameter
Back-Up Plate (Steel)	SBUP1/8"	.375	.129
Back-Up Plate (Steel)	SBUP3/16"	.375	.192
Back-Up Plate (Aluminum)	ABUP1/8"	.375	.129
Back-Up Plate (Aluminum)	ABUP3/16"	.375	.192

Mushroom Plugs

Pop Rivet

Mushroom Plugs



Product Description	Part Number	Lead-in Diameter	Plug Diameter	Stem Diameter
Plug for 3/16" Aluminum Rivet	MPA61	.096	.432	.1195
Plug for 3/16" Aluminum Rivet	MPA6	.116	.432	.127



Painted Rivet



Pop Rivet

Pop is able to paint the rivets to the customer desired colors. A sample color patch is needed.



Trouble Shooting Guide

Rivet Diameter	Rivet Body Length	Blind Side Protrusion	Grip Range	Rivet Part Number	Hole Size	Shear Strength	Tensile Strength
Over Maximum recommended hole	X	X					
Under minimum recommended hole			X	X		X	X
Grip thickness over maximum			X	X			X
Grip thickness under minimum	X			X		X	
Improper Hole Control							
Excessive variation in size	X	X	X	X		X	X
Noncircular hole	X	X	X	X			X
Tapered hole	X	X	X	X			X
Burrs and sharp edges	X	X	X	X			X
Applicable material too soft	X	X	X				
Non-perpendicular set	X	X	X	X	X	X	X
Wrong nosepiece on tooling	X	X		X			
Gap between material thicknesses	X	X	X	X	X		
Insufficient secondary side clearance				X	X		



5056 Aluminum/Steel Rivet



Surebonder Rivet

5056 Aluminum Body/Carbon Steel Zinc Plated Mandrel

Nominal Body Diameter	Part Number	Grip Range	Hole Size and Drill No.	Body Length	Typical Shear Min.	Typical Tensile Min.	Type
3/32	ADS32	.020-.125	.097-.100 #41	.236	90	120	Domed Head
3/32	ADS34	.126-.250	.097-.100 #41	.362	90	120	Domed Head
1/8	ADS41	.020-.062	.129-.133 #30	.201	170	220	Domed Head
1/8	ADS42	.063-.125	.129-.133 #30	.264	170	220	Domed Head
1/8	ADS43	.126-.187	.129-.133 #30	.323	170	220	Domed Head
1/8	ADS44	.126-.250	.129-.133 #30	.390	170	220	Domed Head
1/8	ADS45	.251-.312	.129-.133 #30	.449	170	220	Domed Head
1/8	ADS46	.251-.375	.129-.133 #30	.512	170	220	Domed Head
1/8	ADS48	.376-.500	.129-.133 #30	.638	170	220	Domed Head
1/8	ADS410	.501-.625	.129-.133 #30	.764	170	220	Domed Head
5/32	ADS52	.020-.125	.160-.164 #20	.287	260	350	Domed Head
5/32	ADS53	.126-.187	.160-.164 #20	.350	260	350	Domed Head
5/32	ADS54	.188-.250	.160-.164 #20	.413	260	350	Domed Head
5/32	ADS56	.251-.375	.160-.164 #20	.535	260	350	Domed Head
5/32	ADS58	.376-.500	.160-.164 #20	.661	260	350	Domed Head
3/16	ADS62	.020-.125	.192-.196 #11	.315	380	500	Domed Head
3/16	ADS64	.126-.250	.192-.196 #11	.437	380	500	Domed Head
3/16	ADS66	.251-.375	.192-.196 #11	.563	380	500	Domed Head
3/16	ADS68	.376-.500	.192-.196 #11	.689	380	500	Domed Head
3/16	ADS610	.501-.625	.192-.196 #11	.815	380	500	Domed Head
3/16	ADS612	.626-.750	.192-.196 #11	.937	380	500	Domed Head
3/16	ADS614	.751-.875	.192-.196 #11	1.063	380	500	Domed Head
3/16	ADS616	.876-1.000	.192-.196 #11	1.189	380	500	Domed Head
1/4	ADS84	.063-.250	.257-.261 F	.488	700	920	Domed Head
1/4	ADS86	.251-.375	.257-.261 F	.610	700	920	Domed Head
1/4	ADS88	.376-.500	.257-.261 F	.736	700	920	Domed Head
1/4	ADS810	.501-.625	.257-.261 F	.862	700	920	Domed Head
1/4	ADS812	.626-.750	.257-.261 F	.988	700	920	Domed Head
1/4	ADS814	.751-.875	.257-.261 F	1.110	700	920	Domed Head
1/4	ADS816	.876-1.000	.257-.261 F	1.236	700	920	Domed Head
1/8	ADSLF42	.063-.125	.129-.133 #30	.264	170	220	Large Flange
1/8	ADSLF43	.126-.187	.129-.133 #30	.323	170	220	Large Flange
1/8	ADSLF44	.126-.250	.129-.133 #30	.390	170	220	Large Flange
1/8	ADSLF46	.251-.375	.129-.133 #30	.512	170	220	Large Flange
5/32	ADSLF54	.126-.250	.160-.164 #20	.413	260	350	Large Flange
3/16	ADSLF64	.126-.250	.192-.196 #11	.437	380	500	Large Flange
3/16	ADSLF66	.251-.375	.192-.196 #11	.563	380	500	Large Flange
3/16	ADSLF68	.376-.500	.192-.196 #11	.689	380	500	Large Flange
3/16	ADSLF610	.501-.625	.192-.196 #11	.815	380	500	Large Flange
3/16	ADSLF612	.626-.750	.192-.196 #11	.937	380	500	Large Flange
3/16	ADSLF614	.751-.875	.192-.196 #11	1.063	380	500	Large Flange
3/16	ADSLF616	.876-1.000	.192-.196 #11	1.189	380	500	Large Flange
1/8	AKS42	.092-.125	.129-.133 #30	.264	170	220	120 Degree Countersunk
1/8	AKS43	.126-.187	.129-.133 #30	.323	170	220	120 Degree Countersunk
1/8	AKS44	.126-.250	.129-.133 #30	.390	170	220	120 Degree Countersunk
5/32	AKS54	.126-.250	.160-.164 #20	.413	260	350	120 Degree Countersunk
3/16	AKS64	.126-.250	.192-.196 #11	.437	380	500	120 Degree Countersunk

Rivets

5052 Aluminum/Aluminum Rivet



Surebonder Rivet

5052 Aluminum Body/Aluminum Mandrel

Nominal Body Diameter	Part Number	Grip Range	Hole Size and Drill No.	Body Length	Typical Shear Min.	Typical Tensile Min.	Type
3/32	ADA32	.020-.125	.097-.100 #41	.236	70	80	Domed Head
3/32	ADA34	.126-.250	.097-.100 #41	.362	70	80	Domed Head
3/32	ADA36	.251-.75	.097-.100 #41	.488	70	80	Domed Head
1/8	ADA41	.020-.062	.129-.133 #30	.201	120	150	Domed Head
1/8	ADA42	.063-.125	.129-.133 #30	.264	120	150	Domed Head
1/8	ADA43	.126-.187	.129-.133 #30	.323	120	150	Domed Head
1/8	ADA44	.188-.250	.129-.133 #30	.390	120	150	Domed Head
1/8	ADA45	.251-.312	.129-.133 #30	.449	120	150	Domed Head
1/8	ADA46	.313-.375	.129-.133 #30	.512	120	150	Domed Head
1/8	ADA48	.376-.500	.129-.133 #30	.638	120	150	Domed Head
1/8	ADA410	.501-.625	.129-.133 #30	.764	120	150	Domed Head
5/32	ADA52	.020-.125	.160-.164 #20	.287	190	230	Domed Head
5/32	ADA53	.126-.187	.160-.164 #20	.350	190	230	Domed Head
5/32	ADA54	.188-.250	.160-.164 #20	.413	190	230	Domed Head
5/32	ADA56	.251-.375	.160-.164 #20	.535	190	230	Domed Head
5/32	ADA58	.376-.500	.160-.164 #20	.661	190	230	Domed Head
5/32	ADA512	.626-.750	.160-.164 #20	.886	190	230	Domed Head
3/16	ADA62	.020-.125	.192-.196 #11	.315	260	320	Domed Head
3/16	ADA64	.126-.250	.192-.196 #11	.437	260	320	Domed Head
3/16	ADA66	.251-.375	.192-.196 #11	.563	260	320	Domed Head
3/16	ADA68	.376-.500	.192-.196 #11	.689	260	320	Domed Head
3/16	ADA610	.501-.625	.192-.196 #11	.815	260	320	Domed Head
3/16	ADA612	.626-.750	.192-.196 #11	.937	260	320	Domed Head
3/16	ADA614	.751-.875	.192-.196 #11	1.063	260	320	Domed Head
3/16	ADA616	.876-1.000	.192-.196 #11	1.189	260	320	Domed Head
1/4	ADA84	.063-.250	.257-.261 F	.488	460	560	Domed Head
1/4	ADA86	.251-.375	.257-.261 F	.610	460	560	Domed Head
1/4	ADA88	.376-.500	.257-.261 F	.736	460	560	Domed Head
1/4	ADA810	.501-.625	.257-.261 F	.862	460	560	Domed Head
1/4	ADA812	.626-.750	.257-.261 F	.988	460	560	Domed Head
1/4	ADA814	.751-.875	.257-.261 F	1.110	460	560	Domed Head
1/4	ADA816	.876-1.000	.257-.261 F	1.236	460	560	Domed Head
1/8	ADALF42	.063-.125	.129-.133 #30	.264	120	150	Large Flange
1/8	ADALF44	.126-.250	.129-.133 #30	.390	120	150	Large Flange
1/8	ADALF46	.251-.375	.129-.133 #30	.512	120	150	Large Flange
1/8	ADALF48	.376-.500	.129-.133 #30	.638	120	150	Large Flange
5/32	ADALF54	.126-.250	.160-.164 #20	.413	190	220	Large Flange
5/32	ADALF56	.251-.375	.160-.164 #20	.535	190	220	Large Flange
5/32	ADALF58	.376-.500	.160-.164 #20	.661	190	220	Large Flange
3/16	ADALF64	.126-.250	.192-.196 #11	.437	260	320	Large Flange
3/16	ADALF66	.251-.375	.192-.196 #11	.563	260	320	Large Flange
3/16	ADALF68	.376-.500	.192-.196 #11	.689	260	320	Large Flange
3/16	ADALF610	.501-.625	.192-.196 #11	.815	260	320	Large Flange
3/16	ADALF612	.626-.750	.192-.196 #11	.937	260	320	Large Flange
1/8	AKA42	.092-.125	.129-.133 #30	.264	120	150	120 Degree Countersunk
1/8	AKA43	.126-.187	.129-.133 #30	.323	120	150	120 Degree Countersunk
1/8	AKA44	.126-.250	.129-.133 #30	.390	120	150	120 Degree Countersunk
5/32	AKA54	.126-.250	.160-.164 #20	.413	190	230	120 Degree Countersunk
3/16	AKA64	.188-.250	.192-.196 #11	.437	260	320	120 Degree Countersunk



Steel/Steel Rivet



Surebonder Rivet

1006 Carbon Steel Body/1042 Carbon Steel Zinc Plated Mandrel

Nominal Body Diameter	Part Number	Grip Range	Hole Size and Drill No.	Body Length	Typical Shear Min.	Typical Tensile Min.	Type
3/32	SDS32	.032-.125	.097-.100 #41	.245	146	157	Domed Head
3/32	SDS34	.126-.250	.097-.100 #41	.369	146	157	Domed Head
1/8	SDS41	.032-.062	.129-.133 #30	.198	247	269	Domed Head
1/8	SDS42	.063-.125	.129-.133 #30	.270	247	269	Domed Head
1/8	SDS43	.126-.187	.129-.133 #30	.331	247	269	Domed Head
1/8	SDS44	.126-.250	.129-.133 #30	.387	247	269	Domed Head
1/8	SDS45	.251-.312	.129-.133 #30	.455	247	269	Domed Head
1/8	SDS46	.251-.375	.129-.133 #30	.518	247	269	Domed Head
1/8	SDS48	.376-.500	.129-.133 #30	.643	247	269	Domed Head
1/8	SDS410	.501-.625	.129-.133 #30	.770	247	269	Domed Head
5/32	SDS52	.063-.125	.160-.164 #20	.293	382	494	Domed Head
5/32	SDS53	.126-.187	.160-.164 #20	.355	382	494	Domed Head
5/32	SDS54	.126-.250	.160-.164 #20	.418	382	494	Domed Head
5/32	SDS56	.251-.375	.160-.164 #20	.545	382	494	Domed Head
5/32	SDS58	.376-.500	.160-.164 #20	.668	382	494	Domed Head
5/32	SDS510	.501-.625	.160-.164 #20	.793	382	494	Domed Head
3/16	SDS62	.063-.125	.192-.196 #11	.320	651	696	Domed Head
3/16	SDS63	.126-.187	.192-.196 #11	.378	651	696	Domed Head
3/16	SDS64	.126-.250	.192-.196 #11	.441	651	696	Domed Head
3/16	SDS66	.251-.375	.192-.196 #11	.568	651	696	Domed Head
3/16	SDS68	.376-.500	.192-.196 #11	.696	651	696	Domed Head
3/16	SDS610	.501-.625	.192-.196 #11	.822	651	696	Domed Head
3/16	SDS612	.626-.750	.192-.196 #11	.942	651	696	Domed Head
3/16	SDS614	.751-.875	.192-.196 #11	1.070	651	696	Domed Head
3/16	SDS616	.751-1.000	.192-.196 #11	1.195	651	696	Domed Head
1/4	SDS84	.063-.250	.257-.260 F	.495	1101	1281	Domed Head
1/4	SDS86	.251-.375	.257-.261 F	.620	1101	1281	Domed Head
1/4	SDS88	.376-.500	.257-.261 F	.746	1101	1281	Domed Head
1/4	SDS810	.501-.625	.257-.261 F	.869	1101	1281	Domed Head
1/4	SDS812	.626-.750	.257-.261 F	.996	1101	1281	Domed Head
1/4	SDS814	.751-.875	.257-.261 F	1.119	1101	1281	Domed Head
1/4	SDS816	.876-1.000	.257-.261 F	1.246	1101	1281	Domed Head
1/8	SDSLF42	.063-.125	.129-.133 #30	.269	247	269	Large Flange
1/8	SDSLF43	.126-.187	.129-.133 #30	.332	247	269	Large Flange
1/8	SDSLF44	.126-.250	.129-.133 #30	.386	247	269	Large Flange
1/8	SDSLF46	.251-.375	.129-.133 #30	.519	247	269	Large Flange
1/8	SDSLF48	.376-.500	.129-.133 #30	.647	247	269	Large Flange
5/32	SDSLF53	.126-.187	.160-.164 #20	.356	382	494	Large Flange
5/32	SDSLF54	.126-.250	.160-.164 #20	.419	382	494	Large Flange
3/16	SDSLF62	.063-.125	.192-.196 #11	.319	651	696	Large Flange
3/16	SDSLF64	.126-.250	.192-.196 #11	.442	651	696	Large Flange
3/16	SDSLF66	.251-.375	.192-.196 #11	.569	651	696	Large Flange
3/16	SDSLF68	.376-.500	.192-.196 #11	.696	651	696	Large Flange
3/16	SDSLF610	.501-.625	.192-.196 #11	.821	651	696	Large Flange
3/16	SDSLF612	.626-.750	.192-.196 #11	.941	651	696	Large Flange
1/4	SDSLF84	.063-.250	.257-.261 F	.475	1101	1281	Large Flange
1/4	SDSLF86	.251-.375	.257-.261 F	.600	1101	1281	Large Flange
1/4	SDSLF88	.376-.500	.257-.261 F	.746	1101	1281	Large Flange
1/4	SDSLF810	.501-.625	.257-.261 F	.850	1101	1281	Large Flange
1/4	SDSLF812	.626-.750	.257-.261 F	.994	1101	1281	Large Flange
1/4	SDSLF816	.876-1.000	.257-.261 F	1.247	1101	1281	Large Flange
1/8	SKS42	.063-.125	.129-.133 #30	.271	247	269	120 Degree Countersunk
1/8	SKS43	.126-.187	.129-.133 #30	.332	247	269	120 Degree Countersunk
1/8	SKS44	.126-.250	.129-.133 #30	.397	247	269	120 Degree Countersunk
5/32	SKS54	.126-.250	.160-.164 #20	.420	382	494	120 Degree Countersunk
3/16	SKS62	.063-.125	.192-.196 #11	.300	651	696	120 Degree Countersunk
3/16	SKS63	.126-.187	.192-.196 #11	.376	651	696	120 Degree Countersunk
3/16	SKS64	.126-.250	.192-.196 #11	.441	651	696	120 Degree Countersunk
3/16	SKS66	.251-.375	.192-.196 #11	.567	651	696	120 Degree Countersunk

Rivets



Stainless Steel/Stainless Steel Rivet



Surebonder Rivet

300 Series Stainless Steel Body/Stainless Steel Mandrel

Nominal Body Diameter	Part Number	Grip Range	Hole Size and Drill No.	Body Length	Typical Shear Min.	Typical Tensile Min.	Type
1/8	SSDSS42	.063-.125	.129-.133 #30	.255	420	530	Domed Head
1/8	SSDSS43	.126-.187	.129-.133 #30	.317	420	530	Domed Head
1/8	SSDSS44	.126-.250	.129-.133 #30	.380	420	530	Domed Head
1/8	SSDSS46	.251-.375	.129-.133 #30	.505	420	530	Domed Head
1/8	SSDSS48	.376-.500	.129-.133 #30	.630	420	530	Domed Head
5/32	SSDSS52	.020-.125	.160-.164 #20	.280	650	820	Domed Head
5/32	SSDSS54	.188-.250	.160-.164 #20	.405	650	820	Domed Head
5/32	SSDSS56	.251-.375	.160-.164 #20	.530	650	820	Domed Head
3/16	SSDSS62	.020-.125	.192-.196 #11	.305	950	1200	Domed Head
3/16	SSDSS64	.188-.250	.192-.196 #11	.430	950	1200	Domed Head
3/16	SSDSS66	.251-.375	.192-.196 #11	.555	950	1200	Domed Head
3/16	SSDSS68	.376-.500	.192-.196 #11	.680	950	1200	Domed Head
1/8	SSKSS42	.092-.125	.129-.133 #30	.255	420	530	120 Degree Countersunk
1/8	SSDSSLF42	.063-.125	.129-.133 #30	.255	420	530	Large Flange
1/8	SSDSSLF43	.126-.187	.129-.133 #30	.317	420	530	Large Flange
1/8	SSDSSLF44	.188-.250	.129-.133 #30	.380	420	530	Large Flange
3/16	SSDSSLF64	.188-.250	.192-.196 #11	.430	950	1200	Large Flange
3/16	SSDSSLF66	.251-.375	.192-.196 #11	.555	950	1200	Large Flange



Copper/Brass Rivet

Surebonder Rivet

Copper Body/Yellow Brass Mandrel

Nominal Body Diameter	Part Number	Grip Range	Hole Size and Drill No.	Body Length	Typical Shear Min.	Typical Tensile Min.	Type
1/8	CDB42	.020-.125	.129-.133 #30	.264	215	300	Domed Head
1/8	CDB43	.126-.187	.129-.133 #30	.323	215	300	Domed Head
1/8	CDB44	.188-.250	.129-.133 #30	.390	215	300	Domed Head

Aluminum/Stainless Steel Closed End Rivet



Surebonder Rivet

5056 Aluminum Body/304 Stainless Steel Mandrel

Nominal Body Diameter	Part Number	Grip Range	Hole Size and Drill No.	Body Length	Typical Shear Min.	Typical Tensile Min.	Type
3/16	ADSSH64	.126-.250	.192-.196 #11	.452	575	840	Domed Head
3/16	ADSSH66	.251-.375	.192-.196 #11	.590	575	840	Domed Head
3/16	ADSSH68	.376-.500	.192-.196 #11	.709	575	840	Domed Head
3/16	AKSSH64	.126-.250	.192-.196 #11	.520	575	840	120 Degree Countersunk



Aluminum/Steel Closed End Rivet



Surebonder Rivet

5056 Aluminum Body/Carbon Steel Zinc Plated Mandrel

Nominal Body Diameter	Part Number	Grip Range	Hole Size and Drill No.	Body Length	Typical Shear Min.	Typical Tensile Min.	Type
1/8	ADSH42	.063-.125	.129-.133 #30	.295	305	385	Domed Head
1/8	ADSH43	.126-.187	.129-.133 #30	.354	305	385	Domed Head
1/8	ADSH44	.188-.250	.129-.133 #30	.433	305	385	Domed Head
1/8	ADSH46	.3130-.375	.129-.133 #30	.551	305	385	Domed Head
1/8	ADSH48	.376-.500	.129-.133 #30	.669	305	385	Domed Head
5/32	ADSH53	.126-.187	.160-.164 #20	.374	430	605	Domed Head
5/32	ADSH54	.126-.250	.160-.164 #20	.452	430	605	Domed Head
3/16	ADSH62	.063-.125	.192-.196 #11	.335	575	840	Domed Head
3/16	ADSH64	.126-.250	.192-.196 #11	.452	575	840	Domed Head
3/16	ADSH66	.251-.375	.192-.196 #11	.591	575	840	Domed Head
3/16	ADSH68	.376-.500	.192-.196 #11	.709	575	840	Domed Head
1/4	ADSH84	.126-.250	.257-.261 F	.520	900	1100	Domed Head
1/4	ADSH86	.251-.375	.257-.261 F	.650	900	1100	Domed Head
1/8	AKSH41	.031-.062	.129-.133 #30	.277	305	385	120 Degree Countersunk
1/8	AKSH42	.063-.125	.129-.133 #30	.335	305	385	120 Degree Countersunk
1/8	AKSH43	.126-.187	.129-.133 #30	.410	305	385	120 Degree Countersunk
1/8	AKSH44	.188-.250	.129-.133 #30	.472	305	385	120 Degree Countersunk
1/8	AKSH45	.251-.312	.129-.133 #30	.530	305	385	120 Degree Countersunk
5/32	AKSH53	.126-.187	.160-.164 #20	.433	430	605	120 Degree Countersunk
3/16	AKSH64	.126-.250	.192-.196 #11	.520	575	840	120 Degree Countersunk
3/16	AKSH66	.251-.375	.192-.196 #11	.650	575	840	120 Degree Countersunk

Rivets



Aluminum/Aluminum Closed End Rivet

Surebonder Rivet

5052 Aluminum Body/Aluminum Mandrel

Nominal Body Diameter	Part Number	Grip Range	Hole Size and Drill No.	Body Length	Typical Shear Min.	Typical Tensile Min.	Type
1/8	ADAH42	.063-.125	.129-.133 #30	.295	105	150	Domed Head
1/8	ADAH43	.126-.187	.129-.133 #30	.354	105	150	Domed Head
1/8	ADAH44	.188-.250	.129-.133 #30	.433	105	150	Domed Head
5/32	ADAH53	.126-.187	.160-.164 #20	.374	155	240	Domed Head
5/32	ADAH54	.188-.250	.160-.164 #20	.452	155	240	Domed Head
5/32	ADAH55	.251-.312	.160-.164 #20	.512	155	240	Domed Head
3/16	ADAH62	.063-.125	.192-.196 #11	.334	220	310	Domed Head
3/16	ADAH64	.126-.250	.192-.196 #11	.452	220	310	Domed Head
3/16	ADAH66	.251-.375	.192-.196 #11	.591	220	310	Domed Head
3/16	ADAH68	.376-.500	.192-.196 #11	.707	220	310	Domed Head
3/16	ADAH612	.501-.750	.192-.196 #11	.965	220	310	Domed Head



Stainless Steel/Stainless Steel Closed End Rivet



Surebonder Rivet

304 Stainless Steel Body/420 Stainless Steel Mandrel

Nominal Body Diameter	Part Number	Grip Range	Hole Size and Drill No.	Body Length	Typical Shear Min.	Typical Tensile Min.	Type
1/8	SSDSSH43	.126-.187	.129-.133 #30	.374	495	495	Domed Head
5/32	SSDSSH53	.126-.187	.160-.164 #20	.392	785	899	Domed Head
3/16	SSDSSH62	.020-.125	.192-.196 #11	.353	963	989	Domed Head
3/16	SSDSSH64	.189-.250	.192-.196 #11	.492	963	989	Domed Head

Aluminum/Aluminum Expandable Rivet



Surebonder Rivet

5052 Aluminum Body/5052 Aluminum Mandrel

Nominal Body Diameter	Part Number	Grip Range	Hole Size and Drill No.	Body Length	Typical Shear Min.	Typical Tensile Min.	Type
1/8	ADAE44	.019-.250	.129-.133 #30		123	202	Domed Head
1/8	ADAE46	.019-.375	.129-.133 #30		123	202	Domed Head
5/32	ADAE54	.039-.275	.160-.164 #20		134	224	Domed Head
5/32	ADAE56	.039-.275	.160-.164 #20		134	224	Domed Head
3/16	ADAE64	.019-.157	.192-.196 #11		179	247	Domed Head
3/16	ADAE66	.187-.375	.192-.196 #11		179	247	Domed Head
3/16	ADAE68	.197-.472	.192-.196 #11		179	247	Domed Head

Aluminum/Aluminum Multi-Grip Rivet



Surebonder Rivet

5050 Aluminum Body/Aluminum Mandrel Multi-Grip rivet

Nominal Body Diameter	Part Number	Grip Range	Hole Size and Drill No.	Body Length	Typical Shear Min.	Typical Tensile Min.	Type
1/8	ADAMG4244	.062-.250	.129-.142 #30	.437	112	157	Domed Head
1/8	ADAMG4345	.157-.312	.129-.142 #30	.460	112	157	Domed Head
3/16	ADAMG6264	.063-.250	.192-.205 #11	.450	269	382	Domed Head
3/16	ADAMG6366	.187-.375	.192-.205 #11	.605	269	382	Domed Head



Aluminum/Steel Multi-Grip Rivet



Surebonder Rivet

5052 Aluminum Body/Steel Mandrel

Nominal Body Diameter	Part Number	Grip Range	Hole Size and Drill No.	Body Length	Typical Shear Min.	Typical Tensile Min.	Type
1/8	ADSMG4143	.039-.187	.129-.142 #30	.313	112	157	Domed Head
1/8	ADSMG4244	.062-.250	.129-.142 #30	.427	112	157	Domed Head
1/8	ADSMG4345	.157-.312	.129-.142 #30	.453	112	157	Domed Head
1/8	ADSMG4547	.251-.437	.129-.142 #30	.597	112	157	Domed Head
5/32	ADSMG5254	.047-.250	.160-.173 #20	.407	191	269	Domed Head
3/16	ADSMG6264	.063-.250	.192-.205 #11	.429	269	382	Domed Head
3/16	ADSMG6366	.188-.375	.192-.205 #11	.594	269	382	Domed Head
3/16	ADSMG6668	.251-.500	.192-.205 #11	.716	269	382	Domed Head
3/16	ADSMG6861 2	.438-.750	.192-.205 #11	1.050	269	382	Domed Head
1/4	ADSMG8286	.080-.375	.257-.261 F	.598	494	708	Domed Head
1/8	ADSLFMG41 43	.039-.187	.129-.142 #30	.316	112	157	Large Flange
1/8	ADSLDMG42 44	.062-.250	.129-.142 330	.426	112	157	Large Flange
5/32	ADSLFMG52 54	.047-.250	.160-.173 #20	.404	191	269	Large Flange
3/16	ADSLFMG62 64	.063-.250	.192-.205 #11	.435	269	382	Large Flange
3/16	ADSLFMG63 66	.188-.375	.192-.205 #11	.605	269	382	Large Flange
3/16	ADSLFMG66 68	.251-.500	.192-.205 #11	.716	269	382	Large Flange
3/16	ADSLFMG68 612	.438-.750	.192-.205 #11	1.050	269	382	Large Flange
1/8	AKSMG4244	.062-.250	.129-.142 #30	.428	112	157	120 Degree Countersunk
3/16	AKSMG6264	.063-.250	.192-.205 #11	.425	269	382	120 Degree Countersunk
3/16	AKSMG6668	.251-.500	.192-.205 #11	.716	269	382	120 Degree Countersunk

Steel/Steel Multi-Grip Rivet



Surebonder Rivet

1006/1042 Carbon Steel Body/1006/1042 Carbon Steel Mandrel

Multi-Grip Rivet

Nominal Body Diameter	Part Number	Grip Range	Hole Size and Drill No.	Body Length	Typical Shear Min.	Typical Tensile Min.	Type
1/8	SDSMG4244	.062-.250	.129-.142 #30	.427	247	269	Domed Head
5/32	SDSMG5254	.047-.250	.160-.173 #20	.404	382	494	Domed Head
3/16	SDSMG6264	.063-.250	.192-.205 #11	.434	651	696	Domed Head



Aluminum/Aluminum High Strength Structural Rivet



Surebonder Rivet

5056 Aluminum Body/Aluminum Mandrel High Strength Structural Rivet

Nominal Body Diameter	Part Number	Grip Range	Hole Size and Drill No.	Body Length	Typical Shear Min.	Typical Tensile Min.	Type
3/16	ADA-HS-64	.062-.270	.193-.201 #11	.394	518	428	Domed Head
3/16	ADA-HS-67X	.062-.437	.193-.205 311	.551	518	428	Domed Head
1/4	ADA-HS-86	.080-.375	.260-.276 F	.551	1193	765	Domed Head
1/4	ADA-HS-810X	.080-.625	.260-.279 F	.748	1193	765	Domed Head

Steel/Steel High Strength Structural Rivet



Surebonder Rivet

Steel Body/Carbon Steel Zinc Plated Mandrel High Strength Structural Rivet

Nominal Body Diameter	Part Number	Grip Range	Hole Size and Drill No.	Body Length	Typical Shear Min.	Typical Tensile Min.	Type
3/16	SDS-HS-64	.062-.270	.191-.201 #11	.415	1281	989	Domed Head
3/16	SDS-HS-67X	.062-.437	.191-.201 #11	.551	1281	989	Domed Head
1/4	SDS-HS-86	.080-.375	.261-.272 F	.553	2383	1798	Domed Head
1/4	SDS-HS-810X	.080-.625	.261-.272 F	.788	2383	1798	Domed Head
3/16	SKS-HS-67X	.062-.437	.191-.201 #11	.551	1281	989	120 Degree Countersunk

Stainless Steel/Stainless Steel High Strength Structural Rivet



Surebonder Rivet

302HQ Stainless Steel Body/304HC Stainless Steel, Passivated and Brite Finish Mandrel High Strength Structural Rivet

Nominal Body Diameter	Part Number	Grip Range	Hole Size and Drill No.	Body Length	Typical Shear Min.	Typical Tensile Min.	Type
3/16	SSDSS-HS-64	.062-.270	.191-.201 #11	.394	1350	1013	Domed Head
3/16	SSDSS-HS-67X	.062-.437	.191-.201 #11	.551	1350	1013	Domed Head
1/4	SSDSS-HS-86	.080-.375	.261-.272 F	.551	2363	1890	Domed Head
1/4	SSDSS-HS-810X	.080-.625	.261-.272 F	.748	2363	1890	Domed Head

Steel/Steel Surebonder Lock Rivet



Surebonder Rivet



1035 Carbon Steel Body/1035 Carbon Steel Zinc Plated Mandrel

Rivet Diameter	Rivet Body Length	Blind Side Protrusion	Grip Range	Rivet Part Number	Hole Size	Shear Strength	Tensile Strength
1/4	SDS-SL-0812	.059-.138	.264-.272 F	.394	2250	1175	Domed Head
1/4	SDS-SL-0813	.110-.189	.264-.279 F	.449	2475	1175	Domed Head
1/4	SDS-SL-0814	.132-.211	.264-.280 F	.472	2700	1175	Domed Head
1/4	SDS-SL-0815	.189-.268	.264-.280 F	.524	2812	1175	Domed Head
1/4	SDS-SL-0817	.268-.346	.264-.281 F	.598	2925	1175	Domed Head
1/4	SDS-SL-0818	.295-.374	.264-.281 F	.630	3150	1175	Domed Head
1/4	SDS-SL-0821	.425-.504	.264-.282 F	.756	3375	1175	Domed Head



Washer/Back-Up Plate

Surebonder

Back-up washers are recommended when the materials being riveted are too soft (plastics) or have irregular hole sizes or shapes (slotted holes or ejector pin holes). Available in aluminum with mill finish or steel with zinc plating.

Part Number	Rivet Diameter	Material	Outside Diameter	Inside Diameter	Thickness
WASA4	1/8	Aluminum	.375	.129+-.003	.058+-.003
WASA6	3/16	Aluminum	.375	.194+-.003	.058+-.003
WASA4-1/2	1/8	Aluminum	.500	.129+-.003	.058+-.003
WASA6-1/2	3/16	Aluminum	.500	.194+-.003	.058+-.003
WASS4	1/8	Steel	.375	.129+-.003	.058+-.003
WASS6	3/16	Steel	.375	.194+-.003	.058+-.003
WASS6-1/2	3/16	Steel	.500	.194+-.003	.058+-.003

Rivets

RT120HP

Rivedrill



The patented drill attachment that easily converts cordless, electric and pneumatic drills into blind rivet guns. This innovative new tool allows operators to set up to 14 rivets per minute - twice as many as can be set by standard hand tools. And the new RiveDrill is also ergonomically friendly, requiring just 6.6 pounds of pressure to operate, compared to 77.2 pounds required for hand tool operation.

LOBSTER TOOLS

Lobster

- ARV-022M - Riveting capacity: 3/32", 1/8", 5/32" and 3/16".
- AR-022M - Riveting capacity: 3/32", 1/8", 5/32" and 3/16". Same as ARV-022M but without the vacuum mandrel collection system.
- ARV-025M - Riveting capacity: 3/32", 1/8", 5/32", and 3/16".
- ARV-015M - Riveting capacity - 3/32", 1/8", 5/32" and 3/16".
- R1B1 - Cordless riveter, riveting capacity: 3/32", 1/8", 5/32" and 3/16".
- AN-200A - Air rivet nut setter.



FPC835M Rivet Tool

Surebonder Tool

Our light weight, low noise, heavy duty air pneumatic rivet tools feature a removable mandrel collection system that collects spent mandrels keeping the work area safe and clean. Adjustable vacuum securely holds the rivet in the nosepiece even when the tool is pointed downward. The innovative 3 piece jaw design insures a better grip and release of rivet mandrel. Constructed of lightweight aluminum for less user fatigue. Models also feature a left or right, ON/OFF swivel air fitting providing additional flexibility, conserving energy and reducing operating costs. Easy maintenance with long lasting seals. Includes carrying case, wrenches, oil, syringe & nosepieces.



- Weight: 3lbs.
- Rivet diameter capacity: 3/32", 1/8", 5/32", 3/16"
- Stroke: .787"
- Air pressure: 75 to 100 PSI
- Includes: 3/32", 1/8", 5/32" & 3/16" nosepieces.
- Pulling force: 1872 lbs.

FPC845M

Surebonder Tool

Our light weight, low noise, heavy duty air pneumatic rivet tools feature a removable mandrel collection system that collects spent mandrels keeping the work area safe and clean. Adjustable vacuum securely holds the rivet in the nosepiece even when the tool is pointed downward. The innovative 3 piece jaw design insures a better grip and release of rivet mandrel. Constructed of lightweight aluminum for less user fatigue. Models also feature a left or right, ON/OFF swivel air fitting providing additional flexibility, conserving energy and reducing operating costs. Easy maintenance with long lasting seals. Includes carrying case, wrenches, oil, syringe & nosepieces.

- Weight: 4 lbs
- Rivet diameter capacity: 3/16", 1/4"
- Stroke: 1"
- Air pressure: 75 to 100 PSI
- Includes: 3/16" & 1/4" nosepieces
- Pulling force: 3414 lbs



8500 Rivet Tool

Surebonder Hand Tool

An economical rivet tool with slim nose design to fit into tight places. Heavy duty steel construction.

- Sets: 3/32", 1/8", 5/32", 3/16", blind rivets.



8500 Professional Rivet Tool

Surebonder Hand Tool

The most popular contractor tool. Heavy duty steel construction.

- Sets: 3/32", 1/8", 5/32", 3/16", blind rivets.



8700 Swivel Rivet Tool

Surebonder Hand Tool

Swivel head design rotates 360 degree for easy access in tight places. Rugged die cast steel construction.

- Sets: 3/32", 1/8", 5/32", 3/16", blind rivets.



8575 Rivet Tool Kit

Surebonder Hand Tool

A convenient rivet tool kit that includes 60 aluminum rivets.

- Sets: 3/32", 1/8", 5/32", 3/16", rivets - 1/8 grip.





8800 Long Handle Rivet Tool



Surebonder Hand Tool

An economical rivet tool with long handles for increased leverage.

- Sets: 1/8", 5/32", 3/16" rivets.

707 Kit Long Handle Rivet Tool

Surebonder Hand Tool

Rugged long-handled rivet tool that easily sets larger diameter rivets. Carrying case included.

- Sets: 3/32", 1/8", 5/32", 3/16", 1/4" rivets.



8808 Lazy tong Rivet Tool



Surebonder Hand Tool

Durable, dependable hand tool with lattice levering design. Ideal for applications where lateral space is limited.

- Sets: 1/8", 5/32", 3/16", 1/4" rivets.

A-L Series Inserts



AVK Inserts



The A-L series insert is AVK's most versatile product that can be installed into drilled or punched holes in most any material. The A-L series knurled threaded insert features a knurled body and large diameter-low profile head making it ideal for use in punched or drilled holes. It offers the highest all around strength characteristics and has been designed to be used with grade 5 or metric 8.8/9.8 mating screws. The A-L insert can be installed using AVK's ARO brand pneumatic tools or AVK's SPP pneumatic/hydraulic tools. These tools can be located at any position on your assembly line. The A-L insert can be installed either before or after finish.

- Exceptional torque strength is achieved as the insert's knurled body expands filling the hole.
- Quality installations even invariable thickness materials are assured by AVK's spin/spin ARO pneumatic tools and our SPP pneumatic/hydraulic tools.
- Superior thread strength is provided due to our internal rolled thread manufacturing process.
- Threads gauge before and after installation due to the increased cross-sectional thickness of the threaded area. Thread dilation is prevented.
- Inventory reduction is possible because of the A-L series wide grip range capacity. It is 2.5 times greater than conventional rivet nuts.
- Corrosion resistance is provided by our standard zinc/yellow dichromate finish (96 hrs. salt spray to white corrosion). For exceptional corrosion protection we offer a tin/zinc alloy finish.
- Available in steel from stock. Additional materials such as aluminum, brass and monel are available by special order.

A-H Series Insert

AVK Inserts



A-H series threaded hex insert features a radius corner hex body. When installed into a corresponding hex hole, the radius corners of the A-H insert expand and fill the hole corners providing exceptional resistance to spinning in the panel. The A-H series is designed to be used with grade 5 or metric class 8.8/9.8 mating screw.

- Exceptional resistance in the panel is achieved as the A-H series hex body expands filling the hole.
- Avoid stress fractures of your material and prolong punch and die life by specifying a radius corner in your hex hole. This is possible when using the A-H series radius hex body insert.
- Quality installations even in variable thickness materials are assured by AVK's spin/spin ARO pneumatic tools and our SPP pneumatic/hydraulic tools.
- Superior corrosion resistance is provided by our standard zinc/yellow dichromate finish (96 hours salt spray to white corrosion). For exceptional corrosion protection we offer a tin/zinc alloy finish.
- Threads gauge before and after installation due to the increased cross-sectional thickness of the thread area. Thread dilation is prevented.
- Inventory reduction is possible because of the A-H series wide grip range capacity. It is 2.5 times greater than conventional rivet nuts.
- Superior thread strength is provided due to our internal rolled thread manufacturing process.
- Available in steel.

A-K Series Insert



AVK Insert

The A-K series threaded insert features a knurled body and a reduced profile head to allow for virtually flush installation. Countersunk drilling or dimpling of the parent material can be eliminated. The A-K insert is designed to be used with grade 5 or metric class 8.8/9.8 mating screw.

- Virtually flush installations are achieved without special hole preparation due to the A-K series minimal head profile.
- Exceptional torque strength is achieved as the insert's knurled body expands filling the hole.
- Quality installations even in variable thickness materials are assured by AVK's spin/spin ARO pneumatic tools and our SPP pneumatic/hydraulic tools.
- Superior thread strength is provided due to our internal rolled thread manufacturing process.
- Threads gauge before and after installation due to the increased cross-sectional thickness of the thread area. Thread dilation is prevented.
- Inventory reduction is possible because of the A-K series wide grip range capacity. It is 2.5 times greater than conventional rivet nuts.
- Superior corrosion resistance is provided by our standard zinc/yellow dichromate finish (96 hour salt spray to white corrosion). For exceptional corrosion protection we offer a tin/zinc alloy finish.
- Available in steel from stock. Additional materials such as aluminum, brass and monel are available by special order.

A-R Series Insert



AVK Insert

A-R series threaded insert has been designed for use in plastics and thin gauge sheet metal applications where increased pull-out resistance is required. The A-R insert features a ProSet slotted body design that when installed folds into four segments gripping the backside of the parent material. This design feature allows the A-R insert to be installed into single, variable or multiple thickness materials.

- Increased pull out in plastics and thin sheet metal.
- Installs into variable thickness materials without tool adjustment.
- Internal rolled threads make the A-R series compatible with grade 5 or metric class 8.8/9.8 screws.
- All surfaces are plated for superior corrosion resistance.

A-S Series Stud

AVK Insert



The A-S series stud threaded insert offers a unique design advantage in that once installed, a threaded stud is left protruding from the workpiece. Component parts can be located on the stud until final assembly is accomplished with mating nut. The A-S stud insert is an ideal alternative to clinch or weld studs. The A-S insert is designed to be used with grade 5 or metric class 8.8/9.8 no thread locking type nuts.



- Protruding stud allows component parts to be located on the stud until final assembly is accomplished with a mating nut.
- Exceptional torque strength is achieved as the stud's knurled body expands filling the hole.
- Quality installation even in variable thickness materials are assured by AVK's spin/spin ARO pneumatic tools or AVK's SPP pneumatic/hydraulic tools.
- Eliminate paint masking procedures as required with weld or clinch studs. The A-S series stud can be installed after painting.
- Superior corrosion resistance is provided by our standard zinc/yellow dichromate finish (96 hours salt spray to white corrosion). Alternative finishes are available.
- Available in steel 1010/1008 shell - steel 1038 stem.

A-P Series Insert

AVK Insert

A-P series closed end radial grooved insert provides excellent torque and pull out strength in honeycomb panels. A hole and cavity is created within the panel. Epoxy is injected filling the cavity and the A-P insert is installed gripping the top skin. Once the epoxy cures, the A-P insert is bonded within the panel and excellent torque and pull out loads are achieved.



1. Drill a hole into the top panel and core material per the AVK specifications.
2. Router the core material creating a cavity 2-1/2 times greater than the insert "D" dimension.
3. Fill the cavity with epoxy and install the A-P series insert.

A-T Series Insert

AVK Insert

The A-T series knurled threaded insert is unique in that it can be installed into most any material above .030/.76 mm in thickness. As the A-T insert is installed, the threaded portion is completely swaged 360 Degree into the sleeve portion and the hole. This permits the A-T insert to be used with grade 8/metric 12.9 mating screw.



- Reduced overall length of the installed A-T series insert allows it to be used in limited clearance applications.
- Quality installations even in variable thickness materials are assured by our spin/spin torque stall tools.
- Inventory reduction is possible because one A-T series insert will work in any thickness material above .030/.76 mm.
- Installs into most any material with a thickness over .030/.76 mm.
- Can be used with grade B/metric class 12.9 screws due to the A-T series high shear load capability.
- Available in steel from stock. Aluminum, brass and series 304 stainless steel are available by special order.

A-W Series Insert



AVK Insert

The A-W series knurled threaded insert can be installed into most any material softer than itself that is thicker than .062/1.57. The A-W insert provides exceptional shear strength and pull out in fiberglass and plywoods. The brass A-W insert is particularly useful for the fiberglass boat industry.

- Additional UNF thread sizes available.
- Hole Size: The A-W series insert hole size will be dependent on parent material density. Experimentation is required for optimum performance.
- Finish: The standard specified finishes for the A-W series insert are cadmium and tin. Alteration to these finishes will reduce performance.
- Thread class: The A-W series insert's internal threads are manufactured oversized to compensate for resulting thread portion shrinkage during the installation swaging process. They are not gaugeable prior to or after installation but will be compatible with class 2A/3A or 6g screws after installation.

Thread Size	Thread Call Out	Hole Size +.005-.000	HD +-.005	L +-.370	D Max	IL Max	Hole Depth Min.
6-32 UNC	632	15/64 (.234)	.255	.370	.233	.205	.400
8-32 UNC	832	17/64 (.266)	.285	.370	.264	.205	.400
10-24 UNC	1024	19/64 (.297)	.320	.370	.295	.205	.400
10-32 UNF	1032	19/64 (.297)	.320	.370	.295	.205	.400
1/4-20 UNC	420	25/64 (.391)	.415	.515	.389	.275	.540
15/16-18 UNC	518	17/32 (.531)	.550	.615	.528	.325	.640
3/8-16 UNC	616	19/32 (.594)	.615	.740	.590	.390	.770
M4x0.7 ISO	470	6.75	7.24	9.40	6.71	5.21	10.16
M5x0.8 ISO	580	7.54	8.13	9.40	7.50	5.21	10.16
M6x1.0 ISO	610	9.92	10.54	13.08	9.88	6.99	13.72
M8x1.25 ISO	8125	13.49	13.97	15.62	13.41	8.26	16.26
M10x1.5 ISO	1015	15.00	15.62	18.80	14.99	9.91	19.56

R-N Series Rivet Nut Threaded Insert



AVK Insert

R-N series rivetnut threaded insert features a heavy duty head profile and increased wall thickness in the collapse area. This makes the R-N rivetnut ideal for leg leveling. The R-N insert can be installed either prior to or after finish.

- Increased pull-out loads are achievable in leg leveling applications when using the R-N series due to its heavy duty head profile and thick wall construction.
- Superior thread strength is provided due to our internal rolled thread manufacturing process.
- Superior corrosion resistance is provided by our standard cadmium finish (72 hours salt spray).
- Uniform installation is guaranteed because of the dimensional tolerances and concentricity tolerances built into our product made possible by our cold forming technology.
- Available in steel and aluminum

A-O Series Insert



AVK Insert

The A-O series threaded insert features a reduced profile head design which is similar to the superior A-K series knurled threaded insert. It also has a smaller body diameter than the A-K series insert. The A-O insert can be specified when the application design parameters require a smaller hole or closer hole to edge tolerances. The A-O insert can be installed either prior to or after finish further enhancing its flexibility in your manufacturing environment.

- Grip range can be affected by parent material density and actual hole size. AVK suggests trial installations to determine optimum grip.
- Additional UNF fine thread materials are available.

Thread Size	Thread Call Out	Grip Range	Grip Call Out	Hole size +.006-.000	HD +-.010	HH+-.003	L+-.015	D Max	IL Max
6-32 UNC	632	.020-.080	80	1/4 (.250)	.295	.018	.385	.249	.315
8-32 UNC	832	.020-.080	80	1/4 (.250)	.295	.018	.385	.249	.315
10-24 UNC	1024	.020-.130	130	9/32 (.2912)	.320	.020	.440	.280	.330
10-32 UNC	1032	.020-.130	130	9/32 (.2912)	.320	.020	.440	.280	.330
1/4-20 UNC	420	.030-.165	165	3/8 (.375)	.425	.022	.580	.374	.440
5/16-18 UNC	518	.040-.200	200	1/2 (.500)	.560	.022	.690	.499	.540
3/8-16 UNC	616	.040-.200	200	1/2 (.500)	.560	.022	.690	.499	.540
M4x0.7 ISO	470	0.50-2.00	2.0	6.4	7.49	0.46	9.78	6.32	8.00
M5x0.8 ISO	580	0.50-3.30	3.3	7.2	8.13	0.51	11.18	7.11	8.38
m6x1.0 ISO	610	0.76-4.20	4.2	9.6	10.80	0.56	14.73	9.50	11.18
M8x1.25 ISO	8125	1.02-5.10	5.1	12.7	14.22	0.56	17.53	12.67	13.72
M10x1.5 ISO	1015	1.02-5.10	5.1	12.7	14.22	0.56	17.53	12.67	13.72

UKO Series

Sherex Insert



UKO Small Flange Metric Series

- The UKO series offers small flange head for near flush installation.
- The metric body dimensions allow for use in metric size holes.

Part Number Steel	Thread Size	Grip Range	L	D	K	d	Hole Size
TU-SM4UKO30	M4X0.7 ISO	0.5-3.0	10.75	6.5	0.5	6.0	6.0
TU-SM5UKO30	M5X0.8 ISO	0.5-3.0	12.0	7.5	0.5	7.0	7.0
TU-SM5UKO55	M5X0.8 ISO	3.0-5.5	15.0	7.5	0.5	7.0	7.0
TU-SM6UKO30	M6X1.0 ISO	0.5-3.0	14.5	9.5	0.5	9.0	9.0
TU-SM6UKO55	M6X1.0 ISO	3.0-5.5	16.5	9.5	0.5	9.0	9.0
TU-SM8UKO30	M8X1.25 ISO	0.5-3.0	16.0	11.5	0.5	11.0	11.0
TU-SM8UKO55	M8X1.25 ISO	3.0-5.5	18.5	11.5	0.5	11.0	11.0
TU-SM10UKO35	M10X1.5 ISO	0.8-3.5	19.5	12.9	0.5	12.4	12.5



CAL Series

Sherex Insert



CAL Large Flange Knurled Body Thin Wall Series

- CAL series has a large flange to provide increased strength in punched and drilled holes.
- Knurled body provides a higher resistance to spin out when installed in soft material.
- Available in Closed End
- Available in Wedge Head
- Available in Sealed Head

Part Number	Thread Size	Grip Range	L	HD	HT	D	IL	LB	ILB	ITD	Hole Size
CAL2-0632-080	6-32 UNC	.020-.080	.420	.390	.030	.265	.305	.740	.640	.610	.266
CAL2-0632-130	6-32 UNC	.080-.130	.470	.390	.030	.265	.305	.740	.580	.670	.266
CAL2-0832-080	8-32 UNC	.020-.080	.420	.390	.030	.265	.305	.740	.640	.610	.266
CAL2-0832-130	8-32 UNC	.080-.130	.470	.390	.030	.265	.305	.740	.580	.670	.266
CAL2-1024-130	10-24 UNC	.020-.130	.475	.415	.030	.296	.315	.990	.845	.730	.297
CAL2-1024-225	10-24 UNC	.130-.225	.585	.415	.030	.296	.315	.990	.735	.840	.297
CAL2-1032-130	10-32 UNF	.020-.130	.475	.415	.030	.296	.315	.990	.845	.730	.297
CAL2-1032-225	10-32 UNF	.130-.225	.585	.415	.030	.296	.315	.990	.735	.840	.297
CAL2-2520-165	1/4-20 UNC	.027-.165	.580	.500	.030	.390	.380	1.190	1.005	.895	.391
CAL2-2520-260	1/4-20 UNC	.165-.260	.680	.500	.030	.390	.380	1.190	.905	1.035	.391
CAL2-2528-165	1/4-28 UNF	.027-.165	.580	.500	.030	.390	.380	1.190	1.005	.895	.391
CAL2-2528-260	1/4-28 UNF	.165-.260	.680	.500	.030	.390	.380	1.190	.905	1.035	.391
CAL2-3118-150	5/16-18 UNC	.027-.150	.690	.685	.035	.530	.470	1.390	1.175	.995	.531
CAL2-3118-312	5/16-18 UNC	.150-.312	.805	.685	.035	.530	.425	1.390	1.025	1.120	.531
CAL2-3124-150	5/16-24 UNF	.027-.150	.690	.685	.035	.530	.470	1.390	1.175	.995	.531
CAL2-3124-312	5/16-24 UNF	.150-.312	.805	.685	.035	.530	.425	1.390	1.025	1.120	.531
CAL2-3716-150	3/8-16 UNC	.027-.150	.690	.685	.035	.530	.470	1.390	1.175	.995	.531
CAL2-3716-312	3/8-16 UNC	.150-.312	.805	.685	.035	.530	.425	1.390	1.025	1.120	.531
CAL2-3724-150	3/8-24 UNF	.027-.150	.690	.685	.035	.530	.470	1.390	1.175	.995	.531
CAL2-3724-312	3/8-24 UNF	.150-.312	.805	.685	.035	.530	.425	1.390	1.025	1.120	.531
CAL2-5013-200	1/2-13 UNC	.063-.200	1.150	.865	.047	.685	.850	2.365	2.070	1.505	.688
CAL2-5013-350	1/2-13 unc	.200	.350	1.300	.865	.047	.685	.850	2.365	1.920	.688

CAK Series

Sherex Insert

CAK Small Flange Knurled Body Thin Wall Series

- The CAK series has a small flange for a near flush installation.
- Knurled body provides a higher resistance to spin out when installed in soft materials
- Available in closed end.

Part Number	Thread Size	Grip Range	L	HD	HT	D	IL	LB	ILB	ITD	Hole Size
CAK2-0632-080	3-21 UNC	.020-.080	.420	.310	.019	.265	.305	.740	.640	.610	.266
CAK2-0632-130	6-32 UNC	.080-.130	.470	.310	.019	.265	.305	.740	.580	.670	.266
CAK2-0832-080	8-32 UNC	.020-.080	.420	.310	.019	.265	.305	.740	.640	.610	.266
CAK2-0832-130	8-32 UNC	.080-.130	.470	.310	.019	.265	.305	.740	.580	.670	.266
CAK2-1024-130	10-24 UNC	.020-.130	.475	.340	.019	.296	.315	.990	.845	.730	.297
CAK2-1024-225	10-24 UNC	.130-.225	.585	.340	.019	.296	.315	.990	.735	.840	.297
CAK2-1032-130	10-32 UNF	.020-.130	.475	.340	.019	.296	.315	.990	.845	.730	.297
CAK21032-225	10-32 UNF	.130-.225	.585	.340	.019	.296	.315	.990	.735	.840	.297
CAK2-2520-165	1/4-20 UNC	.027-.165	.580	.455	.022	.390	.380	1.190	1.005	.895	.391
CAK2-2520-260	1/4-20 UNC	.165-.260	.680	.455	.022	.390	.380	1.190	.905	1.035	.391
CAK2-2528-165	1/4-28 UNF	.027-.165	.580	.455	.022	.390	.380	1.190	1.005	.895	.391
CAK2-2528-260	1/4-28 UNF	.165-.260	.680	.455	.022	.390	.380	1.190	.905	1.035	.391
CAK2-3118-150	5/16-18 UNC	.027-.150	.690	.595	.022	.530	.470	1.390	1.175	.995	.531
CAK2-3118-312	5/16-18 UNC	.150-.312	.805	.595	.022	.530	.425	1.390	1.025	1.120	.531
CAK2-3124-150	5/16-24 UNF	.027-.150	.690	.595	.022	.530	.470	1.390	1.175	.995	.531
CAK2-3124-312	5/16-24 UNF	.150-.312	.805	.595	.022	.530	.425	1.390	1.025	1.120	.531
CAK2-3716-150	3/8-16 UNC	.027-.150	.690	.595	.022	.530	.470	1.390	1.175	.995	.531
CAK2-3716-312	3/8-16 UNC	.150-.312	.805	.595	.022	.530	.425	1.390	1.025	1.120	.531
CAK2-3724-150	3/8-24 UNF	.027-.150	.690	.595	.022	.530	.470	1.390	1.175	.995	.531
CAK2-3724-312	3/8-24 UNF	.150-.312	.805	.595	.022	.530	.425	1.390	1.025	1.120	.531
CAK2-470-2.0	M4X0.7 ISO	.50-2.00	10.67	7.87	.48	6.73	7.75	18.80	16.26	15.49	6.75
CAK2-470-3.3	M4X0.7 ISO	2.00-3.30	11.94	7.87	.48	6.73	7.75	18.80	14.73	17.02	6.75
CAK2-580-3.3	M5X0.8 ISO	.50-3.30	12.07	8.64	.48	7.52	8.00	25.15	21.46	18.54	7.60
CAK2-580-5.7	M5X0.8 ISO	3.30-5.70	14.86	8.64	.48	7.52	8.00	25.15	18.67	21.37	7.60
CAK2-610-4.2	M6X1.0 ISO	.70-4.20	14.73	11.56	.55	9.91	9.65	30.23	25.53	22.73	10.00
CAK2-610-6.6	M6X1.0 ISO	4.20-6.60	17.27	11.56	.55	9.91	9.65	30.23	22.99	26.29	10.00
CAK2-8125-3.8	M8X1.25 ISO	.70-3.80	17.53	15.11	.55	13.46	11.94	35.31	29.85	25.27	13.50
CAK2-8125-7.9	M8X1.25 ISO	3.80-7.90	20.45	15.11	.55	13.46	10.80	35.31	26.04	28.45	13.50
CAK2-1015-3.8	M10X1.5 ISO	.70-3.80	17.53	15.11	.55	13.46	11.94	35.31	29.85	25.27	13.50
CAK2-1015-7.9	M10X1.5 ISO	3.80-7.90	20.45	15.11	.55	13.46	10.80	35.31	26.04	28.45	13.50

CAH Series



Sherex Insert

CAH Half Hex Body Large Flange Thin Wall Series

- The CAH series offers a semi hex body for excellent resistance to spin out in the hole.
- Available in closed end.
- Available in sealed head.

Part Number	Thread Size	Grip Range	L	HD	HT	D	IL	LB	ILB	ITD	Hole Size
CAH2-0632-080	6-32 UNC	.020-.080	.385	.375	.027	.249	.295	.740	.640	.575	.250
CAH2-0632-130	6-32 UNC	.080-.130	.435	.375	.027	.249	.295	.740	.580	.640	.250
CAH2-0832-080	8-32 UNC	.020-.080	.385	.375	.027	.249	.295	.740	.640	.575	.250
CAH2-0832-130	8-32 UNC	.080-.130	.435	.375	.027	.249	.295	.740	.580	.640	.250
CAH2-1024-130	10-24 UNC	.020-.130	.435	.390	.027	.280	.275	1.030	.845	.695	.281
CAH2-1024-225	10-24 UNC	.130-.225	.535	.390	.027	.280	.275	1.030	.735	.805	.281
CAH2-1032-130	10-32 UNF	.020-.130	.435	.390	.027	.280	.275	1.030	.845	.695	.281
CAH2-1032-225	10-32 UNF	.130-.225	.535	.390	.027	.280	.275	1.030	.735	.805	.281
CAH2-2520-165	1/4-20 UNC	.027-.165	.585	.510	.030	.374	.400	1.190	1.015	.945	.375
CAH2-2520-260	1/4-20 UNC	.165-.260	.685	.510	.030	.374	.400	1.190	.915	1.085	.375
CAH2-2528-165	1/4-28 UNF	.027-.165	.585	.510	.030	.374	.400	1.190	1.015	.945	.375
CAH2-2528-260	1/4-28 UNF	.165-.260	.685	.510	.030	.374	.400	1.190	.915	1.085	.375
CAH2-3118-150	5/16-18 UNC	.027-.150	.685	.655	.035	.499	.530	1.445	1.235	1.045	.500
CAH2-3118-312	5/16-18 UNC	.150-.312	.845	.655	.035	.499	.515	1.445	1.220	1.170	.500
CAH2-3124-150	5/16-24 UNF	.027-.150	.685	.655	.035	.499	.530	1.445	1.235	1.045	.500
CAH2-3124-312	5/16-24 UNF	.150-.312	.845	.655	.035	.499	.515	1.445	1.220	1.170	.500
CAH2-3716-150	3/8-16 UNC	.027-.150	.685	.655	.035	.499	.530	1.45	1.235	1.045	.500
CAH2-3716-312	3/8-16 UNC	.150-.312	.845	.655	.035	.499	.515	1.445	1.220	1.170	.500
CAH2-3724-150	3/8-24 UNF	.027-.150	.685	.655	.035	.499	.530	1.445	1.235	1.045	.500
CAH2-3724-312	3/8-24 UNF	.150-.312	.845	.655	.035	.499	.515	1.445	1.220	1.170	.500
CAH2-470-2.0	M4X0.7 ISO	.50-2.00	9.78	9.53	.68	6.35	7.49	18.80	16.26	14.61	6.35
CAH2-470-3.3	M4X0.7 ISO	2.00-3.30	11.05	9.53	.68	6.35	7.49	18.80	14.73	16.26	6.35
CAH2-580-3.3	M5X0.8 ISO	.50-3.30	11.05	9.91	.68	7.10	6.99	26.16	21.46	17.65	7.14
CAH2-580-5.7	M5X0.8 ISO	3.30-5.70	13.59	9.91	.68	7.10	6.99	26.16	18.67	20.45	7.14
CAH2-610-4.2	M6X1.0 ISO	.70-4.20	14.86	12.96	.76	9.50	10.16	30.23	25.78	24.00	9.53
CAH2-610-6.6	M6X1.0 ISO	4.20-6.60	17.40	12.96	.76	9.50	10.16	30.23	23.24	27.56	9.53
CAH2-812S-3.8	M8X1.25 ISO	.70-3.80	17.40	16.64	.89	12.70	13.46	36.70	31.37	26.54	12.70
CAH2-812S-7.9	M8X1.25 ISO	3.80-7.90	21.46	16.64	.89	12.70	13.08	36.70	30.99	29.72	12.70
CAH2-1015-3.8	M10X1.5 ISO	.70-3.80	17.40	16.64	.89	12.70	13.46	36.70	31.37	26.54	12.70
CAH2-1015-7.9	M10X1.5 ISO	3.80-7.90	21.46	16.64	.89	12.70	13.08	36.70	30.99	29.72	12.70

UFO Series



Sherex Insert

UFO Countersunk Head Metric Series

- The UFO series offers countersunk head for flush installation into the parent material.
- The metric body dimensions allows for use in metric holes.

Part Number Steel	Thread Size	Grip Range	L	D	K	d	Hole Size
TU-SM3UFO35	M3X0.5 ISO	1.7-3.5	11.25	8.0	1.5	5.0	5.1
TU-SM4UFO35	M4X0.7 ISO	1.7-3.5	11.5	9.0	1.5	6.0	6.0
TU-SM4UFO50	M4X0.7 ISO	3.5-5.0	13.0	9.0	1.5	6.0	6.0
TU-SM5UFO40	M5X0.8 ISO	1.7-4.0	13.0	10.0	1.5	7.0	7.0
TU-SM5UFO65	M5X0.8 ISO	4.0-6.5	16.0	10.0	1.5	7.0	7.0
TU-SM6UFO45	M6X1.0 ISO	1.7-4.5	17.0	12.0	1.5	9.0	9.0
TU-SM6UFO65	M6X1.0 ISO	4.5-6.5	19.0	12.0	1.5	9.0	9.0
TUSM8UFO45	M8X1.25 ISO	1.7-4.5	19.0	14.0	1.5	11.0	11.0
TU-SM8UFO65	M8X1.25 ISO	4.5-6.5	21.0	14.0	1.5	11.0	11.0
TU-SM10UFO45	M10X1.5 ISO	1.7-4.5	21.0	15.40	1.5	12.4	12.5
TU-SM10UFO65	M10X1.5 ISO	4.5-6.5	23.0	15.4	1.5	12.4	12.5
TU-SM12UFO45	M12X1.75 ISO	2.0-4.5	26.0	19.0	1.8	16.0	16.0
TU-SM12UFO75	M12X1.75 ISO	4.5-7.5	29.0	19.0	1.8	16.0	16.0



CAO Series

Sherex Insert



CAO Small Flange Smooth Body Thin Wall Series.

- The CAO series offers a line of body diameters that will fit in common hole sizes.
- The small flange head also allows for near flush installations.
- Available in closed end.

Part Number	Thread Size	Grip Range	L	HD	HT	D	IL	Hole Size
CAO2-0632-080	6-32 UNC	.020-.080	.385	.295	.018	.249	.315	.250
CAO2-0832-080	8-32 UNC	.020-.080	.385	.295	.018	.249	.315	.250
CAO2-1024-130	10-24 UNC	.020-.130	.440	.320	.020	.280	.330	.281
CAO2-1032-130	10-32 UNF	.020-.130	.400	.320	.020	.280	.330	.281
CAO2-2520-165	1/4-20 UNC	.030-.165	.580	.425	.022	.374	.440	.375
CAO2-2528-165	1/4-28 UNF	.030-.165	.580	.425	.022	.374	.440	.375
CAO2-3118-200	5/16-18 UNC	.040-.200	.690	.560	.022	.499	.540	.500
CAO2-3124-200	5/16-24 UNF	.040-.200	.690	.560	.022	.499	.540	.500
CAO2-3716-200	3/8-16 UNC	.040-.200	.690	.560	.022	.499	.540	.500
CAO2-3724-200	3/8-24 UNF	.040-.200	.690	.560	.022	.499	.540	.500
CAO2-470-2.0	M4X0.7 ISO	.50-2.00	9.78	7.49	.46	6.32	8.00	6.40
CAO2-580-3.3	M5X0.8 ISO	.50-3.30	11.18	8.13	.51	7.11	8.38	7.20
CAO2-610-4.2	M6X1.0 ISO	.76-4.20	14.73	10.80	.56	9.50	11.18	9.60
CAO2-8125-5.1	M8X1.25 ISO	1.02-5.10	17.53	14.22	.56	12.67	13.72	12.70
CAO2-1015-5.1	M10X1.5 ISO	1.02-5.10	17.53	14.22	.56	12.67	13.72	12.70

CA Series



Sherex Insert

CA Heavy Duty Rivet Nut Flat Head Series.

- The CA series offers a thick head and thick collapse chamber wall thickness for heavy duty applications.
- Available with a countersunk head style for a flush installation.
- Available in a keyed head style for reduced spin out.
- Available in closed end.
- Available in countersunk head.
- Available in keyed head.

Part Number	Tread Size	Grip Range	L	HD	HT	D	IL	Hole Size
CA-0440S-060	4-40 UNC	.010-.060	.345	.270	.025	.155	.230	.155
CA-0440S-085	4-40 UNC	.060-.085	.370	.270	.025	.155	.230	.155
CA-0440S-110	4-40 UNC	.085-.100	.400	.270	.025	.155	.230	.155
CA-0632S-075	6-32 UNC	.010-.075	.438	.325	.032	.189	.300	.189
CA-0632S-120	6-32 UNC	.075-.120	.500	.325	.032	.189	.315	.189
CA-0632S-160	6-32 UNC	.120-.160	.500	.325	.032	.189	.270	.189
CA-0832S-075	8-32 UNC	.010-.075	.438	.357	.032	.221	.300	.221
CA-0832S-120	8-32 UNC	.075-.120	.500	.357	.032	.221	.315	.221
CA-0832S-160	8-32 UNC	.120-.160	.500	.357	.032	.221	.270	.221
CA-1024S-080	10-24 UNC	.010-.080	.531	.406	.038	.250	.380	.250
CA-1024S-130	10-24 UNC	.080-.130	.594	.406	.038	.250	.390	.250
CA-1024S-180	10-24 UNC	.130-.180	.641	.406	.038	.250	.390	.250
CA-1032S-080	10-32 UNF	.010-.080	.531	.406	.038	.250	.380	.250
CA-1032S-130	10-32 UNF	.080-.130	.594	.406	.038	.250	.390	.250
CA-1032S-180	10-32 UNF	.130-.180	.641	.406	.038	.250	.390	.250
CA-2520S-080	1/4-20 UNC	.020-.080	.625	.475	.058	.332	.450	.332
CA-2520S-140	1/4-20 UNC	.080-.140	.687	.475	.058	.332	.450	.332
CA-2520S-200	1/4-20 UNC	.140-.200	.750	.475	.058	.332	.450	.332
CA-3118S-125	5/16-18 UNC	.030-.125	.750	.665	.062	.413	.505	.413
CA-3118S-200	5/16-18 UNC	.125-.200	.875	.665	.062	.413	.555	.413
CA-3118S-275	5/16-18 UNC	.200-.275	.937	.655	.062	.413	.540	.413
CA-3716S-115	3/8-16 UNC	.030-.115	.844	.781	.088	.490	.585	.490
CA-3716S-200	3/8-16 UNC	.115-.200	.938	.781	.088	.490	.595	.490
CA-3716S-285	3/8-16 UNC	.200-.285	1.031	.781	.088	.490	.605	.490
CA-5013S-150	1/2-13 UNC	.050-.150	.906	.906	.085	.625	.605	.625
CA-5013S-250	1/2-13 UNC	.150-.250	1.031	.906	.085	.625	.630	.625
CA-5013S-350	1/2-13 UNC	.250-.350	1.141	.906	.085	.625	.640	.625



CFW/CAW Series

Sherex Insert



CFW/CAW Diamond Knurled 360 Degree Swaging Series

- The CFW/CAW series offers a knurled body for increased spin out resistance in soft material such as fiberglass and plywood.
- Increased wall thickness gives increased shear strength.
- Cadmium free finish allows the CFW series to be used in any industry, including automotive.

Part Number	Thread Size	Cadmium Free & RoHS Compliant	HD +/- .13	L +/- .38	D Max	Hole Sized +/- .13/-.00
CAW2-0632	6-32 UNC	N	.255	.370	.233	.234
CAW2-0832	8-32 UNC	N	.285	.370	.264	.266
CAW2-1024	10-24 UNC	N	.320	.370	.295	.297
CAW2-1032	10-32 UNF	N	.320	.370	.295	.297
CAW2-2520	1/4-20 UNC	N	.415	.515	.389	.391
CAW2-3118	5/16-18 UNC	N	.550	.615	.528	.531
CAW2-3716	3/8-16 UNC	N	.615	.740	.590	.594
CFW2-0632	6-32 UNC	Y	.255	.370	.233	.234
CFW2-0832	8-32 UNC	Y	.285	.370	.264	.266
CFW2-1024	10-24 UNC	Y	.320	.370	.295	.297
CFW2-1032	10-32 UNF	Y	.320	.370	.295	.297
CFW2-2520	1/4-20 UNC	Y	.415	.515	.389	.391
CFW2-3118	5/16-18 UNC	Y	.550	.615	.528	.531
CFW2-3716	3/8-16 UNC	Y	.615	.740	.590	.594
CAW2-470	M4X0.7 ISO	N	7.24	9.40	6.71	6.75
CAW2-580	M5X0.8 ISO	N	8.13	9.40	7.50	7.54
CAW2-610	M6X1.0 ISO	N	10.54	13.08	9.88	9.92
CAW2-8125	M8X1.25 ISO	N	13.97	15.62	13.41	13.49
CAW2-1015	M10X1.5 ISO	N	15.62	18.80	14.99	15.00
CFW2-470	M4X0.7 ISO	Y	7.24	9.40	6.71	6.75
CFW2-580	M5X0.8 ISO	Y	8.13	9.40	7.50	7.54
CFW2-610	M6X1.0 ISO	Y	10.54	13.08	9.88	9.92
CFW2-8125	M8X1.25 ISO	Y	13.97	15.62	13.41	13.49
CFW2-1015	M10X1.5 ISO	Y	15.62	18.80	14.99	15.00

CFT/CAT Series



Sherex Inserts

CFT/CAT Knurles 360 Degree Swaging Series

- The CFT/CAT series offers one rivet nut for materials of any thickness greater than .030 inches.
- Cadmium free finish allows the CFT series to be used in any industry, including applications.
- CFT series should be used in metal applications.

Part Number	Thread Size	Cadmium Free & RoHS Compliant	HD +/- .13	L +/- .38	D Max	Mat Thick 0.76-2.29	Mat Thick 2.31-3.15	Mat Thick 3.17-4.72	Mat Thick 4.72-Over
CAT2-0440	4-40 UNC	N	.211	.370	.1875	.1875	.1935	.1935	.1960
CAT2-0632	6-32 UNC	N	.240	.370	.2185	.2188	.2210	.2280	.2280
CAT2-0832	8-32 UNC	N	.269	.370	.2495	.2500	.2570	.2656	.2656
CAT2-1024	10-24 UNC	N	.306	.370	.2805	.2812	.2900	.2900	.2969
CAT2-1032	10-32 UNF	N	.306	.370	.2805	.2812	.2900	.2900	.2969
CAT2-2520	1/4-20 UNC	N	.400	.515	.3745	.750	.3750	.3860	.3906
CAT2-3118	5/16-18 UNC	N	.528	.615	.4995	.5000	.5000	.5156	.5156
CAT2-3716	3/8-16 UNC	N	.588	.745	.5615	.5625	.5625	.5781	.5781
CAT2-5013	1/2-13 UNC	N	.800	.935	.7485	.7500	.7656	.7810	.7970
CFT2-0440	4-40 UNC	Y	.211	.370	.1875	.1875	.1935	.1935	.1960
CFT2-0632	6-32 UNC	Y	.240	.370	.2185	.2188	.2210	.2280	.2280
CFT2-0832	8-32 UNC	Y	.269	.370	.2495	.2500	.2570	.2656	.2656
CFT2-1024	10-24 UNC	Y	.306	.370	.2805	.2812	.2900	.2900	.2969
CFT2-1032	10-32 UNF	Y	.306	.370	.2805	.2812	.2900	.2900	.2969
CFT2-2520	1/4-20 UNC	Y	.400	.515	.3745	.750	.3750	.3860	.3906
CFT2-3118	5/16-18 UNC	Y	.528	.615	.4995	.5000	.5000	.5156	.5156
CFT2-3716	3/8-16 UNC	Y	.588	.745	.5615	.5625	.5625	.5781	.5781
CFT2-5013	1/2-13 UNC	Y	.800	.935	.7485	.7500	.7656	.7810	.7970
CAT2-350	M3X0.5 ISO	N	5.36	9.40	4.76	4.75	4.90	4.900	4.97
CAT2-470	M4X0.7 ISO	N	6.83	9.40	6.34	6.35	6.52	6.740	6.74
CAT2-580	M5X0.8 ISO	N	7.77	9.40	7.12	7.14	7.36	7.360	7.54
CAT2-610	M6X1.0 ISO	N	10.16	13.08	9.51	9.52	9.52	9.800	9.92
CAT2-8125	M8X1.25 ISO	N	13.41	15.62	12.69	12.70	12.70	13.090	13.09
CAT2-1015	M10X1.5 ISO	N	14.94	18.92	14.26	14.28	14.28	14.680	14.68
CAT2-12175	M12X1.75 ISO	N	20.32	23.75	19.01	19.05	19.44	19.830	20.24
CFT2-350	M3X0.5 ISO	Y	5.36	9.40	4.76	4.75	4.90	4.900	4.97
CFT2-470	M4X0.7 ISO	Y	6.83	9.40	6.34	6.35	6.52	6.740	6.74
CFT2-580	M5X0.8 ISO	Y	7.77	9.40	7.12	7.14	7.36	7.360	7.54
CFT2-610	M6X1.0 ISO	Y	10.16	13.08	9.51	9.52	9.52	9.800	9.92
CFT2-8125	M8X1.25 ISO	Y	13.41	15.62	12.69	12.70	12.70	13.090	13.09
CFT2-1015	M10X1.5 ISO	Y	14.94	18.92	14.26	14.28	14.28	14.680	14.68
CFT2-12175	M12X1.75 ISO	Y	20.32	23.75	19.01	19.05	19.44	19.830	20.24

CPB Series



Sherex Inserts



CPB Prebulbed Slotted Body Series

- CPB series offers large grip range for installation into single, variable or multiple thickness materials.
- Large backside footprint provides increased pull out resistance.
- The CPB series can be installed into thin plastics and will not distort the base materials.
- Available in wedge head.
- Available in trim head.

Part Number	Thread Size	Grip Range	HD	L	HT	D	IL	Hole Size
CPB2-1024-175	10-24 UNC	.020-.175	.490-.510	.828	.038	.329	.410	.336
CPB2-1024-320	10-24 UNC	.175-.320	.490-.510	.921	.038	.329	.410	.336
CPB2-1032-175	10-32 UNF	.020-.175	.490-.510	.828	.038	.329	.410	.336
CPB2-1032-320	10-32 UNF	.175-.320	.490-.510	.921	.038	.329	.410	.336
CPB2-2520-280	1/4-20 UNC	.020-.280	.610-.645	1.000	.059	.382	.505	.390
CPB2-2520-500	1/4-20 UNC	.280-.500	.610-.645	1.234	.059	.382	.505	.390
CPB2-3118-280	5/16-18 UNC	.020-.280	.740-.770	1.141	.062	.495	.570	.500
CPB2-3118-500	5/16-18 UNC	.280-.500	.740-.770	1.375	.062	.495	.570	.500
CPB2-580-4.45	M5X0.8 ISO	0.50-4.45	12.45-12.95	21.03	0.96	8.35	10.00	8.55
CPB2-580-8.1	M5X0.8 ISO	4.45-8.10	12.45-12.95	23.80	0.96	8.35	10.00	8.55
CPB2-610-7.1	M6X1.0 ISO	0.50-7.10	15.50-16.38	25.40	1.50	9.70	12.80	10.00
CPB2-610-12.7	M6X1.0 ISO	7.10-12.70	15.50-16.38	31.32	1.50	9.70	12.80	10.00
CPB2-8125-7.1	M8X1.25 ISO	0.50-7.10	18.80-19.65	28.95	1.57	12.57	14.48	12.70
CPB2-8125-12.7	M8X1.25 ISO	7.10-12.70	18.80-19.65	34.90	1.57	12.57	14.48	12.70

CPN Series

Sherex Insert



CPN Straight Shank Slotted Body Series

- The CPN series offers a large grip range for installation into single, variable or multiple thickness materials.
- Large backside footprint provides increased pull out resistance.
- The CPN series can be installed into thin plastics and will not distort the base material.
- CPN must be installed with spin-pull installation tooling.
- Available in wedge head.

Part Number	Thread Size	Grip Range	HD	L	HT	D	IL	Hole Size
CPN2-1024-175	10-24 UNC	.020-.175	.490-.510	.781	.038	.272	.425	.273
CPN2-1024-320	10-24 UNC	.175-.320	.490-.510	.921	.038	.272	.425	.273
CPN2-1032-175	10-32 UNF	.020-.175	.490-.510	.781	.038	.272	.425	.273
CPN2-1032-320	10-32 UNF	.175-.320	.490-.510	.921	.038	.272	.425	.273
CPN2-2520-280	1/4-20 UNC	.020-.280	.610-.645	1.000	.059	.346	.505	.347
CPN2-2520-500	1/4-20 UNC	.280-.500	.610-.645	1.234	.059	.346	.505	.347
CPN2-3118-280	5/16-18 UNC	.020-.280	.740-.770	1.141	.062	.437	.570	.438
CPN2-3118-500	5/16-18 UNC	.280-.500	.740-.770	1.375	.062	.437	.570	.438
CPN2-580-4.45	M5X0.8 ISO	0.50-4.45	12.45-12.95	21.03	0.96	7.47	9.90	7.48
CPN2-580-8.1	M5X0.8 ISO	4.45-8.10	12.45-12.95	23.80	0.96	7.47	9.90	7.48
CPN2-610-7.1	M6X1.0 ISO	0.50-7.10	15.50-16.38	25.40	1.50	8.79	12.80	8.80
CPN2-610-12.7	M6X1.0 ISO	7.10-12.70	15.50-16.38	31.32	1.50	8.79	12.80	8.80
CPN2-8125-7.1	M8X1.25 ISO	0.50-7.10	18.80-19.65	28.95	1.57	11.10	14.48	11.11
CPN2-8125-12.7	M8X1.25 ISO	7.10-12.70	18.80-19.65	34.90	1.57	11.10	14.48	11.11



CFH/CFHD Series



Sherex Insert

CFH & CFHD Full Hex Body Series

- The CFH series offers full hexagonal body for exceptional spin out resistance.
- The CFHD series offers the same benefits as the CFH series but with higher strength.

Part Number	Thread Size	Grip Range	HD	L	HT	D	IL	Hole Size
CFH2-1024-085	10-24 UNC	.010-.085	.329-.359	.344	.043	.223	.200	.224
CFH2-1024-135	10-24 UNC	.085-.135	.329-.359	.406	.043	.223	.210	.224
CFH2-1024-185	10-24 UNC	.135-.185	.329-.359	.453	.043	.223	.210	.224
CFH2-1032-085	10-32 UNF	.010-.085	.329-.359	.344	.043	.223	.200	.224
CFH2-1032-135	10-32 UNF	.085-.135	.329-.359	.406	.043	.223	.210	.224
CFH2-1032-185	10-32 UNF	.135-.185	.329-.359	.453	.043	.223	.210	.224
CFH2-2520-085	1/4-20 UNC	.020-.085	.422-.452	.406	.043	.296	.250	.297
CFH2-2520-145	1/4-20 UNC	.085-.145	.422-.452	.469	.043	.296	.250	.297
CFH2-2520-205	1/4-20 UNC	.145-.205	.422-.452	.531	.043	.296	.250	.297
CFH2-3118-105	5/16-18 UNC	.030-.105	.547-.577	.562	.048	.368	.375	.369
CFH2-3118-175	5/16-18 UNC	.105-.175	.547-.577	.640	.048	.368	.380	.369
CFH2-3118-245	5/16-18 UNC	.175-.245	.547-.577	.703	.048	.368	.375	.369
CFH2-3716-115	3/8-16 UNC	.030-.115	.641-.671	.625	.058	.437	.400	.438
CFH2-3716-205	3/8-16 UNC	.115-.205	.641-.671	.718	.058	.437	.405	.438
CFH2-3716-295	3/8-16 UNC	.205-.295	.641-.671	.812	.058	.437	.410	.438
CFH2-580-2.1	M5X0.8 ISO	0.50-2.15	9.14-9.90	10.30	1.09	6.35	6.72	6.35
CFH2-580-3.5	M5X0.8 ISO	2.15-3.55	9.14-9.90	11.90	1.09	6.35	6.72	6.35
CFH2-580-5.0	M5X0.8 ISO	3.55-5.05	9.14-9.90	13.48	1.09	6.35	6.72	6.35
CFH2-610-2.1	M6X1.0 ISO	0.50-2.15	10.71-11.47	10.30	1.09	7.51	6.22	7.51
CFH2-610-3.6	M6X1.0 ISO	2.15-3.65	10.71-11.47	11.90	1.09	7.51	6.22	7.51
CFH2-610-5.2	M6X1.0 ISO	3.65-5.20	10.71-11.47	13.48	1.09	7.51	6.22	7.51
CFH2-8125-2.5	M8X1.25 ISO	0.50-2.55	14.69-15.45	15.86	1.57	10.08	10.35	10.08
CFH2-8125-4.5	M8X1.25 ISO	2.50-4.55	14.69-15.45	17.84	1.57	10.08	10.35	10.08
CFH2-8125-6.6	M8X1.25 ISO	4.55-6.60	14.69-15.45	19.82	1.57	10.08	10.35	10.08
CFH2-1015-2.9	M10X1.50 ISO	0.75-2.95	17.10-17.86	15.88	1.57	11.89	13.08	11.89
CFH2-1015-5.2	M10X1.50 ISO	2.95-5.20	17.10-17.86	18.24	1.57	11.89	13.08	11.89
CFH2-1015-7.5	M10X1.50 ISO	5.20-7.50	17.10-17.86	20.62	1.57	11.89	13.08	11.89
CFHD2-2520-080	1/4-20 UNC	.020-.080	.454-.484	.500	.058	.312	.340	.312
CFHD2-2520-150	1/4-20 UNC	.080-.150	.454-.484	.578	.058	.312	.345	.312
CFHD2-3118-100	5/16-18 UNC	.020-.100	.579-.609	.625	.062	.397	.405	.397
CFHD2-3118-180	5/16-18 UNC	.100-.180	.579-.609	.703	.062	.397	.405	.397
CFHD2-3716-125	3/8-16 UNC	.020-.125	.673-.703	.703	.088	.468	.450	.468
CFHD2-3716-230	3/8-16 UNC	.125-.230	.673-.703	.812	.088	.468	.450	.468

UPO Series



Sherex Insert

UPO Large Flange Metric Series

- The UPO series offers a large flange for increased strength and better containment of round or oversized holes.
- The metric body dimensions allows for use in metric holes.

Part Number Steel	Thread Size	Grip Range	L	D	K	d	Hole Size
TU-SM3UPO20	M3X0.5 ISO	0.5-2.0	9.8	8.0	0.8	5.0	5.1
TU-SM3UPO30	M3X0.5 ISO	2.0-3.0	10.8	8.0	0.8	5.0	5.1
TU-SM4UPO30	M4X0.7 ISO	0.5-3.0	10.8	10.0	0.8	6.0	6.0
TU-SM4UPO45	M4X0.7 ISO	3.0-4.5	12.3	10.0	0.8	6.0	6.0
TU-SM5UPO30	M5X0.8 ISO	0.5-3.0	12.0	11.0	1.0	7.0	7.0
TU-SM5UPO55	M5X0.8 ISO	3.0-5.5	15.0	11.0	1.0	7.0	7.0
TU-SM6UPO30	M6X1.0 ISO	0.5-3.0	14.5	13.0	1.5	9.0	9.0
TU-SM6UPO55	M6X1.0 ISO	3.0-5.5	16.5	13.0	1.5	9.0	9.0
TU-SM6UPO80	M6X1.0 ISO	5.5-8.0	19.0	13.0	1.5	9.0	9.0
TU-SM8UPO30	M8X1.25 ISO	0.5-3.0	16.0	16.0	1.5	11.0	11.0
TU-SM8UPO55	M8X1.25 ISO	3.0-5.5	18.5	16.0	1.5	11.0	11.0
TU-SM8UPO80	M8X1.25 ISO	5.5-8.0	21.5	16.0	1.5	11.0	11.0
TU-SM10UPO35	M10X1.5 ISO	0.8-3.5	19.8	18.5	2.3	12.4	12.5
TU-SM10UPO60	M10X1.5 ISO	3.5-6.0	22.8	18.5	2.3	12.4	12.5
TU-SM10SPO35	M10X1.5 ISO	0.8-3.5	21.0	19.0	2.0	13.0	13.0
TU-SM10SPO60	M10X1.5 ISO	3.5-6.0	24.0	19.0	2.0	13.0	13.0
TU-SM12UPO40	M12X1.75 ISO	1.0-4.0	25.0	23.0	2.0	16.0	16.0
TU-SM12UPO70	M12X1.75 ISO	4.0-7.0	28.0	23.0	2.0	16.0	16.0



HUPO/HUKO Series

Sherex Insert



HUPO & HUKO Large and Small Flange Hexagonal Metric Series

- The HUPO series has a large flange that provides increased strength.
- HUPO - Hexagonal shank body for improved spin out.
- HUPO - The metric body dimensions allow for use in metric holes.
- The HUKO series has a smaller flange head that gives a near flush installation into the parent material.
- HUKO - Hexagonal shank body for improved spin out
- HUKO - The metric body dimension allows for use in metric holes.

Part Number Steel	Thread Size	Grip Range	L	D	K	d	Hole Size
TU-SM4HUPO20	M4X0.7 ISO	0.5-2.0	10.0	9.0	1.0	6.0	6.0
TU-SM5HUPO30	M5X0.8 ISO	0.53-0	13.0	10.0	1.0	7.0	7.0
TU-SM6HUPO30	M6X1.0 ISO	0.5-3.0	14.5	13.0	1.5	9.0	9.0
TU-SM6HUPO55	M6X1.0 ISO	3.0-5.5	16.5	13.0	1.5	9.0	9.0
TU-SM8HUPO30	M8X1.25 ISO	0.5-3.0	16.5	16.0	1.5	11.0	11.0
TU-SM8HUPO55	M8X1.25 ISO	3.0-5.5	19.0	16.0	1.5	11.0	11.0
TU-SM8HUPO80	M8X1.25 ISO	5.5-8.0	22.0	16.0	1.5	11.0	11.0
TU-SM10HSPO35	M10X1.5 ISO	0.8-3.5	21.0	19.0	2.0	13.0	13.0
TU-SM10HSPO60	M10X1.5 ISO	3.5-6.0	23.5	19.0	2.0	13.0	13.0
TU-SM12HUPO40	M12X1.75 ISO	1.0-4.0	25.0	23.0	2.0	16.0	16.0
TU-SM4HUKO20	M4X0.7 ISO	0.5-2.0	11.0	6.6	0.6	6.0	6.0
TU-SM5HUKO30	M5X0.8 ISO	0.5-3.0	14.0	7.7	0.6	7.0	7.0
TU-SM5HUKO55	M5X0.8 ISO	3.0-5.5	16.5	7.7	0.6	7.0	7.0
TU-SM6HUKO30	M6X1.0 ISO	0.5-3.0	16.0	9.8	0.7	9.0	9.0
TU-SM6HUKO55	M6X1.0 ISO	3.0-5.5	18.5	9.8	0.7	9.0	9.0
TU-SM8HUKO30	M8X1.25 ISO	0.5-3.0	18.0	11.8	0.7	11.0	11.0
TU-SM8HUKO55	M8X1.25 ISO	3.0-5.5	20.5	11.8	0.7	11.0	11.0
TU-SM10HUKO35	M10X1.5 ISO	0.8-3.5	23.0	13.8	0.7	13.0	13.0

UPO RS/UFO RS Series

Sherex Insert



UPO RS & UFO RS Large And Countersunk Knurled Metric Series.

- The UPO RS series has a large flange that provides increased strength and better containment of round or oversized holes.
- UPO RS - Unique knurling increases spin out resistance in soft materials.
- The UFO RS has a countersunk head style for flush installations.
- UFO RS - Unique knurling increases spin out resistance.

Part Number Steel	Thread Size	Grip Range	L	D	K	d	Hole Size
TU-SM4UPO30R	M4X0.7 ISO	0.5-3.0	10.75	10.0	0.75	6.3	6.4
TU-SM4UPO45R	M4X0.7 ISO	3.0-4.5	12.25	10.0	0.75	6.3	6.4
TU-SM5UPO30R	M5X0.8 ISO	0.5-3.0	12.0	11.0	1.0	7.3	7.4
TU-SM5UPO55R	M5X0.8 ISO	3.0-5.5	15.0	11.0	1.0	7.3	7.4
TU-SM6UPO30R	M6X1.0 ISO	0.5-3.0	14.5	13.0	1.5	9.3	9.4
TU-SM6UPO55R	M6X1.0 ISO	3.0-5.5	16.5	13.0	1.5	9.3	9.4
TU-SM8UPO30R	M8X1.25 ISO	0.5-3.0	16.0	16.0	1.5	11.4	11.5
TU-SM8UPO55R	M8X1.25 ISO	3.0-5.5	18.5	16.0	1.5	11.4	11.5
TU-SM10UPO35R	M10X1.5 ISO	0.8-3.5	19.75	18.5	2.25	12.9	13.0
TU-SM10UPO60R	M10X1.5 ISO	3.5-6.0	22.75	18.5	2.25	12.9	13.0
TU-SM4UFO35R	M4X0.7 ISO	1.7-3.5	11.5	9.0	1.5	6.3	6.4
TU-SM4UFO50R	M4X0.7 ISO	3.5-5.0	13.0	9.0	1.5	6.3	6.4
TU0SM5UFO40R	M5X0.8 ISO	1.7-4.0	13.0	10.0	1.5	7.3	7.4
TU-SM5UFO65R	M5X0.8 ISO	4.0-6.5	16.0	10.0	1.5	7.3	7.4
TU-SM6UFO45R	M6X1.0 ISO	1.7-4.5	17.0	12.0	1.5	9.3	9.4
TU-SM6UFO65R	M6X1.0 ISO	4.5-6.5	19.0	12.0	1.5	9.3	9.4
TU-SM8UFO45R	M8X1.25 ISO	1.7-4.5	19.0	14.0	1.5	11.4	11.5
TU-SM8UFO65R	M8X1.25 ISO	4.5-6.5	21.0	14.0	1.5	11.4	11.5
TU-SM10UFO45R	M10X1.5 ISO	1.7-4.5	21.0	15.4	1.5	12.9	13.0
TU-SM10UFO65R	M10X1.5 ISO	4.5-6.5	23.0	15.4	1.5	12.9	13.0

UKO/HUKO Inch Series



Sherex Insert

UKO & HUKO Imperial Thread Series - Stainless Steel

- The UKO inch series has a smaller flange head that gives a near flush installation.
- UKO - Round shank body.
- UKO - Dimensions in inches.
- HUKO inch series has a smaller flange head that gives a near flush installation.
- HUKO - Hexagonal shank body.
- HUKO - Dimensions in inches.

Part Number	Thread Size	Grip Range	L	D	K	Diameter Inch	Diameter Metric	Hole Size Inch	Hole Size Metric
TU-SS1032UKO30	10-32 UNF	.020-.118	.472	.295	.020	.276	7.0	.276	7.0
TU-SS2520UKO30	1/4-20 UNC	.020-.118	.571	.374	.020	.354	9.0	.354	9.0
TU-SS3118UKO30	5/16-18 UNC	.020-.118	.630	.453	.020	.433	11.0	.433	11.0
TU-SS1032HUKO30	10-32 UNF	.020-.118	.472	.295	.020	.276	7.0	.276	7.0
TU-SS2520HUKO30	1/4-20 UNC	.020-.118	.571	.374	.020	.354	9.0	.354	9.0
TU-SS3118HUKO30	5/16-18 UNC	.020-.118	.630	.453	.020	.433	11.0	.433	11.0



CLM/CKM Series

Sherex Insert

CLM & CKM Large & Small Flange Knurled Metric Body Series

- The CLM series is the true metric version of the CAL series.
- The CKM series is the true metric version of the CAK series.

Part Number	Thread Size	Grip Range	L	HD	HT	D	IL	Hole Size
CLM2-470-3.0	M4X0.7 ISO	0.25-3.00	11.5	8.62-9.38	0.75	5.95	7.10	6.00
CLM2-580-3.0	M5X0.8 ISO	0.25-3.00	13.0	9.62-10.38	1.00	6.95	7.90	7.00
CLM2-610-3.0	M6X1.0 ISO	0.50-3.00	16.0	12.62-13.38	1.50	8.95	9.40	9.00
CLM2-8125-3.0	M8X1.25 ISO	0.50-3.00	17.5	15.62-16.38	1.50	10.95	11.00	11.00
CLM2-1015-3.5	M10X1.5 ISO	0.50-3.50	22.00	18.12-18.88	2.25	12.95	14.50	13.00
CKM2-470-3.0	M4X0.7 ISO	0.25-3.00	11.3	6.70-7.20	0.46	5.95	7.10	6.00
CKM2-580-3.0	M4X0.8 ISO	0.25-3.00	12.7	7.70-8.20	0.46	6.95	7.90	7.00
CKM2-610-3.0	M6X1.0 ISO	0.50-3.00	15.3	9.70-10.20	0.50	8.95	9.40	9.00
CKM2-8125-3.0	M8X1.25 ISO	0.50-3.00	17.3	11.62-12.38	0.63	10.95	11.00	11.00
CKM2-1015-3.5	M10X1.5 ISO	0.50-3.50	20.4	13.62-14.38	0.80	12.95	14.50	13.00



Riv-Float

Sherex Insert

Riv-Float



- Accounts for tolerance stack up in joint design and misalignment during service of the joint.
- Floating nut aligns to drive angle of screw virtually eliminating cross threading and spin out.
- Allows for installation in post painted or powder coat applications where weld nuts or cage nuts are typically used.
- RoHS compliant zinc electroplate to 8 with trivalent chromate - 96/240 hours.
- Designed with higher thread strength than regular rivet nuts.
- Mechanically locked Riv-Float is available with prevailing torque feature to IFI spec 100/107.
- Ensure easy, accurate, and fast attachment of components in off-center applications.

Part Number	Thread Size	Radial Deflection	Grip Range	L	HD	HT	D	IL	Hole Size
RFK2-0832-130	8-32 UNC	0.020	0.027-.130	.7195	.455	.022	.390	.522	.391
RFK2-1032-150	10-32 UNF	0.015	0.027-.150	.7195	.455	.022	.390	.522	.391
RFK2-2520-150	1/4-20 UNC	0.030	0.027-.150	.8190	.595	.022	.530	.630	.531
RFK2-470-3.3	M4X0.7 ISO	0.51	0.7-3.3	18.28	11.56	0.55	9.91	13.25	10.00
RFK2-580-3.8	M5X0.8 ISO	0.38	0.7-3.8	18.28	11.56	0.55	9.91	13.25	10.00
RFK2-610-3.8	M6X1.0 ISO	0.76	0.7-3.8	20.80	15.11	0.55	13.46	16.00	13.50
RFL2-0832-130	8-32 UNC	0.020	.027-.130	.7195	.500	.030	.390	.522	.391
RFL2-1032-150	10-32 UNF	0.015	.027-.150	.7195	.500	.030	.390	.522	.391
RFL2-2520-150	1/4-20 UNC	0.030	.027-.150	.8190	.685	.035	.530	.630	.531
RFL2-470-3.03	M4X0.7 ISO	0.51	.07-3.3	18.28	12.70	0.76	9.91	13.25	10.00
RFL2-580-3.8	M5X0.8 ISO	0.38	0.7-3.8	18.28	12.70	0.76	9.91	13.25	10.00
RFL2-610-3.8	M6X1.0 ISO	0.76	0.7-3.8	20.80	17.40	0.89	13.46	16.00	13.50

Riv-Float Short



Sherex Insert

Riv-Float Short

- Accounts for tolerance stack up in joint design and misalignment during service of the joint.
- New low-profile design provides greater backside clearance.
- Allows for installation post finish in applications where weld nuts or cage nuts are typically used.
- Mechanically locked Riv-Float - short available with prevailing torque feature to IFI SPEC 100/107. -.020" radial float.
- RoHS Compliant.
- Ensure easy, accurate, and fast attachment of components in off-center applications.

Part Number	Thread Size	Radial Deflection	Grip Range	L	HD	HT	D	IL	Hole Size
RFSK2-0832-100	8-32 UNC	0.020	.020-.100	.394	.480	.025	.431	.246	.433
RFSK2-1024-100	10-24 UNC	0.020	.020-1.00	.394	.480	.025	.431	.246	.433
RFSK2-1032-100	10-32 UNF	0.020	.020-.100	.394	.480	.025	.431	.246	.433
RFSK2-470-2.5	M4X0.7 ISO	0.50	0.50-2.50	10.00	12.20	.63	10.95	6.25	11.00
RFSK2-580-2.5	M5X0.8 ISO	0.50	0.50-2.50	10.00	12.20	.63	10.95	6.25	11.00
RFSL2-0832-100	8-32 UNC	0.020	.020-.100	.406	.555	.033	.431	.246	.433
RFSL2-1024-100	10-24 UNC	0.020	.020-.100	.406	.555	.033	.431	.246	.433
RFSL2-1032-100	10-32 UNF	0.020	.020-.100	.406	.555	.033	.431	.246	.433
RFSL2-470-2.5	M4X0.7 ISO	0.50	0.50-2.50	10.30	14.10	.85	10.95	6.25	11.00
RFSL2-580-2.5	M5X0.8 ISO	0.50	0.50-2.50	10.30	14.10	.85	10.95	6.25	11.00

M4 and M5 Hand Tool



Sherex Hand Tool

- M4 (imperial tool) included: 1/4-20, 5/16-18, 3/8-16, and 1/2-13 head sets.
- M4 (metric tool) includes: M6, M8, M10 and M12 head sets.
- M5 (imperial tool) includes: 10-32, 1/4-20, 5/16-18 and 3/8-16 head sets.
- M5 (metric tool) includes: M5, M6, M8, and M10 head sets.



Thread Size	Head Sets	Anvil	Mandrel
6-32	MHS-0632	MA-0632	M-0632
8-32	MHS-0832	MA-0832	M-0832
10-24	MHS-1024	MA-1024	M-1024
10-32	MHS-1032	MA-1032	M-1032
1/4-20	MHS-2520	MA-2520	M-2520
1/4-28	MHS-2528	MA-2528	M-2528
5/16-18	MHS-3118	MA-3118	M-3118
5/16-24	MHS-3124	MA-3124	M-3124
3/8-16	MHS-3716	MA-3716	M-3716
3/8-24	MHS-3724	MA-3724	M-3724
1/2-13	MHS-5013	MA-5013	M-5013
1/2-20	MHS-5020	MA-5020	M-5020
M4	MHS-M4	MA-M4	M-M4
M5	MHS-M5	MA-M5	M-M5
M6	MHS-M6	MA-M6	M-M6
M8	MHS-M8	MA-M8	M-M8
M10	MHS-M10	MA-M10	M-M10
M12	MHS-M12	MA-M12	M-M12

LHF Tool

Sherex Hand Tool

LHF202 (Imperial tool) includes: 8-32, 10-24, 1/4-20 head set.
 LHF202M (Metric tool) includes: M4, M5, M6 head set. This hand tool was designed to install any rivet nut ranging in size from 6-32 to 1/4-28 (M4-M6). This tool is ideal for small production work and prototyping.

Thread Size	Mandrel	Anvil
6-32	LHFM-2528	LHFA 25
8-32	LHFM 2528	LHFA 25
10-32	LHFM 1032	LHFA 10RF
1/4-20	LHFM 2520	LHFA 25RF
M4	LHFM-2528	LHFA 25
M5	LHFM M5	LHFA M5RF
M6	LHFM M6	LHFA M6RF
6-32	LHFM 0632	LHFA 0632
8-32	LHFM 0832	LHFA 0832
10-24	LHFM 1024	LHFA 10
10-32	LHFM 1032	LHFA 10
1/4-20	LHFM 2520	LHFA 25
1/4-28	LHFM 2528	LHFA 25
M4	LHFM M4	LHFA M4
M5	LHFM M5	LHFA M5
M6	LHFM M6	LHFA M6





Flex-5P and Flex-5S

Sherex Tool

Flex-5P: The Sherex Flex-5P utilizes a pull to pressure method of installation. This method allows the same insert type to be installed into varying material thicknesses (within the grip range of the part) without any adjustment to the tool. **Flex-5S:** The Sherex Flex-5S utilizes a pull to stroke method of installation. This method allows the insert to be installed to the same distance each time. This is helpful when installing into soft materials (prevents crushing of the base material) or when a specific installed length is required.

- Installs rivet nuts from: M3-M10 and #4-40-3/8-16
- Push to start nose piece to spin on fastener
- Single stage trigger
- Automatic reverse with manual reverse bypass
- Quick change mandrel design
- Light weight tool (4.2 lbs)
- Can be suspended from a balancer
- Socket head cap screw mandrel
- Installs rivet nut studs from: M5-M8 and #10-24-5/16-24
- Available in an in-line version
- Split tool available (remote booster for lighter tool)
- Upgradeable to process monitoring

Thread Size	Complete Headset	Anvil	Mandrel	Hex Driver	Reducing Sleeve
M3	FL5-HS-M3	FL5-HS-00903	M-M3-40	FL5-HS-01003	FL5-HS-09103
M4	FL5-HS-M4	FL5-HS-00904	M-M4-55	FL5-HS-01004	FL5-HS-09104
M5	FL5-HS-M5	FL5-HS-00905	M-M5-65	FL5-HS-01005	FL5-HS-09105
M6	FL5-HS-M6	FL5-HS-00906	M-M6-65	FL5-HS-01006	FL5-HS-09106
M8	FL5-HS-M8	FL5-HS-00908	M-M8-65	FL5-HS-01008	FL5-HS-09108
M10	FL5-HS-M10	FL5-HS-00910	M-M10-65	FL5-HS-01010	XXXX
#4-40 UNC	FL5-HS-0440	FL5-HS-00854	M-0440-175	FL5-HS-00754	FL5-HS-09154
#6-32 UNC	FL5-HS-0632	FL5-HS-00856	M-0632-175	FL5-HS-00756	FL5-HS-09156
#8-32 UNC	FL5-HS-0832	FL5-HS-00858	M-0832-175	FL5-HS-00758	FL5-HS-09158
#10-24 UNC	FL5-HS-1024	FL5-HS-00850	M-1024-250	FL5-HS-00750	FL5-HS-09150
#10-32 UNF	FL5-HS-1032	FL5-HS-00850	M-1032-250	FL5-HS-00750	FL5-HS-09150
1/4-20 UNC	FL5-HS-2520	FL5-HS-00848	M-2520-250	FL5-HS-00748	FL5-HS-09148
1/4-28 UNF	FL5-HS-2528	FL5-HS-00848	M-2528-250	FL5-HS-00748	FL5-HS-09148
5/16-18 UNC	FL5-HS-3118	FL5-HS-00840	M-3118-250	FL5-HS-00740	FL5-HS-09140
5/16-24 UNF	FL5-HS-3124	FL5-HS-00840	M-3124-250	FL5-HS-00740	FL5-HS-09140
3/8-16 UNC	FL5-HS-3716	FL5-HS-00842	M-3716-250	FL5-HS-00742	XXXX
3/8-24 UNF	FL5-HS-3724	FL5-HS-00842	M-3724-250	FL5-HS-00742	XXXX

Spin Tools



Sherex Tool

Rivet Nut Pneumatic Spin - Spin Tools. Designed for installing steel or aluminum CAL, CAK, CAH, CAO, CFT/CAT, CFT/CAW and CPB rivet nut inserts. Features quick change nose piece for head set replacement without tools.



- Can install stainless in these series.
- SSG-800 Pistol Style Series
- SSG-910 Right Angle Style Series.
- SSG-900 Inline Style Series.

Part Number	Thread Size	Tool RPM'	Air Pressure	Weight	Air Inlet	Air Use	Min Hole Size	Complete Head Assembly	Hex Driver	Mandrel	Bearing Set
SSG-801, 901 & 911	4-40	3000	35-45	3.0	1/4	5	3/8	HS-0440	HD-4	M-0440-150	BS-4
SSG-801, 901 & 911	6-32	3000	70-80	3.0	1/4	5	3/8	HS-0632	HD-6	M-0632-150	BS-6
SSG-801, 901 & 911	8-32	3000	70-90	3.0	1/4	5	3/8	HS-0832	HD-8	M-0832-175	BS-8
SSG-801, 901 & 911	M3	3000	35-45	3.0	1/4	5	3/8	HS-M3	HD-M3	M-M3-150	BS-M3
SSG-801, 901 & 911	M4	3000	35-45	3.0	1/4	5	3/8	HS-M4	HD-M4	M-M4-45	BS-M4
SSG-802, 902 & 912	10-24	1500	60-80	3.0	1/4	5	3/8	HS-1024	HD-10	M-1024-200	BS-10
SSG-802, 902 & 912	10-32	1500	60-80	3.0	1/4	5	3/8	HS-1032	HS-10	M-1032-200	BS-10
SSG-802, 902 & 912	1/4-20	1500	70-90	3.0	1/4	5	3/8	HS-2520	HD-25	M-2520-200	BS-25
SSG-802, 902 & 912	1/4-28	1500	70-90	3.0	1/4	5	3/8	HS-2528	HD-25	M-2528-200	BS-25
SSG-802, 902 & 912	M5	1500	70-80	3.0	1/4	5	3/8	HS-M5	HD-M5	M-M5-50	BS-M5
SSG-802, 902 & 912	M6	1500	70-80	3.0	1/4	5	3/8	HS-M6	HD-M6	M-M6-50	BS-M6
SSG-803, 903 & 913	5/16-18	600	90-110	3.0	1/4	5	3/8	HS-3118	HD-31	M-3118-225	BS-31
SSG-803, 903 & 913	5/16-24	600	90-110	3.0	1/4	5	3/8	HS-3124	HD-31	M-3124-200	BS-31
SSG-803, 903 & 913	3/8-16	600	90-110	3.0	1/4	5	3/8	HS-3716	HD-37	M-3716-225	BS-37
SSG-803, 903 & 913	3/8-24	600	90-110	3.0	1/4	5	3/8	HA-3724	HD-37	M-3724-250	BS-37
SSG-803, 903 & 913	M8	600	90-110	3.0	1/4	5	3/8	HS-M8	HD-M8	M-M8-55	BS-M8
SSG-803, 903 & 913	M10	600	90-110	3.0	1/4	5	3/8	HS-M10	HD-M10	M-M10-55	BS-M10
SSG-804	5/16-18	600	90-110	3.0	1/4	5	3/8	HS-3118	HD-31	M-3118-225	BS-31
SSG-804	5/16-24	600	90-110	3.0	1/4	5	3/8	HS-3124	HD-31	M-3124-200	BS-31
SSG-804	3/8-16	600	90-110	3.0	1/4	5	3/8	HS-3716	HD-37	M-3716-225	BS-37
SSG-804	3/8-24	600	90-110	3.0	1/4	5	3/8	HA-3724	HD-37	M-3724-250	BS-37
SSG-804	M8	600	90-110	3.0	1/4	5	3/8	HS-M8	HD-M8	M-M8-55	BS-M8
SSG-804	M10	600	90-110	3.0	1/4	5	3/8	HS-M10	HD-M10	M-M10-55	BS-M10
SSG-808	1/2-13	275	75-120	4.0	1/4	5	3/8	HS-5013	HD-50	M-5013-225	BS-50
SSG-808	1/2-20	275	75-120	4.0	1/4	5	3/8	HS-5020	HD-50	M-5020-225	BS-50
SSG-808	M12	275	75-120	4.0	1/4	5	3/8	HS-M12	HS-M12	M-M12-300	BS-M12

Rivet Nut Hand Tool



Sherex Hand Tool



Rivet nut hand tool - the only hand tool you will ever need. Tired of buying multiple tools to install the different styles of rivet nuts? Presenting the Sherex design hand installation tool, which is capable of handling all styles of rivet nuts from 6-32 to 3/8 and M3 to M10. Tools may be purchased individually by size or in a wide variety of conversion kits. Each tool has the same body size, thereby requiring only 11/16" ratchet and one 7/8" wrench to install all sizes and styles of rivet nuts. In addition, this line of hand installation tool uses a standard socket head cap screw as a mandrel, making replacement convenient and economical.

Part Number	Thread
RNHT-0632	6-32
RNHT-0832	8-32
RNHT-1024	10-24
RNHT-1032	10-32
RNHT-2520	1/4-20
RNHT-2528	1/4-28
RNHT-3118	5/16-18
RNHT-3124	5/16-24
RNHT-3716	3/8-16
RNHT-3724	3/8-24
RNHT-4320	7/16-20
RNHT-M3	M3
RNHT-M4	M4
RNHT-M5	M5
RNHT-M6	M6
RNHT-M8	M8
RNHT-2528RF	6-32
RNHT-2528RF	8-32
RNHT-1032RF	10-32
RNHT-2520RF	1/4-20
RNHT-2528RF	M4
RNHT-M5RF	M5
RNHT-M6RF	M6

Brynof Screws
are MADE IN
THE U.S.A.

Standard Drill Screw With Bonded Washers



Brynof Manufacturing. High-quality standard drill screws with ProCorr finish are also available with galvanized bonded washers.



Part Number	Description
BA250	10-16 x 3/4 Hi-hex washer head #3 point self-drill zinc with bonded washer.
BA251	10-16 x 3/4 Hi-hex washer head #3 point self-drill ProCorr with bonded washer.
BA295	10-16 x 1-1/2 Hi-hex washer head #3 point self-drill ProCorr with bonded washer.
BA435	12-14 x 3/4 Hex washer head #3 point self-drill ProCorr with bonded washer.
BA445	12-14 x 1 Hex washer head #3 point self-drill ProCorr with bonded washer.
BA455	12-14 x 1-1/4 Hex washer head #3 point self-drill ProCorr with bonded washer.
BA465	12-14 x 1-1/2 Hex washer head #3 point self-drill ProCorr with bonded washer.
BA475	12-14 x 2 Hex washer head #3 point self-drill ProCorr with bonded washer.
BA485	12-14 x 2-1/2 Hex washer head #3 point self-drill ProCorr with bonded washer.
BA495	12-14 x 3 Hex washer head #3 point self-drill ProCorr with bonded washer.
BA510	12-14 x 4 Hex washer head #3 point self-drill ProCorr with bonded washer.
BA595	1/4-14 x 3/4 Hex washer head #3 point self-drill ProCorr with bonded washer.
BA610	1/4-14 x 7/8 #12 Hex washer head #1 point stitch self-drill ProCorr with bonded washer.
BA620	1/4-14 x 1 Hex washer head #3 point self-drill ProCorr with bonded washer.
BA630	1/4-14 x 1-1/4 Hex washer head #3 point self-drill ProCorr with bonded washer.
BA640	1/4-14 x 1-1/2 Hex washer head #3 point self-drill ProCorr with bonded washer.
BA650	1/4-14 x 2 Hex washer head #3 point self-drill ProCorr with bonded washer.
BA660	1/4-14 x 2-1/2 Hex washer head #3 point self-drill ProCorr with bonded washer.
BA670	1/4-14 x 3 Hex washer head #3 point self-drill ProCorr with bonded washer.
BA675	1/4-14 x 4 Hex washer head #3 point self-drill ProCorr with bonded washer.

Standard Drill Screws in 302 SS with Silver Topcoat (SWD)

Brynof Manufacturing. This material provides exceptional corrosion protection. These screws can not drill into steel but work very well in aluminum. ProCorr GB topcoat mitigates the significant galvanic reaction that can occur between stainless steel and aluminum. The head marking and non-magnetic condition identifies it as a 300 series stainless fastener.



Part Number	Description
AC255	10-16 x 3/4 Hex washer head #3 point stainless steel self-drill ProCorr GB.
AC470	12-14 x 3/4 Hex washer head #3 point 302 stainless steel self-drill ProCorr GB.
AC480	12-14 x 1 Hex washer head #3 point 302 stainless steel self-drill ProCorr GB.
AC665	1/4-14 x 3/4 Hex washer head #3 point 302 stainless steel self-drill ProCorr GB.
AC680	1/4-14 x 1 Hex washer head #3 point 302 stainless steel self-drill ProCorr GB.

Heavy Drillers #4 & #5 points for steel Up to 1/2" Thick.

Brynof Manufacturing. All parts have ProCorr coating with 1000 hour salt spray performance.



Part Number	Description
AB250	12-24 x 7/8 Hex washer head #4 point self-drill ProCorr coated.
AB265	12-24 x 1-1/4 Hex washer head #4.5 point self-drill ProCorr coated.
AB280	12-24 x 1-1/4 Hex washer head #5 point self-drill ProCorr coated.
AB295	12-24 x 1-1/2 Hex washer head #5 point self-drill ProCorr coated.
AB310	12-24 x 2 Hex washer head #5 point self-drill ProCorr coated.
AB330	12-24 x 3 Hex washer head #5 point self-drill ProCorr coated.



Heavy Drillers #4 & #5 points with bonded Washers



Brynof Manufacturing. All parts have ProCorr coating with 1000 hour salt spray performance.

Part Number	Description
BB250	12-24 x 7/8 Hex washer head #4 point self-drill ProCorr with bonded washer.
BB265	12-24 x 1-1/4 Hex washer head #4.5 point self-drill ProCorr with bonded washer.
BB280	12-24 x 1-1/4 Hex washer head #5 point self-drill ProCorr with bonded washer.
BB295	12-24 x 1-1/2 Hex washer head #5 point self-drill ProCorr with bonded washer.
BB310	12-24 x 2 Hex washer head #5 point self-drill ProCorr with bonded washer.
BB330	12-24 x 3 Hex washer head #5 point self-drill ProCorr with bonded washer.

Standard Self Drill Screws

Brynof Manufacturing. The following are what is considered to be the basic parts of any construction drill screw program. All but one feature Brynof's ProCorr coating, which provides 1000 hours of salt spray protection.



Part Number	Description
AA250	10-16 x 3/4 Hi-hex washer head #3 point self-drill zinc plated
AA251	10-16 x 3/4 Hi-hex washer head #3 point self-drill ProCorr coated
AA270	10-16 x 1 Hi-hex washer head #3 point self-drill ProCorr coated
AA295	10-16 x 1-1/2 Hi-hex washer head #3 point self-drill ProCorr coated
AA435	12-14 x 3/4 Hex washer head #3 point self-drill ProCorr coated
AA445	12-14 x 1 Hex washer head #3 point self-drill ProCorr coated
AA455	12-14 x 1-1/4 Hex washer head #3 point self-drill ProCorr coated
AA465	12-14 x 1-1/2 Hex washer head #3 point self-drill ProCorr coated
AA475	12-14 x 2 Hex washer head #3 point self-drill ProCorr coated
AA485	12-14 x 2-1/2 Hex washer head #3 point self-drill ProCorr coated
AA495	12-14 x 3 Hex washer head #3 point self-drill ProCorr coated
AA510	12-14 x 4 Hex washer head #3 point self-drill ProCorr coated
AA595	1/4-14 x 3/4 Hex washer head #3 point self-drill ProCorr coated
AA610	1/4-14 x 7/8 #12 Hex washer head #1 point stitch self-drill ProCorr coated
AA620	1/4-14 x 1 Hex washer head #3 point self-drill ProCorr coated
AA630	1/4-14 x 1-1/4 Hex washer head #3 point self-drill ProCorr coated
AA640	1/4-14 x 1-1/2 Hex washer head #3 point self-drill ProCorr coated
AA650	1/4-14 x 2 Hex washer head #3 point self-drill ProCorr coated
AA660	1/4-14 x 2-1/2 Hex washer head #3 point self-drill ProCorr coated
AA670	1/4-14 x 3 Hex washer head #3 point self-drill ProCorr coated
AA675	1/4-14 x 4 Hex washer head #3 point self-drill ProCorr coated

GR-5 Drill Screw

Brynof Manufacturing. The alternative to Elco Dril-Flex drill screws, GR-5 drill screws are made from alloy steel heat treated to Grade 5 specifications (RC 28-34), with a higher hardness on the drill point and lead threads, and coated with out ProCorr finish. This creates a drill screw that provides quick, positive drilling while preventing vbrittle failures and eliminating "head popping".



Part Number	Description
AD240	10-16 x 3/4 Hex Washer Head #3 Pt.
AD465	12-14 x 7/8 Hex Washer Head #3 Pt.
AD470	12-14 x 1 Hex Washer Head #3 Pt.
AD480	12-14 x 1-1/2 Hex Washer Head #4 Pt.
AD485	12-14 x 1-1/2 Hex Washer Head #3 Pt.
AD495	12-14 x 2 Hex Washer Head #3 Pt.
AN200	12-14 x 1 Phillips Undercut Flat #3 Pt.
AD590	12-24 x 1-3/4 Hex Washer Head #5 Pt.
AD665	1/4-14 x 1 Hex Washer Head #3 Pt.
AD685	1/4-14 x 1-1/2 Hex Washer Head #3 Pt.
AD705	1/4-14 x 2 Hex Washer Head #3 Pt.
AD765	1/4-20 x 1-1/8 Hex Washer Head #4 Pt.
AD785	1/4-20 x 1-1/2 Hex Washer Head #4 Pt.
AD790	1/4-20 x 1-3/4 Hex Washer Head #5 Pt.
AD800	1/4-20 x 2 Hex Washer Head #4 Pt.
AD815	1/4-20 x 2-1/2 Hex Washer Head #4 Pt.
AD830	1/4-20 x 3-3/8 Hex Washer Head #4 Pt.

Threaded Rod



Threaded Rod

Part Number	Description
HTHR025	1/2" X 20 12' All Threaded Rod EG
HTHR037	3/8" X 16 12' All Threaded Rod EG
HTHR050	1/2" X 13 12' All Threaded Rod EG

Strut

Unistrut

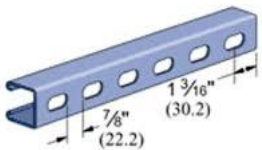

Part Number	Description
P1000 10 GR	1-5/8" X 1-5/8" X 10', 12 GA, Green 10 GR
P1000 10 PG	1-5/8" X 1-5/8" X 10', 12 GA., 10 PG
P1000T 10 GR	1-5/8" X 1-5/8" X 10', 12 GA, Slotted Hole, Green 10 GR
P1000T 10 PG	1-5/8" X 1-5/8" X 10', 12 GA, Slotted Hole, 10 PG
P1001 10 GR	1-5/8" X 3-1/4" X 10', 12 GA, Green 10 GR
P1001 10 PG	1-5/8" X 3-1/4" X 10', 12 GA, 10 PG
P1001T 10 GR	1-5/8" X 3-1/4" X 10' 12 GA Slotted Hole, Green 10 GR
P1001T 10 PG	1-5/8" X 3-1/4" X 10', 12 GA Slotted Hole, 10 PG
P3001 10 GR	1-5/8" X 2-3/4" X 10', 12 GA, 10 GR
P3001 10 PG	1-5/8" X 2-3/4" X 10' 12 GA, 10 PG
P3300 10 GR	1-5/8" X 7/8" X 10' 12 GA, 10 GR
P3300 10 PG	1-5/8" X 7/8" X 10' 12 GA, 10 PG
P3300T 10 GR	1-5/8" X 7/8" X 10' 12 GA Slotted Hole, 10 GR
P3300T 10 PG	1-5/8" X 7/8" X 10' 12 GA Slotted Hole, 10 PG
P3301 10 GR	1-5/8" X 1-3/4" X 10' 12 GA, 10 GR
P3301 10 PG	1-5/8" X 1-3/4" X 10' 12 GA, 10 PG
P3301T 10 GR	1-5/8" X 1-3/4" X 10' 12 GA Slotted Hole, 10 GR
P3301T 10 PG	1-5/8" X 1-3/4" X 10' 12 GA Slotted Hole, 10 PG
P4000 10 GR	1-5/8" X 13/16" X 10' 16 GA, 10 GR
P4000 10 PG	1-5/8" X 13/16" X 10' 16 GA, 10 PG
P4000T 10 GR	1-5/8" X 13/16" X 10' 16 GA Slotted Hole, 10 GR
P4000T 10 PG	1-5/8" X 13/16" X 10' 16 GA Slotted Hole, 10 PG
P4001 10 GR	1-5/8" X 1-5/8" X 10' 16 GA, 10 GR
P4001 10 PG	1-5/8" X 1-5/8" X 10' 16 GA, 10 PG
P4100 10 GR	13/16" X 1-5/8" X 10' 14 GA, 10 GR
P4100 10 PG	13/16" X 1-5/8" X 10' 14 GA, 10 PG
P4100T 10 GR	13/16" X 1-5/8" X 10' 14 GA Slotted Hole, 10 GR
P4100T 10 PG	13/16" X 1-5/8" X 10' 14 GA Slotted Hole, 10 PG

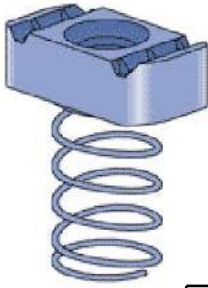

Strut and Rod Accessories

Accessories

Part Number	Description
HFLW037 EG	3/8" Flat round washer
150516250	5/8" Flat round washer
HFLW050 EG	1/2" Flat round washer
HHCS037125 EG	3/8" x 1-1/4" Hex head cap screw
HHCS050094 EG	1/2" x 15/16" Hex head cap screw
HHCS050119 EG	1/2" x 1-3/16" Hex head cap screw
HHXN037 EG	3/8" Hexagon nut
150511625	5/8" Hexagon nut
HHXN050 EG	1/2" Hexagon nut
K1063 EG	3/8" KWIK washer ZNPLTD
L1064 EG	1/2" KWIK washer, ZNPLTD
P1006-1420 EG	1/4-20 Channel nut with spring
P4006-1420EG	1/4-20 Channel nut with spring
P1008 EG	3/8" Spring nut for P1000 series channel
P1010 EG	1/2" Spring nut for P1000 series channel
150506250	5/8" Spring nut for 1-5/8 channel
P4008 EG	3/8" Spring nut for P4100 series channel
P4010 EG	1/2" Spring nut for P4100 series channel
P3006-1420 EG	1/4" Channel nut without spring
P3008 EG	3/8" Channel nut without spring
P3010 EG	1/2" Channel nut without spring
P3013 EG	1/2" Channel nut without spring
P1062 EG	5/16" Square washer
P1062 GR	5/16" Square washer
P1063 EG	3/8" Spring washer, ZNPLTD
P1063 GR	3/8" Square washer
P1064 EG	1/2" Square washer ZNPLTD
P1064 GR	1/2" Square washer
P2471 EG	3/4" Square washer
P2785 EG	Beam clamp
P2786 EG	Beam clamp
P1047 EG	"U" shape fittings
P1047 GR	"U" shape fittings
P1067 EG	Flat plate fitting
P1067 GR	Flat plate fitting
P1080A EG	Flat plate fitting
P1380A GR	Flat plate fitting
P2072A EG	Wing shape fittings
P2072A GR	Wing shape fittings
P2072A SQ EG	Wing shape fittings
P2072A SQ GR	Wing shape fittings
P1111 EG	1/2" Pipe clamps for rigid steel conduit
P1112 EG	3/4" Pipe clamps for rigid steel conduit
P1113 EG	1" Pipe clamp for rigid steel conduit
P1114 EG	1-1/4" Pipe clamps for rigid steel conduit
P1115 EG	1-1/2" Pipe clamps for rigid steel conduit
P1117 EG	2" Pipe clamps for rigid steel conduit
P1118 EG	2-1/2" Pipe clamps for rigid steel conduit
P1119 EG	3" Pipe clamps for rigid steel conduit
P1120 EG	3-1/2" Pipe clamps for rigid steel conduit
P1121 EG	4" Pipe clamps for rigid steel conduit
P1211 EG	1/2" Universal clamps for rigid or thin wall conduit
P1212 EG	3/4" Universal clamps for rigid or thin wall conduit
P1213 EG	1" Universal clamps for rigid or thin wall conduit
P1214 EH	1-1/4" Universal clamps for rigid or thin wall conduit
P1215 EG	1-1/2" Universal clamps for rigid or thin wall conduit
P1217 EG	2" Universal clamps for rigid or thin wall conduit
P1425 EG	1/2" Pipe clamps for thin wall conduit (E.M.T.)
P1431 EG	2" Pipe clamps for thin wall conduit (E.M.T.)
P2038 EG	2" Pipe clamps for O.D. tubing



St. Louis Pneumatic Tool



Made in the U.S.A.

Part Number	Item	Description
SLP-83025	1/4" Heavy duty die grinder	20,000 RPM performance generated from the .5 horsepower motor. Includes two wrenches.
SLP-83030	1/4" Low-speed heavy duty die grinder	3,500 RPM for grinding and material removal applications requiring high torque and low speed. Includes two wrenches
SLP-83125	1/4" Mini die grinder	25,000 RPM, rear exhaust. Includes two wrenches.
SLP-83120	120 Degree mini die grinder	20,000 RPM with .3 horsepower. Includes two wrenches.
SLP-83150	1/4" Right angle mini die grinder	20,000 RPM with .3 horsepower. Includes two wrenches.
SLP-83154	1/4" Low-speed right angle mini die grinder	Includes rear exhaust feature and two wrenches.
SLP-83150SPK	Surface preparation kit with 1/4" right angle mini die grinder	Includes SLP-83150, 1/4 right angle mini die grinder, grinding stones, flap wheel, 3" R-type holder, 2" R-type holder and collet wrenches.
SLP-83151	Mini angle head die grinder with R-type spindle	Includes safety throttle lever and wrenches.
SLP-83225	1/4" mid-size die grinder	22,000 vibrationless performance with rear exhaust. Equipped with safety throttle lever. Includes two wrenches.
SLP-83060	1/4" Pistol grip die grinder	18,000 RPM and through-handle exhaust. Includes two wrenches.
SLP-83225L	1/4" Lighted mid-size die grinder	Equipped with safety throttle lever. Features 22,000 RPM and rear exhaust. Includes two wrenches.
SLP-83260L	1/4" Lighted mini pistol grip die grinder	Includes through-handle exhaust and two wrenches.
SLP-82030	3" Horizontal cut-off grinder	.5 horsepower motor. Equipped with safety throttle lever. Includes 3" cutting wheel and hub wrench.
SLP-82032	4" Horizontal cut-off grinder	Includes 4" cutting wheel and hub wrench.
SLP-84025	1/4" Mini angle drill	.3 horsepower motor delivers 20,000 RPM. 1/4" Drill chuck. Equipped with safety throttle lever.
SLP-84026	1/4" Low-speed mini angle drill	4,500 RPM, 1/4" drill chuck, equipped with safety throttle lever.
SLP-84038	Heavy duty in-line drill	20,000 RPM, equipped with safety throttle lever.
SLP-84228L	3/8" Lighted in-line drill	22,000 RPM with rear exhaust. Equipped with safety throttle.
SLP-84138	3/8" High speed drill	18,000 RPM. Includes chuck key.
SLP-84140	1/4" High-speed drill	Includes industrial duty 1/4" drill chuck and key.
SLP-84538	1/4" Mini low-speed drill	2,100 RPM and .4 horsepower. Includes chuck key.
SLP-84538L	1/4" Lighted low-speed mini drill	.4 horsepower and 2,100 RPM. Includes 1/4" industrial duty chuck and key.
SLP-84128	3/8" Low speed drill	.5 horsepower motor, includes industrial duty 3/8" drill chuck and key.
SLP-84338L	3/8" Lighted low-speed drill	2,250 RPM. Includes chuck key.
SLP-84238	3/8" Reversible low-speed drill	.5 horsepower motor. Includes industrial duty 3/8" chuck and key. Also includes auxiliary side handle.
SLP-84250	1/2" Reversible low-speed drill	Includes industrial duty 1/2" drill chuck and key. Also includes auxiliary side handle.
SLP-84228L	Lighted high-speed in-line drill	22,000 RPM with rear exhaust. Equipped with safety throttle lever.
SLP-84438L	Lighted low-speed in-line drill	Includes rear exhaust feature. Chuck key included.
SLP-84338L	3/8" Lighted low-speed drill	2,250 RPM. Includes chuck key.
SLP-84538L	1/4" Lighted low-speed mini drill	2,100 RPM, includes 1/4" industrial duty chuck and key.
SLP-83225L	1/4" Lighted mid-size die grinder	Features 22,000 RPM and rear exhaust. Includes two wrenches.
SLP-83260L	1/4" Lighted mini pistol grip die grinder	Includes through-handle exhaust and two wrenches.
SLP-87025	1/4" mini ratchet	280 RPM, features double pawl construction and rear exhaust.
SLP-87038	3/8" Stubby ratchet	280 RPM.
SLP-87238	3/8" Super duty ratchet	.5 Horsepower motor, 200 RPM. Rear exhaust directs air away from the work area.
SLP-87138	3/8" Heavy duty ratchet	230 RPM.
SLP-81070	5" Disc sander	18,000 RPM, includes 3" and 5" backing pads and hub wrench.
SLP-85300	Heavy duty medium barrel hammer	Includes one spring-type chisel retainer.
SLP-82140	4" Angle grinder	12,000 RPM and rear exhaust performance, imported.
SLP-82145	4-1/2" Angle grinder	12,000 RPM and rear exhaust performance, imported.
SLP-82170	7" Angle grinder	7,500 RPM and with an air motor rated at 1.25 horsepower, imported.
SLP-86012	Mini needle scraper	Includes 12 needles, imported.
SLP-84619	Needle scaler	Includes 4,600 blows per minute. Includes needle tube with three positions and 19 needles, imported.
SLP-87550	1/2" Twin regulator impact wrench	405 ft.-lbs of maximum torque.
SLP-87580	1" Impact wrench	1,100 ft.-lbs. imported.
SLP-87575	3/4" Impact wrench	1,100 ft. - lbs., imported.

St. Louis Pneumatic Tool

Commodity Fasteners

- Bolts

Hex Bolts, Hex Screws, Machine Bolts, Tap Bolts, Carriage Bolts, Timber Bolts, Lag Screws Hex Head, Plow Bolts, Step Bolts, Elevator Bolts, and Anchor Bolts with Nut and Washer.

- Structural Bolts

Structural Bolts A325 Hex Head, Structural Bolts A325 Hex Head Full Thread, Structural Bolts A325 Hex Head USA, tension Control Bolt Assemblies A325, Tru-Tension Bolt Assemblies A325 USA, Structural Bolts A490 Hex Head, Structural Bolts A490 Hex Head USA, Tension Control Bolt Assemblies A490, and Tru-Tension Bolt Assemblies A490 USA.

- Cap Screws

Cap Screws Grade 2, Cap Screws Grade 5 NC, Cap Screws Grade 5 NF, Cap Screws Grade 5 NC USA, Cap Screws Grade 5 NF USA, Cap Screws Grade 8 NC USA, and Cap Screws Grade 8 NF USA.

- Threaded Rod and Studs

threaded Rod Grade A NC, Threaded Rod Grade A NF, Threaded Rod Grade A Left Hand, Threaded Rod Grade B7 Alloy Steel NC, Threaded Rod Grade B7 Alloy Steel NF, Threaded Rod Grade B7 Alloy Steel 8 Pitch, and Studs Grade B7 Alloy Steel.

- Steel Stock

Steel Rounds Unthreaded Rod, Keystock Square, Steel Flats, Slotted Steel Flats, Steel Angles, and Slotted Steel Angles.

- Nuts

Finished Hex Nuts, Hex Jam Nuts, Heavy Hex Nuts, Square Nuts, Hex Machine Nuts, Square Machine Screw Nuts. Slotted Finished Hex Nuts, Hi Nuts, Coupling Nuts, Left Hand Finished Hex Nuts, Wing Nuts, Acorn Nuts, Cap Nuts, T Nuts, Nylon Insert Locknuts, All Metal Hex Locknuts, Reversible Locknuts, Star Locknuts, Hex Flange Nuts, Full Height Heavy Flexloc, Thin Height Heavy Flexloc, Full Height Large Diameter Flexloc, Thin Height Large Diameter Flexloc, Microsize Flexloc, and Full Height Metric Flexloc.

- Washers

USS Flat Washers, SAE Flat Washers, Fender Washers, F436 Hard Round Washers, F436 Square Bevel Hardened Washer, D.T.I. Washers, Cultivator Washers, Round Malleable Washers, Shear Plate Malleable Washers, Finishing Washers, Bond Sealing Washers, Split Lock Washers, and Lock Washers.

- Machine Screws

Machine Screws, Stove Bolts, Sems Screws, and Thumb Screws.

- Wood Screws

- Tapping Screws

Tapping Screws, Thread Cutting Screws, and Thread Rolling Screws.

- Self Drilling Screws

Self Drilling Screws, and Self Drilling Drywall Screws.

- Construction Screws

Drywall Screws, Deck Screws, Woodex Screws, Dec-King External Wood Screws, Particle Board Screws, Laminating Screws, Trugrip GT Hex Washer Head, and Woodbinder Pole Barn Screws.

- Anchoring Products

Wedge Anchors, Sleeve Anchors, Drop-In Anchors, Plastic Anchors, Hollow Wall Anchors, Cobra Anchors, Toggle Anchors & Bolts, Nylon Nail Anchors, Eye Couplings, Mungo Framing Anchors, Mungo Plugs, Machine Screw Anchors, Wood Screw Anchors, Expansion Anchors, Hammer Drive Anchors, Acoustical Screws, Concrete Screws & Bits.

- Sockets

Socket Head Cap Screw, Socket Flat Head Cap Screw, Socket Button Head Cap Screw, Socket Set Screw, Soucket Head Shoulder Screw, Square Head Set Screws, and Hex Keys.

- Metric Fasteners

- Stainless Steel

- Brass

- Drill Bits

BRAUER FASTENER QUOTE REQUEST FORM

Rivet

Date: _____

Type (open, closed, mono & etc.): _____

Rivet Diameter: _____

Rivet body length (B): _____

Grip Range: _____

Finish: _____

Material: _____

Quantity: _____

A: _____

C: _____

D: _____

Other important information: _____

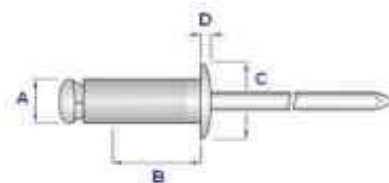

Solid/Tubular Rivet

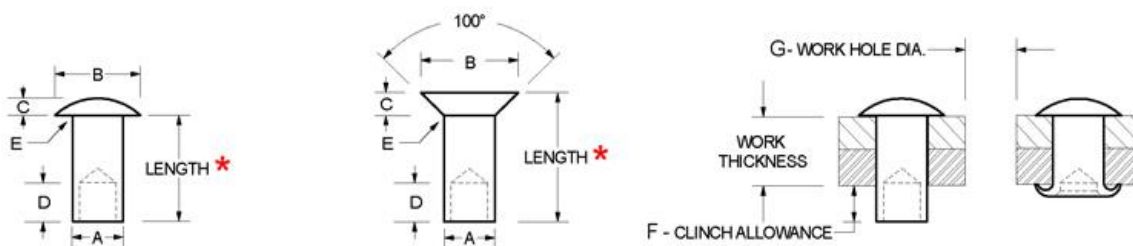

Type (solid, semi & etc.): _____

Length: _____

A: _____

B: _____

C: _____

D: _____

E: _____

Finish: Material: Quantity: _____

Other important information: _____

Inserts

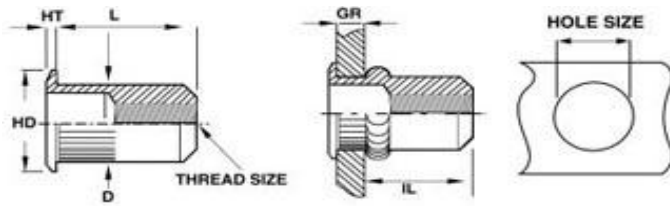

Open End

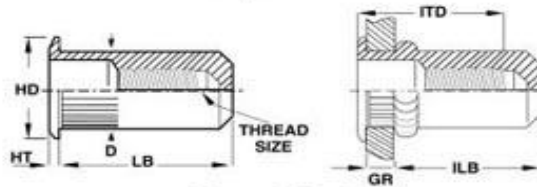

Closed End

Type (large flange, small flange & etc): _____

Length (L): _____

HD: _____

HT: _____

D: _____

Thread Size: _____

Hole Size: _____

Grip Range: _____

Finish: _____

Material: _____

Quantity: _____

Other important information: _____

Screws

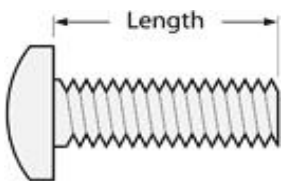

Head Above Surface

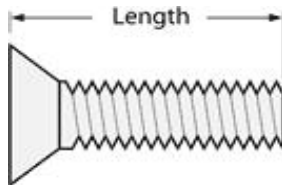

Countersunk Head

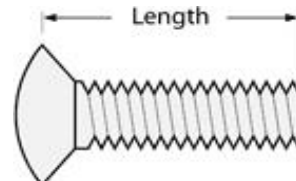

Oval Head

Type: _____

Length (L): _____

Diameter: _____

Thread Pitch or Count: Finish: _____

Material: _____

Quantity: _____

Other important information: _____



International
Organization for
Standardization



Brynmolf
Manufacturing, Inc.

Lobster Tools



*The Most Comprehensive Line
of Blind Rivet Nuts in the World!*



BARKER



POP®



Brauer Supply Company General Terms, Conditions, Freight Policies, and Return Policies

(This document is for Reference only. For the latest guidelines, visit www.brauersupply.com)

PRICE:

- All orders subject to the prices in effect on the date of shipment or specific quotation.
- All prices and specifications subject to change without notice.

TERMS:

- 10TH Prox / Net 30 Days from Date of Invoice.
- Payment Discounts, if any, will be shown on the invoice.
- Customer agrees to pay service charges of 1 ½ % per month on all past due accounts.
- Customer agrees to pay a \$30.00 service charge on any and all returned checks.
- Customer agrees to pay any and all costs involved in the recovery of monies owed due to returned checks, past due accounts, or other causes resulting in money owed to Brauer Supply Company. These monies include, but are not limited to the original amounts owed along with collection fees, attorney fees, court costs, and any other fees and/or charges related to the collection of amounts owed.

MINIMUM BILLING AND SPECIAL ORDERS:

- \$10.00 minimum on all cash and/or check purchases.
- \$20.00 minimum on all charge, CBD, or COD purchases.
- A minimum of 25% deposit will be required on orders for special material.

SHORTAGES DUE TO BRAUER SUPPLY COMPANY ERROR:

- All claims of shortages, errors, or defective goods must be filed within fifteen (15) days after receipt of material (See below for Return Goods policies related to errors or defective goods).

WARRANTIES:

- All statements, warranties, and product representations relating to products sold by Brauer Supply Company are those stated on the most current literature from our manufacturers/suppliers. Brauer Supply Company makes no warranties of its own, either expressed or implied.

LIMITATION OF LIABILITY:

- Brauer Supply Company will not be liable for failure to deliver product to purchaser in a timely fashion for any reason, including, but not limited to, market conditions, product scarcity, failure of manufacturer to meet production schedules, credit decisions, or any other circumstances whether or not under the direct control of Brauer Supply Company, nor will Brauer Supply Company be held liable for any actual, consequential, or liquidated damages resulting from the above conditions. Any provisions, statements, or conditions in purchaser's request-to-quote or purchase order, either written or oral, are hereby specifically rejected.
- Brauer Supply's failure to perform any term or condition of sales agreements as a result of conditions beyond its control, such as, but not limited to, war, strikes, fires, floods, acts of terrorism, civil unrest, acts of God, governmental restrictions, power failures, or damage, failure, or destruction of computer/network systems/facilities/servers, shall not be deemed a breach of those agreements.

RETURN OF GOODS:

- No goods or materials will be accepted for return without our written consent in the form of an RGA (Return Goods Authorization). This can be expedited by supplying us, via telephone, email, or in writing, with the following information -
 1. Date and number of the invoice on which the material was billed. If material not yet invoiced, the date and number of work order and/or packing list.
 2. Description and quantity of the material being returned.
 3. Reason for the return.
- No material will be accepted for return unless the following conditions are met -
 1. Stock items must have been purchased within 120 calendar days preceding the date of return. If material was defective or shipped incorrectly, Brauer Supply Company must be notified within 15 days of the date on which the material shipped.

BRAUER SUPPLY COMPANY FREIGHT POLICIES

2. Special items or Brauer Supply non-stock items will not be accepted for return unless our suppliers agree to accept the returned material.
 3. Material must be returned in original cartons and in a resalable condition as determined solely by Brauer Supply Company.
 4. The customer agrees to pay all transportation charges for the return to Brauer Supply Company and/or the manufacturer.
- Once Brauer Supply Company agrees to accept the return, you will receive a written Return Goods Authorization. Upon receipt of the material at Brauer Supply Company or at our supplier as applicable, Brauer Supply Company will credit your account subject to the following terms –
 1. All packing slips and paperwork originating with the customer must reference the Return Goods Authorization number and the date and invoice number (or date and work order / packing slip number if not yet invoiced) on which the material was originally billed (or shipped if not yet invoiced).
 2. Material which can be put back into Brauer Supply Company stock will be credited back at invoice price, less 10% for material returned in full cartons or less 25% for broken cartons.
 3. Special items and Brauer Supply non-stock items for which our suppliers have agreed to accept the return will be credited at invoice price less a pre-agreed restocking charge.
 4. If the return is due to an error by Brauer Supply Company or our supplier, Brauer Supply will either pick up the material, or request that you ship the material to Brauer Supply Company or our Supplier as applicable. Replacement material will be shipped or delivered promptly. Brauer Supply Company or our supplier will pay all freight charges related to the return of defective or incorrect material and the replacement of same with proper material. Replacement material will then be billed in the usual manner.
 5. Any credits due will be applied to open balances for future orders. Cash customers will receive a check or credit card credit issued from our accounting office.
 6. Brauer Supply reserves the right to apply any refund to any outstanding balance that may exist on a customer's account.

FREIGHT POLICIES AS OF MAY 1, 2013

- All shipments of \$150.00 or more will be shipped freight allowed via our trucks on regularly scheduled days in our regular delivery areas.
- Invoices of less than \$150.00 shipped via Brauer Supply Company vehicles on regularly scheduled days in our regular delivery areas will be subject to a \$25.00 delivery fee.
- Any fuel surcharges in effect will apply to all shipments made via Brauer Supply Company vehicles regardless of order size.
- Contact our office for details on regular delivery schedules and areas.
- Short shipped or backordered items regardless of order size may qualify for freight allowed shipping.
- All orders shipped via UPS or other third party carriers will be sent prepaid, no freight allowed and be subject to an \$8.00 handling charge.
- Orders may be sent 3rd party freight allowed when shipped for Brauer Supply Company's convenience or to fulfill back orders.
- All LTL (less than full truckload) shipped via common carrier will be shipped prepaid, no freight allowed. Freight charges will be billed to customer. Large orders or specifically quoted material may qualify for allowed freight.
- Material shipped direct from one of our manufacturers/suppliers to a customer will be shipped according to their freight policies. Freight charges may be billed to the customer according to such policies.
- Certain material is always shipped no freight allowed. Contact your salesperson or our inside customer service personnel for details.
- When Brauer Supply Company incurs the freight cost, Brauer reserves the right to select the carrier.
- When the customer specifies a carrier or requests expedited delivery/special handling, the customer will be responsible for all freight charges.



The Complete Industrial Supply House

Headquarters

1218 South Vandeventer Avenue
St. Louis, MO 63110
314-534-7150
Fax: 314-534-1816

Union Branch

498 Dubois Valley Drive
Union, MO 63084
636-583-8855
Fax: 636-583-8286

Insulation Division

1218 South Vandeventer Avenue
St. Louis, MO 63110
314-534-7150
Fax: 314-534-6867

Joplin Branch

1802 Katherine Street
Joplin, MO 64801
417-624-9600
Fax: 417-624-9602

Jackson Branch

2652 S Old Orchard Road
Jackson, MO 63755
573-243-4877
Fax: 573-243-9484

Festus Branch

1014 Airport Road
Festus, MO 63028
636-931-8600
Fax: 636-931-8601

Columbia Branch

3320 Brown Station Rd
Columbia, MO 65202
573-442-1171
Fax: 573-875-0730

Springfield, MO Branch

3105-A East Elm
Springfield, MO 65802
417-862-7117
Fax: 417-862-7997

O'Fallon Branch

1231 Tom Ginnever Avenue
O'Fallon, MO 63366
636-978-6700
Fax: 636-978-6720

Springfield, IL Branch

1475 Taylor Avenue
Springfield, IL 62703
217-544-0265
Fax: 217-544-0715

Swansea Branch

105 Service Street
Swansea, IL 62226
618-233-1733
Fax: 618-233-4426

Kansas City Branch

74 South James Street
Kansas City, KS 66118
913-281-3100
Fax: 913-281-3103

