

WELL ORIGIN LIMITED / AMAC CORPORATE JET AG

A319-115 VP-CAD

MSN 05040

AIRCRAFT SPECIFICATION SUMMARY

Completion outfitted at AMAC Aerospace AG Basel



GENERAL INFORMATION

Manufacturer Serial Number	05040	Engine Model	CFM56-5B7/3
AICJ Fleet Number:	110	Current Operator	AMAC CORPORATE JET AG
Date of First Flight:	06 Mar 2012		
Entry Date of First Service:	25 Feb 2013		
Zero Clock Setting date:	06 Mar 2015 (at 21:12 FH & 15 FC)		
VIP cabin Refurbishing Period:	02 Apr 2014 to 02 October 2015		
4 ATCs installed:			
ACT 1	3 121 l (824 US Gal)	ACT 2	3 121 l (824 US Gal)
ACT 3	2 186 l (577 US Gal)	ACT 4	2 186 l (577 US Gal)

OPERATIONAL WEIGHTS

Weight Variant: **WV 10**

Maximum Taxi Weight	76 900 kg	169 535 lb
Maximum Takeoff Weight (MTOW)	76 500 kg	168 653 lb
Maximum Landing Weight (MLW)	62 500 kg	137 788 lb
Maximum Zero Fuel Weight (MZFW)	58 500 kg	128 970 lb
Minimum Weight	35 400 kg	78 044 lb

TIME / CYCLE DATA - AIRFRAME (as of 22 June 2018)

Hours since New **61:37 Flight Hours**

Cycles since New **27 Flight Cycles**

TIME / CYCLE DATA - ENGINES

<u>Pos.</u>	<u>Serial No.</u>	<u>Hrs / Cycles Since New</u>	<u>Item / Limit</u>	<u>Shop Visit</u>
1	643891	61:34 Hrs / 27 Cyc	N/A	No
2	643893	61:34 Hrs / 27 Cyc	N/A	No

TIME / CYCLE DATA – APU

APU HRS: **325**

APU CYC: **254**

MAINTENANCE CHECK DATA (Cayman CAA Approved Program)

<u>Check</u>	<u>Check Life</u>	<u>Last Actioned</u>	<u>Next Due</u>
1A Check	6 MO	30 June 2018	06 September 2018
1C Check	24 MO	30 June 2018	06 March 2020
6 Year Check / 3C	72 Months	N/A	06 March 2021
12 Year Check/ 6C	144 Months	N/A	06 March 2027
LDG Overhaul	120 Months	N/A	06 March 2022

Note: Last Maintenance Performed by AMAC Aerospace AG Basel EASA Approval Certificate N° CH.145.0363& CAACI Approval Certificate N°015- CAY-AMO-2008 on the **30 of June 2018**, accomplished Return to Operation after 2YR storage, schedule MX tasks up to 1C check, SB Package and ADs.

INTERIOR

- Aircraft delivered “green” by Airbus
- Interior installation completed by AMAC Aerospace AG Basel (completion started on 02 April 2014)
- Aircraft entered into VIP service in October 2015

INTERIOR CONFIGURATION

Seating Capacity (TT&L): **19 PAX and 2 Flight Attendants (ref. to LOPA)**

Forward Galley (Sell): **G 1 Pos.**

Rear Galley (Sell): **G 4 Pos. & G5 Pos.**

Lavatories: **1 Fwd, 1 Mid (bathroom), 1 Aft**

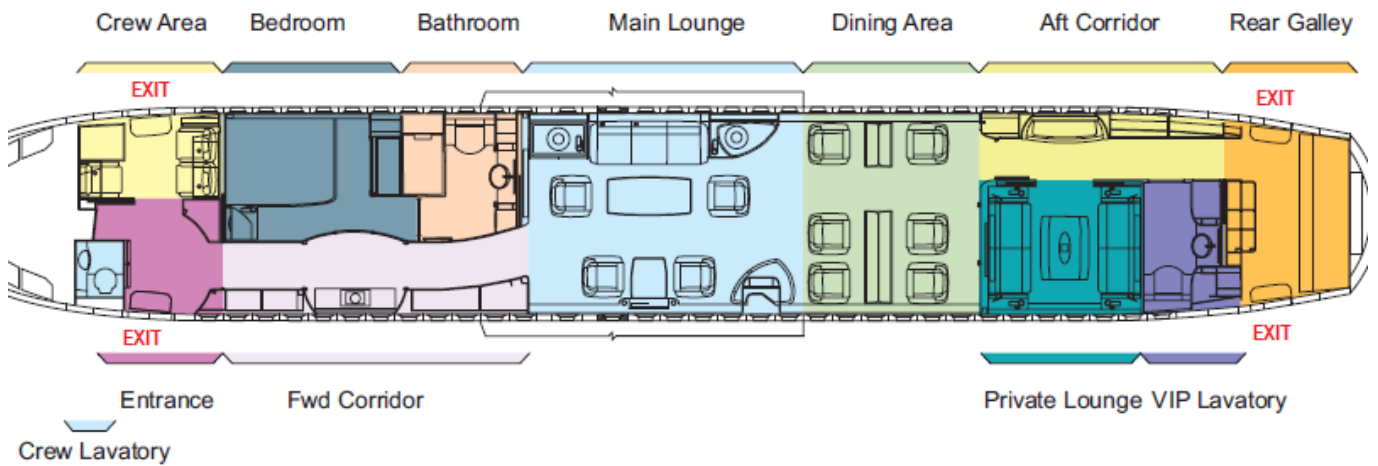

Crew Area
[S1E, S1F, S2F]



Main Lounge
[S3E, S4A, S8A, S9E]



Dining Area
[S10F, S11F]

Single Seats



Main lounge
[DIV1]



Private lounge
[DIV2, DIV4]



Aft corridor
[DIV3]

Divans

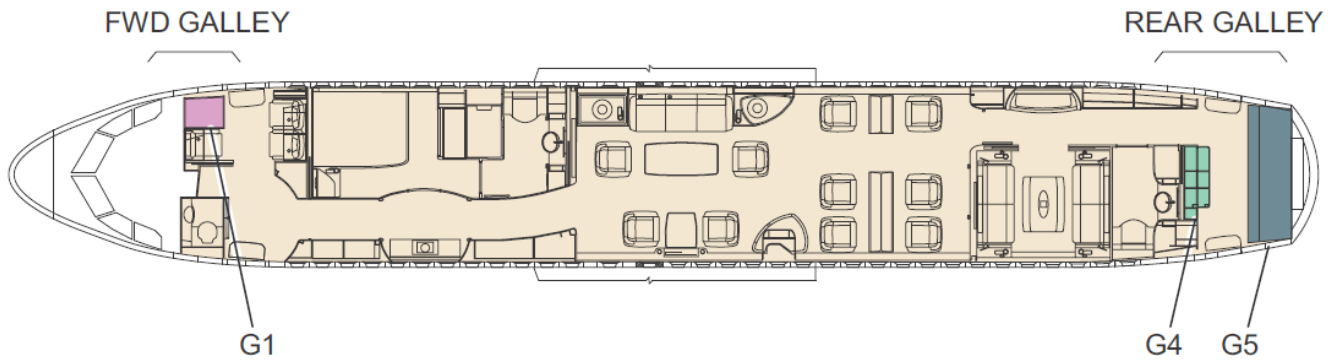

INTERIOR MAIN FEATURES

- CCC/PGA/Rockwell Collins IFE/CMS system (Down Looking Zoom Camera, Quad Camera, Tails Camera, PVIS, RCA plug, USB plug, VGA plug, HDMI plug, iPod Station, Blu-Ray Player, AVOD)
- Main Lounge fitted with two Monitors 52" + 42"; Bedroom fitted with 42" Monitor
- DT Systems / ALTO Audio system: Surround 7.1 in Main Lounge; Surround 5.1 in Bedroom & Private Lounge
- EAR Soundproofing system (Noise Level 51dB (SIL) in Bedroom & Private Lounge, Noise Level 53dB (SIL) in Main Lounge)
- Switches & Controls: Membrane Switch Panel / Graphical Switch Panel / Remote Control (iPhone) / Touchscreen
- Two Zones temperature control (Zone 1: Crew Area + Entrance + Bedroom + Bathroom + Fwd Corridor; Zone 2: Main Lounge + Dining Area + Private Lounge + Rear Galley)
- Cabin Humidification System (CAIR™) (FWD Cabin Humidifier + AFT Cabin Humidifier)
- Additional Heating (Bathroom + VIP Lavatory)
- Cabin Telephone System (5ea Cordless Phone, 3ea+1ea Corded Phone, provision for printer)
- LAN / WLAN available in the complete Aircraft cabin
- 230V/50Hz power outlets compatible with Chinese standard plugs; 115V/400Hz service power outlets
- 19 PAX TTOL seats (seats FS-series & divans FD-series manufactured by PAC)
- 2 Flight Attendant TTOL seats (WA-series manufactured by PMV)
- 1 Non TTOL seat
- Seats and divans convertible to night configuration
- Lights/Lenses/Lamps with RGB control (EMTEQ / CCC)
- Ceiling panels fitted with Starlight made by EIS ELECTRONICS
- Electrically operated window shades (other windows plugged)

- Optical Smoke detectors are fully autonomous and provide aural and visual warnings
- Chemical Oxygen System and Oxygen Masks fulfils the requirements of 22 minutes
- Three (3) portable therapeutic oxygen bottles distributed over the cabin - Master Bedroom, Main Lounge and Private Lounge
- Total potable water: 437.0 L (115.4 Gallons (US))
- LH & RH FWD and AFT PAX doors active (LH & RHOFFWING EXITS deactivated)

INTERIOR EQUIPMENT

ATA	Description	Manufacturer / Model	Part Number	Qty
21	HUMIDIFIER	CTT	501-207	2
21	CAIR SYSTEM KIT CCU100-00AB	CTT	ELK-CA319-11	1
21	AIR DRYER PART OF SPLCA319-11	CTT	2001-060	1
21	ELECTRICAL HEATING UNIT	AMAC AEROSPACE	AASA38-71-02-C	2
21	AIR HEATER	COXANDCO	2831-52	3
21	TOWEL HEATER	VILLINGER	TH-001	1
23	INTERPHONE	HOLMCO	318194	1
23	CORDED PHONE	TRUENORTH	TN1003-201	3
23	IP HANDSET	TRUE AVIONIC	TN1010-2300	5
23	HANDSET	TRUENORTH	TN2003-104	1
23	SPEAKER	CCC	500-0110-01	30
23	PA SPEAKER	DAYTON AUDIO	DAEX-32	72
23	PA SPEAKER	NOKIA	4913211080	3
23	SUBWOOFER	CCC	020-0057-30	3
23	2X4 AUDIO ADC	CCC	020-0012-06	1
23	SSP/AMP	CCC	020-0133-20	4
23	EMI FILTER BOX	STEECON	3516016-1	1
23	WIFI ACCESS POINT	TRUENORTH	TN1017-100	2
23	C-STREAM ROUTER	CCC	020-0037-01	1
23	AIP-ATTEND INDICATION PANEL	LEKI	Z111H0033131	1
23	CAM (CABIN ASSIGNMENT MODULE)	AIRBUS	Z054H600E661	1
23	RS-485 CTL	CCC	020-1069-01	4
23	ARINC 429 CONTROLLER	CCC	020-0110-10	1
23	ETHERNET SWITCH	CCC	020-0123-30	3
24	DC/DC CONVERTER	KGS ELECTRONICS	LT-46C	2
24	FREQUENCY CONVERTER	AVIONIC INSTRUMENTS INC.	1-002-0102-2343	4
24	TRU	ELDEC	81-084-01	1
24	POWER OUTLET	EMTEQ	EAC-B3256700xxx	28
25	ESPRESSO MAKER	IACBUCCI	AL-EX15-200E-35	2
25	FRIDGE	B/E AEROSPACE	228-5	1
25	FRIDGE	AEROLUX	AL-RF65-520-13	1
25	WINE CHILLER	SELECTRA GOURMET	B/E AEROSPACE	1
25	COFFEE MAKER MODEL 1603-AC3P-S14	TIA	400-1907-01	2

25	HOT CUP	DRIESSEN	DLH 1834 / JF003001	1
25	WATER HEATER	LERMER	L13471-(24)	1
25	STEAM OVEN	SELL	8202-16-0000-01	2
25	SKILLET WOK (INDUCTION HOT PLATE)	IACOBUCCI	HFCK01001-0100 / IHP4-01	1
25	DISHWASHER	AMAC	AA-SA-25DW1-1	1
25	DEFIBRILLATOR	MEDAIRE UK	942150	1
25	MEDICAL MONITORING DEVICE	RDT	TEMPUS-IC	1
25	ELECTRONIC SAFE LOCK	RONDO	6124-141	1
25	WINDOW SHADE	VISION SYSTEMS	170-220xx-xxx	25
25	SKYSHOW	CCC	020-0130-10	1
25	STARLIGHT UNIT (SLU)	EIS ELECTRONICS	C1659-7654-LU-001	4
25	PORTABLE ELT	HONEYWELL	1153534-1M232	1
35	CHEMICAL GENERATOR (+OXYGEN BOX)	PACIFIC PRECISION PRODUCTS	E63420-00 (P25056)	27
35	PORTABLE O2 BOTTLE	ZODIAC AEROSPACE	9700-C1A-BF23A	2
35	OXYGEN UNIT	EMS GMBH	WS120	3
38	WATER STERILIZER	INTERNATIONAL WATER GUARD	NPS-A6 / 09-130021-102	2
38	GREYWATER CHAMBER CONTROLLER	EIS ELECTRONICS	9613300-6501	1
38	TANK LEVEL CTL	CCC	020-0156-01	1
38	PORTABLE WATER TANK 200L	MT AEROSPACE	96-32001-4002	1
38	FLUSH CONTROL UNIT	MONOGRAM	14330-004M-3	2
44	MEDIA LOADER	CCC	020-0113-10	1
44	MEDIA CLIENT III	CCC	020-0108-10	4
44	LCU	CCC	020-0175-10	2
44	APPLE TV CTL	CCC	020-0177-01	3
44	SERIALIZER	CCC	020-0115-01	3
44	DIRECT CONNECT	CCC	020-0181-01	5
44	BLURAY PLAYER	CCC	300-0001-10	4
44	15.6" TS	CCC	251-0015-02	2
44	42" MONITOR	CCC	251-0042-03	2
44	50" MONITOR	CCC	251-0050-02	1
44	IPOD TOUCH 64GB SPACE GRAY	CCC	500-0104-01	4
44	MAINTENANCE LAPTOP	CCC	500-0031-01	1
44	VCCU	OTONOMY	1000-1100-001	1
44	HD QUAD CAMMERA	OTONOMY	1000-1200-001	1
44	HD TAIL CAMMERA	OTONOMY	1000-1300-001	1
44	HD ZOOM CAMMERA	OTONOMY	1000-1400-001	1
44	CTI	OTONOMY	1000-1500-001	1
44	PIR	OTONOMY	1000-1710-001	2
44	GSM ANTENNA	OTONOMY	3100-ANT-001	1

AVIONICS / NAVIGATION EQUIPMENT

Standard A319 Flight Deck Configuration

ATA	Description	Manufacturer / Model	Part Number	Qty
22	FAC	THALES AVIONICS	B397BAM0621	2
22	FMGC	THALES AVIONICS	C13042AA05	2
22	FM SOFTWARE	HONEYWELL	PS4087600-903	2
22	FCU	THALES AVIONICS	C12850AC03	1
23	AMU	TEAM	4031SA140204	1
23	HF RADIO TRANSCEIVER	ROCKWELL COLLINS / HFS-900D	822-0990-003	2
23	VHF COMMUNICATION TRANSCEIVER	ROCKWELL COLLINS / VHF-2100	822-1287-120 (#1 & #2) 822-1287-121 (#3)	3
23	SDU	ROCKWELL COLLINS / SRT-2100B	822-1785-401	1
23	HSDU	ROCKWELL COLLINS / HST-2110B	822-2232-040	2
23	HGA	CHELTON ANTENNAS	4141-89-99	1
23	SELCAL DECODER	COBHAM AVIONICS	BC2065C	1
27	ELAC	THALES AVIONICS	39451291-09	2
27	SEC	THALES AVIONICS	B372BBM0104	3
31	MCDU	HONEYWELL	4089740-961	2
31	FWC	AIRBUS	35-0E0-5302-1212	2
31	SDAC	AIRBUS	35-0E5-5002-05	2
31	ATSU HW (sw for FANS B)	AIRBUS	LA2T0G21006CA010	1
31	DCDU	GE AVIATION	401MFD03-02	2
31	SSFDR	L3COM / FA2100 FDR	2100-4045-00	1
31	CVR	L3COM / FA2100 CVR	2100-1026-02	1
31	FDIMU	SAGEM	ED48A200	1
31	DMU	SAGEM	ED48A200	1
31	CFDIU	THALES AVIONICS	C12860AA03	1
31	PRINTER	HONEYWELL / PTA-45B	8055515-4501	1
32	LGCIU	ELDEC CORP.	80-178-03-88013	2
32	BSCU	MESSIER-BUGATTI	E21327106	1
34	ATC TRANSPONDER	ROCKWELL COLLINS / TPR-901	822-1338-021	2
34	DME	ROCKWELL COLLINS / DME-900	822-0329-020	2
34	ADF RECEIVER	ROCKWELL COLLINS / ADF-900	822-0299-020	1
34	EGPWS	HONEYWELL MK5 EGPWS	965-1676-002	1
34	AIRDATA INERTIAL REFERENCE UNIT	HONEYWELL ADIRU	HG2030BE03	3
34	MULTI MODE RECEIVER (MMR)	ROCKWELL COLLINS / GLU-920	822-1152-122	2
34	WEATHER RADAR TRANSCEIVER	ROCKWELL COLLINS / WRT-701X	622-5132-624	1
34	RADIO ALTIMETER TRANSCEIVER	ROCKWELL COLLINS / LRA-900	822-0334-020	2
34	TCAS COMPUTER	ROCKWELL COLLINS / TTR-921	822-1293-332	1
34	VOR/MARKER BEACON RECEIVER	ROCKWELL COLLINS / VOR-900	822-0297-020	2
49	APU ECB	HAMILTON SUNDSTRAND	4500003M	1
73	ECU HW	CFM INT.	2123M56P04	2
73	ECU SW	CFM INT.	2044M38P07	2

Other specific features:

POST SB A320-00-1054 CERTIFICATION - HIGH ALTITUDE OPERATIONS UP TO 41,100 FT.