

FORTYEIGHT MULTISYSTEM EVO TRACK - SURFACE/SUSPENSION

Surface / Suspension Track System

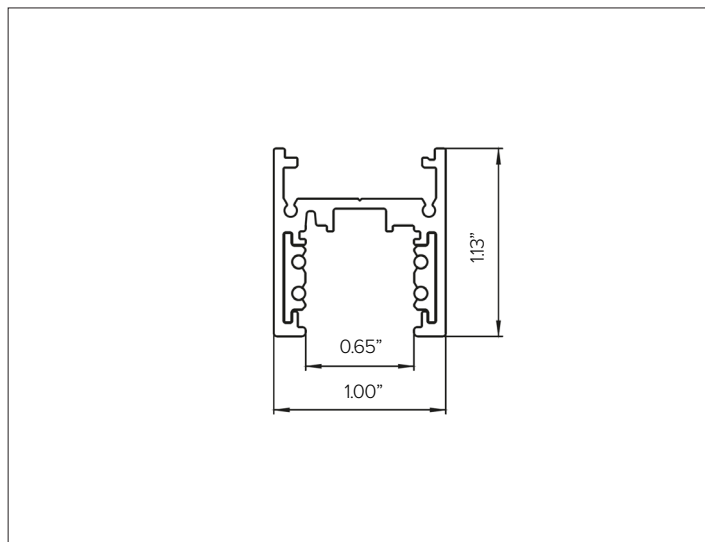
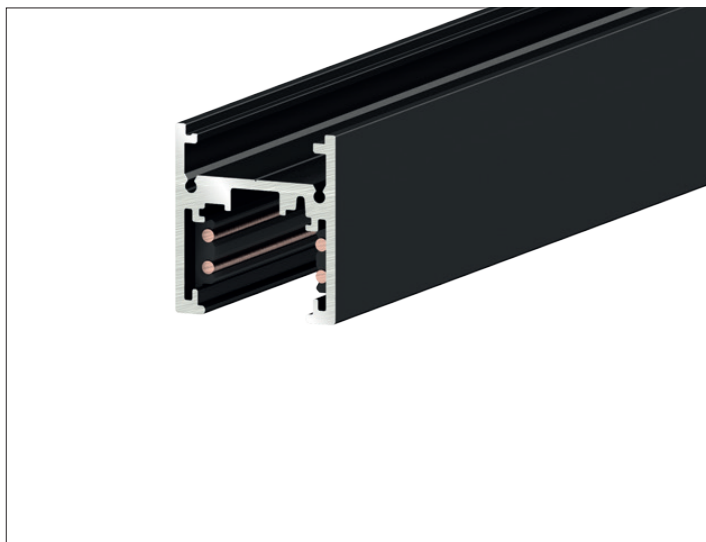

CONCEPT

Surface/suspension mounted electrified track system.

MECHANICAL CHARACTERISTICS

Dimensions	1.00"W X 1.13"H
Materials	Aluminum track with PVC insulated copper conductors that feed electricity to the fixture and provide attachment support.
Finish	<input type="radio"/> White <input checked="" type="radio"/> Black
Power Connection	Mechanical electrical polarized connections.
Functionality	Different mounting configurations are achievable using electrical feeds and connectors that make it possible to build a simple or complex systems.
Mounting	To be installed directly to surface (wall or ceiling) or suspension configurations achieved through available mounting options.
Protection	IP20

ELECTRICAL CHARACTERISTICS

Power Supply	Remote power supply options available.
Voltage	48V DC. Max of 4 connectors per individual power supply.
Circuit	1 circuit, 4 conductor
Control	0-10V to 1% DALI / Wireless Bluetooth Casambi to 0% Control

CERTIFICATIONS

cULus Class 2 SELV Listed.
RoHS3 EU 215/863

WARRANTY

5 year limited warranty.

FORTYEIGHT MULTISYSTEM EVO TRACK - SURFACE/SUSPENSION

SPECIFICATION INFORMATION

1	2	3	4	5	6	7	8	9	10
---	---	---	---	---	---	---	---	---	----

Ex: 9500-UL4/B-ST6-E / 9504/ST6-B / 9504/ST6-B-F / S-9000/T / 9501-S-KL/B-E / S-9500/115-B / DELV30148DJBX

1 - TRACK	2 - END CAP	3 - CUTTING TOOL	4 - ELECTRICAL FEED	5 - ELECTRICAL CONNECTOR	6 - MOUNTING	7 - MECHANICAL JOINT CONNECTOR	8 - INTERFACE	9 - POWER SUPPLY	10 - CONTROLLER
REQUIRED	REQUIRED	REQUIRED	REQUIRED	OPTIONAL	REQUIRED	OPTIONAL	OPTIONAL	REQUIRED	OPTIONAL

1 - TRACK (REQUIRED)

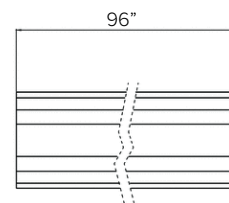
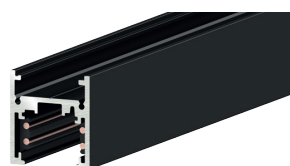
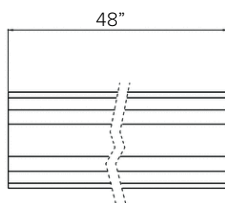
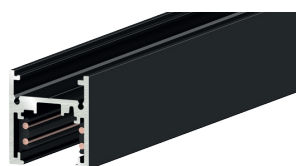

STUCCHI MULTISYSTEM EVO surface mounting track, field cuttable with specialized tool (REQUIRED).

Finish ☐ White ☒ Black

Part No. **9500-UL4/W-ST6-E** **9500-UL4/B-ST6-E**

STUCCHI MULTISYSTEM EVO surface mounting track, field cuttable with specialized tool (REQUIRED).

Finish ☐ White ☒ Black

Part No. **9500-UL8/W-ST6-E** **9500-UL8/B-ST6-E**

2 - END CAP (REQUIRED)

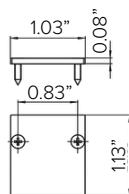

STUCCHI MULTISYSTEM EVO metal end cap, 1pc.

Finish ☐ White ☒ Black

Part No. **9504/ST6-W2** **9504/ST6-B**

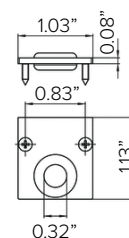

STUCCHI MULTISYSTEM EVO metal end cap with cable feed-through hole, 1pc.

Finish ☐ White ☒ Black

Part No. **9504/ST6-W2-F** **9504/ST6-B-F**

3 - CUTTING TOOL (REQUIRED)

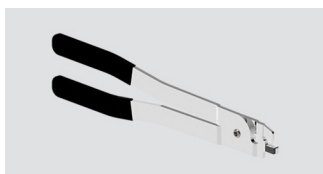

Cutting tool for track conductors.

Part No. **S-9000/T**

FORTYEIGHT MULTISYSTEM EVO TRACK - SURFACE/SUSPENSION

4 - ELECTRICAL FEED (REQUIRED)

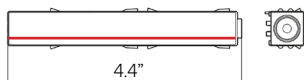

STUCCHI MULTISYSTEM EVO linear end feed polarity left.

Finish ☐ White ☒ Black

Part No. **9501-S-KL/W-E** **9501-S-KL/B-E**

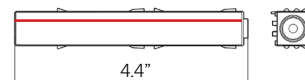

STUCCHI MULTISYSTEM EVO linear end feed polarity right.

Finish ☐ White ☒ Black

Part No. **9501-S-KR/W-E** **9501-S-KR/B-E**

5 - ELECTRICAL CONNECTOR (OPTIONAL)

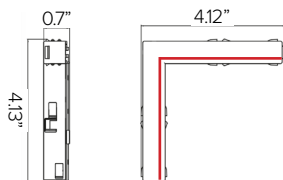

STUCCHI MULTISYSTEM EVO L – Polarized electrical joint connector, internal polarity. **Max of 5 connectors per individual power supply.**

Finish ☐ White ☒ Black

Part No. **9511-KI/W-E** **9511-KI/B-E**

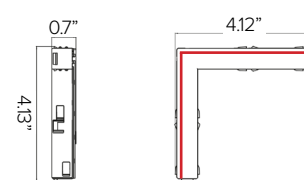

STUCCHI MULTISYSTEM EVO L – Polarized electrical joint connector, external polarity. **Max of 5 connectors per individual power supply.**

Finish ☐ White ☒ Black

Part No. **9511-KE/W-E** **9511-KE/B-E**

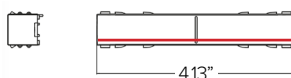
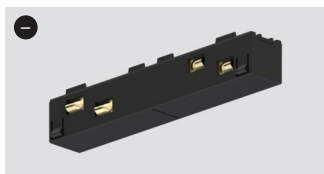

STUCCHI MULTISYSTEM EVO linear – Polarized electrical joint connector. **Max of 5 connectors per individual power supply.**

Finish ☐ White ☒ Black

Part No. **9503-S-K/W-E** **9503-S-K/B-E**

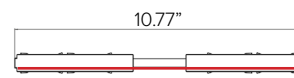

STUCCHI MULTISYSTEM EVO Adjustable – Polarized electrical joint connector. **Max of 5 connectors per individual power supply.**

Finish ☐ White ☒ Black

Part No. **9518-S-K/W-E** **9518-S-K/B-E**

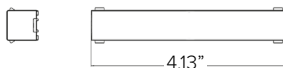
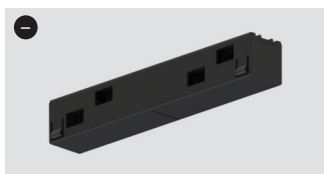

STUCCHI MULTISYSTEM EVO aesthetic non-electric mechanical linear joint.

Finish ☐ White ☒ Black

Part No. **9503-S/W-M-E** **9503-S/B-M-E**

FORTYEIGHT MULTISYSTEM EVO TRACK - SURFACE/SUSPENSION

6 – MOUNTING (REQUIRED)

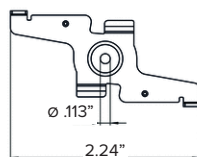
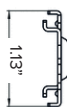

STUCCHI MULTISYSTEM EVO Ceiling surface mount bracket

Finish ☐ White ☒ Black

Part No. **S-9500/115-W2** **S-9500/115-B**

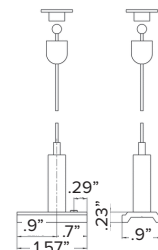

STUCCHI MULTISYSTEM EVO suspension kit. 16ft length cable. Recommended 2ea per 4ftL track, 3ea for 8ft track or 4ea per 16ft interconnected track in combination with 9500-KIT2-5.

Part No. **9500-KIT1-5**

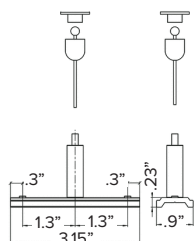

STUCCHI MULTISYSTEM EVO suspension kit for interconnecting tracks. 16ft length cable provided. To be used combination with 9500-KIT1-5 on the non interconnected lengths.

Part No. **9500-KIT2-5**

7 – MECHANICAL JOINT CONNECTOR (OPTIONAL)

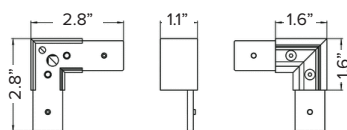

STUCCHI MULTISYSTEM EVO mechanical L-connection joint with steel bracket.

Finish ☐ White ☒ Black

Part No. **S-9511/W2-ST6** **S-9511/B-ST6**

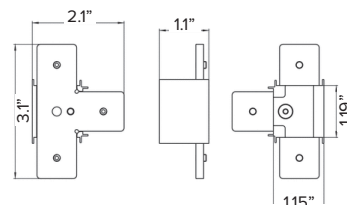

STUCCHI MULTISYSTEM EVO mechanical T-connection joint with steel bracket.

Finish ☐ White ☒ Black

Part No. **S-9513/W2-P-ST6** **S-9513/B-P-ST6**

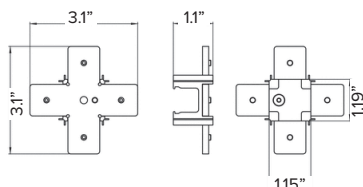

STUCCHI MULTISYSTEM EVO mechanical X-connection joint with steel bracket.

Finish ☐ White ☒ Black

Part No. **S-9517/W2-P-ST6** **S-9517/B-P-ST6**

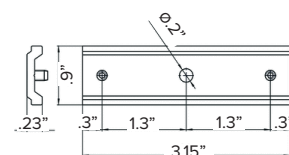

STUCCHI MULTISYSTEM EVO linear joint connector. Required for use in interconnected lengths track lengths.

Part No. **S-9500/323-LA**

FORTYEIGHT MULTISYSTEM EVO TRACK - SURFACE/SUSPENSION

7 - INTERFACE (OPTIONAL)

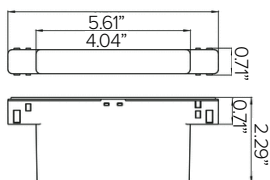

FORTYEIGHT MULTISYSTEM wireless bluetooth interface. Generates a local bus per run for individual fixture control for up to 96W max or 64 fixtures. Can control fixtures in indoor applications via [Casambi wireless bluetooth protocol](#). **Only to be used with Dali/Wireless Bluetooth Casambi version of FORTYEIGHT fixture range.**

Finish ☐ White ☒ Black

Part No. **APP1-M-C0-9519/W-E** **APP1-M-C0-9519/B-E**

8 - POWER SUPPLY (REQUIRED)

ENCLOSURE

Part No.	Wattage	Rating	In / Out Voltage	Certification	Dimensions (Enclosure)	Description
PS062	100W	NEMA3R	120-277V / 48V	UL-SELV	6.3" x 10.79" x 2.17"	MEAN WELL HLG ELECTRONIC DRIVER MOUNTED IN UL LISTED ENCLOSURE.
PS063	150W	NEMA3R	120-277V / 48V	UL-SELV	6.3" x 10.79" x 2.17"	MEAN WELL HLG ELECTRONIC DRIVER MOUNTED IN UL LISTED ENCLOSURE.
PS064	185W	NEMA3R	120-277V / 48V	UL-SELV	6.3" x 10.79" x 2.17"	MEAN WELL HLG ELECTRONIC DRIVER MOUNTED IN UL LISTED ENCLOSURE.
PS065	240W	NEMA3R	120-277V / 48V	UL-SELV	6.3" x 10.79" x 2.17"	MEAN WELL HLG ELECTRONIC DRIVER MOUNTED IN UL LISTED ENCLOSURE.

MAX CABLE DISTANCE

Driver Wattage	Overall Distance	Max Track Length	Max Lead Wire (provided by others)
100W	160FT	26FT	134FT
150W	120FT	26FT	94FT
185W	65FT	26FT	39FT
200W	60FT	26FT	34FT
240W	48FT	26FT	22FT

*Voltage drop calculations are based on 18gu wire.

9 - CONTROLLER (OPTIONAL)

COMPATIBLE WITH WIRELESS BLUE TOOTH CASAMBI VERSION ONLY FOR INDIVIDUAL FIXTURE CONTROL.



Casambi Xpress remote controller, indoor mounted only. Four programmable presets. CR2430 battery (Included). **For DALI / Wireless Bluetooth Casambi control only. Each controller can program up to 4ea APP1-M-C0-9519 interfaces.**

Finish ☐ White ☒ Black

Part No. **SWITCH26** **SWITCH25**