

North West Sittingbourne

Committee March 2021

Contents

- Local Plan Mitigation Overview
- NW Sittingbourne Accesses
- Wider Mitigating schemes
- Required restrictions

Swale Borough Proposal Plan

Item	Item	Item
• 2018/19 Council Budget Approval	• 2018/19 Council Budget Approval	• 2018/19 Council Budget Approval
• 2018/19 Council Budget Approval	• 2018/19 Council Budget Approval	• 2018/19 Council Budget Approval
• 2018/19 Council Budget Approval	• 2018/19 Council Budget Approval	• 2018/19 Council Budget Approval
• 2018/19 Council Budget Approval	• 2018/19 Council Budget Approval	• 2018/19 Council Budget Approval
• 2018/19 Council Budget Approval	• 2018/19 Council Budget Approval	• 2018/19 Council Budget Approval
• 2018/19 Council Budget Approval	• 2018/19 Council Budget Approval	• 2018/19 Council Budget Approval
• 2018/19 Council Budget Approval	• 2018/19 Council Budget Approval	• 2018/19 Council Budget Approval
• 2018/19 Council Budget Approval	• 2018/19 Council Budget Approval	• 2018/19 Council Budget Approval
• 2018/19 Council Budget Approval	• 2018/19 Council Budget Approval	• 2018/19 Council Budget Approval

- Strategic Green Belt
- Strategic Flood Risk Area
- Proposed Highways Extensions
- Proposed Cycle Routes to be built for high capacity strategy

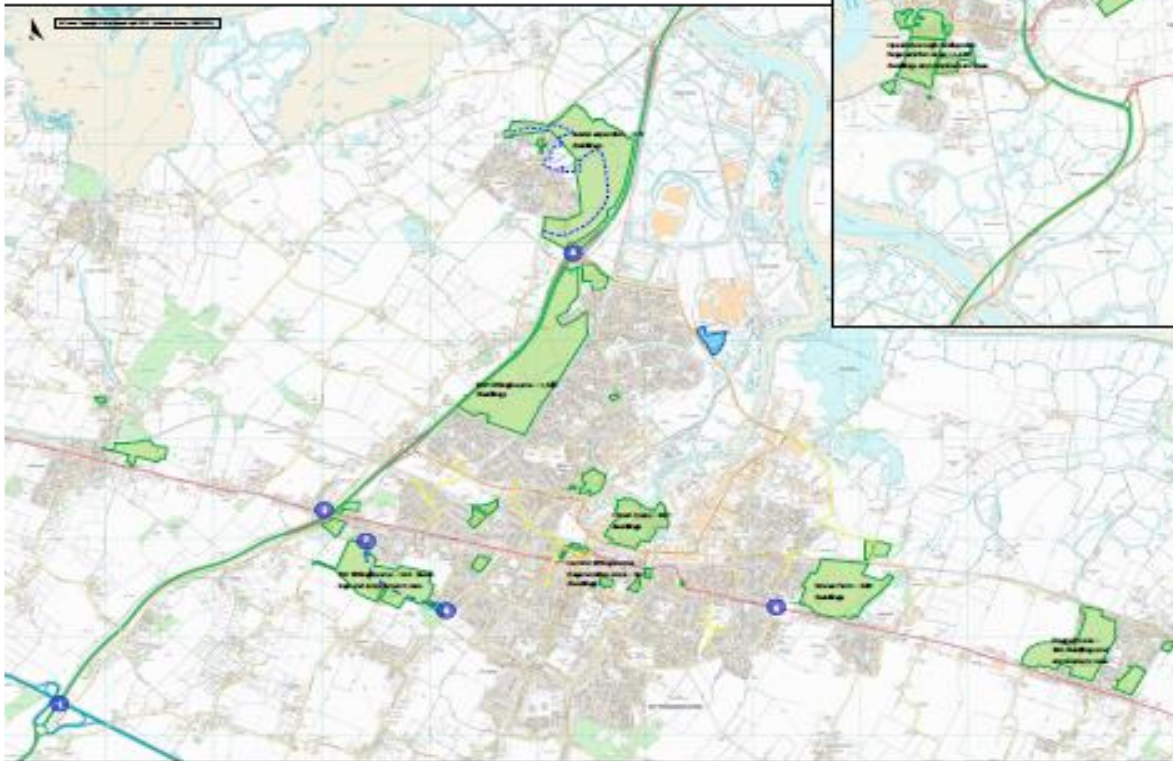

Grovehurst Rd Access

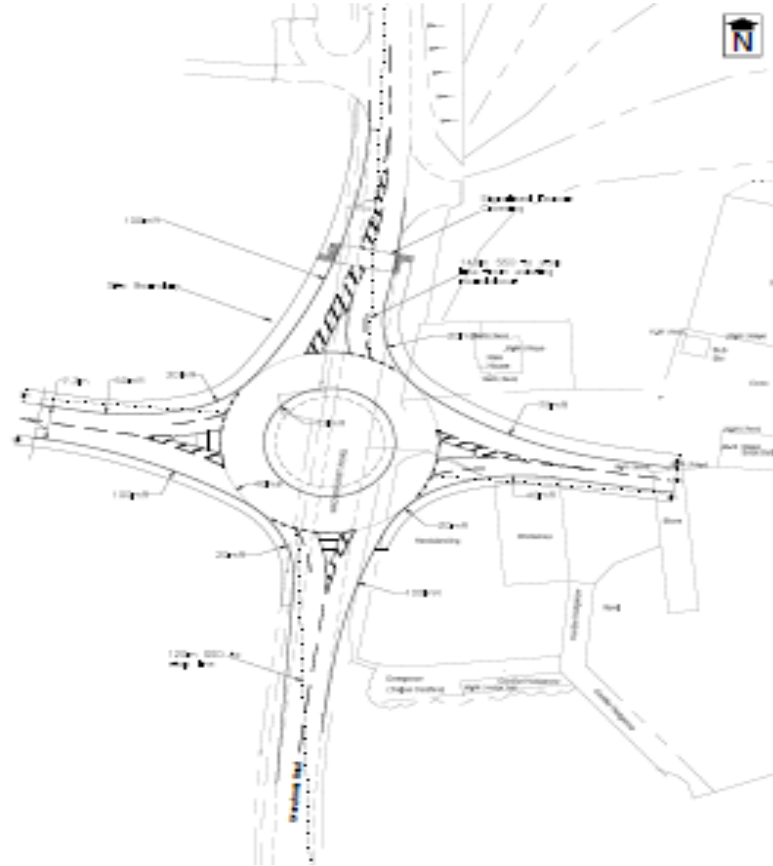

Phase 1 South Quinton Road Access

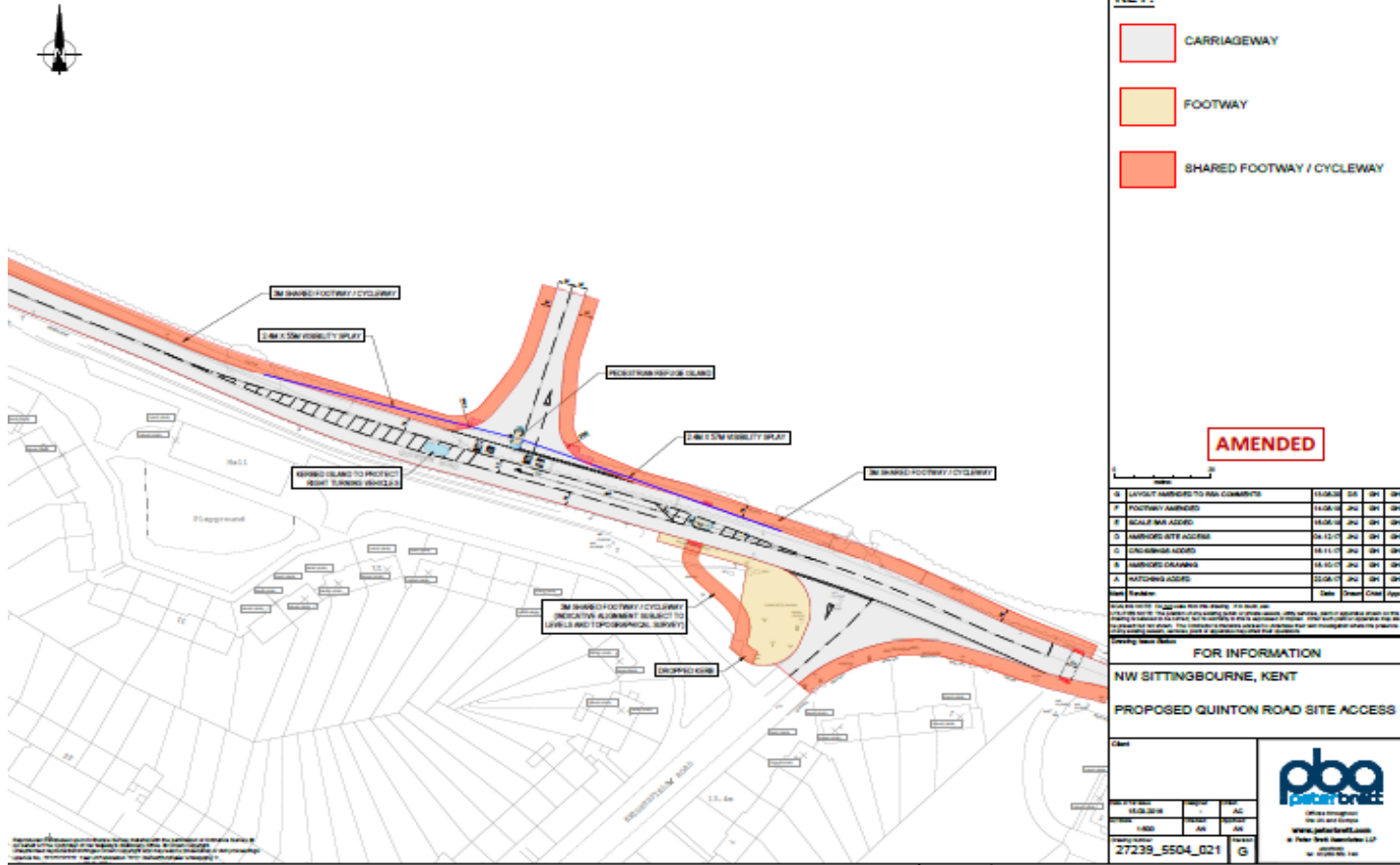

KEY:

- CARRIAGEWAY
- FOOTWAY
- SHARED FOOTWAY / CYCLEWAY

AMENDED

REV	DESCRIPTION	DATE	BY	CHK
0	LEVELT AMENDED TO REF COMMENTS	11.08.14	SH	SH
1	FOOTWAY AMENDED	11.08.14	SH	SH
2	SOUP & BAR ASSESS	11.08.14	SH	SH
3	HARDWARE SITE ACCESS	26.12.14	SH	SH
4	CARRIAGEWAY ASSESS	16.11.15	SH	SH
5	HARDWARE DRAWING	16.10.15	SH	SH
6	MATCHING ASSESS	22.08.15	SH	SH

FOR INFORMATION

NW SITTINGSBOURNE, KENT

PROPOSED QUINTON ROAD SITE ACCESS

Client		 pba pbsenior brand 100 St Ann Street Maidstone, Kent ME14 2JF www.pbaonline.co.uk 01622 550400 © PBA Senior Brand Limited All Rights Reserved
Drawn	AC	
Checked	SH	
Project No	27239_5504_021	

Bobbing A249 Interchange

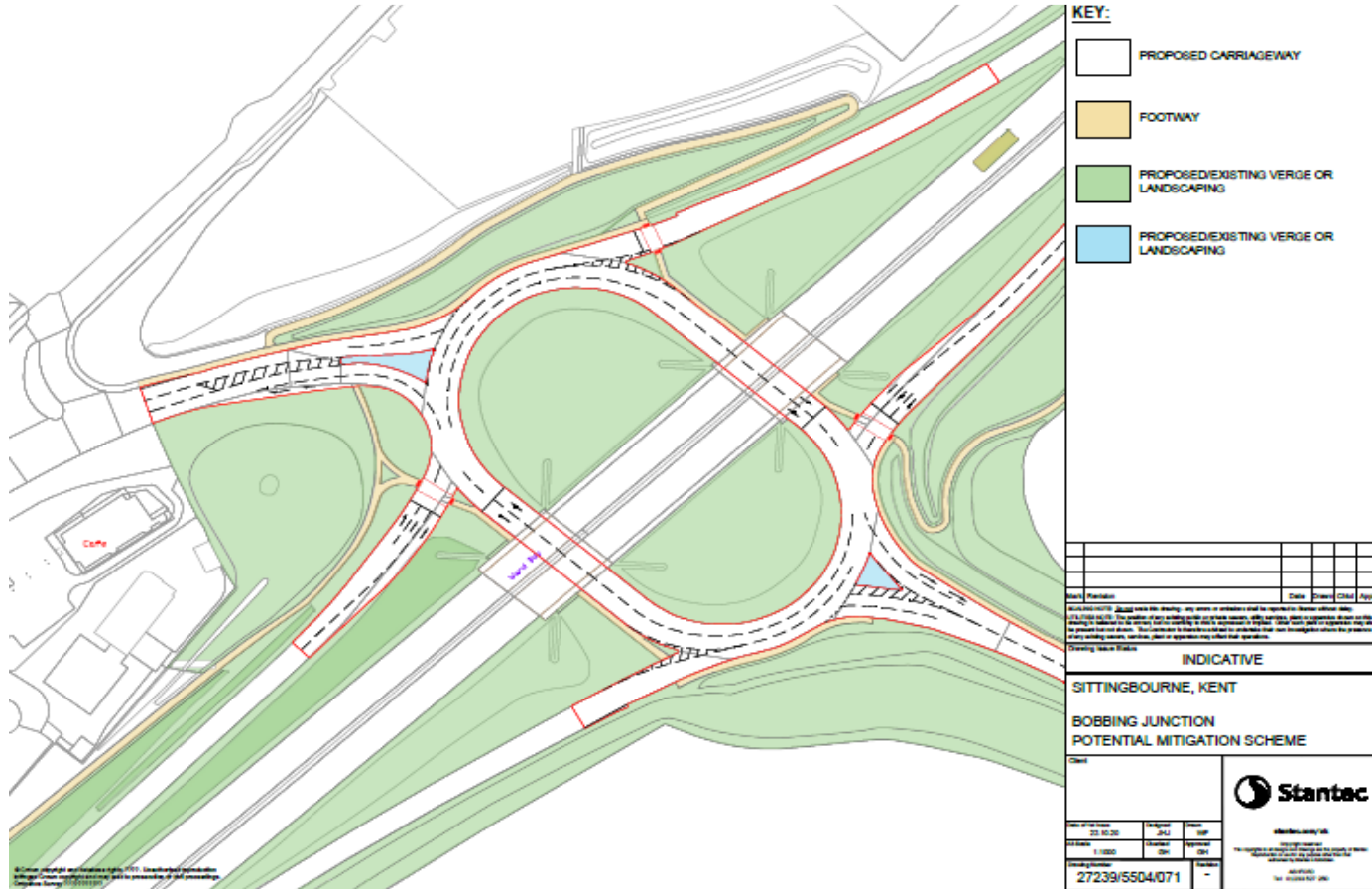

Wider mitigation

- Internal cycle route connecting Grovehurst Road, Quinton Road, Bramblefield Lane, - Sheppey Way
- External cycle route between Quinton Road and Town Centre. £400k @ 50th occupation.
- Bus route and stops through site
- Bus, Cycle, Rail vouchers up to £350 per dwelling
- Link to Kemsley Halt within NR ownership, £60k
- Internal Primary and Secondary schools
- Vicarage Road rail crossing controls
- Improvements to PROW ZU6, ZU8, ZU54, ZU11 & ZR110

Restrictions

- Temporary footway/cycleway to be provided from the South portion prior to opening of schools
- Ped/cycle link from Bramblefield Lane to Quinton Road prior to 400th Occupation
- No more than 257 occupations to access via Quinton Rd until such time as Bobbing/A249 open
- Prior to 200th, Ped/cycle link to Kemsley Halt open and available to the site boundary.
- Funding for site to Town centre cycleway by 50th occupation
- No more than 91 occupations from the North until works awarded for Grovehurst Rd/A249 and M2/J5 open.
- No more than 100 dwellings occupied until interim Grovehurst Works and 450 before full scheme

KCC Highways & Transportation Swale

Thank you

Colin Finch: Principal Transport & Development Planner