



The pinnacle of performance and security

HP LaserJet Managed E60000 series
HP LaserJet Managed MFP E62500 series



The world's most secure printing¹



Maximum productivity.
High-speed performance.



More. Pages, Performance,
and Protection.

The world's most secure printing¹



Only HP Enterprise devices repair themselves from attacks in real time while offering outstanding manageability. Automatically monitor threats, detect intrusions, and validate operating software while centrally managing your fleet with ease.



Always on guard

Only HP Enterprise devices offer built-in security features that are always on guard.¹

- With HP Sure Start, each device regularly checks its operating code and repairs itself from attempted hacks.
- Whitelisting checks firmware during startup to help ensure it's authentic, good code.
- Run-time intrusion detection continually monitors activity to detect and stop attacks, then automatically reboots.
- HP Connection Inspector stops malware from "calling home" to malicious servers, stealing data, and compromising your network, then automatically triggers a self-healing reboot.

Thwart potential attacks by receiving instant notification of security issues. These devices work with leading Security Information and Event Management (SIEM) tools like Splunk, ArcSight, and SIEMonster.



Take security to the next level

Help protect your device with more than 150/250 (printer/MFP) embedded security features.² Protect information on the device and in transit over the network. Store data on the 256-bit encrypted HP High-Performance Secure Hard Disk.³

Further safeguard data stored on the device—keys, passwords, certificates, and more—using the optional HP Trusted Platform Module.⁴

Add features such as card readers and more through the Hardware Integration Pocket. Add the optional HP Access Control to help reinforce security, while helping to reduce costs.⁵

Optional HP JetAdvantage Security Manager offers an effective, policy-based approach to help secure HP printing and imaging devices.⁶ Easily set security configuration policies and automatically validate settings for every HP printer and MFP in your fleet.

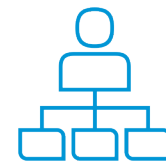

Centralize control to help build business efficiency

Centralize control of your printing environment with HP Web Jetadmin—and help build business efficiency.⁷

Simplify business printing with the industry's first SaaS (Software as a Service) portal for managing both apps and users—HP JetAdvantage On Demand boosts productivity and eliminates the need for server and software investments using one convenient website.^{8,9}

Save IT time and make printing easy for the entire enterprise by using a single driver for all HP devices.¹⁰

➡ For more information about security, please see Appendix A, page 21; for details about fleet management, please see Appendix B, page 24.

Maximum productivity. High-speed performance.

Get the job done with a device equipped for high-speed performance. Be confident that your employees can speed through their tasks without interruption.

Keep business moving

Breeze through tasks—this device prints your first page from ready and sleep mode as fast as 5.3 and 7.8 seconds, respectively.^{11,12} Print up to 75 pages per minute (ppm),¹³ simplex (E60075 series and MFP E62575z models)—with up to 85% duplex efficiency.

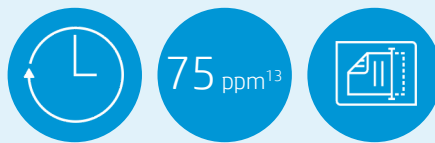

With the MFP E62500 series, accelerate workflow with single-pass, two-sided scanning. Scan up to 90 images per minute (ipm), simplex, and up to 180 ipm, duplex, with the Flow MFP models.¹⁴

Loaded for productivity

Spend less time loading paper with a 4,400-sheet (E60000 series) or a 3,750-sheet (MFP E62500 series) maximum input capacity.¹⁵ Empower employees with additional paper-handling accessories (see pages 7 and 10).¹⁶ Standard and optional 550-sheet input trays fit a whole ream of paper and support paper sizes from 4 x 6 inch to legal (A6 to 216 x 356 mm).



Equip employees to breeze through tasks with an adjustable touchscreen control panel—available on select models. (For more information, see Appendix C on page 25.) The 5-bin stapler/stacker with job offset allows you to set up each bin for a different department or option, such as face down, fax,¹⁷ and copy. An easy-access USB port on all models allows users to easily walk up and print.¹⁸

Designed to conserve

Help keep productivity up and energy use down. This efficient device is designed for exceptionally low energy consumption—thanks to its innovative design and specially formulated toner.¹⁹



Help cut costs with HP Auto-On/Auto-Off Technology²⁰ and HP Instant-on Technology²¹—intelligence that readies your printer or MFP right when you need it and turns it off when you don't. Print efficiently on lightweight, high-performance HP EcoFFICIENT paper—designed to save energy.

More. Pages, Performance, and Protection.



Get more pages and help protect your device, using Original HP Toner cartridges with JetIntelligence.²²



More quality pages than ever before

Get the most prints for your money. Specially designed Original HP Toner cartridges with JetIntelligence deliver up to 64% more pages per cartridge than predecessors.²² Precision black toner is engineered to deliver consistent placement of toner particles and produce sharp text, bold blacks, and crisp graphics.



Help protect your investment

Don't put your printer or MFP—or print quality—at risk. Help retain the consistent Original HP quality you paid for with innovative, anti-fraud technology. Enable office-wide adherence to printing policies with cartridge authentication technology.



Ready to work, right away

Speed through print jobs right out of the box. These devices ship with preinstalled, specially designed Original HP LaserJet toner cartridges with JetIntelligence. Auto seal removal enables simple and seamless cartridge replacement, so you can get back to business fast—without costly delays or frustrating messes.



Print uninterrupted and get more pages with HP Black Contract/Managed LaserJet Toner cartridges.^{22,23} (YC/MCC: 41,000/50,000 pages²⁴)

Give workgroups the speed they need



With the MFP E62500 series, accelerate workflow, improve accuracy, and easily connect people throughout your organization. Complete high-volume scan jobs fast—up to 180 ipm for Flow models¹⁴—and avoid extra steps with a Flow MFP designed for maximum productivity.

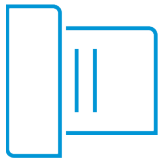

Fast, unattended scanning

Turn stacks of paper documents into digital files. Load up to 150 pages into the automatic document feeder for fast two-sided, single-pass scanning (MFP E62500 series only).²⁵ Spend less time waiting with two-sided scan speeds up to 120 ipm¹⁴ (up to 180 ipm¹⁴ for Flow models). Choose Flow models for advanced workflow features such as HP EveryPage and a pull-out keyboard.¹⁷



Easily scan, copy, and fax

Easily make copies or send faxes using the scanner glass or the ADF (MFP E62500 series only). Scan a variety of media sizes from the ADF—from checks (2.7 x 5.8 in) to banners (8.5 x 34 in). Send scanned documents directly to email, network folders, LAN fax addresses,²⁶ or Microsoft® SharePoint®. Walk up and print from or scan to a memory device using the easy-access USB.¹⁸



Optional workflow solutions

With HP Embedded Capture, scanning and distributing information is as easy as pressing a button. HP Digital Sending Software leverages existing IT infrastructure and uses a common administrative utility and user interface. HP Capture and Route is scalable and makes it easy to control, track, and distribute scanned content.

Flow MFP features¹⁷



HP EveryPage featuring ultrasonic multi-feed detection



Faster scan speeds



Automatic page orientation, auto-crop, and auto-tone



Pull-out keyboard



Built-in OCR



Extended-life ADF

Get to know the HP LaserJet Managed E60000 series

HP LaserJet Managed E60075x shown

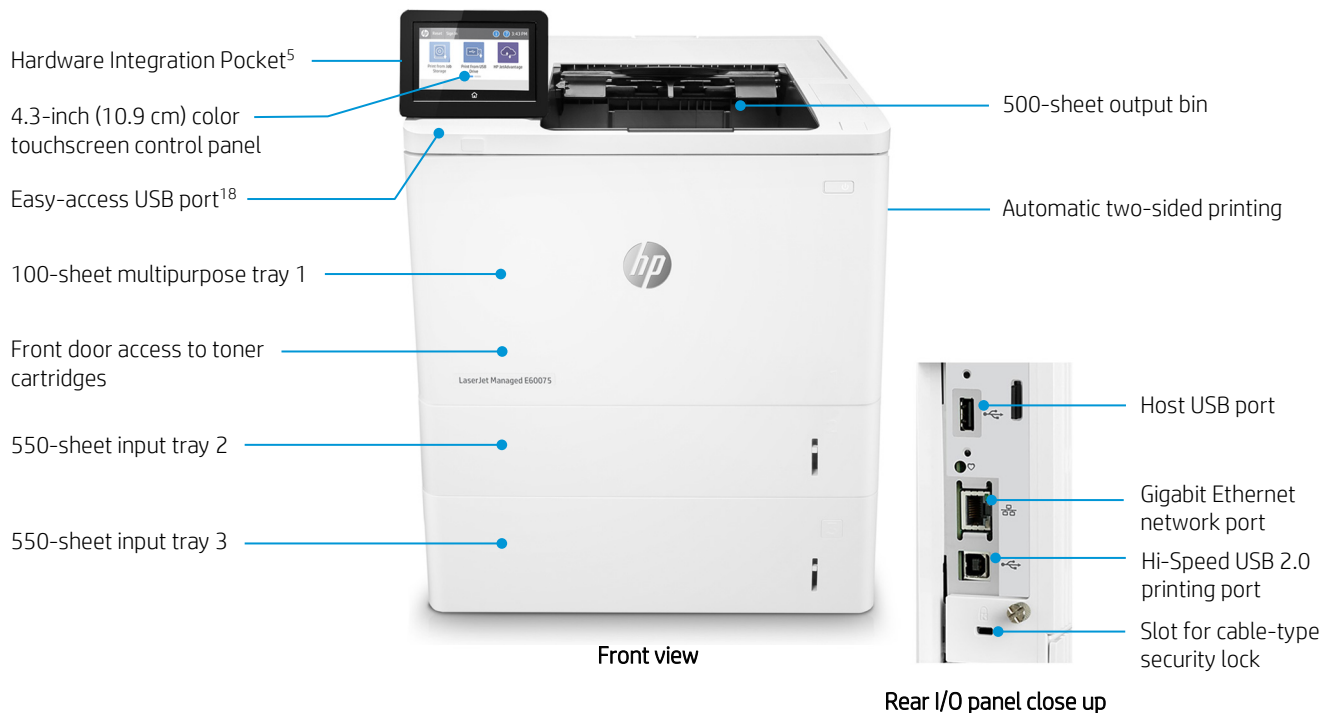

Series at a glance



Model (product number)	E60055dn (M0P33A)	E60065dn (M0P35A)	E60065x (M0P36A)	E60075dn (M0P39A)	E60075x (M0P40A)
Print speeds (letter/A4) ¹³	Up to 55/52 ppm	Up to 65/61 ppm	Up to 65/61 ppm	Up to 75/71 ppm	Up to 75/71 ppm
Control panel	2.7-inch (6.9 cm) LCD with keypad	2.7-inch (6.9 cm) LCD with keypad	4.3-inch (10.9 cm) touchscreen	2.7-inch (6.9 cm) LCD with keypad	4.3-inch (10.9 cm) touchscreen
Hardware Integration Pocket ⁵	✓	✓	✓	✓	✓
Input capacity (standard/maximum) ²⁸	650/4,400	650/4,400	1,200/4,400	650/4,400	1,200/4,400
5-bin stapler/stacker/mailbox	Optional	Optional	Optional	Optional	Optional
Wireless direct, ²⁹ NFC touch-to-print ³⁰	Optional	Optional	Optional	Optional	Optional
Wireless networking ³¹	Optional	Optional	Optional	Optional	Optional
HP High-Performance Secure Hard Disk	Optional	Optional	Optional	Optional	Optional

Paper-handling accessories – E60000 series



550-sheet Paper Feeder (LOH17A)

2,100-sheet Paper Feeder (LOH18A)

Envelope Feeder (LOH21A)³²

Printer Stand (LOH19A)

Stapler/Stacker/Mailbox (LOH20A)

Optional^{28,33}

Add up to four additional (*dn models*); add up to three additional (*x models*)

Add up to one (*all models*)

Add up to two (*all models*)

Add up to one (*all models*)

Add up to one (*all models*)

HP LaserJet Managed MFP E60000 series – Configuration

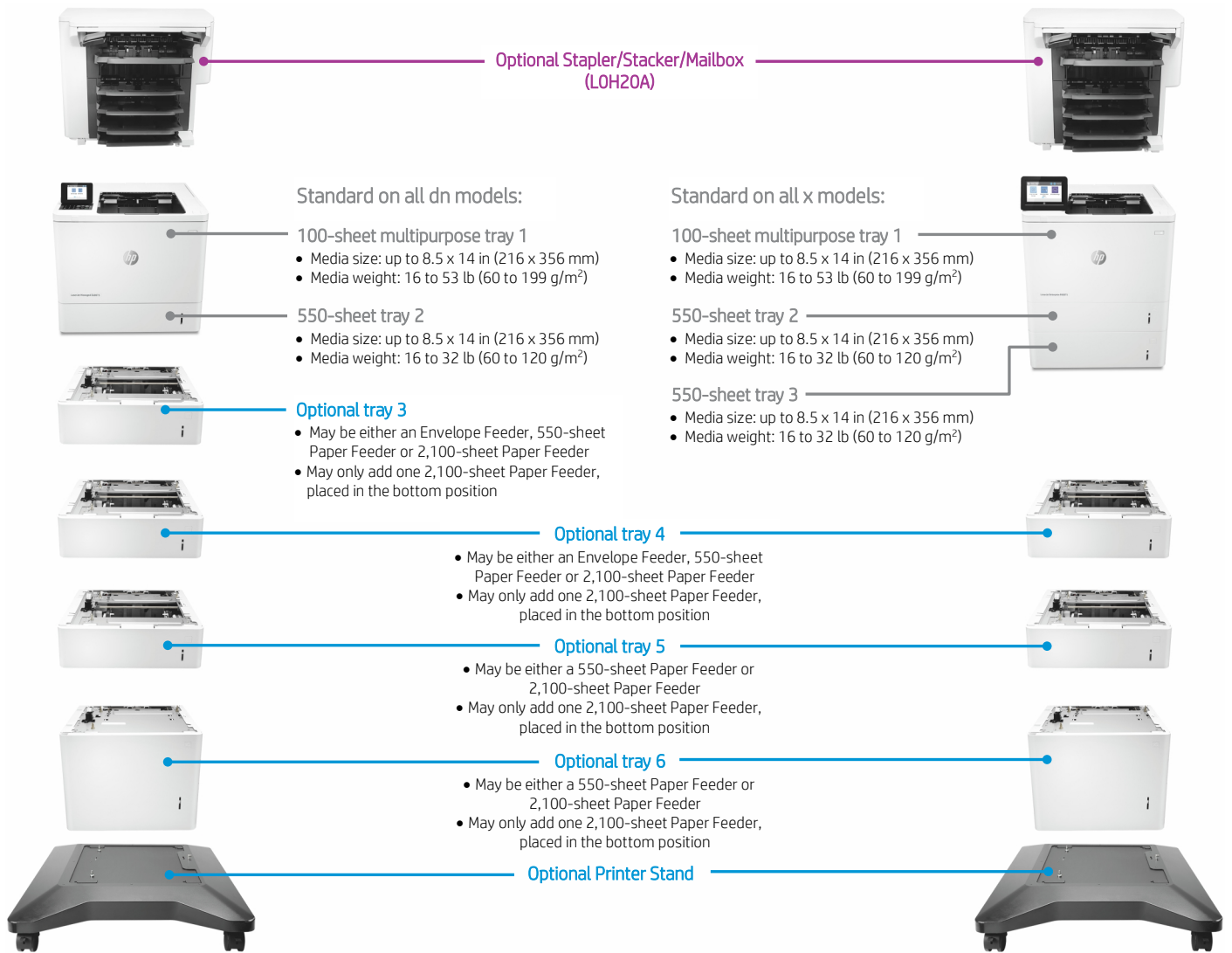

Get to know the HP LaserJet Managed MFP E62500 series

HP LaserJet Managed Flow MFP E62575z shown

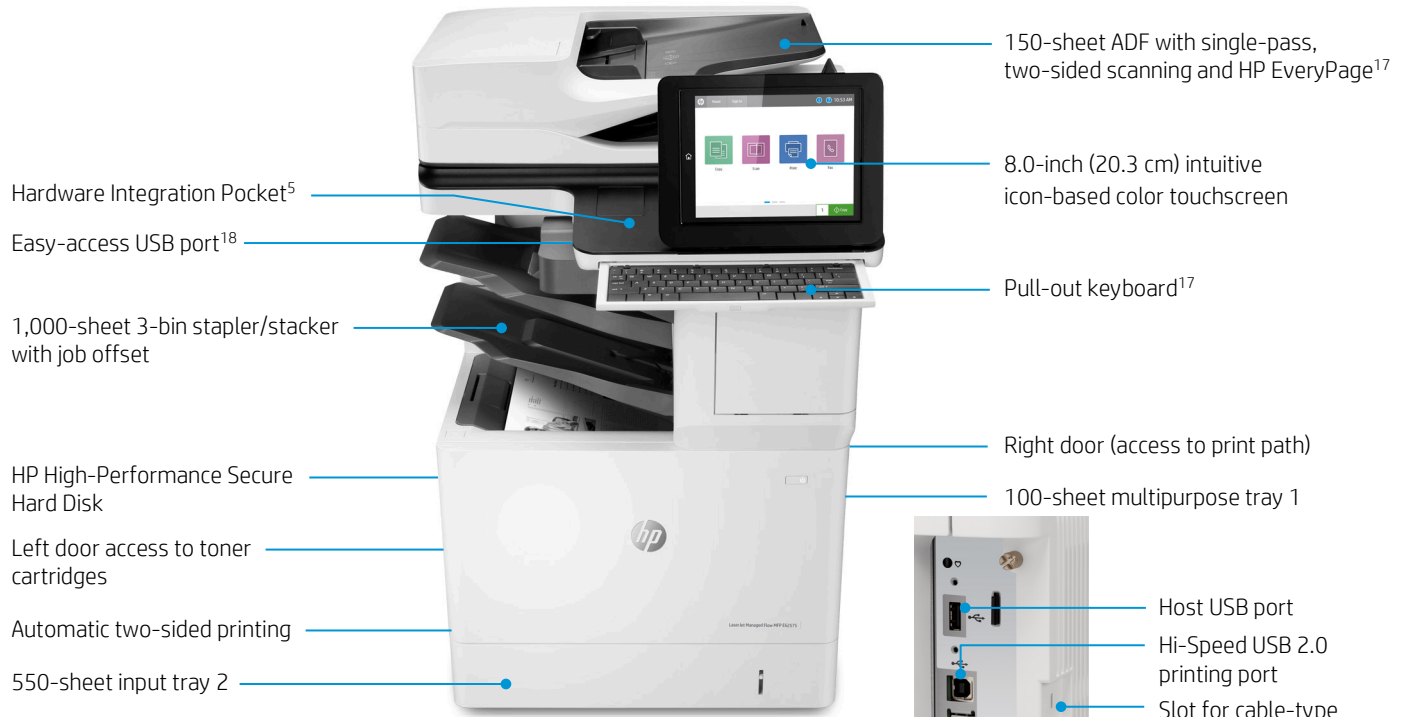

Front view

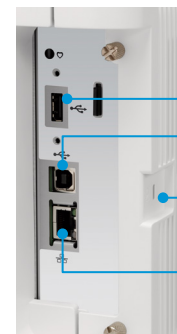

Rear I/O panel close-up

Series at a glance



Model (product number)	MFP E62555dn (J8J66A)	MFP E62565hs (J8J73A)	Flow MFP E62565h (J8J74A)	Flow MFP E62565z (J8J79A)	Flow MFP E62575z (J8J80A)
Print speeds (letter/A4) ¹³	Up to 55/52 ppm	Up to 65/61 ppm	Up to 65/61 ppm	Up to 65/61 ppm	Up to 75/71 ppm
HP High Performance Secure Hard Disk	Optional	✓	✓	✓	✓
Fax capabilities	Optional	Optional	Optional	Optional	Optional
Input capacity (standard/maximum) ³⁴	650/3,750	650/3,750	650/3,750	650/3,750	650/3,750
Envelope feeder ³⁵	Optional (up to two)	Optional (up to two)	Optional (up to two)	Optional (up to two)	Optional (up to two)
3-bin stapler/stacker with job offset	Not available	✓	Not available	✓	✓
Advanced workflow features, including pull-out keyboard ¹⁷	Not available	Not available	✓	✓	✓
Wireless direct, ²⁹ NFC touch-to-print ³⁰	Optional	Optional	Optional	Optional	Optional
Wireless networking ³¹	Optional	Optional	Optional	Optional	Optional

Paper-handling accessories – MFP E62500 series



550-sheet Paper Feeder (J8J89A)



1x550-sheet Paper Feeder with Stand and Cabinet (J8J91A)³⁶



3x550-sheet Paper Feeder and Stand (J8J93A)³⁷



1x550 and 2,000-sheet HCL Feeder and Stand (J8J92A)³⁸



Envelope Feeder (J8J90A)³⁵

Optional ^{33,34}	Add up to four (<i>all models</i>)	Add up to one (<i>all models</i>)	Add up to one (<i>all models</i>)	Add up to one (<i>all models</i>)	Add up to two (<i>all models</i>)
Max device input with accessory (without additional accessories) ¹⁵	2,850 sheets	1,200 sheets	2,300 sheets	3,200 sheets	N/A

HP LaserJet Managed MFP E62500 series – Configuration

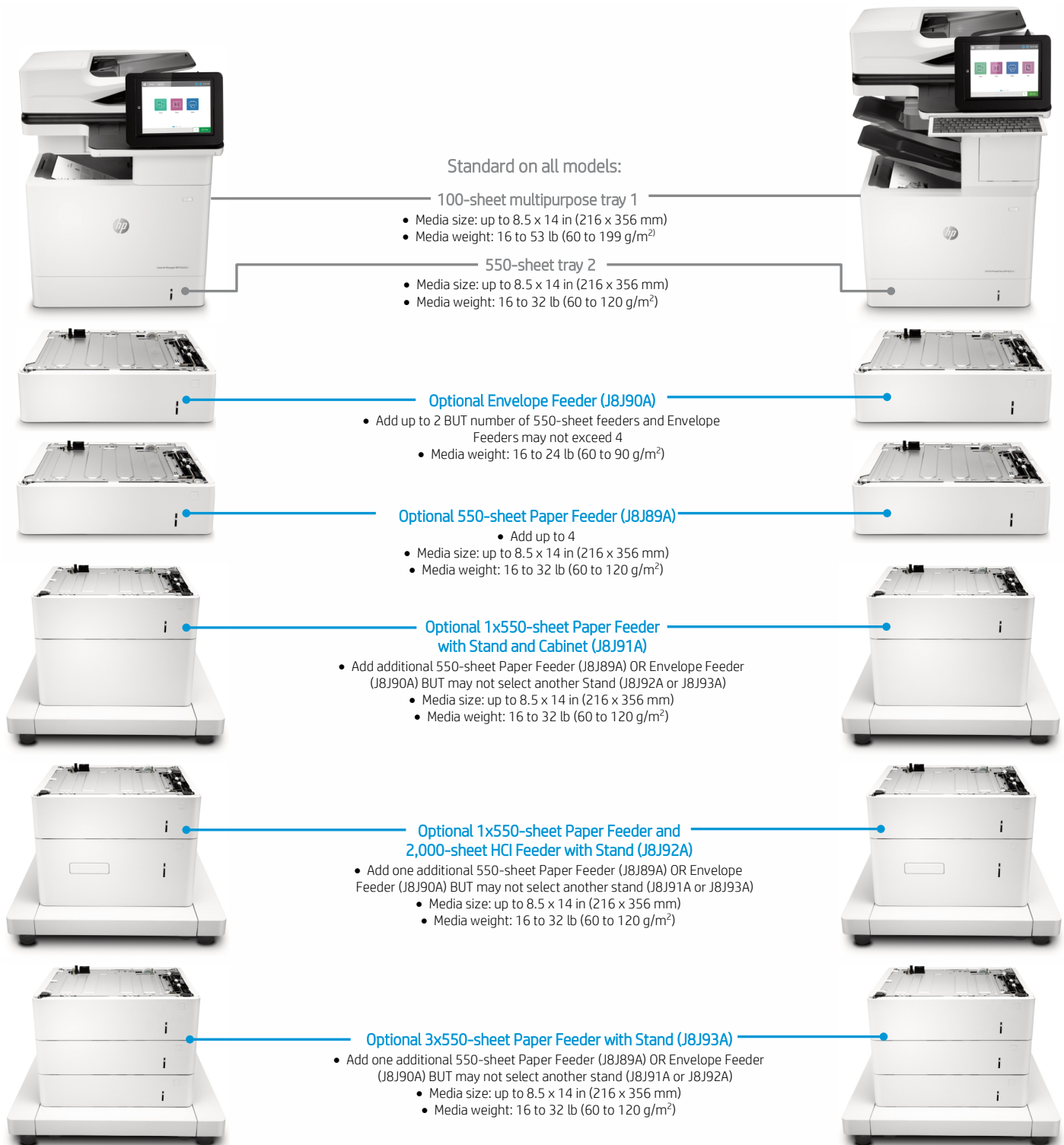

What's new



HP LaserJet Managed E60065x



HP LaserJet Managed M605xm

Benefits

Print speed: up to 65 ppm, simplex; up to 53 ipm, duplex (letter)¹³

Up to 58 ppm, simplex; up to 38 ipm, duplex (letter)¹³

Save time with 12% faster simplex, 39% faster duplex—with up to 81% faster duplex efficiency

FPO as fast as 5.3/7.8 seconds from ready/sleep^{11,12}

FPO as fast as 7/9.5 seconds from ready/sleep^{11,12}

Less wait time with up to 24% faster FPO from ready; 18% faster from sleep

150+ embedded security settings,² including HP Sure Start, run-time intrusion detection, whitelisting, and HP Connection Inspector

HP Sure Start not available; Whitelisting, run-time intrusion detection, and HP Connection Inspector available with firmware upgrade

Enhanced protection with key security technologies designed to thwart attackers' efforts and self-heal

Up to 1,200-sheet standard input (4,400 maximum¹⁵); input trays hold 550 sheets; optional 5-bin stapler/stacker/mailbox with job offset

Up to 1,100-sheet standard input (3,600 maximum¹⁵); input trays hold 500 sheets; optional stapler/stacker/mailbox

Improved paper-handling options with 22% more maximum input; with 550-sheet trays, add a whole ream before the paper runs completely out

RMPV of 5,000 to 40,000 pages³⁹

RMPV of 5,000 to 16,000 pages³⁹

Print up to 150% more pages every month

HP Black Managed LaserJet Toner cartridges with JetIntelligence (~50,000 pages)^{23,24}

Original HP Black Toner cartridges (~25,000 pages)²⁴

Up to 2x more professional-quality pages,²² peak printing performance, and anti-fraud technology

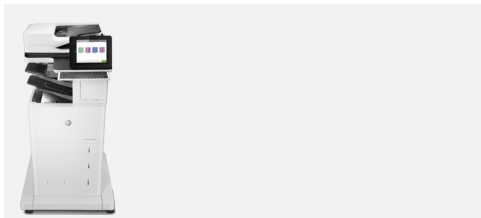

HP LaserJet Managed Flow MFP E62575z



HP LaserJet Managed Flow MFP M630zm

Benefits

Print speed: up to 75 ppm, simplex; up to 62 ipm, duplex (letter)¹³

Up to 60 ppm, simplex; up to 41 ipm, duplex (letter)¹³

25% faster simplex, 51% faster duplex—with up to 85% duplex efficiency

150-sheet ADF and duplex scan speeds up to 180 ipm,¹⁴ black and color (Flow models)

100-sheet ADF with duplex scan speeds up to 60/45 ipm (black/color)

Increased workflow productivity with 50% larger ADF capacity, and 4 times as fast two-sided color scanning

FPO as fast as 5.3 seconds from ready^{11,12}

FPO as fast as 8.5 seconds from ready

Up to 38% faster FPO from ready

250+ embedded security settings,² including HP Sure Start, run-time intrusion detection, whitelisting, and HP Connection Inspector

HP Sure Start not available; Whitelisting, run-time intrusion detection, and HP Connection Inspector available with firmware upgrade

Enhanced protection with key security technologies designed to thwart attackers' efforts and self-heal

3-bin stapler/stacker with job offset and up to 3,750 sheets maximum input capacity;¹⁵ input trays hold 550 sheets

Up to 3,100-sheet input (standard/maximum); input trays hold 500 sheets

Improved paper-handling options and 21% higher maximum input capacity; with 550 sheet trays, add a whole ream before the paper runs completely out

HP Black Managed LaserJet Toner cartridge with JetIntelligence (~50,000 pages)^{23,24}

Original HP Black Toner cartridges (~25,000 pages)²⁴

Up to 2x more professional-quality pages,²² peak printing performance, and anti-fraud technology

HP LaserJet Managed E60000 series technical specifications

	HP LaserJet Managed E60055dn	HP LaserJet Managed E60065 series	HP LaserJet Managed E60075 series
Product number	E60055dn: M0P33A	E60065dn: M0P35A E60065x: M0P36A	E60075dn: M0P39A E60075x: M0P40A
Control panel/data entry	2.7-inch (6.9 cm) LCD with keypad	E60065dn: 2.7-inch (6.9 cm) LCD with keypad E60065x: 4.3-inch (10.9 cm) color touchscreen	E60075dn: 2.7-inch (6.9 cm) LCD with keypad E60075x: 4.3-inch (10.9 cm) color touchscreen
Plus Hardware Integration Pocket ⁵			
Print speed¹³			
Simplex	Up to 55/52 ppm (letter/A4)	Up to 65/61 ppm (letter/A4)	Up to 75/71 ppm (letter/A4)
Duplex	Up to 45/43 ipm (letter/A4)	Up to 53/50 ipm (letter/A4)	Up to 62/58 ipm (letter/A4)
First page out	From ready: ¹¹ as fast as 5.3/5.4 seconds (letter/A4); From sleep: ¹² as fast as 7.8/7.9 seconds (letter/A4)		
Print resolution	FastRes1200 (600 x 600 x 8 dpi), 1200 x 1200 dpi		
Printing features	Print preview, print multiple pages per sheet (2, 4, 6, 9, 16), collation, watermarks, store print jobs, easy-access USB		
Processor	1.2 GHz		
Memory	512 MB, standard; 1.5 GB, maximum with purchase of 1 GB accessory DIMM		
Storage	4 GB EMMC non-volatile storage; Firmware encryption (AES 128 or AES 256) of customer/job data; Secure Cryptographic Erase – Job Data, Secure Erase – Disk Optional: HP High-Performance Secure Hard Disk, minimum 500 GB; AES 256 hardware encryption or greater; Secure erase capabilities (Secure File Erase – Temporary Job Files, Secure Erase – Job Data, Secure ATA Erase – Disk)		
Durability ratings			
Recommended monthly page volume ³⁹	5,000 to 30,000 pages	5,000 to 40,000 pages	5,000 to 50,000 pages
Duty cycle ⁴⁰	Up to 375,000 pages	Up to 420,000 pages	Up to 450,000 pages
Media specifications			
Input capacity	Up to 650 sheets (up to 4,400 maximum ¹⁵) Tray 1: Up to 100 sheets Tray 2: Up to 550 sheets	E60065dn: Up to 650 sheets (up to 4,400 maximum ¹⁵) Tray 1: Up to 100 sheets Tray 2: Up to 550 sheets E60065x: Up to 1,200 sheets (up to 4,400 maximum ¹⁵) Tray 1: Up to 100 sheets Trays 2 and 3: Up to 550 sheets each	E60075dn: Up to 650 sheets (up to 4,400 maximum ¹⁵) Tray 1: Up to 100 sheets Tray 2: Up to 550 sheets E60075x: Up to 1,200 sheets (up to 4,400 maximum ¹⁵) Tray 1: Up to 100 sheets Trays 2 and 3: Up to 550 sheets each
Output capacity	Up to 500 sheets (standard); up to 1,300 sheets with optional 5-bin stapler/stacker/mailbox accessory		
Two-sided printing	Automatic		
Media sizes	Tray 1: Letter, legal, statement, executive, Oficio (8.5 x 13 in), 3 x 5 in, 4 x 6 in, 5 x 7 in, 5 x 8 in, envelopes (No. 9, No. 10, Monarch (7 3/4)); A4, A5, A6, RA4, B5, B6 (JIS), Oficio (216 x 340 mm), 16K, 10 x 15 cm, postcards (JIS single and double), envelopes (C5, B5, C6, DL, ISO); Custom media sizes: 3 x 5 to 8.5 x 14 in (76 x 127 to 216 x 356 mm) Tray 2, optional trays 3, 4, 5, and 6: Letter, legal, executive; A4, A5, A5-R, B5 (JIS), 16K; Custom media sizes: 3.9 x 5.8 to 8.5 x 14 in (99 x 148 to 216 x 356 mm) Duplex: Letter, legal, executive; A4, A5, RA4, B5 (JIS), Oficio (216 x 340 mm) Optional 2,100-sheet feeder: Letter, legal, executive; A4, A5, A5-R, B5 (JIS), 16K		
Media weights	Tray 1: plain: 16 to 53 lb (60 to 199 g/m ²); envelopes: 16 to 24 lb (60 to 90 g/m ²) Tray 2, optional trays 3, 4, 5, and 6, optional 2,100-sheet feeder, duplex: 16 to 32 lb (60 to 120 g/m ²)		
Media types	Paper (plain, light, bond, recycled, heavy, extra heavy, cardstock, pre-printed, pre-punched, colored, rough, heavy rough), mono transparency, labels, letterhead, envelope, heavy envelope		
Print languages	HP PCL 6, HP PCL 5 (HP PCL 5 driver available from the Web only), HP postscript level 3 emulation, native PDF printing (v 1.7), Apple® AirPrint®		
Fonts	105 internal TrueType fonts scalable in HP PCL, 92 internal scalable fonts in HP postscript level 3 emulation (Euro symbol built-in); 1 internal Unicode Font (Andale Mono WorldType); 2 Internal Windows Vista® 8 Fonts (Calibri, Cambria); Additional font solutions available via third-party flash memory cards; HP LaserJet Fonts and IPDS Emulation available at hp.com/go/laserjetfonts		
Connectivity	2 Hi-Speed USB 2.0 Host; 1 Hi-Speed USB 2.0 Device; 1 Gigabit Ethernet 10/100/1000T network		
Mobile printing	HP ePrint, ⁴¹ Apple AirPrint, ⁴² Mopria-certified, Google Cloud Print™ 2.0 Optional: Wireless direct printing ²⁹ and NFC touch-to-print ³⁰ (with purchase of HP Jetdirect 3000w NFC/Wireless Accessory)		

	HP LaserJet Managed E60055dn	HP LaserJet Managed E60065 series	HP LaserJet Managed E60075 series
Network capabilities	Standard: via HP Jetdirect Ethernet embedded print server supports: 10Base-T, 100Base-Tx, 1000Base-T; 802.3az (EEE) support on Fast Ethernet and Gigabit Ethernet; IPsec Optional: 802.11b/g/n wireless networking (with purchase of HP Jetdirect 3000w NFC/Wireless Accessory) ³¹		
Network protocols	Via built-in networking solution: TCP/IP, IPv4, IPv6 Print: TCP-IP port 9100 Direct Mode, LPD (raw queue support only), Web Services Printing, IPP 2.0, Apple AirPrint, HP ePrint, FTP Print, Google Cloud Print Discovery: SLP, Bonjour, Web Services Discovery IP config: IPv4 (BootP, DHCP, AutoIP, Manual, TFTP Config, ARP-Ping), IPv6 (Stateless Link-Local and via Router, Statefull via DHCPv6) Management: SNMPv2/v3, HTTP/HTTPS, Telnet, TFTP Config, FTP FW Download, Syslog Security: SNMPv3, SSL Cert Management, Firewall, ACL, 802.1x		
Security	Identity Management: Kerberos authentication, LDAP authentication, 1000 user PIN codes, optional HP and third-party advanced authentication solutions (e.g., badge readers) Network: IPsec/firewall with Certificate, Pre-Shared Key, and Kerberos authentication, Supports WJA-10 IPsec configuration Plug in, 802.1X authentication (EAP-PEAP, EAP-TLS), SNMPv3, HTTPS, Certificates, Access Control List Data: Storage Encryption, Encrypted PDF and email (uses FIPS 140 validated cryptographic libraries from Microsoft), Secure Erase, SSL/TLS (HTTPS), Encrypted Credentials Device: Security lock slot, USB port disablement, Hardware Integration Pocket for security solutions, ⁵ Intrusion Detection with Red Balloon Security Technology - Constant in-device monitoring for attacks, HP SureStart Secure Boot - BIOS Integrity Checking with self-healing capability, Whitelisting - loads only known good code (DLLs, EXEs, etc.) Security Management: Compatible with HP JetAdvantage Security Manager, ⁶ Device Security Syslog Messages processed and accessible in ArcSight and Splunk SIEMs		
Compatible operating systems⁴³	Windows® OS: Windows 10 all 32- and 64-bit editions (excluding RT OS for Tablets), Windows 7 all 32- and 64-bit editions, Windows 8/8.1 all 32- and 64-bit editions (excluding RT OS for Tablets), Windows Vista all 32-bit editions (Home Basic, Premium, Professional, etc.), Windows XP SP3 32-bit editions (XP Home, XP Pro, etc.) Mac OS: 10.12 Sierra, OS X 10.10 Yosemite, OS X 10.11 El Capitan Mobile OS: Android™ Linux Boss (5.0), Linux Debian (7.0, 7.1, 7.2, 7.3, 7.4, 7.5, 7.6, 7.7, 7.8, 7.9, 8.0, 8.1, 8.2, 8.3, 8.4, 8.5, 8.6), Linux Fedora (22, 23, 24), Linux Mint (17, 17.1, 17.2, 17.3, 18), Linux Red Hat Enterprise (6.0, 7.0), Linux SUSE (13.2, 42.1), Linux Ubuntu (12.04, 14.04, 15.10, 16.04, 16.10) Other OS: UNIX™		
Compatible network operating systems	Citrix MetaFrame Presentation Server 3.0, Citrix MetaFrame XP Presentation Server (Feature Release 1, 2, and 3), Citrix on Windows Server® 2003/2003R2, Citrix on Windows Server 2008/2008R2/2008 R2 SP1, Citrix on Windows Server 2012/2012R2, Citrix Presentation Server 4.0/4.5, Citrix XenApp 5.0 (Plus Feature Pack 2 and 3) for Windows Server 2008 Terminal Services 32- and 64-bit, Citrix XenApp 6.0/6.5 (for Windows Server 2008 R2 Terminal Services, 32- and 64-bit), Citrix XenApp 6.0/6.5/7.5 (for Windows Server 2008 R2 SP1 Terminal Services, 32- and 64-bit), Citrix XenApp 7.5 (for Windows Server 2012 and 2012 R2 Terminal Services, 64-bit), Citrix XenDesktop 5.6 (for Windows Server 2008 R2 Terminal Services, 32- and 64-bit), Citrix XenDesktop 5.6/7.0/7.5 (for Windows Server 2008 R2 SP1 Terminal Services, 32- and 64-bit), Citrix XenDesktop 7.0/7.5 (for Windows Server 2012 and 2012 R2 Terminal Services, 64-bit) Novell NetWare 6.5/SP8 Novell Clients novell.com/iprint , Novell iPrint Appliance v1.0, Novell Open Enterprise Server 11/SP1, Novell Open Enterprise Server 2 for Linux, Novell Servers novell.com/iprint Windows Server 2003/2003 R2 32-/64-bit (SP1/SP2) Standard/Enterprise/Datacenter (+ Cluster and Terminal Services), Windows Server 2003/2003 R2 32-bit (SP1/SP2), Standard/Enterprise (+ Cluster and Terminal Services), Windows Server 2008 32-/64-bit (SP2) Standard/Enterprise (+ Cluster and Terminal Services), Windows Server 2008 R2 64-bit (SP1) Standard/Enterprise (+ Cluster and Terminal Services), Windows Server 2008/2008 R2 32-/64-bit (SP1/SP2) Standard/Enterprise/Datacenter (+ Cluster and Terminal Services), Windows Server 2012/2012 R2 64-bit Standard/Foundation/Essentials/Datacenter (+ Cluster and Terminal Services), Windows Server 2016/ 64-bit Standard/ Essential/Datacenter (+ Cluster and Terminal Services)		
System requirements, Windows	A compatible operating system (see above), 2 GB available hard disk space, OS compatible hardware (for OS hardware requirements see microsoft.com)		
System requirements, Macintosh	A compatible operating system (see above), 1.3 GB available hard disk space (for operating system compatible hardware requirements see apple.com)		
Dimensions, operating (width x depth x height)	E60055dn, E60065dn, and E60075dn: 17 x 18.3 x 15 in (431 x 466 x 380 mm) E60065x and E60075x: 17 x 18.3 x 19.9 in (431 x 466 x 505 mm)		
Dimensions, maximum⁴⁴ (width x depth x height)	E60055dn, E60065dn, and E60075dn: 17 x 40.9 x 17.8 in (431 x 1040 x 453 mm) E60065x and E60075x: 17 x 43.3 x 22.9 in (431 x 1100 x 581 mm)		
Weight (with print cartridges)	E60055dn, E60065dn, and E60075dn: 47.7 lb (21.6 kg) E60065x and E60075x: 58 lb (26.3 kg)		
What's in the box	HP LaserJet Managed Printer, automatic duplexer, HP Black Original LaserJet Toner Cartridge (~11,000 pages), ²⁴ CD with software drivers and documentation, Documentation (Hardware Install Guide), Power cord E60065x and E60075x: Plus 550-sheet input feeder 3		
Software included	HP Connected, HP Device Experience (DXP), HP PCL 6 Printer Driver, HP Software Installer/Uninstaller, Mac OS Welcome Screen (Directs users to 123.HP.com or OS App Source for printer software), Online user manuals		

	HP LaserJet Managed E60055dn	HP LaserJet Managed E60065 series	HP LaserJet Managed E60075 series
Downloadable software	HP Easy Start (Guided Software Install for Windows OS and Mac); HP ePrint Software (ePrint Mobile Driver for Windows); HP ePrint Software (for Windows); HP JetAdvantage Security Manager; ⁶ HP Mobile Printing hp.com/us/en/ads/mobility/overview.html ; HP PCL6 print driver only (No installer for "Add Printer" installs); HP PCL6 print driver with installer, Product Documentation and Support; HP Proxy Agent Software; HP Universal Print Drivers (PCL6 and PS for Windows); ¹⁰ Linux/Unix Print Drivers; Mac Software Solution; Printer Administrator Resource Kit; SAP (PS Print Drivers); HP Web Jetadmin; ⁷ Windows driver only solution; Windows Full Software Solution		
Warranty	One-year, next-business day, onsite warranty Warranty and support options vary by product, country and local legal requirements. Go to hp.com/support to learn about HP award winning service and support options in your region.		
HP SureSupply supported	HP SureSupply alerts you when your print cartridge is running low and helps you purchase online or locally through HP or a participating retailer. Only available with Original HP supplies; Internet access required. To learn more, visit hp.com/go/SureSupply .		

Environmental and power specifications

	HP LaserJet Managed E60055dn	HP LaserJet Managed E60065 series	HP LaserJet Managed E60075 series
Environmental ranges			
Temperatures	Operating: 59 to 90.5° F (15 to 32.5° C); Recommended operating: 59 to 80.6° F (15 to 27° C); Storage: -4 to 104° F (-20 to 40° C)		
Relative Humidity	Operating range: 10 to 80% RH; Recommended operating range: 30 to 70% RH; Storage range: 10 to 90% RH		
Acoustic power emissions⁴⁵	Ready mode: Inaudible; Printing: 6.9 B(A)		
Acoustic pressure emissions (bystander)			
Ready mode	Inaudible (<i>all models</i>)		
Active mode	Printing mono, simplex A4 at 53 ppm: 55 dB(A)	Printing mono, simplex A4 at 62 ppm: E60065dn: 55 dB(A) E60065x: 54 dB(A)	Printing mono, simplex A4 at 71 ppm: E60075dn: 56 dB(A) E60075x: 55 dB(A)
Power specifications⁴⁶			
Power supply	Built-in 115V or 220V (Not dual voltage, power supply varies by part number with # option code identifier) 100 V-127 V nominal @ +/-10% (min 90 V, max 140 V); 50-60 Hz nominal +/- 3 Hz (min 47 Hz, max 63 Hz); 12 A 220 V-240 V nominal @ +/-10% (min 198 V, max 264 V); 50-60 Hz nominal +/- 3 Hz (min 47 Hz, max 63 Hz); 6 A		
Power consumption	Active: 780 watts, Ready: 15.3 watts, Sleep: 3.1 watts, Off/Auto-off: <0.1 watts		
Typical electricity consumption (TEC)	2.131 kWh/week	2.622 kWh/week	3.173 kWh/week
Energy-saving features	HP Auto-On/Auto-Off Technology ²⁰		
Environmental specifications	All models: ENERGY STAR® certified; CECP; EPEAT® Silver ⁴⁷		
		E60065dn and E60075dn: Plus optional EPEAT Gold ⁴⁷	
Safety and regulatory compliance	IEC 60950-1:2005 +A1:2009 +A2:2013 (International); EN60950-1:2006 +A1:2009 +A1:2010 +A12:2011 +A2:2013 (EU); EN 60825-1:2007 / IEC 60825-1:2007 (Class 1 Laser Product); EN 62479:2010 / IEC 62479:2010; Low Voltage Directive 2006/95/EC with CE Mark (Europe); GS Certificate (Germany, Europe); UL/cUL Listed and UC CoC (US/Canada); CAN/CSA C22.2 No. 60950-1-07 2nd Ed. 2011-12; Compliance with Laser safety standards 21 CFR 1040.10 and 1040.11 except for deviations pursuant to Laser notice No. 50, dated June 24, 2007; Other safety approvals as required by individual countries		
Electromagnetic emission standard	CISPR 22:2008 (International) - Class A; EN 55022: 2010 (EU) - Class A; EN 61000-3-2: 2006 +A1: 2009 +A2: 2009; EN 61000-3-3: 2008; EN 55024: 2010; EMC Directive 2004/108/EC; FCC CFR 47 Part 15 Class A / ICES-003, Issue 5 Class A; Other EMC approvals as required by individual countries		

HP LaserJet Managed MFP E62500 series technical specifications

	HP LaserJet Managed MFP E62555dn	HP LaserJet Managed MFP E62565hs	HP LaserJet Managed Flow MFP E62565h	HP LaserJet Managed Flow MFP E62565z	HP LaserJet Managed Flow MFP E62575z
Product number	J8J66A	J8J73A	J8J74A	J8J79A	J8J80A
Control panel/data entry	8-inch (20.3 cm) SVGA LCD (color graphics), smooth gesture-enabled touchscreen; Hardware Integration Pocket ⁵				
	Plus pull-out keyboard				
Print speed¹³					
Simplex (letter/A4)	Up to 55/52 ppm	Up to 65/61 ppm		Up to 75/71 ppm	
Duplex (letter/A4)	Up to 45/43 ipm	Up to 53/50 ipm		Up to 62/58 ipm	
First page out	From ready: ¹¹ as fast as 5.3/5.4 seconds (letter/A4)				
	From sleep: ¹² as fast as 7.8/7.9 seconds (letter/A4)			From sleep: ¹² as fast as 12.1/12.2 seconds (letter/A4)	
Print resolution⁴⁸	FastRes 1200 (600 x 600 x 8bpp dpi), 1200 x 1200 dpi				
Scanning resolution	Up to 600 dpi				
ADF scan speed¹⁴					
Single-sided	Up to 75/69 ppm (letter/A4, black and color)		Up to 90/83 ppm (letter/A4, black and color)		
Two-sided	Up to 120/111 ipm (letter/A4, black and color)		Up to 180/167 ipm (letter/A4, black and color)		
Features					
Printing	Print preview, duplex printing, print multiple pages per sheet (2, 4, 6, 9, 16), collation, watermarks, store print jobs, easy-access USB				
Scanning	Flatbed scanner, up to 8.75 x 14.375 in (220 x 365 mm); 150-sheet ADF with two-sided, single-pass scanning; Advanced features: Optimize text/picture, image adjustments, job build, output quality setting, selectable scan resolution 75 to 600 dpi, auto detect color, edge erase, job notification, blank page suppression, Quick Sets				
	Plus HP EveryPage with ultrasonic multi-feed detection, Embedded Optical Character Recognition (OCR), auto-orientation, auto-crop-to-page, auto-tone				
Digital sending	Standard: Scan to email, save-to-network folder, save-to-USB drive, send to SharePoint, send to FTP, send to Internet fax, ²⁶ local address book, SMTP over SSL, send to LAN fax, ²⁶ blank page removal, edge erase, auto color sense, auto crop to content, compact PDF, Quick Sets Optional: via HP Digital Sending Software (HP DSS): send to folder, send-to-workflow, send-to-printer, authentication, digital fax (send to LAN, Internet), OCR, local address book; Optional via HP Embedded Capture: metadata capture and validation, data transfer, scan workflow management				
	Plus HP EveryPage with ultrasonic multi-feed detection, Embedded Optical Character Recognition (OCR), auto-orientation, auto-crop-to-page, auto-tone				
File formats ⁴⁸	PDF, JPEG, TIFF, MTIFF, XPS, PDF/A; Scan to easy-access USB: PDF, JPEG, TIFF, MTIFF, XPS, PDF/A; Print from easy-access USB: PDF, PS, Print Ready files (.prn, .pcl, .cht)				
	Plus TEXT (OCR), Unicode TEXT (OCR), RTF (OCR), Searchable PDF (OCR), Searchable PDF/A (OCR), HTML (OCR), CSV (OCR); Scan to easy access USB: TEXT (OCR), Unicode TEXT (OCR), RTF (OCR), Searchable PDF (OCR), Searchable PDF/A (OCR), HTML (OCR), CSV (OCR)				
Copying	Two-sided copying, scalability, image adjustments (darkness, contrast, background cleanup, sharpness), N-up, N or Z-ordering, content orientation, collation, booklet, job build, edge-to-edge, job storage, ID Copy, Book Copy, A-to-B Copy (different media sizes); Copy resolution: up to 600 x 600 dpi (flatbed), up to 600 x 450 dpi (ADF)				
Faxing (<i>optional on all models</i>)	Fax speed: ⁴⁹ 3 seconds per page/33.6 kbps (letter/A4); fax forwarding, receive fax polling, broadcasting to up to 210 locations, speed dial up to 1000 numbers, each with 210 destinations, auto-fax reduction, auto-redialing, stored faxes, fax archiving, scale-to-fit, fax address book, LAN/Internet fax, fax number confirmation, holiday fax schedule Fax resolution: Standard 203 x 98 dpi, fine 203 x 196 dpi, superfine 300 x 300 dpi, best up to 300 x 300 dpi (400 x 400 dpi for received faxes only); 256 levels of gray				

	HP LaserJet Managed MFP E62555dn	HP LaserJet Managed MFP E62565hs	HP LaserJet Managed Flow MFP E62565h	HP LaserJet Managed Flow MFP E62565z	HP LaserJet Managed Flow MFP E62575z
Processor	1.2 GHz				
Memory	Standard: 1.5 GB (printer) and 512 MB (scanner) Maximum: 2 GB system memory with purchase of 1 GB DDR3 144-pin Accessory DIMM (only 512 MB is addressable by the system)		Standard: 2.5 GB system memory (1.5 GB printer and 1 GB scanner) Maximum: 3 GB system memory with purchase of 1 GB DDR3 144-pin Accessory DIMM (only 512 MB is addressable by the system)		
Storage	Standard: 16 GB EMMC Optional: HP High-Performance Secure Hard Disk, minimum 320 GB	Embedded HP High-Performance Secure Hard Disk, minimum 320 GB (AES 256 hardware encryption or greater; secure erase capabilities: Secure File Erase-Temporary Job Files, Secure Erase-Job Data, Secure ATA Erase-Disk)			
Durability ratings					
RMPV ³⁹	5,000 pages to as high as 40,000 pages				
RMSV ²⁷	14,250 pages to as high as 23,750 pages		26,750 pages to as high as 44,500 pages		
Duty cycle ⁴⁰	Up to 450,000 pages				
Media specifications					
Input capacity ³⁴	Up to 650 sheets standard (up to 3,750 maximum) Tray 1: Up to 100 sheets Tray 2: Up to 550 sheets				
Output capacity	Up to 500 sheets	Up to 1,000 sheets with 3-bin stapler/stacker	Up to 500 sheets	Up to 1,000 sheets with 3-bin stapler/stacker	
Two-sided printing	Automatic				
Media sizes	Tray 1: Letter, legal, statement, executive, Oficio (8.5 x 13 in), 3 x 5 in, 4 x 6 in, 5 x 7 in, envelopes (No. 9, No. 10, Monarch); A4, A5, A6, RA4, B5 (JIS), B6 (JIS), 16K, 10 x 15 cm, Oficio (216 x 340 mm), postcards (JIS single and double), envelopes (DL ISO, C5, C6, B5); Custom media sizes: 3 x 5 to 8.5 x 14 in (76 x 127 to 216 x 356 mm) Tray 2 and optional trays 3, 4, and 5: Letter, legal, executive; A4, A5, A5-R, RA4, B5 (JIS), 16K; Custom media sizes: 3.9 x 5.8 to 8.5 x 14 in (99 x 148 to 216 x 356 mm) Optional HCI: Letter, legal; A4; Custom media sizes: 8.27 x 11 to 8.5 x 14 (210 x 279 to 216 x 356 mm) Duplex: Letter, legal, executive; A4, A5, RA4, B5 (JIS), Oficio (216 x 340 mm) ADF: Letter, legal, Oficio, executive, statement, 16K, 4 x 6 in, 5 x 7 in, 5 x 8 in; A4, RA4, A5, A6, B5, B6 (JIS), Postcard (JIS), DPostcard (JIS)				
Media weights	Tray 1: Plain: 16 to 53 lb (60 to 199 g/m ²); Envelopes: 16 to 24 lb (60 to 90 g/m ²) Tray 2 and optional trays 3, 4, and 5, optional HCI, duplex: 16 to 32 lb (60 to 120 g/m ²) ADF: 12 to 53 lb (45 to 199 g/m ²)				
Media types	Paper (plain, light, bond, recycled, heavy, extra heavy, cardstock, pre-printed, pre-punched, colored, rough, heavy rough), mono transparency, labels, letterhead, envelope, heavy envelope				
Print languages	HP PCL 6, HP PCL 5 (HP PCL 5 driver available from the Web only), HP postscript level 3 emulation, native PDF printing (v 1.7), Apple AirPrint ⁴²				
Fonts	105 internal TrueType fonts scalable in HP PCL, 92 internal scalable fonts in HP postscript level 3 emulation (Euro symbol built-in); 1 internal Unicode Font (Andale Mono WorldType); 2 Internal Windows Vista 8 Fonts (Calibri, Cambria); Additional font solutions available via third-party flash memory cards; HP LaserJet Fonts and IPDS Emulation available at hp.com/go/laserjetfonts				
Connectivity	2 Hi-Speed USB 2.0 Host; 1 Hi-Speed USB 2.0 Device; 1 Gigabit Ethernet 10/100/1000T network; Optional fax				
Mobile printing	HP ePrint, ⁴¹ Apple AirPrint, ⁴² Mopria-certified, Google Cloud Print 2.0 Optional: Wireless direct printing ²⁹ and NFC touch-to-print ³⁰ (with purchase of HP Jetdirect 3000w NFC/Wireless Accessory)				
Network capabilities	Standard: via HP Jetdirect Ethernet embedded print server supports: 10Base-T, 100Base-Tx, 1000Base-T; 802.3az (EEE) support on Fast Ethernet and Gigabit Ethernet; IPsec Optional: 802.11a/b/g/n wireless networking enabled (with purchase of HP Jetdirect 3000w NFC/Wireless Accessory) ³¹				

	HP LaserJet Managed MFP E6255dn	HP LaserJet Managed MFP E62565hs	HP LaserJet Managed Flow MFP E62565h	HP LaserJet Managed Flow MFP E62565z	HP LaserJet Managed Flow MFP E62575z
Network protocols	<p>Via built-in networking solution: TCP/IP, IPv4, IPv6</p> <p>Print: TCP-IP port 9100 Direct Mode, LPD (raw queue support only), Web Services Printing, IPP 2.0, Apple AirPrint,⁴² HP ePrint, FTP Print, Google Cloud Print</p> <p>Discovery: SLP, Bonjour, Web Services Discovery</p> <p>IP Config: IPv4 (BootP, DHCP, AutoIP, Manual, TFTP Config, ARP-Ping), IPv6 (Stateless Link-Local and via Router, Statefull via DHCPv6)</p> <p>Management: SNMPv2/v3, HTTP/HTTPS, Telnet, TFTP Config, FTP FW Download, Syslog</p> <p>Security: SNMPv3, SSL Cert Management, Firewall, ACL, 802.1x</p>				
Security	<p>Identity management: Kerberos authentication, LDAP authentication, 1000 user PIN codes, optional HP and 3rd party advanced authentication solutions (e.g., badge readers)</p> <p>Network: IPsec/firewall with Certificate, Pre-Shared Key, and Kerberos authentication, Supports WJA-10 IPsec configuration Plug-in, 802.1X authentication (EAP-PEAP, EAP-TLS), SNMPv3, HTTPS, Certificates, Access Control List</p> <p>Data: Storage Encryption, Encrypted PDF and Email (uses FIPS 140 validated cryptographic libraries from Microsoft), Secure Erase, SSL/TLS (HTTPS), Encrypted Credentials</p> <p>Device: Security lock slot, USB port disablement, Hardware Integration Pocket for security solutions,⁵ Intrusion Detection with Red Balloon Security Technology - Constant in-device monitoring for attacks, HP Sure Start Secure Boot - BIOS Integrity Checking with self-healing capability, Whitelisting - loads only known good code (DLLs, EXEs, etc.)</p> <p>Security management: Compatible with HP JetAdvantage Security Manager,⁶ Device Security Syslog Messages processed and accessible in ArcSight and Splunk SIEMs</p>				
Compatible operating systems⁴³	<p>Windows 10 all 32- and 64-bit editions (excluding RT OS for Tablets), Windows 7 all 32- and 64-bit editions, Windows 8/8.1 all 32- and 64-bit editions (excluding RT OS for Tablets), Windows Vista all 32-bit editions (Home Basic, Premium, Professional, etc.), Windows XP SP3 32-bit editions (XP Home, XP Pro, etc.)</p> <p>Mac OS 10.12 Sierra, OS X 10.10 Yosemite, OS X 10.11 El Capitan</p> <p>Mobile OS: Android</p> <p>Linux Boss (5.0), Linux Debian (7.0, 7.1, 7.2, 7.3, 7.4, 7.5, 7.6, 7.7, 7.8, 7.9, 8.0, 8.1, 8.2, 8.3, 8.4, 8.5, 8.6), Linux Fedora (22, 23, 24), Linux Mint (17, 17.1, 17.2, 17.3, 18), Linux Red Hat Enterprise (6.0, 7.0), Linux SUSE (13.2, 42.1), Linux Ubuntu (12.04, 14.04, 15.10, 16.04, 16.10)</p> <p>Other: UNIX</p>				
Compatible network operating systems	<p>Citrix MetaFrame Presentation Server 3.0, Citrix MetaFrame XP Presentation Server (Feature Release 1, 2, and 3), Citrix on Windows Server 2003/2003 R2, Citrix on Windows Server 2008/2008 R2/2008 R2 SP1, Citrix on Windows Server 2012/2012 R2, Citrix Presentation Server 4.0/4.5, Citrix XenApp 5.0 (Plus Feature Pack 2 and 3) for Windows Server 2008 Terminal Services 32- and 64-bit, Citrix XenApp 6.0/6.5 [for Windows Server 2008 R2 Terminal Services, 32- and 64-bit], Citrix XenApp 6.0/6.5/7.5 [for Windows Server 2008 R2 SP1 Terminal Services, 32- and 64-bit], Citrix XenApp 7.5 [for Windows Server 2012 and 2012 R2 Terminal Services, 64-bit], Citrix XenDesktop 5.6 [for Windows Server 2008 R2 Terminal Services, 32- and 64-bit], Citrix XenDesktop 5.6/7.0/7.5 [for Windows Server 2008 R2 SP1 Terminal Services, 32- and 64-bit], Citrix XenDesktop 7.0/7.5 [for Windows Server 2012 and 2012 R2 Terminal Services, 64-bit]</p> <p>Novell NetWare 6.5/SP8 Novell Clients novell.com/iprint, Novell iPrint Appliance v1.0, Novell Open Enterprise Server 11/SP1, Novell Open Enterprise Server 2 for Linux, Novell Servers novell.com/iprint</p> <p>Windows Server 2003/2003 R2 32-/64-bit (SP1/SP2) Standard/Enterprise/Datacenter (+ Cluster and Terminal Services), Windows Server 2003/2003 R2 32-bit (SP1/SP2), Standard/Enterprise (+ Cluster and Terminal Services), Windows Server 2008 32-/64-bit (SP2) Standard/Enterprise (+ Cluster and Terminal Services), Windows Server 2008 R2 64-bit (SP1) Standard/Enterprise (+ Cluster and Terminal Services), Windows Server 2008/2008 R2 32-/64-bit (SP1/SP2) Standard/Enterprise/Datacenter (+ Cluster and Terminal Services), Windows Server 2012/2012 R2 64-bit Standard/Foundation/Essentials/Datacenter (+ Cluster and Terminal Services)</p>				
System requirements, Windows	A compatible operating system (see above), 2 GB available hard disk space (OS hardware requirements, see microsoft.com)				
System requirements, Macintosh	A compatible operating system (see above), 1.3 GB available hard drive space, Internet (OS hardware requirements, see apple.com)				
Dimensions, operating (width x depth x height)	20.15 x 22 x 25.2 in (512 x 558 x 640 mm)	27.5 x 25.2 x 30.9 in (700 x 639 x 785 mm)	33.7 x 29.9 x 40.4 in (856 x 760 x 1025 mm)	20.15 x 22.0 x 30.7 in (512 x 558 x 779 mm)	
Dimensions, maximum⁴⁴ (width x depth x height)	40.5 x 31.7 x 34.1 in (1030 x 808 x 865 mm)	40.5 x 31.7 x 34.1 in (1030 x 808 x 865 mm)	40.5 x 31.7 x 42.0 in (1030 x 808 x 1067 mm)	40.5 x 35 x 35 in (1030 x 890 x 890 mm)	
Weight (with print cartridges)	73.2 lb (33.2 kg)		87.7 lb (39.8 kg)		
What's in the box	HP LaserJet Managed Multifunction Printer, Power Cord, HP Black Original LaserJet Toner Cartridge (~11,000 pages), ²⁴ CD with software drivers and documentation				

	HP LaserJet Managed MFP E62555dn	HP LaserJet Managed MFP E62565hs	HP LaserJet Managed Flow MFP E62565h	HP LaserJet Managed Flow MFP E62565z	HP LaserJet Managed Flow MFP E62575z
Software included⁴⁸	HP Connected, HP Device Experience (DXP), HP PCL 6 (XPS) Printer Driver, HP Software Installer/Uninstaller, Mac OS Welcome Screen (Directs users to 123.hp.com or OS App Source for printer software), Online user manuals				
Downloadable software	HP Easy Start (Guided Software Install for Windows OS and Mac); HP ePrint Software (ePrint Mobile Driver for Windows); HP ePrint Software (for Windows); HP JetAdvantage Security Manager; ⁶ HP Mobile Printing hp.com/us/en/ads/mobility/overview ; HP PCL6 (XPS) print driver only (No installer for "Add Printer" installs); HP PCL6 (XPS) print driver with installer; Product Documentation and Support; HP Proxy Agent Software; HP Universal Print Drivers (PCL6 and PS for Windows); Linux/Unix Print Drivers; Mac Software Solution; Printer Administrator Resource Kit; SAP (PS Print Drivers); HP Web Jetadmin; ⁷ Windows driver only solution; Windows Full Software Solution				
Warranty	One-year, next-business day, onsite warranty. Warranty and support options vary by product, country and local legal requirements. Go to hp.com/support to learn about HP award winning service and support options in your region.				
HP SureSupply supported	HP SureSupply alerts you when you should replace a print cartridge and helps you purchase locally or via the Internet. For more information, visit hp.com/learn/suresupply . Only available with original HP supplies; Internet access required.				

Environmental and power specifications

	HP LaserJet Managed MFP E62555dn	HP LaserJet Managed MFP E62565hs	HP LaserJet Managed Flow MFP E62565h	HP LaserJet Managed Flow MFP E62565z	HP LaserJet Managed Flow MFP E62575z
Environmental ranges					
Temperatures	Operating range: 59 to 90.5° F (15 to 32.5° C); Recommended operating range: 59 to 80.6° F (15 to 27° C); Storage: -4 to 104° F (-20 to 40° C)				
Relative Humidity Range	Operating range: 10 to 80% RH; Recommended operating range: 30 to 70% RH; Storage range: 10 to 90% RH				
Acoustic power emissions⁴⁵					
Ready mode	Inaudible (<i>all models</i>)				
Active printing	6.9 B(A)	6.9 B(A)			7.1 B(A)
Active copying	7.4 B(A)	7.4 B(A)			7.5 B(A)
Active scanning	7.2 B(A)	7.2 B(A)			7.2 B(A)
Acoustic pressure emissions (bystander)					
Ready mode	Inaudible (<i>all models</i>)				
Active printing	55 dB(A)	56 dB(A)			57 dB(A)
Active copying	59 dB(A)	60 dB(A)			60 dB(A)
Active scanning	58 dB(A) (<i>all models</i>)				
Power specifications⁴⁶					
Power supply	Built-in 115V or 220V power supply (Not dual voltage, power supply varies by part number with # Option code identifier) 100 V-127 V nominal @ +/-10% (min 90 V, max 140 V); 50-60 Hz nominal +/- 3 Hz (min 47 Hz, max 63 Hz); 12 A 220 V-240 V nominal @ +/-10% (min 198 V, max 264 V); 50-60 Hz nominal +/- 3 Hz (min 47 Hz, max 63 Hz); 6 A				
Power consumption	Printing/copying: 740 watts; Ready: 29 watts; Sleep: 3.3 watts; Auto-off/wake on LAN: 0.8 watts; Manual off: 0.1 watts				
Energy-saving features	HP Auto-On/Auto-Off Technology, ²⁰ Instant-on Technology, Instant-on Copy				
Environmental specifications	ENERGY STAR certified; CECP; EPEAT Silver registered models available ⁴⁷				
Typical Electricity Consumption (TEC)	2.348 kWh/week	2.849 kWh/week			3.478 kWh/week
Safety and regulatory compliance	IEC 60950-1:2005 +A1:2009 +A2:2013 (International); EN60950-1:2006 +A11:2009 +A1:2010 +A12:2011 +A2:2013 (EU); EN 60825-1:2007 / IEC 60825-1:2007 (Class 1 Laser Product); EN 62479:2010 / IEC 62479:2010; Low Voltage Directive 2006/95/EC with CE Mark (Europe); GS Certificate (Germany, Europe); UL/cUL Listed and UC CoC (US/Canada); CAN/CSA C22.2 No. 60950-1-07 2nd Ed. 2011-12; Compliance with Laser safety standards 21 CFR 1040.10 and 1040.11 except for deviations pursuant to Laser notice No. 50, Dated June 24, 2007; Other safety approvals as required by individual countries				
Electromagnetic emission standard	CISPR 22: 2008/EN 55022: 2010 (Class A), EN 61000-3-2: 2006 +A1: 2009 + A2: 2009; EN 61000-3-3 :2008; EN 55024:2010; FCC Title 47 CFR, Part 15 Class A (USA); ICES-003, Issue 4 (Canada); EMC Directive 2004/108/EC with CE Marking (Europe); other EMC approvals as required by individual countries				

Ordering information

Product	HP LaserJet Managed E60055dn	M0P33A	
	HP LaserJet Managed E60065dn	M0P35A	
	HP LaserJet Managed E60065x	M0P36A	
	HP LaserJet Managed E60075dn	M0P39A	
	HP LaserJet Managed E60075x	M0P40A	
	HP LaserJet Managed MFP E62555dn	J8J66A	
	HP LaserJet Managed MFP E62565hs	J8J73A	
	HP LaserJet Managed Flow MFP E62565h	J8J74A	
	HP LaserJet Managed Flow MFP E62565z	J8J79A	
	HP LaserJet Managed Flow MFP E62575z	J8J80A	
Supplies	E60000 series:		
	HP Black Managed LaserJet Toner Cartridge (~50,000 pages) ²⁴	W9004MC	
	HP 37Y Extra-High-Yield Black Contract Original LaserJet Toner Cartridge (~41,000 pages) ²⁴	CF237YC	
	HP LaserJet 110V Fuser Maintenance Kit (225,000 pages)	LOH24A	
	HP LaserJet 220V Fuser Maintenance Kit (225,000 pages)	LOH25A	
	HP Staple Cartridge Refill (5,000 staples)	J8J96A	
	MFP E62500 series:		
	HP Black Managed LaserJet Toner Cartridge (~50,000 pages) ²⁴	W9004MC	
	HP 37Y Extra-High-Yield Black Contract Original LaserJet Toner Cartridge (~41,000 pages) ²⁴	CF237YC	
	HP LaserJet 110v Fuser Maintenance Kit (225,000 pages)	J8J87A	
	HP LaserJet 220v Fuser Maintenance Kit (225,000 pages)	J8J88A	
	HP ADF Maintenance Kit (150,000 pages)	J8J95A	
	HP Staple Cartridge Refill (5,000 staples)	J8J96A	
	Accessories	E60000 series:	
		HP LaserJet 550-sheet Paper Feeder	LOH17A
		HP LaserJet 2,100-sheet Paper Feeder	LOH18A
HP LaserJet Printer Stand		LOH19A	
HP LaserJet Stapler/Stacker/Mailbox		LOH20A	
HP Envelope Feeder		LOH21A	
HP Extension Tray Cover		LOH22A	
HP Internal USB Ports (AA Module - CSR-A)		B5L28A	
HP High Performance Secure Hard Disk (FIPS - CSR-A)		B5L29A	
HP Jetdirect 2900nw Print Server ³¹		J8031A	
HP Jetdirect 3000w NFC/Wireless Direct Accessory ³⁰		J8030A	
HP Trusted Platform Module Accessory		F5562A	
1 GB memory DIMM Kit		G6W84A	
E62500 series:			
HP LaserJet 550-sheet Paper Feeder		J8J89A	
HP LaserJet 1x550-sheet Paper Feeder with Stand and Cabinet		J8J91A	
HP LaserJet 1x550 and 2,000-sheet HCI Feeder and Stand		J8J92A	
HP LaserJet 3x550-sheet paper Feeder and Stand		J8J93A	
HP LaserJet Envelope Feeder		J8J90A	
HP Internal USB Ports (AA Module - CSR-A)		B5L28A	
HP High Performance Secure Hard Disk (FIPS - CSR-A)		B5L29A	
HP Foreign Interface Harness (FIH)		B5L31A	
HP LaserJet MFP Analog Fax Accessory 500		CC487A	
HP Jetdirect 2900nw Print Server ³¹		J8031A	
HP Jetdirect 3000w NFC/Wireless Accessory ³⁰		J8030A	
HP Trusted Platform Module Accessory		F5562A	
HP LaserJet Keyboard Overlay Kit Sweden (Flow models only)		A7W14A	
HP LaserJet Keyboard Overlay Kit - Danish/French-Switzerland/German-Switzerland (in the box when ordering BAZ option) (Flow models only)		A7W13A	
HP LaserJet Keyboard Overlay Kit for Simplified Chinese & Traditional Chinese (Flow models only)		A7W12A	
1 GB Memory DIMM Kit		E5K48A	
Solutions		HP Web Jetadmin: hp.com/go/wja	
		HP Universal Print Driver: hp.com/go/upd	
	HP JetAdvantage Security Manager: hp.com/go/securitymanager		
	HP JetAdvantage On Demand Cloud Solutions: hp.com/go/jetadvantageondemand		
	HP LaserJet Fonts, Barcodes, and IPDS Emulation available at hp.com/go/laserjetfonts To learn more about available infrastructure, management, and workflow solutions, visit hp.com/go/printing_solutions		

Appendix A: Security features



Resources

HP JetAdvantage Security Solutions:

- Web site: hp.com/go/printsecurity
- Solution brief: <http://h20195.www2.hp.com/V2/GetPDF.aspx/4AA3-1295ENW.pdf>
- Video: <http://hp.brightcovegallery.com/products/detail/video/4270905124001/>

HP JetAdvantage Security Manager:⁵

- Web site: hp.com/go/securitymanager
- Brochure: <http://h20195.www2.hp.com/V2/GetPDF.aspx/4AA3-9275ENW.pdf>
- Video: <http://hp.brightcovegallery.com/products/detail/video/4270837770001/>

The world's most secure printing¹

The HP LaserJet Managed E60000 and MFP E62500 series are designed to work together with security solutions to help reduce risk, improve compliance, and protect your network from end to end. Protect your device, data, and documents with built-in and optional security features.²

Protect your device

As capabilities expand and devices become more integrated into your work, device security becomes increasingly important. These features help protect the device:

- **Embedded protection:** Multi-level, built-in features help protect your device against complex security threats from boot up to shut down. For details, see hp.com/go/PrintersThatProtect.
 - HP Sure Start helps the device BIOS to boot up properly every time with unaltered HP genuine code and without corruption. If an anomaly is detected, the device can repair itself by rebooting.
 - Whitelisting helps the device firmware to load properly with HP genuine code—without corruption—every time.
 - Run-time intrusion detection guards against malware, by continually monitoring activity to detect and stop attacks. If an anomaly is detected, the device automatically reboots.
 - HP Connection Inspector stops malware from “calling home” to malicious servers, stealing data, and compromising your network. It evaluates outgoing network connections to determine what’s normal, stop suspicious requests, and automatically trigger a self-healing reboot.
- **Encrypted storage with secure erase:** The device comes with built-in encryption to protect data. When stored data is no longer needed, use built-in device capabilities to securely overwrite data and safely remove sensitive information. HP offers multiple mechanisms to erase stored data, including functionality that is designed to conform to U.S. National Institute of Science and Technology (NIST) Special Publication 800-88.
- **Ports and protocols:** FTP and Telnet are closed by default to help prevent unsecure protocols from being used. Unused physical ports (such as host USB ports or network ports) can be disabled to prevent unauthorized use.
- **Administrator access control for device:** You can set administrator passwords so only IT staff or other authorized personnel can set up and configure device settings.
- **Common Criteria Certification:** HP Enterprise devices are certified as compliant with internationally recognized security standards, such as Common Criteria Certification (CCC) and FIPS 140.

Protect your data

Your device harbors sensitive information—make sure it’s not at risk.

- **Network protection:** 802.1x or IPsec encrypted network standards can help protect data traveling over the network between the device and management tools such as HP Web Jetadmin⁷ or the Embedded Web Server.
- **Encrypt data in transit:**
 - Protect print jobs traveling to the device with encryption such as Internet Print Protocol over TLS (IPPS). Or, Secure Encrypted Print with HP Universal Print Driver¹⁰ provides true symmetric AES256 print job encryption and decryption from the client to the page based on a user-defined password using FIPS 140 validated cryptographic libraries from Microsoft.
 - Use CipherSuite Encryption Strength to select encryption strength to prevent the use of legacy or insecure protocols for data in transit.
 - Scanned PDFs and emails can be encrypted using built-in FIPS 140 validated cryptographic libraries from Microsoft.
 - HP offers a rich portfolio of HP JetAdvantage Workflow Solutions that provide advanced capture and route capabilities with enterprise level security. For more information, visit hp.com/go/documentmanagement.
- **Encrypt data at rest:**
 - The HP High-Performance Secure Hard Disk³ provides full 256-bit AES hardware encryption to protect sensitive business information, such as print jobs or passwords.

- The optional HP Trusted Platform Module (TPM) helps strengthen protection of encrypted credentials and data by automatically sealing device encryption keys to the TPM. It provides secure device identity by generating and protecting certificate private keys.⁴
- **Firewall:** Prevent malware and viruses from entering your network by limiting printer access to computing devices in network.
- **Authentication and authorization:** Manage user access using native features or optional solutions.
 - With native user authentication, you can require users to sign in with PIN/PIC, LDAP, or Windows/Kerberos authentication. You can also integrate these with Active Directory.
 - With optional authentication solutions like HP Access Control, you can enable advanced authentication using proximity cards or NFC-enabled mobile devices. To learn more, visit hp.com/go/hpac. The Hardware Integration Pocket enables integration of select card readers.⁵
- **Role-based access controls:** Restrict access to management utilities, avoid unwanted device configurations, and help reduce costs and security risks through printer feature restrictions.
 - With HP FutureSmart 4, you have more control than ever before over device security and permission settings. IT administrators can decide who can interact with certain device capabilities.
 - Optional HP Access Control Rights Management allows you to give different capabilities to different users, or even entire departments, depending on their needs. For example, you can limit who can fax, scan to email, or scan to fax.²⁶
- **Mobile printing:** Optional wireless direct printing²⁹ and optional NFC touch-to-print³⁰ allow mobile users to connect to the printer or MFP without accessing the company network. HP also offers server-based mobile print solutions that provide secure pull printing, as well as advanced management and reporting capabilities. For more information about HP Access Control, please visit hp.com/go/businessmobileprinting.
- **CA and Device Identity Certificates:** This device supports identity certificates signed by a corporate certificate authority, which provides verification of identity and authenticity. This device also supports CA certificates for validation of identity certificates. Certificates can enable secure end-to-end communications with the device when used with features like IPsec, Secure-IPP, HP ePrint, and more. Additional certificates can be stored for validating S/MIME email servers and 802.1x authentication. Save time by using HP JetAdvantage Security Manager to automatically install and renew certificates.⁶



Safeguard your physical documents

HP offers several solutions to help keep documents from falling into the wrong hands and help prevent fraud.

- **PIN/Pull printing:** Have documents held and released only to the person who printed them. Pull printing solutions help protect sensitive data by requiring authentication at the device, and give users the flexibility of pulling the documents from any device that is enabled with the solution.
 - Built-in PIN printing: When users send confidential print jobs, they assign a PIN which they must enter at the device to release the job.
 - HP JetAdvantage Secure Print: With this affordable solution designed for SMB, jobs can be stored in the cloud or on the user's desktop. It's easy to set up and use, allows users to release jobs from a mobile device, and supports multi-vendor devices. For more information, visit hp.com/go/JetAdvantageSecurePrint.⁵⁰
 - HP JetAdvantage Private Print: With HP's free cloud-based solution you get the advantages of pull printing, without the complexity. It is simple to set up and does not require a server, installation, or maintenance. To learn more, visit hp.com/go/JetAdvantagePrivatePrint.⁵¹
 - HP Access Control Secure Pull Printing: This optional robust server-based solution offers multiple forms of authentication including badge release, as well as enterprise level security, management, and scalability. To learn more, visit hp.com/go/hpac.

Easily manage security across the fleet

HP JetAdvantage Security Manager

Easily set security configuration policies and automatically validate settings for every HP printer and MFP in your fleet. Optional HP JetAdvantage Security Manager offers an effective, policy-based approach.⁶

- Automate many tedious tasks so you can free up time for your IT staff and protect the data and documents that matter most to your business.
- Streamline the process to securely deploy and monitor devices by applying a single security policy across the fleet.
- Easily create a print security policy for your environment by leveraging the HP Security Manager Base Policy template.
- Secure new HP devices as soon as they are added to your network, or after a reboot, with HP Instant-on Security. The software automatically configures settings to comply with your corporate security policy.
- Improve the security of your infrastructure and device communications by deploying unique identity certificates and monitoring to ensure they remain valid. With HP Security Manager's efficient fleet management of certificates, the administrative overhead to install certificates across your fleet is now less than manually installing on a single device.
- Actively maintain and verify compliance with your defined security policies by using HP Security Manager automated monitoring and risk-based reporting.

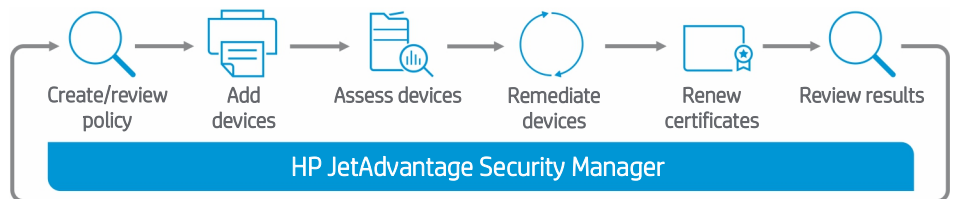

To learn more about HP JetAdvantage Security Manager, please visit hp.com/go/securitymanager.

Works with SIEM tools

Get instant notification of potential security issues so immediate action can be taken to prevent potential attacks. Event data from HP Enterprise devices can be sent to Security Information and Event Management (SIEM) tools such as ArcSight, Splunk, or SIEMonster for real-time monitoring. IT security can easily view printer endpoints as part of the broader IT ecosystem to detect and resolve printer security alerts.



HP security best practices

Since 2005, HP has published security best practice checklists for networked environments common to enterprises and small to medium businesses. For more information on HP security solutions and checklists, please visit hp.com/go/printsecurity.

Appendix B: Fleet management features

Simple one-to-one device management

The printer or MFP can also be managed using the HP Embedded Web Server. Use a web browser to monitor status, configure network parameters, or access device features.

Resources

HP Web Jetadmin:

- Web site: hp.com/go/wja
- Solution brief: <http://h20195.www2.hp.com/V2/GetPDF.aspx/4AA5-2718ENW.pdf>
- Video: <http://hp.brightcovegallery.com/solutions/detail/video/4271055504001/>

HP Universal Print Driver:

- Web site: hp.com/go/upd
- Solution brief: <http://h20195.www2.hp.com/V2/GetPDF.aspx/4AA2-4781ENW>

Efficiently manage from a central location

The HP LaserJet Managed E60000 and MFP E62500 series are supported by HP Web Jetadmin,⁷ an HP JetAdvantage Management Solution. This single solution allows you to efficiently manage a wide variety of networked and PC-connected devices, including printers, multifunction products, and scanners. Remotely install, configure, troubleshoot, safeguard, and manage your devices—ultimately increasing business productivity by helping you save time, control costs, protect your assets, and provide a better return on your investment. Easily integrate new HP LaserJet Pro and Enterprise devices without having to upgrade HP Web Jetadmin. A universal plug-in lets you support most features of new devices and apply corporate policies in one step—helping to save time and simplify device management.⁷

HP Web Jetadmin enables you to:

- Gain a clear picture of how many and what kinds of devices you have.
- Get visibility into your supplies usage, so you can make smarter purchasing decisions, reduce spending, and even track and allocate printing costs to individual departments or users.
- Simplify, and, in many cases, automate routine tasks. For example, you can apply fleet-wide policies to automatically configure new devices with the right printing and security settings when they're added to your network.
- Give your help desk staff the tools they need—such as automatic alerts—to resolve problems quickly, and often proactively, before a call is even received.
- Verify that your devices are up-to-date with the latest firmware and are properly configured (especially important for organizations that need to meet regulatory requirements).
- Use robust tracking and reporting tools to help you make better decisions about how your devices are deployed across your organization, so you can make the most of your IT investments.
- Take advantage of additional options, like the HP Database Connectivity Module, which works together with Web Jetadmin to help you establish and help achieve environmental goals.
- Get the ultimate in investment protection with HP Web Jetadmin Premium Support. This expanded service option gives your staff access to HP's dedicated software support engineers, who provide advice, usage recommendations, problem diagnosis, and more.

HP Web Jetadmin can benefit IT-managed print environments of all sizes, from large enterprises managing thousands of devices to small businesses with just a handful. For more information—or to download this software tool at no additional charge—visit hp.com/go/wja.

Make it easy for all to print with one common driver

The HP Universal Print Driver (UPD) enables both mobile Microsoft device users and traditional desktop users to access the full features of nearly every HP device in your managed printing environment without the need for assistance.¹⁰

Eliminate the clutter on your computer by replacing multiple print drivers with one versatile solution. Empower IT by dramatically reducing the number of drivers they have to manage—and by giving them the tools they need to improve efficiency. With the HP UPD, your IT team can easily adjust device settings to help reduce printing costs, improve security, and help meet environmental goals. For example, it's simple to push two-sided printing or quicker sleep times across the fleet. Plus, the valuable tools in the HP UPD Printer Administrator's Resource Kit help you save time and money by streamlining IT tasks, implementing printing policies, and monitoring usage across the enterprise. You can also use the HP UPD in tandem with HP Web Jetadmin to create fleet-wide managed printer lists, reports, and more.

You can download this valuable fleet driver solution and the tools in the Printer Administrator's Resource Kit for no additional charge. For more information about how the HP Universal Print Driver can help you protect your imaging and printing investment, simplify management, and boost productivity, visit hp.com/go/upd.

Appendix C: Control panel features

Upgrade to a modern interface

The HP Color LaserJet Managed E60000 and MFP E62500 series are powered by HP FutureSmart 4.0 firmware. Its modern, user-friendly interface keeps things simple and intuitive across your fleet of Enterprise devices. A scalable control panel interface improves future extensibility and allows for customization, along with a robust set of new apps and usability features. You can even customize with your own wallpaper image and company logo. The new Message Center, with more detailed information and helpful animations, makes it easy to address device events. The simplified home screen displays just a few core apps by default. Additional apps are easily accessed by swiping right to left, like with a smartphone or tablet.



To access additional apps on the new printer user interface, simply swipe right to left



Edit jobs right at the MFP

The control panel on the MFP E62500 series features an enhanced image preview—now for both copies and scans. Right from the MFP's 8.0-inch (20.3 cm) color touchscreen control panel, you can easily preview and edit scans before sending them. You can apply changes (like rotating) to a single page, or to multiple pages at once. Batch separation allows users to create separate PDF or PDF/A files from scanned pages. Flow models can also create PDF OCR and PDF/A OCR files.



The new MFP user interface enables **swipe**, **rotate**, and **drag-and-drop** capabilities

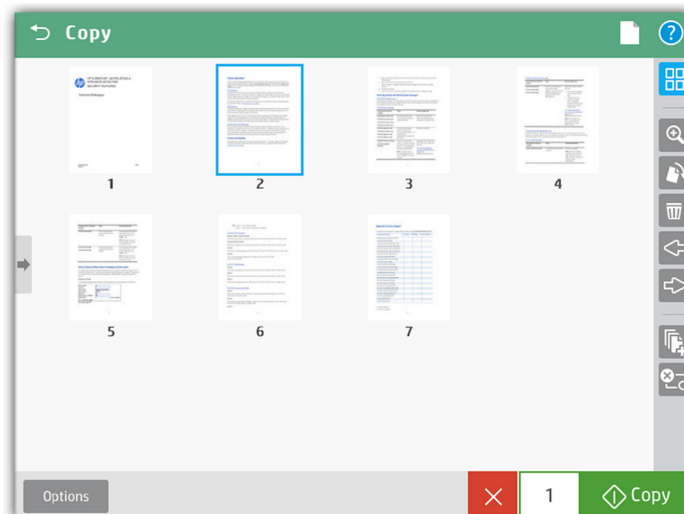

- Zoom
- Rotate pages
- Delete pages
- Change page order
- Add pages (job build)
- Cancel job

You can start a **preview** prior to committing to the copy job

Use Quick Sets to launch automated workflows

The digital sending capability on the MFP E62500 series models allows users to route documents to a variety of destinations like email recipients, network folders, fax,²⁶ FTP, a USB device, or Microsoft SharePoint.

Quick Sets automate all of the steps of a complicated workflow and provide easy access to the configurations you use most, such as page size, resolution, and file format. You can also specify security settings, such as encrypted PDFs to be delivered through encrypted and signed emails.

Help users find what they need by moving individual Quick Sets to any screen or folder using the home screen customization feature. With Quick Sets, IT can promote or block access to certain device features. Calls to the helpdesk can be reduced when users have everything they need and are restricted from accessing settings they shouldn't tamper with.

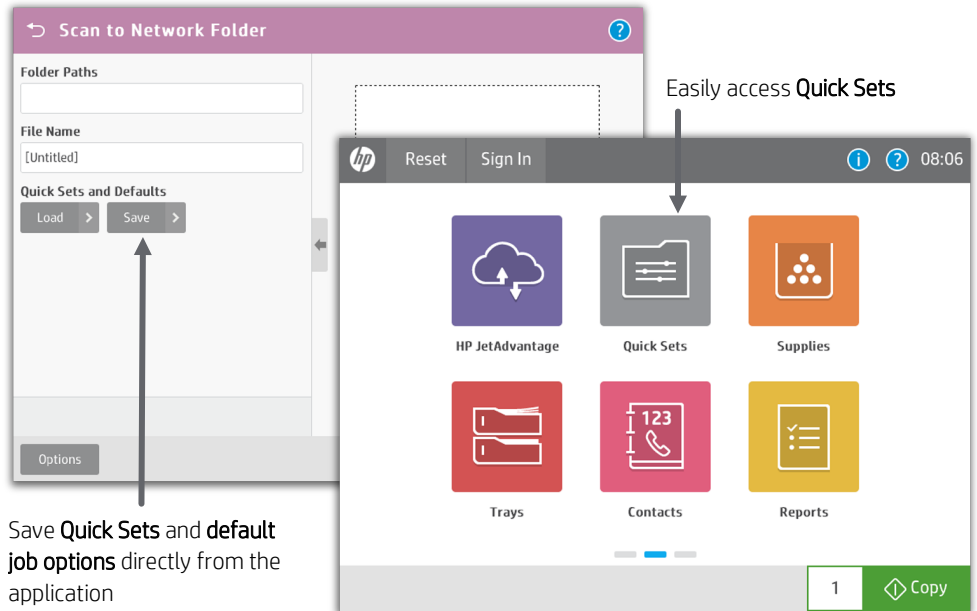

Save **Quick Sets** and **default job options** directly from the application

Troubleshoot with ease

The HP LaserJet Managed E-series can help save your IT department valuable time when it comes to troubleshooting problems. The Remote Control Panel allows users to operate the user interface remotely, so IT can troubleshoot problems without running to the printer or MFP.⁵² Users can also quickly troubleshoot technical issues with HP's innovative, cloud-based Online Help services that are relevant and up to date. Easily solve problems from your PC or mobile device. A Quick Response (QR) code on the touchscreen links to Online Help using smart phones and tablets.⁵³ You can also find these links in the HP Embedded Web Server event log.

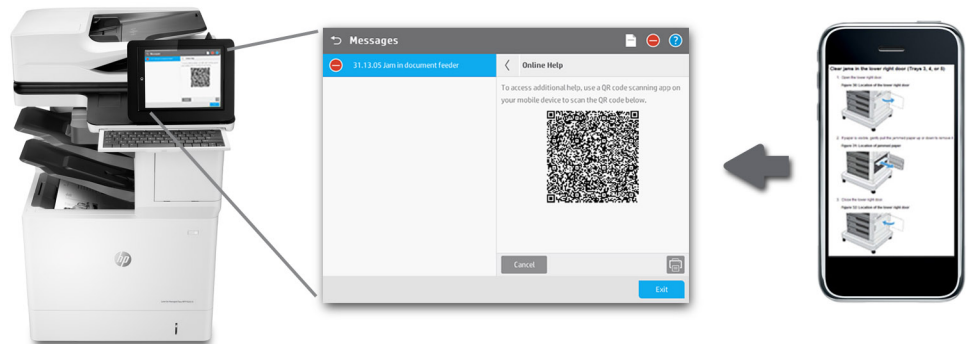

¹ Based on HP review of 2017 published security features of competitive in-class printers. Only HP offers a combination of security features that can monitor to detect and automatically stop an attack then self-validate software integrity in a reboot. For a list of compatible products, visit: hp.com/go/PrintersThatProtect. For more information, visit: hp.com/go/printersecurityclaims.

² Some features require additional purchase. A FutureSmart service pack update may be required to activate security features. Learn more at hp.com/go/printsecurity.

³ The HP High-Performance Secure Hard Disk is standard on the HP LaserJet Managed MFP E62565hs, E62565h, E62565z, E62575z models; it can be added as an optional accessory to all E60000 models and the MFP E62555dn model.

⁴ Use of the optional HP Trusted Platform Module accessory may require a firmware upgrade.

⁵ Solutions deployed through the Hardware Integration Pocket (HIP) may require additional purchase.

⁶ HP JetAdvantage Security Manager must be purchased separately. For details, see hp.com/go/securitymanager.

⁷ HP Web Jetadmin is available for download at no additional charge at hp.com/go/wja.

⁸ Based on an HP assessment of print manufacturers SaaS offerings as of September 1, 2016, no other print manufacturer offers a single cloud portal for user and app management.

⁹ Requires Internet access. Supported browsers include Microsoft Internet Explorer® 9-11, Google Chrome™ 9 and newer, Mozilla® Firefox® 4 and newer, and Safari® 5 and newer. Compatible with select HP LaserJet, PageWide, OfficeJet Pro, and Digital Sender Flow devices that can connect to the Internet. Some apps support multi-vendor environments. May require a firmware upgrade. Learn more at hp.com/go/jetadvantageondemand.

¹⁰ The HP Universal Print Driver is available for download at no additional charge at hp.com/go/upd.

¹¹ Measured using ISO/IEC 17629. Exact speed varies depending on the system configuration, software application, driver, and document complexity. Learn more at hp.com/go/printerclaims.

¹² Measured after 15 minutes in sleep. Exact speed varies depending on the system configuration, software application, driver, document complexity, and time in sleep.

¹³ Measured using ISO/IEC 24734; excludes first set of test documents. For more information, see hp.com/go/printerclaims. Exact speed varies depending on the system configuration, software application, driver, and document complexity.

¹⁴ Scan speed measured from ADF at default 300 dpi (black-and-white, grayscale, and color). Actual processing speeds may vary depending on scan resolution, network conditions, computer performance, and application software.

¹⁵ Purchase of optional paper trays required to reach maximum input capacity.

¹⁶ Standard and optional paper-handling accessories vary by model. See paper-handling accessories tables, pages 7 and 10, for details.

¹⁷ The pull-out keyboard and HP EveryPage are only available on the HP LaserJet Managed Flow MFP E62565h, Flow MFP E62565z, and Flow MFP E62575z models.

¹⁸ An administrator must enable the easy-access USB port before use.

¹⁹ Energy claim based on TEC data reported on energystar.gov as of January 2017. Data normalized to determine energy efficiency of in-class laser printers with published speed of 55 to 75 ppm (letter). Subject to device settings. Actual results may vary.

²⁰ HP Auto-On/Auto-Off Technology capabilities are subject to printer and settings.

²¹ Compared with products that use traditional fusing.

²² Based on ISO/IEC 19752 cartridge yields for HP 90X High Yield Black Original LaserJet Toner cartridges (CE390XC) compared with HP Black Managed LaserJet Toner cartridges (W9004MC). Learn more at hp.com/go/learnaboutsplies.

²³ HP Black Managed LaserJet Toner cartridges are not included in printer purchase; purchase separately. Learn more at hp.com/go/learnaboutsplies.

²⁴ Stated yield is based on 5% coverage and may vary based on coverage and media type used, media size, short edge feed on A3 devices, and job size.

²⁵ All models of the HP LaserJet Managed E62500 series include a 150-sheet ADF. The ADF can scan media sizes from checks (2.7 x 5.8 in) to banners (8.5 x 34 in).

²⁶ Fax capability is optional on the HP LaserJet Managed Flow MFP E62555dn model and is not available on the HP LaserJet Managed E60000 series.

²⁷ The Recommended Monthly Scan Volume (RMSV) is up to 44,500 for the Flow M631h, Flow M632z, and Flow M633z models and up to 23,750 pages for all other models. HP recommends that the number of scanned pages per month be within the stated range for optimum device performance, based on factors including supplies replacement intervals and device life over an extended warranty period.

²⁸ The HP LaserJet Managed E60055dn, E60065dn, and E60075dn models come standard with a 100-sheet multipurpose tray 1 and 550-sheet tray 2. You may add up to four additional optional 550-sheet Paper Feeders (LOH17A), or add the optional 2,100-sheet Paper Feeder (LOH18A) and one additional optional 550-sheet Paper Feeder (LOH17A) to the dn models. The HP LaserJet Managed E60065x and E60075x models come standard with a 100-sheet multipurpose tray 1 and two 550-sheet paper trays. You may add up to three additional optional 550-sheet Paper Feeders (LOH17A), or add the 2,100-sheet Paper Feeder (LOH18A) to the x models. All optional accessories support media sizes up to letter (A4).

²⁹ Add wireless direct by selecting the optional HP Jetdirect 3000w NFC/Wireless Direct Accessory. If selected, you cannot also select the HP Jetdirect 2900nw Print Server (J8031A). Mobile device needs to be connected directly to the signal of a wireless direct supported MFP or printer prior to printing. Depending on mobile device, an app or driver may also be required. For details, see hp.com/go/mobileprinting.

³⁰ Touch-to-print capability is optional for all models and can be added by selecting the optional HP Jetdirect 3000w NFC/Wireless Direct Accessory (J8030A). If selected, you cannot also select the HP Jetdirect 2900nw Print Server (J8031A). Mobile device must support Near Field Communication (NFC)-enabled printing. For more information, see hp.com/go/businessmobileprinting.

³¹ All models can add wireless networking with selection of the optional HP Jetdirect 2900nw Print Server (J8031A). If selected, you cannot also select the HP Jetdirect 3000w NFC/Wireless Accessory (J8030A). Wireless performance is dependent on physical environment and distance from access point, and may be limited during active VPN connections.

³² The E60000 series may add a maximum of two Envelope Feeders (LOH21A). A combination of 550-sheet Paper Feeders and Envelope Feeders cannot exceed a total number of four for the dn models (MOP33A, MOP35A, MOP39A) or three for the x models (MOP36A, MOP40A).

³³ For U.S. models, configuration does not meet ADA height requirements if more than 3 stackable accessories are added to the base model or a stackable accessory is added to a 2,100-sheet Paper Feeder.

³⁴ The HP LaserJet Managed E62500 series models come standard with a 100-sheet multipurpose tray 1 and 550-sheet tray 2. Add up to four additional optional 550-sheet Paper Feeders (J8J89A), or add one of these optional accessories: 1x550-sheet Paper Feeder with Stand (J8J91A), 3x550-sheet Paper Feeder and Stand (J8J93A), or 1x550/2,000-sheet HCl feeder and Stand (J8J92A). Add up to one additional optional 550-sheet Paper Feeder (J8J89A) or one Envelope Feeder (J8J90A) to any of the feeder/stand accessories (J8J91A, J8J92A, J8J93A). All optional accessories support media up to 8.5 x 14 in.

³⁵ The E62500 series may add a maximum of two Envelope Feeders (J8J90A). A combination of 550-sheet Paper Feeders (J8J89A) and Envelope Feeders (J8J90A) cannot exceed a total number of four.

³⁶ If you select the HP LaserJet 1x550-sheet Paper Feeder and Stand (J8J91A), you cannot select another feeder/stand accessory (J8J92A or J8J93A). You may add one additional 550-sheet Paper Feeder (J8J89A) or one Envelope Feeder (J8J90A).

³⁷ If you select the HP LaserJet 3x550-sheet Feeder and Stand (J8J93A), you cannot select another feeder/stand accessory (J8J91A or J8J92A). You may add one additional 550-sheet Paper Feeder (J8J89A) or one Envelope Feeder (J8J90A).

³⁸ If you select the HP LaserJet 1x550/2,000-sheet HCl Feeder and Stand (J8J92A), you cannot select another feeder/stand accessory (J8J91A or J8J93A). You may add one additional 550-sheet Paper Feeder (J8J89A) or one Envelope Feeder (J8J90A).

³⁹ HP recommends that the number of printed pages per month be within the stated range for optimum device performance, based on factors including supplies replacement intervals and device life over an extended warranty period.

⁴⁰ Duty cycle is defined as the maximum number of pages per month of imaged output. This value provides a comparison of product robustness in relation to other HP LaserJet or HP Color LaserJet devices, and enables appropriate deployment of printers and MFPs to satisfy the demands of connected individuals or groups.

⁴¹ Printer requires ePrint account registration. App or software may be required. Wireless operations are compatible with 2.4 GHz operations only. Learn more at hp.com/go/mobileprinting.

⁴² Supports the following devices running iOS 4.2 or later: iPad®, iPad 2, iPhone® (3GS or later), iPod touch® (3rd generation or later). Works with HP's AirPrint-enabled printers and requires the printer be connected to the same network as your iOS device. Wireless performance is dependent on physical environment and distance from the access point.

⁴³ Full solution software available only for Windows 7 and newer, UPD software available only for Windows 7 and newer, HP Software for Mac and Windows is no longer included on the CD, but can be downloaded from 123.hp.com. Legacy Windows Operating Systems (XP, Vista, and equivalent servers) get print and Scan drivers only with a reduced feature set, Windows RT OS for Tablets (32- and 64-bit) uses a simplified HP print driver built into the RT OS.

⁴⁴ Maximum dimensions of the device are measured with all paper trays folded out and standard accessories installed.

⁴⁵ Acoustic values are subject to change. Printing value measured while printing mono, simplex A4 at 53 ppm (E60055dn), simplex A4 at 62 ppm (E60065 series), simplex A4 at 71 ppm (E60075 series), printing mono simplex A4 at 53 ppm (MFP E62555 series), printing mono simplex A4 at 62 ppm (MFP E62565 series), printing mono simplex A4 at 71 ppm (MFP E6575 series), and ADF scan mono simplex A4 at 95 ipm (all MFP series). For current information, see hp.com/support.

⁴⁶ Power requirements are based on the country/region where the scanner is sold. Do not convert operating voltages. This will damage the device and void the product warranty.

⁴⁷ EPEAT® registered where applicable. EPEAT registration varies by country. See epeat.net for registration status by country.

⁴⁸ Scan software not included in box. HP Scan and TWAIN driver available for download at hp.com/support.

⁴⁹ Based on standard ITU-T test image #1 at standard resolution and MMR encoding, the HP fax device can transmit at 3 sec/page for V.34 and 6 sec/page for V.17.

⁵⁰ HP JetAdvantage Secure Print works with any network-connected printer or MFP. On-device authentication is available for many HP LaserJet, LaserJet, and OfficeJet Pro devices and selected non-HP devices. Some devices may require a firmware upgrade. Internet connection required for cloud storage and retrieval of print jobs. Print-job release from a mobile device requires a network connection and QR code. For more information and a list of supported printers and MFPs, see hp.com/go/JetAdvantageSecurePrint.

⁵¹ HP JetAdvantage Private Print is available at no charge and requires that the printer be connected to the Internet with web services enabled. Not available in all countries. Learn more at hp.com/go/JetAdvantagePrivatePrint.

⁵² Availability dependent on firmware or software updates or upgrades.

⁵³ Online Help must be enabled on the printer or MFP. Mobile device must have an Internet connection to access online services.

