

Armitage Venesta Washroom Systems Specification

Pre-Plumbed Panel Lining System: IPS Evolve

Panels & Flashgaps
Panel Edges

Panel Heights:

Top: (To suit ceiling height t.b.c on site.)

Middle: 670mm

Bottom: 430mm

Cubicle System: Radius Tufwall

Partitions & Pilasters

Doors

Panel Edges

Radiused Headrails, Pedestals, Wall Cleats, Indicator

Bolts & Hinges (Light Grey Coated Aluminium)

Overall Height of Cubicles = 1950mm

(includes Headrail & 150mm Floor Clearance)

Sanitary ware:

- A1: Armitage Shanks Portman 50cm wall hung washbasin
- A2: Armitage Shanks 50cm wall hung urinal with urinal dividers
- A3: Armitage Shanks Contour back to wall WC pan
- A4: Armitage Shanks right handed 'Doc M' plus pack
- A5: Starlite concealed thermostatic shower valve with regulators, 230mm concealed inlet angled shower arm and Triton swivel mounted shower head

This drawing is copyright of PENTARQ and may not be reproduced without permission.

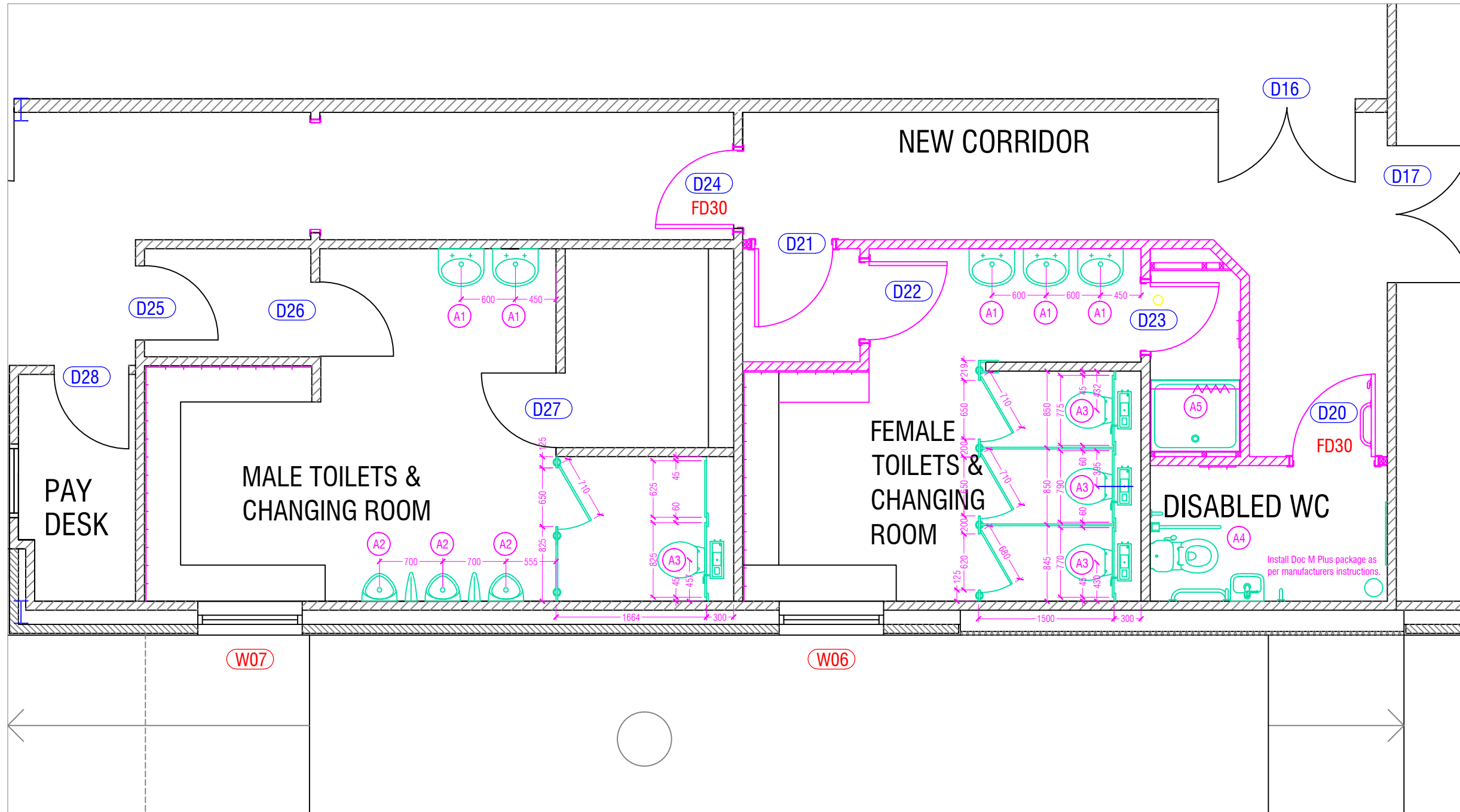

CONSTRUCTION ISSUE
18/03/11 TENDER ISSUE

Client: St Andrews Community Association	
Project: Alterations & Extensions to the St Andrews Community Centre	
Drawing: Cubicle & Sanitaryware Setting-Out	
Scale: 1:50	A3
Drawn: Oct 2010	Checked:

PENTARQ
www.pentarq.co.uk

33 Albert Street, KIRKWALL
Orkney, KW15 1HL
T: 01856 872022 F: 01856 874381 E: kirkwall@pentarq.co.uk

41 Trail Street, THURSO
Caithness, KW14 8EG
T: 01847 893212 F: 01847 894494 E: thurso@pentarq.co.uk

Ref: 5409	No: A	No: 013	Amd:
--------------	----------	------------	------