

## Conduit Caps

Conduit cap and insulating bushing.



EMT50C



EMT75C

CATALOG NUMBER	UPC/DCI/NAED MFG #018997	TRADE SIZE	UNIT PKG	STD PKG	DIM A	DIM B
EMT50C	12203	1/2	100	100	.531	.840
EMT75C	12204	3/4	100	100	.531	1.056
EMT100C	12207	1	100	100	.625	1.280
EMT125C	12209	1-1/4	100	100	.625	1.660
EMT150C	12211	1-1/2	100	100	.625	1.915
EMT200C	12213	2	50	50	.625	2.377
EMT250C*	12215	2-1/2	25	25	1.225	3.062
EMT300C*	12217	3	25	25	1.225	3.690
EMT350C*	12219	3-1/2	25	25	1.231	4.187
EMT400C*	12221	4	25	25	1.233	4.815

Refer to page I-1 for Rigid Insulating Bushings size 1/2" through 4".

\*Can also be used for rigid, IMC, and PVC rigid conduit.

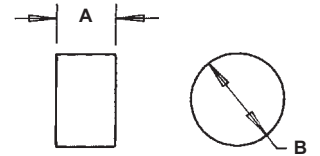

Use this capped version to seal off conduit during concrete pours. Then remove cap/seal with razor knife or use screwdriver to punch hole in cap. (EMT300C)

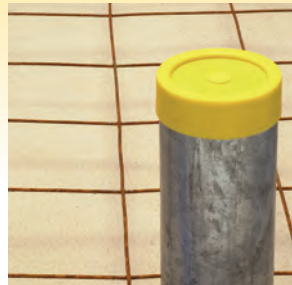

String can be used to aid removal.

## Zinc Combination Couplings

### EMT to Rigid

EMT compression to screw-in rigid metal conduit.

Zinc die-cast.



2400

CATALOG NUMBER	UPC/DCI/NAED MFG #018997	TRADE SIZE	UNIT PKG	STD PKG	DIM A	DIM B	DIM C
2400	06920	1/2"	50	50	1.000	1.267	.946
2410	06921	3/4"	50	50	1.000	1.412	1.200
2411	06922	3/4"	50	50	1.210	1.475	1.200

Use with any listed fitting.

