

# WATER DELIVERIES BY WATERMASTER

## WATER SHORTAGES

Contact Watermaster to regulate diversions.

## WATERMASTER

Delivers on priority basis, oldest right 100%, then next right 100% and so on until all water delivered.

## BENEFICIAL USE

Must occur for water to delivered.

## FUTILE CALL

Junior water called for by senior right must reach senior diversion point and then senior place of use or cannot be delivered.

## TRIBUTARIES

Not regulated unless problem identified.

**NOTE:** in 57-B, all five creeks are covered as main sources so can be regulated by Watermaster. Example of a tributary source in this water district would be Little Hart Creek, not expected to be regulated unless problem occurs. IDWR will assist Watermaster in handling tributary issues.

The five source creeks are Bates, Browns, Catherine, Hart, and Pickett.

## GUIDELINES

See handout "Water District Guidelines Established By IDWR" for more details about how a water district should work.

\*MOPD: Y = Multiple Pts of Diversion, Pod Diversion Rates(s) is 0  
 U = Multiple Pts of Diversion, Pod Diversion Rates(s) Not 0  
 N = No Multiple Pts of Diversion (only 1)  
 from old Decree plus licenses & permits

| WATER RIGHT NUMBER | OWNER NAME    | PRIORITY | DATE       | POINT OF DIVERSION | TOTAL DIVERSION | POD DIVERSION NAME | STATUS |
|--------------------|---------------|----------|------------|--------------------|-----------------|--------------------|--------|
| 57-00047           | LINEHAN, NORA | C        | 04/01/1876 | D 04S 01W 29       | 1.364           |                    | N 01   |
| 57-02004           | LINEHAN, NORA | C        | 03/15/1905 | L 04S 01W 29       | 0.800           |                    | N 01   |
| 57-00077           | LINEHAN, NORA | C        | 04/01/1907 | D                  | 1.740           |                    | N 01   |

WATER SOURCE: BROWN CREEK

|           |                     |   |            |              |       |  |      |
|-----------|---------------------|---|------------|--------------|-------|--|------|
| 57-00055  | BROWN, G. F.        | C | 03/16/1885 | D 05S 01W 24 | 3.360 |  | N 01 |
| 57-00072B | CAROTHERS, JAMES F. | C | 10/01/1901 | D 05S 01W 27 | 0.500 |  | N 01 |
| 57-00072A | CAROTHERS, JAMES    | C | 10/01/1901 | D 05S 01W 24 | 0.400 |  | N 01 |
| 57-00074A | CAROTHERS, J. F.    | C | 04/01/1904 | D 05S 01W 24 | 0.800 |  | N 01 |
| 57-00074B | CAROTHERS, JAMES F. | C | 04/01/1904 | D 05S 01W 27 | 1.071 |  | N 01 |
| 57-00079  | KOEPPE, WILLIAM     | C | 03/11/1908 | D 05S 01W 24 | 1.840 |  | N 01 |
| 57-00081  | KOEPPE, WILLIAM     | C | 07/19/1908 | D 04S 01E 31 | 1.000 |  | N 01 |

WATER SOURCE: CATHERINE CREEK

|           |                    |   |            |              |        |  |      |
|-----------|--------------------|---|------------|--------------|--------|--|------|
| 57-00039  | NEIL, J. M.        | C | 04/01/1868 | D            | 3.180  |  | N 01 |
| 57-00040A | HUNT, CORA MAUDE   | C | 10/01/1869 | D 04S 01E 29 | 2.880  |  | N 01 |
| 57-00040B | NEIL, J. M.        | C | 10/01/1869 | D            | 5.160  |  | N 01 |
| 57-00049  | NEIL, J. M.        | C | 01/14/1879 | D            | 6.360  |  | N 01 |
| 57-00050  | NEIL, J. M.        | C | 04/05/1879 | D            | 4.200  |  | N 01 |
| 57-00054  | NEIL, J. M.        | C | 01/08/1884 | D            | 0.480  |  | N 01 |
| 57-00058  | HYDE, B. H.        | C | 04/01/1885 | D            | 0.700  |  | N 01 |
| 57-00069  | NEIL, J. M.        | C | 04/01/1896 | D            | 2.580  |  | N 01 |
| 57-00070  | NEIL, J. M.        | C | 04/01/1897 | D            | 3.060  |  | N 01 |
| 57-02010  | DAVIES, HERBERT H. | C | 12/02/1907 | L 04S 01E 27 | 0.900  |  | N 01 |
| 57-00078  | HENDERSON, THOMAS  | C | 05/22/1908 | D 04S 01E 26 | 0.320  |  | N 01 |
| 57-00080  | HENDERSON, THOMAS  | C | 05/22/1908 | D 04S 01E 26 | 0.380  |  | N 01 |
| 57-02259  | COX, WILLIAM E.    | C | 01/09/1963 | L 04S 01E 23 | 10.400 |  | Y 01 |
| 57-02259  | COX, WILLIAM E.    | C | 01/09/1963 | L 04S 01E 26 | 10.400 |  | Y 01 |
| 57-02259  | COX, WILLIAM E.    | C | 01/09/1963 | L 04S 01E 26 | 10.400 |  | Y 01 |

\* WATER SOURCE: GROUNDWATER

|          |                    |   |            |              |       |  |      |
|----------|--------------------|---|------------|--------------|-------|--|------|
| 57-07564 | MURDOCH, DENNIS    | C | 09/01/1992 | P 04S 01E 24 | 3.370 |  | Y 01 |
| 57-07564 | MURDOCH, DENNIS    | C | 09/01/1992 | P 04S 01E 26 | 3.370 |  | Y 01 |
| 57-07564 | MURDOCH, DENNIS    | C | 09/01/1992 | P 04S 01E 24 | 3.370 |  | Y 01 |
| 57-07585 | JONES, JOHN W      | C | 02/23/1993 | P 04S 01E 30 | 0.400 |  | Y 01 |
| 57-07582 | JOHNSTON, J SHERAL | C | 12/22/1993 | P 04S 01W 24 | 0.200 |  | N 01 |

\* ground water (wells) ~ unlikely to be regulated by watermaster

# DELIVERABLE WATER RIGHTS

\*MPOD: Y = Multiple Pts of Diversion, Pod Diversion Rates) is 0  
 U = Multiple Pts of Diversion, Pod Diversion Rates) Not 0  
 N = No Multiple Pts of Diversion (1 or less)

*Recommended  
 in SRBA  
 - Not yet decreed -*

| WATER RIGHT NUMBER | CURRENT OWNER NAME | PRIORITY DATE | S T G | POINT OF DIVERSION | F L G | TOTAL DIVERSION | POD DIVERSION NAME | M P O S D E |
|--------------------|--------------------|---------------|-------|--------------------|-------|-----------------|--------------------|-------------|
|--------------------|--------------------|---------------|-------|--------------------|-------|-----------------|--------------------|-------------|

WATER SOURCE: BATES CREEK

|          |                     |            |   |            |      |           |  |      |
|----------|---------------------|------------|---|------------|------|-----------|--|------|
| 57-00047 | PARKINSON, JOSEPH L | 04/01/1876 | D | 04S 01W 29 | NWSM | 1.050 CFS |  | N 01 |
| 57-00077 | PARKINSON, JOSEPH L | 04/01/1907 | D | 04S 01W 29 | NWSM | 0.700 CFS |  | N 01 |

WATER SOURCE: BROWNS CREEK

|          |              |            |   |            |       |           |  |      |
|----------|--------------|------------|---|------------|-------|-----------|--|------|
| 57-00055 | COX, SHIRLEY | 03/16/1885 | D | 05S 01W 24 | NEWNE | 3.360 CFS |  | N 01 |
| 57-00072 | COX, SHIRLEY | 10/01/1901 | D | 05S 01W 24 | NEWNE | 0.900 CFS |  | N 01 |
| 57-00074 | COX, SHIRLEY | 04/01/1904 | D | 05S 01W 24 | NEWNE | 1.870 CFS |  | N 01 |
| 57-00079 | COX, SHIRLEY | 03/11/1908 | D | 05S 01W 24 | NEWNE | 1.840 CFS |  | N 01 |
| 57-00081 | COX, SHIRLEY | 07/19/1908 | D | 05S 01W 24 | NEWNE | 0.810 CFS |  | N 01 |

WATER SOURCE: CATHERINE CREEK

|          |                 |            |   |            |        |           |  |      |
|----------|-----------------|------------|---|------------|--------|-----------|--|------|
| 57-00039 | WHITE, WILLIAM  | 04/01/1868 | D | 04S 01E 30 | NWWSM  | 0.610 CFS |  | N 01 |
| 57-00078 | MURDOCH, DENNIS | 05/22/1907 | D | 04S 01E 26 | NESENU | 0.320 CFS |  | N 01 |
| 57-00080 | MURDOCH, DENNIS | 05/22/1908 | D | 04S 01E 26 | NESENU | 0.380 CFS |  | Y 01 |
| 57-02259 | MURDOCH, DENNIS | 01/09/1963 | L | 04S 01E 23 | SWNESE | 0.780 CFS |  | Y 01 |
| 57-02259 | MURDOCH, DENNIS | 01/09/1963 | L | 04S 01E 26 | NESENU | 0.780 CFS |  | Y 01 |

WATER SOURCE: HART CREEK

|          |                     |            |   |            |        |           |  |      |
|----------|---------------------|------------|---|------------|--------|-----------|--|------|
| 57-00038 | WHITE, BEVERLY      | 04/01/1866 | D | 04S 01W 35 | NENENE | 2.840 CFS |  | N 01 |
| 57-00059 | COX, SHIRLEY        | 03/01/1886 | D | 05S 01W 5  | NESESE | 0.290 CFS |  | N 01 |
| 57-00071 | BACHMAN, HELEN JOAN | 04/01/1901 | D | 05S 01W 19 | SENWNU | 0.850 CFS |  | N 01 |
| 57-00073 | JESS, GEORGE W      | 04/01/1902 | D | 05S 01W 4  | SWMENE | 0.260 CFS |  | N 01 |
| 57-00075 | COX, SHIRLEY        | 04/01/1905 | D | 05S 02W 24 | NESSW  | 0.320 CFS |  | N 01 |
| 57-02199 | GIUSTI, ELVA MARIE  | 04/20/1951 | L | 04S 01W 35 | NEENE  | 1.000 CFS |  | N 01 |

WATER SOURCE: PICKETT CREEK

|           |                     |            |   |            |        |           |  |      |
|-----------|---------------------|------------|---|------------|--------|-----------|--|------|
| 57-00046A | PARKINSON, JOSEPH L | 03/31/1868 | D | 04S 01W 28 | SENU   | 0.540 CFS |  | Y 01 |
| 57-00046A | PARKINSON, JOSEPH L | 03/31/1868 | D | 04S 01W 21 | SESE   | 0.540 CFS |  | Y 01 |
| 57-00047B | WHITE, WILLIAM      | 02/14/1870 | D | 04S 01W 24 | SESESW | 0.540 CFS |  | N 01 |
| 57-00047A | JONES, JOHN WILLIAM | 02/14/1870 | D | 04S 01W 24 | NESESW | 0.400 CFS |  | N 01 |
| 57-00046B | PARKINSON, JOSEPH L | 08/28/1875 | D | 04S 01W 28 | SENU   | 0.700 CFS |  | Y 01 |
| 57-00046B | PARKINSON, JOSEPH L | 08/28/1875 | D | 04S 01W 21 | SESE   | 0.700 CFS |  | Y 01 |
| 57-00051  | PARKINSON, JOSEPH L | 04/01/1880 | D | 04S 01W 31 | NESE   | 1.520 CFS |  | N 01 |
| 57-00053  | STAHL, ELMER        | 04/01/1882 | D | 04S 01W 25 | NEWNE  | 1.390 CFS |  | Y 01 |
| 57-00053  | STAHL, ELMER        | 04/01/1882 | D | 04S 01W 24 | SESESW | 1.390 CFS |  | Y 01 |

*RECOMMENDED RIGHTS SRBA - DO NOT  
 USE TO DELIVER - FOR INFO.  
 USE ONLY*

- Missile Base Rd. 73N 39E
- Mormon Blvd. 60N 55E
- Mn. Rd. S. 52N 5E
- Mud Flat Rd. 55N 38E
- Mud Flat Rd. 70N 43E
- Murphy Flat Rd. 81N 27E
- Murphy-Grandview Rd. 74N 32E
- Murray's Ln. 113N 3E
- Old Dump Rd. 111N 3E
- Opalene Rd. 101N 11E
- Oreana Rd. 73N 32E

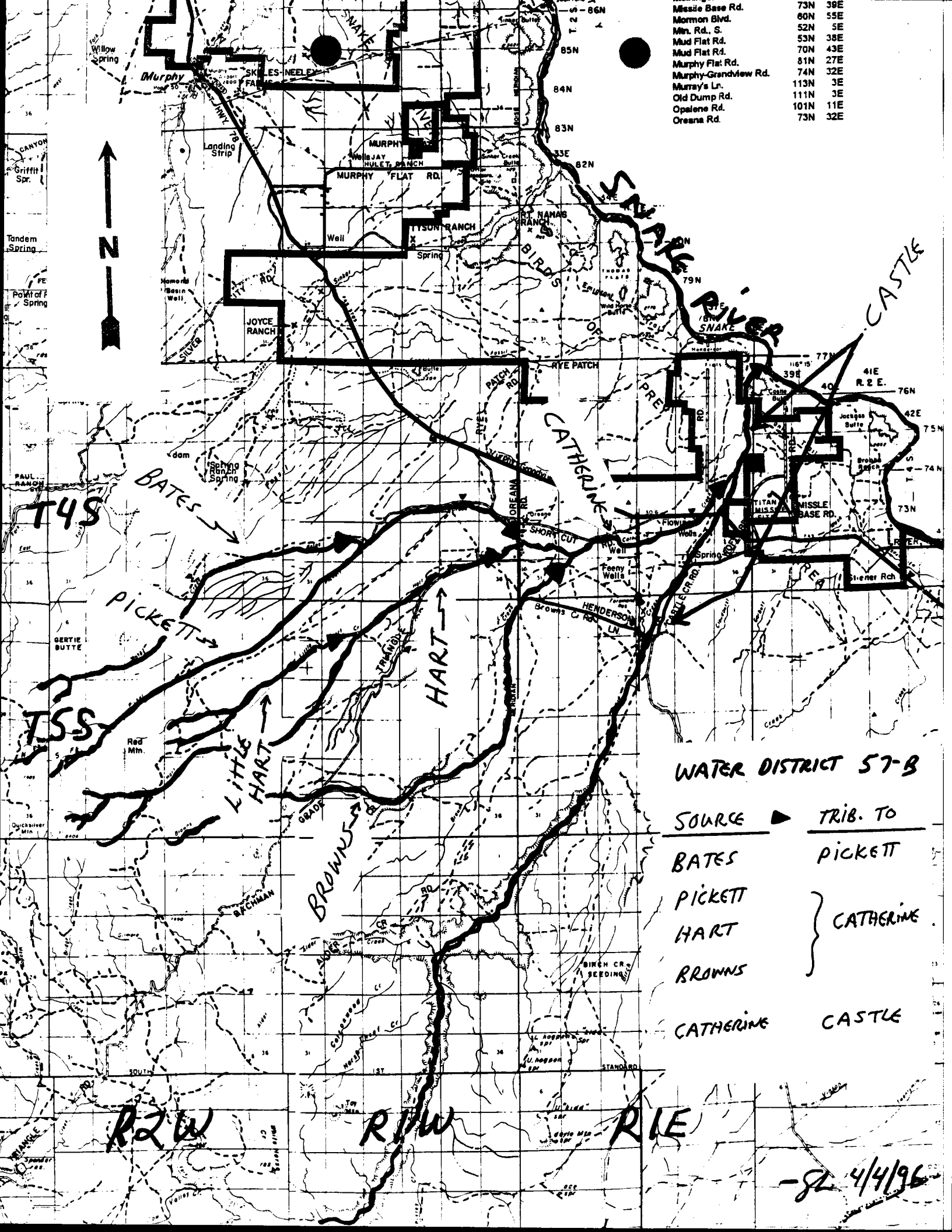

**WATER DISTRICT 57-B**

| SOURCE    | TRIB. TO  |
|-----------|-----------|
| BATES     | PICKETT   |
| PICKETT   | CATHERINE |
| HART      |           |
| BROWNS    |           |
| CATHERINE | CASTLE    |

R2W

R1W

R1E

-82 4/4/96

\*MPOD: Y = Multiple Pts of Diversion, Pod Diversion Rate(s) Is 0  
 U = Multiple Pts of Diversion, Pod Diversion Rate(s) Not 0  
 N = No Multiple Pts of Diversion (1 or less)

| WATER RIGHT NUMBER | CURRENT OWNER NAME   | PRIORITY DATE | T | G   | POINT OF DIVERSION | F       | L | TOTAL DIVERSION | POD DIVERSION NAME | M | P  | O | S | U | D | E |
|--------------------|----------------------|---------------|---|-----|--------------------|---------|---|-----------------|--------------------|---|----|---|---|---|---|---|
| 57-00060           | WHITE, WILLIAM       | 04/01/1886    | D | 04S | 01W 24             | SESESW  |   | 3.350 CFS       |                    | N | 01 |   |   |   |   |   |
| 57-00063           | PARKINSON, JOSEPH L  | 04/15/1886    | D | 04S | 01W 22             | SENESSW |   | 2.190 CFS       |                    | N | 01 |   |   |   |   |   |
| 57-00063           | PARKINSON, JOSEPH L  | 04/15/1886    | D | 04S | 01W 22             | SENESSW |   | 2.190 CFS       |                    | Y | 01 |   |   |   |   |   |
| 57-00064           | ROBINSON, MERVILLE A | 05/01/1886    | D | 04S | 01W 23             | NENESSW |   | 0.940 CFS       |                    | Y | 01 |   |   |   |   |   |
| 57-00067           | ROBINSON, MERVILLE A | 03/01/1889    | D | 04S | 01W 23             | NESESE  |   | 0.420 CFS       |                    | N | 01 |   |   |   |   |   |