

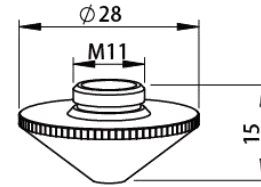
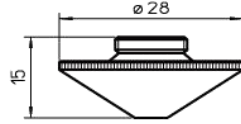

**Precitec Laser Consumables**

**Nozzle**

	Centricut P/N	Raysoar P/N	OEM Ref.No.	Description	Pkg qty
1	PT345-0008X	LPTN01-5908		PT-Nozzle HD,0.8 mm	10
2	PT345-0008			PT-Nozzle HD,0.8 mm	1
3	PT345-1548		P0591-571-00010	PT-Nozzle HD,1.0 mm	1
4	PT345-1548X	LPTN01-5910	P0591-571-00010	PT-Nozzle HD,1.0 mm	10
5	PT345-1549		P0591-572-00012	PT-Nozzle HD,1.2 mm	1
6	PT345-1549X	LPTN01-5912	P0591-572-00012	PT-Nozzle HD,1.2 mm	10
7	PT345-1555X	LPTN01-5914		PT-Nozzle HD,1.4 mm	10
8	PT345-1463		P0591-573-00015	PT-Nozzle HD,1.5 mm	1
9	PT345-1463X	LPTN01-5915	P0591-573-00015	PT-Nozzle HD,1.5 mm	10
10	PT345-0001		P0591-574-00018	PT-Nozzle HD,1.8 mm	1
11	PT345-0001X	LPTN01-5918	P0591-574-00018	PT-Nozzle HD,1.8 mm	10
12	PT345-1550		P0591-575-00020	PT-Nozzle HD,2.0 mm	1
13	PT345-1550X	LPTN01-5920	P0591-575-00020	PT-Nozzle HD,2.0 mm	10
14	PT345-0003			PT-Nozzle HD,2.3 mm	1
15	PT345-0003X	LPTN01-5923		PT-Nozzle HD,2.3 mm	10
16	PT345-1551		P0591-576-00025	PT-Nozzle HD,2.5 mm	1
17	PT345-1551X	LPTN01-5925	P0591-576-00025	PT-Nozzle HD,2.5 mm	10
18	PT345-1552			PT-Nozzle HD,2.75 mm	1
19	PT345-1552X			PT-Nozzle HD,2.75 mm	10
20	PT345-0002			PT-Nozzle HD,3.0 mm	1
21	PT345-0002X	LPTN01-5930		PT-Nozzle HD,3.0 mm	10
22	PT345-0005			PT-Nozzle HD,3.2 mm	1
23	PT345-0005X			PT-Nozzle HD,3.2 mm	10
24	PT345-0006			PT-Nozzle HD,3.5 mm	1
25	PT345-0006X	LPTN01-5935		PT-Nozzle HD,3.5 mm	10
26	PT345-0004			PT-Nozzle HD,4.0 mm	1
27	PT345-0004X	LPTN01-5940		PT-Nozzle HD,4.0 mm	10
28	PT345-0007			PT-Nozzle HD,4.5 mm	1
29	PT345-0007X	LPTN01-5945		PT-Nozzle HD,4.5 mm	10

	Centricut P/N	Raysoar P/N	OEM Ref.No.	Description	Pkg qty
30	PT345-0830	LPTN01-5950		PT-Nozzle HD,5.0 mm	1
31		LPTN01-5960		PT-Nozzle HD,6.0 mm	10
32	PT345-1547CPX	LPTN01-5908CP		PT-Nozzle HD,0.8 mm CP	10
33	PT345-1548CP			PT-Nozzle HD,1.0 mm CP	1
34	PT345-1548CPX	LPTN01-5910CP	P0591-571-00010	PT-Nozzle HD,1.0 mm CP	10
35	PT345-1549CPX	LPTN01-5912CP	P0591-572-00012	PT-Nozzle HD,1.2 mm CP	10
36	PT345-1555CPX			PT-Nozzle HD,1.4 mm CP	10
37	PT345-1463CP		P0591-573-00015	PT-Nozzle HD,1.5 mm CP	1
38	PT345-1463CPX	LPTN01-5915CP	P0591-573-00015	PT-Nozzle HD,1.5 mm CP	10
39	PT345-0001CPX	LPTN01-5918CP	P0591-574-00018	PT-Nozzle HD,1.8 mm CP	10
40	PT345-1550CP		P0591-575-00020	PT-Nozzle HD,2.0 mm CP	1
41	PT345-1550CPX	LPTN01-5920CP	P0591-575-00020	PT-Nozzle HD,2.0 mm CP	10
42	PT345-0003CPX	LPTN01-5923CP		PT-Nozzle HD,2.3 mm CP	10
43	PT345-1551CP		P0591-576-00025	PT-Nozzle HD,2.5 mm CP	1
44	PT345-1551CPX	LPTN01-5925CP	P0591-576-00025	PT-Nozzle HD,2.5 mm CP	10
45	PT345-0002CP			PT-Nozzle HD,3.0 mm CP	1
46	PT345-0002CPX	LPTN01-5930CP		PT-Nozzle HD,3.0 mm CP	10
47	PT345-0006CP	LPTN01-5935CP		PT-Nozzle HD,3.5 mm CP	10
48	PT345-0004CP			PT-Nozzle HD,4.0 mm CP	1
49	PT345-0004CPX	LPTN01-5940CP		PT-Nozzle HD,4.0 mm CP	10
50	PT345-0007CPX	LPTN01-5945CP		PT-Nozzle HD,4.5 mm CP	10
51	PT345-0830CP	LPTN01-5950CP		PT-Nozzle HD,5.0 mm CP	1

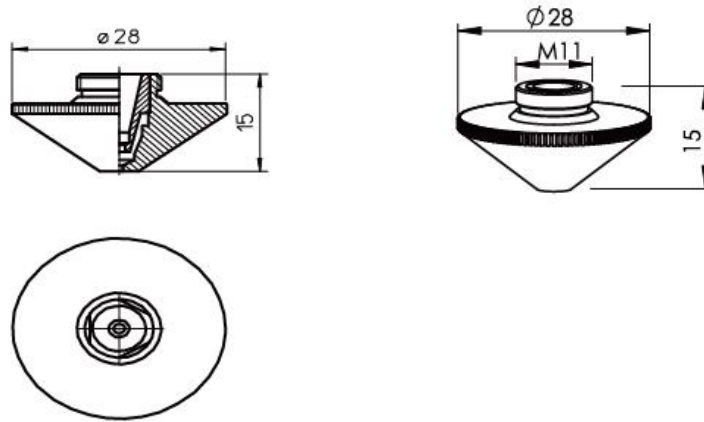

	Centricut P/N	Raysoar P/N	OEM Ref.No.	Description	Pkg qty
1	PT358-0669	LPTN02-5908		PT-Nozzle double,0.8 mm/inner 1.5 mm	1
2	PT358-0691X			PT-Nozzle double,0.9 mm/inner 1.5 mm	10
3	PT358-0010			PT-Nozzle double,1.0 mm/inner 1.5 mm	1
4	PT358-0010X	LPTN02-5910		PT-Nozzle double,1.0 mm/inner 1.5 mm	10
5	PT358-0125			PT-Nozzle double,1.2 mm/inner 1.5 mm	1
6	PT358-0125X	LPTN02-5912	P0591-002-00012	PT-Nozzle double,1.2 mm/inner 1.5 mm	10
7		LPTN02-59125		PT-Nozzle double,1.25 mm/inner 1.5 mm	10
8	PT358-0124X	LPTN02-5914		PT-Nozzle double,1.4 mm/inner 1.5 mm	10
9	PT358-0015			PT-Nozzle double,1.5 mm/inner 1.5 mm	1
10	PT358-0015X	LPTN02-5915	P0591-002-00015	PT-Nozzle double,1.5 mm/inner 1.5 mm	10
11	PT358-0018			PT-Nozzle double,1.8 mm/inner 1.5 mm	1
12	PT358-0018X	LPTN02-5918	P0591-002-00018	PT-Nozzle double,1.8 mm/inner 1.5 mm	10
13	PT358-0020			PT-Nozzle double,2.0 mm/inner 1.5 mm	1
14	PT358-0020X	LPTN02-5920	P0591-002-00020	PT-Nozzle double,2.0 mm/inner 1.5 mm	10
15	PT358-0023			PT-Nozzle double,2.3 mm/inner 1.5 mm	1
16	PT358-0023X	LPTN02-5923		PT-Nozzle double,2.3 mm/inner 1.5 mm	10
17	PT358-0007			PT-Nozzle double,2.5 mm/inner 1.5 mm	1
18	PT358-0007X	LPTN02-5925		PT-Nozzle double,2.5 mm/inner 1.5 mm	10
19	PT358-0030			PT-Nozzle double,3.0 mm/inner 1.5 mm	1
20	PT358-0030X	LPTN02-5930		PT-Nozzle double,3.0 mm/inner 1.5 mm	10
21	PT358-0035			PT-Nozzle double,3.5 mm/inner 1.5 mm	1
22	PT358-0035X	LPTN02-5935		PT-Nozzle double,3.5 mm/inner 1.5 mm	10
23	PT358-0040			PT-Nozzle double,4.0 mm/inner 1.5 mm	1
24	PT358-0040X	LPTN02-5940		PT-Nozzle double,4.0 mm/inner 1.5 mm	10
25	PT358-0045			PT-Nozzle double,4.5 mm/inner 1.5 mm	1

	Centricut P/N	Raysoar P/N	OEM Ref.No.	Description	Pkg qty
26	PT358-0045X	LPTN02-5945		PT-Nozzle double,4.5 mm/inner 1.5 mm	10
27	PT358-0050			PT-Nozzle double,5.0 mm/inner 1.5 mm	1
28	PT358-0050X	LPTN02-5950		PT-Nozzle double,5.0 mm/inner 1.5 mm	10
29		LPTN02-5908CP		PT-Nozzle double,0.8 mm/inner 1.5 mm CP	10
30	PT358-0010CP			PT-Nozzle double,1.0 mm/inner 1.5 mm CP	1
31	PT358-0010CPX	LPTN02-5910CP		PT-Nozzle double,1.0 mm/inner 1.5 mm CP	10
32	PT358-0125CP			PT-Nozzle double,1.2 mm/inner 1.5 mm CP	1
33	PT358-0125CPX	LPTN02-5912CP		PT-Nozzle double,1.2 mm/inner 1.5 mm CP	10
34	PT358-0124CPX	LPTN02-5914CP		PT-Nozzle double,1.4 mm/inner 1.5 mm CP	10
35	PT358-0015CP			PT-Nozzle double,1.5 mm/inner 1.5 mm CP	1
36	PT358-0015CPX	LPTN02-5915CP		PT-Nozzle double,1.5 mm/inner 1.5 mm CP	10
37		LPTN02-5916CP		PT-Nozzle double,1.6 mm/inner 1.5 mm CP	10
38	PT358-0018CP			PT-Nozzle double,1.8 mm/inner 1.5 mm CP	1
39	PT358-0018CPX	LPTN02-5918CP		PT-Nozzle double,1.8 mm/inner 1.5 mm CP	10
40	PT358-0020CP			PT-Nozzle double,2.0 mm/inner 1.5 mm CP	1
41	PT358-0020CPX	LPTN02-5920CP		PT-Nozzle double,2.0 mm/inner 1.5 mm CP	10
42	PT358-0023CP			PT-Nozzle double,2.3 mm/inner 1.5 mm CP	1
43	PT358-0023CPX	LPTN02-5923CP		PT-Nozzle double,2.3 mm/inner 1.5 mm CP	10
44	PT358-0025CP			PT-Nozzle double,2.5 mm/inner 1.5 mm CP	1
45	PT358-0025CPX	LPTN02-5925CP		PT-Nozzle double,2.5 mm/inner 1.5 mm CP	10
46	PT358-0030CP			PT-Nozzle double,3.0 mm/inner 1.5 mm CP	1
47	PT358-0030CPX	LPTN02-5930CP		PT-Nozzle double,3.0 mm/inner 1.5 mm CP	10
48	PT358-0035CP			PT-Nozzle double,3.5 mm/inner 1.5 mm CP	1
49	PT358-0035CPX	LPTN02-5935CP		PT-Nozzle double,3.5 mm/inner 1.5 mm CP	10
50	PT358-0040CPX	LPTN02-5940CP		PT-Nozzle double,4.0 mm/inner 1.5 mm CP	10
51	PT358-0045CPX	LPTN02-5945CP		PT-Nozzle double,4.5 mm/inner 1.5 mm CP	10

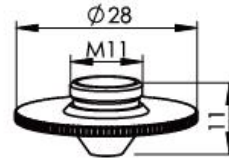
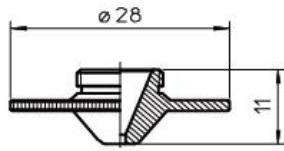

	Centricut P/N	Raysoar P/N	OEM Ref.No.	Description	Pkg qty
1	PT348-0010	LPTN03-5710		PT-Nozzle HD,1.0 mm	1
2	PT348-0012	LPTN03-5712		PT-Nozzle HD,1.2 mm	1
3	PT348-0015	LPTN03-5715		PT-Nozzle HD,1.5 mm	1
4	PT348-0020	LPTN03-5720		PT-Nozzle HD,2.0 mm	1
5	PT348-0025	LPTN03-5725		PT-Nozzle HD,2.5 mm	1
6	PT348-0030	LPTN03-5730		PT-Nozzle HD,3.0 mm	1
7	PT348-1086	LPTN03-5735		PT-Nozzle HD,3.5 mm	1
8	PT348-1087	LPTN03-5740		PT-Nozzle HD,4.0 mm	1
9	PT348-1088	LPTN03-5745		PT-Nozzle HD,4.5 mm	1
10	PT348-1089	LPTN03-5750		PT-Nozzle HD,5.0 mm	1

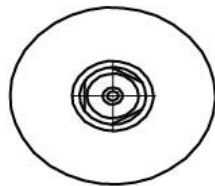
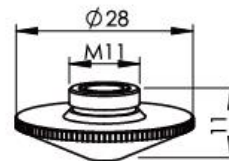
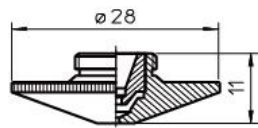

	Centricut P/N	Raysoar P/N	OEM Ref.No.	Description	Pkg qty
1	PT377-0001	LPTN04-5710		PT-Nozzle double,1.0 mm/inner 1.5 mm	1
2		LPTN04-5712		PT-Nozzle double,1.2 mm/inner 1.5 mm	1
3	PT377-0002	LPTN04-5715		PT-Nozzle double,1.5 mm/inner 1.5 mm	1
4	PT377-0003	LPTN04-5720		PT-Nozzle double,2.0 mm/inner 1.5 mm	1
5	PT377-0004	LPTN04-5725		PT-Nozzle double,2.5 mm/inner 1.5 mm	1
6	PT377-0005	LPTN04-5730		PT-Nozzle double,3.0 mm/inner 1.5 mm	1
7	PT377-0001CP	LPTN04-5710CP		PT-Nozzle double,1.0 mm/inner 1.5 mm CP	1
8	PT377-1160CP	LPTN04-5712CP		PT-Nozzle double,1.2 mm/inner 1.5 mm CP	1
9	PT377-1161CP			PT-Nozzle double,1.4 mm/inner 1.5 mm CP	1
10	PT377-0002CP	LPTN04-5715CP		PT-Nozzle double,1.5 mm/inner 1.5 mm CP	1
11	PT377-1162CP			PT-Nozzle double,1.8 mm/inner 1.5 mm CP	1
12	PT377-0003CP	LPTN04-5720CP		PT-Nozzle double,2.0 mm/inner 1.5 mm CP	1
13	PT377-0004CP	LPTN04-5725CP		PT-Nozzle double,2.5 mm/inner 1.5 mm CP	1
14	PT377-0005CP	LPTN04-5730CP		PT-Nozzle double,3.0 mm/inner 1.5 mm CP	1
15	PT377-1184CP			PT-Nozzle double,3.5 mm/inner 1.5 mm CP	1

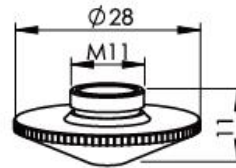
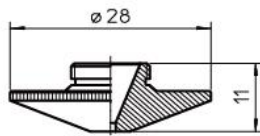

	Centricut P/N	Raysoar P/N	OEM Ref.No.	Description	Pkg qty
1	PT377-0010	LPTN05-5710	P0571-291-00010	PT-Nozzle,1.0 mm	1
2	PT377-0012	LPTN05-5712	P0571-292-00012	PT-Nozzle,1.2 mm	1
3	PT377-0015	LPTN05-5715	P0571-293-00015	PT-Nozzle,1.5 mm	1
4	PT377-0018	LPTN05-5718		PT-Nozzle,1.8 mm	1
5	PT377-0020	LPTN05-5720	P0571-295-00020	PT-Nozzle,2.0 mm	1
6	PT377-0025	LPTN05-5725	P0571-297-00025	PT-Nozzle,2.5 mm	1
7	PT377-0030	LPTN05-5730		PT-Nozzle,3.0 mm	1



	Centricut P/N	Raysoar P/N	OEM Ref.No.	Description	Pkg qty
1	PT348-1341		P0571-282-00012	PT-Nozzle,1.2 mm	1
2	PT348-1342		P0571-283-00015	PT-Nozzle,1.5 mm	1
3	PT348-0018		P0571-284-00018	PT-Nozzle,1.8 mm	1
4	PT348-1343		P0571-285-00020	PT-Nozzle,2.0 mm	1
5	PT348-1344		P0571-286-00025	PT-Nozzle,2.5 mm	1

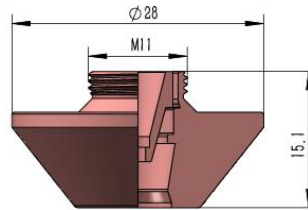

	Centricut P/N	Raysoar P/N	OEM Ref.No.	Description	Pkg qty
1		LPTN06-5975		PT-Nozzle,7.5 mm	1

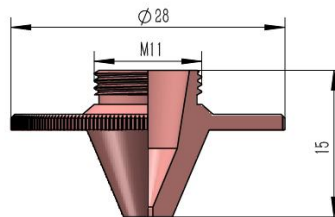

	Centricut P/N	Raysoar P/N	OEM Ref.No.	Description	Pkg qty
1		LPTN07-5915		PT-Nozzle,1.5 mm	1
2		LPTN07-5920		PT-Nozzle,2.0 mm	1
3		LPTN07-5925		PT-Nozzle,2.5 mm	1
4		LPTN07-5930		PT-Nozzle,3.0 mm	1



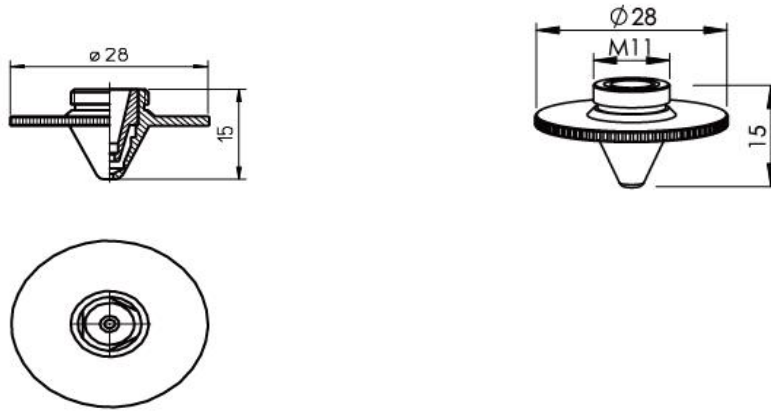

	Centricut P/N	Raysoar P/N	OEM Ref.No.	Description	Pkg qty
1	PT358-0001		6930250001	PT-Nozzle double 3D,0.8 mm/inner 1.5 mm	1
2	PT358-0002		6930250002	PT-Nozzle double 3D,1.0 mm/inner 1.5 mm	1
3	PT358-0003		6930250003	PT-Nozzle double 3D,1.2 mm/inner 1.5 mm	1
4	PT358-0004		6930250004	PT-Nozzle double 3D,1.5 mm/inner 1.5 mm	1
5	PT358-0005			PT-Nozzle double 3D,1.8 mm/inner 1.5 mm	1
6	PT358-0002CP			PT-Nozzle double 3D,1.0 mm/inner 1.5 mm CP	1
7	PT358-0003CP			PT-Nozzle double 3D,1.2 mm/inner 1.5 mm CP	1
8	PT358-0004CP	LPTN08-5915CP		PT-Nozzle double 3D,1.5 mm/inner 1.5 mm CP	1
9	PT358-0005CP			PT-Nozzle double 3D,1.8 mm/inner 1.5 mm CP	1



	Centricut P/N	Raysoar P/N	OEM Ref.No.	Description	Pkg qty
1	PT406-0799			PT-Nozzle HD,0.8 mm	1
2	PT406-0001			PT-Nozzle HD,1.0 mm	1
3	PT406-0002			PT-Nozzle HD,1.2 mm	1
4	PT406-0003	LPTN09-5915		PT-Nozzle HD,1.5 mm	1
5		LPTN09-5920		PT-Nozzle HD,2.0 mm	1

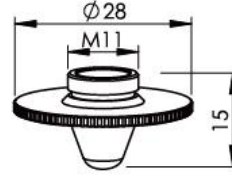
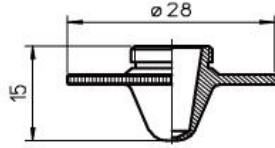

	Centricut P/N	Raysoar P/N	OEM Ref.No.	Description	Pkg qty
1	PT406-0008			PT-Nozzle,0.8 mm	1
2	PT406-0010			PT-Nozzle,1.0 mm	1
3	PT406-0125			PT-Nozzle,1.2 mm	1
4	PT406-0015		P0591-1049-00015	PT-Nozzle,1.5 mm	1
5	PT406-0018		P0591-1050-00018	PT-Nozzle,1.8 mm	1
6	PT406-0020			PT-Nozzle,2.0 mm	1

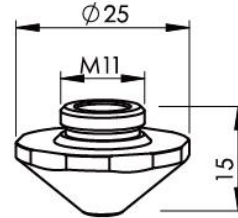
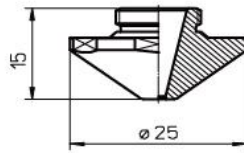

	Centricut P/N	Raysoar P/N	OEM Ref.No.	Description	Pkg qty
1		LOSN05-5910		Nozzle-1.0 mm	1
2		LOSN05-5910CP		Nozzle-1.0 mm CP	1
3		LOSN05-5915		Nozzle-1.5 mm	1
4		LOSN05-5915CP		Nozzle-1.5 mm CP	1
5		LOSN05-5918		Nozzle-1.8 mm	1
6		LOSN05-5920		Nozzle-2.0 mm	1
7		LOSN05-5920CP		Nozzle-2.0 mm CP	1
8		LOSN05-5923		Nozzle-2.3 mm	1
9		LOSN05-5925		Nozzle-2.5 mm	1
10		LOSN05-5927		Nozzle-2.7 mm	1
11		LOSN05-5930		Nozzle-3.0 mm	1
12		LOSN05-5935		Nozzle-3.5 mm	1
13		LOSN05-5940		Nozzle-4.0 mm	1
14		LOSN05-5945		Nozzle-4.5 mm	1
15		LOSN05-5950		Nozzle-5.0 mm	1

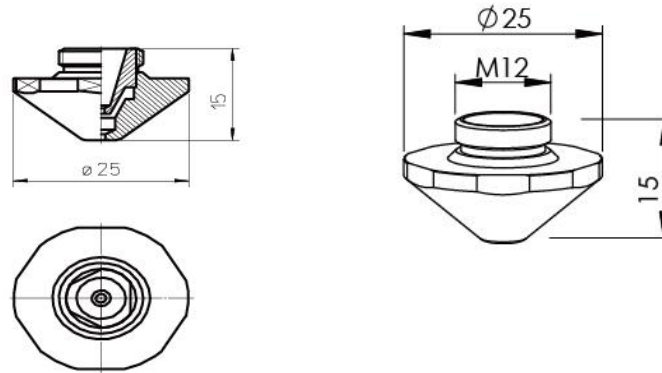

	Centricut P/N	Raysoar P/N	OEM Ref.No.	Description	Pkg qty
1		LOSN06-5910		Nozzle-1.0 mm double	1
2		LOSN06-5910CP		Nozzle-1.0 mm double CP	1
3		LOSN06-5912		Nozzle-1.2 mm double	1
4		LOSN06-5914		Nozzle-1.4 mm double	1
5		LOSN06-5915		Nozzle-1.5 mm double	1
6		LOSN06-5915CP		Nozzle-1.5 mm double CP	1
7		LOSN06-5918		Nozzle-1.8 mm double	1
8		LOSN06-5920		Nozzle-2.0 mm double	1
9		LOSN06-5920CP		Nozzle-2.0 mm double CP	1
10		LOSN06-5923		Nozzle-2.3 mm double	1
11		LOSN06-5925		Nozzle-2.5 mm double	1
12		LOSN06-5930		Nozzle-3.0 mm double	1
13		LOSN06-5935		Nozzle-3.5 mm double	1
14		LOSN06-5940		Nozzle-4.0 mm double	1
15		LOSN06-5945		Nozzle-4.5 mm double	1
16		LOSN06-5950		Nozzle-5.0 mm double	1

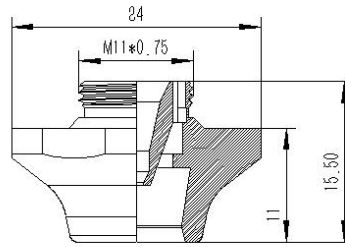

	Centricut P/N	Raysoar P/N	OEM Ref.No.	Description	Pkg qty
1		LRSN06-5015		Nozzle-5.0 mm double FBC5.0-1.5	1
2		LRSN06-5020		Nozzle-5.0 mm double FBC5.0-2.0	1
3		LRSN06-6020		Nozzle-6.0 mm double FBC6.0-2.0	1
4		LRSN06-7025		Nozzle-7.0 mm double FBC7.0-2.5	1
5		LRSN06-7030		Nozzle-7.0 mm double FBC7.0-3.0	1
6		LRSN06-7520		Nozzle-7.5 mm double FBC7.5-2.0	1
7		LRSN06-9520		Nozzle-9.5 mm double FBC9.5-2.0	1
8		LRSN06-9525		Nozzle-9.5 mm double FBC9.5-2.5	1
9		LRSN06-9530		Nozzle-9.5 mm double FBC9.5-3.0	1

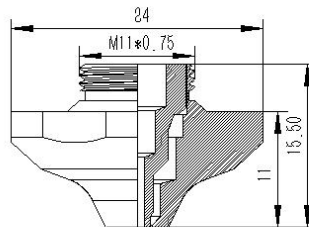

	Centricut P/N	Raysoar P/N	OEM Ref.No.	Description	Pkg qty
1		LRSN08-59100		Nozzle-10.0 mm double BFL	1
2		LRSN08-59100SS		Nozzle-10.0 mm double BFL	1
3		LRSN08-5925		Nozzle-2.5 mm double BFL	1
4		LRSN08-5925SS		Nozzle-2.5 mm double BFL	1
5		LRSN08-5930		Nozzle-3.0 mm double BFL	1
6		LRSN08-5930SS		Nozzle-3.0 mm double BFL	1
7		LRSN08-5940		Nozzle-4.0 mm double BFL	1
8		LRSN08-5940SS		Nozzle-4.0 mm double BFL	1
9		LRSN08-5960		Nozzle-6.0 mm double BFL	1
10		LRSN08-5960SS		Nozzle-6.0 mm double BFL	1

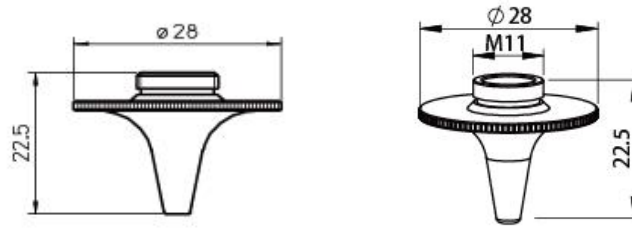

	Centricut P/N	Raysoar P/N	OEM Ref.No.	Description	Pkg qty
1	PT390-0040		P0578-0411-00010	PT-Nozzle radius long,1.0 mm	1
2	PT390-0005		P0578-0412-00012	PT-Nozzle radius long,1.2 mm	1
3	PT390-0006		P0578-0413-00015	PT-Nozzle radius long,1.5 mm	1
4	PT390-0009		P0578-0414-00018	PT-Nozzle radius long,1.8 mm	1
5	PT390-0007		P0578-0415-00020	PT-Nozzle radius long,2.0 mm	1
6	PT390-0008		P0578-0417-00025	PT-Nozzle radius long,2.5 mm	1
7	PT390-0005CP			PT-Nozzle radius long,1.2 mm CP	1
8	PT390-0006CP			PT-Nozzle radius long,1.5 mm CP	1
9	PT390-0007CP			PT-Nozzle radius long,2.0 mm CP	1

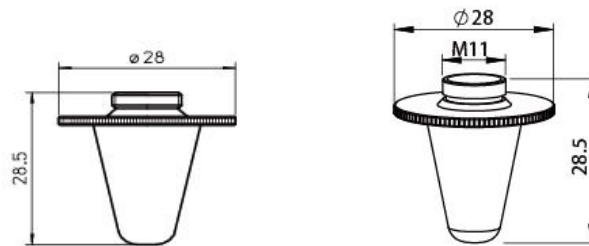

	Centricut P/N	Raysoar P/N	OEM Ref.No.	Description	Pkg qty
1	PT390-0010		P0573-563-00010	PT-Nozzle long,1.0 mm	1
2	PT390-0012		P0573-563-00012	PT-Nozzle long,1.2 mm	1
3	PT390-0015		P0573-563-00015	PT-Nozzle long,1.5 mm	1
4	PT390-0018			PT-Nozzle long,1.8 mm	1
5	PT390-0020		P0573-564-00020	PT-Nozzle long,2.0 mm	1
6	PT390-0025		P0573-566-00025	PT-Nozzle long,2.5 mm	1
7	PT390-0030			PT-Nozzle long,3.0 mm	1

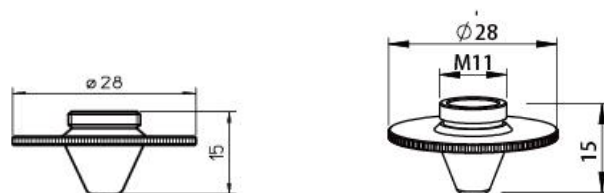

	Centricut P/N	Raysoar P/N	OEM Ref.No.	Description	Pkg qty
1	PT350-1590		P0591-569-00008	PT-Nozzle,0.8 mm	10
2	PT350-1331		P0591-561-00010	PT-Nozzle,1.0 mm	10
3	PT350-1351		P0591-562-00012	PT-Nozzle,1.2 mm	10
4	PT350-1351X		P0591-562-00012	PT-Nozzle,1.2 mm	10
5	PT350-1352		P0591-563-00015	PT-Nozzle,1.5 mm	10
6	PT350-1352X		P0591-563-00015	PT-Nozzle,1.5 mm	10
7	PT350-1353		P0591-564-00018	PT-Nozzle,1.8 mm	10
8	PT350-1354		P0591-565-00020	PT-Nozzle,2.0 mm	10
9	PT350-0023			PT-Nozzle,2.3 mm	10
10	PT350-1591		P0591-566-00025	PT-Nozzle,2.5 mm	10
11	PT350-0030			PT-Nozzle,3.0 mm	10
12	PT350-1590CP		P0591-569-00008	PT-Nozzle,0.8 mm CP	10
13	PT350-1331CP		P0591-561-00010	PT-Nozzle,1.0 mm CP	10
14	PT350-1351CP		P0591-562-00012	PT-Nozzle,1.2 mm CP	10
15	PT350-1352CP		P0591-563-00015	PT-Nozzle,1.5 mm CP	10
16	PT350-0001CP			PT-Nozzle,1.7 mm CP	10
17	PT350-1353CP		P0591-564-00018	PT-Nozzle,1.8 mm CP	10
18	PT350-1354CP		P0591-565-00020	PT-Nozzle,2.0 mm CP	10
19	PT350-0002CP			PT-Nozzle,2.3 mm CP	10
20	PT350-1591CP		P0591-566-00025	PT-Nozzle,2.5 mm CP	10
21	PT350-0003CP			PT-Nozzle,3.0 mm CP	10

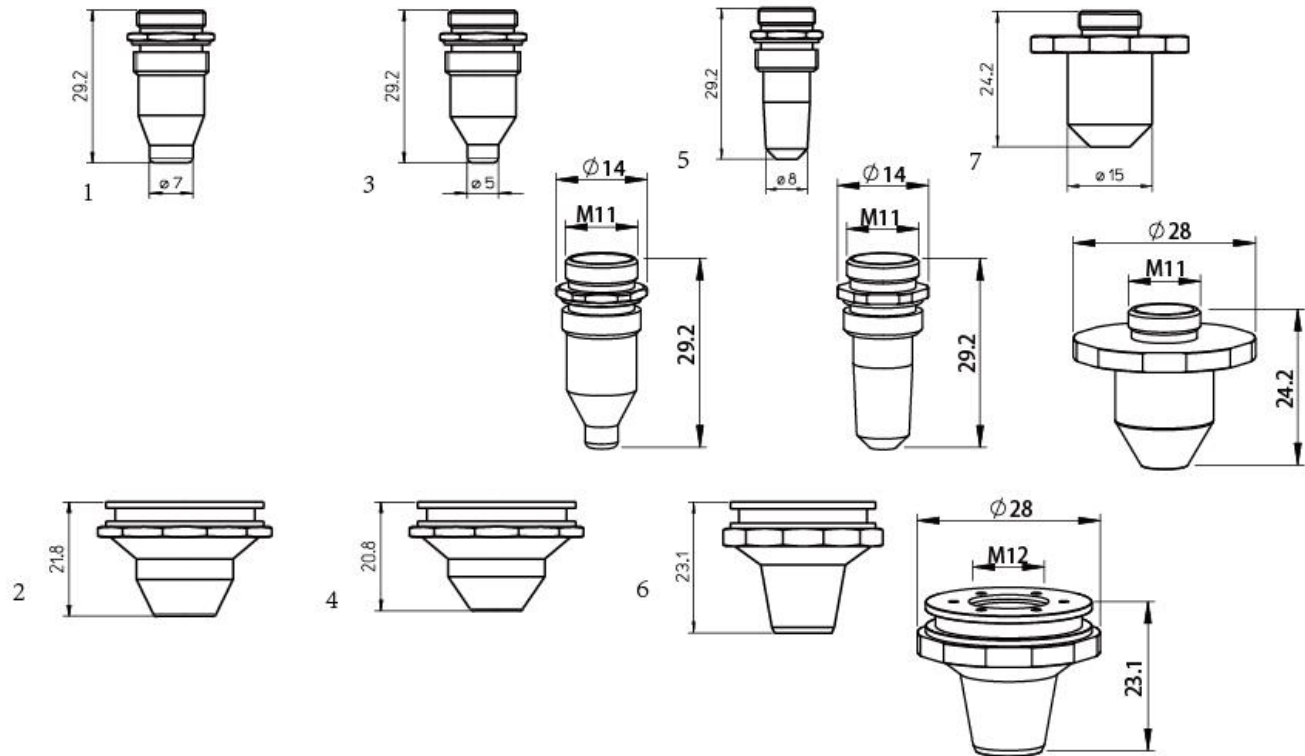

	Centricut P/N	Raysoar P/N	OEM Ref.No.	Description	Pkg qty
1	PT348-4175		20054175	Inner nozzle-1.9 mm	1
2	PT348-4176		20054176	Outer nozzle-8.0 mm	1
3	PT348-5175	LKON02-2060-0		Inner nozzle-1.7 mm	1
4	PT348-5176	LKON02-2060-1		Outer nozzle-6.0 mm	1
5	PT348-1545			PT-Nozzle,1.9 mm	1
5	PT348-1594			PT-Nozzle,1.2 mm	1
6	PT348-0414			Outer nozzle-7.0 mm	1
7	PT348-1598			PT-Nozzle,3.0 mm	1

## 3D Nozzle

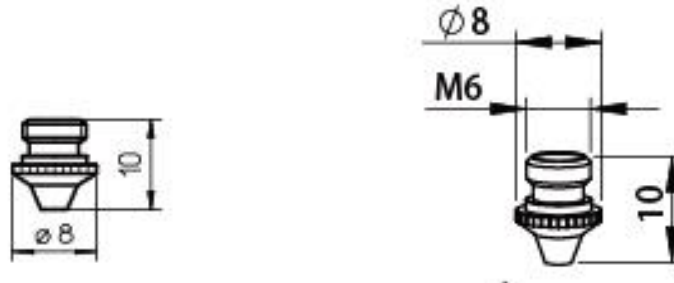

	Centricut P/N	Raysoar P/N	OEM Ref.No.	Description	Pkg qty
1	PT379-0010X		280943,P0494-787-00010	PT-Nozzle KN TAK,1.0 mm	10
2	PT379-0012X		280942,P0494-788-00012	PT-Nozzle KN TAK,1.2 mm	10
3	PT379-0015X		280941,P0494-789-00015	PT-Nozzle KN TAK,1.5 mm	10
4	PT379-0018X			PT-Nozzle KN TAK,1.8 mm	10
5	PT379-0020X			PT-Nozzle KN TAK,2.0 mm	10



	Centricut P/N	Raysoar P/N	OEM Ref.No.	Description	Pkg qty
1	PT347-1034X	LPTN35-3512Z	P0352-324-00012	PT-Nozzle ZK,1.2 mm	10
2	PT347-1013X		P0352-325-00015	PT-Nozzle ZK,1.5 mm	10
3	PT347-0899X		P0352-326-00018	PT-Nozzle ZK,1.8 mm	10
4	PT347-0044-3		P0352-327-00020	PT-Nozzle ZK,2.0 mm	1
5	PT347-0044X		P0352-327-00020	PT-Nozzle ZK,2.0 mm	10
6	PT347-1025X		P0352-328-00025	PT-Nozzle ZK,2.5 mm	10





	Centricut P/N	Raysoar P/N	OEM Ref.No.	Description	Pkg qty
1	PT347-1006X		P0352-333-00010	PT-Nozzle KK,1.0 mm	10
2	PT347-1030X	LPTN35-3512K	P0352-334-00012	PT-Nozzle KK,1.2 mm	10
3	PT347-1031X	LPTN35-3515K	P0352-335-00015	PT-Nozzle KK,1.5 mm	10
4	PT347-0898X		P0352-336-00018	PT-Nozzle KK,1.8 mm	10
5	PT347-1020X	LPTN35-3520K	P0352-336-00020	PT-Nozzle KK,2.0 mm	10
6		LPTN35-3525K		PT-Nozzle KK,2.5 mm	10
7		LPTN35-3530K		PT-Nozzle KK,3.0 mm	10

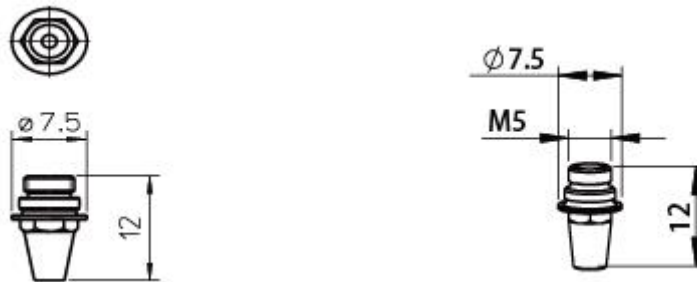

	Centricut P/N	Raysoar P/N	OEM Ref.No.	Description	Pkg qty
1	PT347-1761	LPTN35-3512S	P0491-1001-00015	PT-Nozzle hexagonal DE M1.5 KS,1.2 mm	1
2	PT347-1762		P0491-1001-00015	PT-Nozzle hexagonal DE M1.5 KS,1.5 mm	1
3	PT347-1764		P0491-1002-00020	PT-Nozzle hexagonal DE M1.5 KS,2.0 mm	1
4	PT347-1760X		P0491-1001-00015	PT-Nozzle hexagonal DE M1.5 KS,1.0 mm	1
5	PT347-1761X		P0491-1002-00020	PT-Nozzle hexagonal DE M1.5 KS,1.2 mm	1
6	PT347-1762X		L301762	PT-Nozzle hexagonal DE M1.5 KS,1.5 mm	1
7	PT347-1764X		L301764	PT-Nozzle hexagonal DE M1.5 KS,2.0 mm	1



	Centricut P/N	Raysoar P/N	OEM Ref.No.	Description	Pkg qty
1	PT347-0005X		46713300290-10	PT-Nozzle 3D,1.0 mm	10
2	PT347-0290-1.2		46713300290-12	PT-Nozzle 3D,1.2 mm	1
3	PT347-0090X		46713300290-12	PT-Nozzle 3D,1.2 mm	10
4	PT347-0290		P0352-381-00015	PT-Nozzle 3D,1.5 mm	1
5	PT347-0290X	LPTN35-3515D	P0352-381-00015	PT-Nozzle 3D,1.5 mm	10
6	PT347-0118X		P0352-377-00018	PT-Nozzle 3D,1.8 mm	10
7	PT347-0280		P0352-382-00020	PT-Nozzle 3D,2.0 mm	1
8	PT347-0280X	LPTN35-3520D	P0352-382-00020	PT-Nozzle 3D,2.0 mm	10
9	PT347-0001		46713300280-25	PT-Nozzle 3D,2.5 mm	1
10	PT347-0001X		46713300280-25	PT-Nozzle 3D,2.5 mm	10
11	PT347-0002		46713300280-30,46713300430	PT-Nozzle 3D,3.0 mm	1
12	PT347-0002X		46713300280-30,46713300430	PT-Nozzle 3D,3.0 mm	10
13	PT347-0005		46713300280-35	PT-Nozzle 3D,3.5 mm	1
14	PT347-0035X		46713300280-35	PT-Nozzle 3D,3.5 mm	10



	Centricut P/N	Raysoar P/N	OEM Ref.No.	Description	Pkg qty
1	PT344-1813X		P0589-424-00008	PT-Nozzle,0.8 mm	10
2	PT344-1813CPX		P0589-424-00008	PT-Nozzle,0.8 mm CP	10
3	PT344-1789X		P0589-426-00010	PT-Nozzle,1.0 mm	10
4	PT344-1561X		281561,778550	PT-Nozzle,1.2 mm	10
5	PT344-1499X	LPTN33-5815	281814,149957	PT-Nozzle,1.5 mm	10
6	PT344-0020X	LPTN33-5820	P0589-428-00020	PT-Nozzle,2.0 mm	10

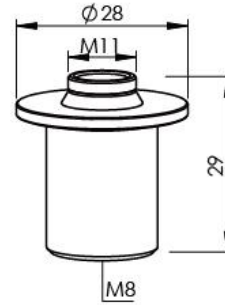
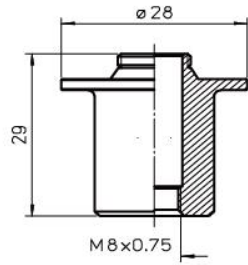

	Centricut P/N	Raysoar P/N	OEM Ref.No.	Description	Pkg qty
1	PT406-0333			PT-Nozzle adapter,L=29 M8	1

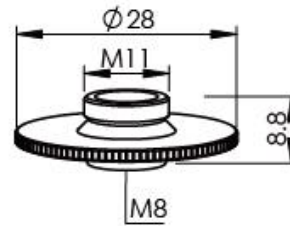
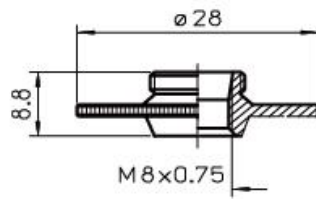

	Centricut P/N	Raysoar P/N	OEM Ref.No.	Description	Pkg qty
1	PT406-0043			PT-Nozzle adapter	1

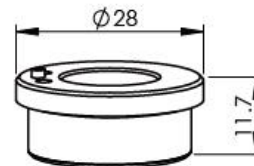
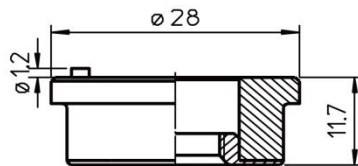

	Centricut P/N	Raysoar P/N	OEM Ref.No.	Description	Pkg qty
1	PT348-1330	LRSC09-0003	281330,P0571-260-00001,6930281330	PT-Nozzle holder KT B2国产不锈钢片	1
2		LRSC09-0002	281330,P0571-260-00001,6930281330	PT-Nozzle holder KT B2进口铜片	1

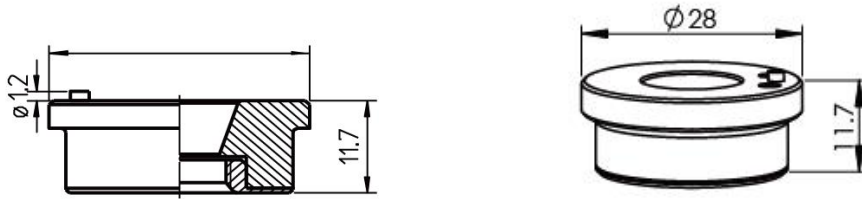

	Centricut P/N	Raysoar P/N	OEM Ref.No.	Description	Pkg qty
1	PT348-1051	LPTC09-0003	P0571-1051-00001,6930281333	PT-Nozzle holder KT B2"Con	1
2		LPTC09-0001	P0571-1051-00001,6930281333	PT-Nozzle holder KT B2"Con	1
		LPTC09-0002		PT-Nozzle holder KT B2"Con	1



	Centricut P/N	Raysoar P/N	OEM Ref.No.	Description	Pkg qty
1		LPTC09-0003A		PT-Nozzle holder KT B2"Con Height of pin 1.55mm	1
2		LPTC09-0002H		PT-Nozzle holder KT B2"Con Height of pin 2.3mm	1

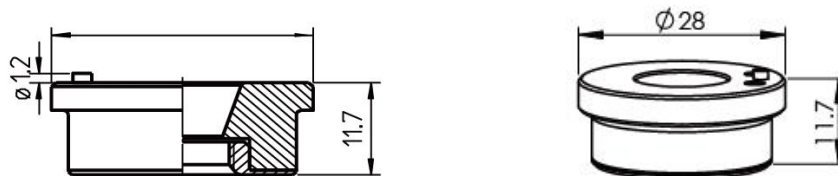

	Centricut P/N	Raysoar P/N	OEM Ref.No.	Description	Pkg qty
1		LRSC09-0001A		PT-Nozzle holder KT B2"Con M12*1.0	1
2		LRSC09-0001B		PT-Nozzle holder KT B2"Con M12.1*0.9	1
3		LRSC09-0001F		PT-Nozzle holder KT B2"Con M12*1.0	1



	Centricut P/N	Raysoar P/N	OEM Ref.No.	Description	Pkg qty
1		LPTC09-XB01		PT-Nozzle holder KT B2"Con	1

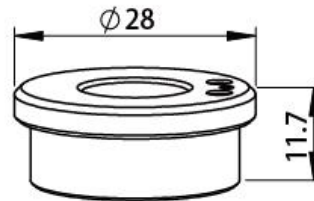
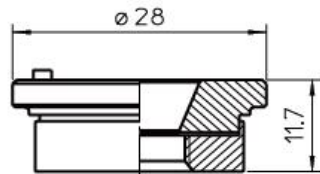

	Centricut P/N	Raysoar P/N	OEM Ref.No.	Description	Pkg qty
1	PT348-1330C	LRSC09-0002C	281330,P0571-260-00001,6930281330	PT-Nozzle holder,ceramic	1
2		LRSC09-0002E	281330,P0571-260-00001,6930281330	PT-Nozzle holder,ceramic	1

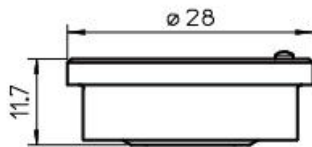

	Centricut P/N	Raysoar P/N	OEM Ref.No.	Description	Pkg qty
1	PT348-1518		281518,P0571-265-00001	PT-Nozzle holder IT B2"Z,aluminum	1

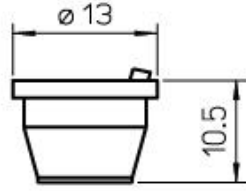

	Centricut P/N	Raysoar P/N	OEM Ref.No.	Description	Pkg qty
1	PT347-0110	LPTC09-0110	P0491-130-00001	PT-Nozzle holder KT M1.5\"K S OEM,ceramic	1



	Centricut P/N	Raysoar P/N	OEM Ref.No.	Description	Pkg qty
1	PT311-0001		P0492-702-00002	PT-Insulating ring	1
2	PT347-4297		P0492-702-00001,29100021	PT-Insulating ring outer body	1



	Centricut P/N	Raysoar P/N	OEM Ref.No.	Description	Pkg qty
1	PT311-1146	LPTC09-0211	281146,P0380-211-00001,29100033	PT-Nozzle holder ITM 1.5\"DZ	1
2	PT311-1146OEM		281146,P0380-211-00001,29100033	PT-Nozzle holder ITM 1.5\"DZ OEM	1



	Centricut P/N	Raysoar P/N	OEM Ref.No.	Description	Pkg qty
1		LPTE09-1232	P0571-1095-00001 P0571-271-00001 P0591-21232	PT-PRECITEC LASER HEAD NUT MU HP	1

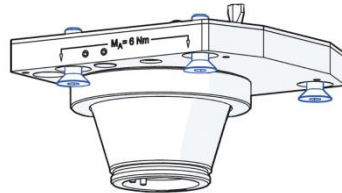

	Centricut P/N	Raysoar P/N	OEM Ref.No.	Description	Pkg qty
1		LPTE14-9180	P 0595-59180	Sensor insert ProCutter 08 F125	1
2		LPTE14-0123	P 0595-60123	Sensor insert ProCutter 08 F150	1
3		LPTE14-9120	P 0595-59120	Sensor insert ProCutter 08 F200	1
4		LPTE14-9180R	P 0595-59180	Sensor insert ProCutter 08 F125	1
5		LPTE14-0123R	P 0595-60123	Sensor insert ProCutter 08 F150	1
6		LPTE14-9120R	P 0595-59120	Sensor insert ProCutter 08 F200	1
7		LPET14-4859R	P 0595-84859	Sensor insert ProCutter 12KW F200	1
8		LPTE14-0399R	P 0595-90339 P 0595-90399	Sensor insert ProCutter 15KW F200	1
9		LPTE14-5002R	P 0580-5002-00001	Sensor insert LightCutter F100/F125/F150/F200	1
10		LPTE14-5003R	P 0580-65003	Sensor insert LightCutter F100/F125/F150/F200	1
11		LPTE14-7918R	P 0580-67918 (DAZU)	Sensor insert LightCutter F100/F125/F150/F200	1

## Fiber Optics

### Protection Windows



	Raysoar P/N	OEM Ref.No.	Description	Model of Cutting Head	Brandname
1	LPTO11-2235S	P0589-360-00001/2	Fused Silica PW D22.35 T4.0 AR/AR@1064nm	HP SSL/Minicutter	Raypower
2	LPTO11-3050S	P0795-1201-00001	Fused Silica PW D30.00 T5.0 AR/AR@1064nm	Lightcutter	Raypower
3	LPTO11-2120S	P588-1022-00001	Fused Silica PW D21.50 T2.0 AR/AR@1064nm	Procutter 08 6000W	Raypower
4	LPTO11-2120E	P588-1022-00001	Fused Silica PW D21.50 T2.0 AR/AR@1064nm	Procutter 10/12/15 10KW-15KW	Raypower
5	LPTO11-3770S	P0595-58601	Fused Silica PW D37.00 T7.0 AR/AR@1064nm	Procutter 08 6000W	Raypower
6	LPTO11-3770E	P0595-58601	Fused Silica PW D37.00 T7.0 AR/AR@1064nm	Procutter 10/12/15 10KW-15KW	Raypower

### Focus and Collimating Lens ASSY





	Raysoar P/N	OEM Ref.No.	Description	Model of Cutting head	Brandname
1	LPTO01-F125HL	P0591-1262-00001	Fused Silica D30 F125 Focusing Lens ASSY	HP SSL	Raypower
2	LPTO01-F200HL	P0591-1263-00001	Fused Silica D30 F200 Focusing Lens ASSY		
3	LPTO17-C100HL	P0591-1186-00001	Fused Silica D30 F100 Collimation Lens ASSY		
4	LPTO01-F125LL	P0580-1103-00001	Fused Silica D30 F125 Focusing Lens ASSY	Lightcutter	
5	LPTO01-F150LL	P0580-1104-00001	Fused Silica D30 F150 Focusing Lens ASSY		
6	LPTO17-C100LL	P0580-2102-00001	Fused Silica D30 F100 Collimation Lens ASSY	Procutter	
7	LPTO01-F125PP	P0595-59761	Fused Silica D37 F125 Focusing Lens ASSY		
8	LPTO01-F150PP	P0595-70894	Fused Silica D37 F150 Focusing Lens ASSY		
9	LPTO01-F200PP	P0595-70900	Fused Silica D37 F200 Focusing Lens ASSY	Procutter 10/12/15	
10	LPTO17-C100PP		Fused Silica D37 F100 Collimation Lens ASSY		
11	LPTO01-F200PS		Fused Silica D37 F200 Focusing Lens ASSY 15KW	Minicutter	
12	LPTO17-C100PAS		Fused aspheric lens D37 F100 Collimation Lens ASSY 15KW		
13	LPTO01-F125ML		Fused Silica D25 F125 Focusing Lens ASSY	Minicutter	
14	LPTO17-C075ML		Fused Silica D25 F75 Focusing Lens ASSY		

## Air Filter

	Raysoar P/N	OEM Ref.No.	Description
1	LATP07-DD17		DD17
2	LATP07-DD17D		DD17
3	LATP07-DDP17		DDP17
4	LATP07-PD17		PD17
5	LATP07-PD17D		PD17
6	LDNP07-UP05-1		Ultrapac 2000 0005
7	LDNP07-UP05-2		Ultrapac 2000 0005
8	LSMP07-AF40		AF40P-060S
9	LSMP07-AFD40		AFD40P-060AS

## Water Cooling Unit



	Raysoar P/N	OEM Ref.No.	Description
1	LTRW07-6152	146152	Original Chisso filter for water circuit 30 x 68 x 248 mm
2	LTRW07-6153	146153	
3	LTRW07-3137	1933137	Original Chisso filter for water circuit 30 x 68 x 500 mm
4	LTRW07-8631	1888631	Original Chisso filter for water circuit 28 x 62 x 508 mm
5	LTRW13-3112	1653112	Easy-Kit -Cu-3 Standard(50-119L)

## Dust Extraction Unit



	Raysoar P/N	Machine Type	Description
1	LDNP07-0818F	P190818	Ultra-web FR 350*240*660mm
2	LDNP07-1920F	P191920	Cartridge Ultra-web DFO UW FR D290*366mm L660mm

## Oscillater

	Raysoar P/N	OEM Ref.No.	Description
1	LLBM07-2023		Vacuum pump filter
2	LLBM06-GS32-2	10.07.04.03.003	Vacum pump oil LVO 120

## Laser Gas

	Raysoar P/N	OEM Ref.No.	Description
1	LELL13-L78		Lasal 78 CO2%:He%:N2%=4:70:26



1



2



3



4



5



6



7



8



9



10



11



12



13



14

**Optics Accessories**

	Raysoar P/N	OEM Ref.No.	Description
1	LOPC15-1260		Focus Lens Stress Detection Kit(Ophir EZ Test)(1.5"lens)
	LOPC15-1280		Focus Lens Stress Detection Kit(Ophir EZ Test)(2.0"lens)
2	LTRC15-7388		Mirror Polish.1UM 80ML
3	LRSC15-ALCO-500		Ethanol 99.7%
4	LRSC15-A236		IPA Isopropyl A236 400ml
5	LRSC15-GSBL		Air Duster 85g
6	LRSC15-FCS3		Optics Cleaning Liquid(Imported) 58ml
7	LRSC15-ACET-500		Optics Cleaning Liquid 500ml
8	LRSC15-0714		Knit polyester swabs 20pcs
9	LRSC15-759B		Knit polyester swabs 100pcs
10	LRSC15-9625		Knit polyester swabs 50pcs
11	TR300-6452		Original Tiffan Lens Cleaning Paper(50 sheets)
12	LRSC15-CLPA		Domestic Lens Cleaning Paper(40 sheets)
13	TR300-1115		Lens cleaning cotton pads-80 pcs
14	LRSC15-KT3008		Cleanroom wipers KX KT-3008 9"