

FUJIFILM

expect INNOVATION™

HA PREMIER



OS-TECH

HA42x9.7BE RD

Technology That Inspires...

FUJINON

HA42x9.7BE RD



OS-TECH

Zoom Ratio / Format	42X / 2/3"
Focal Length	9.7 ~ 410 mm
Extender	(2X) 19.4 ~ 820 mm
Maximum Relative Aperture	1:2.0 (9.7 ~ 225 mm)
	1:3.7 (410 mm)
Maximum Photometric Aperture T-No.	1:2.2 (9.7 ~ 225 mm)
	1:4.0 (410 mm)
Angular Field of View	9.7 mm 52° 37' x 31° 03'
16:9 Aspect Ratio	410 mm 1° 20' x 0° 45'
	(2X) 19.4 mm 27° 46' x 15° 49'
	820 mm 0° 40' x 0° 23'
M.O.D. from Image Plane	3.18 m
M.O.D. from Front of Lens	2.8m
Object Dimensions at M.O.D.	9.7 mm 2619 x 1472 mm
	410 mm 64 x 36 mm
	(2X) 19.4 mm 1339 x 753 mm
	820 mm 33 x 19 mm
Filter Size	ø 127 mm P=0.75 (On Barrel)
Dia ø x Length (w/o Hood)	ø130 x 338.5 mm
Weight (w/o Hood)	5.3 kg
Options	Built In OS-TECH
Features	Inner Focus / Zoom Limit / Built In OS-TECH / Quick Zoom

*RD contain servos for zoom and focus.

ACCESSORIES: HD & SD ENG/EPF

THREE-MODE FINE FOCUS

By shifting the sensitivity from the wide side to the telephoto side of the focus range, this control provides more precise focusing for studio or sports productions.

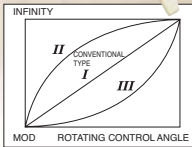

SERIAL DIGITAL REMOTE CONTROL BY PC

Remote control of zoom, focus and iris for Digipower lenses is possible via serial digital link, providing accurate positioning for virtual studio and other applications requiring digital precision.

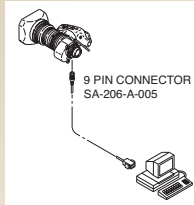

DIGI ZOOM DEMAND*

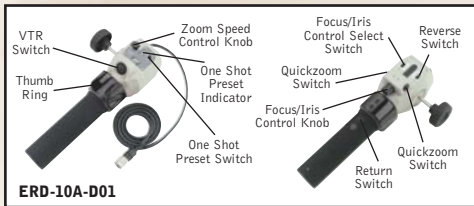

*New Digital features only available on ERM/ERD-M/S.

- A. CFC-990 Flex Cable
- B. FMM-3B/6B Manual Module
- C. ZMM-6 Manual Module
- D. EBF-1 Focus Cable
- E. MCA-6
- F. ERD-20A-A01/A02 Zoom Demand
- G. FSP-13G Focus Positional Module
- H. EPD-4A-E02
- I. CZH-14 Focus Handle
- J. CFH-11 Focus Handle
- K. MCA-7 Mounting Clamp
- L. EPD-20A-A01/A02 Focus Demand
- M. ERD-10A-D01 Zoom Demand
- N. ALH-117A-02A Support for HA36x/A36x HA42x

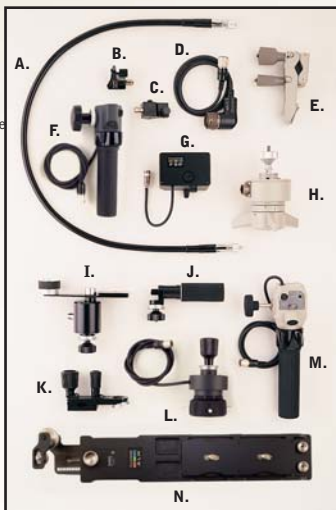

Note: ERD-20A-A02 (F) and EPD-20A-A02 (L) replace the ERD-T22 and EPD-2CA.

DIGI POWER REAR CONTROL KITS

MS-11D Manual Focus/Servo Zoom
For use with RM/ZM type lenses.

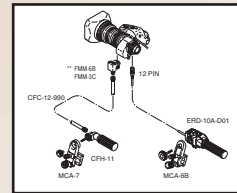

SS-11D Servo Focus/Servo Zoom
For use with RM/ZM type lenses.

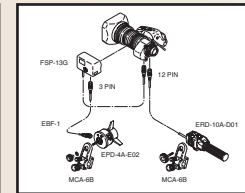

SS-13D Servo Focus/Servo Zoom
For use with RD/ZD type lenses.

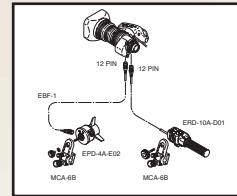

SS-14S Servo Focus/Servo Zoom
For use with RD/ZD type lenses.

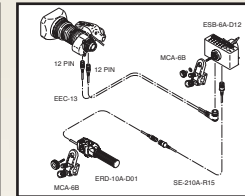

STANDARD REAR CONTROL KITS

MS-11 Manual Focus/Servo Zoom

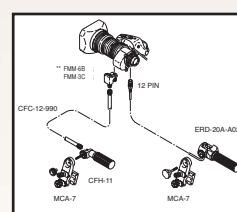

SS-11 Servo Focus/Servo Zoom
Not available on HA42x, HA36x and A36x

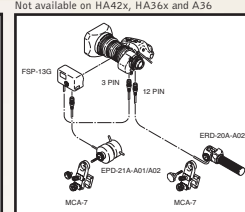

SS-13A Servo Focus/Servo Zoom
For use with ERD type lenses.

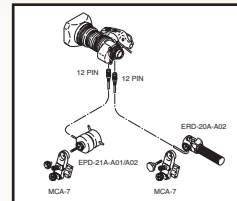

MM-11 Manual Focus/Manual Zoom
Not available on HA42x, HA36x and A36x

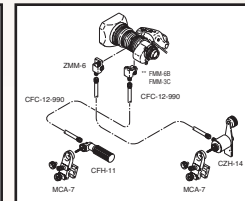

*Specify camera type

**FMM-3C for use on HA36x, HA42x and HA25x

MOUNTING SYSTEM

Fujinon has replaced the "cone" shaped mounting system with the "tooth" system. The cone type may still be ordered as a special order.



New Style
MCA-7



Old Style
MCA-1A
(Discontinued)

For Sales Contact Information go to
www.Fujinon.com