

Type:	Project:	Qty:
	Date:	
Catalog #:		

Description:

The Regolo RR6 series is a nominal 6" profile surface mount LED luminaire. The slender design is ideal for corridors, open and private offices, classrooms, lobbies and general purpose rooms.

Specifications:

Construction: The housing consists of visible extruded aluminum side rails with formed cold rolled steel back channel and heavy gauge end caps. Standard finish is powder coat textured white. Optional silver, black or custom color paint finishes.

Reflector / Driver: Reflector / driver cover is finished with high reflectance white paint. Optional asymmetric semi-specular aluminum reflector. Standard constant current electronic driver with 0-10V dimming input; dimming range from 100% down to 1%. Universal (UNV) voltage is from 120 - 277V, 50/60 Hz.

Shielding: Extruded frosted or satin white acrylic snap-in lens with DR.

LED Module: Distributed LED array in a variety of lumen output packages. LED color is available in 3000K, 3500K or 4000K and in 80CRI or 90CRI. Module is replaceable. L90 ≥ 100,000 hrs.

Mounting: Surface mounting, individual or continuous row.

Labels: ETL listed, conforms to UL Standard 1598 / 8750 and CSA Standard C22.2, Damp location.

Warranty: 5-year limited warranty on LED and Driver.

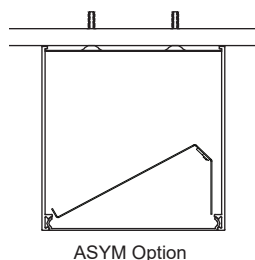
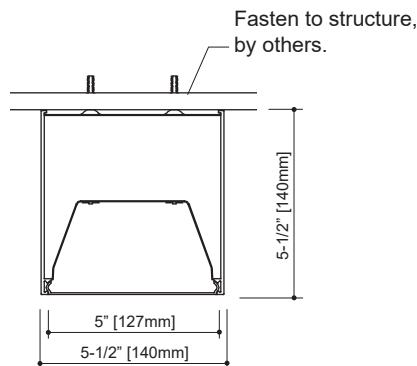

Ordering Information

Sample: RR6-05L35-UNV-D-11-FRF-WH-8'-ASYM

Series	Lumen Package ¹ / Color	Voltage	Driver	Circuit	Shielding	Color	Length	Options
RR6								
RR6 (Surface - Nom. 6")	05 (~571 lm/ft, 4.85W/ft)	80CRI	UNV	Dimming (0-10V)	11 Single Circuit 11EM Single Circuit w/ EM 11B ⁴ Single Circuit w/ Battery Pack CEC CEC Compliant (10W Battery Pack)	FRF (Frosted Flush) STF (Satin White Flush)	2' 3' 4' 5' 6' 7' 8'	DSOS Combined Daylight & Occupancy Sensor ASYM ⁶ Asymmetric Reflector GLR Fusing See Accessories for Corners and Downlight Modules
	L30							
	L35	D0 ³ (Dim to 1%, fade to off)						
	09 (~882 lm/ft, 7.79W/ft)	L40	277	D02 ³ (Dim to 0%)				
	10 (~1035 lm/ft, 9.39W/ft)	90CRI		Lutrone Dimming				
	13 (~1269 lm/ft, 11.6W/ft)	H30	Consult Factory for Custom Lumen Package	See Page 2 for Ordering Codes				
	17 (~1576 lm/ft, 14.6W/ft)	H35		DALI Dimming				
	H40	eldoLED ECOdrive ELE (Dim to 1%) eldoLED SOLOdrive ELS (Dim to 0%)						
							Continuous Runs ⁵ XX' Specify run length in 1 foot increments. Consult factory for custom lengths.	

Notes:

- Nominal lumen output per foot w/ frosted lens and 3500K.
- Standard driver, don't connect low-voltage wires for non-dimming applications. Consult factory for specifications and manufacturer.
- Consult factory for specifications and manufacturer.
- Battery pack not available in fixtures 3' or less.
- 6" increments are common custom lengths. We can provide custom run length down to the nearest (+/- 1/8").
- Only available with Frosted Flush lens.



Lens Options

Shielding



Frosted Lens
This diffuser is designed for a balance between efficiency and lens uniformity. (Transmission ~ 89%)

Satin White Lens
This diffuser is designed for visible lens uniformity. It's recommended for regressed lens configuration in our shallow housing. (Transmission ~ 69%)

Sensor Option



Lutron Driver Ordering Codes

Nulite Code	Lutron Prefix	Lutron Series	Dim Level	Quantity of Wires	Dim to Dark (Smooth)
L11*	PEQ	Hi-Lume™ Premiere	0.1%	2	X
L12	LTEA	Hi-Lume™ 2-Wire 120V forward phase	1%	No Control Wires - Uses Hot	
L15	LDE1	Hi-Lume™ H-Series	1%	2	X
L16	LDE5	Hi-Lume™ 5-Series	5%	2	

*Maximum lumen package with L11 is 05

Back of Housing Mounting Holes & Power Feed KO

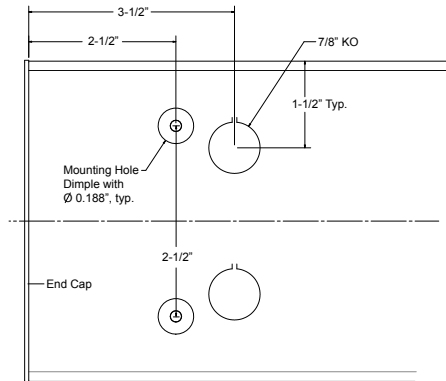

Individual Lengths

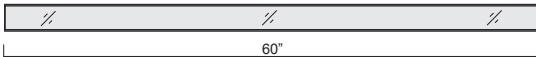
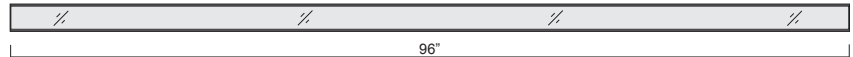
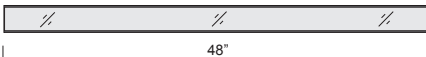
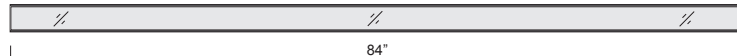
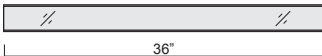
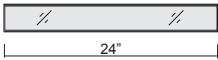

End caps add an additional 1/8" to either end of a fixture/row.

Continuous Run Lengths

		Run Length																																																				
		2'	3'	4'	5'	6'	7'	8'	9'	10'	11'	12'	13'	14'	15'	16'	17'	18'	19'	20'	21'	22'	23'	24'	25'	26'	27'	28'	29'	30'	31'	32'	33'	34'	35'	36'	37'	38'	39'	40'	41'	42'	43'	44'										
Number of Housings	2'	1																																																				
	3'		1																																																			
	4'			1					1	1	1	1						1	1	1	1					1	1	1	1					1	1	1	1							1	1	1	1							
	5'				1				1																		1																											
	6'					1				1																	1																											
	7'						1				1																1																											
	8'							1				1	1	1	1			2	1	1	1	1	2	2	2	2	3	2	2	2	3	3	3	3	3	4	3	3	3	4	4	4	4	4	4	4	5	4	4	4	4	5		

Photometric Curves

Cat. # RR6-05L35-...-FRF-...-4'
 Wattage/ft - 4.85
 Lumens/Watt - 118

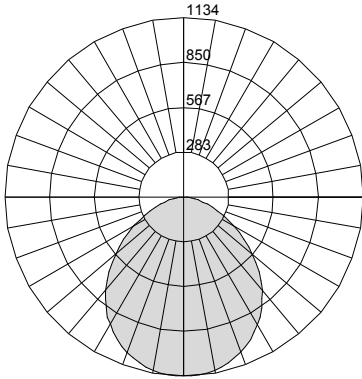

Cat. # RR6-09L35-...-FRF-...-4'
 Wattage/ft - 7.79
 Lumens/Watt - 113

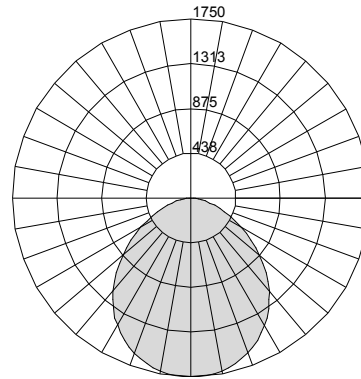

Cat. # RR6-05L35-...-FRF-...-4'-ASYM
 Wattage/ft - 5.25
 Lumens/Watt - 109

