

GL 306 Classroom Computer Options

GL306 is equipped with a standard classroom computer located on the AV cabinet in the front corner of the room as well as a classroom laptop. The standard classroom PC is hard wired to the AV system and can be displayed by selecting Classroom PC as the source on the AV controller. The standard classroom PC has a Wacom touchscreen monitor located on the cabinet. You can use your finger or a stylus with this monitor.

If you desire to use a computer that is not tethered to the AV cabinet, there is an instructor laptop provided for your use, the HP Spectre. To display content using this computer you will have to select wireless presenter as the source on the AV controller. You will then need to follow the wireless presenter instructions to utilize the wireless presenter system.

Please use the following instructions when logging into the Classroom Laptop to ensure you have access to your NPS profile.

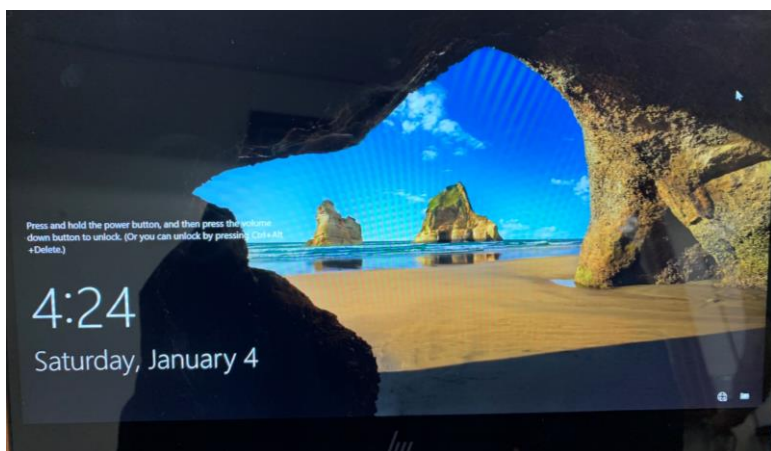

If the laptop is turned off, the power button is on the side of the top left corner of the computer. You will see the standard welcome screen.

Before signing in you will need to connect to the network to access your profile.

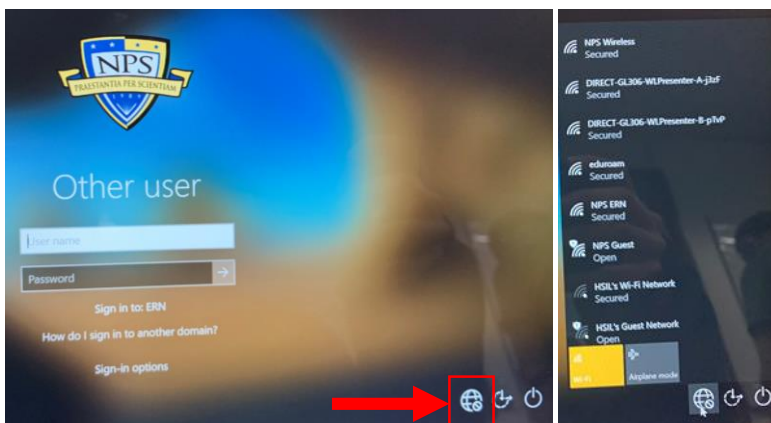

Select the network icon.

Select "NPS Wireless" from the list of available networks.

Provide your CAS credentials to login.

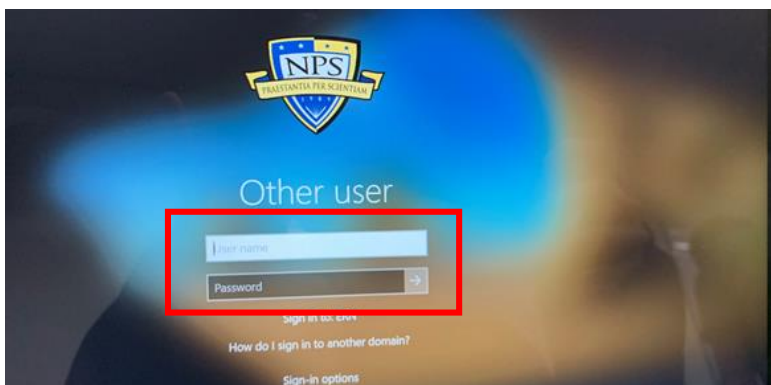

Log-in using your standard CAS log-in credentials as you would do on a standard classroom PC.

Display Content from GL 306 Classroom Laptop

The classroom laptop is NOT wired to the classroom AV system. In order to display content you will need to connect to the wireless presenter. In GL306 there are two wireless presenter systems available. On the AV controller select either ALPHA or BRAVO as the source and select a display you wish you use, either the front or rear display (additional instructions provided in the *GL 306 AV Startup Tutorial*).

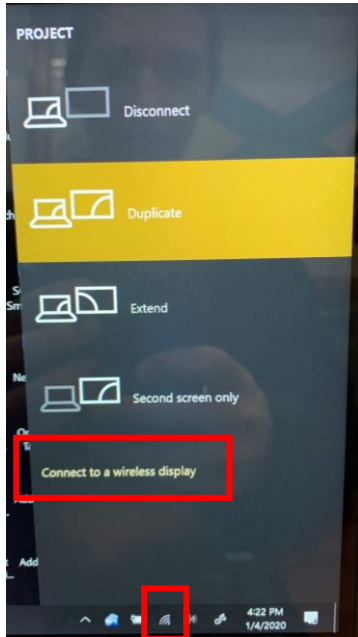

On the Classroom Laptop:

Make sure you are connected to “NPS Wireless” network

Press the F4 key to access the Project Menu.

Select “Connect to a wireless display”

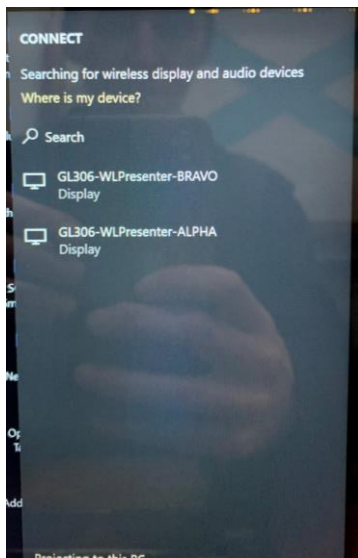

Select the Wireless Presenter you wish to utilize: ALPHA or BRAVO.

If additional assistance is needed please refer to Wireless Presenter Quick Start Guide.