

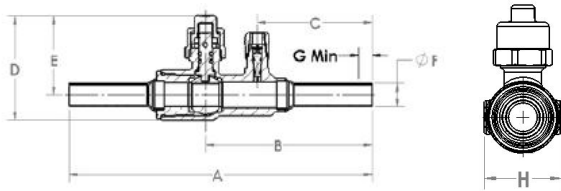

Features:

- Design Pressure (DP) / Maximum abnormal pressure (MAP): 775 psig, 53 bar
- Continuous operating temperature (COT): -40°F/300°F, -40°C/149°C
- Contact factory or visit website for compatibility with CFC, HCFC, HFC and HFO refrigerants and oils
- Full port construction to match line size ID
- Internally equalized ball design
- Rupture-proof encapsulated stem
- MCM Seal Technology
- UL/cUL Listed, Conforms to EU Pressure Equipment Directive and UK Pressure Equipment Regulation, CRN 0C1241.9C
- Tube extensions meet ASTM B280 specifications for size



Part Number	Valve Insulation Kit Part Number	Size		Cv	Kv	A		B		C		D		E		F		G Min		Wt		Seal Cap Kit	Insulation Cover
		in	mm			in	mm	in	mm	in	mm	in	mm	in	mm	in	mm	in	mm	lb	kg		
A 18959	A 19101U	1/4	6	1.0	1	6.51	165	3.62	92	2.52	64	2.23	57	1.69	43	0.25	6	0.38	10	0.69	0.31	A 17842	MSBVINSCEN
A 18960	A 19102U	3/8	10	4.0	3	6.15	156	3.44	87	2.34	59	2.23	57	1.69	43	0.38	10	0.38	10	0.61	0.28	A 17842	MSBVINSCEN
A 18961	A 19103U	1/2	13	5.0	4	6.43	163	3.54	90	2.44	62	2.23	57	1.69	43	0.50	13	0.44	11	0.59	0.27	A 17842	MSBVINSCEN
A 18962	A 19104U	5/8	17	10.0	9	6.07	154	3.36	85	2.26	57	2.23	57	1.69	43	0.63	16	0.56	14	0.62	0.28	A 17842	MSBVINSCEN

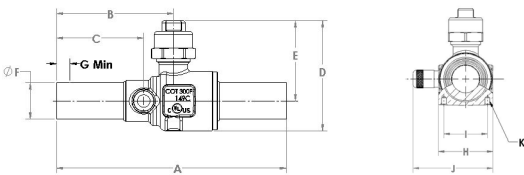

Part Number	Size	Cv	Kv	A		B		C		D		E		F		G Min		H		I		J		K		Wt		Seal Cap Kit
				in	mm	in	mm	in	mm	in	mm	in	mm	in	mm	in	mm	in	mm	in	mm	in	mm	in	mm	in	mm	
A 18963	3/4	19	19.0	16	6.12	155	3.11	79	2.39	61	2.66	68	1.94	49	0.75	19	0.69	18	2.17	55	1.18	30	2.17	55	M4 X 0.7	0.86	0.39	A 17843
A 18964	7/8	22	27.5	24	5.54	141	2.82	72	2.10	53	2.66	68	1.94	49	0.88	22	0.81	21	2.17	55	1.18	30	2.17	55	M4 X 0.7	0.87	0.39	A 17843

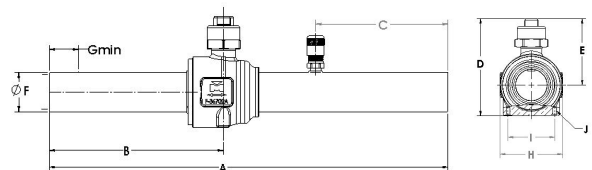
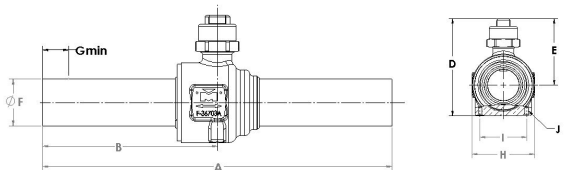

Standard

Standard, with Access

Part Number	Size	Cv	Kv	A		B		C		D		E		F		G Min		H		I		J		Port	Wt		Seal Cap Kit
				in	mm	in	mm	in	mm	in	mm	in	mm	in	mm	in	mm	in	mm	in	mm	in	mm		lb	kg	
AF17865	* 1 1/8	29	54.0	47	11.30	287	4.94	125			3.15	80	2.15	55	1.13	29	0.97	25	2	51	1.50	38	M4 X 0.7	1.00	1.71	0.78	A 17843
AF17866	* 1 3/8	35	89.1	77	10.20	259	5.10	130			3.72	94	2.55	65	1.38	35	1.03	26	2.34	59				1.25	3.17	1.44	A 17844
AG17865	** 1 1/8	29	54.0	47	11.30	287	4.94	125	3.75	95	3.15	80	2.15	55	1.13	29	0.97	25	2	51	1.50	38	M4 X 0.7	1.00	1.78	0.81	A 17843
AG17866	** 1 3/8	35	89.1	77	10.20	259	5.10	130	2.25	57	3.72	94	2.55	65	1.38	35	1.03	26	2.34	59				1.25	2.60	1.18	A 17844

* Standard
** Standard, with Access