

















































MARYLAND STATE HIGHWAY ADMINISTRATION

ROAD INVENTORY SHEET

Party Chief BB  
 Recorder MB  
 Assistant \_\_\_\_\_  
 Map No./Dir. 1  
 State Coordinates \_\_\_\_\_

Road No. MD 214  
 Road Name CENTRAL AVE  
 County P. G.  
 Date 3-12-97  
 Sheet No. 17 OF 28

TRAFFIC CONTROLS: STOP SIGN-SS,  
 TRAFFIC LIGHT-T.L.,  
 FLASHING RED BALL-F.R.

PARKING RESTRICTIONS: A.M. PEAK,  
 P.M. PEAK, A.M./P.M. PEAK, NO PARKING  
 ANYTIME=N.P., COMM/IND. ACCESS=E

SYSTEM				TRAFFIC			LINE DIAGRAM				TRAFFIC			PAVEMENT DATA
FUNC'T CLASS	HWY SYS	HPMS SAMPLE	PREC. REST.	COM/IND ACCESS	CONTROL	COM/IND ACCESS	PREC. REST.							
URBAN Other Principal Arterial State Secondary														
											2-24' I			
											7-10' I SHD Out			
											24' Grass MEF			
											JC-C In			
											4 ML			

# LINE DIAGRAM

SYSTEM				TRAFFIC		TRAFFIC				PAVEMENT DATA	
FUNCI CLASS	HWY SYS	HPMS SAMPLE	PRG. REST.	COM/IND ACCESS	PRG. REST.	CONTR.	COM/IND ACCESS	PRG. REST.	CONTR.	COM/IND ACCESS	PRG. REST.
URBAN Other Principal Arterial											
State Secondary											
<div style="display: flex; justify-content: space-between;"> <div style="width: 45%;"> <p>CORD LIMITS of Bowie</p> <p>← 12' IZ DE 12' IZ LTD →</p> <p>CHURCH RD</p> <p>Co 59 TL</p> <p>12' I ACC 12' I LTD</p> </div> <div style="width: 50%; text-align: right;"> <p>8 79 ST=45 MPH</p> <p>8 75</p> <p>8 64 9</p> <p>8 66</p> <p>8 64 59</p> <p>8 62</p> <p>8 61</p> <p>DEC on SHD</p> <p>8 54</p> <p>8 50</p> <p>8 33</p> </div> </div>											
2-24' I 2-10' I SHD OUT 24' Grass MED JC-c In 4 ML X											
2-24' I 2-10' I SHD OUT 2-4' I SHD In 18' Grass MED 4 ML X											





























SYSTEM				TRAFFIC		LINE DIAGRAM			TRAFFIC			PAVEMENT DATA	
FED. AID.	FUNCT. CLASS.	HWY. SYS.	HPMS SAMPLE	PRKG. REST.	COM/IND ACCESS				CONTROL	COM/IND ACCESS	PRKG. REST.		
						PATUXENT RIVER RD							
						↑							
						0.66							
						BR# 2045							
						1345	AA COUNTY						
						1343	PATUXENT PG CO						
						1341	LINE RIVER						
							30' JCA						24' I
							JUNKYARD						2-5' G
							12' JCA						2 ML
							13 26						
							13 22						
							E X						
							Rural minor Arterial						
							State Secondary						



SR-01  
L-19-01  
GOLCF

DT/TT  
2-2-95  
94 MU  
EX 2

ROAD INVENTORY SHEET

Party Chief B. BALZANNA  
Recorder G. WILLIAMS  
Assistant \_\_\_\_\_  
Map No./Dir. E-11 / N  
State Coordinates 840-460

Road No. MD 216  
Road Name SEVENTH ST  
County PRINCE GEORGES  
Date 7/28/93  
Sheet No. 1 OF 3

BB/AL  
9-11-77  
STRI

TRAFFIC CONTROLS: STOP SIGN=SS,  
TRAFFIC LIGHT=T.L.,  
FLASHING RED BALL=F.R.

TRAFFIC CODES  
PARKING RESTRICTIONS: A.M. PEAK,  
P.M. PEAK, A.M./P.M. PEAK, NO PARKING  
ANYTIME=N.P., COMM/IND. ACCESS=E

SYSTEM				TRAFFIC			LINE DIAGRAM				TRAFFIC			PAVEMENT DATA	
FED. AID.	FUNCT. CLASS.	HWY. SYS.	HPMS SAMPLE	PRKG. REST.	COM/IND. ACCESS		CONTROL	COM/IND. ACCESS	PRKG. REST.						
						LAUREL Ave (#1)								30'I JCC 2ML	
						MU 024 0211									
						CARROLL AVE									
						MU 0080									
						TALBOT Ave									
						MU 011 198 (W.B.) ←									
						COMPTON AVE									
						MU 0090									
						GORMAN Ave									
						MU 000 198 (E.B.)									

UPBAY collector  
Municipal - TUBBED MD 216  
Mun. Tapped MD 216 (M.O.A. 10-06-94)

WILTL  
IRITL

NP

F

F

F

K

F

F

F

F

K

TL

E

TL

X

X

X

X

Y

# LINE DIAGRAM

SYSTEM		TRAFFIC		LINE DIAGRAM	TRAFFIC		PAVEMENT DATA
FED. AID.	FUNCT. CLASS.	PRKG. REST.	COM/IND ACCESS		CONTROL	COM/IND ACCESS	
	URBAN minor Arterial						25' I RT
							12' I LT
							4' J MED
							JCC 10' I RT
							3 ML
				0.57 SL = 4 mph			
				12' I RT			
				12' I LT			
				MAIN ST			
				MU 0.52 0.230	TL	X	2-22' I
							TC-C
							6' GRS MED
							4 UML
				0.49		BSX	
				SL = 2.5 mph			
				0.46			
				0.44			26' I ON TARI
							To 48' I
				PRINCE GEORGE ST (#1)			JC-C
				0.42 MU 0.351		X	2 ML
				ALLEY #7			36' I
				0.39 MU 0.090			JC-C
							2 ML
				MONTGOMERY AVE ST			
				MU 0.35 0.260	SS	X	
				ALLEY #15			
				MU 0.150 0.33			
				PARK AVE (#2)			
				MU 0.30 0.303			30' I
							JC-C
							2 UML

URBAN collector  
 Municipal - Tabbed as MO 216  
 Mun - 10-05-84 MD 216 (M.O.A. 10-06-84)  
 NP

NP

BSX

NP

SS

X

X

X

ROAD INVENTORY SHEET

Party Chief BB  
 Recorder GW  
 Assistant \_\_\_\_\_  
 Map No./Dir. E-11 / N  
 State Coordinates \_\_\_\_\_

Road No. MD 216  
 Road Name SEVENTH ST  
 County PG  
 Date 7/28/93  
 Sheet No. 3 OF 3

TRAFFIC CONTROLS: STOP SIGN=SS,  
 TRAFFIC LIGHT=T.L.,  
 FLASHING RED BALL=F.R.

TRAFFIC CODES  
 PARKING RESTRICTIONS: A.M. PEAK,  
 P.M. PEAK, A.M./P.M. PEAK, NO PARKING  
 ANYTIME=N.P., COMM/IND. ACCESS=E

SYSTEM				TRAFFIC				LINE DIAGRAM				TRAFFIC				PAVEMENT DATA	
FED. AID.	FUNCT. CLASS.	HWY. SYS.	HPMS SAMPLE	PRKG. REST.	COMM/IND. ACCESS	CONTROL	COMM/IND. ACCESS	PRKG. REST.					CONTROL	COMM/IND. ACCESS	PRKG. REST.		
									BALTIMORE AVE								
									0.09								
									0.62								
									0.59								
									4' LANE								
									STP #12								
									C/LINE								
									C/LINE								
									PAVEMENT								
									12' I RTL								
									URBAN minor Arterial								
									State Secondary								
									MD								
									2-26' I								
									16' J MED								
									JC-C/W/O/T								
									4ML								
									25' I RT								
									12' I LT								
									4' J MED								
									JC-C/W/O/T								
									3ML								











































ROAD INVENTORY SHEET

Party Chief G. DAVIS  
Recorder G. WILLIAMS  
Assistant \_\_\_\_\_  
Map No./Dir. G-12 / N  
State Coordinates \_\_\_\_\_

Road No. MD 223  
Road Name WARDYARD RD  
County PRINCE GEORGES  
Date 7/17/93  
Sheet No. 15 OF 21

TRAFFIC CONTROLS: STOP SIGN=S.S.  
TRAFFIC LIGHT=L.L.,  
FLASHING RED BALL=F.R.

TRAFFIC CODES  
PARKING RESTRICTIONS: A.M. PEAK,  
P.M. PEAK, A.M./P.M. PEAK, NO PARKING  
ANYTIME=N.P., COMM/IND. ACCESS=E

SYSTEM				TRAFFIC		LINE DIAGRAM						TRAFFIC			PAVEMENT DATA
FED. AID.	FUNCT CLASS	HWY. SYS.	HMMS SAMPLE	PRKG. REST.	COM/IND. ACCESS							CONTROL	COM/IND. ACCESS	PRKG. REST.	
							932			EXIT TO CEN		E			
										HUNTER DR					
							924								
										LANTERN LA					
										Co 1871	922				
							918								
										EXIT TO CEN					
							917			CHURCH		E			
							915								
										GREEN ST					
										Co 1870	909				
										COLONIAL LA					
										Co 937	900				
										SWEENEY DR					
										897 Co 2549					
										RICHARDSON RD					24'I
										577 OP 158					2-2'I FAD
															2ML
										DEBORAH ST					
										866 Co 3074					X
															40'I
															JC-C
															2ML

Other URBAN Principal Arterial  
State Secondary

E

X













































MARYLAND STATE HIGHWAY ADMINISTRATION

ROAD INVENTORY SHEET

Party Chief G. DAVIS  
 Recorder A. HATTEN  
 Assistant \_\_\_\_\_  
 Map No./Dir. F-11 B / N  
 State Coordinates \_\_\_\_\_

Road No. MD 295  
 Road Name BALTIMORE WASHINGTON PKWY  
 County PRINCE GEORGES  
 Date 10-15-93  
 Sheet No. 9 OF 14

TRAFFIC CONTROLS: STOP SIGN=S.S.,  
 TRAFFIC LIGHT=T.L.,  
 FLASHING RED BALL=F.R.

TRAFFIC CODES  
 PARKING RESTRICTIONS: A.M. PEAK,  
 P.M. PEAK, A.M./P.M. PEAK, NO PARKING  
 ANYTIME=N.P., COMM/IND. ACCESS=E

SYSTEM				TRAFFIC				LINE DIAGRAM				TRAFFIC				PAVEMENT DATA	
FED. AID.	FUNCT. CLASS.	HWY. SYS.	IRMS SAMPLE	PKG. BEET.	COM/IND. ACCESS	CONTROL	COM/IND. ACCESS	PKG. BEET.					CONTROL	COM/IND. ACCESS	PKG. BEET.		
									RAMP 8 RAMP 7 RAMP 2 GREENBELT RD MD GREEN DALE RD 193 = PFH09 12' I 12' I 12' I 12' I							UNDER HEAVY CONSTRUCTION 2-24' I 2-8' I SHO OUT 5 (C-C) OUT 100'-4' NB MED 4 ML 20' SHO	

NHS  
 URBAN Freeway Expressway  
 State Primary  
 20295000599



















































ROAD INVENTORY SHEET

BB/AL/MP  
10-8-97  
ST R I.  
SHA01  
7-17-01  
B01EF

Party Chief G. DAVIS  
Recorder A. HATTEN  
Assistant \_\_\_\_\_  
Map No./Dir. 1  
State Coordinates 20-402

Road No. RAMP 4  
Road Name NB 295 TO MD 202 B CO 4853  
County P.G  
Date 10-18-19  
Sheet No. 1 OF 1

TRAFFIC CONTROLS: STOP SIGN=S.S.,  
TRAFFIC LIGHT=T.L.,  
FLASHING RED BALL=F.R.

TRAFFIC CODES  
PARKING RESTRICTIONS: A.M. PEAK,  
P.M. PEAK, A.M./P.M. PEAK, NO PARKING  
ANYTIME=N.P., COMM/IND. ACCESS=E

SYSTEM			TRAFFIC		LINE DIAGRAM		TRAFFIC		PAVEMENT DATA
FED. AID.	FUNCT CLASS.	HWY. SYS.	PRKG. REST.	COMM/IND. ACCESS	CONTROL	COMM/IND. ACCESS	PRKG. REST.		
					Cheverly				
					(NO NAME) MERCY LANE				
					APT MD 202 B 005 CO 4853				
					RAMP 1				
					45°				
					PC				
					0.02				19 5'I J CERT X IML
					0.03				30'I J C C IML
					X				18'I IML J CRT
					MD				
					0.00				
					X				
					295				





















Under Construction.  
RI. 88-01  
10-8-97 7-30-98  
BB  
AL  
MD  
CO 302

R/22950040351

ROAD INVENTORY SHEET

Party Chief G. DAVIS  
Recorder A. HATTEN  
Assistant \_\_\_\_\_  
Map No./Dir. F-11D / N  
State Coordinates 827-411

Road No. RAMP 4  
Road Name NB 295 TO RIVERDALE RD  
County PRINCE GEORGES  
Date 10-8-93  
Sheet No. 1 OF 1

TRAFFIC CONTROLS: STOP SIGN=S.S.<sub>7</sub>  
TRAFFIC LIGHT=T.L.,  
FLASHING RED BALL=F.R.

TRAFFIC RESTRICTIONS: A.M. PEAK,  
P.M. PEAK, A.M./P.M. PEAK, NO PARKING  
ANYTIME=N.P., COMM/IND., ACCESS=E

SYSTEM				TRAFFIC			LINE DIAGRAM				TRAFFIC		PAVEMENT DATA	
FED. AID.	FUNCT. CLASS.	HYD. SYS.	HPMS SAMPLE	PKG. REST.	COM/IND.	ACCESS	CONTROL	COM/IND.	ACCESS	PKG. REST.				

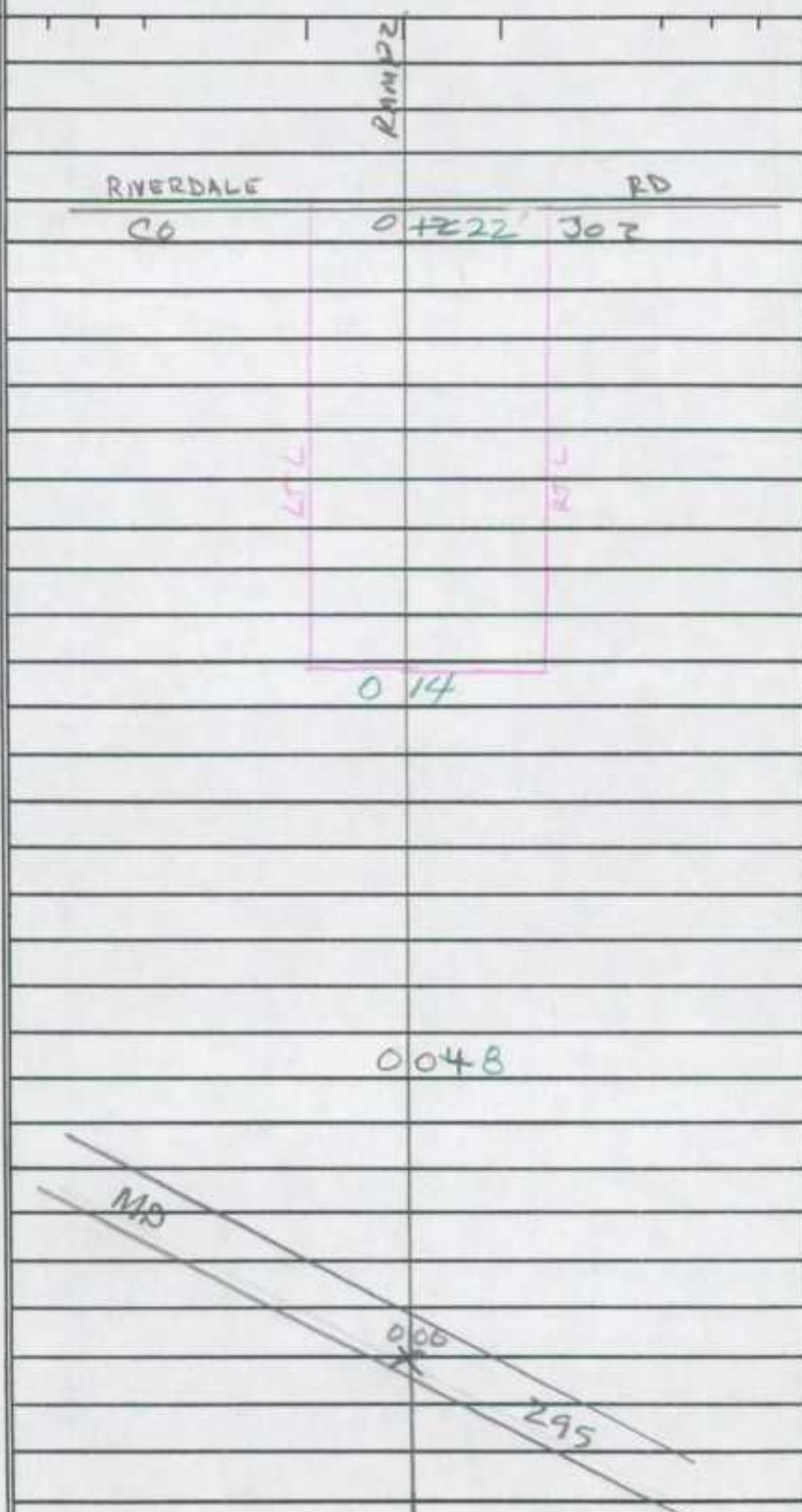

CONTROL	COM/IND.	ACCESS	PKG. REST.

32' I  
J-C-G  
1ML  
24'  
20'I  
2ML  
J-C-G.  
20'I  
2ML  
J-C-RF



RP 22950060353  
Under construction  
RI  
10-8-97  
BB  
AL  
MP  
SR of  
T-20  
6000

ROAD INVENTORY SHEET

Party Chief G. DAVIS  
Recorder A. HATTEN  
Assistant \_\_\_\_\_  
Map No./Dir. F-11D/5  
State Coordinates 827-411

Road No. RAMP 6  
Road Name FR RIVERDALE RD TO SB MD 295  
County PRINE GEORGES  
Date 10-8-93  
Sheet No. 1 OF 1

TRAFFIC CONTROLS: STOP SIGN=S, S<sub>v</sub>  
TRAFFIC LIGHT=L, L<sub>v</sub>  
FLASHING RED BALL=F.R.

TRAFFIC CODES  
PARKING RESTRICTIONS: A.M. PEAK,  
P.M. PEAK, A.M./P.M. PEAK, NO PARKING  
ANYTIME=N.P., COMM/IND. ACCESS=E

SYSTEM				TRAFFIC		LINE DIAGRAM			TRAFFIC		PAVEMENT DATA	
FED. AID.	FUNCT CLASS.	HWY. SYS.	HPMS SAMPLE	PRKG. REST.	COMM/IND. ACCESS				CONTROL	COMM/IND. ACCESS	PRKG. REST.	
						<u>RIVERDALE RD</u> <u>CO 302 000 MD 410</u>			TL			20 15'I 1ML J.C.C.
						<u>RAMP</u>						





ROAD INVENTORY SHEET

RP 22950080375  
Under construction.  
RI  
10-8-97  
BB  
AL  
MP  
5901  
7-20-98  
601EF

Party Chief G. DAVIS  
Recorder A. HATTEN  
Assistant \_\_\_\_\_  
Map No./Dir. F-11 D / S  
State Coordinates B27-411

Road No. RAMP 8  
Road Name FR 53 295 RD RIVERDALE RD  
County PRINCE GEORGES  
Date 10-18-93  
Sheet No. 1 OF 1

TRAFFIC CONTROLS: STOP SIGN=S  
TRAFFIC LIGHT=T.L.,  
FLASHING RED BALL=F.R.

TRAFFIC CODES  
PARKING RESTRICTIONS: A.M. PEAK,  
P.M. PEAK, A.M./P.M. PEAK, NO PARKING  
ANYTIME=N.P., COMM/IND. ACCESS=E

SYSTEM				TRAFFIC			LINE DIAGRAM					TRAFFIC				PAVEMENT DATA	
FED. AID.	FUNCT CLASS.	HWY. SYS.	HPMS SAMPLE	PRG. REST.	COM/IND. ACCESS		CONTROL	COM/IND. ACCESS	PRG. REST.								

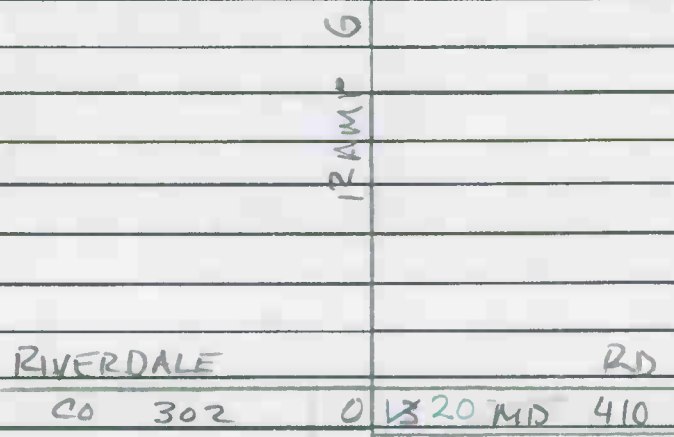

36  
26' I  
2 ML  
J C C  
X  
16 I  
1 ML  
J C RT  
Y



















































ROAD INVENTORY SHEET

Party Chief GD  
 Recorder GW  
 Assistant \_\_\_\_\_  
 Map No./Dir. H-11 / N  
 State Coordinates \_\_\_\_\_

Road No. US 301 / MD 5  
 Road Name CRAWN Hvy  
 County PG  
 Date 8/19/93  
 Sheet No. 3 OF 35

TRAFFIC CONTROLS: STOP SIGN=S.S.,  
 TRAFFIC LIGHT=T.L.,  
 FLASHING RED BALL=F.R.

TRAFFIC CODES  
 PARKING RESTRICTIONS: A.M. PEAK,  
 P.M. PEAK, A.M./P.M. PEAK, NO PARKING  
 ANYTIME=N.P., COMM/IND. ACCESS=E

SYSTEM				TRAFFIC		LINE DIAGRAM	TRAFFIC		PAVEMENT DATA
FED. AID.	FUNCT. CLASS.	HWY. SYS.	HPMS SAMPLE	PRKG. REST.	COM/IND. ACCESS		CONTROL	COM/IND. ACCESS	
						170			2-24" T
				4E		164			<del>2-14" T</del>
						163			<del>2-14" T</del>
						158			<del>2-14" T</del>
				2E		154			<del>2-14" T</del>
				E		151			<del>2-14" T</del>
						143			
						124			36" RCP
						122			
						117			
						107			
									2-30" T
									2-14" T
									12" T HD
									12" T HD
									2-14" T
									2-14" T
									30" GRS MED
									4-6" GML

N.H.S.  
 Rural Other Principal Arterial  
 State Primary

10301000000





ROAD INVENTORY SHEET

Party Chief GD  
Recorder GW  
Assistant \_\_\_\_\_  
Map No./Dir. H-1 / N  
State Coordinates \_\_\_\_\_

Road No. US 301 / MD5  
Road Name CRAW  
County PG  
Date 7/19/93  
Sheet No. 5 OF 35

TRAFFIC CONTROLS: STOP SIGN=SS,  
TRAFFIC LIGHT=T.L.,  
FLASHING RED BALL=F.R.

TRAFFIC CODES  
PARKING RESTRICTIONS: A.M. PEAK,  
P.M. PEAK, A.M./P.M. PEAK, NO PARKING  
ANYTIME=N.P., COMM/IND. ACCESS=E

SYSTEM				TRAFFIC				TRAFFIC				PAVEMENT DATA																									
FED. AID.	FUNCT. CLASS.	HWY. SYS.	HPMS SAMPLE	PRKG. REST.	COM/IND. ACCESS	CONTROL	COM/IND. ACCESS	PRKG. REST.																													
N.H.S. Rural Other Principal Arterial State Primary								ONE WAY US 301 NB US 301/MD5 SHORCUT RD Co 164 J-C-INT ON SHD RTZ				260		24'I																							
				255		246						245		241		230		229		228		227		226		225		224		223		222		221		220	
				250		246						245		241		230		229		228		227		226		225		224		223		222		221		220	
				246		245						241		230		229		228		227		226		225		224		223		222		221		220			
				245		241						230		229		228		227		226		225		224		223		222		221		220					
				241		230						229		228		227		226		225		224		223		222		221		220							
				230		229						228		227		226		225		224		223		222		221		220									
				229		228						227		226		225		224		223		222		221		220											
				228		227						226		225		224		223		222		221		220													
				227		226						225		224		223		222		221		220															
226		225		224		223		222		221		220																									
225		224		223		222		221		220																											
224		223		222		221		220																													
223		222		221		220																															
222		221		220																																	
221		220																																			
220																																					

TRAFFIC CODES: STOP SIGN=SS, TRAFFIC LIGHT=T.L., FLASHING RED BALL=F.R.

TRAFFIC CODES: PARKING RESTRICTIONS: A.M. PEAK, P.M. PEAK, A.M./P.M. PEAK, NO PARKING ANYTIME=N.P., COMM/IND. ACCESS=E

PAVEMENT DATA:  
 24'I  
 10' I SHORT  
 2ML  
 36'I RT  
 24'I LT  
 2-10'I shd  
 2-4'I shd  
 22' GR5 MED  
 5ML  
 2-24'I  
 2-10'I SHORT  
 2-4'I SHORT  
 22' GR5 MED  
 4ML









ROAD INVENTORY SHEET

Party Chief GD  
 Recorder GW  
 Assistant \_\_\_\_\_  
 Map No./Dir. H-12 / N  
 State Coordinates \_\_\_\_\_

Road No. US 301  
 Road Name CRAIN Hwy  
 County PG  
 Date 8/19/93  
 Sheet No. 9 OF 35

TRAFFIC CONTROLS: STOP SIGN=SS,  
 TRAFFIC LIGHT=T.L.,  
 FLASHING RED BALL=F.R.

TRAFFIC CODES  
 PARKING RESTRICTIONS: A.M. PEAK,  
 P.M. PEAK, A.M./P.M. PEAK, NO PARKING  
 ANYTIME=N.P., COMM/IND. ACCESS=E

SYSTEM					TRAFFIC			TRAFFIC			PAVEMENT DATA																																
FED. AID.	FUNCT. CLASS.	HWY. SYS.	HPMS SAMPLE	PRKG. REST.	COM/IND. ACCESS	CONTROL	COM/IND. ACCESS	PRKG. REST.																																			
NHS Rural Other Principal Arterial State Primary 103010000484					E			<h3 style="margin: 0;">LINE DIAGRAM</h3>					E E 2-24'I 2-10'I SHD 2-4'I 60' GA 4ML																														
								585			579					571			562			548			532			519			514			511			506			500			





ROAD INVENTORY SHEET

Party Chief GD  
 Recorder GW  
 Assistant \_\_\_\_\_  
 Map No./Dir. H-12/G12/N  
 State Coordinates \_\_\_\_\_

Road No. US 301  
 Road Name CRAIN HWY  
 County PG  
 Date 8/20/93  
 Sheet No. 11 OF 35

TRAFFIC CONTROLS: STOP SIGN=SS,  
 TRAFFIC LIGHT=T.L.,  
 FLASHING RED BALL=F.R.

TRAFFIC CODES  
 PARKING RESTRICTIONS: A.M. PEAK,  
 P.M. PEAK, A.M./P.M. PEAK, NO PARKING  
 ANYTIME=N.P., COMM/IND. ACCESS=#

SYSTEM				TRAFFIC				LINE DIAGRAM				TRAFFIC				PAVEMENT DATA	
FED. AID.	FUNCT CLASS.	HWY. SYS.	HPMS SAMPLE	PRKG. REST.	COM/IND. ACCESS	CONTROL	COM/IND. ACCESS	PRKG. REST.	LINE NO.	TYPE	TRAFFIC	PRKG. REST.	PAVEMENT	THICKNESS			
									732								
									727								
									717								
									716								
									712								
									701								
									700								
									687								
									681								
									676								
									672								
									669								
									664								
													2-24" I				
													2-10" I SHD				
													2-4" I SHD IN				
													60' GRASS				
													4ml				

Rural Other Principal Arterial  
 State Primary  
 103010000484

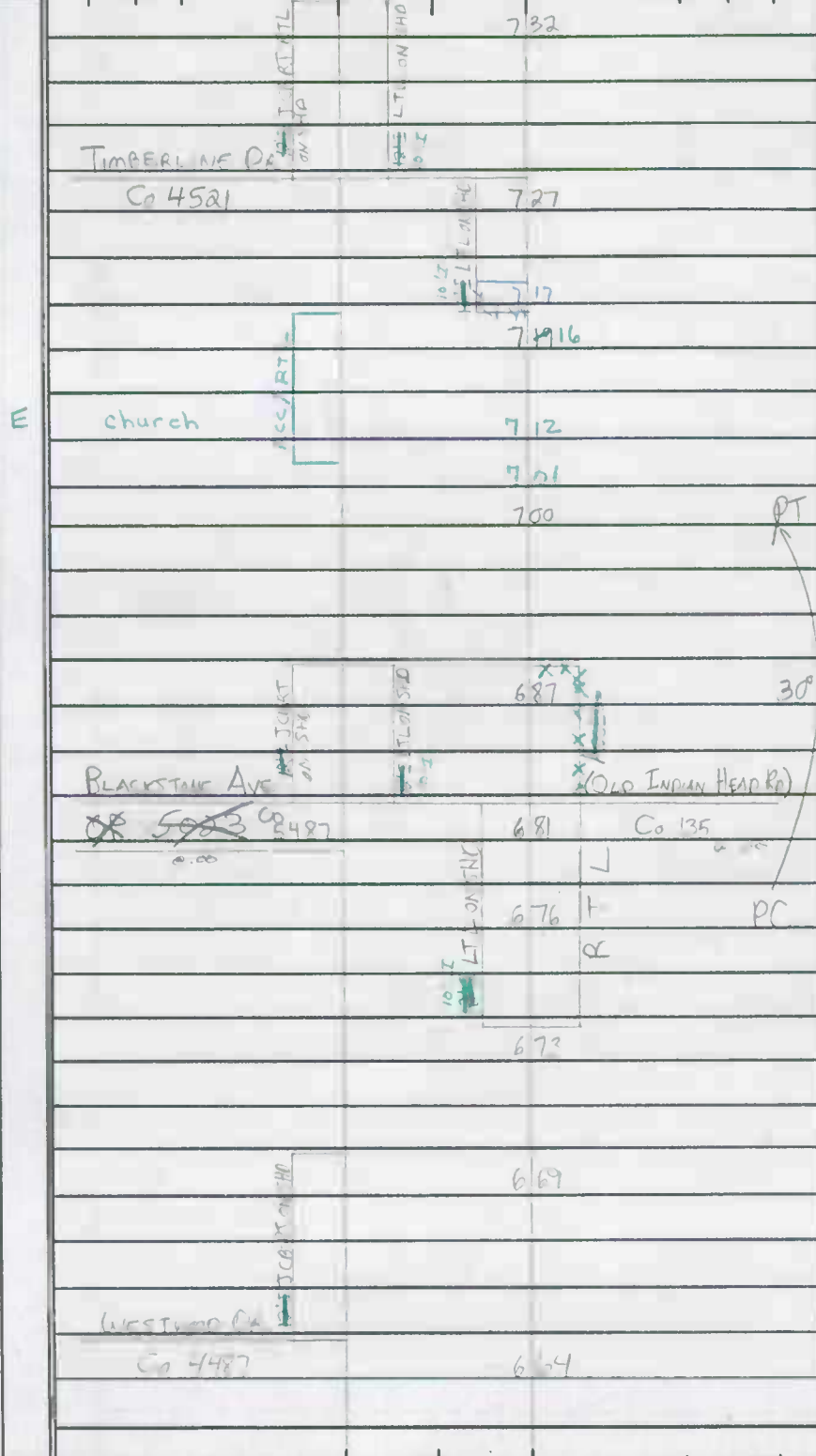

PAVEMENT DATA

2-24" I  
 2-10" I SHD  
 2-4" I SHD IN  
 60' GRASS  
 4ml

SYSTEM				TRAFFIC		LINE DIAGRAM	TRAFFIC			PAVEMENT DATA
FED. AID.	FUNCT. CLASS.	HWY. SYS.	HPMS SAMPLE	PRG. REST.	COM/IND ACCESS		CONTROL	COM/IND ACCESS	PRG. REST.	
						818				
						RTL				
						816				
						RTL				
						813				
						RTL				
						806				
						789				
						780				
						772				
						761				
						757				
						747				
						742				
						736				
									2-24 I	
									2-18 I SAND	
									2-4 I SAND	
									60' SAND	
									4ML	

NHS  
 URBAN Other Principal Arterial  
 State Primary  
 10301000-04811

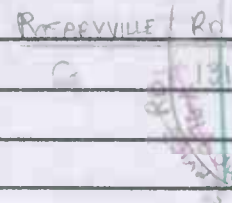

TL

mm  
34

TL ON RD







ROAD INVENTORY SHEET

99-37 ST  
G0-2F  
2-8-00

Party Chief GD  
Recorder GW  
Assistant \_\_\_\_\_  
Map No./Dir. G-12 / N  
State Coordinates \_\_\_\_\_

Road No. 1/5 301  
Road Name CRAW HWY  
County PG  
Date 8/20/93  
Sheet No. 15 OF 35

TRAFFIC CONTROLS: STOP SIGN=SS,  
TRAFFIC LIGHT=T.L.,  
FLASHING RED BALL=F.R.

TRAFFIC CODES  
PARKING RESTRICTIONS: A.M. PEAK,  
P.M. PEAK, A.M./P.M. PEAK, NO PARKING  
ANYTIME=N.P., COMM/IND. ACCESS=E

FED. AID.	SYSTEM			TRAFFIC			LINE DIAGRAM					TRAFFIC			PAVEMENT DATA
	FUNC. CLASS.	HWY. SYS.	HPMS SAMPLE	PRKG. REST.	COM/IND. ACCESS	CONTROL	COM/IND. ACCESS	PRKG. REST.	CONTROL	COM/IND. ACCESS	PRKG. REST.	CONTROL	COM/IND. ACCESS	PRKG. REST.	
	NHS	Urban	Other Principal Arterial												
			State												
			Primary												

2-24 I  
2-12' F  
2-12' I SH  
JCB ATT  
JCB ATT  
4ML  
X

2-24 I  
2-10' F  
2-4' F SH  
32' GRS MED  
4ML GR

16 of 35

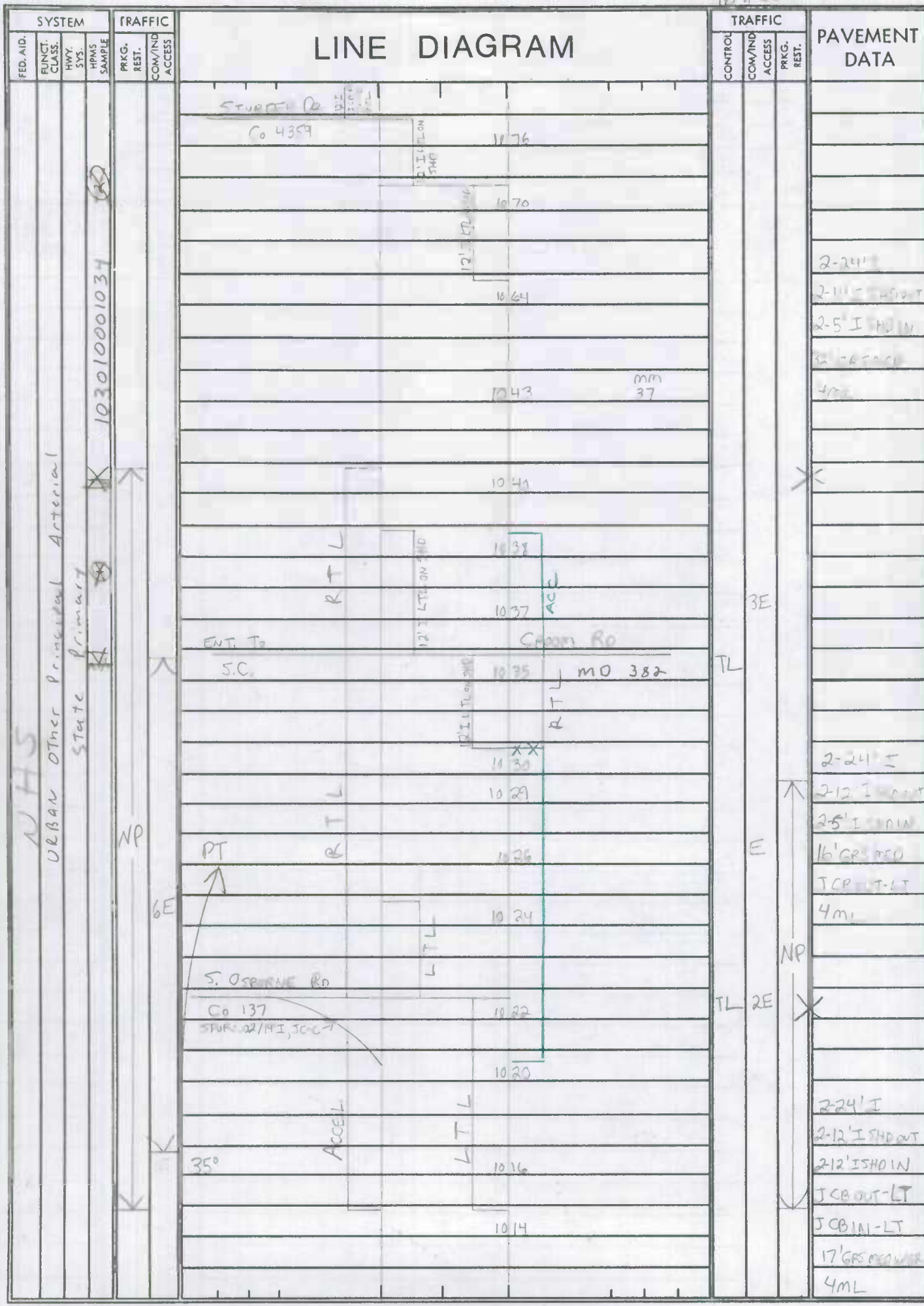

# LINE DIAGRAM

### TRAFFIC

### PAVEMENT DATA

FED. AID. SYSTEM  
FUNCT. CLASS. HWY. SYS.  
HPMS SAMPLE  
PRKG. REST. COM/IND ACCESS

CONTROL COM/IND ACCESS PRKG. REST.

103010001034

URBAN Other Principal Arterial  
State Primary

2-24" I  
2-11" I SHO OUT  
2-5" I SHO IN  
32' GRASS  
4ML  
  
2-24" I  
2-12" I SHO OUT  
2-5" I SHO IN  
16' GRASS  
JCB OUT-LT  
4ml  
  
2-24" I  
2-12" I SHO OUT  
2-12" I SHO IN  
JCB OUT-LT  
JCB IN-LT  
17' GRASS  
4ML

NHS

NP

6E

PT

ACCEL

LTL

1016

1014

1020

1022

1024

1026

1029

1130

1035

1037

1039

1041

1043

1064

1070

1076

TL

3E

E

NP

TL

2E

X

X



ROAD INVENTORY SHEET

Party Chief GD  
 Recorder GW  
 Assistant \_\_\_\_\_  
 Map No./Dir. G-12 / N  
 State Coordinates \_\_\_\_\_

Road No. US 301  
 Road Name Cross Hwy  
 County PG  
 Date 8/20/93  
 Sheet No. 17 OF 35

TRAFFIC CONTROLS: STOP SIGN=SS,  
 TRAFFIC LIGHT=T.L.,  
 FLASHING RED BALL=F.R.

TRAFFIC CODES  
 PARKING RESTRICTIONS: A.M. PEAK,  
 P.M. PEAK, A.M./P.M. PEAK, NO PARKING  
 ANYTIME=N.P., COMM/IND. ACCESS=E

SYSTEM				TRAFFIC				LINE DIAGRAM				TRAFFIC				PAVEMENT DATA
FED. AID.	FUNCT. CLASS.	HWY. SYS.	HPMS SAMPLE	PRKG. REST.	COMM/IND. ACCESS	CONTROL	COMM/IND. ACCESS	PRKG. REST.	LINE NO.	LINE NO.	CONTROL	COMM/IND. ACCESS	PRKG. REST.	PAVEMENT DATA		
									1119							
									1115							
									1113							
									1111							
									1110							
									1103							
									1100							
									1097							
									1095							
									1083							
									1081							
														2-24' I		
														2-11' SHI CUT		
														2-5' TYPICAL		
														32' GRASS		
														4ML		

URBAN Other Principal Arterial  
 State Primary  
 103010001034

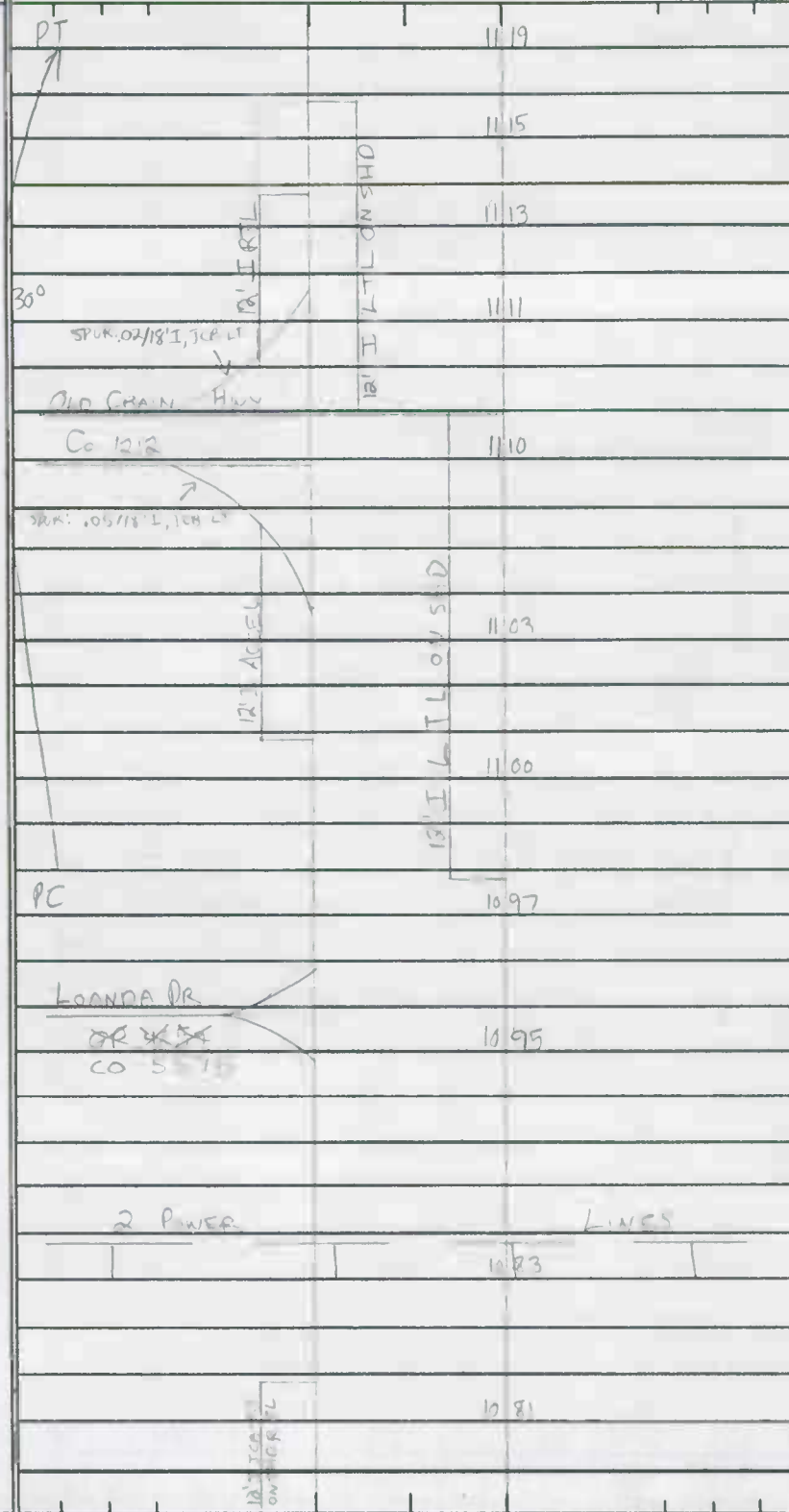

TRAFFIC CODES  
 PARKING RESTRICTIONS: A.M. PEAK,  
 P.M. PEAK, A.M./P.M. PEAK, NO PARKING  
 ANYTIME=N.P., COMM/IND. ACCESS=E

























99-32 ST  
60-2F  
2-8-00

ROAD INVENTORY SHEET

Party Chief GD  
Recorder GW  
Assistant \_\_\_\_\_  
Map No./Dir. G-12 / N  
State Coordinates \_\_\_\_\_

Road No. 115 301  
Road Name CRAIN Hwy  
County PG  
Date 8/23/93  
Sheet No. 27 OF 35

TRAFFIC CONTROLS: STOP SIGN=SS,  
TRAFFIC LIGHT=T.L.,  
FLASHING RED BALL=F.R.

TRAFFIC CODES  
PARKING RESTRICTIONS: A.M. PEAK,  
P.M. PEAK, A.M./P.M. PEAK, NO PARKING  
ANYTIME=N.P., COMM/IND. ACCESS=E

SYSTEM				TRAFFIC				TRAFFIC				PAVEMENT DATA		
FED. AID.	FUNCT. CLASS.	HWY. SYS.	HPMS SAMPLE	PRKG. REST.	COM/IND. ACCESS	CONTROL	COM/IND. ACCESS	PRKG. REST.	LINE DIAGRAM		CONTROL	COM/IND. ACCESS	PRKG. REST.	PAVEMENT DATA
										1843				
										1825				
										1812				
										1811				
										1788				
										1781				
										1773				
										1748				
										1743				2-24" E
										1737				2-16" I SHOW
										1735				2-4" I SHOW
										1732				3-16" I SHOW
										1731				4ML
										1711				4ML

NHS  
Rural Other Principal Arterial  
State Primary

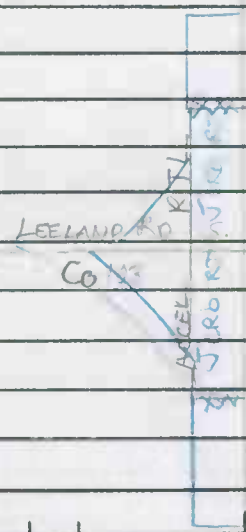

2-24" E  
2-16" I SHOW  
2-4" I SHOW  
3-16" I SHOW  
4ML





00-46 ST  
2-14-01  
G01EF

ROAD INVENTORY SHEET

Party Chief GD  
Recorder GW  
Assistant \_\_\_\_\_  
Map No./Dir. G-12/F12 / N  
State Coordinates \_\_\_\_\_

Road No. US 301  
Road Name CRAW HWY  
County PG  
Date 9/23/93  
Sheet No. 29 OF 35

TRAFFIC CONTROLS: STOP SIGN=SS,  
TRAFFIC LIGHT=T.L.,  
FLASHING RED BALL=F.R.

TRAFFIC CODES  
PARKING RESTRICTIONS: A.M. PEAK,  
P.M. PEAK, A.M./P.M. PEAK, NO PARKING  
ANYTIME=N.P., COMM/IND. ACCESS=E

SYSTEM				TRAFFIC			LINE DIAGRAM				TRAFFIC			PAVEMENT DATA	
FED. AID.	FUNCT. CLASS.	HWY. SYS.	HPMS SAMPLE	PRKG. REST.	COMM/IND. ACCESS	CONTROL	COMM/IND. ACCESS	PRKG. REST.					CONTROL	COMM/IND. ACCESS	PRKG. REST.
									<p style="text-align: center;">LINE DIAGRAM</p>						

NHS  
 Rural Other Principal Arterial  
 State Primary









ROAD INVENTORY SHEET

Party Chief GD  
 Recorder GW  
 Assistant rewritten 12-19-94 T.T.  
 Map No./Dir. F12 / N  
 State Coordinates \_\_\_\_\_

Road No. LLS 301  
 Road Name CRAIN HWY  
 County P.G  
 Date 8-24-93  
 Sheet No. 33 OF 36

SYSTEM			TRAFFIC		LINE DIAGRAM	TRAFFIC		PAVEMENT DATA
FED. AID.	FUNCT CLASS.	HWY. SYS.	PRKG. REST.	COM/IND. ACCESS		CONTROL	COM/IND. ACCESS	
					22 51		FY	24' I RT
					22 31			36' I LT
					10' I			2-10' I SHO OUT
					X-OVER	22 26		2-4' I SHO IN
					22 23			70' NB MED
					22 19			5 ML
					22 07			
					(MOUNT OAK RD)	22 01		
					MU 1915			
					12' I. 5' 8' RT			
					21 98			
					21 95			
					21 93		E	2-24' I
					21 94			2-10' I SHO OUT
								2-4' I SHO IN
								70'-320' WIDTH
								VAR NB MED
								4 ML

TRAFFIC CONTROLS: STOP SIGN=SS,  
 TRAFFIC LIGHT=T.L.,  
 FLASHING RED BALL=F.R.

PARKING RESTRICTIONS: A.M. PEAK,  
 P.M. PEAK, A.M./P.M. PEAK, NO PARKING  
 ANYTIME=N.P., COMM/IND. ACCESS=E

NHS  
 RURAL OTHER PRINCIPAL ARTERIAL  
 STATE PRIMARY  
 103010002131 (1991)

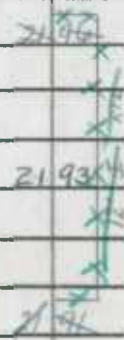









SR-01  
6-5-01  
GOLF

99-9 ST  
60/EF  
2-8-00

ROAD INVENTORY SHEET

Party Chief G. DAVIS  
Recorder G. WILLIAMS  
Assistant \_\_\_\_\_  
Map No./Dir. 11-11 / SW  
State Coordinates 837-315

Road No. US 301 (SEG. 2 of STATE LA #1)  
Road Name From MP 2.26-2.93  
County PRINCE GEORGES  
Date 8/19/93  
Sheet No. 1 OF 2

BB/AL  
9-5-97  
ST #2

TRAFFIC CONTROLS: STOP SIGN=SS,  
TRAFFIC LIGHT=T.L.,  
FLASHING RED BALL=F.R.

TRAFFIC CODES  
PARKING RESTRICTIONS: A.M. PEAK,  
P.M. PEAK, A.M./P.M. PEAK, NO PARKING  
ANYTIME=N.P., COMM/IND. ACCESS=E

SYSTEM				TRAFFIC				LINE DIAGRAM				TRAFFIC				PAVEMENT DATA	
FED. AID.	FUNCT. CLASS.	HWY. SYS.	HPMS SAMPLE	PRKG. REST.	COMM/IND. ACCESS	CONTROL	COMM/IND. ACCESS	PRKG. REST.	LINE DIAGRAM				CONTROL	COMM/IND. ACCESS	PRKG. REST.	PAVEMENT DATA	
																15' I 2-1/2" I SHO 1ml	
																24' I CH TAPER TO 14' I 2-10' I SHO 1ml	
																24' I 2-10' I SHO 2ml	

Rural Other Principal Arterial  
State Secondary

(CAUTION REFERENCE  
MP 2.26 = US 301 MP 2.93)





MARYLAND STATE HIGHWAY ADMINISTRATION  
ROAD INVENTORY SHEET

SRAI  
6-5-01  
GOLF  
99-9ST  
GD/EF  
2-8-00

Party Chief G. DAVIS  
Recorder A. HATTEN  
Assistant \_\_\_\_\_  
Map No./Dir. H-11 / SW  
State Coordinates 844-322

Road No. US 301 S GOVT OF SIGHT LA#2  
Road Name FROM MP 404 TO MP 325  
County PRINCE GEORGES  
Date 9-1-93  
Sheet No. \_\_\_\_\_ OF 3

BB/AL  
9-5-97  
ST P.I.

TRAFFIC CONTROLS: STOP SIGN=SS,  
TRAFFIC LIGHT=T.L.,  
FLASHING RED BALL=F.R.

TRAFFIC CODES

PARKING RESTRICTIONS: A.M. PEAK,  
P.M. PEAK, A.M./P.M. PEAK, NO PARKING  
ANYTIME=N.P., COMM/IND. ACCESS=E

SYSTEM				TRAFFIC		LINE DIAGRAM										TRAFFIC			PAVEMENT DATA	
FED. AID.	FUNCT. CLASS.	HWY. SYS.	HPMS SAMPLE	PRKG. REST.	COMM/IND. ACCESS											CONTROL	COMM/IND. ACCESS	PRKG. REST.		
																E			E	24'I 2-10'I SHD out 2 ML (60'-200'+VAR. N.B. MED)
						<p>X-REF.: M.P. 600 = US 301 NB MP. 424</p>														

Rural Other Principal Arterial  
State Primary





ROAD INVENTORY SHEET

Party Chief C. DAVIS  
 Recorder H. HATTEN  
 Assistant \_\_\_\_\_  
 Map No./Dir. H-11 / SW  
 State Coordinates 844 - 322

Road No. US 301 SB OUT OF SIGHT LA #2  
 Road Name FROM MP 484 TO MP 325  
 County PRINCE GEORGES  
 Date 9 - 1 - 93  
 Sheet No. 3 OF 3

TRAFFIC CONTROLS: STOP SIGN=SS,  
 TRAFFIC LIGHT=T.L.,  
 FLASHING RED BALL=F.R.

PARKING RESTRICTIONS: A.M. PEAK,  
 P.M. PEAK, A.M./P.M. PEAK, NO PARKING  
 ANYTIME=N.P., COMM/IND. ACCESS=E

SYSTEM				TRAFFIC		LINE DIAGRAM						TRAFFIC		PAVEMENT DATA	
FED. AID.	FUNCT. CLASS.	HWY. SYS.	HPMS SAMPLE	PRKG. REST.	COM/IND. ACCESS							CONTROL	COM/IND. ACCESS		PRKG. REST.
						BRANDYWINE RD									
						MD 381				CO 599		TL			

Rural Other Principal Arterial  
State Primary

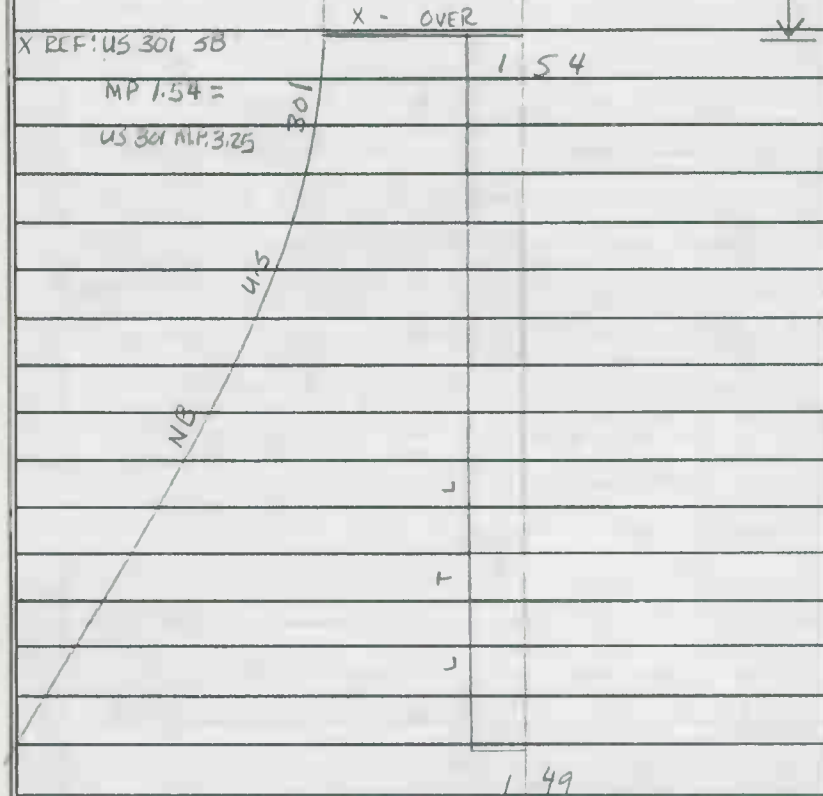

24' I  
 2-10' I SHD  
 2 ML



MARYLAND STATE HIGHWAY ADMINISTRATION

ROAD INVENTORY SHEET

DT/T  
12-1-94  
94-75

BR/AL  
9-5-97  
ST P.I.

Party Chief G. Davis  
Recorder G. Williams  
Assistant \_\_\_\_\_  
Map No./Dir. F-12 / N-S  
State Coordinates \_\_\_\_\_

Road No. US 301 to SH 19 #3  
Road Name F.R. MP 21.31-19.02  
County Prince Georges  
Date 8/24/93  
Sheet No. 1 OF 4

TRAFFIC CONTROLS: STOP SIGN=SS,  
TRAFFIC LIGHT=T.L.,  
FLASHING RED BALL=F.R.

TRAFFIC CODES

PARKING RESTRICTIONS: A.M. PEAK,  
P.M. PEAK, A.M./P.M. PEAK, NO PARKING  
ANYTIME=N.P., COMM/IND. ACCESS=E

SYSTEM				TRAFFIC		LINE DIAGRAM	TRAFFIC			PAVEMENT DATA
FED. AID.	FUNCT. CLASS.	HWY. SYS.	HPMS SAMPLE	PKG. REST.	COMM/IND. ACCESS		CONTROL	COMM/IND. ACCESS	PKG. REST.	
						0100		E		
						0153	ACCEL/RTL	E	24 I	
						0170	DR	2E	6' SHD RT	
						0149	MV	TL	J CRPT	
						0147	L	2E	4' SHD RT	
						0145	R		2ML	
						0143	X X		24 I	
						0142	X X		10' I SHD RT	
						0139	X X		4' I SHD RT	
						0132	X X		2ML	
						0124	X X		24 I	
						0113	US 301 SL=55		10' I SHD RT	
						0105	ACCEL		4' I SHD RT	
						0100	C-3643		2ML	
						0073	C-3643		X 24 I	
						0000	C-3643		10' I SHD RT	
						130'	← 130' →		4' I SHD RT	
									2ML	

Rural Other Principal Aerial  
 State Primary

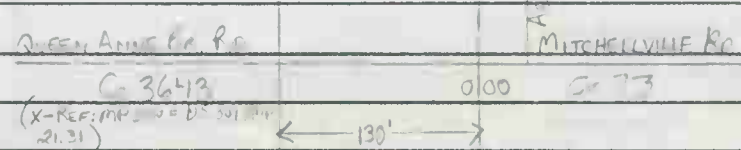

TL  
FR



SYSTEM				TRAFFIC				TRAFFIC				PAVEMENT DATA			
FED. AID.	FUNCT. CLASS.	Hwy. SYS.	HPMS SAMPLE	PRKG. REST.	COM/IND ACCESS	CONTROL	COM/IND ACCESS	PRKG. REST.							
Rural Other Principal Arterial State Primary				LINE DIAGRAM											

RAMP # 8

109

12'I RTL

107

105

094

ZE

086

30  
47

24'I  
10'ISHORT  
4'I SHOLT  
2ML

080

AISEL

X-REF TO US 301 N LA PENNSAUBRY PA

X-REF TO 10/24' 12'ISHORT  
JC B RT, 20'ISHORT 2ML

077

RTIL

MU 21351

075

12'I RTL

072

066

AISEL

PATRIOT LA

065

MU 2098

064

RTIL

24'I  
10'ISHORT  
JC B RT  
4'I SHOLT  
2ML

ROAD INVENTORY SHEET

Party Chief GD  
Recorder GW  
Assistant \_\_\_\_\_  
Map No./Dir. F12/G:12 / N  
State Coordinates \_\_\_\_\_

Road No. US 301 SE BAYVIEW RD L&B 3  
Road Name From MD 2131-1902  
County PG  
Date 8/24/93  
Sheet No. 3 OF 4

TRAFFIC CONTROLS: STOP SIGN=S.S.  
TRAFFIC LIGHT=T.L.,  
FLASHING RED BALL=F.R.

PARKING RESTRICTIONS: A.M. PEAK,  
P.M. PEAK, A.M./P.M. PEAK, NO PARKING  
ANYTIME=N.P., COMM/IND. ACCESS=E

Rural Other Principal Arterial  
State Primary

SYSTEM				TRAFFIC		LINE DIAGRAM	TRAFFIC			PAVEMENT DATA
FED. AID.	FUNCT. CLASS.	HWY. SYS.	HPMS SAMPLE	PRKG. REST.	COMM/IND. ACCESS		CONTROL	COMM/IND. ACCESS	PRKG. REST.	
						<div style="position: absolute; top: 40%; left: 40%; width: 50%; height: 20%;"> <div style="border: 1px solid black; padding: 5px;"> <p>140 12' I ACCEL</p> </div> <div style="border: 1px solid black; padding: 5px; margin-top: 10px;"> <p>137 12' I ACCEL</p> </div> <div style="border: 1px solid black; padding: 5px; margin-top: 10px;"> <p>PUR: 03/1981 I SMO 8' ISHD LT, JCB ET</p> </div> <div style="border: 1px solid black; padding: 5px; margin-top: 10px;"> <p>MD 135 978-B</p> </div> <div style="position: absolute; top: 60%; left: 60%; font-size: 24px; font-weight: bold; color: red;"> <p>RAMP #5</p> </div> </div>				
						<div style="position: absolute; top: 60%; left: 40%; width: 50%; height: 20%;"> <div style="border: 1px solid black; padding: 5px;"> <p>123 12' I ACCEL / DECC IN TH</p> </div> <div style="border: 1px solid black; padding: 5px; margin-top: 10px;"> <p>121 12' I RT L ON TH</p> </div> <div style="border: 1px solid black; padding: 5px; margin-top: 10px;"> <p>STRAIGHT ← EB</p> </div> <div style="border: 1px solid black; padding: 5px; margin-top: 10px;"> <p>214</p> </div> </div>				
						<div style="position: absolute; top: 75%; left: 40%; width: 50%; height: 20%;"> <div style="border: 1px solid black; padding: 5px;"> <p>119 12' I RT L ON TH</p> </div> <div style="border: 1px solid black; padding: 5px; margin-top: 10px;"> <p>48' I, JCC 2 3/4' I, JCC</p> </div> </div>				
						<div style="position: absolute; top: 85%; left: 40%; width: 50%; height: 20%;"> <div style="border: 1px solid black; padding: 5px;"> <p>117 12' I ACCEL / DECC IN TH</p> </div> </div>				
						<div style="position: absolute; top: 95%; left: 40%; width: 50%; height: 20%;"> <div style="border: 1px solid black; padding: 5px;"> <p>RAMP #7</p> </div> </div>				
						<div style="position: absolute; top: 70%; left: 20%;"> <p>MD w.B.</p> </div>				
									<p>24' I 10' I SHORT 4' I SHORT 2ML</p>	





ROAD INVENTORY SHEET

Party Chief G DAVIS  
Recorder A. FIATTON  
Assistant \_\_\_\_\_  
Map No./Dir. G-11 / E  
State Coordinates 824-383

Road No. MD 332  
Road Name CENTRAL AVE  
County PG  
Date 9-16-93  
Sheet No. 1 OF 2

00-13ST  
2-16-01  
G01EF

BB/AL  
8-27-97  
ST R.I

TRAFFIC CONTROLS: STOP SIGN=S.S.,  
TRAFFIC LIGHT=T.L.,  
FLASHING RED BALL=F.R.

PARKING RESTRICTIONS: A.M. PEAK,  
P.M. PEAK, A.M./P.M. PEAK, NO PARKING  
ANYTIME=N.P., COMM/IND. ACCESS=E

SYSTEM				TRAFFIC		LINE DIAGRAM										TRAFFIC			PAVEMENT DATA										
FED. AID.	FUNCT. CLASS.	HWY. SYS.	HMS SAMPLE	PRKG. REST.	COM/IND. ACCESS	CONTROL	COM/IND. ACCESS	PRKG. REST.											CONTROL	COM/IND. ACCESS	PRKG. REST.								

URBAN Minor Arterial  
State Secondary

TRAFFIC CODES  
4  
TL  
2E  
No PKG

TRAFFIC CODES  
4  
TL  
No PKG  
E

PAVEMENT DATA  
30' F  
JCC  
2" TC  
2" SI  
2" ML  
JCC

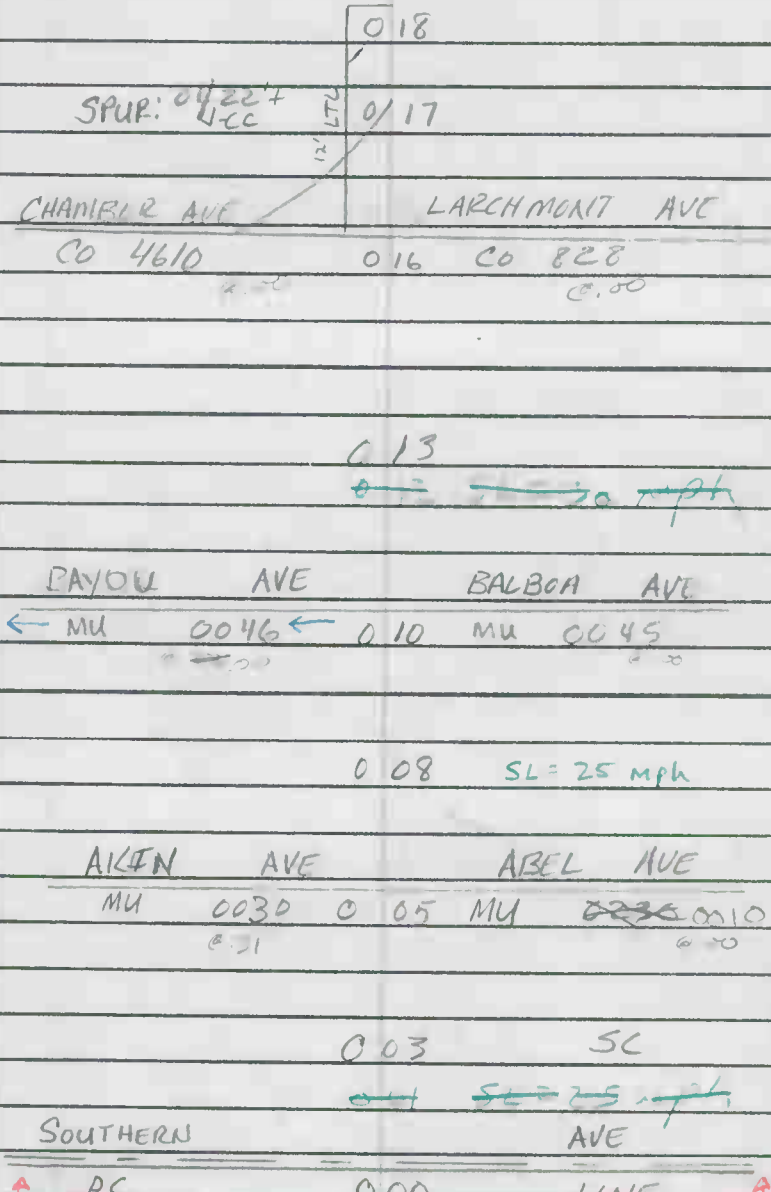

SYSTEM				TRAFFIC		LINE DIAGRAM						TRAFFIC		PAVEMENT DATA			
FED. AID.	FUNCT. CLASS.	HWY. SYS.	HPMS SAMPLE	PRKG. REST.	COM/IND ACCESS							CONTROL	COM/IND ACCESS	PRKG. REST.			
URBAN Minor Arterial				State Secondary													
				E						0 41	CAPITOL HGETS P.O	E					
				E						0 38		E			22' F		
				E						0 37	CAPITOL HGETS V.F.D	E			<del>2-7.7 SHD</del>		
				E		QUIRE AVE						E		*	<del>1.622 PF</del>		
				E		MU 0240 0.00				0 35		E			2 ML		
				E						0 32		E					
				E						0 30		E					
				E						0 28		E					
				E						0 26		E					
				E						0 24	CAPITOL HGETS CO 393	E					
				E						0 21	BLVD NOVA AVE CO 371	E					
				E						0 20	CBC	E			22' I		
				E						0 19	8' x 10' x 8'	E			2-3 ISHD		
				E								E			36' F		
				E								E			J CC		
				E								E			2 ML		

\* Corp Limits move from .59 to .56 Taken From  
 1991 Capital Heights map

SHA 51.3 - 8 Revised  
 4.83

MARYLAND STATE HIGHWAY ADMINISTRATION

ROAD INVENTORY SHEET

Party Chief G. DAVIS  
 Recorder A. HATTEN  
 Assistant \_\_\_\_\_  
 Map No./Dir. G-11 / E  
 State Coordinates \_\_\_\_\_

Road No. MD 332  
 Road Name CENTRAL AVE  
 County PG  
 Date 9-16-93  
 Sheet No. 3 OF 5

TRAFFIC CONTROLS: STOP SIGN=SS,  
 TRAFFIC LIGHT=L.,  
 FLASHING RED BALL=F.R.

TRAFFIC CODES  
 PARKING RESTRICTIONS: A.M. PEAK,  
 P.M. PEAK, A.M./P.M. PEAK, NO PARKING  
 ANYTIME=N.P., COMM/IND. ACCESS=E

SYSTEM				TRAFFIC		LINE DIAGRAM				TRAFFIC		PAVEMENT DATA		
FED. AID.	FUNCT. CLASS.	HWY. SYS.	HMS. SAMPLE	PRKG. REST.	COMM/IND. ACCESS						CONTROL	COMM/IND. ACCESS	PRKG. REST.	
						VENTURA AVE								2-TISMI
						0.63	CO	722						JCCO-KT
						VALE PL								
						0.30		304	0.62					
						ULINE PL								
						<del>PNT. RD</del> XXXXXX XX XXX								
						0.56			0.59					
						Corp Limits								
						0.56			0.56					
						0.55								
						TUNIC AVE TOPEKA AVE								
						0.54	CO	1679						
						0.00			0.00					
						SULTAN AVE SUFFOLK AVE								
						0.48	CO	370						22'I
						0.27			0.00					237'SHO
						0.46			PKG LOT					LIPRRT
						0.44								2 MC
														JCC

URBAN Minor Arterial  
 State Secondary

E

E

E

E



SYSTEM				TRAFFIC				TRAFFIC				PAVEMENT DATA
FED. AID.	FUNCT. CLASS.	HWY. SYS.	HPMS SAMPLE	PRG. REST.	COM/IND ACCESS	CONTROL	COM/IND ACCESS	PRG. REST.	PRG. REST.	PAVEMENT DATA		

# LINE DIAGRAM

URBAN Minor Arterial  
State Secondary

YEOMAN PL  
CO 3888

12' I CHAN  
REF 088  
136

LYNDEN HILL SCHOOL

ROLLINS AVE  
083 CO 369

077  
077 = 45 #

MARYLAND PARK DR  
CO 1505 076

XENIA AVE  
074 CO 720

073

WHIST PL  
CO 503 069

↑  
4'  
JS

22' T  
6' SHO RT  
8' SHO CT  
1' CRB RT  
1' CRB CT  
2' ML

\*

22' T  
2-7' SHO  
1' CRB RT  
2' ML

ROAD INVENTORY SHEET

Party Chief G. DAVIS  
 Recorder A. HATTEN  
 Assistant \_\_\_\_\_  
 Map No./Dir. G11 / E  
 State Coordinates \_\_\_\_\_

Road No. MD 332  
 Road Name CENTRAL AVE  
 County PG  
 Date 9-16-93  
 Sheet No. 5 OF 5

TRAFFIC CONTROLS: STOP SIGN=S.S.,  
 TRAFFIC LIGHT=T.L.,  
 FLASHING RED BALI=F.R.

TRAFFIC RESTRICTIONS: A.M. PEAK,  
 P.M. PEAK, A.M./P.M. PEAK, NO PARKING  
 ANYTIME=N.P., COMM/IND. ACCESS=E

SYSTEM				TRAFFIC			LINE DIAGRAM										TRAFFIC			PAVEMENT DATA	
FED. AID.	FUNCT. CLASS.	HWY. SYD.	HWY. SAMPLE	PRIOG. REST.	COMM/IND. ACCESS	CONTROL	COMM/IND. ACCESS	PRIOG. REST.											CONTROL	COMM/IND. ACCESS	PRIOG. REST.
									(No NAME) 101 OP 44												
									096 CO 721												
									MD SPHR .04/26'I JCLL 094 2-4'J SOWKE												
									093												

TRAFFIC DATA

20' E  
 1 CC  
 ZUML  
 24' E  
 J CRB RT  
 8' J ON RT  
 2 ML  
 X 24  
 22' E  
 6' J SH RT  
 8' J SH LT  
 1' CRB RT  
 1' CRB LT  
 2 ML





ROAD INVENTORY SHEET

SR-01  
6-5-91  
GD/EF

96-25T

Party Chief BB  
Recorder MG  
Assistant \_\_\_\_\_  
Map No./Dir. G-11 / N  
State Coordinates 825-351

Road No. MD 337  
Road Name ALLENTOWN Rd  
County P.G  
Date 3-27-97  
Sheet No. 1 OF 8

BB/AL  
9-9-97  
ST R. I

SYSTEM			TRAFFIC			LINE DIAGRAM						TRAFFIC			PAVEMENT DATA
DIVISION	CLASS	TYPE	REG. BELT	COOR.ING	ACCESS	CONTROL	COMING ACCESS	REG. BELT							
									PERRIE LA				2-25' I		
									Co 2149				12' I PAT MED		
									X OVER				CLT		
									TL E				JC-C OUT		
									0.14				X 4 ML		
									0.08				24' I RT		
									0.06				38' I LT		
									0.05 12' H ACCEL				16' S MED		
									0.04 12' H				JC-C IN/OUT		
									Ramp #3				SML		
									LTL ON MED						
									0.03						
									NB LA						
									MD						
									0.01 S						
									SBLA						
									MD						
									0.00						
									#16253						
									S						
									#5						
									S						
									#7						
									#8						
									ALLENTOWN Rd						
									Co						

TRAFFIC CONTROLS: STOP SIGN-S.S.,  
TRAFFIC LIGHT-T.L.,  
FLASHING RED BALL=F.R.

TRAFFIC CODES  
PARKING RESTRICTIONS: A.M. PEAK,  
P.M. PEAK, A.M./P.M. PEAK, NO PARKING  
ANYTIME-N.P., COMA/INP, ACCESS-E

SYSTEM				TRAFFIC				TRAFFIC				PAVEMENT DATA			
FUNCI	CLASS	HWY	SYS	NAME	REG	REST	OW/IN	ACCESS	CH/REG	COM/ND	ACCESS	REG.	REST.		
<b>LINE DIAGRAM</b>															
URBAN Minor Arterial STATE secondary															
MAXWELL DR															
Co 2176															
12' I LTA 0.96															
PTA															
0.89															
14' I RTL 0.84															
0.81															
AUTH RD															
Co 127															
LTL 12' I 0.78															
35°															
0.74															
0.66															
0.45															
0.37															
0.30 PC															
ROBIN LA															
Co 1456															
0.24															
24' I RT															
38' I LT															
10' F SHO OUT RT															
JCBS-IN															
JC B OUT LT															
16' Grass MED															
54 ML															
X 2-24' I															
10' F SHO OUT R															
JCBS-IN															
JC B OUT LT															
16' Grass MED															
X 4 ML															
2-25' I															
12' I PNT MED															
CLT															
JC-C OUT															
4 ML															







ROAD INVENTORY SHEET

Party Chief GD  
 Recorder GW  
 Assistant \_\_\_\_\_  
 Map No./Dir. G-11 / N  
 State Coordinates \_\_\_\_\_

Road No. MD 337  
 Road Name ALLENTOWN RD  
 County PG  
 Date 8/18/93  
 Sheet No. 5 OF 8

TRAFFIC CONTROLS: STOP SIGN=SS,  
 TRAFFIC LIGHT=T.L.,  
 FLASHING RED BALL=F.R.

TRAFFIC RESTRICTIONS: A.M. PEAK,  
 P.M. PEAK, A.M./P.M. PEAK, NO PARKING  
 ANYTIME=N.P., COMM/IND. ACCESS=E

SYSTEM				TRAFFIC				LINE DIAGRAM				TRAFFIC				PAVEMENT DATA	
FED. AID.	FUNCT. CLASS.	HWY. SYS.	HPMS SAMPLE	PRKG. REST.	COM/IND. ACCESS	CONTROL	COM/IND. ACCESS	PRKG. REST.	CONTROL	COM/IND. ACCESS	PRKG. REST.	CONTROL	COM/IND. ACCESS	PRKG. REST.	PAVEMENT DATA		
															20'I		
															2-10' FSHD		
															2ML		
															X		
															2-26'I		
															2-10' FSHD AT		
															16'I PT MED		
															4ML ON TAPE		
															16' 20'I		
															2ML		
															X		
															2-26'I		
															16' FSHD AT		
															J CASP-LT		
															15'I PT MED		
															4ML		
															X		
															2-25'I		
															2-10' FSHD AT		
															J CAS IN		
															16' GR MED		
															4ML		

Urban Minor Arterial  
 State Secondary  
 NP  
 SEE HPMS on GV Roads

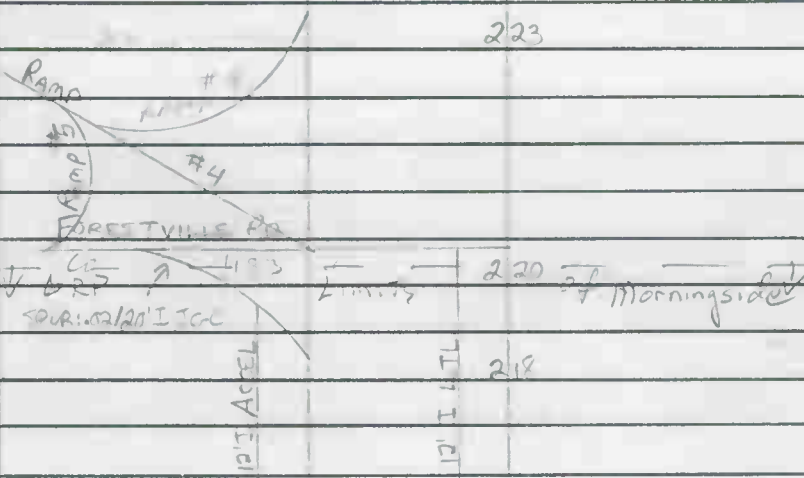

RE  
 RE  
 E  
 E

TL E

NP

96 CoEx #56  
3-27-97

6088

# LINE DIAGRAM

BB/MG

SYSTEM				TRAFFIC				TRAFFIC				PAVEMENT DATA			
FED. AID.	FUNCT. CLASS.	HWY. SYS.	HPMS SAMPLE	PRKG. REST.	COM/IND ACCESS	CONTROL	COM/IND ACCESS	PRKG. REST.	CONTROL	COM/IND ACCESS	PRKG. REST.	CONTROL	COM/IND ACCESS	PRKG. REST.	
URBAN minor Arterial URBAN Other Principal Arterial State Secondary															
<p>531 (X REF TO MP 536 ON GV 119)</p>															
<p>2 84</p>															
<p>2 70</p>															
<p>2 65</p>															
<p>2 64</p>															
<p>2 6 X 3</p>															

F VHS

URBAN Other Principal Arterial  
State Secondary

URBAN minor Arterial

NP

SUITLAND  
GV 119

PARKWAY  
119

288

12' I R T T I  
ACCEL

PKWY

SUITLAND

RD W A Y

1 2 4

ALLEN TOWN  
0 2 N E

G

END STATE MAINT

NP

SEE

GV 119

2 2 1

48-4 TAPPED

GRS MED

JCE

HAL

X

\*

20' I

2ML

20' I

56-L

1ML

20' I

2-10' FSHD

2ML



ROAD INVENTORY SHEET GV 119

95-1  
2011  
3/20/11

92-435t

Party Chief GD  
Recorder GW  
Assistant \_\_\_\_\_  
Map No./Dir. G 118/N  
State Coordinates \_\_\_\_\_

Road No. MD 337  
Road Name SUITLAND PKWY  
County PRINCE GEORGES  
Date 8/18/93  
Sheet No. 7 OF 8

TRAFFIC CONTROLS: STOP SIGN=SS,  
TRAFFIC LIGHT=T.L.,  
FLASHING RED BALL=F.R.

TRAFFIC CODES  
PARKING RESTRICTIONS: A.M. PEAK,  
P.M. PEAK, A.M./P.M. PEAK, NO PARKING  
ANYTIME=N.P., COMM/IND. ACCESS=E

SYSTEM				TRAFFIC			LINE DIAGRAM										TRAFFIC			PAVEMENT DATA	
FED. AID.	FUNCT. CLASS.	HWY. SYS.	HPMS SAMPLE	PRKG. REST.	COM/IND. ACCESS											CONTROL	COM/IND. ACCESS	PRKG. REST.			
																			SEE GV 119		
																			<del>228 I</del> <del>JC-C</del> <del>4ml</del> <del>228 I</del> <del>42' x 4' T</del> <del>GRATED</del> <del>JC-C</del> <del>4ml</del>		

N.H.S.  
 MAP OF THE PRINCIPAL ARTERIAL

SYSTEM				TRAFFIC		LINE DIAGRAM				TRAFFIC		PAVEMENT DATA			
FED. AID.	PLANT. CLASS.	HWY. SYS.	HMMS SAMPLE	PRCG. REST.	CONVING ACCESS					CONTROL	CONVING ACCESS	PRCG. REST.			
<p>MD STATE SECONDARY</p> <p>WHS</p> <p>UNRAV OTHERS PRINCIPAL AND OTHER</p>				<p>(PENN. AVE sec X)</p> <p>CO RA XXXXXXXX</p> <p>RESIDENTIAL Hwy</p> <p>5500</p> <p>5520</p> <p>5540</p> <p>341</p> <p>4 TL</p> <p>MD</p> <p>SPUR</p> <p>04/22'E sec</p> <p>SPUR</p> <p>03/22'I sec</p> <p>338</p> <p>336</p> <p>334</p> <p>12'I AC/DELA</p> <p>Ramp</p> <p>330</p> <p>328 ANDREWS AFB</p> <p>326</p> <p>ENT TO</p>										<p>2.28'I</p> <p>Se-C</p> <p>1 1/2" Med</p> <p>4 ML</p>	
				<p>337</p> <p>MD</p>										<p>SEE</p>	
				<p>335</p>										<p>GV 119</p>	
				<p>334</p>										<p>2.28'I</p> <p>Se-C</p> <p>1 1/2" Med</p> <p>4 ML</p>	
				<p>333</p>											
				<p>332</p>											
				<p>331</p>											
				<p>330</p>											
				<p>329</p>											
				<p>328</p>											
				<p>327</p>											
				<p>326</p>											
				<p>325</p>											
				<p>324</p>											

ROAD INVENTORY SHEET

98-14st  
G.D.E.F.  
2/4/99

DT/TT  
11-17-94  
94-46  
94-45

Party Chief G. DAVIS  
Recorder G. WILLIAMS  
Assistant \_\_\_\_\_  
Map No./Dir. I-2 / N  
State Coordinates 875-264

Road No. MD 381  
Road Name BRANDYLINE RD  
County PRINCE GEORGES  
Date 7/21/93  
Sheet No. 1 OF 11

BOAL  
9-3-97  
STRI  
SR-01  
5-3-01  
80/2F

TRAFFIC CONTROLS: STOP SIGN=S.S.  
TRAFFIC LIGHT=T.L.,  
FLASHING RED BALL=F.R.

PARKING RESTRICTIONS: A.M. PEAK,  
P.M. PEAK, A.M./P.M. PEAK, NO PARKING  
ANYTIME-N.P., COMM/IND. ACCESS=E

SYSTEM				TRAFFIC		LINE DIAGRAM				TRAFFIC			PAVEMENT DATA
FED. AID.	FUNCT CLASS.	HWY. SYS.	HMMS SAMPLE	PKG. REST.	COM/IND. ACCESS	CONTROL	COM/IND. ACCESS	PKG. REST.	CONTROL	COM/IND. ACCESS	PKG. REST.	PAVEMENT DATA	
												24'I	
												2-10'FSHD	
												2MI	
				015								X	
				014									
				013									
				017									
				006									
				005									
				003								24'I	
				000								2-10'FSHD	
												2MI	

Rural Major Collector  
State Secondary

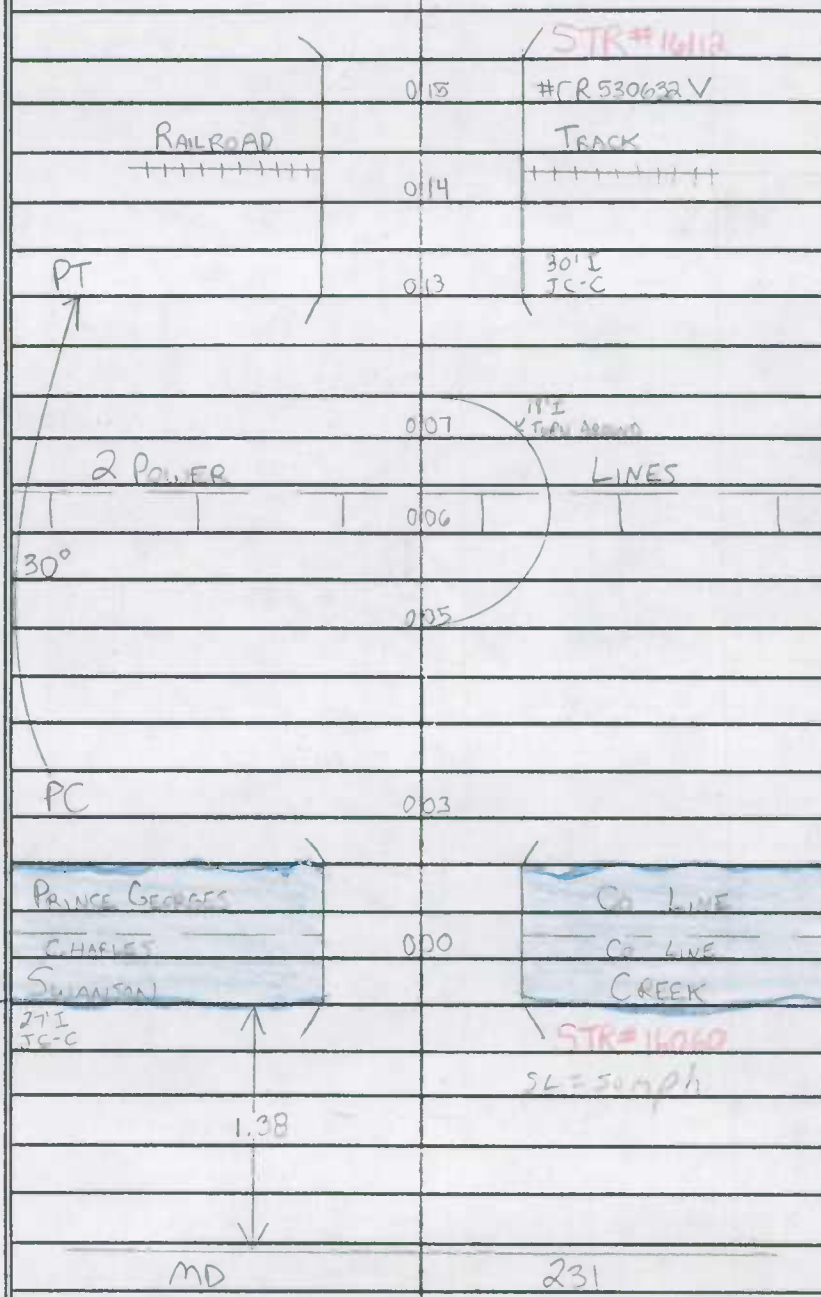

24'I  
2-10'FSHD  
2MI

Y





MARYLAND STATE HIGHWAY ADMINISTRATION

ROAD INVENTORY SHEET

Party Chief G. DAVIS  
Recorder G. WILLIAMS  
Assistant \_\_\_\_\_  
Map No./Dir. I-R / N  
State Coordinates \_\_\_\_\_

Road No. MD 381  
Road Name BRANDYWINE RD  
County PRINCE GEORGES  
Date 7/21/93  
Sheet No. 9 OF 19

TRAFFIC CONTROLS: STOP SIGN=SS,7  
TRAFFIC LIGHT=T.L.,  
FLASHING RED BALL=F.R.

TRAFFIC RESTRICTIONS: A.M. PEAK,  
P.M. PEAK, A.M./P.M. PEAK, NO PARKING  
ANYTIME=N.P., COMM/IND. ACCESS=E

SYSTEM				TRAFFIC		LINE DIAGRAM				TRAFFIC				PAVEMENT DATA	
FED. AID.	FUNCT. CLASS.	HWY. SYS.	HPMS SAMPLE	PRKG. REST.	COM/IND. ACCESS							CONTROL	COM/IND. ACCESS	PRKG. REST.	
							203	CHURCH				E			
				E		P.O. AQUASCO	197								
						ST PHILLIPS RD CO 195	194								24'I 2-2' ISHD 2ML
							189	SL = 50 MPH							X
							180								
						OP 309	178								
						EAGLE HARBOR RD CO 204	175								44'I 2ML
							170		180°						X
							153								24'I 2-8' ISHD 2ML  24'I 2-10' ISHD 2ML

Rural major Collector  
State Secondary





ROAD INVENTORY SHEET

Party Chief G. DAVIS Road No. MD 391  
Recorder G. WILLIAMS Road Name BRANDYVINE RD  
Assistant \_\_\_\_\_ County PRINCE GEORGES  
Map No./Dir. I-12 / N Date 7/21/93  
State Coordinates \_\_\_\_\_ Sheet No. 5 OF 19

SYSTEM					TRAFFIC			LINE DIAGRAM				TRAFFIC			PAVEMENT DATA		
FED. AID.	FUNCT CLASS.	HWY. SYS.	HPMS SAMPLE	PKG. REST.	COM/IND. ACCESS	CONTROL	COM/IND. ACCESS	PKG. REST.					CONTROL	COM/IND. ACCESS	PKG. REST.		
																	24'I
																	2-2' <sup>I</sup> SHO
																	2ML

TRAFFIC CONTROLS: STOP SIGN=S, S  
TRAFFIC LIGHT=L, L,  
FLASHING RED BALL=F, R.

TRAFFIC CODES  
PARKING RESTRICTIONS: A.M. PEAK,  
P.M. PEAK, A.M./P.M. PEAK, NO PARKING  
ANYTIME=N.P., COMM/IND. ACCESS=E

Rural Major Collector  
State Secondary

F

420

410

401  
SPUR: 02/16'I

ARVASEO FARM RD

399 Co 2062

396

380

376

370

F

RT

408

PC

X

X

X

X

24'I

2-2'<sup>I</sup>SHO

2ML

24'I

4'I SHO RT

6'I SHO RT

2ML

24'I

2-2'<sup>I</sup>SHO

2ML

24'I

2-3'I SHO

2ML

24'I

2-2'<sup>I</sup>SHO

2ML

SYSTEM				TRAFFIC		LINE DIAGRAM	TRAFFIC			PAVEMENT DATA
FED. AID.	FUNCT. CLASS.	HWY. SYS.	HPMS SAMPLE	PRKG. REST.	COM/IND ACCESS		CONTROL	COM/IND ACCESS	PRKG. REST.	
						OP 316				
						PT				
						30°				
						PC				
									24' E	
									2-2' FSHD	
									2ML	
									*	
						466			PT	
									40°	
									PC	
									*	
						457			24' E	
									2-2' FSHD	
									2ML	
									*	
						444			24' E	
									2-2' FSHD	
									2ML	
									*	
						434			24' E	
									2-2' FSHD	
									2ML	

Rural major collector  
State Secondary

MARYLAND STATE HIGHWAY ADMINISTRATION

ROAD INVENTORY SHEET

Party Chief G. DAVIS  
 Recorder G. WILLIAMS  
 Assistant \_\_\_\_\_  
 Map No./Dir. H-12 / N  
 State Coordinates \_\_\_\_\_

Road No. MD 381  
 Road Name BRANDYWINE RD  
 County PRINCE GEORGES  
 Date 7/21/93  
 Sheet No. 7 OF 19

TRAFFIC CONTROLS: STOP SIGN=SS,  
 TRAFFIC LIGHT=T.L.,  
 FLASHING RED BALL=F.R.

TRAFFIC CODES  
 PARKING RESTRICTIONS: A.M. PEAK,  
 P.M. PEAK, A.M./P.M. PEAK, NO PARKING  
 ANYTIME=N.P., COMM/IND. ACCESS=E

SYSTEM					TRAFFIC			LINE DIAGRAM				TRAFFIC			PAVEMENT DATA	
FED. AID.	FUNCT. CLASS.	HWY. SYS.	HPMS SAMPLE	PKG. REST.	COM/IND. ACCESS	CONTROL	COM/IND. ACCESS	PKG. REST.					CONTROL	COM/IND. ACCESS	PKG. REST.	
																24'I
																2-4'I SHO
																2ML
																X
																24'I
																2'F SHO RT
																5'I SHO LT
																2ML
																X
																24'I
																2ML
																X
																24'I
																2-3'I SHO
																2ML
																X
																24'I
																4'I SHO LT
																2ML
																X
																24'I
																2-2' SHO
																2ML

Rural Major Collector  
 State Secondary

Cross RD  
 MD 518 382

559

544

528

511



SYSTEM				TRAFFIC		LINE DIAGRAM	TRAFFIC			PAVEMENT DATA
FED. AID.	FUNCT. CLASS.	HWY. SYS.	HPMS SAMPLE	PKG. REST.	COMING ACCESS		CONTROL	COMING ACCESS	PKG. REST.	
						639			X	
					M	637				
						WILLIAM S. SCHMITT EDUCATION CENTER 636				
					M	634				24'I 2-4'I SHD 2ML
						626			X	
										24'I 2'F SHD RT 2ML
						618			X	
						615				
						P.G. Co OUTDOOR EDUCATION CENTER 614		E		24'I 8'I SHD RT JC-C 2ML
						609			X	
										24'I 2ML
						571		E	X	
										24'I 4'I SHD RT 2ML
						563		E	X	
										24'I 2-4'I SHD 2ML

Rural Major Collector  
State Secondary

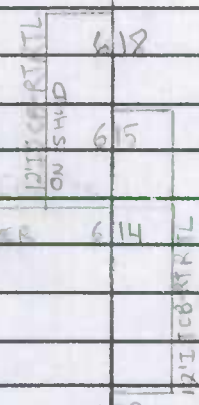

GRAVEL PIT

MARYLAND STATE HIGHWAY ADMINISTRATION

ROAD INVENTORY SHEET

Party Chief G. DAVIS  
 Recorder G. WILLIAMS  
 Assistant \_\_\_\_\_  
 Map No./Dir. H-12 / N  
 State Coordinates \_\_\_\_\_

Road No. MD 381  
 Road Name BRANDYWINE RD  
 County PRINCE GEORGES  
 Date 7/2/91  
 Sheet No. 9 OF 19

TRAFFIC CONTROLS: STOP SIGN = SS,  
 TRAFFIC LIGHT = T.L.,  
 FLASHING RED BALL = F.R.

PARKING RESTRICTIONS: A.M. PEAK,  
 P.M. PEAK, A.M./P.M. PEAK, NO PARKING  
 ANYTIME = P., COMM/IND. ACCESS = E

SYSTEM				TRAFFIC		LINE DIAGRAM										TRAFFIC		PAVEMENT DATA		
FED. AID.	FUNCT. CLASS.	HWY. SYS.	HPMS SAMPLE	PRKG. REST.	COMM/IND. ACCESS											CONTROL	COMM/IND. ACCESS	PRKG. REST.		
						829												X	24'I	
						823						30'							2-2' F SHO	
						806						SL = 40mph							ZML	
						795												X		
						779						CHURCH					E			
						770						<del>HORSEHEAD RD Co 191</del>								
						766						CHURCH					E			
						760						<del>HORSE HEAD RD Co 4855</del>					E			
						715						SAND + GRAVEL PIT					E			
						712						ORME RD Co 192							24'I	
																			2-3' I SHO	
																			ZML	

Rural Major Collector  
 State Secondary

DIAGRAM OF THE  
 RTTL





# MARYLAND STATE HIGHWAY ADMINISTRATION

## ROAD INVENTORY SHEET

Party Chief G. DAVIS  
 Recorder G. WILLIAMS  
 Assistant \_\_\_\_\_  
 Map No./Dir. 11-12 / N  
 State Coordinates \_\_\_\_\_

Road No. MD 381  
 Road Name BRANDYWINE RD  
 County PRINCE GEORGES  
 Date 7/11/93  
 Sheet No. 11 OF 19

TRAFFIC CONTROLS: STOP SIGN=S.S.  
 TRAFFIC LIGHT=T.L.,  
 FLASHING RED BALL=F.R.

PARKING RESTRICTIONS: A.M. PEAK,  
 P.M. PEAK, A.M./P.M. PEAK, NO PARKING  
 ANYTIME=N.P., COMM/IND. ACCESS=E

SYSTEM				TRAFFIC		LINE DIAGRAM			TRAFFIC			PAVEMENT DATA
FED. AID.	FUNCT CLASS.	HWY. SYS.	HPMS SAMPLE	PRG. REST.	COM/IND. ACCESS	CONTROL	COM/IND. ACCESS	PRG. REST.	CONTROL	COM/IND. ACCESS	PRG. REST.	PAVEMENT DATA

Rural Major Collector  
 State Secondary

1014  
 1009  
 1007  
 989 SL=50mph  
 986  
 984  
 980  
 942 Co 594  
 938  
 931

NP  
 E  
 E  
 X  
 X

24" I  
 8" I SADAT  
 8" I SHO LT  
 2" ML  
 24" I  
 2-3" I SHO  
 2" ML  
 24" I  
 2-3" I SHO  
 2" ML

ASHBOX RD  
 Co 163

LETCHER RD  
 Co 594

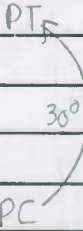







# LINE DIAGRAM

SYSTEM				TRAFFIC		TRAFFIC				PAVEMENT DATA	
FED. AID.	FUNCT. CLASS.	HWY. SYS.	HPMS SAMPLE	PRG. REST.	COM/IND ACCESS	CONTROL	COM/IND ACCESS	PRG. REST.			
											24'I
											<del>24'I</del>
											2ML
											*
											24'I
											11' SHORT
											2' SHORT
											2ML
											OLD INDIAN HEAD RD
											1336 Co 174
											*
											24'I
											2-7' SHDS
											2ML
											*
											38'I
											9' SHORT
											ICE RT
											2ML
											*
											24'I
											2-3' SHORT
											<del>24'I</del>
											2ML
											LEE ACRES DR
											1179 RVT RD
											1180
											PREPARED 1183
											1177
											PT
											30°
											*
											24'I
											2' SHORT
											2ML
											24'I
											2' SHORT
											2ML

Rural Major Collector  
 State Secondary  
 KD 203810001228

MARYLAND STATE HIGHWAY ADMINISTRATION

ROAD INVENTORY SHEET

Party Chief G. DAVIS  
 Recorder G. WILLIAMS  
 Assistant \_\_\_\_\_  
 Map No./Dir. H-12/H-11/N  
 State Coordinates \_\_\_\_\_

Road No. MD 381  
 Road Name BRANDYWINE RD  
 County PRINCE GEORGES  
 Date 7/21/93  
 Sheet No. 15 OF 19

TRAFFIC CONTROLS: STOP SIGN=S.S.  
 TRAFFIC LIGHT=T.L.,  
 FLASHING RED BALL=F.R.

PARKING RESTRICTIONS: A.M. PEAK,  
 P.M. PEAK, A.M./P.M. PEAK, NO PARKING  
 ANYTIME=N.P., COMM/IND. ACCESS=E

SYSTEM				TRAFFIC		LINE DIAGRAM	TRAFFIC			PAVEMENT DATA
FED. AID.	FUNCT. CLASS.	HWY. SYS.	HPMS SAMPLE	PKG. REST.	COM/IND. ACCESS		CONTROL	COM/IND. ACCESS	PKG. REST.	
						<del>1298</del> <del>(A X A)</del> <sup>Road</sup> <del>MARKING</del>				*
						1296 TOWER RD COM/IND				PT
										30°
						1291				PC
										24I
										2-21 FSHD
										2ML
						1288				5L = 30mph
										*
						1287				24I
										4-15 SHRT
						1285				4-15 SHRT
										2ML
										*
						1282				24I
										2-5 FSHD
										2ML
										*
						1278				24I
										4-15 SHRT
										4-15 SHRT
										2ML
										*
						1255				24I
										2-5 FSHD
										2ML

Rural Major Collector  
 State Secondary

E  
E









MARYLAND STATE HIGHWAY ADMINISTRATION

ROAD INVENTORY SHEET

Party Chief G. DAVIS  
 Recorder G. WILLIAMS  
 Assistant \_\_\_\_\_  
 Map No./Dir. H-11 / N  
 State Coordinates \_\_\_\_\_

Road No. MD 381  
 Road Name BRANDYWINE RD  
 County PRINCE GEORGES  
 Date 7/21/93  
 Sheet No. 19 OF 19

TRAFFIC CONTROLS: STOP SIGN=SS,  
 TRAFFIC LIGHT=T.L.,  
 FLASHING RED BALL=F.R.

TRAFFIC CODES  
 PARKING RESTRICTIONS: A.M. PEAK,  
 P.M. PEAK, A.M./P.M. PEAK, NO PARKING  
 ANYTIME=N.P., COMM/IND. ACCESS=E

SYSTEM				TRAFFIC		LINE DIAGRAM	TRAFFIC			PAVEMENT DATA
FED. AID.	FUNCT. CLASS.	HWY. SYS.	HPMS SAMPLE	PKG. REST.	COM/IND. ACCESS		CONTROL	COM/IND. ACCESS	PKG. REST.	
						BRANDYWINE RD Co 599				
						US 1453 301				
						SPUR: 02/18 I 8' I SHOULDER				
						SPUR: 03/17 I, 8' I SHO RT, I SHO LT				
						1451				2-15'I J-C-C 3' J MED 2ML
						1450				
						1449				24'I 2-8' I SHO 2ML

Rural Major Collector  
 State Secondary  
 203810001446

TL

X





ROAD INVENTORY SHEET

SR-01  
7/5/01  
GRET

Party Chief office Inv. A.L.  
Recorder \_\_\_\_\_  
Assistant \_\_\_\_\_  
Map No./Dir. F11A/E  
State Coordinates 800-415

Road No. MD 410  
Road Name East-West Hwy  
County P.G.  
Date 5-19-98  
Sheet No. 1 OF 18

TRAFFIC CONTROLS: STOP SIGN-SS,  
TRAFFIC LIGHT-T.L.,  
FLASHING RED BALL-F.R.

TRAFFIC CODES  
PARKING RESTRICTIONS: A.M. PEAK,  
P.M. PEAK, A.M./P.M. PEAK, NO PARKING  
ANYTIME=N.P., COMM/IND. ACCESS=E

SYSTEM				TRAFFIC				LINE DIAGRAM				TRAFFIC				PAVEMENT DATA	
FUNCT CLASS	HWY SYS	HPMS SAMPLE	PREC. REST.	COM/IND. ACCESS	CONTROL	COM/IND. ACCESS	PREC. REST.					CONTROL	COM/IND. ACCESS	PREC. REST.			
								Red Top Rd							2-24'I		
								0 10 Co 703							2-10'I shd out		
								0 09 PT							10' Pnt Med CLT		
								0 07							J c-c OUT 4ml		
								15°									
								10'I RTL LT							34'I RT		
								0 05							24'I LT		
								12'I							J' c-c		
								0 04							4' J Med		
								0 02							5ml		
								spurt. 01 16'I J c-c									
								spurt. 01 15'I J c-c									
								06. 60 line									
								Montgomery MD									
								0 00 650									

Urban Other Principal Arterial  
State Secondary

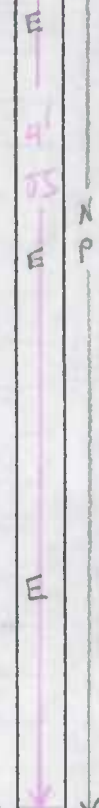
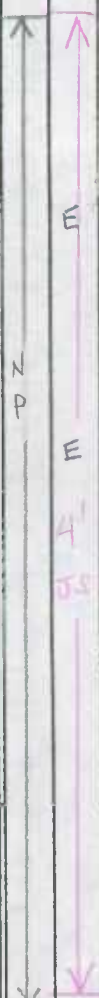



LINE DIAGRAM

SYSTEM				TRAFFIC				TRAFFIC				PAVEMENT DATA												
FUNDC. CLASS	HWY SYS	HPMS SAMPLE	PKG. REST.	CONTR. ACCESS	CONTR. ACCESS	CONTR. ACCESS	PKG. REST.	CONTR. ACCESS	CONTR. ACCESS	CONTR. ACCESS	CONTR. ACCESS	CONTR. ACCESS	CONTR. ACCESS											
Urban Other Principal Arterial State Secondary													Olson Rd		CO 895		0 27							
													PT				0 24							
													10th Ave		CO 764		0 23							
													30°				0 19							
													Kentland Ave		MU 0790		0 17							
													PC				0 13							
																	0 11		SL=30 mph					
																							2-24'I	
																							2-10'I shd out	
																							10' Pnt Med	
																							CLT	
																							J C-C out	
																							4ML	

4'  
JS

4'  
JS



ROAD INVENTORY SHEET

Party Chief GD  
 Recorder GW  
 Assistant AH  
 Map No./Dir. F-11A / E  
 State Coordinates \_\_\_\_\_

Road No. MD 410  
 Road Name EAST-WEST Hwy  
 County PG  
 Date 8/26/93  
 Sheet No. 3 OF 18

TRAFFIC CONTROLS: STOP SIGN=S.S.,  
 TRAFFIC LIGHT=T.L.,  
 FLASHING RED BALL=F.R.

TRAFFIC CODES  
 PARKING RESTRICTIONS: A.M. PEAK,  
 P.M. PEAK, A.M./P.M. PEAK, NO PARKING  
 ANYTIME=N.P., COMM/IND. ACCESS=E

SYSTEM				TRAFFIC		LINE DIAGRAM						TRAFFIC			PAVEMENT DATA	
FED. AID.	FUNCT. CLASS.	HWY. SYS.	HPMS SAMPLE	PRKG. REST.	COMM/IND. ACCESS							CONTROL	COMM/IND. ACCESS	PRKG. REST.		
						<b>LINE DIAGRAM</b>									44'I	
						010864 Park						E	X		4mL	
						SLIGO 010763 CREEK										
						40'S JCC										
						SPR. 01/30'I										
						010758										
						CHILLUM MANOR RD										
						010757 Co 772										
						Co 168B										
						SPR. 01/12'I										
						010746										
						SPR. 01/12'I										
						010745										
						2 POWER LINES										
						010741										
						010738										
						LINDEN AVE FAIRMOUNT AVE										
						Co 894 010636 Co 763									2-24'I	
						4' JS									2-16' ITHORNT	
						4' JS									10' PTAED	
						4' JS									JCC	
						4' JS									4mL	

Urban Other Principal Arterial  
State Secondary

4' JS

4' JS













SYSTEM				TRAFFIC				TRAFFIC				PAVEMENT DATA					
FED. AID.	FUNCT. CLASS.	HWY. SYS.	HPMS SAMPLE	PRKG. REST.	COM/IND ACCESS	CONTROL	COM/IND ACCESS	PRKG. REST.									
URBAN Other Principal Arterial State Secondary				NP				LINE DIAGRAM				34' I LT					
												44 <sup>TH</sup> Ave		10' I RT		13' GA MED	
												MU 0440 (Urban, Park)		3 47 <sup>03</sup> ← Ave 0440 (Zoned) .28		5 ml	
												10' I LTL		3 47 <sup>00</sup>			
												43 <sup>RD</sup> St		2 3 96 MU 9435			
												2 3 96 MU 9435		2 3 93			
												43 <sup>RD</sup> (Urban, Park)		10' I LTL			
												2 3 93		43 <sup>RD</sup> Ave (#3)			
												MU 0430		2 3 4 <sup>90</sup> ← mu 9433			
												42 <sup>ND</sup> Ave		2 3 2076 MU 9420			
												41 <sup>ST</sup> P <sub>4</sub> #3		2 3 72 → mu 9413			
												2 3 70		ADAMS CHAPEL RD			
												2 3 65		ADAMS CHAPEL RD			
												2 3 61		ADAMS CHAPEL RD			
												2 3 59		ADAMS CHAPEL RD			
				NP				2-34' I									
								JC-C									
								12' GAS MED									
								6 ML									
								2-24' I									
								10' I SHOVRT									
								JCB AT-LT									
								JCPS-1A									
								15' GAS MED									
								4 ML									

URBAN Other Principal Arterial  
State Secondary

NP

NP

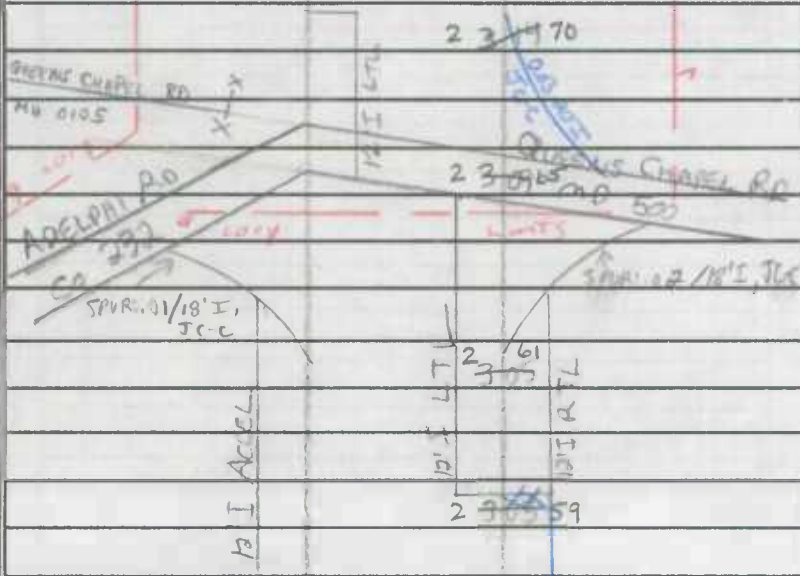

34' I LT  
 24' I RT  
 13' GAS MED  
 JC-C  
 5 ml

2-34' I  
 JC-C  
 12' GAS MED  
 6 ML

2-24' I  
 10' I SHOVRT  
 JCB AT-LT  
 JCPS-1A  
 15' GAS MED  
 4 ML























Co 96  
22897  
BB/MS

16 of 18

SYSTEM				TRAFFIC				TRAFFIC			PAVEMENT DATA			
FED. AID.	FUNCT. CLASS.	HWY. SYS.	HPMS SAMPLE	PRKG. REST.	COM/IND ACCESS	CONTROL	COM/IND ACCESS	PRKG. REST.						
URBAN Other Principal Arterial State Secondary				<p style="text-align: center;"><b>LINE DIAGRAM</b></p>				<p style="text-align: center;">TL</p>			2-24'I			
											2-10' ISH			
											JCB-W			
											15' GRS MED			
											4ML			
											X			
											2-24'I			
											2-10' ISH			
											2-3' ISH			
											20' GRS MED			
											4ML			
											X			
											2-24'I			
											JCB OUT RT			
											12' ISH OUT LT			
JCB-W														
28' GRS MED														
4ML														
X														
2-24'I														
JCB														
28' GRS MED														
4ML														













SR-01  
5/18/01  
GOLF

ROAD INVENTORY SHEET

Party Chief G. DAVIS  
Recorder G. WILLIAMS  
Assistant \_\_\_\_\_  
Map No./Dir. G-11C / E  
State Coordinates 802-355

Road No. MD 414  
Road Name OXON HILL RD  
County PRINCE GEORGES  
Date 8/13/93  
Sheet No. 1 OF 12

BB/AL  
9-8-97  
ST R.I.

TRAFFIC CONTROLS: STOP SIGN=SS,  
TRAFFIC LIGHT=T.L.,  
FLASHING RED BALL=F.R.

TRAFFIC CODES  
PARKING RESTRICTIONS: A.M. PEAK,  
P.M. PEAK, A.M./P.M. PEAK, NO PARKING  
ANYTIME=N.P., COMM/IND. ACCESS=E

SYSTEM				TRAFFIC			LINE DIAGRAM						TRAFFIC			PAVEMENT DATA		
FED. AID.	FUNCT. CLASS.	HWY. SYS.	HWYS. SAMPLE	PRKG. REST.	COMM/IND. ACCESS	CONTROL	COMM/IND. ACCESS	PRKG. REST.							CONTROL	COMM/IND. ACCESS	PRKG. REST.	
									FELKER AVE									2-24'I
									020 Co 4729									14'I IPTMED
									018									JCS-OUT
									015									4ML CTL
									STR#16220									(62'I, JCC)
									Ramp #4 I-295 To I-95									
									012									
									179' V.C. 69' C-C									68'I
									008									JCC
									005									6ML
									004									
									003									24'I RT
									000 210									36'I LT
									MD									JCS-OUT
									OXON HILL RD									4'J MED
									Co 114									5ML

ULBAW Other Principal Arterial  
State Secondary  
20N14000000

TL

TL









ROAD INVENTORY SHEET

Party Chief GD  
 Recorder GW  
 Assistant \_\_\_\_\_  
 Map No./Dir. G-11C/E  
 State Coordinates \_\_\_\_\_

Road No. MD 414  
 Road Name ST PAULINAS RD  
 County PG  
 Date 8/18/93  
 Sheet No. 5 OF 12

TRAFFIC CONTROLS: STOP SIGN=S.S.,  
 TRAFFIC LIGHT=L.L.,  
 FLASHING RED BALL=F.R.

TRAFFIC CODES

PARKING RESTRICTIONS: A.M. PEAK,  
 P.M. PEAK, A.M./P.M. PEAK, NO PARKING  
 ANYTIME=N.P., COMM/IND. ACCESS=E

SYSTEM				TRAFFIC				LINE DIAGRAM				TRAFFIC			PAVEMENT DATA	
FED. AID.	FUNC'T CLASS.	HWY. SYS.	URBAN SAMPLE	PRIOR. REST.	COM/IND. ACCESS	CONTROL	COM/IND. ACCESS	PRIOR. REST.								

URBAN Other Principal Arterial  
State Secondary

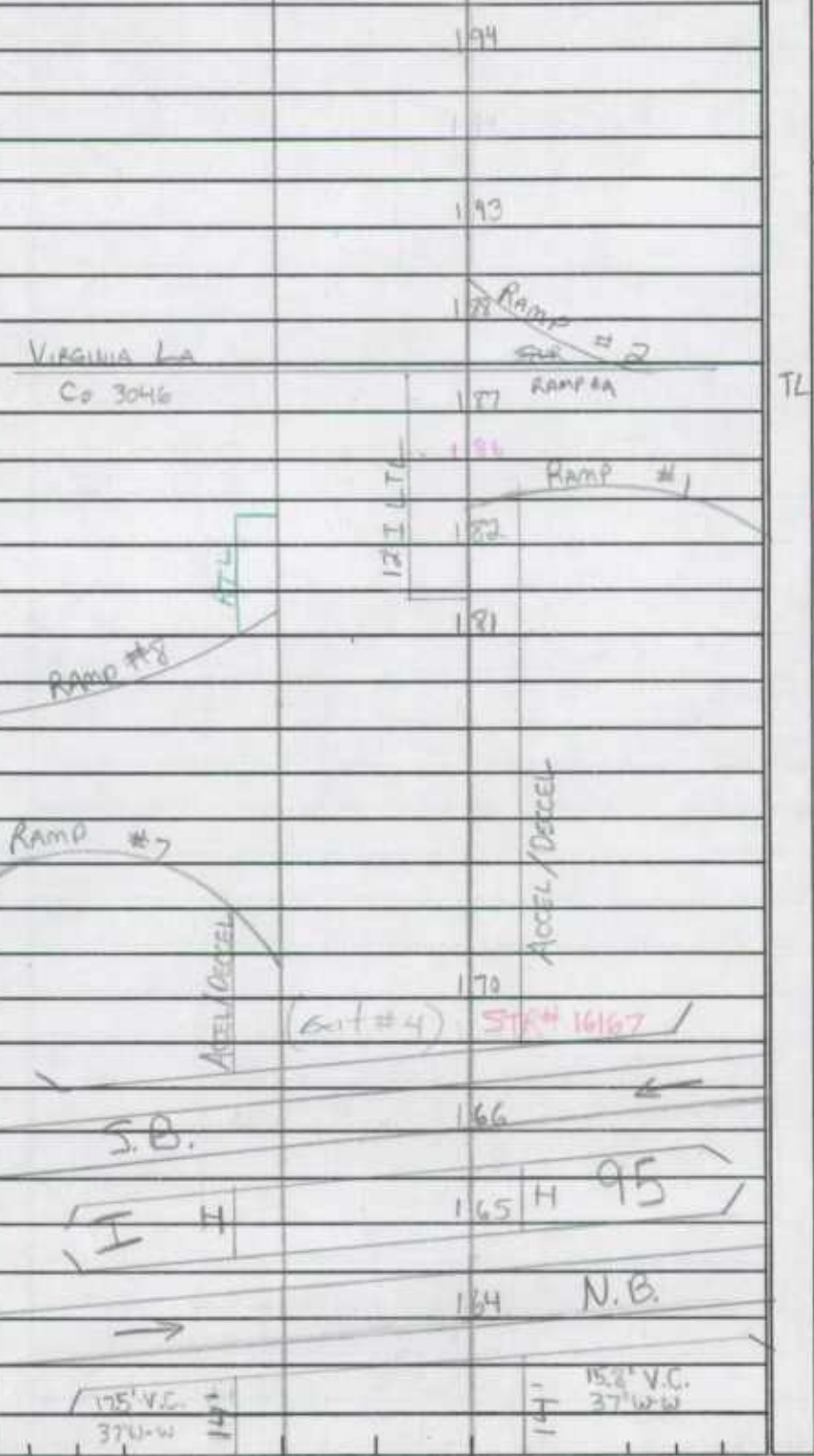

2.27' I  
16' J MED  
JCC  
4 ML





ROAD INVENTORY SHEET

Party Chief GD  
Recorder GW  
Assistant \_\_\_\_\_  
Map No./Dir. G-110/E  
State Coordinates \_\_\_\_\_

Road No. MD414  
Road Name ST BARNABAS RD  
County PG  
Date 8/18/93  
Sheet No. 7 OF 12

TRAFFIC CONTROLS: STOP SIGN=SS,  
TRAFFIC LIGHT=L.,  
FLASHING RED BALL=F.R.

TRAFFIC CODES  
PARKING RESTRICTIONS: A.M. PEAK,  
P.M. PEAK, A.M./P.M. PEAK, NO PARKING  
ANYTIME=N.P., COMM/IND. ACCESS=E

SYSTEM				TRAFFIC		LINE DIAGRAM			TRAFFIC				PAVEMENT DATA
FED. AID.	FUNCT. CLASS.	HWY. SYS.	HPMS SAMPLE	PRKG. REST.	COMM/IND. ACCESS				CONTROL	COMM/IND. ACCESS	PRKG. REST.		
						GATEWAY SQ							
								297					
						OP 463							
						HAGAN RD							
								289 Co 124					
						(John A. Thompson Rd)							
								286					
						CHURCH							
								283					
						PC							
								280					
						KERNAL LA							
								279		CHURCH			
						LIME ST							
								272					
						SOUTH BARNABAS RD							
								268		Co 1461			
						CHURCH							
								249					
						FRAZIER DR							
								245		PVT RD			
												2-22'I	
												6" TPT ASPHALT	
												JCS-11	
												4ML	

URBAN Other Principal Arterial  
State Secondary

E  
E  
E  
E

E

80F12

SYSTEM				TRAFFIC		TRAFFIC			PAVEMENT DATA	
FED. AID.	FUNCT. CLASS.	HWY. SYS.	HPWS SAMPLE	PRKG. REST.	COM/IND	CONTROL	COM/IND	ACCESS	PRKG. REST.	
			20414 000 0350							
Urban Other Principal Arterial										
State Secondary										
					346					2-28'I
					341	PT				4'I MED
					338	CREMEN RD				JC-C
					332	Co 3165				6ML
					326	DALLAS DR				
					323	Co 967				
					320	TEMPLE HILLS RD				
					319	PC				
					316	RALEIGH RD				2-24'I
					314	Co 3733				JC-C OUT
					306	TEMPLE HILL RD				10'I PROTECT
					305	Co 123				4ML
						DEER PARK DR				
						Co 700				

47

ROAD INVENTORY SHEET

Party Chief GD  
Recorder GW  
Assistant \_\_\_\_\_  
Map No./Dir. G-11B / E  
State Coordinates \_\_\_\_\_

Road No. MD 414  
Road Name ST BARNABAS RD  
County PG  
Date 8/18/99  
Sheet No. 9 OF 12

TRAFFIC CONTROLS: STOP SIGN=S.S.,  
TRAFFIC LIGHT=T.L.,  
FLASHING RED BALL=F.R.

PARKING RESTRICTIONS: A.M. PEAK,  
P.M. PEAK, A.M./P.M. PEAK, NO PARKING  
ANYTIME=N.P., COMM/IND. ACCESS=E

SYSTEM				TRAFFIC				TRAFFIC				PAVEMENT DATA						
FED. AID.	FUNCT CLASS.	HWY. SYS.	HPMS SAMPLE	PRKG. REST.	COM/IND. ACCESS	CONTROL	COM/IND. ACCESS	PRKG. REST.	CONTR.	COM/IND. ACCESS	PRKG. REST.	PAVEMENT DATA						
<b>LINE DIAGRAM</b>																		
URBAN - The Principal Arterial State Secondary 204140000350				12' I L T L 12' I L T L 12' I L T L 12' I L T L 12' I L T L 12' I L T L 12' I L T L 12' I L T L 12' I L T L 12' I L T L 12' I L T L 12' I L T L 12' I L T L 12' I L T L				389							3" I LT			
								387										2" I AT
								381							PC			4" J MOD
								374 Co 1728										1" CC
								373										5mL
								Hilly Tree Rd										
								371 Co 2840										
								369										
								368 5L-35mph										
								STAMP RD										
								364 Co 2655										
								363										
								359										
								CLIFTON RD										
								354 Co 4015										2-38'I
351										4" J MOD								
										3" C-C								
										6mL								





ROAD INVENTORY SHEET

BONITA ST

Party Chief GD  
Recorder GW  
Assistant \_\_\_\_\_  
Map No./Dir. C-11D / E  
State Coordinates \_\_\_\_\_

Road No. MD 414  
Road Name ST BARNABAS RD / OLD SILVER HILL RD  
County PG  
Date 8/18/93  
Sheet No. 11 OF 12

TRAFFIC CONTROLS: STOP SIGN=SS,  
TRAFFIC LIGHT=T.L.,  
FLASHING RED BALL=F.R.

TRAFFIC CODES  
PARKING RESTRICTIONS: A.M. PEAK,  
P.M. PEAK, A.M./P.M. PEAK, NO PARKING  
ANYTIME=N.P., COMM/IND. ACCESS=E

SYSTEM				TRAFFIC				LINE DIAGRAM				TRAFFIC				PAVEMENT DATA	
FED. AID.	FUNCT. CLASS.	HWY. SYS.	HPMS SAMPLE	PRKG. REST.	COM/IND. ACCESS	CONTROL	COM/IND. ACCESS	PRKG. REST.	STATION	STATION	CONTROL	COM/IND. ACCESS	PRKG. REST.				
									467	SMITHSON INTL				2-27'I	JCC		
									465	80'				4'JAED	3ML		
									463	SILVER							
									458	MD							
									460	SPR. 02/14'I JCC							
									457	SPR. 03/16'I JCC				12'I RT	27'I LT		
									455	ST BARNABAS RD				4'JAED	JCC		
									452	WILKINSON DR				3ML			
									448	Ca 3973							
									445								
									444	12'I X-OVER							
									442	APPS							
									4385								
									432					2-27'I	4'JMED		
														JCC	4ML		

Urban Other Principal Arterial  
State Secondary

# LINE DIAGRAM

SYSTEM					TRAFFIC		TRAFFIC			PAVEMENT DATA	
FED. AID.	FUNCT. CLASS.	HWY. SYS.	HPMS SAMPLE	PRG. REST.	COM/IND	ACCESS	CONTROL	COM/IND	ACCESS	PRG. REST.	

3210 A  
Co 4737

MO

511

5

SS

~~OLD SILVER HILL RD~~  
MO 474-A  
BANITA ST  
Co 1197

CO NI TP

90 SS

507

E

502

4E

26'I  
2-4'I STRDS  
30'E  
2ML

2E

497

V

X

COLEBRIDGE DR  
Co 607

496

E

48'I  
JCC  
2ML

V

492

E

491

E

489

E

X

2E

4191

E

32'I  
2ML

478

=

474

FY

CEDAR DR  
Co 1636

473

SILVER HILL  
VFD

V

X

E

471

FY

9 SS

468

E

48'I  
JOB-RT  
2ML

URBAN Collector  
STATE Secondary





209

# LINE DIAGRAM

SYSTEM				TRAFFIC		TRAFFIC		PAVEMENT DATA			
FED. AID.	FUNCT. CLASS.	HWY. SYS.	HPMS SAMPLE	PRKG. REST.	COM/IND ACCESS	CONTROL	COM/IND ACCESS		PRKG. REST.		
<p style="text-align: center;">NHS</p> <p style="text-align: center;">URBAN Other Principal Arterial</p> <p style="text-align: center;">State Secondary</p>				E	GOVT ENT.	MAYWOOD LA	070	Co 2042			
							068			E	
							064				
						12' I L T L	061	Co 1447	TERRACE DR		
							058				
							057			E	
							052	Co 3162	SILVER PARK DR		
							050			E	
						12' I L T L	048	Op 8	(ALDENBY DR) ENT TO ARTS		
							045			E	
							043				
						12' I L T L	040			E	
							037			E	
							030				
						12' I L T L	030				

2-36'I  
16'GRS MED  
JC-C  
6ML









6099

# LINE DIAGRAM

SYSTEM				TRAFFIC		TRAFFIC				PAVEMENT DATA				
FED. AID.	FUNCT. CLASS.	HWY. SYS.	HPMS SAMPLE	PRKG. REST.	COM/IND ACCESS	CONTROL	COM/IND ACCESS	PRKG. REST.						
<div style="display: flex; justify-content: space-between;"> <span style="writing-mode: vertical-rl; transform: rotate(180deg);">NHS</span> <span style="writing-mode: vertical-rl; transform: rotate(180deg);">URBAN Other Principal Arterial</span> <span style="writing-mode: vertical-rl; transform: rotate(180deg);">State Secondary</span> </div>				3E		213	↗		5E					
				↘		209		↘						
					E	207	(PLAZA DR)		E					
					E	204	Co 4723		E					
					E	201	SILVER HILL CT							
					E	200	Ext To AOTS							
					2E	190	ROYAL PLAZA DR		4'	JS				
					E	187	SUTLAND HS.	Co <del>47</del> <del>5477</del>	TL					
					4'	184								
					JS	180	SUNSET LA							
					E	178	Co 117							
					E	175	BROOKS DR		2E					
					E	173	Co 2828		TL					
					E	169								
														2-36'I JC-C 16'GRS MED 6ML



95-10,28  
BB AH  
3/20/96

ROAD INVENTORY SHEET

Party Chief GD  
Recorder GW  
Assistant \_\_\_\_\_  
Map No./Dir. G-11 B / N  
State Coordinates \_\_\_\_\_

Road No. MD 458  
Road Name SILVER HILL RD  
County PG  
Date 8/19/93  
Sheet No. 7 OF 9

TRAFFIC CONTROLS: STOP SIGN=SS,  
TRAFFIC LIGHT=T.L.,  
FLASHING RED BALL=F.R.

TRAFFIC CODES  
PARKING RESTRICTIONS: A.M. PEAK,  
P.M. PEAK, A.M./P.M. PEAK, NO PARKING  
ANYTIME=N.P., COMM/IND. ACCESS=E

SYSTEM				TRAFFIC			LINE DIAGRAM	TRAFFIC			PAVEMENT DATA
FED. AID.	FUNCT CLASS.	HWY. SYS.	HPMS SAMPLE	PRKG. REST.	COM/IND. ACCESS	CONTROL		COM/IND. ACCESS	PRKG. REST.		
						12' I L T L					
						236					236' I
						235					15' GRS MED
						233					JC-C 6ML
						230					
						231					
						228					
						225					
						224					
						223					
						221					
						219					
						216					
						215					

Urban Other Principal Arterial  
State Secondary

NH3

4'  
JS

E

12' I L T L

12' I L T L

12' I L T L

12' I L T L

12' I L T L

12' I L T L

12' I L T L

12' I L T L

12' I L T L

12' I L T L

12' I L T L

12' I L T L

12' I L T L

12' I L T L

12' I L T L

PENNSYLVANIA MD  
SPUR 05/22/1, JOC  
SPUR 02/20/1, JOC  
SPUR 01/21/1, JOC  
SPUR 09/22/1, JOC  
AVE  
4  
TL

WEST RD AVE  
219 G HILL 705  
OLD SILVER HILL RD  
2018  
PG

24' I RT  
36' I LT  
15' GRS MED  
JC-C  
5ML

2-36' I  
JC-C  
16' GRS MED  
6ML



ROAD INVENTORY SHEET

Party Chief GD  
 Recorder GW  
 Assistant \_\_\_\_\_  
 Map No./Dir. G-118/N  
 State Coordinates \_\_\_\_\_

Road No. MD 458  
 Road Name SILVER HILL RD  
 County PG  
 Date 8/19/93  
 Sheet No. 9 OF 9

SYSTEM				TRAFFIC				TRAFFIC				PAVEMENT DATA			
FED. AID.	FUNCT. CLASS.	HWY. SYS.	HPMS SAMPLE	PRKG. REST.	COM/IND. ACCESS	CONTROL	COM/IND. ACCESS	PRKG. REST.							
<b>LINE DIAGRAM</b>															
<p>TRAFFIC CODES:</p> <ul style="list-style-type: none"> <li>STOP SIGN=SS</li> <li>TRAFFIC LIGHT=T.L.</li> <li>FLASHING RED BALL=F.R.</li> </ul>															
<p>TRAFFIC CODES:</p> <ul style="list-style-type: none"> <li>A.M. PEAK, P.M. PEAK, A.M./P.M. PEAK, NO PARKING ANYTIME=N.P., COMM/IND. ACCESS=E</li> </ul>															
URBAN Other Principal Arterial															
State Secondary															
												2-39'I 4'J MED JCC GAL			
												X			
												2-39'I 15'GRADED JCC GAL			





ROAD INVENTORY SHEET

SR-01  
F.S-01  
GOLF

00-11 ST  
2-16-01  
GOLF

BB/A  
10-2-97  
ST R-I

Party Chief GD  
Recorder GW  
Assistant \_\_\_\_\_  
Map No./Dir. G-118 / N  
State Coordinates 219-362

Road No. Ramp 4  
Road Name N.B.GV119 To E.B.MD 458  
County P.G.  
Date 8/7/93  
Sheet No. 1 OF 1

TRAFFIC CONTROLS: STOP SIGN=SS,  
TRAFFIC LIGHT=T.L.,  
FLASHING RED BALL=F.R.

TRAFFIC CODES  
PARKING RESTRICTIONS: A.M. PEAK,  
P.M. PEAK, A.M./P.M. PEAK, NO PARKING  
ANYTIME=N.P., COMM/IND. ACCESS=E

SYSTEM				TRAFFIC				LINE DIAGRAM				TRAFFIC				PAVEMENT DATA			
FED. AID.	FUNCT. CLASS.	HWY. SYS.	URBAN SAMPLE	PKG. REST.	COM/IND. ACCESS	CONTROL	COM/IND. ACCESS	PKG. REST.	LINE DIAGRAM				CONTROL	COM/IND. ACCESS	PKG. REST.	PAVEMENT DATA			
																<p>14'I JCC 1ML</p> <p>14'I JCC 1ML</p> <p>20'I JC-C 1ML</p>			





MARYLAND STATE HIGHWAY ADMINISTRATION

ROAD INVENTORY SHEET

SR01  
7-20-01  
GURF

20/AL  
9-22-97  
ST R.I.

Party Chief G. DAVIS  
Recorder A. ROUTH  
Assistant \_\_\_\_\_  
Map No./Dir. E 11 A / E  
State Coordinates \_\_\_\_\_

Road No. I-495  
Road Name CAPITAL BELTWAY  
County PRINCE GEORGES  
Date 4-7-94  
Sheet No. 1 OF 4

TRAFFIC CONTROLS: STOP SIGN=SS,  
TRAFFIC LIGHT=T.L.,  
FLASHING RED BALL=F.R.

TRAFFIC CODES  
PARKING RESTRICTIONS: A.M. PEAK,  
P.M. PEAK, A.M./P.M. PEAK, NO PARKING  
ANYTIME-N.P., COMM/IND. ACCESS=E

SYSTEM				TRAFFIC		LINE DIAGRAM				TRAFFIC		PAVEMENT DATA			
FED. AID.	FUNCT. CLASS.	HWY. SYS.	HPMS SAMPLE	PRKG. REST.	COMM/IND. ACCESS					CONTROL	COMM/IND. ACCESS	PRKG. REST.			
						LINE DIAGRAM									
						I-495 SB OUT OF STATE LANE									
						Doo'w-w/18'VC								48'I	
						STR# 16120      STR# 16174								2-10'J Shd	
						RIGGS      RD								100-200 VAD	
						MD      0 50      212								NBM	
						X								4ML	
						48'I RT									
						72'ILT									
						2-10'I Shd									
						2-12'I Shd									
						75'Grass med									
						10mL									
						X									
						48'I RT									
						72'ILT									
						2-10'I Shd									
						2-12'I Shd									
						5'NJ8m									
						10mL									
						Y									
						PRINCE GEORGE MONTGOMERY									
						0.07									
						WELCOME TO PG CO.									
						0.00									
						RAMP									
						.10									
						LINE LINE									















\* Corp. Limits changes at 0.84, 1.16, and 2.22 from Hyattsville 1992 map

MARYLAND STATE HIGHWAY ADMINISTRATION

ROAD INVENTORY SHEET

Party Chief GD  
Recorder GW  
Assistant AH  
Map No./Dir. F-11C / N  
State Coordinates 809-405

Road No. MD 500  
Road Name QUEENS CHAPEL RD  
County PG  
Date 8/25/93  
Sheet No. 3 OF 7

TRAFFIC CONTROLS: STOP SIGN=S.S.,  
TRAFFIC LIGHT=T.L.,  
FLASHING RED BALL=F.R.

TRAFFIC CODES  
PARKING RESTRICTIONS: A.M. PEAK,  
P.M. PEAK, A.M./P.M. PEAK, NO PARKING  
ANYTIME=N.P., COMM/IND. ACCESS=E

SYSTEM				TRAFFIC				LINE DIAGRAM				TRAFFIC				PAVEMENT DATA			
FED. AID.	FUNCT. CLASS.	HWY. SYS.	IRMS SAMPLE	PRKG. REST.	COM/IND. ACCESS	CONTROL	COM/IND. ACCESS	PRKG. REST.	STATION	DESCRIPTION	CONTROL	COM/IND. ACCESS	PRKG. REST.	THICKNESS	WIDTH	GRADE	DEPTH		
									099									2-24'I	
									099									10' I SHO RT	
																		JCB-LT	
																		13' GRS MED	
																		JCB5-1W	
																		4ML	
									093									X	
																		34'I RT	
																		24'I LT	
									090									2-6' I SHO RT	
									086									JCBS-1W	
																		X	
									084									10' GRS MED	
																		5ML	
									080									X	
									079									34'I RT	
																		24'I LT	
									076									10' GRS MED	
																		JC-C	
																		5ML	
									074									X	
																		2-34'I	
									073									10' GRS MED	
																		JC-C	
																		6ML	

URBAN Minor Arterial  
State Secondary

TRAFFIC CODES  
RE  
E  
RE  
RE  
NA

TL  
E  
RE  
RE  
TL  
NA

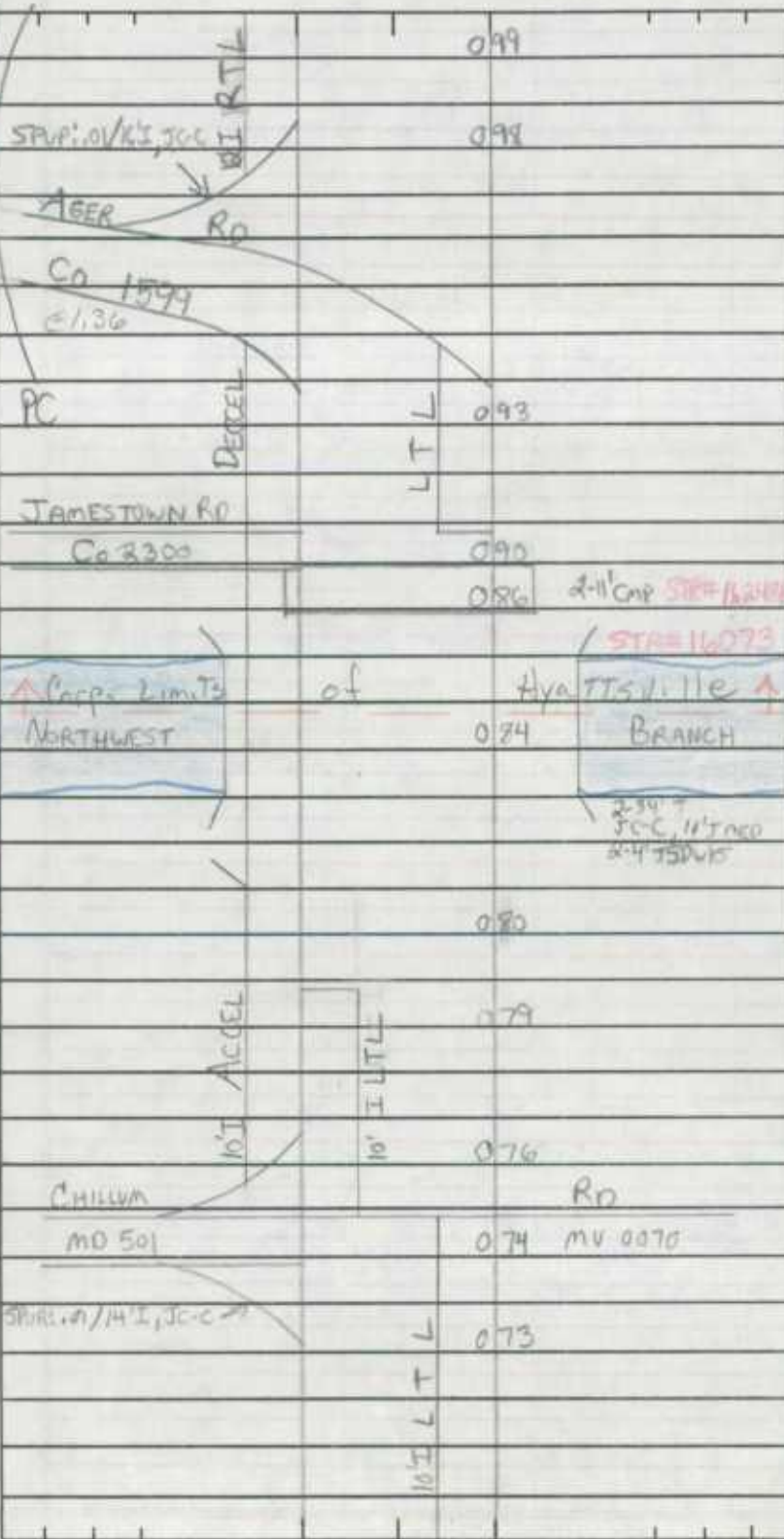

PAVEMENT DATA

2-24'I  
10' I SHO RT  
JCB-LT  
13' GRS MED  
JCB5-1W  
4ML  
X  
34'I RT  
24'I LT  
2-6' I SHO RT  
JCBS-1W  
X  
10' GRS MED  
5ML  
34'I RT  
24'I LT  
10' GRS MED  
JC-C  
5ML  
X  
2-34'I  
10' GRS MED  
JC-C  
6ML

SYSTEM				TRAFFIC		LINE DIAGRAM				TRAFFIC				PAVEMENT DATA			
FED. AID.	FUNCT. CLASS.	Hwy. Sys.	HPMS SAMPLE	PRKG. REST.	COM/IND ACCESS							CONTROL	COM/IND ACCESS	PRKG. REST.			
URBAN Minor Arterial State Secondary 7				NP 4 JS 8E		LONGFELLOW ST 140 ← MV 0260 .72				NC 9 JS E E TL X							
						LANCER DR MV 135 0230 0.30											
						HAMILTON MANOR DR MV 0140 126 0.20											
						JEFFERSON ST (#1) 124 MV 0181 0.41											
						ALLEY #28 LTL MV 8270 121 0.00											
						HAMILTON ST 118 hmts Co 1204 116 MD 208											
						SPUR 01/15'S, JCC 113 SPUR 05/15'S, JCC											
						112 LTL R											
						109											
						106											
						100											
						40° 10' I RT L											
																74' I JCC 6ML	
																36' I RT 24' I LT 12' I SHORT RT 2-2' I SHO IN 6' GR5 MED JCC 5ML	
						2-24' I 10' I SHORT JCB-LT 13' GR5 MED JCB5-IN 4ML											

































SYSTEM				TRAFFIC		LINE DIAGRAM				TRAFFIC		PAVEMENT DATA		
FED. AID.	FUNCT. CLASS.	HWY. SYS.	HPMS SAMPLE	PKG. REST.	COWING ACCESS						CONTROL	COWING ACCESS	PKG. REST.	
						9TH	6012	LMTS	4 94	Bowie				
						CO	762		4 92					
									4 91 SL = 30mph					
														24'I
														2-6'ISHD
														2 ML
														X
														24'I
														6'ISHDR
														8'ISHDLT
														2 ML
														X
									4 37					
									4 33					
									4 28					
						DRISCOLL		DR						
						CO	5071		4 26					2-12'I
														10'ISHDOUTR
														JCRIS OUTLT
									4 20					12'IPNT MED
														2 ML
						SPRINGFIELD		RD		HILLMEADE				
						CO	3641		4 12	CO	4661			
									4 08					
									4 05					
									4 04					X 24'I
														2-9'ISHD
									3 92					2-ML

URBAN Minor Arterial  
State Secondary

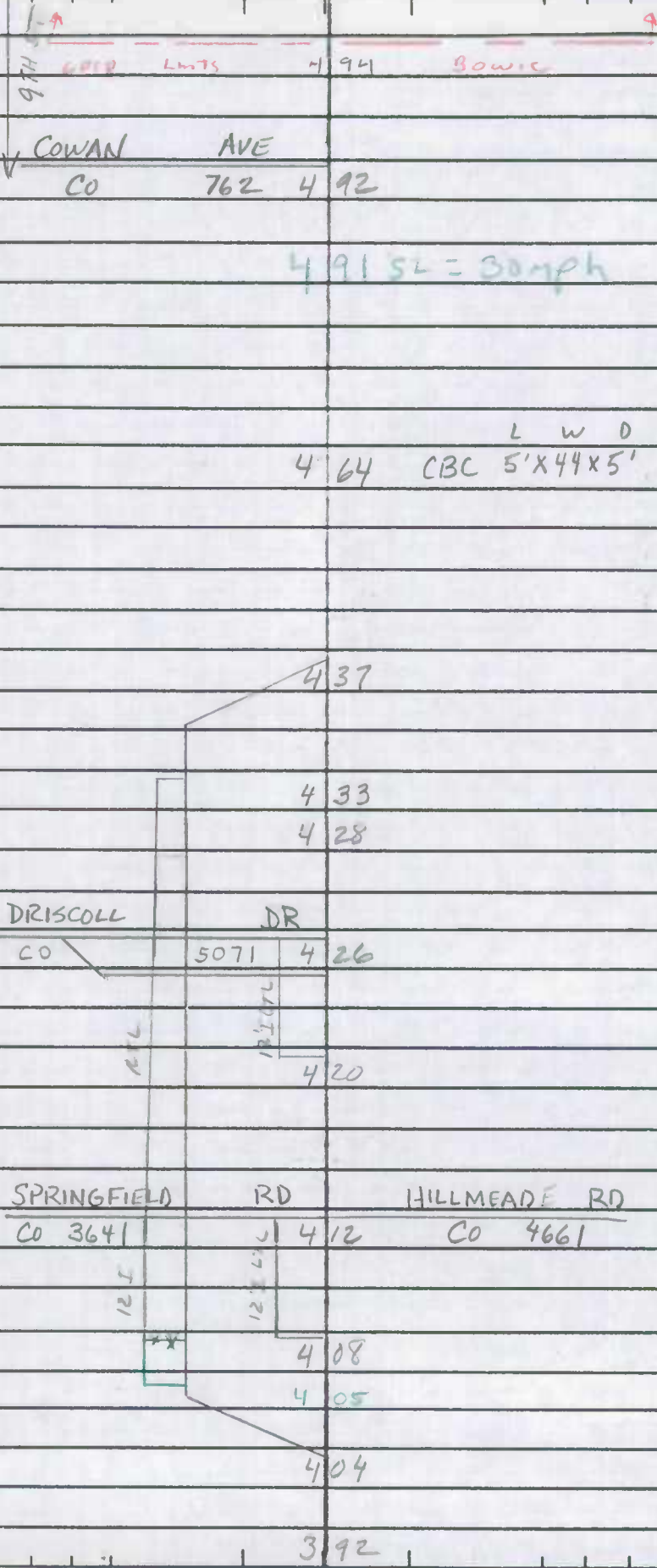

E  
E  
E









MARYLAND STATE HIGHWAY ADMINISTRATION

ROAD INVENTORY SHEET

Party Chief G. DAVIS  
 Recorder A. HATTEN  
 Assistant \_\_\_\_\_  
 Map No./Dir. F-12 / E  
 State Coordinates \_\_\_\_\_

Road No. MD 564  
 Road Name CHESTNUT AVE / 11<sup>TH</sup> ST  
 County PRINCE GEORGES  
 Date 10 - 1 - 93  
 Sheet No. 11 OF 12

TRAFFIC CONTROLS: STOP SIGN-SS,  
 TRAFFIC LIGHT-T.L.,  
 FLASHING RED BALL-F.R.

TRAFFIC RESTRICTIONS: A.M. PEAK,  
 P.M. PEAK, A.M./P.M. PEAK, NO PARKING  
 ANYTIME-N.P., COMM/IND. ACCESS=E

SYSTEM				TRAFFIC		LINE DIAGRAM						TRAFFIC		PAVEMENT DATA		
FED. AID.	FUNCT CLASS	HWY. SYS.	HPMS SAMPLE	PRKG. REST.	COM/IND. ACCESS							CONTROL	COM/IND. ACCESS	PRKG. REST.		
						ELM AVE HUNTINGTON SOUTH										
						MU 0600 6 00 REC. AREA										
						MYRTLE AVE										
						MU 5 865 1930									20'I	
						<del>5 83 500 2000</del>									2-6' J	
						5 840									2 ML	
						<del>5 76</del>									26'I	
						<del>5 73 2000</del>									J CRB RT	
						(11 <sup>TH</sup> ST)									6'I SHOET	
						5 741 MU 9110 900									2 ML	
						CHESTNUT AVE									36'I	
						CHESTNUT									JCC	
						(11 <sup>TH</sup> ST)									2 MC	
						CHESTNUT									32'I	
						CHESTNUT									JCC	
						CHESTNUT									34'I	
						CHESTNUT									J W-W	
						CHESTNUT									2 ML	

URBAN Minor Arterial  
 State Secondary

TT

11<sup>TH</sup> ST  
 900'  
 4'  
 11<sup>TH</sup> ST  
 900'  
 4'







SR-01  
7-11-01  
GOLF

(92-13a ST)

ROAD INVENTORY SHEET

Party Chief GD  
Recorder JS  
Assistant \_\_\_\_\_  
Map No./Dir. F-11 / SW  
State Coordinates 840-412

Road No. MD 564 W/BL (out of sight La)  
Road Name \_\_\_\_\_  
County PRINCE GEORGES  
Date 4-8-93  
Sheet No. 1 OF 1

BBJA  
9-18-97  
STR.I.  
AIT

TRAFFIC CONTROLS: STOP SIGN=SS  
TRAFFIC LIGHT=T.L.,  
FLASHING RED BALL=F.R.

TRAFFIC CODES

PARKING RESTRICTIONS: A.M. PEAK,  
P.M. PEAK, A.M./P.M. PEAK, NO PARKING  
ANYTIME=N.P., COMM/IND. ACCESS=E

SYSTEM			TRAFFIC			LINE DIAGRAM				TRAFFIC			PAVEMENT DATA	
FED. AID.	FUNCT. CLASS.	HWY. SYS.	HPMS SAMPLE	PRKG. REST.	COM/IND. ACCESS	CONTROL	COM/IND. ACCESS	PRKG. REST.						
ONE WAY														
MD														
						TL								

FAV 579  
UNSAN MINERAL

MD  
03/25'I 10'I RT  
JCLT

(CIPRIANO RD)

MD  
00 CO 28

01/26'I Jc-c

MD  
08/15'I 10'I RT  
JCLT

34'I  
Jc-c  
3mL

24'I  
Jc-c  
2mL



ROAD INVENTORY SHEET

RPO5950070152

SR-91  
7-11-99  
GOLF

97-56  
3-11-98  
BOLAP

(92-3 ST)

10-7-97

BB  
AL  
M-P

Party Chief GD  
Recorder JS  
Assistant \_\_\_\_\_  
Map No./Dir. FILE / W  
State Coordinates 845-406

Road No. RAMP 7  
Road Name WBI-595 to 58 MD 704  
County PRINCE GEORGES  
Date 4/5/93  
Sheet No. 1 OF 1

TRAFFIC CONTROLS: STOP SIGN=SS,  
TRAFFIC LIGHT=T.L.,  
FLASHING RED BALL=F.R.

TRAFFIC CODES  
PARKING RESTRICTIONS: A.M. PEAK,  
P.M. PEAK, A.M./P.M. PEAK, NO PARKING  
ANYTIME=N.P., COMM/IND. ACCESS=E

SYSTEM				TRAFFIC		LINE DIAGRAM				TRAFFIC		PAVEMENT DATA		
FED. AID.	FUNCT. CLASS.	HWY. SYS.	HPMS SAMPLE	PRKG. REST.	COM/IND. ACCESS					CONTROL	COM/IND. ACCESS	PRKG. REST.		
						M L KING JR		HWY						24' J
						MD	03029	704			TL			2-4' J-RT
														J-C
														2 ml
							026							* 2
							024							24' J
														10' J SHORT
						PT	022							4' J SHO LT
														1 ml
							018							X
						60°								15' J
														12' J SHD BT
														4' J SHD LT
														1 ml
						PC	007							X
														15' J
														12' J SHORT
														1 ml
														JW-RT
							000							Y

595















ROAD INVENTORY SHEET

RP 0595 02 0894

STR. I.  
10-6-97  
ALIBB/MP

90-2  
STATE

Party Chief AL  
Recorder BB  
Assistant \_\_\_\_\_  
Map No./Dir. 1  
State Coordinates \_\_\_\_\_

Road No. Ramp #2  
Road Name From W.B.I 595 to NB MD 197  
County P.G.  
Date 3-25-91  
Sheet No. 1 OF 1

91-7 (666)  
3-19-92  
DT/JS

TRAFFIC CONTROLS: STOP SIGN=SS,  
TRAFFIC LIGHT=T.L.,  
FLASHING RED BALL=F.R.

TRAFFIC CODES  
PARKING RESTRICTIONS: A.M. PEAK,  
P.M. PEAK, A.M./P.M. PEAK, NO PARKING  
ANYTIME=N.P., COMM/IND. ACCESS=E

SYSTEM				TRAFFIC				LINE DIAGRAM				TRAFFIC				PAVEMENT DATA	
FED. AID.	FUNCT. CLASS.	HWY. SYST.	HWY. SAMPLE	PKCG. REST.	COMM/IND. ACCESS	CONTROL	COMM/IND. ACCESS	PKCG. REST.					CONTROL	COMM/IND. ACCESS	PKCG. REST.	PAVEMENT DATA	
									LINE DIAGRAM								
																24' I 10' I SHD JCLT 2ML X 24' I 12' I SHD 3' I SPS 2ML X 24' I 12' I SHD 4' I SHD 10' I 22' I SHD TML SMALL RT 2ML X 24' J 12' I SHD 22' I SHD 22' I SHD 2XML Y	





MARYLAND STATE HIGHWAY ADMINISTRATION

ROAD INVENTORY SHEET

1205930030634

SR-01  
7-13-91  
GJL/CF

90-2  
STATE  
S.T.R.I.  
10-6-97  
ALIBB/MP

Party Chief AL  
Recorder BB  
Assistant \_\_\_\_\_  
Map No./Dir. /  
State Coordinates \_\_\_\_\_

Road No. Ramp# 3  
Road Name From Ramp#6 to NB MD197  
County P.G.  
Date 3/25/91  
Sheet No. 1 OF 1

TRAFFIC CONTROLS: STOP SIGN=S.S.,  
TRAFFIC LIGHT=T.L.,  
FLASHING RED BALL=F.R.

TRAFFIC CODES  
PARKING RESTRICTIONS: A.M. PEAK,  
P.M. PEAK, A.M./P.M. PEAK, NO PARKING  
ANYTIME=N.P., COMM/IND. ACCESS=E

SYSTEM				TRAFFIC		LINE DIAGRAM						TRAFFIC				PAVEMENT DATA
FED. AID.	FUNCT. CLASS.	HWY. SYS.	HRMS. SAMPLE	PRKG. REST.	COM/IND. ACCESS							CONTROL	COM/IND. ACCESS	PRKG. REST.		
						Collington (WBL) Rd										
						0 145					72					
						MD (SBL)	197									
						0 13	PT									
							45°									36' I 24' I 10' ISHDLT 4' SHDLT 15' ISHDLT 28' ML
						0 06	PC									X
							Ramp #6									24' I 10' ISHDLT 2' ML 4' SHDLT
						0 00	Ramp #6									V





ROAD INVENTORY SHEET

KPO 595004 0706  
SR-01  
7-12-01  
GOLF

Party Chief DT  
Recorder JS  
Assistant \_\_\_\_\_  
Map No./Dir. /  
State Coordinates \_\_\_\_\_

Road No. RAMP 4  
Road Name FR MD197 NB TO ICG 595EB  
County PRINCE GEORGES  
Date 3-18-92  
Sheet No. 1 OF 1

91-7 (state)  
ST. R I  
10-6-97  
ALIBB/MP

TRAFFIC CONTROLS: STOP SIGN=SS,  
TRAFFIC LIGHT=T.L.,  
FLASHING RED BALL=F.R.

TRAFFIC RESTRICTIONS: A.M. PEAK,  
P.M. PEAK, A.M./P.M. PEAK, NO PARKING  
ANYTIME=N.P., COMM/IND. ACCESS=E

SYSTEM				TRAFFIC			LINE DIAGRAM						TRAFFIC			PAVEMENT DATA	
FED. AID.	FUNCT CLASS.	HWY. SYS.	HPMS SAMPLE	PRKG. REST.	COMM/IND. ACCESS		CONTROL	COMM/IND. ACCESS	PRKG. REST.								
						<p>14' J</p> <p>12' J SMD RT</p> <p>3' J SMD</p> <p>1mL</p>											
						<p>14' I</p> <p>10' I SMD</p> <p>3' I SMD</p> <p>1mL</p>											



ROAD INVENTORY SHEET

120595005 0669  
ST. RI 10-6-97  
ALBB/MP  
90-2 STATE  
91-7 STATE  
3-13-92  
BT/JS

Party Chief AL  
Recorder BB  
Assistant \_\_\_\_\_  
Map No./Dir. 1  
State Coordinates \_\_\_\_\_

Road No. Ramp #5  
Road Name From S.B MD197 TO E.B. IS95  
County P.G.  
Date 3-25-91  
Sheet No. 1 OF 1

TRAFFIC CONTROLS: STOP SIGN=S.S.,  
TRAFFIC LIGHT=T.L.,  
FLASHING RED BALL=F.R.

TRAFFIC CODES  
PARKING RESTRICTIONS: A.M. PEAK,  
P.M. PEAK, A.M./P.M. PEAK, NO PARKING  
ANYTIME=N.P., COMM/IND. ACCESS=E

SYSTEM				TRAFFIC				LINE DIAGRAM				TRAFFIC			PAVEMENT DATA	
FED. AID.	FUNCT. CLASS.	HYD. SYS.	URBAN SAMPLE	PRVG. REST.	COMM/IND. ACCESS	CONTROL	COMM/IND. ACCESS	PRVG. REST.	LINE DIAGRAM		CONTROL	COMM/IND. ACCESS	PRVG. REST.	PAVEMENT DATA		
														16 J		
									<p>0 33</p> <p>0 30</p> <p>0 28</p> <p>0 25</p> <p>0 02</p> <p>0 00</p>							





















SR-01  
7-12-01  
GD/DF

BB/AL  
STR.I  
9-17-97

ROAD INVENTORY SHEET

Party Chief G. DAVIS  
Recorder A HATTEN  
Assistant \_\_\_\_\_  
Map No./Dir. B-11-B / N  
State Coordinates 827-385

Road No. MD 707  
Road Name MARTIN LUTHER KING JR HWY  
County PRINCE GEORGES  
Date 9-14-93  
Sheet No. 1 OF 17

**LINE DIAGRAM**

TRAFFIC CONTROLS: STOP SIGN=SS,  
TRAFFIC LIGHT=L,  
FLASHING RED BALL=F.R.

TRAFFIC CODES  
PARKING RESTRICTIONS: A.M. PEAK,  
P.M. PEAK, A.M./P.M. PEAK, NO PARKING  
ANYTIME=N.P., COMM/IND. ACCESS=E

SYSTEM				TRAFFIC				TRAFFIC				PAVEMENT DATA	
FED. AID.	FUNCT CLASS.	HWY. SYS.	H/W/S SAMPLE	PKG. REST.	COMM/IND. ACCESS	CONTROL	COMM/IND. ACCESS	PKG. REST.					

URBAN minor Arterial State Secondary

TRAFFIC CODES  
No PKG

TRAFFIC CODES  
No PKG

PAVEMENT DATA  
2-32' I  
16' J MED  
J CC  
6 ML  
No PKG  
32' I RT  
40' I LT  
4' J MED  
J-CC  
58 ML

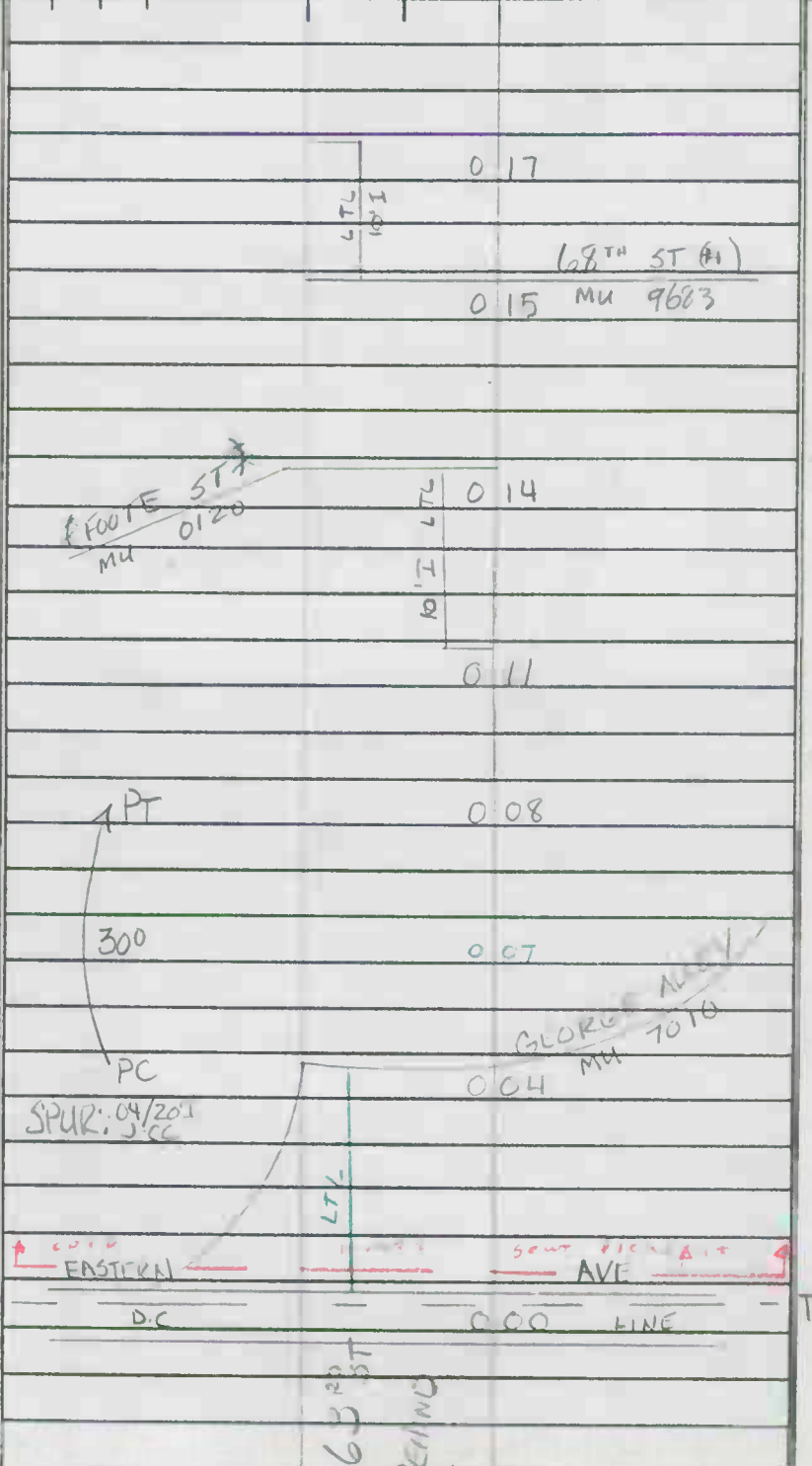

SYSTEM				TRAFFIC		LINE DIAGRAM					TRAFFIC		PAVEMENT DATA			
FED. AID.	FUNGT. CLASS.	HWY. SYS.	HPMS SAMPLE	PRKG. REST.	COM/IND ACCESS						CONTROL	COM/IND ACCESS	PRKG. REST.			
																2-34'I
																15' CPS MED
																J-CC
																6 ML

URBAN minor Arterial  
State Secondary

65<sup>TH</sup> AVE  
MU ~~9896~~  
9650

0.37

0.34

0.33  $S_L = 30\text{mph}$

0.32

0.31

0.29

ADDISON RD

0.27 CO 366

0.25

ADDISON RD

CO 351

0.22

0.19

X

TL

TL

V

4  
JS

2E

4  
JS

E



ROAD INVENTORY SHEET

Party Chief G. DAVIS  
 Recorder A. HATTEN  
 Assistant \_\_\_\_\_  
 Map No./Dir. B-11-B / N  
 State Coordinates 827-385

Road No. MD 704  
 Road Name MARTIN LUTHER KING JR HWY  
 County P.G  
 Date 9-14-93  
 Sheet No. 3 OF 17

98-2 MU  
G.D.  
E.F.  
2/24/99

TRAFFIC CONTROLS: STOP SIGN=SS,  
TRAFFIC LIGHT=T.L.,  
FLASHING RED BALL=F.R.

TRAFFIC CODES  
 PARKING RESTRICTIONS: A.M. PEAK,  
P.M. PEAK, A.M./P.M. PEAK, NO PARKING  
ANYTIME=N.P., COMM/IND. ACCESS=E

SYSTEM				TRAFFIC				LINE DIAGRAM		TRAFFIC				PAVEMENT DATA	
FED. AID.	FUNCT. CLASS.	HWY. SYS.	HPMS SAMPLE	PKG. REST.	COM/IND. ACCESS	CONTROL	COM/IND. ACCESS			PKG. REST.					

URBAN Minor Arterial  
State Secondary

IT  
H  
JS  
E  
GE

V  
4  
JS  
PKG  
NO  
9E

APTS 0.68

CABIN BRANCH DR  
GREIG ST 0.67 MU 0050  
MU 0160  
H  
71<sup>ST</sup> AVEX  
0.61 MU 9710

APT. 0.59

M.L. KING JR CT  
GEORGE POWELL CT  
0.55 MU 0146  
0.54 SL = 40 MPH

69<sup>TH</sup> PL  
MU 9690 0.51

I  
R  
0.49  
0.46

2-34'I  
15'6R3 MED  
J-CC  
6 ML



ROAD INVENTORY SHEET

Party Chief GD  
 Recorder AH  
 Assistant \_\_\_\_\_  
 Map No./Dir. FIELD / U  
 State Coordinates 827-385

Road No. MD 704  
 Road Name MARTIN LUTHER KING HWY  
 County PG  
 Date 9-14-93  
 Sheet No. 5 OF 17

TRAFFIC CONTROLS: STOP SIGN=F.S.S.,  
 TRAFFIC LIGHT=T.L.,  
 FLASHING RED BALL=F.R.

TRAFFIC CONTROLS: A.M. PEAK,  
 P.M. PEAK, A.M./P.M. PEAK, NO PARKING  
 ANYTIME=N.P., COMM/IND. ACCESS=F

SYSTEM				TRAFFIC				LINE DIAGRAM				TRAFFIC				PAVEMENT DATA					
FED. AID.	FUNCT. CLASS.	HWY. SYS.	HPMS SAMPLE	PRKG. REST.	COM/IND. ACCESS									CONTROL	COM/IND. ACCESS	PRKG. REST.					

Urban Minor Arterial  
 State Secondary

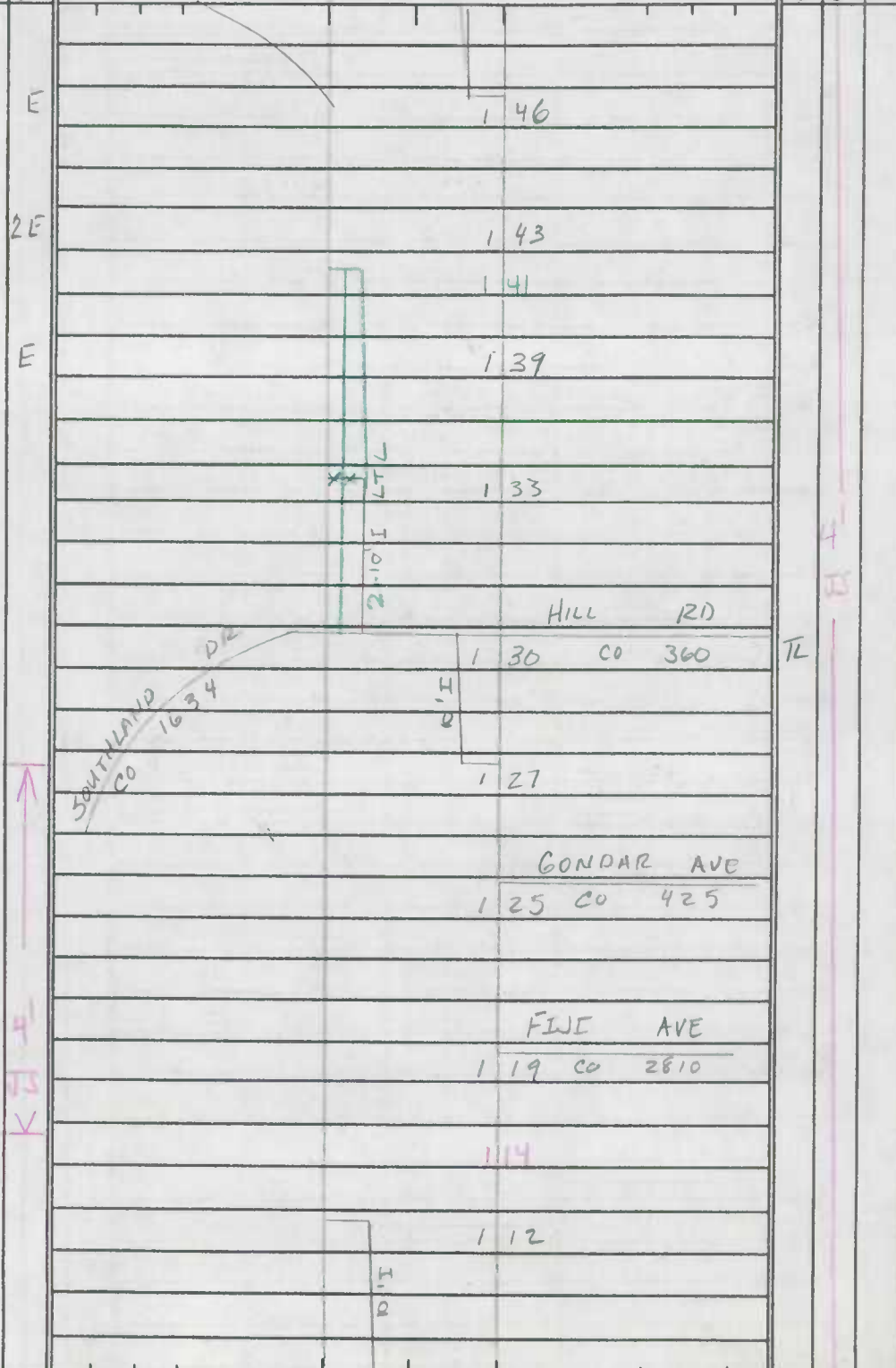

2-34' I  
 15' GRS MED  
 J-CC  
 6 ML



SYSTEM				TRAFFIC				LINE DIAGRAM				TRAFFIC				PAVEMENT DATA						
FED. AID.	FUNCT. CLASS.	HWY. SYS.	HPWS SAMPLE	PRKG. REST.	COM/IND ACCESS							CONTROL	COM/IND ACCESS	PRKG. REST.								
Urban Minor Arterial State Secondary																						

RYDERWOOD CT  
OP 4863

1 89  
1 83

COLUMBIA AVE  
Co 336

1 74

ROOSEVELT AVE  
Co 1188

10' I  
10' I  
1 65  
1 62

1 57

1 55

LTY

10' I  
1 53  
2D  
75

1 51

SPUR 01/25' I  
J-CC

TL

SHERIFF  
Co

1 48

SPUR 01/25' I  
J-CC

2-36' I  
15' CRS MED  
J-CC  
6 ML

2-34' I  
15' CRS MED  
J-CC  
6 ML

4  
J3

4  
J3

2E

2E

X

ROAD INVENTORY SHEET

Party Chief GP  
 Recorder A.H.  
 Assistant \_\_\_\_\_  
 Map No./Dir. F11D /  
 State Coordinates \_\_\_\_\_

Road No. MD 704  
 Road Name MARTIN LUTHER KING JR HWY  
 County PG  
 Date 9-14-93  
 Sheet No. 7 OF 17

TRAFFIC CONTROLS: STOP SIGN=S.S.,  
 TRAFFIC LIGHT=T.L.,  
 FLASHING RED BALL=F.R.

TRAFFIC RESTRICTIONS: A.M. PEAK,  
 P.M. PEAK, A.M./P.M. PEAK, NO PARKING  
 ANYTIME=N.P., COMM/IND. ACCESS=E

SYSTEM				TRAFFIC		LINE DIAGRAM										TRAFFIC		PAVEMENT DATA		
FED. AID.	FUNCT. CLASS.	HWY. SYS.	URBAN SAMPLE	PRKG. REST.	COMM/IND. ACCESS											CONTROL	COMM/IND. ACCESS	PRKG. REST.		
						LINE DIAGRAM														
						<div style="display: flex; justify-content: space-between;"> <span>WEST SPRING ST</span> <span>CO 2635</span> <span>2 32</span> </div>														
						<div style="display: flex; justify-content: space-between;"> <span></span> <span>10' I</span> <span>2 28</span> </div>														
						<div style="display: flex; justify-content: space-between;"> <span></span> <span>10' I</span> <span>2 22</span> </div>														
						<div style="display: flex; justify-content: space-between;"> <span></span> <span>10' I</span> <span>2 21</span> </div>														
						<div style="display: flex; justify-content: space-between;"> <span>COLUMBIA PARK RD</span> <span>CO 3668</span> <span>2 18</span> <span>BELLE HAVEN DR</span> <span>CO 319</span> </div>														
						<div style="display: flex; justify-content: space-between;"> <span></span> <span>10' I</span> <span>2 14</span> </div>														
						<div style="display: flex; justify-content: space-between;"> <span></span> <span>10' I</span> <span>2 08</span> <span>SC.</span> </div>													2-36' I	
						<div style="display: flex; justify-content: space-between;"> <span></span> <span>10' I</span> <span>2 02</span> </div>													15' GR5 MED	
																			J-CC	
																			6 ML	

URBAN Minor Arterial  
 State Secondary

3E

4J  
5

2E

TL

E  
4'  
J  
E  
E

SYSTEM				TRAFFIC		LINE DIAGRAM				TRAFFIC				PAVEMENT DATA						
FED. AID.	FUNCT. CLASS.	HWY. SYS.	HPMS SAMPLE	PRKG. REST.	COM/IND ACCESS					CONTROL	COM/IND ACCESS	PRKG. REST.								
URBAN Minor Arterial State Secondary																				

GOODLAND DR

CO 3848

2 71

10' I LTL

2 69

2 67

10' I LTL

2 62

GREENLEAF RD

2 59 CO 1231

TL

X

SP# 16013

CATTAIL

2 50

BRANCH

L W D  
CBC 20' 100' 15'

FLAGSTAFF ST

CO 3727

2 43

10' I

2 37

EAST RIDGE DR

CO 2034

2 38

24' I RT  
36' I LT  
15' GRS MDL  
J CC  
5' ML

2-36' I  
15' GRS MDL  
J CC  
6 ML





\* Corp limits chg. from 2000 Glenarden map

SYSTEM				TRAFFIC				TRAFFIC				PAVEMENT DATA													
FED. AID.	FUNCT. CLASS.	HWY. SYS.	HPMS SAMPLE	PRKG. REST.	CONVING ACCESS	CONTROL	CONVING ACCESS	PRKG. REST.																	
URBAN Minor Arterial State Secondary 207040000343								LINE DIAGRAM																	
								TL								TL									
								12' I LTL	3 66	CLENARDEN PKWY															
									3 61 0 140	MU															
								12' I LTL																	
								12' I	3 54	CLENARDEN PKWY															
										MU															
									<del>3 51</del>																
									3 52																
								12' I	3 50																
									3 48																
								12' I LTL	3 46																
								12' I	3 43																
									<del>3 43</del>																
								12' I LTL	3 36																
										(HUBBARD RD) (BARLOWE DR)															
									3 32	MU 0165 MU 0009															
								12' I LTL																	
								12' I	3 27																
										corp limit Glenarden chg															
	3 24																								

2-36' I  
 4" J med  
 J-CC  
 6 ML

X 24' I LT  
 X 36' I RT  
 15' CR5 MED  
 J-CC  
 5X ML

00-42 ST  
2-21-01  
601EF

ROAD INVENTORY SHEET

Party Chief G. DAVIS  
Recorder A. HATTEN  
Assistant \_\_\_\_\_  
Map No./Dir. FIID /  
State Coordinates \_\_\_\_\_

Road No. MD 704  
Road Name MARTIN LUTHER KING HWY  
County \_\_\_\_\_  
Date \_\_\_\_\_  
Sheet No. 11 OF 17

TRAFFIC CONTROLS: STOP SIGN=SS,  
TRAFFIC LIGHT=T.L.,  
FLASHING RED BALL=F.R.

PARKING RESTRICTIONS: A.M. PEAK,  
P.M. PEAK, A.M./P.M. PEAK, NO PARKING  
ANYTIME=N.P., COMM/IND. ACCESS=E

SYSTEM					TRAFFIC			LINE DIAGRAM			TRAFFIC			PAVEMENT DATA	
FED. AID.	FUNCT CLASS.	HWY. SYS.	HPMS SAMPLE	PRKG. REST.	COM/IND. ACCESS	CONTROL	COM/IND. ACCESS	PRKG. REST.	LINE DIAGRAM			CONTROL	COM/IND. ACCESS	PRKG. REST.	PAVEMENT DATA
															24' I RT
															36' I LT
															4' J MED
															J-CC
															5 ML

URBAN minor Arterial  
State Secondary

207040000343

Dalhousie CT  
Exit in TH

REED ST

3 83 Glen ARDEN

JOHNSON AVE  
MU 3 75 191

3 76

E  
4'  
TL

2-36' I  
4' J MED  
J CC  
6 ML



SYSTEM				TRAFFIC		LINE DIAGRAM				TRAFFIC		PAVEMENT DATA	
FED. AID.	FUNCT. CLASS.	TRAV. SYS.	HPMS SAMPLE	PRKG. REST.	CONVND ACCESS					CONTROL	COM/ND ACCESS	PRKG. REST.	
	URBAN Minor Arterial					SPUR: 02/21' J-CC							
	State Secondary					WHITFIELD CD							
						4 52		74			TL		
						SPUR: 04/18' I-CC							
						4 51		SMR 02/21' I-CC					
						4 50							
						4 48							
						4 46							
								4 39					
						IS		4 37		95			
								4 34		32' J RT 29' J LT 15' J MED J-WW			
								4 28		SL=50mph			2-24' I
								4 21					2-10' SHOULDER
													15' GRASS MED
													J CRASH LN
													4 ML
								4 19					
								4 18					
						ARDWICK -							
						CD				ARDMORE RD			
						4 15		65			TL		X
						SPUR: 03 14' I-CC							
													24' I RT
								4 13					30' I LT
													4' J MED
													J CC
								4 12					4 ML
											ZE		
								4 09					

2-24' I  
2-10' SHOULDER  
15' GRASS MED  
J CRASH LN  
4 ML

24' I RT  
30' I LT  
4' J MED  
J CC  
4 ML

URBAN Minor Arterial  
State Secondary

SPUR: 02/21' J-CC

04/18' I-CC

WHITFIELD CD

CHAPEL RD

SPUR: 04/18' I-CC

SMR 02/21' I-CC

SMR 147

IS

32' J RT  
29' J LT  
15' J MED  
J-WW

4 28 SL=50mph

ARDWICK -

ARDMORE RD

SPUR: 03 14' I-CC

ROAD INVENTORY SHEET

Party Chief GD  
Recorder A.H.  
Assistant \_\_\_\_\_  
Map No./Dir. F11D/  
State Coordinates \_\_\_\_\_

Road No. MD 704  
Road Name MARTIN LUTHER KING JR HWY  
County PG  
Date 9-14-93  
Sheet No. 13 OF 17

TRAFFIC CONTROLS: STOP SIGN=S.S.,  
TRAFFIC LIGHT=T.L.,  
FLASHING RED BALL=F.R.

TRAFFIC CODES  
PARKING RESTRICTIONS: A.M. PEAK,  
P.M. PEAK, A.M./P.M. PEAK, NO PARKING  
ANYTIME=N.P., COMM/IND. ACCESS=E

SYSTEM				TRAFFIC			LINE DIAGRAM						TRAFFIC			PAVEMENT DATA			
FED. AID.	FUNCT CLASS.	HWY. SYS.	HWAYS SAMPLE	PRKG. REST.	COM/IND.	ACCESS	CONTROL	COW/IND.	ACCESS	PRKG.	REST.								
URBAN	Minor Arterial	State	Secondary																36' RT
																			24' LT
																			2-3' SHO &
																			1 CC 12 I shd in LT
																			5 ML
																			2-24' J
																			75' 60' MED
																			1 CC
																			4 ML
																			12' I shd in RT

LINE DIAGRAM

PAVEMENT DATA

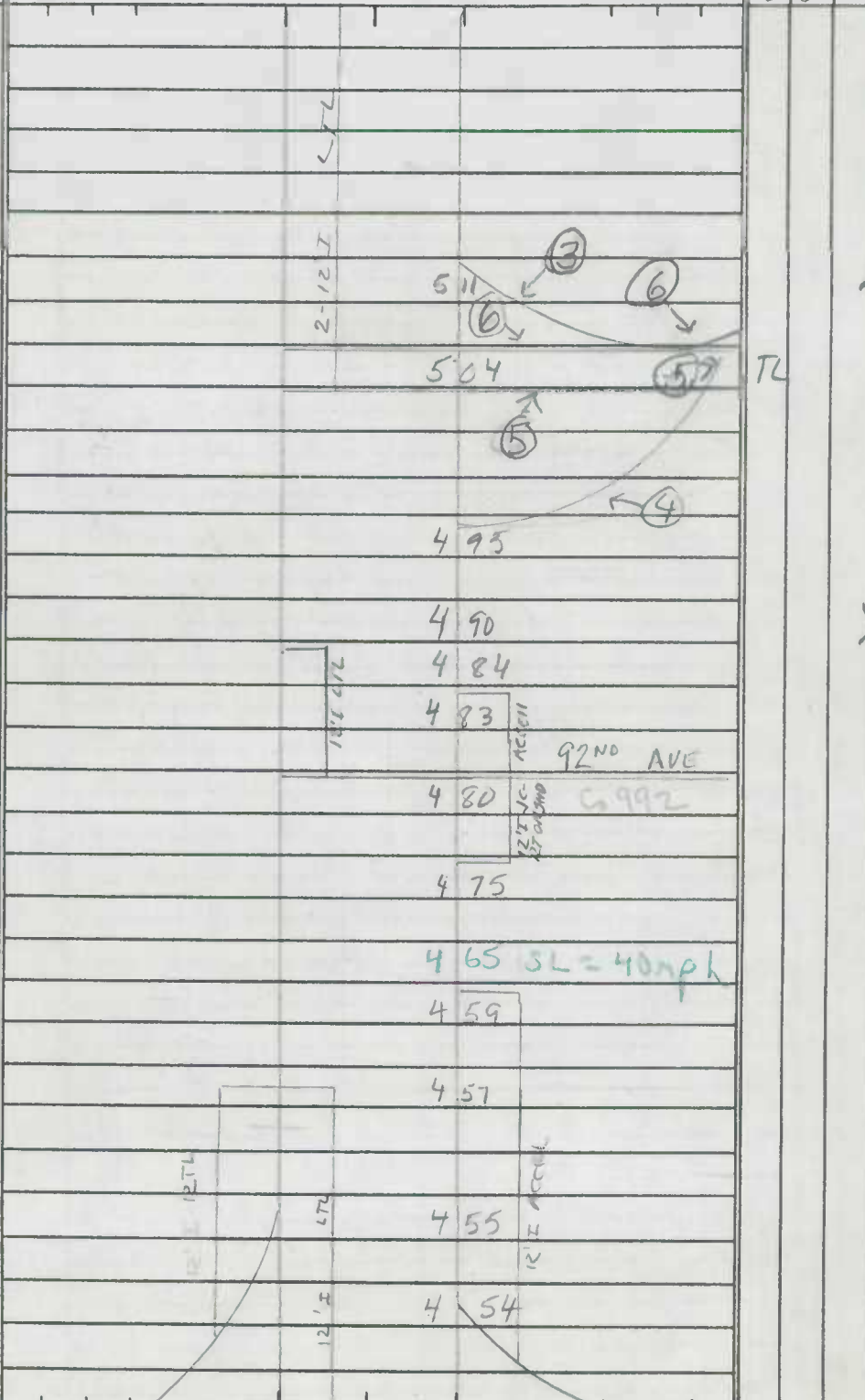

36' RT  
24' LT  
2-3' SHO &

1 CC 12 I shd in LT

5 ML

2-24' J

75' 60' MED

1 CC

4 ML

12' I shd in RT

2-24' J

2-10' I SHO &

15' 60' MED

1 CC

4 ML

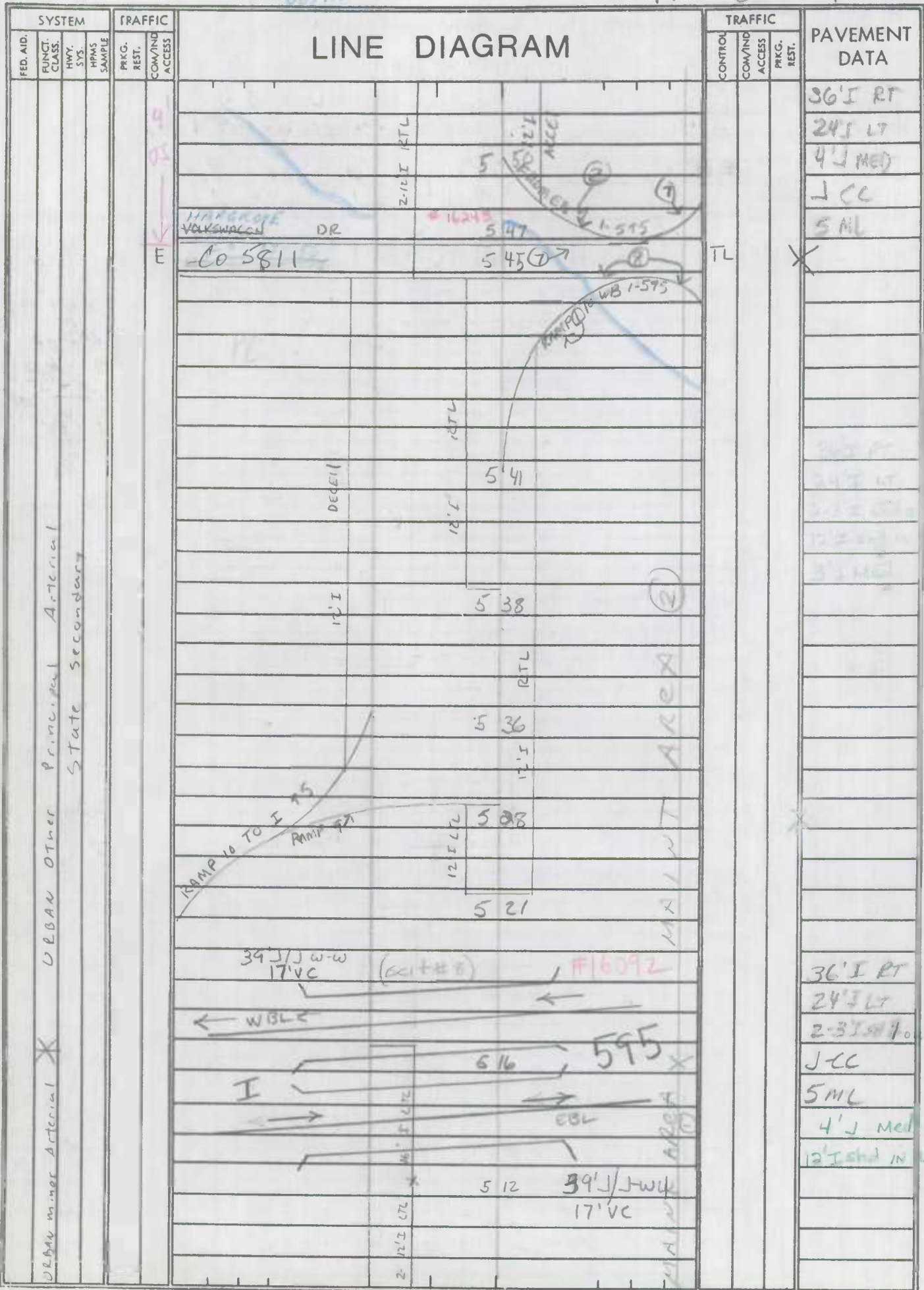

36'I RT  
 24'I LT  
 2-3' J/J w-w  
 JCC  
 5ML  
 4'J Med  
 12' I chd in LT



MARYLAND STATE HIGHWAY ADMINISTRATION

ROAD INVENTORY SHEET

Party Chief G.D  
 Recorder A.H  
 Assistant \_\_\_\_\_  
 Map No./Dir. F12 /  
 State Coordinates \_\_\_\_\_

Road No. MD 704  
 Road Name MARTIN LUTHER KING JR HWY  
 County PG  
 Date 9-14-93  
 Sheet No. 15 OF 17

TRAFFIC CONTROLS: STOP SIGN=SS,  
 TRAFFIC LIGHT=L.,  
 FLASHING RED BALL=F.R.

PARKING RESTRICTIONS: A.M. PEAK,  
 P.M. PEAK, A.M./P.M. PEAK, NO PARKING  
 ANYTIME=N.P., COMM/IND. ACCESS=E

SYSTEM				TRAFFIC				TRAFFIC				PAVEMENT DATA											
FED. AID.	FUNCT CLASS.	HWY. SYS.	HPMS SAMPLE	PRG. REST.	COM/IND.	ACCESS	CONTROL	COM/IND.	ACCESS	PRG. REST.													
URBAN Other Principal Arterial State Secondary				LINE DIAGRAM				E		X		24' RT											
												36' LT		4' J MED		J-CC		5 ML					
												2-12' I		12' I		5 74							
												12' I		12' I		5 69							
												SOUTHGATE BUS PARK				12' I		5 65		E		2-36' I	
												EASTRINT BUS PARK				12' I		5 59				4' J MED	
												2-12' I		12' I		5 56						J-CC	
												12' I		12' I		5 55						6 ML	
												2-12' I		12' I		5 54						X	
												12' I		12' I		5 53						36' RT	
												2-12' I		12' I		5 52						24' LT	
												12' I		12' I		5 51						4' J MED	
												2-12' I		12' I		5 50						J-CC	
												12' I		12' I		5 49						5 ML	
												2-12' I		12' I		5 48							
												12' I		12' I		5 47							
												2-12' I		12' I		5 46							

SYSTEM				TRAFFIC				TRAFFIC				PAVEMENT DATA	
FED. AID.	FUNCT. CLASS.	HWY. SYS.	HPMS SAMPLE	PRKG. REST.	COM/IND ACCESS	CONTROL	COM/IND ACCESS	PRKG. REST.					
URBAN Other Principal Arterial State Secondary								LINE DIAGRAM				56'I	
												60' I	
												<del>20'I</del>	
												<del>20'I</del>	
												6 21	
												6 20	
												BUSINESS PKWY	
												LOTTSFORD VISTA RD	
												CO 4897	
												CO 67	
SPUR 01/22'I J-CC				PC								TL	
												6 18	
												X	
												6 17	
												X	
												6 15	
												X	
												X	
												X	
												X	
12'I 4' LT												E	
												E	
												E	
												E	
												E	
												E	
												E	
												E	
												E	
												E	
SPUR 01/17'I J-CC				SPUR 01/17'I J-CC								E	
												E	
												E	
												E	
												E	
												E	
												E	
												E	
												E	
												E	
FORBES CO				BLVD CO								TL	
												5 95	
												5 93	
												5 87	
												5 84	
												5 82	
												4224	
												5 80	
												5 80	
												5 80	
SPUR 02/17'I J-CC				SPUR 01/17'I J-CC								X 24'I R7	
												36'I LT	
												4' J MED	
												<del>8'I SPUR</del>	
												J-CC	
												5 MIL	
												5 MIL	
												5 MIL	
												5 MIL	
												5 MIL	

MARYLAND STATE HIGHWAY ADMINISTRATION

ROAD INVENTORY SHEET

Party Chief GD  
Recorder EF  
Assistant \_\_\_\_\_  
Map No./Dir. F-12 / N  
State Coordinates \_\_\_\_\_

Road No. MD 704  
Road Name MARTIN LUTHER KING JR HWY  
County PG  
Date 2-20-01  
Sheet No. 17 OF 17

TRAFFIC CONTROLS: STOP SIGN-SS7  
TRAFFIC LIGHT=L.L.,  
FLASHING RED BALL=F.R.

TRAFFIC CODES  
PARKING RESTRICTIONS: A.M. PEAK,  
P.M. PEAK, A.M./P.M. PEAK, NO PARKING  
ANYTIME=N.P., COMA/IND., ACCESS=E

SYSTEM				TRAFFIC				LINE DIAGRAM				TRAFFIC				PAVEMENT DATA	
FUNCT CLASS	HWY SYS	HPMS SAMPLE		REG. EST.	COM/IND	ACCESS		CONTROL	COM/IND	ACCESS	PKG.	REST.					
URBAN OTHER PRINCIPAL ARTERIAL																	
				STATE SECONDARY													
				ANNAPOLIS RD													
				MD 450				653				TL					
				203-20I-Jcc				(STEVE *16081 Removed)									
				650													
				SPUR CONNECTOR													
				646				to old section MD 704									
				643				10' S									
				PT				630									
				LOTTSFORD VISTA RD													
				CO 929				628									
				30°													
																2:36'I	
																15'GRS Med	
																Jcc	
																6ML	





SR01  
5-11-01  
60/EP

ROAD INVENTORY SHEET

BB/AL  
8-27-97  
STRI.  
MT

Party Chief G. DAVIS  
Recorder A. HATTEN  
Assistant \_\_\_\_\_  
Map No./Dir. 6-12 / N  
State Coordinates 871-357

Road No. MD 717  
Road Name WATER ST  
County PRINCE GEORGES  
Date 9-1-93  
Sheet No. 1 OF 2

TRAFFIC CONTROLS: STOP SIGN=S.S.  
TRAFFIC LIGHT=T.L.,  
FLASHING RED BALL=F.R.

TRAFFIC RESTRICTIONS: A.M. PEAK,  
P.M. PEAK, A.M./P.M. PEAK, NO PARKING  
ANYTIME=N.P., COMM/IND. ACCESS=E

SYSTEM				TRAFFIC		LINE DIAGRAM						TRAFFIC		PAVEMENT DATA				
FED. AID.	FUNCT. CLASS.	HWY. SYS.	IRMS SAMPLE	PKG. REST.	COM/IND. ACCESS	CONTROL	COM/IND. ACCESS	PKG. REST.							CONTROL	COM/IND. ACCESS	PKG. REST.	
	URBAN	LOCAL																30'I J-CC 2 ML
	URBAN	MINOR ARTERIAL							<p>WB LA</p> <p>006</p> <p>MD 005 4</p> <p>EB LA</p> <p>004</p> <p>16079</p> <p>ENT TO PIERCE RIDE AND EQUESTRIAN CENTER</p>									
	URBAN	STATE SECONDARY																









MARYLAND STATE HIGHWAY ADMINISTRATION

ROAD INVENTORY SHEET

Party Chief G. DAVIS  
 Recorder A. HATTEN  
 Assistant \_\_\_\_\_  
 Map No./Dir. G-12/E  
 State Coordinates 868-358

Road No. MD 725  
 Road Name OLD MARLBORO PIKE/MAIN ST  
 County PRINCE GEORGES  
 Date 9-2-93  
 Sheet No. 3 OF 8

TRAFFIC CONTROLS: STOP SIGN=SS,  
 TRAFFIC LIGHT=T.L.,  
 FLASHING RED BALL=F.R.

TRAFFIC CODES  
 PARKING RESTRICTIONS: A.M. PEAK,  
 P.M. PEAK, A.M./P.M. PEAK, NO PARKING  
 ANYTIME=N.P., COMM/IND. ACCESS=E

SYSTEM			TRAFFIC		LINE DIAGRAM										TRAFFIC			PAVEMENT DATA								
FED. AID.	FUNCT. CLASS.	HWY. SYS.	HPMS SAMPLE	PKG. REST.	COM/IND. ACCESS																					
				NO PKG		ELM ST WATER ST																				
						Co 4027 078 MD 717																				
						ST																				
						SERVICE LA																				
						MU 0110 073																				
						MAIN																				
						071																				
						065																				
						OLD MARLBORO PIKE																				
						CRAN TRINITY LA																				
						MU 0030 MU 0115																				
						1217																				
						SERVICE LA																				
						MU 0010 059																				
						ELM ST																				
						MU 0050 054																				
						24'I																				
						2ML																				

URBAN Minor Arterial (UPPER MAIN) State Secondary

D 20725000025

TRAFFIC CONTROL: METERED PKG

TRAFFIC CONTROL: METERED PKG

PAVEMENT DATA

35'I  
 J.C.C.  
 2ML

22'I  
 ON TAP R 70  
 35'I  
 2ML

24'I  
 2ML



# LINE DIAGRAM

SYSTEM				TRAFFIC		LINE DIAGRAM				TRAFFIC		PAVEMENT DATA			
FED. AID.	FUNCT. CLASS.	Hwy. Sys.	HPMS SAMPLE	PKG. REST.	COM/IND ACCESS					CONTROL	COM/IND ACCESS	PKG. REST.			
URBAN Minor Arterial (Upper Expressway)						1.00	PRATT ST MU 0560				E				
						0.97					E				
						0.94	(30°)				E				
						0.92	PRATT ST Mu 0020				E			28 I J.C.C. 2 ML	
						0.90	(45°)				E				
						0.89	(EAST COURT DR)				E				
						0.88	CO 4951				E				
						0.85	UPPER MARLBORO POSTOFFICE      PG. CO. COURTHOUSE				E				
						0.83	WEST COURT DR				E			35' I J-CC	

NO PKG

METER PKG

28 I  
J.C.C.  
2 ML

35' I  
J-CC



SYSTEM				TRAFFIC		TRAFFIC			PAVEMENT DATA				
FED. AID.	FUNCT. CLASS.	HWY. SYS.	HPMS SAMPLE	PRKG. REST.	COM/IND ACCESS	CONTROL	COM/IND ACCESS	PRKG. REST.					
OTHER PRINCIPAL ARTERIAL URBAN STATE SECONDARY				LINE DIAGRAM									
				PEERLESS AVE PC PUT WB 1 48									
				E 1 46						E			
				E 1 43									41'
				E 1 42									24'I
				E (RXR) 1 39									7' SHOULDER
				E (RXR) 1 35									<del>16' SHOULDER</del>
				FLASHING LIGHTS AND CROSSINGS AND GATE									J-CRT 2 ML
				#CR 529-574 F									X
				E 1 33									
FLASHING LIGHTS GATE AND CROSSINGS													
E 1 31 (RXR)													
									24'I				
									2 ML				
									36'I				
									J-CRT				
									3 ML				



ROAD INVENTORY SHEET

95-15 ST  
08/11  
3/26/96

Party Chief G. DAVIS  
Recorder A. HATTEN  
Assistant \_\_\_\_\_  
Map No./Dir. 6-12/E  
State Coordinates \_\_\_\_\_

Road No. MD 725  
Road Name MARLBORO PIKE  
County PRINCE GEORGES  
Date 8-2-93  
Sheet No. 7 OF 8

TRAFFIC CONTROLS: STOP SIGN=SS,  
TRAFFIC LIGHT=T.L.,  
FLASHING RED BALL=F.R.

TRAFFIC CODES  
PARKING RESTRICTIONS: A.M. PEAK,  
P.M. PEAK, A.M./P.M. PEAK, NO PARKING  
ANYTIME=N.P., COMM/IND. ACCESS=E

SYSTEM				TRAFFIC		LINE DIAGRAM			TRAFFIC		PAVEMENT DATA	
FED. AID.	FUNCT. CLASS.	HWY. SYS.	HPMS SAMPLE	PRKG. REST.	COM/IND. ACCESS				CONTROL	COM/IND. ACCESS	PRKG. REST.	
												24'I
						PC	166		E			8'I SHOULDR
												4'I SHOULDR
												2 ML
							164					
							162	TOBACCO MARKET	E			
							159		E			
							156	SL=30mph	E			28'I
												24'I
												4'I SHOULDR
												2 ML
							153					4'I
												24'I
												7'I SHOULDR
												10'I SHOULDR
												J CURBT
												2 ML

OTHER PRINCIPAL ARTERIAL-URBAN (Prinwood)  
STATE SECONDARY

TRAFFIC CODES  
K  
K  
K

PC

300

PT

A

X

X

N.P.

△

LINE DIAGRAM

SYSTEM				TRAFFIC		TRAFFIC				PAVEMENT DATA				
FED. AID.	FUNCT. CLASS.	HWY. SYS.	HPMS SAMPLE	PRKG. REST.	COM/IND ACCESS	CONTROL	COM/IND ACCESS	PRKG. REST.						
	OTHER PRINCIPAL ARTERIAL URBAN (3000-10000) STATE SECONDARY													

CO. 4025

US

1 86 301

SPUR: 03/207

SPUR: 02/207

E

1 82

PT

1 78

SC

1 76

1 75

30°

1 72

224I  
2' ICLTL  
Jcer out  
4ML

36I  
X JERT  
3' I SHD LT  
2 ML  
36' I Jcer RT  
3 ML

24I  
8' I SHD RT  
9' I SHD LT  
2 ML

E

NP

ROAD INVENTORY SHEET

SR93  
GDAH  
10/4/93

91-27  
3-4-92  
DT/JS  
92-1ml  
3-25-93  
92/JS

DT/TT  
12-29  
91-21

Party Chief G DAVIS  
Recorder A HATTEN  
Assistant \_\_\_\_\_  
Map No./Dir. F-11 / N  
State Coordinates 819-403

Road No. MD 769-B  
Road Name EDMONSTON RD  
County PRINCE GEORGES  
Date 10/4/93  
Sheet No. 1 OF 2

BBA/L  
9-17-97  
ST R.I.

TRAFFIC CONTROLS: STOP SIGN=SS,  
TRAFFIC LIGHT=T.L.,  
FLASHING RED BALL=F.R.

PARKING RESTRICTIONS: A.M. PEAK,  
P.M. PEAK, A.M./P.M. PEAK, NO PARKING  
ANYTIME=N.P., COMM/IND. ACCESS=E

SYSTEM				TRAFFIC		LINE DIAGRAM		TRAFFIC			PAVEMENT DATA
FED. AID.	FUNCT. CLASS.	HWY. SYS.	HPMS SAMPLE	PRKG. REST.	COM/IND. ACCESS			CONTROL	COM/IND. ACCESS	PRKG. REST.	
				BS		UPSHUR ST					
						0 25 MU 0152					
						0 24					
				E		0 23					
						TILDEN RD					
						MU 0 21 130		TL			
						10' LTL 10' RTL					
						0 18					
						0 17 BLADENBURG F.D.			E		
						TAYLOR ST →					
				BS		0 12 MU 0122				BS	
						0 07			RE	X	
						0 04			E	BS	
						MD 0 00 450		TL			

URBAN LOCAL  
STATE SECONDARY

NO PKG

40' ML  
ST  
20'

26' I  
JCC  
2 ML

26' I  
JCC  
2 ML

50' I  
JCC  
4 ML





ROAD INVENTORY SHEET

90-3  
3-14-91  
SR 01  
7-5-01  
GDLFP  
91-13 extra (st)  
3-4-93  
DTLS  
SR 93  
60/4H  
10/5/93  
BB/AL  
ST RE  
9-17-97

Party Chief G. DAVIS  
 Recorder A. HATTEN  
 Assistant \_\_\_\_\_  
 Map No./Dir. F-11D / N  
 State Coordinates 820-399

Road No. MD 769-C  
 Road Name 52<sup>ND</sup> AVE  
 County PRINCE GEORGES  
 Date 10-5-93  
 Sheet No. 1 OF 5

TRAFFIC CONTROLS: STOP SIGN=S.S.  
 TRAFFIC LIGHT=T.L.,  
 FLASHING RED BALL=F.R.

TRAFFIC RESTRICTIONS: A.M. PEAK,  
 P.M. PEAK, A.M./P.M. PEAK, NO PARKING  
 ANYTIME=N.P., COMM/IND. ACCESS=E

SYSTEM				TRAFFIC		LINE DIAGRAM						TRAFFIC		PAVEMENT DATA		
FED. AID.	FUNC. CLASS.	HWY. SYS.	HPMS SAMPLE	PRKG. REST.	COM/IND. ACCESS	CONTROL	COM/IND. ACCESS	PRKG. REST.					CONTROL	COM/IND. ACCESS	PRKG. REST.	
																24'
																48' I
																JCELT
																2 ML
																13' I SHDR
																2' I SHDR
																X
																24' I
																13' I SHDR
																JCRB RT
																3' I SHDR
																2 ML
																X
																24' I
																10' I SHDR
																13' I SHDR
																JCELT
																2 ML
																X
																37' I
																JCC
																3 ML
																X

URBAN LOCAL  
STATE SECONDARY

PKG

KNO

E

E

NO PKG

SS

TU

KILMER PL  
2307 015

JACKSON ST  
009 CO 2775

007

006

004

INWOOD ST  
002 CO 5163

SPUR 2104/22T

KENILWORTH AVE  
MD 000 201





MARYLAND STATE HIGHWAY ADMINISTRATION

ROAD INVENTORY SHEET

Quincy ST  
48th ST

Party Chief G. DAVIS  
Recorder A. HATTEN  
Assistant \_\_\_\_\_  
Map No./Dir. F-110/N  
State Coordinates 820-399

Road No. MD 769-C  
Road Name 52ND AVE  
County PRINCE GEORGES  
Date 10-5-93  
Sheet No. 3 OF 5

TRAFFIC CONTROLS: STOP SIGN=SS,  
TRAFFIC LIGHT=T.L.,  
FLASHING RED BALL=F.R.

TRAFFIC RESTRICTIONS: A.M. PEAK,  
P.M. PEAK, A.M./P.M. PEAK, NO PARKING  
ANYTIME=N.P., COMM/IND. ACCESS=E

URBAN LOCAL  
STATE SECONDARY

SYSTEM				TRAFFIC			LINE DIAGRAM			TRAFFIC			PAVEMENT DATA
FED. AID.	FUNCT CLASS.	HWY. SYS.	HPMS SAMPLE	PRKG. REST.	COMM/IND. ACCESS	CONTROL	COMM/IND. ACCESS	PRKG. REST.	TEXT	PRKG. REST.	TEXT	TEXT	

046 NEWTON ST  
MV 0065 PC

12' I J CRT RTL

044

↑ CORP LMTS  
CEMETERY RD  
BLADENSBURG  
SIGN: BLADENSBURG

037

NEWTON ST  
CO 345 035

22'I  
2ML

X

E

24  
~~26'I~~  
J CRT RT  
2ML  
13'I SH RT

SYSTEM				TRAFFIC				LINE DIAGRAM	TRAFFIC				PAVEMENT DATA	
FED. AID.	FUNCT. CLASS.	HWY. SYS.	HPMS SAMPLE	PRKG. REST.	COM/IND ACCESS	CONTROL	COM/IND ACCESS		PRKG. REST.					
							0 92	PT				40'I	JCC	2 ML
								QUINCY PC						
							0 90 MU 0070							
							0 88							
							0 82							
							0 81							
							0 79							
							0 78							
							0 75							
							0 72							
							0 63 SL = 30mph							
							0 62							
							0 55							
								PT						

URBAN LOCAL  
STATE SECONDARY

E  
4  
4  
E  
E  
E  
E  
E

PT  
4  
4  
E  
E  
E  
E  
E

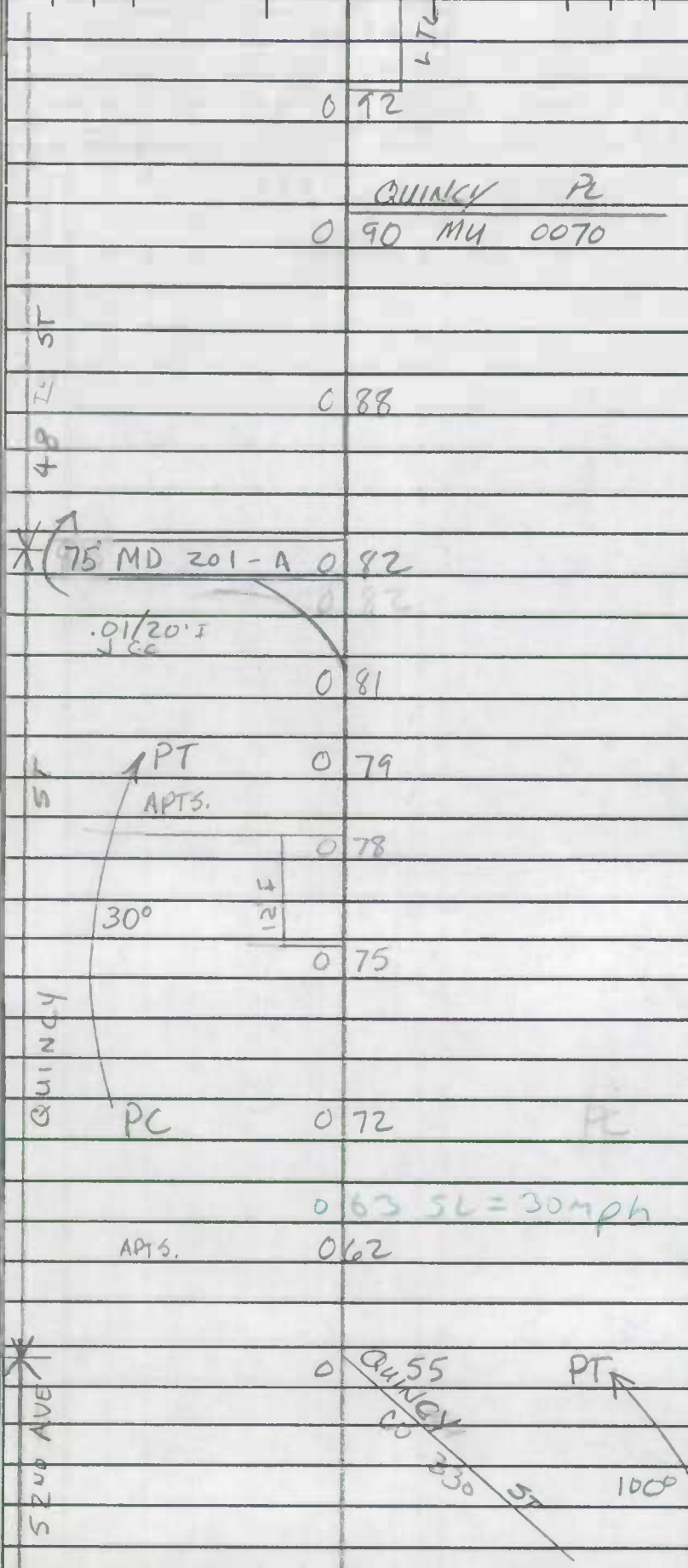

40'I  
JCC  
2 ML  
  
35'I  
JCC  
2 ML  
  
24'I  
JCCB LT  
2 ML  
  
22'I  
2 ML

ROAD INVENTORY SHEET

Party Chief G. DAVIS  
 Recorder A. HATTEN  
 Assistant \_\_\_\_\_  
 Map No./Dir. F-11 D / N  
 State Coordinates \_\_\_\_\_

Road No. MD 769-C  
 Road Name 48TH ST  
 County PRINCE GEORGES  
 Date 10-5-93  
 Sheet No. 5 OF 5

TRAFFIC CONTROLS: STOP SIGN=SS,  
 TRAFFIC LIGHT=T.L.,  
 FLASHING RED BALL=F.R.

PARKING RESTRICTIONS: A.M. PEAK,  
 P.M. PEAK, A.M./P.M. PEAK, NO PARKING  
 ANYTIME=N.P., COMM/IND. ACCESS=E

SYSTEM				TRAFFIC				LINE DIAGRAM										TRAFFIC				PAVEMENT DATA						
FED. AID.	FUNCTION CLASS.	HWY. SYST.	UNAS. SAMPLE	PRIO. REST.	COMM/IND. ACCESS											CONTROL	COMM/IND. ACCESS	PRIO. REST.										

18'I  
JCC  
1 ML

40'I  
JCC  
2 ML











MARYLAND STATE HIGHWAY ADMINISTRATION

ROAD INVENTORY SHEET

Party Chief GO  
 Recorder EF  
 Assistant \_\_\_\_\_  
 Map No./Dir. F-12 / N  
 State Coordinates \_\_\_\_\_

Road No. MD 953  
 Road Name GLENN DALE RD  
 County PG  
 Date 2-20-01  
 Sheet No. 3 OF 7

TRAFFIC CONTROLS: STOP SIGN-SS,  
 TRAFFIC LIGHT-T.L.,  
 FLASHING RED BALL-F.R.

TRAFFIC CODES  
 PARKING RESTRICTIONS: A.M. PEAK,  
 P.M. PEAK, A.M./P.M. PEAK, NO PARKING  
 ANYTIME-IN.P., COMM/IND. ACCESS=E

SYSTEM			TRAFFIC		LINE DIAGRAM	TRAFFIC			PAVEMENT DATA
FUNC. CLASS	HWY. SYS.	HPMS SAMPLE	REG. REST.	COM/IND. ACCESS		CONTROL	COM/IND. ACCESS	REG. REST.	
					127				
					125				
					123				
					126				
					116				
					113				48'I Jc-c 3ML
					111				X 36'I Jc-b-RT 3ML
					Atwell Ave CO 091 4370				X
					089				<del>60'I</del> Jc-c 4ML
					085				*
					PC 078				12'ISHDLT 36 48'I Jc-c 4ML3

URBAN COLLECTOR  
STATE SECONDARY

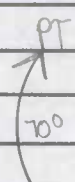







# LINE DIAGRAM

SYSTEM				TRAFFIC		TRAFFIC			PAVEMENT DATA	
FED. AID.	FUNCT. CLASS.	HWY. SYS.	HPMS SAMPLE	PRKG. REST.	COM/IND ACCESS	CONTROL	COM/IND ACCESS	PRKG. REST.		
										22'I 2ML
					309					X
				E	321					
				E	GLENDALE SPECIAL E.L. CENTER	318				
						308				
					HARBOR AVE					
					CO 5502	302				
						299			48" CMP	22'I IC-C 2ML
					MARTIN AVE					
					(PAVED)	298			GLENN BROOK ST Co 5320	X
					DOLBY AVE					
					OP RD	293				
					E. FRANKLIN AVE					
					Co 1833	289				
					DUNBARRY				ST	24'I
					Co	284			1825	2-2' SAND
										IC-C 2ML

URBAN COLLECTION  
State Secondary







SR-01  
7-11-01  
GDI/EF

ROAD INVENTORY SHEET

Party Chief B. BALZANNA  
Recorder G. WILLIAMS  
Assistant \_\_\_\_\_  
Map No./Dir. F-12A / N  
State Coordinates 851-418

Road No. MD 953 A  
Road Name GLENN DALE RD  
County PRINCE GEORGES  
Date 8/3/93  
Sheet No. 1 OF 1

BB/AL  
9-2-97  
ST R.I.

TRAFFIC CONTROLS: STOP SIGN=SS,  
TRAFFIC LIGHT=T.L.,  
FLASHING RED BALL=F.R.

TRAFFIC RESTRICTIONS: A.M. PEAK,  
P.M. PEAK, A.M./P.M. PEAK, NO PARKING  
ANYTIME=N.P., COMM/IND. ACCESS=E

SYSTEM				TRAFFIC		LINE DIAGRAM						TRAFFIC			PAVEMENT DATA		
FED. AID.	FUNCT. CLASS.	HWY. SYS.	HPMS SAMPLE	PRKG. REST.	COMM/IND. ACCESS							CONTROL	COMM/IND. ACCESS	PRKG. REST.			
						XX XX ROAD 015 END									26'I	ICB-RT 2 ML	
						013						E			36'I on TAPER	X	
						011						E			To 26'I	2 ML	
						LANHAM SEVERN RD										X	
						MD 564						SS					
						URBAN State									24'I	2 ML	
						010									JCRB-LT	X	
						003									26'I	2 ML	
						(DUVALL ST)									JCRB-LT	X	
						Co 2901 000											
						AMTRAK XX XX #529594E											
						XX XX											
						MD 95											









S/L NOT POSTED

MARYLAND STATE HIGHWAY ADMINISTRATION

SR-01  
5-8-01  
GOLF

ROAD INVENTORY SHEET

Party Chief G. Dons  
Recorder G. Williams  
Assistant \_\_\_\_\_  
Map No./Dir. G-12 / N  
State Coordinates 855-335

Road No. MD 976-A  
Road Name SERVICES RD  
County PRINCE GEORGES  
Date 8/30/93  
Sheet No. 1 OF 1

BB/AL  
9-3-97  
ST R.I.

TRAFFIC CONTROLS: STOP SIGN=SS,  
TRAFFIC LIGHT=T.L.,  
FLASHING RED BALL=F.R.

TRAFFIC RESTRICTIONS: A.M. PEAK,  
P.M. PEAK, A.M./P.M. PEAK, NO PARKING  
ANYTIME=N.P., COMM/IND. ACCESS=E

SYSTEM				TRAFFIC		LINE DIAGRAM						TRAFFIC			PAVEMENT DATA			
FED. AID.	FUNCT. CLASS.	Hwy. Sys.	HPMS SAMPLE	PRKG. REST.	COM/IND. ACCESS	CONTROL	COM/IND. ACCESS	PRKG. REST.							CONTROL	COM/IND. ACCESS	PRKG. REST.	
									ROAD 018 4 END									12'ZF
									0.14 12									16'ZF
									-0.09									
									ROSAERVILLE Rd									
									Co 007 131									
									CHURCH PRE LOT									24'ZF
									006 2 SB LANE									24'
									005 301									
									SPUR 01/146									
									003 US									24'ZF I
									(90°) 001 301									10' SHOUL
									Rd 000 301 SB LANE									2ML
									US 000 301									18'F

URBAN local  
State Secondary

E  
NP  
V







SYSTEM				TRAFFIC		LINE DIAGRAM			TRAFFIC			PAVEMENT DATA
FED. AID.	FUNCT. CLASS.	HWY. SYS.	HPMS SAMPLE	PRKG. REST.	COM/IND ACCESS	CONTROL	COM/IND ACCESS	PRKG. REST.				
URBAN Collector						<p>← 012 hmts      Bowie →</p> <p>0 542</p>						
						<p>RTL I J RT I J RT</p>						
						<p>* POINTER RIDGE DR</p>						
						<p>MU 2170      0 580</p>						
						<p>0 547      R/R (R) SIGN! RAILROAD CROSSING</p>			<p>X</p>			
						<p>COLLINGTON      0 48      BRANCH</p> <p>247 J-W-W</p>						
						<p>← 012 hmts      0 474      Bowie →</p>						
						<p>402 529-570</p>						
						<p>LIGHTS &amp; CROSSINGS</p> <p>0 481      LIGHTS &amp; CROSSINGS</p>						
						<p>0 480</p>			<p>E</p>			
URBAN Local						<p>0 3234      R/R (R) SIGN! RAILROAD CROSSING</p>						
						<p>PT</p> <p>0 3229</p>						
State Secondary						<p>40</p>						
									<p>20' I 10' FSHD RT 2 ML</p>			
					<p>20' I 2 ML</p>							



















MARYLAND STATE HIGHWAY ADMINISTRATION

ROAD INVENTORY SHEET

96-30 ST  
BB/MLG  
3-19-97  
SR-01  
5-1-01  
GOLF  
95-145T  
BE/AL  
8-27-97  
ST R.I.  
AIT

Party Chief G. DAVIS  
Recorder A. HATTEN  
Assistant \_\_\_\_\_  
Map No./Dir. 6-12 / NW  
State Coordinates 862-358

Road No. MD 980 D OUT OF SIGHT LA  
Road Name RITCHIE MARBLES RD  
County PRINCE GEORGES  
Date 9-2-93  
Sheet No. 1 OF 1

TRAFFIC CONTROLS: STOP SIGN=SS  
TRAFFIC LIGHT=T.L.,  
FLASHING RED BALL=F.R.

TRAFFIC CODES

PARKING RESTRICTIONS: A.M. PEAK,  
P.M. PEAK, A.M./P.M. PEAK, NO PARKING  
ANYTIME=N.P., COMM/IND. ACCESS=E

SYSTEM				TRAFFIC			LINE DIAGRAM	TRAFFIC			PAVEMENT DATA
FED. AID.	FUNCT. CLASS.	HWY. SYS.	HPMS SAMPLE	PRKG. REST.	COMM/IND. ACCESS	CONTROL		COMM/IND. ACCESS	PRKG. REST.		
							△				
							PT 450 MD 980 0/24				20' I J C-C 1 ML
							0 18				X
							PC 0 10				X
							MD 4 0 06				X
							WB 0 03 SL=30mph				X
							0 00				X
							MD H WB				X

Rural major - coll  
State Secondary



