

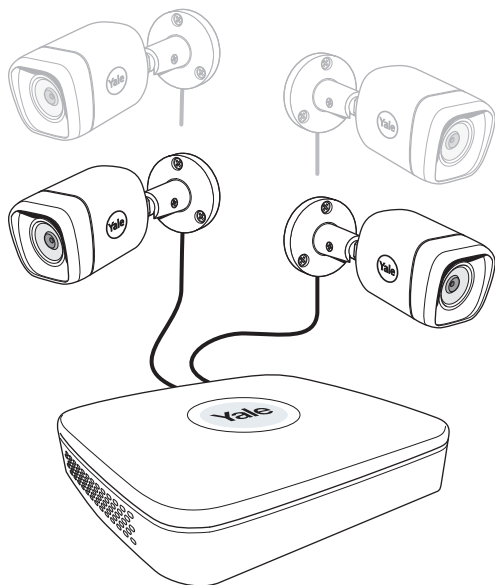

# CCTV Menu Operations Manual

SV-4C-2ABFX / SV-8C-4ABFX



SV-4C-2DB4MX

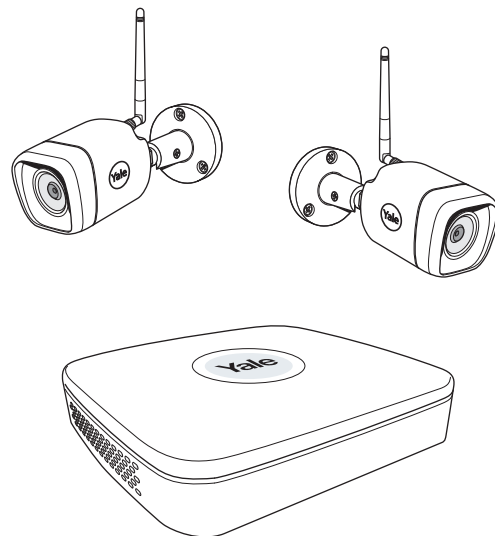



### Disclaimer!

This Manual will guide you through the standard settings and operations for normal Residential CCTV usage. The system is based on a professional system and may contain advanced features and settings that are typically not needed for residential use.

This manual will be continuously updated and be available at [www.yalelock.com/smart-living](http://www.yalelock.com/smart-living).

## (GB) Index



Section	Page
<b>1</b> Plan the camera location Connect cables as described in the manual that was included in the Kit. ....	03
<b>2</b> Download App - Personal registration in the App (It is better to have the App ready before starting the setup of the system.) ....	04
Initial setup: <b>3</b>  Wired Kit .....	05-06
<b>4</b>  WiFi Kit .....	07-11
<b>5</b> Menu overview .....	12
<b>6</b> Setting Date and Time - Synchronizing WiFi camera time .....	13
<b>7</b> Setting up recording and motion detection .....	14-16
<b>8</b> Searching in recorded video .....	17-18
<b>9</b> Backing up a video sequence .....	19
<b>10</b> Adding a WiFi camera .....	20
<b>11</b> Moving WiFi camera up in the channel list .....	21
<b>12</b> Notification via email and App message .....	22
<b>13</b> System information .....	23
Yale info and help desk .....	24

1

## Plan camera locations and connect cables

**It is the users responsibility to make sure to follow the local regulations for setting up camera surveillance.**

## Plan the camera location

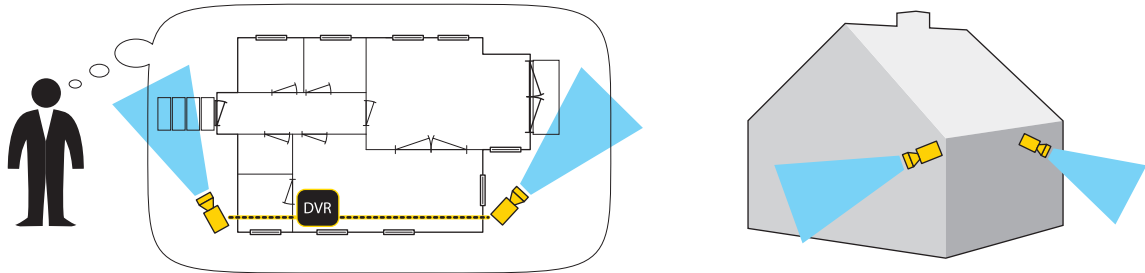

## Connect cables according to the manual that came with your Kit.

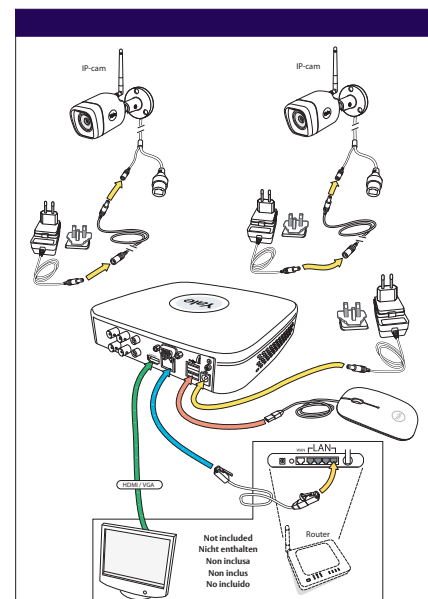
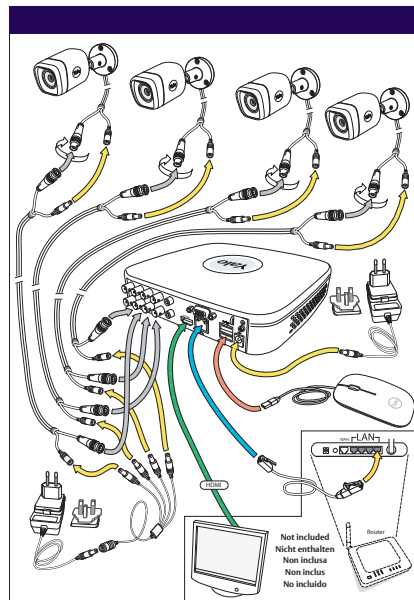
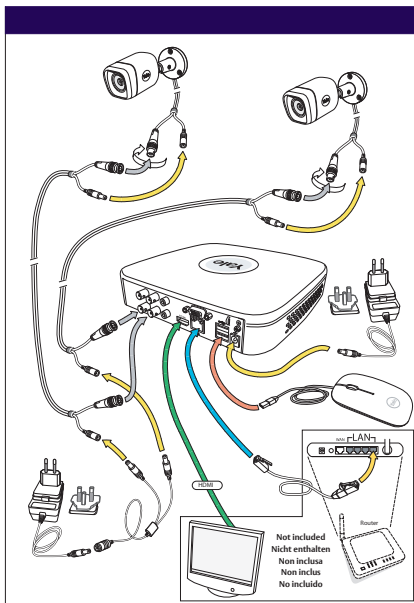

2

# Download App - Personal registration in the App

## Download App for Android or IOS: "Yale Smart Living VIEW"

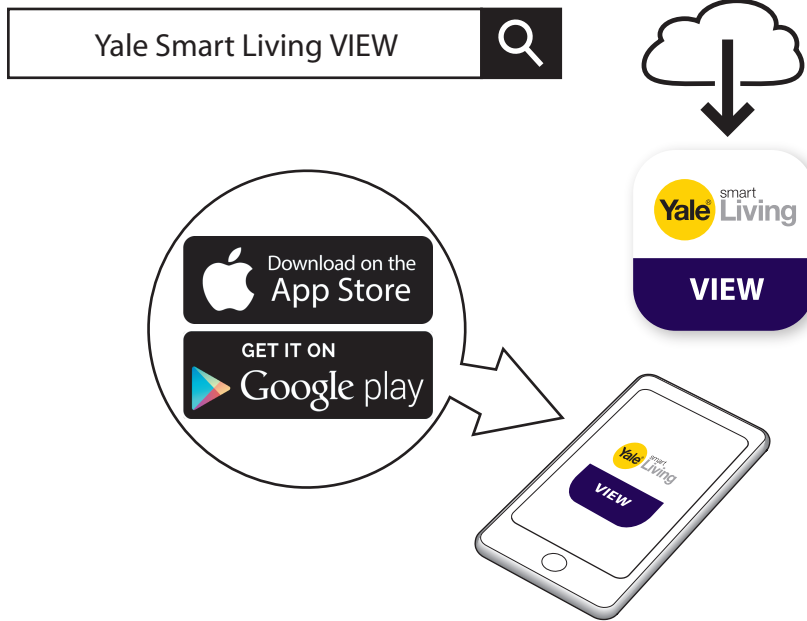

## Personal registration in the App



Please enter username

Enter password

Log-in

Register, Forgotten password?



Email Register

Please enter username

Enter password

Email

Register

< Log-in



### App Log-in page:

Initial setup:

- 1) Click Register

This will be your opening page, after you have registered in steps 2) to 6).

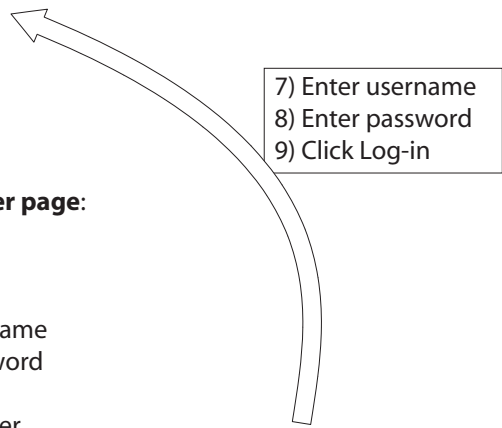

### Email Register page:

Initial setup:

- 2) Enter username
- 3) Enter password
- 4) Enter email
- 5) Click Register
- 6) Click Log-in

This will take you back to.

3

## Initial setup - Wired Kit

 Initial setup for system with wired cameras.

Device Initialization

1 Enter Password    2 Unlock Pattern    3 Password Protection

User: admin

Password:

Use a password that has 8 to 32 characters, it can be a combination of letter(s), number(s) and symbol(s) with at least two kinds of them. (please do not use special symbols like " " ; &)

Confirm Password:

Prompt Question:

Next

1) Key in password

(Click in box and keyboard display will appear)

2) Confirm password

3) Click NEXT

Device Initialization

1 Enter Password    2 Unlock Pattern    3 Password Protection

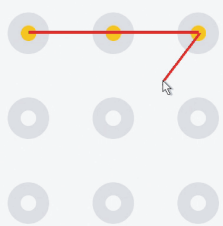

The unlock pattern shall at least contain 4 grids. Please draw again.

Back    Skip

4) Draw unlock pattern  
(Min. 4 dots)

Draw again to confirm Draw unlock pattern

**Remember this pattern!**  
This will be your key to access the system.

5) Click NEXT

Device Initialization

1 Enter Password    2 Unlock Pattern    3 Password Protection

Email Address

Security Questions

Question 1: What is your favorite children's book?  
Answer:

Question 2: What was the first name of your first boss?  
Answer:

Question 3: What is the name of your favorite fruit?  
Answer:

Save

6) write email address and complete security Questions  
(These are optional and can be switched OFF by "un-ticking" boxes)

7) Security Questions:

8) Click SAVE

Startup Wizard

Welcome to the Setup Wizard. This startup wizard will help you set parameters. Click Next to continue.

Auto-check for updates  
Notify automatically when updates are available. The system will check for updates daily.  
Online Upgrade is a service that provides you with firmware updates from the cloud. This service will collect device information in order to inform you about available firmware updates. Such information may include your device name, firmware version and device identification numbers. Such information is processed for the sole purpose of informing you about firmware updates.

Next

9) As default leave Auto-check for updates ticked.  
(This will automatically keep your system up to date; but only if connected to the internet via Router)

10) Click NEXT

3

Initial setup - Wired Kit

Initial setup for system with wired cameras.

Network connection

Auto  Manual

IP Address: 0 . 0 . 0 . 0

Subnet Mask: 0 . 0 . 0 . 0

Default Gateway: 0 . 0 . 0 . 0

Preferred DNS: 8 . 8 . 8 . 8

Alternate DNS: 8 . 8 . 4 . 4

Cancel Refresh Next

11) Click Refresh to update Network connection.

12) Click NEXT

Add New Yale WiFi Camera

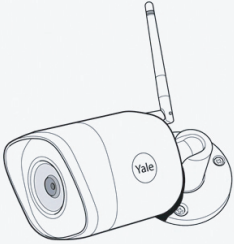

Do you have any Yale Smart Home WiFi cameras to add to the system?



Back No Yes

13) If you have only wired cameras in your Kit click NO. (WiFi cameras can be added later if needed)

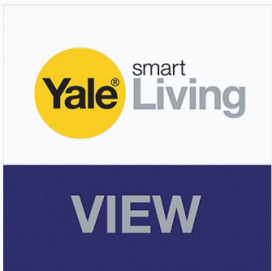
Connect to Mobile App

Scan QR Code in the app to connect to your YALE DVR

Serial: 3M0213BYAZAD569

Back Next

The App needs to be installed and registered before scanning.

14) If you want access to your system via the Yale View App, scan the QR code to connect to your DVR system. (If not click NEXT)

15) Click NEXT

Setup Complete

Congratulations, your Yale CCTV is now ready to use!

Please visit [www.yalelock.com/smart-living](http://www.yalelock.com/smart-living) for more information about your new CCTV system.

OK

16) Click OK

The DVR system is now turned ON and cameras are recording. System is as default running in "Regular Mode", which means that cameras are recording 24 hours a day and will overwrite the hard drive when full. Other "Modes" and backing up recorded video will be explained later in the manual.

4

## Initial setup - WiFi Kit

 Initial setup for system with WiFi cameras.

Device Initialization

1 Enter Password    2 Unlock Pattern    3 Password Protection

User: admin

Password:

Use a password that has 8 to 32 characters, it can be a combination of letter(s), number(s) and symbol(s) with at least two kinds of them. (please do not use special symbols like " " ; &)

Confirm Password:

Prompt Question:

Next

1) Key in password

(Click in box and keyboard display will appear)

2) Confirm password

3) Click NEXT

Device Initialization

1 Enter Password    2 Unlock Pattern    3 Password Protection

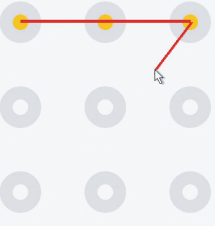

The unlock pattern shall at least contain 4 grids. Please draw again.

Back    Skip

4) Draw unlock pattern  
(Min. 4 dots)

Draw again to confirm Draw unlock pattern

**Remember this pattern!**  
This will be your key to  
access the system.

5) Click NEXT

Device Initialization

1 Enter Password    2 Unlock Pattern    3 Password Protection

Email Address

Security Questions

Question 1: What is your favorite children's book?  
Answer:

Question 2: What was the first name of your first boss?  
Answer:

Question 3: What is the name of your favorite fruit?  
Answer:

Save

6) Write email address and complete security Questions  
(These are optional and can be switched OFF by "un-ticking" boxes)

7) Security Questions:

8) Click SAVE

Startup Wizard

Welcome to the Setup Wizard. This startup wizard will help you set parameters. Click Next to continue.

Auto-check for updates  
Notify automatically when updates are available. The system will check for updates daily.  
Online Upgrade is a service that provides you with firmware updates from the cloud. This service will collect device information in order to inform you about available firmware updates. Such information may include your device name, firmware version and device identification numbers. Such information is processed for the sole purpose of informing you about firmware updates.

Next

9) As default leave Auto-check for updates ticked.  
(This will automatically keep your system up to date;  
but only if connected to the internet via Router)

10) Click NEXT

4

## Initial setup - WiFi Kit

 Initial setup for system with WiFi cameras.

Network connection

Auto  Manual

IP Address

Subnet Mask

Default Gateway

Preferred DNS

Alternate DNS

11) Click Refresh to update Network connection.

12) Click Next

Add New Yale WiFi Camera

Do you have any Yale Smart Home WiFi cameras to add to the system?

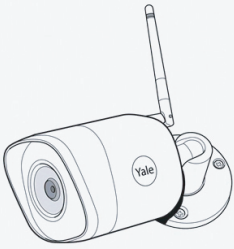

13) If you have WiFi cameras in your Kit (wireless camera) click YES.

Connect Camera's Ethernet Cable

Connect each IP Camera to your home router using the Ethernet cable provided. If you have more cameras than available ports, or you have other types of camera to add, you can add more cameras later via the main menu.

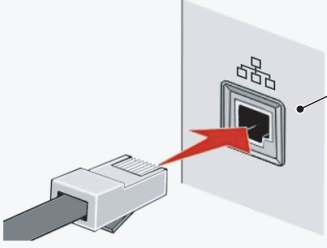

14) Connect Ethernet cables as described in the Yale Quick guide included in the box with the DVR unit.

15) Click Next



4

## Initial setup - WiFi Kit



## Initial setup for system with WiFi cameras.

Press scan to search for new cameras

Back

Scan

16) Click Scan

New Yale Camera Found

IP Address	Type
192.168.1.10	SV-DB4MX-B
xxx.xxx.x.xx	SV-DB4MX-B
xxx.xxx.x.xx	SV-DB4MX-B
xxx.xxx.x.xx	SV-DB4MX-B

Note: Please check all your new Yale WiFi cameras are listed here and press Next.

Back

Scan again

Next

17) Click Next

17) All your connected cameras (WiFi) should now show up on the list. If all your cameras do not show up on the list, click Scan again. If they still do not show up, check that they are all connected to power and camera Ethernet cables are connected to the same router as the DVR system.

Set New Camera Passwords

Use current recorder password

18) Leave box ticked and all cameras will have the same password as you chose for the DVR system in the beginning.

All cameras connected to this CCTV system will share the same password

Back

Next

19) Click Next

4

## Initial setup - WiFi Kit



## Initial setup for system with WiFi cameras.

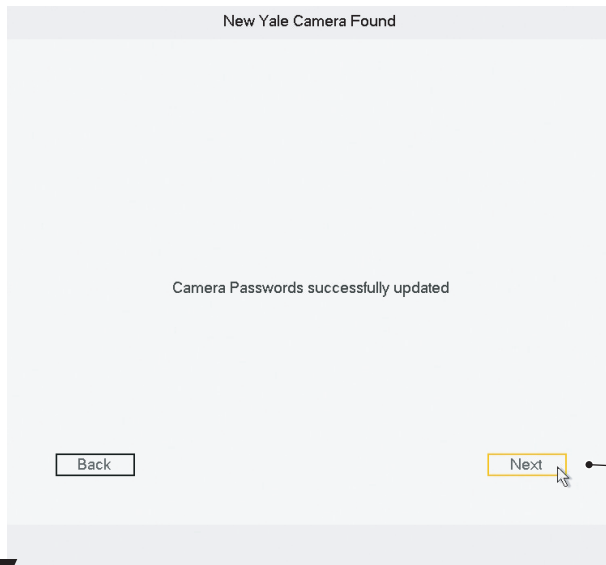

20) Click Next

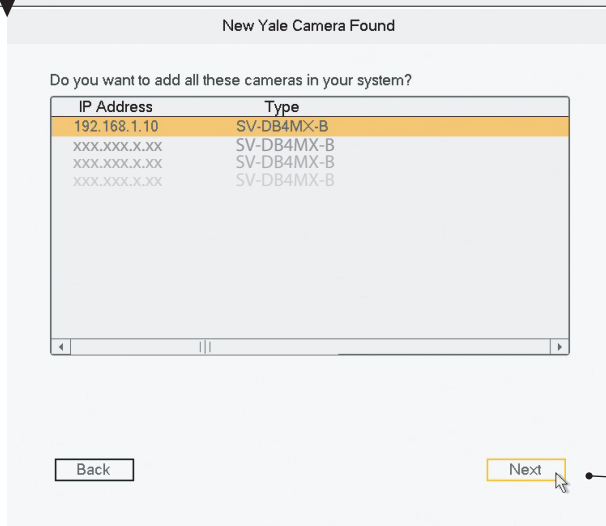

21) Click Next

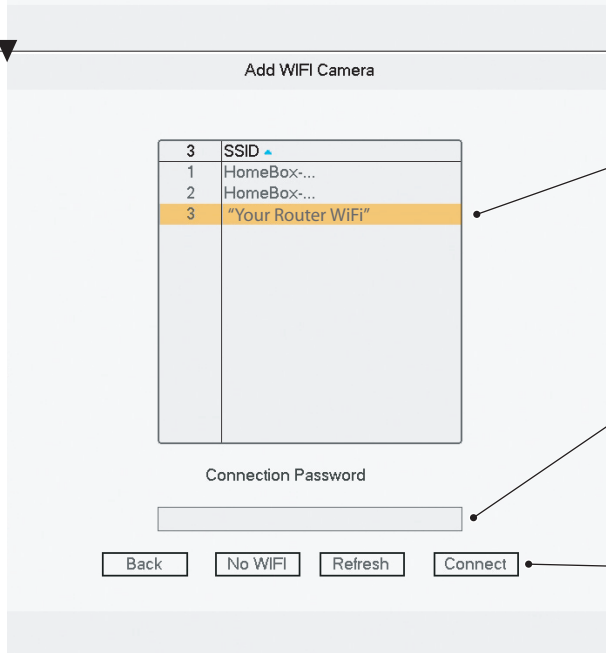

22) Select the router you want to connect to.

23) Write Connection Password for your Router.  
(Same as when you connect any computer or smartphone to you lokal router/network.)

24) Click Connect

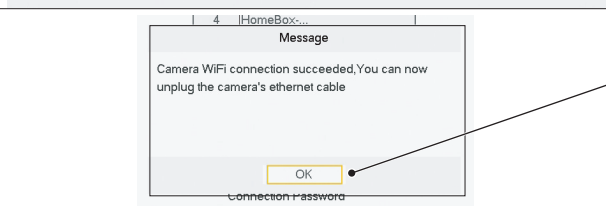

25) Click OK

You can now unplug the ethernet/network cable from your WiFi camera. It is now wirelessly connected to your router. Camera power can be unplugged and then plugged in again when mounted in the desired location, within range of the router.

4

## Initial setup - WiFi Kit

 Initial setup for system with WiFi cameras.

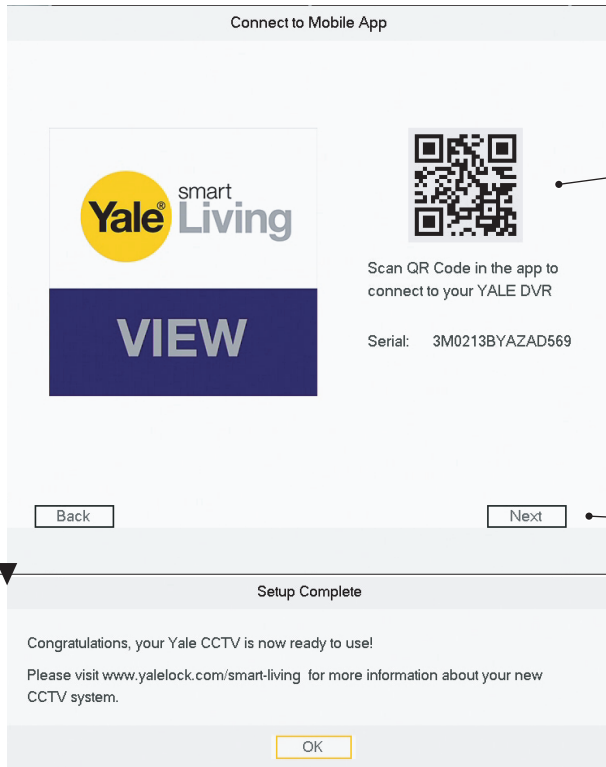

**The App needs to be installed and registered before scanning.**

26) If you want access to your system via the Yale View App, scan the QR code to connect to your DVR system. (If not click NEXT)

27) Click NEXT

28) Setup is now complete.

**The DVR system is now turned ON and cameras are recording. System is as default running in "Regular Mode," which means that cameras are recording 24 hours a day and will overwrite the hard drive when full. Other "Modes" and backing up recorded video will be explained later in the manual.**

Menu overview

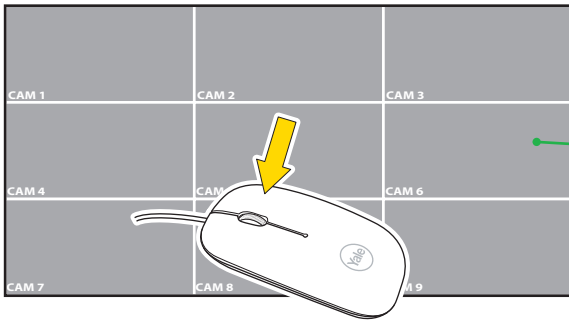

**Right Click** in the live view > brings up the top menu for the live view screen options.

**CAM windows can be dragged to rearrange order.**

**The system is flexible for you to set to your personal preferences and it can always be reset to default setting.**

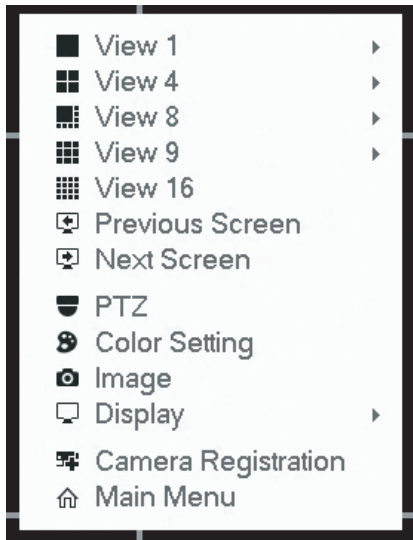

Different view options for the live view screen. (Example shown is an 8 channel system, 4 channel will have fewer options.)

(PTZ and Image, not in use with this model)

Colour Setting and Display. Options for live view screen.

Camera Registration. Shortcut to Camera Registration in the Main Menu

**Here you can find video recordings when you want to investigate or document events.**

**Main Menu**  
**OPERATIONS, INFO, SETTING**

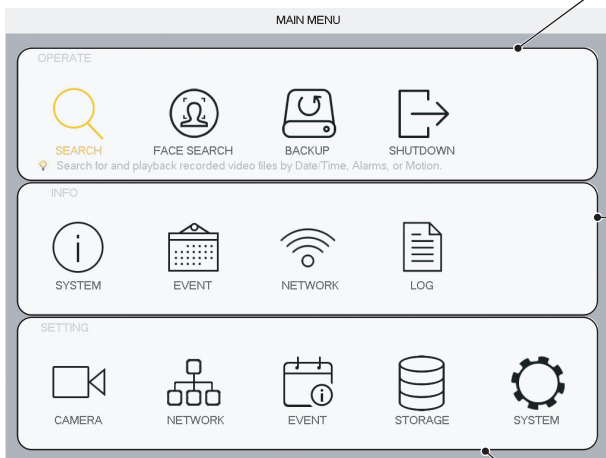

**OPERATE: SEARCH:** Search for and playback recorded video by date and Time.  
**FACE SEARCH:** Search and playback recorded video by face detection. (If feature is applied)  
**BACKUP:** Plan backup of recorded video, to external media.  
**SHUTDOWN:** Shutdown / Logout / Reboot

**INFO: SYSTEM:** HDD information, recording information.  
**EVENT:** Lists of events, motion detection.  
**Network:** List of Network activities.  
**LOG:** List of operations / changes to the system.

**Here you can personalise system settings and adjust recording event triggers.**

**SETTING: CAMERA:** General camera setting.  
**Network:** General network setting.  
**EVENT:** Personal settings for recording triggers.  
**STORAGE:** Time planning for recording and HDD tools.  
**SYSTEM:** System settings.

## Setting Date and Time

### Date and Time

- 1) Go to **SYSTEM > GENERAL > Date & Time**
- 2) Set **Year, Month, Date** and **Hour, Minutes**.
- 3) Set your timeline according to GMT
- 4) Click **Save**.
- 5) Click **Apply**.
- 6) Click **Save**.

## Synchronizing WiFi camera time. Only needs to be set if WiFi cameras are being connected.

### The WiFi cameras internal clock needs to be repeatedly synchronized to keep the same time as the system.

- 1) Go to **SYSTEM > GENERAL**
- 2) In **IPC Time Sync**, set the interval at which the WiFi camera will be synchronized. ( 24 hours, recommended )
- 3) Click **Apply**
- 4) Click **Save**

7

# Setting up recording and motion detection

## Setting up recording schedule and recommended residential motion detection (MD)

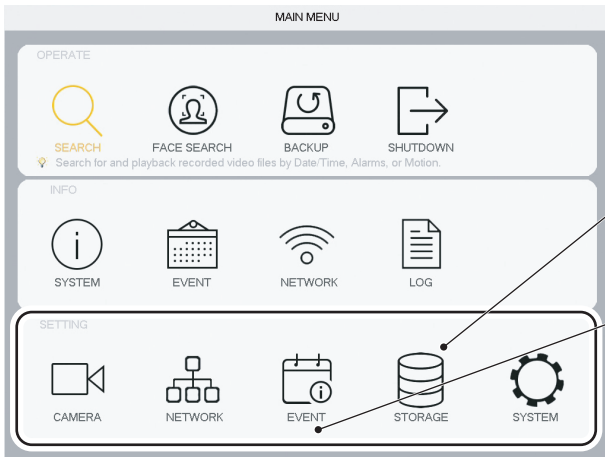

(A) Click **STORAGE**  
Setting up **SCHEDULE** (week planning) for recordings and event triggers.

Click **Event**  
Setting up movement-triggers for recordings.  
Mode: (B) **VIDEO DETECT = MD** (Motion Detect)  
(Detection of simple movement)  
(C) **IVS = INTEL** (Detection of specific movement)  
(D) **FACE DETECT** (Triggers when it detects a face-shape, not a specific face !)

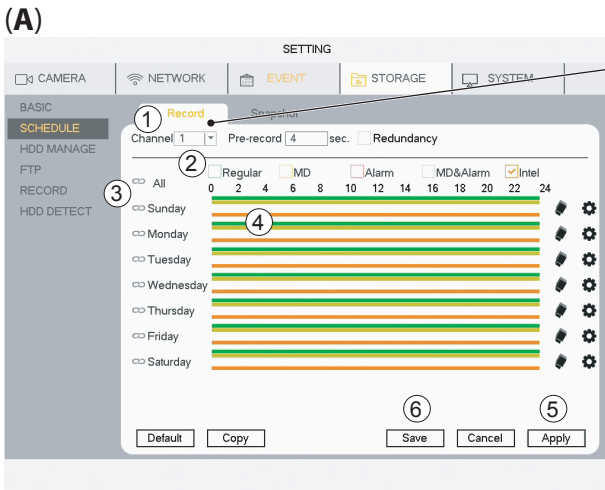

**SCHEDULE - Record**  
1) Select Channel (Channel = Camera)  
2) Select Mode : **Regular** (Continuous video recording)  
**MD** (Detection of simple movement)  
**Intel** = IVS (Detection of specific movement)  
3) Select Day(s) or All  
4) Drag coloured bars to match period(s) of the day(s) you want detected. (Drag again to delete bar)  
5) When you have planned the week for the Channel - click **Apply** and continue to next Channel.  
6) When all Channels have been planned and applied - click **Save**  
Click **Default** will take you back to factory setting.

### (B) MD (Motion Detection) recommended residential motion detection (MD)

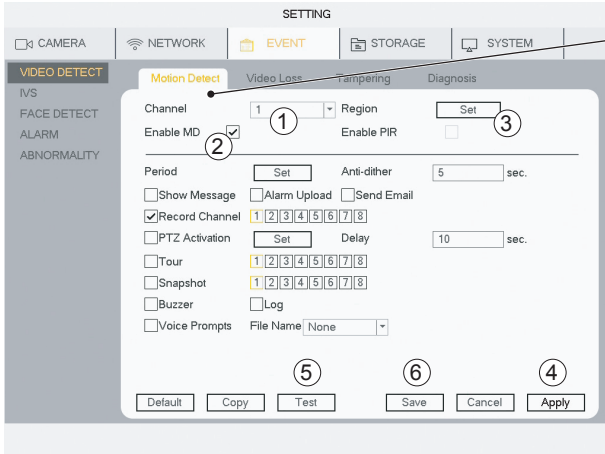

**VIDEO DETECT - Motion Detect**  
1) Select **Channel** (Channel = Camera)  
2) Tick **Enable MD**  
3) Click **Set** to change motion sensor area. Default is the whole field of view.

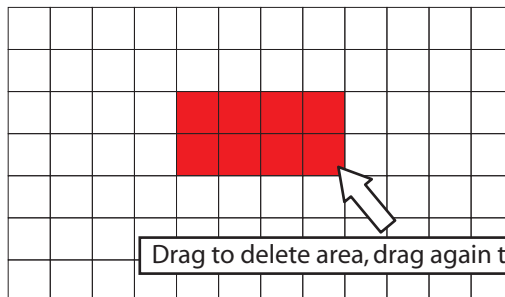

Drag to delete area, drag again to select new area(s)

4) Click **Apply**  
5) Click **Test** to check motion detection is working as planned. (Buzzer can be activate to test motion detection)  
6) When all Channels have been planned and applied - click **Save**  
Click **Default** will take you back to factory setting.

**Standard residential motion detection (MD) is supported by both Wired and WiFi cameras.**

7

Setting up recording and motion detection

Setting up advanced IVS motion detection (wired cameras only).

(C) IVS = Intel

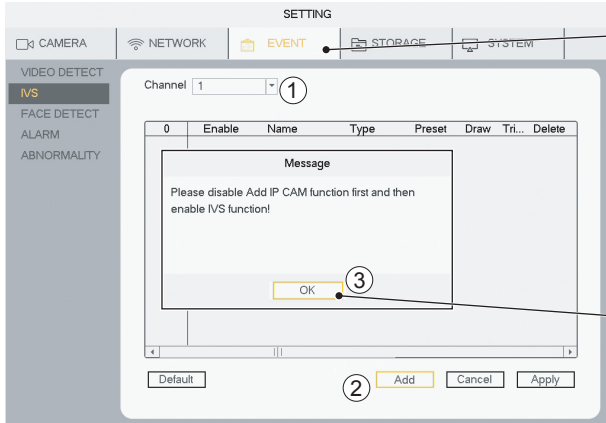

**EVENT- IVS = Intel**  
(To add IVS functionality to your wired cameras go through the following steps.)

- 1) Select Channel (Channel = Camera)
- 2) Click **Add**

**Message**  
3) Click **OK**

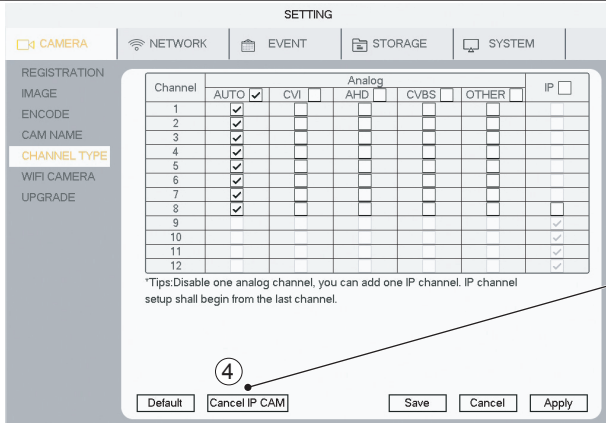

4) Go to **CAMERA** menu - **CHANNEL TYPE**  
Click **Cancel IP CAM**  
(The WiFi cameras already installed (if any) will not be affected)  
System will now reboot.

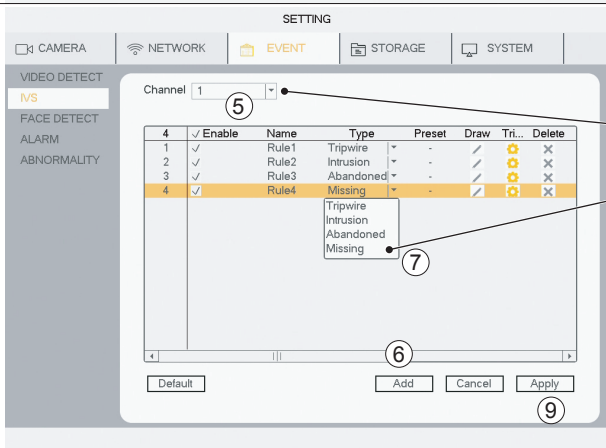

Open **EVENT- IVS** menu again  
5) Select Channel (Channel = Camera)  
6) Click **Add**  
7) Choose Type: Tripwire/Intrusion/Abandoned/Missing  
8) **Draw** "rule" for the type. (When drawing, right click to finish shape)  
9) Click **Apply**  
(Buzzer can be activate to test motion detection)

Tripwire	Intrusion	Abandoned	Missing
<p>Trigger: when line is crossed</p>	<p>Trigger: when area out line is crossed entry or exit</p>	<p>Trigger: when something is left in the area - for longer than 30 seconds</p>	<p>Trigger: when something is missing from the area - for longer than 30 seconds</p>

### Setting up face detection (wired camera only).

**The face detect function only works with Wired camera on CHANNEL 1**

#### (D) FACE DETECT

**EVENT- FACE DETECT** (Triggers when it detects a face-shape, not a specific face !)

- 1) Select **Channel 1**
- 2) Tick **Enable**
- 3) Click **Set**  
(Here you can set the minimum size of the face that will trigger.)
- 4) Click **Apply**
- 5) When the Channel has been set and applied - click **Save**  
(Buzzer can be activate to test motion detection)

Click **Default** will take you back to factory setting.

**Face detection is useful at locations like front door, at face high or slightly above.**



8

# Searching in recorded video

## Searching in recorded video by Time/Date, Motion detection, Face detection

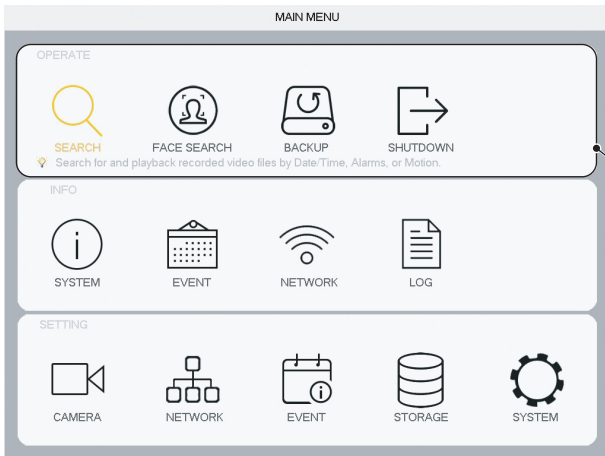

When you have setup your system, this menu is where you can find video recordings to investigate or document events.

**OPERATE: (A) SEARCH:** Search for and playback recorded video by Date and Time.  
**(B) FACE SEARCH:** Search and playback recorded video by face detection. (If feature is applied)

**BACKUP:** Plan backup of recorded video, to external media (External HDD or USB memory).

**SHUTDOWN:** Shutdown / Logout / Reboot

### (A) SEARCH

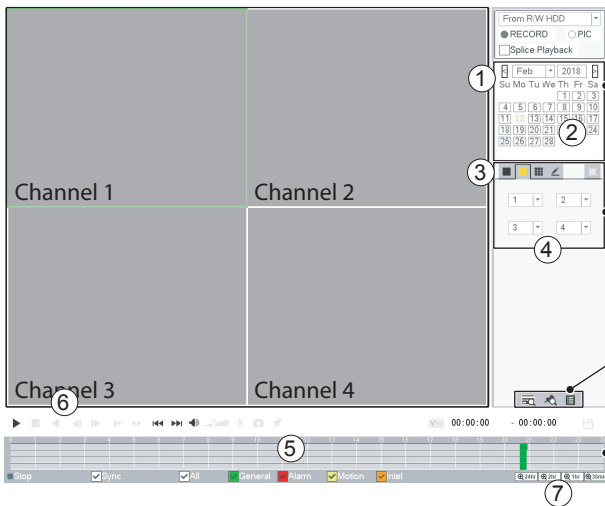

**How to find a recording:**  
 1) Select **YEAR** and **Month**.  
 2) Select **Day**.

**Set up display:**  
 3) Select **1/4/9** channel view.  
 4) Select which **channels to watch**.

List of recordings by type, Regular / MD / IVS(INTEL):  
 Select Channel at top. Double click to start listed recording.

**24 hour timeline:**  
 5) Click timeline to view recording.

### 6) Controls for play back:

- ▶ Play
- Stop
- ◀ Play (backwards)
- ◀▶ One frame steps (Only when paused)
- ▶ Slow Playback (x1/2 / x1/4 / x1/8 x / x1/16)
- ▶▶ Fast Playback (x2 / x4 / x8 / x16)

### 7) Zoom timeline:

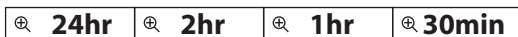

**Timeline:**

■ **General** = Regular   
 ■ **Motion** = MD   
 ■ **Intel** = IVS

No changes can be made in the Search window while video is playing. Stop video to change parameters.

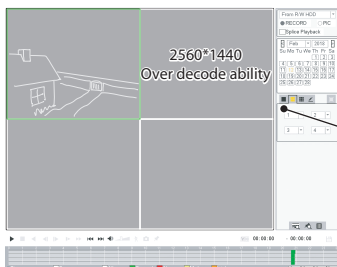

If you have a WiFi camera(s) connected together with wired camera(s), single view must be used to see the WiFi cameras.  
 WiFi cameras are high resolution and can not be viewed at the same time as wired (low res.) cameras.  
 They must be viewed in single view, separately.

### Searching in recorded video by Time/Date, Motion detection, Face detection

The screenshot displays a video search interface. On the left, there is a vertical list of five face-shaped icons representing search results. Below this list is a large grey rectangular area, likely a video player. To the right of the video player is a search control panel. At the top of this panel is a date selector showing 'Feb' and '2018'. Below the date selector is a calendar grid for the month of February. Further down, there are 'Start' and 'End' time fields, both set to '2018 - 02 - 12 | 00:00:00' and '2018 - 02 - 12 | 23:59:59' respectively. At the bottom of the search panel is a search input field with a magnifying glass icon and the text 'Search'. Below the search panel, there is a status bar with 'Search Results: 0' on the left and an 'Export' button on the right.

**FACE SEARCH** will show a picture taken of the face shape, captured by the camera.

**SEARCH** by Year / Month / Date

## Backing up a video sequence to storage media.

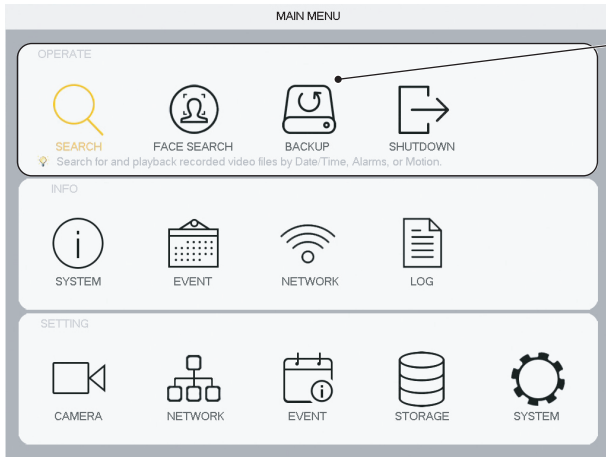

**OPERATE: BACKUP:** Plan backup of recorded video, to external media (External HDD or USB memory).

### Backup from SEARCH Menu

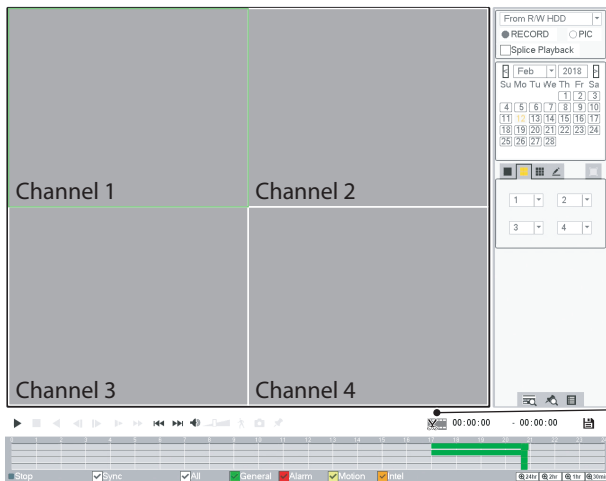

## Backup - recorded video

External storage media, HDD or a USB memory stick, need to be plugged in to USB (back of unit).

Save a video sequence to external memory.

Use timeline to select period.

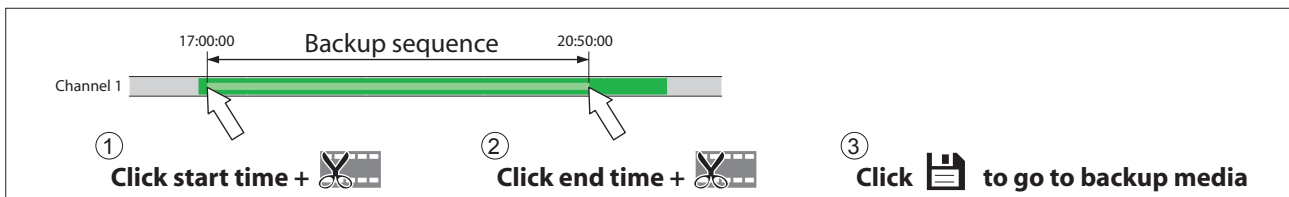

### Backup from BACKUP Menu

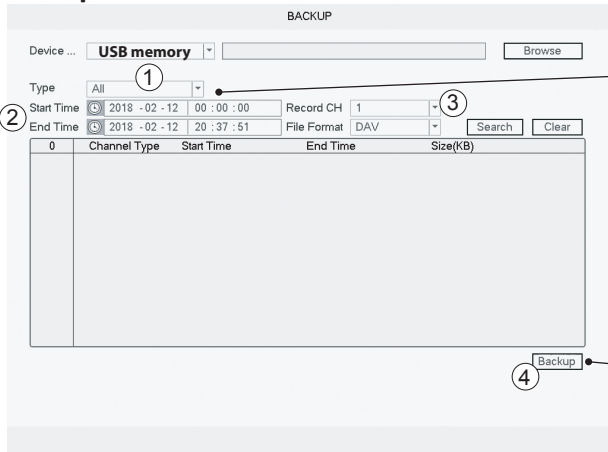

Save a video sequence to external memory.

- 1) Set **Type** to backup.
- 2) Set **Start** and **END - Date / Time** to backup.
- 3) Set **Channel**.

4) Click **Backup**.

## Adding a WiFi camera to you DVR

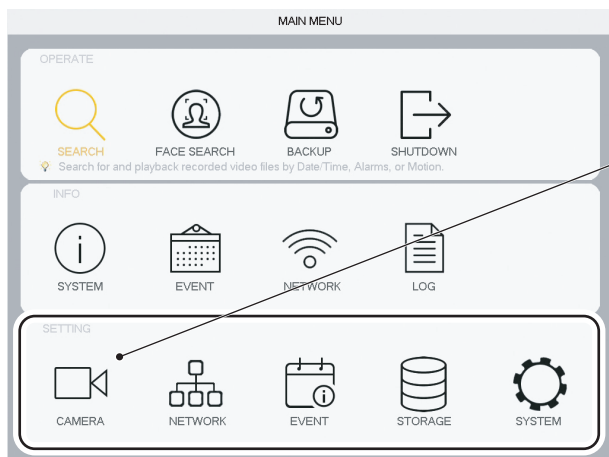
Go to **Camera**

**Camera needs to be connected via ethernet cable to the router, for the DVR to search for it.**

See the manual that came with your kit for details of how to connect cables.

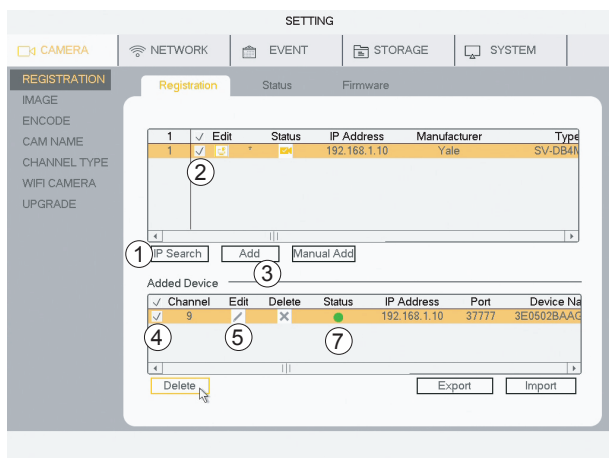

## REGISTRATION

- 1) Click **IP Search**
- 2) Select camera (tick)
- 3) Click **Add**

**You will be asked if you want to use the same password for your camera, as you are using for the DVR ( -RECOMENDED- )**

**Go to 8)**

(In Added Device you camera will now be listed, with Green status.)

*If you did not select same password as system, continue from 4)*

4) In Added Device select camera (tick)

5) Click **Edit**

6) Write password and click **OK**

7) Status will now change to green.

Camera is now active. (connected via ethernet cable)

**(If your system have already got WiFi cameras connected, steps 8 to 14 will be already filled in)**

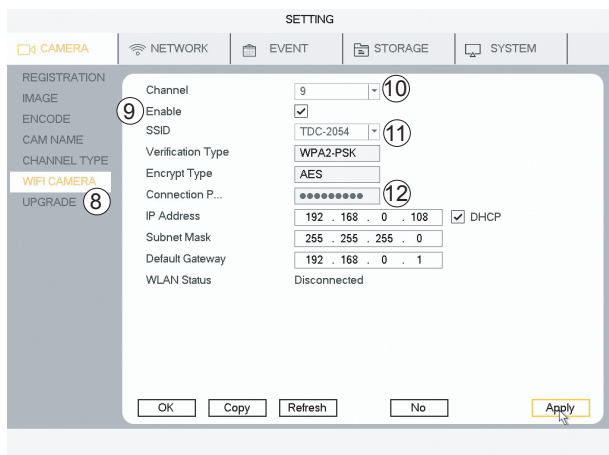
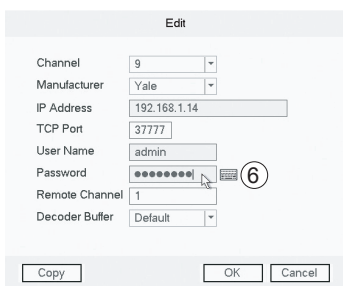

## Setting up WiFi camera connection to your router.

8) Go to **WiFi CAMERA**

9) Tick **Enable**

10) Select channel (the one your new WiFi is connected to)

11) Select your router from the list.

12) Enter **PASSWORD** for your router

13) Click **Apply**

14) Click **OK**

**The WiFi camera can now be disconnected from the ethernet cable and power supply. The camera can be placed in the desired location within range of the router.**

11

## Moving WiFi camera in the channel list

### Rearranging WiFi camera in channel list

How to move WiFi cameras up the channels list for simpler overview when searching and in the App.

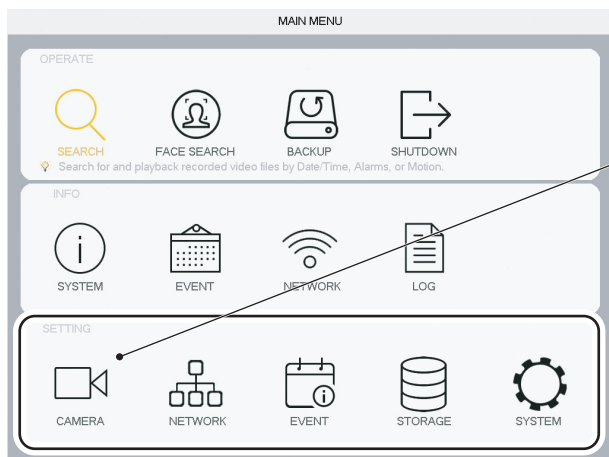

Go to **Camera**

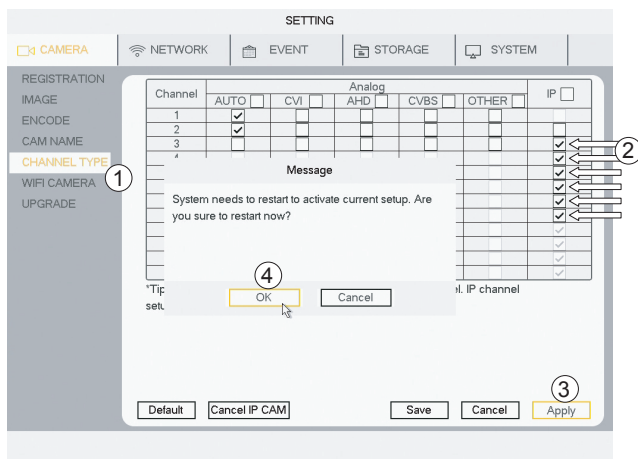

1) Go to **CHANNEL TYPE**

2) Tick (change) channel to **IP**

**If you have wired cameras connected to the first 2 channels then tick IP up to the first one after your wired channels.**

(In this case No.3)

3) Click **Apply**

4) Click **OK**

**System will then restart.**

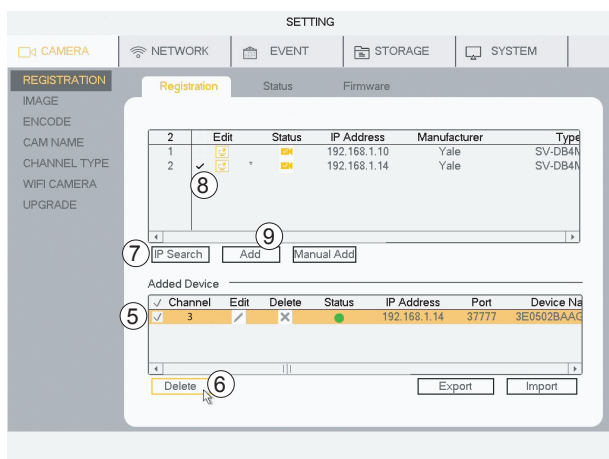

**After restart go to REGISTRATION**

**Your cameras will have to be deselected and added again.**

5) Tick to **select camera**

6) Click **Delete** to remove camera(s)

Reinstalling camera(s) in the new channels.

7) Click **IP search**

8) Tick to **select camera**

9) Click **Add**

**Camera will now be listed in Added Device under the new channel No.**

**The WiFi camera can now be disconnected from the ethernet cable and power supply. The camera can be placed in the desired location within range of the router, reattached to the power supply again.**

### Setting notifications to send message to you via mail and App.

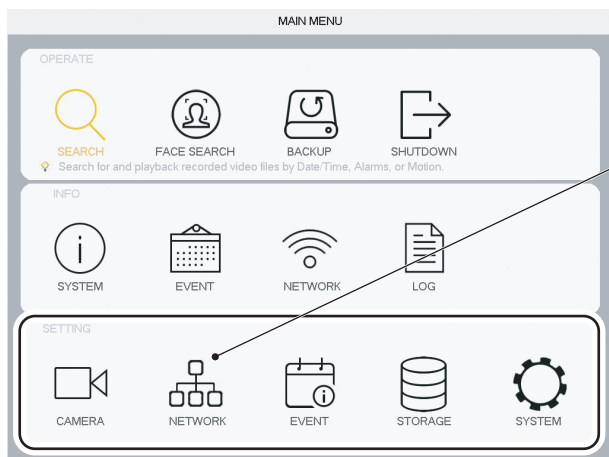

Go to **Network**

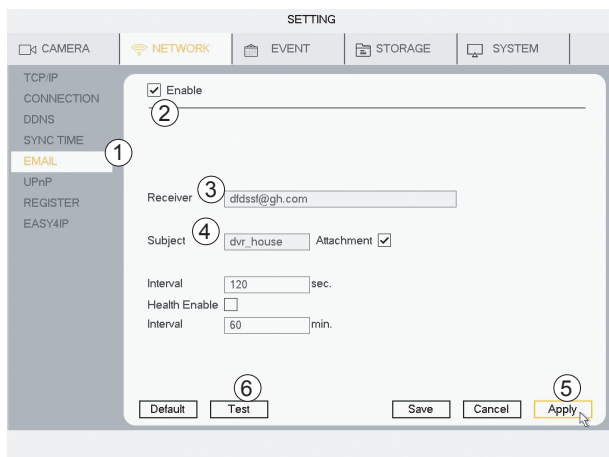

- 1) Go to **EMAIL**
- 2) Tick **Enable**
- 3) Write your email in **RECEIVER**
- 4) Write **Subject** ( will make it easy to recognize the email )
- 5) Click **Apply**
- 6) Click **Test** ( the system will now send a test mail )

**Activating email notification on motion detection.**  
(The same can be done for IVS and face detection)

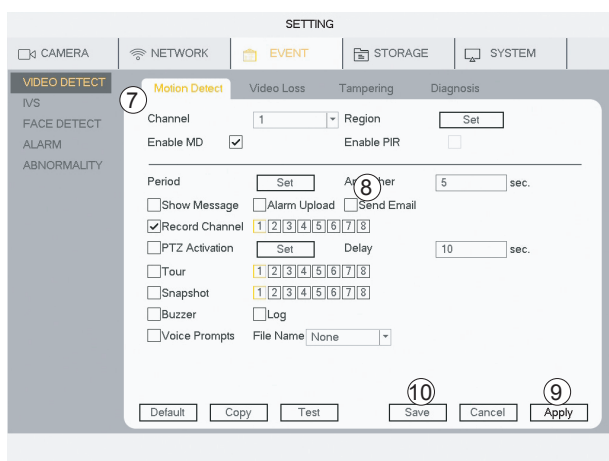

- 7) Go to **Event > VIDEO DETECT > Motion Detect**
- 8) Click **Send Email**
- 9) Click **Apply**
- 10) Click **Save**

**The system will now send you an email every time motion is detected.**



**If you have the App connected, it will receive a message every time motion is detected.**

## Estimating recording time on the hard drive.

INFO

SYSTEM EVENT NETWORK LOG

HDD

RECORD **REC ESTIMATE**

BPS

CHANNEL INFO

VERSION

Channel	Edit	Bit Rate(Kb/S)	Record Time	Resolution
1	/	2048	24	1280*720(720P)
2	/	2816	24	2560*1440(2560x1440)
3	/	2048	24	1280*720(720P)
4	/	2048	24	1280*720(720P)
5	/	2048	24	1280*720(720P)
6	/	2048	24	1280*720(720P)
7	/	2048	24	1280*720(720P)
8	/	2048	24	1280*720(720P)
9	/	2048	24	1280*720(720P)
10	/	2048	24	1280*720(720P)
11	/	2048	24	1280*720(720P)
12	/	2048	24	1280*720(720P)

Known Space Known Time

Capacity 2,000 TB = 2000 GB Select

Time 38 Days

Note: The record estimation data here is for reference only. Please be cautious when you are calculating record period.

### Harddrive recording time estimated

- 1) Go to INFO > SYSTEM > REC ESTIMATE
- 2) Check that all Cameras / channels are ticked.
- 3) Click select (in the pop up click OK)
- 4) Time will now show an estimate of time left to record.

**If recording over-runs the hard drive capacity, it will as default overwrite the oldest recording.**

## Formatting / erasing the hard drive.

SETTING

CAMERA NETWORK EVENT STORAGE SYSTEM

BASIC

SCHEDULE

**HDD MANAGE**

FTP

RECORD

HDD DETECT

SATA 1

O

1*	Device Name	Type	Status	Free Space/Total Space
All				1.80 TB/1.81 TB
1*	SATA-1	Read/Write	Normal	1.80 TB/1.81 TB

Refresh Format Save Cancel Apply

**Warning this will erase all recordings on your hard drive.**

- 1) Go to **STORAGE > HDD MANAGE**
- 2) Tick selected hard drive.
- 3) Click **Format**
- 4) Click **Apply**
- 5) Click **OK** (in the pop up menu)

**The system will now restart.**

# i Support

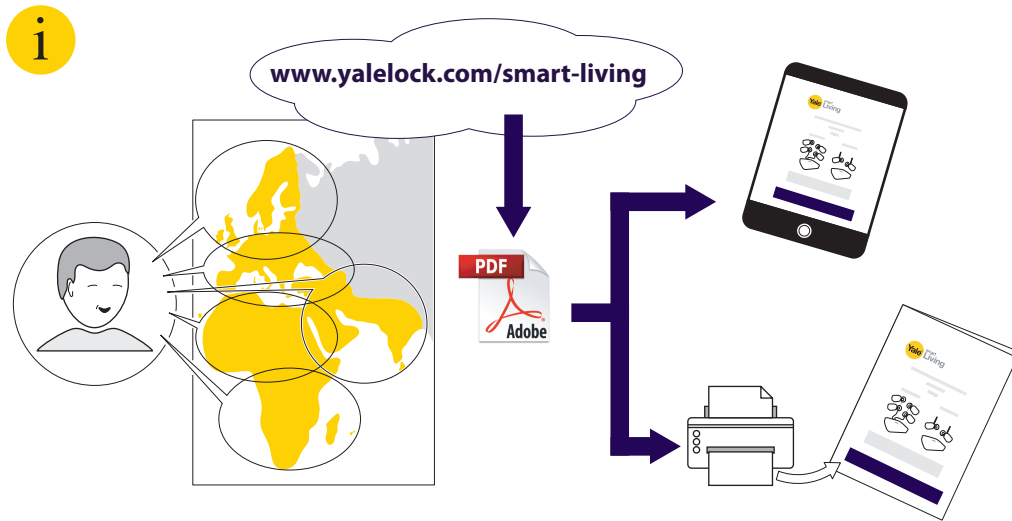

**THE YALE BRAND**, with its unparalleled global reach and range of products, reassures more people in more countries than any other consumer locking solution.

**THE ASSA ABLOY GROUP** is the world's leading manufacturer and supplier of locking solutions, dedicated to satisfying end-user needs for security, safety and convenience.