

**LEPA**   
*Aim for excellence*

# AquaChanger 120

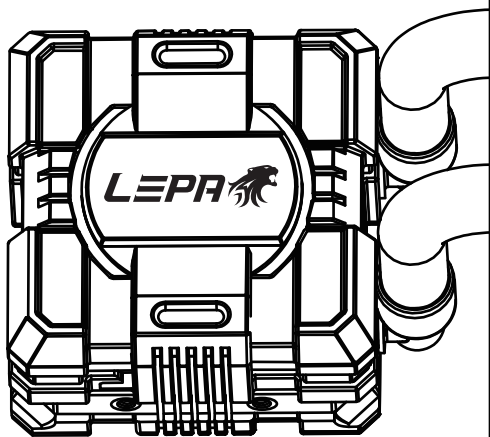

Model		LPWAC120-HF
Cold Plate	Material	Copper
Pump	Bearing	Ceramic Bearing
	MTBF	50,000 hrs
	Motor Speed	2700 rpm $\pm$ 10%
	Rated Voltage	12V
	Rated Current	0.3A
Radiator	Dimension	154 x 120 x 27 mm
	Material	Aluminum
Tube	Material	Rubber
	Length	300 mm
Weight (w/o fan)		580 g
Bracket	Compatibility	Intel® LGA 775/1150/1151/1155/1156/1366/2011/2011-3 AMD® AM2/AM2+/AM3/AM3+/FM1/FM2/FM2+
	Dimension	120 x 120 x 25 mm
Fan	Speed	500 ~ 2300 rpm $\pm$ 10%
	Rated Voltage	12V
	Rated Current	0.38 A
	Air Flow	22.5 ~ 103.6 CFM 38.2 ~ 176.0 m <sup>3</sup> /h
	Static Pressure	0.2 ~ 4.5 mm- H <sub>2</sub> O
	Noise Level	14 ~ 35 dBA
	Connector	4 pin PWM
Warranty		2 years

\*Some MB put the capacitors around the boarder of CPU bracket, please carefully install the cooler on can avoid the mechanical interference.

# PART LIST

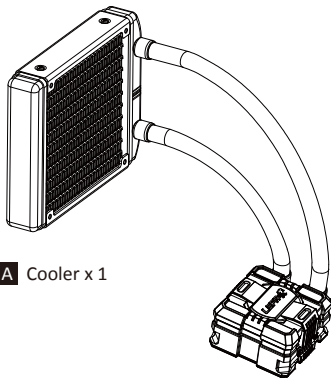

**A** Cooler x 1

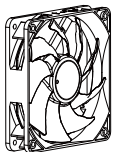

**B** Fan x 1

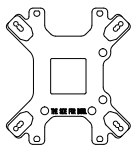

**C** Back Plate x 1



**D** Position Screw x 4

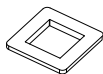

**E** Square Washer x 1



**F** Stand-off x 4



**G** Case Screw x 8



**H** Fan Screw x 8



**I** Intel LGA2011 Screw x 4



**J** Spring Screw x 4



**K** Insulating Sheet x 4

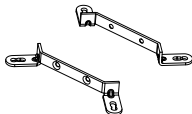

**L** Intel Bracket x 2

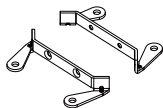

**M** AMD Bracket x 2



**N** Bracket Screw x 4

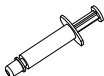

**O** Thermal Grease x 1

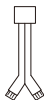

**P** PWM Y cable x 1



**Q** Molex Adaptor x 1

**INTEL INSTALLATION**

**AquaChanger 120**

## Step 1

**EN**  
Attach the fan and the radiator to the case.

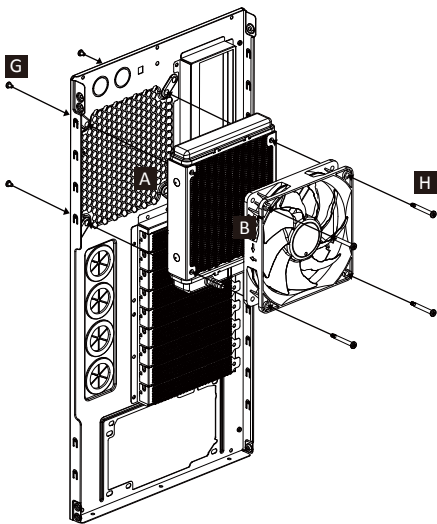

# Step 2-1

**EN**

<If your CPU socket is Intel LGA 2011, please skip to step 3-2.>

Install the screw into the corresponding position hole on the back plate for your CPU socket.

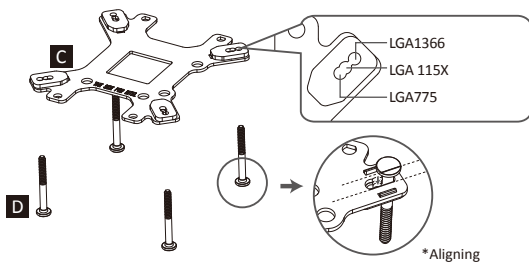
**LGA 775/1150/1151/1155/1156/1366**

# Step 2-2

**EN**

For LGA 775, please attach and click the square washer to the center of the back plate.

**LGA775**

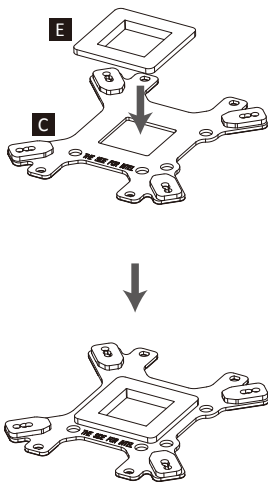

# Step 3-1

LGA 775/1150/1151/1155/1156/1366

Intel

## EN

Install the back plate on the back of motherboard; place the stand-off on the motherboard to fix the back plate.

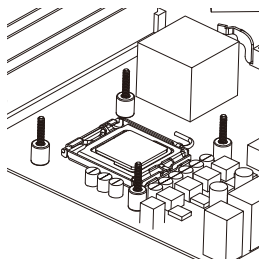
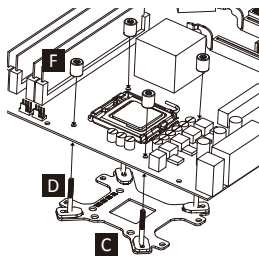



# Step 3-2

EN

Please fasten the LGA 2011 screw directly to the motherboard until all four screws are secured. (Socket LGA 2011 does not required to use the back plate for installation)

LGA 2011/2011-3

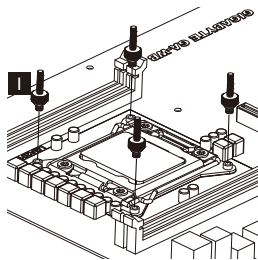

# Step 4

Intel

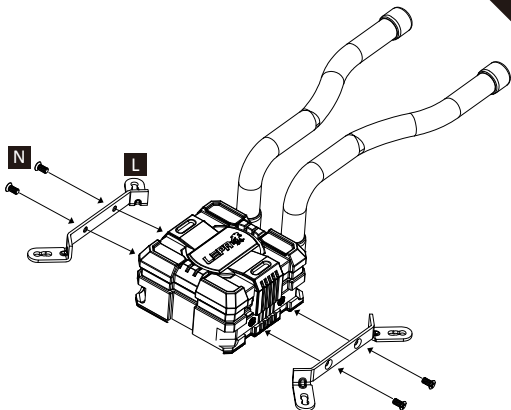

**EN**  
Install the Intel bracket to the pump.

# Step 5

**EN**  
Apply the thermal grease on the CPU surface.

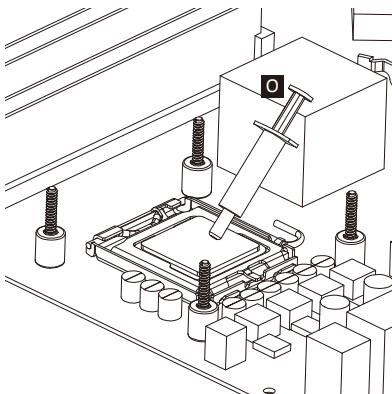

# Step 6

**EN**  
Remove the protection film on the cold plate.

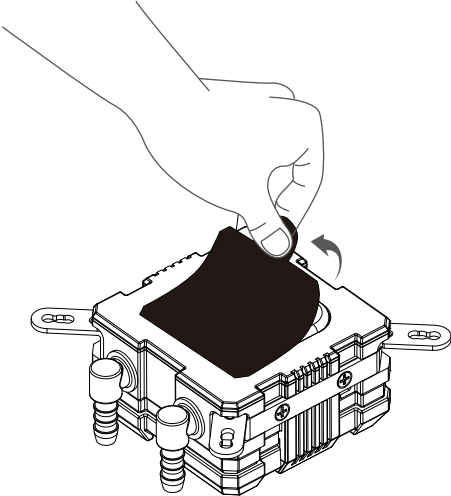

# Step 7

**EN**  
Place the pump on the CPU and tighten the four spring screws.

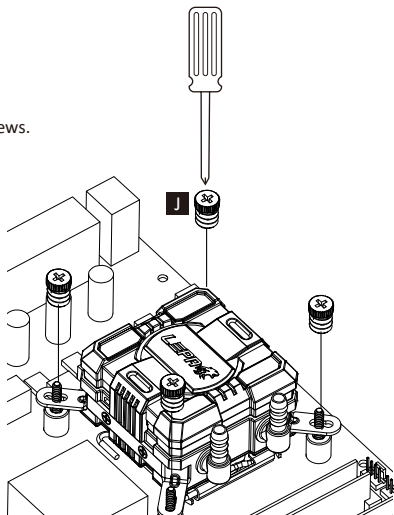

# Step 8

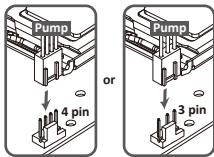
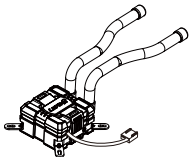

Intel

**EN**  
Connect the pump power connector to 3-pin or 4-pin connector on the motherboard.

Notice: If you recognize that your mainboard's CPU fan or PWM sockets do not provide enough voltage to power the pump, please use the included 4-pin Molex adaptor and connect the pump directly to your PSU.

# Step 9

**EN**  
Connect the fan connector to the 4-pin connector on the motherboard.

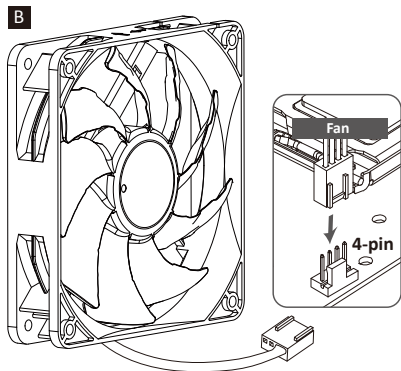

# AMD INSTALLATION

**AquaChanger 120**



## Step 1

**EN**  
Attach the fan and the radiator to the case.

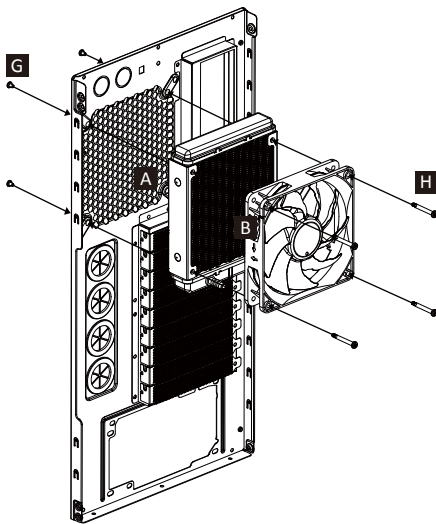

# Step 2

AMD

EN

Stick the insulating sheet on the corresponding position.

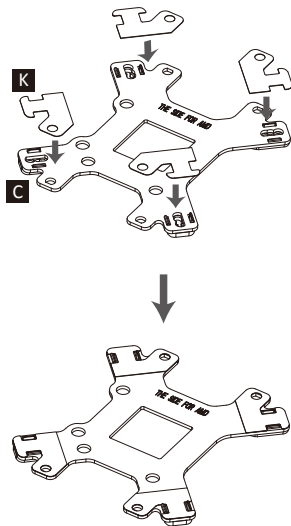

# Step 3

**EN**  
Please remove the original heatsink mount holder before further installation.

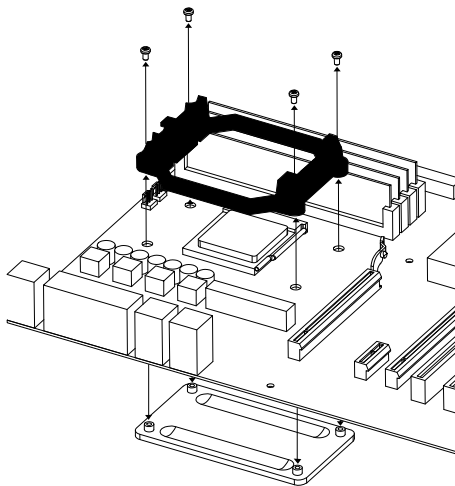

# Step 4

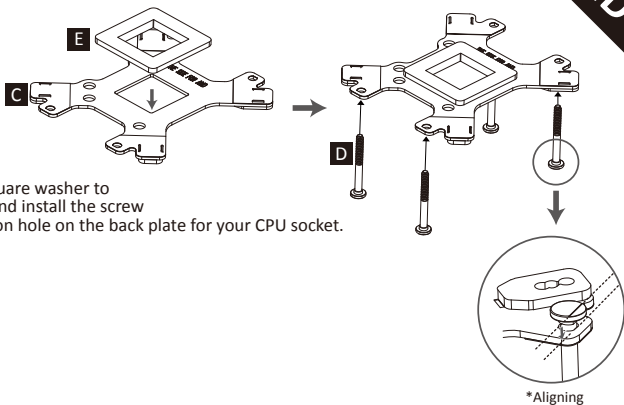

**EN**

Please attach and click the square washer to the center of the back plate and install the screw into the corresponding position hole on the back plate for your CPU socket.

# Step 5

EN

Install the back plate on the back of motherboard; place the stand-off on the motherboard to fix the back plate.

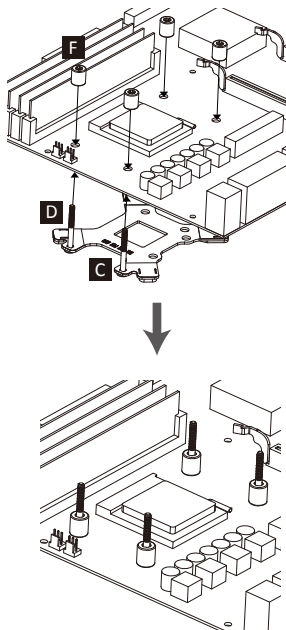

# Step 6

AMD

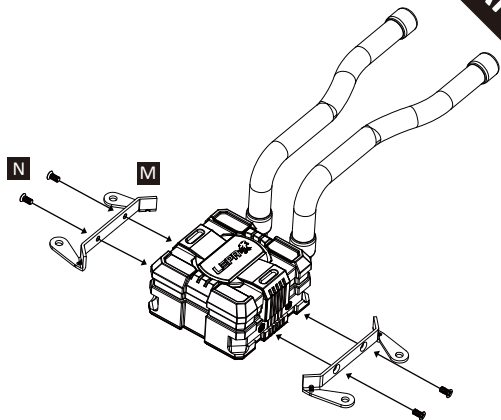

**EN**  
Install AMD bracket to the pump.

# Step 7

**EN**  
Apply the thermal grease on the CPU surface.

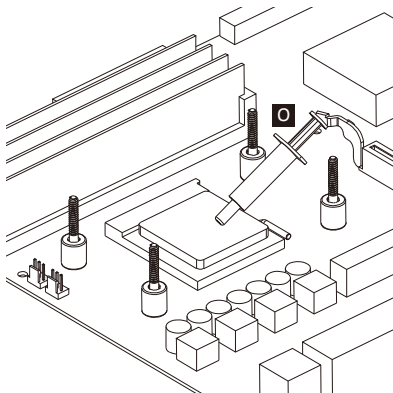

# Step 8

**EN**  
Remove the protection film on the cold plate.

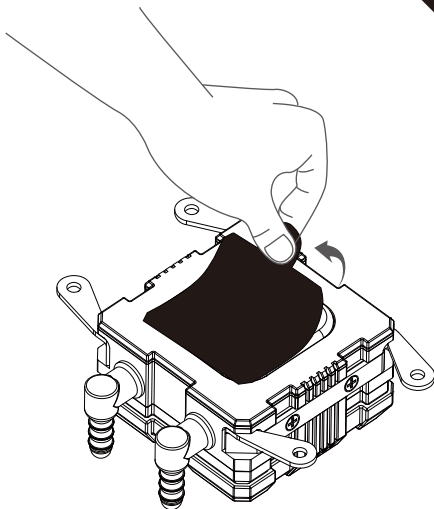



# Step 9

**EN**  
Place the pump on the CPU and tighten the four spring screws.

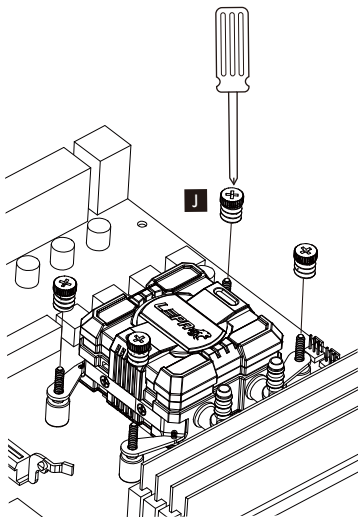

# Step 10

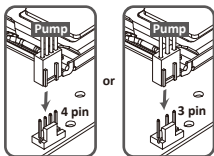
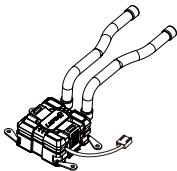

**EN** Connect the pump power connector to 3-pin or 4-pin connector on the motherboard.

Notice: If you recognize that your mainboard's CPU fan or PWM sockets do not provide enough voltage to power the pump, please use the included 4-pin Molex adaptor and connect the pump directly to your PSU.

# Step 11

**EN**  
Connect the fan connector to the 4-pin connector on the motherboard.

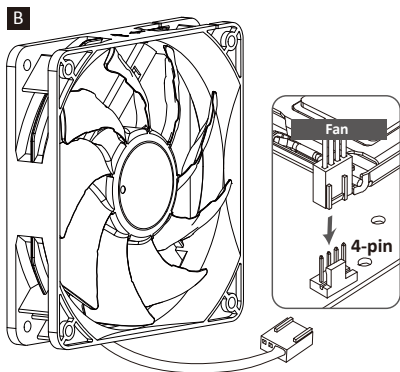



**LEPA**

*Aim for excellence*