

# HH915D Hi-Hat Stand

Production from Jan. 2017

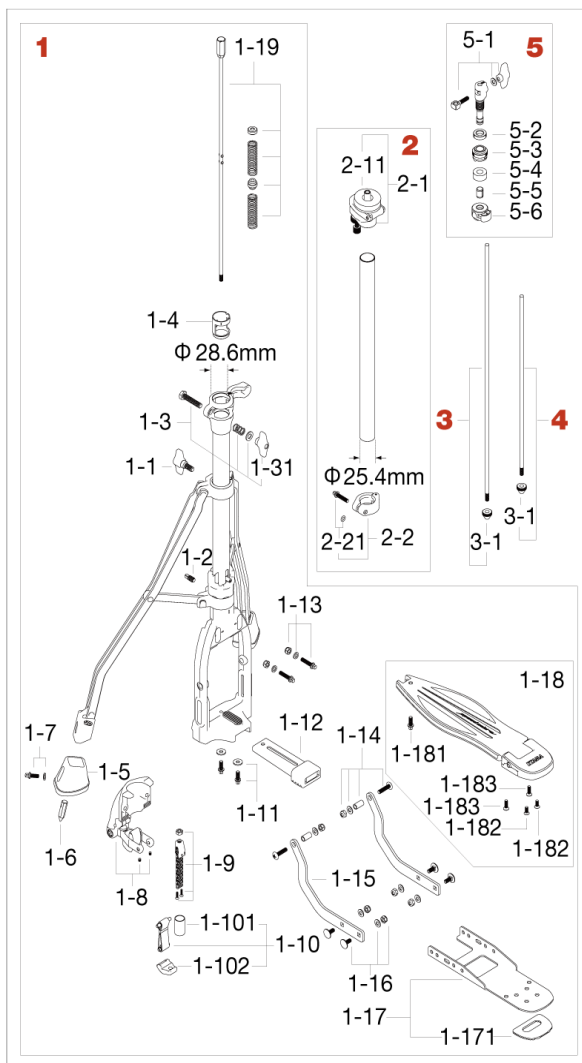

No.	Model No.	Description
<b>1</b>	HH915D1	<b>Base assembly (Lever Glide)</b>
1-1	TS816P	T-bolt (M8x16mm, 2pcs/pack)
1-2	S812SH	Screw (M8x12mm)
1-3	HBS840WN8	Bolt (M8x40mm), spring, washer & T-nut assembly
1-31	WN8P	Wing nut (M8, 2pcs/Pack)
1-4	NB2825CH	Nylon bushing (28.6mm-25.4mm)
1-5	RF905D	Rubber feet
1-6	DSP38	Spike
1-7	MS615SHW	Square head bolt & washer (M6x15mm)
1-8	HH915D11	Back plate w/ Lever Glide unit
1-9	HH905D12	Chain assembly
1-10	HH915D13	Strap w/shafts,pressure plate & protective tube
1-101	HH905D131	Protective tube only
1-102	HH905D132	Pressure plate
1-11	MS615SHLW	Square head bolt & large washer (M6x15mm)
1-12	HH905D16	Stabilizing plate w/ rubber cap
1-13	MS625SHWNN	Bolt (M6x25mm), washers & nylon nut
1-14	HH905-119	Bolt, washers, bushing & nut
1-15	HH915N120	Arm plate
1-16	B615ANT6WC	Bolt, washers & nut
1-17	HH915D15	Under plate only
1-171	HP9N92	Rubber plate (heel side)
1-18	HP91N8	Footboard w/screws
1-181	MS615SH	Square head bolt (M6x15mm)
1-182	S512	Screw (M5x12mm)
1-183	S516	Screw (M5x16mm)
1-19	HH905D14	Lower pull rod & spring assembly
<b>2</b>	HH905D2	<b>Upper tube assembly w/Memory lock</b>
2-1	SS15N	Spring Seat
2-11	SS15FW	Felt washer
2-2	ML254C	Memory lock (25.4mm)
2-21	MS625SHR	Square head bolt (M6x25mm) w/O-ring
<b>3</b>	HH905-3	<b>Upper pull rod (Regular) w/plastic nut (M6)</b>
3-1	HH905-31	Plastic nut
<b>4</b>	HH905D3S	<b>Upper pull rod (Short) w/plastic nut (M6)</b>
<b>5</b>	QHC7	<b>Quick-set Hi-hat clutch</b>
5-1	EBA624WN	Eye bolt (M6 x24) & washer, T-nut assembly
5-2	QHC7LN	Lock nut (M14)
5-3	QHC7AN	Swing-lock clutch nut (M14)
5-4	CL08-13P	Felt washer (2pcs/pack)
5-5	SLC085	Collar
5-6	QHC7ST	Cymbal stopper