

6DR LED 6" Downlight – Round

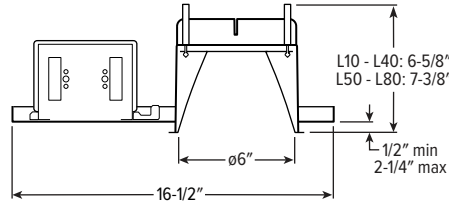
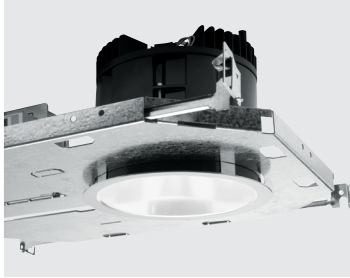

CATALOG #: _____

TYPE: _____

PROJECT: _____

NEW CONSTRUCTION AND REMODEL



ORDERING EXAMPLE: 6DR - TL - L20/835 - OPTIONS - CONTROL/DIM - UNV - OW - OF - CS - TRIM OPTIONS - N - F1

HOUSING TRIM MOUNT

HOUSING

SERIES	LUMENS ^[1]	CRI	CCT	OPTIONS	CONTROL	DRIVER	VOLTAGE
6DR - TL TrimLock	L10	1,000lm ^[2]	8 80	27 2700K	See page 4 for EMERGENCY BATTERY OPTIONS.	See page 7 for ADDITIONAL CONTROL/DRIVER OPTIONS.	See page 7 for ADDITIONAL CONTROL/DRIVER OPTIONS.
	L15	1,500lm	9 90 ^[3]	30 3000K			UNV 120-277V 347 347V ^[10]
	L20	2,000lm		35 3500K	SCA__ Sloped ceiling adapter ^[4]	None	DIM Dimming driver, 0-10V
	L30	3,000lm		40 4000K	ATH Airtight construction	AVI-LVFA AvI-on wireless fixture control ^[7]	DIM1 1% Dimming driver, 0-10V
	L40	4,000lm		50 5000K	F Fuse	AWNR Lutron Athena wireless node integral fixture control, RF only ^[8]	DA Driver with 12V auxiliary power, without external dimming wires ^[9]
	L50	5,000lm			CP Chicago plenum (CCEA) ^[5]		
	L60	6,000lm			SDT Stepdown transformer ^[6]		
	L70	7,000lm					
	L80	8,000lm					

TRIM ^[11]

TRIM TYPE	DISTRIBUTION ^[12]	FLANGE TYPE	REFLECTOR FINISH	TRIM OPTIONS	
O Open reflector	W Wide 65° Open 55° Flush 55° Regressed	OF 1/2" standard flange	Open trim types	MWT Textured white trim flange ^[20]	
L Flush lens		SF 1/4" mud-in flange ^[18]	CS Clear semi-specular anodize	IP IP65 rated trim ^[21]	
R Regressed lens			SG Satin-glow anodize	AD Diffuse acrylic lens ^[22]	
A Angled lens ^[13]		M Medium ^[15]		PD Diffuse 1/8" polycarbonate lens ^[23]	
S Non-conductive flush lens for shower applications ^[14]				TD Diffuse polycarbonate lens media at top of open reflector ^[24]	
	N Narrow ^[16] 10° Open 25° Flush 25° Regressed		CG Champagne gold anodize	WET/CC Wet location, covered ceiling listed ^[25]	
			PW Pewter anodize	AM Anti-microbial ^[26]	
			SPC Clear specular anodize		
		WW Wall wash ^[17]		RG Rose gold anodize	
			WH White texture powder coat		
			BL Black texture powder coat		
			MB Black texture splay with white flange ^[19]		

MOUNTING

MOUNTING TYPE ^[27]	MOUNTING HARDWARE ^[28]
N Open pan for new construction	F1 Integral 2-position fixed pan bracket, universal bar hanger included ^[31]
I IC-rated enclosure for new construction ^[29]	BA1 Adjustable butterfly pan bracket, bar hanger not included ^[32]
R Remodel kit ^[30]	CA1 Adjustable caterpillar pan bracket, universal bar hanger included ^[33]

NOTES

- ¹ Lumen output based on O trim type, W distribution and CS finish, 80 CRI/3500K CCT. Actual lumens may vary +/-5%. See page 2 for FIXTURE PERFORMANCE DATA.
- ² Not available with EM/10W emergency batteries.
- ³ Extended lead times may apply. Consult factory for availability.
- ⁴ 11-1/2" aperture, specify degrees of slope in 5° increments, 05°-30°. Not available with I Mounting Type, S Trim Type, ATH, IP, or WET/CC Options. Painted white. Other colors available, consult factory. See page 3 for SLOPED CEILING ADAPTOR DETAILS.
- ⁵ I Mounting Type required.
- ⁶ May be required for 347V, see product builder at hew.com/product-builder.
- ⁷ DA Driver only. See page 7 for AVI-ON BLUETOOTH WIRELESS CONTROL DETAILS.
- ⁸ DA Driver only.
- ⁹ AvI-on and Lutron Athena Controls only.
- ¹⁰ Not available with EM batteries, DA or DMX Drivers.
- ¹¹ Trim ships separately.
- ¹² Beam angle based on CS or WH reflector finish. See page 2 for FIXTURE PERFORMANCE DATA.
- ¹³ Available with WW Distribution only.
- ¹⁴ W Distribution, OF Flange Type and WH Reflector Finish only. Standard with AD diffuse acrylic lens. IP and WET/CC options standard.
- ¹⁵ Not available with lumen stops L50 and higher when specified with flush or regressed trim types.
- ¹⁶ Not available with lumen stops L50 and higher when specified with flush or regressed trim types.
- ¹⁷ O and A Trim Types only.
- ¹⁸ For use with mud-in plaster construction only, supplied with mud flange installation kit. See page 4 for FLANGE TYPE DETAILS. Not available with ATH or IP options.
- ¹⁹ R Trim Type only. Not available with MWT.
- ²⁰ Not available with WH Reflector Finish, L or S Trim Types.
- ²¹ L and R trim types only.
- ²² Not available with O trim type. W and WW distributions only.
- ²³ Not available with O trim type. W and WW distributions only.
- ²⁴ O Trim Type only. WET/CC standard unless ordered with EM/RTS. L50 lumen package max.
- ²⁵ L50 lumen package max with O Trim Type. Not available with PD trim option.
- ²⁶ WH and BL Reflector Finishes only. Not available with S Trim Type.
- ²⁷ Mounting hardware required (N and I only), ordered separately, see MOUNTING HARDWARE ordering info. See page 5 for MOUNTING TYPE DETAILS.
- ²⁸ Additional mounting hardware options available. See page 6 for MOUNTING HARDWARE DETAILS.
- ²⁹ L30 lumen package max. Not available with EM batteries or Lutron Athena Controls.
- ³⁰ Also used in new construction sheetrock ceilings. Pan-less installation.
- ³¹ N and I Mounting Types only. I Mounting requires external brackets.
- ³² N Mounting Type only.
- ³³ N Mounting Type only.

6DR LED 6" Downlight – Round

FEATURES

TrimLock®

- Innovative TrimLock reflector retention system ensures trim remains flush with ceiling plane
- Wide range of lumen options for general illumination
- Beam angles ranging from 10° narrow to 65° wide for tailored performance
- Industry-leading efficacies as high as 116 lm/W
- New construction mounting pan, IC-rated, or pan-less remodel kit available
- Fully room-side accessible
- Die-cast trim includes flush, regressed or angled lens
- Sloped adapter accommodates vaulted ceilings
- Optional non-conductive lens for shower applications
- IP65-rated die-cast trim includes easy-to-clean flush lens
- Open reflector with nine finishes complements any interior style
- Available on QuickShip
- Wireless in-fixture control solutions available

SPECIFICATIONS

- HOUSING** – Die-cast aluminum trim housing with forged aluminum heat sink. Galvanized steel splice compartment with driver mounting plate/enclosure. Swing-out mounting arms field adjust for ceiling thickness from 1/2" – 2-1/4".
- TRIMLOCK** – Innovative TrimLock reflector retention system ensures the trim remains flush with the ceiling plane.
- OPEN REFLECTOR** – Low-iridescent anodized aluminum. Clear semi-specular finish standard.
- LENSED TRIM** – Die-cast aluminum frame with micro-prismatic, acrylic lens.
- ELECTRICAL** – High-performance Class 2 C.O.B. LED array. Modular quick-connect plug for easy field-connection of LED light assembly to driver. Reported L70>55,000 hours. Reported L90>55,000 hours. Estimated L70 = 200,000 hours.
- MOUNTING** – Recessed. 20 ga. galvanized steel mounting pan for new construction or IC-rated enclosure. Remodel kit option includes receiver bracket hardware. Minimum 24" O.C. marked spacing required for L60 - L80 lumen packages.
- LISTINGS** –
 - cCSAus conforms to UL STD 1598; Certified to CAN/CSA STD C22.2 No. 250.0 for dry and damp locations. LED light assembly conforms to UL 2108 for remote installation.
 - Suitable for wet location under covered ceiling when specified with WET/CC or TD options.
 - ENERGY STAR® certified in select configurations, see www.energystar.gov
 - IC-rated for direct contact with insulation when specified with I Mounting Type.
 - City of Chicago Environmental Air approved when specified with CP option.
 - Complies with ASTM-E283 when specified with ATH option.
 - RoHS compliant.
 - Title 24 (JAB) compliant in select configurations, see www.cacertappliances.energy.ca.gov.
 - Complies with the Buy American Act and other federal regulations. Request certification at hew.com/baa.
- WARRANTY** – 5-year limited warranty, see hew.com/warranty.

FIXTURE PERFORMANCE DATA

OPEN REFLECTOR TRIM TYPE

	DIST.	DELIVERED LUMENS	WATTAGE	EFFICACY (lm/W)
L10	W	1014	8.7	117
	M	982	8.7	113
	N	1003	8.7	115
L15	W	1497	13.8	109
	M	1495	13.8	108
	N	1528	13.8	111
L20	W	1988	19.0	105
	M	1983	19.1	104
	N	2026	19.1	106
L30	W	3062	26.9	114
	M	3003	26.9	112
	N	3000	26.9	112
L40	W	4094	36.5	112
	M	4016	36.4	110
	N	4011	36.4	110
L50	W	5014	43.9	114
	M	4935	43.9	112
	N	5047	43.9	115
L60	W	6043	54.0	112
	M	5948	54.0	110
	N	6083	54.0	113
L70	W	7008	67.8	103
	M	6898	67.8	102
	N	7055	67.8	104
L80	W	8018	79.8	101
	M	7891	79.8	99
	N	8071	79.8	101

FLUSH LENS TRIM TYPE

	DIST.	DELIVERED LUMENS	WATTAGE	EFFICACY (lm/W)
L10	W	774	8.7	89
	M	910	8.7	105
	N	909	8.7	105
L15	W	1178	13.8	85
	M	1385	13.8	100
	N	1384	13.8	100
L20	W	1562	19.5	80
	M	1837	19.1	96
	N	1836	19.5	94
L30	W	2335	26.9	87
	M	2782	26.9	103
	N	2718	26.9	101
L40	W	3122	36.5	86
	M	3720	36.4	102
	N	3635	36.4	100
L50	W	3824	43.9	87
	M	-	-	-
	N	-	-	-
L60	W	4609	54.0	85
	M	-	-	-
	N	-	-	-
L70	W	5345	67.8	79
	M	-	-	-
	N	-	-	-
L80	W	6115	79.8	77
	M	-	-	-
	N	-	-	-

REGRESSED LENS TRIM TYPE

	DIST.	DELIVERED LUMENS	WATTAGE	EFFICACY (lm/W)
L10	W	716	8.7	82
	M	883	8.7	102
	N	897	8.7	103
L15	W	1090	13.8	79
	M	1344	13.8	97
	N	1366	13.8	99
L20	W	1445	19.5	74
	M	1782	19.1	93
	N	1812	19.5	93
L30	W	2160	26.9	80
	M	2699	26.9	100
	N	2683	26.9	100
L40	W	2889	36.5	79
	M	3609	36.4	99
	N	3587	36.4	99
L50	W	3537	43.9	81
	M	-	-	-
	N	-	-	-
L60	W	4264	54.0	79
	M	-	-	-
	N	-	-	-
L70	W	4945	67.8	73
	M	-	-	-
	N	-	-	-
L80	W	5657	79.8	71
	M	-	-	-
	N	-	-	-

MULTIPLIER TABLES

	COLOR TEMPERATURE	
	CCT	CONVERSION FACTOR
80 CRI	2700K	0.92
	3000K	0.98
	3500K	1.00
	4000K	1.01
	5000K	1.02

90 CRI	2700K	0.76
	3000K	0.79
	3500K	0.82
	4000K	0.84
	5000K	0.88

	REFLECTOR FINISH	
	CATALOG NUMBER	CONVERSION FACTOR
O TRIM	CS	1.00
	SG ¹	0.92
	GD	0.93
	CG	0.96
	PW	0.86
	SPC	1.02
	RG	0.88
	WH ¹	0.89
	BL ¹	0.47

R TRIM	WH	1.00
	CS	0.98
	BL	0.79

	TRIM	
	CATALOG NUMBER	CONVERSION FACTOR
S	0.85	
AD	0.85	
PD	0.85	
TD	0.75	
WET/CC ²	0.85	

¹ Distribution will also be affected, consult factory.

² Use multiplier when specified with O Trim Type.

- Photometrics tested in accordance with IESNA LM-79. Results based on O trim type, W distribution, CS finish, 80 CRI/3500K CCT, wattage for 120V input, and 25°C ambient temperature. Actual performance may vary +/-5%.
- To calculate lumen output in emergency mode, multiply the battery wattage by the efficacy.
- Use multiplier tables to calculate additional options.



6DR LED 6" Downlight – Round

PHOTOMETRY

6DR-TL-L20/835-DIM-UNV-OW-OF-CS Report #: 20687; 12/12/18 | Total Luminaire Output: 1988 lumens; 19.0 Watts | Efficacy: 104.6 lm/W | 80 CRI; 3500K CCT

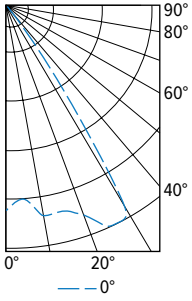

CANDLEPOWER DISTRIBUTION	VERTICAL ANGLE	HORIZONTAL ANGLE	ZONAL LUMENS
		0°	
	0	1672	
	5	1579	151
	15	1735	492
	25	1982	917
	35	604	380
	45	46	36
	55	13	12
	65	2	2
	75	0	0
	85	0	0
	90	0	0

LUMEN SUMMARY	ZONE	LUMENS	% FIXTURE
	0 - 40	1939	98
	0 - 60	1987	100
	0 - 90	1988	100
	0 - 180	1988	100

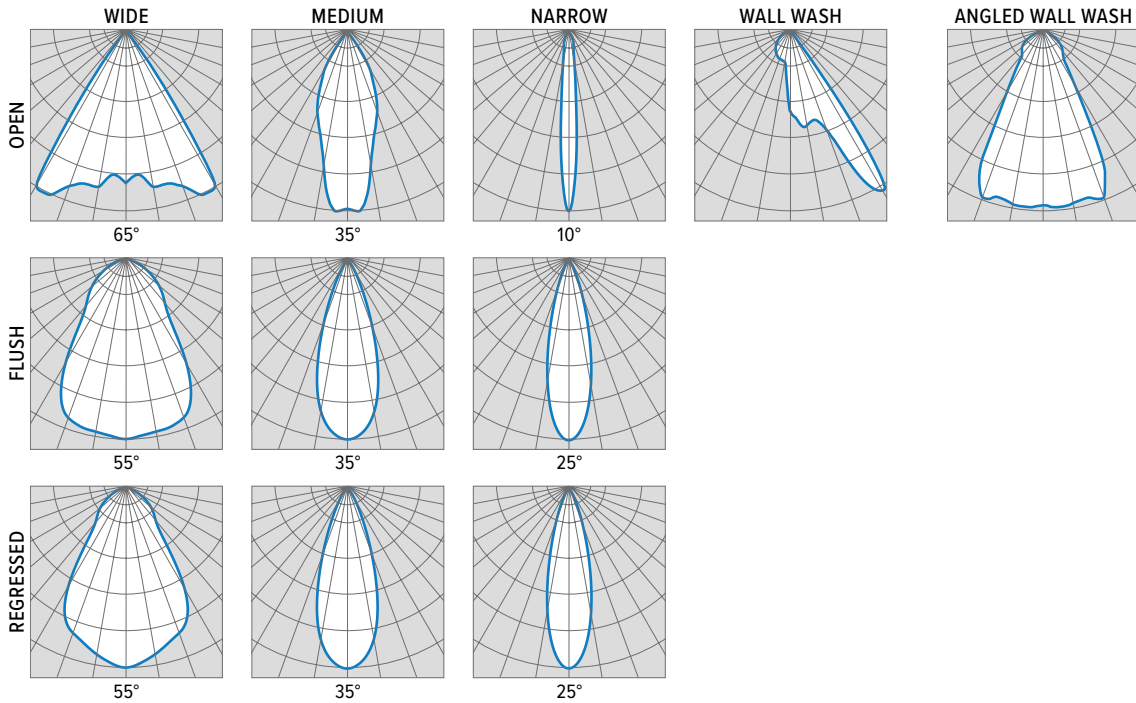

TRIMLOCK DETAILS

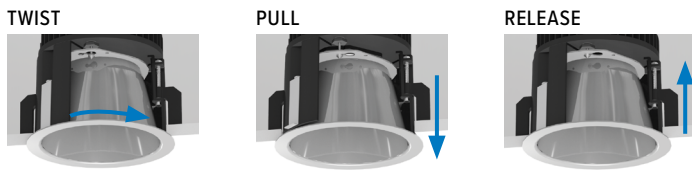

SLOPED CEILING ADAPTOR DETAILS

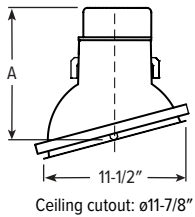

LUMENS	A (HEIGHT)						PLENUM HEIGHT
	5°	10°	15°	20°	25°	30°	
L10 - L40	10-11/16"	10-7/8"	10-15/16"	10-7/8"	10-13/16"	10-5/8"	11-1/4"
L50 - L80	11-7/16"	11-9/16"	11-5/8"	11-5/8"	11-1/2"	11-1/4"	12"

15° Shown

6DR LED 6" Downlight – Round

TRIM TYPE DETAILS

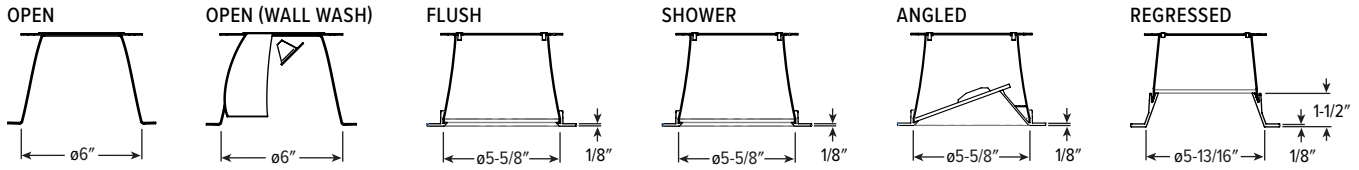

FLANGE TYPE DETAILS

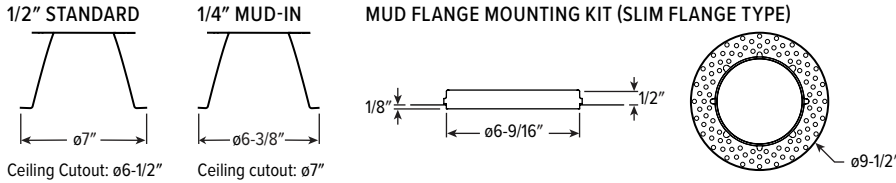

EMERGENCY BATTERY OPTIONS

Additional limitations apply, see page 1. Specify CEC in the option code when California Energy Commission regulations are required.

CATALOG NUMBER	DESCRIPTION
EM/7W	7-watt emergency battery ^[1]
EM/7W/RTS	7-watt emergency battery with regressed test switch ^[2]
EM/7W/IPRTS	7-watt emergency battery with IP65 rated regressed test switch
EM/10W	10-watt emergency battery ^[1]
EM/10W/RTS	10-watt emergency battery with regressed test switch ^[2]
EM/10W/IPRTS	10-watt emergency battery with IP65 rated regressed test switch

- 1 Not available with S Trim Type or IP Option.
- 2 Not available with S Trim Type, IP or WET/CC Options.

REGRESSED TEST SWITCH DETAILS

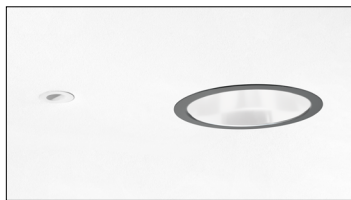

Shown Installed

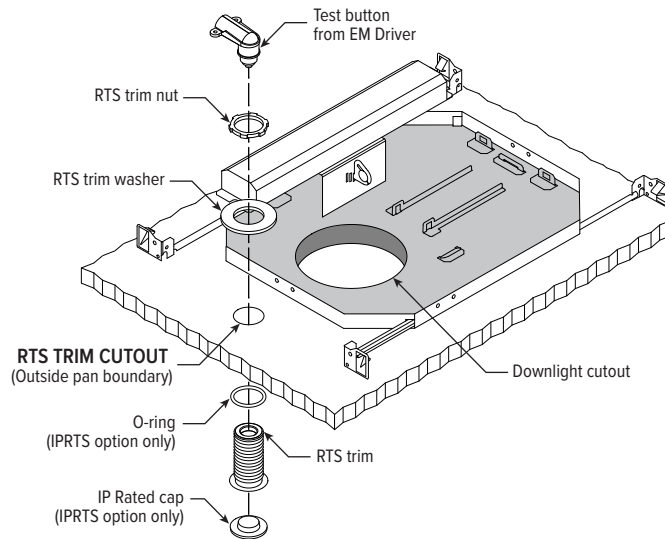

REFLECTOR FINISH DETAILS

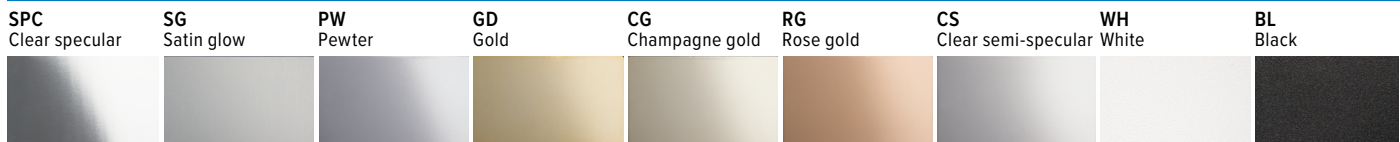

6DR LED 6" Downlight – Round

MOUNTING TYPE DETAILS

NEW CONSTRUCTION

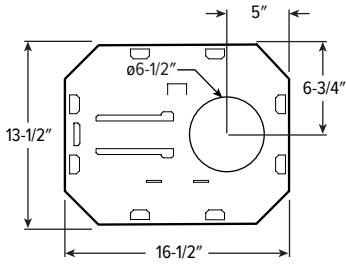

IC-RATED

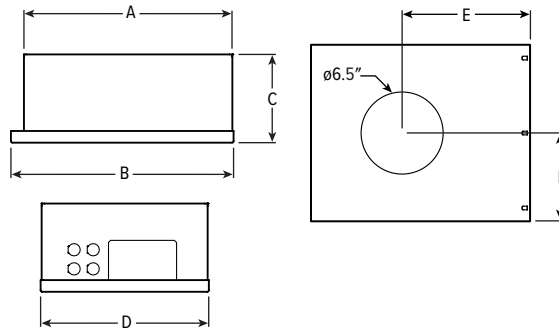

LUMENS	LENGTH					
	A	B	C	D	E	F
L10 - L20	15-3/16"	16"	6-3/8"	12-1/8"	9-1/2"	6-1/16"
L30	16-5/8"	17-1/2"	7-7/8"	14"	10-1/4"	7"

REMODEL

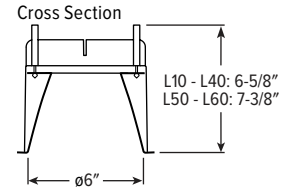

Receiver Bracket

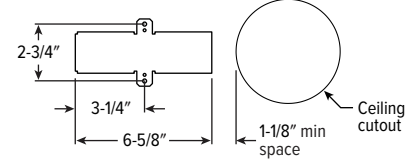

Driver and Junction Box

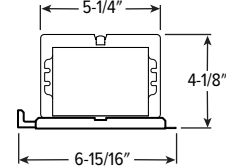

APERTURE ADAPTOR ORDERING INFO

ORDERING EXAMPLE: 4DR - GR - 0575 - WHT			
SERIES	CATALOG NUMBER	CEILING CUTOUT	FINISH
4AR 6AR	GR	Specify ceiling cutout in 1/8" increments. Example: 5.75" = 0575	CS Clear semi-specular powder coat
4DR 6DR			WH White texture powder coat
4DS 6DS			BL Black texture powder coat
4PR 6PR			
4PS 6PS			
8DR			
		See Kit Components for application limits.	

For use with remodel downlights. Additional finishes available, consult factory.
For limitations and instructions, see hew.com/aperture-adaptor.pdf



6DR LED 6" Downlight – Round

MOUNTING HARDWARE DETAILS

F1 Integral 2-position fixed pan bracket, universal bar hanger included

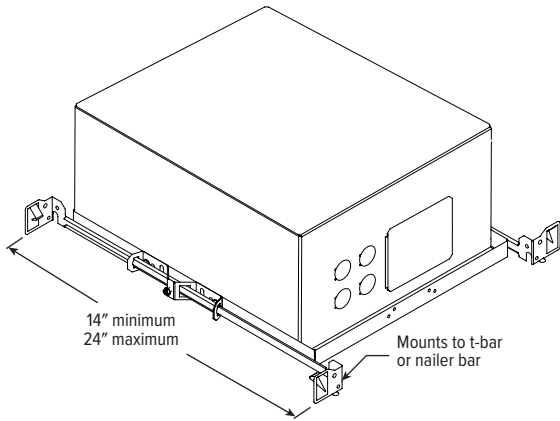
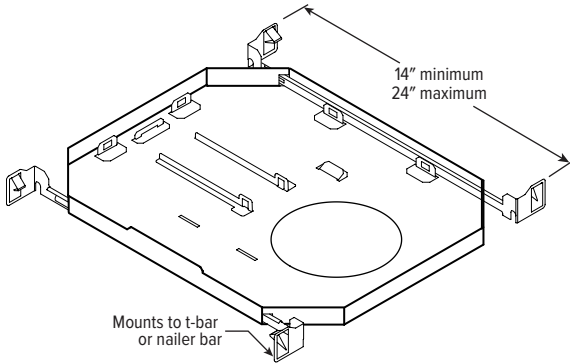

F1 with I Mounting Type

BA1 Adjustable butterfly pan bracket, bar hanger not included (N Mounting Type only)

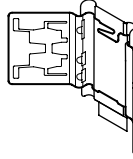

BA2 Adjustable butterfly pan bracket, heavy-duty universal bar hanger included (N Mounting Type only)

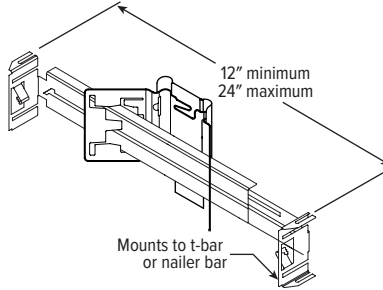

CA1 Adjustable caterpillar pan bracket, universal bar hanger included (N Mounting Type only)

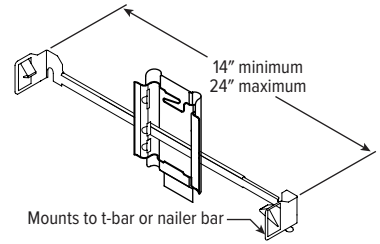

CA2 Adjustable caterpillar pan bracket, t-bar hanger included (N Mounting Type only)

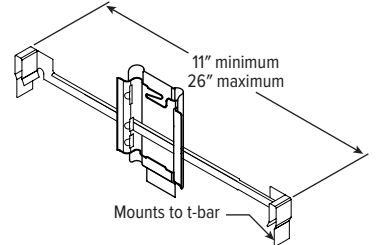

SEE NEXT PAGE FOR CONTROL DETAILS.



6DR LED 6" Downlight – Round

AVI-ON BLUETOOTH WIRELESS CONTROL DETAILS

FEATURES

Simple

- Gateway-free distributed control
- Factory pre-commissioning
- Contractor friendly installation
- Occupancy/vacancy/daylight sensing

Scalable

- Virtually unlimited network size
- Spans small offices to large warehouses
- Flexible control strategies

Secure

- Optional cloud connectivity
- UL IoT platinum security rating
- DLC 5.0 compliant

COMMISSIONING & INSTALLATION TOOLS

Avi-on mobile apps provide intuitive, quick installation and commissioning. Pro tools are available to qualified installers. Live commissioning training and on-site or remote support by Avi-on must be ordered separately through Avi-on.



Commissioning Mobile App



Zone Scanner Web App



Commissioning Pro App

SYSTEM COMPONENTS

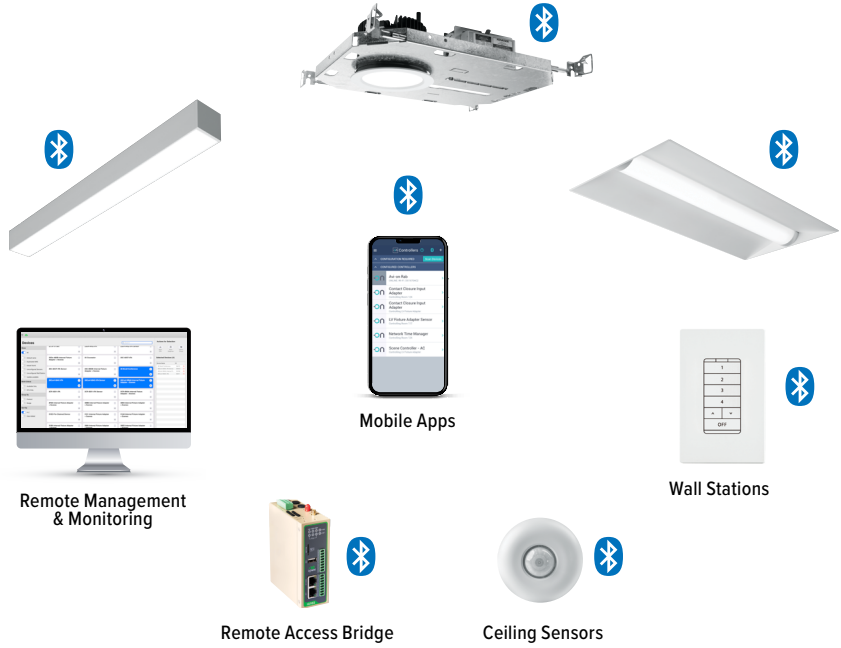

The Bluetooth® word mark and logos are registered trademarks owned by Bluetooth SIG, Inc. and any use of such marks by Avi-on is under license. Other trademarks and trade names are those of their respective owners.

ACCESSORIES

WALL STATIONS	
AVI-2401AC	Scene controller - numbered 1-4, 120-277VAC
AVI-2402BAT	Scene controller - numbered 1-4, battery powered
AVI-2401AC-2	Dimmer with presets - percentages, 120-277VAC
AVI-2402BAT-2	Dimmer with presets - percentages, battery powered
AVI-2401AC-3	On/off/dimming, 120-277VAC
AVI-2402BAT-3	On/off/dimming, battery powered

NETWORK	
AVI-RAB-LTE	Remote access bridge
AVI-KIT-NTM	Network time manager with battery backup
CEILING MOUNT SENSORS	
AVI-KIT-SEN-DUCM	PIR motion and ultrasonic sensor kit
AVI-KIT-SEN-ICM	PIR motion and photocell sensor kit

For load controllers and additional accessory info, see hew.com/avi-on

ADDITIONAL CONTROL/DRIVER OPTIONS

Lumen restrictions apply: L40 max for DMX driver, L40 max for Lutron drivers, L15 min to L60 max for DIM LINE driver. R mounting type requires top access with DMX controls. R Mounting Type requires 12" minimum plenum depth when specified with VRF/DBI controls. 347V may require stepdown transformer, see product builder at hew.com/product-builder. I Mounting Type not available with Lutron controls.

CATALOG NUMBER	DESCRIPTION
AVI-LVFA/DA	Avi-on wireless fixture control for use with driver with 12V auxiliary power
AWNDR/DA	Lutron Athena wireless node integral fixture control, RF only, for use with driver with 12V auxiliary power
VRF/DBI/LDE1	Lutron Vive integral fixture control, RF only (DFCSJ-OEM-RF) and digital link interface, with Lutron Hi-lume 1% EcoSystem dimming LED driver
FCJS/DIM	Lutron Vive PowPak wireless fixture control with dimming driver
FCJS/DIM1	Lutron Vive PowPak wireless fixture control with 1% dimming driver
DIM	Dimming driver prewired for 0-10V low voltage applications
DIM1	1% dimming driver prewired for 0-10V low voltage applications
DIM LINE	Line voltage dimming driver (TRIAC and ELV compatible at 120V only)
DALI	DALI dimming driver
DMX	0.1% dimming driver for DMX controls
LDE1	Lutron Hi-lume 1% EcoSystem dimming LED driver

