

DBPE/U 104 Multipole Receptacles

Contact polarity A

Contact polarity Z

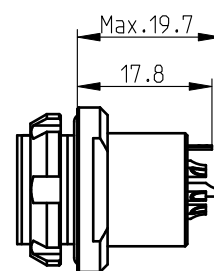
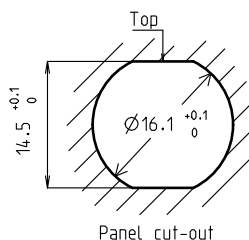
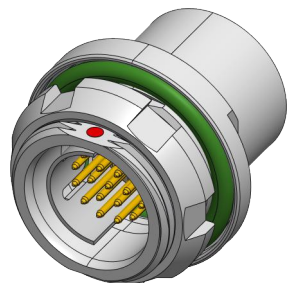
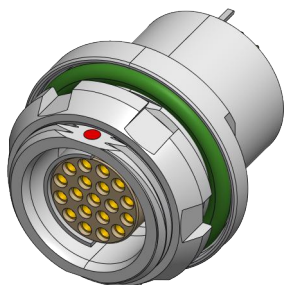

All dimensions see note 1)

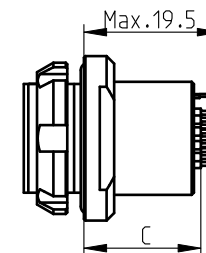

Solder (-x39/-x49)

PCB (-x30/-x40)

CONTACT CONFIGURATION	Contacts	Solder cup \varnothing	C	PIN \varnothing	
104 A Z	065	6	0.79	15.5 15.2	0.50 0.63
104 A Z	054	7	0.79	15.5 15.2	0.50 0.63
104 A Z	066	8	0.79	15.5 15.2	0.50 0.63
104 A Z	055	9	0.79/1.18	15.5 15.2	0.50 0.63
104 A Z	056	11	0.79	15.5 15.2	0.50 0.63

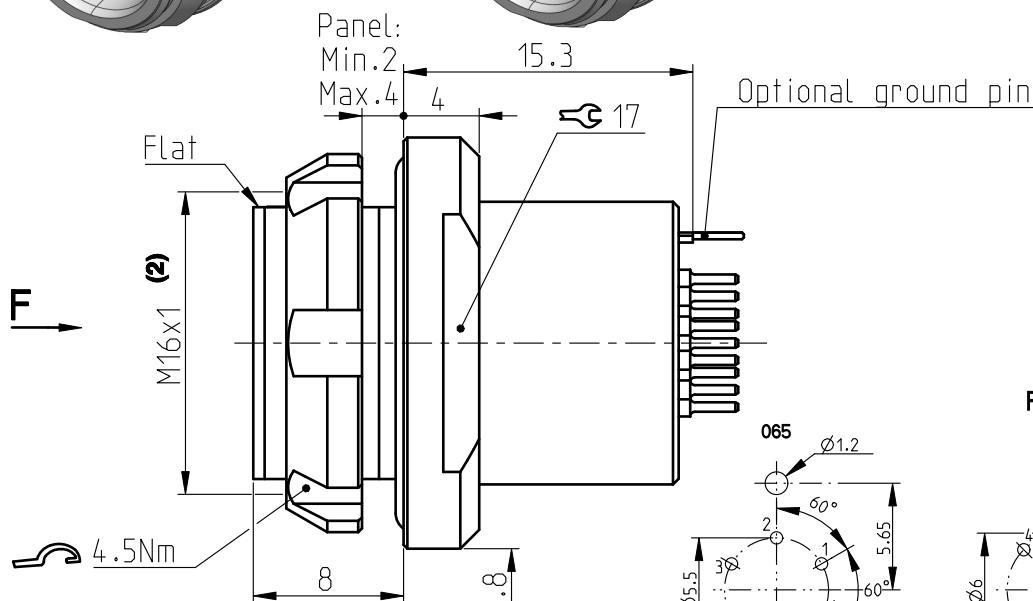

Pin layout / PCB hole pattern for polarity A - View from F (3)

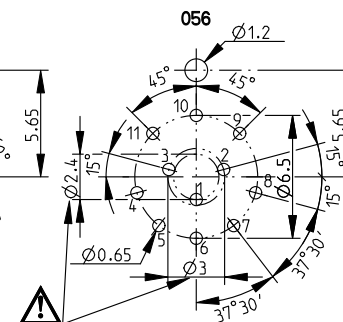
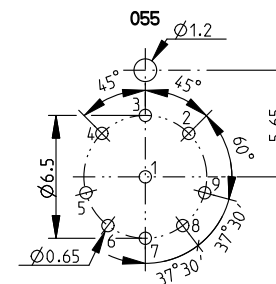
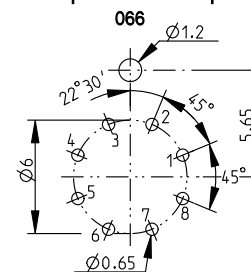
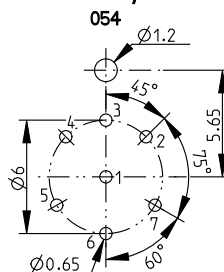
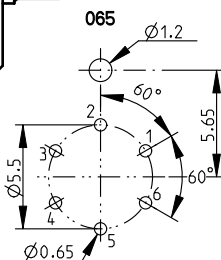

Keying codes (View from F)

Code 1 (-1xx)

Code 2 (-2xx)

Code 3 (-3xx)

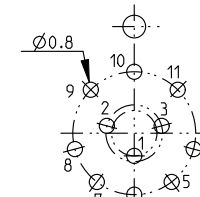
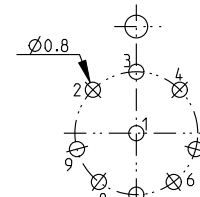
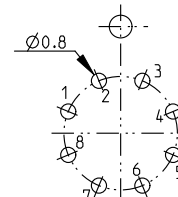
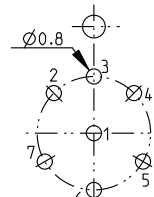
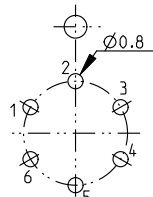
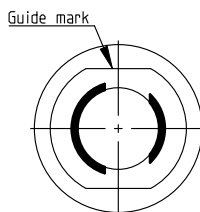
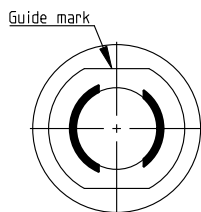
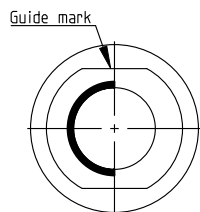

All dimensions in mm

Rev. 6

Pages 2/5

Notes:
 1) All tolerances resulting from connector assembly are typically ± 0.3 mm
 2) If receptacle is screwed directly into threaded hole, oversize thread by $+0.05$ mm

3) Recommended PCB hole dimensions may be adjusted to application

Part number example : DBPE 104 A092-130

600477



www.fischerconnectors.com

DBPE/U 104 Multipole Receptacles

Contact polarity A

Contact polarity Z

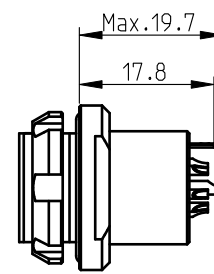
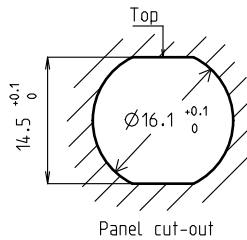
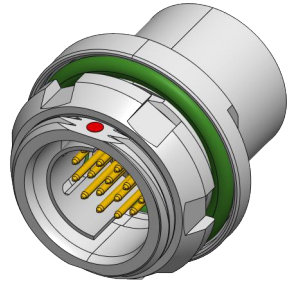
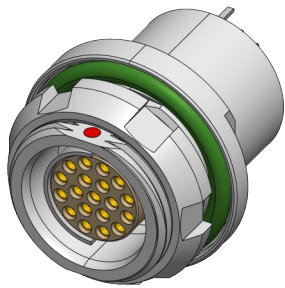

All dimensions see note 1)

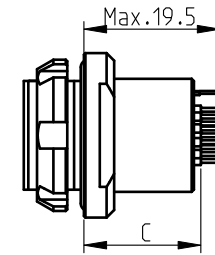

Solder (-x39/-x49)

PCB (-x30/-x40)

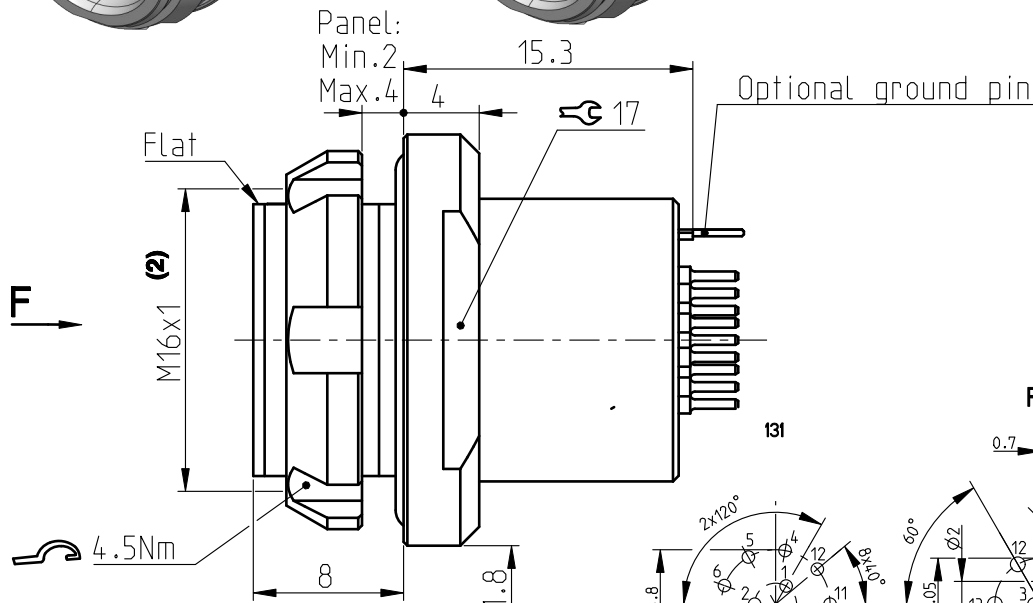

CONTACT CONFIGURATION	Contacts	Solder cup \varnothing	C	PIN \varnothing
104 A 131	12	-	16.1	0.40
104 A 130	14	-	16.1	0.40 0.50
104 A/Z 086	16	0.79	15.5	0.50
104 A/Z 092	19	0.79	15.5 15.2	0.50
104 A 135	20	See page 5	-	-

Pin layout / PCB hole pattern for polarity A - View from F (3)

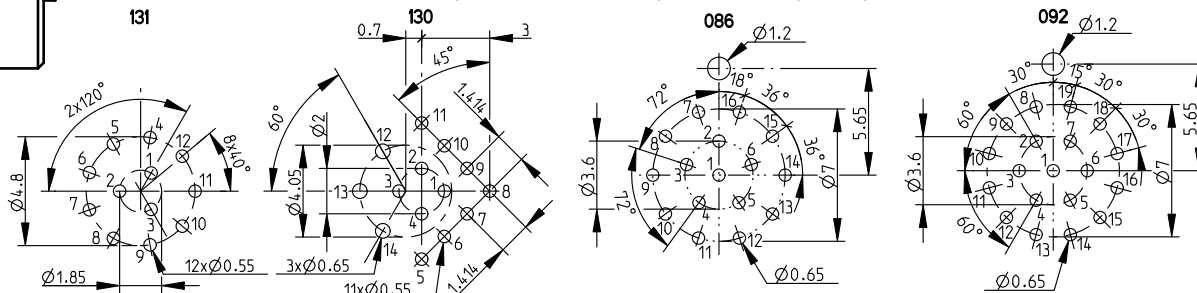

Keying codes (View from F)

Code 1 (-1xx)

Code 2 (-2xx)

Code 3 (-3xx)

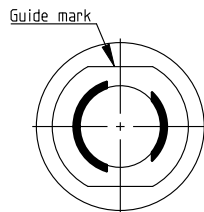
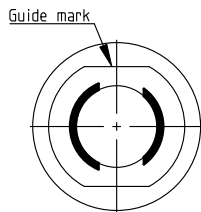
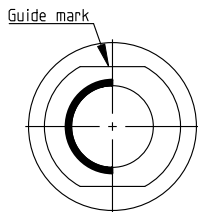

(4)

(4)

Polarity Z - View from F

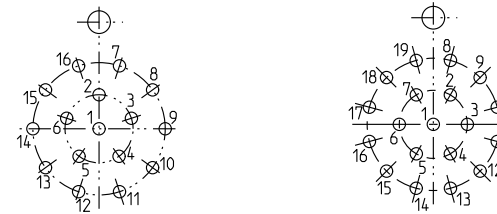

(See page 5)

(See page 5)

All dimensions in mm

Rev.

Pages

Notes :

- 1) All tolerances resulting from connector assembly are typically ± 0.3 mm
- 2) If receptacle is screwed directly into threaded hole, oversize thread by $+0.05$ mm

- 3) Recommended PCB hole dimensions may be adjusted to application
- 4) Please contact us

600477

6

3/5

Part number example : DBPE 104 A092-130



www.fischerconnectors.com

DBPE/U 104 Multipole Receptacles

Contact polarity A

Contact polarity Z

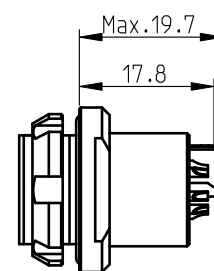
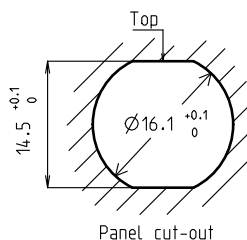
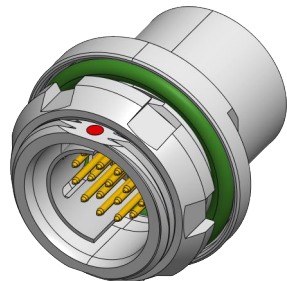
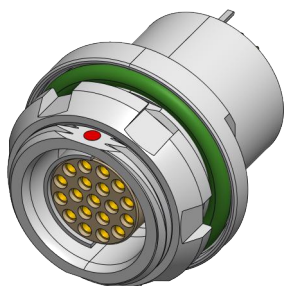

Solder (-x39/-x49)

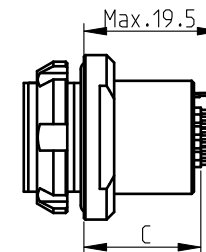

PCB (-x30/-x40)

All dimensions see note 1)

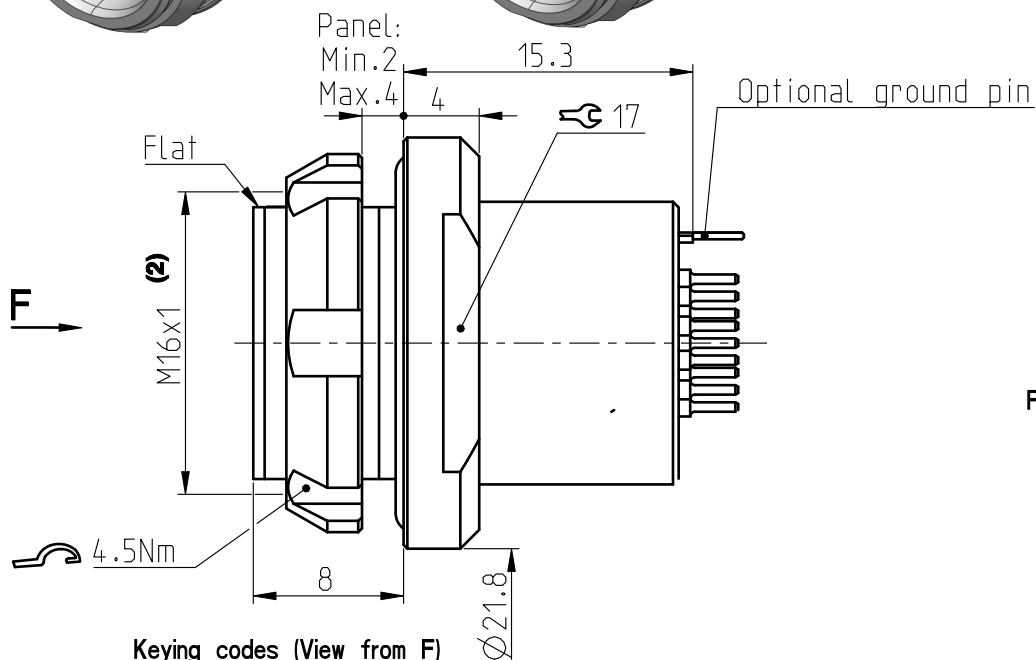

CONTACT CONFIGURATION	Contacts	Solder cup \varnothing	C	PIN \varnothing
104 A 124	27	0.43	15.6	0.40

Keying codes (View from F)

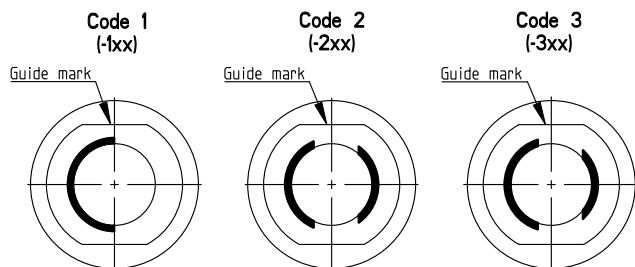

Pin layout / PCB hole pattern for polarity A - View from F (3)

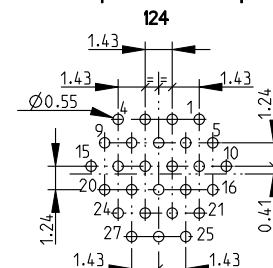

Polarity Z - View from F

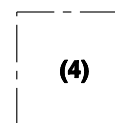

All dimensions in mm

Rev.

Pages

Notes :

- 1) All tolerances resulting from connector assembly are typically ± 0.3 mm
- 2) If receptacle is screwed directly into threaded hole, oversize thread by $+0.05$ mm

- 3) Recommended PCB hole dimensions may be adjusted to application
- 4) Please contact us

600477

6

4/5

Part number example : DBPE 104 A092-130

fischer
CONNECTORS

www.fischerconnectors.com

DBPE/U 104 Multipole Receptacles

All dimensions see note 1)

Contact polarity A

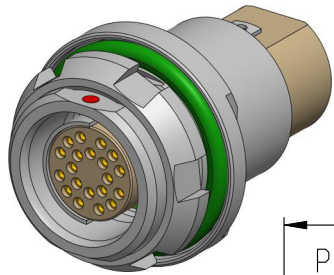

Solder (-x39/-x49)
with potting tube

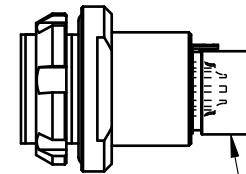
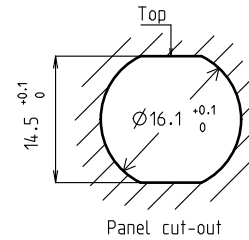
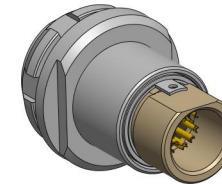

Potting tube (3)

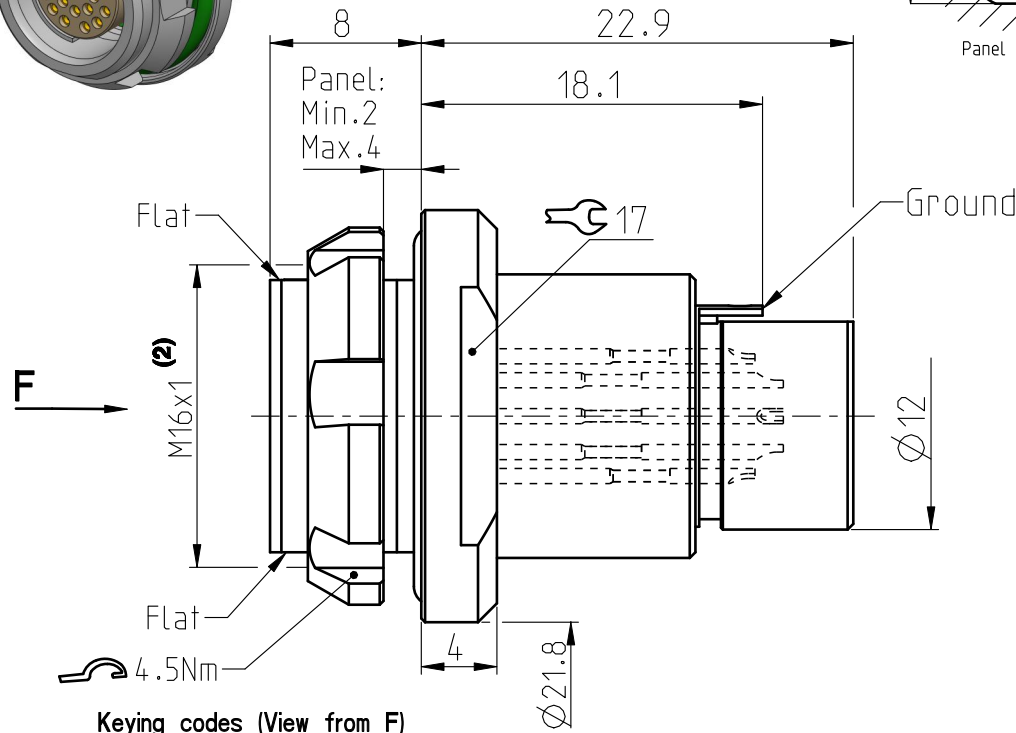

CONTACT CONFIGURATION	Contacts	Solder cup Ø
104 A 135	20	Contact Nr. 1 to 8 = 0.43 Contact Nr. 9 to 20 = 0.55

Keying codes (View from F)

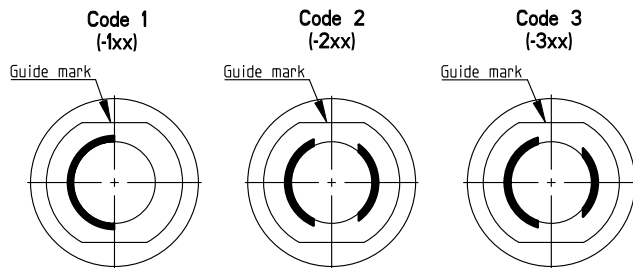

Pin numbering for polarity A - View from F

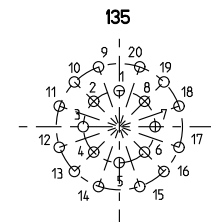

All dimensions in mm

Rev.

Pages

Notes :

- 1) All tolerances resulting from connector assembly are typically $\pm 0.3\text{mm}$
- 2) If receptacle is screwed directly into threaded hole, oversize thread by $+0.05\text{mm}$

3) Potting tube only for solder version. For signal integrity.

Part number example : DBPE 104 A092-130

600477

6

5/5

fischer
CONNECTORS

www.fischerconnectors.com