

# Extreme 7520 Series Quick Reference

Follow these steps to get the switch ready for use.

For complete installation instructions see the *Extreme 7520 Hardware Installation Guide* at [www.extremenetworks.com/support/documentation/](http://www.extremenetworks.com/support/documentation/)

## Necessary Tools

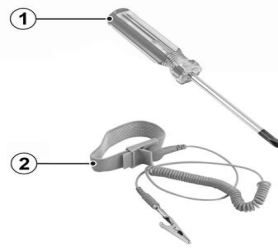

- 1 #2 Phillips screwdriver (magnetic screwdriver recommended)
- 2 ESD-protective wrist strap

## 1 Prepare the Site

The installation site must meet the following requirements:

- Appropriately grounded power receptacles located within 1.8 m (6 ft.)
- A readily accessible device for disconnecting power, such as a breaker or master switch
- Network cabling within reach
- Clearance of at least of 7.6 cm (3.0 in.) on all sides for proper ventilation
- Temperature between 0°C (32°F) and 45°C (113°F) -- or as noted in "Operating Temperature:" -- with fluctuations of less than 10°C (18°F) per hour

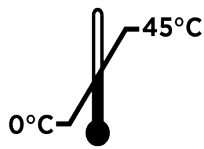

## 2 Unpack the Box

Remove the packing material, and then verify that all of the following components are included:

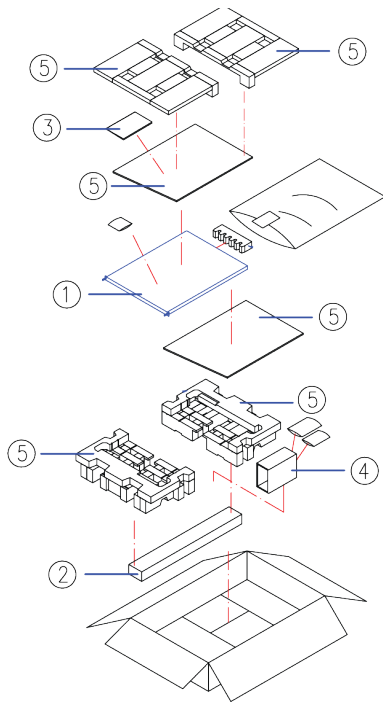

- 1 Switch
- 2 4-post Rack Mount Kit
- 3 Manual
- 4 Accessories
- 5 Cushion/Pad

If the switch appears to be damaged, contact Extreme Networks. See "Getting Help" for more information.

Extreme Networks does not include power input cords with this product. To purchase the correct power cord for your country, refer to [www.extremenetworks.com/product/powercords/](http://www.extremenetworks.com/product/powercords/).

## 3 Install the Switch

You can install any 7520 switch in a standard 19-inch equipment rack.

Mount the 7520 switch in a standard equipment rack, in either of the following ways:

- Four-post mount, using the mounting kit provided.
- Two-post mount, using mounting brackets (not provided) to attach the front or the middle of the switch to the posts.

### Four-Post Mount

- 1 Separate the inner sliding rails from the outer rails by extending the rails and pulling on the disconnect latch. Note which direction the sliding rails slide from the outer rails for correct installation.
- 2 Attach the outer rail to the rack, securing it with the M5 screws.
- 3 Attach an inner rail to the side of the unit, using the M4 screws.
  - If using the 1U long rack ears (already attached to the inner rail): Ensure that the rack ear is flush with the either the front or the rear panel of the unit and continue to step 4.
  - If using the 1U or 2U short rack ears, attach one to the side of the unit using the #6-32 screws, so that the rack ear is flush with either the front or the rear panel of the unit.
- 4 Repeat steps 2 and 3 for the other side of the chassis.
- 5 Insert the chassis into the rail kit and secure it to the rack using the thumb screws on the mounting ears.

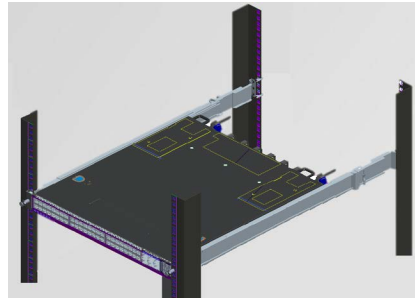

### Two-Post Mount

**Note:** The following diagram shows a mid-mounted configuration. The brackets also support a front-mounted configuration.

- 1 Attach a mounting bracket to each side of the switch. You can attach the brackets at the middle of the switch, as shown, or at the front

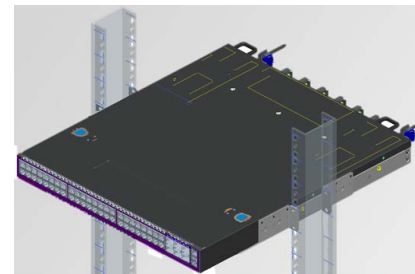

- 2 Secure the brackets to the rack posts using rack-mounting screws that are appropriate for the rack (not provided).
- 3 Attach a mounting bracket to one side of the switch, so that its flange (ear) aligns with the rack post. Then secure it to the rack post.
- 4 Attach a mounting bracket to the other side of the switch and then to the rack post.

## 4 Connect Power

7520 switches run on AC or DC power. Connect the switch to a primary power source.



**Note:** Installing the system as described in this guide meets the protective earth grounding requirements of the National Electrical Code (NEC) UL 60950 and IEC 60950 standards. However, in some cases, it may be necessary to use an alternative grounding method. In these cases, a 14 AWG wire can be connected between the grounding lug on the chassis and a nearby building ground point.

### Connecting to the Primary Power Source

To attach the 7520 switch to a power source, do the following:

- 1 Connect the AC power cord to the AC power input socket on the power supply and an AC power outlet.
- 2 For DC powered supplies, verify that the DC circuit is de-energized and then do the following:
  - a Identify the grounding stud on the DC power supply. The grounding stud is next to the DC input connector, identified by the international symbol for earth ground.
  - b Using the nut and washer provided, connect the ring terminal end of the ground wire to the grounding stud on the DC power supply. Use green and yellow stranded copper wire, sized at least 14 AWG.
  - c Connect the other end of the ground wire to a reliable earth ground.
  - d Connect the DC power input cables to the DC input connector provided.

Use copper wires rated for at least 60°C and sized between 14 AWG and 8 AWG.

- e Energize the circuit.
- 3 When power is connected, verify that the switch's PWR LED turns green. If the PWR LED does not turn green, refer to the *Extreme 7520 Hardware Installation Guide* for troubleshooting information.

## 5 Update and Configure the Switch

Upgrade to a generally available (GA) version of the software before you use this unit. Switch Engine is the default operating system (OS) for the 7520 Series. You can change the switch OS from the Bootloader Menu on initial activation only. See the *Extreme 7520 Hardware Installation Guide* for all OS selection and upgrade procedures.

To change the switch OS via the Bootloader Menu:

- 1 Connect the switch to a console with a baudrate of 115200.
- 2 When the switch is powered or reset, press the **spacebar** key within 30 seconds after seeing the "7520 Boot Menu" screen to activate the Bootloader Menu.
- 3 Use the **down-arrow** key to select **Change the switch OS to Fabric Engine**, then press **Enter**.
- 4 The switch will install Fabric Engine, then reset.

### Safety Notices



**Caution! Shock hazard!**  
Disconnect all power inputs before servicing.



**Electrical Hazard:** Only qualified instructed or skilled personnel should perform installation, repair, or disassembly procedures.  
**Risques d'électrocution:** Seul un personnel qualifié ou expérimenté peut effectuer les procédures d'installation, de réparation ou de démontage.



**Warning:** Extreme Networks power supplies do not have switches for turning the unit on and off. Before servicing, disconnect all power cords to remove power from the device. Make sure that these connections are easily accessible.  
**Avvertimento:** Les alimentations d'Extreme Networks n'ont pas d'interrupteurs pour allumer ou éteindre l'appareil. Avant l'entretien, débranchez tous les cordons d'alimentation pour couper l'alimentation de l'appareil. Assurez-vous que ces connexions sont facilement accessibles.



**Warning:** This equipment is designed for installation in restricted access locations and suitable for installation in Information Technology Rooms in accordance with Article 645 of the National Electrical Code and NFPA 75, not suitable for use in locations where children are likely to be present.  
**Avvertimento:** Cet équipement est conçu pour être installé dans des endroits à accès restreint et peut être installé dans des salles informatiques conformément à l'article 645 du Code national de l'électricité et à la norme NFPA 75, et ne peut être installé dans des endroits où des enfants sont susceptibles d'être présents.



**Warning:** A dedicated Listed circuit breaker rated at 15A is to be used for each power supply connection.  
**Avvertimento:** Un disjoncteur certifié 15A et dédié à l'installation doit être utilisé pour chaque connexion d'alimentation.



**Caution:** Before mounting the device, ensure that the rack can support it without compromising stability. Otherwise, personal injury or equipment damage may result.



**Caution:** Follow appropriate ESD procedures when unpacking and handling the switch. These include unpacking the switch in an ESD-safe environment and wearing appropriate ESD protective gear, such as ESD-safe footwear and ESD wrist straps where appropriate.



**Caution:** Use of controls or adjustments or performance of procedures other than those specified herein may result in hazardous radiation exposure.



**Warning:** Do not use optical instruments to view the laser output. The use of optical instruments to view laser output increases eye hazard. Use only UL/CSA, IEC/EN60825-1/-2 recognized pluggable modules.

**Avvertimento:** Ne pas utiliser d'instruments optiques pour mesurer la puissance laser. L'utilisation d'instruments optiques pour mesurer la puissance laser peut augmenter les risques de dommages oculaires. Utilisez uniquement des modules certifiés UL/CSA, IEC/EN60825-1/-2.

## Hardware Components

Figure 1 Front Panels for 7520 Series Switches

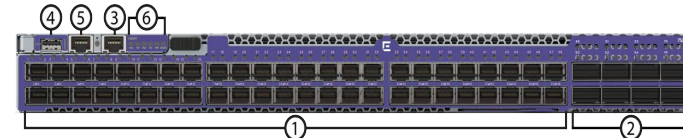

7520-48Y-8C

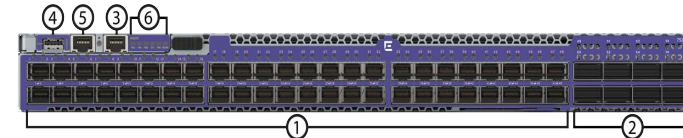

7520-48YE-8CE

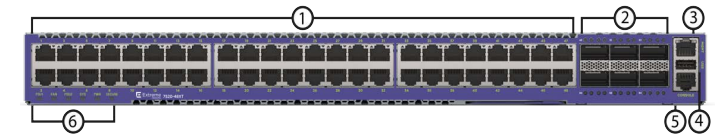

7520-48XT-6C

- 1 1/10/25G SFP28 ports for 7520-48Y; 10/25Gbps SFP28 MACsec capable ports for 7520-48YE-8CE; 1G/10GBase-T RJ-45 ports for 7520-48XT
- 2 40/100Gbps QSFP28 ports (MACsec capable on 7520-48YE only)
- 3 Management port
- 4 USB port
- 5 Console port
- 6 System LEDs

Figure 2 Rear Panel for 7520 Series Switches

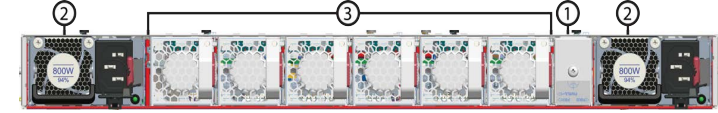

- 1 Grounding lug
- 2 Power supply modules
- 3 Fan modules

For component details, see the *Extreme 7520 Hardware Installation Guide*.

## Operating Conditions

### Operating Temperature:

7520-48Y-8C, 7520-48YE-8CE, and 7520-48XT-6C, AC/DC, front-to-back:

0°C (32°F) to 50°C (122°F) at sea level; 0°C (32°F) to 40°C (104°F) up to 3000 m (10,000 ft)

7520-48Y-8C, 7520-48YE-8CE, and 7520-48XT-6C, AC/DC, back-to-front:

0°C (32°F) to 45°C (113°F) at sea level; 0°C (32°F) to 40°C (104°F) up to 3000 m (10,000 ft)

### Storage Temperature:

-40°C to 70°C (-40°F to 158°F)

### Operating Relative Humidity:

5% to 95% (non-condensing)

## Interfaces

Each Extreme 7520 switch has an RJ-45 serial console port, a 10/100/1000BASE-T out-of-band management port, and a USB Type A storage port. A four-post rack mount kit (part no. XN-4P-RKMT298) is provided with each switch. 7520 factory switches are pre-loaded with both Switch Engine and Fabric Engine OSs.

The following table lists the specific interfaces for each switch.

7520-48Y-8C (base)	48 1/10/25Gbps SFP28 ports, 8 40/100Gbps QSFP28 ports, 2 empty power supply slots, 6 empty fan slots.
7520-48Y-8C-AC-F	48 1/10/25Gbps SFP28 ports, 8 40/100Gbps QSFP28 ports, dual AC power supplies, 6 fan units, front-to-back airflow.
7520-48Y-8C-AC-R	48 1/10/25Gbps SFP28 ports, 8 40/100Gbps QSFP28 ports, dual AC power supplies, 6 fan units, back-to-front airflow.
7520-48YE-8CE (base)	48 10/25Gbps SFP28 MACsec capable ports, 8 40/100Gbps QSFP28 MACsec capable ports, 2 empty power supply slots, 6 empty fan slots.
7520-48YE-8CE-AC-F	48 10/25Gbps SFP28 MACsec capable ports, 8 40/100Gbps QSFP28 MACsec capable ports, dual AC power supplies, 6 fan units, front-to-back airflow.
7520-48YE-8CE-AC-R	48 10/25Gbps SFP28 MACsec capable ports, 8 40/100Gbps QSFP28 MACsec capable ports, dual AC power supplies, 6 fan units, back-to-front airflow.
7520-48XT-6C (base)	48 1G/10GBase-T ports, 6 40/100Gbps QSFP28 ports, 2 empty power supply slots, 6 empty fan slots.
7520-48XT-6C-AC-F	48 1G/10GBase-T ports, 6 40/100Gbps QSFP28 ports, dual AC power supplies, 6 fan units, front-to-back airflow.
7520-48XT-6C-AC-R	48 1G/10GBase-T ports, 6 40/100Gbps QSFP28 ports, dual AC power supplies, 6 fan units, back-to-front airflow.

## Power Specifications

All models	AC Input: 100-120/200-240 VAC, 50/60 Hz, 3.5/1.8 A Max. for each PSU DC Input -48 VDC, 7.5 A Max. for each PSU (Except for China / 除中国地区)
------------	----------------------------------------------------------------------------------------------------------------------------------------------

## Power Supply and Fan Options

XN-ACPWR-800W-F	800W AC power supply, Front-to-Back airflow
XN-ACPWR-800W-R	800W AC power supply, Back-to-Front airflow
XN-DCPWR-800W-F	800W DC power supply, Front-to-Back airflow
XN-DCPWR-800W-R	800W DC power supply, Back-to-Front airflow
XN-FAN-001-F	Fan unit, Front-to-Back airflow
XN-FAN-001-R	Fan unit, Back-to-Front airflow

### Available Rack-Mount Kits

XN-2P-RKMT299	Two-post rack mount kit for 7520 switches
XN-4P-RKMT298	Four-post rack mount kit for 7520-48Y and 7520-48XT switches (included)
XN-4P-RKMT302	Four-post rack mount kit for the 7520-48YE-8CE switch (included)

### Getting Help

For additional support related to 7520 switches or this document, contact Extreme Networks using one of the following methods:

<b>Product Documentation</b>	<a href="https://www.extremenetworks.com/documentation/">https://www.extremenetworks.com/documentation/</a>
<b>Global Technical Assistance Center (GTAC)</b>	Phone: 1-800-998-2408 (toll-free in U.S. and Canada) or +1-408-579-2826. For the support phone number in your country, visit: <a href="http://www.extremenetworks.com/support/contact/">http://www.extremenetworks.com/support/contact/</a>
<b>GTAC Knowledge</b>	Get on-demand and tested resolutions from the GTAC Knowledgebase, or create a help case if you need more guidance. Visit: <a href="https://gtacknowledge.extremenetworks.com/">https://gtacknowledge.extremenetworks.com/</a>
<b>The Hub</b>	A forum for Extreme customers to connect with one another, get questions answered, share ideas and feedback, and get problems solved. The community is monitored by Extreme Networks employees, but is not intended to replace specific guidance from GTAC. Visit: <a href="https://community.extremenetworks.com">https://community.extremenetworks.com</a>
<b>Support Portal</b>	Manage cases, downloads, service contracts, product licensing, and training and certifications. Visit: <a href="http://support.extremenetworks.com/">http://support.extremenetworks.com/</a>

## Notice

Copyright © 2023 Extreme Networks, Inc. All Rights Reserved.

### Legal Notices

Extreme Networks, Inc. reserves the right to make changes in specifications and other information contained in this document and its website without prior notice. The reader should in all cases consult representatives of Extreme Networks to determine whether any such changes have been made.

The hardware, firmware, software or any specifications described or referred to in this document are subject to change without notice.

### Trademarks

Extreme Networks and the Extreme Networks logo are trademarks or registered trademarks of Extreme Networks, Inc. in the United States and/or other countries.

All other names (including any product names) mentioned in this document are the property of their respective owners and may be trademarks or registered trademarks of their respective companies/owners.

For additional information on Extreme Networks trademarks, please see: [www.extremenetworks.com/company/legal/trademarks/](http://www.extremenetworks.com/company/legal/trademarks/)

### Warranty

Warranty information for 7520 switches is located online at: [www.extremenetworks.com/support/policies/](http://www.extremenetworks.com/support/policies/)

## Regulatory and Compliance Information

### Federal Communications Commission (FCC) Notice

This device complies with Part 15 of the FCC rules. Operation is subject to the following two conditions: (1) this device may not cause harmful interference, and (2) this device must accept any interference received, including interference that may cause undesired operation.

**NOTE:** This equipment has been tested and found to comply with the limits for a class A digital device, pursuant to Part 15 of the FCC rules. These limits are designed to provide reasonable protection against harmful interference when the equipment is operated in a commercial environment. This equipment uses, generates, and can radiate radio frequency energy and if not installed in accordance with the operator's manual, may cause harmful interference to radio communications. Operation of this equipment in a residential area is likely to cause interference in which case the user will be required to correct the interference at his own expense.

**WARNING:** Changes or modifications made to this device which are not expressly approved by the party responsible for compliance could void the user's authority to operate the equipment.

### Industry Canada Notice CAN ICES-3 (A)/NMB-3(A)

This digital apparatus does not exceed the class A limits for radio noise emissions from digital apparatus set out in the Radio Interference Regulations of the Canadian Department of Communications.

Le présent appareil numérique n'émet pas de bruits radioélectriques dépassant les limites applicables aux appareils numériques de la class A prescrites dans le Règlement sur le brouillage radioélectrique édicté par le ministère des Communications du Canada.

### Class A ITE Notice

**WARNING:** This equipment is compliant with Class A of CISPR 32. In a residential environment this equipment may cause radio interference.

### Product Safety

This product complies with the following international safety standards:

- UL 62368-1
- UL 60950-1
- CAN/CSA C22.2 No. 62368-1-14
- CAN/CSA C22.2 No. 60950-1-07
- IEC 62368-1
- IEC 60950-1
- EN 62368-1
- EN 60950-1
- 2014/35/EU
- CNS 15598-1
- GB 4943.1

### Optical Module Compliance

Extreme Networks pluggable optical modules and direct-attach cables meet the following regulatory requirements:

- UL and/or CSA registered component for North America
- Class 1 or Class 1M Laser Product
- FCC 21 CFR Chapter 1, Sub-chapter J in accordance with FDA & CDRH requirements
- IEC/EN 60825-1:2007, IEC/EN 60825-2:2004+A1+A2 or later, European Standard

### Korea EMC Statement

이 기기는 업무용 환경에서 사용할 목적으로 적

합성평가를 받은 기기로서 가정용 환경에서 사

용하는 경우 전파간섭의 우려가 있습니다.

### Australia (RCM)

**WARNING:** This equipment is compliant with Class A of CISPR 32. In a residential environment this equipment may cause radio interference.

### Electromagnetic Compatibility (EMC)

This product complies with the following: FCC 47 CFR Part 15 Subpart B Class A (US), ICES-003 (Canada), EN 55032 (ITE Emissions), EN 55035 (ITE Immunity), EN 61000-3-2 (Harmonics), EN 61000-3-3 (Flicker), 2014/30/EU (EMC Directive), EN 300 386 (Telecom), EN 55011 (ISM), EN 61000-6-2 (Ind. Immunity), EN 61000-6-4 (Ind. Emissions), RCM (Australia), VCCI (Japan), MSIP KCC (Korea), BSMI (Taiwan), ANATEL (Brazil), TEC (India), CQC (China)

### VCCI Notice

This is a Class A product based on the standard of the Voluntary Control Council for Interference by Information Technology Equipment (VCCI). If this equipment is used in a domestic environment, radio disturbance may arise. When such trouble occurs, the user may be required to take corrective actions.

<p>この装置は、クラスA機器です。この装置を住宅環境で使用すると電波妨害を引き起こすことがあります。この場合には使用者が適切な対策を講ずるよう要求されることがあります。</p>	<p>VCCI – A</p>
-------------------------------------------------------------------------------------------	-----------------

### BSMI EMC Statement – Taiwan

This is a Class A product. In a domestic environment this product may cause radio interference in which case the user may be required to take adequate measures.

Taiwan BSMI 報關義務人

申請人: 愛爾蘭商極進網絡技術行動有限公司台灣分公司

地址: 臺北市松山區南京東路 4 段 126 號 5 樓

警告:為避免電磁干擾, 本產品

不應安裝或使用於住宅環境。

警告：在居住环境中, 运行此设

备可能会造成无线电干扰。

### Battery Warning- Taiwan

警告

如果更換不正確之電池型式會有爆炸的風險，

請依製造商說明書處理用過之電池。

### Battery Notice

**Warning:** This product contains a battery used to maintain product information. If the battery should need replacement it must be replaced by Service Personnel. Please contact Technical Support for assistance.

Risk of explosion if battery is replaced by an incorrect type. Dispose of expended battery in accordance with local disposal regulations. **Avertissement:** Ce produit renferme une pile servant à conserver les renseignements sur le produit. Le cas échéant, faites remplacer la pile par le personnel du service de réparation. Veuillez communiquer avec l'assistance technique pour du soutien.

Il y a risque d'explosion si la pile est remplacée par un type de pile incorrect. Éliminez les piles usées en conformité aux règlements locaux d'élimination des piles.

### Hazardous Substances- China and Taiwan BSMI RoHS

Guidance concerning the China and Taiwan BSMI RoHS (Restriction of Hazardous Substances) directive for this Extreme Networks® product can be found on the following web page:

[www.extremenetworks.com/support/documentation/restriction-hazardous-substances/](http://www.extremenetworks.com/support/documentation/restriction-hazardous-substances/)

The page contains tables detailing the presence of 10 substances defined by the RoHS directive.

### Hazardous Substances - EU

This product complies with the requirements of Directive 2011/65/EU of the European Parliament and of the Council of 8 June 2011 on the restriction of the use of certain hazardous substances in electrical and electronic equipment.

### European Waste Electrical and Electronic Equipment (WEEE) Notice



In accordance with Directive 2012/19/EU of the European Parliament on waste electrical and electronic equipment (WEEE):

- 1** The symbol above indicates that separate collection of electrical and electronic equipment is required.
- 2** When this product has reached the end of its serviceable life, it cannot be disposed of as unsorted municipal waste. It must be collected and treated separately.
- 3** It has been determined by the European Parliament that there are potential negative effects on the environment and human health as a result of the presence of hazardous substances in electrical and electronic equipment.
- 4** It is the users' responsibility to utilize the available collection system to ensure WEEE is properly treated.

For information about the available collection system, please contact Extreme Customer Support at +353 61 705500 (Ireland).

### Read Me First - Switch OS Selection

Scan for instructions to choose your preferred switch OS on the Universal Switch.



P/N 9037254-00 Rev. AF

