

# JOHNSON Components™



108-0750-001



108-0754-001



108-0753-001

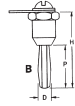

## STANDARD BANANA PLUGS

This group of standard banana plugs has accurately machined brass studs which extend the full length of the plugs, providing extra strength. Springs are nickel-silver-highly resistant to corrosion. Bodies and hardware .0001 nickel-plated.

Cat. No.	Dwg.	S	P	D	H	Thread	Net Price
108-0750-001	A	3/8"	17/32"	.175"	1 1/8"	6-32	\$3.05
108-0750-002	A	3/4"	17/32"	.175"	1 1/2"	6-32	3.39
108-0753-001	B	—	17/32"	.175"	1 5/16"	6-32	2.55

This banana plug is similar to the standard types listed above, except that it is designed for riveting. Springs are beryllium copper, cadmium-plated.

108-0754-001	C	1/32"	1 3/32"	.155"	1 3/16"	—	2.14
--------------	---	-------	---------	-------	---------	---	------



108-0740-001



## STANDARD BANANA JACKS

High quality, machined brass banana jack. Nickel-plated. Furnished complete with solder terminal and nut.

Cat. No.	F	D	S	H	Hole Dia.	Thread	Net Price
108-0740-001	3/8"	1/4"	17/32"	5/8"	.166"	1/4"-28	\$2.80
108-0740-102	3/8"	1/4"	1 3/32"	5/8"	1/16"	1/4"-32	3.84



108-0752-001

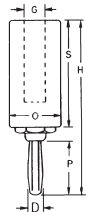

## STANDARD INSULATED BANANA PLUGS

These standard insulated banana plugs are equipped with plastic handles, brass nickel-plated bodies, and nickel-silver springs. The 108-0752-001 has a black plastic handle-the 108-0752-002, red.

Cat. No.	S	P	D	H	G	O	Net Price
----------	---	---	---	---	---	---	-----------

### STANDARD INSULATED BANANA PLUGS

108-0752-001	1 3/8"	1 7/32"	.175"	2 1/8"	7/32"	7/16"	\$3.66
108-0752-002	1 3/8"	1 7/32"	.175"	2 1/8"	7/32"	7/16"	3.66



108-0300-001

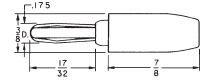

## SOLDERLESS BANANA PLUGS

Compact, high voltage insulated plug for a wide variety of applications. Designed for fast, solderless connection of up to 16 gauge stranded wire. Body and pin are constructed of one-piece nickel-plated brass with high grade nickel-silver springs. Sleeve is molded. Current rating: 15 amps.

Cat. No.	Colour	Net Price
108-0301-001	White	\$2.36
108-0302-001	Red	2.36
108-0303-001	Black	2.36
108-0304-001	Green	2.36
108-0307-001	Yellow	2.36
108-0310-001	Blue	2.36

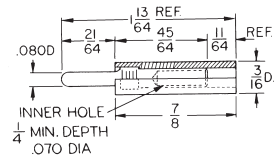

## INSULATED SMALL HANDLE TIP PLUG

For standard tip jack, .080" dia. Brass body, nickel plated. Nylon insulated handle. Solder type connection. Current: 10 amps. Contact resistance: 0.010 ohms max.

Cat. No.	Colour	Net Price
105-0771-001	White	\$2.03
105-0772-001	Red	2.03
105-0773-001	Black	2.03

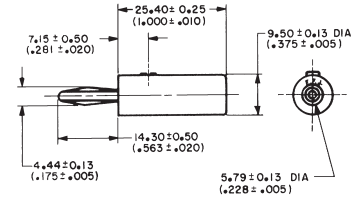
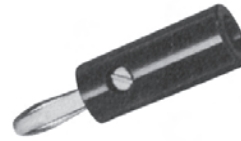

## SOLDERLESS BANANA PLUG WITH SIDE SET SCREW

Set screw provides dependable connection for low voltage applications. Quickly makes terminations with up to 16 gauge wire. Nickel silver spring with nickel plated brass body. Current rating: 15 amps. Breakdown voltage: 50 VDC. Contact resistance: 0.010 ohms max.

Cat. No.	Colour	Net Price
108-1702-101	Red	\$3.64
108-1703-101	Black	3.64

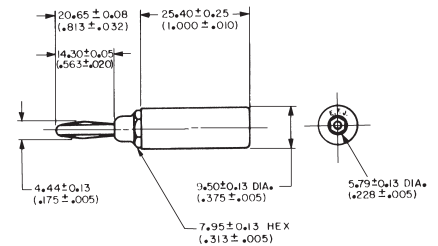

## SOLDER STUD HEX BODY BANANA PLUG

Versatile plug offers two assembly methods. Solder wire to tin plated stud or make solderless connection by feeding wire through stud flaring strands and screw stud into body. Solder stud accepts up to 16 gauge wire. Nickel silver spring with nickel plated brass body. Current rating: 15 amps. Breakdown voltage: 5000 VDC. Contact resistance: 0.010 ohms max.

Cat. No.	Colour	Net Price
108-1762-101	Red	\$3.83
108-1763-101	Black	3.83

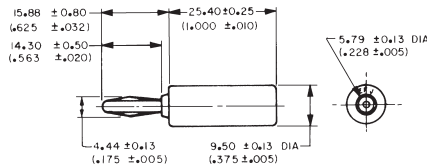

## SOLDER STUD ROUND BODY BANANA PLUG

Versatile plug design offers two assembly methods. Solder wire to tin plated stud or make solderless connection by feeding wire through stud, flaring strands, and screwing stud into body. Solder stud accepts up to 16 gauge wire. Nickel silver spring with nickel plated brass body. Current rating: 15 amps. Breakdown voltage: 5000 VDC. Contact resistance: 0.010 ohms max.

Cat. No.	Colour	Net Price
108-1722-101	Red	\$4.58
108-1723-101	Black	4.58

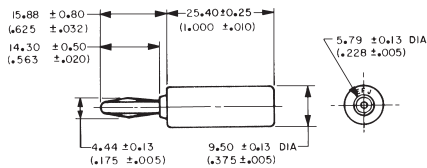

## SOLDERLESS ROUND BODY BANANA PLUG

Plug design gives dependable service with functional 1 inch handle. Wire passes through plug, wraps around neck of plug and locks in place by screwing handle on to body for solderless connection. Use up to 16 gauge wire with plug. Nickel silver spring with nickel plated brass body. Current rating: 15 amps. Breakdown voltage: 5000 VDC. Contact resistance: 0.010 ohms max.

Cat. No.	Colour	Net Price
108-1722-103	Red	\$3.48
108-1723-103	Black	3.48

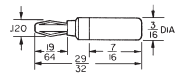

108-1000-001

## MINIATURE BANANA PLUGS

Extremely small insulated banana plugs with precision machined phosphor bronze body, nickel-plated. One-piece springs are beryllium copper, nickel plated, .120" dia., Polyamide sleeve. Current rating: 15 amps.

Cat. No.	Colour	Net Price
108-1002-001	Red	\$3.48
108-1003-001	Black	3.48

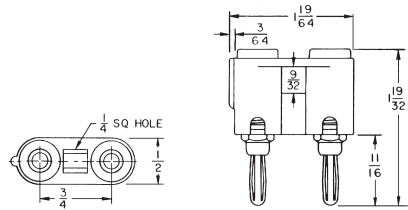

## DUAL BANANA PLUGS

Extremely versatile dual banana plug available for either solderless or set screw connection. Molded body incorporates polarity indication and strain relief hole for wire leads. Springs are high quality nickel-silver—bodies are nickel plated. Accurately machined brass studs extend full length of pins for extra strength. Voltage breakdown: 10,000 VDC. Capacity plug to plug: 1.3 pf. Current rating: 15 amps.

Cat. No.	Colour	Net Price
<b>WITH SET SCREWS</b>		
108-0252-001	Red	\$12.42
108-0253-001	Black	12.42

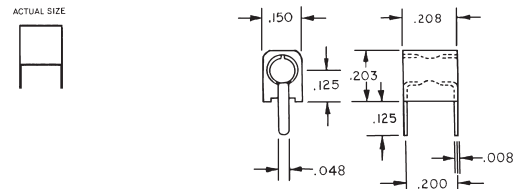

## MINIATURE HORIZONTAL TEST JACK

Compact size fits into today's high density circuit board designs. Probe access from both ends. Contact: Copper aluminum alloy. Finish: Nickel silver. Body: Nylon per MIL-M-20693A. Current: rating: 5 amps. Breakdown voltage: 3000 VDC min. Contact resistance: 0.010 ohms max. Adjacent jack C: 1pF maximum at 1 MHz. Accepts 0.080" dia. tip plug in either end.

Cat. No.	Colour	Net Price
105-1102-001	Red	\$.96
105-1103-001	Black	.96

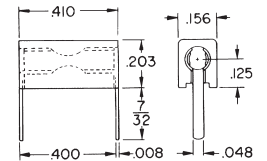
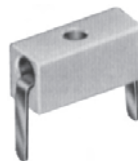

## HORIZONTAL TEST JACK

Unique design accepts .080" dia. tip plug in either end, or from top or bottom. Available in silver-plated and iridized beryllium copper formed contacts or gold-plated beryllium contacts. Two common terminals. Current rating 5 amps, breakdown voltage 3000 volts D.C., nylon insulated.

## HORIZONTAL JACK

Cat. No.	Colour	Net Price
<b>SILVER-PLATED CONTACTS</b>		
105-0751-001	White	\$.86
105-0752-001	Red	.86
105-0753-001	Black	.86
105-0754-001	Green	.86
105-0757-001	Yellow	.86
105-0760-001	Blue	.86

Mounts in two .54 ± .002" holes on .400 ± .005" centres.

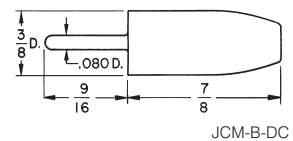

## SOLDERLESS TIP PLUG

Completely insulated, molded sleeve. Recessed metal head prevents exposure of metal surfaces when engaged in any standard tip jack. All metal parts are nickel-plated brass. Designed for solderless connection of up to 16 gauge stranded wire. Fits all standard tip jacks. Current rating: 10 amps.

Cat. No.	Colour	Net Price
105-0301-001	White	\$1.75
105-0302-001	Red	1.75
105-0303-001	Black	1.75
105-0304-001	Green	1.75
105-0307-001	Yellow	.99

## KINGS TRUE 75 OHM BNC CONNECTORS

BNC 75 ohm connectors are BNC connectors with a reduced dielectric and reduced O.D. or centre contacts to achieve 75 ohms. They will mate with 50 ohm BNC connectors with no damage. All the connectors in this group have captive centre contacts. The same crimp tool is used for both the 50 and 75 ohm connectors. All BNC connectors listed, except where noted, are recognized under the Component Program of Underwriters Laboratories, Inc. Voltage rating: 500 volts rms. Frequency range: 0-2 GHz. **ENVIRONMENTAL:** Vibration: MIL-STD-202 Method 204, Test Cond. B. Shock: MIL-STD-202 Method 213, Test Cond. B. Corrosion (salt spray): MIL-STD-202 Method 101, Test Cond. B. Moisture resistance: MIL-STD-202 Method 106. Temperature range: PTFE insulators: -85° to 329°F (-65°C to +165°C). **MATERIAL:** Bodies and Fittings: Brass, ASTM-B-16. **FINISHES:** Gold plated over copper. Bodies and Fittings: Tarnish resistant alloy electrodeposit finish.



### 75 OHM BNC PLUGS

Cat. No.	Use With Belden Cable	Dimensions (mm)		Crimp Die	Net Price
		A	B		
2065-1-9	8279, 8279A, 9209, 9209A, 9244, 82241, 88241	27.9	14.2	KTH-2261	\$5.34
2065-11-9	1164A, 1164B, 1167B, 1263A, 1406B, 1407B, 1417, 1818B, 1865A, 8218	25.1	14.2	KTH-2025	4.74
2065-2-9	1426A, 1505A, 8212, 8241F, 9100, 9110, 9165, 9171, 9240, 9259, 9265, 9274, 9275, 9659	27.9	14.2	KTH-2261	4.87
2065-15-9	2881, 9141, 8281B, 88281, 8281F	27.9	14.5	KTH-2119	3.23
2065-7-9	8241, 8241A	27.9	14.2	KTH-2261	5.07
2065-10-9	9248, 1694A	27.9	14.5	KTH-2250	4.87

**Note:** For crimp dies shown in table above, use KTH-1000 crimp tool shown in Kings connector section.



2029-20-9

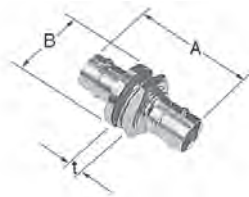

2029-9-9  
2029-15-9  
2029-16-9



MOUNTING HOLE FOR 2029-9-9

### 75 OHM ADAPTERS WITHIN SERIES

Cat. No.	Adapter Ends	Dimensions (mm)			Net Price
		A	B	t	
<b>BULKHEAD</b>					
2029-9-9	Jack-Jack	32.5	17.5	4.0	\$45.68
2029-15-9	Jack-Jack	32.5	—	—	33.56
2029-16-9	Jack-Plug-Jack	32.5	26.9	—	33.56
<b>RIGHT ANGLE</b>					
2029-20-9	Jack-Plug	22.2	22.9	—	67.11

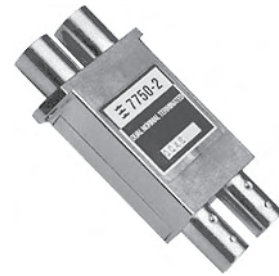

7750 SERIES STANDARD SIZE DUAL VIDEO JACKS

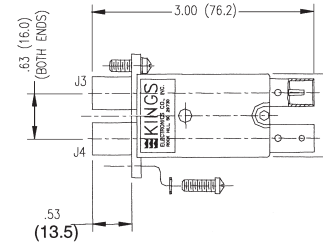

SCHEMATICS

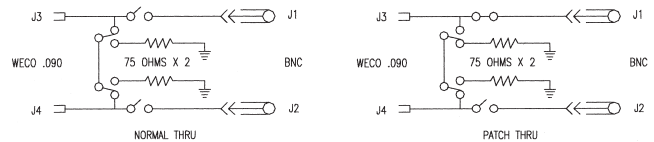

P/N 7750-2 AND 7750-5  
DUAL NORMAL TERMINATED  
(INTERNALLY WITH RESISTOR 75 OHMS +/-5%)

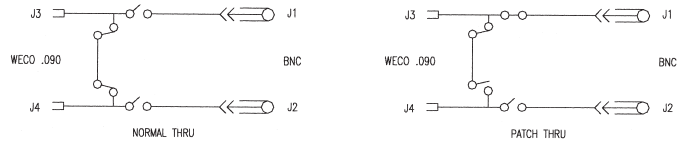

P/N 7750-3 AND 7750-6  
DUAL NORMAL UNTERMINATED



P/N 7750-4 AND 7750-7  
DUAL FEED THRU MODE

## KINGS 7780 SERIES HIGH FREQUENCY (4.3 GHz PLUS) STANDARD SIZE DUAL VIDEO JACKS

Kings high definition 7780 series of video jacks have been designed to meet SMPTE 292 requirements and include the same proven reliability of its predecessors, the 7500 series and the high frequency 7730 series video jacks. Kings 7780 series of video jacks mate with standard size (.37 diameter) patch plugs with W.E. .090" centre pins. Mechanical life: 30,000 cycles min. Temperature range: -40°C to +85°C. **MATERIAL:** Contacts: beryllium copper, gold plated. Housing finish: nickel plate.

Cat. No.	Description	Net Price
7780-2	HD Dual normal terminated	\$82.69
7780-3	HD Dual normal	78.06
7780-4	HD Dual feed through	75.01



**KINGS 7785 SERIES STANDARD SIZE  
DUAL VIDEO JACKFIELDS**

Cat. No.	Description	Net Price
7785-6	1 × 24 term	\$1727.90
7785-29	1 × 24 non term	1606.49
7785-7	1 × 26 term	1821.31
7785-31	1 × 26 non term	1737.25
7785-41	1.5 × 24 term	1825.75
7785-40	1.5 × 28 term	2087.35
7785-8	2 × 24 term	1457.04
7785-32	2 × 24 non term	1376.98
7785-4	2 × 26 term	1457.04
7785-30	2 × 26 non term	1457.04



**KINGS 7575 SERIES STANDARD SIZE  
SINGLE VIDEO JACKFIELDS**

Cat. No.	Description	Net Price
7575-46	1.5 × 28 term	\$2087.35
7575-15	2 × 24 term	1457.04



7510-4  
7510-5  
7510-7  
7510-16

7510-5

7510-7

**KINGS 7510 SERIES STANDARD SIZE PATCH,  
ADAPTER AND TERMINATION PLUGS**

Cat. No.	Configuration	Cable Type	Pin Size	Net Price
7510-1	Patch plug, cable entry	RG-59/U	.090"	\$51.04
7510-2	Patch plug, cable entry	Belden 9259	.090"	33.62
7510-4	Patch plug, cable entry	Belden 8281	.090"	54.30
7510-16	Patch plug, cable entry	Belden 1694A	.090"	54.30
7510-5	Patch plug to BNC adapter	—	—	94.93
7510-7	Patch plug termination	—	—	49.10



7520-9

7520-10

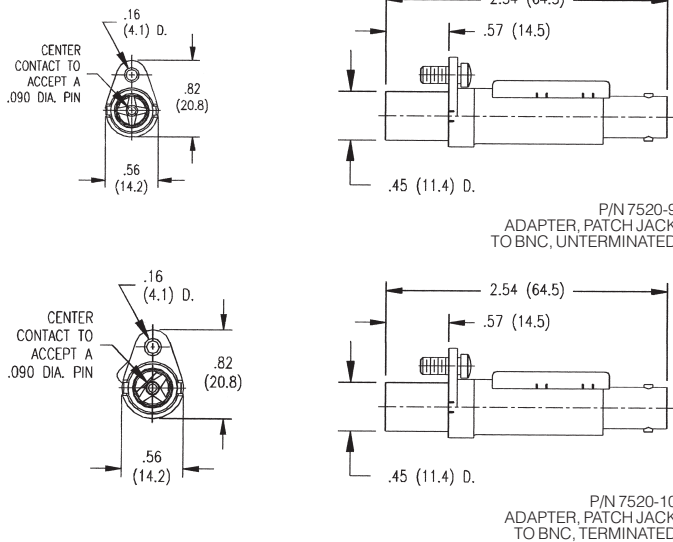

**KINGS 7520 SERIES STANDARD  
SIZE SINGLE VIDEO JACKS**

Kings high performance 7520 series jacks are ideal for use from analog through HDTV formats. These single video jacks mate with standard size (.37" diameter) patch plugs with WE .090" centre pins. The single video jacks provide a feed-through and/or terminated signal path between the BNC input/output connector and the patch jack. Impedance: 75 ohm. Mechanical life: 30,000 mating min. Temperature range: -40°C to +85°C. **MATERIAL:** Contacts: beryllium copper, gold plated. Housing finish: nickel plate.

Cat. No.	Description	Net Price
7520-9	Patch jack to BNC, non term	\$35.22
7520-10	Patch jack to BNC, term	51.64

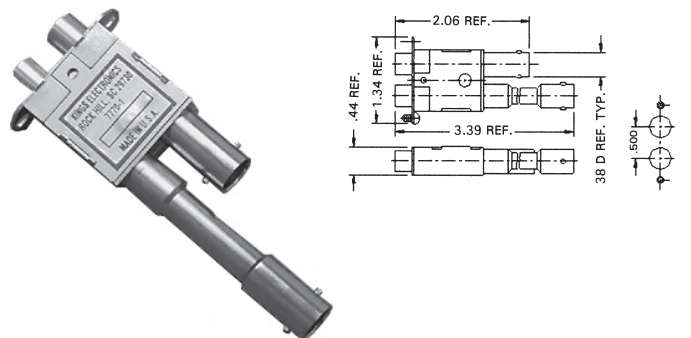

**KINGS 7790 SERIES HIGH DEFINITION (3GHZ)  
MID SIZE DUAL VIDEO JACKS**

Kings high definition mid size 7790 series of video jacks have been designed to exceed SMPTE 292 requirements and include the same proven reliability of its predecessor, the 7400 series. The mid size video jack P/N 7790-1 is self-normal and self-terminating. Return loss: -20 dB to 3 GHz, through -15 dB to 3 GHz, patched. Impedance: 75 ohms. Mechanical life: 30,000 cycles min. Temperature range: -65°C to +125°C. **MATERIAL:** Contacts: beryllium copper, gold plated. Housing finish: TR-5®.

Cat. No.	Description	Net Price
7790-1	Dual normal terminated	\$61.42
7790-3	Dual normal unterminated	53.57
7790-4	Dual feel thru mode	53.51



Metal body RCA plug. Maximum cable 7.5mm ø.

Cat. No.	Net Price Per 100
<b>24-100-0</b>	<b>\$65.00</b>



Metal plug with strain relief. Maximum cable 6.0mm ø.

Cat. No.	Net Price Per 100
<b>24-104-0</b>	<b>\$72.00</b>



Coloured plastic with strain relief. Maximum cable 4.5mm ø.

Cat. No.	Net Price Per 100
<b>24-111-0</b>	<b>\$21.67</b>



Black plastic right angle RCA plug. Max. cable 5.1 mm.

Cat. No.	Net Price Per 100
<b>24-114-0</b>	<b>\$46.67</b>



Crimp RCA plug for RG59/U.

Cat. No.	Net Price Per 100
<b>24-116-0</b>	<b>\$57.00</b>



Gold plated plug with spring strain relief. 5.5mmø cable.

Cat. No.	Net Price Per 100
<b>24-120-0</b>	<b>\$108.00</b>



Colour coded gold plated RCA plugs. Max. cable 5.0mm ø.

Cat. No.	Colour	Net Price Per 100
<b>24-121-0</b>	Black	<b>\$83.00</b>
<b>24-122-0</b>	Red	<b>\$83.00</b>



Colour coded gold plated RCA plugs. Max. cable 6.0mm ø.

Cat. No.	Colour	Net Price Per 100
<b>24-124-0</b>	Black	<b>\$113.00</b>
<b>24-125-0</b>	Red	<b>113.00</b>



Metal inline RCA jack. Maximum cable 7.5mm ø.

Cat. No.	Net Price Per 100
<b>24-150-0</b>	<b>\$67.00</b>



Gold plated colour coded inline jacks. Max. cable 5.0 ø.

Cat. No.	Colour	Net Price Per 100
<b>24-161-0</b>	Black	<b>\$93.00</b>



Panel mount RCA jack. Mounting hole 6mm ø.

Cat. No.	Net Price Per 100
<b>24-180-0</b>	<b>\$33.33</b>



Gold plated RCA jack. Mounting hole 6mm ø.

Cat. No.	Net Price Per 100
<b>24-181-0</b>	<b>\$58.00</b>



### PC MOUNT RCA JACK

Cat. No.	Net Price Per 100
<b>24-191-0</b>	<b>\$30.08</b>



2.5mm mono plug .48mm long × 10mm ø. Cable diameter 4.0mm ø.

Cat. No.	Net Price Per 100
<b>24-203-0</b>	<b>\$33.00</b>



23mm long × 8mm ø. Cable diameter 4mm ø.

Cat. No.	Net Price Per 100
<b>24-211-0</b>	<b>\$35.00</b>



2.5mm stereo plug. 22mm long × 8.5mm ø. Cable diameter 4mm ø.

Cat. No.	Net Price Per 100
<b>24-221-0</b>	<b>\$128.00</b>



2.5mm stereo plug. 48mm long × 10mm ø. Cable diameter 4.0mm ø.

Cat. No.	Net Price Per 100
<b>24-223-0</b>	<b>\$88.00</b>

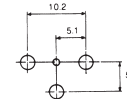

MOUNTING DIMENSIONS

### RIGHT ANGLE PC MOUNT RCA JACK

Cat. No.	Net Price Per 100
<b>24-195-0</b>	<b>\$25.00</b>