

- > Up to 50 PPM
- > Black & White MFP
- > Small/Med. Workgroup
- > Copy, Print, Scan, Fax
- > Secure MFP



Outperforming the competition.

You can't stop progress. In fact, Toshiba is dedicated to finding better ways to hurry it along. Take, for instance, our new e-STUDIO356/456/506 Series for workgroups. We've managed to raise the bar with this series. It's proof that progress sometimes comes in small packages.

Packing a powerful punch

It used to be that large companies utilized large multifunction products and smaller businesses used smaller devices with fewer functions. However, in the past few years, Toshiba has helped change all of that. A prime example is the new e-STUDIO356/456/506 Series. We've managed to include a lot of features that are typically reserved for larger MFPs – like impressive warm up and first copy out times, color scanning, and print speeds of up to 50 pages per minute. There's also walk up printing, simply by plugging in a USB flash drive, and you can fill a paper tray on the fly, without halting operation. Even

bigger features include a full 9" LCD Touch Screen with large, easy-to-read control buttons and an optional total paper capacity of up to 3,200 sheets.

And there's more

In-house document production is bigger and better than ever before, thanks to the e-STUDIO356/456/506 Series. Able to go where larger MFPs would have never been considered, this smaller, more economical series makes document storage, management and production possible. And, the next generation e-BRIDGE open platform allows software solutions to be integrated with Toshiba systems so you can increase productivity and better manage your workflow.



- > 3,200-Sheet Capacity
- > USB Direct Scan & Print
- > Large 9" Touch Screen
- > Add Paper "On the Fly"
- > Compact Footprint
- > Self-Encrypting Drive



- > 36,600 Toner Yield
- > Exceptionally Crisp Output
- > Super G3 Faxing
- > Color Scanning
- > Standard Network Printer



e-STUDIO456 with Saddle-Stitch Finisher

A big step with a small footprint.

You may not know what to expect in today's business environment, but at least you know what to expect from Toshiba. Impressive performance, unparalleled quality, and exceptional features. Not to mention reliability, dependability and versatility. It's all part of our relentless pursuit of leading innovation.

e-STUDIO™ 356/456/506

Everything you wanted

The e-STUDIO356/456/506 Series comes fully loaded with the features and benefits you'd expect from Toshiba. Network printing is standard, along with limitless duplex for two-sided output. Color scanning allows you to capture, manage and store images in full color. Compact service modules reduce down time and costs while a 36,600-page toner yield minimizes the frequency of cartridge replacement. There are several energy-saving and eco-friendly features, as well as heightened security. In case all of that isn't enough, you can choose from a

host of options like walk-up faxing, PC-LAN faxing, and advanced scanning to MS Word, Excel, and Searchable PDF.

From start to finish

Starting with a warm-up time of 20 seconds, a first copy time of 3.7 seconds, and output at 35, 45 or 50 pages per minute, you can rest assured this series will keep up with demand. Reduce or enlarge originals if you'd like, from 25% to 400%. You'll be impressed by the unparalleled image quality of each printed page, at 2400 x 600 dpi. In addition to quality, you'll also appreciate quantity. The standard paper capacity

is 1,100 sheets, and if your workload demands it, you can opt for up to 3,200 sheets. Also, take advantage of the e-STUDIO356/456/506 Series' various new finisher options, including an inner finisher with hole-punch, contributing to an overall smaller footprint.

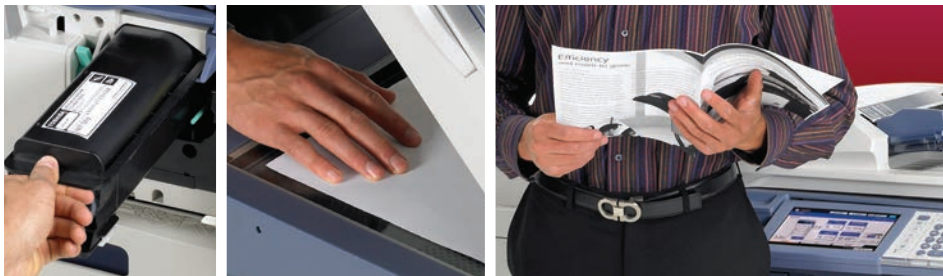

- > 20 Sec. Warm-up Time
- > 3.7 Sec. First Copy Time
- > High-Speed Duplex
- > Change Toner "On the Fly"
- > Multiple Finishing Options



e-STUDIO506 with 2,000-Sheet LCF, Hole Punch, and Saddle-Stitch Finisher.



e-STUDIO456 with 2,000-Sheet LCF, Hole Punch, and 50-Sheet Staple Console Finisher.



e-STUDIO356 with 50-Sheet Inner Finisher and Hole Punch.



e-STUDIO356 with 2,000-Sheet LCF.

Smarter, safer, and greener.

At Toshiba, we work hard to produce MFPs with a level of performance that is unsurpassed. We also realize that is only part of a bigger picture. With security and environmental concerns at an all-time high, as well as the need to manage the workflow more efficiently, we consider those features to be just as important as copy, print, scan, and fax.



Environmental performance

Along with each new series of Toshiba products released, we seek to find new ways of reducing our carbon footprint and yours. The e-STUDIO356/456/506 Series is more environmentally friendly because we've eliminated hazardous substances, reduced paper and toner waste, and continued to participate in new, industry-leading programs and practices like our zero-waste-to-landfill toner recycling. Of course, the e-STUDIO356/456/506 Series is also Energy Star Tier 2 rated.



More secure than ever

The e-STUDIO356/456/506 Series utilizes a new Self Encrypting Drive (SED) technology with 256-bit AES Encryption and Automatic Data Invalidation (ADI) that renders the drive useless if removed. This technology is exclusive to Toshiba. In addition, Data Overwrite is standard and meets the Department of Defense requirements by writing over any data stored on the HDD during document processing. For added security, you can also opt for an IPsec enabler. This encrypts data being sent to or from a device.



The Managed Document Experts

At Toshiba, we've moved far beyond the box. Our people bring innovative, real-world solutions to all your document management needs. We'll help you cut costs, secure your documents and reduce your environmental footprint. And if there's one thing every business and our planet can use right now, it's managing to do more with less.

So call or visit your nearest Toshiba dealer. We'd be happy to show you how the e-STUDIO356/456/506 Series outperforms the competition.



- > Compact Footprint
- > Energy Star Tier 2 Rated
- > Solutions Ready
- > Self Encrypting Drive
- > Data Overwrite





- > Black & White MFP
- > Up to 50 PPM
- > Sml/Med Workgroup
- > Copy, Print, Scan, Fax
- > Secure MFP

Specifications

Copying Process/Type	IEPM (Dry Process)/Laser Technology
Original Reading Method	CCD Line Sensor
Copy/Print Resolution	2400 x 600 dpi (with Smoothing)
Copy/Print Speed	35 / 45 / 50 ppm
Warm-Up Time	Appx. 20 Seconds
First Copy Time	3.7 Seconds
Duty Cycle	125K / 150K / 150K
Multiple Copying	Up to 999 Copies
Standard Paper Supply	2 x 550-Sheet, 100-Sheet Stack Feed Bypass
Maximum Paper Supply	Up to 3,200 Sheets
Acceptable Paper Size	Cassette: Statement-R to Ledger (17-28 lbs.); Bypass: Statement-R to Ledger (17-110 lbs.); LCF: Letter (17-28 lbs.)
Special Paper	Bypass: Envelope, Tab Sheet
Memory	1GB RAM, 160 GB HDD
Reduction/Enlargement	25% to 400%
Bypass Tray	100-Sheet Stack Feed Bypass
Control Panel	9" Wide VGA Color Touch-Screen
Dimensions	Appx. 23" x 23" x 30" (W x D x H)
Weight	Appx. 132 lbs.
Power Supply	115 Volts; 15 Amps
Power Consumption	Maximum 1.5kW
PM Cycle	125K / 150K / 150K
Black Toner Yield	36.6K Impressions @ 6%
Drum Type/Yield	Organic Photoconductor; 125K / 150K / 150K
Developer Yield	125K / 150K / 150K

Print (Standard)

Print Speed	35 / 45 / 50 ppm
PDL Support	PCL6, PostScript3, XPS
Operating Systems	Windows 2000/XP/2003/Vista/2008/7; Mac X OS10.2.4/10.3/10.4/10.5; UNIX, Linux, CUPS
Protocol Support	IPX/SPX, TCP/IP (IPv4/IPv6), EtherTalk, AppleTalk PAP, LPR/LPD, IPP w/Authentication, SMB, Netware
Drivers	Windows 2000/XP/2003/Vista/2008/7; Mac X OS 10.2.4/10.3/10.4/10.5 (OS 10.4 PPD); UNIX, Linux, AS/400, SAP R/3
Connectivity	Ethernet 10/100/1000BaseT, USB 2.0, 802.11b/g Wireless LAN
Device Management	TopAccess
Certification	WHQL, Novell, HPOS (Dazel), Vista Premium

Scan (Standard)

Scan Speed	57 spm LT-Size @ 300 dpi, 45 spm LT-Size @ 600 dpi when copying, 43 spm LT-Size @ 300 dpi (Color Scanning)
Scan Resolution	100 dpi, 150 dpi, 200 dpi, 300 dpi, 400 dpi, 600 dpi
File Format	TIFF, PDF, Slim PDF, JPEG, XPS MS Word, MS Excel, Searchable PDF w/Adv. Scanning option

E-Filing (Standard)

Operation Method	Color Touch Screen Control Panel or Client PC
Number of Boxes	1 Public Box; 200 Private User Boxes
Capacity of Boxes	100 Folder per Box; 400 Documents per Folder; 1000 Pages per Documents

Security (Standard)

Data Encryption	256 Bit AES
HDD Overwrite	Meets Department of Defense (DoD) standard 5220.22M
Authentication	LDAP, SMTP, Windows Server Domain

Facsimile Option

Compatibility	Super G3, G3
Data Compression	MH / MR / MMR / JBIG
Transmission Speed	Appx. 3 Seconds per Page
Fax Modem Speed	33.6 Kbps
Fax Memory	Transmission and Reception 1GB (HDD); Backup Permanent (HDD)
Memory Transmission	100 Jobs, 2,000 Destinations Max; 400 Destinations/Job
Scan Speed	0.7 Seconds per Page; 50 Scans per Minute
Other Fax Functions	Internet Fax; Network Fax

Accessories (Options)

Input Options	
100-Sheet RADF	MR3022
Platen Cover	KA1640PC
Additional Paper Options	
550-Sheet Paper Feed Pedestal	KD1025
2,000-Sheet Large Capacity Feeder	KD1026
550-Sheet Paper Feed Unit	MY1033
Finishing Options	
Job Separator	MJ5006
Work Tray	KK4550
Bridge Kit for Finisher	KN2520
50-Sheet Inner Finisher	MJ1032*
Saddle-Stitch Finisher (high capacity)	MJ1106N
Saddle-Stitch Finisher (low capacity)	MJ1033*
50-Sheet Staple Console Finisher	MJ1101
2 or 3 Hole Punch Unit for MJ1032	MJ6007
2 or 3 Hole Punch Unit for MJ1101 and MJ1106N	MJ6103
2 or 3 Hole Punch Unit for MJ1033	MJ6008
Connectivity/Security Options	
Fax Kit	GD1250NXF
2nd Line Fax	GD1260F
IPSec Enabler	GP1080
Wireless LAN Adapter	GN1050
Antenna	GN3010
Meta Scan Enabler	GS1010
Advanced Scanning	GB1280T
Miscellaneous Options	
SmartCard Reader, HID iClass	ART11236
SmartCard Reader, HID Prox	ART11230
SmartCard Reader, Inditag	ART12161
SmartCard Reader, LEGIC	ART11248
SmartCard Reader, Multi ISO/Mifare	ART11443
SmartCard Reader, Multi 125	ART11242
Card Reader Bracket	6BC02231846
Accessible Arm Handle	KK2550
Harness Kit for Coin Controller	QQ1180

*MJ1032/MJ1033 finishers not compatible with e-STUDIO506 model.



Corporate Office	9740 Irvine Blvd., Irvine, CA 92618 Tel: 949-462-6000
East Coast	959 Route 46 East, 5th Floor, Parsippany, NJ 07054 Tel: 973-3136-2700
Midwest	8770 W. Bryn Mawr Ave., Suite 700, Chicago, IL 60631 Tel: 773-380-6000
South	2037 Bakers Mill Rd., Dacula, GA 30019 Tel: 678-546-9385
West Coast	9740 Irvine Blvd., Irvine, CA 92618 Tel: 949-462-6000
Web Site	www.business.toshiba.com

Designs and Specifications subject to change without notice. For best results and reliable performance, always use supplies manufacturer or designated by Toshiba. Not all options and accessories may be available at the time of product launch. Please contact a local Authorized Toshiba Dealership for Availability. Toner yields are estimates based on 6% coverage, letter-size page. Driver and connectivity feature support varies by client/network operating system.