

# SHARP

Be Original.

PN-UH701

PN-UH601

Commercial LCD Displays

## Capture Their Attention with Engaging Detail



**4K**

3840 × 2160 Pixels



# 4K Ultra-HD Monitors a Far-Reaching Impact

Give your message a big-screen boost with a Sharp commercial LCD display. Whether you choose the 70" Class (69 <sup>43</sup>/<sub>64</sub>" diagonal) or 60" Class (60 <sup>5</sup>/<sub>64</sub>" diagonal) model, the PN-UH701/UH601 displays convey your message with the true-to-life precision of 4K Ultra-HD resolution. Built-in tuner support and business-friendly features are packed into an elegantly slender frame. In settings including hospitality, business and retail, the PN-UH701/601 displays excel at reaching your audience. They'll be more informed, more entertained and more engaged.



## Superb 4K Image Quality

With four times the pixel resolution of full HD, the PN-UH701/UH601 displays bring out all of the color depth, detail and clarity that the content creator intended. With videos and photos displayed at up to 4K Ultra HD, you get to see subtle textures and fine details not visible at full HD resolution. The high pixel count means there's no need to worry about jaggies, even on such a large screen.



## B2B Features for Ultimate Control

Business owners can easily manage the functionality of the PN-UH701/UH601 commercial LCD displays due to their many user friendly features. They include a powerful RS-232C command set, which permits flexible remote control capabilities from connected devices. In addition, displaying still images or videos couldn't be easier with the USB port. Business owners will also appreciate optimal content control with added lockout features including IR Remote, Power, Channel, Volume, Input, OSD disable, and LED disable. All this with 16/7 reliability and a three-year limited commercial warranty.

## Bigger Screen, Slimmer Bezel

Fit more screen in less space with the PN-UH701/UH601. Streamlined for a pleasing appearance and minimal protruding parts, this monitor weighs only 76.1/55.2 lbs. A bezel thickness\* of just <sup>29</sup>/<sub>64</sub>" and <sup>7</sup>/<sub>16</sub>" makes for easy placement in offices, public places, stores and other commercial establishments.

\* PN-UH701: <sup>29</sup>/<sub>64</sub>" (right/left), <sup>7</sup>/<sub>16</sub>" (top), <sup>5</sup>/<sub>8</sub>" (bottom\*\*)  
PN-UH601: <sup>7</sup>/<sub>16</sub>" (right/left/top), <sup>5</sup>/<sub>8</sub>" (bottom\*\*)

\*\* Excluding protruding indicator panel



### Enhanced Connectivity

Two HDMI™ inputs let you connect multiple HD sources, including digital signage and cable boxes. A powerful RS-232C command set enables flexible remote control from connected devices. And a built-in USB port lets you present a variety of digital content. Simply insert a USB memory device into the monitor and the built-in media player starts playing your photos, music and videos right away.

### A Visual Boost to Presentations

Add impact to your business presentations by connecting your PC to the PN-UH701/UH601 displays. Text, graphs, pictures and tables can all be displayed in stunningly detailed 4K Ultra-HD resolution.



### Customer Support

Purchase includes a limited three-year commercial warranty, plus Sharp's best-in-class customer support service.

### Built-in Speakers for Powerful Audio

Powerful 10 W speakers deliver high-fidelity audio, so all of your scenes sound as good as they look.

### Public Mode

If you select Public Mode via the remote controller, operational controls are disabled on the PN-UH701/UH601 itself. This prevents unwanted adjustments by people in public locations such as stores and restaurants.



# Specifications

Model Name	PN-UH701	PN-UH601
Installation	Landscape	
LCD Panel	70" Class (69 43/64" diagonal) LCD	
	60" Class (60 5/64" diagonal) LCD	
Max. Resolution	3,840 x 2,160 pixels	
Max. Display Colors (approx.)	1.07 billion colors	
Pixel Pitch (H x V)	0.40075x 0.40075 mm	
Max. Brightness*1	300 cd/m <sup>2</sup>	
Contrast Ratio	4,000 : 1	
Viewing Angle (H/V)	176°/176° (CR ≥ 10)	
Active Screen Area (W x H)	60 19/32" x 34 3/32"	
Response Time	8 ms	
Backlight	LED, edge lit	
Computer Input	HDMI	
Plug & Play	VESA DDC2B	
Video Color System	NTSC-M/PAL-N/PAL-M	
Analog/Digital Turner	NTSC/ATSC	
Input Terminals*2	HDMI x 2, Video (3.5 mm-diameter mini stereo jack) x 1, RS-232C (3.5 mm-diameter mini stereo jack) x 1, ANT/Cable x 1, USB x 1	
Output Terminals*2	Audio: 3.5 mm-diameter mini stereo jack (L/R) x 1	
Input/Output Terminals*2	Ethernet RJ-45 x 1	
Speaker Output	10 W + 10 W	
Power Supply	110 – 240 V AC 50/60Hz	
Power Consumption	185 W	
Operating Temperature	0°C to 40°C	
Dimensions (W x D x H) (approx.) (display only)	61 9/16" x 3 25/64" x 35 3/4"	
Weight (approx.) (display only)	76.1 lbs	
	53 23/64" x 3 25/64" x 31 5/32"	
	55.2 lbs	

\*1 Brightness depends on input mode and other picture settings. Brightness level will decrease slightly over the lifetime of the product. Due to the physical limitations of the equipment, it is not possible to maintain a precisely constant level of brightness. \*2 Use a commercially available connection cable for PC and other video connections.

## Dimensions

(PN-UH701)

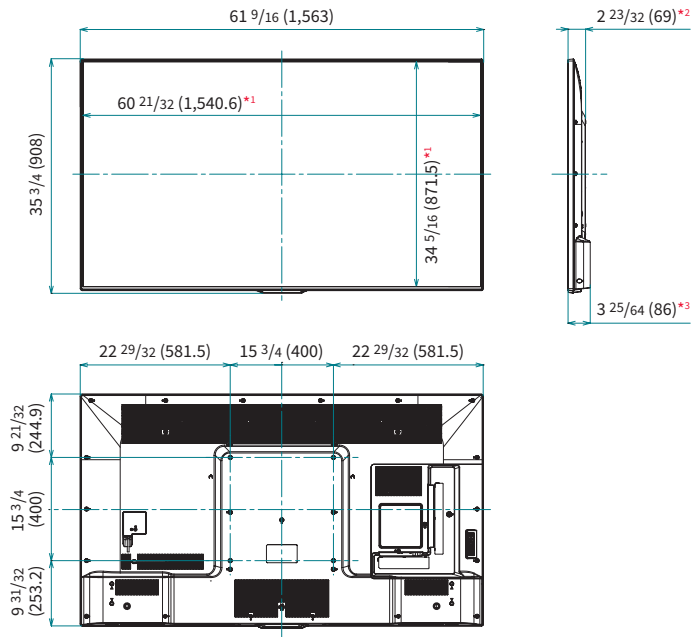

(PN-UH601)

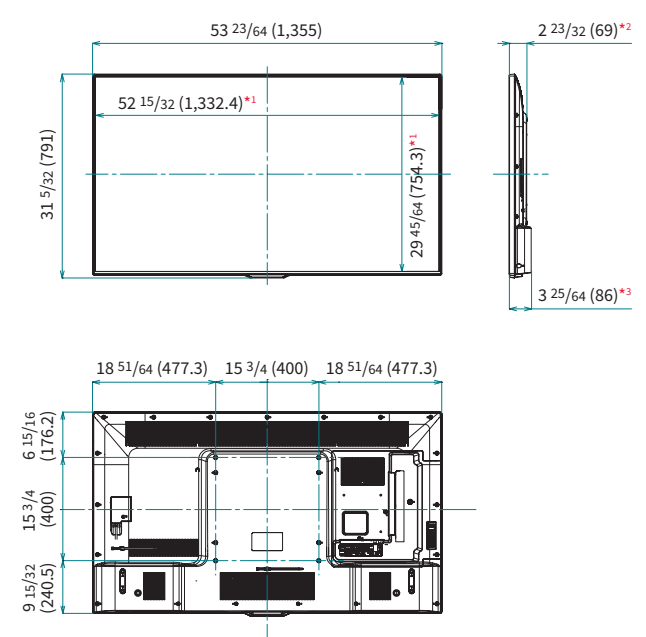

Units: inch (mm)  
 \*1 Active area \*2 Thinnest part \*3 Including projecting parts



SHARP ELECTRONICS CORPORATION  
 100 Paragon Drive, Montvale, NJ 07645  
 1-800-BE-SHARP • www.sharppusa.com

Sharp is a registered trademark of Sharp Corporation. The terms HDMI, High-Definition Multimedia Interface and the HDMI logo are trademarks or registered trademarks of HDMI Licensing Administrator, Inc. All other brand names and product names may be trademarks or registered trademarks of their respective owners. All screen images appearing in this brochure are simulated. Design and specifications are subject to change without prior notice.