

DC PLUGS ATTACHABLE® 3-POLE

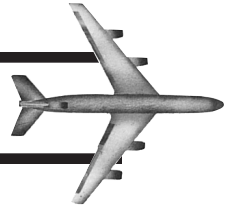

Attachable® Portable Plugs and Receptacles, 3 Pole. R65 and R68 Series 28VDC



R65 PORTABLE PLUG

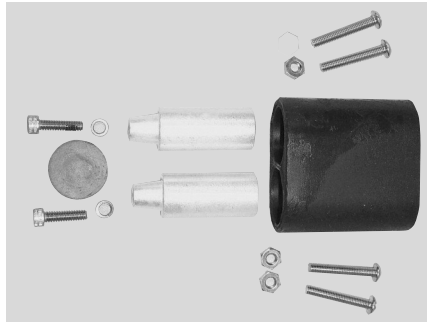

R65 GROMMET "G" KIT

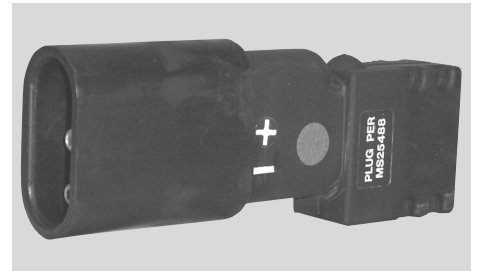

R68 PORTABLE Receptacle

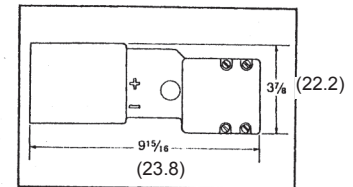
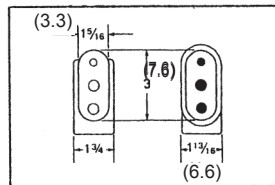
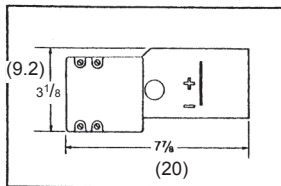

Electrical Ratings: 30°C rise Power Components, 450A Continuous 1500A for 1 minute, Control Components, 35A continuous

The ATTACHABLE® Portable Plugs and Receptacles are molded of a proprietary synthetic elastomer, a compound specially selected for its resistance to moisture and chemicals as well as its ability to stand up under severe wear and tear. Power contacts are of machined copper, silver-plated to reduce contact resistance. Contact lugs may be either crimped or

soldered to cables. The R65 and R68 series are manufactured to MS25488 specifications and are listed on Qualified Product List (QPL) for MIL-C-7974D. Portable receptacles are particularly useful where a portable connection is required or for extending existing cables.

® Attachable is a registered Trademark of Anderson Airmotive

3-Pole DC 28V Attachable® Plugs-2 wire

| COMPLETE PLUG NO. | MILITARY PART NO. | BODY ONLY PART NO | CABLE ACCOMMODATION | GROMMET KIT NO. | PORT RECEPTACLE PART NO. | Schematic |
|-------------------|-------------------|-------------------|---|-----------------|--------------------------|-----------|
| R65G1E | MS25488-25 | 110368G2E | 2-1/0(50mm) MIL-C-5756C Single Conductor | 112080G1 | R68G1E | |
| R65G2E | MS25488-26 | 110368G2E | 2-2/0(70mm) MIL-C-5756C Single Conductor | 112080G2 | R68G2E | |
| R65G3E | MS25488-27 | 110368G2E | 2-4/0(120mm) MIL-C-5756C Single Conductor | 112080G3 | R68G3E | |
| R65G6E | | 110368G2E | 2-4/0(120mm) Oval Twin Conductor | 112080G6 | R68G6E | |
| R65G8E | | 110368G2E | 2-1/0(35mm) Welding Single Conductor | 112080G8 | R68G8E | |
| R65G10E | | 110368G2E | 2-4/0(120mm) Welding Single Conductor | 112080G10 | R68G10E | |
| R65G20E | | 110368G2E | 2-2/0(70mm) Welding Single Conductor | 112080G20 | R68G20E | |
| R65G25E | | 110368G2E | 2-3/0 (90mm) welding Single Conductor | 112080G25 | R68G25E | |
| R65G43E | | 110368G2E | #8/2 (8mm) welding Single Jacket | 112080G43 | R68G43E | |

Other models available for different cable sizes, configurations and options

R65Gxx(E)(F)(EN) xx-model number (F) Euro Contact
(E) Standard Contact (EN) EcoNose