

INTRODUCTION

FLUID END ACCESSORIES

TSC's fluid end accessories are available for most of the popular triplex mud pumps. CNC machining renders these accessories uniformly dimensional and interchangeable with OEM. The perfect exterior surface reflects our superior quality.

Associated items

- Valve and cylinder head plug.
- Valve and cylinder head thread ring.
- Valve and cylinder head lock.
- Valve guide.
- Stud and nut.
- Specialty items.



FLUID END MODULE & ACCESSORIES

GARDNER DENVER PZ-11 HP (PZL) (7500PSI)
TSC Manufacturing and Supply, LLC.

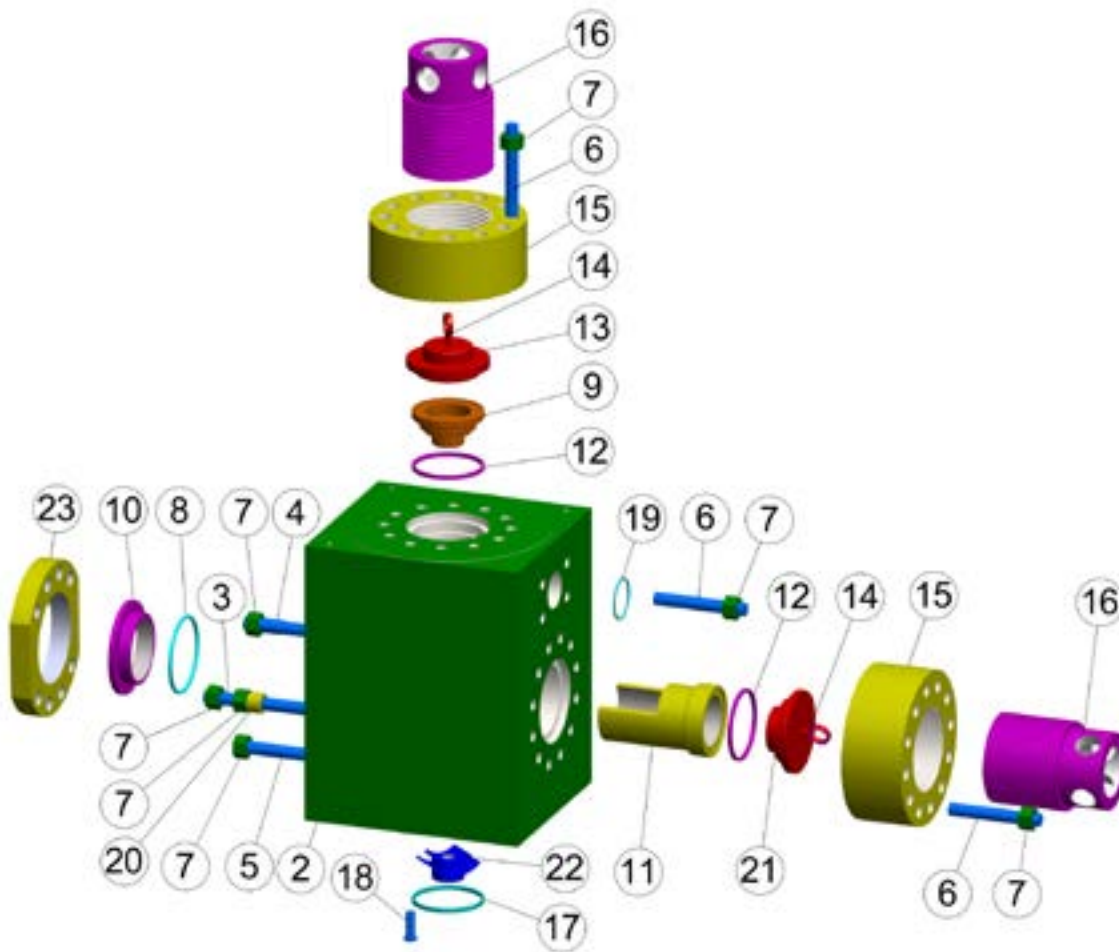

TSC Manufacturing and Supply LLC, 13788 West Road, Suite 100, Houston, Texas 77041, USA
Tel: +1 832 456 3900 Fax: +1 832 456 3998 E-mail: sales@t-s-c.com

FLUID END MODULE & ACCESSORIES**GARDNER DENVER PZ-11 HP (PZL) (7500PSI)**

| ITEM | PART NUMBER | DESCRIPTION | QTY/PUMP |
|------|------------------|--|----------|
| | TS-FEMPZ101175CA | FLUID END MODULE COMPLETE ASSEMBLY (INCLUDES ITEM 2-23) | 3 |
| 1 | TS-300PZL2039 | FLUID END MODULE STUDDED (INCLUDES ITEM 2-9) | 3 |
| 2 | TS-300PZL029 | FLUID END MODULE ONLY | 3 |
| 3 | TS-302PZL110 | STUD, LINER CLAMP | 36 |
| 4 | TS-300PZL110 | STUD, FLUID CYLINDER TO FRAME ALIGNMENT(UPPER) | 6 |
| 5 | TS-303PZL110 | STUD, FLUID CYLINDER TO FRAME (LOWER) | 6 |
| 6 | TS-301PZL110 | STUD, THREADED RING & DISCHARGE MANIFOLD | 84 |
| 7 | TS-50B36 | NUT (FOR ABOVE) | 168 |
| 8 | TS-303PZL316 | SEAL, WEAR PLATE | 3 |
| 9 | TS-302PZL483 | GUIDE, VALVE (UPPER) | 3 |
| 10 | TS-301PZL234 | WEAR PLATE | 3 |
| 11 | TS-301PZL205 | RETAINER, VALVE GUIDE | 3 |
| 12 | TS-309PZL316 | SEAL, CYLINDER HEAD & VALVE COVER | 6 |
| 13 | TS-302PZL147 | COVER, VALVE(UPPER) | 3 |
| 14 | TS-15P27 | EYE BOLT | 6 |
| 15 | TS-300PZL387 | RING, THREADED | 6 |
| 16 | TS-300PZL587 | COVER LOCK | 6 |
| 17 | TS-25BE41 | GASKET, SUCTION MANIFOLD | 3 |
| 18 | TS-655EG10N | SCREW, SUCTION MANIFOLD | 24 |
| 19 | TS-302PZL316 | GASKET, DISCHARGE MANIFOLD | 3 |
| 20 | TS-300PZL229 | BUSHING | 12 |
| 21 | TS-303PZL147 | COVER, VALVE(LOWER) | 3 |
| 22 | TS-303PZL483 | GUIDE, VALVE (LOWER) | 3 |
| 23 | TS-300PZL455 | LINER CLAMP | 3 |
| 24 | TMPZ11HP-STUDSET | PZ-11 HP STUDS AND NUTS SET (INCLUDES 12 PCS TS-302PZL110, 2 PCS TS-300PZL110, 2 PCS TS-303PZL110, 56 PCS TS-50B36, 28 PCS TS-302PZL110) | 3 |
| 25 | TMPZ11HP-SEALKIT | PZ-11 HP MODULE SEAL KIT (INCLUDES TWO TS-309PZL316, ONE TS-303PZL316, ONE TS-25BE41, ONE TS-302PZL316) | 3 |

TSC does not warrant or represent that any of such information is accurate, or that any products listed are compatible with each other.
Any deviations from the OEM products should be verified as to compatibility.