

EXTRACTOR TOOL

MODEL NO. 249250

FORM NO. 042049

FEB. 1981

PARTS LIST



ADVANCE
MACHINE COMPANY
INTERNATIONAL HEADQUARTERS, Spring Park, Minnesota 55384 USA
EUROPE, 4 Rue Jean Engling, Dommeldange, Luxembourg
CANADA, 45 Iron Street, Rexdale, Ontario



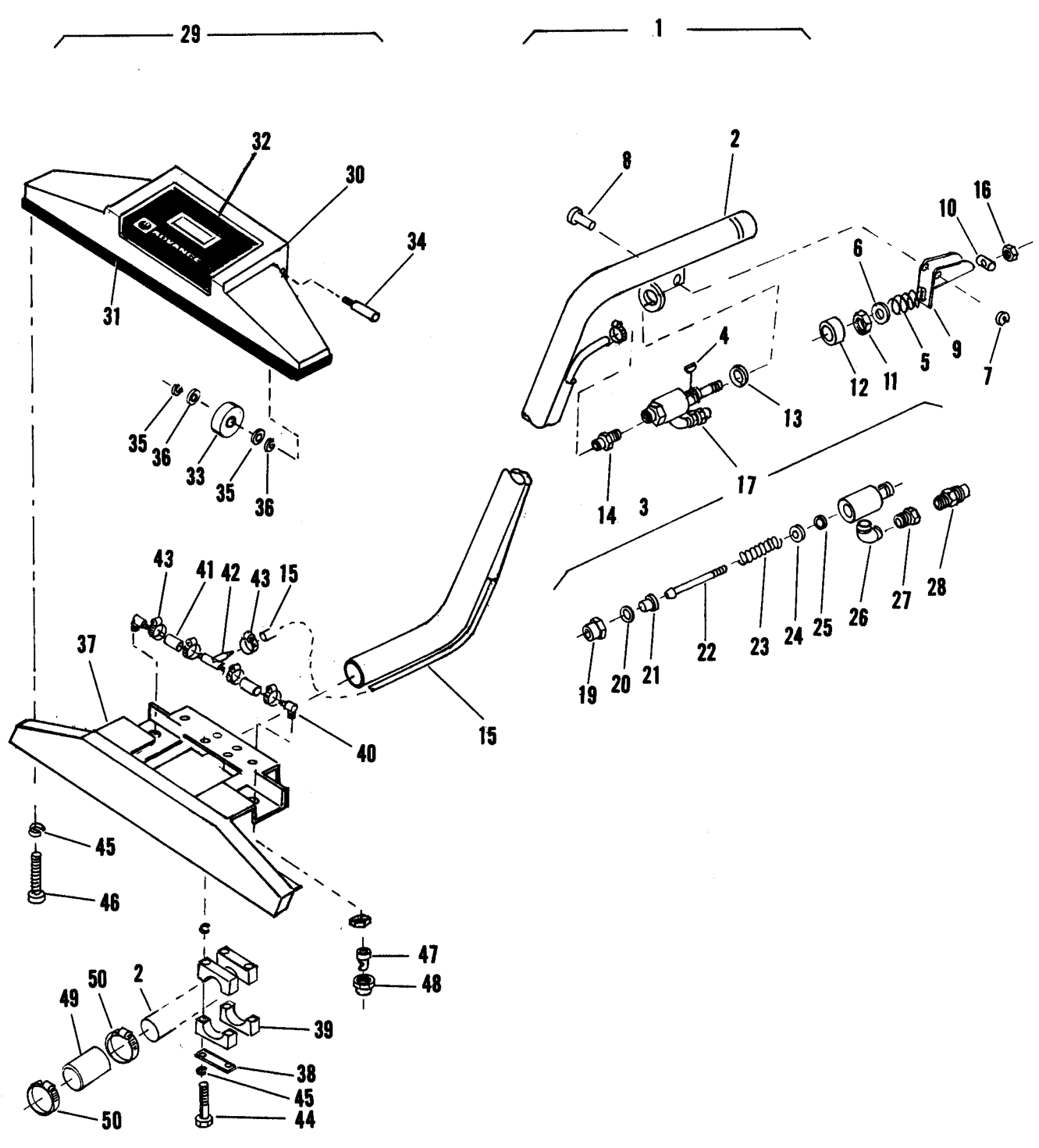

EXTRACTOR TOOL

EXTRACTOR TOOL

ITEM	PART NO	QTY	DESCRIPTION
1	249 252	1	WAND ASS'Y.,Incls:Items 2 -17
2	249 064	1	WAND,Weldment
3	756 364	1	CLAMP,Hose SAE #4
4	106 445	1	KEY,Woodruff .12 X.50
5	745 697	1	SPRING,Comm
6		1	WASHER,Flat #6
7	321 128	1	RING,Retaining Ext.
8	249 716	1	PIN,.187 X 1.156
9	249 708	1	HANDLE
10	249 704	1	GUIDE,Handle
11	746 934	1	NUT,Jam .625-18
12	249 706	1	SPACER
13	760 148	1	LOCKWASHER,5/8"
14	104 299	1	BARB,3/8 X 1/8 Brass
15	249 278	1	TUBE,Pvc .375 X 40.00
16		1	NUT,Hex #5-40 Brass
17	249 700	1	VALVE ASS'Y.,Incls Items 18-28
18	746 904	1	BODY,Valve
19	753 841	1	CAP,Valve
20	742 552	1	O-RING
21	746 928	1	SEAT,Valve
22	746 908	1	STEM,Valve
23	756 276	1	SPRING
24	746 919	1	WASHER,Brass
25	760 288	1	O-RING
26	111 309	1	ELBOW
27	748 886	1	ADAPTER
28	249 857	1	PLUG, Disconnect
29	249 256	1	SHROUD ASS'Y.,Incls:Items 30 - 36
30	249 258	1	CASTING,Shroud
31	249 282	1	STRIP
32	017 750	1	DECAL,Liquidator
33	324 499	2	WHEEL,3.00 X .781
34	180 036	2	AXLE
35	163 767	4	WASHER,Spring .375
36		4	WASHER,Flat 3/8"
37	249 262	1	SHOE,Weldment
38	249 884	2	PLATE
39	249 878	4	BLOCK
40	249 048	2	CONNECTOR
41	249 276	2	TUBE,Pvc .37 X 2.25
42	249 280	1	TEE,Barb 3/8 X 3/8 X 3/8
43	756 364	5	CLAMP,Hose SAE #4
44		4	BOLT,Hex Hd 1/4-20 X2.25
45		10	WASHER,Shakeproof 1/4"
46		6	SCREW,Pan Hd 1/4-20 X.50
47	249 042	2	NOZZLE,Floodjet
48	149 044	2	CAP,Retainer
49	249 274	1	HOSE, 1.5 X 4.00
50	329 145	2	CLAMP,Hose SAE #24