

**NOTE: INTERNAL VALVE HYDRAULICS**

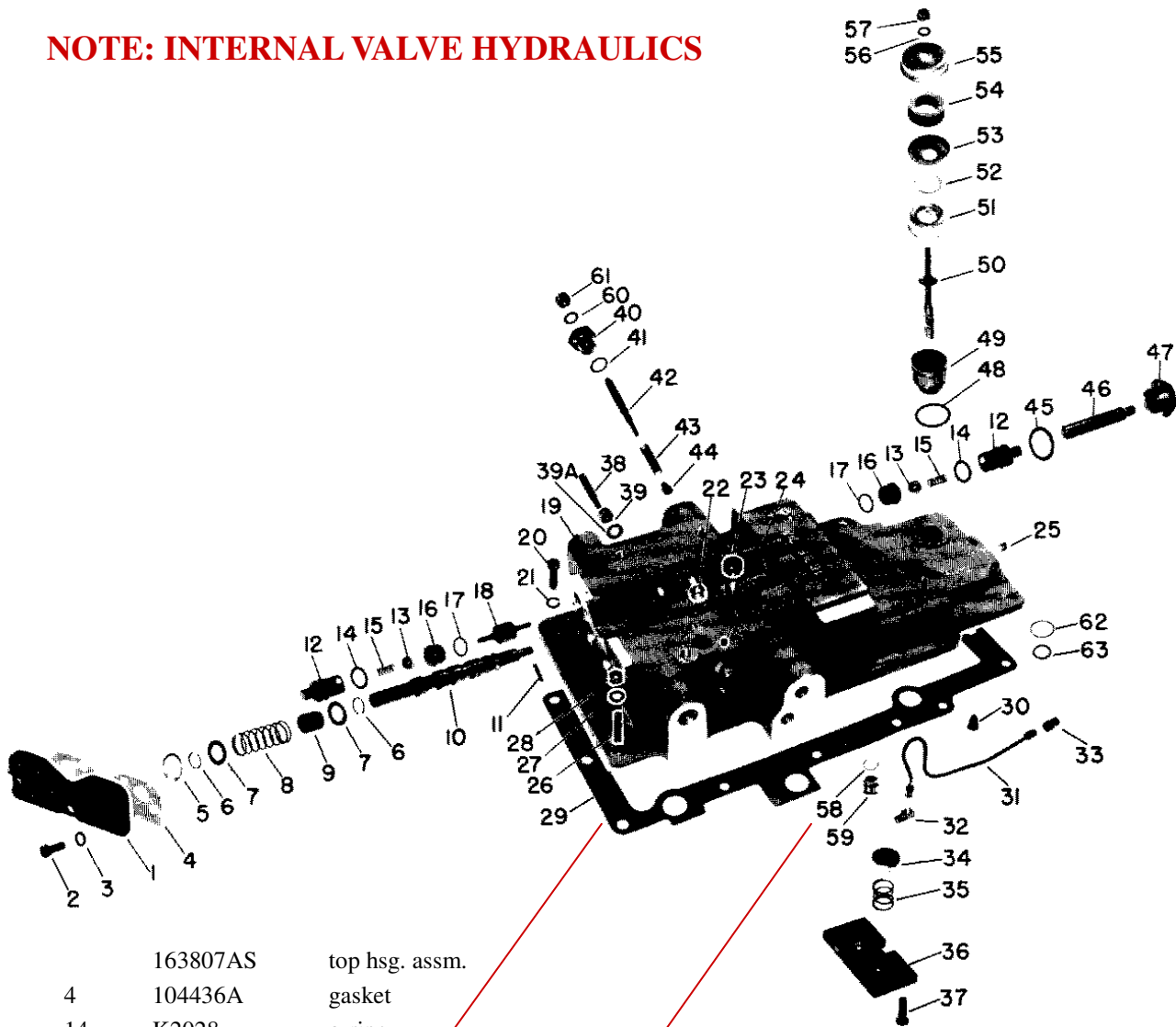

- |    |            |                 |
|----|------------|-----------------|
|    | 163807AS   | top hsg. assm.  |
| 4  | 104436A    | gasket          |
| 14 | K2028      | o-ring          |
| 17 | 168935A    | o-ring          |
| 29 | 163808A    | gasket          |
| 41 | K2026      | o-ring          |
| 45 | 104427A    | gasket          |
| 48 | K2027A     | o-ring          |
| 54 | 30-3171795 | element         |
| 58 | 70923379   | o-ring (12 req) |
| 60 | B235A      | washer, sealing |
| 61 | 167674A    | cap             |
| 62 | 70923560   | o-ring          |
| 63 | 163809A    | ring, teflon    |

**NOTE: INTERNAL VALVE HYDRAULICS**

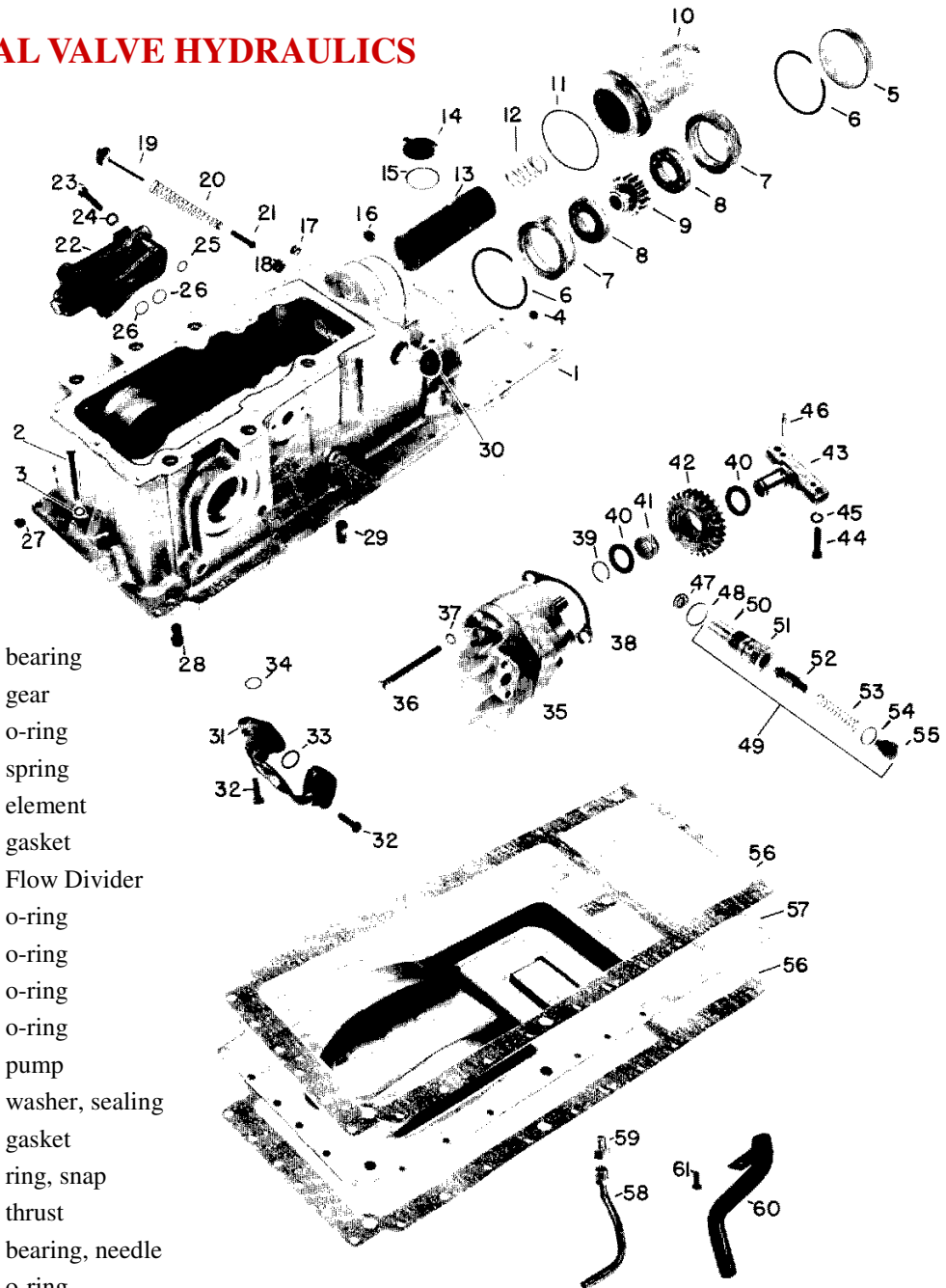

8	1174298	bearing
9	155741A	gear
11	70923816	o-ring
12	H210	spring
13	30-3348717	element
15	C298	gasket
22	165838AS	Flow Divider
25	70923376	o-ring
26	70923379	o-ring
33	70923379	o-ring
34	70923574	o-ring
35	30-3062449	pump
37	B235A	washer, sealing
38	103346A	gasket
39	70927926	ring, snap
40	E617	thrust
41	70560253	bearing, needle
48	70923648	o-ring
49	169076AS	valve assm.
56	160405A	gasket
57	30-3055051	pan
58	169071A	line
59	70937481	connector

**NOTE: INTERNAL VALVE HYDRAULICS**

Breakdown O.E.M. Hydraulic Pump ( 30-3062449 )

- 15    30-3047059    Seal, Shaft
- 168956A     Seal Kit

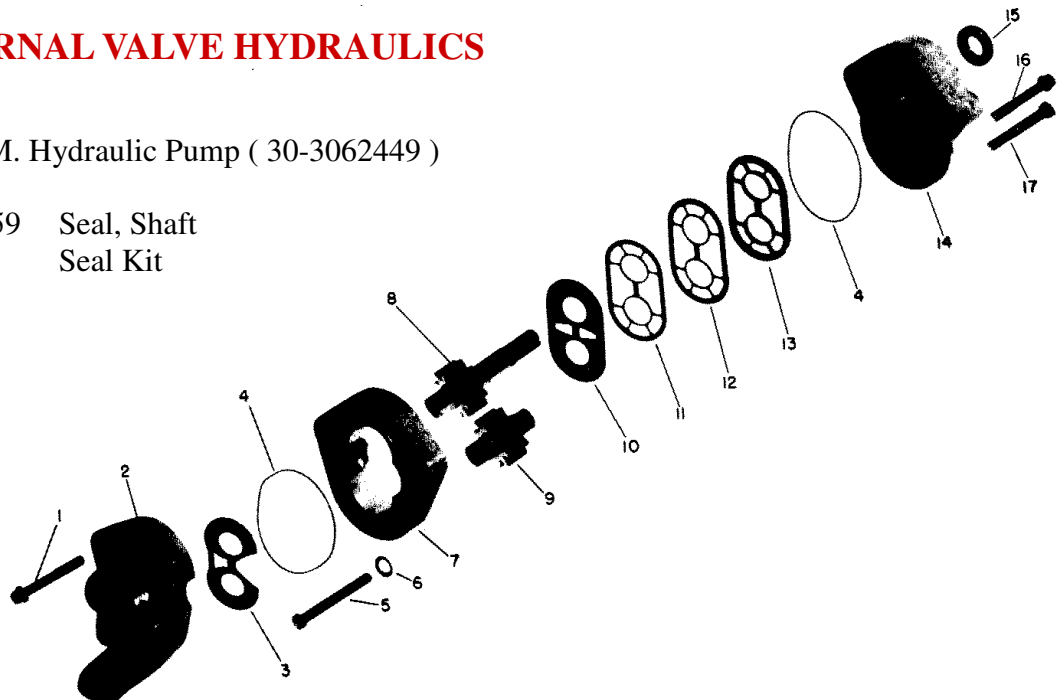

**NEW STYLE  
Replacement Hydraulic Pump**

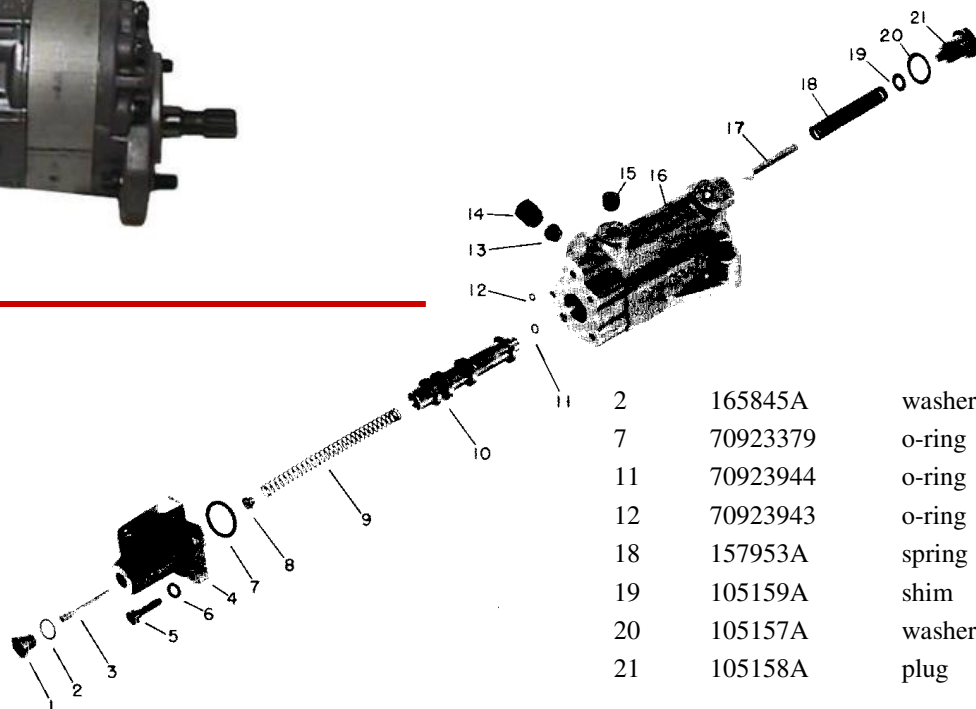
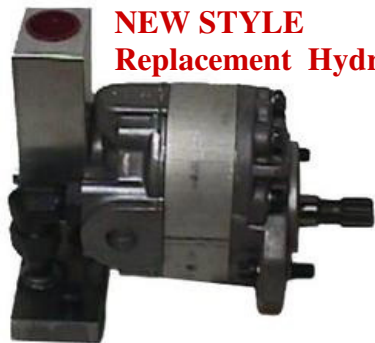

- |    |          |                 |
|----|----------|-----------------|
| 2  | 165845A  | washer, sealing |
| 7  | 70923379 | o-ring          |
| 11 | 70923944 | o-ring          |
| 12 | 70923943 | o-ring          |
| 18 | 157953A  | spring          |
| 19 | 105159A  | shim            |
| 20 | 105157A  | washer          |
| 21 | 105158A  | plug            |

**NOTE: INTERNAL VALVE HYDRAULICS**

- |    |            |                  |
|----|------------|------------------|
| 1  | 107385A    | ring             |
| 3  | 162876A    | seal             |
| 4  | 107533A    | bushing          |
| 12 | 166138A    | ring, teflon     |
| 13 | 70924135   | o-ring           |
| 22 | 30-3042766 | elbow            |
| 29 | 163389AS   | valve assm.      |
| 31 | 70923376   | o-ring ( 5 req ) |
| 32 | 70923379   | o-ring           |
| 33 | 100491A    | ring             |
| 34 | 155824A    | seal             |
| 35 | 155826A    | ring             |
| 36 | K6636      | ring             |
| 37 | 161675A    | piston           |
| 38 | 155825A    | plug             |
| 39 | 155823A    | link             |

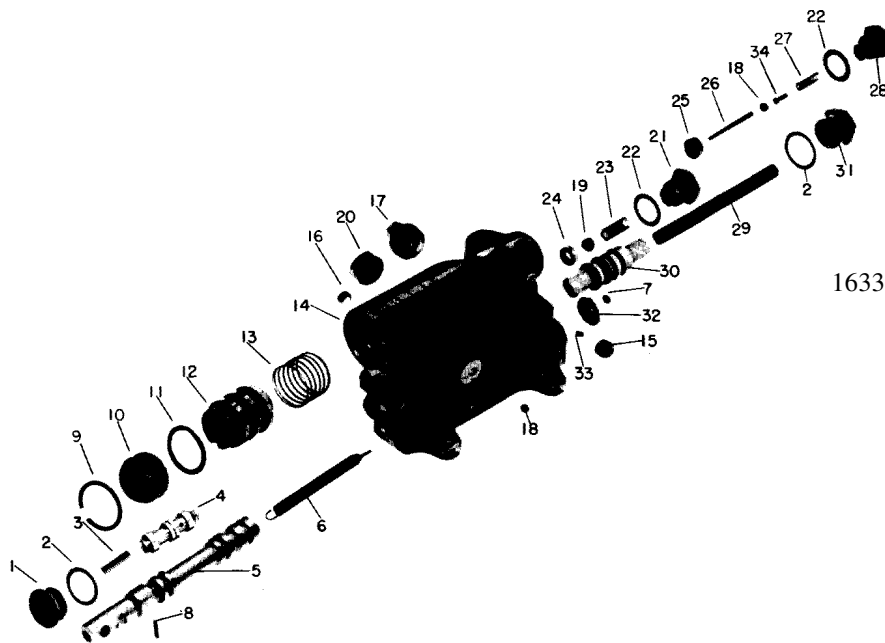
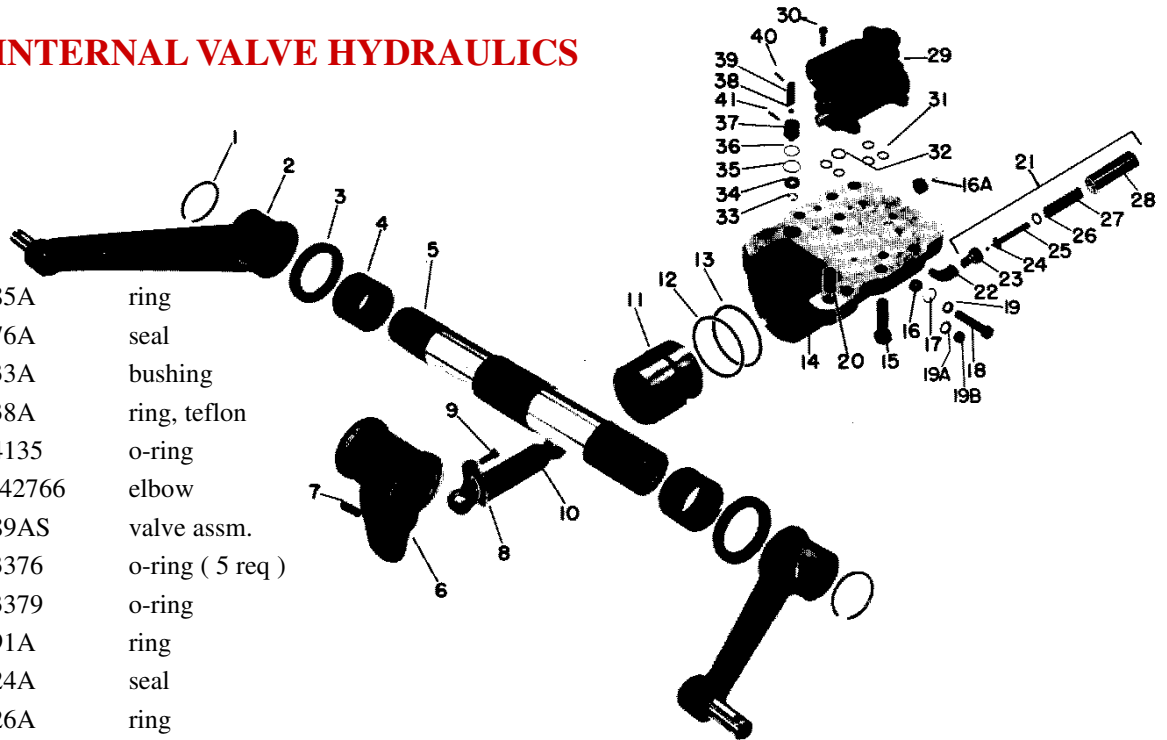

163389AS valve assm.

## NOTE: INTERNAL VALVE HYDRAULICS

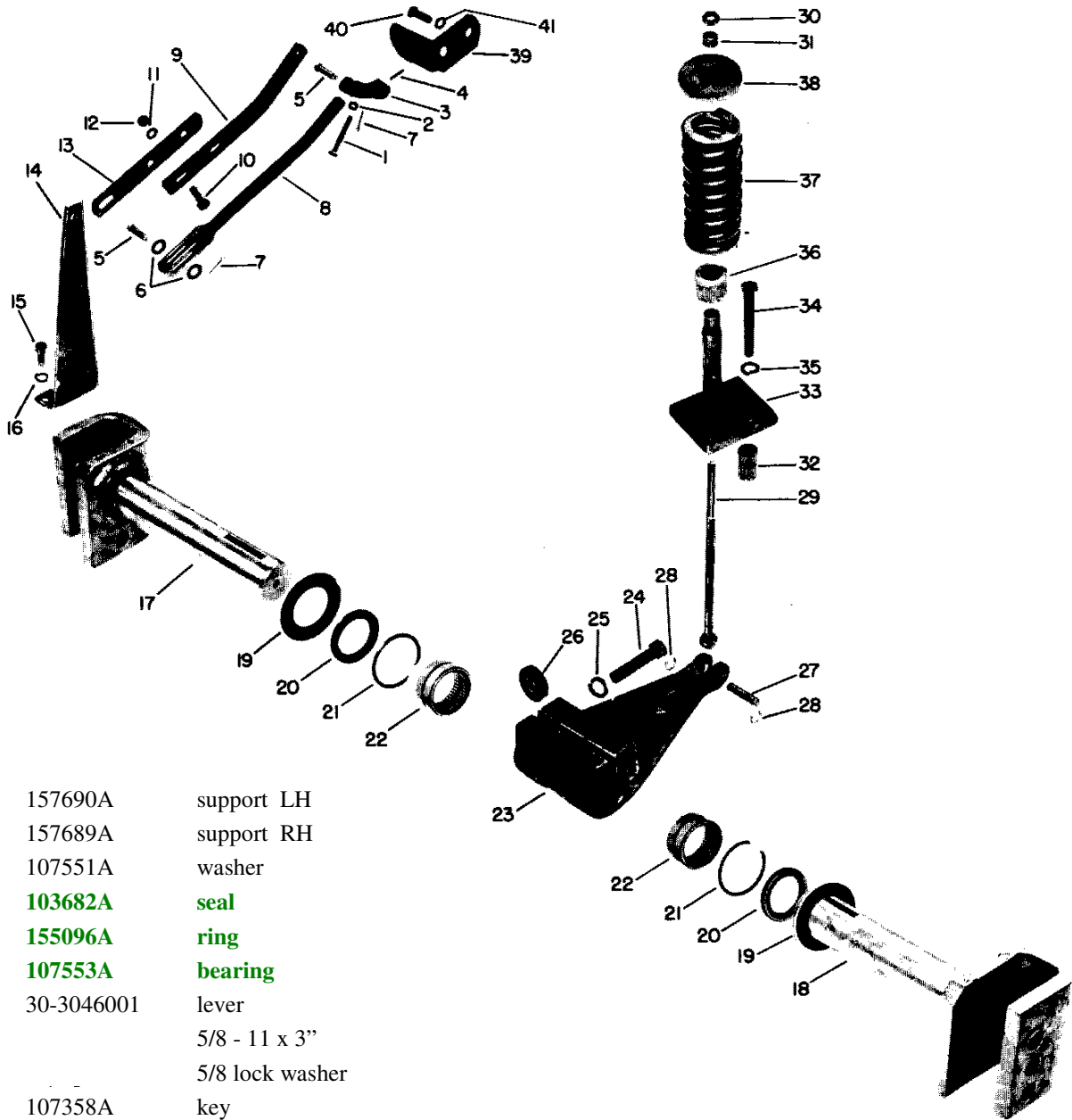

- |    |                |                 |
|----|----------------|-----------------|
| 17 | 157690A        | support LH      |
| 18 | 157689A        | support RH      |
| 19 | 107551A        | washer          |
| 20 | <b>103682A</b> | <b>seal</b>     |
| 21 | <b>155096A</b> | <b>ring</b>     |
| 22 | <b>107553A</b> | <b>bearing</b>  |
| 23 | 30-3046001     | lever           |
| 24 |                | 5/8 - 11 x 3"   |
| 25 |                | 5/8 lock washer |
| 26 | 107358A        | key             |
| 27 | 104200A        | pin             |
| 28 | 104201A        | ring, ,snap     |
| 29 | 107603A        | rod             |

**NOTE: INTERNAL VALVE HYDRAULICS**

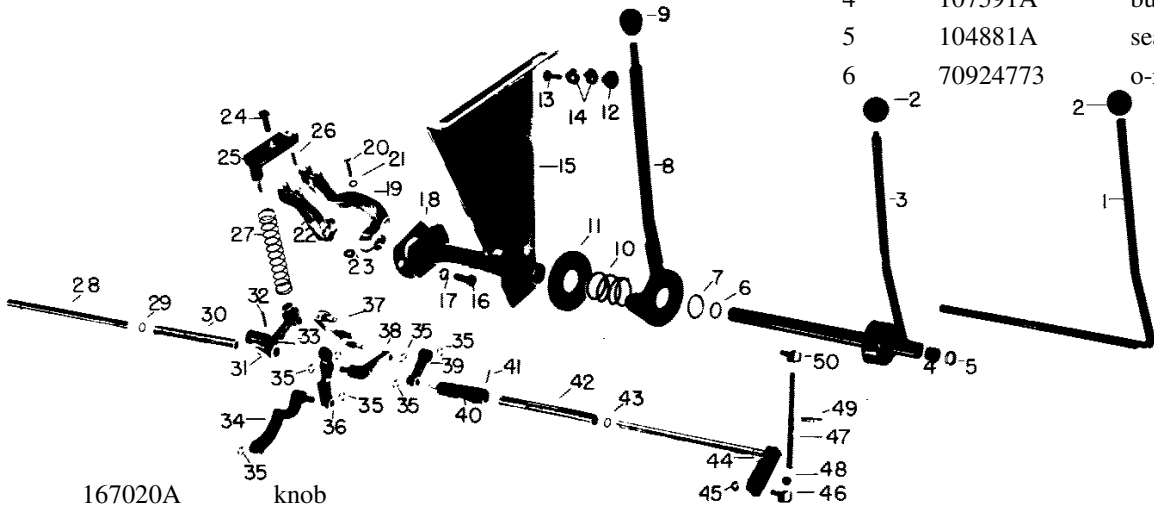

9	167020A	knob			
10	104481A	spring			
11	104480A	disc, friction	29	70923560	o-ring
12	167019A	knob	36	165472A	rocker
13	70921908	bolt	43	70923560	o-ring
14	167018A	stop	46	104485A	swivel
18	167010A	gasket	47	104486A	shaft
23	104445A	key	50	104484A	swivel

8	167592A	hose
11	30-3001385	cooler
13	166511A	line
20	165376AS	valve
25	166513A	line
		by-pass to hydraulic housing
27	30-3056392	tube
		steering return hose to by-pass

