

- | | |
|-------------------------|-----------------------------|
| 1. Guard | 4. Locknut, 3/8-24 |
| 2. Bracket | 5. Screw (not shown) |
| 3. Bolt, 3/8-24 x 5 in. | 6. Bolt, 3/8-24 x 5-1/2 in. |

Figure 2. Bolt Positions-Late 1984 and Later XL Models

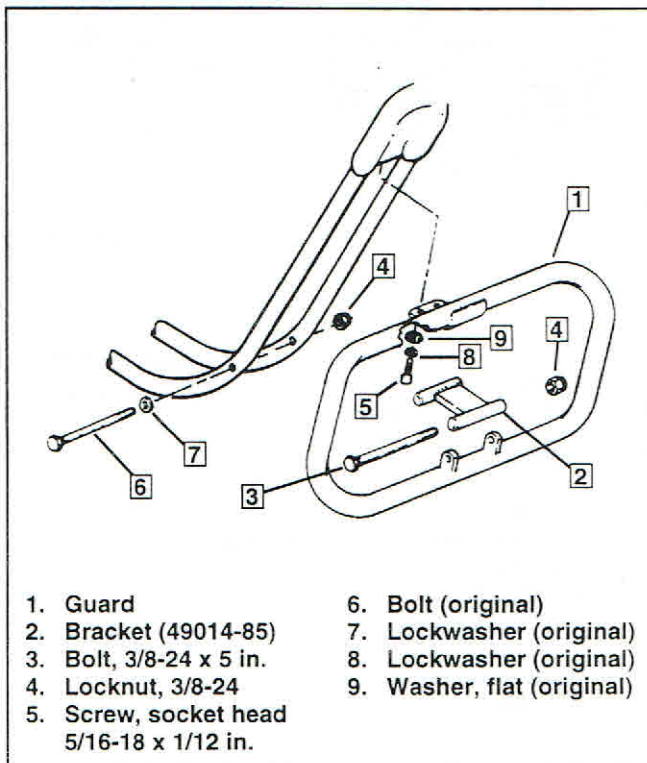

- | | |
|---|----------------------------|
| 1. Guard | 6. Bolt (original) |
| 2. Bracket (49014-85) | 7. Lockwasher (original) |
| 3. Bolt, 3/8-24 x 5 in. | 8. Lockwasher (original) |
| 4. Locknut, 3/8-24 | 9. Washer, flat (original) |
| 5. Screw, socket head
5/16-18 x 1/12 in. | |

Figure 3. Installation (Generator Models)

5. Attach bracket (2) to guard (1) using bolt (3) and locknut (4), as shown.
6. Tighten nut (4) on bolt (3) to 33 ft-lbs torque.
7. See Figure 1. Tighten upper socket head mounting screw (5) to 19 ft-lbs torque.
8. On 1986 models, remove clutch cable from clutch hand lever and route cable through engine guard. Install cable at hand lever and adjust freeplay according to procedure outlined in the 1986 XLH Service Manual.
9. Check for interference of clutch and brake cables with engine guard when handlebars are turned fully to the right and left.

Installation- 1982 - Early 1984 XL Models and XR-1000 Models (Equipped with Generator)

NOTE

Read all instructions carefully before beginning installation. Cover front fender with a clean rag to protect it from scratches during installation procedures.

1. See Figure 3. Remove screws (5), lockwashers (8) and flat washers (9) from underside of steering head. Discard original screws (5). Retain washers, locking and flat, for reassembly. Do not remove shim washers between frame and motor bracket.
2. Remove bolt (6), spacer (7) and nut (4) at frame downtubes.
3. Attach bracket (2), Part number 49014-85, to guard (1) using bolt (3) and locknut (4), as shown.
4. Position guard (1) with upper mounting bracket under steering head and bracket (2) aligned with holes in frame downtube. Place original lockwashers (8) and flat washers (9) on socket head screws (5). Insert screws (5) through upper bracket on guard (1), through upper engine mount and thread into tapped holes in steering head.
5. Insert original bolt (6) through frame downtubes and bracket (2). Place new locknut (4) on bolt (6) and tighten to 33 ft-lbs torque.
6. Tighten upper socket head mounting screws (5) to 19 ft-lbs torque.



Service Parts

Part No. 49018-88A

Date 2/94

XL Engine Guard Kit

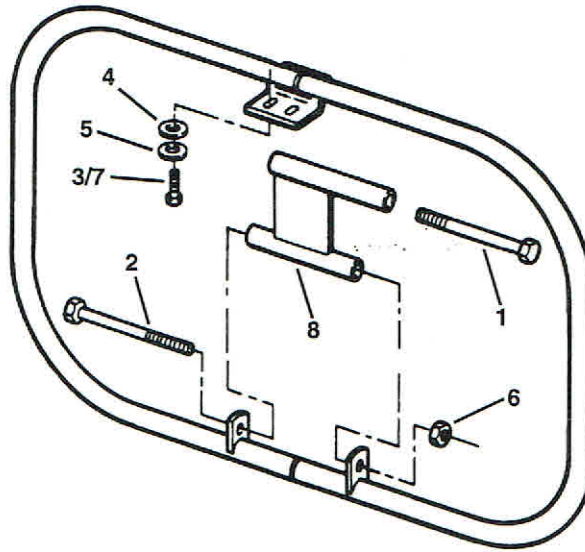

Item	Description	Part No.
1	Bolt	4333
2	Bolt	4313
3	Screw	4816A
4	Washer	6336B
5	Washer	6474
6	Locknut	7775
7	Screw	45999-81A
8	Bracket	49014-86