

Section 9

Miscellaneous Tank Parts, Lights & Suspensions



Section 9

Miscellaneous Tank Parts, Lights & Suspension

Air Tanks	5	Quick Reference Chart	11
Cones	4	Schrader Roller w/ Interlock	5
Conspicuity Tape (DOT Tape)	3	Spill Kits	4
Fenders & Accessories	1	Suspensions	12-14
Gauge Sticks	4	Tank Testing Equipment	9
Hose Tube Accessories	2	Thickness Gauge	10
Light Boxes	8	Toolboxes & Accessories	5
Lighting	6	Union w/ Zerk	5
Placards & Accessories	3	Upper Couplers	7
Product Identification Marker	6		

How to properly Measure Trailer Fenders

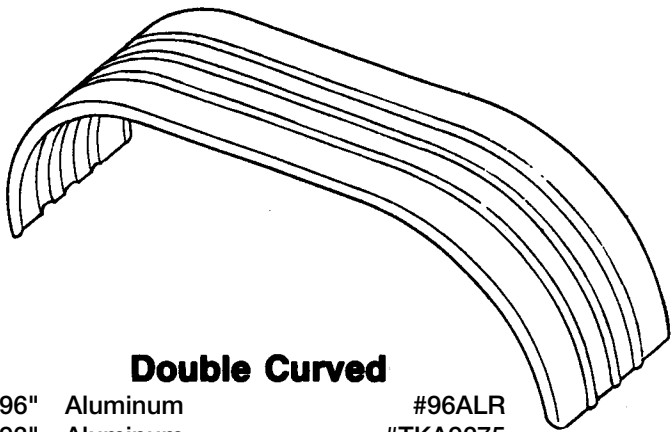
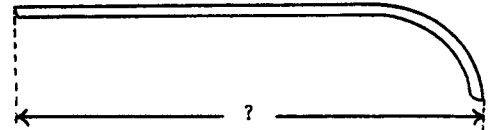
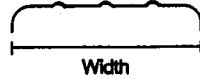
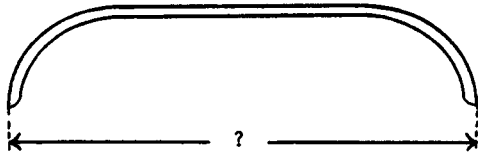

Double Curved

- 96" Aluminum #96ALR
- 93" Aluminum #TKA9275
- 99" Aluminum #TKA92751
- 105" Aluminum #063172
- 105" Aluminum (Tractor) #217PO69850
- 99" Aluminum Inverted #9289-0119
- 99" Aluminum L/R Inverted #9286-0126

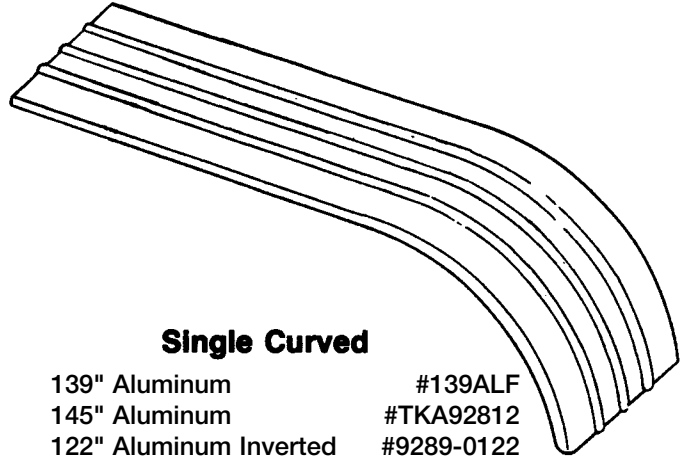

Single Curved

- 139" Aluminum #139ALF
- 145" Aluminum #TKA92812
- 122" Aluminum Inverted #9289-0122
- 139" Aluminum Inverted #9289-0121

Universal Fender Bracket

FLL171511MM

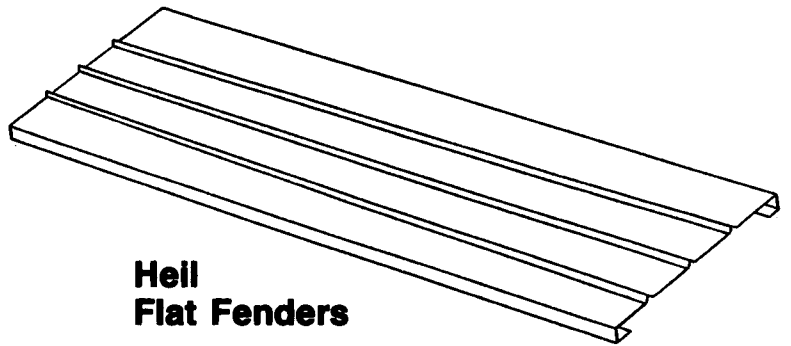
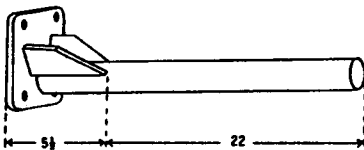

Heil Flat Fenders

- 132" Aluminum # 132ALFF

Fruehauf Fender End Closure

#TKG09331



Fender U BOLTS



- # 2UB - 2" U-bolt
- #030966 - 2" Stainless
- #10572-08509 - 2" CAD Plated

Heil Fender Chanel

2175761

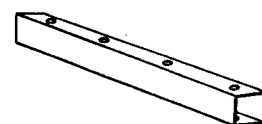

HOSE TUBE ACCESSORIES

ALUMINUM END CAPS

PART NUMBER	DESCRIPTION
6EPLATE	6" ALUMINUM CAP
7EPLATE	7" ALUMINUM CAP
8EPLATE	8" ALUMINUM CAP
10EPLATE	10" ALUMINUM CAP



SINGLE DOOR

PART NUMBER	DESCRIPTION
HTD6	6" HOSE TUBE DOOR
HTD7	7" HOSE TUBE DOOR
HTD8	8" HOSE TUBE DOOR
8PLHTD	8" PIN STYLE HT DOOR
HTD10	10" HOSE TUBE DOOR



DOOR LATCHES

PART NUMBER	DESCRIPTION
HTDLH6ASY	6" HT DOOR LATCH ASSY
HTDLH8ASY	8" HT DOOR LATCH ASSY

DOUBLE DOOR

PART NUMBER	DESCRIPTION
HTD88	8" DOUBLE HT DOOR
8DBLHTD	8" PIN STYLE DBL HT DOOR



DOOR LATCH

PART NUMBER	DESCRIPTION
5697C	MAILBOX LATCH



HOSE TUBE STRAPS

PART NUMBER	DESCRIPTION
6HSTRAP	6" HOSE TUBE STRAP
7HSTRAP	7" HOSE TUBE STRAP
8HSTRAP	8" HOSE TUBE STRAP
10HSTRAP	10" HOSE TUBE STRAP
7764361	8" DBL HOSE TUBE STRAP



FRUEHAUF STYLE STRAP & J-BOLT

PART NUMBER	DESCRIPTION
TKE00894	6" STRAP
TKE00891	8" STRAP
ZKA9836	3/8" PLATED J-BOLT

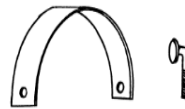

TARP STRAPS

PART NUMBER	DESCRIPTION
SSE10	10" TARP STRAP
SSE15	15" TARP STRAP
SSE21	21" TARP STRAP
93890002	STRAP TROUGH HOOK



HOSE TUBE U-BOLTS

PART NUMBER	DESCRIPTION
030726	6" U-BOLT
030727	8" U-BOLT
10UBOLT	10" U-BOLT



HOSE TROUGHS

We can custom build your troughs to any dimension from any material.

Aluminum - Stainless Steel - Steel

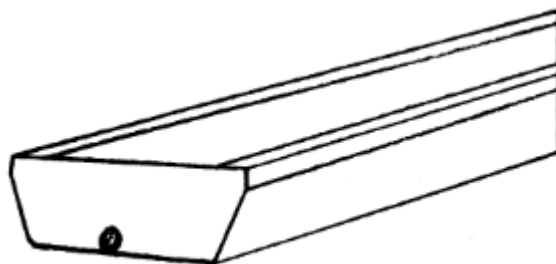

PLACARDS / CONSPICUITY TAPE

LABELMASTER



#126CT
DUO-FLIP PLACARD
FLAMMABLE 3
COMBUSTIBLE 3
POISON 6
CORROSIVE 8
BLANK



#81-HOT
SPACEMASTER
"HOT" MARKINGS



#80SM97
SLIDEMASTER
PLACARD HOLDER



#80SM-3
SLIDEMASTER
PLACARD HOLDER
PLASTIC SHIELD

#81-CLIP
S/S PLACARD CLIP



#81FB
FENDER BRACKET



#RT10



#PL21R



#TP11



#RT15



#TR25R



#TP10



**MANY D.O.T. APPROVED
PLACARDS AVAILABLE**
VINYL PLACARDS
SLIP IN PLACARDS
*SPECIAL ORDERS MUST
MEET MANUF. MINIMUMS*



REFLECTIVE TAPE
#98010ES 2" X 12" WHITE PART
#98032ES 2" X 150' WHITE/RED PART



**ARCHED REAR HEAD
REFLECTIVE TAPE**
#9878-0009 2" X 24"

GROUNDING REELS & ACCESSORIES



AMETEK GROUND REELS
#700-50R 50' GROUNDING REEL
#200-20R 20' GROUNDING REEL



WOODHEAD GROUNDING REELS
#143025 25' GROUNDING REEL
#143050 50' GROUNDING REEL



#TKG25191
 STATIC GROUNDING BALL



#90331
 SINGLE EYELET GROUNDING STRAP

CONES, GAUGES STICKS & SPILL KITS



SAFETY CONES

#RS45015C 18" 3# ORANGE
#RS45015C-LIME 18" 3# LIME
#RS70032C 28" 7# ORANGE
#RS70032C-LIME 28" 7# LIME



GAUGE STICKS

#GP14 14' OVERALL/MEASURES 12'
#GP16 16' OVERALL/MEASURES 14'



#SPILLKIT
 10 - PADS
 2 - 48" SOCKS
 1 - PAIR GLOVES
 1 - DISPOSAL BAG
 PACKAGED IN A ZIPPERED BAG



#ENV300
 (100 COUNT)
 15" X 19" ABSORBENT PAD



#ENV-SPK-5
 1 - 5 GAL. BUCKET
 20 - PADS
 2 - 48" SOCKS
 1 - PAIR GLOVES
 1 - GOGGLE
 1 - DISPOSAL BAG
 PACKAGED IN DOT APPROVED BUCKET

TOOLBOXES & ACCESSORIES



#151-3983-A00
Single Door 33"Wx30"Hx28"D

#151-3984
Double Door 48"Wx30"Hx28"D



*****CALL FOR TOOLBOX SPECS AND PRICING*****

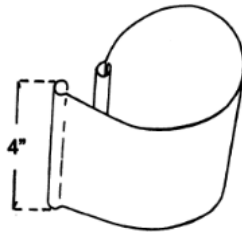

#TKG02763 4" WIDE "C" SPRING
#TKG02762 2" WIDE "C" SPRING



1" WIDE "C" SPRINGS
#BRN471308 4" "C" SPRING



#4876 2 POINT W/ LOCK
#4871 3 POINT W/ LOCK
*all latch kits include rods and guides

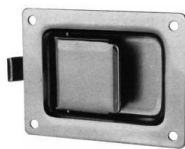

#56300AX TEE HANDLE
#27X345E HANDLE PIN



AIR TANKS, INTERLOCKS & UNIONS



AIR TANKS

*Measurements are overall

#9674-0001 STEEL 8"X33"
#9674-0002 ALUM 8"X33"
#9674-0003 STEEL 12"X28"
#9674-0007 ALUM 12"X28"

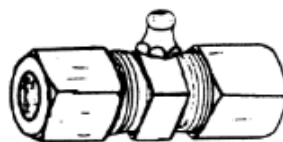

#GU38BR
UNION W/ ZERK
*3/8 ONLY



SCHRADER ROLLER INTERLOCK

#34190099 VALVE
#34170159 VALVE REPAIR KIT

PRODUCT IDENTIFICATION MARKERS



ROTO TAGS
#ROTOTAG8 8 SIDED ROTO TAG
#ROTOTAG4 4 SIDED ROTO TAG
 *All Roto Tags come blank

8-SIDED DECALS

#REGUNL #FUELOIL
 #UNLPLUS #DIESEL
 #PREMUNL #ULTRALS
 #AVGAS #DYEDDIESEL
 #VAPOR #KERO
 #LOSUL #EMPTY
 #HISUL #ETHANOL
 #JET #E85

4-SIDED DECALS

#4REGUNL #4LOSUL
 #4UNIPLUS #4HISUL
 #4PREMUNL #4ULTRALS
 #4EMPTY #4FUEL
 #4DIESEL #4KERO



#TKA699-0015
 TRUCKNOLOGY 8 SIDED
 ENCLOSED PRODUCT
 MARKER

DECALS INCLUDED:

REGULAR
 UNLEADED PLUS
 PREMIUM UNLEADED
 EMPTY
 #2 FUEL
 KEROSENE
 DIESEL-H.S.
 DIESEL-L.S.

LIGHTING



Do what's best.



UPPER COUPLERS

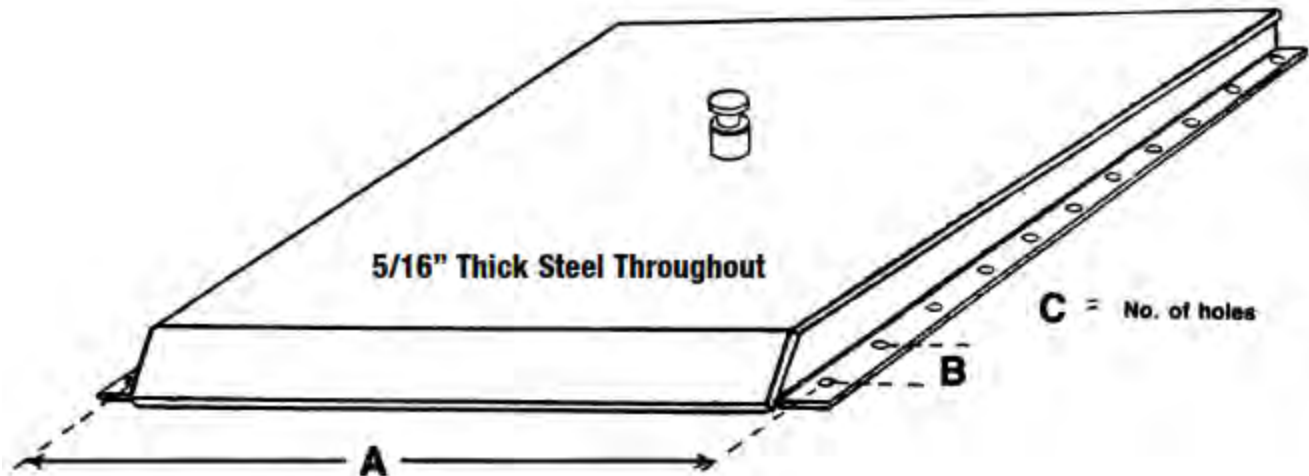

MANUFACTURER	PART #	A	B	C
ACRO	502-74X	37 3/8	3	14
BRENNER	507-02X	41	4	10
BUTLER	504-23X	36	2	24
BUTLER	503-02X	41	2	18
CUSTOM	508-51X	38 1/4	3	10
CUSTOM	508-17X-C	38 1/4	3	13
FRUEHAUF	509-40X	39	3	13
FRUEHAUF (INSERTED)	309-40X	39	3	13
HEIL	9136-0090	40 1/4	3	11
HEIL	9136-0166	46 1/4	3	11
HEIL "REVOLVER"	50301B	40 1/4	3	13
LGM (HEIL,POLAR,FRUEHAUF)	394025-3	39 - 40 1/2	3	11
LGM (MOST CHEMICAL)	404125-4	40 - 42	4	9
TRAILMOBILE "O.V." MODEL BULKER	511-31X	42 1/2	3	13
POLAR	503-03X	40 5/8	2	19
TRAILMOBILE "D" MODEL	508-17X	38 1/4	3	13
TRAILMOBILE "PETRO 80"	503-19X	40	6	6

LIGHT BOXES

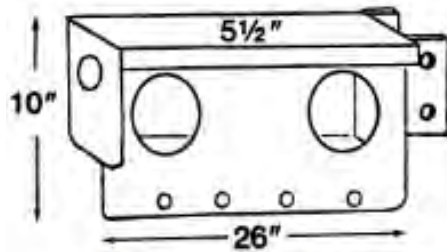

FRUEHAUF ALUMINUM
#TKG00531 ROADSIDE
#TKG00532 CURBSIDE

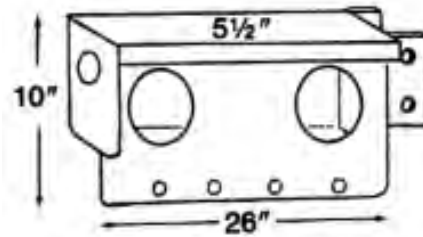

FRUEHAUF ALUMINUM
#TKG4770-5 ROADSIDE
#TKG4770-6 CURBSIDE

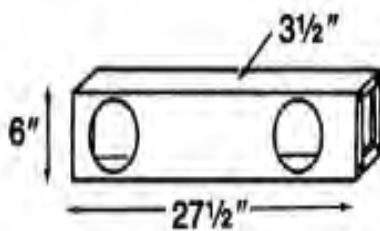

HEIL ALUMINUM
#1513099 LEFT OR RIGHT

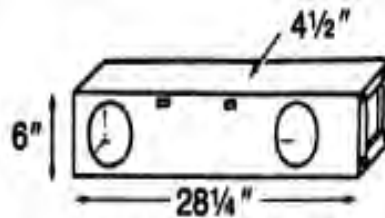

HEIL ALUMINUM
#1512935 LEFT OR RIGHT

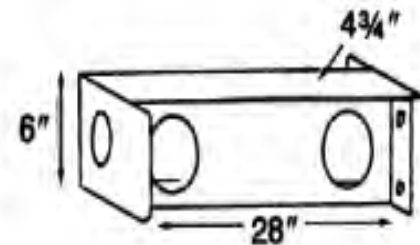

HEIL ALUMINUM
#1513508 CURBSIDE
#1513509 ROADSIDE

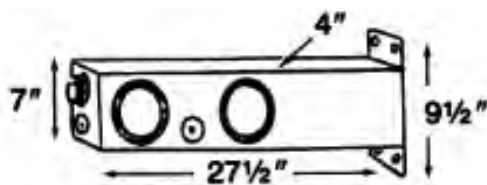

UNIVERSAL STAINLESS
STEEL W/ LIGHTS (TRUCK-LITE)
& REFLECTORS
#KMO132 CURBSIDE
#KMO133 ROADSIDE

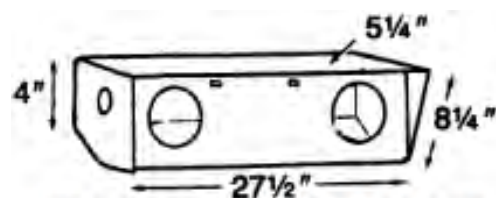

HEIL OR BUTLER STAINLESS
STEEL
#151381965 CURBSIDE
#151381966 ROADSIDE

TANK TESTING EQUIPMENT

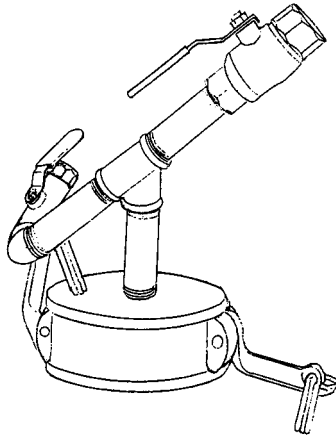

Pressure / Vacuum Cap

This device is used to create both pressure or vacuum in any tank. All that is needed is a shop air source to operate.

Part # VACTESTER

Slack-Tube Manometer

This is used to monitor the rate of leakage in a tank.

Part # 121130

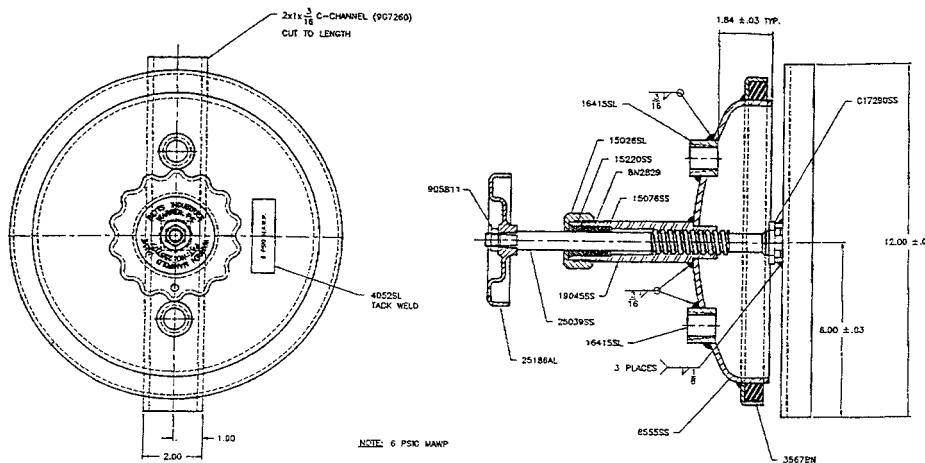
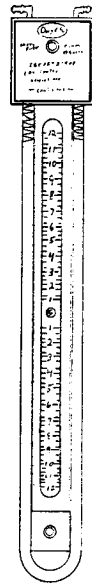

Betts™ INDUSTRIES, INC.
WARREN, PA.

PAF Manhole Test Fixture

Part # 6556LCB



Now YOU can test your vents and manholes to verify compliance to HM 183 requirements with Knappco's Combination 16" and 20" Tester.

- NEEDLE CONTROL VALVE FOR PRECISE AIR PRESSURE CONTROL
- PRESET SAFETY RELIEF VALVE
- QUICK DISCONNECT AIR FITTINGS
- HEAVY DUTY CLAMP RING
- ALUMINUM AND PLATED STEEL COMPONENTS

Part # 5428



CYGNUS FAMILY OF MULTIPLE ECHO ULTRASONIC THICKNESS GAUGES FOR THE TRUCKING INDUSTRY

Multiple echo ultrasonic metal thickness gauging means coatings such as paint, decals, and rubber lining DO NOT have to be removed in order to obtain a thickness measurement - only measures the metal - measures on rough corroded surfaces with minimal surface preparation - no grinding - fast - accurate - no false readings - repeatable results - easy to use - complies with HM183 regulations.



CYGNUS 2 PART# 050-2000

Rugged light weight ultra durable construction
- 'O' ring seal for water tight - water/dirt/shock resistant - large bright easy to read "red" LED display - display is located on "top" of the gauge - leather case with belt loop so gauge can be worn around waist - stable calibration - no calibration drift - linear accuracy over full range - no zero adjustment - metric or inch switch - operates on 3 AA batteries - variety of probe options - resolution/accuracy +/- .002" (0.05mm)



CYGNUS 4 PART# 050-4000

Rugged construction IP65 rating - sealed electronics with 'O' ring - water/dirt/shock resistant - backlit LCD display for easy viewing from bright sunlight to complete darkness - calibrates to a known thickness or a known velocity of sound - displays sound velocity of material under test - stable calibration - linear accuracy - no zero adjustment - operator controls inch or metric readout - facility to freeze measurement - variety of probe options - resolution/accuracy +/- .002" (0.05mm)

OPTIONS

MECHANICAL PIT GAUGE

- Available in inch or metric

MACHINED TEST BLOCKS

- Set of 4 test blocks
 - Stainless 304
 - Stainless 316
 - Carbon 283
 - Aluminum 5454

9-10

www.wertswelding.com

Quick Reference Charts

TTMA Flanges

Size	OD	ID	BC	No. of Holes	Hole Size
2"	4-1/2	2-7/16	3-3/4	6	7/16
3"	5-5/8	3-9/16	4-7/8	8	7/16
4"	6-5/8	4-9/16	5-7/8	8	7/16
5"	7-3/4	5-9/16	7	12	7/16
6"	9	6-11/16	8-1/8	12	7/16
8"	10-7/8	8-11/16	10-1/8	16	7/16

150 LB. ANSI Flanges

NOM PIPE SIZE	DIAM OF BOLT CIRCLE	DIAM OF BOLTS	NO OF BOLTS
1/2	2 3/4	1/2	4
3/4	2 3/4	1/2	4
1	3 3/4	1/2	4
1 1/4	3 3/4	1/2	4
1 1/2	3 3/4	1/2	4
2	4 3/4	3/4	4
2 1/2	5 1/2	3/4	4
3	6	3/4	4
3 1/2	7	3/4	8
4	7 1/2	3/4	8
5	8 1/2	3/4	8
6	9 1/2	3/4	8
8	11 3/4	3/4	8
10	14 1/4	3/4	12
12	17	3/4	12

Decimal Equivalents

1/64	.015625
1/32	.03125
3/64	.46875
1/16	.0625
5/64	.078125
3/32	.09375
7/64	.109375
1/8	.125
9/64	.140625
5/32	.15625
11/64	.171875
3/16	.1875
13/64	.203125
7/32	.21875
15/64	.234375
1/4	.250
17/64	.265625
9/32	.28125
19/64	.296875
5/16	.3125
21/64	.328125
11/32	.34375
23/64	.359375
3/8	.375
25/64	.390625
13/32	.40625
27/64	.421875
7/16	.4375
29/64	.453125
15/32	.46875
31/64	.484375
1/2	.500
33/64	.515625
17/32	.53125
35/64	.546875
9/16	.5625
37/64	.578125
19/32	.59375
39/64	.609375
5/8	.625
41/64	.640625
21/32	.65625
43/64	.671875
11/16	.6875
45/64	.703125
23/32	.71875
47/64	.734375
3/4	.750
49/64	.765625
25/32	.78125
51/64	.796875
13/16	.8125
53/64	.828125
27/32	.84375
55/64	.859375
7/8	.875

TTMA Sumps

Size	I.D.	O.D.	B.C.	No. of Studs
2, 2 1/2, 3"	5	9-1/8	6-1/4	6
4"	6	10-5/16	7-1/4	8
6"	8-3/16	12-5/8	9-1/4	12

Pipe

PIPE SIZE	O.D. in inches	10	40	80
1/8	.405	.011	.008	.005
		.1863	.2447	.3145
1/4	.540	.009	.008	.009
		.3297	.4248	.5351
3/8	.675	.009	.009	.009
		.4235	.5676	.7388
1/2	.840	.009	.009	.009
		.6710	.8510	1.088
3/4	1.050	.009	.009	.009
		.8572	1.131	1.474
1	1.315	.009	.009	.009
		1.404	1.679	2.172
1 1/4	1.660	.009	.009	.009
		1.806	2.273	2.997
1 1/2	1.900	.009	.009	.009
		2.085	2.718	3.631
2	2.375	.009	.009	.009
		2.638	3.653	5.022
2 1/2	2.875	.009	.009	.009
		3.531	5.793	7.661
3	3.500	.009	.009	.009
		4.332	7.576	10.25
3 1/2	4.0	.009	.009	.009
		4.973	9.109	12.51
4	4.50	.009	.009	.009
		5.613	10.79	14.98
4 1/2	5.0			
5	5.563	.009	.009	.009
		7.770	14.62	20.78
6	6.625	.009	.009	.009
		9.289	18.97	28.57
7	7.625			
8	8.625	.009	.009	.009
		13.40	28.55	43.39
9	9.625			
10	10.75	.009	.009	.009
		18.70	40.48	64.33

SUSPENSIONS

TRANSPRO MODEL 86 & 88 TRAILER SUSPENSION

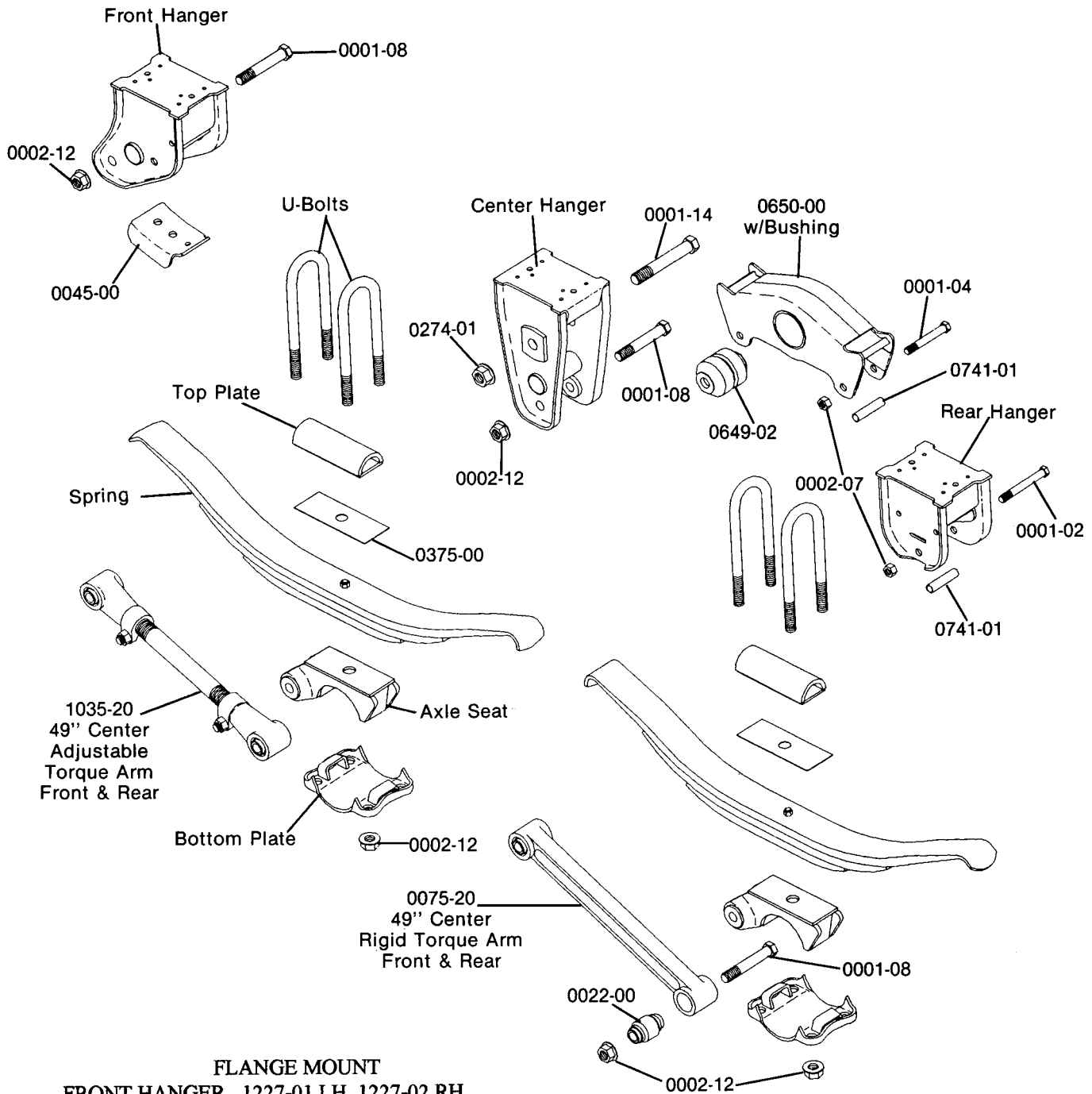

FLANGE MOUNT
 FRONT HANGER 1227-01 LH, 1227-02,RH
 CENTER HANGER 0401-00
 REAR HANGER 1228-01 LH, 1228-02 RH

MODEL 21-B TRAILER SUSPENSION

**STANDARD 49" AXLE CENTERS SHOWN
5" AXLE SEATS SHOWN**

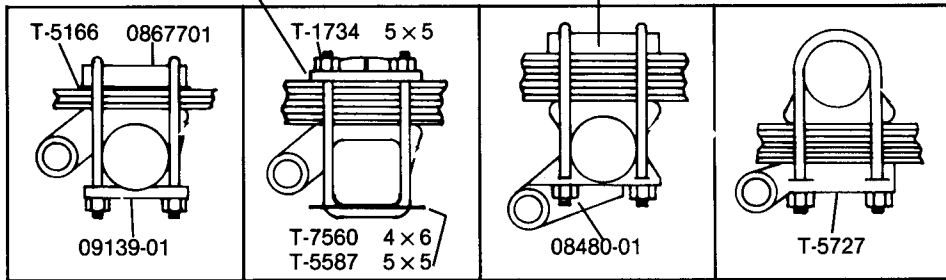
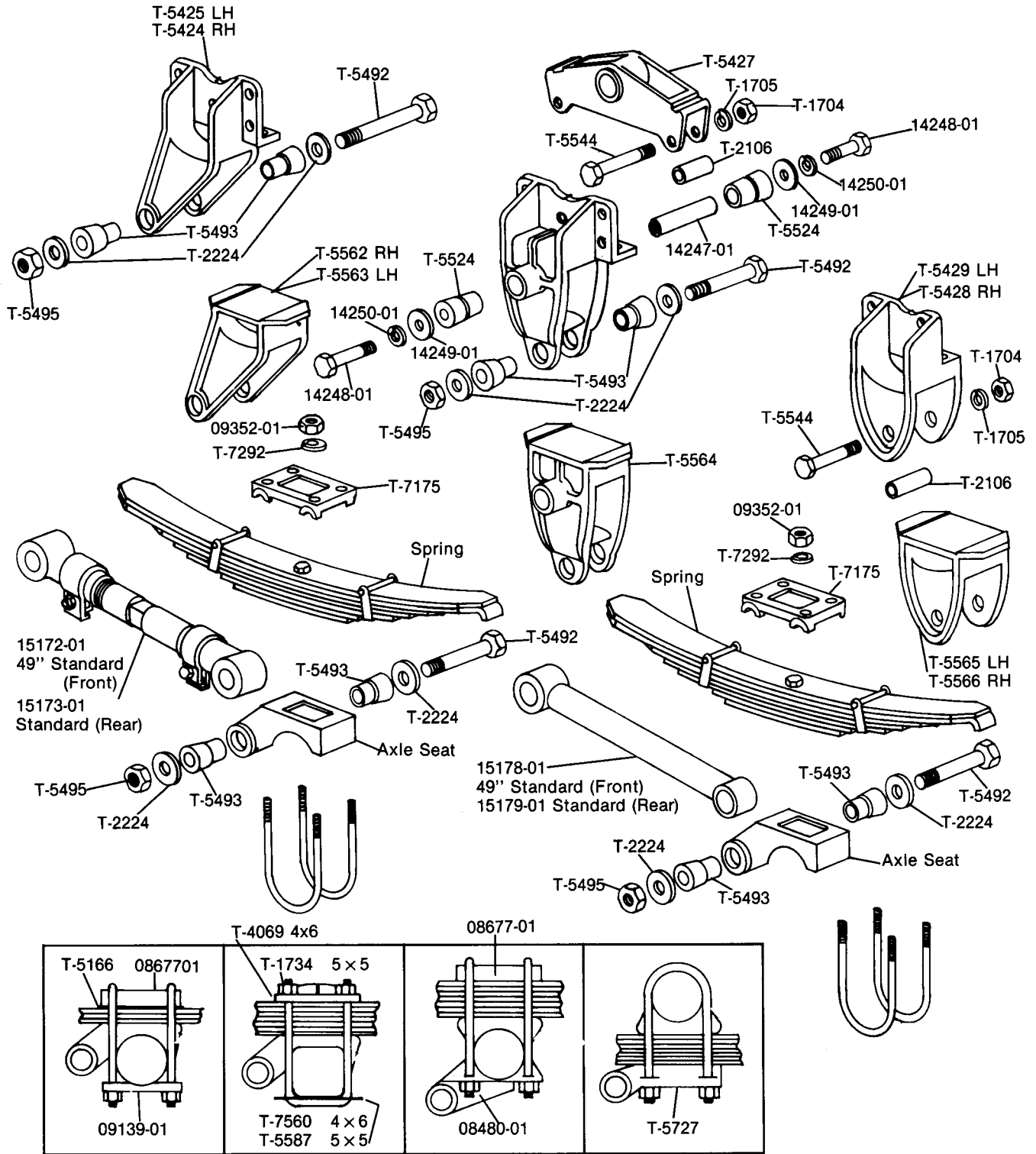

INVERTED
U-BOLTS

SQUARE AND
RECTANGLE

NO HOP
STABILIZED AXLE

UNDERSLUNG

TK18997 - Rebush (1) End of Torque Arm
TK18998 - Rebush (1) Equalizer

Leaf Springs

ORIGINAL MFG.	TRA#	OEM#	# OF LEAVES	WIDTH	ARCH
FRUEHAUF	TRA699	UXBO201	4	3	4 1/8
REYCO	TRA2270	T3564	8	3	3 5/8
REYCO *		2151101	3	3	4
TRANSPRO	TRA3340	007901	3	3	6
TRANSPRO	TRA3341	007902	3	3	3
TRANSPRO *	TRA3373	095400	3	3	2 3/4

* -- Heavy Duty

DELPHI CHASSIS "LITEFLEX" COMPOSITE TRAILER SPRINGS

PART # 21607-01
USE ON REYCO 21B -
HUTCHENS - BINKLEY
AND TRANSPRO (86-88)

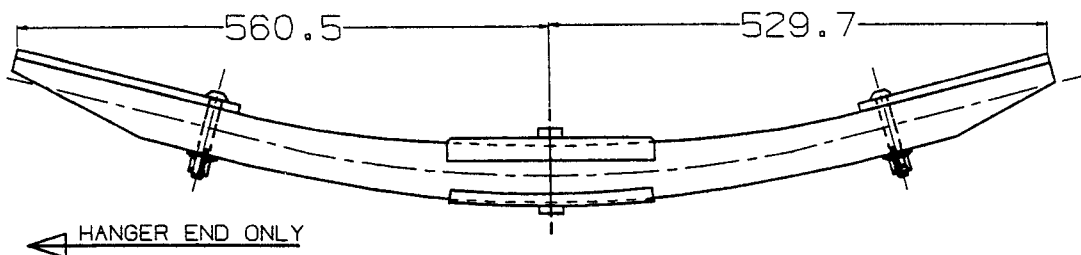

PART # 20016-01 OR 16316-01
USE ON REYCO21B -
HUTCHENS SUSPENSIONS

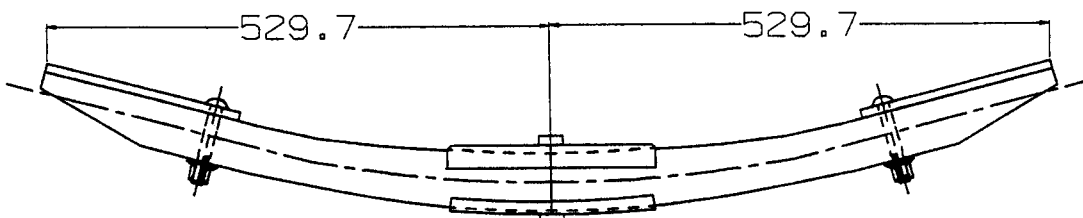

8 - 7

9-14