

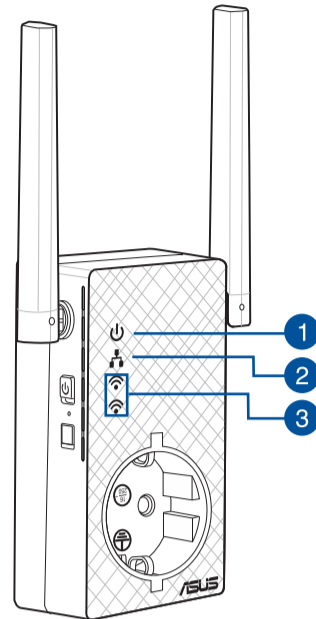

RP-AC53 Dual-band Wireless Repeater

Quick Start Guide

E11934
Second Edition
August 2016

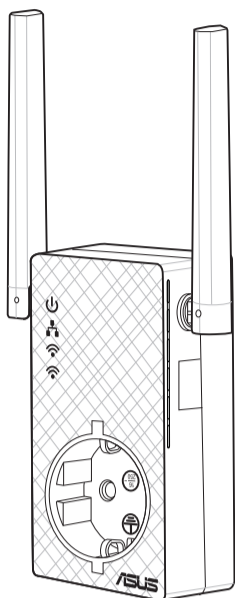

- Power LED**
On: RP-AC53 is plugged to a power outlet and powered on.
Off: RP-AC53 is unplugged from a power outlet or powered off.
- Ethernet LED**
On: Ethernet is connected.
Off: Ethernet cable is disconnected.
- 2.4 GHz / 5 GHz Wi-Fi LED**
Green : Best 2.4 GHz / 5 GHz Wi-Fi Repeater connection with parent AP.
Orange: Good 2.4 GHz / 5 GHz Wi-Fi repeater connection with parent AP.
Red: Poor 2.4 GHz / 5 GHz Wi-Fi Repeater connection with parent AP.
Off: Disconnected from parent AP.

Method One Quick Setup with WPS (Wi-Fi Protected Setup) For router/Access Point(AP) with WPS support

1 Power On

Place your RP-AC53 near your router/AP and plug it to a power outlet.



Press the power switch to ON. Wait until the power LED turns solid green and Wi-Fi LEDs stop blinking, indicating that RP-AC53 is ready to connect to the parent AP.

2 Connect via WPS (Wi-Fi Protected Setup)

Connect via WPS (Wi-Fi Protected Setup)

1. Press the WPS button on your Router/AP.
2. Press the WPS button on your RP-AC53 for more than five (5) seconds until the LEDs start to blink.

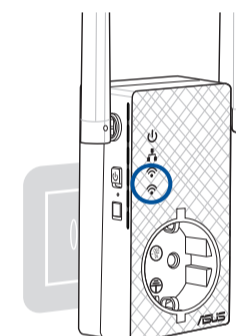
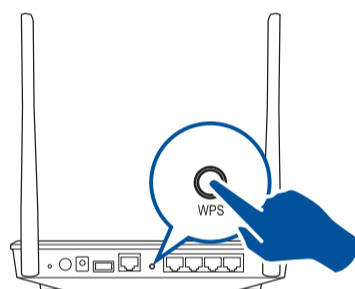

The LEDs flash about two (2) minutes and turn solid green. The color of the LED indicates the Wi-Fi signal strength.

NOTE: Ensure that your router/AP supports WPS. Otherwise, use Method TWO.

3 Place in an ideal location

After placing your RP-AC53 in an ideal location, RP-AC53 connects to your router/AP in about one (1) minute.

NOTES:

- Place your RP-AC53 between your router/AP and wireless device to get the best extender performance.
- Place your RP-AC53 in a location where you can get green or orange Wi-Fi LED.

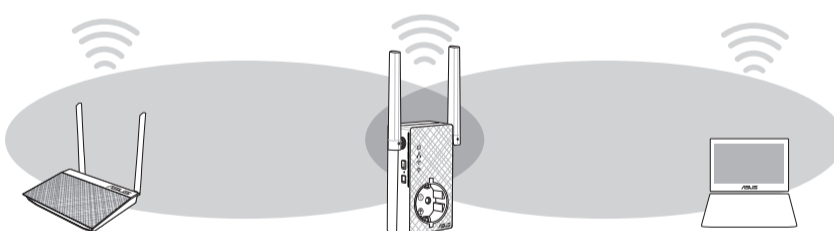

IMPORTANT! We recommend that you place your RP-AC53 in open or spacious location.

Enjoy!



Your RP-AC53's wireless network name (SSID) changes to your existing Wi-Fi network name, ending with **_RPT** or **_RPT5G** and shares your router/AP's Wireless Password.

Frequently Asked Questions (FAQ)

Q1: What should I do if my router does not support WPS?

A1: You can use Method Two to set up RP-AC53.

Q2: What should I do when only one band Wi-Fi LED is on?

A2: When you are connecting to a dual-band router but only 2.4 GHz or 5 GHz Wi-Fi LED is on, press the WPS button on both the router and the RP-AC53 again and check that both 2.4 GHz and 5 GHz Wi-Fi LEDs are on.

Q2: How do I reset RP-AC53?

A2: Press the RESET button on the side of RP-AC53 for about five (5) seconds until the LEDs blink slowly.

Q4: What should I do if RP-AC53 web interface is not accessible?

- A4: You can do any of the following:
- Connect your computer and RP-AC53 using an Ethernet cable, and connect to RP-AC53's SSID or network name.
 - Set up your computer to obtain an IP address automatically.
 - On a web browser, ensure that you correctly enter the web address <http://repeater.asus.com>

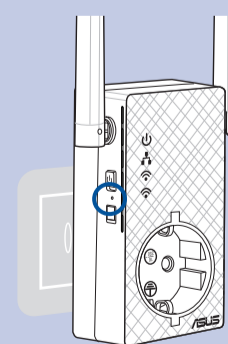

Method Two

Set up using your web browser

1 Power On

Place your RP-AC53 near your router/AP and plug it to a power outlet.



Wait until the power LED turns solid green and Wi-Fi LEDs stop blinking, indicating that RP-AC53 is ready to connect to parent AP.

2 Login

Disconnect your Ethernet connection. On your Wi-Fi enabled device, such as your desktop PC/notebook/tablet, find the default network name of your RP-AC53 and click or tap **Connect**.

NOTE: The screenshot below is from a desktop PC.

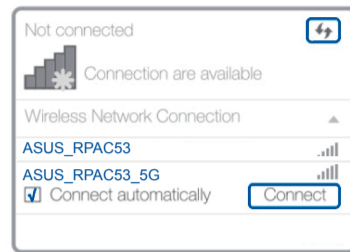

On a web browser, enter <http://repeater.asus.com> to access RP-AC53 web GUI (graphical user interface). Enter **admin** as the username and password.

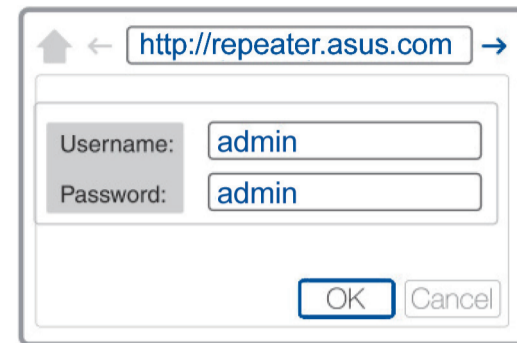

3 Configure RP-AC53

IMPORTANT! For the best Wi-Fi extender performance, place your RP-AC53 in an ideal location. Refer to Step 3 in Method One

1. On a web browser, enter <http://repeater.asus.com>.
2. Connect to a Wi-Fi network and when prompted, enter the security key. If your Wi-Fi network is hidden, click **Manual setting**.

3. You can either tick **Copy AP SSID/Password, Use the default setting** or enter the SSID and security key/password for your extended network. When done, click **Connect**.

NOTE: When you have ticked **Use the default setting**, your RP-AC53's wireless network name (SSID) changes to your existing Wi-Fi network name, ending with **_RPT** or **_RPT5G** and shares your router/AP's Wireless Password.

4. Connect your wireless devices to the new Extender network.

4 Place in an ideal location

After placing your RP-AC53 in an ideal location, RP-AC53 connects to your router/AP in about one (1) minute.

NOTES:

- Place your RP-AC53 between your router/AP and wireless device to get the best extender performance.
- Place your RP-AC53 in a location where you can get green or orange Wi-Fi LED.

IMPORTANT! We recommend that you place your RP-AC53 in open or spacious location.



Enjoy!

Your RP-AC53's wireless network name (SSID) changes to your existing Wi-Fi network name, ending with **_RPT** or **_RPT5G** and shares your router/AP's Wireless Password.

Connect your wireless devices to the new Extender network and then start to surf the Internet.

NOTE: If you have renamed your extended network name in step 3, your RP-AC53's SSID will change accordingly.

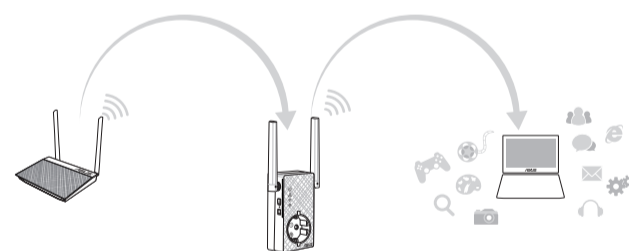

Media Bridge (Ethernet Adapter)

Set up RP-AC53 via Method One or Method Two, then you can use it as a wireless adapter to connect Ethernet devices such as Blu-ray player, game console, DVR, or smart TV.

Ethernet Connection

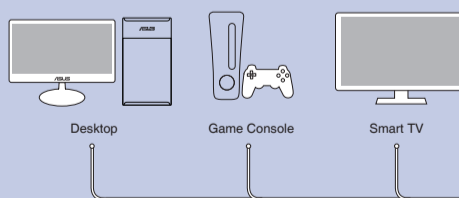

Wireless Connection

