

Contents:

- 1 – Enclosure
- 1 – Aluminum Mounting Plate
- 1 – Mounting Template
- 1 – Hardware Kit
 - (2) Adhesive Mounting Clips
 - (1) RTV Silicone Sealant Pack
 - (6) # 10-32 x 3/8" Screws
 - (2) # 6-32 x 1/4" Screws
 - (1) UTP *MINI-COM* TX6 Plus Jack Module
 - (1) 2 Position Surface Mount Box
 - (2) UTP 2' CAT 6 Patch Cord
 - (4) Cable Ties

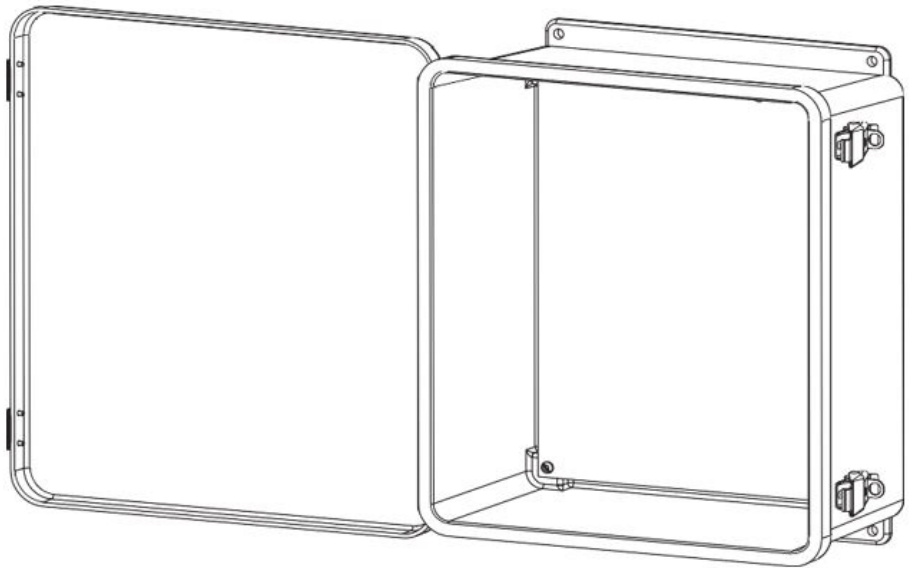

PZNWE12 (Shown Open)

Note: Installer should use the following assembly instructions as a guideline to mount desired Wireless Access Point (WAP), External Antennas, and Powering Device. In the following instructions a *CISCO AIRONET* AIR-AP1242AG WAP is shown being installed, however any similar sized WAP with external antennas can be installed in a similar manner.

Assembly Instructions:

1. Use the supplied Mount Template as a guide to locate the hole locations required on the Aluminum Mounting Plate. The supplied template reflects the use of a *CISCO* 1200 series wireless access point using POE for power supply.

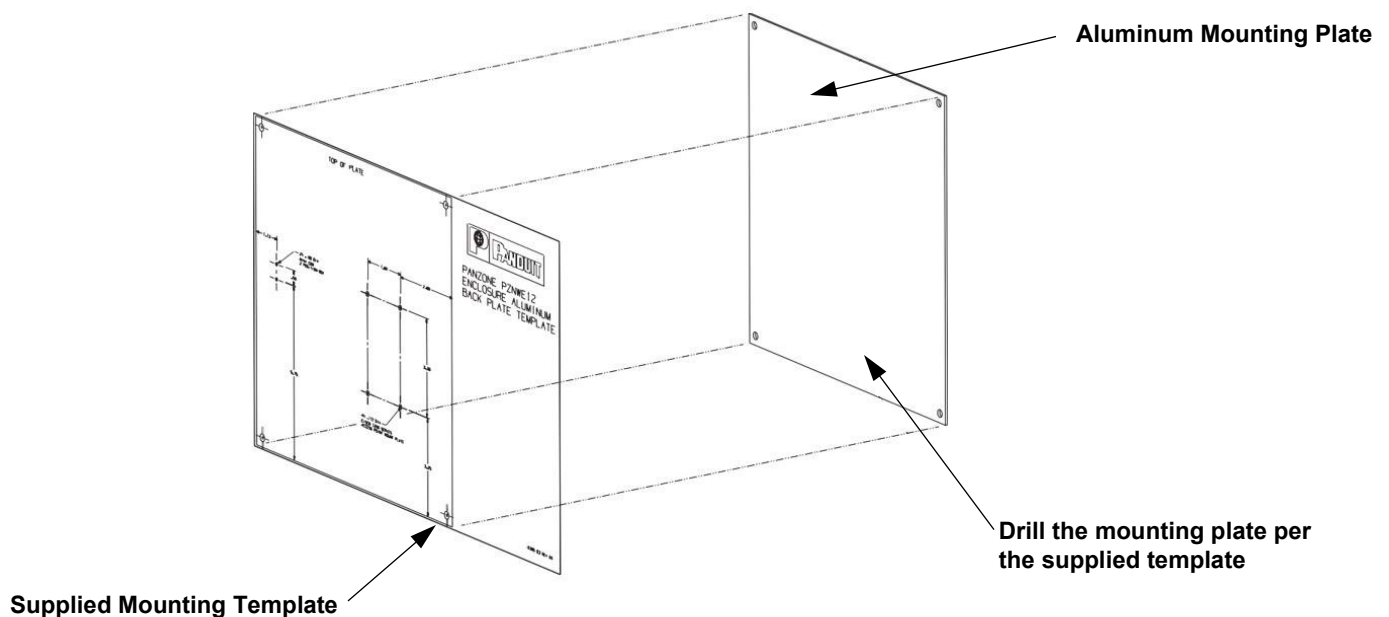

2. Attach the Mounting Plate to the enclosure with the supplied # 10-32 x 3/8" screws and washers.

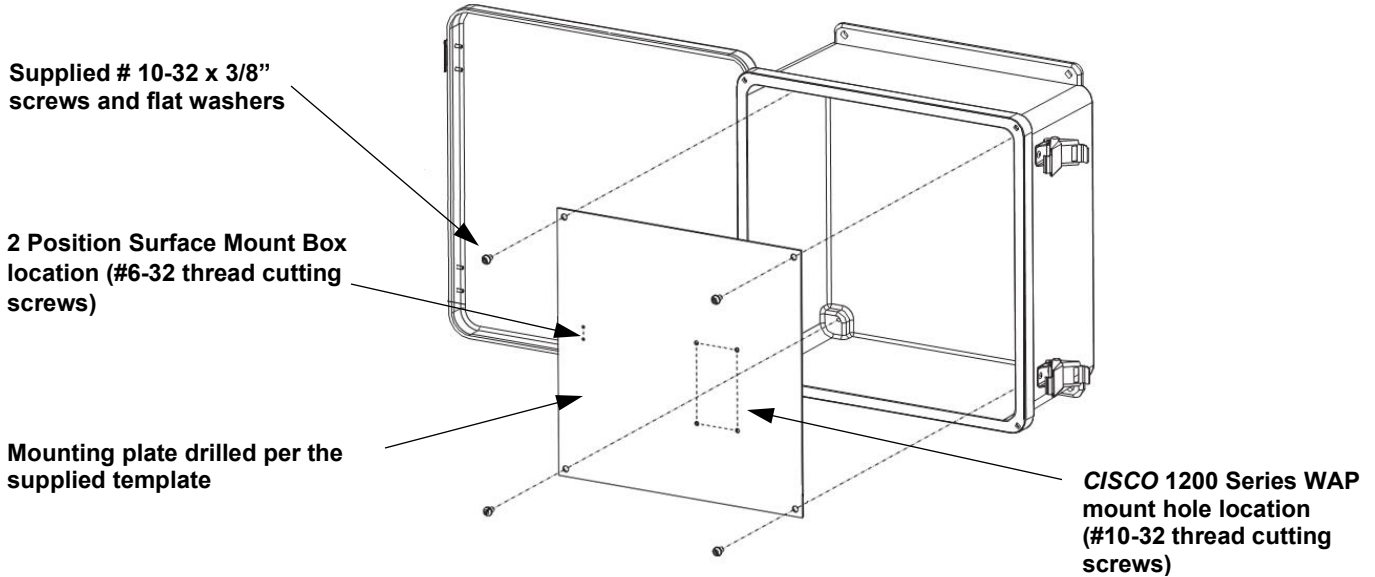

3. For incoming cables install a cord grip or conduit fitting on the bottom surface of the enclosure in line with supplied surface mount box. Apply RTV silicone to the surface of the collar of the cord grip to maintain a liquid tight seal.

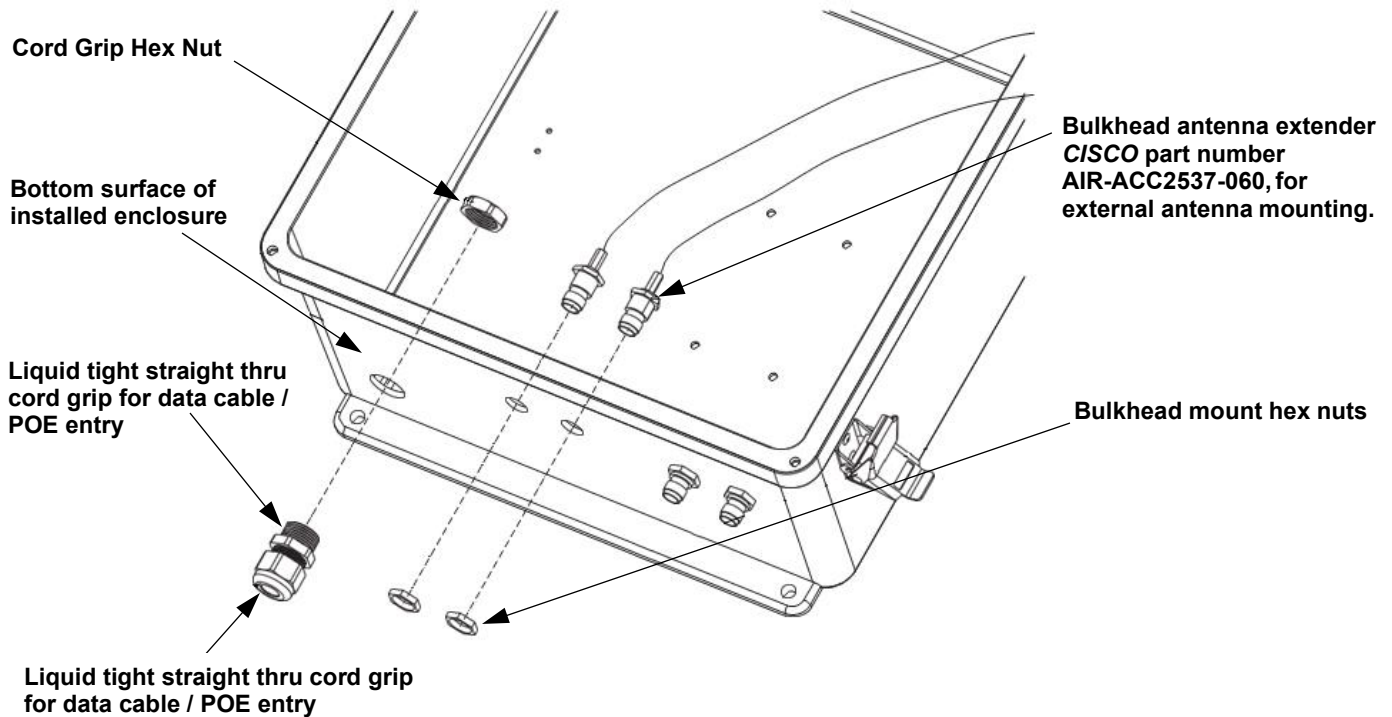

4. Install a bulkhead antenna extender, such as CISCO part number AIR-ACC2537-060 to the bottom surface of the enclosure as shown. Apply RTV silicone to the surface of the collar of the extender to maintain a liquid tight seal. The desired mount hole diameter is .53".

5. Fasten the 2 position surface mount box base and the WAP mount plate to the aluminum back plate with the supplied thread forming screws.

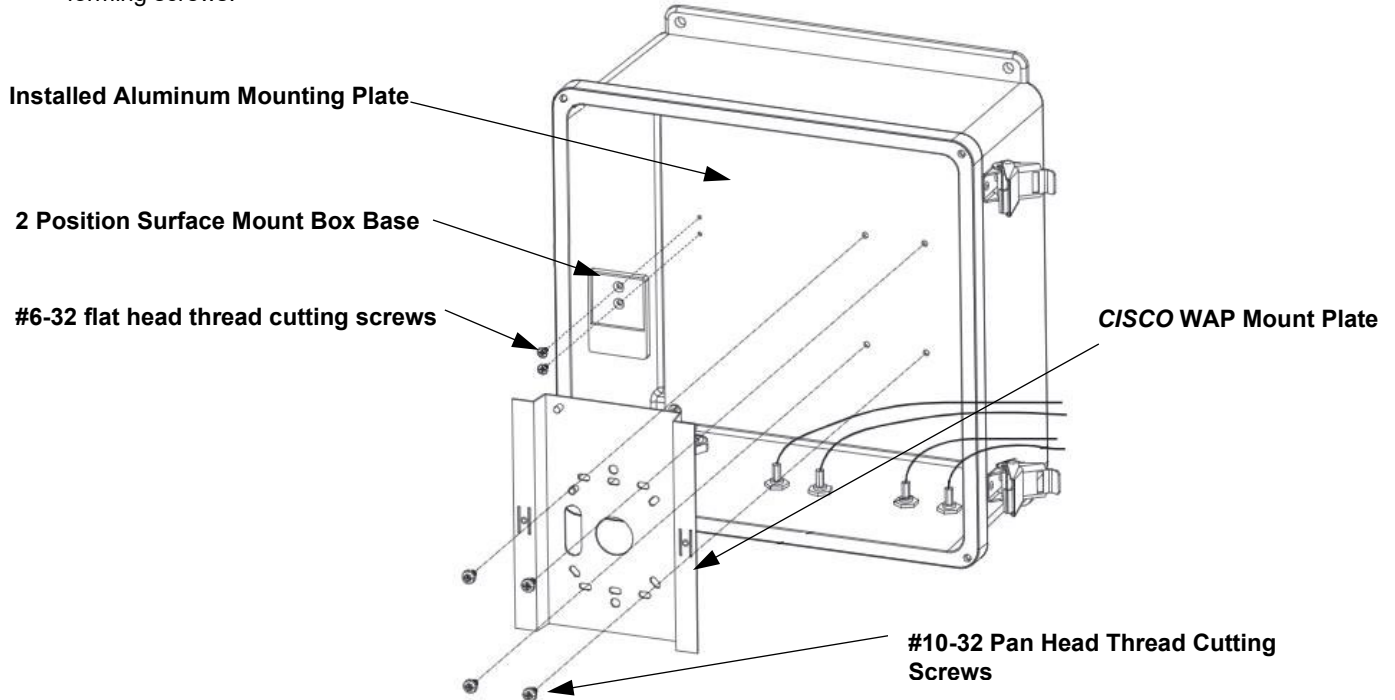

6. Run the network cable into the enclosure and terminate to the *MINI-COM* TX6 jack module installed in the surface mount box. Insert one end of the 2' patch cord supplied into the opposite end of the jack module and route to the wireless access point RJ45 port as shown.

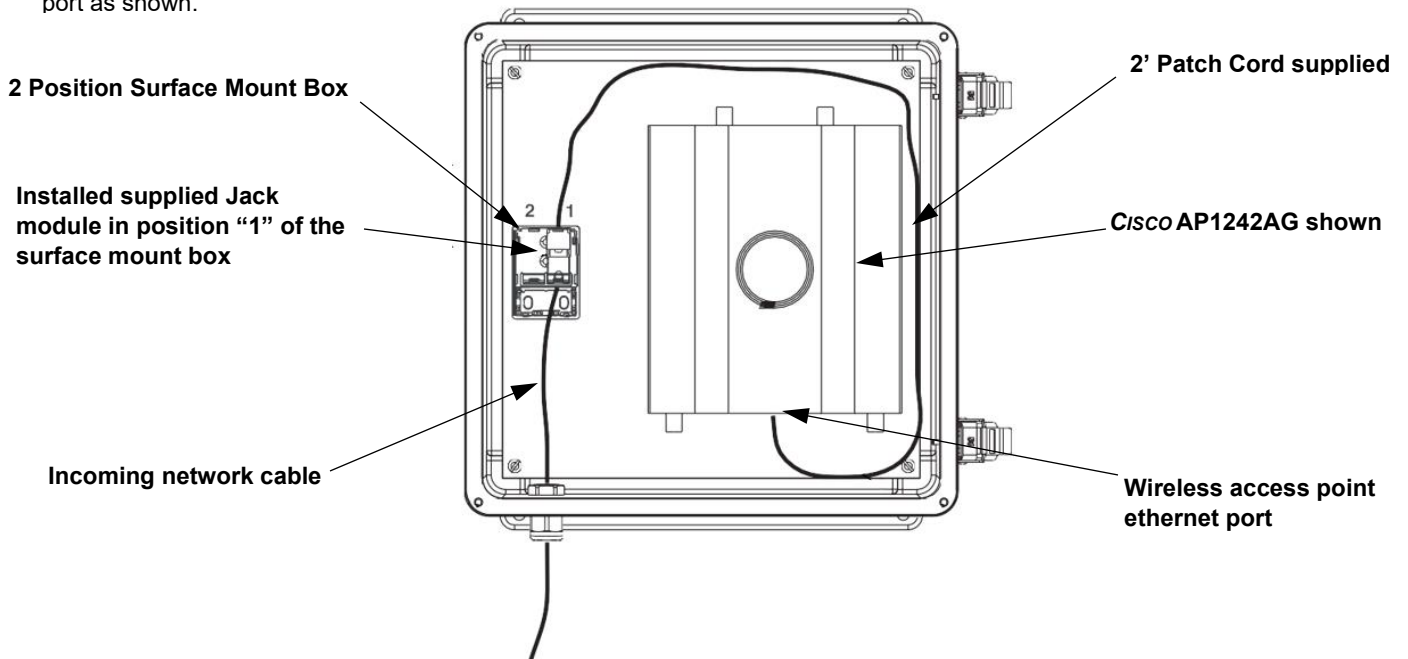

- Attach the required external antennas to the bulkhead fittings installed on the bottom surface of the enclosure. Wrap the excess bulkhead cable slack around the mounted wireless access point.

